

SUBMITTAL TO THE BOARD OF SUPERVISORS
COUNTY OF RIVERSIDE, STATE OF CALIFORNIA

410 B



SUBMITTAL DATE:
November 7, 2008

FROM: TLMA - Transportation Department

SUBJECT: Plot Plan 19469 (Flood Control Facilities)
A Subdivision in the Sun City Area
Subdivision Improvement Agreements

RECOMMENDED MOTION: That the Board approve the attached Subdivision Improvement Agreements as approved by County Counsel.

BACKGROUND: The developer desires to enter into Improvement Agreements to guarantee the construction of the required improvements and has submitted Improvement Agreements and Securities which have been approved by County Counsel.

This project is located within the new City of Menifee boundaries. Since the original bonds and agreements were entered into by the County as the beneficiary, the County will continue to administer this agreement in consultation with the City.

Juan C. Perez
Director of Transportation

HS:lf
Submittals: Vicinity Map
Road/Drainage (Flood) Agrmts

REVIEWED BY EXECUTIVE OFFICE

DATE 11/21/08
Departmental Concurrence Tina Grande

FORM APPROVED COUNTY COUNSEL

BY: PAMELA J. WALLS DATE 10/30/08

Policy

Consent

Dep't Recomm.:
Per Exec. Ofc.:

Prev. Agn. Ref.

District: 3

Agenda Number:

ATTACHMENTS FILED
WITH THE CLERK OF THE BOARD

2.23



Plot Plan 19469

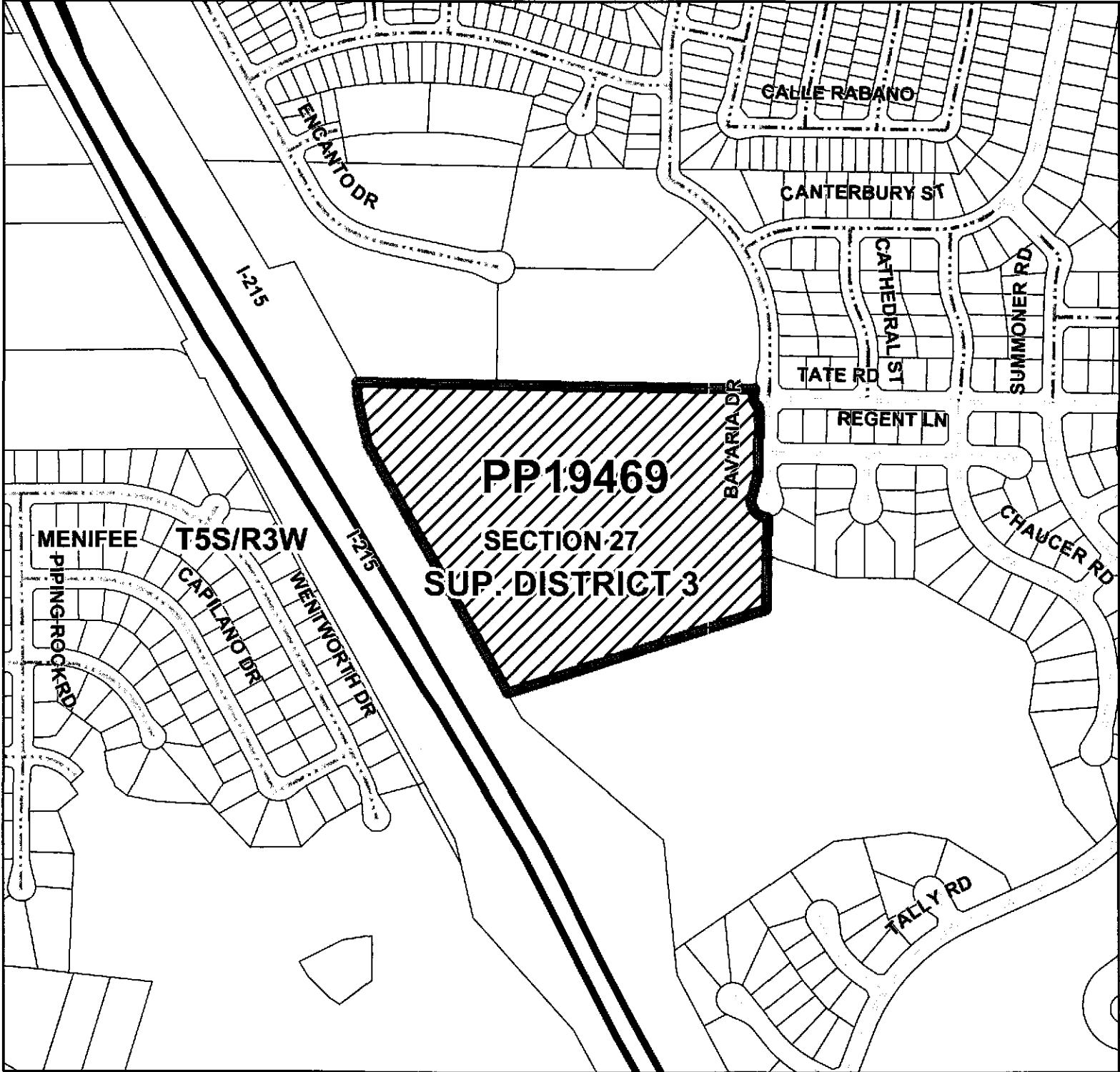

Roadway Legend

- | | | |
|--|-----------------------------|-------------|
| FEDERAL AID INTERSTATE; STATE HIGHWAYS | NON-COUNTY ROAD | HWY |
| F.A.S./F.A.U. MAINTAINED | CITY ROAD | INTERCHANGE |
| PAVED SURFACE MAINTAINED | UNDEFINED | INTERSTATE |
| GRAVELED SURFACE MAINTAINED | ABANDON | OFFRAMP |
| DIRT SURFACE MAINTAINED | VACATED | ONRAMP |
| ACCEPTED FOR PUBLIC USE | CITY OR WILDOMAR MAINTAINED | USHWY |