

SUBMITTAL TO THE BOARD OF SUPERVISORS
COUNTY OF RIVERSIDE, STATE OF CALIFORNIA

511 B



SUBMITTAL DATE:
December 8, 2008

FROM: TLMA - Transportation Department

SUBJECT: Miscellaneous Case 3953 (Lake Elsinore Tract 25479)
A Subdivision in Lake Elsinore Area
Extension of Time Agreements

RECOMMENDED MOTION: That the Board approve the attached Subdivision Improvement Agreements as approved by County Counsel.

BACKGROUND: The developer desires to enter into extension of time agreements (which grant an extension of time for twelve months to complete improvements), and has submitted agreements and securities which have been approved by County Counsel.

REVIEWED BY EXECUTIVE OFFICE
DATE 12/10/08
Departmental Concurrence
Tice, Glenn

FORM APPROVED COUNTY COUNSEL
BY: Elena M. Boeva 11/12/08
DATE
ELENA M. BOEVA



Juan C. Perez
Director of Transportation

HS:lf
Submittals: Vicinity Map
Water System Agrmts
Sewer System Agrmts

Policy

Consent

Dept's Recomm.:
Per Exec. Ofc.:

Prev. Agn. Ref.

District: 1

Agenda Number:

ATTACHMENTS FILED
WITH THE CLERK OF THE BOARD

2.8



Miscellaneous Case 3953 (Tract 25479)

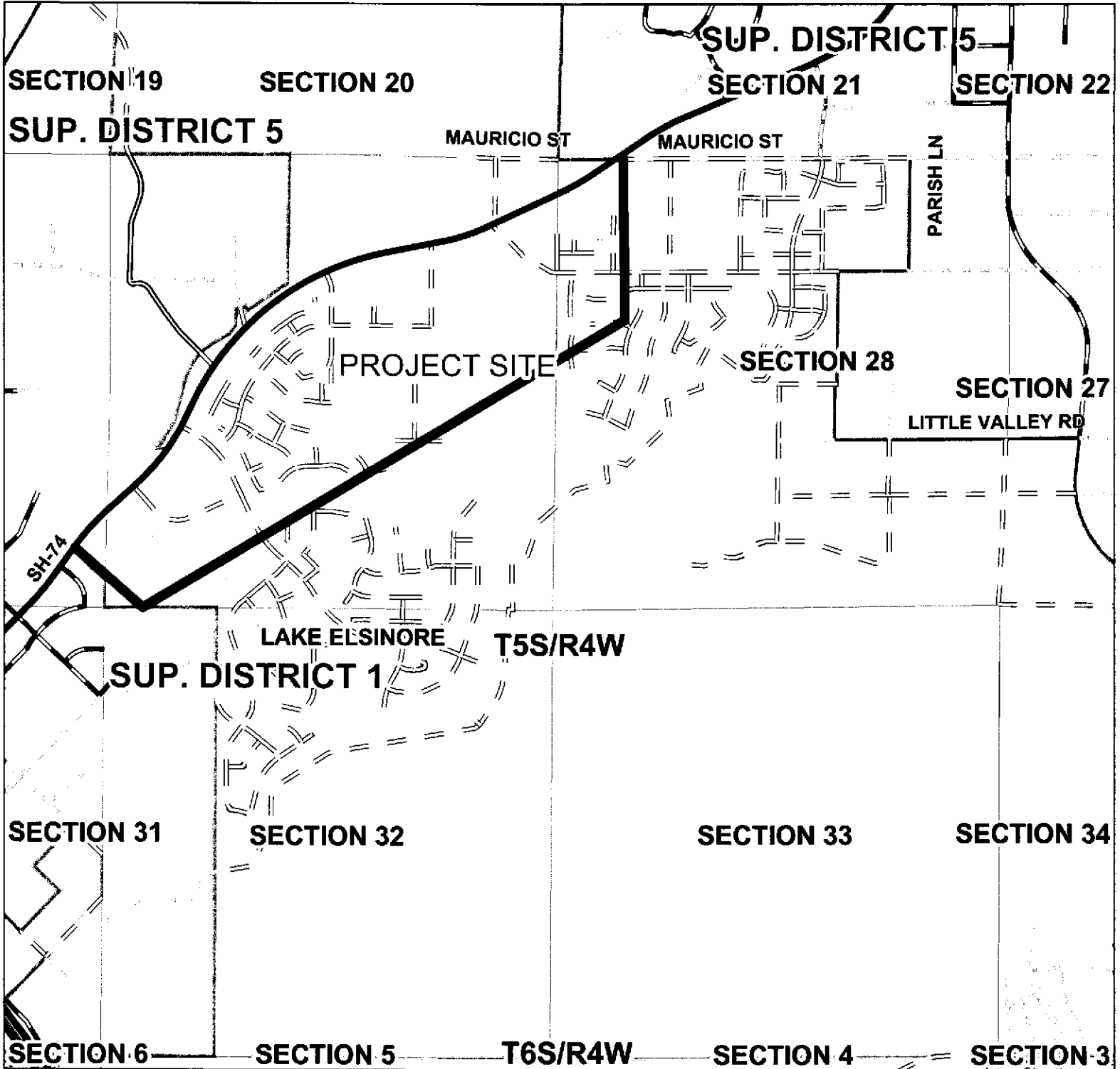

Roadway Legend

- | | | |
|--|-----------------------------|-------------|
| FEDERAL AID INTERSTATE: STATE HIGHWAYS | NON-COUNTY ROAD | HWY |
| F.A.S./F.A.U. MAINTAINED | CITY ROAD | INTERCHANGE |
| PAVED SURFACE MAINTAINED | UNDEFINED | INTERSTATE |
| GRAVELED SURFACE MAINTAINED | ABANDON | OFFRAMP |
| DIRT SURFACE MAINTAINED | VACATED | ONRAMP |
| ACCEPTED FOR PUBLIC USE | CITY OR WILDOMAR MAINTAINED | USHWY |