

**SUBMITTAL TO THE BOARD OF SUPERVISORS
COUNTY OF RIVERSIDE, STATE OF CALIFORNIA**

916B



SUBMITTAL DATE:
January 15, 2009

FROM: TLMA - Transportation Department

SUBJECT: Tract 30656
A Schedule "A" Subdivision in the Wildomar Area
Extension of Time Agreements

RECOMMENDED MOTION: That the Board approve the attached agreements (which grant an extension of time for twelve months to complete improvements).

BACKGROUND: On October 2, 2007, the Board entered into agreements with Beazer Homes Holdings Corporation for the improvement of streets and the installation of a water and sewer system within the above referenced subdivision. The required improvements have been partially completed in accordance with the approved plans, and the faithful performance securities are now posted by Arch Insurance Company as follows:

- \$500,000 - Bond #SU5010780 for the completion of street improvements
- \$65,800 - Bond #SU5010780 for the completion of the water system
- \$48,900 - Bond #SU5010780 for the completion of the sewer system

The developer requests an extension of time for the completion of this project. Our records indicate that this project is approximately 90% completed for streets and utility work. The agreements for the extension of time have been approved by County Counsel. **(Continued)**

Juan C. Perez
Director of Transportation

HS:lf
Submittals: Vicinity Map
Road/Drainage Agrmts
Water System Agrmts
Sewer System Agrmts

REVIEWED BY EXECUTIVE OFFICE

DATE 1/14/09
Tina Grande

FORM APPROVED COUNTY COUNSEL

BY: Elena M. Soeva
DATE 12/24/08

Departmental Concurrence

Policy

Consent

Dept's Recomm.:
Per Exec. Ofc.:

Prev. Agn. Ref. 10/02/07 - 2.36

District: 3

Agenda Number:

The Honorable Board of Supervisors

RE: Tract 30656

Page 2 of 2

This project is located within the new City of Wildomar boundaries. Since the original bonds and agreements were entered into by the County as the beneficiary, the County will continue to administer this agreement in consultation with the City.

Vicinity Map

Tract 30656



The County of Riverside assumes no warranty or legal responsibility for the information contained on the map. Data and information represented on the map is subject to updates, modifications and may not be complete or appropriate for all purposes. County GIS and other sources should be queried for the most current information. Do not copy or resell this map.

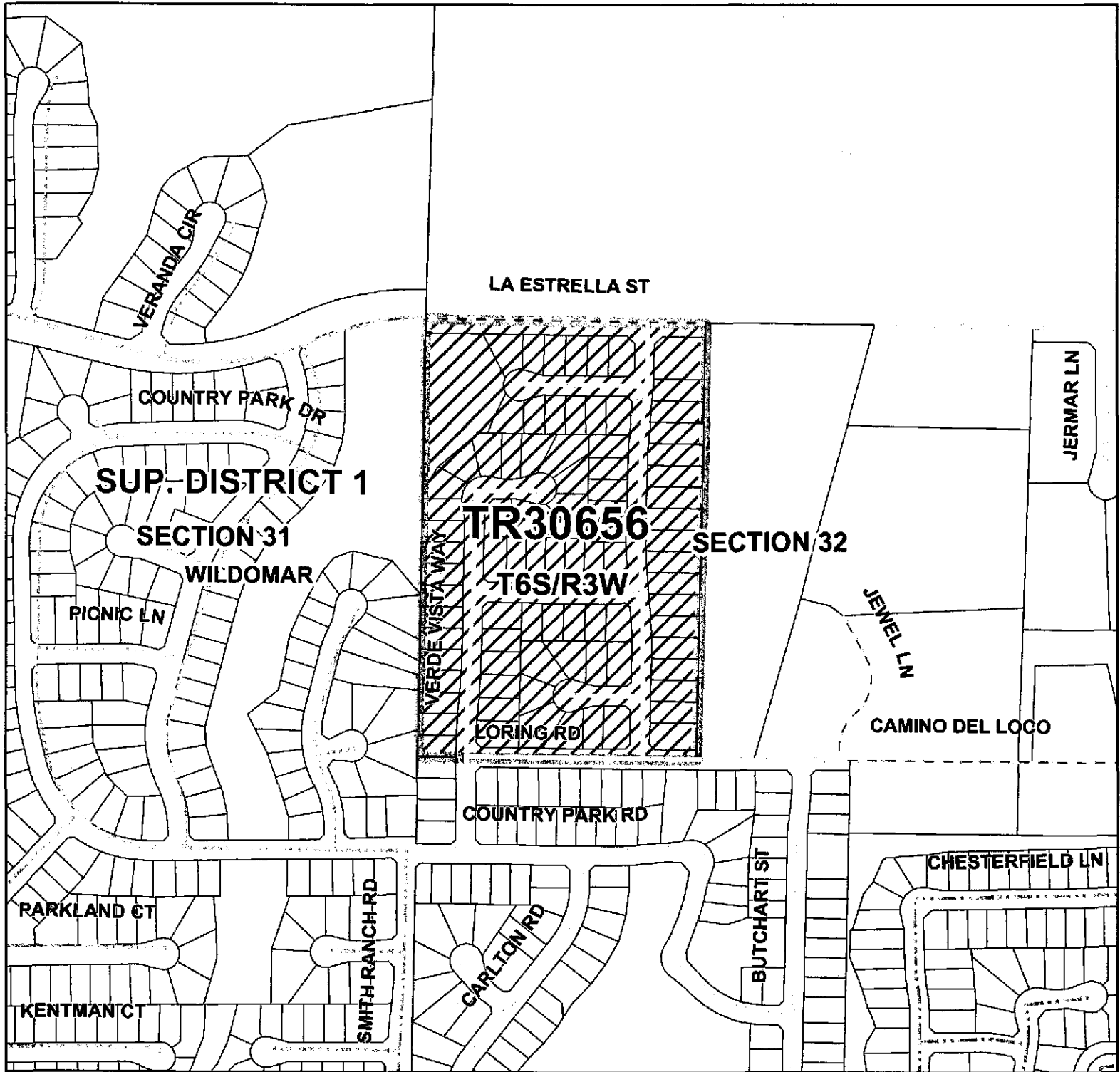

Roadway Legend

- | | | |
|--|-----------------------------|-------------|
| FEDERAL AID INTERSTATE; STATE HIGHWAYS | NON-COUNTY ROAD | HWY |
| F.A.S./F.A.U. MAINTAINED | CITY ROAD | INTERCHANGE |
| PAVED SURFACE MAINTAINED | UNDEFINED | INTERSTATE |
| GRAVELED SURFACE MAINTAINED | ABANDON | OFFRAMP |
| DIRT SURFACE MAINTAINED | VACATED | ONRAMP |
| ACCEPTED FOR PUBLIC USE | CITY OR WILDOMAR MAINTAINED | USHWY |