

SUBMITTAL TO THE BOARD OF SUPERVISORS
COUNTY OF RIVERSIDE, STATE OF CALIFORNIA

207B



FROM: TLMA - Transportation Department

SUBMITTAL DATE:

January 15, 2009

SUBJECT: Tract 29208-1
A Schedule "A" Subdivision in the Eastvale Area
Extension of Time Agreements

RECOMMENDED MOTION: That the Board approve the attached agreements (which grant an extension of time for twelve months to complete improvements).

BACKGROUND: On September 26, 2006, the Board entered into agreements with Western Pacific Housing, Inc. for the improvement of streets and the installation of a water and sewer system within the above referenced subdivision. Accompanying these agreements were faithful performance securities posted by Travelers Casualty and Surety Company of America as follows:

- \$2,653,500 - Bond #093SB103657470BCM for the completion of street improvements
- \$378,000 - Bond #093SB103657471BCM for the completion of the water system
- \$609,000 - Bond #093SB103657472BCM for the completion of the sewer system

The developer requests an extension of time for the completion of this project. Our records indicate that this project is approximately 90% completed for streets and utility work. The agreements for the extension of time have been approved by County Counsel.

Juan C. Perez
Director of Transportation

HS:lf

Submittals: Vicinity Map
Road/Drainage Imprv Agrmts
Water System Imprv Agrmts
Sewer System Imprv Agrmts

REVIEWED BY EXECUTIVE OFFICE

DATE 1/26/09 Tina Grande

FORM APPROVED COUNTY COUNSEL
BY: Elena M. Boeva 12/18/08
DATE

Policy

Consent

Dept's Recomm.:
Per Exec. Ofc.:

Prev. Agn. Ref. 09/26/06 - 2.18

District: 2

Agenda Number:

ATTACHMENTS FILED
WITH THE CLERK OF THE BOARD

2.8

Vicinity Map



The County of Riverside assumes no warranty or legal responsibility for the information contained on this map. Data and information represented on this map is subject to updates, modifications and may not be complete or appropriate for all purposes. County GIS and other sources should be queried for the most current information. Do not copy or reuse this map.

TR 29208-1

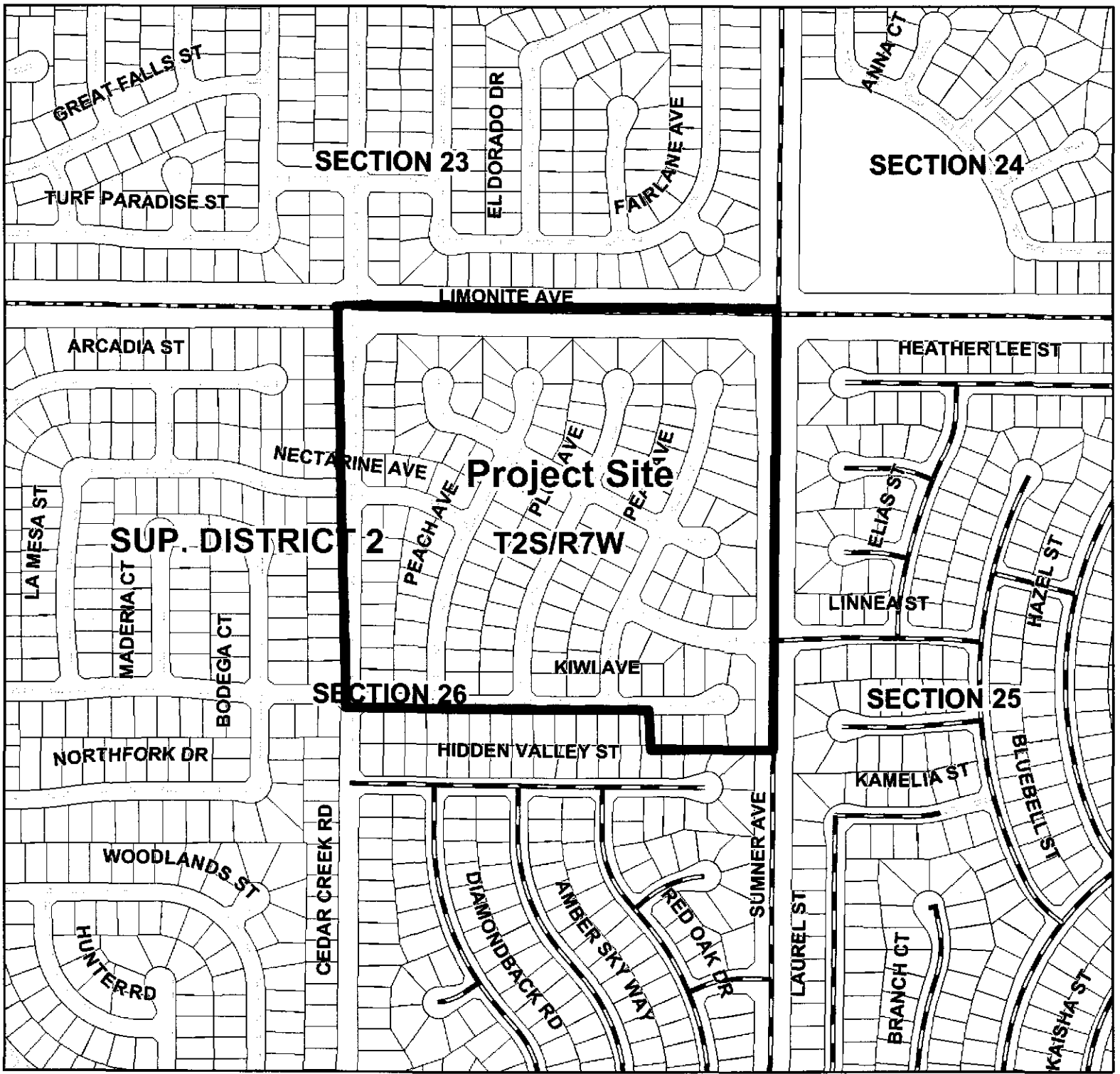

Roadway Legend

- | | | |
|----------------------------------------|-----------------------------|-------------|
| FEDERAL AID INTERSTATE; STATE HIGHWAYS | NON-COUNTY ROAD | HWY |
| F.A.S./F.A.U. MAINTAINED | CITY ROAD | INTERCHANGE |
| PAVED SURFACE MAINTAINED | UNDEFINED | INTERSTATE |
| GRAVELED SURFACE MAINTAINED | ABANDON | OFFRAMP |
| DIRT SURFACE MAINTAINED | VACATED | ONRAMP |
| ACCEPTED FOR PUBLIC USE | CITY OR WILDOMAR MAINTAINED | USHWY |