

**SUBMITTAL TO THE BOARD OF SUPERVISORS
COUNTY OF RIVERSIDE, STATE OF CALIFORNIA**

406 B



FROM: TLMA - Transportation Department

SUBMITTAL DATE:
February 11, 2009

SUBJECT: Tract 30695
A Schedule "A" Subdivision in the Murrieta Area
Extension of Time Agreements

RECOMMENDED MOTION: That the Board approve the attached agreements (which grant an extension of time for twelve months to complete improvements).

BACKGROUND: On August 29, 2006, the Board entered into agreements with Lennar Spencer's Crossing, LLC for the improvement of streets and the installation of a water and sewer system within the above referenced subdivision. Accompanying these agreements were faithful performance securities posted by Fidelity and Deposit Company of Maryland as follows:

- \$1,007,000 - Bond #08821725 for the completion of street improvements
- \$182,000 - Bond #08821725 for the completion of the water system
- \$183,500 - Bond #08821725 for the completion of the sewer system
- \$35,900 - Bond #08821726 for the completion of the monumentation

The developer requests an extension of time for the completion of this project. Our records indicate that this project is approximately 90% completed for streets and utility work. The agreements for the extension of time have been approved by County Counsel.

Juan C. Perez
Director of Transportation

HS:lf
Submittals: Vicinity Map
Road/Drainage Imprv Agrmts
Water System Imprv Agrmts
Sewer System Imprv Agrmts
Monumentation Agreements

REVIEWED BY EXECUTIVE OFFICE
DATE 2/11/09
Tina Grande
Departmental Concurrence

FORM APPROVED COUNTY COUNSEL
BY: Elena M. Boeva 01/08/09
ELENA M. BOEVA
DATE

Policy
 Policy

Consent
 Consent

Dept't Recomm.:
Per Exec. Ofc.:

Prev. Agn. Ref. 08/29/06 - 2.10 | District: 3 | Agenda Number:

2.25

Vicinity Map



The County of Riverside assumes no warranty or legal responsibility for the information contained on this map. Data and information represented on this map is subject to updates, modifications and may not be complete or appropriate for all purposes. County GIS and other sources should be queried for the most current information. Do not copy or reuse this map.

Tract 30695

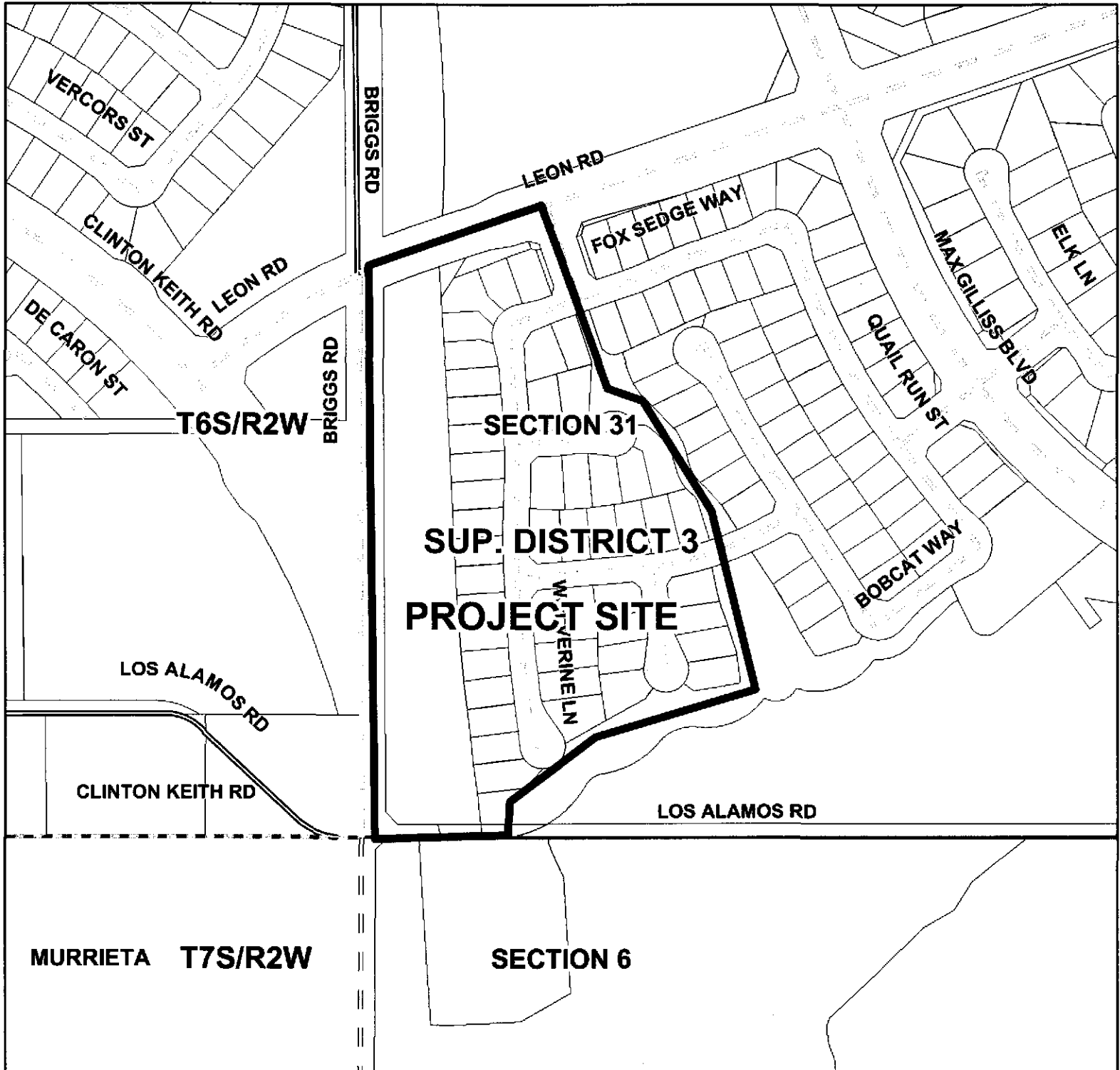

Roadway Legend

- | | | |
|--|-----------------------------|-------------|
| FEDERAL AID INTERSTATE; STATE HIGHWAYS | NON-COUNTY ROAD | HWY |
| F.A.S./F.A.U. MAINTAINED | CITY ROAD | INTERCHANGE |
| PAVED SURFACE MAINTAINED | UNDEFINED | INTERSTATE |
| GRAVELED SURFACE MAINTAINED | ABANDON | OFFRAMP |
| DIRT SURFACE MAINTAINED | VACATED | ONRAMP |
| ACCEPTED FOR PUBLIC USE | CITY OR WILDOMAR MAINTAINED | USHWY |