

**SUBMITTAL TO THE BOARD OF SUPERVISORS
COUNTY OF RIVERSIDE, STATE OF CALIFORNIA**

508B



FROM: TLMA - Transportation Department

SUBMITTAL DATE:
March 2, 2009

SUBJECT: Tract 30817
A Schedule "A" Subdivision in the Eastvale Area
Extension of Time Agreements

RECOMMENDED MOTION: That the Board approve the attached agreements (which grant an extension of time for twelve months to complete improvements).

BACKGROUND: On October 30, 2007, the Board entered into agreements with North Corona 417, LLC for the improvement of streets and the installation of a water and sewer system within the above referenced subdivision. The required improvements have been partially completed in accordance with the approved plans, and securities are now posted by Arch Insurance Company as follows:

- \$1,000,000 - Bond #SU5005498 for the completion of street improvements
- \$93,300 - Bond #SU5005498 for the completion of the water system
- \$103,900 - Bond #SU5005498 for the completion of the sewer system

The developer requests an extension of time for the completion of this project. Our records indicate that this project is approximately 90% completed for streets and utility work. The agreements for the extension of time have been approved by County Counsel.



Juan C. Perez
Director of Transportation

HS:lf
Submittals: Vicinity Map
Road/Drainage Agrmts
Water System Agrmts
Sewer System Agrmts

REVIEWED BY EXECUTIVE OFFICE
DATE 2/23/09
Tina Grande

FORM APPROVED COUNTY COUNSEL
BY: ELENA M. BOEVA
DATE 01/20/09
Departmental Concurrence

Policy

Consent

Dep't Recomm.:
Per Exec. Ofc.:

Prev. Agn. Ref. 10/30/07 - 2.18 | District: 2 | Agenda Number:

Vicinity Map



The County of Riverside assumes no warranty or legal responsibility for the information contained on this map. Data and information represented on this map is subject to update, modification and may not be complete or appropriate for all purposes. County GIS and other sources should be queried for the most current information. Do not copy or reuse the map.

Tract 30817

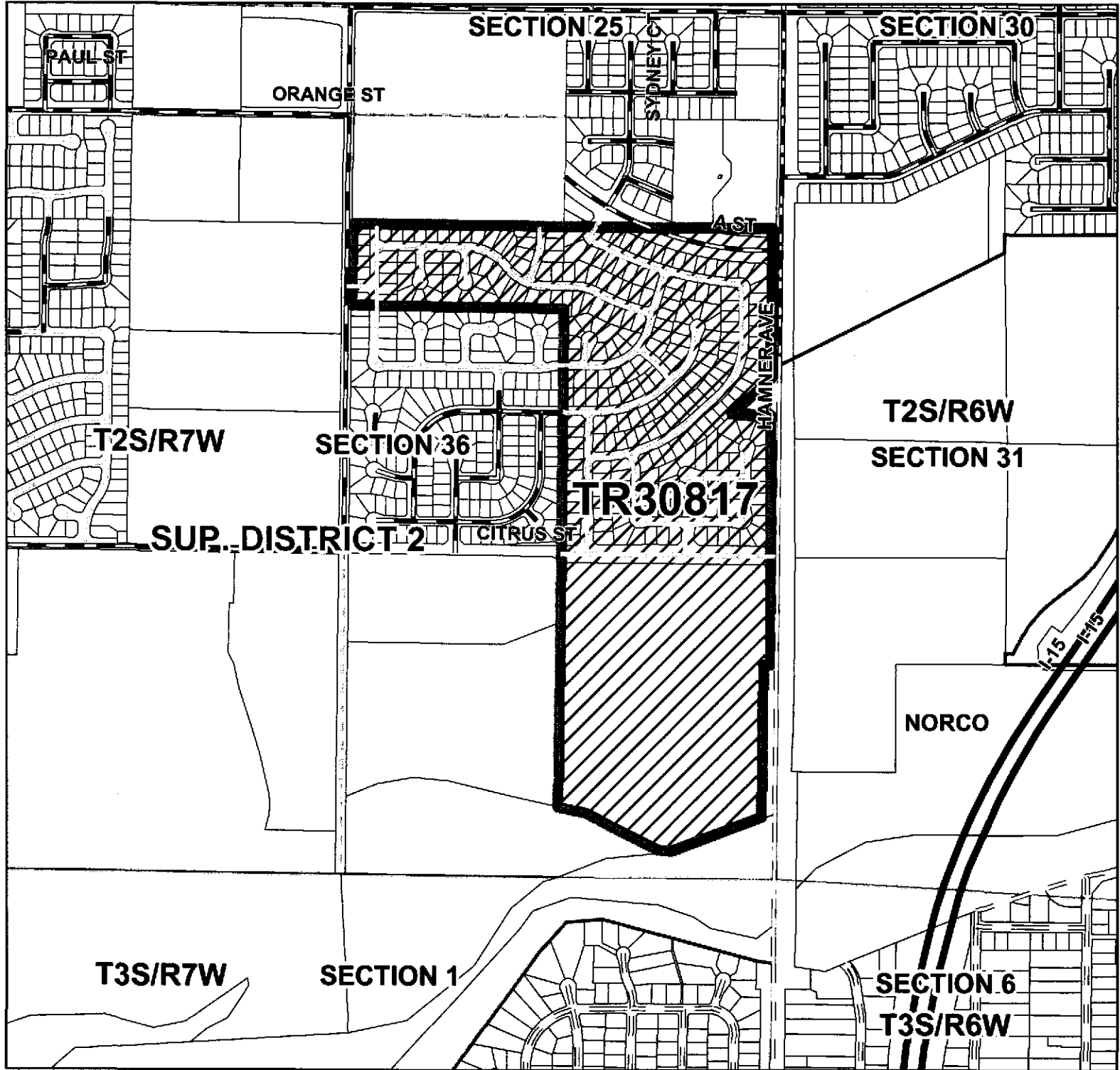

Roadway Legend

- | | | |
|--|-----------------------------|-------------|
| FEDERAL AID INTERSTATE; STATE HIGHWAYS | NON-COUNTY ROAD | HWY |
| F.A.S./F.A.U. MAINTAINED | CITY ROAD | INTERCHANGE |
| PAVED SURFACE MAINTAINED | UNDEFINED | INTERSTATE |
| GRAVELED SURFACE MAINTAINED | ABANDON | OFFRAMP |
| DIRT SURFACE MAINTAINED | VACATED | ONRAMP |
| ACCEPTED FOR PUBLIC USE | CITY OR WILDOMAR MAINTAINED | USHWY |