

**SUBMITTAL TO THE BOARD OF SUPERVISORS  
COUNTY OF RIVERSIDE, STATE OF CALIFORNIA**

622 B



**FROM:** TLMA - Transportation Department

**SUBMITTAL DATE:**

March 16, 2009

**SUBJECT:** Tract 30069  
A Schedule "A" Subdivision in the Murrieta Area  
**Extension of Time Agreements**

**RECOMMENDED MOTION:** That the Board approve the attached agreements (which grant an extension of time for twelve months to complete improvements).

**BACKGROUND:** On September 26, 2006, the Board entered into agreements with Brookfield W 633, LLC for the improvement of streets and the installation of a water and sewer system within the above referenced subdivision. Accompanying these agreements were faithful performance securities posted by Insurance Company of the West as follows:

- \$1,000,000 - Bond #2167835 for the completion of street improvements
- \$47,100 - Bond #2167836 for the completion of the water system
- \$54,400 - Bond #2167837 for the completion of the sewer system
- \$59,900 - Bond #216784 for the completion of the monumentation

The developer requests an extension of time for the completion of this project. Our records indicate that this project is approximately 10% completed for streets and utility work. The agreements for the extension of time have been approved by County Counsel.

Juan C. Perez  
Director of Transportation

HS:lf

- Submittals: Vicinity Map  
 Road/Drainage Imprv Agrmts  
 Water System Imprv Agrmts  
 Sewer System Imprv Agrmts  
 Monumentation Agreements

REVIEWED BY EXECUTIVE OFFICE

DATE 3/16/09  
Tina Grande

DATE 03/06/09  
Departmental Concurrence

FORM APPROVED COUNTY COUNSEL

BY: ELENA M. BOEVA

Policy

Consent

Dept's Recomm.:  
Per Exec. Ofc.:

Prev. Agn. Ref. 09/26/06 - 2.22 | District: 3 | Agenda Number:

# Vicinity Map



The County of Riverside assumes no warranty or legal responsibility for the information contained on this map. Data and information represented on this map is subject to updates, modifications and may not be complete or appropriate for all purposes. County GIS and other sources should be queried for the most current information. Do not copy or reuse this map.

## Tract 30069

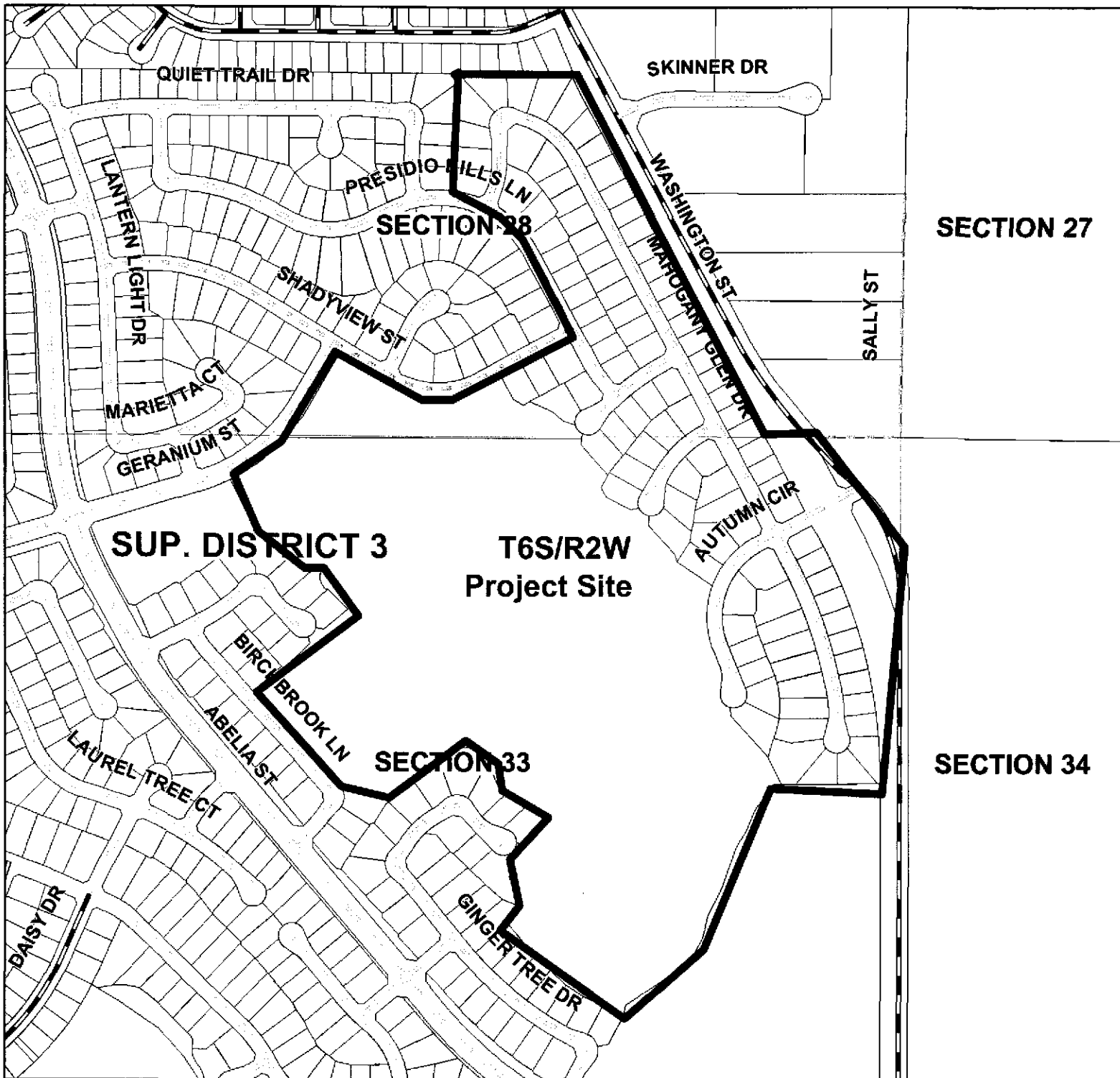

### Roadway Legend

- |  |                             |             |
|--|-----------------------------|-------------|
| FEDERAL AID INTERSTATE; STATE HIGHWAYS | NON-COUNTY ROAD             | HWY         |
| F.A.S./F.A.U. MAINTAINED               | CITY ROAD                   | INTERCHANGE |
| PAVED SURFACE MAINTAINED               | UNDEFINED                   | INTERSTATE  |
| GRAVELED SURFACE MAINTAINED            | ABANDON                     | OFFRAMP     |
| DIRT SURFACE MAINTAINED                | VACATED                     | ONRAMP      |
| ACCEPTED FOR PUBLIC USE                | CITY OR WILDOMAR MAINTAINED | USHWY       |