

**SUBMITTAL TO THE BOARD OF SUPERVISORS  
COUNTY OF RIVERSIDE, STATE OF CALIFORNIA**

110A



**SUBMITTAL DATE:**  
March 30, 2009

**FROM:** TLMA - Transportation Department

**SUBJECT:** Construction of regional trail on Bain Street, 450' North of Limonite Avenue to Galena Street, Mira Loma area.

**RECOMMENDED MOTION:** That the Board of Supervisors approve the plans and specifications for the construction of regional trail on Bain Street, 450' North of Limonite Avenue to Galena Street, Mira Loma area. Authorize the Clerk to advertise for bids to be received in the office of the Director of Transportation up to the hour of 2:00 pm, Wednesday, April 22, 2009 at which time bids will be opened.

**BACKGROUND:** The proposed trail is located about 35' from the existing edge of pavement and includes the construction of a 10 foot wide decomposed granite (DG) path, a wood post fence and associated improvements within the 2-mile long segment along the west side of the San Sevaine Channel's existing chain link fence.

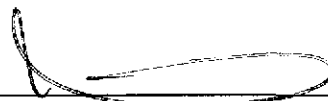
  
\_\_\_\_\_  
Juan C. Perez  
Director of Transportation

JCP:jrj  
(Continued On Attached Page)

<b>FINANCIAL DATA</b>	Current F.Y. Total Cost:	\$ 379,050	In Current Year Budget:	Yes
	Current F.Y. Net County Cost:	\$ 0	Budget Adjustment:	No
	Annual Net County Cost:	\$ 0	For Fiscal Year:	2008/2009
<b>SOURCE OF FUNDS:</b> Riverside County Regional Parks and Open Space District (100%)			<b>Positions To Be Deleted Per A-30</b>	<input type="checkbox"/>
			<b>Requires 4/5 Vote</b>	<input type="checkbox"/>

**C.E.O. RECOMMENDATION:**

APPROVE

BY   
Tina Grande

**County Executive Office Signature**

Policy  
 Policy

Consent  
 Consent

Dep't Recomm.:  
Per Exec. Ofc.:

Prev. Agn. Ref. 3/3/09, Item 3.31

District: 2

Agenda Number:

The Honorable Board of Supervisors

RE: Construction of regional trail on Bain Street, 450' North of Limonite Avenue to Galena Street, Mira Loma area.

March 30, 2009

Page 2 of 2

The project is necessary to provide a usable and safe regional trail to connect to designated trails on either side of the project.

The Riverside County Transportation Department (County) is performing the design and construction services for this project.

By minute order dated March 3, 2009 (Agenda item 3.31) the Board approved the project's funding agreement between the County and the Regional Parks and Open Space District (Parks). Parks has "Development Impact Fees" to fund the entire cost of this project.

The Parks, County and Riverside County Flood Control and Water Conservation District (District) will enter into a separate agreement (License Agreement). This agreement will allow the use of County and District right-of-way to be used for the regional trail. The operation and maintenance of the existing flood control facilities including the San Sevaine Channel will remain the District's responsibility. However, the operation and maintenance of the trail and its appurtenance will be the Park District's responsibility.

The submitted plans and specifications have been approved as to form by County Counsel.

Environmental clearance is complete.

Project No: B8-0693

C O U N T Y   O F   R I V E R S I D E

**BAIN STREET**

REGIONAL TRAIL  
450' NORTH OF LIMONITE AVENUE  
TO GALENA STREET  
PROJECT NO. B8-0693

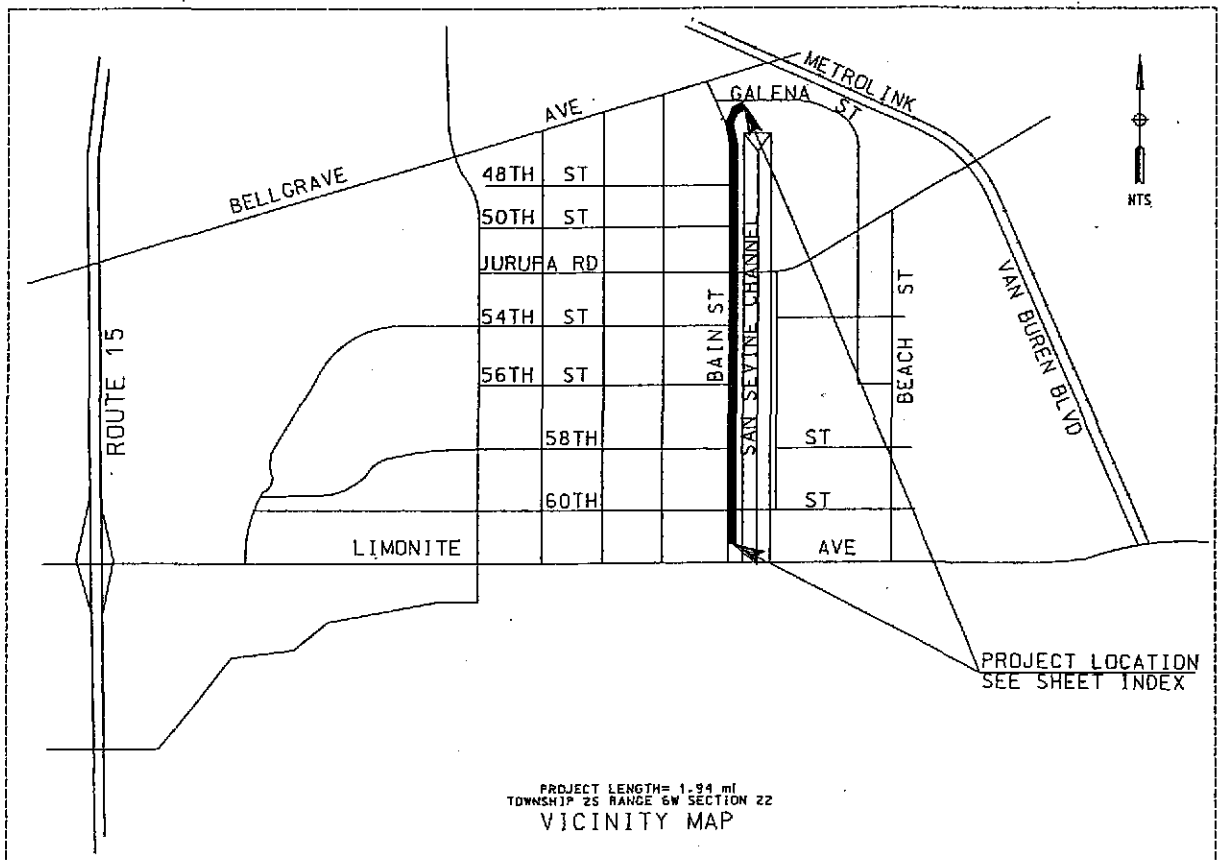
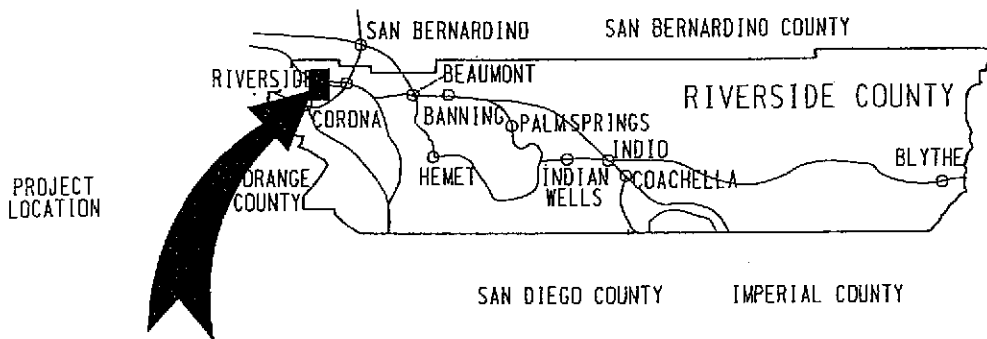

**NOTICE INVITING BIDS**

County of Riverside, herein called Owner, invites sealed proposals for:

**BAIN STREET 10' REGIONAL TRAIL PROJECT**

**450' NORTH OF LIMONITE AVE. TO GALENA STREET**

**PROJECT NO. B8-0693**

Proposal shall be delivered to the Riverside County Transportation Department, 14<sup>th</sup> Street Annex, 3525 14<sup>th</sup> Street, Riverside, California 92501, telephone (951) 955-6780 not later than 2:00 p.m., on Wednesday, April 29, 2009, to be promptly opened in public at said address. Each proposal shall be in accordance with plans, specifications, and other contract documents, dated February, 2009, and prepared by County of Riverside, whose address is same as the above, from whom they may be obtained upon deposit of \$30.00 per set plus mailing. No refund. Prospective bidders may preview the plans, specifications and other contract documents, at no charge prior to purchase, at the above noted location.

The Contractor is required to have a Class "A" license or C-12 license at the time of bid submission.

Engineering Estimate:	\$ 341,000.00 - \$398,000.00
Bid Bond	10 %
Performance Bond	100 %
Payment Bond	100 %
Working Days	15 Days

[www.tlma.co.riverside.ca.us/trans](http://www.tlma.co.riverside.ca.us/trans)