

**SUBMITTAL TO THE BOARD OF SUPERVISORS
COUNTY OF RIVERSIDE, STATE OF CALIFORNIA**

809 B

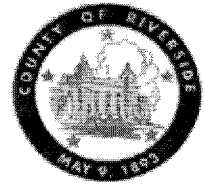

FROM: TLMA - Transportation Department

SUBMITTAL DATE:
August 24, 2009

SUBJECT: Tract 30780 (City of Perris) and MS 3988
A Subdivision in the Perris Area
Extension of Time Agreements

RECOMMENDED MOTION: That the Board approve the attached agreements (which grant an extension of time for twelve months to complete improvements).

BACKGROUND: On May 20, 2008, the Board entered into agreements with KB Home Coastal, Inc. for the improvement of streets adjacent to the above referenced subdivision. Accompanying these agreements were faithful performance securities posted by Liberty Mutual Insurance Company as follows:

\$92,000 - Bond #024022709 for the completion of street improvements

The developer requests an extension of time for the completion of this project. Our records indicate that this project is approximately 0% completed for streets and utility work. The agreements for the extension of time have been approved by County Counsel.



Juan C. Perez
Director of Transportation

HS:lf
Submittals: Vicinity Map
Road/Drainage Imprv Agrmts

REVIEWED BY EXECUTIVE OFFICE
DATE 11/20/09 Tina Grande
Departmental Concurrence

FORM APPROVED COUNTY COUNSEL
BY: Elena M. Boeva 01/23/09
ELENAM. BOEVA
DATE

Policy
 Policy

Consent
 Consent

Dep't Recomm.:
Per Exec. Ofc.:

Prev. Agn. Ref. 05/20/08 - 2.30 | District: 5 | Agenda Number:

ATTACHMENTS FILED
WITH THE CLERK OF THE BOARD

0 215 430 860 Feet
1 inch = 417 feet

Vicinity Map Tract 30780 (MS 3988)



The County of Riverside assumes no warranty or legal responsibility for the information contained on this map. Data and information represented on this map is subject to updates, modifications and may not be complete or appropriate for all purposes. County GIS and other sources should be queried for the most current information. Do not copy or resell this map.

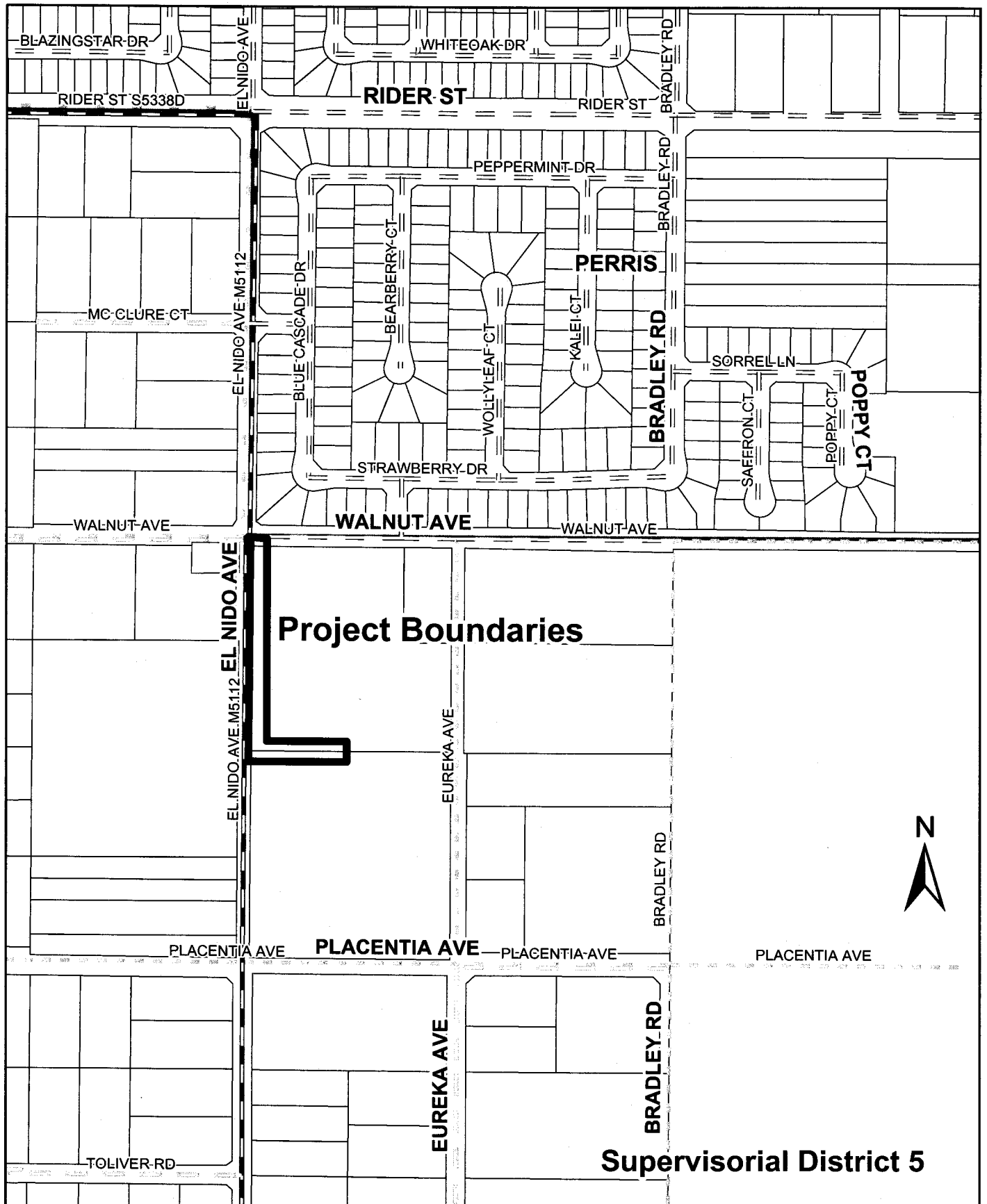

Supervisorial District 5