

**SUBMITTAL TO THE FLOOD CONTROL AND
WATER CONSERVATION DISTRICT BOARD
COUNTY OF RIVERSIDE, STATE OF CALIFORNIA**

8703



FROM: General Manager-Chief Engineer

SUBMITTAL DATE:
September 1, 2009

SUBJECT: Public Hearing for Corona Drains East Ontario Avenue Storm Drain, Stage 1
Project No. 2-0-00351-01

RECOMMENDED MOTION:

Adopt Resolution No. F2009-25 which

finds that the project will not have a significant adverse effect upon the environment and is in compliance with the Western Riverside County Multiple Species Habitat Conservation Plan;

Continued on Page 2.

BACKGROUND:

Continued on Page 2.

Warren D. Williams

KF:mcv
P8\125341

WARREN D. WILLIAMS
General Manager-Chief Engineer

FINANCIAL DATA	Current F.Y. District Cost:	N/A	In Current Year Budget:	N/A
	Current F.Y. County Cost:	N/A	Budget Adjustment:	N/A
	Annual Net District Cost:	N/A	For Fiscal Year:	N/A

SOURCE OF FUNDS: N/A	Positions To Be Deleted Per A-30	<input type="checkbox"/>
	Requires 4/5 Vote	<input type="checkbox"/>

C.E.O. RECOMMENDATION: N/A **APPROVE**

BY: *Michael R. Shetler*
Michael R. Shetler

County Executive Office Signature

FORM APPROVED COUNTY COUNSEL
BY: *Larisa R-Mickenna*
DATE: *9/2/09*
Departmental Concurrence

- Dep't Recomm.: Consent Policy
- Per Exec. Ofc.: Consent Policy

Prev. Agn. Ref.: | **District:** 2nd | **Agenda Number:**

11.10

**FLOOD CONTROL AND WATER CONSERVATION DISTRICT BOARD SUBMITTAL
COUNTY OF RIVERSIDE, STATE OF CALIFORNIA**

SUBJECT: Public Hearing for Corona Drains East Ontario Avenue Storm Drain, Stage 1
Project No. 2-0-00351-01

SUBMITTAL DATE: September 1, 2009

Page 2

RECOMMENDED MOTION (continued):

adopts a Mitigated Negative Declaration;

authorizes the District to proceed with the project;

directs the Clerk of the Board to deliver the Mitigated Negative Declaration and the Notice of Determination to the Office of the County Clerk and Recorder for filing within 5 working days of this Board hearing.

BACKGROUND:

This hearing is in accordance with the requirements of CEQA and Section 18 of the District Act.

P8\125341

1 BOARD OF SUPERVISORS

RIVERSIDE COUNTY FLOOD CONTROL AND WATER CONSERVATION DISTRICT

2
3 RESOLUTION NO. F2009-25
4 APPROVING CORONA DRAINS EAST ONTARIO AVENUE STORM DRAIN, STAGE 1

5 WHEREAS, on July 14, 2009 the Board adopted Resolution No. F2009-24
6 pursuant to Section 18 of the District Act giving notice of its intention to construct a project in
7 Zone 2, within the unincorporated El Cerrito community of Riverside County and the City of
8 Corona, designated as Corona Drains East Ontario Avenue Storm Drain, Stage 1 and giving
9 further notice that the project would be considered at a public hearing on September 1, 2009;
10 and

11 WHEREAS, notice of the public hearing was properly made by publication and
12 posting as required by law, and all persons desiring to be heard on the matter were given the
13 opportunity to appear and present testimony, both oral and written; and

14 WHEREAS, all requirements of the California Environmental Quality Act and the
15 District Rules to Implement the Act have been met and the General Manager-Chief Engineer of
16 the District has found that the project will not have a significant adverse effect upon the
17 environment and has completed a Mitigated Negative Declaration; now, therefore,

18 BE IT RESOLVED, DETERMINED AND ORDERED by the Board of
19 Supervisors of the Riverside County Flood Control and Water Conservation District in regular
20 session assembled on September 1, 2009 based upon the evidence and testimony presented on
21 the matter, both written and oral, that:

22 1. The Project is **not** within the Criteria Area set forth in and established by
23 the Western Riverside County Multiple Species Habitat Conservation Plan (MSHCP).

24 2. The Project is consistent with the Riparian/Riverine Area and Vernal Pool
25 requirements of the MSHCP. Pursuant to Section 6.1.2 of the MSHCP, Riparian/Riverine areas
26 are lands which contain habitat dominated by trees, shrubs, persistent emergents, or emergent
27 mosses and lichens, which occur close to or which depend upon soil moisture from a nearby
28 fresh water source, or areas with freshwater flow during all or a portion of the year. Vernal

FORM APPROVED COUNTY COUNSEL
BY *LARISA R-MCKENNA* DATE *6/26/09*

1 Pools are seasonal wetlands that occur in depression areas that have wetlands indicators of all
2 three parameters (soils, vegetation, and hydrology) during the wetter portion of the growing
3 season. It has been determined that although the Project area does not contain any vernal pools,
4 the Project area does include Riparian/Riverine Area as defined by the MSHCP. However, the
5 proposed storm drain alignment established by the Project does not adversely impact this
6 Riparian/Riverine Area. In addition, the proposed storm drain alignment does not contain
7 suitable habitat for least Bell's vireo, Southwestern Willow Flycatcher, Yellow-breasted chat, or
8 Yellow Warbler. Therefore, no further surveys or conservation measures are required.

9 3. The Project is consistent with the Narrow Endemic Plant Species
10 requirements of the MSHCP. Pursuant to Section 6.1.3 of the MSHCP, habitat assessments
11 and/or focused surveys for certain narrow endemic plant species are required for properties
12 within mapped survey areas. The survey area maps have been reviewed and the Project is not
13 within a mapped survey area for Narrow Endemic Plant Species. Therefore, no further surveys
14 or conservation measures are required.

15 4. The Project is consistent with the Urban-Wildlands Interface requirements
16 of the MSHCP. Section 6.1.4 of the MSHCP presents guidelines to minimize indirect effects of
17 a project in proximity to the MSHCP Conservation Area. This section provides mitigation
18 measures for impacts associated with: Drainage, Toxics, Lighting, Noise, Invasives, Barriers
19 and Grading/Land Development. The Project has been reviewed and it has been determined
20 the Project does not occur within or adjacent to the Criteria Area. A portion of the project is
21 within property designated as Public/Quasi-Public (P/QP) land in the MSHCP. The existing
22 concrete channel will be reconstructed to allow for the connection of the storm drain into the
23 channel. It has been determined by the District that the project will not alter the existing land
24 use for the currently designated P/QP land such that it would not contribute to Reserve
25 Assembly. Therefore, no further analysis or implementation of any conservation measures is
26 required.

27 5. The Project is consistent with the Database Updates/Additional Surveys
28 requirements of the MSHCP. Pursuant to Section 6.3.2 of the MSHCP, habitat assessments

1 and/or focused surveys for certain additional plant and animal species are required for
2 properties within mapped survey areas. The survey area maps have been reviewed and the
3 Project is not within a mapped survey area.

4 6. The Project is consistent with the Public/Quasi-Public Land provisions
5 contained in Section 3.2.1 of the MSHCP. Section 3.2.1 describes lands within the MSHCP
6 conservation area including those designated as Public/Quasi-Public (PQP) lands. Section
7 3.2.1 states that if a Permittee elects to use property currently depicted as PQP Lands in a way
8 that alters the land use such that it would not contribute to Reserve Assembly, the Permittee
9 shall locate and acquire or otherwise encumber replacement acreage at a minimum ratio of 1:1.
10 The Permittee must make findings that the replacement acreage is biologically equivalent or
11 superior to the existing property. A portion of the project is within property designated as
12 Public/Quasi-Public (P/QP) land in the MSHCP. The existing concrete channel will be
13 reconstructed to allow for the connection of the storm drain into the channel. It has been
14 determined by the District that the project will not alter the existing land use for the currently
15 designated P/QP land such that it would not contribute to Reserve Assembly. Therefore, no
16 further analysis is required.

17 7. The project designated as Corona Drains East Ontario Avenue Storm Drain,
18 Stage 1 is approved and the District is hereby authorized to proceed with the project.

19 8. The project will not have a significant adverse effect upon the environment
20 and a Mitigated Negative Declaration is adopted.

21 BE IT FURTHER RESOLVED that, within 5 working days of this Board hearing,
22 the Clerk of the Board is directed to deliver the adopted Mitigated Negative Declaration and the
23 Notice of Determination to the Office of the County Clerk and Recorder, who are thereby
24 directed to file same, all as required by law.

**Riverside County Flood Control
and Water Conservation District**

Riverside, California

**FINAL
CEQA
INITIAL STUDY/ENVIRONMENTAL
ASSESSMENT**

**FOR THE
CORONA DRAINS - EAST ONTARIO AVENUE
STORM DRAIN, STAGE 1**

ZONE 2

RIVERSIDE COUNTY, CALIFORNIA

September 2009

WARREN D. WILLIAMS
General Manager-Chief Engineer

MITIGATED NEGATIVE DECLARATION

State Clearinghouse Number:
2009061086

Contact Person:
Kris Flanigan

Telephone Number:
951.955.8581
Email: kflaniga@rcflood.org

Lead Agency and Project Sponsor: Riverside County Flood Control and Water Conservation District

Address: 1995 Market Street

City: Riverside

Zip: 92501

Project Title and Description:

Corona Drains - East Ontario Avenue Storm Drain, Stage 1 – The proposed project is the construction, operation and maintenance of a flood control and drainage system consisting of 4,400 lineal feet of new underground storm drain, ranging from approximately 30 inches to 84 inches in diameter, and the removal and reconstruction of approximately 360 feet of existing concrete channel.

The proposed outlet for the drainage system is the District's existing El Cerrito Channel, a concrete channel located at the northeast corner of Ontario Avenue and El Cerrito Road. From the proposed outlet, the project alignment will extend northwest within the right of way of Ontario Avenue for approximately 3,500 lineal feet then continue north within the right of way of State Street for approximately 300 feet. A subsequent phase of the project would provide laterals in Ambassador Avenue and Rising Sun Road. Upon completion, the storm drain system will provide 100-year flood protection to existing development located northeasterly of Ontario Avenue.

Project Location:

The majority of the proposed project is located in the unincorporated area of Riverside County, California. A portion of the project is located in the city of Corona. [USGS "Corona South, California" 7.5 Topographic Quadrangle: Township 4 South, Range 6 West, Section 8 (extrapolated)].

The General Manager-Chief Engineer of the Riverside County Flood Control and Water Conservation District has made a finding that the proposed Corona Drains - East Ontario Avenue Storm Drain, Stage 1 Project will not have a significant adverse effect on the environment. An Initial Study/Environmental Assessment supporting this finding is attached. This finding will become final upon adoption of this Mitigated Negative Declaration by the Board of Supervisors of the Riverside County Flood Control and Water Conservation District. Mitigation measures are as follows:

Refer to attached Mitigation Monitoring Program Table

Signature: 
WARREN D. WILLIAMS
General Manager-Chief Engineer

Dated: 9/19/09

The Board of Supervisors of the Riverside County Flood Control and Water Conservation District, assembled in regular session on September 1, 2009, has determined that the Corona Drains - East Ontario Avenue Storm Drain, Stage 1 Project will not have a significant adverse effect on the environment and has adopted this Mitigated Negative Declaration.

Signature: _____
KECIA HARPER-IHEM
Clerk of the Board

Dated: _____

Attachment

- Copies to: 1) County Clerk
 2) Flood Control

KF:AD:mcv
P8\126452

**RIVERSIDE COUNTY FLOOD CONTROL
AND WATER CONSERVATION DISTRICT**

CORONA DRAINS - EAST ONTARIO AVENUE STORM DRAIN, STAGE 1

MITIGATION MONITORING PROGRAM TABLE

Issue	Potential Impact	Mitigation Measures	Action	Implementing Agency	Governing Agency	Implementation Timing	Monitoring Frequency
XI. Noise	The use of heavy equipment during project construction will result in periodic and temporary increased noise levels near a residential area.	MM XI-1. Use of heavy equipment that may impact adjacent residential area shall be limited from 7 a.m. to 7 p.m. during weekdays, and prohibited on Saturdays, Sundays and holidays, except under special circumstances approved by the District.	Ensure that construction activity is limited to the described hours.	RCFC&WCD (Design and Construction Division)	None	During the construction period	Periodic monitoring during project construction
XI. Noise	The use of heavy equipment during project construction will result in periodic and temporary increased noise levels near a residential area.	MM XI-2. Each resident adjacent to the storm drain construction site shall be notified in writing three days prior to operating heavy construction equipment near the residents. The notice shall include the expected work schedule and the District's contact information. The District shall alert the construction contractor of any noise complaints and incorporate any feasible and practical techniques which minimize the noise impacts on adjacent residents.	Ensure that the described notices are provided to each resident adjacent to the storm drain construction site and inform the contractor of any complaints and feasible corrective measures.	RCFC&WCD (Design and Construction Division)	None	During construction	During construction
XV. Transportation/Traffic	Construction activities may impact the routes of emergency service vehicles.	MM XV-1. At all times during construction, the contractor shall ensure that emergency fire or medical vehicles are able to access all adjacent areas.	Ensure adequate emergency access through construction areas at all times.	RCFC&WCD (Design and Construction Division)	None	During construction	Monitor as needed during construction

**RIVERSIDE COUNTY FLOOD CONTROL
AND WATER CONSERVATION DISTRICT**

**California Environmental Quality Act (CEQA)
Environmental Assessment
Initial Study**

1. **Project title:** Corona Drains - East Ontario Avenue Storm Drain, Stage 1
2. **Lead agency name and address:** Riverside County Flood Control and Water Conservation District
Attention: Environmental/Regulatory Services Section
1995 Market Street
Riverside, California 92501
3. **Contact person email address and phone number:** Kris Flanigan
kflaniga@rcflood.org
951.955.8581
4. **Project location:**
The majority of the proposed project is located in the unincorporated area of Riverside County, California. A portion of the project is located in the city of Corona. [USGS "Corona South, California" 7.5 Topographic Quadrangle: Township 4 South, Range 6 West, Section 8 (extrapolated)].
5. **Project sponsor's name and address:** N/A
6. **General plan designation:**
The City of Corona General Plan designates the project area and adjacent areas as residential and commercial land uses. The County of Riverside General Plan (RCIP) designates the area for low density residential and commercial land uses. The proposed underground storm drain will primarily be constructed within existing streets and will not conflict with the policies of either the City of Corona's General Plan or the RCIP.
7. **Description of project:** *(Describe the whole action involved, including but not limited to later phases of the project, and any secondary, support, or off-site features necessary for its implementation. Attach additional sheets if necessary.)*
Corona Drains - East Ontario Avenue Storm Drain – This focused initial study addresses the potential environmental impacts related to the construction, operation and maintenance of the proposed Corona Drains - East Ontario Avenue Storm Drain Project (project). The proposed project is a flood control facility consisting of reinforced concrete pipe ranging from approximately 30 inches to 84 inches in diameter. The proposed project is expected to occur in phases. The initial phase, "Stage 1", of the proposed project consists of approximately 4,400 lineal feet of reinforced concrete pipe ranging from approximately 30 inches to 84 inches in diameter. The proposed outlet for the project is the District's existing El Cerrito Channel, a concrete channel at the northeast corner of Ontario Avenue and El Cerrito Road. From the proposed outlet, the project alignment will extend northwest within the Ontario Avenue right of way for approximately 3,500 lineal feet then approximately 300 feet northerly within the State Street right of way. Stage 1 will also include the removal and reconstruction of approximately 360 feet of existing concrete channel. The subsequent phase of the project would provide laterals in Ambassador Avenue and Rising Sun Road. These laterals are proposed within existing streets and impacts are discussed in this initial study. Upon completion, the proposed storm drain system will provide 100-year flood protection to existing development northeasterly of Ontario Avenue.

Earlier Analyses Used:

City of Corona General Plan
Riverside County General Plan (RCIP)

Impacts Adequately Addressed in Earlier Analyses:

The above documents address the potential environmental impacts of the land use allocations proposed in the City of Corona General Plan and the RCIP. While the previous documents did not specifically address the proposed project, the documents address general land use policy within the project area.

8. Surrounding land uses and setting: *(Briefly describe the project's surroundings)*

Corona Drains - East Ontario Avenue Storm Drain Project - The proposed underground storm drain system will be constructed mostly within existing roadways surrounded by residential and commercial development. The storm drain system outlet will be constructed within the existing El Cerrito Channel. The entirety of the project area is heavily disturbed.

9. Other public agencies whose approval may be required: *(e.g., permits, financing approval, or participation agreement.)*

Federal Agencies (not "public agencies" as defined by CEQA) - *None*

State Agencies - *California Department of Fish and Game (Section 1602 Streambed Alteration Agreement)*

Regional Water Quality Control Board - *Santa Ana Region (401 Water Certification or Porter - Cologne Water Quality Control Act)*

City/County Agencies -

City of Corona (City) - Approval of construction activities within City maintained roads

Riverside County Transportation Department (County) - Approval of construction activities with County maintained roads

Financing Approval or Participation Agreements - *None*

ENVIRONMENTAL FACTORS POTENTIALLY AFFECTED:

The environmental factors checked below would be potentially affected by this project, involving at least one impact that is a "Potentially Significant Impact" as indicated by the following checklist:

- | | | |
|--|---|--|
| <input type="checkbox"/> Aesthetics | <input type="checkbox"/> Mineral Resources | <input type="checkbox"/> Land Use/Planning |
| <input type="checkbox"/> Agriculture Resources | <input checked="" type="checkbox"/> Noise | |
| <input type="checkbox"/> Air Quality | <input type="checkbox"/> Population/Housing | |
| <input type="checkbox"/> Biological Resources | <input type="checkbox"/> Public Services | |
| <input type="checkbox"/> Cultural Resources | <input type="checkbox"/> Recreation | |
| <input type="checkbox"/> Geology/Soils | <input checked="" type="checkbox"/> Transportation/Traffic | |
| <input type="checkbox"/> Hazards & Hazardous Materials | <input type="checkbox"/> Utilities/Service Systems | |
| <input type="checkbox"/> Hydrology/Water Quality | <input type="checkbox"/> Mandatory Findings of Significance | |

SECTION 18 PUBLIC HEARING MAP

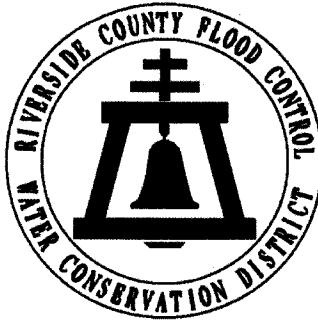

CORONA DRAINS EAST ONTARIO AVE. STORM DRAIN PROJECT NO. 2-0-0351 MARCH 2009

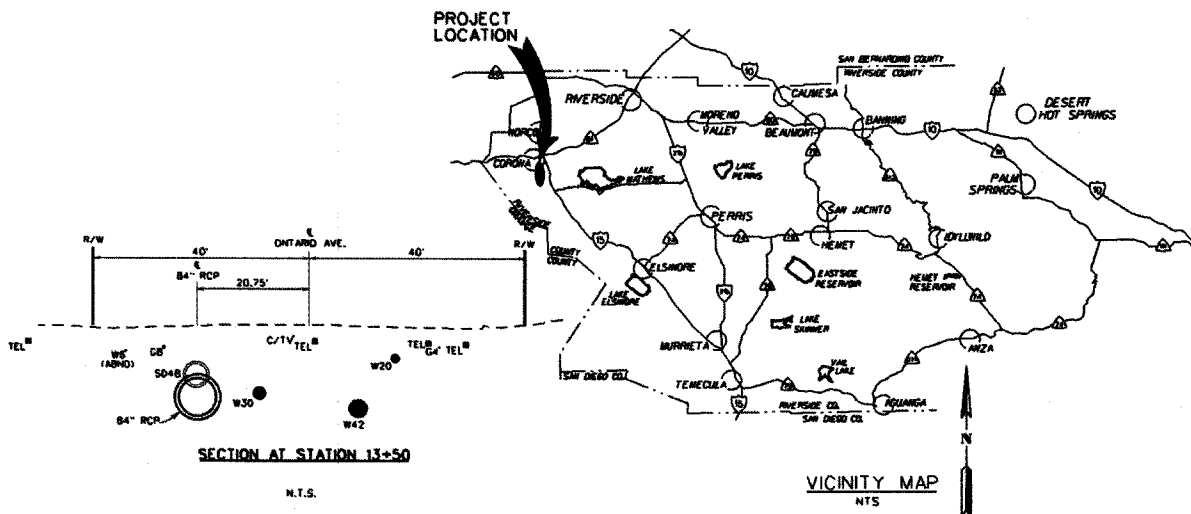
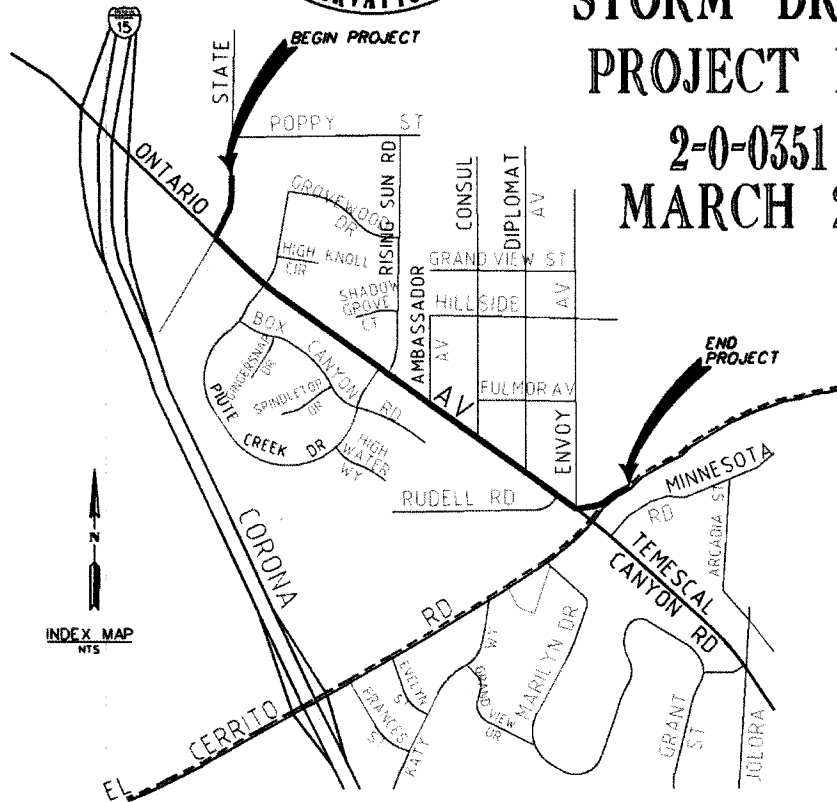

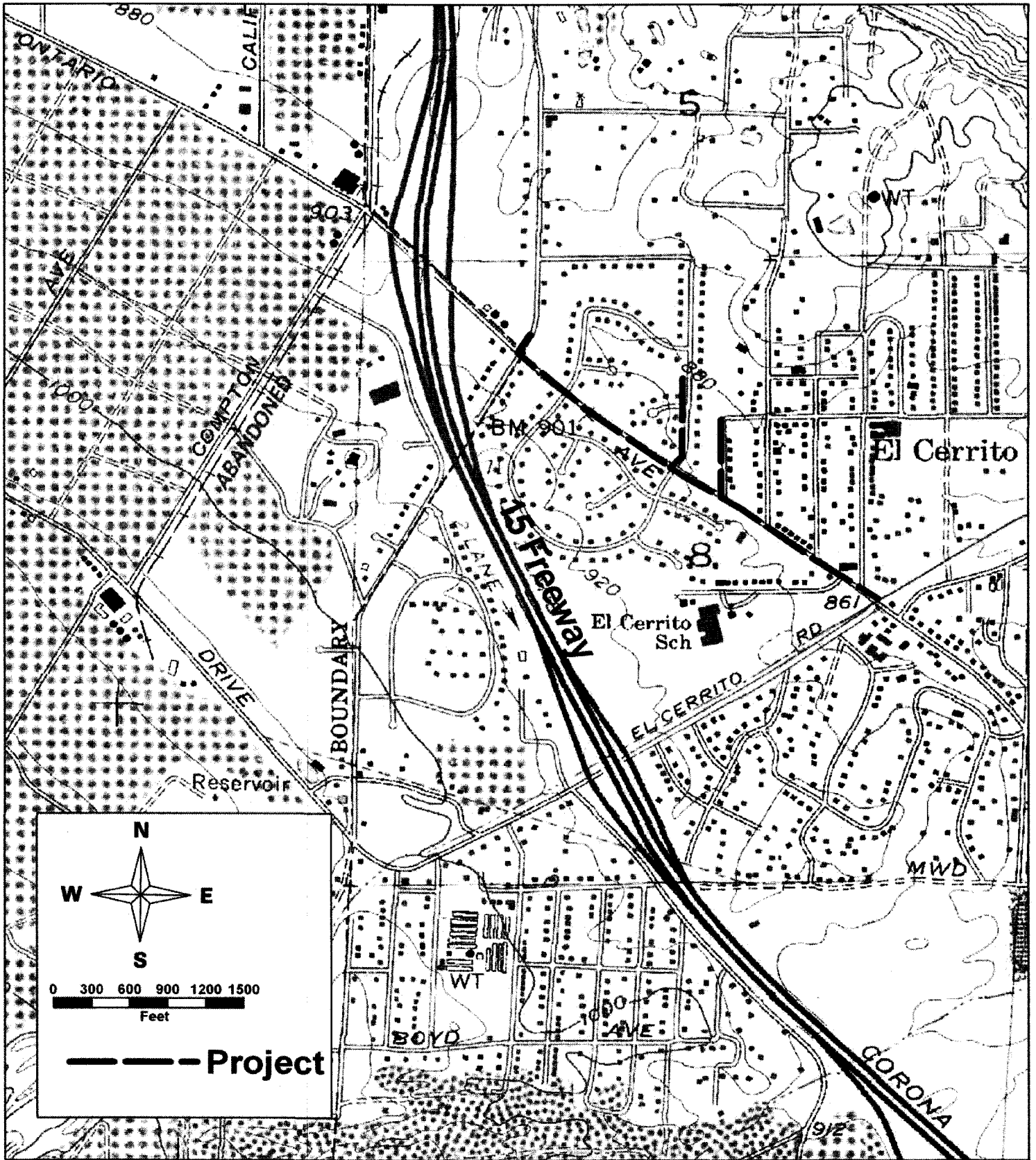

Corona Drains-East Ontario Avenue S.D.

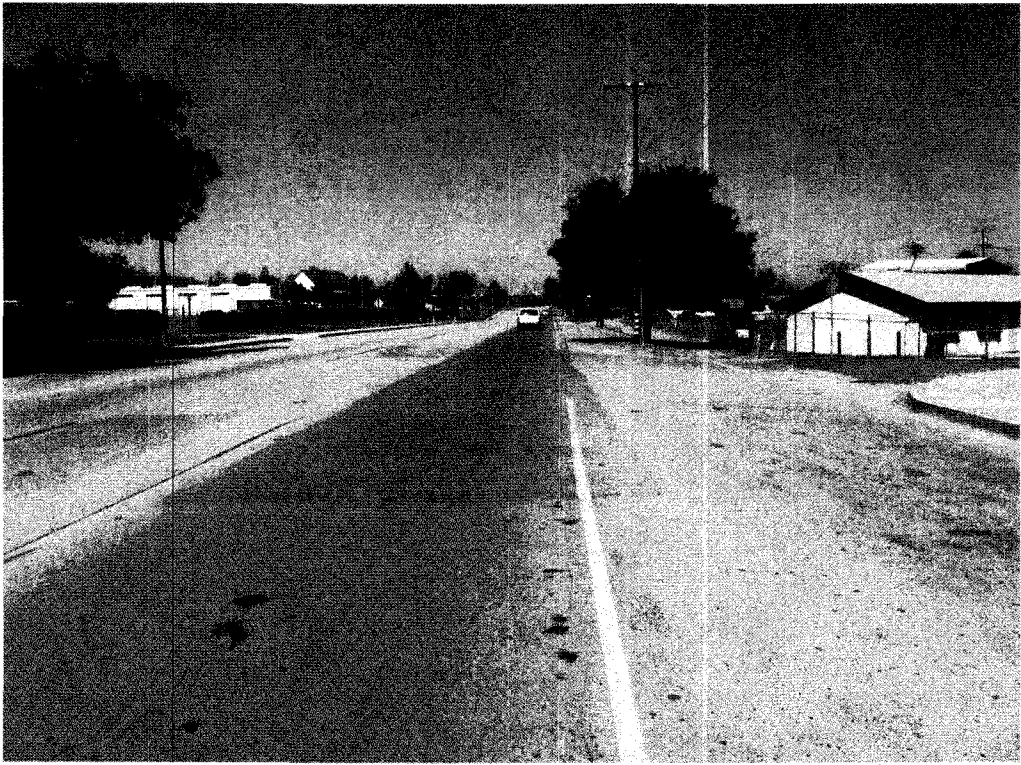

Ontario Avenue looking north from near Diplomat Avenue



Ontario Avenue looking south just north of El Cerrito Road



El Cerrito Channel looking northeast at location of proposed storm drain connection



El Cerrito Channel looking west at location of proposed storm drain connection

Potentially Significant Impact
 Potentially Significant Unless Mitigation Incorporated
 Less than Significant Impact
 No Impact

ENVIRONMENTAL FACTORS:

I. AESTHETICS. Would the project:

- Ia) Have a substantial adverse effect on a scenic vista? (1,2)

No Impact. Scenic vistas or highways do not exist within the project area. Most of the project consists of an underground storm drain located within existing street rights of way. The above ground portion consists of replacing a dilapidated stormwater channel with a newly constructed channel of equal size.

- Ib) Substantially damage scenic resources, including, but not limited to trees, rock outcroppings, and historic buildings within a state scenic highway? (1,2)

No Impact. Refer to response Ia. The proposed project area does not provide any scenic resources.

- Ic) Substantially degrade the existing visual character or quality of the site and its surroundings? (1,2)

No Impact. Refer to response Ia.

- Id) Create a new source of substantial light or glare, which would adversely affect day or nighttime views in the area? (1,2)

No Impact. Construction, operation and maintenance of the proposed project will not produce any new sources of light or glare.

II. AGRICULTURAL RESOURCES. In determining whether impacts to agricultural resources are significant environmental effects, lead agencies may refer to the California Agricultural Land Evaluation and Site Assessment Model (1997) prepared by the California Department of Conservation as an optional model to use in assessing impacts on agriculture and farmland. Would the project:

- Iia) Convert Prime Farmland, Unique Farmland, or Farmland of Statewide Importance (Farmland), as shown on the maps prepared pursuant to the Farmland Mapping and Monitoring Program of the California Resources Agency, to non-agricultural use? (1,2)

No Impact. The proposed project site is not located within areas designated as Prime Farmland, Unique Farmland, or Farmland of Statewide Importance. The proposed project will

<i>Potentially Significant Impact</i>	<i>Potentially Significant Unless Mitigation Incorporated</i>	<i>Less than Significant Impact</i>	<i>No Impact</i>
---	---	---	------------------

be located primarily underground within existing streets.

- IIb) Conflict with existing zoning for agricultural use, or a Williamson Act contract? (1,2)

No Impact. The proposed project would not conflict with existing zoning because it will not involve any changes to current General Plan land use or zoning designations. Additionally, the proposed project area is not subject to a Williamson Act Contract.

- IIc) Involve other changes in the existing environment which, due to their location or nature, could result in conversion of Farmland, to non-agricultural use? (1,2)

No Impact. Refer to response IIa.

III. AIR QUALITY. Where available, the significance criteria established by the applicable air quality management or air pollution control district may be relied upon to make the following determinations. Would the project:

- IIIa) Conflict with or obstruct implementation of the applicable air quality plan? (3)

No Impact. The proposed project is located within the South Coast Air Basin (SoCAB), which is classified as non-attainment for several of the six criteria pollutants utilized to determine attainment of National Ambient Air Quality Standards. The South Coast Air Quality Management District (SCAQMD) has jurisdiction over air quality issues within the SoCAB and has established the Air Quality Management Plan (AQMP) for the SoCAB. In the April 1993 CEQA Air Quality Handbook, the South Coast Air Quality Management District (SCAQMD) established threshold values of emissions to assist local agencies in determining if proposed projects may result in significant adverse air quality impacts. The proposed project is consistent with the AQMP and will not hinder the implementation of its programs. No mitigation is required.

- IIIb) Violate any air quality standard or contribute substantially to an existing or projected air quality violation? (3)

Less Than Significant Impact. The proposed project is the construction, operation and maintenance of a flood control and drainage system. The operation and maintenance of the proposed project will not result in any significant air quality impacts (see IIIc). However, the construction of the project has the potential to result in short-term minimal air quality impacts. The construction of the project is expected to occur in phases. Construction for the initial phase of the proposed project consists of the installation of approximately 4,400 lineal feet of underground concrete pipe, and the removal and reconstruction of approximately 360 feet of existing concrete channel. Anticipated construction activities associated with the construction of the underground storm drain include asphalt cutting, trench excavation, pipe laying, backfilling, backfill compaction and repaving. Anticipated construction activities associated with the replacement of the dilapidated concrete channel include demolition, debris removal,

Potentially Significant Impact
 Potentially Significant Unless Mitigation Incorporated
 Less than Significant Impact
 No Impact

regrading, recompacting, and placement of new concrete. It should be noted that the construction for subsequent phases of the proposed project would consist of shorter duration and type of activities/equipment. SCAQMD construction emission thresholds considered to be significant are listed in Table 1.

Table 1
Construction Thresholds and Estimated Emissions

Air Pollutant	SCAQMD Significance Criteria for Construction (lbs/day)	Project Estimated Construction Emissions (lbs/day)
Nitrogen Oxides	100	46.87
Reactive Organic Compounds	75	7.60
Sulfur Oxides	150	0.01
Carbon Monoxide	550	26.49
PM10	150	3.58
PM2.5	55	2.85

The duration of the project's initial construction phase is expected to last nine months. The estimated construction emissions shown in Table 1 are based on data derived from URBEMIS 2007 (version 9.2.4) air pollution emissions model and the following assumptions:

- Two (2) excavators
- Two (2) dump trucks
- One (1) paver
- One (1) paving equipment to repave the street
- One (1) roller
- One (1) rubber tired loader
- Two (2) signal boards
- One (1) tractors/loaders/backhoe
- One (1) water truck for dust control

Based on the values shown in Table 1, the estimated short-term emissions from construction equipment are not expected to exceed daily air emission thresholds as established by SCAQMD. Although the project is not anticipated to cause or contribute to regional or cumulative air quality impacts, a mitigation measure that requires compliance with SCAQMD rules will be incorporated into the project to ensure the potential for local fugitive dust nuisance generated during construction is minimized to the maximum extent feasible.

IIIc) Result in cumulatively considerable net increase of any criteria pollutant for which the project region is non-attainment under an applicable federal or state ambient air quality standard (including releasing emissions which exceed quantitative thresholds for ozone precursors)? (3)

	<i>Potentially Significant Unless Mitigation Incorporated</i>	<i>Potentially Significant Unless Mitigation Incorporated</i>	<i>Less than Significant Impact</i>	<i>No Impact</i>
--	---	---	---	------------------

Less Than Significant Impact. The South Coast Air Basin is classified as a non-attainment area. The proposed project will not generate short-term construction emissions that exceed the daily or quarterly air emission thresholds as established by SCAQMD.

- III d) Expose sensitive receptors to substantial pollutant concentrations? (N/A)

Less than Significant Impact. Sensitive receptors include existing residential uses along the proposed project alignment. As shown in III b above, construction emissions are considered less than significant according to SCAQMD threshold criteria. Emissions associated with the operation and maintenance of the storm drain project will be intermittent and less than significant.

- III e) Create objectionable odors affecting a substantial number or people? (N/A)

No Impact. The only potential for project-related odor will be from construction related diesel exhaust. These odors would be transitory and would not create objectionable odors affecting a substantial number of people. The operation and maintenance of an underground storm drain facility will not create any objectionable odors affecting a substantial number of people.

IV. BIOLOGICAL RESOURCES. Would the project:

- IV a) Have a substantial adverse effect, either directly or through habitat modifications, on any species identified as a candidate, sensitive, or special status species in local or regional plans, policies, or regulations, or by the California Department of Fish and Game or U.S. Fish and Wildlife Service? (1,2,5)

No Impact. Nearly all of the proposed project is located within existing street rights-of-way. Reconstruction of the existing concrete channel portion will occur within existing flood control right of way. Potential habitat for species identified as candidate, sensitive or special status does not exist within the project footprint.

- IV b) Have a substantial adverse effect on any riparian habitat or other sensitive natural community identified in local or regional plans, policies, regulations or by the California Department of Fish and Game or U.S. Fish and Wildlife Service? (N/A)

No impact. The proposed underground storm drain facility is located primarily within existing street rights-of-way. The existing concrete channel reconstruction occurs within existing flood control right of way. No riparian habitat or other sensitive natural communities will be impacted by the project.

- IV c) Have a substantial adverse effect on federally protected wetlands as defined by Section 404 of

<i>Potentially Significant Impact</i>	<i>Potentially Significant Unless Mitigation Incorporated</i>	<i>Less than Significant Impact</i>	<i>No Impact</i>
---	---	---	------------------

the Clean Water Act (including, but not limited to, marsh, vernal pools, coastal, etc.) through direct removal, filling, hydrological interruption, or other means? (N/A)

No Impact. Wetlands do not currently exist on the project site. Refer to response IVb above.

IVd) Interfere substantially with the movement of any native resident or migratory fish or wildlife species or with established native resident or migratory wildlife corridors, or impede the use of native wildlife nursery sites? (N/A)

No Impact. Refer to response IVa and IVb above.

IVe) Conflict with any local policies or ordinances protecting biological resources, such as a tree preservation policy or ordinance? (1,2)

No Impact. The proposed project will not conflict with any local policy or ordinances protecting biological resources.

IVf) Conflict with the provisions of an adopted Habitat Conservation Plan, Natural Community Conservation Plan, or other approved local, regional, or state habitat conservation plan? (5)

Less Than Significant Impact. The project does not conflict with the provisions of an adopted Habitat Conservation Plan Natural Community Conservation Plan, or other approved local, regional or State habitat conservation plan.

On June 17, 2003, the Riverside County Board of Supervisors adopted the Western Riverside County Multiple Species Habitat Conservation Plan (MSHCP). The MSHCP is a comprehensive, multi-jurisdictional habitat conservation plan focusing on the conservation of species and their associated habitats in Western Riverside County. The existing concrete channel is located on property the Riverside Conservation Authority (RCA) tentatively identified as Public/Quasi Public (PQP) Lands per the MSHCP; however, the proposed channel reconstruction will not alter the existing land use in such a way that it no longer contributes to the MSHCP "Reserve Assembly". Pursuant to recent discussion with RCA staff, existing District right of way that lacks significant habitat or does not otherwise support MSHCP conservation goals will have the tentative PQP designation removed through RCAs final reconciliation process for PQP lands which is currently underway. [Personal communication with Ken Graff, RCA, January 27, 2009].

The proposed project is not located within a Criteria Area as established by the MSHCP. The proposed project area is not located in habitat assessment areas identified in the MSHCP and it lacks suitable habitat for species listed in Sections 6.1.2 (Protection of Species Associated with Riparian/Riverine Areas and Vernal Pools) and 6.1.3 (Protection of Narrow Endemic Species) of the MSHCP. Furthermore, the proposed project is not located within additional survey areas identified in Section 6.3.2 of the MSHCP. The project is not located in proximity to the MSHCP conservation area as described in Section 6.1.4 (Guidelines Pertaining to the Urban/Wildlife Interface) of the MSHCP, and is, therefore, not subject to the guidelines in this

<i>Potentially Significant Impact</i>	<i>Potentially Significant Unless Mitigation Incorporated</i>	<i>Less than Significant Impact</i>	<i>No Impact</i>
---	---	---	------------------

section.

The District shall implement applicable provisions of Section 7.5.3 (Construction Guidelines) and Appendix C Standard Best Management Practices in compliance with the MSHCP. Additionally, Section 13.4 of the MSHCP Implementing Agreement requires the District to pay a mitigation fee to RCA equal to 3% of the project's capital cost. Thus, the proposed project is consistent with the MSHCP.

V. CULTURAL RESOURCES. Would the project:

- Va) Cause a substantial adverse change in the significance of a historical resource as defined in §15064.5? (1,2)

Less Than Significant. It is unlikely that any historical, archaeological or paleontological resources will be impacted during construction. A record search conducted by the Eastern Information Center and the Native American Heritage Commission failed to indicate the presence of any known cultural resources or archaeological resources within the project area. Additionally, project construction will take place primarily within previously excavated areas e.g., existing street and channel rights-of-way.

If any cultural resources (historic or prehistoric) are exposed during ground excavation, ground disturbance activities in the vicinity of the discovery will be terminated immediately until a qualified cultural resources specialist evaluates the resources. Any discovered resources that merit long-term consideration shall be collected and reported in accordance with standard archaeological management requirements.

- Vb) Cause a substantial adverse change in the significance of an archaeological resource pursuant to §15064.5? (1,2)

Less Than Significant. Refer to response Va) above.

- Vc) Directly or indirectly destroy a unique paleontological resource site or unique geologic feature? (1,2)

Less Than Significant. Refer to response Va) above.

- Vd) Disturb any human remains, including those interred outside of formal cemeteries? (1,2)

Less Than Significant. It is unlikely that human remains are located within the proposed project area.

Per State Health and Safety Code 7050.5, if human remains are encountered during construction, no further disturbance shall occur until the Riverside County Coroner has made a determination of origin and disposition pursuant to Public Resources Code Section 5097.98. The Riverside County Coroner must be notified within 24 hours. If the County Coroner determines that the remains are not historic, but prehistoric, the Native American Heritage Commission (NAHC) must be contacted to determine the most likely descendent for this area.

Potentially Significant Impact
 Potentially Significant Unless Mitigation Incorporated
 Less than Significant Impact
 No Impact

Once the most likely descendent is determined, treatment of the Native American human remains will proceed pursuant to Public Resources Code 5097.98. The NAHC may become involved with decisions concerning the disposition of the remains.

VI. GEOLOGY AND SOILS. Would the project:

Via) Expose people or structures to potential substantial adverse effects, including the risk of loss, injury or death involving:

- i) Rupture of a known earthquake fault, as delineated on the most recent Alquist-Priolo Earthquake Fault Zoning Map issued by the State Geologist for the area or based on other substantial evidence of a Known fault? Refer to Division of Mines and Geology Special Publication 42. (1,2)

Less Than Significant Impact. According to Figure 12 of the Temescal Canyon Area Plan of the RCIP, the project site is within a half mile of a currently delineated State of California, Alquist-Priolo Earthquake Fault Zone, the Elsinore Fault. The proposed project is a storm drain facility located within existing public rights-of-way. Thus, the proposed project will not expose people or structures to potential substantial adverse effects resulting from seismic activity.

- ii) Strong seismic groundshaking? (1,2)

Less Than Significant Impact. Most of southern California is subject to strong seismic ground shaking due to the sheer number of faults traversing the region. According to Figure S-12 of the RCIP, the project area is located within an area of "very high" risk for seismic ground shaking. However, the proposed project is a storm drain facility located within existing public rights-of-way. Therefore, the proposed project will not expose people or structures to potential substantial adverse effects due to seismic ground shaking.

- iii) Seismic-related ground failure, including liquefaction? (N/A)

Less Than Significant Impact. According to Figure 12 of the Temescal Canyon Area Plan of the RCIP, the project is located within an area that contains shallow groundwater, and sediments are depicted as having low to very high susceptibility of liquefaction. However, the proposed project is a storm drain facility located within existing public rights-of-way. Therefore, the proposed project will not have a significant impact on people or structures due to seismic-related ground failure.

- iv) Landslides or mudflows? (N/A)

No Impact. According to Figure 14 of the Temescal Canyon Area Plan of the RCIP, the project area is not identified as being susceptibility for seismically-induced

Potentially Significant Impact *Potentially Significant Unless Mitigation Incorporated* *Less than Significant Impact* *No Impact*

landslides or mudflows. The proposed project will not expose people or structures to landslides or mudflows.

- VIb) Result in substantial changes in topography, unstable soil conditions from excavation, grading or fill, or soil erosion or the loss of topsoil? (1,2)

Less Than Significant Impact. During construction, excavated areas will be subject to erosion but any potential adverse impacts will be minimized by implementing an effective combination of construction-site erosion and sediment control measures. Pursuant to the applicable provisions of the NPDES Municipal Permit for Stormwater Discharges Associated with Construction Activity, the District's construction contractor will be required to prepare and implement a Stormwater Pollution Prevention Plan (SWPPP) to control erosion and sedimentation.

- VIc) Be located on a geologic unit or soil that is unstable, or that would become unstable as a result of the project, and potentially result in on- or off-site landslide, lateral spreading, subsidence, liquefaction or collapse? (1,2)

No Impact. The proposed project will not be located on a geologic unit or soil that is unstable, or that would become unstable as a result of the project.

- VIId) Be located on expansive soil, as defined in Table 18-1-B of the Uniform Building Code (1994), creating substantial risks to life or property? (1,2)

No Impact. The proposed project is not located in an area known to have expansive soils. A geotechnical report will be prepared prior to the finalization of the project's design. Recommendations from the report will be incorporated into the design and construction of the project. Therefore, the project will not create substantial risks to life or property.

VII. HAZARDS AND HAZARDOUS MATERIALS.

Would the project:

- VIIa) Create a significant hazard to the public or the environment through the routine transport, use, or disposal of hazardous materials? (N/A)

Less Than Significant Impact. Construction of the proposed project involves the use of fuel and other petroleum products for construction vehicles and equipment. The construction phase may include the transport of gasoline and diesel fuel to the project site and onsite storage for the sole purpose of fueling construction equipment. Best Management Practices (BMPs) stipulating proper storage of hazardous materials and vehicle fueling will be included in the SWPPP. Future maintenance activities may involve the occasional limited use of herbicides and pesticides in accordance with Federal, State and local regulations.

BMPs will be in place to ensure the lawful and proper storage and use of these materials. All

<i>Potentially Significant Impact</i>	<i>Potentially Significant Unless Mitigation Incorporated</i>	<i>Less than Significant Impact</i>	<i>No Impact</i>
---	---	---	------------------

transport, handling, use and disposal of substances such as petroleum products, solvents and paints related to construction, operation and maintenance of the flood control facilities will comply with all Federal, State and local laws regulating the management and use of hazardous materials. Therefore, the project will not create a significant hazard to the public or the environment.

- VIIb) Create a significant hazard to the public or the environment through reasonably foreseeable upset and accident conditions involving the release of hazardous materials into the environment? (1,2,4)

Less Than Significant Impact. The proposed project involves the incidental handling of hazardous materials through the operation and maintenance of equipment used for construction of the proposed project. However, BMPs will be implemented for the duration of project construction that will avoid and minimize the release of hazardous materials into the environment. See response VIIa).

- VIIc) Emit hazardous emissions or handle hazardous or acutely hazardous materials, substances, or waste within one-quarter mile of an existing or proposed school? (N/A)

Less Than Significant Impact. The project area is located within the Corona Unified School District. One school facility exists within 1/4 mile of the proposed project area. The proposed project does not include any activities or uses that would pose a significant source for hazardous emissions or hazardous materials.

The District will comply or, in the case of its contractors, require compliance with all Federal, State and local laws regulating the use, storage and transport of hazardous materials.

- VIIId) Be located on a site, which is included on a list of hazardous materials sites compiled pursuant to Government Code Section 65962.5 and, as a result, would it create a significant hazard to the public or the environment? (4)

Less Than Significant Impact. A review of the Department of Toxic Substance Control's Hazardous Waste and Substances List (Cortese List) indicates that the proposed project is not located on any identified hazardous material sites. Also, a review of the State Water Resources Control Board's Leaking Underground Storage Tank (LUST) database and the Environmental Protection Agency's Enviromapper database indicates that there are no LUSTs within the proposed project area. However, there is a low potential that excavation activities during construction could uncover hazardous materials. In the event that hazardous waste is discovered during site preparation or construction, the identified hazardous waste and/or hazardous material shall be handled and disposed of in the manner specified by the State of California Hazardous Substances Control Law (Health and Safety Code, Division 20, Chapter 6.5) and according to the requirements of the California Administrative Code, Title 30, Chapter 22.

- VIIe) For a project located within an airport land use plan or, where such a plan has not been adopted,

Potentially Significant Impact	Potentially Significant Unless Mitigation Incorporated	Less than Significant Impact	No Impact
--------------------------------------	--	------------------------------------	-----------

within two miles of a public airport or public use airport, would the project result in a safety hazard for people residing or working in the project area? (N/A)

No Impact. The project will not be located within an airport land use plan or within an area that may be affected by an airport.

VIIIf) For a project within the vicinity of a private airstrip, would the project result in a safety hazard for people residing or working in the project area? (N/A)

No Impact. The project will not be located within the vicinity of a private airstrip.

VIIIf) Impair implementation of or physically interfere with an adopted emergency response plan or emergency evacuation plan? (1)

No Impact. According to the RCIP, an adopted emergency response plan or emergency plan does not exist within the proposed project area. The Traffic Control Plan prepared for the project will ensure that temporary construction impacts will not significantly interfere or impair traffic flow or access through the project area. Temporary traffic impacts associated with the proposed project are further addressed in Section XV of this document.

VIII. HYDROLOGY AND WATER QUALITY. Would the project:

VIIIa) Result in substantial discharges of typical storm water pollutants (*e.g. sediment from construction activities, hydrocarbons, and metals from motor vehicles, nutrients and pesticides from landscape maintenance activities, metals of other pollutants from industrial operation,*) or substantial changes to surface water quality including, but not limited to, temperature, dissolved oxygen, pH, or turbidity? (N/A)

Less Than Significant Impact. Implementation of the proposed project will result in the construction, operation and maintenance of a storm drain system. The proposed storm drain will outlet into the District's existing concrete El Cerrito Channel northeast of the intersection of Ontario Avenue and El Cerrito Road. The proposed project will not create new sources of stormwater pollution. The storm drain is designed to collect and convey stormwater runoff emanating from the surrounding developed areas. This runoff is expected to contain various stormwater pollutants in amounts that are typically found in stormwater runoff emanating from urbanized areas.

Due to the fact that the proposed project will not change the existing or proposed landuse of the surrounding area, the type and amount of typical stormwater pollutants in the runoff discharged by the project is not expected to vary significantly from the existing condition. It

<i>Potentially Significant Impact</i>	<i>Potentially Significant Unless Mitigation Incorporated</i>	<i>Less than Significant Impact</i>	<i>No Impact</i>
---	---	---	------------------

is anticipated that the proposed project will provide some measure of incidental water quality benefit by conveying stormwater within the storm drain system rather than allowing stormwater to sheet flow through residences, streets and other urbanized areas.

The discharge of pollutants will be further minimized through the ongoing implementation of the District's and County of Riverside's compliance programs under the National Pollutant Discharge Elimination System (NPDES) Municipal Separate Storm Sewer System (MS4) permit issued by the California Regional Water Quality Control Board, Santa Ana Region. The MS4 permit requires that the District, County and other municipalities implement a broad range of BMPs to reduce the discharge of stormwater pollutants to the maximum extent practicable. These BMPs are specified in each permittee's Stormwater Management Plan.

The potential short-term discharge of stormwater pollutants during construction activities will be minimized to an insignificant level through the implementation of the BMPs stipulated in the SWPPP [see also VIb) and VIIa)].

- VIIIb) Substantially deplete groundwater supplies or interfere substantially with groundwater recharge such that there would be a net deficit in aquifer volume or a lowering of the local groundwater table level (*e.g., the production rate of pre-existing nearby wells would drop to a level which would not support existing land uses or planned uses for which permits have been granted*)? (N/A)

No Impact. The proposed project will not result in the withdrawal or use of groundwater. The proposed storm drain system will be constructed within an area that is already developed and where substantial groundwater recharge does not currently occur. Therefore, the proposed project will not deplete groundwater supplies or interfere with groundwater recharge such that there would be a net deficit in aquifer volume or a lowering of the local groundwater table level.

- VIIIc) Substantially alter the existing drainage pattern of the site or area, including through the alteration of a watercourse or wetland, in a manner which would result in substantial erosion or siltation on- or off-site? (N/A)

Less than Significant Impact. Drainage patterns in the project area will not be altered in a manner which would result in the alteration of a watercourse, wetland, substantial erosion, or siltation on or offsite. The proposed project will relieve local erosion, siltation and flooding problems within an existing urbanized area by providing a system of adequate drainage infrastructure in the area.

- VIIIId) Substantially alter the existing drainage pattern of the site or area, including through the alteration of a watercourse or wetland, or substantially increase the rate or amount of surface runoff in a manner which would result in flooding on- or off-site? (N/A)

<i>Potentially Significant Impact</i>	<i>Potentially Significant Unless Mitigation Incorporated</i>	<i>Less than Significant Impact</i>	<i>No Impact</i>
---	---	---	------------------

No Impact. The proposed project lies within an area that is already developed and the project does not alter existing or proposed landuse within the project area, therefore, the project will not increase the quantity of surface water runoff.

Implementation of the proposed project will result in the construction, operation and maintenance of a storm drain system that will outlet into the District's existing El Cerrito Channel northeast of the intersection of Ontario Avenue and El Cerrito Road. El Cerrito has sufficient capacity to convey the runoff from the proposed project.

- VIIIe) Create or contribute runoff water, which would exceed the capacity of existing or planned stormwater drainage systems or provide substantial additional sources of polluted runoff? (N/A)

No Impact. The proposed project does not modify existing landuse, therefore, the project will not create or contribute new sources of stormwater runoff or polluted runoff. See VIIIId above.

- VIIIIf) Substantially change the amount of surface water in any water body or wetlands? (N/A)

Less Than Significant Impact. The proposed storm drain system will convey surface runoff to the existing concrete lined El Cerrito Channel northeast of the intersection of Ontario Avenue and El Cerrito Road. El Cerrito Channel continues for approximately 2500 feet to the northeast where it drains into Temescal Wash. El Cerrito Channel is not a natural water body or wetland. It only receives infrequent ephemeral stormwater discharges. Since the proposed project will collect and convey surface runoff toward the existing channel, storm flows may reach the channel more frequently. However, the outlet will be a maintained flood control facility. Mitigation is not required.

- VIIIg) Place housing within a 100-year flood hazard area as mapped on a federal Flood Hazard Boundary or Flood Insurance Rate Map or other flood hazard delineation map? (N/A)

No Impact. The proposed project will not place housing within a 100-year flood hazard area. The proposed facility will reduce the exposure of people and property to local flood hazards.

- VIIIh) Place structures or fill within a 100-year flood hazard area, which would impede or redirect flood flows? (N/A)

No Impact. The proposed project site is not mapped as a 100-year flood hazard area. The proposed facility will reduce the exposure of people and property to local flood hazards.

- VIIIi) Expose people or structures to a significant risk of loss, injury or death involving flooding, including flooding as a result of the failure of a levee or dam? (N/A)

No Impact. Refer to responses VIIIg) and VIIIh).

<i>Potentially Significant Impact</i>	<i>Potentially Significant Unless Mitigation Incorporated</i>	<i>Less than Significant Impact</i>	<i>No Impact</i>
---	---	---	------------------

IX. LAND USE PLANNING. Would the project:

- IXa) Physically divide an established community?
(N/A)

No Impact. The proposed project is an underground storm drain located mostly within existing streets. The project would not physically divide an established community.

- IXb) Conflict with any applicable land use plan, policy, or regulation of an agency with jurisdiction over the project (including, but not limited to the general plan, specific plan, local coastal program, or zoning ordinance) adopted for the purpose of avoiding or mitigating an environmental effect? (1,2)

No Impact. The proposed project is consistent with the City of Corona and RCIP designation and will not impact existing or proposed land uses.

- IXc) Conflict with any applicable habitat conservation plan or natural community conservation plan? (5)

Less Than Significant Impact. On June 17, 2003, the Riverside County Board of Supervisors adopted the Western Riverside County Multiple Species Habitat Conservation Plan (MSHCP). The MSHCP is a comprehensive, multi-jurisdictional habitat conservation plan focusing on the conservation of species and their associated habitats in Western Riverside County. The existing concrete channel is located on property the Riverside Conservation Authority (RCA) tentatively identified as Public/Quasi Public (PQP) Lands per the MSHCP; however, the proposed channel reconstruction will not alter the existing land use in such a way that it no longer contributes to the MSHCP "Reserve Assembly". Pursuant to recent discussion with RCA staff, existing District right of way that lacks significant habitat or does not otherwise support MSHCP conservation goals will have the tentative PQP designation removed through RCAs final reconciliation process for PQP lands which is currently underway. [Personal communication with Ken Graff, RCA, January 27, 2009]. The proposed project is not located within a Criteria Area as established by the MSHCP. The proposed project area is not located in habitat assessment areas identified in the MSHCP and it lacks suitable habitat for species listed in Sections 6.1.2 (Protection of Species Associated with Riparian/Riverine Areas and Vernal Pools) and 6.1.3 (Protection of Narrow Endemic Species) of the MSHCP. Furthermore, the proposed project is not located within additional survey areas identified in Section 6.3.2 of the MSHCP. The project is not located in proximity to the MSHCP conservation area as described in Section 6.1.4 (Guidelines Pertaining to the Urban/Wildlife Interface) of the MSHCP, and is, therefore, not subject to the guidelines in this section. The District shall implement applicable provisions of Section 7.5.3 (Construction Guidelines) and Appendix C Standard Best Management Practices in compliance with the MSHCP. Additionally, Section 13.4 of the MSHCP Implementing Agreement requires the District to contribute mitigation through payment of 3% of total capital costs. Such payment may be offset through acquisition of replacement habitat or creation of new habitat. The mitigation must be implemented prior to impacts to Covered Species or their habitat. The District shall fully comply with these obligations.

<i>Potentially Significant Impact</i>	<i>Potentially Significant Unless Mitigation Incorporated</i>	<i>Less than Significant Impact</i>	<i>No Impact</i>
---	---	---	------------------

X. MINERAL RESOURCES. Would the project:

- Xa) Result in the loss of availability of a known mineral resource that would be of value to the region and the residents of the state? (1,2)

No Impact. According to the RCIP much of the project vicinity is classified by the State of California as a Mineral Resource Zone 3 (MRZ-3). This classification denotes mineral deposits are likely to exist, however, the significance of the deposit is undetermined. The proposed project is an underground storm drain system mostly located within existing street rights-of-way and would not affect known mineral resources and would not change any land uses within the project area that would affect known mineral resources.

- Xb) Result in the loss of availability of a locally important mineral resource recovery site delineated on a local general plan, specific plan or other land use plan? (1,2)

No Impact. The project site is not within a delineated mineral resource recovery area.

XI. NOISE. Would the project result in:

- XIa) Exposure of persons to or generation of noise levels in excess of standards established in the local general plan or noise ordinance, or applicable standards of other agencies? (N/A)

Potentially Significant Unless Mitigation Incorporated. The proposed project would involve the temporary and intermittent use of construction equipment for various construction and maintenance activities over the life of the project. Construction and maintenance equipment may result in temporary increases above existing noise levels. Limiting construction and maintenance activities to daylight working hours on weekdays when adjacent areas are less sensitive to changes in noise levels than evening and weekend hours will ensure that the proposed project does not conflict with local noise policies.

MM XI-1 Use of heavy equipment that may impact adjacent residential areas shall be limited from 7 a.m. to 7 p.m. during weekdays, and prohibited on Saturdays, Sundays and holidays, except under special circumstances approved by the District.

- XIb) Exposure of persons to or generation of excessive groundborne vibration or groundborne noise levels? (N/A)

Potentially Significant Unless Mitigation Incorporated. The proposed project would involve the temporary and intermittent use of construction equipment for various construction and maintenance activities over the life of the project. Construction and maintenance equipment may result in temporary increases above existing noise levels. Construction equipment noise generally ranges from 70 to 95 dBA at 50 feet from the source. At about 500 feet from the source, intermittent levels from the loudest construction equipment would be

Potentially Significant Impact
 Potentially Significant Unless Mitigation Incorporated
 Less than Significant Impact
 No Impact

about 75 dBA. Maintenance activities would be infrequent and involve less equipment than the initial construction of the proposed project. Residential areas are located adjacent to the project site and could be temporarily affected by increased noise levels during construction. The long-term operation and maintenance of the proposed project would not cause a significant increase in noise levels. To ensure that potential short-term impacts are less than significant, the proposed project will comply with mitigation measures XI-1 and XI-2, and Section 17.84.040 of the City of Corona Municipal Code.

MM XI-2 Each resident adjacent to the storm drain construction site shall be notified in writing three days prior to operating heavy construction equipment near the residents. The notice shall include the expected work schedule and the District's contact information. The District shall alert the construction contractor of any noise complaints and incorporate any feasible and practical techniques which minimize the noise impacts on adjacent residences.

XIc) A substantial permanent increase in ambient noise levels in the project vicinity above levels existing without the project? (N/A)

No Impact. The construction, operation or maintenance of the proposed project will not result in a permanent substantial ambient noise increase. Mitigation is not required.

XId) A substantial temporary or periodic increase in ambient noise levels in the project vicinity above levels existing without the project? (N/A)

Potentially Significant Unless Mitigation Incorporated. See response XIa).

XIe) For a project located within an airport land use plan or, where such a plan has not been adopted, within two miles of a public airport or public use airport, would the project expose people residing or working in the project area to excessive noise levels? (N/A)

No Impact. The proposed project area is not located within two miles of a public airport or public use airport, which would expose people residing or working in the project area to excessive noise levels.

XIf) For a project within the vicinity of a private airstrip, would the project expose people residing or working in the project area to excessive noise levels? (N/A)

No Impact. The proposed project is not located within the vicinity of a private airstrip that would expose people residing or working in the project area to excessive noise levels.

XII. POPULATION AND HOUSING. Would the project:

XIIa) Induce substantial population growth in an area,

<i>Potentially Significant Impact</i>	<i>Potentially Significant Unless Mitigation Incorporated</i>	<i>Less than Significant Impact</i>	<i>No Impact</i>
---	---	---	------------------

either directly (for example, by proposing new homes and businesses) or indirectly (for example, through extension of roads or other infrastructure)? (1,2)

No Impact. The proposed storm drain will provide improved flood protection to an area that, for the most part, is already developed. The proposed project is not expected to result in any change to existing land use patterns or trigger substantial growth in the area. Regardless, any development that may occur is subject to the policies of the City of Corona General Plan and the Riverside County Comprehensive General Plan, and to further review by the City and the County.

XIIb) Displace substantial numbers of existing housing, necessitating the construction of replacement housing elsewhere? (N/A)

No Impact. Existing residential structures within the proposed project area will not be displaced nor will replacement housing be necessary.

XIIc) Displace substantial numbers of people, necessitating the construction of replacement housing elsewhere? (N/A)

No Impact. Refer to response XIIb).

XIII. PUBLIC SERVICES.

XIIIa) Would the project result in substantial adverse physical impacts associated with the provision of new or physically altered governmental facilities, need for new or physically altered governmental facilities, the construction of which could cause significant environmental impacts, in order to maintain acceptable service ratios, response times or other performance objectives for any of the following public services:

Fire protection? (N/A)

No Impact. The construction of the proposed project will not impact existing fire protection services or other public services. Standard construction and notification procedures will avoid any potential impacts related to temporary street closures and other potential traffic impacts during construction. Once implemented, the proposed project will reduce the need for fire department services related to flooding.

Police protection? (N/A)

No Impact. Refer to response XIIIa).

Schools? (N/A)

	<i>Potentially Significant Unless Mitigation Incorporated</i>	<i>Potentially Significant</i>	<i>Less than Significant Impact</i>	<i>No Impact</i>
--	---	------------------------------------	---	------------------

No Impact. The construction of the proposed project will not impact any existing schools.

Parks? (N/A)

No Impact. The construction of the proposed project will not impact any existing parks.

Maintenance of public facilities, including roads? (N/A)

No Impact. Public roads and flood control facilities are the only public facilities that may be impacted by the proposed project. Once completed, the proposed project will reduce the potential for flood damage to the public roads within the project area. Thus, the need to maintain and repair public roads due to flood damage will be reduced.

Other governmental facilities? (N/A)

No Impact. No additional government services will be impacted by the proposed project.

XIV. RECREATION.

XIVa) Would the project increase the use of existing neighborhood and regional parks or other recreational facilities such that substantial physical deterioration of the facility would occur or be accelerated? (N/A)

No Impact. The proposed project will not increase the use of any parks or recreational facilities.

XIVb) Does the project include recreational facilities or require the construction or expansion of recreational facilities which might have an adverse physical effect on the environment? (N/A)

No Impact. The project does not include recreational facilities nor will it require the construction and expansion of such facilities.

XV. TRANSPORTATION AND TRAFFIC. Would the project:

XVa) Cause an increase in traffic, which is substantial in relation to the existing traffic load and capacity of the street system (i.e., result in a substantial increase in either the number of vehicle trips, the volume to capacity ratio on roads, or congestion at intersections)? (N/A)

Potentially Significant Impact	Potentially Significant Unless Mitigation Incorporated	Less than Significant Impact	No Impact
--------------------------------------	--	------------------------------------	-----------

Less Than Significant Impact. The proposed storm drain system will be constructed mostly within existing roads. Any traffic impacts will be limited to the construction period. Temporary street and lane closures during construction will be coordinated with the City of Corona and the County Transportation Department to ensure that adverse impact to traffic flow is less than significant. Construction workers and other construction related vehicles traveling to the project site may result in a minor increase in traffic volume in the vicinity of the project during the approximate 9-month construction period, however, the minor amount of increased traffic will not substantially change existing levels of traffic.

- XVb) Exceed, either individually or cumulatively, a level of service standard established by the county congestion management agency for designated roads or highways? (N/A)

No Impact. The proposed project will not result in any permanent changes in traffic levels. Refer to response XVa) above.

- XVc) Substantially increase hazards due to a design feature (e.g., sharp curves or dangerous intersections) or incompatible uses (e.g., farm equipment)? (N/A)

No Impact. Existing roadways will not be modified.

- XVd) Result in inadequate emergency access? (N/A)

Potentially Significant Unless Mitigation Incorporated. The construction of the proposed facility may require temporary lane closures on nearby roads. A Traffic Control Plan (TCP) that will detail and coordinate all traffic movement through the project area will be implemented throughout project construction. The TCP will be reviewed and approved by the City/County prior to construction. With the implementation of the TCP, combined with the short-term nature of traffic-related impacts and the inclusion of the following mitigation measure, impacts to emergency access will be less than significant:

MM XV-1 At all times during construction, the contractor shall ensure that emergency fire or medical vehicles are able to access all adjacent areas.

- XVe) Result in inadequate parking capacity? (N/A)

No Impact. The proposed project will not affect any existing parking facilities or increase the need for additional parking facilities. Temporary parking related to construction activities is typically available on the construction site.

XVI. UTILITIES AND SERVICE SYSTEMS. Would the project

- XVIa) Require or result in the construction or relocation of water or wastewater treatment or transmission facilities or expansion of existing facilities, the construction of which could cause significant environmental effects? (N/A)

<i>Potentially Significant Impact</i>	<i>Potentially Significant Unless Mitigation Incorporated</i>	<i>Less than Significant Impact</i>	<i>No Impact</i>
---	---	---	------------------

Less Than Significant Impact. The proposed project will not require or result in the construction of water or wastewater treatment or transmission facilities or expansion of existing facilities.

Minor relocations of existing utility lines, e.g., water, sewer, gas, telephone, etc., may be required during construction to avoid conflict with the alignment of the proposed project. All utility relocations that may be required will be coordinated with the utility owners. Because these minor utility relocations will occur within the project footprint and only during the construction of the proposed storm drain system, the impact upon existing utilities and service systems will be less than significant.

- XVIb) Require or result in the construction of new storm water drainage facilities or expansion of existing facilities, the construction of which could cause significant environmental effects? (N/A)

Less Than Significant Impact. The proposed project consists of the construction of drainage facilities to alleviate flooding within the project area. Other drainage facilities will not be required as a result of the proposed project.

- XVIc) Have sufficient water supplies available to serve the project from existing entitlements and resources, or are new or expanded entitlements needed? (N/A)

No Impact. The proposed project will only require the temporary use of water during construction. Existing water supplies are expected to be adequate.

- XVI d) Result in a determination by the wastewater treatment provider which serves or may serve the project that it has adequate capacity to serve the project's projected demand in addition to the provider's existing commitments? (N/A)

No Impact. The proposed project will not result in any wastewater discharges.

- XVI e) Be served by a landfill with sufficient permitted capacity to accommodate the project's solid waste disposal needs? (N/A)

Less Than Significant Impact. The implementation of the proposed project will only result in the temporary generation of solid waste during construction. Increased waste quantities will be minimal when compared to existing waste streams. Existing solid waste disposal facilities are expected to dispose of construction generated waste with no significant impacts.

- XVI f) Comply with federal, state, and local statutes and regulations related to solid waste? (N/A)

No Impact. Any waste disposal that is required during project construction or maintenance will be done in compliance with the appropriate statutes and regulations.

	<i>Potentially Significant Unless Mitigation Incorporated</i>	<i>Potentially Significant</i>	<i>Less than Significant Impact</i>	<i>No Impact</i>
<i>Potentially Significant Impact</i>				

XVII. MANDATORY FINDINGS OF SIGNIFICANCE.

XVIIa) Does the project have the potential to degrade the quality of the environment, substantially reduce the habitat of a fish or wildlife species, cause a fish or wildlife population to drop below self-sustaining levels, threaten to eliminate a plant or animal community, reduce the number or restrict the range of a rare or endangered plant or animal or eliminate important examples of the major periods of California history or prehistory?

Less Than Significant Impact. As demonstrated by this Initial Study/Environmental Assessment, potential impacts to the environment, wildlife, vegetation and cultural resources will not occur, will be less than significant or will be mitigated to a level of insignificance.

XVIIb) Does the project have the potential to achieve short-term, to the disadvantage of long-term, environmental goals?

No Impact. As shown by this Initial Study/Environmental Assessment, the proposed project will not result in significant adverse impacts to long-term environmental goals.

XVIIc) Does the project have impacts that are individually limited, but cumulatively considerable? (*"Cumulatively considerable" means that the incremental effects of a project are considerable when viewed in connection with the effects of past projects, the effects of other current projects, and the effects of probable future projects.*)

Less Than Significant Impact. As discussed in this document, most of the potential adverse impacts such as noise and air quality are temporary and will cease upon construction completion. Due to the relatively small area of impact and the relatively short construction period, potential impacts would not be cumulatively considerable.

XVIIId) Does the project have environmental effects, which will cause substantial adverse effects on human beings, either directly or indirectly?

No Impact. Substantial direct or indirect effects on human beings have not been identified by this Environmental Assessment/Initial Study.

DETERMINATION: (To be completed by the Lead Agency)

On the basis of this initial evaluation:

- I find that the proposed project COULD NOT have a significant effect on the environment, and a NEGATIVE DECLARATION will be prepared.
- I find that although the proposed project could have a significant effect on the environment, there will not be a significant effect in this case because the mitigation measures described on an attached sheet have been added to the project. A MITIGATED NEGATIVE DECLARATION will be prepared.
- I find that the proposed project MAY have a significant effect on the environment, and an ENVIRONMENTAL IMPACT REPORT is required.
- I find that the proposed project MAY have a "potentially significant impact" or "potentially significant unless mitigated" impact on the environment, but at least one effect 1) has been adequately analyzed in an earlier document pursuant to applicable legal standards, and 2) has been addressed by mitigation measures based on the earlier analysis as described on attached sheets, if the effect is a "potentially significant impact" or "potentially significant unless mitigated." An ENVIRONMENTAL IMPACT REPORT is required, but it must analyze only the effects that remain to be addressed.
- I find that although the proposed project could have a significant effect on the environment, there WILL NOT be a significant effect in this case because all potentially significant effects (a) have been analyzed adequately in an earlier EIR pursuant to applicable standards, and (b) have been avoided or mitigated pursuant to that earlier EIR, including revisions or mitigation measures that are imposed upon the proposed project.

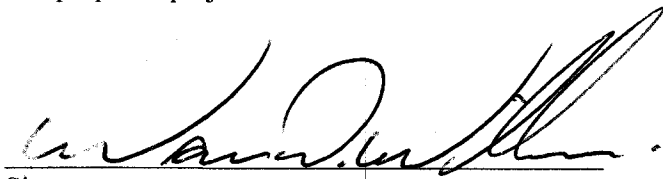

Signature

WARREN D. WILLIAMS

Printed Name

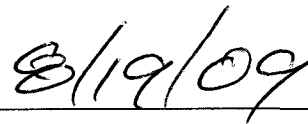

Date

General Manager-Chief Engineer

Title

INITIAL STUDY CHECKLIST REFERENCE LIST

1. RCIP, Riverside County Planning Department, Adopted October 7, 2003
2. City of Corona General Plan, March 17, 2004
3. South Coast Air Quality Management District, Air Quality Handbook, Chapter 6 "Determining the Air Quality Significance of a Project"
4. Hazardous Waste and Substance Sites List (Cortese List)
5. Western Riverside County Multiple Species Habitat Conservation Plan, Adopted June 17, 2003

COMMENTS AND RESPONSES



Conti

ARNOLD SCHWARZENEGGER
GOVERNOR

July 23, 2009

Kris Flanigan
Riverside County Flood Control and Water Conservation
1995 Market Street
Riverside, CA 92501

Subject: Corona Drains East Ontario Avenue Storm Drain, Stage 1
SCH#: 2009061086

Dear Kris Flanigan:

The State Clearinghouse submitted the above named Mitigated Negative Declaration to selected state agencies for review. The review period closed on July 21, 2009, and no state agencies submitted comments by that date. This letter acknowledges that you have complied with the State Clearinghouse review requirements for draft environmental documents, pursuant to the California Environmental Quality Act.

Please call the State Clearinghouse at (916) 445-0613 if you have any questions regarding the environmental review process. If you have a question about the above-named project, please refer to the ten-digit State Clearinghouse number when contacting this office.

Sincerely,

Terry Roberts
Director, State Clearinghouse

STATE OF CALIFORNIA

GOVERNOR'S OFFICE *of* PLANNING AND RESEARCH

STATE CLEARINGHOUSE AND PLANNING UNIT

RECEIVED

JUL 29 2009

RIVERSIDE COUNTY FLOOD CONTROL
WATER CONSERVATION DISTRICT



CYNTHIA BRYANT
DIRECTOR

**Document Details Report
State Clearinghouse Data Base**

SCH# 2009061086
Project Title Corona Drains East Ontario Avenue Storm Drain, Stage 1
Lead Agency Riverside County Flood Control and Water Conservation

Type MND Mitigated Negative Declaration
Description The proposed project is the construction, operation and maintenance of a flood control and drainage system consisting of 4,400 lineal ft of new underground storm drain, ranging from ~30 inches to 84 inches in diameter, and the removal and reconstruction of ~360 ft of existing concrete channel.

Lead Agency Contact

Name Kris Flanigan
Agency Riverside County Flood Control and Water Conservation
Phone 951-955-8581 **Fax**
email
Address 1995 Market Street
City Riverside **State** CA **Zip** 92501

Project Location

County Riverside
City Corona
Region
Lat / Long
Cross Streets Ontario Ave & El Cerrito Rd
Parcel No. 277-120 (various)
Township 4S **Range** 6W **Section** 8 **Base** SBB&M

Proximity to:

Highways I-15
Airports
Railways
Waterways Temescal Wash
Schools El Cerrito Intermediate, Santiago HS, Orange ES, Susan B Anthony ES
Land Use

Project Issues Noise; Traffic/Circulation

Reviewing Agencies Resources Agency; Department of Fish and Game, Region 6; Department of Parks and Recreation; California Highway Patrol; Caltrans, District 8; Regional Water Quality Control Board, Region 8; Native American Heritage Commission

Date Received 06/22/2009 **Start of Review** 06/22/2009 **End of Review** 07/21/2009

STATE OF CALIFORNIA

Arnold Schwarzenegger, Governor

NATIVE AMERICAN HERITAGE COMMISSION

915 CAPITOL MALL, ROOM 364
SACRAMENTO, CA 95814
(916) 653-6251
Fax (916) 857-6390
Web Site www.nahc.ca.gov
e-mail: de_nahc@pacbell.net



November 14, 2008

Mr. Kris Flanigan

RIVERSIDE COUNTY FLOOD CONTROL AND WATER CONSERVATION DISTRICT

1995 Market Street
Riverside, CA 92501-1770

Sent by FAX to: 951-684-8409

No. of Pages: 3

Re: Request for a Sacred Lands File records search and Native American Contacts list for the proposed Corona Drains-East Ontario Avenue Storm Drain, Stage 1 (Project No. 2-0-00351-01) located in the unincorporated Temescal Area, Riverside County, California

Dear Mr. Flanigan:

The Native American Heritage Commission (NAHC) was able to perform a record search of its Sacred Lands File (SLF) for the affected project area/area of potential effect (APE). The SLF failed to indicate the presence of Native American cultural resources in the immediate project area. The absence of specific site information in the Sacred Lands File does not guarantee the absence of cultural resources in any project area.

Early consultation with Native American tribes in your area is the best way to avoid unanticipated discoveries once a project is underway. Enclosed are the names of culturally affiliated Native American Contacts that may have knowledge of cultural resources in the project area. A list of Native American contacts is attached to assist you. It is advisable to contact the persons listed; if they cannot supply you with specific information about the impact on cultural resources.

Lead agencies should consider avoidance, as defined in Section 15370 of the California Environmental Quality Act (CEQA) when significant cultural resources could be affected by a project. Also, Public Resources Code Section 15064.5(f) and Section 15097.98 and Health & Safety Code Section 7050.5 provide for provisions for accidentally discovered archeological resources during construction and mandate the processes to be followed in the event of an accidental discovery of any human remains in a project location other than a 'dedicated cemetery. Discussion of these should be included in your environmental documents, as appropriate.

If you have any questions about this response to your request, please do not hesitate to contact me at (916) 653-6251.

Sincerely,

Dave Singleton
Program Analyst

Attachment: Native American Contact List

Native American Contacts
Riverside County
November 14, 2008

Pechanga Band of Mission Indians
Paul Macarro, Cultural Resource Center
 P.O. Box 1477 Luiseno
 Temecula , CA 92593
 (951) 308-9295 Ext 8106
 (951) 676-2768
 (951) 506-9491 Fax

Cupa Cultural Center (Pala Band)
Shasta Gaughen, Assistant Director
 35008 Pala-Temecula Rd.PMB Box 445 Luiseno
 Pala , CA 92059
 cupa@palatribe.com
 (760) 742-1590
 (760) 742-4543 - FAX

Ramona Band of Cahuilla Mission Indians
Joseph Hamilton, Chairman
 P.O. Box 391670 Cahuilla
 Anza , CA 92539
 admin@ramonatribe.com
 (951) 763-4105
 (951) 763-4325 Fax

Willie Pink
 48310 Pechanga Road Luiseno
 Temecula , CA 92592
 wjpink@hotmail.com
 (909) 936-1216
 Prefers e-mail contact

Santa Rosa Band of Mission Indians
John Marcus, Chairman
 P.O. Box 609 Cahuilla
 Hemet , CA 92546
 srtribaloffice@aol.com
 (951) 658-5311
 (951) 658-6733 Fax

Soboba Band of Luiseno Indians
Erica Helms, Cultural Resources Manager
 P.O. Box 487 Luiseno
 San Jacinto , CA 92581
 dhill@soboba-nsn.gov
 (951) 654-2765
 FAX: (951) 654-4198

Morongo Band of Mission Indians
Michael Contreras, Cultural Heritage Prog. Manager
 13000 Fields Road Cahuilla
 Banning , CA 92220 Serrano
 (951) 755-5025
 (951)201-1866 - cell
 (951) 922-0105 Fax

This list is current only as of the date of this document.

Distribution of this list does not relieve any person of statutory responsibility as defined in Section 7050.5 of the Health and Safety Code, Section 5097.94 of the Public Resources Code and Section 5097.98 of the Public Resources Code.

This list is only applicable for contacting local Native Americans with regard to cultural resources for the proposed Corona Drains - East Ontario Avenue Storm Drain, Stage 1 (Project No. 2-0-00351-01; located in the Unincorporated Temescal Area of Riverside County, California for which a Sacred Lands File search and a Native American Contacts list were requested.

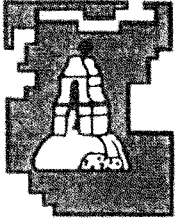

PALA BAND OF MISSION INDIANS

Tribal Historic Preservation Office
35008 Pala Temecula Rd. PMB 445
Pala, CA 92059

Ph: (760) 891-3591
Fax: (760) 742-4543

RECEIVED

JUN 01 2009

RIVERSIDE COUNTY FLOOD CONTROL
WATER CONSERVATION DISTRICT

May 27, 2009

Kris Flanigan, Senior Civil Engineer
Riverside County Flood Control
and Water Conservation District
1995 Market Street
Riverside, CA 92501

Re: Corona Drains – East Ontario Avenue S.D. Project No. 2-0-00351-01

Dear Mr. Flanigan:

The Pala Band of Mission Indians Tribal Historic Preservation Office has received your notification of the project referenced above. This letter constitutes our response on behalf of Robert Smith, Tribal Chairman.

We have consulted our maps and determined that the projects as described are not within the boundaries of the recognized Pala Indian Reservation. The projects are also beyond the boundaries of the territory that the tribe considers its Traditional Use Area (TUA). Therefore, we defer to the wishes of Tribes in closer proximity to the project areas.

We appreciate involvement with your initiative and look forward to working with you on future efforts. If you have questions or need additional information, please do not hesitate to contact me by telephone at 760-891-3591 or by e-mail at sgaughen@palatribe.com.

Sincerely,

Shasta C. Gaughen, MA
Tribal Historic Preservation Officer
Pala Band of Mission Indians

Native American Heritage Commission

Response

As described in Section V. of the Initial Study, known cultural resources do not exist within the project area. The District requested a Sacred Lands File Search for the referenced project. The enclosed NAHC letter dated November 14, 2008 indicates that Native American cultural resources are not present within the immediate project area. Nonetheless, the record search does not guarantee the absence of cultural resources. As recommended by the NAHC, the District has contacted all the nearest Native American tribes and requested any information they have regarding Native American cultural resources within the project area. To date, the District has received only the attached comment letter dated May 27, 2009 from the Pala Band of Mission Indians. The letter from the Pala Band states that the project is outside of the Pala Indian Reservation and beyond the territory the tribe considers its Traditional Use Area (TUA).

Applicable recommendations from the tribes will be incorporated into the final construction specifications. As stated in Section V of the Initial Study any unknown cultural resources uncovered during construction shall be evaluated by a qualified cultural resources specialist. Potential adverse impacts to cultural resources will remain below a level of significance.

EASTERN INFORMATION CENTER

CALIFORNIA HISTORICAL RESOURCES INFORMATION SYSTEM

Department of Anthropology, University of California, Riverside, CA 92521-0418

(951) 827-5745 - Fax (951) 827-5409 - eickw@ucr.edu

Inyo, Mono, and Riverside Counties

September 24, 2008

RC RIV ST-67
RECEIVED

SEP 29 2008

RIVERSIDE COUNTY FLOOD CONTROL
WATER CONSERVATION DISTRICT

Kris Flanigan
Riverside County Flood Control District
and Water Conservation District
1995 Market Street
Riverside, CA 92501

Re: Cultural Resources Records Search for the Corona Drains-Ontario Avenue
Storm Drain, Stage 1 (Project No. 2-0-00351-01)

Dear Mr. Flanigan,

We received your request on September 18, 2008, for a cultural resources records search for the Corona Drains-Ontario Avenue Storm Drain, Stage 1 project, located in Section 8 T.4S, R.6W, SBBM, in the El Cerrito area of Riverside County. We have reviewed our maps, records, and reports against the project area defined on the map you provided.

Our records indicate that five cultural resources studies have been conducted within a quarter-mile radius of your project area. Two of these studies involved the project area, and another is located immediately adjacent.

No cultural resources properties are recorded within the boundaries of the project area nor within a quarter-mile radius of the project area.

Additional sources of information consulted are identified below.

National Register of Historic Places (NRHP): no listed properties are located within the boundaries of the project area.

California Office of Historic Preservation (OHP), Archaeological Determinations of Eligibility (ADOE): no listed sites are located within the boundaries of the project area.

Kris Flanigan
September 24, 2008
Page 2

California Office of Historic Preservation (OHP), Historic Property Directory (HPD): no listed properties are located within the boundaries of the project area.

Note: not all properties in the California Historical Resources Information System are listed in the OHP ADOE and HPD; the ADOE and HPD comprise lists of properties submitted to the OHP for review.

The 1947 USGS Corona 15' topographic map does not indicate the presence of possible historical structures or features within the boundaries of the project area.

Based on the information reviewed, there is a low probability of cultural resources being present within the boundaries of the project area and further study is not recommended. However, this assessment does not rule out the possible presence of previously unidentified cultural resources. Persons involved in development of the project area should be sensitive to the significant and irreplaceable nature of cultural resources.

State and federal law requires that if any cultural resources are found during construction, work is to stop and the lead agency and a cultural resources professional be consulted to determine the importance of the find and its appropriate management.

Sincerely,

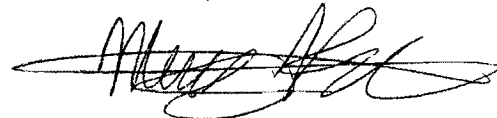
A handwritten signature in black ink, appearing to read 'Megan Rogers', written over a horizontal line.

Megan Rogers
Information Officer

Enclosure

Eastern Information Center

Response

As described in Section V. of the Initial Study, known cultural resources do not exist within the project area. The District requested a cultural resources records search from the Eastern Information Center (EIC) for the referenced project. The enclosed EIC letter dated September 24, 2008 indicates that no cultural resources properties are recorded within the boundaries of the project area nor within a quarter-mile radius of the project area.. Nonetheless, the record search does not guarantee the absence of cultural resources.

As stated in Section V of the Initial Study any unknown cultural resources uncovered during construction shall be evaluated by a qualified cultural resources specialist. Potential adverse impacts to cultural resources will remain below a level of significance.



California Regional Water Quality Control Board
Santa Ana Region



Linda S. Adams
*Secretary for
Environmental Protection*

3737 Main Street, Suite 500, Riverside, California 92501-3348
Phone (951) 782-4130 • FAX (951) 781-6288
www.waterboards.ca.gov/santaana

Arnold Schwarzenegger
Governor

RECEIVED

JUL 16 2009

RIVERSIDE COUNTY FLOOD CONTROL
WATER CONSERVATION DISTRICT

Kris Flanigan
Riverside Co. Flood Control & Water Conservation Dist.
("RCFC&WCD")
Environmental/Regulatory Services Section
1995 Market Street
Riverside, CA 92501

**COMMENTS ON THE DRAFT INITIAL STUDY/ENVIRONMENTAL ASSESSMENT
("IS/EA") FOR THE CORONA DRAINS – EAST ONTARIO AVENUE STORM DRAIN,
STAGE 1**

Dear Mr. Flanigan:

Thank you for providing Regional Board staff the opportunity to comment on the IS/EA for the subject project. The project involves the construction of a new storm drain within existing rights-of-way largely in Ontario Avenue between El Cerrito Road and State Street in the community of El Cerrito. The project includes the removal and reconstruction of 360 linear feet of a concrete-lined channel.

The IS/EA indicates that no approvals are necessary from any Federal Agency and only an approval from the Department of Fish and Game is needed. Regional Board staff believes that an authorization to discharge dredge or fill material to the 360 feet of concrete-lined channel is needed from the Regional Board. Depending on federal jurisdiction by the U.S. Army Corps of Engineers, the Regional Board may provide this authorization under a Clean Water Act Section 401 Water Quality Standards Certification or under State Board Order No. 2004-0004-DWQ. The matter of federal jurisdiction and the nature of the Regional Board's authorization should be clarified in the final Mitigated Negative Declaration prior to its adoption.

In the likely event that the Regional Board is a Responsible Agency, Regional Board staff is providing the following comments:

Please indicate where the 360 feet of concrete-lined channel is located. Provided that the 360 feet of concrete-lined channel is replaced in-kind, Regional Board staff agrees that compensatory mitigation for impacts to beneficial uses of the channel are not necessary.

California Environmental Protection Agency

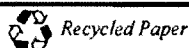

The project indicates that the project is "Stage 1", suggesting that it is part of a larger project with additional stages. Please explain the nature of these additional stages and include them in the general environmental impact analysis or the cumulative impact analysis areas of the IS/EA.

The Section 18 Public Hearing Map, circulated in the IS/EA, shows the storm drain alignment turning east prior to the El Cerrito Road intersection. According to aerial photos, this would put the alignment beneath a building. Please correct or clarify this in the final MND.

Please provide additional detail explaining how the County will comply with the Riverside County Municipal Separate Storm Sewer System ("MS4") Permit in order to remove pollutants from storm water runoff discharges from the proposed storm drain system to the maximum extent practicable. Please identify in the final MND specific structural and non-structural best management practices that will be employed.

If you have any questions, please contact me at afischer@waterboards.ca.gov or at (951) 320-6363.

Sincerely,



Adam Fischer
Environmental Scientist
Clean Water Act Section 401 Coordinator



WARREN D. WILLIAMS
General Manager-Chief Engineer



1995 MARKET STREET
RIVERSIDE, CA 92501
951.955.1200
FAX 951.788.9965
www.rcflood.org

RIVERSIDE COUNTY FLOOD CONTROL
AND WATER CONSERVATION DISTRICT

August 18, 2009

CERTIFIED MAIL
RETURN RECEIPT REQUESTED

Mr. Adam Fischer, 401 Coordinator
California Regional Water
Quality Control Board - Santa Ana Region
3737 Main Street, Suite 500
Riverside, CA 92501-3348

Dear Mr. Fischer:

Re: Corona Drains-East Ontario Avenue
Storm Drain, Stage 1
Project No. 2-0-00351

This is in response to your letter dated July 15, 2009 regarding the draft initial study/mitigated negative declaration for the District's Corona Drains-East Ontario Avenue Storm Drain, Stage 1 project.

You had requested that the matter of federal jurisdiction and the nature of the Regional Board's authorization be clarified in the final mitigated declaration prior to its adoption. At this time, the District is not certain whether the U.S. Army Corps of Engineers (COE) will assert its authority under Section 404 of the Clean Water Act to regulate the concrete channel reconstruction portion of the project. If the COE chooses to regulate this activity, a 401 Water Quality Standards Certification will be obtained from the Regional Board. The Regional Board has been added under "Other public agencies whose approval may be required" in the final initial study.

Other questions posed in your letter are addressed below as follows:

Please indicate where the 360 feet of concrete-lined channel is located. The 360 feet of concrete-lined channel is located at the southeast portion of the project northeasterly of the intersection of Ontario Avenue and El Cerrito Road.

The project indicates that the project is "Stage 1", suggesting that it is part of a larger project with additional stages. Please explain the nature of these additional stages and include them in the general environmental impact analysis or the cumulative impact analysis areas of the IS/EA. The initial study analyzes the potential environmental impacts to all phases of the project which includes future underground storm drain laterals within the street section of both Rising Sun Road and Ambassador Avenue. The construction of the laterals is not anticipated in the near future and may require further CEQA analysis if the scope and/or area of impact changes. No other facilities are proposed or foreseen at this time.

Mr. Adam Fischer
Re: Corona Drains-East Ontario Avenue
Storm Drain, Stage 1
Project No. 2-0-00351

-2-

August 18, 2009

The Section 18 Public Hearing Map, circulated in the IS/EA, shows the storm drain alignment turning east prior to the El Cerrito Road intersection. According to aerial photos, this would put the alignment beneath a building. Please correct or clarify this in the final MND. The Section 18 map is schematic in nature. The proposed storm drain would not have any impacts to existing buildings in the area. The storm drain alignment is proposed entirely within existing public right of way.

Please provide additional detail explaining how the County will comply with the Riverside County Municipal Separate Storm Sewer System ("MS4") Permit in order to remove pollutants from storm water runoff discharges from the proposed storm drain system to the maximum extent practicable. Please identify in the final MND specific structural and non-structural best management practices that will be employed. The proposed project would construct an underground storm drain system within existing street rights-of-way. The proposed project complies with the Santa Ana Region RWQCB NPDES MS4 Permit, Board Order R8-2002-0011 (Permit) and the Drainage Area Management Plan (DAMP). The DAMP describes the Permittee programs implemented to comply with the Permit. The Permit requires Permittees with land use authority (such as the County of Riverside and City of Corona) to eliminate sources of pollutants to the MS4, and thereby minimize, to the Maximum Extent Practicable, the impact of discharges from the MS4 to receiving waters, including the Santa Ana River. As the District has no land use authority to control the discharge of pollutants into its system, the District relies on county and city programs to control pollutant sources to District MS4 to the maximum extent practicable. The District's responsibilities under the Permit are focused on coordinating Permittee activities, implementing regional programs on behalf of the Permittees, properly operating and maintaining its MS4 and controlling illicit connections and illegal discharges to its MS4. These programs work in concert to minimize the discharges of pollutants to the MS4 and, subsequently, from the MS4 to receiving waters.

Each Permittee is also independently responsible for ensuring its proposed public works projects comply with the new development requirements of the Permit. The proposed project is an underground storm drain that will be constructed within an existing street. The District evaluated the new development requirements of the Permit and has categorized this project as an "Other Development Project" and, therefore, not subject to the Water Quality Management Plan requirements of the Permit. To comply with the other Development Project requirements of the Permit and the DAMP, the District evaluated applicable site and source control BMPs, such as ensuring slope stability, maintaining pre-project infiltrative capacity, and using curb markers or stencils to remind the public not to dump waste into the MS4. As the operation of an underground storm drain does not generate pollutants, additional site and source control BMPs are considered not applicable. The following applicable site and source control BMPs were evaluated:

Site Design BMPs:

- Maintain Stable Channels and Slopes: There is no potential for slope or channel instability as the proposed project is an underground storm drain discharging into an existing concrete channel. The affected portion of the existing concrete channel will be reconstructed in-kind; and
- There are no impacts to the infiltrative capacity of the project site as the project is an underground storm drain in an existing street.

Mr. Adam Fischer
Re: Corona Drains-East Ontario Avenue
Storm Drain, Stage 1
Project No. 2-0-00351

-3-

August 18, 2009

Source Control BMPs:

- All inlets for this storm drain system will be stenciled/marked with the "Only Rain Down the Drain" message; and
- Proper MS4 maintenance as described in the DAMP.

Because the project consists of constructing an underground storm drain within existing street right of way, opportunities to implement additional source control measures are not feasible.

If you have any questions, concerns or would like to arrange for a field visit, please contact me at 951.955.8581.

Very truly yours,



KRIS FLANIGAN
Senior Civil Engineer

Enclosures

cc: Jason Uhley
Bob Cullen

KF:mcv
P8\126433

Notice of Determination

To: Office of Planning and Research

For U.S. Mail:
P.O. Box 3044
Sacramento, CA 95812-3044

Street Address:
1400 Tenth Street
Sacramento, CA 95814

From: Riverside County Flood Control
1995 Market Street
Riverside, CA 92501
Contact: Kris Flanigan
Phone: 951.955.8581

Lead Agency (if different from above):

County Clerk
County of Riverside
2724 Gateway Drive
Riverside, CA 92507

SUBJECT:

Filing of Notice of Determination in compliance with Section 21108 or 21152 of the Public Resources Code.

State Clearinghouse Number (if submitted to State Clearinghouse): 2009061086

Project Title:

Corona Drains East Ontario Avenue Storm Drain Stage 1

Project Location (include county)

The proposed project area is located in Ontario Avenue between El Cerrito Road and State Street within the unincorporated Temescal area of Riverside County and the city of Corona within USGS 7.5 Minute, Corona North, California Topographic Quadrangle: Township 4 South, Range 6 West, Section 8.

Project Description

The proposed project consists of constructing and maintaining approximately 4,400 lineal feet of an underground storm drain system.

This is to advise that the Riverside County Flood Control and Water Conservation District has approved the above described Lead Agency or Responsible Agency

project on September 1, 2009 and has made the following determinations regarding the above described project:
(Date)

1. The project will not have a significant effect on the environment.
2. A Mitigated Negative Declaration was prepared for this project pursuant to the provisions of CEQA.
3. Mitigation measures were made a condition of the approval of the project.
4. A mitigation reporting or monitoring plan was adopted for this project.
5. A statement of Overriding Considerations was not adopted for this project.
6. Findings were not made pursuant to the provisions of CEQA.

This is to certify that the final EIR with comments and responses and record of project approval, or the Negative Declaration, is available to the General Public at: The Office of the Clerk to the Board, County Administrative Center, 4080 Lemon Street, Riverside, CA 92501

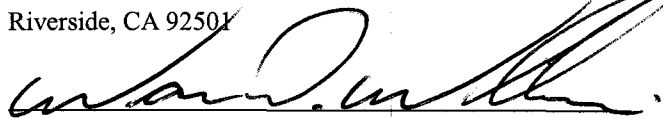
Signature (Public Agency)

8/20/09 GMCE
Title

8/20/09
Date

Date received for filing at OPR:

Authority cited: Sections 21083 and 21087, Public Resources Code.
Reference: Sections 21000-21174, Public Resources Code.

Revised 2004

RIVERSIDE COUNTY FLOOD CONTROL AND WATER CONSERVATION DISTRICT

BOARD OF SUPERVISORS

RESOLUTION NO. F2009-24
SETTING A PUBLIC HEARING DATE FOR
CORONA DRAINS EAST ONTARIO STORM DRAIN, STAGE 1
AND GIVING NOTICE OF INTENT TO ADOPT A
MITIGATED NEGATIVE DECLARATION THEREFOR
IN ACCORDANCE WITH SECTION 18 OF THE DISTRICT ACT
AND THE CALIFORNIA ENVIRONMENTAL QUALITY ACT (CEQA)

1
2
3
4
5
6
7
8
9
10
11
12
13
14
15
16
17
18
19
20
21
22
23
24
25
26
27
28

WHEREAS, this Board intends to undertake a project within the unincorporated El Cerrito community of Riverside County and the City of Corona, designated as Corona Drains East Ontario Avenue Storm Drain, Stage 1; and

WHEREAS, the proposed project is generally within Ontario Avenue between State Street to the north and El Cerrito Road to the south; and

WHEREAS, the proposed project consists of the construction and subsequent operation and maintenance of approximately 3,800 lineal feet of underground storm drain system; and

WHEREAS, reference is made to the engineering estimate of the cost of the proposed project, entitled "Engineer's Statement" on file with the Clerk of this Board; and

WHEREAS, reference is made to a map dated March 2009, bearing the name and showing the general location and typical section of the proposed project which is also on file with the Clerk of the Board; and

WHEREAS, the General Manager-Chief Engineer of the District has found that the proposed project will not have a significant adverse effect on the environment and has prepared a Mitigated Negative Declaration which will not become final until adopted by this Board; and

WHEREAS, any person wishing to comment on the proposed project or the Mitigated Negative Declaration may do so in writing between the date of this notice and the public hearing, or may appear and be heard at the time and place noted below; and

WHEREAS, in a subsequent legal challenge any person may be limited to raising only those issues he, she or someone else raised at the public hearing. Neg. Declaration No. Determination, or in written comments delivered before or at the public hearing; and

FORM APPROVED COUNTY COUNSEL
BY CARISA R-MCKENNA
DATE 6/22/09

FILED

JUL 30 2009

COUNTY CLERK
Filed per P.R.C. 21152
POSTED

JUL 30 2009

Removed: _____

LARRY W. WARD, CLERK
By T. Marshall Deputy

By: _____ Dept.
County of Riverside, State of California

CERTIFICATE OF POSTING

(Original copy, duly executed, must be attached to original at the time of filing)

I, Lorena Verducco Records Specialist, do hereby certify that I am not
(NAME AND TITLE)
a party to the within action or proceeding; that on 7/30/09, I posted a
(DATE)
copy of the following document:

RESOLUTION NO. F2009-24 SETTING A PUBLIC HEARING DATE FOR CORONA DRAINS EAST ONTARIO AVENUE STORM DRAIN, STAGE 1 AND GIVING NOTICE OF INTENT TO ADOPT A MITIGATED NEGATIVE DECLARATION THEREFOR IN ACCORDANCE WITH SECTION 18 OF THE DISTRICT ACT AND THE CALIFORNIA ENVIRONMENTAL QUALITY ACT (CEQA)

by posting at City of Corona City Hall, 400 S. Vicentia Avenue, Corona, California

Date: 7/30/09

Lorena Verducco, Records Specialist
(Signature) aty of Corona

Corona Drains - East Ontario Ave Storm Drain, Stage 1

Project No. 2-8-0351

Engineer's Statement

This proposed project is located within the unincorporated community of El Cerrito and City of Corona in Riverside County, California. The project is an ultimate storm drain system designed to collect runoff from a 240-acre watershed located Ontario Ave and El Cerrito Road and convey it to the El Cerrito Channel. When complete this storm drain will provide 100-year flood protection.

This project will require the removal and construction of approximately 350 ft of channel to accommodate the confluence with a larger mainline pipe. The mainline consists of approximately 3800 lineal feet of reinforced concrete pipe (RCP) ranging in diameter from 36 inches to 84 inches. The laterals in Stage 1 consist of approximately 400 lineal feet of RCP ranging in diameter from 30 inches to 60 inches. From the outlet at the El Cerrito Channel near the intersection of El Cerrito Rd, Temescal Canyon Rd, and Ontario Ave, the main line extends northwest approximately 3500 lineal feet in Ontario Ave until State St, approximately 300 lineal feet north in State St and connecting to the outlet of an existing underground detention storage system under the Corona Cerrito Plaza parking lot. One lateral will connect to the main line near the intersection of Ontario Avenue and State Street and extend approximately 200 lineal feet northwest on Ontario Ave. The other two laterals will extend north approximately 90 ft in Ambassador Ave and approximately 60 ft in Rising Sun Rd in Stage 1. The full extent of the Ambassador Avenue lateral and Rising Sun Rd lateral will be completed in Stage 2. The cost of the proposed project is approximately \$3,229,000.

SECTION 18 PUBLIC HEARING MAP

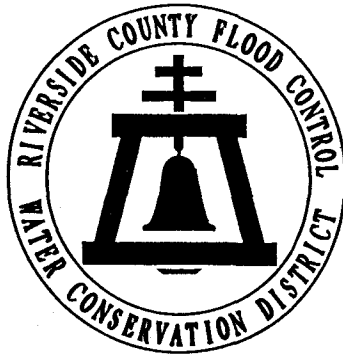

ONTARIO AVE. STORM DRAIN PROJECT NO. 2-0-0351

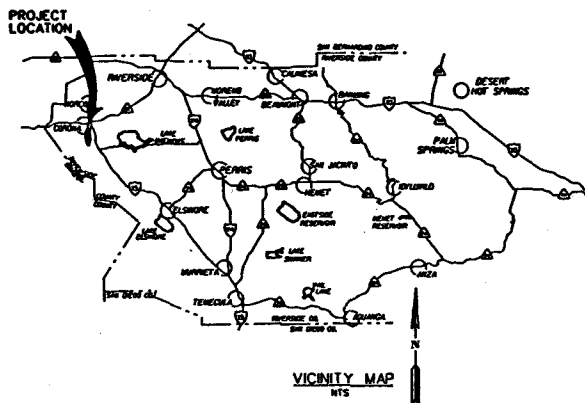
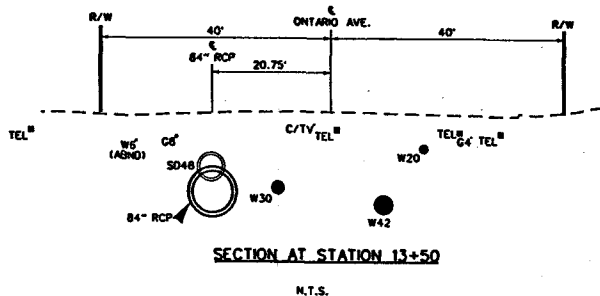
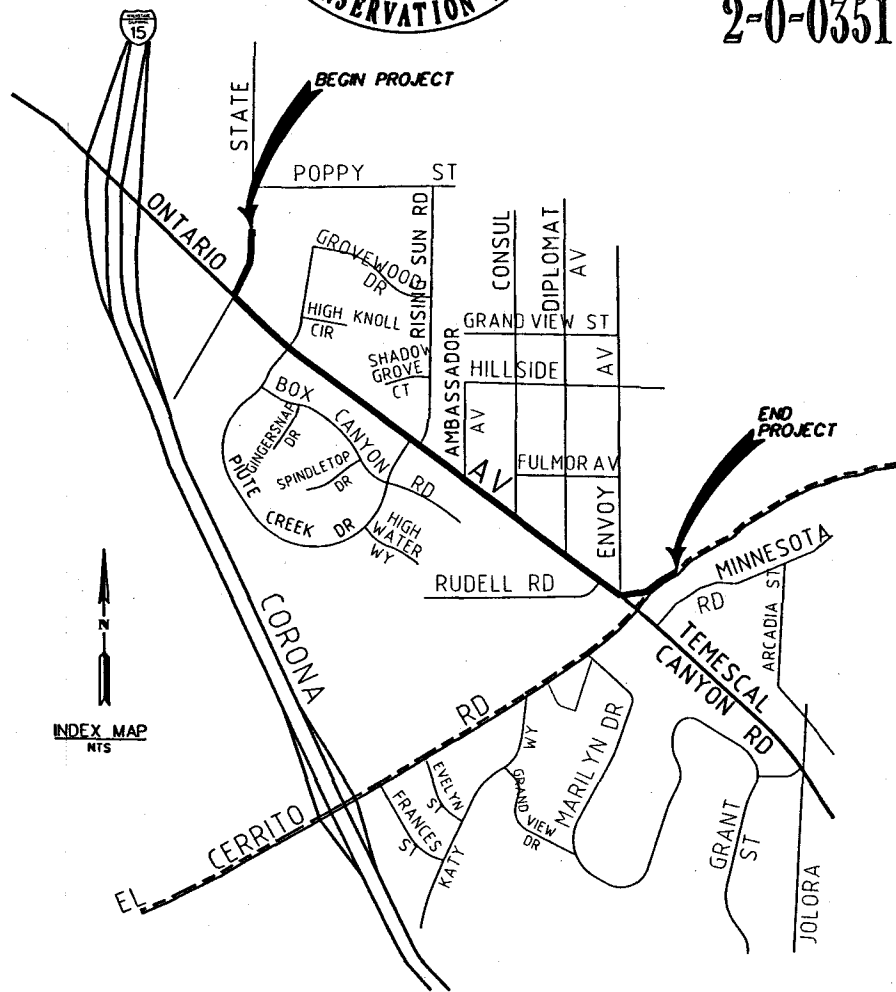

RIVERSIDE COUNTY CLERK-RECORDER

AUTHORIZATION TO BILL

TO BE FILLED OUT BY SUBMITTING AGENCY

DATE: 7/29/2009

BUSINESS UNIT/AGENCY: FLOOD CONTROL - FCARC

ACCOUNTING STRING:

ACCOUNT: 527780

FUND: 25120

DEPT ID: 947420

PROGRAM: _____

AMOUNT: \$2,057.00

REF: CEQA Notice of Determination, Corona Drains-East Ontario Ave Storm Drain Stg 1 , 2-8-00351-01-30

THIS AUTHORIZES THE COUNTY CLERK & RECORDER TO ISSUE AN INVOICE FOR PAYMENT OF ALL FEES FOR THE ACCOMPANYING DOCUMENTS.

NUMBER OF DOCUMENTS INCLUDED: 1

AUTHORIZED BY: Luz C. Yambo

PRESENTED BY: Kris Flanigan

CONTACT: Luz C. Yambo (951) 955-1249

TO BE FILLED OUT BY COUNTY CLERK

ACCEPTED BY: _____

DATE: _____

DOCUMENT NO(S)/INVOICE NO(S): _____