

SUBMITTAL TO THE BOARD OF SUPERVISORS  
COUNTY OF RIVERSIDE, STATE OF CALIFORNIA

314 B



SUBMITTAL DATE:  
September 21, 2009

FROM: TLMA - Transportation Department

SUBJECT: Tract 25253-1  
A Schedule "A" Subdivision in the Menifee Area  
Extension of Time Agreements

RECOMMENDED MOTION: That the Board approve the attached agreements (which grant an extension of time for twelve months to complete improvements).

BACKGROUND: On June 3, 2008, the Board entered into agreements with Richmond American Homes of Maryland, Inc. for the improvement of streets and the installation of a water and sewer system within the above referenced subdivision. Accompanying these agreements were faithful performance securities posted by Arch Insurance Company as follows:

- \$455,000 - Bond #SU5008370 for the completion of street improvements
- \$25,400 - Bond #SU5008370 for the completion of the water system
- \$30,030 - Bond #SU5008370 for the completion of the sewer system

The developer requests an extension of time for the completion of this project. Our records indicate that this project is approximately 90% completed for streets and utility work. The agreements for the extension of time have been approved by County Counsel. **(Continued)**

Juan C. Perez  
Director of Transportation

HS:lf  
Submittals: Vicinity Map  
Road/Drainage Agrmts  
Water System Agrmts  
Sewer System Agrmts

REVIEWED BY EXECUTIVE OFFICE

DATE 9/15/09  
BY Tina Grande  
Departmental Concurrence

FORM APPROVED COUNTY COUNSEL

DATE 9/11/09  
BY ELENA M. BOEVA

Policy

Consent

Dep't Recomm.:  
Per Exec. Ofc.:

Prev. Agn. Ref. 06/03/08 - 2.25 | District: 3 | Agenda Number:

2.27

The Honorable Board of Supervisors

RE: Tract 25253-1

Page 2 of 2

This project is located within the new City of Menifee boundaries. Since the original bonds and agreements were entered into by the County as the beneficiary, the County will continue to administer this agreement in consultation with the City.

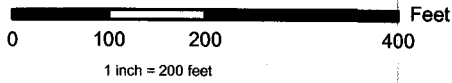

# Tract 25253-1 Vicinity Map



The County of Riverside assumes no warranty or legal responsibility for the information contained on this map. Data and information represented on this map is subject to updates, modifications and may not be complete or appropriate for all purposes. County GIS and other sources should be queried for the most current information. Do not copy or resell this map.

**Supervisory District 3**

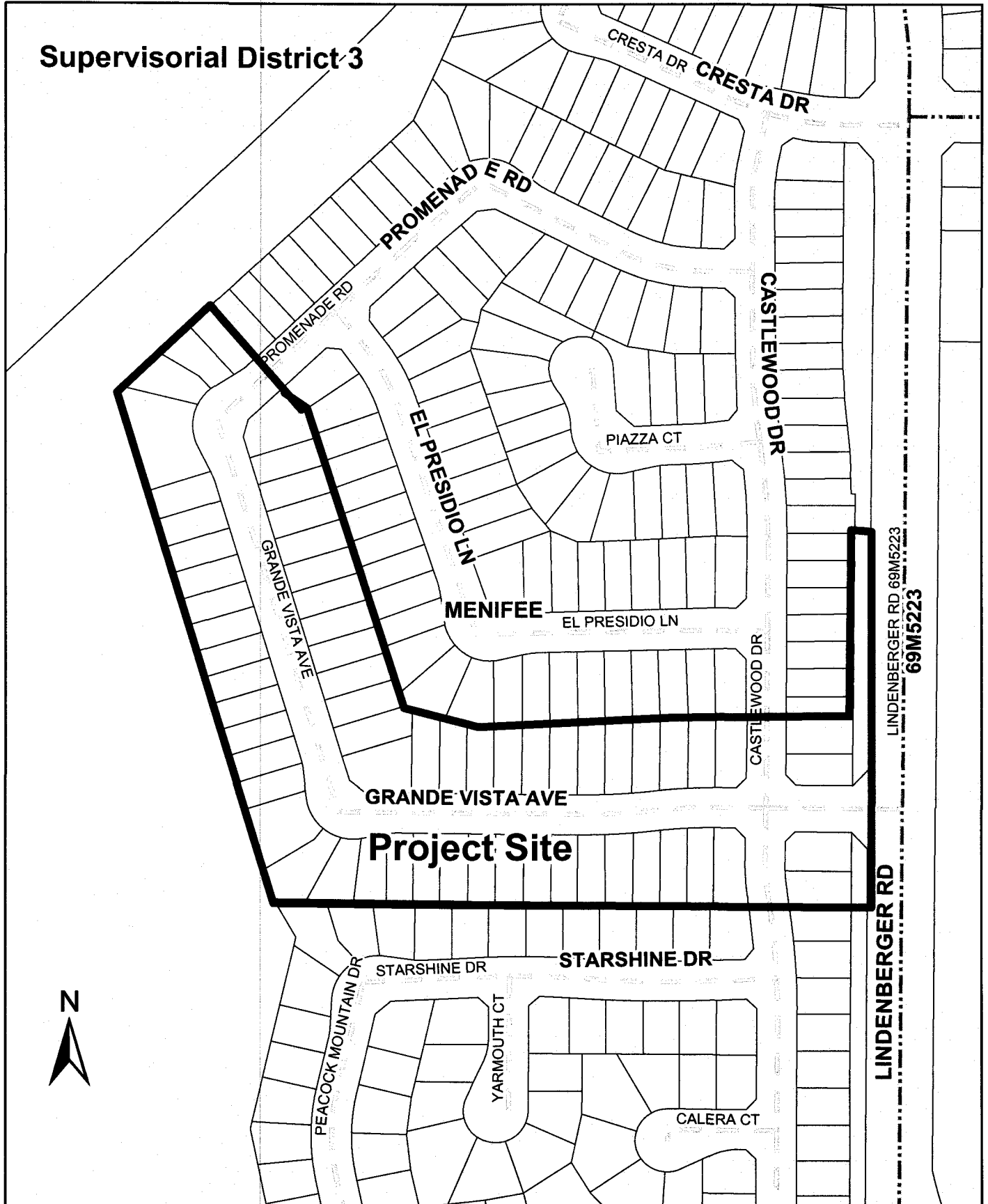

LINDENBERGER RD 69M5223  
69M5223

LINDENBERGER RD