

SUBMITTAL TO THE BOARD OF SUPERVISORS
COUNTY OF RIVERSIDE, STATE OF CALIFORNIA

601 B



FROM: TLMA - Transportation Department

SUBMITTAL DATE:
December 29, 2009

SUBJECT: Summarily vacating the right to accept a portion of Burch Street, in the Mead Valley area, First Supervisorial District.

RECOMMENDED MOTION: Adopt Resolution No. 2010-007, summarily vacating the right to accept a portion of Burch Street.

BACKGROUND: EDA and the Transportation Department joined together in a cooperative effort to improve and bring into the County Maintained Road System many streets in the Mead Valley area. Burch Street needed to be realigned to eliminate small portions of property that were unusable by the adjacent property owners. A mutual agreement with the property owners was reached to realign the road, and the new alignment was dedicated by the property owners and accepted by the County. Per the agreement the excess right-of-way on Burch Street would be vacated by the County upon completion of the construction and acceptance of the new alignment. This resolution vacating the excess right-of-way completes the agreement.

Juan C. Perez
Director of Transportation

WJH
Attachments: Resolution No. 2010-007
Exhibit "A"

REVIEWED BY EXECUTIVE OFFICE

DATE 12/30/09
Tina Grande

FORM APPROVED COUNTY COUNSEL
BY: Synthia M. Guinzel
SYNTHIA M. GUNZEL

DATE 12/29/09
Mental Concurrence

Dept's Recomm.: Consent Policy
Per Exec. Ofc.: Consent Policy

Prev. Agn. Ref.

District: 1

Agenda Number:

2.8

2
3
4 **RESOLUTION NO. 20010-007**

5 SUMMARILY VACATING THE RIGHT TO ACCEPT A PORTION OF
6 BURCH STREET, IN THE MEAD VALLEY AREA

7 (AB 09015)

8 (First Supervisorial District)

9
10 **WHEREAS**, the hereinafter-described, Burch Street, described in Instrument
11 No. 121276, Recorded October 2, 1975, Official Records of Riverside County,
12 California.

13
14 **WHEREAS**, The offer of dedication of Burch Street has not been accepted by
15 the County of Riverside and;

16
17 **WHEREAS**, the hereinafter-described Burch Street is not necessary and is
18 excess Right of Way, and not required for public street or highway purposes, now,
19 therefore;

20
21 **BE IT RESOLVED, DETERMINED AND ORDERED** by the Board of
22 Supervisors of the County of Riverside, State of California, in regular session
23 assembled on _____, 2010, as follows;

FORM APPROVED COUNTY COUNSEL
BY: SYNTHIA M. GUNZEL 12-28-09
DATE
SYNTHIA M. GUNZEL

1
2
3
4
5
6
7
8
9
10
11
12
13
14
15
16
17
18
19
20
21
22
23
24
25

RESOLUTION NO. 2010-007

1. Pursuant to Section 8334(a) of the Streets and Highways Code that the hereinafter-described Burch Street is excess Right-of-Way, is no longer required for public street and highway purposes and is hereby summarily vacated.

2. That the herein-described Burch Street is unnecessary for present or prospective public use, including use as a non-motorized transportation facility. Said road is in the County of Riverside, State of California and is described as follows;

Burch Street (see Exhibit "A") All of that Declaration of Dedication, Recorded as Instrument No. 121276 on October 2, 1975, Official Records of Riverside County, California.

EXCEPTING AND RESERVING from the vacation an easement for any existing public utilities and public service facilities, together with the right to maintain, operate, replace, remove, or renew such facilities, pursuant to section 8340 of the Streets and Highways Code.

1 **RESOLUTION NO. 2010-007**

2

3 **BE IT FURTHER RESOLVED, DETERMINED AND ORDERED** that the Clerk
4 of the Board is directed to cause a certified copy of this resolution to be recorded in
5 the office of the Recorder of the County of Riverside, California.

6

7

8

9

10

11

12

13

14

15

16

17

18

19

20

21

22

23

24 WJH

25 W.O. # B8-06947G

WOODWARD STREET

EXHIBIT "A"

Vacation of the right to accept a portion of Birch Street



N.T.S.
T. 4S, R. 4W
SECTION 4
SBM

LOT 17

LOT 18

MB 17/75

Vacating
Instrument #121276
Recorded 10/2/1975

LOT 19

LOT 20

BURCH STREET

ALEXANDER STREET

60.00'

60.00'

30.00'

CIL

Dedicated and Accepted per
Instrument No. 2009-0056120
recorded 2/05/2009

Dedicated and Accepted Per
Instrument No. 2009-0056121
recorded 2/05/2009

LOT 29

LOT 30

VICINITY MAP



N.T.S.
T. 4S, R. 4W
SECTION 4
SBM

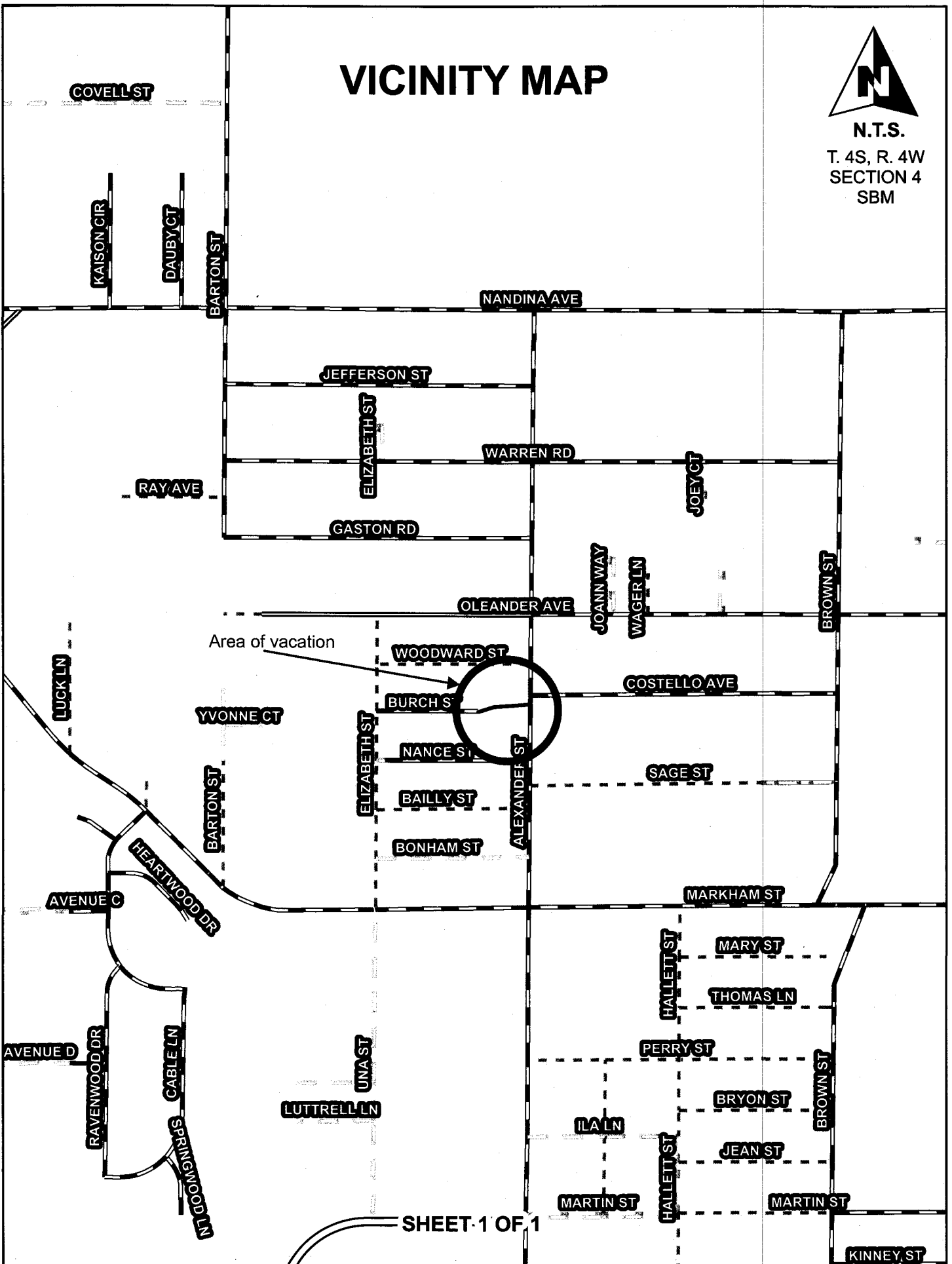

SHEET 1 OF 1

To be removed before recording