

EXHIBIT "A"

DESCRIPTION OF BOUNDARIES

The boundaries of Zone 146 to be annexed into Landscaping and Lighting Maintenance District No. 89-1-Consolidated, of the County of Riverside are coterminous with the boundaries of APN 247-081-025 and 027 as shown on Assessment Roll in the County of Riverside, State of California in Fiscal Year 2010-11.

1
2
3
4
5
6
7
8
9
10
11
12
13
14
15
16
17
18
19
20
21
22
23
24

ZONE 146

PORTION OF SECTION 7, T.2S., R.4W.
CONDITIONAL USE PERMIT NO. 03577

2 PARCELS



The County of Riverside assumes no warranty or legal responsibility for the information contained on this map. Data and information represented on this map is subject to updates, modifications and may not be complete or appropriate for all purposes. County GIS and other sources should be queried for the most current information. Do not copy or resell this map.

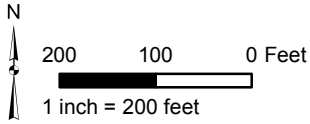

ASSESSMENT DIAGRAM

Printed by jpickeri on 12/16/09

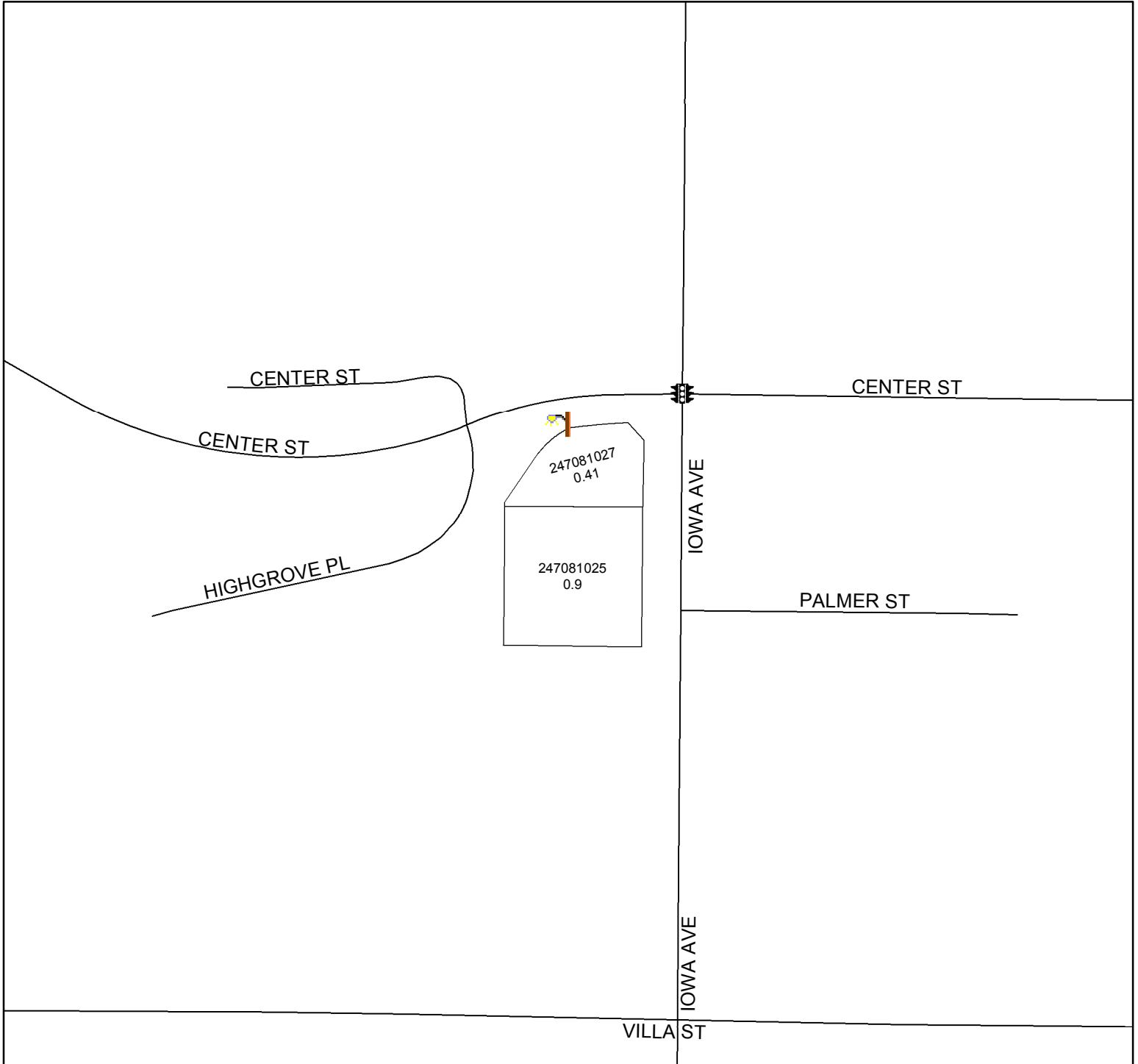

- DENOTES MAINTAINED STREETLIGHT
- DENOTES MAINTAINED TRAFFIC SIGNAL