

FORM APPROVED COUNTY COUNSEL
 BY: *[Signature]* 3/8/10 DATE

Departmental Concurrence

**SUBMITTAL TO THE BOARD OF SUPERVISORS
 COUNTY OF RIVERSIDE, STATE OF CALIFORNIA**

279A



FROM: TLMA - Transportation Department

SUBMITTAL DATE:
 March 4, 2010

SUBJECT: Indian Canyon Drive at Interstate 10 (I-10), reconstruction of interchange in the City of Palm Springs and the unincorporated area of Riverside County.

RECOMMENDED MOTION: That the Board of Supervisors approve the plans and specifications for the improvement of the Indian Canyon Drive Interchange project at Interstate 10 (I-10) in the City of Palm Springs and the unincorporated area of Riverside County. Authorize the Clerk to advertise for bids to be received in the office of the Director of Transportation up to the hour of 2:00 pm, Wednesday, April 28, 2010, at which time bids will be opened.

BACKGROUND: The City of Palm Springs is the lead agency for the design and environmental approvals for the Interchange at Indian Canyon Drive and I-10 Project. Based on the County's ability and experience to construct similar projects, the City desires that the County manage the

[Signature]

Juan C. Perez
 Director of Transportation

JCP:jj
 (Continued On Attached Page)

FINANCIAL DATA	Current F.Y. Total Cost:	\$ 26,400,000	In Current Year Budget:	Yes
	Current F.Y. Net County Cost:	\$ 0	Budget Adjustment:	No
	Annual Net County Cost:	\$ 0	For Fiscal Year:	2009/2010

SOURCE OF FUNDS: City of Palm Springs (99.29%), Measure A -Coachella Valley (0.36%), TUMF [CVAG] (0.27 %), and RDA (0.08%)	Positions To Be Deleted Per A-30	<input type="checkbox"/>
	Requires 4/5 Vote	<input type="checkbox"/>

C.E.O. RECOMMENDATION:

APPROVE

BY: *[Signature]*
 Tina Grande

County Executive Office Signature

Policy Policy

Consent Consent

Dept's Recomm.:
 Per Exec. Ofc.:

Prev. Agn. Ref. | District: 5 | Agenda Number:

3.64

The Honorable Board of Supervisors

RE: Indian Canyon Drive at Interstate 10 (I-10), reconstruction of interchange in the City of Palm Springs and the unincorporated area of Riverside County.

March 4, 2010

Page 2 of 2

construction phase of this project. Management tasks include advertisement, contract awarding and construction administration. The City will provide all funding for the County to perform these activities. A cooperative agreement has been prepared and will be executed by both parties prior to or concurrently with the award of the construction contract agreement.

The Indian Canyon Drive Interchange at I-10 is identified in the County's Transportation Improvement Program and is a high priority facility in the Coachella Valley Association of Government (CVAG) Regional Arterial Program. Significant growth in the area has increased traffic volume beyond the capacity of the interchange; as a result, the interchange traffic service is currently failing during the peak hours of operation. The proposed improvements to the interchange will increase the capacity and enhance the traffic operation to a satisfactory level for current and future traffic volumes.

The improvements to the Indian Canyon Drive Interchange consist of the replacement of the existing bridge over I-10 with a new six-lane overcrossing, reconstruction of portions of Indian Canyon Drive, Garnet Avenue, and 20th Avenue, the realignment and widening of the interchange ramps, the addition of westbound and eastbound loop on-ramps and signalization of the ramp termini.

The City competed for Federal Economic Stimulus funds under the American Recovery and Reinvestment Act for this project and was successful in obtaining \$5,518,000. In addition to improved traffic operations, the interchange project will create construction jobs and safety at this interchange.

The submitted plans and specifications have been approved as to form by County Counsel.

Environmental clearance is complete.

Project No: A8-0372

Federal Aid No: ESPLHPLU – 5282 (034) and HP21L – 5282 (035)

STATE HIGHWAY IN RIVERSIDE COUNTY IN THE CITY OF PALM SPRINGS ON INTERSTATE 10 FROM 0.86 km WEST TO 0.70 km EAST OF INDIAN CANYON Dr OVERCROSSING

TO BE SUPPLEMENTED BY STANDARD PLANS DATED JULY 2004

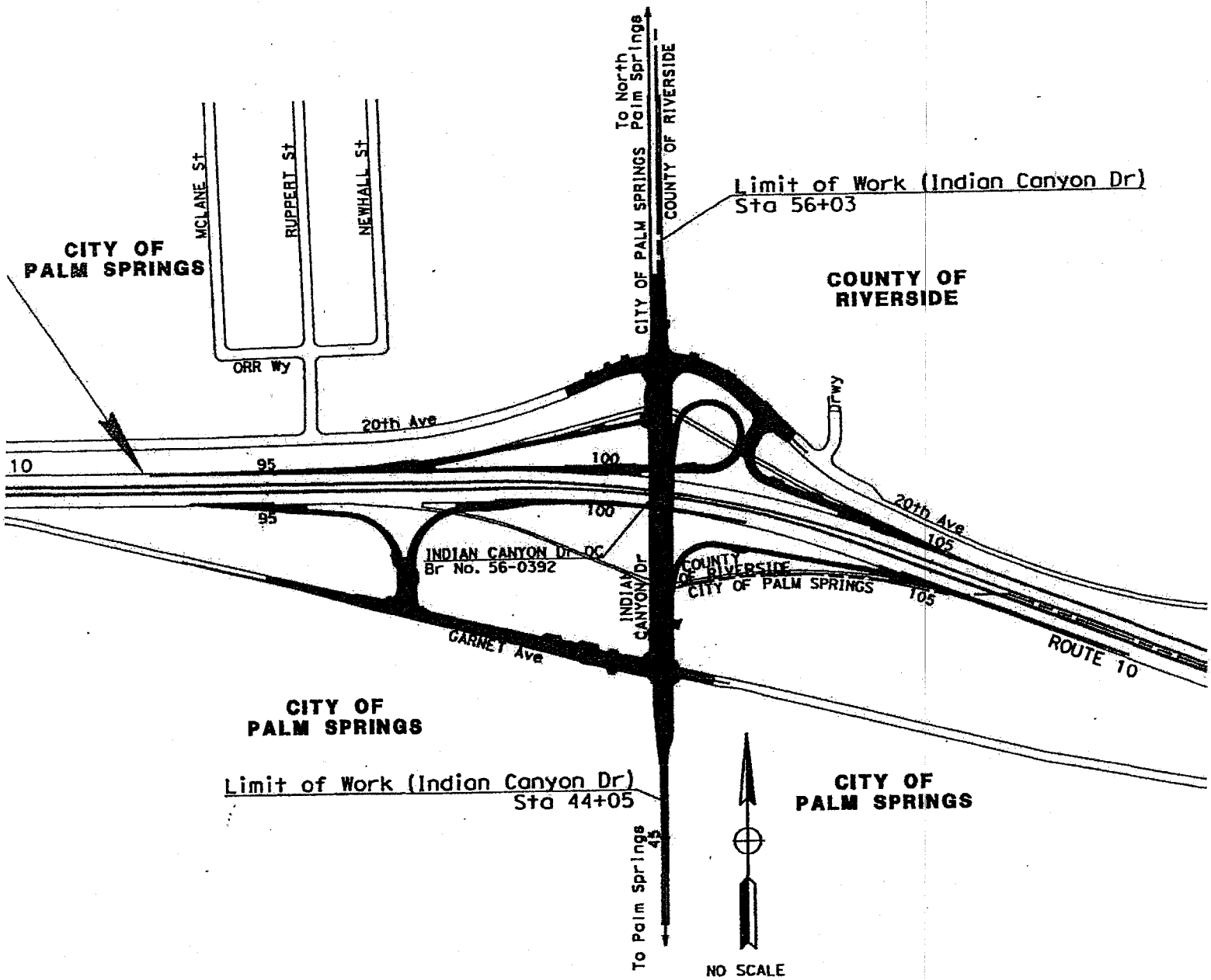

VICINITY MAP