

**SUBMITTAL TO THE BOARD OF SUPERVISORS
COUNTY OF RIVERSIDE, STATE OF CALIFORNIA**

508B



SUBMITTAL DATE:
May 12, 2010

FROM: TLMA - Transportation Department

SUBJECT: Accepting Brandon Road, Daemon Hills Drive, Dana Drive and Holt Meadows Drive for public road and utility purposes, in the Anza area, Third Supervisorial District.

RECOMMENDED MOTION: Adopt Resolution No. 2010-113, accepting Brandon Road, Daemon Hills Drive, Dana Drive and Holt Meadows Drive for public road and utility purposes, but not into the County Maintained Road System.

BACKGROUND: The applicant for Parcel Map 35279 has requested the acceptance of these roads in order to have sufficient accepted public right of way to satisfy the condition of approval for access to a public County maintained road.

REVIEWED BY EXECUTIVE OFFICE

DATE 4/12/10
Tina Grande
Departmental Concurrence

FORM APPROVED COUNTY COUNSEL
BY: Synthia M. Gunzel 4-1-10
DATE
SYNTHIA M. GUNZEL

Juan C. Perez
Director of Transportation

AM
Attachments: Resolution No. 2010-113
Exhibit "A"

Policy

Consent

Dept's Recomm.:
Per Exec. Ofc.:

Prev. Agn. Ref.

District: 3

Agenda Number:

2.15

2
3 **RESOLUTION NO 2010-113**

4
5 ACCEPTING PORTIONS OF BRANDON ROAD, DAEMON HILLS DRIVE, DANA
6 DRIVE AND HOLT MEADOWS DRIVE IN THE ANZA AREA,
7 FOR PUBLIC USE.
8 (Third Supervisorial District)
9

10 **WHEREAS**, the hereinafter described roads were offered for dedication for road and
11 public utility purposes per Parcel Map and Instrument numbers hereinafter-referred to, which
12 offers of dedication have not been previously accepted for public use by the County of
13 Riverside, now, therefore;

14
15 **BE IT RESOLVED, DETERMINED AND ORDERED** by the Board of Supervisors of
16 the County of Riverside, State of California, in regular session assembled on _____ ,
17 2010, that this Board accepts the offers of dedication and recognizes that said roads are
18 public roads open for use by the general public;

19
20 **BE IT FURTHER RESOLVED, DETERMINED, AND ORDERED** that this acceptance
21 is for the purpose of vesting title in the County of Riverside on behalf of the public for public
22 road and utility uses, and is not an acceptance of the roads into the County Maintained Road
23 System pursuant to Section 941 of the Streets and Highways Code and that said roads will
24

FORM APPROVED COUNTY COUNSEL
BY: *Sybil M. Gunzel* DATE: *5-1-10*
SYBIL M. GUNZEL

1 **Resolution No. 2010-113**

2
3 not become part of the County Maintained Road System unless subsequently accepted into
4 said Maintained Road System by a resolution adopted by this Board;

5
6 Said roads are in the County of Riverside, State of California, and are described as follows:

7
8 **Brandon Road** (See Exhibit "A")

9 That portion of Brandon Road (30.00 feet wide) dedicated for public use per
10 Instrument No. 145420, Recorded December 21, 1971, of Official Record of Riverside
11 County, California.

12
13 **Daemon Hills Drive** (See Exhibit "A")

14 That portion of Daemon Hills Drive (30.00 feet wide) dedicated for public use as Lot
15 "C" and Lot "D" per Parcel Map No. 11943 recorded in Book 54 page 96, of parcel maps,
16 Records of Riverside County, California.

17
18 **Dana Drive** (See Exhibit "A")

19 That portion of Dana Drive (30.00 feet wide) dedicated for public use as Lot "A" and
20 Lot "B" per Parcel Map No. 11943 recorded in Book 54 page 96, of parcel maps, Records of
21 Riverside County, California.

22
23 **Holt Meadows Drive** (See Exhibit "A")

24 That portion of Holt Meadows Drive (30.00 feet wide) dedicated for public use as Lot
25 "E" and Lot "F" Parcel Map No. 11943 recorded in Book 54 page 96, of parcel maps, and

1 **Resolution No. 2010-113**

2
3 Instrument No. 145420, Recorded December 21, 1971, Official Records of Riverside County,
4 California.

5
6 **BE IT FURTHER RESOLVED** that the Clerk of the Board shall cause a certified copy of this
7 resolution to be recorded in the Office of the County Recorder of Riverside County, California.

8

9

10

11

12

13

14

15

16

17

18

19

20

21

22

23

24 AM

25 W.O. No. PM35279

26

EXHIBIT "A"

ACCEPTING PORTIONS OF BRANDON ROAD,
DAEMON HILLS DRIVE, DANA DRIVE AND HOLT MEADOWS DRIVE

BAUTISTA ROAD



N.T.S.
T. 7S, R. 3E
SECTION 7

PM 35279

DANA DRIVE

DAEMON HILLS DRIVE

LOT "C"
LOT "D"

30' LOT "B" LOT "A"

PAR 1

PAR 2

PAR 4

PAR 3

PM 54/96

LOT "E" 30' LOT "F"

30'

BRANDON ROAD

INST # 145420 REC 12-21-1971

INST # 145420
REC 12-21-1971

30'

HOLT MEADOWS DRIVE

BAUTISTA ROAD

SHEET 1 OF 1

VICINITY MAP

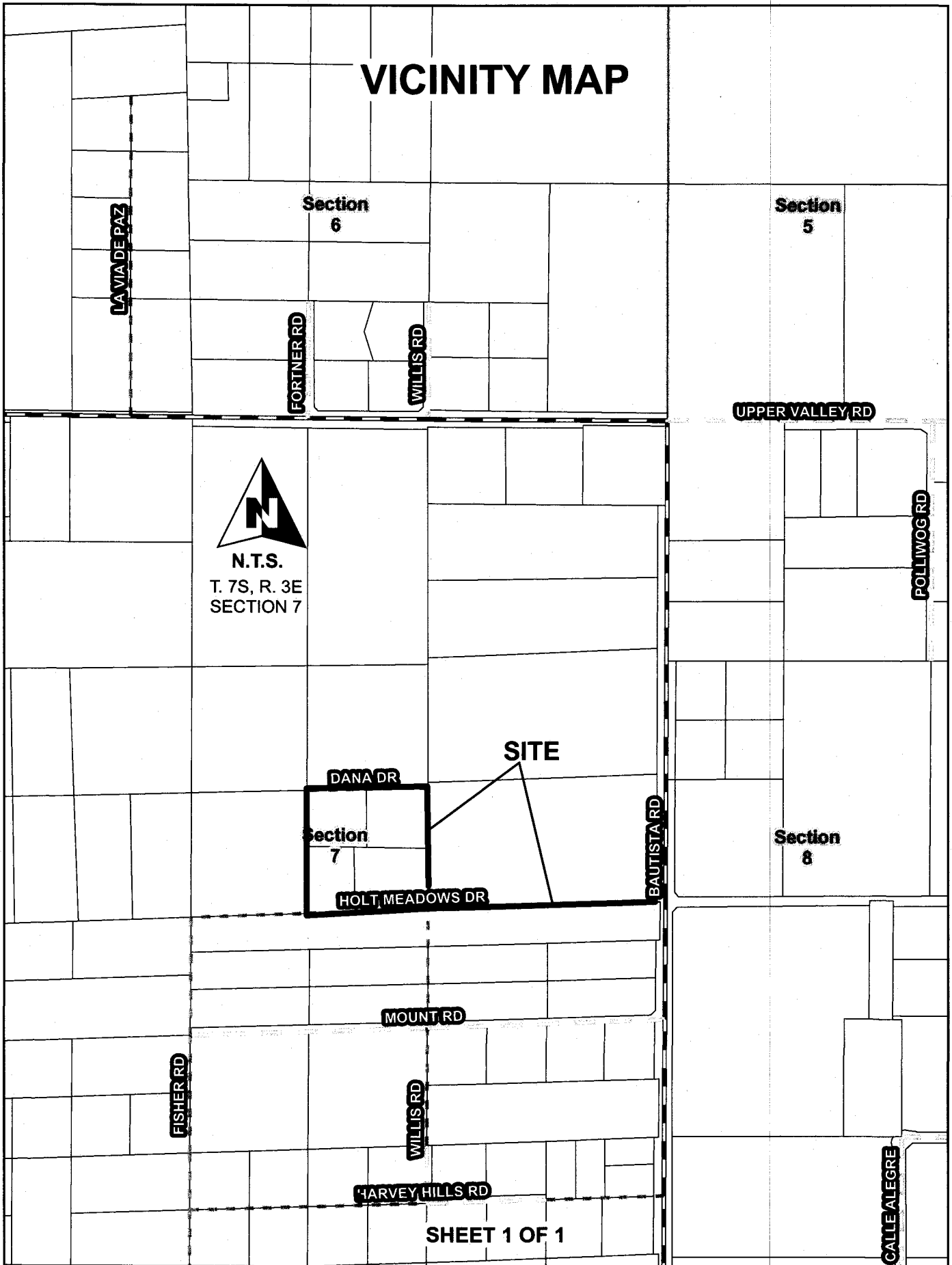

REMOVE PRIOR TO RECORDATION