

SUBMITTAL TO THE BOARD OF SUPERVISORS
COUNTY OF RIVERSIDE, STATE OF CALIFORNIA

603 B



FROM: TLMA - Transportation Department

SUBMITTAL DATE:
April 17, 2010

SUBJECT: Summarily vacating the right to accept all the roads as shown on Date Palm Beach Unit No. 1, in the Salton Sea Area, Fourth Supervisorial District.

RECOMMENDED MOTION: Adopt Resolution No. 2010-061, summarily vacating the right to accept all roads as shown on Date Palm Beach Unit No. 1.

BACKGROUND: The Desert Beach Homeowners Association has requested the vacation of the right to accept roads within Date Palm Beach Unit No. 1. The roads which were dedicated to public use by the map have not been accepted and have been maintained by the Homeowners Association. This vacation will allow the Homeowners Association to have continued control of their roads. The Transportation Department does not object to this vacation. No access to any lot will be eliminated.

REVIEWED BY EXECUTIVE OFFICE

DATE 4/21/10
Tina Grande
Departmental Concurrence

FORM APPROVED COUNTY COUNSEL
BY: Synthia M. Gunzel 4-8-10
DATE
SYNTHIA M. GUNZEL

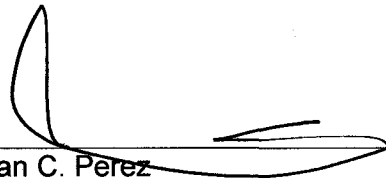
Juan C. Perez
Director of Transportation

AM
Attachments: Resolution No. 2010-061
Exhibit "A"

Dept Recomm.: Consent Policy
Per Exec. Ofc.: Consent Policy

Prev. Agn. Ref. ATTACHMENTS FILED District: 4 Agenda Number:

WITH THE CLERK OF THE BOARD

2.16

2
3 **RESOLUTION NO. 2010-061**

4
5 **SUMMARILY VACATING THE RIGHT TO ACCEPT ALL THE ROADS AS SHOWN**
6 **ON DATE PALM BEACH UNIT NO. 1, IN THE SALTON SEA AREA**
7 **(AB 07005)**
8 **(Fourth Supervisorial District)**

9
10 **WHEREAS**, the hereinafter-described roads were reserved for public road
11 purposes by the tract map hereinafter-referenced, which reservation has not been
12 previously accepted for public use by the County of Riverside;

13
14 **WHEREAS**, the hereinafter-described roads are not necessary and are excess
15 Right of Way, and not required for public street or highway purposes, now, therefore;

16
17 **BE IT RESOLVED, DETERMINED AND ORDERED** by the Board of
18 Supervisors of the County of Riverside, State of California, in regular session
19 assembled on _____, 2010, as follows:

- 20
21 1. Pursuant to Section 8334(a) of the Streets and Highways Code that
22 the hereinafter-described roads are excess Right of Way and are no longer
23 required for public street and highway purposes and is hereby summarily
24 vacated.

25
FORM APPROVED COUNTY COUNSEL
BY: Synthia M. Gunzel 4-8-10
DATE
SYNTHIA M. GUNZEL

1 **RESOLUTION NO. 2010-061**

2
3
4
5
6
7
8
9
10
11
12
13
14
15
16
17
18
19
20
21
22
23
24
25

Said roads are in the County of Riverside, State of California and are described as follows:

MEDINA DRIVE, TRIPOLI DRIVE, ALGERIA DRIVE, MOROCCO AVENUE, DAYTONA AVENUE, EAST PALM AVENUE, WEST PALM AVENUE AND DAMASCUS AVENUE (See Exhibit "A")

All of the following lots: "A" Medina Drive, "B" Tripoli Drive, "C" Algeria Drive, "D" & "E" Morocco Avenue, "G" & "F" Daytona Avenue, "H" & "I" East Palm Avenue, "J" & "K" West Palm Avenue, "M" & "L" Damascus Avenue; all as shown on Date Palm Beach Unit No. 1 on file in Book 18, page 9 Records of Riverside County, California, lying within Section 34, Township 7 South, Range 10 East, San Bernardino Meridian.

EXCEPTING AND RESERVING from the vacation an easement for any existing public utilities and public service facilities, together with the right to maintain, operate, replace, remove, or renew such facilities, pursuant to section 8340 of the Streets and Highways Code.

1 **RESOLUTION NO. 2010-061**

2

3 **BE IT FURTHER RESOLVED, DETERMINED AND ORDERED** that the Clerk
4 of the Board is directed to cause a certified copy of this resolution to be recorded in
5 the office of the Recorder of the County of Riverside, California.

6

7

8

9

10

11

12

13

14

15

16

17

18

19

20

21

22

23

24 **AM**

25 **W.O. # AB 07005**

EXHIBIT "A"

VACATION

STATE HIGHWAY 111

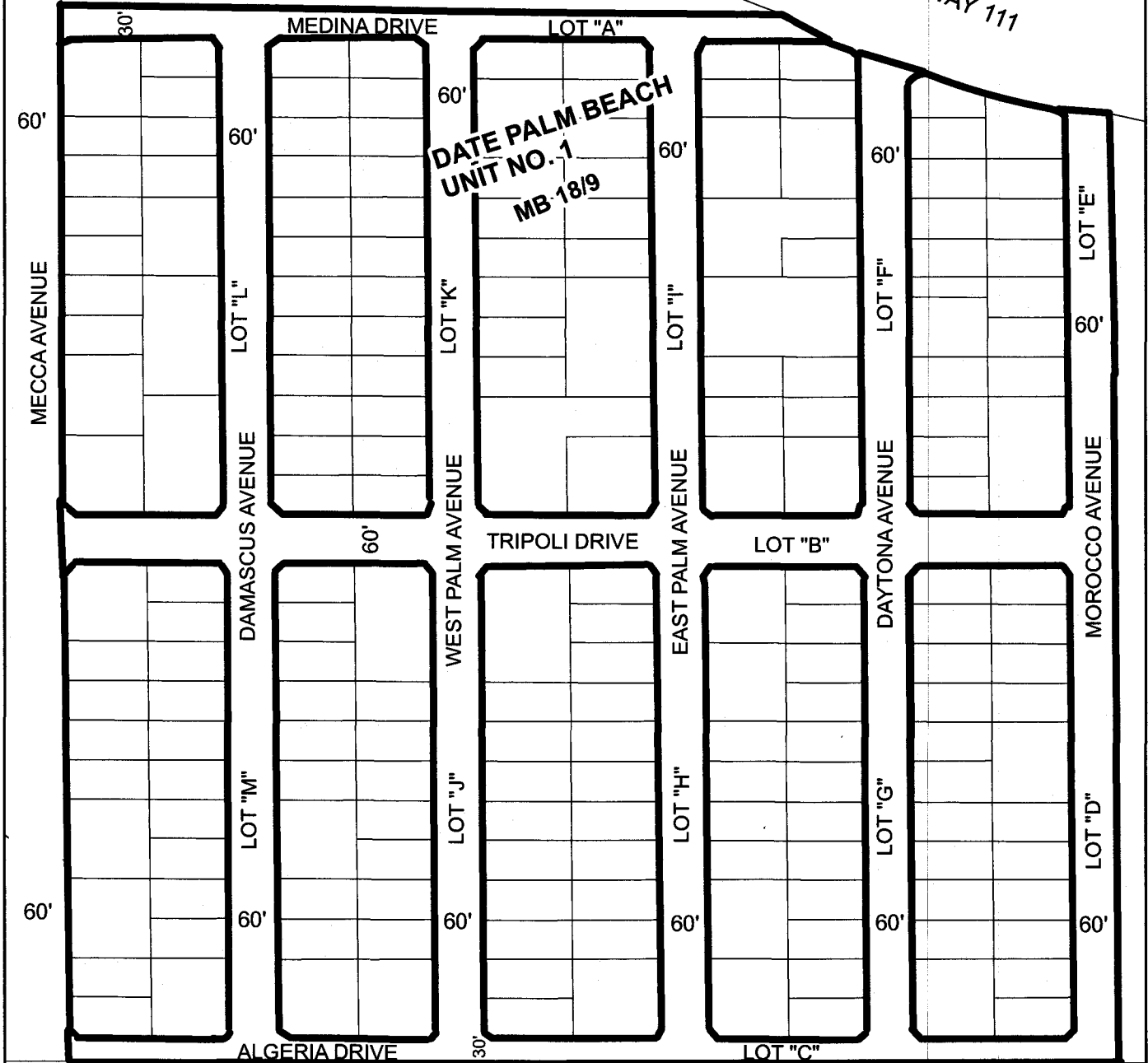

SALTON SEA

SHEET 1 OF 1



N.T.S.
T. 7S, R. 10E
SECTION 34

VICINITY MAP

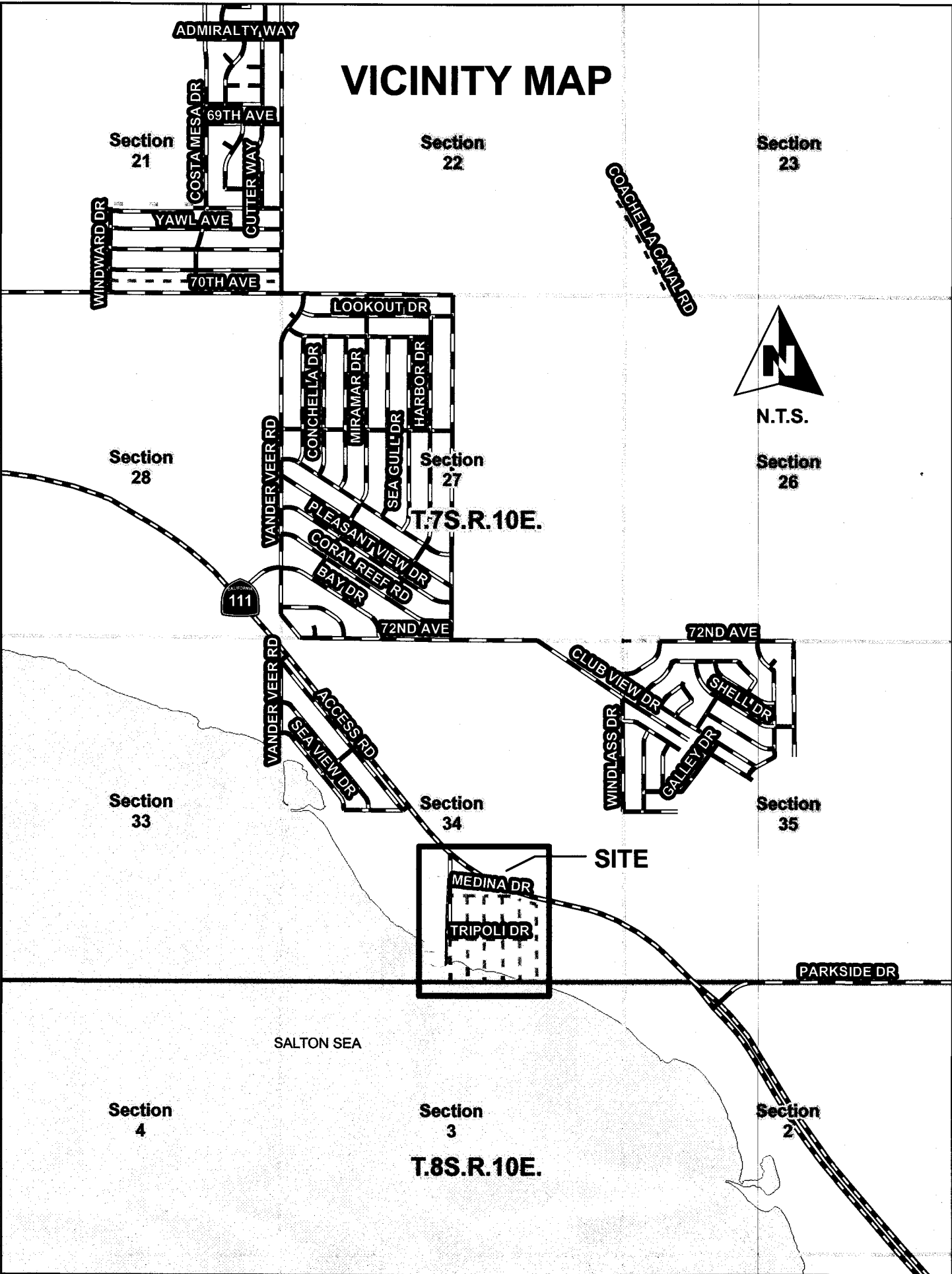

REMOVE PRIOR TO RECORDATION