

**SUBMITTAL TO THE BOARD OF SUPERVISORS
COUNTY OF RIVERSIDE, STATE OF CALIFORNIA**



866 A

FROM: TLMA - Transportation Department

SUBMITTAL DATE:
May 13, 2010

SUBJECT: Indian Canyon Drive at Interstate 10 (I-10), reconstruction of interchange in the City of Palm Springs and the unincorporated area of Riverside County.

RECOMMENDED MOTION: That the Board of Supervisors:

1. Conduct a public hearing with respect to the request received from low bidder Granite Construction Company regarding the subject improvements, to substitute a subcontractor due to clerical error; and at the close of the public hearing, pursuant to §4107.5 of the California Public Contract Code and in the absence of compelling reasons to the contrary, approve the request of Granite Construction to substitute Foundation Pile, Inc. in place of West Coast/Tipco Pile Driving, JV as the subcontractor for the work of pile driving, and;

Juan C. Perez
Director of Transportation

JCP:jrs:sb
(Continued On Attached Pages)

FINANCIAL DATA	Current F.Y. Total Cost:	\$ 16,526,137	In Current Year Budget:	Yes
	Current F.Y. Net County Cost:	\$ 0	Budget Adjustment:	No
	Annual Net County Cost:	\$ 0	For Fiscal Year:	2009/2010
SOURCE OF FUNDS: City of Palm Springs (99.92%), Mission Springs Water District (0.08%)				Positions To Be Deleted Per A-30 <input type="checkbox"/> Requires 4/5 Vote <input type="checkbox"/>

C.E.O. RECOMMENDATION:

APPROVE

BY:
Tina Grande

County Executive Office Signature

FORM APPROVED COUNTY COUNSEL
 BY: NEAL R. KIPNIS
 DATE: 5/13/10
 Departmental Concurrence

Policy
 Policy

Consent
 Consent

Dept't Recomm.:
 Per Exec. Ofc.:

Prev. Agn. Ref. 3/16/10, Item 3.64 | **District:** 5 | **Agenda Number:**

The Honorable Board of Supervisors

RE: Indian Canyon Drive at Interstate 10 (I-10), reconstruction of interchange in the City of Palm Springs and the unincorporated area of Riverside County.

May 13, 2010

Page 2

RECOMMENDED MOTIONS continued:

2. Subject to approval of Item 1; accept the low bid of Granite Construction Company of Indio, CA in the amount of \$16,526,137, and award the contract to that firm and authorize the Chairman of the Board to execute the contract documents, and;
3. Authorize the Director of Transportation to approve up to \$150,000 single item change orders not to exceed a cumulative amount of 10% (\$1,652,614) of the original contract amount, and;
4. Amend the project's budget as proposed on Attachment "A".

BACKGROUND:

By Minute Order dated March 16, 2010 (agenda item 3.64) the Board authorized the Clerk of the Board to advertise for the reconstruction of the Indian Canyon Drive at Interstate 10 (I-10) interchange within the City of Palm Springs and the unincorporated area of Riverside County.

Bids for the project were opened in the office of the Director of Transportation at 2:00 PM, Wednesday, April 28, 2010. Nine bids were received. The basis for the selection of a contractor is the lowest responsive and responsible bidder for all schedules of work. The lowest responsive and responsible bid was submitted by Granite Construction Company of Indio, CA, in the amount of \$16,526,137.

The total bid price, submitted by Granite Construction Company is \$8,949,463 (35%) below the Engineer's Estimate. The project will be completed within the existing budget shown on Attachment "A".

Pursuant to §4107 and 4107.5 of the California Public Contract Code, Granite Construction Company has requested that West Coast/Tipco Pile Driving, JV be substituted with Foundation Pile, Inc., as its subcontractor related to the bridge piling scope of work on the project. Granite Construction Company requested this substitution based on the grounds that West Coast/Tipco Pile Driving, JV was listed mistakenly, and Foundation Pile, Inc. was erroneously excluded from Granite Construction Company's list of subcontractors in its bid due to an inadvertent clerical error (California Public Contract Code §4107.5). On May 6, 2010, the required notice of Granite Construction Company's request to change subcontractors was given by County to West Coast/Tipco Pile Driving, JV. The request for substitution; the affidavits of the clerical error received from the prime contractor, the listed subcontractor and the intended subcontractor, as required under the statute; the letter giving notice of the request to West Coast/Tipco Pile Driving, JV; and the letter giving notice of this public hearing, are attached and designated as Attachment "B".

This public hearing is required pursuant to §4107 and §4107.5 of the California Public Contract Code. The Office of County Counsel and the Transportation Department have reviewed the documents received from Granite Construction, West Coast/Tipco Pile Driving, JV and

The Honorable Board of Supervisors

RE: Indian Canyon Drive at Interstate 10 (I-10), reconstruction of interchange in the City of Palm Springs and the unincorporated area of Riverside County.

May 13, 2010

Page 3

Foundation Pile, Inc., and are of the opinion the requirements of the two referenced statutes are met, and recommend that the declared clerical error and requested substitution be approved.

The Indian Canyon Drive Interchange at I-10 is identified in the County's Transportation Improvement Program and is a high priority facility in the Coachella Valley Association of Government (CVAG) Regional Arterial Program. Significant growth in the area has increased traffic volume beyond the capacity of the interchange; as a result, the interchange traffic service is currently failing during the peak hours of operation. The proposed improvements to the interchange will increase the capacity and enhance the traffic operation to a satisfactory level for current and future traffic volumes.

The improvements to the Indian Canyon Drive Interchange consist of the replacement of the existing bridge over I-10 with a new six-lane overcrossing, reconstruction of portions of Indian Canyon Drive, Garnet Avenue, and 20th Avenue, the realignment and widening of the interchange ramps, the addition of westbound and eastbound loop on-ramps and signalization of the ramp termini.

The City competed for Federal Economic Stimulus funds under the American Recovery and Reinvestment Act for this project and was successful in obtaining \$5,518,000. In addition to improved traffic operations, the interchange project will create construction jobs and safety at this interchange.

The City of Palm Springs will provide the County with all funding to Advertise, Award and Administer the project. A construction cooperative agreement has been prepared and has been executed by both parties. Preparation of construction plans and acquisition of right-of-way was performed by the City.

The adjustment of water valves to grade, owned by The Springs Water District, was included in the bid package as an alternate bid schedule. The District has approved the award of the alternate bid schedule as bid by the apparent low bidder, and the costs for the work will be funded by the District.

The Contractor is qualified.

Project Numbers: Project No: A8-0372
 Federal Aid No: ESPLHPLU – 5282 (034) and HP21L – 5282 (035)

**STATE HIGHWAY
IN RIVERSIDE COUNTY
IN THE CITY OF PALM SPRINGS
ON INTERSTATE 10
FROM 0.86 km WEST TO 0.70 km EAST OF
INDIAN CANYON Dr OVERCROSSING**

TO BE SUPPLEMENTED BY STANDARD PLANS DATED JULY 2004

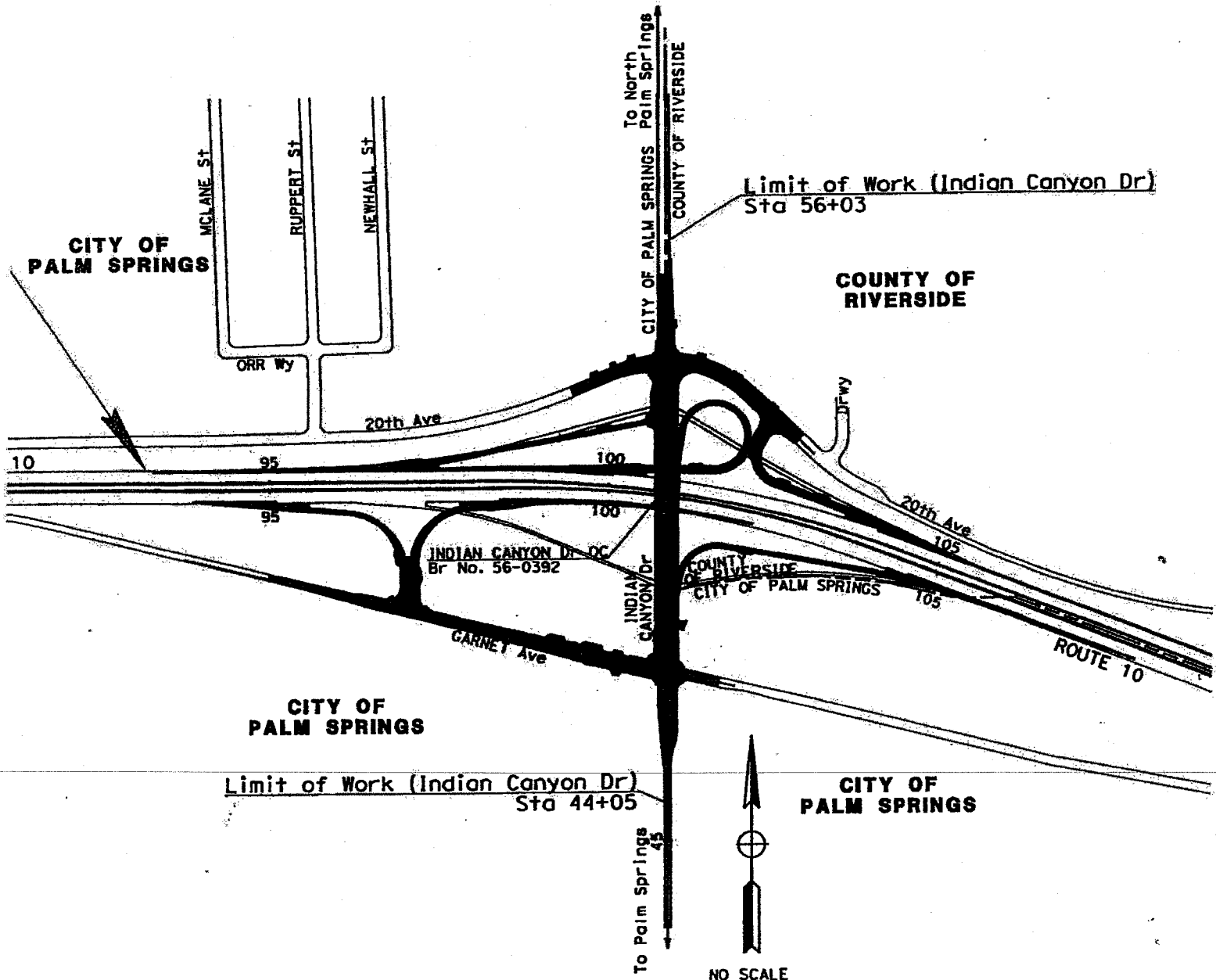

VICINITY MAP

Attachment "A"

Riverside County Transportation Department

Project: **Indian Canyon Drive Interchange Project (Advertise, Award and Administer Only)**

Project No.(s): **A8-0372**

Project Costs and Budget

Activity	Incurred Costs	Projected Costs	Total Costs	Existing Budget	Proposed Budget
Preliminary Survey					
Environmental					
Design					
Right-of-way					
Utilities					
Construction		16,526,137	16,526,137		
Construction Contingency 10.0%		1,652,614	1,652,614	30,750,000	18,179,000
Construction Engineering & Inspection	130,850	3,681,000	3,811,850	1,845,000	3,812,000
Construction Survey	4,500	500,000	504,500	800,000	505,000
Totals:	135,350	22,359,751	22,495,101	33,395,000	22,496,000

Project Funding

Code	Name	Existing Budget	Proposed Budget
990	Misc. Mision Springs Water District		17,000
718	City of Palm Springs	33,395,000	22,479,000
Totals		33,395,000	22,496,000

Comments

City incurred costs for Environmental, Design, and R/W are not included here.

Attachment "A"

Riverside County Transportation Department

Project: Indian Canyon Drive Interchange Project (Total)

Project No.(s): A8-0372

Project Costs and Budget

Activity	Incurred Costs	Projected Costs	Total Costs	Existing Budget	Proposed Budget
Preliminary Survey					
Environmental					
Design	200,007	10,000	210,007	227,000	210,000
Right-of-way	27,028		27,028	9,000	27,000
Utilities					
Construction		16,526,137	16,526,137	30,750,000	18,179,000
Construction Contingency 10.0%		1,652,614	1,652,614		
Construction Engineering & Inspection	130,850	3,671,000	3,801,850	1,845,000	3,802,000
Construction Survey	4,500	500,000	504,500	800,000	505,000
Totals:	362,385	22,359,751	22,722,136	33,631,000	22,723,000

Project Funding

Code	Name	Existing Budget	Proposed Budget
340	Transportation Uniform Mitigation Fee (CVAG)	4,431,000	81,000
718	City of Palm Springs	29,054,000	22,385,000
301	Measure A/ Coachella Valley	121,000	
332	Redevelopment Agency	25,000	25,000
622	DIF AP2 Maj. Imp. Fnd- Coachella West Area		215,000
990	Misc. Mision Springs Water District		17,000
Totals		33,631,000	22,723,000

Comments

City incurred costs for Environmental, Design, and R/W are not included here.



April 30, 2010

Via Facsimile to (951) 955-3164

Riverside County Transportation Department
14th Street Transportation Annex
3532 14th Street
Riverside, California 92501

Re: Request for Subcontractor Substitution
Indian Canyon Drive at Interstate 10
Reconstruction of Interchange, Project No. A8-0372
Federal Aid No. ESPLHPLU-5282(034) & HP21L-5282 (035)

Attn: Joel Jimenez

Dear Mr. Jimenez:

On April 28, 2010, Granite Construction Company ("Granite") submitted the apparent low bid on the Indian Canyon Drive at Interstate 10 Reconstruction of Interchange, Project No. A8-0372, Federal Aid No. ESPLHPLU-5282(034) & HP21L-5282 (035) ("Project"). However, in submitting its proposal, Granite inadvertently listed West Coast/Tipco Pile Driving, JV, for the bridge pile driving work, when in fact, it intended to list Foundation Pile, Inc. By this correspondence, Granite formally requests subcontractor substitution pursuant to California Public Contract Code § 4107(a) (5) to add Foundation Pile, Inc. ("Foundation") in place of West Coast/Tipco Pile Driving, JV, as its subcontractor relative to the bridge piling scope of work on the Project on the grounds Foundation was erroneously and inadvertently excluded from Granite's list of subcontractors in its bid due to clerical error.

As evidenced by the declaration of John P. Douglas, attached hereto, Granite's failure to list Foundation was an inadvertent clerical error and did not facilitate any bid peddling or bid shopping in violation of the California Subcontractor Listing Law.

The Subcontractor Listing Law was enacted by the California Legislature over 50 years ago to protect subcontractors from the unfair and undesirable business practice of bid peddling and bid shopping by entities with whom they subcontract. In Public Contract Code ("PCC") §4101 the Legislature expressly declared:

The Legislature find that the practices of bid shopping and bid peddling in connection with the construction, alteration and repair of public improvements often result in poor quality of material and workmanship to the detriment of the public, deprived the public of full benefits of fair competition among prime contractors and subcontractors, and lead to insolvencies, loss of wages to employees, and other evils.

Southern California Region
38000 Monroe St.
Indio, CA 92203
Phone 760/775-7500
FAX 760/775-8227

Riverside County Transportation Department
April 30, 2010
Page 2 of 2

In interpreting the Subcontractor Listing Law, the California Supreme Court has defined bid peddling and bid shopping to be:

Bid shopping is the use of the low bid already received by the general contractor to pressure other subcontractors into submitting even lower bids. Bid peddling, conversely, is an attempt by the subcontractor to undercut known bids already submitted to the general contractor in order to procure the job. Southern California Acoustics Co., Inc., v. C.V. Holder, Inc., (1969) 71 Cal.2d 719, 726-727.

Relative to the Project, Granite has not engaged in any post-bid subcontractor bid peddling or bid shopping as defined under California law. Specifically, Granite did not contact any bridge piling subcontractors and solicit from them lower bids by announcing the bid of other similar subcontractors ("bid shopping"). Likewise, Granite did not receive from any subcontractors submitting bids for the bridge piling work, offers to beat or undercut any other subcontractor's prices ("bid peddling").

Based on the foregoing, Granite respectfully request permission to substitute Foundation as a subcontractor on the Project. In the event the Department is unwilling to grant Granite's request for subcontractor substitution, Granite is ready, willing and able to self perform this scope of work as required by Public Contract Code Section 4106.

Very truly yours,
GRANITE CONSTRUCTION COMPANY

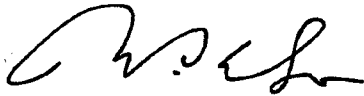

John P. Douglas
Southern California Region Chief Estimator

Declaration of WEST COAST/TIPCO PILE DRIVING J.V.
I, ANTHONY WILL, declare as follows:

1. I am the MANAGING PARTNER of West Coast/Tipco Pile Driving, JV's. On April 28, 2010, I submitted West Coast/Tipco Pile Driving, JV's bid (a copy of which is attached hereto) in writing to Granite Construction Company ("Granite"), as well as other contractors submitting bids, in the amount of \$646,396.00 relative to the bridge pile scope of work on Indian Canyon Drive at Interstate 10, Reconstruction of Interchange, Project No. A8-0372, Federal Aid No. ESPLHPLU-5282(034) & HP21L-5282 (035) ("Project").
2. At no point in the bidding process did Granite request I lower my bid ("bid shopping") and at no point in the bidding process did I offer to lower Foundation's bid to beat or undercut the bid of any other subcontractor ("bid peddling").
3. I understand that West Coast/Tipco Pile Driving, JV was not the low bidder for the bridge piling work, and was inadvertently listed as the subcontractor for Granite Construction Company on the above referenced job. I understand that Foundation Pile was the low bidder on the project, should have been listed as the subcontractor for the project, and will be used by Granite Construction Company for the bridge piling work on the project.

I declare, under the penalty of perjury, the foregoing to be true and correct.

Executed this 4th day of May, 2010.

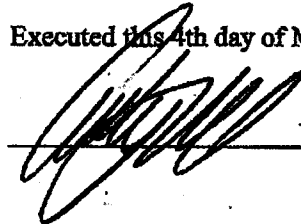

Declaration of Foundation Pile, Inc.

I, Jeff Bird, declare as follows:

1. I am the Sr. Estimator of Foundation Pile, Inc ("Foundation")
2. On April 28, 2010, I submitted Foundations's bid (a copy of which is attached hereto) in writing to Granite Construction Company ("Granite"), as well as other contractors submitting bids, in the amount of \$598,246.00 relative to the bridge pile scope of work on Indian Canyon Drive at Interstate 10, Reconstruction of Interchange, Project No. A8-0372, Federal Aid No. ESPLHPLU-5282(034) & HP21L-5282 (035) ("Project").
3. At no point in the bidding process did Granite request I lower my bid ("bid shopping") and at no point in the bidding process did I offer to lower Foundation's bid to beat or undercut the bid of any other subcontractor ("bid peddling").

I declare, under the penalty of perjury, the foregoing to be true and correct.

Executed this 30th day of April, 2010.



Jeff Bird

Declaration of John P. Douglas, Regional Chief Estimator, Granite Construction Company

I, John P. Douglas, declare as follows:

1. I assisted in the preparation of Granite Construction Company's bid to the Riverside County Transportation Department, for the Indian Canyon Drive at Interstate 10 Reconstruction of Interchange, Project No. A8-0372, Federal Aid No. ESPLHPLU-5282(034) & HP21L-5282 (035) ("Project") by receiving subcontractor bids on April 28, 2010, relative to the bridge piling scope of work on the Project.
2. Relative to the bridge piling scope of work on the Project, Granite received the following subcontractor bids:
 1. Foundation Pile, Inc., bid for \$598,246, Exhibit A;
 2. West Coast/Tipco Pile Driving, JV, bid for \$646,396, Exhibit B
3. Based on the foregoing, Granite in submitting its proposal, included the subcontractor bid amount of Foundation as its bridge piling subcontractor on the Project, in the amount of \$598,246 in response to its bid.
4. Granite has not engaged in any post-bid subcontractor bid pedaling or bid shopping as defined under California law. Specifically, Granite did not contact any bridge piling subcontractors and solicit from them lower bids by announcing the bid of other similar subcontractors ("bid shopping"). Likewise, Granite did not receive from any of its subcontractors, offers to beat any other subcontractor's prices ("bid peddling").
5. In filling out the bid form for the Project, Granite erroneously failed to list Foundation, as Granite's bridge pile subcontractor through inadvertence and mistake.
6. Granite's bid was based upon Foundation's bid; however, Granite inadvertently and unintentionally omitted the correct subcontractor on the required listing.

I declare under the penalty of perjury, the foregoing to be true and correct.

Executed in Riverside County, this 30th day of April, 2010.



John P. Douglas, Southern California Regional Chief Estimator

COUNTY OF RIVERSIDE
TRANSPORTATION AND
LAND MANAGEMENT AGENCY

Transportation Department

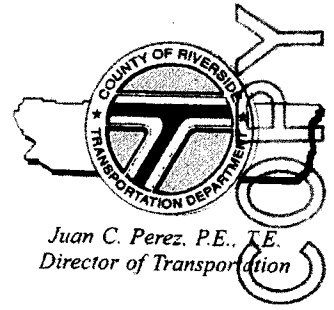

Juan C. Perez, P.E., T.E.
Director of Transportation

May 6, 2010

West Coast/Tipco Pile Driving, JV
Mr. Anthony Will, Managing Partner
818 Grayson Road
Pleasant Hill, CA 94523

RE: Indian Canyon Drive Interchange at Interstate 10

Dear Mr. Will:

Pursuant to §4107 of the California Public Contract Code, we are hereby notifying your Joint Venture that Granite Construction Company has requested that West Coast/Tipco Pile Driving, JV be substituted with Foundation Pile, Inc., as its subcontractor related to the bridge piling scope of work on the Indian Canyon Drive Interchange project.

Granite Construction Company has requested this substitution based on the grounds that West Coast/Tipco Pile Driving, JV was mistaken listed, and Foundation Pile, Inc. was erroneously excluded from Granite Construction Company's list of subcontractors in its bid due to an inadvertent clerical error (California Public Contract Code §4107.5).

Written objections to the above substitution must be submitted within 5 working days of your receipt of this letter and should be addressed to:

Riverside County Transportation Department
Attn: Joel Jimenez, PE
3525 14th Street
Riverside, CA 92501

Please return a signed and dated copy of this letter to the above address.

Sincerely,

Receipt of Letter:

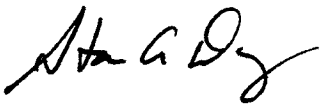
for 
Joel Jimenez
Senior Civil Engineer

West Coast/Tipco Pile Driving, JV Date

COUNTY OF RIVERSIDE
TRANSPORTATION AND
LAND MANAGEMENT AGENCY

Transportation Department

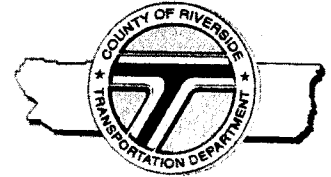

Juan C. Perez, P.E., T.E.
Director of Transportation

May 13, 2010

West Coast/Tipco Pile Driving, JV
Mr. Anthony Will, Managing Partner
818 Grayson Road
Pleasant Hill, CA 94523

RE: Indian Canyon Drive Interchange at Interstate 10

Dear Mr. Will:

Pursuant to §4107 of the California Public Contract Code, we are hereby notifying your Joint Venture that a public hearing has been set for 9:30 a.m. or as soon thereafter, on May 25, 2010, as this matter may be heard, at the Board of Supervisor's Chambers, located on the first floor of the County Administrative Center, 4080 Lemon Street in Riverside, California 92501.

At the public hearing set forth above, the Board of Supervisors will hear the testimony regarding Granite Construction Company's request that West Coast/Tipco Pile Driving, JV be substituted with Foundation Pile, Inc., as its subcontractor related to the bridge piling scope of work on the Indian Canyon Drive Interchange project.

Granite Construction Company has requested this substitution based on the grounds that West Coast/Tipco Pile Driving, JV was mistaken listed, and Foundation Pile, Inc. was erroneously excluded from Granite Construction Company's list of subcontractors in its bid due to an inadvertent clerical error (California Public Contract Code §4107.5).

Sincerely,

A handwritten signature in black ink that reads "Joel Jimenez".

for
Joel Jimenez
Senior Civil Engineer

Form 11 Attachment

Contract/Lease/Purchase Summary Data

Contract (for Services)

- Approval/Renewal
- Sole Source
- Personal Services
- Independent Contractor
- Other than Low Bid
- Change Order

Public Works

Lease

- Approval/Renewal
- Multi-Year Lease
- Equipment
- Real Property
- Change Order

Purchase (for Materials)

- Sole Source
- Other than Low Bid
- Change Order

Selection Committee Member Names (RFP's Only)

User Department:	Transportation Department
-------------------------	---------------------------

N/A

Vendor/Lessor Name:	Granite Construction Company
----------------------------	------------------------------

Minority Status:

M W DV None

Vendor/Lessor Location:	Indio, CA
--------------------------------	-----------

Local Preference Applied: Yes No N/A

Local Preference Award Cost \$
(5% maximum preference)

Local Preference FYTD: Cost \$

of Orders

Applicable Board Policy #

Comments:

RFQ/RFP Process:

Date Mailed:
Response Date:
of Responses:
of Qualified Responses:

Bidding Process:

Bid Range: \$ 16,526,137.00 to \$ 20,083,101.50
Local Bid Range: N/A
Responsive and
Responsible Bid Range: \$ 16,526,137.00 to \$ 20,083,101.50

Contract/Lease Renewals Only

Existing Agreement Items

Proposed Agreement Items

1. Rates
2. Terms
3. Conditions
4. Legal Issues
5. Accountability
6. Utilities

(continue on blank sheet if necessary)

NOTE: COMPETITIVELY BID PUBLIC WORKS CONTRACT

Riverside County Transportation Department

Summary of Bids

PROJECT:

Advertised: March 16, 2010 (Agenda Item: 3.64)

I-10 at Indian Canyon Dr Interchange Improvement Project
 Project No. A8-0372
 Federal Aid No. ESPLHPLU-5282(034) & HP21L-5282(035)

Bids Open: 2 pm Date: Wednesday, April 28, 2010

	Company Name	Base Bid Subtotal	Alternate Bid - MISSION SPRINGS WATER DISTRICT	Total
	COUNTY'S ESTIMATE	\$25,465,100.00	\$10,500.00	\$25,475,600.00
1	GRANITE CONST. CO.	\$16,510,737.00	\$15,400.00	\$16,526,137.00
2	SECURITY PAVING CO., INC.	\$16,992,002.00	\$5,110.00	\$16,997,112.00
3	SEMA CONSTRUCTION, INC.	\$17,320,936.20	\$13,300.00	\$17,334,236.20
4	RIVERSIDE CONSTRUCTION CO.	\$17,477,944.50	\$3,500.00	\$17,481,444.50
5	SKANSKA USA CIVIL WEST	\$17,561,037.00	\$4,620.00	\$17,565,657.00
6	FTR INTERNATIONAL, INC.	\$17,931,221.00	\$17,500.00	\$17,948,721.00
7	ORTIZ ENTERPRISES, INC.	\$18,104,492.90	\$6,300.00	\$18,110,792.90
8	BEADOR CONSTRUCTION	\$18,137,019.00	\$14,000.00	\$18,151,019.00
9	SUKUT CONSTRUCTION, INC.	\$20,075,681.50	\$7,420.00	\$20,083,101.50
	<i>Average Bid Prices</i>	<i>\$17,790,119.01</i>	<i>\$9,683.33</i>	<i>\$17,799,802.34</i>

Riverside County Transportation Department Summary of Bids

PROJECT: I-10/Indian Canyon Drive Interchange Improvements

Advertised: March 16, 2010 (Agenda Item: 3.64)
Bids Open: 2 pm Date: Wednesday, April 28, 2010

PROJECT NO. A8-0372; ESPLHPLU-5282(034); HP21-L-5282 (035)

Granite Construction Co.
Indio, CA 92203

COUNTY'S ESTIMATE

BASE BID ITEM NO.	ITEM CODE	CONTRACT ITEM	UNITS	QUANTITY	UNIT PRICE	ENG ESTIMATE	BID UNIT PRICE	BID ESTIMATE
1	000003	ENDANGERED SPECIES PROTECTION	LS	1	50,000.00	50,000.00	2,000.00	2,000.00
2	000003	NONNATIVE PLANT PRECLUSION	LS	1	10,000.00	10,000.00	1,500.00	1,500.00
3	000003	CONSTRUCTION MONITORING CAMERA (POLE AND ELECTRIC SERVICE)	LS	1	50,000.00	50,000.00	985.00	985.00
4 (S,F)	000003	METAL SCRIPT LETTERS (RAILING METHOD)	LS	1	39,600.00	39,600.00	6,500.00	6,500.00
5	-----	ITEM DELETED BY ADDENDUM	-----	-----	-----	-----	-----	-----
6	070012	PROGRESS SCHEDULE (CRITICAL PATH METHOD)	LS	1	10,000.00	10,000.00	4,500.00	4,500.00
7	071325	TEMPORARY FENCE (TYPE ESA)	M	610	16.00	9,760.00	14.00	8,540.00
8	000003	TEMPORARY FENCE (TYPE WILDLIFE)	M	610	30.00	18,300.00	18.00	10,980.00
9	074016	CONSTRUCTION SITE MANAGEMENT	LS	1	150,000.00	150,000.00	15,000.00	15,000.00
10	074020	WATER POLLUTION CONTROL	LS	1	10,000.00	10,000.00	500.00	500.00
11	074018	HEALTH AND SAFETY PLAN	LS	1	5,000.00	5,000.00	500.00	500.00
12	074028	TEMPORARY FIBER ROLLS	M	10,800	9.00	97,200.00	7.00	75,600.00
13	074029	TEMPORARY SILT FENCE	M	960	9.00	8,640.00	17.00	16,320.00
14	074033	TEMPORARY CONSTRUCTION ENTRANCE	EA	3	3,500.00	10,500.00	4,500.00	13,500.00
15	074035	TEMPORARY CHECK DAM	M	52	9.00	468.00	35.00	1,820.00
16	074037	MOVE-IN/MOVE-OUT (TEMPORARY EROSION CONTROL)	EA	4	1,000.00	4,000.00	350.00	1,400.00
17	074038	TEMPORARY DRAINAGE INLET PROTECTION	EA	39	400.00	15,600.00	125.00	4,875.00
18	074039	TEMPORARY HYDRAULIC MULCH (POLYMER STABILIZED FIBER MATRIX)	M2	136,000	1.00	136,000.00	0.20	27,200.00
19	074041	STREET SWEEPING	LS	1	65,000.00	65,000.00	65,000.00	65,000.00
20	074042	TEMPORARY CONCRETE WASHOUT (PORTABLE)	LS	1	25,000.00	25,000.00	8,500.00	8,500.00
21	120090	CONSTRUCTION AREA SIGNS	LS	1	47,000.00	47,000.00	18,000.00	18,000.00
22	120100	TRAFFIC CONTROL SYSTEMS	LS	1	140,000.00	140,000.00	150,000.00	150,000.00
23	120120	TYPE III BARRICADE	EA	140	75.00	10,500.00	35.00	4,900.00
24	120143	TEMPORARY PAVEMENT DELINEATION	M	4,460	0.95	4,237.00	5.00	22,300.00
25	120149	TEMPORARY PAVEMENT MARKING (PAINT)	M2	100	30.00	3,000.00	40.00	4,000.00
26	120199	TRAFFIC PLASTIC DRUM	EA	590	55.00	32,450.00	30.00	17,700.00
27	128650	PORTABLE CHANGEABLE MESSAGE SIGN	EA	10	10,000.00	100,000.00	7,500.00	75,000.00
28	129000	TEMPORARY RAILING (TYPE K)	M	5,300	35.00	185,500.00	27.00	143,100.00
29	129110	TEMPORARY CRASH CUSHION [SAND FILLED]	EA	210	260.00	54,600.00	275.00	57,750.00
30	129110	TEMPORARY CRASH CUSHION [ABSORB 350]	EA	6	3,500.00	21,000.00	11,500.00	69,000.00
31	150701	REMOVE YELLOW TRAFFIC STRIPE [HAZARDOUS WASTE]	M	2,870	2.00	5,740.00	2.50	7,175.00
32	150608	REMOVE CHAIN LINK FENCE	M	610	20.00	12,200.00	14.00	8,540.00
33	150659	REMOVE TERMINAL SECTION	EA	3	1,500.00	4,500.00	2,000.00	6,000.00
34	150662	REMOVE METAL BEAM GUARD RAILING	M	660	35.00	23,100.00	22.00	14,520.00
35	150710	REMOVE TRAFFIC STRIPE	M	34,100	2.00	68,200.00	1.90	64,790.00
36	150713	REMOVE PAVEMENT MARKING	M2	52	6.00	312.00	20.00	1,040.00

**Riverside County Transportation Department
Summary of Bids**

PROJECT: I-10/Indian Canyon Drive Interchange Improvements

Advertised: March 16, 2010 (Agenda Item: 3.64)
Bids Open: 2 pm Date: Wednesday, April 28, 2010

PROJECT NO. A8-0372; ESPLHPLU-5282(034); HP21-L-5282 (035)

**Granite Construction Co.
Indio, CA 92203**

COUNTY'S ESTIMATE

BASE BID (CONTINUED) ITEM NO.	ITEM CODE	CONTRACT ITEM	UNITS	QUANTITY	UNIT PRICE	ENG ESTIMATE	BID UNIT PRICE	BID ESTIMATE
37	150722	REMOVE PAVEMENT MARKER	EA	8,520	1.50	12,780.00	2.00	17,040.00
38	150742	REMOVE ROADSIDE SIGN	EA	43	142.00	6,106.00	100.00	4,300.00
39	150760	REMOVE SIGN STRUCTURE	EA	2	5,000.00	10,000.00	3,500.00	7,000.00
40	150806	REMOVE CULVERT	M	360	120.00	43,200.00	60.00	21,600.00
41	150820	REMOVE INLET	EA	1	800.00	800.00	1,000.00	1,000.00
42	150821	REMOVE HEADWALL	EA	21	750.00	15,750.00	275.00	5,775.00
43	153153	COLD PLANE ASPHALT CONCRETE PAVEMENT (45 MM MAXIMUM)	M2	1,080	4.00	4,320.00	8.50	9,180.00
44	160101	CLEARING AND GRUBBING	LS	1	82,500.00	82,500.00	82,500.00	82,500.00
45	170101	DEVELOP WATER SUPPLY	LS	1	10,000.00	10,000.00	10,000.00	10,000.00
46 (F)	190101	ROADWAY EXCAVATION	M3	29,170	20.00	583,400.00	15.00	437,550.00
47	190110	LEAD COMPLIANCE PLAN (METRIC)	LS	1	5,000.00	5,000.00	500.00	500.00
48	190113	ASBESTOS COMPLIANCE PLAN	LS	1	5,000.00	5,000.00	500.00	500.00
49	193118	CONCRETE BACKFILL	M3	14	80.00	1,120.00	225.00	3,150.00
50	194001	DITCH EXCAVATION	M3	320	30.00	9,600.00	8.00	2,560.00
51	198001	IMPORTED BORROW	M3	71,000	25.00	1,775,000.00	7.25	514,750.00
52	203016	EROSION CONTROL (TYPE D)	M2	13,200	1.50	19,800.00	0.65	8,580.00
53	203021	FIBER ROLLS (METRIC)	M	10,500	9.00	94,500.00	8.00	84,000.00
54	203026	MOVE-IN/MOVE-OUT (EROSION CONTROL)	EA	1	1,448.00	1,448.00	350.00	350.00
55	208731	200 MM CORRUGATED HIGH DENSITY POLYETHYLENE PIPE CONDUIT	M	68	200.00	13,600.00	200.00	13,600.00
56	220101	FINISHING ROADWAY	LS	1	28,000.00	28,000.00	25,000.00	25,000.00
57	260201	CLASS 2 AGGREGATE BASE	M3	14,600	50.00	730,000.00	22.00	321,200.00
58	280000	LEAN CONCRETE BASE	M3	190	190.00	36,100.00	200.00	38,000.00
59	374002	ASPHALTIC EMULSION (FOG SEAL COAT)	TONN	6	725.00	4,350.00	3,000.00	18,000.00
60	390106	ASPHALT CONCRETE (OPEN GRADED)/OPEN GRADED FRICTION COURSE	TONN	1,310	100.00	131,000.00	90.00	117,900.00
61	390130	HOT MIX ASPHALT (TYPE A)	TONN	320	90.00	28,800.00	99.50	31,840.00
62	000003	HOT MIX ASPHALT (TYPE A BOND BREAKER)	TONN	120	115.00	13,800.00	110.00	13,200.00
63	000003	HOT MIX ASPHALT (TYPE C)	TONN	31,200	90.00	2,808,000.00	71.00	2,215,200.00
64	394071	PLACE HOT MIX ASPHALT DIKE	M	4,570	6.00	27,420.00	6.50	29,705.00
65	394090	PLACE HOT MIX ASPHALT (MISCELLANEOUS AREA)	M2	320	100.00	32,000.00	40.00	12,800.00
66	397005	TACK COAT	TONN	38	550.00	20,900.00	1,400.00	53,200.00
67	401066	CONCRETE PAVEMENT (EXIT RAMP TERMINI) [JOINTED PLAIN CONCRETE PAVEMENT]	M3	430	300.00	129,000.00	275.00	118,250.00
68	401108	RAPID STRENGTH CONCRETE [JOINTED PLAIN CONCRETE PAVEMENT]	M3	3,780	1,000.00	3,780,000.00	205.00	774,900.00
69	000003	SEAL ISOLATION JOINT	M	1,280	20.00	25,600.00	4.00	5,120.00
70	414091	SEAL LONGITUDINAL JOINT	M	2,140	6.00	12,840.00	4.00	8,560.00
71	414101	SEAL TRANSVERSE JOINT	M	2,120	6.00	12,720.00	4.00	8,480.00

**Riverside County Transportation Department
Summary of Bids**

PROJECT: I-10/Indian Canyon Drive Interchange Improvements

Advertised: March 16, 2010 (Agenda Item: 3.64)
Bids Open: 2 pm Date: Wednesday, April 28, 2010

PROJECT NO. A8-0372; ESPLHPLU-5282(034); HP21-L-5282 (035)

**Granite Construction Co.
Indio, CA 92203**

COUNTY'S ESTIMATE

BASE BID (CONTINUED) ITEM NO.	ITEM CODE	CONTRACT ITEM	UNITS	QUANTITY	UNIT PRICE	ENG ESTIMATE	BID UNIT PRICE	BID ESTIMATE
72	518201	MASONRY STONE WALL	M2	23	262.50	6,037.50	800.00	18,400.00
73 (F)	510129	CLASS 2 CONCRETE (BOX CULVERT)	M3	190	850.00	161,500.00	1,000.00	190,000.00
74 (F)	510502	MINOR CONCRETE (MINOR STRUCTURE)	M3	110	1,350.00	148,500.00	2,000.00	220,000.00
75 (F)	520107	BAR REINFORCING STEEL (BOX CULVERT)	KG	21,271	2.50	53,177.50	2.00	42,542.00
76 (F)	560218	FURNISH SIGN STRUCTURE (TRUSS)	KG	30,000	9.00	270,000.00	9.00	270,000.00
77 (F)	560219	INSTALL SIGN STRUCTURE (TRUSS)	KG	30,000	1.20	36,000.00	1.00	30,000.00
78	560234	FURNISH LAMINATED PANEL SIGN (25.4 MM -TYPE A)	M2	67	180.00	12,060.00	250.00	16,750.00
79	560238	FURNISH SINGLE SHEET ALUMINUM SIGN (1.6 MM- UNFRAMED)	M2	56	130.00	7,280.00	125.00	7,000.00
80	560239	FURNISH SINGLE SHEET ALUMINUM SIGN (2.0 MM- UNFRAMED)	M2	30	140.00	4,200.00	140.00	4,200.00
81	560241	FURNISH SINGLE SHEET ALUMINUM SIGN (1.6 MM- FRAMED)	M2	13	170.00	2,210.00	135.00	1,755.00
82	560242	FURNISH SINGLE SHEET ALUMINUM SIGN (2.0 MM- FRAMED)	M2	71	160.00	11,360.00	150.00	10,650.00
83	561015	1524 MM CAST-IN-DRILLED-HOLE CONCRETE PILE (SIGN FOUNDATION)	M	23	3,200.00	73,600.00	4,000.00	92,000.00
84	566011	ROADSIDE SIGN - ONE POST	EA	85	400.00	34,000.00	350.00	29,750.00
85	566012	ROADSIDE SIGN - TWO POST	EA	17	900.00	15,300.00	575.00	9,775.00
86	568001	INSTALL SIGN (STRAP AND SADDLE BRACKET METHOD)	EA	8	110.00	880.00	350.00	2,800.00
87	568015	INSTALL SIGN (MAST-ARM HANGER METHOD)	EA	22	200.00	4,400.00	375.00	8,250.00
88	620909	450 MM ALTERNATIVE PIPE CULVERT	M	71	300.00	21,300.00	160.00	11,360.00
89	620913	600 MM ALTERNATIVE PIPE CULVERT	M	230	350.00	80,500.00	170.00	39,100.00
90	620924	900 MM ALTERNATIVE PIPE CULVERT	M	120	550.00	66,000.00	180.00	21,600.00
91	664097	600 MM BITUMINOUS COATED CORRUGATED STEEL PIPE (2.77 MM THICK)	M	200	450.00	90,000.00	200.00	40,000.00
92	664110	900 MM BITUMINOUS COATED CORRUGATED STEEL PIPE (2.77 MM THICK)	M	50	750.00	37,500.00	225.00	11,250.00
93	717072	100 MM POLYVINYL CHLORIDE SEWER PIPE	M	37	50.00	1,850.00	50.00	1,850.00
94	721008	ROCK SLOPE PROTECTION (LIGHT, METHOD B)	M3	140	120.00	16,800.00	160.00	22,400.00
95	721430	CONCRETE (CHANNEL LINING)	M3	73	300.00	21,900.00	500.00	36,500.00
96	729010	ROCK SLOPE PROTECTION FABRIC	M2	330	20.00	6,600.00	25.00	8,250.00
97 (F)	731504	MINOR CONCRETE (CURB AND GUTTER)	M3	250	650.00	162,500.00	775.00	193,750.00
98 (F)	000003	MINOR CONCRETE (COLORED)	M2	1,890	120.00	226,800.00	120.00	226,800.00
99 (F)	731521	MINOR CONCRETE (SIDEWALK)	M3	260	600.00	156,000.00	525.00	136,500.00
100 (F)	731530	MINOR CONCRETE (TEXTURED PAVING)	M2	1,190	180.00	214,200.00	125.00	148,750.00
101 (F)	750001	MISCELLANEOUS IRON AND STEEL	KG	1,262	4.50	5,679.00	10.00	12,620.00
102	800391	CHAIN LINK FENCE (TYPE CL-1.8)	M	940	50.00	47,000.00	65.00	61,100.00
103	820105	DELINEATOR (SPECIAL)	EA	23	75.00	1,725.00	60.00	1,380.00
104	820107	DELINEATOR (CLASS 1)	EA	160	50.00	8,000.00	50.00	8,000.00
105	832003	METAL BEAM GUARD RAILING (WOOD POST)	M	670	90.00	60,300.00	99.00	66,330.00
106	839541	TRANSITION RAILING (TYPE WB)	EA	4	3,800.00	15,200.00	6,000.00	24,000.00

**Riverside County Transportation Department
Summary of Bids**

PROJECT: I-10/Indian Canyon Drive Interchange Improvements

Advertised: March 16, 2010 (Agenda Item: 3.64)

Bids Open: 2 pm Date: Wednesday, April 28, 2010

PROJECT NO. A8-0372; ESPLHPLU-5282(034) & HP21L-5282 (035)

**Granite Construction Co.
Indio, CA 92203**

COUNTY'S ESTIMATE

BASE BID (CONTINUED) ITEM NO.	ITEM CODE	CONTRACT ITEM	UNITS	QUANTITY	UNIT PRICE	ENG ESTIMATE	BID UNIT PRICE	BID ESTIMATE
107	839568	TERMINAL ANCHOR ASSEMBLY (TYPE SFT)	EA	5	900.00	4,500.00	900.00	4,500.00
108	839585	ALTERNATIVE FLARED TERMINAL SYSTEM (TYPE SRT)	EA	9	2,200.00	19,800.00	3,500.00	31,500.00
109	839605	CRASH CUSHION (REACT 9SCBS)	EA	3	50,000.00	150,000.00	75,000.00	225,000.00
110	839703	CONCRETE BARRIER (TYPE 60C)	M	270	300.00	81,000.00	525.00	141,750.00
111	839705	CONCRETE BARRIER (TYPE 60E)	M	89	600.00	53,400.00	515.00	45,835.00
112	840515	THERMOPLASTIC PAVEMENT MARKING	M2	360	40.00	14,400.00	40.00	14,400.00
113	840563	200 MM THERMOPLASTIC TRAFFIC STRIPE	M	1,210	3.00	3,630.00	3.00	3,630.00
114	840571	100 MM THERMOPLASTIC TRAFFIC STRIPE (BROKEN 5.18 M - 2.14 M)	M	9,600	2.00	19,200.00	2.25	21,600.00
115	840656	PAINT TRAFFIC STRIPE (2-COAT)	M	13,100	2.00	26,200.00	1.25	16,375.00
116	850101	PAVEMENT MARKER (NON-REFLECTIVE)	EA	15,300	2.00	30,600.00	2.10	32,130.00
117	850110	PAVEMENT MARKER (RETROREFLECTIVE-SPECIAL TYPE C)	EA	86	60.00	5,160.00	5.00	430.00
118	850111	PAVEMENT MARKER (RETROREFLECTIVE-SPECIAL TYPE D)	EA	790	3.00	2,370.00	5.00	3,950.00
119	850112	PAVEMENT MARKER (RETROREFLECTIVE-SPECIAL TYPE G)	EA	2,790	4.00	11,160.00	5.00	13,950.00
120	850113	PAVEMENT MARKER (RETROREFLECTIVE-SPECIAL TYPE H)	EA	450	4.00	1,800.00	5.00	2,250.00
121	860251	SIGNAL AND LIGHTING (LOCATION 1)	LS	1	150,000.00	150,000.00	210,000.00	210,000.00
122	860252	SIGNAL AND LIGHTING (LOCATION 2)	LS	1	150,000.00	150,000.00	195,000.00	195,000.00
123	860300	SIGNAL AND LIGHTING (CITY STREET LOCATION 1)	LS	1	180,000.00	180,000.00	235,000.00	235,000.00
124	860302	SIGNAL AND LIGHTING (CITY STREET LOCATION 2)	LS	1	180,000.00	180,000.00	250,000.00	250,000.00
125	860460	LIGHTING AND SIGN ILLUMINATION	LS	1	175,000.00	175,000.00	590,000.00	590,000.00
126	860701	INTERCONNECTION CONDUIT AND CONDUCTOR	LS	1	15,000.00	15,000.00	160,000.00	160,000.00
127	861101	RAMP METERING SYSTEM (LOCATION 1)	LS	1	75,000.00	75,000.00	130,000.00	130,000.00
128	861102	RAMP METERING SYSTEM (LOCATION 2)	LS	1	80,000.00	80,000.00	140,000.00	140,000.00
129	861103	RAMP METERING SYSTEM (LOCATION 3)	LS	1	75,000.00	75,000.00	120,000.00	120,000.00
130	861104	RAMP METERING SYSTEM (LOCATION 4)	LS	1	90,000.00	90,000.00	130,000.00	130,000.00
131	861349	REMOVE EXISTING SIGNAL SYSTEM (LOCATION 1)	LS	1	10,000.00	10,000.00	80,000.00	80,000.00
132	861350	REMOVE EXISTING SIGNAL SYSTEM (LOCATION 2)	LS	1	10,000.00	10,000.00	80,000.00	80,000.00
133	999990	MOBILIZATION	LS	1	2,000,000.00	2,000,000.00	834,000.00	834,000.00
134	000003	COURSE OF CONSTRUCTION INSURANCE	LS	1	25,000.00	25,000.00	8,000.00	8,000.00
135	019901	DEMOBILIZATION	LS	1	467,000.00	467,000.00	500.00	500.00
136	066102	DUST ABATEMENT	LS	1	25,000.00	25,000.00	45,000.00	45,000.00
137	066105	RESIDENT ENGINEER OFFICE	LS	1	410,000.00	410,000.00	25,000.00	25,000.00
138	066840	TRAFFIC SIGNAL CONTROLLER ASSEMBLY [WITH BATTERY BACK-UP][2-LOCATIONS]	LS	1	13,600.00	13,600.00	13,600.00	13,600.00
139	066843	MODEL 170 CONTROLLER ASSEMBLY [RAMP METER] [4-LOCATIONS]	LS	1	19,200.00	19,200.00	19,200.00	19,200.00
140	066015	FEDERAL TRAINEE PROGRAM	LS	1	8,800.00	8,800.00	5,000.00	5,000.00
141	047403	610 MM STEEL PIPE CASING	M	26	200.00	5,200.00	1,000.00	26,000.00

**Riverside County Transportation Department
Summary of Bids**

PROJECT: I-10/Indian Canyon Drive Interchange Improvements

Advertised: March 16, 2010 (Agenda Item: 3.64)
Bids Open: 2 pm Date: Wednesday, April 28, 2010

PROJECT NO. A8-0372; ESPLHPLU-5282(034); HP21-L-5282 (035)

**Granite Construction Co.
Indio, CA 92203**

COUNTY'S ESTIMATE

BASE BID (CONTINUED) ITEM NO.	ITEM CODE	CONTRACT ITEM	UNITS	QUANTITY	UNIT PRICE	ENG ESTIMATE	BID UNIT PRICE	BID ESTIMATE
142	157550	BRIDGE REMOVAL	LS	1	150,000.00	150,000.00	85,000.00	85,000.00
143 (F)	192003	STRUCTURE EXCAVATION (BRIDGE)	M3	1,150	100.00	115,000.00	90.00	103,500.00
144 (F)	193003	STRUCTURE BACKFILL (BRIDGE)	M3	490	120.00	58,800.00	125.00	61,250.00
145	490566	FURNISH STEEL PILING (HP 360 X 132)	M	2,977	300.00	893,100.00	165.00	491,205.00
146	490567	DRIVE STEEL PILE (HP 360 X 132)	EA	196	2,500.00	490,000.00	1,525.00	298,900.00
147	*****	ITEM DELETED BY ADDENDUM	*****	*****	*****	*****	*****	*****
148	*****	ITEM DELETED BY ADDENDUM	*****	*****	*****	*****	*****	*****
149	500020	PRESTRESSING PRECAST GIRDER	LS	1	120,000.00	120,000.00	95,000.00	95,000.00
150 (F)	510051	STRUCTURAL CONCRETE, BRIDGE FOOTING	M3	220	700.00	154,000.00	425.00	93,500.00
151 (F)	510053	STRUCTURAL CONCRETE, BRIDGE	M3	1,710	1,100.00	1,881,000.00	870.00	1,487,700.00
152 (F)	510086	STRUCTURAL CONCRETE, APPROACH SLAB (TYPE N)	M3	210	1,000.00	210,000.00	650.00	136,500.00
153	511036	ARCHITECTURAL SURFACE [LAVA ROCK FACING]	M2	170	110.00	18,700.00	250.00	42,500.00
154 (F)	511063	FRACTURED FIN TEXTURE	M2	140	110.00	15,400.00	130.00	18,200.00
155	512254	FURNISH PRECAST PRESTRESSED CONCRETE BULB-TEE GIRDER (25 M-30 M)	EA	26	30,000.00	780,000.00	20,000.00	520,000.00
156	512255	FURNISH PRECAST PRESTRESSED CONCRETE BULB-TEE GIRDER (30 M-35 M)	EA	13	35,000.00	455,000.00	24,000.00	312,000.00
157	512500	ERECT PRECAST PRESTRESSED CONCRETE GIRDER	EA	39	5,000.00	195,000.00	2,200.00	85,800.00
158	519123	JOINT SEAL (TYPE B - MR 50 MM)	M	72	230.00	16,560.00	300.00	21,600.00
159 (F)	520102	BAR REINFORCING STEEL (BRIDGE)	KG	244,000	4.65	1,134,600.00	2.00	488,000.00
160 (F)	721810	SLOPE PAVING (CONCRETE)	M3	72	800.00	57,600.00	1,360.00	97,920.00
161 (F)	750505	BRIDGE DECK DRAINAGE SYSTEM	KG	470	20.00	9,400.00	22.50	10,575.00
162 (F)	833088	TUBULAR HANDRAILING	M	10	100.00	1,000.00	240.00	2,400.00
163 (F)	833142	CONCRETE BARRIER (TYPE 26 MODIFIED)	M	110	400.00	44,000.00	690.00	75,900.00
164	839727	CONCRETE BARRIER (TYPE 736 MODIFIED)	M	110	350.00	38,500.00	420.00	46,200.00
165 (F)	833020	CHAIN LINK RAILING [MINI MESH]	M	91	200.00	18,200.00	1,250.00	113,750.00
		BSAE BID TOTAL				25,465,100.00		16,510,737.00
		ITEMS 1 - 165						

ALTERNATE BID:

THE MISSION SPRINGS WATER DISTRICT								
166	0000003	ADJUST WATER VALVE COVER TO GRADE	EA	14	750.00	10,500.00	1,100.00	15,400.00
		ALTERNATE BID TOTAL				10,500.00		15,400.00
		ITEMS 166						
		PROJECT TOTAL				25,475,600.00		16,526,137.00
		ITEMS 1 - 166						

**Riverside County Transportation Department
Summary of Bids**

PROJECT: I-10/Indian Canyon Drive Interchange Improvements

Advertised: March 16, 2010 (Agenda Item: 3.64)
Bids Open: 2 pm Date: Wednesday, April 28, 2010

PROJECT NO. A8-0372; ESPLHPLU-5282(034); HP21-L-5282 (035)

**Security Paving Co., Inc.
Sun Valley, CA 91352**

**SEMA Const. Inc.
Lake Forest, CA 92630**

BASE BID ITEM NO.	ITEM CODE	CONTRACT ITEM	UNITS	QUANTITY	BID UNIT PRICE	BID ESTIMATE	BID UNIT PRICE	BID ESTIMATE
1	000003	ENDANGERED SPECIES PROTECTION	LS	1	4,320.00	4,320.00	4,000.00	4,000.00
2	000003	NONNATIVE PLANT PRECLUSION	LS	1	2,000.00	2,000.00	9,400.00	9,400.00
3	000003	CONSTRUCTION MONITORING CAMERA (POLE AND ELECTRIC SERVICE)	LS	1	8,100.00	8,100.00	16,100.00	16,100.00
4 (S,F)	000003	METAL SCRIPT LETTERS (RAILING METHOD)	LS	1	32,400.00	32,400.00	51,900.00	51,900.00
5	-----	ITEM DELETED BY ADDENDUM	-----	-----	-----	-----	-----	-----
6	070012	PROGRESS SCHEDULE (CRITICAL PATH METHOD)	LS	1	5,000.00	5,000.00	5,000.00	5,000.00
7	071325	TEMPORARY FENCE (TYPE ESA)	M	610	14.00	8,540.00	8.50	5,185.00
8	000003	TEMPORARY FENCE (TYPE WILDLIFE)	M	610	16.00	9,760.00	8.50	5,185.00
9	074016	CONSTRUCTION SITE MANAGEMENT	LS	1	15,000.00	15,000.00	43,800.00	43,800.00
10	074020	WATER POLLUTION CONTROL	LS	1	5,000.00	5,000.00	10,000.00	10,000.00
11	074018	HEALTH AND SAFETY PLAN	LS	1	1,000.00	1,000.00	5,500.00	5,500.00
12	074028	TEMPORARY FIBER ROLLS	M	10,800	8.40	90,720.00	7.00	75,600.00
13	074029	TEMPORARY SILT FENCE	M	960	7.35	7,056.00	6.00	5,760.00
14	074033	TEMPORARY CONSTRUCTION ENTRANCE	EA	3	3,000.00	9,000.00	1,000.00	3,000.00
15	074035	TEMPORARY CHECK DAM	M	52	6.00	312.00	46.00	2,392.00
16	074037	MOVE-IN/MOVE-OUT (TEMPORARY EROSION CONTROL)	EA	4	420.00	1,680.00	500.00	2,000.00
17	074038	TEMPORARY DRAINAGE INLET PROTECTION	EA	39	210.00	8,190.00	84.00	3,276.00
18	074039	TEMPORARY HYDRAULIC MULCH (POLYMER STABILIZED FIBER MATRIX)	M2	136,000	0.25	34,000.00	0.22	29,920.00
19	074041	STREET SWEEPING	LS	1	60,000.00	60,000.00	19,000.00	19,000.00
20	074042	TEMPORARY CONCRETE WASHOUT (PORTABLE)	LS	1	5,500.00	5,500.00	10,800.00	10,800.00
21	120090	CONSTRUCTION AREA SIGNS	LS	1	25,000.00	25,000.00	51,500.00	51,500.00
22	120100	TRAFFIC CONTROL SYSTEMS	LS	1	150,000.00	150,000.00	275,000.00	275,000.00
23	120120	TYPE III BARRICADE	EA	140	80.00	11,200.00	190.00	26,600.00
24	120143	TEMPORARY PAVEMENT DELINEATION	M	4,460	2.10	9,366.00	0.70	3,122.00
25	120149	TEMPORARY PAVEMENT MARKING (PAINT)	M2	100	27.00	2,700.00	35.00	3,500.00
26	120199	TRAFFIC PLASTIC DRUM	EA	590	105.00	61,950.00	82.00	48,380.00
27	128650	PORTABLE CHANGEABLE MESSAGE SIGN	EA	10	4,860.00	48,600.00	3,800.00	38,000.00
28	129000	TEMPORARY RAILING (TYPE K)	M	5,300	29.00	153,700.00	33.00	174,900.00
29	129110	TEMPORARY CRASH CUSHION [SAND FILLED]	EA	210	178.00	37,380.00	170.00	35,700.00
30	129110	TEMPORARY CRASH CUSHION [ABSORB 350]	EA	6	2,100.00	12,600.00	20,600.00	123,600.00
31	150701	REMOVE YELLOW TRAFFIC STRIPE [HAZARDOUS WASTE]	M	2,870	1.60	4,592.00	3.30	9,471.00
32	150608	REMOVE CHAIN LINK FENCE	M	610	14.00	8,540.00	17.00	10,370.00
33	150659	REMOVE TERMINAL SECTION	EA	3	160.00	480.00	700.00	2,100.00
34	150662	REMOVE METAL BEAM GUARD RAILING	M	660	28.00	18,480.00	27.00	17,820.00
35	150710	REMOVE TRAFFIC STRIPE	M	34,100	0.10	3,410.00	0.15	5,115.00
36	150713	REMOVE PAVEMENT MARKING	M2	52	16.00	832.00	20.00	1,040.00

**Riverside County Transportation Department
Summary of Bids**

PROJECT: I-10/Indian Canyon Drive Interchange Improvements

Advertised: March 16, 2010 (Agenda Item: 3.64)

Bids Open: 2 pm Date: Wednesday, April 28, 2010

PROJECT NO. A8-0372; ESPLHPLU-5282(034); HP21-L-5282 (035)

**Security Paving Co., Inc.
Sun Valley, CA 91352**

**SEMA Const. Inc.
Lake Forest, CA 92630**

ITEM NO.	ITEM CODE	CONTRACT ITEM	UNITS	QUANTITY	BID UNIT PRICE	BID ESTIMATE	BID UNIT PRICE	BID ESTIMATE
37	150722	REMOVE PAVEMENT MARKER	EA	8,520	0.55	4,686.00	0.70	5,964.00
38	150742	REMOVE ROADSIDE SIGN	EA	43	168.00	7,224.00	94.00	4,042.00
39	150760	REMOVE SIGN STRUCTURE	EA	2	3,000.00	6,000.00	1,900.00	3,800.00
40	150806	REMOVE CULVERT	M	360	40.00	14,400.00	60.00	21,600.00
41	150820	REMOVE INLET	EA	1	800.00	800.00	950.00	950.00
42	150821	REMOVE HEADWALL	EA	21	570.00	11,970.00	610.00	12,810.00
43	153153	COLD PLANE ASPHALT CONCRETE PAVEMENT (45 MM MAXIMUM)	M2	1,080	11.00	11,880.00	15.00	16,200.00
44	160101	CLEARING AND GRUBBING	LS	1	30,000.00	30,000.00	82,500.00	82,500.00
45	170101	DEVELOP WATER SUPPLY	LS	1	60,000.00	60,000.00	10,000.00	10,000.00
46 (F)	190101	ROADWAY EXCAVATION	M3	29,170	12.00	350,040.00	14.00	408,380.00
47	190110	LEAD COMPLIANCE PLAN (METRIC)	LS	1	7,000.00	7,000.00	5,000.00	5,000.00
48	190113	ASBESTOS COMPLIANCE PLAN	LS	1	8,000.00	8,000.00	31,900.00	31,900.00
49	193118	CONCRETE BACKFILL	M3	14	262.00	3,668.00	200.00	2,800.00
50	194001	DITCH EXCAVATION	M3	320	7.00	2,240.00	16.00	5,120.00
51	198001	IMPORTED BORROW	M3	71,000	12.00	852,000.00	7.00	497,000.00
52	203016	EROSION CONTROL (TYPE D)	M2	13,200	1.05	13,860.00	1.30	17,160.00
53	203021	FIBER ROLLS (METRIC)	M	10,500	9.50	99,750.00	7.00	73,500.00
54	203026	MOVE-IN/MOVE-OUT (EROSION CONTROL)	EA	1	525.00	525.00	500.00	500.00
55	208731	200 MM CORRUGATED HIGH DENSITY POLYETHYLENE PIPE CONDUIT	M	68	150.00	10,200.00	130.00	8,840.00
56	220101	FINISHING ROADWAY	LS	1	13,000.00	13,000.00	10,000.00	10,000.00
57	260201	CLASS 2 AGGREGATE BASE	M3	14,600	29.00	423,400.00	82.00	1,197,200.00
58	280000	LEAN CONCRETE BASE	M3	190	210.00	39,900.00	390.00	74,100.00
59	374002	ASPHALTIC EMULSION (FOG SEAL COAT)	TONN	6	1,200.00	7,200.00	1,500.00	9,000.00
60	390106	ASPHALT CONCRETE (OPEN GRADED)(OPEN GRADED FRICTION COURSE)	TONN	1,310	120.00	157,200.00	180.00	235,800.00
61	390130	HOT MIX ASPHALT (TYPE A)	TONN	320	97.00	31,040.00	190.00	60,800.00
62	000003	HOT MIX ASPHALT (TYPE A BOND BREAKER)	TONN	120	175.00	21,000.00	250.00	30,000.00
63	000003	HOT MIX ASPHALT (TYPE C)	TONN	31,200	103.00	3,213,600.00	110.00	3,432,000.00
64	394071	PLACE HOT MIX ASPHALT DIKE	M	4,570	6.00	27,420.00	1.60	7,312.00
65	394090	PLACE HOT MIX ASPHALT (MISCELLANEOUS AREA)	M2	320	26.00	8,320.00	52.00	16,640.00
66	397005	TACK COAT	TONN	38	640.00	24,320.00	520.00	19,760.00
67	401066	CONCRETE PAVEMENT (EXIT RAMP TERMINI) [JOINTED PLAIN CONCRETE PAVEMENT]	M3	430	300.00	129,000.00	360.00	154,800.00
68	401108	RAPID STRENGTH CONCRETE [JOINTED PLAIN CONCRETE PAVEMENT]	M3	3,780	565.00	2,135,700.00	380.00	1,436,400.00
69	000003	SEAL ISOLATION JOINT	M	1,280	37.00	47,360.00	22.00	28,160.00
70	414091	SEAL LONGITUDINAL JOINT	M	2,140	18.00	38,520.00	6.50	13,910.00
71	414101	SEAL TRANSVERSE JOINT	M	2,120	18.00	38,160.00	6.50	13,780.00

**Riverside County Transportation Department
Summary of Bids**

PROJECT: I-10/Indian Canyon Drive Interchange Improvements

Advertised: March 16, 2010 (Agenda Item: 3.64)
Bids Open: 2 pm Date: Wednesday, April 28, 2010

PROJECT NO. A8-0372; ESPLHPLU-5282(034); HP21-L-5282 (035)

**Security Paving Co., Inc.
Sun Valley, CA 91352**

**SEMA Const. Inc.
Lake Forest, CA 92630**

ITEM NO.	ITEM CODE	CONTRACT ITEM	UNITS	QUANTITY	BID UNIT PRICE	BID ESTIMATE	BID UNIT PRICE	BID ESTIMATE
72	518201	MASONRY STONE WALL	M2	23	340.00	7,820.00	260.00	5,980.00
73 (F)	510129	CLASS 2 CONCRETE (BOX CULVERT)	M3	190	485.00	92,150.00	750.00	142,500.00
74 (F)	510502	MINOR CONCRETE (MINOR STRUCTURE)	M3	110	1,800.00	198,000.00	1,300.00	143,000.00
75 (F)	520107	BAR REINFORCING STEEL (BOX CULVERT)	KG	21,271	2.00	42,542.00	1.20	25,525.20
76 (F)	560218	FURNISH SIGN STRUCTURE (TRUSS)	KG	30,000	5.60	168,000.00	6.23	186,900.00
77 (F)	560219	INSTALL SIGN STRUCTURE (TRUSS)	KG	30,000	0.45	13,500.00	0.30	9,000.00
78	560234	FURNISH LAMINATED PANEL SIGN (25.4 MM -TYPE A)	M2	67	147.00	9,849.00	220.00	14,740.00
79	560238	FURNISH SINGLE SHEET ALUMINUM SIGN (1.6 MM- UNFRAMED)	M2	56	90.00	5,040.00	100.00	5,600.00
80	560239	FURNISH SINGLE SHEET ALUMINUM SIGN (2.0 MM- UNFRAMED)	M2	30	96.00	2,880.00	110.00	3,300.00
81	560241	FURNISH SINGLE SHEET ALUMINUM SIGN (1.6 MM- FRAMED)	M2	13	115.00	1,495.00	200.00	2,600.00
82	560242	FURNISH SINGLE SHEET ALUMINUM SIGN (2.0 MM- FRAMED)	M2	71	122.00	8,662.00	140.00	9,940.00
83	561015	1524 MM CAST-IN-DRILLED-HOLE CONCRETE PILE (SIGN FOUNDATION)	M	23	2,010.00	46,230.00	3,800.00	87,400.00
84	566011	ROADSIDE SIGN - ONE POST	EA	85	300.00	25,500.00	240.00	20,400.00
85	566012	ROADSIDE SIGN - TWO POST	EA	17	420.00	7,140.00	550.00	9,350.00
86	568001	INSTALL SIGN (STRAP AND SADDLE BRACKET METHOD)	EA	8	240.00	1,920.00	110.00	880.00
87	568015	INSTALL SIGN (MAST-ARM HANGER METHOD)	EA	22	790.00	17,380.00	460.00	10,120.00
88	620909	450 MM ALTERNATIVE PIPE CULVERT	M	71	193.00	13,703.00	170.00	12,070.00
89	620913	600 MM ALTERNATIVE PIPE CULVERT	M	230	166.00	38,180.00	210.00	48,300.00
90	620924	900 MM ALTERNATIVE PIPE CULVERT	M	120	229.00	27,480.00	240.00	28,800.00
91	664097	600 MM BITUMINOUS COATED CORRUGATED STEEL PIPE (2.77 MM THICK)	M	200	200.00	40,000.00	200.00	40,000.00
92	664110	900 MM BITUMINOUS COATED CORRUGATED STEEL PIPE (2.77 MM THICK)	M	50	300.00	15,000.00	250.00	12,500.00
93	717072	100 MM POLYVINYL CHLORIDE SEWER PIPE	M	37	40.00	1,480.00	71.00	2,627.00
94	721008	ROCK SLOPE PROTECTION (LIGHT, METHOD B)	M3	140	175.00	24,500.00	140.00	19,600.00
95	721430	CONCRETE (CHANNEL LINING)	M3	73	300.00	21,900.00	310.00	22,630.00
96	729010	ROCK SLOPE PROTECTION FABRIC	M2	330	3.00	990.00	10.00	3,300.00
97 (F)	731504	MINOR CONCRETE (CURB AND GUTTER)	M3	250	605.00	151,250.00	640.00	160,000.00
98 (F)	000003	MINOR CONCRETE (COLORED)	M2	1,890	120.00	226,800.00	58.00	109,620.00
99 (F)	731521	MINOR CONCRETE (SIDEWALK)	M3	260	530.00	137,800.00	430.00	111,800.00
100 (F)	731530	MINOR CONCRETE (TEXTURED PAVING)	M2	1,190	140.00	166,600.00	97.00	115,430.00
101 (F)	750001	MISCELLANEOUS IRON AND STEEL	KG	1,262	5.00	6,310.00	4.00	5,048.00
102	800391	CHAIN LINK FENCE (TYPE CL-1.8)	M	940	40.00	37,600.00	50.00	47,000.00
103	820105	DELINEATOR (SPECIAL)	EA	23	42.00	966.00	31.00	713.00
104	820107	DELINEATOR (CLASS 1)	EA	160	37.00	5,920.00	36.00	5,760.00
105	832003	METAL BEAM GUARD RAILING (WOOD POST)	M	670	64.00	42,880.00	84.00	56,280.00
106	839541	TRANSITION RAILING (TYPE WB)	EA	4	3,150.00	12,600.00	2,800.00	11,200.00

**Riverside County Transportation Department
Summary of Bids**

PROJECT: I-10/Indian Canyon Drive Interchange Improvements

Advertised: March 16, 2010 (Agenda Item: 3.64)
Bids Open: 2 pm Date: Wednesday, April 28, 2010

PROJECT NO. A8-0372; ESPLHPLU-5282(034) & HP21L-5282 (035)

**Security Paving Co., Inc.
Sun Valley, CA 91352**

**SEMA Const. Inc.
Lake Forest, CA 92630**

ITEM NO.	ITEM CODE	CONTRACT ITEM	UNITS	QUANTITY	BID UNIT PRICE	BID ESTIMATE	BID UNIT PRICE	BID ESTIMATE
107	839568	TERMINAL ANCHOR ASSEMBLY (TYPE SFT)	EA	5	735.00	3,675.00	1,000.00	5,000.00
108	839585	ALTERNATIVE FLARED TERMINAL SYSTEM [TYPE SRT]	EA	9	2,310.00	20,790.00	2,300.00	20,700.00
109	839605	CRASH CUSHION (REACT 9SCBS)	EA	3	61,000.00	183,000.00	51,100.00	153,300.00
110	839703	CONCRETE BARRIER (TYPE 60C)	M	270	200.00	54,000.00	210.00	56,700.00
111	839705	CONCRETE BARRIER (TYPE 60E)	M	89	256.00	22,784.00	420.00	37,380.00
112	840515	THERMOPLASTIC PAVEMENT MARKING	M2	360	37.00	13,320.00	22.00	7,920.00
113	840563	200 MM THERMOPLASTIC TRAFFIC STRIPE	M	1,210	3.10	3,751.00	5.00	6,050.00
114	840571	100 MM THERMOPLASTIC TRAFFIC STRIPE (BROKEN 5.18 M - 2.14 M)	M	9,600	1.45	13,920.00	1.10	10,560.00
115	840656	PAINT TRAFFIC STRIPE (2-COAT)	M	13,100	1.20	15,720.00	0.25	3,275.00
116	850101	PAVEMENT MARKER (NON-REFLECTIVE)	EA	15,300	1.30	19,890.00	1.40	21,420.00
117	850110	PAVEMENT MARKER (RETROREFLECTIVE-SPECIAL TYPE C)	EA	86	5.00	430.00	6.50	559.00
118	850111	PAVEMENT MARKER (RETROREFLECTIVE-SPECIAL TYPE D)	EA	790	5.00	3,950.00	6.50	5,135.00
119	850112	PAVEMENT MARKER (RETROREFLECTIVE-SPECIAL TYPE G)	EA	2,790	5.00	13,950.00	2.90	8,091.00
120	850113	PAVEMENT MARKER (RETROREFLECTIVE-SPECIAL TYPE H)	EA	450	5.00	2,250.00	6.50	2,925.00
121	860251	SIGNAL AND LIGHTING (LOCATION 1)	LS	1	119,700.00	119,700.00	112,100.00	112,100.00
122	860252	SIGNAL AND LIGHTING (LOCATION 2)	LS	1	101,850.00	101,850.00	106,900.00	106,900.00
123	860300	SIGNAL AND LIGHTING (CITY STREET LOCATION 1)	LS	1	185,850.00	185,850.00	190,000.00	190,000.00
124	860302	SIGNAL AND LIGHTING (CITY STREET LOCATION 2)	LS	1	190,050.00	190,050.00	185,000.00	185,000.00
125	860460	LIGHTING AND SIGN ILLUMINATION	LS	1	231,000.00	231,000.00	241,100.00	241,100.00
126	860701	INTERCONNECTION CONDUIT AND CONDUCTOR	LS	1	56,805.00	56,805.00	86,000.00	86,000.00
127	861101	RAMP METERING SYSTEM (LOCATION 1)	LS	1	55,650.00	55,650.00	53,700.00	53,700.00
128	861102	RAMP METERING SYSTEM (LOCATION 2)	LS	1	72,345.00	72,345.00	64,500.00	64,500.00
129	861103	RAMP METERING SYSTEM (LOCATION 3)	LS	1	56,595.00	56,595.00	43,000.00	43,000.00
130	861104	RAMP METERING SYSTEM (LOCATION 4)	LS	1	58,800.00	58,800.00	59,100.00	59,100.00
131	861349	REMOVE EXISTING SIGNAL SYSTEM (LOCATION 1)	LS	1	8,190.00	8,190.00	8,500.00	8,500.00
132	861350	REMOVE EXISTING SIGNAL SYSTEM (LOCATION 2)	LS	1	9,450.00	9,450.00	9,800.00	9,800.00
133	999990	MOBILIZATION	LS	1	815,534.00	815,534.00	1,250,000.00	1,250,000.00
134	000003	COURSE OF CONSTRUCTION INSURANCE	LS	1	115,000.00	115,000.00	241,700.00	241,700.00
135	019901	DEMOBILIZATION	LS	1	26,000.00	26,000.00	25,000.00	25,000.00
136	066102	DUST ABATEMENT	LS	1	31,000.00	31,000.00	89,700.00	89,700.00
137	066105	RESIDENT ENGINEER OFFICE	LS	1	65,000.00	65,000.00	56,700.00	56,700.00
138	066840	TRAFFIC SIGNAL CONTROLLER ASSEMBLY [WITH BATTERY BACK-UP][2-LOCATIONS]	LS	1	13,600.00	13,600.00	13,600.00	13,600.00
139	066843	MODEL 170 CONTROLLER ASSEMBLY [RAMP METER] [4-LOCATIONS]	LS	1	19,200.00	19,200.00	19,200.00	19,200.00
140	066015	FEDERAL TRAINEE PROGRAM	LS	1	8,000.00	8,000.00	23,000.00	23,000.00
141	047403	610 MM STEEL PIPE CASING	M	26	400.00	10,400.00	870.00	22,620.00

**Riverside County Transportation Department
Summary of Bids**

PROJECT: I-10/Indian Canyon Drive Interchange Improvements

Advertised: March 16, 2010 (Agenda Item: 3.64)
Bids Open: 2 pm Date: Wednesday, April 28, 2010

PROJECT NO. A8-0372; ESPLHPLU-5282(034); HP21-L-5282 (035)

**Security Paving Co., Inc.
Sun Valley, CA 91352**

**SEMA Const. Inc.
Lake Forest, CA 92630**

BASE BID (CONTINUED)		CONTRACT ITEM	UNITS	QUANTITY	BID UNIT PRICE	BID ESTIMATE	BID UNIT PRICE	BID ESTIMATE
142	157550	BRIDGE REMOVAL	LS	1	90,000.00	90,000.00	85,800.00	85,800.00
143 (F)	192003	STRUCTURE EXCAVATION (BRIDGE)	M3	1,150	80.00	92,000.00	110.00	126,500.00
144 (F)	193003	STRUCTURE BACKFILL (BRIDGE)	M3	490	85.00	41,650.00	190.00	93,100.00
145	490566	FURNISH STEEL PILING (HP 360 X 132)	M	2,977	137.00	407,849.00	140.00	416,780.00
146	490567	DRIVE STEEL PILE (HP 360 X 132)	EA	196	1,323.00	259,308.00	130.00	25,480.00
147	*****	ITEM DELETED BY ADDENDUM	*****	*****	*****	*****	*****	*****
148	*****	ITEM DELETED BY ADDENDUM	*****	*****	*****	*****	*****	*****
149	500020	PRESTRESSING PRECAST GIRDER	LS	1	98,000.00	98,000.00	90,700.00	90,700.00
150 (F)	510051	STRUCTURAL CONCRETE, BRIDGE FOOTING	M3	220	500.00	110,000.00	340.00	74,800.00
151 (F)	510053	STRUCTURAL CONCRETE, BRIDGE	M3	1,710	715.00	1,222,650.00	578.00	988,380.00
152 (F)	510086	STRUCTURAL CONCRETE, APPROACH SLAB (TYPE N)	M3	210	620.00	130,200.00	400.00	84,000.00
153	511036	ARCHITECTURAL SURFACE [LAVA ROCK FACING]	M2	170	245.00	41,650.00	470.00	79,900.00
154 (F)	511063	FRACTURED FIN TEXTURE	M2	140	248.00	34,720.00	300.00	42,000.00
155	512254	FURNISH PRECAST PRESTRESSED CONCRETE BULB-TEE GIRDER (25 M-30 M)	EA	26	18,700.00	486,200.00	18,600.00	483,600.00
156	512255	FURNISH PRECAST PRESTRESSED CONCRETE BULB-TEE GIRDER (30 M-35 M)	EA	13	18,700.00	243,100.00	18,600.00	241,800.00
157	512500	ERECT PRECAST PRESTRESSED CONCRETE GIRDER	EA	39	2,072.00	80,808.00	1,800.00	70,200.00
158	519123	JOINT SEAL (TYPE B - MR 50 MM)	M	72	273.00	19,656.00	82.00	5,904.00
159 (F)	520102	BAR REINFORCING STEEL (BRIDGE)	KG	244,000	1.75	427,000.00	1.74	424,560.00
160 (F)	721810	SLOPE PAVING (CONCRETE)	M3	72	457.00	32,904.00	590.00	42,480.00
161 (F)	750505	BRIDGE DECK DRAINAGE SYSTEM	KG	470	22.00	10,340.00	12.00	5,640.00
162 (F)	833088	TUBULAR HANDRAILING	M	10	210.00	2,100.00	200.00	2,000.00
163 (F)	833142	CONCRETE BARRIER (TYPE 26 MODIFIED)	M	110	416.00	45,760.00	130.00	14,300.00
164	839727	CONCRETE BARRIER (TYPE 736 MODIFIED)	M	110	335.00	36,850.00	100.00	11,000.00
165 (F)	833020	CHAIN LINK RAILING [MINI MESH]	M	91	1,450.00	131,950.00	1,100.00	100,100.00
BSAE BID TOTAL						16,992,002.00		17,320,936.20
ITEMS 1 - 165								

ALTERNATE BID:

THE MISSION SPRINGS WATER DISTRICT		CONTRACT ITEM	UNITS	QUANTITY	BID UNIT PRICE	BID ESTIMATE	BID UNIT PRICE	BID ESTIMATE
166	0000003	ADJUST WATER VALVE COVER TO GRADE	EA	14	365.00	5,110.00	950.00	13,300.00
ALTERNATE BID TOTAL						5,110.00		13,300.00
ITEMS 166								

PROJECT TOTAL		BID ESTIMATE	BID ESTIMATE
ITEMS 1 - 166		16,997,112.00	17,334,236.20

**Riverside County Transportation Department
Summary of Bids**

PROJECT: I-10/Indian Canyon Drive Interchange Improvements

Advertised: March 16, 2010 (Agenda Item: 3.64)

Bids Open: 2 pm Date: Wednesday, April 28, 2010

PROJECT NO. A8-0372; ESPLHPLU-5282(034); HP21-L-5282 (035)

Riverside Construction Co.

**Skanska USA Civil West
Riverside, CA 92509**

BASE BID ITEM NO.	ITEM CODE	CONTRACT ITEM	UNITS	QUANTITY	BID UNIT PRICE	BID ESTIMATE	BID UNIT PRICE	BID ESTIMATE
1	000003	ENDANGERED SPECIES PROTECTION	LS	1	15,000.00	15,000.00	3,000.00	3,000.00
2	000003	NONNATIVE PLANT PRECLUSION	LS	1	5,600.00	5,600.00	1,000.00	1,000.00
3	000003	CONSTRUCTION MONITORING CAMERA (POLE AND ELECTRIC SERVICE)	LS	1	25,000.00	25,000.00	7,500.00	7,500.00
4 (S,F)	000003	METAL SCRIPT LETTERS (RAILING METHOD)	LS	1	15,000.00	15,000.00	26,000.00	26,000.00
5	-----	ITEM DELETED BY ADDENDUM	-----	-----	-----	-----	-----	-----
6	070012	PROGRESS SCHEDULE (CRITICAL PATH METHOD)	LS	1	5,000.00	5,000.00	1,700.00	1,700.00
7	071325	TEMPORARY FENCE (TYPE ESA)	M	610	15.00	9,150.00	6.50	3,965.00
8	000003	TEMPORARY FENCE (TYPE WILDLIFE)	M	610	20.00	12,200.00	28.50	17,385.00
9	074016	CONSTRUCTION SITE MANAGEMENT	LS	1	25,000.00	25,000.00	20,000.00	20,000.00
10	074020	WATER POLLUTION CONTROL	LS	1	7,500.00	7,500.00	3,500.00	3,500.00
11	074018	HEALTH AND SAFETY PLAN	LS	1	2,500.00	2,500.00	2,500.00	2,500.00
12	074028	TEMPORARY FIBER ROLLS	M	10,800	7.00	75,600.00	5.35	57,780.00
13	074029	TEMPORARY SILT FENCE	M	960	10.00	9,600.00	5.50	5,280.00
14	074033	TEMPORARY CONSTRUCTION ENTRANCE	EA	3	5,000.00	15,000.00	4,000.00	12,000.00
15	074035	TEMPORARY CHECK DAM	M	52	10.00	520.00	18.50	962.00
16	074037	MOVE-IN/MOVE-OUT (TEMPORARY EROSION CONTROL)	EA	4	500.00	2,000.00	500.00	2,000.00
17	074038	TEMPORARY DRAINAGE INLET PROTECTION	EA	39	200.00	7,800.00	116.00	4,524.00
18	074039	TEMPORARY HYDRAULIC MULCH (POLYMER STABILIZED FIBER MATRIX)	M2	136,000	0.30	40,800.00	0.60	81,600.00
19	074041	STREET SWEEPING	LS	1	50,000.00	50,000.00	86,000.00	86,000.00
20	074042	TEMPORARY CONCRETE WASHOUT (PORTABLE)	LS	1	15,000.00	15,000.00	10,000.00	10,000.00
21	120090	CONSTRUCTION AREA SIGNS	LS	1	35,000.00	35,000.00	42,500.00	42,500.00
22	120100	TRAFFIC CONTROL SYSTEMS	LS	1	200,000.00	200,000.00	135,000.00	135,000.00
23	120120	TYPE III BARRICADE	EA	140	75.00	10,500.00	50.00	7,000.00
24	120143	TEMPORARY PAVEMENT DELINEATION	M	4,460	2.00	8,920.00	4.00	17,840.00
25	120149	TEMPORARY PAVEMENT MARKING (PAINT)	M2	100	25.00	2,500.00	35.00	3,500.00
26	120199	TRAFFIC PLASTIC DRUM	EA	590	75.00	44,250.00	43.00	25,370.00
27	128650	PORTABLE CHANGEABLE MESSAGE SIGN	EA	10	3,500.00	35,000.00	7,600.00	76,000.00
28	129000	TEMPORARY RAILING (TYPE K)	M	5,300	30.00	159,000.00	31.00	164,300.00
29	129110	TEMPORARY CRASH CUSHION [SAND FILLED]	EA	210	200.00	42,000.00	218.00	45,780.00
30	129110	TEMPORARY CRASH CUSHION [ABSORB 350]	EA	6	8,500.00	51,000.00	5,100.00	30,600.00
31	150701	REMOVE YELLOW TRAFFIC STRIPE [HAZARDOUS WASTE]	M	2,870	2.00	5,740.00	2.00	5,740.00
32	150608	REMOVE CHAIN LINK FENCE	M	610	15.00	9,150.00	16.00	9,760.00
33	150659	REMOVE TERMINAL SECTION	EA	3	350.00	1,050.00	250.00	750.00
34	150662	REMOVE METAL BEAM GUARD RAILING	M	660	25.00	16,500.00	26.00	17,160.00
35	150710	REMOVE TRAFFIC STRIPE	M	34,100	0.10	3,410.00	2.00	68,200.00
36	150713	REMOVE PAVEMENT MARKING	M2	52	15.00	780.00	2.00	104.00

Riverside County Transportation Department Summary of Bids

PROJECT: I-10/Indian Canyon Drive Interchange Improvements

Advertised: March 16, 2010 (Agenda Item: 3.64)
Bids Open: 2 pm Date: Wednesday, April 28, 2010

PROJECT NO. A8-0372; ESPLHPLU-5282(034); HP21-L-5282 (035)

Riverside Construction Co.
Riverside, CA 92502

Skanska USA Civil West
Riverside, CA 92509

ITEM NO.	ITEM CODE	CONTRACT ITEM	UNITS	QUANTITY	BID UNIT PRICE	BID ESTIMATE	BID UNIT PRICE	BID ESTIMATE
37	150722	REMOVE PAVEMENT MARKER	EA	8,520	0.50	4,260.00	0.50	4,260.00
38	150742	REMOVE ROADSIDE SIGN	EA	43	100.00	4,300.00	46.00	1,978.00
39	150760	REMOVE SIGN STRUCTURE	EA	2	3,000.00	6,000.00	1,800.00	3,600.00
40	150806	REMOVE CULVERT	M	360	50.00	18,000.00	62.50	22,500.00
41	150820	REMOVE INLET	EA	1	550.00	550.00	2,575.00	2,575.00
42	150821	REMOVE HEADWALL	EA	21	500.00	10,500.00	575.00	12,075.00
43	153153	COLD PLANE ASPHALT CONCRETE PAVEMENT (45 MM MAXIMUM)	M2	1,080	6.00	6,480.00	3.00	3,240.00
44	160101	CLEARING AND GRUBBING	LS	1	82,500.00	82,500.00	25,000.00	25,000.00
45	170101	DEVELOP WATER SUPPLY	LS	1	10,000.00	10,000.00	22,500.00	22,500.00
46 (F)	190101	ROADWAY EXCAVATION	M3	29,170	25.00	729,250.00	38.00	1,108,460.00
47	190110	LEAD COMPLIANCE PLAN (METRIC)	LS	1	5,000.00	5,000.00	2,500.00	2,500.00
48	190113	ASBESTOS COMPLIANCE PLAN	LS	1	2,500.00	2,500.00	2,500.00	2,500.00
49	193118	CONCRETE BACKFILL	M3	14	200.00	2,800.00	1,310.00	18,340.00
50	194001	DITCH EXCAVATION	M3	320	25.00	8,000.00	10.50	3,360.00
51	198001	IMPORTED BORROW	M3	71,000	8.50	603,500.00	1.00	71,000.00
52	203016	EROSION CONTROL (TYPE D)	M2	13,200	1.75	23,100.00	1.38	18,216.00
53	203021	FIBER ROLLS (METRIC)	M	10,500	8.00	84,000.00	5.50	57,750.00
54	203026	MOVE-IN/MOVE-OUT (EROSION CONTROL)	EA	1	500.00	500.00	200.00	200.00
55	208731	200 MM CORRUGATED HIGH DENSITY POLYETHYLENE PIPE CONDUIT	M	68	200.00	13,600.00	94.00	6,392.00
56	220101	FINISHING ROADWAY	LS	1	50,000.00	50,000.00	6,500.00	6,500.00
57	260201	CLASS 2 AGGREGATE BASE	M3	14,600	55.00	803,000.00	23.50	343,100.00
58	280000	LEAN CONCRETE BASE	M3	190	200.00	38,000.00	200.00	38,000.00
59	374002	ASPHALTIC EMULSION (FOG SEAL COAT)	TONN	6	1,400.00	8,400.00	665.00	3,990.00
60	390106	ASPHALT CONCRETE (OPEN GRADED)(OPEN GRADED FRICTION COURSE)	TONN	1,310	132.00	172,920.00	95.00	124,450.00
61	390130	HOT MIX ASPHALT (TYPE A)	TONN	320	175.00	56,000.00	95.00	30,400.00
62	000003	HOT MIX ASPHALT (TYPE A BOND BREAKER)	TONN	120	270.00	32,400.00	217.00	26,040.00
63	000003	HOT MIX ASPHALT (TYPE C)	TONN	31,200	112.00	3,494,400.00	82.00	2,558,400.00
64	394071	PLACE HOT MIX ASPHALT DIKE	M	4,570	7.50	34,275.00	6.40	29,248.00
65	394090	PLACE HOT MIX ASPHALT (MISCELLANEOUS AREA)	M2	320	50.00	16,000.00	50.00	16,000.00
66	397005	TACK COAT	TONN	38	500.00	19,000.00	590.00	22,420.00
67	401066	CONCRETE PAVEMENT (EXIT RAMP TERMINI) [JOINTED PLAIN CONCRETE PAVEMENT]	M3	430	250.00	107,500.00	350.00	150,500.00
68	401108	RAPID STRENGTH CONCRETE [JOINTED PLAIN CONCRETE PAVEMENT]	M3	3,780	350.00	1,323,000.00	555.00	2,097,900.00
69	000003	SEAL ISOLATION JOINT	M	1,280	20.00	25,600.00	21.40	27,392.00
70	414091	SEAL LONGITUDINAL JOINT	M	2,140	7.00	14,980.00	6.30	13,482.00
71	414101	SEAL TRANSVERSE JOINT	M	2,120	7.00	14,840.00	6.30	13,356.00

Riverside County Transportation Department Summary of Bids

PROJECT: I-10/Indian Canyon Drive Interchange Improvements

Advertised: March 16, 2010 (Agenda Item: 3.64)

Bids Open: 2 pm Date: Wednesday, April 28, 2010

PROJECT NO. A8-0372; ESPLHPLU-5282(034); HP21-L-5282 (035)

Riverside Construction Co.
Riverside, CA 92502

Skanska USA Civil West
Riverside, CA 92509

BASE BID (CONTINUED)		CONTRACT ITEM	UNITS	QUANTITY	BID UNIT PRICE	BID ESTIMATE	BID UNIT PRICE	BID ESTIMATE
72	518201	MASONRY STONE WALL	M2	23	375.00	8,625.00	1,500.00	34,500.00
73 (F)	510129	CLASS 2 CONCRETE (BOX CULVERT)	M3	190	575.00	109,250.00	1,050.00	199,500.00
74 (F)	510502	MINOR CONCRETE (MINOR STRUCTURE)	M3	110	1,250.00	137,500.00	1,200.00	132,000.00
75 (F)	520107	BAR REINFORCING STEEL (BOX CULVERT)	KG	21,271	1.50	31,906.50	2.00	42,542.00
76 (F)	560218	FURNISH SIGN STRUCTURE (TRUSS)	KG	30,000	6.00	180,000.00	7.00	210,000.00
77 (F)	560219	INSTALL SIGN STRUCTURE (TRUSS)	KG	30,000	0.30	9,000.00	0.30	9,000.00
78	560234	FURNISH LAMINATED PANEL SIGN (25.4 MM -TYPE A)	M2	67	150.00	10,050.00	217.00	14,539.00
79	560238	FURNISH SINGLE SHEET ALUMINUM SIGN (1.6 MM- UNFRAMED)	M2	56	130.00	7,280.00	95.00	5,320.00
80	560239	FURNISH SINGLE SHEET ALUMINUM SIGN (2.0 MM- UNFRAMED)	M2	30	165.00	4,950.00	105.00	3,150.00
81	560241	FURNISH SINGLE SHEET ALUMINUM SIGN (1.6 MM- FRAMED)	M2	13	150.00	1,950.00	120.00	1,560.00
82	560242	FURNISH SINGLE SHEET ALUMINUM SIGN (2.0 MM- FRAMED)	M2	71	200.00	14,200.00	140.00	9,940.00
83	561015	1524 MM CAST-IN-DRILLED-HOLE CONCRETE PILE (SIGN FOUNDATION)	M	23	3,500.00	80,500.00	3,500.00	80,500.00
84	566011	ROADSIDE SIGN - ONE POST	EA	85	200.00	17,000.00	250.00	21,250.00
85	566012	ROADSIDE SIGN - TWO POST	EA	17	500.00	8,500.00	250.00	4,250.00
86	568001	INSTALL SIGN (STRAP AND SADDLE BRACKET METHOD)	EA	8	150.00	1,200.00	200.00	1,600.00
87	568015	INSTALL SIGN (MAST-ARM HANGER METHOD)	EA	22	350.00	7,700.00	250.00	5,500.00
88	620909	450 MM ALTERNATIVE PIPE CULVERT	M	71	200.00	14,200.00	240.00	17,040.00
89	620913	600 MM ALTERNATIVE PIPE CULVERT	M	230	235.00	54,050.00	205.00	47,150.00
90	620924	900 MM ALTERNATIVE PIPE CULVERT	M	120	240.00	28,800.00	275.00	33,000.00
91	664097	600 MM BITUMINOUS COATED CORRUGATED STEEL PIPE (2.77 MM THICK)	M	200	265.00	53,000.00	302.00	60,400.00
92	664110	900 MM BITUMINOUS COATED CORRUGATED STEEL PIPE (2.77 MM THICK)	M	50	320.00	16,000.00	505.00	25,250.00
93	717072	100 MM POLYVINYL CHLORIDE SEWER PIPE	M	37	20.00	740.00	101.00	3,737.00
94	721008	ROCK SLOPE PROTECTION (LIGHT, METHOD B)	M3	140	175.00	24,500.00	145.00	20,300.00
95	721430	CONCRETE (CHANNEL LINING)	M3	73	425.00	31,025.00	265.00	19,345.00
96	729010	ROCK SLOPE PROTECTION FABRIC	M2	330	3.50	1,155.00	9.50	3,135.00
97 (F)	731504	MINOR CONCRETE (CURB AND GUTTER)	M3	250	380.00	95,000.00	255.00	63,750.00
98 (F)	000003	MINOR CONCRETE (COLORED)	M2	1,890	65.00	122,850.00	95.00	179,550.00
99 (F)	731521	MINOR CONCRETE (SIDEWALK)	M3	260	380.00	98,800.00	205.00	53,300.00
100 (F)	731530	MINOR CONCRETE (TEXTURED PAVING)	M2	1,190	100.00	119,000.00	160.00	190,400.00
101 (F)	750001	MISCELLANEOUS IRON AND STEEL	KG	1,262	6.50	8,203.00	4.00	5,048.00
102	800391	CHAIN LINK FENCE (TYPE CL-1.8)	M	940	40.00	37,600.00	48.00	45,120.00
103	820105	DELINEATOR (SPECIAL)	EA	23	30.00	690.00	75.00	1,725.00
104	820107	DELINEATOR (CLASS 1)	EA	160	40.00	6,400.00	75.00	12,000.00
105	832003	METAL BEAM GUARD RAILING (WOOD POST)	M	670	60.00	40,200.00	80.00	53,600.00
106	839541	TRANSITION RAILING (TYPE WB)	EA	4	3,500.00	14,000.00	2,650.00	10,600.00

**Riverside County Transportation Department
Summary of Bids**

PROJECT: I-10/Indian Canyon Drive Interchange Improvements

Advised: March 16, 2010 (Agenda Item: 3.64)

Bids Open: 2 pm Date: Wednesday, April 28, 2010

PROJECT NO. A8-0372; ESPLHPLU-5282(034) & HP21L-5282 (035)

BASE BID (CONTINUED)		Riverside Construction Co. Riverside, CA 92502		Skanska USA Civil West Riverside, CA 92509				
ITEM NO.	ITEM CODE	CONTRACT ITEM	UNITS	QUANTITY	BID UNIT PRICE	BID ESTIMATE	BID UNIT PRICE	BID ESTIMATE
107	839568	TERMINAL ANCHOR ASSEMBLY (TYPE SFT)	EA	5	750.00	3,750.00	680.00	3,400.00
108	839585	ALTERNATIVE FLARED TERMINAL SYSTEM [TYPE SRT]	EA	9	2,500.00	22,500.00	2,150.00	19,350.00
109	839605	CRASH CUSHION (REACT 9SCBS)	EA	3	50,000.00	150,000.00	48,600.00	145,800.00
110	839703	CONCRETE BARRIER (TYPE 60C)	M	270	425.00	114,750.00	300.00	81,000.00
111	839705	CONCRETE BARRIER (TYPE 60E)	M	89	550.00	48,950.00	400.00	35,600.00
112	840515	THERMOPLASTIC PAVEMENT MARKING	M2	360	35.00	12,600.00	35.00	12,600.00
113	840563	200 MM THERMOPLASTIC TRAFFIC STRIPE	M	1,210	3.00	3,630.00	3.00	3,630.00
114	840571	100 MM THERMOPLASTIC TRAFFIC STRIPE (BROKEN 5.18 M - 2.14 M)	M	9,600	1.50	14,400.00	1.40	13,440.00
115	840656	PAINT TRAFFIC STRIPE (2-COAT)	M	13,100	1.20	15,720.00	1.15	15,065.00
116	850101	PAVEMENT MARKER (NON-REFLECTIVE)	EA	15,300	1.50	22,950.00	1.25	19,125.00
117	850110	PAVEMENT MARKER (RETROREFLECTIVE-SPECIAL TYPE C)	EA	86	5.00	430.00	5.00	430.00
118	850111	PAVEMENT MARKER (RETROREFLECTIVE-SPECIAL TYPE D)	EA	790	5.00	3,950.00	5.00	3,950.00
119	850112	PAVEMENT MARKER (RETROREFLECTIVE-SPECIAL TYPE G)	EA	2,790	5.00	13,950.00	5.00	13,950.00
120	850113	PAVEMENT MARKER (RETROREFLECTIVE-SPECIAL TYPE H)	EA	450	5.00	2,250.00	5.00	2,250.00
121	860251	SIGNAL AND LIGHTING (LOCATION 1)	LS	1	100,000.00	100,000.00	114,000.00	114,000.00
122	860252	SIGNAL AND LIGHTING (LOCATION 2)	LS	1	95,000.00	95,000.00	97,000.00	97,000.00
123	860300	SIGNAL AND LIGHTING (CITY STREET LOCATION 1)	LS	1	160,000.00	160,000.00	177,000.00	177,000.00
124	860302	SIGNAL AND LIGHTING (CITY STREET LOCATION 2)	LS	1	175,000.00	175,000.00	181,000.00	181,000.00
125	860460	LIGHTING AND SIGN ILLUMINATION	LS	1	250,000.00	250,000.00	230,000.00	230,000.00
126	860701	INTERCONNECTION CONDUIT AND CONDUCTOR	LS	1	45,000.00	45,000.00	54,100.00	54,100.00
127	861101	RAMP METERING SYSTEM (LOCATION 1)	LS	1	42,000.00	42,000.00	53,000.00	53,000.00
128	861102	RAMP METERING SYSTEM (LOCATION 2)	LS	1	55,000.00	55,000.00	68,900.00	68,900.00
129	861103	RAMP METERING SYSTEM (LOCATION 3)	LS	1	52,000.00	52,000.00	53,900.00	53,900.00
130	861104	RAMP METERING SYSTEM (LOCATION 4)	LS	1	55,000.00	55,000.00	56,000.00	56,000.00
131	861349	REMOVE EXISTING SIGNAL SYSTEM (LOCATION 1)	LS	1	15,000.00	15,000.00	7,800.00	7,800.00
132	861350	REMOVE EXISTING SIGNAL SYSTEM (LOCATION 2)	LS	1	15,000.00	15,000.00	9,000.00	9,000.00
133	999990	MOBILIZATION	LS	1	1,650,000.00	1,650,000.00	1,750,000.00	1,750,000.00
134	000003	COURSE OF CONSTRUCTION INSURANCE	LS	1	20,000.00	20,000.00	78,000.00	78,000.00
135	019901	DEMOLITION	LS	1	100,000.00	100,000.00	5,200.00	5,200.00
136	066102	DUST ABATEMENT	LS	1	75,000.00	75,000.00	36,000.00	36,000.00
137	066105	RESIDENT ENGINEER OFFICE	LS	1	35,000.00	35,000.00	61,000.00	61,000.00
138	066840	TRAFFIC SIGNAL CONTROLLER ASSEMBLY [WITH BATTERY BACK-UP][2-LOCATIONS]	LS	1	13,600.00	13,600.00	13,600.00	13,600.00
139	066843	MODEL 170 CONTROLLER ASSEMBLY [RAMP METER] [4-LOCATIONS]	LS	1	19,200.00	19,200.00	19,200.00	19,200.00
140	066015	FEDERAL TRAINEE PROGRAM	LS	1	5,000.00	5,000.00	2,000.00	2,000.00
141	047403	610 MM STEEL PIPE CASING	M	26	950.00	24,700.00	1,070.00	27,820.00

**Riverside County Transportation Department
Summary of Bids**

PROJECT: I-10/Indian Canyon Drive Interchange Improvements

Advertised: March 16, 2010 (Agenda Item: 3.64)
Bids Open: 2 pm Date: Wednesday, April 28, 2010

PROJECT NO. A8-0372; ESPLHPLU-5282(034); HP21-L-5282 (035)

**Riverside Construction Co.
Riverside, CA 92502**
**Skanska USA Civil West
Riverside, CA 92509**

BASE BID (CONTINUED)		CONTRACT ITEM	UNITS	QUANTITY	BID UNIT PRICE	BID ESTIMATE	BID UNIT PRICE	BID ESTIMATE
ITEM NO.	ITEM CODE							
142	157550	BRIDGE REMOVAL	LS	1	65,000.00	65,000.00	110,000.00	110,000.00
143 (F)	192003	STRUCTURE EXCAVATION (BRIDGE)	M3	1,150	100.00	115,000.00	155.00	178,250.00
144 (F)	193003	STRUCTURE BACKFILL (BRIDGE)	M3	490	200.00	98,000.00	84.00	41,160.00
145	490566	FURNISH STEEL PILING (HP 360 X 132)	M	2,977	145.00	431,665.00	149.00	443,573.00
146	490567	DRIVE STEEL PILE (HP 360 X 132)	EA	196	1,200.00	235,200.00	1,150.00	225,400.00
147	*****	ITEM DELETED BY ADDENDUM	*****	*****	*****	*****	*****	*****
148	*****	ITEM DELETED BY ADDENDUM	*****	*****	*****	*****	*****	*****
149	500020	PRESTRESSING PRECAST GIRDER	LS	1	75,000.00	75,000.00	88,000.00	88,000.00
150 (F)	510051	STRUCTURAL CONCRETE, BRIDGE FOOTING	M3	220	500.00	110,000.00	450.00	99,000.00
151 (F)	510053	STRUCTURAL CONCRETE, BRIDGE	M3	1,710	700.00	1,197,000.00	975.00	1,667,250.00
152 (F)	510086	STRUCTURAL CONCRETE, APPROACH SLAB (TYPE N)	M3	210	600.00	126,000.00	510.00	107,100.00
153	511036	ARCHITECTURAL SURFACE [LAVA ROCK FACING]	M2	170	100.00	17,000.00	189.00	32,130.00
154 (F)	511063	FRACTURED FIN TEXTURE	M2	140	100.00	14,000.00	73.00	10,220.00
155	512254	FURNISH PRECAST PRESTRESSED CONCRETE BULB-TEE GIRDER (25 M-30 M)	EA	26	18,000.00	468,000.00	21,200.00	551,200.00
156	512255	FURNISH PRECAST PRESTRESSED CONCRETE BULB-TEE GIRDER (30 M-35 M)	EA	13	18,000.00	234,000.00	24,700.00	321,100.00
157	512500	ERECT PRECAST PRESTRESSED CONCRETE GIRDER	EA	39	1,800.00	70,200.00	1,145.00	44,655.00
158	519123	JOINT SEAL (TYPE B - MR 50 MM)	M	72	350.00	25,200.00	387.00	27,864.00
159 (F)	520102	BAR REINFORCING STEEL (BRIDGE)	KG	244,000	1.50	366,000.00	1.75	427,000.00
160 (F)	721810	SLOPE PAVING (CONCRETE)	M3	72	525.00	37,800.00	400.00	28,800.00
161 (F)	750505	BRIDGE DECK DRAINAGE SYSTEM	KG	470	25.00	11,750.00	10.00	4,700.00
162 (F)	833088	TUBULAR HANDRAILING	M	10	325.00	3,250.00	425.00	4,250.00
163 (F)	833142	CONCRETE BARRIER (TYPE 26 MODIFIED)	M	110	350.00	38,500.00	470.00	51,700.00
164	839727	CONCRETE BARRIER (TYPE 736 MODIFIED)	M	110	300.00	33,000.00	355.00	39,050.00
165 (F)	833020	CHAIN LINK RAILING [MINI MESH]	M	91	1,000.00	91,000.00	1,000.00	91,000.00
		BSAE BID TOTAL				17,477,944.50		17,561,037.00
		ITEMS 1 - 165						

ALTERNATE BID:

THE MISSION SPRINGS WATER DISTRICT		CONTRACT ITEM	UNITS	QUANTITY	BID UNIT PRICE	BID ESTIMATE
ITEM NO.	ITEM CODE					
166	0000003	ADJUST WATER VALVE COVER TO GRADE	EA	14	250.00	3,500.00
		ALTERNATE BID TOTAL				3,500.00
		ITEMS 166				

PROJECT TOTAL		BID ESTIMATE
ITEMS 1 - 166		
	17,481,444.50	17,565,657.00

**Riverside County Transportation Department
Summary of Bids**

PROJECT: I-10/Indian Canyon Drive Interchange Improvements

Advertised: March 16, 2010 (Agenda Item: 3.64)
Bids Open: 2 pm Date: Wednesday, April 28, 2010

PROJECT NO. A8-0372; ESPLHPLU-5282(034); HP21-L-5282 (035)

FTR International, Inc.
Irvine, CA 92602

Ortiz Enterprises, Inc.
Irvine, CA 92618

BASE BID ITEM NO.	ITEM CODE	CONTRACT ITEM	UNITS	QUANTITY	BID UNIT PRICE	BID ESTIMATE	BID UNIT PRICE	BID ESTIMATE
1	000003	ENDANGERED SPECIES PROTECTION	LS	1	75,000.00	75,000.00	30,000.00	30,000.00
2	000003	NONNATIVE PLANT PRECLUSION	LS	1	65,000.00	65,000.00	60,000.00	60,000.00
3	000003	CONSTRUCTION MONITORING CAMERA (POLE AND ELECTRIC SERVICE)	LS	1	20,000.00	20,000.00	15,000.00	15,000.00
4 (S.F)	000003	METAL SCRIPT LETTERS (RAILING METHOD)	LS	1	2,500.00	2,500.00	30,000.00	30,000.00
5	-----	ITEM DELETED BY ADDENDUM	-----	-----	-----	-----	-----	-----
6	070012	PROGRESS SCHEDULE (CRITICAL PATH METHOD)	LS	1	5,000.00	5,000.00	5,000.00	5,000.00
7	071325	TEMPORARY FENCE (TYPE ESA)	M	610	18.00	10,980.00	3.00	1,830.00
8	000003	TEMPORARY FENCE (TYPE WILDLIFE)	M	610	30.00	18,300.00	24.00	14,640.00
9	074016	CONSTRUCTION SITE MANAGEMENT	LS	1	25,000.00	25,000.00	15,000.00	15,000.00
10	074020	WATER POLLUTION CONTROL	LS	1	12,000.00	12,000.00	80,000.00	80,000.00
11	074018	HEALTH AND SAFETY PLAN	LS	1	5,000.00	5,000.00	3,000.00	3,000.00
12	074028	TEMPORARY FIBER ROLLS	M	10,800	8.00	86,400.00	8.00	86,400.00
13	074029	TEMPORARY SILT FENCE	M	960	5.00	4,800.00	4.00	3,840.00
14	074033	TEMPORARY CONSTRUCTION ENTRANCE	EA	3	650.00	1,950.00	10,000.00	30,000.00
15	074035	TEMPORARY CHECK DAM	M	52	6.00	312.00	20.00	1,040.00
16	074037	MOVE-IN/MOVE-OUT (TEMPORARY EROSION CONTROL)	EA	4	600.00	2,400.00	600.00	2,400.00
17	074038	TEMPORARY DRAINAGE INLET PROTECTION	EA	39	100.00	3,900.00	200.00	7,800.00
18	074039	TEMPORARY HYDRAULIC MULCH (POLYMER STABILIZED FIBER MATRIX)	M2	136,000	0.50	68,000.00	0.30	40,800.00
19	074041	STREET SWEEPING	LS	1	160,000.00	160,000.00	80,000.00	80,000.00
20	074042	TEMPORARY CONCRETE WASHOUT (PORTABLE)	LS	1	15,000.00	15,000.00	13,000.00	13,000.00
21	120090	CONSTRUCTION AREA SIGNS	LS	1	50,000.00	50,000.00	100,000.00	100,000.00
22	120100	TRAFFIC CONTROL SYSTEMS	LS	1	68,000.00	68,000.00	125,000.00	125,000.00
23	120120	TYPE III BARRICADE	EA	140	75.00	10,500.00	150.00	21,000.00
24	120143	TEMPORARY PAVEMENT DELINEATION	M	4,460	1.00	4,460.00	3.00	13,380.00
25	120149	TEMPORARY PAVEMENT MARKING (PAINT)	M2	100	10.00	1,000.00	50.00	5,000.00
26	120199	TRAFFIC PLASTIC DRUM	EA	590	55.00	32,450.00	250.00	147,500.00
27	128650	PORTABLE CHANGEABLE MESSAGE SIGN	EA	10	13,500.00	135,000.00	4,000.00	40,000.00
28	129000	TEMPORARY RAILING (TYPE K)	M	5,300	30.00	159,000.00	89.00	471,700.00
29	129110	TEMPORARY CRASH CUSHION [SAND FILLED]	EA	210	215.00	45,150.00	200.00	42,000.00
30	129110	TEMPORARY CRASH CUSHION [ABSORB 350]	EA	6	300.00	1,800.00	11,000.00	66,000.00
31	150701	REMOVE YELLOW TRAFFIC STRIPE [HAZARDOUS WASTE]	M	2,870	3.00	8,610.00	3.00	8,610.00
32	150608	REMOVE CHAIN LINK FENCE	M	610	18.00	10,980.00	10.00	6,100.00
33	150659	REMOVE TERMINAL SECTION	EA	3	260.00	780.00	325.00	975.00
34	150662	REMOVE METAL BEAM GUARD RAILING	M	660	28.00	18,480.00	25.00	16,500.00
35	150710	REMOVE TRAFFIC STRIPE	M	34,100	1.00	34,100.00	0.30	10,230.00
36	150713	REMOVE PAVEMENT MARKING	M2	52	15.00	780.00	52.00	2,704.00

**Riverside County Transportation Department
Summary of Bids**

PROJECT: I-10/Indian Canyon Drive Interchange Improvements

Advertised: March 16, 2010 (Agenda Item: 3.64)
Bids Open: 2 pm Date: Wednesday, April 28, 2010

PROJECT NO. A8-0372; ESPLHPLU-5282(034); HP21-L-5282 (035)

FTR International, Inc.
Irvine, CA 92602

Ortiz Enterprises, Inc.
Irvine, CA 92618

ITEM NO.	ITEM CODE	CONTRACT ITEM	UNITS	QUANTITY	BID UNIT PRICE	BID ESTIMATE	BID UNIT PRICE	BID ESTIMATE
37	150722	REMOVE PAVEMENT MARKER	EA	8,520	2.00	17,040.00	2.00	17,040.00
38	150742	REMOVE ROADSIDE SIGN	EA	43	105.00	4,515.00	100.00	4,300.00
39	150760	REMOVE SIGN STRUCTURE	EA	2	5,000.00	10,000.00	3,500.00	7,000.00
40	150806	REMOVE CULVERT	M	360	93.00	33,480.00	110.00	39,600.00
41	150820	REMOVE INLET	EA	1	1,130.00	1,130.00	1,900.00	1,900.00
42	150821	REMOVE HEADWALL	EA	21	1,240.00	26,040.00	1,200.00	25,200.00
43	153153	COLD PLANE ASPHALT CONCRETE PAVEMENT (45 MM MAXIMUM)	M2	1,080	12.00	12,960.00	8.00	8,640.00
44	160101	CLEARING AND GRUBBING	LS	1	82,500.00	82,500.00	82,500.00	82,500.00
45	170101	DEVELOP WATER SUPPLY	LS	1	10,000.00	10,000.00	10,000.00	10,000.00
46 (F)	190101	ROADWAY EXCAVATION	M3	29,170	10.00	291,700.00	18.00	525,060.00
47	190110	LEAD COMPLIANCE PLAN (METRIC)	LS	1	5,000.00	5,000.00	5,000.00	5,000.00
48	190113	ASBESTOS COMPLIANCE PLAN	LS	1	2,500.00	2,500.00	5,000.00	5,000.00
49	193118	CONCRETE BACKFILL	M3	14	233.00	3,262.00	200.00	2,800.00
50	194001	DITCH EXCAVATION	M3	320	8.00	2,560.00	11.00	3,520.00
51	198001	IMPORTED BORROW	M3	71,000	9.80	695,800.00	11.00	781,000.00
52	203016	EROSION CONTROL (TYPE D)	M2	13,200	1.00	13,200.00	2.00	26,400.00
53	203021	FIBER ROLLS (METRIC)	M	10,500	8.00	84,000.00	8.00	84,000.00
54	203026	MOVE-IN/MOVE-OUT (EROSION CONTROL)	EA	1	600.00	600.00	600.00	600.00
55	208731	200 MM CORRUGATED HIGH DENSITY POLYETHYLENE PIPE CONDUIT	M	68	175.00	11,900.00	170.00	11,560.00
56	220101	FINISHING ROADWAY	LS	1	15,000.00	15,000.00	1,000.00	1,000.00
57	260201	CLASS 2 AGGREGATE BASE	M3	14,600	23.00	335,800.00	42.00	613,200.00
58	280000	LEAN CONCRETE BASE	M3	190	350.00	66,500.00	175.00	33,250.00
59	374002	ASPHALTIC EMULSION (FOG SEAL COAT)	TONN	6	650.00	3,900.00	1,400.00	8,400.00
60	390106	ASPHALT CONCRETE (OPEN GRADED)(OPEN GRADED FRICTION COURSE)	TONN	1,310	120.00	157,200.00	132.00	172,920.00
61	390130	HOT MIX ASPHALT (TYPE A)	TONN	320	88.00	28,160.00	175.00	56,000.00
62	000003	HOT MIX ASPHALT (TYPE A BOND BREAKER)	TONN	120	89.00	10,680.00	270.00	32,400.00
63	000003	HOT MIX ASPHALT (TYPE C)	TONN	31,200	86.00	2,683,200.00	106.00	3,307,200.00
64	394071	PLACE HOT MIX ASPHALT DIKE	M	4,570	2.00	9,140.00	6.00	27,420.00
65	394090	PLACE HOT MIX ASPHALT (MISCELLANEOUS AREA)	M2	320	160.00	51,200.00	50.00	16,000.00
66	397005	TACK COAT	TONN	38	1,500.00	57,000.00	500.00	19,000.00
67	401066	CONCRETE PAVEMENT (EXIT RAMP TERMINI) [JOINTED PLAIN CONCRETE PAVEMENT]	M3	430	480.00	206,400.00	490.00	210,700.00
68	401108	RAPID STRENGTH CONCRETE [JOINTED PLAIN CONCRETE PAVEMENT]	M3	3,780	700.00	2,646,000.00	420.00	1,587,600.00
69	000003	SEAL ISOLATION JOINT	M	1,280	22.00	28,160.00	22.00	28,160.00
70	414091	SEAL LONGITUDINAL JOINT	M	2,140	7.00	14,980.00	7.00	14,980.00
71	414101	SEAL TRANSVERSE JOINT	M	2,120	7.00	14,840.00	7.00	14,840.00

**Riverside County Transportation Department
Summary of Bids**

PROJECT: I-10/Indian Canyon Drive Interchange Improvements

Advertised: March 16, 2010 (Agenda Item: 3.64)
Bids Open: 2 pm Date: Wednesday, April 28, 2010

PROJECT NO. A8-0372; ESPLHPLU-5282(034); HP21-L-5282 (035)

**FTR International, Inc.
Irvine, CA 92602**

**Ortiz Enterprises, Inc.
Irvine, CA 92618**

ITEM NO.	ITEM CODE	CONTRACT ITEM	UNITS	QUANTITY	BID UNIT PRICE	BID ESTIMATE	BID UNIT PRICE	BID ESTIMATE
72	518201	MASONRY STONE WALL	M2	23	214.00	4,922.00	350.00	8,050.00
73 (F)	510129	CLASS 2 CONCRETE (BOX CULVERT)	M3	190	900.00	171,000.00	600.00	114,000.00
74 (F)	510502	MINOR CONCRETE (MINOR STRUCTURE)	M3	110	1,600.00	176,000.00	1,050.00	115,500.00
75 (F)	520107	BAR REINFORCING STEEL (BOX CULVERT)	KG	21,271	2.00	42,542.00	1.90	40,414.90
76 (F)	560218	FURNISH SIGN STRUCTURE (TRUSS)	KG	30,000	7.00	210,000.00	5.40	162,000.00
77 (F)	560219	INSTALL SIGN STRUCTURE (TRUSS)	KG	30,000	1.00	30,000.00	0.92	27,600.00
78	560234	FURNISH LAMINATED PANEL SIGN (25.4 MM -TYPE A)	M2	67	225.00	15,075.00	210.00	14,070.00
79	560238	FURNISH SINGLE SHEET ALUMINUM SIGN (1.6 MM- UNFRAMED)	M2	56	115.00	6,440.00	107.00	5,992.00
80	560239	FURNISH SINGLE SHEET ALUMINUM SIGN (2.0 MM- UNFRAMED)	M2	30	115.00	3,450.00	142.00	4,260.00
81	560241	FURNISH SINGLE SHEET ALUMINUM SIGN (1.6 MM- FRAMED)	M2	13	130.00	1,690.00	120.00	1,560.00
82	560242	FURNISH SINGLE SHEET ALUMINUM SIGN (2.0 MM- FRAMED)	M2	71	150.00	10,650.00	140.00	9,940.00
83	561015	1524 MM CAST-IN-DRILLED-HOLE CONCRETE PILE (SIGN FOUNDATION)	M	23	4,272.00	98,256.00	3,100.00	71,300.00
84	566011	ROADSIDE SIGN - ONE POST	EA	85	360.00	30,600.00	340.00	28,900.00
85	566012	ROADSIDE SIGN - TWO POST	EA	17	1,250.00	21,250.00	1,100.00	18,700.00
86	568001	INSTALL SIGN (STRAP AND SADDLE BRACKET METHOD)	EA	8	110.00	880.00	100.00	800.00
87	568015	INSTALL SIGN (MAST-ARM HANGER METHOD)	EA	22	210.00	4,620.00	200.00	4,400.00
88	620909	450 MM ALTERNATIVE PIPE CULVERT	M	71	277.00	19,667.00	220.00	15,620.00
89	620913	600 MM ALTERNATIVE PIPE CULVERT	M	230	234.00	53,820.00	240.00	55,200.00
90	620924	900 MM ALTERNATIVE PIPE CULVERT	M	120	336.00	40,320.00	310.00	37,200.00
91	664097	600 MM BITUMINOUS COATED CORRUGATED STEEL PIPE (2.77 MM THICK)	M	200	306.00	61,200.00	290.00	58,000.00
92	664110	900 MM BITUMINOUS COATED CORRUGATED STEEL PIPE (2.77 MM THICK)	M	50	320.00	16,000.00	355.00	17,750.00
93	717072	100 MM POLYVINYL CHLORIDE SEWER PIPE	M	37	250.00	9,250.00	220.00	8,140.00
94	721008	ROCK SLOPE PROTECTION (LIGHT, METHOD B)	M3	140	190.00	26,600.00	130.00	18,200.00
95	721430	CONCRETE (CHANNEL LINING)	M3	73	265.00	19,345.00	350.00	25,550.00
96	729010	ROCK SLOPE PROTECTION FABRIC	M2	330	8.00	2,640.00	10.00	3,300.00
97 (F)	731504	MINOR CONCRETE (CURB AND GUTTER)	M3	250	416.00	104,000.00	395.00	98,750.00
98 (F)	000003	MINOR CONCRETE (COLORED)	M2	1,890	47.00	88,830.00	44.00	83,160.00
99 (F)	731521	MINOR CONCRETE (SIDEWALK)	M3	260	360.00	93,600.00	340.00	88,400.00
100 (F)	731530	MINOR CONCRETE (TEXTURED PAVING)	M2	1,190	87.00	103,530.00	82.00	97,580.00
101 (F)	750001	MISCELLANEOUS IRON AND STEEL	KG	1,262	4.00	5,048.00	10.00	12,620.00
102	800391	CHAIN LINK FENCE (TYPE CL-1.8)	M	940	50.00	47,000.00	38.00	35,720.00
103	820105	DELINEATOR (SPECIAL)	EA	23	50.00	1,150.00	125.00	2,875.00
104	820107	DELINEATOR (CLASS 1)	EA	160	50.00	8,000.00	50.00	8,000.00
105	832003	METAL BEAM GUARD RAILING (WOOD POST)	EA	670	85.00	56,950.00	61.00	40,870.00
106	839541	TRANSITION RAILING (TYPE WB)	EA	4	2,700.00	10,800.00	3,500.00	14,000.00

**Riverside County Transportation Department
Summary of Bids**

PROJECT: I-10/Indian Canyon Drive Interchange Improvements

**Advertised: March 16, 2010 (Agenda Item: 3.64)
Bids Open: 2 pm Date: Wednesday, April 28, 2010**

**PROJECT NO. A8-0372; ESPLHPLU-5282(034) & HP21L-5282 (035)
FTR International, Inc.
Irvine, CA 92602**

**Ortiz Enterprises, Inc.
Irvine, CA 92618**

ITEM NO.	ITEM CODE	CONTRACT ITEM	UNITS	QUANTITY	BID UNIT PRICE	BID ESTIMATE	BID UNIT PRICE	BID ESTIMATE
107	839568	TERMINAL ANCHOR ASSEMBLY (TYPE SFT)	EA	5	700.00	3,500.00	700.00	3,500.00
108	839585	ALTERNATIVE FLARED TERMINAL SYSTEM [TYPE SRT]	EA	9	2,200.00	19,800.00	2,200.00	19,800.00
109	839605	CRASH CUSHION (REACT 9SCBS)	EA	3	22,000.00	66,000.00	49,000.00	147,000.00
110	839703	CONCRETE BARRIER (TYPE 60C)	M	270	380.00	102,600.00	200.00	54,000.00
111	839705	CONCRETE BARRIER (TYPE 60E)	M	89	360.00	32,040.00	200.00	17,800.00
112	840515	THERMOPLASTIC PAVEMENT MARKING	M2	360	20.00	7,200.00	41.00	14,760.00
113	840563	200 MM THERMOPLASTIC TRAFFIC STRIPE	M	1,210	2.00	2,420.00	5.00	6,050.00
114	840571	100 MM THERMOPLASTIC TRAFFIC STRIPE (BROKEN 5.18 M - 2.14 M)	M	9,600	1.00	9,600.00	1.60	15,360.00
115	840656	PAINT TRAFFIC STRIPE (2-COAT)	M	13,100	1.00	13,100.00	1.30	17,030.00
116	850101	PAVEMENT MARKER (NON-REFLECTIVE)	EA	15,300	3.00	45,900.00	1.40	21,420.00
117	850110	PAVEMENT MARKER (RETROREFLECTIVE-SPECIAL TYPE C)	EA	86	3.00	258.00	28.00	2,408.00
118	850111	PAVEMENT MARKER (RETROREFLECTIVE -SPECIAL TYPE D)	EA	790	3.00	2,370.00	8.00	6,320.00
119	850112	PAVEMENT MARKER (RETROREFLECTIVE-SPECIAL TYPE G)	EA	2,790	3.00	8,370.00	6.00	16,740.00
120	850113	PAVEMENT MARKER (RETROREFLECTIVE-SPECIAL TYPE H)	EA	450	2.00	900.00	10.00	4,500.00
121	860251	SIGNAL AND LIGHTING (LOCATION 1)	LS	1	125,000.00	125,000.00	100,000.00	100,000.00
122	860252	SIGNAL AND LIGHTING (LOCATION 2)	LS	1	110,000.00	110,000.00	85,000.00	85,000.00
123	860300	SIGNAL AND LIGHTING (CITY STREET LOCATION 1)	LS	1	180,000.00	180,000.00	145,000.00	145,000.00
124	860302	SIGNAL AND LIGHTING (CITY STREET LOCATION 2)	LS	1	185,000.00	185,000.00	160,000.00	160,000.00
125	860460	LIGHTING AND SIGN ILLUMINATION	LS	1	375,000.00	375,000.00	235,000.00	235,000.00
126	860701	INTERCONNECTION CONDUIT AND CONDUCTOR	LS	1	70,000.00	70,000.00	40,000.00	40,000.00
127	861101	RAMP METERING SYSTEM (LOCATION 1)	LS	1	60,000.00	60,000.00	45,000.00	45,000.00
128	861102	RAMP METERING SYSTEM (LOCATION 2)	LS	1	75,000.00	75,000.00	55,000.00	55,000.00
129	861103	RAMP METERING SYSTEM (LOCATION 3)	LS	1	60,000.00	60,000.00	44,000.00	44,000.00
130	861104	RAMP METERING SYSTEM (LOCATION 4)	LS	1	60,000.00	60,000.00	46,000.00	46,000.00
131	861349	REMOVE EXISTING SIGNAL SYSTEM (LOCATION 1)	LS	1	15,000.00	15,000.00	8,000.00	8,000.00
132	861350	REMOVE EXISTING SIGNAL SYSTEM (LOCATION 2)	LS	1	15,000.00	15,000.00	9,000.00	9,000.00
133	999990	MOBILIZATION	LS	1	1,250,000.00	1,250,000.00	2,000,000.00	2,000,000.00
134	000003	COURSE OF CONSTRUCTION INSURANCE	LS	1	160,000.00	160,000.00	129,000.00	129,000.00
135	019901	DEMobilIZATION	LS	1	50,000.00	50,000.00	10,000.00	10,000.00
136	066102	DUST ABATEMENT	LS	1	10,000.00	10,000.00	35,000.00	35,000.00
137	066105	RESIDENT ENGINEER OFFICE	LS	1	150,000.00	150,000.00	135,000.00	135,000.00
138	066840	TRAFFIC SIGNAL CONTROLLER ASSEMBLY [WITH BATTERY BACK-UP][2-LOCATIONS]	LS	1	13,600.00	13,600.00	13,600.00	13,600.00
139	066843	MODEL 170 CONTROLLER ASSEMBLY [RAMP METER] [4-LOCATIONS]	LS	1	19,200.00	19,200.00	19,200.00	19,200.00
140	066015	FEDERAL TRAINEE PROGRAM	LS	1	45,000.00	45,000.00	11,000.00	11,000.00
141	047403	610 MM STEEL PIPE CASING	M	26	1,500.00	39,000.00	950.00	24,700.00

**Riverside County Transportation Department
Summary of Bids**

PROJECT: I-10/Indian Canyon Drive Interchange Improvements

Advertised: March 16, 2010 (Agenda Item: 3.64)
Bids Open: 2 pm Date: Wednesday, April 28, 2010

PROJECT NO. A8-0372; ESPLHPLU-5282(034); HP21-L-5282 (035)

BASE BID (CONTINUED)		FTR International, Inc. Irvine, CA 92602		Ortiz Enterprises, Inc. Irvine, CA 92618				
ITEM NO.	ITEM CODE	CONTRACT ITEM	UNITS	QUANTITY	BID UNIT PRICE	BID ESTIMATE	BID UNIT PRICE	BID ESTIMATE
142	157550	BRIDGE REMOVAL	LS	1	68,000.00	68,000.00	78,000.00	78,000.00
143 (F)	192003	STRUCTURE EXCAVATION (BRIDGE)	M3	1,150	30.00	34,500.00	125.00	143,750.00
144 (F)	193003	STRUCTURE BACKFILL (BRIDGE)	M3	490	35.00	17,150.00	120.00	58,800.00
145	490566	FURNISH STEEL PILING (HP 360 X 132)	M	2,977	155.00	461,435.00	140.00	416,780.00
146	490567	DRIVE STEEL PILE (HP 360 X 132)	EA	196	1,220.00	239,120.00	1,650.00	323,400.00
147	*****	ITEM DELETED BY ADDENDUM	*****	*****	*****	*****	*****	*****
148	*****	ITEM DELETED BY ADDENDUM	*****	*****	*****	*****	*****	*****
149	500020	PRESTRESSING PRECAST GIRDER	LS	1	95,000.00	95,000.00	90,000.00	90,000.00
150 (F)	510051	STRUCTURAL CONCRETE, BRIDGE FOOTING	M3	220	715.00	157,300.00	350.00	77,000.00
151 (F)	510053	STRUCTURAL CONCRETE, BRIDGE	M3	1,710	645.00	1,102,950.00	535.00	914,850.00
152 (F)	510086	STRUCTURAL CONCRETE, APPROACH SLAB (TYPE N)	M3	210	430.00	90,300.00	600.00	126,000.00
153	511036	ARCHITECTURAL SURFACE [LAVA ROCK FACING]	M2	170	760.00	129,200.00	115.00	19,550.00
154 (F)	511063	FRACTURED FIN TEXTURE	M2	140	780.00	109,200.00	125.00	17,500.00
155	512254	FURNISH PRECAST PRESTRESSED CONCRETE BULB-TEE GIRDER (25 M-30 M)	EA	26	20,500.00	533,000.00	18,000.00	468,000.00
156	512255	FURNISH PRECAST PRESTRESSED CONCRETE BULB-TEE GIRDER (30 M-35 M)	EA	13	23,150.00	300,950.00	18,000.00	234,000.00
157	512500	ERECT PRECAST PRESTRESSED CONCRETE GIRDER	EA	39	1,320.00	51,480.00	1,200.00	46,800.00
158	519123	JOINT SEAL (TYPE B - MR 50 MM)	M	72	387.00	27,864.00	387.00	27,864.00
159 (F)	520102	BAR REINFORCING STEEL (BRIDGE)	KG	244,000	2.10	512,400.00	1.65	402,600.00
160 (F)	721810	SLOPE PAVING (CONCRETE)	M3	72	400.00	28,800.00	400.00	28,800.00
161 (F)	750505	BRIDGE DECK DRAINAGE SYSTEM	KG	470	18.00	8,460.00	40.00	18,800.00
162 (F)	833088	TUBULAR HANDRAILING	M	10	435.00	4,350.00	325.00	3,250.00
163 (F)	833142	CONCRETE BARRIER (TYPE 26 MODIFIED)	M	110	490.00	53,900.00	365.00	40,150.00
164	839727	CONCRETE BARRIER (TYPE 736 MODIFIED)	M	110	280.00	30,800.00	145.00	15,950.00
165 (F)	833020	CHAIN LINK RAILING [MINI MESH]	M	91	1,100.00	100,100.00	1,400.00	127,400.00
BSAE BID TOTAL						17,931,221.00		18,104,492.90
ITEMS 1 - 165								

ALTERNATE BID:

THE MISSION SPRINGS WATER DISTRICT		FTR International, Inc. Irvine, CA 92602		Ortiz Enterprises, Inc. Irvine, CA 92618				
ITEM NO.	ITEM CODE	CONTRACT ITEM	UNITS	QUANTITY	BID UNIT PRICE	BID ESTIMATE	BID UNIT PRICE	BID ESTIMATE
166	0000003	ADJUST WATER VALVE COVER TO GRADE	EA	14	1,250.00	17,500.00	450.00	6,300.00
ALTERNATE BID TOTAL						17,500.00		6,300.00
ITEMS 166								

PROJECT TOTAL		FTR International, Inc. Irvine, CA 92602		Ortiz Enterprises, Inc. Irvine, CA 92618				
ITEM NO.	ITEM CODE	CONTRACT ITEM	UNITS	QUANTITY	BID UNIT PRICE	BID ESTIMATE	BID UNIT PRICE	BID ESTIMATE
PROJECT TOTAL						17,948,721.00		18,110,792.90
ITEMS 1 - 166								

**Riverside County Transportation Department
Summary of Bids**

PROJECT: I-10/Indian Canyon Drive Interchange Improvements

Advertised: March 16, 2010 (Agenda Item: 3.64)

Bids Open: 2 pm Date: Wednesday, April 28, 2010

PROJECT NO. A8-0372; ESPLHPLU-5282(034); HP21-L-5282 (035)

**Beador Construction
Corona, CA 92883**

**Sukut Construction, Inc.
Riverside, CA 92505**

BASE BID	ITEM NO.	ITEM CODE	CONTRACT ITEM	UNITS	QUANTITY	BID UNIT PRICE	BID ESTIMATE	BID UNIT PRICE	BID ESTIMATE
1	000003		ENDANGERED SPECIES PROTECTION	LS	1	5,000.00	5,000.00	2,500.00	2,500.00
2	000003		NONNATIVE PLANT PRECLUSION	LS	1	5,000.00	5,000.00	6,000.00	6,000.00
3	000003		CONSTRUCTION MONITORING CAMERA (POLE AND ELECTRIC SERVICE)	LS	1	25,000.00	25,000.00	9,000.00	9,000.00
4 (S,F)	000003		METAL SCRIPT LETTERS (RAILING METHOD)	LS	1	52,500.00	52,500.00	13,000.00	13,000.00
5	-----		ITEM DELETED BY ADDENDUM	-----	-----	-----	-----	-----	-----
6	070012		PROGRESS SCHEDULE (CRITICAL PATH METHOD)	LS	1	5,000.00	5,000.00	5,000.00	5,000.00
7	071325		TEMPORARY FENCE (TYPE ESA)	M	610	4.50	2,745.00	10.50	6,405.00
8	000003		TEMPORARY FENCE (TYPE WILDLIFE)	M	610	6.50	3,965.00	10.50	6,405.00
9	074016		CONSTRUCTION SITE MANAGEMENT	LS	1	30,000.00	30,000.00	15,000.00	15,000.00
10	074020		WATER POLLUTION CONTROL	LS	1	12,500.00	12,500.00	2,120.00	2,120.00
11	074018		HEALTH AND SAFETY PLAN	LS	1	2,500.00	2,500.00	2,120.00	2,120.00
12	074028		TEMPORARY FIBER ROLLS	M	10,800	7.75	83,700.00	5.00	54,000.00
13	074029		TEMPORARY SILT FENCE	M	960	6.75	6,480.00	7.75	7,440.00
14	074033		TEMPORARY CONSTRUCTION ENTRANCE	EA	3	2,400.00	7,200.00	3,100.00	9,300.00
15	074035		TEMPORARY CHECK DAM	M	52	5.75	299.00	227.00	11,804.00
16	074037		MOVE-IN/MOVE-OUT (TEMPORARY EROSION CONTROL)	EA	4	500.00	2,000.00	900.00	3,600.00
17	074038		TEMPORARY DRAINAGE INLET PROTECTION	EA	39	125.00	4,875.00	325.00	12,675.00
18	074039		TEMPORARY HYDRAULIC MULCH (POLYMER STABILIZED FIBER MATRIX)	M2	136,000	0.23	31,280.00	0.20	27,200.00
19	074041		STREET SWEEPING	LS	1	125,000.00	125,000.00	1,900.00	1,900.00
20	074042		TEMPORARY CONCRETE WASHOUT (PORTABLE)	LS	1	15,000.00	15,000.00	19,000.00	19,000.00
21	120090		CONSTRUCTION AREA SIGNS	LS	1	25,000.00	25,000.00	8,500.00	8,500.00
22	120100		TRAFFIC CONTROL SYSTEMS	LS	1	533,133.40	533,133.40	175,000.00	175,000.00
23	120120		TYPE III BARRICADE	EA	140	47.00	6,580.00	64.00	8,960.00
24	120143		TEMPORARY PAVEMENT DELINEATION	M	4,460	0.50	2,230.00	3.25	14,495.00
25	120149		TEMPORARY PAVEMENT MARKING (PAINT)	M2	100	8.00	800.00	34.00	3,400.00
26	120199		TRAFFIC PLASTIC DRUM	EA	590	40.00	23,600.00	424.00	250,160.00
27	128650		PORTABLE CHANGEABLE MESSAGE SIGN	EA	10	11,250.00	112,500.00	10,600.00	106,000.00
28	129000		TEMPORARY RAILING (TYPE K)	M	5,300	20.00	106,000.00	26.00	137,800.00
29	129110		TEMPORARY CRASH CUSHION [SAND FILLED]	EA	210	250.00	52,500.00	196.00	41,160.00
30	129110		TEMPORARY CRASH CUSHION [ABSORB 350]	EA	6	3,000.00	18,000.00	5,300.00	31,800.00
31	150701		REMOVE YELLOW TRAFFIC STRIPE [HAZARDOUS WASTE]	M	2,870	2.25	6,457.50	2.10	6,027.00
32	150608		REMOVE CHAIN LINK FENCE	M	610	6.25	3,812.50	17.50	10,675.00
33	150659		REMOVE TERMINAL SECTION	EA	3	250.00	750.00	530.00	1,590.00
34	150662		REMOVE METAL BEAM GUARD RAILING	M	660	26.00	17,160.00	23.00	15,180.00
35	150710		REMOVE TRAFFIC STRIPE	M	34,100	0.45	15,345.00	1.40	47,740.00
36	150713		REMOVE PAVEMENT MARKING	M2	52	13.50	702.00	23.00	1,196.00

Riverside County Transportation Department Summary of Bids

PROJECT: I-10/Indian Canyon Drive Interchange Improvements

Advertised: March 16, 2010 (Agenda Item: 3.64)
Bids Open: 2 pm Date: Wednesday, April 28, 2010

PROJECT NO. A8-0372; ESPLHPLU-5282(034); HP21-L-5282 (035)

BASE BID (CONTINUED)		CONTRACT ITEM		UNITS	QUANTITY	BID UNIT PRICE	BID ESTIMATE	BID UNIT PRICE	BID ESTIMATE
ITEM NO.	ITEM CODE								
37	150722	REMOVE PAVEMENT MARKER		EA	8,520	1.00	8,520.00	1.05	8,946.00
38	150742	REMOVE ROADSIDE SIGN		EA	43	50.00	2,150.00	159.00	6,837.00
39	150760	REMOVE SIGN STRUCTURE		EA	2	7,425.00	14,850.00	6,360.00	12,720.00
40	150806	REMOVE CULVERT		M	360	38.00	13,680.00	49.00	17,640.00
41	150820	REMOVE INLET		EA	1	1,250.00	1,250.00	1,060.00	1,060.00
42	150821	REMOVE HEADWALL		EA	21	750.00	15,750.00	742.00	15,582.00
43	153153	COLD PLANE ASPHALT CONCRETE PAVEMENT (45 MM MAXIMUM)		M2	1,080	9.50	10,260.00	3.80	4,104.00
44	160101	CLEARING AND GRUBBING		LS	1	82,500.00	82,500.00	33,000.00	33,000.00
45	170101	DEVELOP WATER SUPPLY		LS	1	10,000.00	10,000.00	20,000.00	20,000.00
46 (F)	190101	ROADWAY EXCAVATION		M3	29,170	20.00	583,400.00	24.00	700,080.00
47	190110	LEAD COMPLIANCE PLAN (METRIC)		LS	1	5,000.00	5,000.00	5,000.00	5,000.00
48	190113	ASBESTOS COMPLIANCE PLAN		LS	1	5,000.00	5,000.00	1,908.00	1,908.00
49	193118	CONCRETE BACKFILL		M3	14	180.00	2,520.00	423.00	5,922.00
50	194001	DITCH EXCAVATION		M3	320	11.50	3,680.00	12.00	3,840.00
51	198001	IMPORTED BORROW		M3	71,000	6.00	426,000.00	10.00	710,000.00
52	203016	EROSION CONTROL (TYPE D)		M2	13,200	1.30	17,160.00	1.25	16,500.00
53	203021	FIBER ROLLS (METRIC)		M	10,500	6.70	70,350.00	6.75	70,875.00
54	203026	MOVE-IN/REMOVE-OUT (EROSION CONTROL)		EA	1	500.00	500.00	880.00	880.00
55	208731	200 MM CORRUGATED HIGH DENSITY POLYETHYLENE PIPE CONDUIT		M	68	1.75	119.00	111.00	7,548.00
56	220101	FINISHING ROADWAY		LS	1	40,000.00	40,000.00	21,800.00	21,800.00
57	260201	CLASS 2 AGGREGATE BASE		M3	14,600	46.00	671,600.00	35.00	511,000.00
58	280000	LEAN CONCRETE BASE		M3	190	175.00	33,250.00	295.00	56,050.00
59	374002	ASPHALTIC EMULSION (FOG SEAL COAT)		TONN	6	2,075.00	12,450.00	1,450.00	8,700.00
60	390106	ASPHALT CONCRETE (OPEN GRADED)[OPEN GRADED FRICTION COURSE]		TONN	1,310	165.00	216,150.00	135.00	176,850.00
61	390130	HOT MIX ASPHALT (TYPE A)		TONN	320	110.00	35,200.00	185.00	59,200.00
62	000003	HOT MIX ASPHALT (TYPE A BOND BREAKER)		TONN	120	175.00	21,000.00	280.00	33,600.00
63	000003	HOT MIX ASPHALT (TYPE C)		TONN	31,200	105.00	3,276,000.00	111.00	3,463,200.00
64	394071	PLACE HOT MIX ASPHALT DIKE		M	4,570	7.00	31,990.00	12.00	54,840.00
65	394090	PLACE HOT MIX ASPHALT (MISCELLANEOUS AREA)		M2	320	65.00	20,800.00	52.00	16,640.00
66	397005	TACK COAT		TONN	38	1,400.00	53,200.00	525.00	19,950.00
67	401066	CONCRETE PAVEMENT (EXIT RAMP TERMINI) [JOINTED PLAIN CONCRETE PAVEMENT]		M3	430	350.00	150,500.00	440.00	189,200.00
68	401108	RAPID STRENGTH CONCRETE [JOINTED PLAIN CONCRETE PAVEMENT]		M3	3,780	600.00	2,268,000.00	775.00	2,929,500.00
69	000003	SEAL ISOLATION JOINT		M	1,280	21.00	26,880.00	5.75	7,360.00
70	414091	SEAL LONGITUDINAL JOINT		M	2,140	6.25	13,375.00	45.00	96,300.00
71	414101	SEAL TRANSVERSE JOINT		M	2,120	6.25	13,250.00	5.75	12,190.00

Beador Construction
Corona, CA 92883

Sukut Construction, Inc.
Riverside, CA 92505

Riverside County Transportation Department Summary of Bids

PROJECT: I-10/Indian Canyon Drive Interchange Improvements

Advertised: March 16, 2010 (Agenda Item: 3.64)

Bids Open: 2 pm Date: Wednesday, April 28, 2010

PROJECT NO. A8-0372; ESPLHPLU-5282(034); HP21-L-5282 (035)

BASE BID (CONTINUED)		CONTRACT ITEM		UNITS	QUANTITY	BID UNIT PRICE	BID ESTIMATE	BID UNIT PRICE	BID ESTIMATE
ITEM NO.	ITEM CODE								
72	518201	MASONRY STONE WALL		M2	23	435.00	10,005.00	277.00	6,371.00
73 (F)	510129	CLASS 2 CONCRETE (BOX CULVERT)		M3	190	820.00	155,800.00	775.00	147,250.00
74 (F)	510502	MINOR CONCRETE (MINOR STRUCTURE)		M3	110	1,550.00	170,500.00	1,600.00	176,000.00
75 (F)	520107	BAR REINFORCING STEEL (BOX CULVERT)		KG	21,271	1.80	38,287.80	1.50	31,906.50
76 (F)	560218	FURNISH SIGN STRUCTURE (TRUSS)		KG	30,000	5.40	162,000.00	5.85	175,500.00
77 (F)	560219	INSTALL SIGN STRUCTURE (TRUSS)		KG	30,000	0.60	18,000.00	0.47	14,100.00
78	560234	FURNISH LAMINATED PANEL SIGN (25.4 MM -TYPE A)		M2	67	150.00	10,050.00	216.00	14,472.00
79	560238	FURNISH SINGLE SHEET ALUMINUM SIGN (1.6 MM- UNFRAMED)		M2	56	66.00	3,696.00	93.00	5,208.00
80	560239	FURNISH SINGLE SHEET ALUMINUM SIGN (2.0 MM- UNFRAMED)		M2	30	71.00	2,130.00	93.00	2,790.00
81	560241	FURNISH SINGLE SHEET ALUMINUM SIGN (1.6 MM- FRAMED)		M2	13	92.00	1,196.00	123.00	1,599.00
82	560242	FURNISH SINGLE SHEET ALUMINUM SIGN (2.0 MM- FRAMED)		M2	71	104.00	7,384.00	131.00	9,301.00
83	561015	1524 MM CAST-IN-DRILLED-HOLE CONCRETE PILE (SIGN FOUNDATION)		M	23	2,450.00	56,350.00	4,500.00	103,500.00
84	566011	ROADSIDE SIGN - ONE POST		EA	85	270.00	22,950.00	281.00	23,885.00
85	566012	ROADSIDE SIGN - TWO POST		EA	17	575.00	9,775.00	504.00	8,568.00
86	568001	INSTALL SIGN (STRAP AND SADDLE BRACKET METHOD)		EA	8	230.00	1,840.00	186.00	1,488.00
87	568015	INSTALL SIGN (MAST-ARM HANGER METHOD)		EA	22	205.00	4,510.00	265.00	5,830.00
88	620909	450 MM ALTERNATIVE PIPE CULVERT		M	71	208.00	14,768.00	344.00	24,424.00
89	620913	600 MM ALTERNATIVE PIPE CULVERT		M	230	245.00	56,350.00	300.00	69,000.00
90	620924	900 MM ALTERNATIVE PIPE CULVERT		M	120	350.00	42,000.00	250.00	30,000.00
91	664097	600 MM BITUMINOUS COATED CORRUGATED STEEL PIPE (2.77 MM THICK)		M	200	220.00	44,000.00	340.00	68,000.00
92	664110	900 MM BITUMINOUS COATED CORRUGATED STEEL PIPE (2.77 MM THICK)		M	50	280.00	14,000.00	550.00	27,500.00
93	717072	100 MM POLYVINYL CHLORIDE SEWER PIPE		M	37	40.00	1,480.00	31.00	1,147.00
94	721008	ROCK SLOPE PROTECTION (LIGHT, METHOD B)		M3	140	195.00	27,300.00	205.00	28,700.00
95	721430	CONCRETE (CHANNEL LINING)		M3	73	320.00	23,360.00	335.00	24,455.00
96	729010	ROCK SLOPE PROTECTION FABRIC		M2	330	5.50	1,815.00	3.00	990.00
97 (F)	731504	MINOR CONCRETE (CURB AND GUTTER)		M3	250	400.00	100,000.00	540.00	135,000.00
98 (F)	000003	MINOR CONCRETE (COLORED)		M2	1,890	44.00	83,160.00	53.00	100,170.00
99 (F)	731521	MINOR CONCRETE (SIDEWALK)		M3	260	345.00	89,700.00	480.00	124,800.00
100 (F)	731530	MINOR CONCRETE (TEXTURED PAVING)		M2	1,190	80.00	95,200.00	87.00	103,530.00
101 (F)	750001	MISCELLANEOUS IRON AND STEEL		KG	1,262	5.00	6,310.00	3.00	3,786.00
102	800391	CHAIN LINK FENCE (TYPE CL-1.8)		M	940	48.00	45,120.00	63.00	59,220.00
103	820105	DELINEATOR (SPECIAL)		EA	23	100.00	2,300.00	29.00	667.00
104	820107	DELINEATOR (CLASS 1)		EA	160	45.00	7,200.00	29.00	4,640.00
105	832003	METAL BEAM GUARD RAILING (WOOD POST)		M	670	80.00	53,600.00	87.00	58,290.00
106	839541	TRANSITION RAILING (TYPE WB)		EA	4	2,750.00	11,000.00	3,600.00	14,400.00

Beador Construction
Corona, CA 92883

Sukat Construction, Inc.
Riverside, CA 92505

**Riverside County Transportation Department
Summary of Bids**

PROJECT: I-10/Indian Canyon Drive Interchange Improvements

Advertised: March 16, 2010 (Agenda Item: 3.64)

Bids Open: 2 pm Date: Wednesday, April 28, 2010

PROJECT NO. A8-0372; ESPLHPLU-5282(034) & HP21L-5282 (035)

BASE BID (CONTINUED)		Beador Construction Corona, CA 92883		Sukut Construction, Inc. Riverside, CA 92505				
ITEM NO.	ITEM CODE	CONTRACT ITEM	UNITS	QUANTITY	BID UNIT PRICE	BID ESTIMATE	BID UNIT PRICE	BID ESTIMATE
107	839568	TERMINAL ANCHOR ASSEMBLY (TYPE SFT)	EA	5	680.00	3,400.00	636.00	3,180.00
108	839585	ALTERNATIVE FLARED TERMINAL SYSTEM [TYPE SRT]	EA	9	2,225.00	20,025.00	3,100.00	27,900.00
109	839605	CRASH CUSHION (REACT 9SCBS)	EA	3	54,200.00	162,600.00	6,400.00	19,200.00
110	839703	CONCRETE BARRIER (TYPE 60C)	M	270	265.00	71,550.00	350.00	94,500.00
111	839705	CONCRETE BARRIER (TYPE 60E)	M	89	510.00	45,390.00	460.00	40,940.00
112	840515	THERMOPLASTIC PAVEMENT MARKING	M2	360	15.00	5,400.00	48.00	17,280.00
113	840563	200 MM THERMOPLASTIC TRAFFIC STRIPE	M	1,210	1.60	1,936.00	4.00	4,840.00
114	840571	100 MM THERMOPLASTIC TRAFFIC STRIPE (BROKEN 5.18 M - 2.14 M)	M	9,600	0.75	7,200.00	1.90	18,240.00
115	840656	PAINT TRAFFIC STRIPE (2-COAT)	M	13,100	0.20	2,620.00	1.60	20,960.00
116	850101	PAVEMENT MARKER (NON-REFLECTIVE)	EA	15,300	1.00	15,300.00	1.75	26,775.00
117	850110	PAVEMENT MARKER (RETROREFLECTIVE-SPECIAL TYPE C)	EA	86	2.30	197.80	7.00	602.00
118	850111	PAVEMENT MARKER (RETROREFLECTIVE -SPECIAL TYPE D)	EA	790	2.00	1,580.00	7.00	5,530.00
119	850112	PAVEMENT MARKER (RETROREFLECTIVE-SPECIAL TYPE G)	EA	2,790	2.00	5,580.00	7.00	19,530.00
120	850113	PAVEMENT MARKER (RETROREFLECTIVE-SPECIAL TYPE H)	EA	450	2.00	900.00	7.00	3,150.00
121	860251	SIGNAL AND LIGHTING (LOCATION 1)	LS	1	107,000.00	107,000.00	165,000.00	165,000.00
122	860252	SIGNAL AND LIGHTING (LOCATION 2)	LS	1	102,000.00	102,000.00	165,000.00	165,000.00
123	860300	SIGNAL AND LIGHTING (CITY STREET LOCATION 1)	LS	1	180,000.00	180,000.00	200,000.00	200,000.00
124	860302	SIGNAL AND LIGHTING (CITY STREET LOCATION 2)	LS	1	175,000.00	175,000.00	220,000.00	220,000.00
125	860460	LIGHTING AND SIGN ILLUMINATION	LS	1	230,000.00	230,000.00	170,000.00	170,000.00
126	860701	INTERCONNECTION CONDUIT AND CONDUCTOR	LS	1	36,000.00	36,000.00	80,000.00	80,000.00
127	861101	RAMP METERING SYSTEM (LOCATION 1)	LS	1	49,000.00	49,000.00	80,000.00	80,000.00
128	861102	RAMP METERING SYSTEM (LOCATION 2)	LS	1	69,000.00	69,000.00	125,000.00	125,000.00
129	861103	RAMP METERING SYSTEM (LOCATION 3)	LS	1	50,000.00	50,000.00	90,000.00	90,000.00
130	861104	RAMP METERING SYSTEM (LOCATION 4)	LS	1	55,000.00	55,000.00	80,000.00	80,000.00
131	861349	REMOVE EXISTING SIGNAL SYSTEM (LOCATION 1)	LS	1	6,100.00	6,100.00	30,000.00	30,000.00
132	861350	REMOVE EXISTING SIGNAL SYSTEM (LOCATION 2)	LS	1	6,400.00	6,400.00	30,000.00	30,000.00
133	999990	MOBILIZATION	LS	1	1,800,000.00	1,800,000.00	1,540,000.00	1,540,000.00
134	000003	COURSE OF CONSTRUCTION INSURANCE	LS	1	52,000.00	52,000.00	140,000.00	140,000.00
135	019901	DEMOBILIZATION	LS	1	25,000.00	25,000.00	80,000.00	80,000.00
136	066102	DUST ABATEMENT	LS	1	25,000.00	25,000.00	33,920.00	33,920.00
137	066105	RESIDENT ENGINEER OFFICE	LS	1	50,000.00	50,000.00	40,704.00	40,704.00
138	066840	TRAFFIC SIGNAL CONTROLLER ASSEMBLY [WITH BATTERY BACK-UP][2-LOCATIONS]	LS	1	13,600.00	13,600.00	13,600.00	13,600.00
139	066843	MODEL 170 CONTROLLER ASSEMBLY [RAMP METER] [4-LOCATIONS]	LS	1	19,200.00	19,200.00	19,200.00	19,200.00
140	066015	FEDERAL TRAINEE PROGRAM	LS	1	5,000.00	5,000.00	12,720.00	12,720.00
141	047403	610 MM STEEL PIPE CASING	M	26	665.00	17,290.00	600.00	15,600.00

**Riverside County Transportation Department
Summary of Bids**

PROJECT: I-10/Indian Canyon Drive Interchange Improvements

Advised: March 16, 2010 (Agenda Item: 3.64)

Bids Open: 2 pm Date: Wednesday, April 28, 2010

PROJECT NO. A8-0372; ESPLHPLU-5282(034); HP21-L-5282 (035)

BASE BID (CONTINUED)		Beador Construction Corona, CA 92883		Suket Construction, Inc. Riverside, CA 92505				
ITEM NO.	ITEM CODE	CONTRACT ITEM	UNITS	QUANTITY	BID UNIT PRICE	BID ESTIMATE	BID UNIT PRICE	BID ESTIMATE
142	157550	BRIDGE REMOVAL	LS	1	72,000.00	72,000.00	105,000.00	105,000.00
143 (F)	192003	STRUCTURE EXCAVATION (BRIDGE)	M3	1,150	80.00	92,000.00	195.00	224,250.00
144 (F)	193003	STRUCTURE BACKFILL (BRIDGE)	M3	490	155.00	75,950.00	137.00	67,130.00
145	490566	FURNISH STEEL PILING (HP 360 X 132)	M	2,977	150.00	446,550.00	120.00	357,240.00
146	490567	DRIVE STEEL PILE (HP 360 X 132)	EA	196	1,080.00	211,680.00	1,050.00	205,800.00
147	*****	ITEM DELETED BY ADDENDUM	*****	*****	*****	*****	*****	*****
148	*****	ITEM DELETED BY ADDENDUM	*****	*****	*****	*****	*****	*****
149	500020	PRESTRESSING PRECAST GIRDER	LS	1	90,000.00	90,000.00	98,000.00	98,000.00
150 (F)	510051	STRUCTURAL CONCRETE, BRIDGE FOOTING	M3	220	550.00	121,000.00	525.00	115,500.00
151 (F)	510053	STRUCTURAL CONCRETE, BRIDGE	M3	1,710	650.00	1,111,500.00	975.00	1,667,250.00
152 (F)	510086	STRUCTURAL CONCRETE, APPROACH SLAB (TYPE N)	M3	210	640.00	134,400.00	775.00	162,750.00
153	511036	ARCHITECTURAL SURFACE [LAVA ROCK FACING]	M2	170	97.00	16,490.00	42.00	7,140.00
154 (F)	511063	FRACTURED FIN TEXTURE	M2	140	54.00	7,560.00	73.00	10,220.00
155	512254	FURNISH PRECAST PRESTRESSED CONCRETE BULB-TEE GIRDER (25 M-30 M)	EA	26	18,000.00	468,000.00	20,000.00	520,000.00
156	512255	FURNISH PRECAST PRESTRESSED CONCRETE BULB-TEE GIRDER (30 M-35 M)	EA	13	18,165.00	236,145.00	22,000.00	286,000.00
157	512500	ERECT PRECAST PRESTRESSED CONCRETE GIRDER	EA	39	1,970.00	76,830.00	1,950.00	76,050.00
158	519123	JOINT SEAL (TYPE B - MR 50 MM)	M	72	440.00	31,680.00	200.00	14,400.00
159 (F)	520102	BAR REINFORCING STEEL (BRIDGE)	KG	244,000	1.60	390,400.00	1.30	317,200.00
160 (F)	721810	SLOPE PAVING (CONCRETE)	M3	72	620.00	44,640.00	1,050.00	75,600.00
161 (F)	750505	BRIDGE DECK DRAINAGE SYSTEM	KG	470	27.00	12,690.00	52.00	24,440.00
162 (F)	833088	TUBULAR HANDRAILING	M	10	430.00	4,300.00	348.00	3,480.00
163 (F)	833142	CONCRETE BARRIER (TYPE 26 MODIFIED)	M	110	500.00	55,000.00	475.00	52,250.00
164	839727	CONCRETE BARRIER (TYPE 736 MODIFIED)	M	110	335.00	36,850.00	550.00	60,500.00
165 (F)	833020	CHAIN LINK RAILING [MINI MESH]	M	91	1,000.00	91,000.00	139.00	12,649.00
BSAE BID TOTAL						18,137,019.00		20,075,661.50
ITEMS 1 - 165								

ALTERNATE BID:

THE MISSION SPRINGS WATER DISTRICT		ADJUST WATER VALVE COVER TO GRADE		ALTERNATE BID TOTAL				
ITEM NO.	ITEM CODE	CONTRACT ITEM	UNITS	QUANTITY	BID UNIT PRICE	BID ESTIMATE		
166	0000003	ADJUST WATER VALVE COVER TO GRADE	EA	14	1,000.00	14,000.00	530.00	7,420.00
ALTERNATE BID TOTAL						14,000.00		7,420.00
ITEMS 166								
PROJECT TOTAL						18,151,019.00		20,083,101.50
ITEMS 1 - 166								

AGREEMENT

COUNTY OF RIVERSIDE

PROJECT NO. A8-0372

ESPLHPLU-5282 (034) AND HP21L-5282 (035)

THIS AGREEMENT, made and concluded in duplicate as of the date set forth below, between the County of Riverside, party of the first part, and Granite Construction Company, Contractor, party of the second part.

ARTICLE I: WITNESSETH, that for and in consideration of the payments and agreements hereinafter mentioned, to be made and performed by the said party of the first part, and under the conditions expressed in the two bonds, bearing even date with these presents, the said party of the second part agrees with the said party of the first part, at his own proper cost and expense, to do all the work and furnish all the materials, except such as are mentioned in the specifications to be furnished by said party of the first part, necessary to construct and complete in a good, workmanlike and substantial manner and to the satisfaction of the County of Riverside, in accordance with the Special Provisions, "Notice to Contractors", the State of California Department of Industrial Relations Wage Determination, the Federal Wage Determination, the Proposal to the County of Riverside for the Project, addendum No. **1 through 3**, the Bid Bond, the Performance Bond, the Payment Bond, any specific plans for the project not covered by the Standard Specifications and Standard Plans, any change orders issued, and any written instructions and drawings executed and delivered to the Contractor by the County pursuant to the Contract Documents. Also in accordance with the **Standard Plans, dated May 2006**, the **Standard Specifications, dated May 2006**, the General Prevailing Wage Rates of the Department of Transportation, with the effective date being the date of advertisement, and the Labor Surcharge and Equipment Rental Rates, with the effective date being the date of advertisement, and the Labor Surcharge and Equipment Rental Rates, with the effective date being the date of accomplishing the work, which said special provisions Standard Plans, Standard Specifications, Prevailing Wage Rates, and Labor Surcharge and Equipment Rental Rates are hereby specially referred to and by such reference, made a part hereof.

The work to be done is shown on plans entitled **Indian Canyon Drive at Interstate 10 Reconstruction of Interchange**. Project Sheets 1 through 358, approved March 2, 2010 on file with the County Surveyor file No.206-1 through 358, and as revised by addenda, which said project plans are hereby made a part of this contract.

ARTICLE II: The said party of the first part hereby promises and agrees with the said Contractor to employ, and does hereby employ, the said Contractor to provide the materials and to do the work according to the terms and conditions herein contained and

referred to, for the prices hereinafter set forth, and hereby contracts to pay the same at the time, in the manner and upon the conditions herein set forth; and the said parties for themselves, their heirs, executors, administrators, successors and assigns, do hereby agree to the full performance of the covenants herein contained.

ARTICLE III: The statement of prevailing wages appearing in the General Prevailing Wage Rates is hereby specifically referred to and by this reference is made a part of this contract. It is further expressly agreed by and between the parties hereto that should there be any conflict between the terms of this instrument and the bid or proposal of said Contractor, then this instrument shall control and nothing herein shall be considered as an acceptance of the said terms of said proposal conflicting herewith.

ARTICLE IV: By my signature hereunder, as Contractor, I certify that I am aware of the provisions of Section 3700 of the Labor Code which require every employer to be insured against liability for workmen's compensation or to undertake self-insurance in accordance with the provisions of that code and I will comply with such provisions before commencing the performance of the work of this contract.

ARTICLE V: And the said Contractor agrees to receive and accept the following prices as full compensation for furnishing all materials and for doing all the work contemplated and embraced in this agreement; also for all loss or damage, arising out of the nature of the work aforesaid, or from the action of the elements, or from any unforeseen difficulties or obstructions which may arise or be encountered in the prosecution of the work until its acceptance by the County of Riverside, and for all risks of every description connected with the work; also for all expenses incurred by or in consequence of the suspension or discontinuance of work and for well and faithfully completing the work, and the whole thereof, in the manner and according to the plans and specifications, and the requirements of the Engineer under them, to wit:

**INDIAN CANYON DRIVE AT INTERSTATE 10
RECONSTRUCTION OF INTERCHANGE
PROJECT NO. A8-0372
FEDERAL AID NO. ESPLHPLU-5282(034) AND HP21L-5282(035)**

AGREEMENT

BASE BID:

ITEM NO.	ITEM CODE	ITEM	UNIT	ESTIMATED QUANTITY	ITEM PRICE (IN FIGURES)	TOTAL (IN FIGURES)
1.	000003	ENDANGERED SPECIES PROTECTION	LS	1	2,000.00	2,000.00
2.	000003	NONNATIVE PLANT PRECLUSION	LS	1	1,500.00	1,500.00
3.	000003	CONSTRUCTION MONITORING CAMERA (POLE AND ELECTRIC SERVICE)	LS	1	985.00	985.00
4(S,F)	000003	METAL SCRIPT LETTERS (RAILING METHOD)	LS	1	6,500.00	6,500.00
5.	-----	ITEM DELETED BY ADDENDUM	-----	-----	-----	-----
6.	070012	PROGRESS SCHEDULE (CRITICAL PATH METHOD)	LS	1	4,500.00	4,500.00
7.	071325	TEMPORARY FENCE (TYPE ESA)	M	610	14.00	8,540.00
8.	000003	TEMPORARY FENCE (TYPE WILDLIFE)	M	610	18.00	10,980.00
9.	074016	CONSTRUCTION SITE MANAGEMENT	LS	1	15,000.00	15,000.00
10.	074020	WATER POLLUTION CONTROL	LS	1	500.00	500.00
11.	074018	HEALTH AND SAFETY PLAN	LS	1	500.00	500.00
12.	074028	TEMPORARY FIBER ROLLS	M	10,800	7.00	75,600.00
13.	074029	TEMPORARY SILT FENCE	M	960	17.00	16,320.00
14.	074033	TEMPORARY CONSTRUCTION ENTRANCE	EA	3	4,500.00	13,500.00
15.	074035	TEMPORARY CHECK DAM	M	52	35.00	1,820.00
16.	074037	MOVE-IN/MOVE-OUT (TEMPORARY EROSION CONTROL)	EA	4	350.00	1,400.00
17.	074038	TEMPORARY DRAINAGE INLET PROTECTION	EA	39	125.00	4,875.00
18.	074039	TEMPORARY HYDRAULIC MULCH (POLMER STABILIZED FIBER MATRIX)	M2	136,000	0.20	27,200.00
19.	074041	STREET SWEEPING	LS	1	65,000.00	65,000.00
20.	074042	TEMPORARY CONCRETE WASHOUT (PORTABLE)	LS	1	8,500.00	8,500.00
21.	120090	CONSTRUCTION AREA SIGNS	LS	1	18,000.00	18,000.00
22.	120100	TRAFFIC CONTROL SYSTEMS	LS	1	150,000.00	150,000.00
23.	120120	TYPE III BARRICADE	EA	140	35.00	4,900.00
24.	120143	TEMPORARY PAVEMENT DELINEATION	M	4,460	5.00	22,300.00
25.	120149	TEMPORARY PAVEMENT MARKING (PAINT)	M2	100	40.00	4,000.00
26.	120199	TRAFFIC PLASTIC DRUM	EA	590	30.00	17,700.00

**AGREEMENT
(CONTINUED)**

ITEM NO.	ITEM CODE	ITEM	UNIT	ESTIMATED QUANTITY	ITEM PRICE (IN FIGURES)	TOTAL (IN FIGURES)
27.	128650	PORTABLE CHANGEABLE MESSAGE SIGN	EA	10	7,500.00	75,000.00
28.	129000	TEMPORARY RAILING (TYPE K)	M	5,300	27.00	143,100.00
29.	129110	TEMPORARY CRASH CUSHION [SAND FILLED]	EA	210	275.00	57,750.00
30.	129110	TEMPORARY CRASH CUSHION [ABSORB 350]	EA	6	11,500.00	69,000.00
31.	150701	REMOVE YELLOW TRAFFIC STRIPE [HAZARDOUS WASTE]	M	2,870	2.50	7,175.00
32.	150608	REMOVE CHAIN LINK FENCE	M	610	14.00	8,540.00
33.	150659	REMOVE TERMINAL SECTION	EA	3	2,000.00	6,000.00
34.	150662	REMOVE METAL BEAM GUARD RAILING	M	660	22.00	14,520.00
35.	150710	REMOVE TRAFFIC STRIPE	M	34,100	1.90	64,790.00
36.	150713	REMOVE PAVEMENT MARKING	M2	52	20.00	1,040.00
37.	150722	REMOVE PAVEMENT MARKER	EA	8,520	2.00	17,040.00
38.	150742	REMOVE ROADSIDE SIGN	EA	43	100.00	4,300.00
39.	150760	REMOVE SIGN STRUCTURE	EA	2	3,500.00	7,000.00
40.	150806	REMOVE CULVERT	M	360	60.00	21,600.00
41.	150820	REMOVE INLET	EA	1	1,000.00	1,000.00
42.	150821	REMOVE HEADWALL	EA	21	275.00	5,775.00
43.	153153	COLD PLANE ASPHALT CONCRETE PAVEMENT (45 MM MAXIMUM)	M2	1,080	8.50	9,180.00
44.	160101	CLEARING AND GRUBBING	LS	1	82,500.00	82,500.00
45.	170101	DEVELOP WATER SUPPLY	LS	1	10,000.00	10,000.00
46 (F)	190101	ROADWAY EXCAVATION	M3	29,170	15.00	437,550.00
47.	190110	LEAD COMPLIANCE PLAN (METRIC)	LS	1	500.00	500.00
48.	190113	ASBESTOS COMPLIANCE PLAN	LS	1	500.00	500.00
49.	193118	CONCRETE BACKFILL	M3	14	225.00	3,150.00
50.	194001	DITCH EXCAVATION	M3	320	8.00	2,560.00
51.	198001	IMPORTED BORROW	M3	71,000	7.25	514,750.00
52.	203016	EROSION CONTROL (TYPE D)	M2	13,200	0.65	8,580.00
53.	203021	FIBER ROLLS (METRIC)	M	10,500	8.00	84,000.00
54.	203026	MOVE-IN/MOVE-OUT (EROSION CONTROL)	EA	1	350.00	350.00
55.	208731	200 MM CORRUGATED HIGH DENSITY POLYETHYLENE PIPE CONDUIT	M	68	200.00	13,600.00

**AGREEMENT
(CONTINUED)**

ITEM NO.	ITEM CODE	ITEM	UNIT	ESTIMATED QUANTITY	ITEM PRICE (IN FIGURES)	TOTAL (IN FIGURES)
56.	220101	FINISHING ROADWAY	LS	1	25,000.00	25,000.00
57.	260201	CLASS 2 AGGREGATE BASE	M3	14,600	22.00	321,200.00
58.	280000	LEAN CONCRETE BASE	M3	190	200.00	38,000.00
59.	374002	ASPHALTIC EMULSION (FOG SEAL COAT)	TONN	6	3,000.00	18,000.00
60.	390106	ASPHALT CONCRETE (OPEN GRADED) [OPEN GRADED FRICTION COURSE]	TONN	1,310	90.00	117,900.00
61.	390130	HOT MIX ASPHALT (TYPE A)	TONN	320	99.50	31,840.00
62.	000003	HOT MIX ASPHALT (TYPE A BOND BREAKER)	TONN	120	110.00	13,200.00
63.	000003	HOT MIX ASPHALT (TYPE C)	TONN	31,200	71.00	2,215,200.00
64.	394071	PLACE HOT MIX ASPHALT DIKE	M	4,570	6.50	29,705.00
65.	394090	PLACE HOT MIX ASPHALT (MISCELLANEOUS AREA)	M2	320	40.00	12,800.00
66.	397005	TACK COAT	TONN	38	1,400.00	53,200.00
67.	401066	CONCRETE PAVEMENT (EXIT RAMP TERMINI) [JOINTED PLAIN CONCRETE PAVEMENT]	M3	430	275.00	118,250.00
68.	401108	RAPID STRENGTH CONCRETE [JOINTED PLAIN CONCRETE PAVEMENT]	M3	3,780	205.00	774,900.00
69.	000003	SEAL ISOLATION JOINT	M	1,280	4.00	5,120.00
70.	414091	SEAL LONGITUDINAL JOINT	M	2,140	4.00	8,560.00
71.	414101	SEAL TRANSVERSE JOINT	M	2,120	4.00	8,480.00
72.	518201	MASONRY STONE WALL	M2	23	800.00	18,400.00
73 (F)	510129	CLASS 2 CONCRETE (BOX CULVERT)	M3	190	1,000.00	190,000.00
74 (F)	510502	MINOR CONCRETE (MINOR STRUCTURE)	M3	110	2,000.00	220,000.00
75 (F)	520107	BAR REINFORCING STEEL (BOX CULVERT)	KG	21,271	2.00	42,542.00
76 (F)	560218	FURNISH SIGN STRUCTURE (TRUSS)	KG	30,000	9.00	270,000.00
77 (F)	560219	INSTALL SIGN STRUCTURE (TRUSS)	KG	30,000	1.00	30,000.00
78.	560234	FURNISH LAMINATED PANEL SIGN (25.4 MM -TYPE A)	M2	67	250.00	16,750.00
79.	560238	FURNISH SINGLE SHEET ALUMINUM SIGN (1.6 MM-UNFRAMED)	M2	56	125.00	7,000.00
80.	560239	FURNISH SINGLE SHEET ALUMINUM SIGN (2.0 MM-UNFRAMED)	M2	30	140.00	4,200.00
81.	560241	FURNISH SINGLE SHEET ALUMINUM SIGN (1.6 MM-FRAMED)	M2	13	135.00	1,755.00
82.	560242	FURNISH SINGLE SHEET ALUMINUM SIGN (2.0 MM-FRAMED)	M2	71	150.00	10,650.00
83.	561015	1524 MM CAST-IN-DRILLED-HOLE CONCRETE PILE (SIGN FOUNDATION)	M	23	4,000.00	92,000.00
84.	566011	ROADSIDE SIGN - ONE POST	EA	85	350.00	29,750.00

AGREEMENT (CONTINUED)

ITEM NO.	ITEM CODE	ITEM	UNIT	ESTIMATED QUANTITY	ITEM PRICE (IN FIGURES)	TOTAL (IN FIGURES)
85.	566012	ROADSIDE SIGN - TWO POST	EA	17	575.00	9,775.00
86.	568001	INSTALL SIGN (STRAP AND SADDLE BRACKET METHOD)	EA	8	350.00	2,800.00
87.	568015	INSTALL SIGN (MAST-ARM HANGER METHOD)	EA	22	375.00	8,250.00
88.	620909	450 MM ALTERNATIVE PIPE CULVERT	M	71	160.00	11,360.00
89.	620913	600 MM ALTERNATIVE PIPE CULVERT	M	230	170.00	39,100.00
90.	620924	900 MM ALTERNATIVE PIPE CULVERT	M	120	180.00	21,600.00
91.	664097	600 MM BITUMINOUS COATED CORRUGATED STEEL PIPE (2.77 MM THICK)	M	200	200.00	40,000.00
92.	664110	900 MM BITUMINOUS COATED CORRUGATED STEEL PIPE (2.77 MM THICK)	M	50	225.00	11,250.00
93.	717072	100 MM POLYVINYL CHLORIDE SEWER PIPE	M	37	50.00	1,850.00
94.	721008	ROCK SLOPE PROTECTION (LIGHT, METHOD B)	M3	140	160.00	22,400.00
95.	721430	CONCRETE (CHANNEL LINING)	M3	73	500.00	36,500.00
96.	729010	ROCK SLOPE PROTECTION FABRIC	M2	330	25.00	8,250.00
97(F)	731504	MINOR CONCRETE (CURB AND GUTTER)	M3	250	775.00	193,750.00
98(F)	000003	MINOR CONCRETE (COLORED)	M2	1,890	120.00	226,800.00
99(F)	731521	MINOR CONCRETE (SIDEWALK)	M3	260	525.00	136,500.00
100(F)	731530	MINOR CONCRETE (TEXTURED PAVING)	M2	1,190	125.00	148,750.00
101(F)	750001	MISCELLANEOUS IRON AND STEEL	KG	1,262	10.00	12,620.00
102.	800391	CHAIN LINK FENCE (TYPE CL-1.8)	M	940	65.00	61,100.00
103.	820105	DELINEATOR (SPECIAL)	EA	23	60.00	1,380.00
104.	820107	DELINEATOR (CLASS 1)	EA	160	50.00	8,000.00
105.	832003	METAL BEAM GUARD RAILING (WOOD POST)	M	670	99.00	66,330.00
106.	839541	TRANSITION RAILING (TYPE WB)	EA	4	6,000.00	24,000.00
107.	839568	TERMINAL ANCHOR ASSEMBLY (TYPE SFT)	EA	5	900.00	4,500.00
108.	839585	ALTERNATIVE FLARED TERMINAL SYSTEM [TYPE SRT]	EA	9	3,500.00	31,500.00
109.	839605	CRASH CUSHION (REACT 9SCBS)	EA	3	75,000.00	225,000.00
110.	839703	CONCRETE BARRIER (TYPE 60C)	M	270	525.00	141,750.00
111.	839705	CONCRETE BARRIER (TYPE 60E)	M	89	515.00	45,835.00
112.	840515	THERMOPLASTIC PAVEMENT MARKING	M2	360	40.00	14,400.00
113.	840563	200 MM THERMOPLASTIC TRAFFIC STRIPE	M	1,210	3.00	3,630.00

**AGREEMENT
(CONTINUED)**

ITEM NO.	ITEM CODE	ITEM	UNIT	ESTIMATED QUANTITY	ITEM PRICE (IN FIGURES)	TOTAL (IN FIGURES)
114	840571	100 MM THERMOPLASTIC TRAFFIC STRIPE (BROKEN 5.18 M - 2.14 M)	M	9,600	2.25	21,600.00
115	840656	PAINT TRAFFIC STRIPE (2-COAT)	M	13,100	1.25	16,375.00
116	850101	PAVEMENT MARKER (NON-REFLECTIVE)	EA	15,300	2.10	32,130.00
117	850110	PAVEMENT MARKER (RETROREFLECTIVE-SPECIAL TYPE C)	EA	86	5.00	430.00
118	850111	PAVEMENT MARKER (RETROREFLECTIVE -SPECIAL TYPE D)	EA	790	5.00	3,950.00
119	850112	PAVEMENT MARKER (RETROREFLECTIVE-SPECIAL TYPE G)	EA	2,790	5.00	13,950.00
120	850113	PAVEMENT MARKER (RETROREFLECTIVE-SPECIAL TYPE H)	EA	450	5.00	2,250.00
121	860251	SIGNAL AND LIGHTING (LOCATION 1)	LS	1	210,000.00	210,000.00
122	860252	SIGNAL AND LIGHTING (LOCATION 2)	LS	1	195,000.00	195,000.00
123	860300	SIGNAL AND LIGHTING (CITY STREET LOCATION 1)	LS	1	235,000.00	235,000.00
124	860302	SIGNAL AND LIGHTING (CITY STREET LOCATION 2)	LS	1	250,000.00	250,000.00
125	860460	LIGHTING AND SIGN ILLUMINATION	LS	1	590,000.00	590,000.00
126	860701	INTERCONNECTION CONDUIT AND CONDUCTOR	LS	1	160,000.00	160,000.00
127	861101	RAMP METERING SYSTEM (LOCATION 1)	LS	1	130,000.00	130,000.00
128	861102	RAMP METERING SYSTEM (LOCATION 2)	LS	1	140,000.00	140,000.00
129	861103	RAMP METERING SYSTEM (LOCATION 3)	LS	1	120,000.00	120,000.00
130	861104	RAMP METERING SYSTEM (LOCATION 4)	LS	1	130,000.00	130,000.00
131	861349	REMOVE EXISTING SIGNAL SYSTEM (LOCATION 1)	LS	1	80,000.00	80,000.00
132	861350	REMOVE EXISTING SIGNAL SYSTEM (LOCATION 2)	LS	1	80,000.00	80,000.00
133	999990	MOBILIZATION	LS	1	834,000.00	834,000.00
134	000003	COURSE OF CONSTRUCTION INSURANCE	LS	1	8,000.00	8,000.00
135	019901	DEMOBILIZATION	LS	1	500.00	500.00
136	066102	DUST ABATEMENT	LS	1	45,000.00	45,000.00
137	066105	RESIDENT ENGINEER OFFICE	LS	1	25,000.00	25,000.00
138	066840	TRAFFIC SIGNAL CONTROLLER ASSEMBLY [WITH BATTERY BACK-UP] [2-LOCATIONS]	LS	1	13,600.00	13,600.00
139	066843	MODEL 170 CONTROLLER ASSEMBLY [RAMP METER] [4-LOCATIONS]	LS	1	19,200.00	19,200.00
140	066015	FEDERAL TRAINEE PROGRAM	LS	1	5,000.00	5,000.00
141	047403	610 MM STEEL PIPE CASING	M	26	1,000.00	26,000.00

**AGREEMENT
(CONTINUED)**

ITEM NO.	ITEM CODE	ITEM	UNIT	ESTIMATED QUANTITY	ITEM PRICE (IN FIGURES)	TOTAL (IN FIGURES)
142	157550	BRIDGE REMOVAL	LS	1	85,000.00	85,000.00
143(F)	192003	STRUCTURE EXCAVATION (BRIDGE)	M3	1,150	90.00	103,500.00
144(F)	193003	STRUCTURE BACKFILL (BRIDGE)	M3	490	125.00	61,250.00
145	490566	FURNISH STEEL PILING (HP 360 X 132)	M	2,977	165.00	491,205.00
146	490567	DRIVE STEEL PILE (HP 360 X 132)	EA	196	1,525.00	298,900.00
147	-----	ITEM DELETED BY ADDENDUM	-----	-----	-----	-----
148	-----	ITEM DELETED BY ADDENDUM	-----	-----	-----	-----
149	500020	PRESTRESSING PRECAST GIRDER	LS	1	95,000.00	95,000.00
150(F)	510051	STRUCTURAL CONCRETE, BRIDGE FOOTING	M3	220	425.00	93,500.00
151(F)	510053	STRUCTURAL CONCRETE, BRIDGE	M3	1,710	870.00	1,487,700.00
152(F)	510086	STRUCTURAL CONCRETE, APPROACH SLAB (TYPE N)	M3	210	650.00	136,500.00
153	511036	ARCHITECTURAL SURFACE [LAVA ROCK FACING]	M2	170	250.00	42,500.00
154 (F)	511063	FRACTURED FIN TEXTURE	M2	140	130.00	18,200.00
155	512254	FURNISH PRECAST PRESTRESSED CONCRETE BULB-TEE GIRDER (25 M-30 M)	EA	26	20,000.00	520,000.00
156	512255	FURNISH PRECAST PRESTRESSED CONCRETE BULB-TEE GIRDER (30 M-35 M)	EA	13	24,000.00	312,000.00
157	512500	ERECT PRECAST PRESTRESSED CONCRETE GIRDER	EA	39	2,200.00	85,800.00
158	519123	JOINT SEAL (TYPE B - MR 50 MM)	M	72	300.00	21,600.00
159(F)	520102	BAR REINFORCING STEEL (BRIDGE)	KG	244,000	2.00	488,000.00
160(F)	721810	SLOPE PAVING (CONCRETE)	M3	72	1,360.00	97,920.00
161(F)	750505	BRIDGE DECK DRAINAGE SYSTEM	KG	470	22.50	10,575.00
162(F)	833088	TUBULAR HANDRAILING	M	10	240.00	2,400.00
163(F)	833142	CONCRETE BARRIER (TYPE 26 MODIFIED)	M	110	690.00	75,900.00
164	839727	CONCRETE BARRIER (TYPE 736 MODIFIED)	M	110	420.00	46,200.00
165(F)	833020	CHAIN LINK RAILING [MINI MESH]	M	91	1,250.00	113,750.00

SUBTOTAL, BASE BID, ITEMS 1-165:

Sixteen million, five hundred ten thousand, seven hundred thirty seven dollars and zero cents. \$ 16,510,737.00

**AGREEMENT
(CONTINUED)**

**ALTERNATE BID:
THE MISSION SPRING WATER DISTRICT**

ITEM NO.	ITEM CODE	ITEM	UNIT	ESTIMATED QUANTITY	ITEM PRICE (IN FIGURES)	TOTAL (IN FIGURES)
----------	-----------	------	------	--------------------	-------------------------	--------------------

166	000003	ADJUST WATER VALVE COVER TO GRADE	EA	14	1,100.00	15,400.00
-----	--------	-----------------------------------	----	----	----------	-----------

SUBTOTAL, ALTERNATE BID, ITEM 166:

Fifteen Thousands, Four hundred dollars and zero cents. **\$ 15,400.00**

PROJECT TOTAL, ITEMS 1-166:

Sixteen million, five hundred twenty six thousand, one hundred thirty seven dollars and zero cents. **\$ 16,526,137.00**

IN WITNESS WHEREOF the parties hereto have executed this agreement as of the date set forth below.

COUNTY OF RIVERSIDE

GRANITE CONSTRUCTION COMPANY

BY _____
Chairman, Board of Supervisors

BY _____

Dated _____

TITLE: _____
(If Corporation, Affix Seal)

ATTEST:
Kecia Harper-Ihem, Clerk of the Board

ATTEST:

BY _____
Deputy

TITLE: _____

FORM APPROVED COUNTY COUNSEL
BY: Neal R. Kipnis DATE 5/13/18
NEAL R. KIPNIS

Licensed in accordance with an act providing for the registration of Contractors,

License No. _____

Federal Employer Identification Number: _____

BY _____
"County"
(Seal)

"Corporation"
(Seal)