

**SUBMITTAL TO THE BOARD OF SUPERVISORS
COUNTY OF RIVERSIDE, STATE OF CALIFORNIA**

92374



FROM: TLMA - Transportation Department

SUBMITTAL DATE:
June 03, 2010

SUBJECT: Construction of pedestrian sidewalk and associated improvements on Krameria Avenue in the Woodcrest area and on Mayberry Avenue in the Valle Vista area.

RECOMMENDED MOTION: That the Board accept the low bid of Mamco, Inc. of Riverside CA, in the amount of \$264,277. Award the contract to that firm and authorize the Chairman of the Board to execute the contract documents. Amend the TIP by approval of the proposed budget for Krameria Avenue as shown on Attachment A.

BACKGROUND: By Minute Order dated April 20, 2010 (agenda item 3.72) the Board authorized the Clerk of the Board to advertise for the Construction of pedestrian sidewalk and associated improvements on Krameria Avenue in the Woodcrest area and on Mayberry Avenue in the Valle Vista Area. Bids for the project were opened in the office of the Director of Transportation at 2:00 PM, Wednesday, May 05, 2010. Five bids were received. The

Juan C. Perez
Director of Transportation

JCP:jj:rr
(Continued On Attached Pages)

FINANCIAL DATA	Current F.Y. Total Cost:	\$ 264,277	In Current Year Budget:	Yes				
	Current F.Y. Net County Cost:	\$ 0	Budget Adjustment:	No				
	Annual Net County Cost:	\$ 0	For Fiscal Year:	2009/2010				
SOURCE OF FUNDS: Measure A / Western (52%), SB 821 Bicycle and Pedestrian Facilities Program (48%)				<table border="1"> <tr> <td>Positions To Be Deleted Per A-30</td> <td><input type="checkbox"/></td> </tr> <tr> <td>Requires 4/5 Vote</td> <td><input type="checkbox"/></td> </tr> </table>	Positions To Be Deleted Per A-30	<input type="checkbox"/>	Requires 4/5 Vote	<input type="checkbox"/>
Positions To Be Deleted Per A-30	<input type="checkbox"/>							
Requires 4/5 Vote	<input type="checkbox"/>							

C.E.O. RECOMMENDATION:

APPROVE

BY:
Tina Grande

County Executive Office Signature

Policy
 Policy

Consent
 Consent

Dep't Recomm.:
 Per Exec. Ofc.:

Prev. Agn. Ref. 4/20/10 item 3.72 | District: 1,3 | Agenda Number:

FORM APPROVED COUNTY COUNSEL
BY:
MARSHAL VICTOR
5/19/10
DATE

Departmental Concurrence

The Honorable Board of Supervisors

RE: Construction of pedestrian sidewalk and associated improvements on Krameria Avenue in the Woodcrest area and on Mayberry Avenue in the Valle Vista area.

June 03, 2010

Page 2 of 2

Transportation Department's established basis for the selection of a contractor is the lowest responsive and responsible bid for all schedules of work. The lowest and best total bid was submitted by Mamco, Inc of Riverside CA, in the amount of \$264,277. The bid is \$ 139,923 (34.6%) below the Engineer's Estimate.

Krameria Avenue improvements include construction of sidewalk on both north and south sides of Krameria Avenue between Lois Lane and Washington Street. All existing obstructions such as fences, road signs, irrigation systems, mailboxes, trees, and water meters will be relocated as needed. Additional improvements such as widening, additional curb and gutter, curb returns, and curb outlets will also be constructed.

Mayberry Avenue improvements include construction of sidewalk on the south side of Mayberry Avenue between Darmouth Middle School and Stanford Street. All existing obstructions such as fences, road signs, irrigation systems, mailboxes, trees, and water meters will be relocated as needed. Additional improvements such as widening, additional curb and gutter, curb returns, and curb outlets will also be constructed.

The proposed sidewalk will provide a safe path of travel to school. Additional safety improvements include the installation of an access ramp at the intersection of Mayberry Avenue and Standford Street.

The bid documents include the following schedules of work:

Schedule A: Primary items of work on Krameria Avenue.

Alternate 1: Krameria Avenue, adjustment and relocation of water meters and fire hydrants, to be funded by the Western Municipal Water District. (Items 24-27)

Schedule B: Primary items of work on Mayberry Avenue.

Alternate 2: Mayberry Avenue, relocation of water meters, to be funded by the project, (Item 51) due to prior property rights of the District.

The work contemplated under Alternate bid schedule 1 will be performed by the utility owner, Western Municipal Water District, and that schedule of work is not recommended for award.

The work included in Alternate bid schedule 2 is recommended for award.

The Mayberry Avenue project is within the existing budget as shown on Attachment A.

The Contractor will execute the contract and provide bonds and insurance documents after Board approval. The Contractor is qualified.

Project No. B8-0672, Krameria Avenue

Project No. B9-0941, Mayberry Avenue

MAYBERRY AVENUE CONSTRUCT SIDEWALK PROJECT

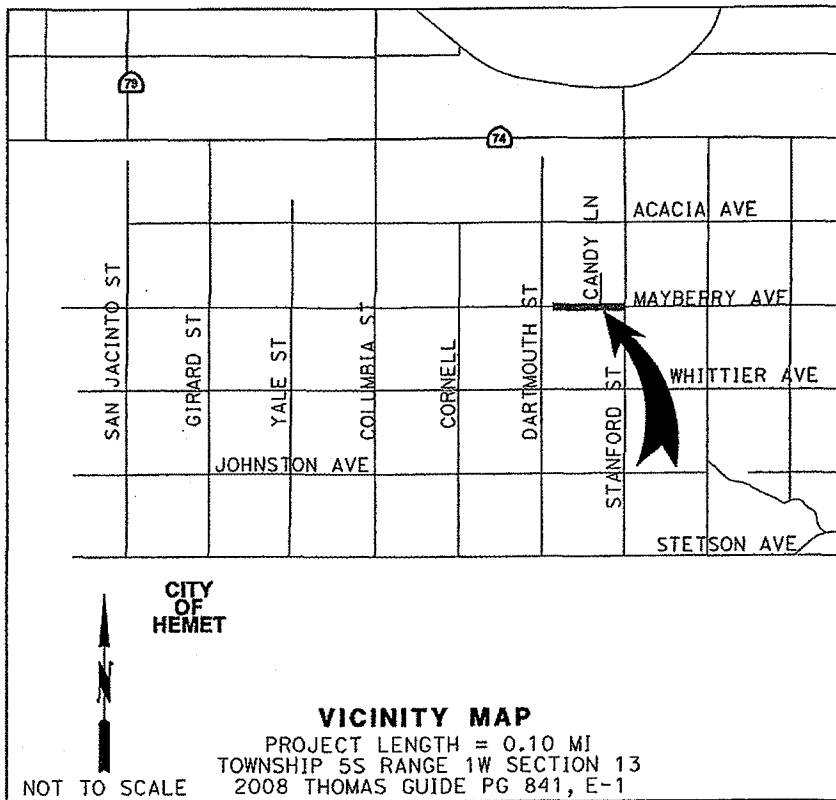
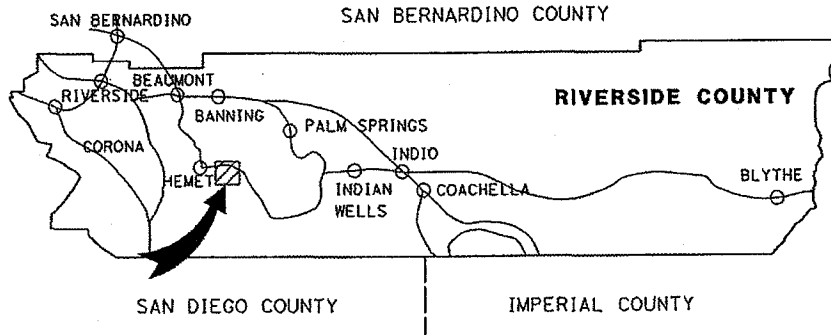

VICINITY MAP

SCALE NONE

EXHIBIT "A"

MAYBERRY AVENUE

CONSTRUCT SIDEWALK PROJECT

DARTMOUTH MIDDLE SCHOOL TO STANFORD ST.

**COUNTY OF RIVERSIDE
DEPARTMENT OF TRANSPORTATION**

**KRAMERIA AVENUE
SIDEWALK PROJECT
WASHINGTON ST. TO LOIS LN.**

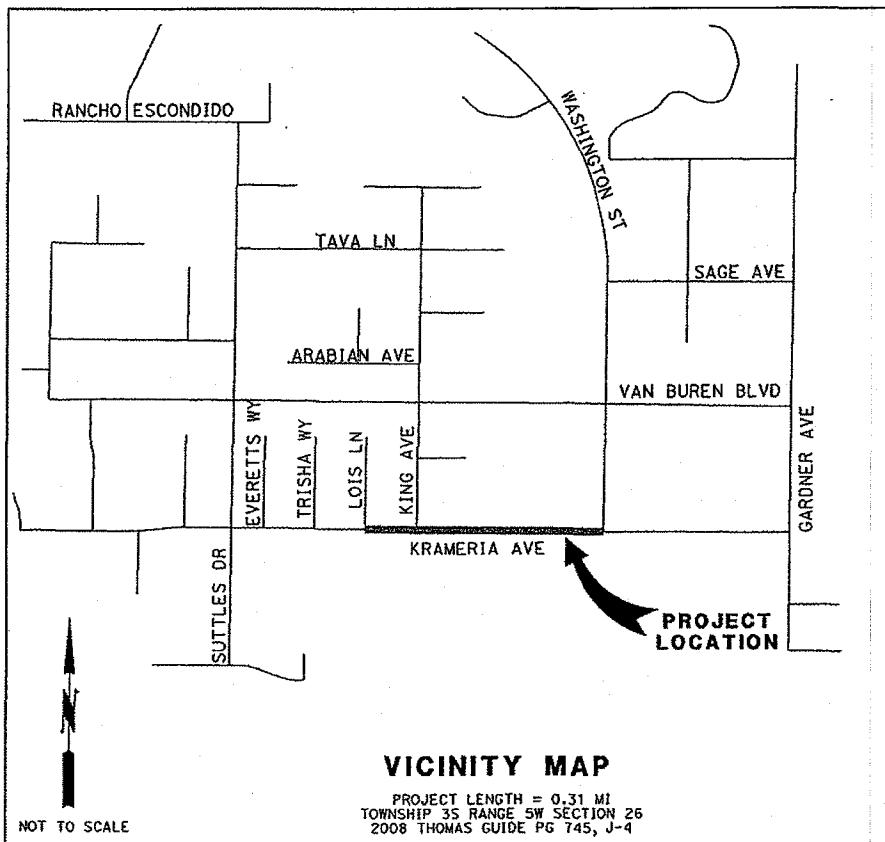
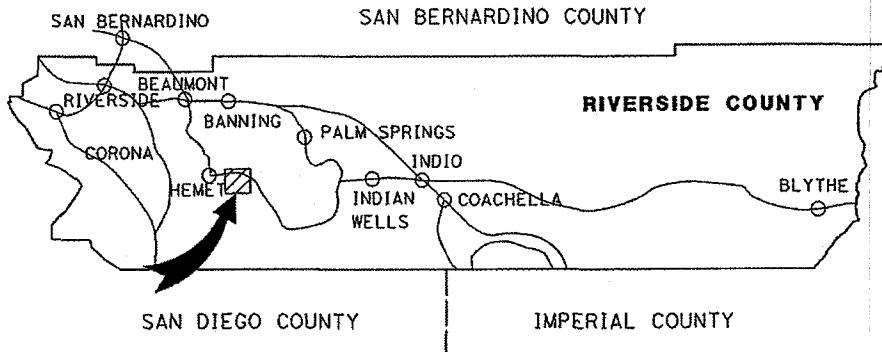

VICINITY MAP
SCALE NONE
EXHIBIT "A"

**KRAMERIA AVENUE
SIDEWALK PROJECT**

WASHINGTON ST. TO LOIS LN.

USERNAME => ghuyrh
DGN FILE => B8-0672 VICINITY MAP.dgn

WO B8-0672

6/1/2009 8:53:03 AM ghuyrh
F:\B8-0672 KRAMERIA AVENUE.dgn\B8-0672 VICINITY MAP.dgn

Attachment "A"

Riverside County Transportation Department

Project: **KRAMERIA AVENUE : SIDEWALK PROJECT**

Project No.(s): **B80672**

Expenses as of: 5/11/2010

Project Costs and Budget

Activity	Incurred Costs	Projected Costs	Total Costs	Existing Budget	Proposed Budget
Preliminary Survey	41,169		42,000	43,000	42,000
Environmental	1,169		2,000	7,000	2,000
Design	139,095		140,000	65,000	140,000
Right-of-way	7,186	3,000	11,000	8,000	11,000
Utilities				3,000	
Construction		191,788	211,000	263,000	211,000
Construction Contingency 10.0%		19,179			
Construction Engineering & Inspection	2,247	40,000	40,000	40,000	40,000
Construction Survey		30,000	30,000	30,000	30,000
Totals:	190,866	283,967	476,000	459,000	476,000

Project Funding

Code	Name	Existing Budget	Proposed Budget
300	Measure A/Western	371,000	388,000
240	SB 821 (Local Transportation Funds)	88,000	88,000
Totals		459,000	476,000

Comments

Attachment "A"

Riverside County Transportation Department

Project: **MAYBERRY AVENUE : SIDEWALK PROJECT**

Project No.(s): **B90941**

Expenses as of: 5/11/2010

Project Costs and Budget

Activity	Incurred Costs	Projected Costs	Total Costs	Existing Budget
Preliminary Survey	23,049		23,049	16,000
Environmental	64		64	2,000
Design	62,119		62,119	45,000
Right-of-way				2,000
Utilities				
Construction		120,000		
Construction Contingency 10.0%		12,500	132,500	150,000
Construction Engineering & Inspection		25,000	25,000	25,000
Construction Survey		10,000	10,000	10,000
Totals:	85,232	167,500	252,732	250,000

Project Funding

Code	Name	Existing Budget
300	Measure AWestern	145,000
240	SB 821 (Local Transportation Funds)	105,000
Totals		250,000

Comments

Form 11 Attachment

Contract/Lease/Purchase Summary Data

Contract (for Services)

- Approval/Renewal
- Sole Source
- Personal Services
- Independent Contractor
- Other than Low Bid
- Change Order
- Public Works

Lease

- Approval/Renewal
- Multi-Year Lease
- Equipment
- Real Property
- Change Order

Purchase (for Materials)

- Sole Source
- Other than Low Bid
- Change Order

Selection Committee Member Names (RFP's Only)

User Department:	Transportation Department
-------------------------	----------------------------------

N/A

Vendor/Lessor Name:	MAMCO, INC.
----------------------------	--------------------

Minority

Status: M W DV None

Vendor/Lessor Location:	Riverside, CA
--------------------------------	----------------------

Local Preference Applied: Yes No N/A

Local Preference Award Cost \$
(5% maximum preference)

Local Preference FYTD: Cost \$

of Orders

Applicable Board Policy #

Comments:

RFQ/RFP Process:

Date Mailed:
Response Date:
of Responses:
of Qualified Responses:

Bidding Process:

Bid Range: \$ 276,276.76 to \$ 403,685.00
Local Bid Range: N/A
Responsible and
Responsible Bid Range: \$ 276,276.76 to \$ 403,685.00

Contract/Lease Renewals Only

Existing Agreement Items

Proposed Agreement Items

1. Rates
2. Terms
3. Conditions
4. Legal Issues
5. Accountability
6. Utilities

(Continue on blank sheet if necessary)

NOTE: COMPETITIVELY BID PUBLIC WORKS CONTRACT

**Riverside County Transportation Department
Summary of Bids**

Advertised: April 20, 2010 (Agenda Item: 3.72)

Bids Open: 2 pm Date: Wednesday, May 05, 2010

PROJECT:
Krameria Avenue and Mayberry Avenue Sidewalk Improvement Projects

PROJECT NO. B8-0672 (Krameria); B9-0941 (Mayberry)

SCHEDULE A (KRAMERIA AVENUE)		COUNTY'S ESTIMATE						Mamco, Inc. Riverside, CA 92504	
ITEM NO.	ITEM CODE	CONTRACT ITEM	UNITS	QUANTITY	UNIT PRICE	ENG ESTIMATE	BID UNIT PRICE	BID ESTIMATE	
1	066102	DUST ABATEMENT	LS	1	1,000.00	1,000.00	1,500.00	1,500.00	
2	074020	WATER POLLUTION CONTROL	LS	1	2,500.00	2,500.00	2,000.00	2,000.00	
3	120100	TRAFFIC CONTROL SYSTEM	LS	1	10,000.00	10,000.00	2,818.38	2,818.38	
4	152370	RELOCATE MAILBOX	EA	12	200.00	2,400.00	450.00	5,400.00	
5	152379	RELOCATE FENCE	LF	450	30.00	13,500.00	20.00	9,000.00	
6	152386	RELOCATE ROADSIDE SIGN-ONE POST	EA	10	250.00	2,500.00	125.00	1,250.00	
6.A	152353	RELOCATE IRRIGATION SYSTEM	LS	1	1,000.00	1,000.00	2,000.00	2,000.00	
7	160101	CLEARING AND GRUBBING	LS	1	15,000.00	15,000.00	3,000.00	3,000.00	
8	170101	DEVELOP WATER SUPPLY	LS	1	2,000.00	2,000.00	1,000.00	1,000.00	
9	190101	ROADWAY EXCAVATION	CY	450	40.00	18,000.00	35.00	15,750.00	
10	220101	FINISHING ROADWAY	LS	1	2,500.00	2,500.00	1,000.00	1,000.00	
11	260201	CLASS 2 AGGREGATE BASE	CY	260	50.00	13,000.00	39.00	10,140.00	
12	390130	HOT MIX ASPHALT	TON	360	100.00	36,000.00	90.00	32,400.00	
13	017305	MINOR CONCRETE (CURB AND GUTTER) (CRS 201)	LF	1,650	15.00	24,750.00	15.00	24,750.00	
14	017310	MINOR CONCRETE (DRIVEWAY APPROACH) (CRS 207)	EA	20	2,500.00	50,000.00	750.00	15,000.00	
15	017315	MINOR CONCRETE (CURB RAMP) (CRS 403 - CASE A)	EA	1	2,500.00	2,500.00	1,900.00	1,900.00	
15.A	017316	MINOR CONCRETE (CURB RAMP) (CRS 403 - CASE B) [MODIFIED]	EA	2	2,500.00	5,000.00	1,800.00	3,600.00	
16	017317	MINOR CONCRETE (CROSS-GUTTER AND SPANDREL)	SQFT	350	15.00	5,250.00	6.00	2,100.00	
17	731516	MINOR CONCRETE (DRIVEWAY)	SQFT	1,500	10.00	15,000.00	4.00	6,000.00	
18	731521	MINOR CONCRETE (SIDEWALK)	SQFT	7,600	6.00	45,600.00	2.95	22,420.00	
19	013904	PLACE ASPHALT CONCRETE DIKE (CRS 212) (8")	LF	90	10.00	900.00	14.00	1,260.00	
20	017003	CATCH BASIN (CURB INLET) (CRS 300)	EA	1	5,100.00	5,100.00	6,800.00	6,800.00	
21	513553	RETAINING WALL (MASONRY WALL)	SQFT	60	25.00	1,500.00	30.00	1,800.00	
22	719530	UNDER SIDEWALK CURB DRAIN (CRS 310)	EA	6	50.00	300.00	400.00	2,400.00	
23	840515	THERMOPLASTIC PAVEMENT MARKING	SQFT	350	4.00	1,400.00	6.00	2,100.00	
23.A	000003	INSTALL 24" BOX TREE [SCHINUS MOLLE 'CALIFORNIA PEPPER TREE]	EA	3	500.00	1,500.00	800.00	2,400.00	
SUBTOTAL						278,200.00		179,788.38	
ITEMS 1-23.A									

ALTERNATE BID ITEMS (WESTERN MUNICIPAL WATER DISTRICT)		COUNTY'S ESTIMATE						Mamco, Inc. Riverside, CA 92504	
ITEM NO.	ITEM CODE	CONTRACT ITEM	UNITS	QUANTITY	UNIT PRICE	ENG ESTIMATE	BID UNIT PRICE	BID ESTIMATE	
24	152401	ADJUST WATER METER TO GRADE	EA	2	250.00	500.00	550.00	1,100.00	
25	152410	RELOCATE WATER METER	EA	8	500.00	4,000.00	900.00	7,200.00	
26	152427	ADJUST FIRE HYDRANT	EA	1	500.00	500.00	1,100.00	1,100.00	
27	152351	RELOCATE HYDRANT	EA	1	5,000.00	5,000.00	2,600.00	2,600.00	
SUBTOTAL						10,000.00		12,000.00	
ITEMS 24-27									

**Riverside County Transportation Department
Summary of Bids**

PROJECT:
Krameria Avenue and Mayberry Avenue Sidewalk Improvement Projects

Advertised: April 20, 2010 (Agenda Item: 3.72)

Bids Open: 2 pm Date: Wednesday, May 05, 2010

PROJECT NO. B8-0672 (Krameria); B9-0941 (Mayberry)

SCHEDULE B (MAYBERRY AVENUE)		COUNTY'S ESTIMATE				Mamco, Inc. Riverside, CA 92504		
ITEM NO.	ITEM CODE	CONTRACT ITEM	UNITS	QUANTITY	UNIT PRICE	ENG ESTIMATE	BID UNIT PRICE	BID ESTIMATE
28	086102	DUST ABATEMENT	LS	1	1,000.00	1,000.00	1,500.00	1,500.00
29	074020	WATER POLLUTION CONTROL	LS	1	1,000.00	1,000.00	2,000.00	2,000.00
30	120100	TRAFFIC CONTROL SYSTEM	LS	1	2,500.00	2,500.00	1,718.38	1,718.38
31	152370	RELOCATE MAILBOX	EA	5	200.00	1,000.00	450.00	2,250.00
32	152379	RELOCATE FENCE	LF	210	30.00	6,300.00	20.00	4,200.00
33	152386	RELOCATE ROADSIDE SIGN-ONE POST	EA	2	250.00	500.00	125.00	250.00
33.A	152353	RELOCATE IRRIGATION SYSTEM	LS	1	1,000.00	1,000.00	2,000.00	2,000.00
34	160101	CLEARING AND GRUBBING	LS	1	15,000.00	15,000.00	8,000.00	8,000.00
35	170101	DEVELOP WATER SUPPLY	LS	1	1,000.00	1,000.00	1,000.00	1,000.00
36	190101	ROADWAY EXCAVATION	CY	50	40.00	2,000.00	35.00	1,750.00
37	220101	FINISHING ROADWAY	LS	1	1,000.00	1,000.00	1,000.00	1,000.00
38	260201	CLASS 2 AGGREGATE BASE	CY	15	50.00	750.00	39.00	585.00
39	390130	HOT MIX ASPHALT	TON	35	100.00	3,500.00	200.00	7,000.00
40	017305	MINOR CONCRETE (CURB AND GUTTER) (CRS 201)	LF	370	15.00	5,550.00	15.00	5,550.00
41	017310	MINOR CONCRETE (DRIVEWAY APPROACH) (CRS 207)	EA	6	2,500.00	15,000.00	750.00	4,500.00
42	017316	MINOR CONCRETE (CURB RAMP) (CRS 403 - CASE B)	EA	2	2,500.00	5,000.00	1,800.00	3,600.00
43	017317	MINOR CONCRETE (CROSS-GUTTER AND SPANDREL)	SQFT	1,300	15.00	19,500.00	6.00	7,800.00
44	731516	MINOR CONCRETE (DRIVEWAY)	SQFT	1,400	10.00	14,000.00	4.00	5,600.00
45	731521	MINOR CONCRETE (SIDEWALK)	SQFT	2,700	6.00	16,200.00	2.95	7,965.00
46	017309	MINOR CONCRETE (TYPE "D" CURB) (CRS 204) [MODIFIED]	LF	140	15.00	2,100.00	14.00	1,960.00
47	000003	REMOVE AND RECONSTRUCT RR TIE RETAINING CURB	LF	80	10.00	800.00	13.00	1,040.00
48	011506	WEDGE PLANE ASPHALT CONCRETE	LF	360	5.00	1,800.00	17.00	6,120.00
49	750008	RECONSTRUCT STEEL UNDERWALK DRAIN FRAME & COVER	LS	1	4,300.00	4,300.00	1,000.00	1,000.00
50	719530	UNDER SIDEWALK CURB DRAIN (CRS 310)	EA	4	50.00	200.00	400.00	1,600.00
SUBTOTAL						121,000.00		79,988.38
ITEMS 28-50								

ALTERNATE BID ITEMS (LAKE HEMET MUNICIPAL WATER DISTRICT)		COUNTY'S ESTIMATE				Mamco Inc. Riverside, CA 92504		
ITEM NO.	ITEM CODE	CONTRACT ITEM	UNITS	QUANTITY	UNIT PRICE	ENG ESTIMATE	BID UNIT PRICE	BID ESTIMATE
51	152410	RELOCATE WATER METER	EA	5	1,000.00	5,000.00	900.00	4,500.00
SUBTOTAL						5,000.00		4,500.00
ITEM 51								

PROJECT TOTAL		COUNTY'S ESTIMATE	
ITEMS 1-51		414,200.00	276,276.76

**Riverside County Transportation Department
Summary of Bids**

Advertised: April 20, 2010 (Agenda Item: 3.72)
Bids Open: 2 pm Date: Wednesday, May 05, 2010

PROJECT:
Krameria Avenue and Mayberry Avenue Sidewalk Improvement Projects

PROJECT NO. B8-0672 (Krameria); B9-0941 (Mayberry)

SCHEDULE A (KRAMERIA AVENUE)		Kormx, Inc. Walnut, CA 91788		Southland Construction Irvine, CA 92602				
ITEM NO.	ITEM CODE	CONTRACT ITEM	UNITS	QUANTITY	BID UNIT PRICE	BID ESTIMATE	BID UNIT PRICE	BID ESTIMATE
1	066102	DUST ABATEMENT	LS	1	2,500.00	2,500.00	100.00	100.00
2	074020	WATER POLLUTION CONTROL	LS	1	2,500.00	2,500.00	100.00	100.00
3	120100	TRAFFIC CONTROL SYSTEM	LS	1	3,500.00	3,500.00	3,000.00	3,000.00
4	152370	RELOCATE MAILBOX	EA	12	100.00	1,200.00	100.00	1,200.00
5	152379	RELOCATE FENCE	LF	450	20.00	9,000.00	20.00	9,000.00
6	152386	RELOCATE ROADSIDE SIGN-ONE POST	EA	10	175.00	1,750.00	100.00	1,000.00
6.A	152353	RELOCATE IRRIGATION SYSTEM	LS	1	5,900.00	5,900.00	5,000.00	5,000.00
7	160101	CLEARING AND GRUBBING	LS	1	7,500.00	7,500.00	5,000.00	5,000.00
8	170101	DEVELOP WATER SUPPLY	LS	1	1,000.00	1,000.00	100.00	100.00
9	190101	ROADWAY EXCAVATION	CY	450	40.00	18,000.00	50.00	22,500.00
10	220101	FINISHING ROADWAY	LS	1	1,000.00	1,000.00	1,000.00	1,000.00
11	260201	CLASS 2 AGGREGATE BASE	CY	260	60.00	15,600.00	60.00	15,600.00
12	390130	HOT MIX ASPHALT	TON	360	110.00	39,600.00	200.00	72,000.00
13	017305	MINOR CONCRETE (CURB AND GUTTER) (CRS 201)	LF	1,650	23.00	37,950.00	30.00	49,500.00
14	017310	MINOR CONCRETE (DRIVEWAY APPROACH) (CRS 207)	EA	20	1,600.00	32,000.00	600.00	12,000.00
15	017315	MINOR CONCRETE (CURB RAMP) (CRS 403 - CASE A)	EA	1	2,300.00	2,300.00	2,500.00	2,500.00
15.A	017316	MINOR CONCRETE (CURB RAMP) (CRS 403 - CASE B) [MODIFIED]	EA	2	2,300.00	4,600.00	2,000.00	4,000.00
16	017317	MINOR CONCRETE (CROSS-GUTTER AND SPANDREL)	SQFT	350	10.00	3,500.00	8.00	2,800.00
17	731516	MINOR CONCRETE (DRIVEWAY)	SQFT	1,500	6.00	9,000.00	6.00	9,000.00
18	731521	MINOR CONCRETE (SIDEWALK)	SQFT	7,600	4.56	34,656.00	4.00	30,400.00
19	013904	PLACE ASPHALT CONCRETE DIKE (CRS 212) (8")	LF	90	40.00	3,600.00	20.00	1,800.00
20	017003	CATCH BASIN (CURB INLET) (CRS 300)	EA	1	5,500.00	5,500.00	3,000.00	3,000.00
21	513553	RETAINING WALL (MASONRY WALL)	SQFT	60	20.00	1,200.00	100.00	6,000.00
22	719530	UNDER SIDEWALK CURB DRAIN (CRS 310)	EA	6	200.00	1,200.00	100.00	600.00
23	840515	THERMOPLASTIC PAVEMENT MARKING	SQFT	350	5.00	1,750.00	20.00	7,000.00
23.A	000003	INSTALL 24" BOX TREE [SCHINUS MOLLE 'CALIFORNIA PEPPER TREE]	EA	3	750.00	2,250.00	400.00	1,200.00
SUBTOTAL						248,556.00		265,400.00
ITEMS 1-23.A								

ALTERNATE BID ITEMS (WESTERN MUNICIPAL WATER DISTRICT)		Kormx, Inc. Walnut, CA 91788		Southland Construction Irvine, CA 92602				
ITEM NO.	ITEM CODE	CONTRACT ITEM	UNITS	QUANTITY	BID UNIT PRICE	BID ESTIMATE	BID UNIT PRICE	BID ESTIMATE
24	152401	ADJUST WATER METER TO GRADE	EA	2	100.00	200.00	100.00	200.00
25	152410	RELOCATE WATER METER	EA	8	900.00	7,200.00	500.00	4,000.00
26	152427	ADJUST FIRE HYDRANT	EA	1	1,500.00	1,500.00	1,000.00	1,000.00
27	152351	RELOCATE HYDRANT	EA	1	4,000.00	4,000.00	2,000.00	2,000.00
SUBTOTAL						12,900.00		7,200.00
ITEMS 24-27								

**Riverside County Transportation Department
Summary of Bids**

Advertised: April 20, 2010 (Agenda Item: 3.72)

Bids Open: 2 pm Date: Wednesday, May 05, 2010

PROJECT:
Krameria Avenue and Mayberry Avenue Sidewalk Improvement Projects

PROJECT NO. B8-0672 (Krameria); B9-0941 (Mayberry)

SCHEDULE B (MAYBERRY AVENUE)		Kormx, Inc. Walnut, CA 91788		Southland Construction Irvine, CA 92602				
ITEM NO.	ITEM CODE	CONTRACT ITEM	UNITS	QUANTITY	UNIT PRICE	BID ESTIMATE	BID UNIT PRICE	BID ESTIMATE
28	066102	DUST ABATEMENT	LS	1	1,500.00	1,500.00	100.00	100.00
29	074020	WATER POLLUTION CONTROL	LS	1	500.00	500.00	100.00	100.00
30	120100	TRAFFIC CONTROL SYSTEM	LS	1	500.00	500.00	2,000.00	2,000.00
31	152370	RELOCATE MAILBOX	EA	5	100.00	500.00	100.00	500.00
32	152379	RELOCATE FENCE	LF	210	20.00	4,200.00	20.00	4,200.00
33	152386	RELOCATE ROADSIDE SIGN-ONE POST	EA	2	150.00	300.00	100.00	200.00
33.A	152353	RELOCATE IRRIGATION SYSTEM	LS	1	4,500.00	4,500.00	3,000.00	3,000.00
34	160101	CLEARING AND GRUBBING	LS	1	4,500.00	4,500.00	2,500.00	2,500.00
35	170101	DEVELOP WATER SUPPLY	LS	1	4,500.00	4,500.00	500.00	500.00
36	190101	ROADWAY EXCAVATION	CY	50	65.00	3,250.00	50.00	2,500.00
37	220101	FINISHING ROADWAY	LS	1	1,000.00	1,000.00	1,000.00	1,000.00
38	260201	CLASS 2 AGGREGATE BASE	CY	15	55.00	825.00	100.00	1,500.00
39	390130	HOT MIX ASPHALT	TON	35	110.00	3,850.00	200.00	7,000.00
40	017305	MINOR CONCRETE (CURB AND GUTTER) (CRS 201)	LF	370	23.00	8,510.00	30.00	11,100.00
41	017310	MINOR CONCRETE (DRIVEWAY APPROACH) (CRS 207)	EA	6	1,800.00	10,800.00	600.00	3,600.00
42	017316	MINOR CONCRETE (CURB RAMP) (CRS 403 - CASE B)	EA	2	2,300.00	4,600.00	2,500.00	5,000.00
43	017317	MINOR CONCRETE (CROSS-GUTTER AND SPANDREL)	SQFT	1,300	9.00	11,700.00	10.00	13,000.00
44	731516	MINOR CONCRETE (DRIVEWAY)	SQFT	1,400	5.50	7,700.00	6.00	8,400.00
45	731521	MINOR CONCRETE (SIDEWALK)	SQFT	2,700	4.30	11,610.00	4.00	10,800.00
46	017309	MINOR CONCRETE (TYPE "D" CURB) (CRS 204) [MODIFIED]	LF	140	18.00	2,520.00	30.00	4,200.00
47	000003	REMOVE AND RECONSTRUCT RR TIE RETAINING CURB	LF	80	25.00	2,000.00	30.00	2,400.00
48	011506	WEDGE PLANE ASPHALT CONCRETE	LF	360	10.00	3,600.00	3.00	1,080.00
49	750008	RECONSTRUCT STEEL UNDERWALK DRAIN FRAME & COVER	LS	1	6,300.00	6,300.00	1,000.00	1,000.00
50	719530	UNDER SIDEWALK CURB DRAIN (CRS 310)	EA	4	200.00	800.00	100.00	400.00
SUBTOTAL						100,065.00		86,080.00
ITEMS 28-50								

ALTERNATE BID ITEMS (LAKE HEMET MUNICIPAL WATER DISTRICT)		Kormx, Inc. Walnut, CA 91788		Southland Construction Irvine, CA 92602				
ITEM NO.	ITEM CODE	CONTRACT ITEM	UNITS	QUANTITY	BID UNIT PRICE	BID ESTIMATE	BID UNIT PRICE	BID ESTIMATE
51	152410	RELOCATE WATER METER	EA	5	100.00	500.00	1,000.00	5,000.00
SUBTOTAL						500.00		5,000.00
ITEM 51								

PROJECT TOTAL				362,021.00		363,680.00	
ITEMS 1-51							

**Riverside County Transportation Department
Summary of Bids**

PROJECT:
Krameria Avenue and Mayberry Avenue Sidewalk Improvement Projects

Advertised: April 20, 2010 (Agenda Item: 3.72)

Bids Open: 2 pm Date: Wednesday, May 05, 2010

PROJECT NO. B9-0672 (Krameria); B9-0941 (Mayberry)

West Coast Structures, Inc.
Riverside, CA 92503

B&T Works Inc.
Wildomar, CA 92595

ITEM NO.	ITEM CODE	CONTRACT ITEM	UNITS	QUANTITY	BID UNIT PRICE	BID ESTIMATE	BID UNIT PRICE	BID ESTIMATE	BID UNIT PRICE	BID ESTIMATE
1	066102	DUST ABATEMENT	LS	1	3,906.00	3,906.00	3,000.00	3,000.00	3,000.00	3,000.00
2	074020	WATER POLLUTION CONTROL	LS	1	555.00	555.00	3,500.00	3,500.00	3,500.00	3,500.00
3	120100	TRAFFIC CONTROL SYSTEM	LS	1	19,051.00	19,051.00	5,000.00	5,000.00	5,000.00	5,000.00
4	152370	RELOCATE MAILBOX	EA	12	189.00	2,268.00	300.00	3,600.00	300.00	3,600.00
5	152379	RELOCATE FENCE	LF	450	21.54	9,693.00	27.00	12,150.00	27.00	12,150.00
6	152386	RELOCATE ROADSIDE SIGN-ONE POST	EA	10	114.00	1,140.00	200.00	2,000.00	200.00	2,000.00
6.A	152353	RELOCATE IRRIGATION SYSTEM	LS	1	2,034.00	2,034.00	4,000.00	4,000.00	4,000.00	4,000.00
7	160101	CLEARING AND GRUBBING	LS	1	15,587.00	15,587.00	20,000.00	20,000.00	20,000.00	20,000.00
8	170101	DEVELOP WATER SUPPLY	LS	1	2,360.00	2,360.00	1,200.00	1,200.00	1,200.00	1,200.00
9	190101	ROADWAY EXCAVATION	CY	450	56.32	25,344.00	27.00	12,150.00	27.00	12,150.00
10	220101	FINISHING ROADWAY	LS	1	1,847.00	1,847.00	1,200.00	1,200.00	1,200.00	1,200.00
11	260201	CLASS 2 AGGREGATE BASE	CY	1	51.25	51.25	60.00	60.00	60.00	60.00
12	390130	HOT MIX ASPHALT	TON	360	94.00	33,840.00	85.00	30,600.00	85.00	30,600.00
13	017305	MINOR CONCRETE (CURB AND GUTTER) (CRS 201)	LF	1,650	20.53	33,874.50	19.60	32,340.00	19.60	32,340.00
14	017310	MINOR CONCRETE (DRIVEWAY APPROACH) (CRS 207)	EA	20	555.00	11,100.00	1,650.00	33,000.00	1,650.00	33,000.00
15	017315	MINOR CONCRETE (CURB RAMP) (CRS 403 - CASE A)	EA	1	2,353.00	2,353.00	3,000.00	3,000.00	3,000.00	3,000.00
15.A	017316	MINOR CONCRETE (CURB RAMP) (CRS 403 - CASE B) (MODIFIED)	EA	2	2,385.00	4,770.00	2,500.00	5,000.00	2,500.00	5,000.00
16	017317	MINOR CONCRETE (GROSS-GUTTER AND SPANDREL)	SQFT	350	6.75	2,362.50	12.00	4,200.00	12.00	4,200.00
17	731516	MINOR CONCRETE (DRIVEWAY)	SQFT	1,500	5.10	7,650.00	5.00	7,500.00	5.00	7,500.00
18	731521	MINOR CONCRETE (SIDEWALK)	SQFT	7,600	2.90	22,040.00	4.00	30,400.00	4.00	30,400.00
19	013904	PLACE ASPHALT CONCRETE DIKE (CRS 212) (8")	LF	90	28.75	2,587.50	13.00	1,170.00	13.00	1,170.00
20	017003	CATCH BASIN (CURB INLET) (CRS 300)	EA	1	4,667.00	4,667.00	4,000.00	4,000.00	4,000.00	4,000.00
21	513553	RETAINING WALL (MASONRY WALL)	SQFT	60	29.52	1,771.20	65.00	3,900.00	65.00	3,900.00
22	719530	UNDER SIDEWALK CURB DRAIN (CRS 310)	EA	6	230.00	1,380.00	1,200.00	7,200.00	1,200.00	7,200.00
23	840515	THERMOPLASTIC PAVEMENT MARKING	SQFT	350	2.94	1,029.00	7.80	2,730.00	7.80	2,730.00
23.A	000003	INSTALL 24" BOX TREE [SCHINUS MOLLE 'CALIFORNIA PEPPER TREE']	EA	3	795.00	2,385.00	900.00	2,700.00	900.00	2,700.00
SUBTOTAL										
ITEMS 1-23.A						228,919.70		251,140.00		251,140.00

ALTERNATE BID ITEMS (WESTERN MUNICIPAL WATER DISTRICT)										
ITEM NO.	ITEM CODE	CONTRACT ITEM	UNITS	QUANTITY	BID UNIT PRICE	BID ESTIMATE	BID UNIT PRICE	BID ESTIMATE	BID UNIT PRICE	BID ESTIMATE
24	152401	ADJUST WATER METER TO GRADE	EA	2	273.00	546.00	400.00	800.00	400.00	800.00
25	152410	RELOCATE WATER METER	EA	8	2,395.00	19,160.00	1,500.00	12,000.00	1,500.00	12,000.00
26	152427	ADJUST FIRE HYDRANT	EA	1	805.00	805.00	600.00	600.00	600.00	600.00
27	152351	RELOCATE HYDRANT	EA	1	1,851.00	1,851.00	2,000.00	2,000.00	2,000.00	2,000.00
SUBTOTAL										
ITEMS 24-27						22,362.00		15,400.00		15,400.00

West Coast Structures, Inc.
Riverside, CA 92503

B&T Works Inc.
Wildomar, CA 92595

**Riverside County Transportation Department
Summary of Bids**

PROJECT:
Krameria Avenue and Mayberry Avenue Sidewalk Improvement Projects

Advertised: April 20, 2010 (Agenda Item: 3.72)
Bids Open: 2 pm Date: Wednesday, May 05, 2010

PROJECT NO. B8-0672 (Krameria); B9-0941 (Mayberry)

SCHEDULE B (MAYBERRY AVENUE)		West Coast Structures, Inc. Riverside, CA 92503		B&T Works Inc. Wildomar, CA 92595				
ITEM NO.	ITEM CODE	CONTRACT ITEM	UNITS	QUANTITY	UNIT PRICE	BID ESTIMATE	BID UNIT PRICE	BID ESTIMATE
28	066102	DUST ABATEMENT	LS	1	2,220.00	2,220.00	1,500.00	1,500.00
29	074020	WATER POLLUTION CONTROL	LS	1	888.00	888.00	2,500.00	2,500.00
30	120100	TRAFFIC CONTROL SYSTEM	LS	1	3,395.00	3,395.00	4,000.00	4,000.00
31	152370	RELOCATE MAILBOX	EA	5	215.50	1,077.50	300.00	1,500.00
32	152379	RELOCATE FENCE	LF	210	35.00	7,350.00	26.00	5,460.00
33	152386	RELOCATE ROADSIDE SIGN-ONE POST	EA	2	136.50	273.00	200.00	400.00
33.A	152353	RELOCATE IRRIGATION SYSTEM	LS	1	1,810.00	1,810.00	8,000.00	8,000.00
34	160101	CLEARING AND GRUBBING	LS	1	15,038.00	15,038.00	13,000.00	13,000.00
35	170101	DEVELOP WATER SUPPLY	LS	1	935.00	935.00	1,800.00	1,800.00
36	190101	ROADWAY EXCAVATION	CY	50	111.44	5,572.00	100.00	5,000.00
37	220101	FINISHING ROADWAY	LS	1	1,820.00	1,820.00	1,000.00	1,000.00
38	260201	CLASS 2 AGGREGATE BASE	CY	15	232.00	3,480.00	125.00	1,875.00
39	390130	HOT MIX ASPHALT	TON	35	115.02	4,025.70	180.00	6,300.00
40	017305	MINOR CONCRETE (CURB AND GUTTER) (CRS 201)	LF	370	27.65	10,230.50	25.00	9,250.00
41	017310	MINOR CONCRETE (DRIVEWAY APPROACH) (CRS 207)	EA	6	816.00	4,896.00	1,600.00	9,600.00
42	017316	MINOR CONCRETE (CURB RAMP) (CRS 403 - CASE B)	EA	2	2,313.00	4,626.00	2,350.00	4,700.00
43	017317	MINOR CONCRETE (CROSS-GUTTER AND SPANDREL)	SQFT	1,300	6.75	8,775.00	9.50	12,350.00
44	731516	MINOR CONCRETE (DRIVEWAY)	SQFT	1,400	5.09	7,126.00	5.50	7,700.00
45	731521	MINOR CONCRETE (SIDEWALK)	SQFT	2,700	3.88	10,476.00	4.50	12,150.00
46	017309	MINOR CONCRETE (TYPE "D" CURB) (CRS 204) (MODIFIED)	LF	140	15.29	2,140.60	18.00	2,520.00
47	000003	REMOVE AND RECONSTRUCT RR TIE RETAINING CURB	LF	80	22.40	1,792.00	15.00	1,200.00
48	011506	WEDGE PLANE ASPHALT CONCRETE	LF	360	15.63	5,626.80	24.00	8,640.00
49	750008	RECONSTRUCT STEEL UNDERWALK DRAIN FRAME & COVER	LS	1	5,111.00	5,111.00	2,000.00	2,000.00
50	719530	UNDER SIDEWALK CURB DRAIN (CRS 310)	EA	4	242.00	968.00	1,800.00	7,200.00
SUBTOTAL					109,652.10			129,645.00
ITEMS 28-50								

ALTERNATE BID ITEMS (LAKE HEMET MUNICIPAL WATER DISTRICT)		West Coast Structures, Inc. Riverside, CA 92503		B&T Works Inc. Wildomar, CA 92595				
ITEM NO.	ITEM CODE	CONTRACT ITEM	UNITS	QUANTITY	BID UNIT PRICE	BID ESTIMATE	BID UNIT PRICE	BID ESTIMATE
51	152410	RELOCATE WATER METER	EA	5	6,602.00	33,010.00	1,500.00	7,500.00
SUBTOTAL						33,010.00		7,500.00
ITEM 51								

PROJECT TOTAL					393,943.80			403,685.00
ITEMS 1-51								

AGREEMENT

THIS AGREEMENT is entered into at Riverside, California as of the date set forth below is between County of Riverside hereafter called "County" and **Mamco, Inc.**, hereafter called "Contractor".

WITNESSETH

RECITALS:

1. Contractor has submitted to County his Contractor's Proposal for the construction of County Project, **Krameria Avenue Sidewalk Improvement Project From Washington Street To Lois Lane, Woodcrest Area, Project No. B8-0672, And Mayberry Avenue Sidewalk Improvement Project From Darmouth Middle School To Stanford Street, Hemet Area, Project No. B9-0941**, in strict accordance with the Contract Documents identified below and County has accepted said Proposal.
2. Contractor states that he has reexamined his Contractor's Proposal and found it to be correct, has ascertained that his subcontractors are properly licensed and possess the requisite skill and forces, has reexamined the site and Contract Documents and is of the opinion that he can presently do the work in accordance with the Contract Documents for the money set forth in his Proposal to be paid as provided in the Contract Documents.

AGREEMENT:

IT IS AGREED BY THE PARTIES AS FOLLOWS:

1. Contract Documents. The entire contract consists of the following: (a) The Agreement. (b) The Notice Inviting Bids. (c) The Instruction to Bidders. (d) The Contractor's Proposal. (e) The Bid Bond. (f) The Payment Bond. (g) The Performance Bond. (h) The General Conditions. (i) The Special Provisions. (j) The Standard Specifications of the State of California Department of Transportation edition of May 2006 as modified in other portions of the Contract Documents. (k) The Standard Plans of the Department of Transportation identified on the plans or in the Special Provisions. (l) The Plans. (m) Addenda **No. 1**. (n) The Determination of Prevailing Wage Rates for Public Work. (o) Any Change Orders issued. (p) Any additional or supplemental specifications, notice, instructions and drawings issued in accordance with the provisions of the Contract Documents. All of said Documents presently in existence are by this reference incorporated herein with like effect as if here set forth in full and upon the proper issuance of other documents they shall likewise be deemed incorporated. The Bid Bond is exonerated upon execution of this Agreement and the Payment Bond and Faithful Performance Bond.
2. The Work. Contractor shall do all things necessary to construct the work generally described in Recital No. 1 in accordance with the Contract Documents.

3. Liquidated Damages and Time of Completion. Attention is directed to the provisions in Section 8-1.06, "Time of Completion", and in Section 8-1.07, "Liquidated Damages", of the Standard Specifications and these Special Provisions.

The Contractor shall begin work within 15 days of the date stated within the written "Notice to Proceed".

The Contractor shall notify the Engineer, in writing, of his intent to begin work at least 72 hours before work is begun. The notice shall be delivered to the Transportation Department's Construction Engineer and shall specify the date the Contractor intends to start. If the project has more than one location of work, a separate notice shall be given for each location.

Should the Contractor begin work in advance of receiving a written "Notice to Proceed", any work performed by him in advance of the date stated in the "Notice to Proceed" shall be considered as having been done by him at his own risk and as a volunteer and subject to the following:

- (1) The Contractor shall, on commencing operations, take all precautions required for public safety and shall observe all the provisions in the Specifications and the Special Provisions.
- (2) All work done according to the contract prior to the issuance of the "Notice to Proceed", will be considered authorized work and will be paid for as provided in the contract.
- (3) The Contractor shall not be entitled to any additional compensation or an extension of time for any delay, hindrance or interference caused by or attributable to commencement of work prior to the issuance of the "Notice to Proceed".

4. Compensation. Contractor shall be paid in the manner set forth in the Contract Documents the amount of his Proposal as accepted by County, the above rates, subject to additions and deductions as provided in the Contract Documents. Said Proposal is on file in the Office of the Clerk of the Board of Supervisors of County.

**KRAMERIA AVENUE
SIDEWALK IMPROVEMENT PROJECT
FROM WASHINGTON STREET TO LOIS LANE**

PROJECT NO. B8-0672

AGREEMENT

SCHEDULE A (KRAMERIA AVENUE):

ITEM No.	ITEM CODE	ITEM	UNIT	ESTIMATED QUANTITY	ITEM PRICE (IN FIGURES)	TOTAL (IN FIGURES)
1	066102	DUST ABATEMENT	LS	1	1,500.00	1,500.00
2	074020	WATER POLLUTION CONTROL	LS	1	2,000.00	2,000.00
3	120100	TRAFFIC CONTROL SYSTEM	LS	1	2,818.38	2,818.38
4	152370	RELOCATE MAILBOX	EA	12	450.00	5,400.00
5	152379	RELOCATE FENCE	LF	450	20.00	9,000.00
6	152386	RELOCATE ROADSIDE SIGN-ONE POST	EA	10	125.00	1,250.00
6.A	152353	RELOCATE IRRIGATION SYSTEM	LS	1	2,000.00	2,000.00
7	160101	CLEARING AND GRUBBING	LS	1	3,000.00	3,000.00
8	170101	DEVELOP WATER SUPPLY	LS	1	1,000.00	1,000.00
9	190101	ROADWAY EXCAVATION	CY	450	35.00	15,750.00
10	220101	FINISHING ROADWAY	LS	1	1,000.00	1,000.00
11	260201	CLASS 2 AGGREGATE BASE	CY	260	39.00	10,140.00
12	390130	HOT MIX ASPHALT	TON	360	90.00	32,400.00
13	017305	MINOR CONCRETE (CURB AND GUTTER) (CRS 201)	LF	1,650	15.00	24,750.00
14	017310	MINOR CONCRETE (DRIVEWAY APPROACH) (CRS 207)	EA	20	750.00	15,000.00
15	017315	MINOR CONCRETE (CURB RAMP) (CRS 403 - CASE A)	EA	1	1,900.00	1,900.00
15.A	017316	MINOR CONCRETE (CURB RAMP) (CRS 403 - CASE B) [MODIFIED]	EA	2	1,800.00	3,600.00
16	017317	MINOR CONCRETE (CROSS-GUTTER AND SPANDREL)	SQFT	350	6.00	2,100.00
17	731516	MINOR CONCRETE (DRIVEWAY)	SQFT	1,500	4.00	6,000.00
18	731521	MINOR CONCRETE (SIDEWALK)	SQFT	7,600	2.95	22,420.00
19	013904	PLACE ASPHALT CONCRETE DIKE (CRS 212) (8")	LF	90	14.00	1,260.00

AGREEMENT (Continued)

SCHEDULE A (KRAMERIA AVENUE):

ITEM No.	ITEM CODE	ITEM	UNIT	ESTIMATED QUANTITY	ITEM PRICE (IN FIGURES)	TOTAL (IN FIGURES)
20	017003	CATCH BASIN (CURB INLET) (CRS 300)	EA	1	6,800.00	6,800.00
21	513553	RETAINING WALL (MASONRY WALL)	SQFT	60	30.00	1,800.00
22	719530	UNDER SIDEWALK CURB DRAIN (CRS 310)	EA	6	400.00	2,400.00
23	840515	THERMOPLASTIC PAVEMENT MARKING	SQFT	350	6.00	2,100.00
23.A	000003	INSTALL 24" BOX TREE [SCHINUS MOLLE 'CALIFORNIA PEPPER TREE']	EA	3	800.00	2,400.00

PROJECT
 SUBTOTAL: One hundred seventy nine thousand, seven hundred eighty eight dollars and thirty eight cents \$ 179,788.38
 ITEMS 1-23.A "WORDS"

NOT SELECTED FOR AWARD-

ALTERNATE BID (WESTERN MUNICIPAL WATER DISTRICT):

ITEM No.	ITEM CODE	ITEM	UNIT	ESTIMATED QUANTITY	ITEM PRICE (IN FIGURES)	TOTAL (IN FIGURES)
24	152401	ADJUST WATER METER TO GRADE	EA	2	----	----
25	152410	RELOCATE WATER METER	EA	8	----	----
26	152427	ADJUST FIRE HYDRANT	EA	1	----	----
27	152351	RELOCATE HYDRANT	EA	1	----	----

ALTERNATE BID
 SUBTOTAL: _____ \$ _____
 ITEMS 24-27 "WORDS"

**MAYBERRY AVENUE
SIDEWALK IMPROVEMENT PROJECT
FROM DARMOUTH MIDDLE SCHOOL TO STANFORD STREET**

PROJECT NO. B9-0941

AGREEMENT

SCHEDULE A (MAYBERRY AVENUE):

ITEM No.	ITEM CODE	ITEM	UNIT	ESTIMATED QUANTITY	ITEM PRICE (IN FIGURES)	TOTAL (IN FIGURES)
28	066102	DUST ABATEMENT	LS	1	1,500.00	1,500.00
29	074020	WATER POLLUTION CONTROL	LS	1	2,000.00	2,000.00
30	120100	TRAFFIC CONTROL SYSTEM	LS	1	1,718.38	1,718.38
31	152370	RELOCATE MAILBOX	EA	5	450.00	2,250.00
32	152379	RELOCATE FENCE	LF	210	20.00	4,200.00
33	152386	RELOCATE ROADSIDE SIGN-ONE POST	EA	2	125.00	250.00
33.A	152353	RELOCATE IRRIGATION SYSTEM	LS	1	2,000.00	2,000.00
34	160101	CLEARING AND GRUBBING	LS	1	8,000.00	8,000.00
35	170101	DEVELOP WATER SUPPLY	LS	1	1,000.00	1,000.00
36	190101	ROADWAY EXCAVATION	CY	50	35.00	1,750.00
37	220101	FINISHING ROADWAY	LS	1	1,000.00	1,000.00
38	260201	CLASS 2 AGGREGATE BASE	CY	15	39.00	585.00
39	390130	HOT MIX ASPHALT	TON	35	200.00	7,000.00
40	017305	MINOR CONCRETE (CURB AND GUTTER) (CRS 201)	LF	370	15.00	5,550.00
41	017310	MINOR CONCRETE (DRIVEWAY APPROACH) (CRS 207)	EA	6	750.00	4,500.00
42	017316	MINOR CONCRETE (CURB RAMP) (CRS 403 - CASE B)	EA	2	1,800.00	3,600.00
43	017317	MINOR CONCRETE (CROSS-GUTTER AND SPANDREL)	SQFT	1,300	6.00	7,800.00
44	731516	MINOR CONCRETE (DRIVEWAY)	SQFT	1,400	4.00	5,600.00
45	731521	MINOR CONCRETE (SIDEWALK)	SQFT	2,700	2.95	7,965.00
46	017309	MINOR CONCRETE (TYPE "D" CURB) (CRS 204) [MODIFIED]	LF	140	14.00	1,960.00
47	000003	REMOVE AND RECONSTRUCT RR TIE RETAINING CURB	LF	80	13.00	1,040.00

AGREEMENT (Continued)

SCHEDULE A (MAYBERRY AVENUE):

ITEM No.	ITEM CODE	ITEM	UNIT	ESTIMATED QUANTITY	ITEM PRICE (IN FIGURES)	TOTAL (IN FIGURES)
48	011506	WEDGE PLANE ASPHALT CONCRETE	LF	360	17.00	6,120.00
49	750008	RECONSTRUCT STEEL UNDERWALK DRAIN FRAME & COVER	LS	1	1,000.00	1,000.00
50	719530	UNDER SIDEWALK CURB DRAIN (CRS 310)	EA	4	400.00	1,600.00

PROJECT
 SUBTOTAL: Seventy nine thousand, nine hundred eighty eight dollars and zero cents \$ 79,988.38
 ITEMS 28-50 "WORDS"

ALTERNATE BID (LAKE HEMET MUNICIPAL WATER DISTRICT):

ITEM No.	ITEM CODE	ITEM	UNIT	ESTIMATED QUANTITY	ITEM PRICE (IN FIGURES)	TOTAL (IN FIGURES)
51	152410	RELOCATE WATER METER	EA	5	900.00	4,500.00

ALTERNATE BID
 SUBTOTAL: Four thousand five hundred dollars and zero cents \$ 4,500.00
 ITEM No. 51 "WORDS"

PROJECT
 TOTAL: Two hundred sixty four thousand, two hundred seventy six dollars and seventy six cents \$ 264,276.76
 ITEMS 1-51 "WORDS"

IN WITNESS WHEREOF the parties hereto have executed this agreement as of the date set forth below.

COUNTY OF RIVERSIDE

Mamco, Inc.

BY _____
Chairman, Board of Supervisors

BY _____

Dated _____

TITLE: _____
(If Corporation, Affix Seal)

ATTEST:
Kecia Harper-Ihem, Clerk of the Board

ATTEST:

BY _____
Deputy

TITLE: _____

Licensed in accordance with an act providing for the registration of Contractors,

License No. _____

Federal Employer Identification Number:

FORM APPROVED COUNTY COUNSEL
BY: MARSHAL VICTOR 5/19/10
MARSHAL VICTOR DATE

BY _____
"County"
(Seal)

"Corporation"
(Seal)