

SUBMITTAL TO THE BOARD OF SUPERVISORS
COUNTY OF RIVERSIDE, STATE OF CALIFORNIA

401B



FROM: TLMA - Transportation Department

SUBMITTAL DATE:
September 16, 2010

SUBJECT: Accepting portions of Howard Road, Boulton Road, Holt Lane and Vesper Road, in the Anza area, Third Supervisorial District.

RECOMMENDED MOTION: Adopt Resolution No. 2010-268, accepting portions of Howard Road, Boulton Road, Holt Lane and Vesper Road.

BACKGROUND: The applicant for Parcel Map 34498 has requested the acceptance of these roads in order to have sufficient accepted public right of way to satisfy the conditions of approval for public primary and secondary access.

REVIEWED BY EXECUTIVE OFFICE

DATE 10/5/10 Tm
Tina Grande

FORM APPROVED COUNTY COUNSEL

BY: Cynthia M. Gunzel 9-23-10
DATE Departmental Concurrence
SYNTHIA M. GUNZEL

Juan C. Perez
Director of Transportation

WJH
Attachments: Resolution No. 2010-268
Exhibit "A"

Dep't Recomm.: ☒ Consent ☐ Policy
Per Exec. Ofc.: ☒ Consent ☐ Policy

Prev. Agn. Ref.

District: 3

Agenda Number:

2.28

2
3 **RESOLUTION NO 2010-268**

4
5 ACCEPTING PORTIONS OF HOWARD ROAD, BOULTON ROAD
6 HOLT LANE AND VESPER ROAD IN THE ANZA AREA

7
8 (Third Supervisorial District)

9
10 **WHEREAS**, the hereinafter described roads were offered for road right of way
11 purposes by the documents hereinafter-referred to, which offers of dedication had not been
12 previously accepted for public use by the County of Riverside, now, therefore;

13
14 **BE IT RESOLVED, DETERMINED AND ORDERED** by the Board of Supervisors of
15 the County of Riverside, State of California, in regular session assembled on _____ ,
16 2010, that this Board accepts the offers of dedication and recognizes that said roads are
17 public roads open for use by the general public;

18
19 **BE IT FURTHER RESOLVED, DETERMINED, AND ORDERED** that this acceptance
20 is for the purpose of vesting title in the County of Riverside on behalf of the public for public
21 road and utility uses, and is not an acceptance of the roads into the County Maintained Road
22 System pursuant to Section 941 of the Streets and Highways Code and that said roads will
23 not become part of the County Maintained Road System unless subsequently accepted into
24 said Maintained Road System by a resolution adopted by this Board;

FORM APPROVED COUNTY COUNSEL
BY: *Synthia M. Gunzel* 9-23-10
DATE: _____
SYNTHIA M. GUNZEL

1 **Resolution No. 2010-268**

2 Said roads are in the County of Riverside, State of California, and are described as follows:

3
4 **Howard Road** (See Exhibit "A")

5 Those portions of Howard Road, (44.00 feet) shown as Lot "M" on Parcel Map filed in
6 Book 50, page 60, of Parcel Maps, and (44.00 feet) shown as Lot "F" on Parcel Map filed in
7 Book 54, Page 97, of Parcel Maps, and (44.00 feet) shown as Lot "A" on Parcel Map filed in
8 Book 20, Page 5, of Parcel Maps, all Records of Riverside County, California, and (30.00
9 feet), of Instrument No. 55870, recorded on May 1, 1973, and (44.00 feet), of Instrument No.
10 55866, recorded May 1, 1974, and (44.00 feet), of Instrument No. 86380, recorded July 10,
11 1974, and (44.00 feet), of Instrument No. 144025, recorded November 11, 1974, all Official
12 Records of Riverside County, California,

13
14 **Boulton Road** (See Exhibit "A")

15 That portion of Boulton Road (30.00 feet) shown as Lot "B" on Parcel Map filed in
16 Book 20, Page 5, of Parcel Maps, Records of Riverside County, California.

17
18 **Holt Lane** (See Exhibit "A")

19 That portion of Holt Lane (30.00 feet) shown as Lot "C" on Parcel map, filed in Book
20 20, Page 5, of Parcel Maps, Records of Riverside County, California.

1 **Resolution No. 2010-26**

2
3 **Vesper Road** (See Exhibit "A")

4 That portion of Vesper Road (30.00 feet) described in Instrument No. 154283 recorded
5 November 29, 1973, and Instrument No. 154283, recorded November 29, 1973, both Official
6 Records of Riverside County, California, and that portion of Vesper Road (30.00 feet) shown
7 as Lot "J" on Parcel Map, filed in Book 56, Page 60, of Parcel Maps, Records of Riverside
8 County, California.

9
10 **BE IT FURTHER RESOLVED** that the Clerk of the Board shall cause a certified copy of this
11 resolution to be recorded in the Office of the County Recorder of Riverside County, California.

12
13
14
15
16
17
18
19
20
21
22
23 WJH

24 W.O. No. FPM34498



N.T.S.
T. 7S, R. 3E
SECTION 18 & 19
S.B.M.

EXHIBIT "A"

Accepting a portion of Howard Road, Boulton Road,
Holt Lane and Vesper Road

PM 34498

BOULTON RD

HOLT LN

See Sheet 3 of 4

CAVE ROCK RD

See sheet 4 of 4

HOWARD RD

See Sheet 2 of 4

MOON MIST DR

AYERS WAY

AYERS RD

VESPER RD

EL RAY CIR

Highway 371

SHEET 1 OF 4



EXHIBIT "A"

Accepting a portion of Howard Road, Boulton Road,
Holt Lane and Vesper Road

N.T.S.
T. 7S, R. 2E & 3E
SECTIONS 19 & 24
S.B.M.

See sheet 3 of 4

CAVE ROCK RD

44' Per Instrument No. 55866
Recorded 5/1/1973
and Instrument No. 144025
Recorded 11/7/1974

T.7S.R.2E.

**Section
24**

44' Per instrument No. 55866
Recorded 5/1/1973
and Instrument No. 86380
Recorded 7/10/1974

HOWARD RD

PM 15/81

Parcel 1

Parcel 2

Parcel 3

Parcel 4

T.7S.R.3E.

**Section
19**

PM 13/94

Parcel 1

Parcel 2

Parcel 3

Parcel 4

AYERS WAY

AYERS RD

Parcel 2

PM54/97

Parcel 3

44' Per PM 54/97
Lot "F"

Parcel 4

30' Per Instrument No.
55870 Rec. 05-01-1973

44' Per PM 56/60
Lot "L"

PM 56/60
Parcel 2

44' Per PM 56/60
Lot "M"

PM 56/60
Parcel 1

HIGHWAY 371

SHEET 2 OF 4

SCOUTS LN



EXHIBIT "A"

Accepting a portion of Howard Road, Boulton Road,
Holt Lane and Vesper Road

T. 7S, R. 2E & 3E
SECTION 13 & 18
S.B.M.

HOWARD RD

Parcel Map 34498

PONY TRL

Section
13

BOULTON RD

Section
18

30' Per PM 20/5
Lot "B"

Lot "A"

Parcel 1

30' Accepted Per PM 84/50

PM 84/50
Parcel 2

T.7S.R.2E.

T.7S.R.3E.

PM 20/5

Parcel 1

HOWARD RD

44' Per PM 20/5
Lot "A"

Parcel 3

Lot "B"

Lot "C"

Lot "D"

HOLT LANE

Parcel 2

30' Per PM 20/5
Lot "C"

CAVE ROCK RD

See sheet 2 of 4

See sheet 4 of 4

Section
24

Section
19

VESPER RD



N.T.S.

T.7S, R. 3E
SECTION 18 & 19
S.B.M.

EXHIBIT "A"

Accepting a portion of Howard Road, Boulton Road,
Holt Lane and Vesper Road

HOLT LN

See Sheet 3 of 4

CAVE ROCK RD

PM 16/1

Parcel 1

Parcel 2

Parcel 3

Parcel 4

30' per Instrument No. 154283
Recorded 11/29/1973

Section
19

PM 16/13

Parcel 1

Parcel 2

Parcel 3

Parcel 4

30' per Instrument No. 154283
Recorded 11/29/1973

AYERS RD

PM 56/60
Parcel 2

30' per PM 56/60
Lot "J"

T.7S.R.3E.

MOON MIST DR

VESPER RD

EL RAY CIR

Section
18

Highway 371

SHEET 4 OF 4



VICINITY MAP

ANZA AREA

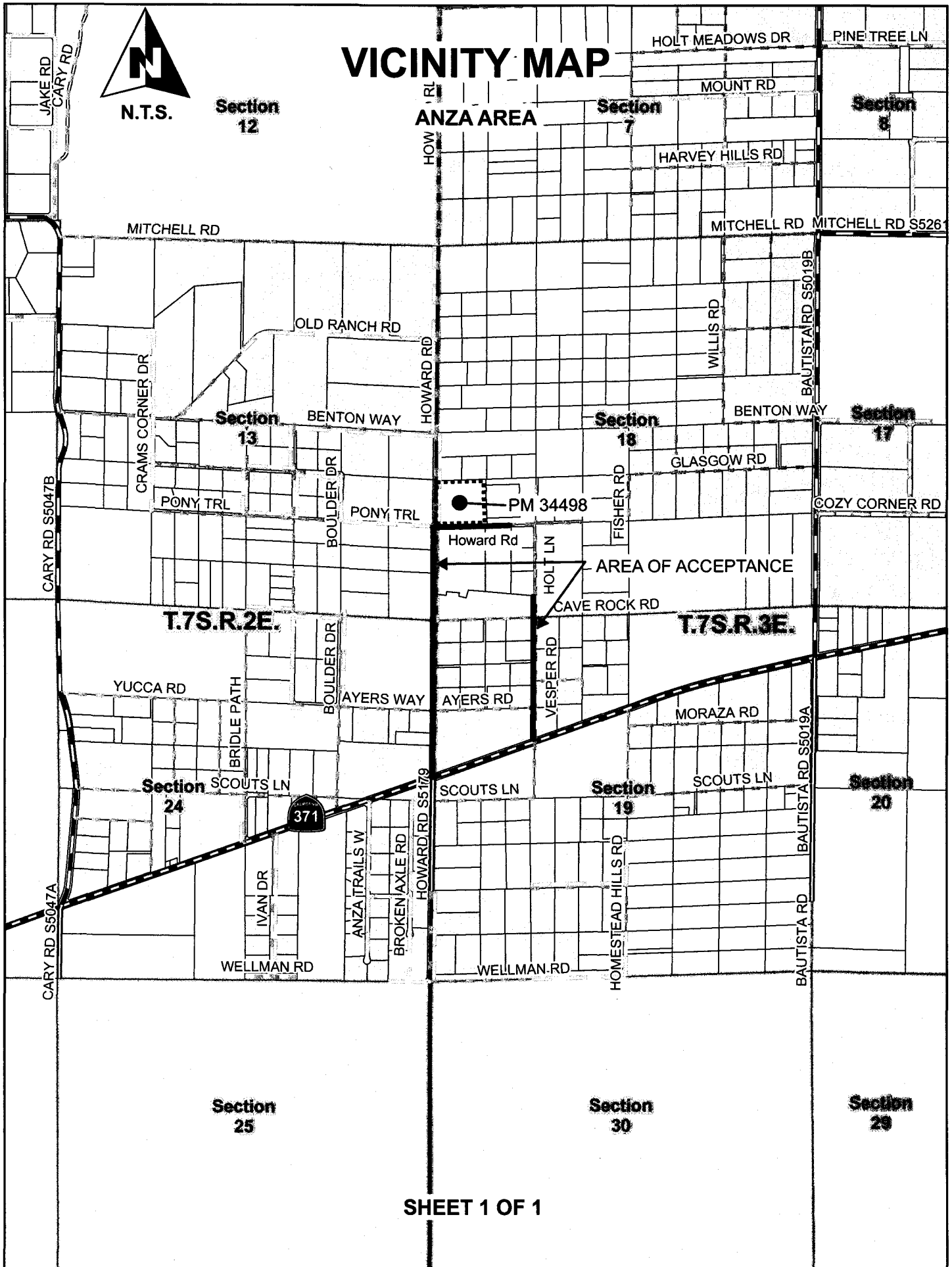

SHEET 1 OF 1