

SUBMITTAL TO THE BOARD OF SUPERVISORS
COUNTY OF RIVERSIDE, STATE OF CALIFORNIA

101B



FROM: TLMA - Transportation Department

SUBMITTAL DATE:
March 24, 2011

SUBJECT: Accepting Kerber Court in the Glen Ivy Hot Springs area, First Supervisorial District.

RECOMMENDED MOTION: Adopt Resolution No. 2011-066, accepting Kerber Court.

BACKGROUND: The applicant has improved Kerber Court within Parcel Map 13387 to county standards for acceptance into the County Maintained Road System.

REVIEWED BY EXECUTIVE OFFICE

DATE 3/24/11 TLMA

Tina Grande

FORM APPROVED COUNTY COUNSEL

BY: Synthia M. Gunzel DATE 3-23-11

DATE Departmental Concurrence

SYNTHIA M. GUNZEL

Juan C. Perez
Director of Transportation

WJH
Attachments: Resolution No. 2011-066
Exhibit "A"

Dept't Recomm.:	<input checked="" type="checkbox"/> Consent	<input type="checkbox"/> Policy
Per Exec. Ofc.:	<input checked="" type="checkbox"/> Consent	<input type="checkbox"/> Policy

Prev. Agn. Ref.

District: 1

Agenda Number:

2.8

1 BOARD OF SUPERVISORS

COUNTY OF RIVERSIDE

2
3 **RESOLUTION NO 2011-066**
4

5 **ACCEPTING KERBER COURT IN THE GLEN IVY HOT SPRINGS AREA**
6 **(First Supervisorial District)**
7

8 **WHEREAS**, the hereinafter described roads were offered for dedication for road
9 and public utility purposes by the documents hereinafter-referred to, which offer of
10 dedication has not been previously accepted for public use by the County of Riverside,
11 now, therefore;
12

13 **BE IT RESOLVED, DETERMINED AND ORDERED** by the Board of Supervisors of
14 the County of Riverside, State of California, in regular session assembled on
15 _____, 2011, that this Board accepts the offer of dedication
16 and recognizes that said roads are public roads open for use by the general public;
17

18 **BE IT FURTHER RESOLVED, DETERMINED, AND ORDERED** that this
19 acceptance is for the purpose of vesting title in the County of Riverside on behalf of the
20 public for public road and utility purposes, and will be an acceptance of the road into the
21 County Maintained Road System, pursuant to Section 941 of the Streets and Highways
22 Code;
23
24

FORM APPROVED COUNTY COUNSEL
BY: *Synthia M. Gunzel* DATE: *3-22-11*
SYNTHIA M. GUNZEL

1 **Resolution No. 2011-066**

2
3 Said road is in Riverside County, California, and is described as follows:

4
5 **Kerber Court** (See Exhibit "A")

6 Kerber Court (50.00 feet wide) shown as Lot's "C" through "F", on Parcel Map No.
7 13387 filed in Book 71, Pages 72 and 73 of Parcel Maps, Records of Riverside
8 County, California

9
10 **BE IT FURTHER RESOLVED, DETERMINED AND ORDERED** that the Clerk of the
11 Board is directed to cause a certified copy of this resolution to be recorded in the office
12 of the Recorder of the County of Riverside, California.

13
14
15
16
17
18
19
20
21
22
23
24 WJH

25 W.O. SUR09027

EXHIBIT "A"

Acceptance of Kerber Court



N.T.S.
T. 5S, R. 6W
SECTION 3
S.B.M.

MB306/60-86

Parcel Map 71/72-73

Parcel 1

Parcel 2

Lot "D"

Lot "E"

Parcel 3

50.00 feet

Lot "C"

Lot "F"

KERBER COURT

Parcel 4

WARM SPRINGS DRIVE

MB 306/60-86

PM 98/34

Parcel 1

SONGSPARROW LN

SHEET 1 OF 1

Parcel 2

VICINITY MAP



N.T.S.

T. 5S, R. 6W
SECTION 3
SBM

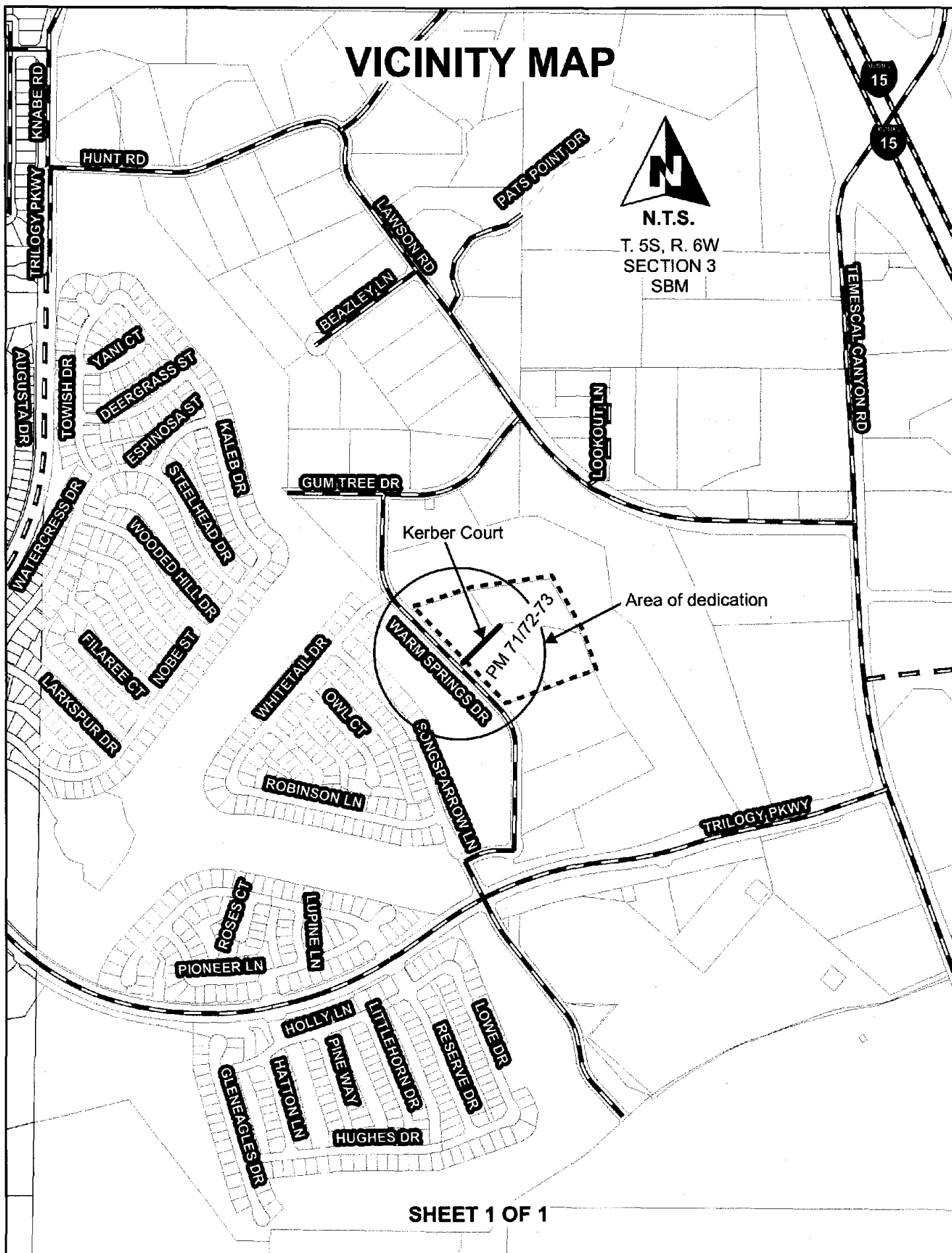

SHEET 1 OF 1

To be removed before recording