

**SUBMITTAL TO THE BOARD OF SUPERVISORS  
COUNTY OF RIVERSIDE, STATE OF CALIFORNIA**



189A

**FROM:** TLMA - Transportation Department

**SUBMITTAL DATE:**  
June 16, 2011

**SUBJECT:** Construction of Rancho California Road and Anza Road roundabout, Rancho California area.

**RECOMMENDED MOTION:** That the Board of Supervisors:

1. Approve the plans and specifications for the construction of a roundabout at the intersection of Rancho California Road and Anza Road in the Temecula Area of Riverside County.
2. Authorize the Clerk to advertise for bids to be received in the office of the Director of Transportation up to the hour of 2:00 pm, Wednesday, July 20, 2011, at which time bids will be opened.

Juan C. Perez  
Director of Transportation

JCP:jrr:rr  
(Continued On Attached Page)

<b>FINANCIAL DATA</b>	Current F.Y. Total Cost:	\$ 1,632,472	In Current Year Budget:	Yes
	Current F.Y. Net County Cost:	\$ 0	Budget Adjustment:	No
	Annual Net County Cost:	\$ 0	For Fiscal Year:	2010/2011
<b>SOURCE OF FUNDS:</b> DIF Major Improvement Fund 30525 (70%), Measure A (30%)			<b>Positions To Be Deleted Per A-30</b>	<input type="checkbox"/>
There are no General Funds used in this project			<b>Requires 4/5 Vote</b>	<input type="checkbox"/>

**C.E.O. RECOMMENDATION:**

APPROVE

BY:   
Tina Grant

**County Executive Office Signature**

FORM APPROVED COUNTY COUNSEL  
BY:   
MARSHAL L. VICTOR  
DATE: 6/15/11

Departmental Circumstances

Dept Recomm.:  Consent  Policy

Per Exec. Ofc.:  Consent  Policy

Prev. Agn. Ref. 9/16/08, Item 3.52 | District: 3 | Agenda Number:

**3.105**

The Honorable Board of Supervisors

RE: Construction of Rancho California Road and Anza Road roundabout,  
Rancho California area.

June 16, 2011

Page 2 of 2

**BACKGROUND:** The Transportation Improvement Program provides for the construction of a single lane roundabout at the intersection of Rancho California Road and Anza Road in the Temecula Valley (Wine Country) area of Riverside County. Capacity improvements are needed to accommodate current traffic, which often queues at the intersection, and future traffic increases. The construction of a roundabout has been determined to be the appropriate operational improvement at this location, and more suitable than a conventional traffic signal.

The proposed roundabout will improve efficiency and safety through the intersection while retaining the special, rural character of the Wine Country landscape. Studies have shown that construction of similar roundabouts have reduced the number of injuries and fatalities in collisions by 75% on average, and 35% for all types of collisions. The Rancho California Road and Anza Road Roundabout will reduce the approach speeds to between 15-20 mph. This will allow vehicular, equestrian, bicycle and pedestrian traffic to interact through the intersection more efficiently and safely.

Additional improvements include the placement of curb and gutter, landscaping, decomposed granite trails, replacement of existing culverts, a storm drain system, and an infiltration basin for water quality purposes and other associated improvements. Also included as an alternate bid item is a separate equestrian trail crossing on Rancho California Road a distance away from the Anza intersection, which would enhance crossing safety for equestrians.

The bid documents include the following schedules of work:

- Base Bid: Primary items of work.
- Alternate 1: Relocation of facilities for Rancho California Water District
- Alternate 2: Construction of a separate equestrian crossing at Rancho California Road for County Parks District.

If the Rancho California Water District and the County Regional Parks District concur with bid prices, as bid by the apparent low bidder, these alternative bid schedules will be included with the contract award and the costs for the work will be funded by the Water District and Parks District.

Construction of the roundabout at Rancho California Road and Anza Road is expected to start in January 2012, when traffic visiting the wineries is typically at its lowest level.

The submitted plans and specifications have been approved as to form by County Counsel.

Environmental clearance is complete.

Project No. B9-0957

# COUNTY OF RIVERSIDE DEPARTMENT OF TRANSPORTATION

## RANCHO CALIFORNIA ROAD AT ANZA ROAD ROUNDBABOUT

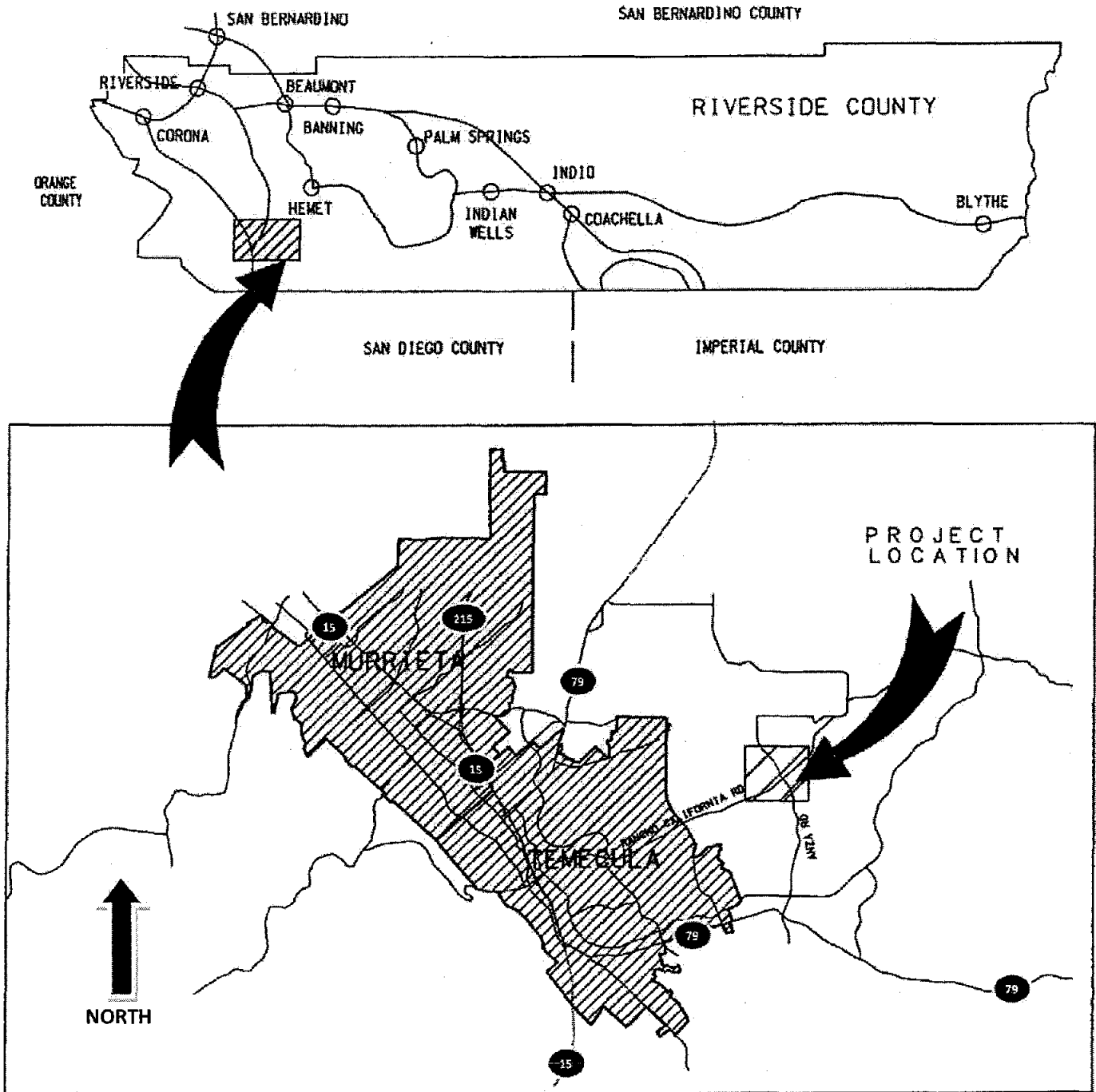

### VICINITY MAP

**PLANTING LEGEND**

SYMBOL	BOTANICAL NAME	COMMON NAME	SIZE	SPACING	QUANTITY	MATERIAL SIZE	MATERIAL USE DETAILS	REMARKS
	<i>OLEA EUROPAEA 'SWAN HILL'</i>	FRUITLESS OLIVE TREE	4' BOX	AS SHOWN	25	30" H X 20" SQ W/L	-	MULTI TRUNK
	<i>CARISSA 'BOWWOOD BEAUTY'</i>	NATAL PLUM	5 GAL	AS SHOWN	7	H X 7' W	M	-
	<i>ROSA X 'NOIRE'</i>	RED CARPET ROSES	1 GAL	AS SHOWN	2	12" H X 3" W	M	-
	<i>MULLENBERGIA RIGIDA</i>	PURPLE MULLY	5 GAL	5' OC	7	H X 7' W	L	-
	4" TO 8" DIA. GROUDED COBBLE STONE							

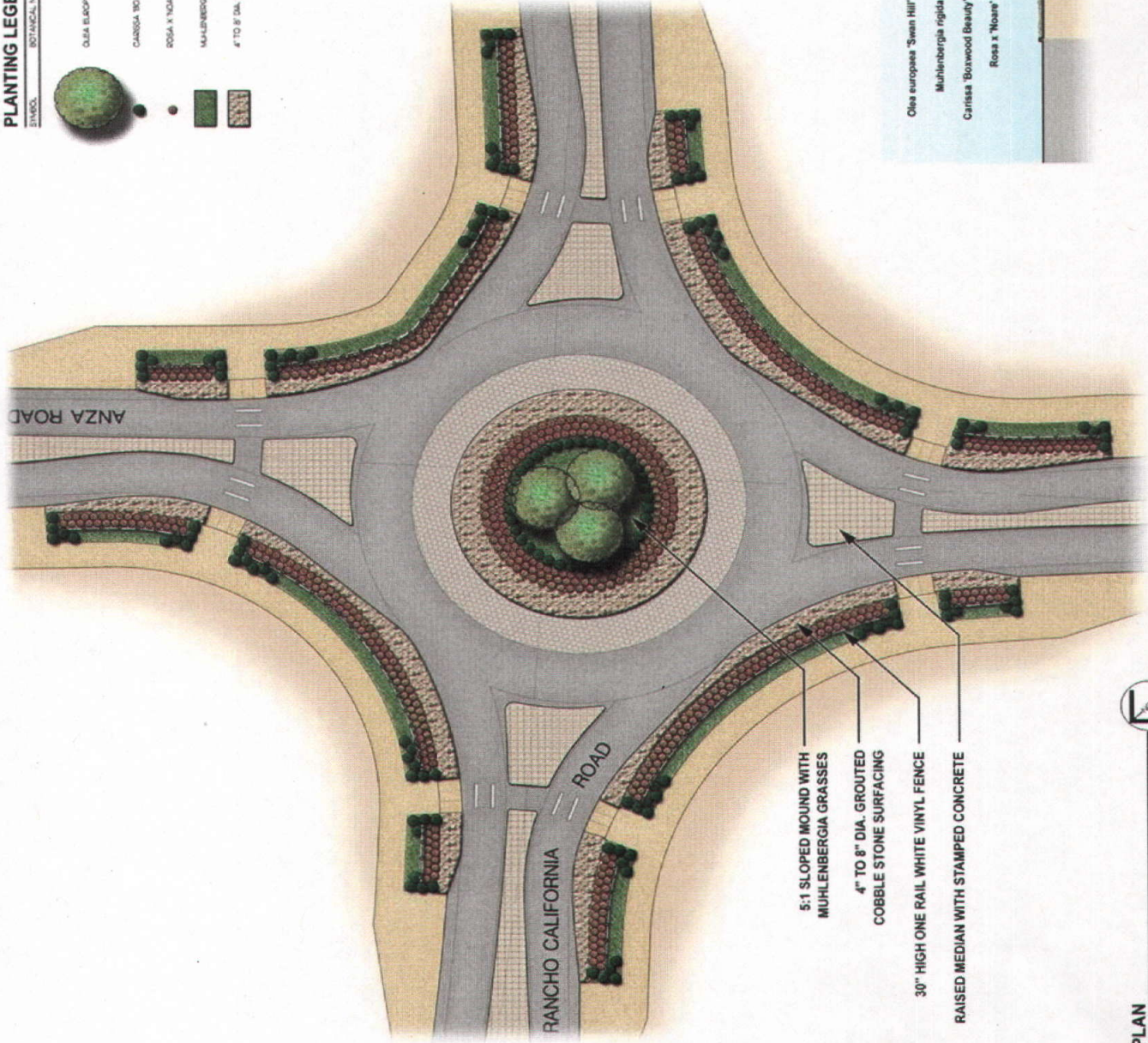

- 5:1 SLOPED MOUND WITH MULLENBERGIA GRASSES
- 4" TO 8" DIA. GROUDED COBBLE STONE SURFACING
- 30" HIGH ONE RAIL VINYL FENCE
- RAISED MEDIAN WITH STAMPED CONCRETE



PLAN

**PROPOSED PLANT MATERIALS**



*Olea europaea 'Swan Hill'*  
- Fruitless Olive Tree



*Muhlenbergia rigida*  
- Purple Mully



*Carissa 'Bowwood Beauty'*  
- Natal Plum



*Rosa x 'Noire'*  
- Red Carpet Roses



ROUNDABOUT ELEVATION

SCALE: 1/8"=1'-0"