

**SUBMITTAL TO THE BOARD OF SUPERVISORS
COUNTY OF RIVERSIDE, STATE OF CALIFORNIA**

321A



FROM: TLMA - Transportation Department

SUBMITTAL DATE:
December 8, 2011

SUBJECT: Ordinance No. 452.231 to establish speed zones enforceable by radar speed detection equipment - Hemet, Lake Elsinore, Murrieta, Temecula, Temescal Canyon and Woodcrest areas

RECOMMENDED MOTION: That the Board of Supervisors:

1. Introduce and adopt, on successive weeks, Ordinance No. 452.231, amending Ordinance No. 452 relating to prima facie speed limits to establish various speed zones in the above-referenced areas of Riverside County.

BACKGROUND: Transportation Department staff has conducted Engineering and Traffic Surveys (E&TS) for various roads in the subject areas, as required by the California Vehicle Code.

Juan C. Perez
Director of Transportation

(Continued On Attached Page)

FINANCIAL DATA	Current F.Y. Total Cost:	\$ 0	In Current Year Budget:	N/A
	Current F.Y. Net County Cost:	\$ 0	Budget Adjustment:	N/A
	Annual Net County Cost:	\$ 0	For Fiscal Year:	N/A

SOURCE OF FUNDS:	Positions To Be Deleted Per A-30	<input type="checkbox"/>
	Requires 4/5 Vote	<input type="checkbox"/>

C.E.O. RECOMMENDATION:

APPROVE

BY:
Tina Grande

County Executive Office Signature

FORM APPROVED COUNTY COUNSEL
 BY:
 PATTY F. SMITH
 DATE: 12/7/11
 Departmental Concurrence

Dept't Recomm.: Consent Policy
 Per Exec. Ofc.: Consent Policy

Prev. Agn. Ref. 06/28/11, 3.110 | **District:** 1 & 3 | **Agenda Number:**

3.20

The Honorable Board of Supervisors

RE: Ordinance No. 452.231 to establish speed zones enforceable by radar speed detection equipment - Hemet, Lake Elsinore, Murrieta, Temecula, Temescal Canyon and Woodcrest areas

December 8, 2011

Page 2 of 2

Based upon the results of the E&TS for these roads, the radar-enforceable speed limits recommended by the Department are summarized in the attached tables. Speed zone diagrams are also provided as a reference.

It is recommended that the Board of Supervisors adopt this amendment at the next regularly scheduled meeting.

County Counsel has approved the ordinance amendment.

Transportation Department staff has contacted the Riverside and Temecula area offices of the California Highway Patrol regarding the proposed speed zones.

1 ORDINANCE NO. 452.231

2 AN ORDINANCE OF THE COUNTY OF RIVERSIDE

3 AMENDING ORDINANCE NO. 452

4 RELATING TO PRIMA FACIE SPEED LIMITS

5 The Board of Supervisors of the County of Riverside ordains as follows:

6 Section 1. Section 2.3 of Ordinance No. 452, entitled “Thirty-five miles per hour,” is
7 amended to add new subsections 108, 109, 110, 111, and 112 thereto to read as follows:

8 “108. On Central Park Drive between the centerline of Calistoga Drive
9 and a point 575 feet east of Sugar Pine Way, a total distance of
10 approximately 0.60 miles, in the Temecula area.

11 109. On Clay Canyon Drive between the centerline of Knabe Road (N)
12 and the centerline of Knabe Road (S), a total distance of
13 approximately 0.75 miles, in the Temescal Canyon area.

14 110. On Haines Street between the centerline of Rider Street and the
15 centerline of Cajalco Road, a total distance of approximately 0.5
16 miles, in the Woodcrest area.

17 111. On Hemet Street between the centerline of Little Lake Road and
18 the centerline of Florida Avenue/SH-74, a total distance of
19 approximately 1.1 mile, in the Hemet area.

20 112. On Willows Avenue between the centerline of North General
21 Kearney Road and the centerline of Central Park Drive, a total
22 distance of approximately 0.78 miles, in the Temecula area.”

23 Section 2. Section 2.4 of Ordinance No. 452, entitled “Forty miles per hour,” is
24 amended to add new subsection 130 thereto to read as follows:

25 “130. On Machado Street between the centerline of Grand Avenue and
26 200 feet north of Alvarado Street, a total distance of approximately
27 0.59 miles, in the Lake Elsinore area.”

1 Section 3. Section 2.5 of Ordinance No. 452, entitled “Forty-five miles per hour,” is
2 amended to add new subsection 152 thereto to read as follows:

3 “152. On Haines Street between the centerline of Cajalco Road and the
4 centerline of Nandina Avenue, a total distance of approximately
5 2.0 miles, in the Woodcrest area.”

6 Section 4. Section 2.6 of Ordinance No. 452, entitled “Fifty miles per hour,” is
7 amended to add new subsection 69 and 70 thereto to read as follows:

8 “ 69. On Calle Nopal between the centerline of Anza Road and the
9 centerline of Cruz Way, a total distance of approximately 1.0 mile,
10 in the Temecula area.

11 70. On Leon Road between the centerline of Clinton Keith Road and
12 the centerline of Baxter Road, a total distance of approximately
13 1.15 miles, in the Murrieta area.”

14 Section 5. Subsection 9 of Section 2.4 of Ordinance No. 452 adopted on February 4,
15 2003, pursuant to Ordinance No. 452.214 is repealed in its entirety. Subsection 9 of Section 2.4
16 established a forty miles per hour speed limit on Hemet Street between the centerline of Little Lake Road
17 and the south curb line of State Highway 74.

18 Subsection 106 of Section 2.5 of Ordinance No. 452 adopted on September 13, 2005,
19 pursuant to Ordinance No. 452.221 is repealed in its entirety. Subsection 106 of Section 2.5 established a
20 forty-five miles per hour speed limit on Calle Nopal between Anza Road and Cruz Way.

21 \\
22 \\
23 \\
24 \\
25 \\
26 \\
27 \\
28 \\

1
2
3
4
5
6
7
8
9
10
11
12
13
14
15
16
17
18
19
20
21
22
23
24
25
26
27
28

Section 6. This ordinance shall take effect 30 days after its adoption.

BOARD OF SUPERVISORS OF THE COUNTY
OF RIVERSIDE, STATE OF CALIFORNIA

BY: _____
Chairman

ATTEST:
KECIA HARPER-IHEM, Clerk of the Board

By: _____
Deputy

APPROVED AS TO FORM:
PAMELA J. WALLS, County Counsel

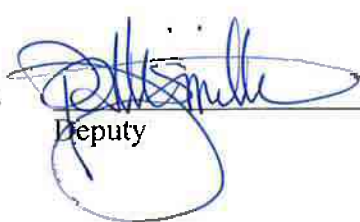
By:  _____
Deputy

**LIST OF SPEED ZONE SUBMITTALS
ORDINANCE AMENDMENT NO 452.231
SUPERVISORIAL DISTRICT NO. 1**

AREA	ROAD NAME/ LIMITS	EXISTING SPEED LIMIT	PROPOSED SPEED LIMIT	NOTES
TEMESCAL CANYON	CLAY CANYON DRIVE Between the centerline of Knabe Road (N) and the centerline of Knabe Road (S)	* Not Posted	35	NEW
WOODCREST	HAINES STREET Between the centerline of Rider Street and the centerline of Cajalco Road	* Not Posted	35	NEW
WOODCREST	HAINES STREET Between the centerline of Cajalco Road and the centerline of Nandina Avenue	* Not Posted	45	NEW
LAKE ELSINORE	MACHADO STREET Between the centerline of Grand Avenue and 200' N/O Alvarado Street	* Not Posted	40	NEW

- * Maximum allowable speed limit for a two-lane highway is 55 mph
- **Maximum allowable speed limit for a multi-lane highway is 65 mph
- ***Change in speed zone boundary

CLAY CANYON DRIVE (#1480)

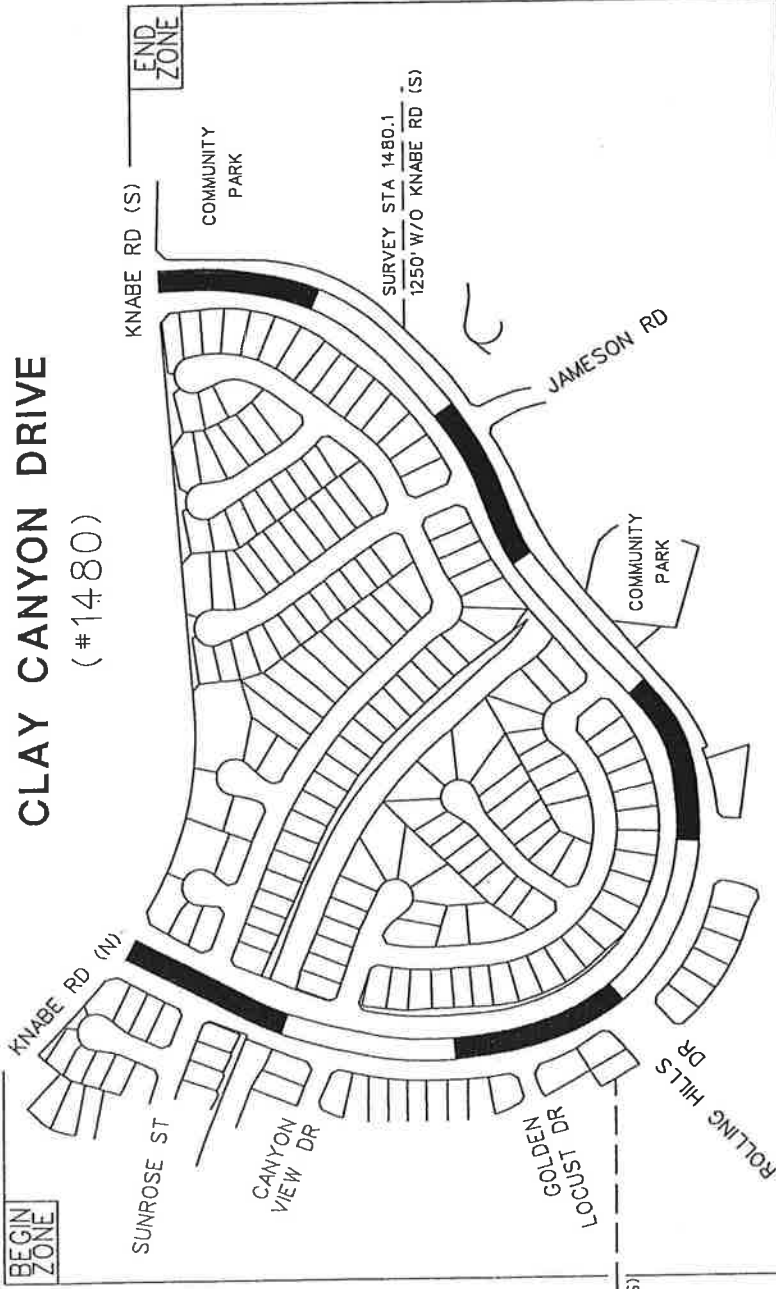

- LEGEND:
- ////// CITY LIMITS
 - ▬ RADAR ZONE
 - - - SURVEY STATION
 - ▬ OTHER STREET OR ROAD
 - ↑ SCHOOL

SURVEY STA 1480.2
2450' W/O KNABE RD (S)

SURVEY STA 1480.1
1250' W/O KNABE RD (S)



NO SCALE

RECOMMENDED SPEED LIMIT	RESIDENTIAL AREA - COMMUNITY PARK - REDUCE TO 35 MPH
85th% TILE SPEED	35 MPH
VEHICLES IN 24 HR (2 WAY)	40.5 MPH (AVERAGE OF TWO SIMILAR STATIONS OF 44.0 MPH & 37.0 MPH)
SEGMENT LENGTH	970
ALL ACCIDENTS IN 2 YRS.	0.75 MILE
ACCIDENT RATE ☆	0
EXISTING SPEED LIMIT	0.00 ACC/MVM
	NOT POSTED

☆ RATE = NO. OF ACCIDENT x 1,000,000
VEH x 365 x 2 x MILE

APPROVED BY:
Lawrence T. Tai
DATE: 8/29/2011
LAWRENCE T. TAI, P.E.
COUNTY TRAFFIC ENGINEER

SURVEY DATE: FEB 17, 2011
MAP DATE: AUG 8, 2011
DRAWN BY: N AHMAD
CAD FILE: CLAY CYN DR.DGN

COUNTY AREA: TEMESCAL CANYON
COUNTY MAP: 33A
SUPERVISOR DISTRICT: 1



COUNTY OF RIVERSIDE
TRANSPORTATION DEPARTMENT
TRAFFIC ENGINEERING DIVISION

ENGINEERING AND TRAFFIC SURVEY
AT
CLAY CANYON DRIVE

HAINES STREET (#1479)

- LEGEND:**
- CITY LIMITS
 - RADAR ZONE
 - SURVEY STATION
 - OTHER STREET OR ROAD
 - SCHOOL

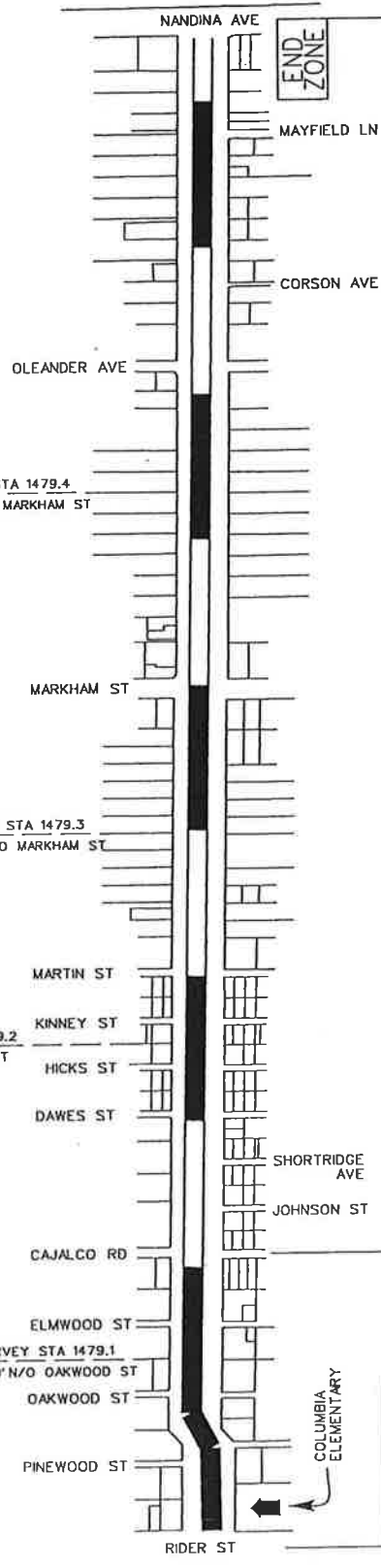

NO SCALE	
RECOMMENDED SPEED LIMIT	45 MPH
85th% TILE SPEED	48.0 MPH
VEHICLES IN 24 HR (2 WAY)	1,100
SEGMENT LENGTH	2.0 MILE
ALL ACCIDENTS IN 2 YRS.	9
ACCIDENT RATE ☆	5.60 ACC/MVM
EXISTING SPEED LIMIT	NOT POSTED

☆ RATE: NO. OF ACCIDENT x 1,000,000
VEH x 365 x 2 x MILE

SURVEY DATE:	APR 7, 2011
MAP DATE:	JUN 6, 2011
DRAWN BY:	N AHMAD
CAD FILE:	HAINES ST.DGN

APPROVED BY: *Lawrence T. Tai*
DATE: 8/25/2011
LAWRENCE T. TAI, P.E.
COUNTY TRAFFIC ENGINEER

MACHADO STREET (#1485)

- LEGEND:
- CITY LIMITS
 - RADAR ZONE
 - SURVEY STATION
 - OTHER STREET OR ROAD
 - SCHOOL

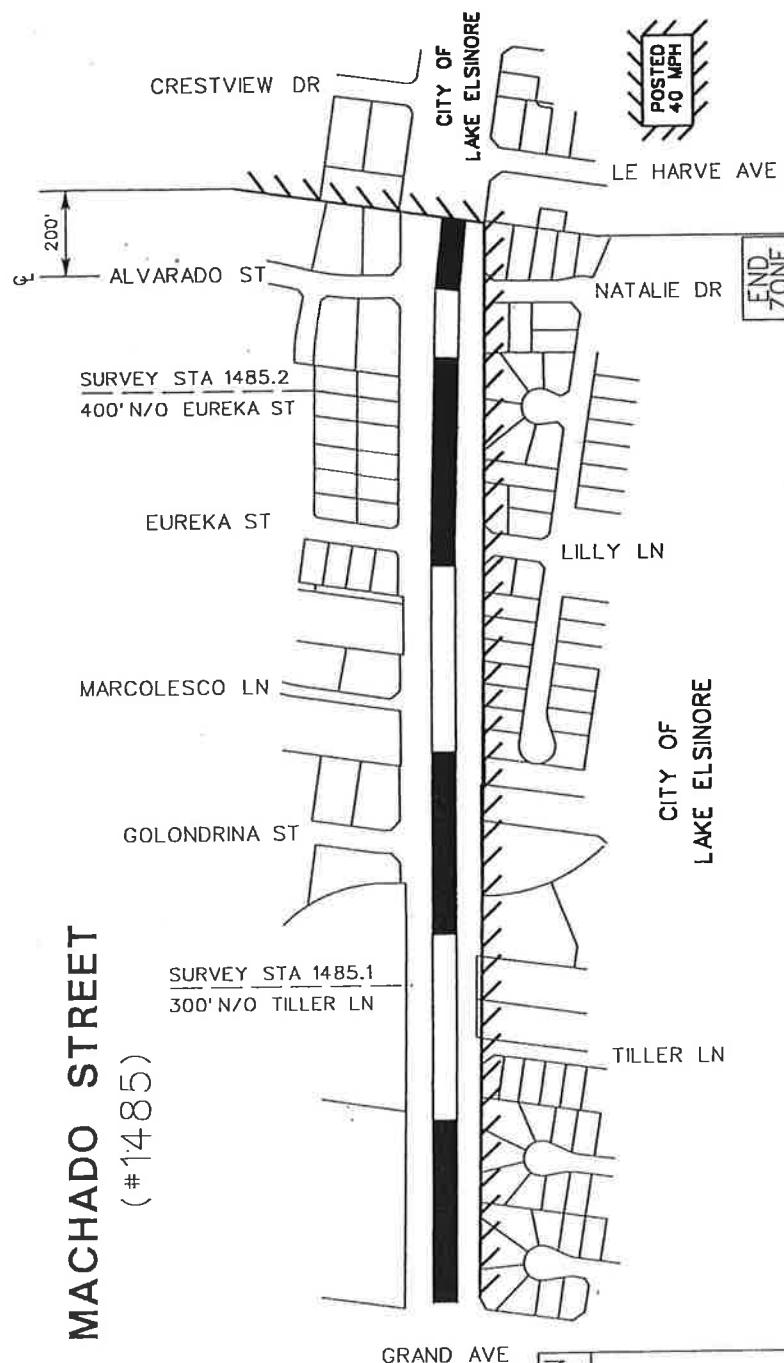

BEGIN ZONE

END ZONE

VARYING ROADWAY WIDTHS - VARYING SIDEWALK IMPROVEMENTS - VARYING C/G IMPROVEMENTS - SCHOOL ZONE XING - REDUCE TO 40 MPH

RECOMMENDED SPEED LIMIT	40 MPH
85th/TILE SPEED	45.5 MPH (AVERAGE OF TWO SIMILAR STATIONS OF 49 MPH & 42 MPH)
VEHICLES IN 24 HR (2 WAY)	4,300
SEGMENT LENGTH	0.59 MILE
ALL ACCIDENTS IN 2 YRS.	1
ACCIDENT RATE ☆	0.54 ACC/MVM
EXISTING SPEED LIMIT	NOT POSTED

☆ RATE: NO. OF ACCIDENT x 1,000,000
VEH x 365 x 2 x MILE

COUNTY AREA:	LAKE ELSINORE	SURVEY DATE:	AUG 23, 2011
COUNTY MAP:	38	MAP DATE:	AUG 29, 2011
SUPERVISOR DISTRICT:	1	DRAWN BY:	N AHMAD
		CAD FILE:	MACHADO.DGN

APPROVED BY: *Lawrence T. Tai*
DATE: 8/31/2011
LAWRENCE T. TAI, P.E.
COUNTY TRAFFIC ENGINEER

**LIST OF SPEED ZONE SUBMITTALS
ORDINANCE AMENDMENT NO 452.231
SUPERVISORIAL DISTRICT NO. 3**

AREA	ROAD NAME/ LIMITS	EXISTING SPEED LIMIT	PROPOSED SPEED LIMIT	NOTES
TEMECULA	CALLE NOPAL Between the centerline of Anza Road and the centerline of Cruz Way	45	50	UPDATE
TEMECULA	CENTRAL PARK DRIVE Between the centerline of Calistoga Drive and a point 575' E/O Sugar Pine Way	* Not Posted	35	NEW
HEMET	HEMET STREET Between the centerline of Little Lake Road and the centerline of Florida Avenue/SH-74	40	35	UPDATE
MURRIETA	LEON ROAD Between the centerline of Clinton Keith Road and the centerline of Baxter Road	** Not Posted	50	NEW
TEMECULA	WILLOWS AVENUE Between the centerline of North General Kearny Road and the centerline of Central Park Drive	* Not Posted	35	NEW

- * Maximum allowable speed limit for a two-lane highway is 55 mph
- **Maximum allowable speed limit for a multi-lane highway is 65 mph
- ***Change in speed zone boundary

CALLE NOPAL

(#1407)

LEGEND:

-  CITY LIMITS
-  RADAR ZONE
-  SURVEY STATION
-  OTHER STREET OR ROAD

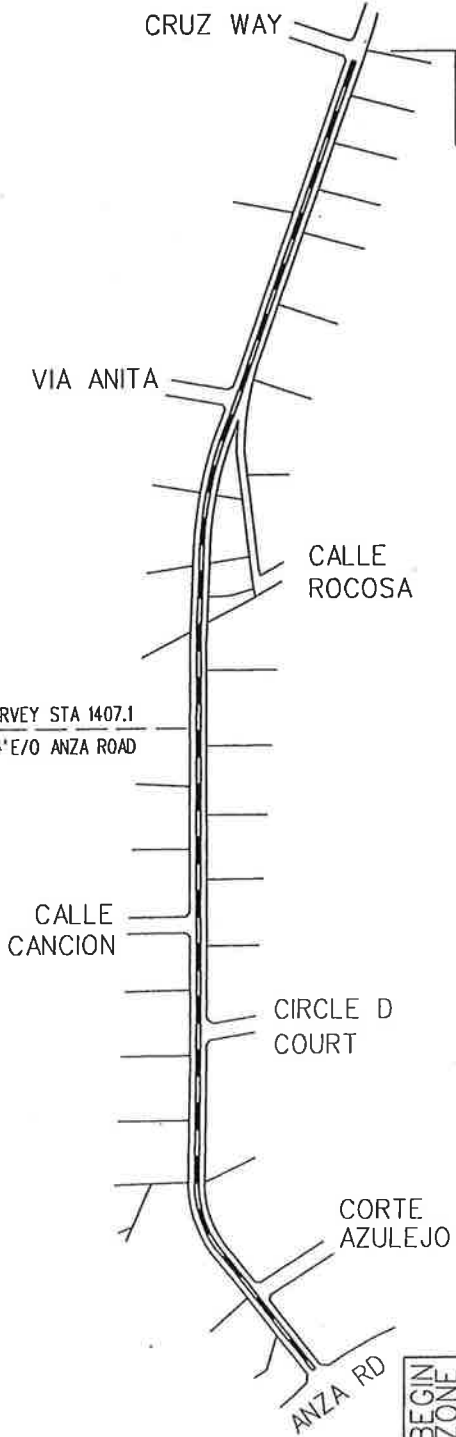

BEGIN ZONE

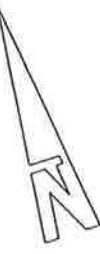

NO SCALE

END ZONE

NARROW ROADWAY - EQUESTRIANS - HIDDEN RESIDENTIAL DRIVEWAYS - REDUCE SPEED LIMIT TO 50 MPH	50 MPH
RECOMMENDED SPEED LIMIT	54.0 MPH
PREVAILING SPEED (85%)	1,000
VEHICLES IN 24 HR (2 WAY)	1.0 MILE
SEGMENT LENGTH	1
ALL ACCIDENTS IN 2 YRS.	1.37 MVM
ACCIDENT RATE ☆	45 MPH (Ord. 452.221 Sec. 2.5 No. 106)
EXISTING SPEED LIMIT	

☆ RATE: $\frac{\text{ACCIDENT} \times 1,000,000}{\text{VEH} \times 365 \times 2 \times \text{MILE}}$

APPROVED BY: *Lawrence T. Talpe*
 DATE: 9/20/2011
 LAWRENCE T. TALPE
 COUNTY TRAFFIC ENGINEER

SURVEY DATE: AUG 23, 2011
 MAP DATE: SEP 12, 2011
 DRAWN BY: N AHMAD
 CAD FILE: CALLE NOPAL.DGN

TEMECULA 129
 SUPERVISOR DISTRICT: 3

COUNTY OF RIVERSIDE
 TRANSPORTATION DEPARTMENT
 TRAFFIC ENGINEERING SECTION
 ENGINEERING AND TRAFFIC SURVEY
 AT
CALLE NOPAL
 PAGE 1 OF 1

CENTRAL PARK DRIVE (#1484)

- LEGEND:
- ////// CITY LIMITS
 - ▬ RADAR ZONE
 - ▬ SURVEY STATION
 - ▬ OTHER STREET OR ROAD
 - 🏫 SCHOOL

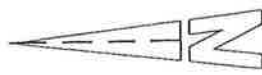
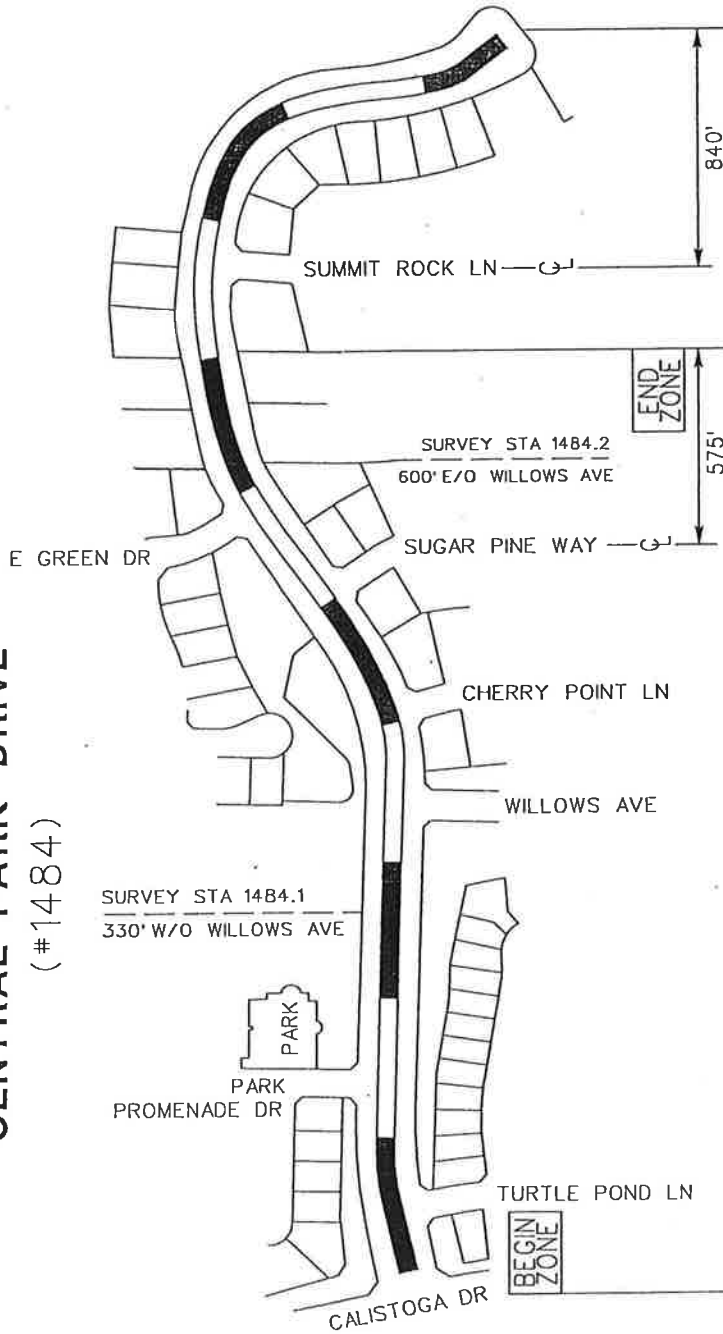

NO SCALE

RECOMMENDED SPEED LIMIT	35 MPH	* 25 MPH
85th/90th TILE SPEED /	37.0 MPH (AVERAGE OF TWO SIMILAR STATIONS OF 40.0 MPH & 34.0 MPH)	
VEHICLES IN 24 HR (2 WAY)	930	
SEGMENT LENGTH	0.60 MILE	
ALL ACCIDENTS IN 2 YRS.	0	
ACCIDENT RATE ☆	0.00 ACC/MVM	
EXISTING SPEED LIMIT	NOT POSTED	* Per CVC 515

☆ RATE: NO. OF ACCIDENT x 1,000,000
VEH x 365 x 2 x MILE

APPROVED BY:

Lawrence T. Tai
DATE: 8/29/2011

LAWRENCE T. TAI, P.E.
COUNTY TRAFFIC ENGINEER



COUNTY OF RIVERSIDE
TRANSPORTATION DEPARTMENT
TRAFFIC ENGINEERING DIVISION

ENGINEERING AND TRAFFIC SURVEY
AT

CENTRAL PARK DRIVE

SURVEY DATE:	FEB 17, 2011
MAP DATE:	AUG 16, 2011
DRAWN BY:	N AHMAD
CAD FILE:	CENTRAL_PARK.DGN

COUNTY AREA:	TEMECULA
COUNTY MAP:	124C
SUPERVISOR DISTRICT:	3

HEMET STREET (# 1107)

- LEGEND:**
- ////// CITY LIMITS
 - ▬ RADAR ZONE
 - - - SURVEY STATION
 - ==== OTHER STREET OR ROAD
 - SCHOOL

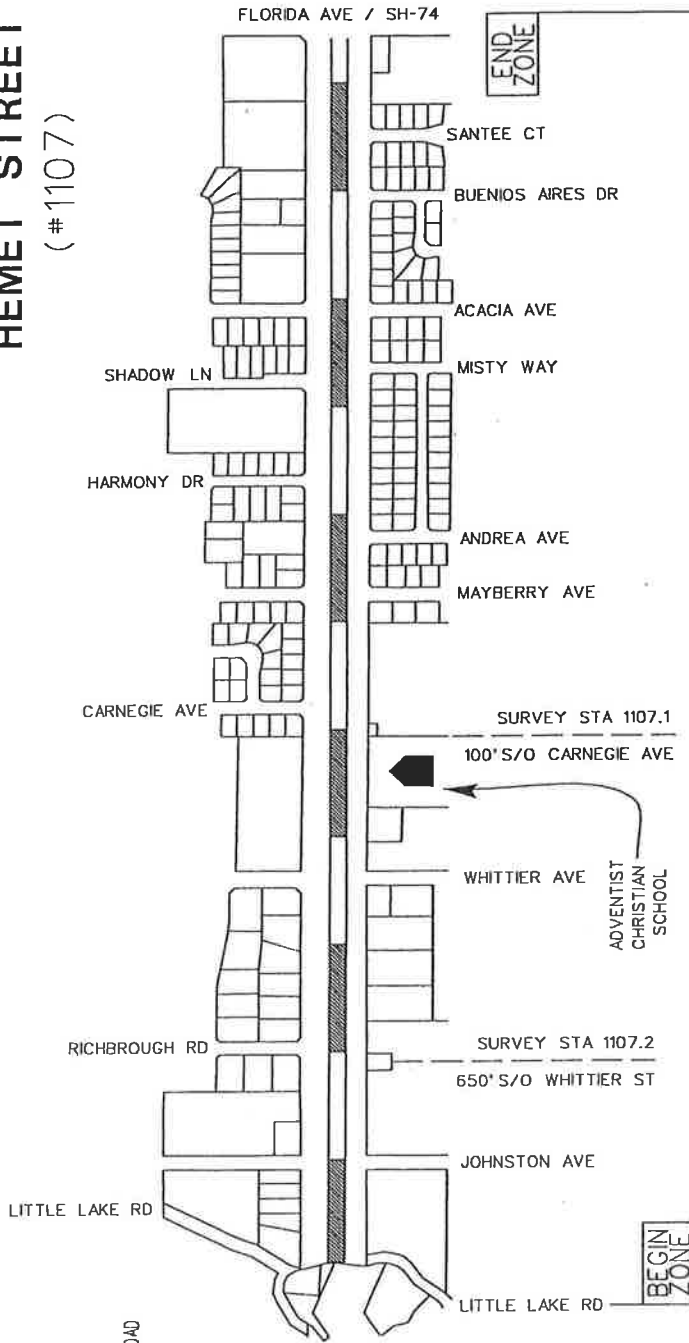

RECOMMENDED SPEED LIMIT	35 MPH
PREVAILING SPEED (85th%)	36.0 MPH (AVERAGE OF TWO SIMILAR STATIONS OF 38.0 & 34.0 MPH)
VEHICLES IN 24 HR (2 WAY)	675
SEGMENT LENGTH	1.1 MILE
ALL ACCIDENTS IN 2 YRS.	1
ACCIDENT RATE ☆	1.84 ACC/MVM
EXISTING SPEED LIMIT	40 MPH (Ord. 452.214 Sec. 2.4 No. 9)

☆ RATE: $\frac{\text{ACCIDENT} \times 1,000,000}{\text{VEH} \times 365 \times 2 \times \text{MILE}}$

APPROVED BY: *Lawrence T. Tai*
 DATE: 8/29/2011
 LAWRENCE T. TAI, P.E.
 COUNTY TRAFFIC ENGINEER

SURVEY DATE:	MAY 3, 2011	MAP DATE:	AUG 17, 2011
DRAWN BY:	N AHMAD	CAD FILE:	HEMET.DGN

COUNTY AREA:	HEMET	COUNTY MAP:	112, 116A
SUPERVISOR DISTRICT:	3		

LEON ROAD (#1481)

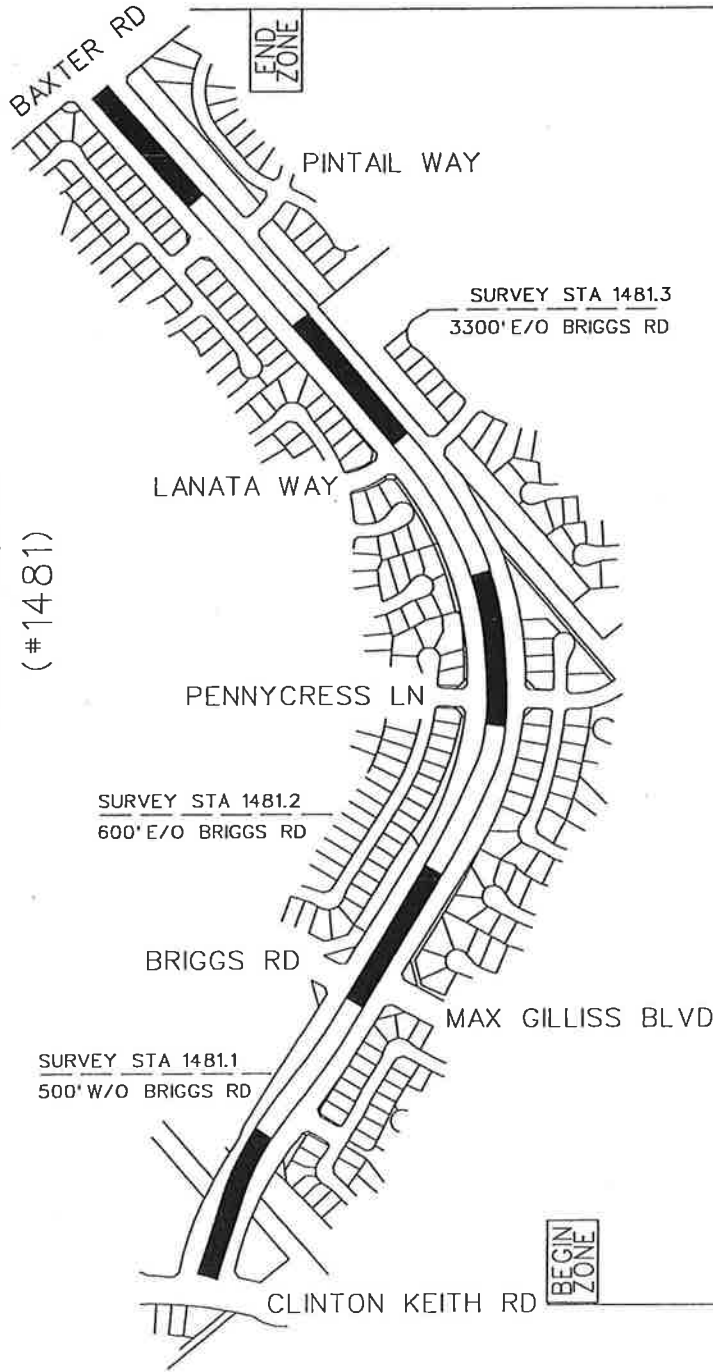

- LEGEND:
- ////// CITY LIMITS
 - ▬ RADAR ZONE
 - - - SURVEY STATION
 - OTHER STREET OR ROAD
 - ↑ SCHOOL



NO SCALE

RECOMMENDED SPEED LIMIT	50 MPH
85th%TILE SPEED	52.0 MPH (AVERAGE OF THREE SIMILAR STATIONS OF 42.0 MPH & 51.0 MPH & 63.0 MPH)
VEHICLES IN 24 HR (2 WAY)	7,180
SEGMENT LENGTH	1.15 MILES
ALL ACCIDENTS IN 2 YRS.	3
ACCIDENT RATE ☆	0.50 ACC/MVM
EXISTING SPEED LIMIT	NOT POSTED

☆ RATE: NO. OF ACCIDENT x 1,000,000
VEH x 365 x 2 x MILE

APPROVED BY:

Lawrence T. Tai
DATE: 8/25/2011

LAWRENCE T. TAI, P.E.
COUNTY TRAFFIC ENGINEER

SURVEY DATE:	MAY 25, 2011
MAP DATE:	AUG 10, 2011
DRAWN BY:	N AHMAD
CAD FILE:	LEON RD.DGN

COUNTY AREA:	MURRIETA
COUNTY MAP:	121B
SUPERVISOR DISTRICT:	3

COUNTY OF RIVERSIDE
TRANSPORTATION DEPARTMENT
TRAFFIC ENGINEERING DIVISION



ENGINEERING AND TRAFFIC SURVEY
AT
LEON ROAD

PAGE 1 OF 1

LEGEND:

- ////// CITY LIMITS
- ▬ RADAR ZONE
- - - SURVEY STATION
- ▬ OTHER STREET OR ROAD
- ↑ SCHOOL

* SEE SHEET
1 OF 2

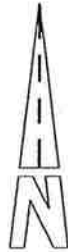

NO SCALE

SURVEY STA 1363.3
900' N/O M.H.S. RD

WILLOWS AVENUE (#1363)

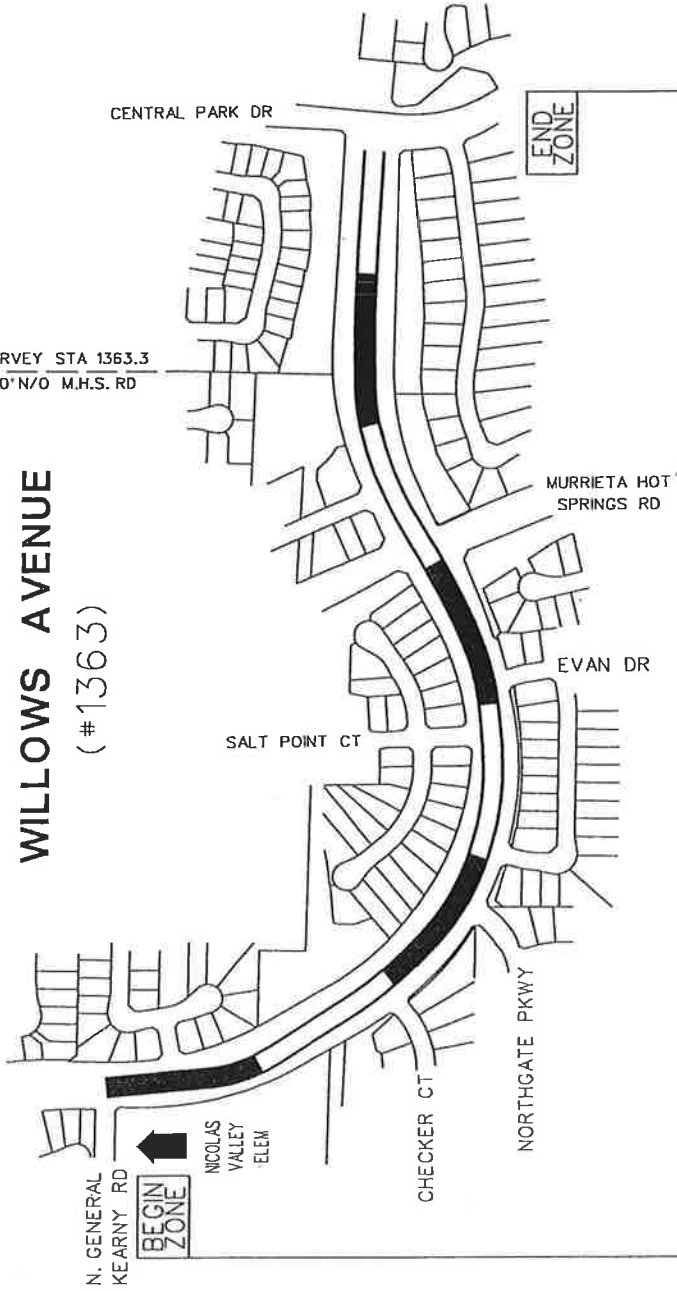

RECOMMENDED SPEED LIMIT	35 MPH
85th/ILE SPEED /	* 42.5 MPH (AVERAGE OF TWO SIMILAR STATIONS OF 45.0 MPH & 40.0 MPH)
VEHICLES IN 24 HR (2 WAY)	3,470
SEGMENT LENGTH	0.78 MILE
ALL ACCIDENTS IN 2 YRS.	6
ACCIDENT RATE ☆	3.04 ACC/MVM
EXISTING SPEED LIMIT	NOT POSTED

☆ RATE: NO. OF ACCIDENT x 1,000,000
VEH x 365 x 2 x MILE

COUNTY AREA:	TEMECULA	SURVEY DATE:	MAY 7, 2008
COUNTY MAP:	128B	MAP DATE:	AUG 16, 2011
SUPERVISOR DISTRICT:	3	DRAWN BY:	N AHMAD
		CAD FILE:	WILLOWS.DGN

APPROVED BY: *Lawrence T. Tai*
DATE: 8/31/2011
LAWRENCE T. TAI, P.E.
COUNTY TRAFFIC ENGINEER

COUNTY OF RIVERSIDE
TRANSPORTATION DEPARTMENT
TRAFFIC ENGINEERING DIVISION
ENGINEERING AND TRAFFIC SURVEY
AT
WILLOWS AVENUE