

1                                ORDINANCE NO. 452.231

2                                AN ORDINANCE OF THE COUNTY OF RIVERSIDE

3                                AMENDING ORDINANCE NO. 452

4                                RELATING TO PRIMA FACIE SPEED LIMITS

5                                The Board of Supervisors of the County of Riverside ordains as follows:

6                                Section 1.     Section 2.3 of Ordinance No. 452, entitled “Thirty-five miles per hour,” is  
7 amended to add new subsections 108, 109, 110, 111, and 112 thereto to read as follows:

8                                    “108. On Central Park Drive between the centerline of Calistoga Drive  
9                                    and a point 575 feet east of Sugar Pine Way, a total distance of  
10                                   approximately 0.60 miles, in the Temecula area.

11                                   109. On Clay Canyon Drive between the centerline of Knabe Road (N)  
12                                   and the centerline of Knabe Road (S), a total distance of  
13                                   approximately 0.75 miles, in the Temescal Canyon area.

14                                   110. On Haines Street between the centerline of Rider Street and the  
15                                   centerline of Cajalco Road, a total distance of approximately 0.5  
16                                   miles, in the Woodcrest area.

17                                   111. On Hemet Street between the centerline of Little Lake Road and  
18                                   the centerline of Florida Avenue/SH-74, a total distance of  
19                                   approximately 1.1 mile, in the Hemet area.

20                                   112. On Willows Avenue between the centerline of North General  
21                                   Kearney Road and the centerline of Central Park Drive, a total  
22                                   distance of approximately 0.78 miles, in the Temecula area.”

23                                Section 2.     Section 2.4 of Ordinance No. 452, entitled “Forty miles per hour,” is  
24 amended to add new subsection 130 thereto to read as follows:

25                                   “130. On Machado Street between the centerline of Grand Avenue and  
26                                   200 feet north of Alvarado Street, a total distance of approximately  
27                                   0.59 miles, in the Lake Elsinore area.”

28                                //

3.69

1           Section 3.     Section 2.5 of Ordinance No. 452, entitled “Forty-five miles per hour,” is  
2 amended to add new subsection 152 thereto to read as follows:

3                     “152. On Haines Street between the centerline of Cajalco Road and the  
4                             centerline of Nandina Avenue, a total distance of approximately  
5                             2.0 miles, in the Woodcrest area.”

6           Section 4.     Section 2.6 of Ordinance No. 452, entitled “Fifty miles per hour,” is  
7 amended to add new subsection 69 and 70 thereto to read as follows:

8                     “ 69. On Calle Nopal between the centerline of Anza Road and the  
9                             centerline of Cruz Way, a total distance of approximately 1.0 mile,  
10                            in the Temecula area.

11                    70. On Leon Road between the centerline of Clinton Keith Road and  
12                            the centerline of Baxter Road, a total distance of approximately  
13                            1.15 miles, in the Murrieta area.”

14           Section 5.     Subsection 9 of Section 2.4 of Ordinance No. 452 adopted on February 4,  
15 2003, pursuant to Ordinance No. 452.214 is repealed in its entirety. Subsection 9 of Section 2.4  
16 established a forty miles per hour speed limit on Hemet Street between the centerline of Little Lake Road  
17 and the south curb line of State Highway 74.

18                     Subsection 106 of Section 2.5 of Ordinance No. 452 adopted on September 13, 2005,  
19 pursuant to Ordinance No. 452.221 is repealed in its entirety. Subsection 106 of Section 2.5 established a  
20 forty-five miles per hour speed limit on Calle Nopal between Anza Road and Cruz Way.

21 \\  
22 \\  
23 \\  
24 \\  
25 \\  
26 \\  
27 \\  
28 \\

1  
2  
3  
4  
5  
6  
7  
8  
9  
10  
11  
12  
13  
14  
15  
16  
17  
18  
19  
20  
21  
22  
23  
24  
25  
26  
27  
28

Section 6. This ordinance shall take effect 30 days after its adoption.

BOARD OF SUPERVISORS OF THE COUNTY  
OF RIVERSIDE, STATE OF CALIFORNIA

BY: \_\_\_\_\_  
Chairman

ATTEST:  
KECIA HARPER-IHEM, Clerk of the Board

By: \_\_\_\_\_  
Deputy

APPROVED AS TO FORM:  
PAMELA J. WALLS, County Counsel

By:  \_\_\_\_\_  
Deputy

**LIST OF SPEED ZONE SUBMITTALS  
ORDINANCE AMENDMENT NO 452.231  
SUPERVISORIAL DISTRICT NO. 1**

AREA	ROAD NAME/ LIMITS	EXISTING SPEED LIMIT	PROPOSED SPEED LIMIT	NOTES
TEMESCAL CANYON	<b>CLAY CANYON DRIVE</b> Between the centerline of Knabe Road (N) and the centerline of Knabe Road (S)	* Not Posted	35	NEW
WOODCREST	<b>HAINES STREET</b> Between the centerline of Rider Street and the centerline of Cajalco Road	* Not Posted	35	NEW
WOODCREST	<b>HAINES STREET</b> Between the centerline of Cajalco Road and the centerline of Nandina Avenue	* Not Posted	45	NEW
LAKE ELSINORE	<b>MACHADO STREET</b> Between the centerline of Grand Avenue and 200' N/O Alvarado Street	* Not Posted	40	NEW

\* Maximum allowable speed limit for a two-lane highway is 55 mph

\*\*Maximum allowable speed limit for a multi-lane highway is 65 mph

\*\*\*Change in speed zone boundary

# CLAY CANYON DRIVE (#1480)

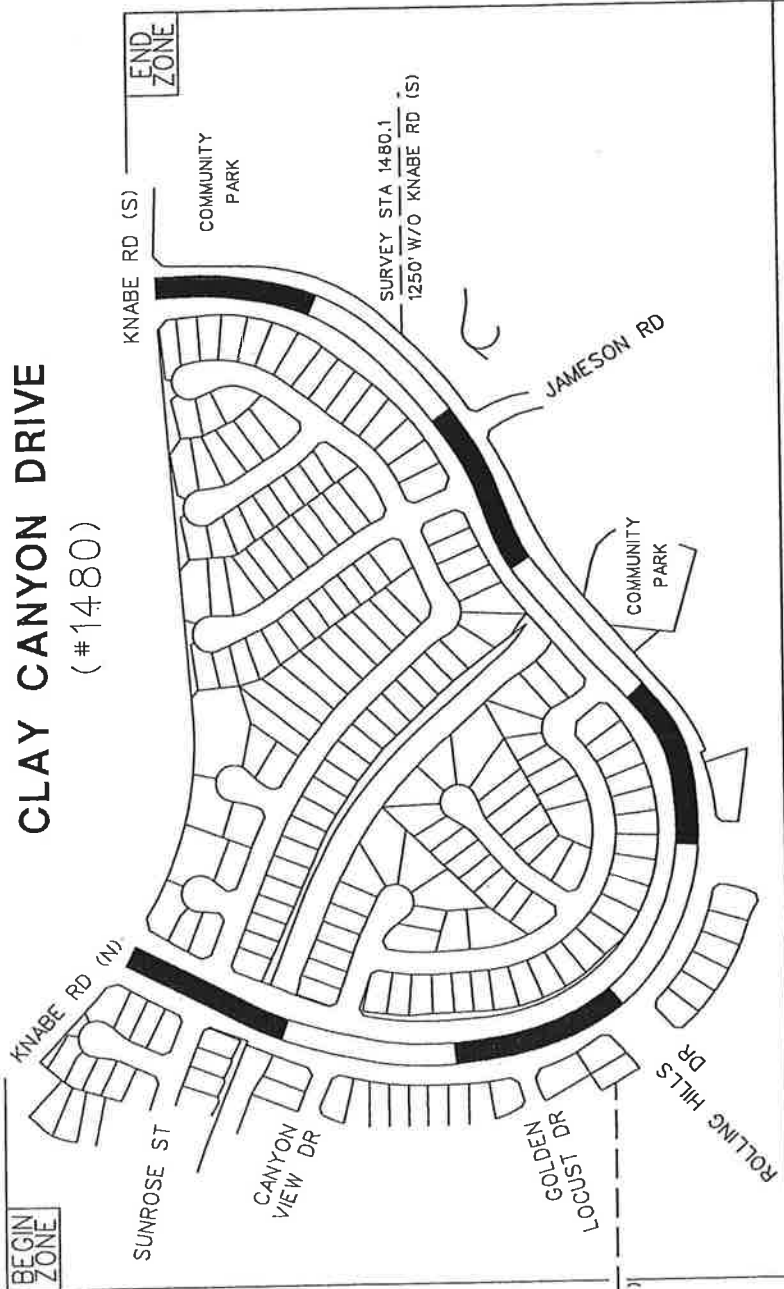

- LEGEND:**
- CITY LIMITS
  - RADAR ZONE
  - SURVEY STATION
  - OTHER STREET OR ROAD
  - SCHOOL

SURVEY STA 1480.2  
2450' W/O KNABE RD (S)



NO SCALE

RECOMMENDED SPEED LIMIT	RESIDENTIAL AREA - COMMUNITY PARK - REDUCE TO 35 MPH
85th/7ILE SPEED	35 MPH
VEHICLES IN 24 HR (2 WAY)	40.5 MPH (AVERAGE OF TWO SIMILAR STATIONS OF 44.0 MPH & 37.0 MPH)
SEGMENT LENGTH	970
ALL ACCIDENTS IN 2 YRS.	0.75 MILE
ACCIDENT RATE ☆	0
EXISTING SPEED LIMIT	0.00 ACC/MVM
	NOT POSTED





☆ RATE:  $\frac{\text{NO. OF ACCIDENT} \times 1,000,000}{\text{VEH} \times 365 \times 2 \times \text{MILE}}$

COUNTY AREA:	TEMESCAL CANYON	SURVEY DATE:	FEB 17, 2011
COUNTY MAP:	33A	MAP DATE:	AUG 8, 2011
SUPERVISOR DISTRICT:	1	DRAWN BY:	N AHMAD
		CAD FILE:	CLAY CYN DR.DGN

APPROVED BY: *Lawrence T. Tai, P.E.*  
DATE: 8/29/2011  
LAWRENCE T. TAI, P.E.  
COUNTY TRAFFIC ENGINEER

# HAINES STREET (#1479)

**LEGEND:**

-  CITY LIMITS
-  RADAR ZONE
-  SURVEY STATION
-  OTHER STREET OR ROAD
-  SCHOOL

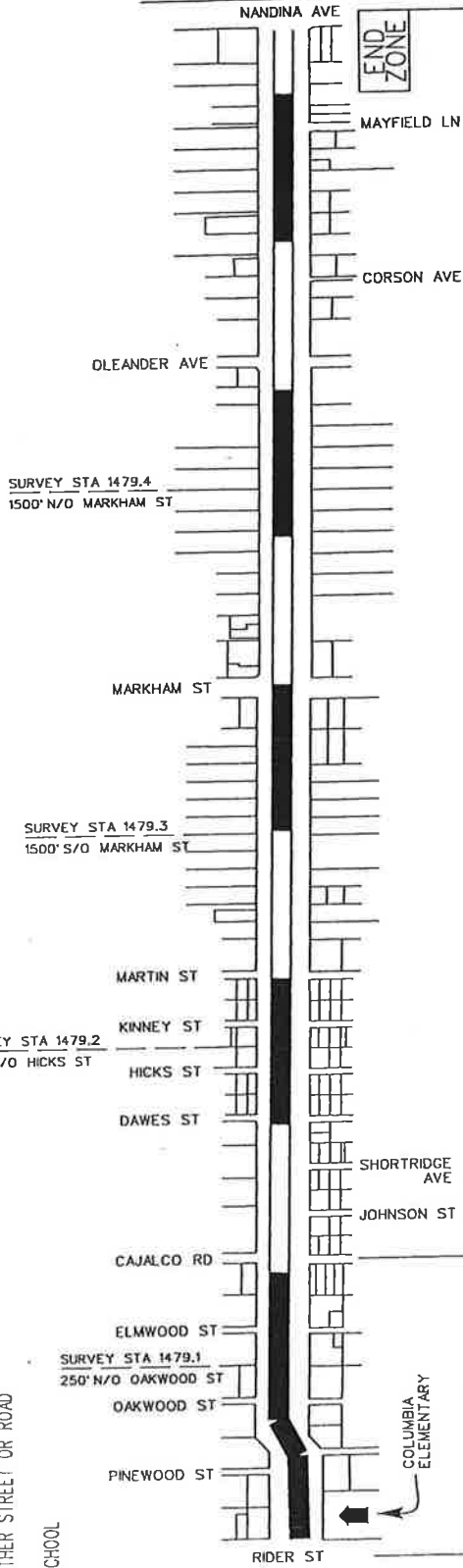

NO SCALE	RESIDENTIAL AREA - HIDDEN DRIVEWAYS - NO SIDEWALKS - NO CURB/GUTTER - DIRT SHOULDERS - REDUCE TO 45 MPH.	
RECOMMENDED SPEED LIMIT	35 MPH	45 MPH
85th%TILE SPEED	37.0 MPH	48.0 MPH
VEHICLES IN 24 HR (2 WAY)	1,000	1,100
SEGMENT LENGTH	0.5 MILE	2.0 MILE
ALL ACCIDENTS IN 2 YRS.	3	9
ACCIDENT RATE ☆	8.22 MVM	5.60 ACC/MVM
EXISTING SPEED LIMIT	NOT POSTED	NOT POSTED





☆ RATE\* NO. OF ACCIDENT x 1,000,000  
VEH x 365 x 2 x .MILE

COUNTY AREA:	WOODCREST	SURVEY DATE:	APR 7, 2011
COUNTY MAP:	58A.58B	MAP DATE:	JUN 6, 2011
SUPERVISOR DISTRICT:	1	DRAWN BY:	N AHMAD
		CAD FILE:	HAINES ST.DGN

APPROVED BY: *Lawrence T. Tai*  
DATE: 8/25/2017  
LAWRENCE T. TAI, P.E.  
COUNTY TRAFFIC ENGINEER

# MACHADO STREET

(#1485)

- LEGEND:**
-  CITY LIMITS
  -  RADAR ZONE
  -  SURVEY STATION
  -  OTHER STREET OR ROAD
  -  SCHOOL

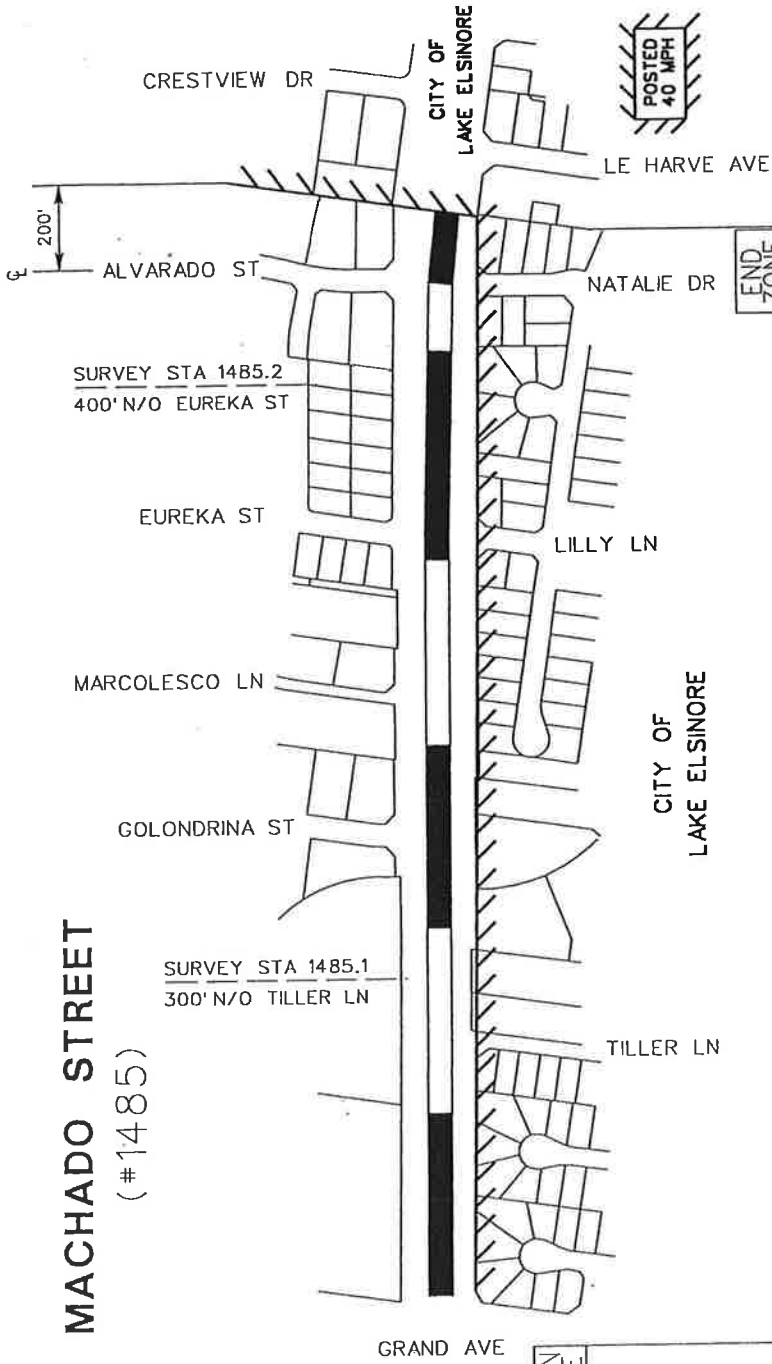

BEGIN ZONE

END ZONE

VARYING ROADWAY WIDTHS - VARYING SIDEWALK IMPROVEMENTS - VARYING C/G IMPROVEMENTS - SCHOOL ZONE XING - REDUCE TO 40 MPH

RECOMMENDED SPEED LIMIT	40 MPH
85th/TILE SPEED	45.5 MPH (AVERAGE OF TWO SIMILAR STATIONS OF 49 MPH & 42 MPH)
VEHICLES IN 24 HR (2 WAY)	4,300
SEGMENT LENGTH	0.59 MILE
ALL ACCIDENTS IN 2 YRS.	1
ACCIDENT RATE ☆	0.54 ACC/MVM
EXISTING SPEED LIMIT	NOT POSTED

☆ RATE: NO. OF ACCIDENT x 1,000,000  
VEH x 365 x 2 x MILE

COUNTY AREA:	LAKE ELSINORE	SURVEY DATE:	AUG 23, 2011
COUNTY MAP:	38	MAP DATE:	AUG 29, 2011
SUPERVISOR DISTRICT:	1	DRAWN BY:	N AHMAD
		CAD FILE:	MACHADO.DGN

APPROVED BY: *Lawrence T. Tai*  
DATE: 8/31/2011

COUNTY OF RIVERSIDE  
TRANSPORTATION DEPARTMENT  
TRAFFIC ENGINEERING DIVISION

ENGINEERING AND TRAFFIC SURVEY AT  
**MACHADO STREET**

PAGE 1 OF 1

**LIST OF SPEED ZONE SUBMITTALS  
ORDINANCE AMENDMENT NO 452.231  
SUPERVISORIAL DISTRICT NO. 3**

AREA	ROAD NAME/ LIMITS	EXISTING SPEED LIMIT	PROPOSED SPEED LIMIT	NOTES
TEMECULA	<b>CALLE NOPAL</b> Between the centerline of Anza Road and the centerline of Cruz Way	45	50	UPDATE
TEMECULA	<b>CENTRAL PARK DRIVE</b> Between the centerline of Calistoga Drive and a point 575' E/O Sugar Pine Way	* Not Posted	35	NEW
HEMET	<b>HEMET STREET</b> Between the centerline of Little Lake Road and the centerline of Florida Avenue/SH-74	40	35	UPDATE
MURRIETA	<b>LEON ROAD</b> Between the centerline of Clinton Keith Road and the centerline of Baxter Road	** Not Posted	50	NEW
TEMECULA	<b>WILLOWS AVENUE</b> Between the centerline of North General Kearny Road and the centerline of Central Park Drive	* Not Posted	35	NEW





\* Maximum allowable speed limit for a two-lane highway is 55 mph  
 \*\*Maximum allowable speed limit for a multi-lane highway is 65 mph  
 \*\*\*Change in speed zone boundary



# CALLE NOPAL

(#1407)

## LEGEND:

-  CITY LIMITS
-  RADAR ZONE
-  SURVEY STATION
-  OTHER STREET OR ROAD

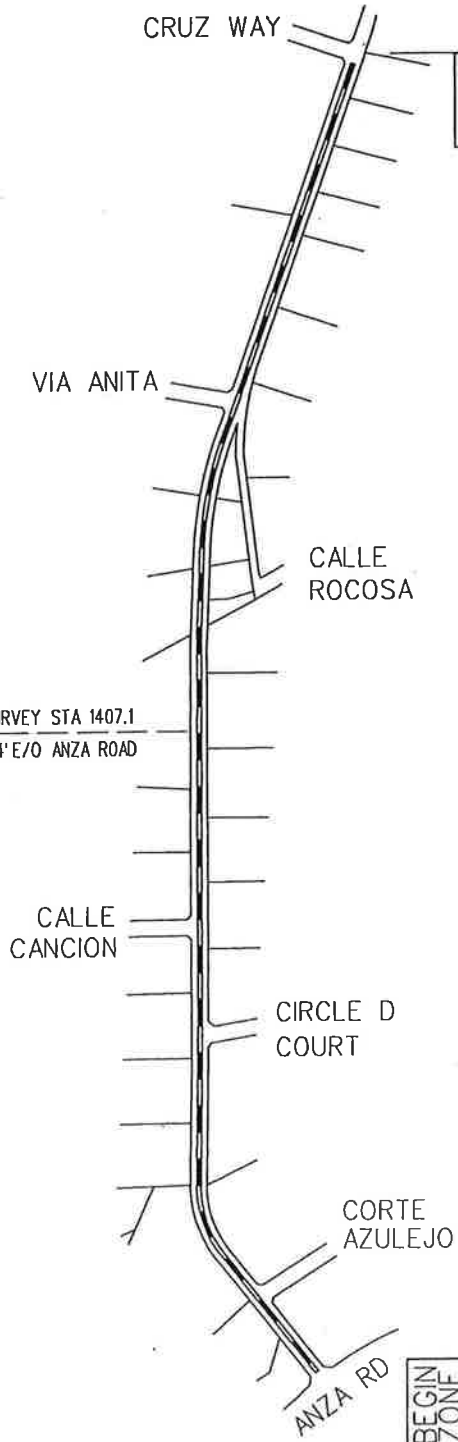

BEGIN ZONE

END ZONE

NO SCALE

RECOMMENDED SPEED LIMIT	50 MPH	NARROW ROADWAY - EQUESTRIANS - HIDDEN RESIDENTIAL DRIVEWAYS - REDUCE SPEED LIMIT TO 50 MPH
PREVAILING SPEED (85%)	54.0 MPH	
VEHICLES IN 24 HR (2 WAY)	1,000	
SEGMENT LENGTH	1.0 MILE	
ALL ACCIDENTS IN 2 YRS.	1	
ACCIDENT RATE ☆	1.37 MVM	
EXISTING SPEED LIMIT	45 MPH (Ord. 452-221 Sec. 2.5 No. 106)	

☆ RATE =  $\frac{\text{ACCIDENT} \times 1,000,000}{\text{VEH} \times 365 \times 2 \times \text{MILE}}$

COUNTY AREA:	TEMECULA	SURVEY DATE:	AUG 23, 2011	APPROVED BY:	<i>Lawrence T. Tai</i>
COUNTY MAP PAGE:	129	MAP DATE:	SEP 12, 2011	DATE:	9/20/2011
SUPERVISOR DISTRICT:	3	DRAWN BY:	N AHMAD	LAWRENCE T. TAI, P.E.	COUNTY TRAFFIC ENGINEER
		CAD FILE:	CALLE NOPAL.DGN		

COUNTY OF RIVERSIDE  
**TRANSPORTATION DEPARTMENT**  
 TRAFFIC ENGINEERING SECTION  
 ENGINEERING AND TRAFFIC SURVEY  
 AT  
**CALLE NOPAL**

PAGE  
1 OF 1

# CENTRAL PARK DRIVE (#1484)

- LEGEND:
- CITY LIMITS
  - RADAR ZONE
  - SURVEY STATION
  - OTHER STREET OR ROAD
  - SCHOOL

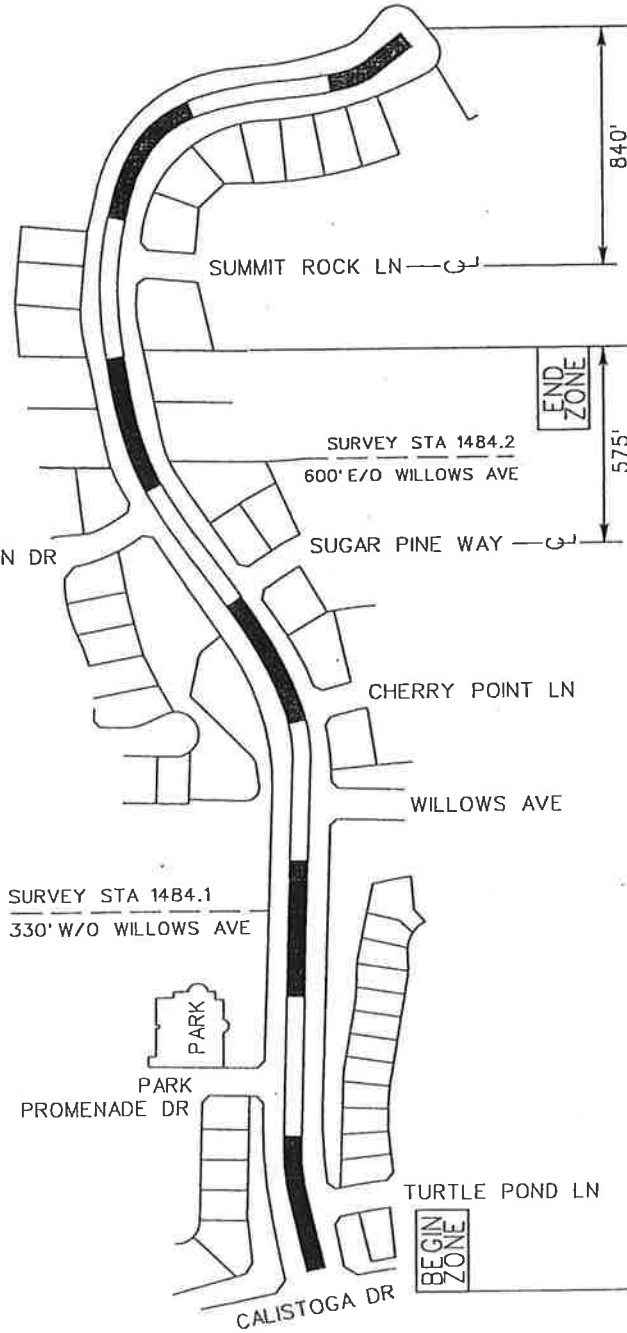

BEGIN ZONE

END ZONE

NO SCALE

RECOMMENDED SPEED LIMIT	35 MPH	* 25 MPH
85th % TILE SPEED /	37.0 MPH (AVERAGE OF TWO SIMILAR STATIONS OF 40.0 MPH & 34.0 MPH)	
VEHICLES IN 24 HR (2 WAY)	930	
SEGMENT LENGTH	0.60 MILE	
ALL ACCIDENTS IN 2 YRS.	0	
ACCIDENT RATE ☆	0.00 ACC/MVM	
EXISTING SPEED LIMIT	NOT POSTED	* Per CVC 515

☆ RATE: NO. OF ACCIDENT x 1,000.000  
VEH x 365 x 2 x MILE

APPROVED BY:

*Lawrence T. Tai*  
DATE: 8/29/2011

LAWRENCE T. TAI, P.E.  
COUNTY TRAFFIC ENGINEER

COUNTY OF RIVERSIDE  
TRANSPORTATION DEPARTMENT  
TRAFFIC ENGINEERING DIVISION

ENGINEERING AND TRAFFIC SURVEY  
AT

CENTRAL PARK DRIVE

SURVEY DATE:	FEB 17, 2011
MAP DATE:	AUG 16, 2011
DRAWN BY:	N AHMAD
CAD FILE:	CENTRAL_PARK.DGN

COUNTY AREA:	TEMECULA
COUNTY MAP:	124C
SUPERVISOR DISTRICT:	3

# HEMET STREET (#1107)

- LEGEND:
- CITY LIMITS
  - RADAR ZONE
  - SURVEY STATION
  - OTHER STREET OR ROAD
  - SCHOOL

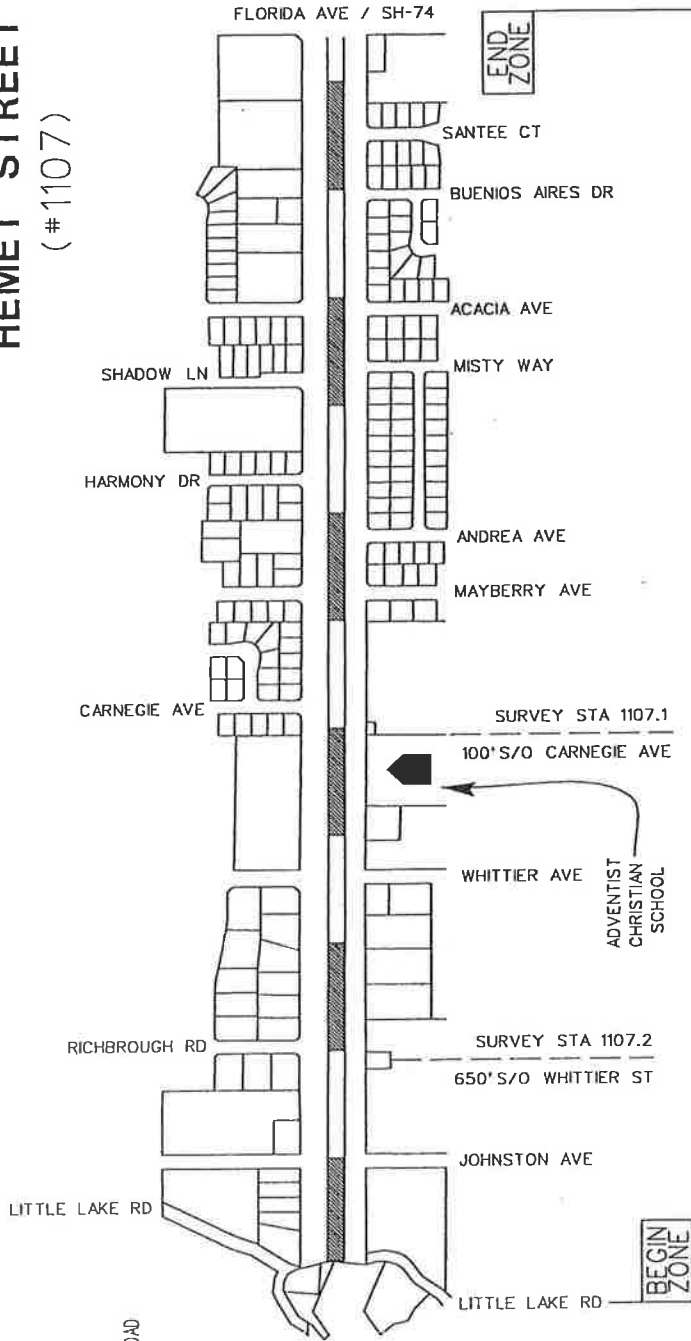

GAP IN R/W  
SEE SHEET  
1 OF 2



NO SCALE

RECOMMENDED SPEED LIMIT	35 MPH
PREVAILING SPEED (85th%)	36.0 MPH (AVERAGE OF TWO SIMILAR STATIONS OF 38.0 & 34.0 MPH)
VEHICLES IN 24 HR (2 WAY)	675
SEGMENT LENGTH	1.1 MILE
ALL ACCIDENTS IN 2 YRS.	1
ACCIDENT RATE ☆	1.84 ACC/MVM
EXISTING SPEED LIMIT	40 MPH (Ord. 452.214 Sec. 2.4 No. 9)

☆ RATE:  $\frac{\text{ACCIDENT} \times 1,000,000}{\text{VEH} \times 365 \times 2 \times \text{MILE}}$

COUNTY AREA:	HEMET	SURVEY DATE:	MAY 3, 2011	APPROVED BY:	<i>Lawrence T. Tai</i>	COUNTY OF RIVERSIDE TRANSPORTATION DEPARTMENT TRAFFIC ENGINEERING DIVISION
COUNTY MAP:	112, 116A	MAP DATE:	AUG 17, 2011	DATE:	8/29/2011	ENGINEERING AND TRAFFIC SURVEY
SUPERVISOR DISTRICT:	3	DRAWN BY:	N AHMAD	CAD FILE:	HEMET.DGN	AT <b>HEMET STREET</b>

# LEON ROAD (#1481)

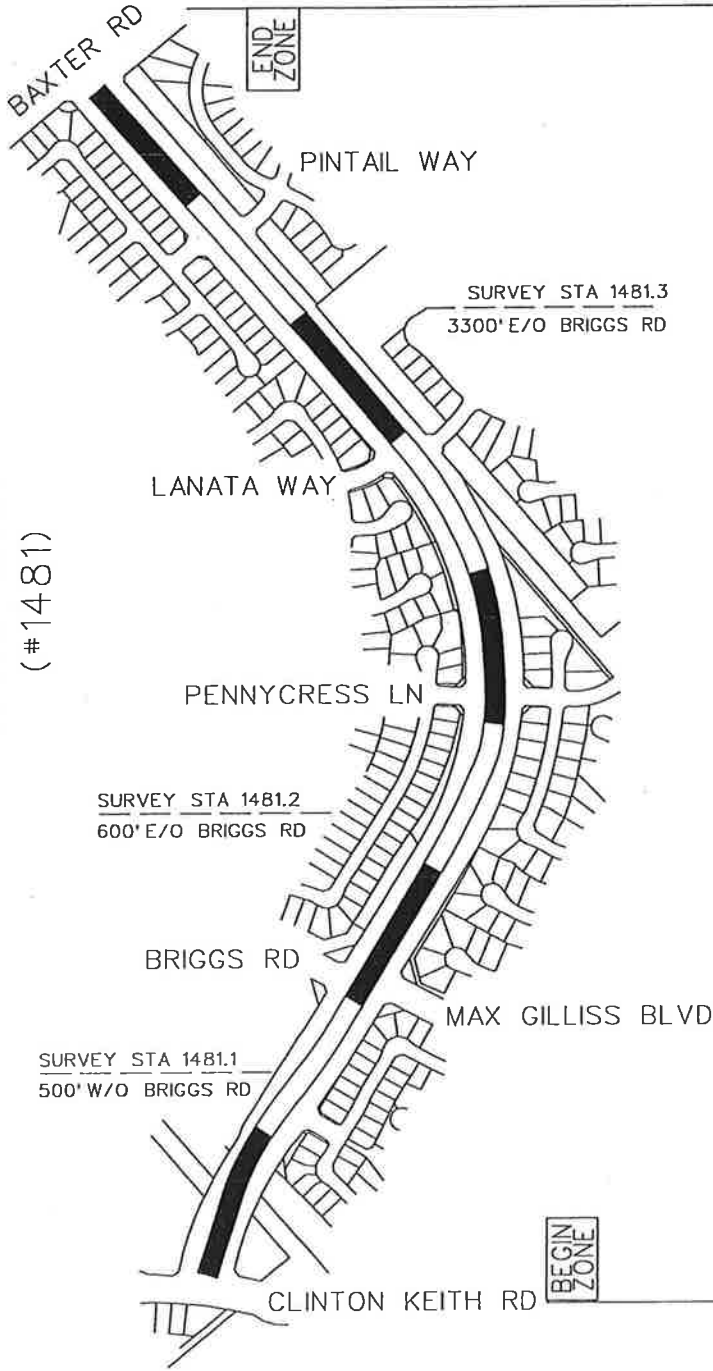

- LEGEND:
- CITY LIMITS
  - RADAR ZONE
  - SURVEY STATION
  - OTHER STREET OR ROAD
  - SCHOOL



NO SCALE

RECOMMENDED SPEED LIMIT	50 MPH
85th%TILE SPEED	52.0 MPH (AVERAGE OF THREE SIMILAR STATIONS OF 42.0 MPH & 51.0 MPH & 63.0 MPH)
VEHICLES IN 24 HR (2 WAY)	7,180
SEGMENT LENGTH	1.15 MILES
ALL ACCIDENTS IN 2 YRS.	3
ACCIDENT RATE★	0.50 ACC/MVM
EXISTING SPEED LIMIT	NOT POSTED

★ RATE:  $\frac{\text{NO. OF ACCIDENT} \times 1,000,000}{\text{VEH} \times 365 \times 2 \times \text{MILE}}$

COUNTY AREA:	MURRIETA	SURVEY DATE:	MAY 25, 2011	APPROVED BY:	<i>Lawrence T. Tai</i>	COUNTY OF RIVERSIDE TRANSPORTATION DEPARTMENT TRAFFIC ENGINEERING DIVISION
COUNTY MAP:	121B	MAP DATE:	AUG 10, 2011	DATE:	8/25/2011	ENGINEERING AND TRAFFIC SURVEY
SUPERVISOR DISTRICT:	3	DRAWN BY:	N AHMAD	CAD FILE:	LEON RD.DGN	AT <b>LEON ROAD</b>
						PAGE 1 OF 1

LEGEND:

- ////// CITY LIMITS
- ▬ RADAR ZONE
- - - SURVEY STATION
- ▬▬▬ OTHER STREET OR ROAD
- ↑ SCHOOL

\* SEE SHEET  
1 OF 2



NO SCALE

# WILLOWS AVENUE (#1363)

SURVEY STA 1353.3  
900' N/O M.H.S. RD

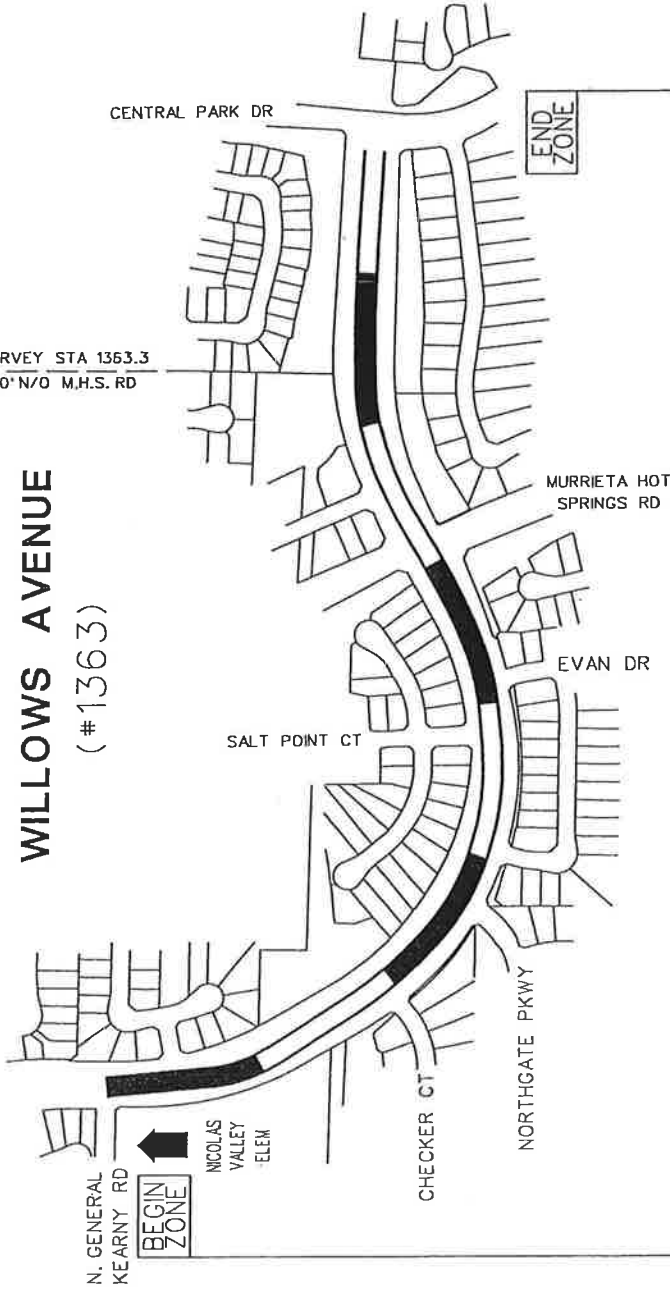

RESIDENTIAL AREA - SCHOOL ZONE - RECREATIONAL COMMUNITY PARK - STUDENT PEDESTRIANS - REDUCE TO 35 MPH	35 MPH
RECOMMENDED SPEED LIMIT	
85th%TILE SPEED /	* 42.5 MPH (AVERAGE OF TWO SIMILAR STATIONS OF 45.0 MPH & 40.0 MPH)
VEHICLES IN 24 HR (2 WAY)	3,470
SEGMENT LENGTH	0.78 MILE
ALL ACCIDENTS IN 2 YRS.	6
ACCIDENT RATE ☆	3.04 ACC/MVM
EXISTING SPEED LIMIT	NOT POSTED

☆ RATE: NO. OF ACCIDENT x 1,000,000  
VEH x 365 x 2 x MILE

COUNTY AREA:	TEMECULA	SURVEY DATE:	MAY 7, 2008
COUNTY MAP:	128B	MAP DATE:	AUG 16, 2011
SUPERVISOR DISTRICT:	3	DRAWN BY:	N AHMAD
		CAD FILE:	WILLOWS.DGN

APPROVED BY: *Lawrence T. Tai*  
DATE: 8/31/2011  
LAWRENCE T. TAI, P.E.  
COUNTY TRAFFIC ENGINEER

**SUBMITTAL TO THE BOARD OF SUPERVISORS  
COUNTY OF RIVERSIDE, STATE OF CALIFORNIA**

321A



**FROM:** TLMA - Transportation Department

**SUBMITTAL DATE:**  
December 8, 2011

**SUBJECT:** Ordinance No. 452.231 to establish speed zones enforceable by radar speed detection equipment - Hemet, Lake Elsinore, Murrieta, Temecula, Temescal Canyon and Woodcrest areas

**RECOMMENDED MOTION:** That the Board of Supervisors:

1. Introduce and adopt, on successive weeks, Ordinance No. 452.231, amending Ordinance No. 452 relating to prima facie speed limits to establish various speed zones in the above-referenced areas of Riverside County.

**BACKGROUND:** Transportation Department staff has conducted Engineering and Traffic Surveys (E&TS) for various roads in the subject areas, as required by the California Vehicle Code.

Juan C. Perez  
Director of Transportation

(Continued On Attached Page)

<b>FINANCIAL DATA</b>	Current F.Y. Total Cost:	\$ 0	In Current Year Budget:	N/A
	Current F.Y. Net County Cost:	\$ 0	Budget Adjustment:	N/A
	Annual Net County Cost:	\$ 0	For Fiscal Year:	N/A

<b>SOURCE OF FUNDS:</b>	Positions To Be Deleted Per A-30	<input type="checkbox"/>
	Requires 4/5 Vote	<input type="checkbox"/>

**C.E.O. RECOMMENDATION:**

APPROVE

BY:   
Tina Grande

County Executive Office Signature

**MINUTES OF THE BOARD OF SUPERVISORS**

On motion of Supervisor Buster, seconded by Supervisor Tavaglione and duly carried, IT WAS ORDERED that the above ordinance is approved as introduced with waiver of reading.

Ayes: Buster, Tavaglione and Benoit  
Nays: None  
Absent: Stone and Ashley  
Date: December 20, 2011  
xc: Transp., COB

Kecia Harper-Ihem  
Clerk of the Board  
By:   
Deputy

Prev. Agn. Ref. 06/28/11, 3.110 | District: 1 & 3 | Agenda Number:

**3.20**

FORM APPROVED COUNTY COUNSEL  
 BY:   
 PATRICIA F. SMITH  
 DATE: 12/7/11  
 Departmental Concurrence

Dept's Recomm.:  Consent  Policy  
 Per Exec. Ofc.:  Consent  Policy

The Honorable Board of Supervisors

RE: Ordinance No. 452.231 to establish speed zones enforceable by radar speed detection equipment - Hemet, Lake Elsinore, Murrieta, Temecula, Temescal Canyon and Woodcrest areas  
December 8, 2011

Page 2 of 2

Based upon the results of the E&TS for these roads, the radar-enforceable speed limits recommended by the Department are summarized in the attached tables. Speed zone diagrams are also provided as a reference.

It is recommended that the Board of Supervisors adopt this amendment at the next regularly scheduled meeting.

County Counsel has approved the ordinance amendment.

Transportation Department staff has contacted the Riverside and Temecula area offices of the California Highway Patrol regarding the proposed speed zones.