

**SUBMITTAL TO THE BOARD OF SUPERVISORS
COUNTY OF RIVERSIDE, STATE OF CALIFORNIA**

961



FROM: TLMA - Transportation Department

SUBMITTAL DATE:
May 23, 2012

SUBJECT: Construction of Briggs Road and Baxter Road and associated improvements in an unincorporated area north east of the City of Murrieta.

RECOMMENDED MOTION: That the Board of Supervisors:

1. Approve three addenda to the specifications and plans, issued prior to the May 9, 2012 bid opening; and
2. Accept the low bid of Mamco, Inc. of Riverside, CA in the amount of \$3,166,400; and
3. Award the contract to Mamco, Inc. and authorize the Chairman of the Board to execute the contract documents; and
4. Approve the project's proposed budget as shown on Attachment A.

BACKGROUND: By Minute Order dated April 10, 2012 (agenda item 3.50), the Board

Juan C. Perez
Director of Transportation and Land Management

JCP:jj:sb
(Continued On Attached Pages)

FORM APPROVED COUNTY COUNSEL
DATE 5/24/12
BY: MARSHAL VICTOR

FINANCIAL DATA	Current F.Y. Total Cost:	\$ 3,166,400	In Current Year Budget:	Yes
	Current F.Y. Net County Cost:	\$ 0	Budget Adjustment:	No
	Annual Net County Cost:	\$ 0	For Fiscal Year:	2011/2012

SOURCE OF FUNDS: Measure A/ Western (10%), Murrieta Valley USD (60%), Developer Contribution (5%), Developer In-Lieu Funds (25%)	Positions To Be Deleted Per A-30	<input type="checkbox"/>
	Requires 4/5 Vote	<input type="checkbox"/>

There are no General Funds used in this project

C.E.O. RECOMMENDATION:

APPROVE

BY:
Tina Grande

County Executive Office Signature

Dept's Recomm.: Consent Policy

Per Exec. Ofc.: Consent Policy

Prev. Agn. Ref. 4/10/12, Item 3.50 | District: 3rd / 3rd | Agenda Number: :

3.65

The Honorable Board of Supervisors

RE: Construction of Briggs Road and Baxter Road and associated improvements in an unincorporated area north east of the City of Murrieta.

May 23, 2012

Page 2 of 3

BACKGROUND: By Minute Order dated April 10, 2012 (agenda item 3.50), the Board authorized the Clerk of the Board to advertise for the construction of Briggs Road and Baxter Road and associated improvements in an unincorporated area north east of the City of Murrieta. Additionally, the specifications and plans were approved by the Board within this agenda item.

During the advertisement period, three addenda were issued to all registered plan holders as a supplement to the specifications and special provisions. Bidders are required to acknowledge the addenda on their Contractor's Proposal, and are also required to take all addenda into account, to be considered for award. The addenda were issued to clarify and modify the approved contract documents. The addenda are attached as Addendum No. 1, Addendum No. 2, and Addendum No. 3.

Bids for the project were opened in the office of the Director of Transportation and Land Management at 2:00 PM, Wednesday, May 9, 2012. Eight bids were received. Due to the complexity of this project and several constraints, all bids came in above the Engineers Estimate. The basis for the selection of a contractor is the lowest responsive and responsible bid. The lowest responsible bid was submitted by Mamco, Inc. of Riverside, in the amount of \$3,385,000 which is \$521,262 (18.2%) above the Engineer's Estimate. Since Alternate 2 is not selected for award, the contract amount will be \$3,166,400. The Agreement includes the following schedules of work:

Base Bid: Primary items of work on Briggs Road and Baxter Road.

Alternate 1: Additional road improvements on Baxter Road; funded by the Brookfield LLC.

Alternate 2: Not selected for award.

Alternate 3: Installation of ultimate size sewer and water pipeline.

The Murrieta Valley Unified School District (District) has constructed Dorothy McElhinny Middle School and the Lisa J. Mails Elementary School west of Briggs Road just south of existing Baxter Road. As part of the school construction, existing dirt roads were paved to provide temporary access to the schools. Since the schools opened, it has become a priority to provide permanent access with road, water and sewer improvements. The road work consists of pavement, curb, gutter and sidewalk of the west half of Briggs next to the schools and the south half of Baxter.

By minute order dated March 20, 2012, (agenda item 3.24) Board of Supervisor has approved the cooperative agreement between the County and District. Since County is the lead agency on this project, the District will provide \$2,445,000 to the County for the improvement costs.

Riverside Mitland 03 LLC concurred with bid prices, as bid by the apparent low bidder for the Alternate 1 bid schedule. Therefore, Alternate 1 bid schedule is included within the contract award and the costs for the Alternate 1 work will be funded by Brookfield LLC.

The Transportation Department is working with EMWD on a cooperative agreement for the installation of the water and sewer pipelines, which will include partial reimbursement to the

The Honorable Board of Supervisors

RE: Construction of Briggs Road and Baxter Road and associated improvements in an unincorporated area north east of the City of Murrieta.

May 23, 2012

Page 3 of 3

County for the work to be performed under Alternate Bid Schedule 3. The contractor will begin work before execution of the agreement to meet the timeline of completing the work prior to the beginning of the new school year.

The Contractor will execute the contract and provide bonds and insurance documents after Board approval. The Contractor is qualified.

Project Number: C2-0156

Attachment "A"

Riverside County Transportation Department

Project: **Briggs Rd and Baxter Rd - School Access**

Project No.(s): **C2-0156**

Project Costs and Budget

Activity	Incurred Costs	Projected Costs	Total Costs	Existing Budget	Proposed Budget
Preliminary Survey					
Environmental	588	2,412	3,000	23,000	3,000
Design	7,894	2,106	10,000	37,000	10,000
Right-of-way					
Utilities		4,000	4,000	18,000	4,000
Construction		3,166,400	3,166,400	2,147,000	3,483,000
Construction Contingency	10%	316,640	316,640		
Construction Engineering & Inspection	13%	1,880	406,120	295,000	408,000
Construction Survey	7%		207,000	105,000	207,000
Totals:	10,362	4,104,678	4,115,040	2,625,000	4,115,000

Project Funding

Code	Name	Existing Budget	Proposed Budget
300	Measure A/ Western	180,000	415,548
855	Murrieta Valley Unified School District	2,445,000	2,445,000
600	Developer Contribution - Riverside Mitland 03 LLC		222,000
602	Developer In-Lieu Funds		1,032,452
Totals		2,625,000	4,115,000

Comments

Incurred costs charged to IP060030 are not included here.

Form 11 Attachment

Contract/Lease/Purchase Summary Data

Contract (for Services)

- Approval/Renewal
- Sole Source
- Personal Services
- Independent Contractor
- Other than Low Bid
- Change Order
- Public Works

Lease

- Approval/Renewal
- Multi-Year Lease
- Equipment
- Real Property
- Change Order

Purchase (for Materials)

- Sole Source
- Other than Low Bid
- Change Order

Selection Committee Member Names (RFP=s Only)

User Department:	Transportation Department
------------------	---------------------------

N/A

Vendor/Lessor Name:	Mamco, Inc.
Vendor/Lessor Location:	Riverside, CA

Minority Status:

- M W DV None

Local Preference Applied: Yes No N/A

Local Preference Award Cost \$ (5% maximum preference)

Local Preference FYTD: Cost \$

of Orders

Applicable Board Policy #

Comments:

RFQ/RFP Process:

Date Mailed:
 Response Date:
 # of Responses:
 # of Qualified Responses:

Bidding Process (OPTION 1 Selected for Award):

Bid Range: \$ 3,385,000.00 to \$3,656,743.92
 Local Bid Range: N/A
 Responsive and Responsible Bid Range: \$ 3,385,000.00 to \$3,656,743.92

Note: Selection of low bid based on the sum of all bid schedules, whether or not all bid schedules are awarded.

Contract/Lease Renewals Only

Existing Agreement Items

Proposed Agreement Items

1. Rates
2. Terms
3. Conditions
4. Legal Issues
5. Accountability
6. Utilities

(continue on blank sheet if necessary)

NOTE: COMPETITIVELY BID PUBLIC WORKS CONTRACT

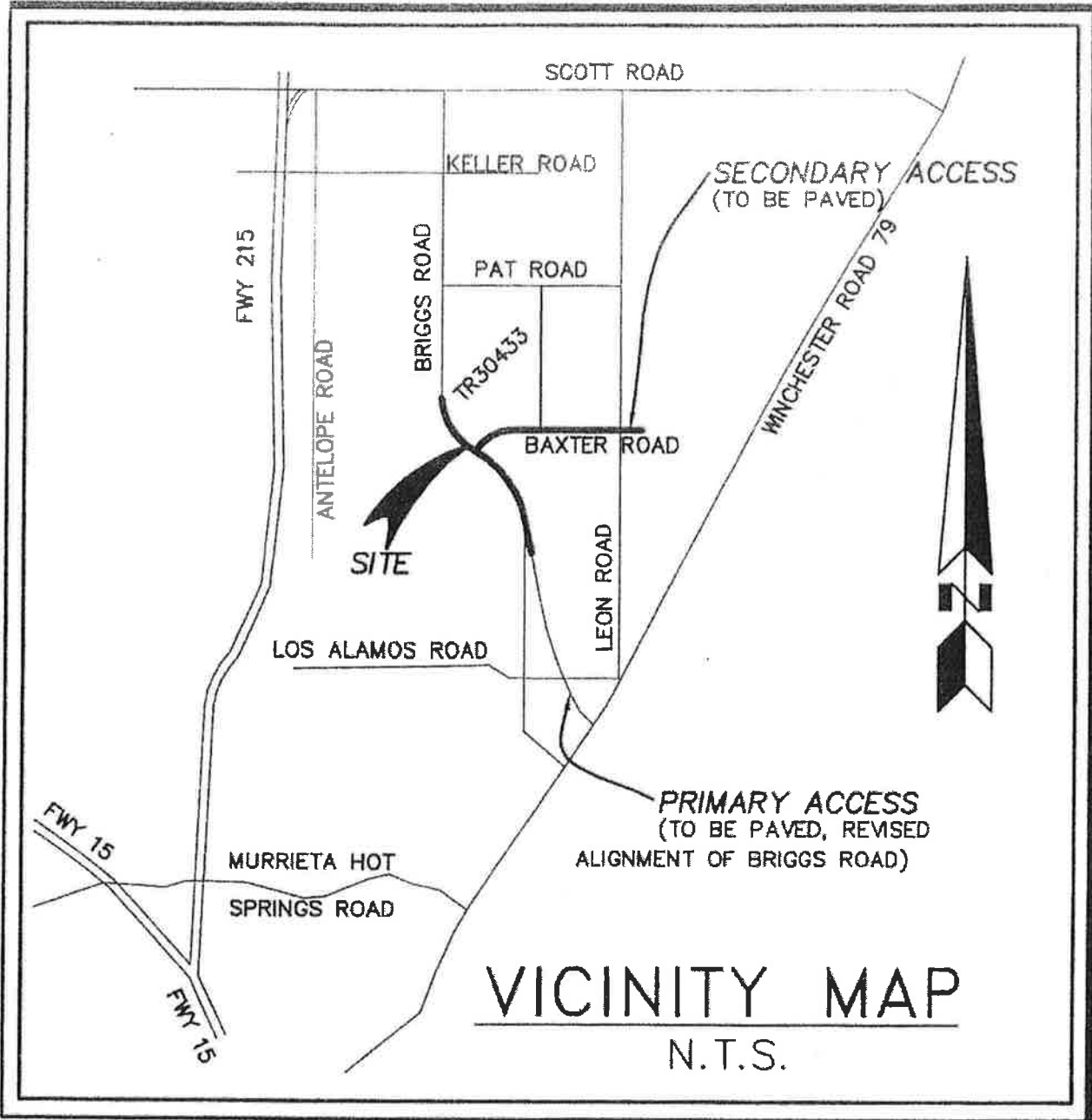

SECTION 31, T 6S, R 2W

**Riverside County Transportation Department
Summary of Bids**

**PROJECT: Road Improvements on
Briggs Road and Baxter Road, North of
the City of Murrieta**

Advertised: April 10, 2012 (Agenda Item: 3.50)
Addenda: 1(4/25/12), 2(5/1/12), 3(5/3/12)
Bids Open: 2 pm Date: Wednesday, May 9, 2012

Project No. C2-156, MS 4089, IP060030

Company Name	Base Bid	Alt. 1 Bid Sch. (Brookfield LLC)	Alt. 2 Bid Sch. (EMWD Option 1)	Alt. 3 Bid Sch. (EMWD Option 2)	Total
COUNTY'S ESTIMATE	2,145,608.20	184,409.40	174,625.00	359,095.00	\$2,863,737.60
1 Mamco, Inc.	2,439,276.40	221,998.60	218,600.00	505,125.00	\$3,385,000.00
2 Cooley Construction, Inc.	2,813,018.46	280,361.62	419,000.00	755,620.00	\$4,268,000.08
3 Road Builders, Inc.	3,205,778.70	253,982.05	380,042.00	674,953.50	\$4,514,756.25
4 Heartland Grading, Inc.	3,266,658.06	303,840.14	402,815.00	715,123.00	\$4,688,436.20
5 FM & Sons, Inc.	2,980,977.50	315,812.40	600,120.00	946,400.00	\$4,843,309.90
6 Utah Pacific Construction Company	4,969,794.00	464,620.00	123,657.00	359,205.00	\$5,917,276.00
7 Southern California Grading, Inc.	4,288,589.20	301,627.27	551,430.00	859,005.00	\$6,000,651.47
8 Hillcrest Contracting	5,111,892.54	310,931.38	449,820.00	784,100.00	\$6,656,743.92
<i>Average Bid Total Price</i>					\$5,034,271.73

**Riverside County Transportation Department
Summary of Bids**

**PROJECT: ROAD IMPROVEMENTS ON BRIGGS ROAD AND
BAXTER ROAD, NORTH OF THE CITY OF MURRIETA**

Advertised: April 10, 2012 (Agenda Item: 3.50)
Addenda: 1(4/25/12), 2(5/1/12), 3(5/3/12)
Bids Open: 2 pm Date: Wednesday, May 9, 2012

PROJECT NO. C2-0156, MS 4089, IP060030

BASE BID		COUNTY'S ESTIMATE			Mamco, Inc. Riverside, CA 92504	
					1	

ITEM NO.	ITEM CODE	CONTRACT ITEM	Like Bid Item	UNITS	QUANTITY	UNIT PRICE	ENG ESTIMATE	BID UNIT PRICE	BID ESTIMATE
1	190101(F)	ROADWAY EXCAVATION	Like 1	CY	144,220	4.00	576,880.00	4.10	591,302.00
2	260201	CLASS 2 AGGREGATE BASE	Like 2	CY	10,371	15.00	155,565.00	24.50	254,089.50
3	390130	HOT MIX ASPHALT	Like 3	TON	5,793	70.00	405,510.00	69.00	399,717.00
4	721007	ROCK SLOPE PROTECTION (1/4-TON, METHOD B)	Like 4	CY	46	40.00	1,840.00	90.00	4,140.00
5	840656	PAINT TRAFFIC STRIPE (2-COAT) [8"]	Like 5	LF	10,712	0.40	4,284.80	0.40	4,284.80
6	066102	DUST ABATEMENT	NA	LS	1	10,000.00	10,000.00	10,000.00	10,000.00
7	074020	WATER POLLUTION CONTROL	NA	LS	1	10,000.00	10,000.00	26,482.64	26,482.64
8	120100	TRAFFIC CONTROL SYSTEM	NA	LS	1	15,000.00	15,000.00	32,000.00	32,000.00
9	160101	CLEARING AND GRUBBING	NA	LS	1	10,000.00	10,000.00	10,000.00	10,000.00
10	170101	DEVELOP WATER SUPPLY	NA	LS	1	5,000.00	5,000.00	5,000.00	5,000.00
11	000001	ITEM DELETED BY ADDENDUM	-----	-----	-----	-----	-----	-----	-----
12	000001	ITEM DELETED BY ADDENDUM	-----	-----	-----	-----	-----	-----	-----
13	011507	COLD PLANE ASPHALT CONCRETE PAVEMENT (.12)	NA	SQFT	352	8.00	2,816.00	1.70	598.40
14	017304	MINOR CONCRETE (CURB AND GUTTER) (CRS 200)	NA	LF	1,495	10.00	14,950.00	12.00	17,940.00
15	017305	MINOR CONCRETE (CURB AND GUTTER) (CRS 201)	NA	LF	3,200	12.00	38,400.00	12.50	40,000.00
16	017306	MINOR CONCRETE (CURB RAMP) (CRS 403)	NA	EA	7	1,500.00	10,500.00	1,350.00	9,450.00
17	731521	MINOR CONCRETE SIDEWALK (CRS401)	NA	SQFT	27,534	4.00	110,136.00	2.25	61,951.50
18	731521A	MINOR CONCRETE SIDEWALK (CRS404)	NA	SQFT	4,459	5.00	22,295.00	2.50	11,147.50
19	017310	MINOR CONCRETE (DRIVE APPROACH)	NA	SQFT	2,592	5.00	12,960.00	4.00	10,368.00
20	017302	MINOR CONCRETE (CROSS-GUTTER) (CRS 209)	NA	SQFT	1,399	5.00	6,995.00	4.00	5,596.00
21	120120A	BARRICADE (CRS 810)	NA	LF	108	75.00	8,100.00	75.00	8,100.00
22	510501	MINOR CONCRETE [V-DITCH]	NA	LF	722	6.00	4,332.00	18.00	12,996.00
23	510520	MINOR CONCRETE (CONCRETE DRAIN)[DOWN-DRAIN]	NA	LF	54	5.00	270.00	50.00	2,700.00
24	840666	PAINT PAVEMENT MARKING (2-COAT)	NA	SQFT	1,316	0.60	789.60	2.60	3,421.60
25	566011	ROADSIDE SIGN - ONE POST	NA	EA	70	200.00	14,000.00	235.00	16,450.00
26	820108	DELINEATOR (CLASS 2) [Type F]	NA	EA	17	60.00	1,020.00	45.00	765.00
27	840656	PAINT TRAFFIC STRIPE (2-COAT) [4"]	NA	LF	4,712	0.20	942.40	0.33	1,554.96
28	840656	PAINT TRAFFIC STRIPE (2-COAT) [12"]	NA	LF	454	0.60	272.40	2.25	1,021.50
29	000003	WATER SYSTEM IMPROVEMENTS	NA	LS	1	250,000.00	250,000.00	200,000.00	200,000.00
30	000003	SEWER SYSTEM IMPROVEMENTS	NA	LS	1	2,000.00	2,000.00	57,000.00	57,000.00
31	000003	STORM DRAIN SYSTEM IMPROVEMENTS	NA	LS	1	250,000.00	250,000.00	440,000.00	440,000.00
32	015601	STREET NAME SIGN (CRS 816)	NA	EA	3	250.00	750.00	400.00	1,200.00

**Riverside County Transportation Department
Summary of Bids**

**PROJECT: ROAD IMPROVEMENTS ON BRIGGS ROAD AND
BAXTER ROAD, NORTH OF THE CITY OF MURRIETA**

Advertised: April 10, 2012 (Agenda Item: 3.50)
Addenda: 1(4/25/12), 2(5/1/12), 3(5/3/12)
Bids Open: 2 pm Date: Wednesday, May 9, 2012

PROJECT NO. C2-0156, MS 4089, IP060030

BASE BID (CONTINUED)		COUNTY'S ESTIMATE		COUNTY'S ESTIMATE		COUNTY'S ESTIMATE			
ITEM NO.	ITEM CODE	CONTRACT ITEM	Like Bid Item	UNITS	QUANTITY	UNIT PRICE	ENG ESTIMATE	BID UNIT PRICE	BID ESTIMATE

33	190161	ROCK EXCAVATION	NA	FA	1	20,000.00	20,000.00	20,000.00	20,000.00
34	000003	MISCELLANEOUS DIRECTED WORK	NA	FA	1	80,000.00	80,000.00	80,000.00	80,000.00
35	019901	DE-MOBILIZATION	NA	LS	1	100,000.00	100,000.00	100,000.00	100,000.00
		SUBTOTAL (Base Bid)					2,145,608.20		2,439,276.40
		ITEMS 1-35						1	

ALTERNATE 1 BID SCHEDULE (BROOKFIELD LLC)		COUNTY'S ESTIMATE		COUNTY'S ESTIMATE		COUNTY'S ESTIMATE			
ITEM NO.	ITEM CODE	CONTRACT ITEM	Like Bid Item	UNITS	QUANTITY	UNIT PRICE	ENG ESTIMATE	BID UNIT PRICE	BID ESTIMATE

36	190101(F)	ROADWAY EXCAVATION	Like 1	CY	247	4.00	988.00	4.10	1,012.70
37	260201	CLASS 2 AGGREGATE BASE	Like 2	CY	781	15.00	11,715.00	24.50	19,134.50
38	390130	HOT MIX ASPHALT	Like 3	TON	432	70.00	30,240.00	69.00	29,808.00
39	721007	ROCK SLOPE PROTECTION (1/4-TON, METHOD B)	Like 4	CY	22	40.00	880.00	90.00	1,980.00
40	840656	PAINT TRAFFIC STRIPE (2-COAT) [8"]	Like 5	LF	2,066	0.40	826.40	0.40	826.40
41	066102	DUST ABATEMENT	NA	LS	1	1,000.00	1,000.00	250.00	250.00
42	074020	WATER POLLUTION CONTROL	NA	LS	1	1,500.00	1,500.00	1,000.00	1,000.00
43	120100	TRAFFIC CONTROL SYSTEM	NA	LS	1	2,500.00	2,500.00	200.00	200.00
44	160101	CLEARING AND GRUBBING	NA	LS	1	4,940.00	4,940.00	300.00	300.00
45	170101	DEVELOP WATER SUPPLY	NA	LS	1	1,000.00	1,000.00	200.00	200.00
46	650014	18" REINFORCED CONCRETE PIPE	NA	LF	318	60.00	19,080.00	69.00	21,942.00
47	650018	24" REINFORCED CONCRETE PIPE	NA	LF	291	70.00	20,370.00	80.00	23,280.00
48	650026	36" REINFORCED CONCRETE PIPE	NA	LF	420	90.00	37,800.00	120.00	50,400.00
49	017104A	JUNCTION STRUCTURE NO. 2	NA	EA	1	3,000.00	3,000.00	3,000.00	3,000.00
50	017101A	MANHOLE NO. 1	NA	EA	3	2,700.00	8,100.00	3,100.00	9,300.00
51	015101A	CONCRETE COLLAR	NA	EA	2	1,500.00	3,000.00	500.00	1,000.00
52	000003	INCLIND TRASH RACK	NA	EA	1	400.00	400.00	3,300.00	3,300.00
53	000003	8" SDR35 P.V.C. SEWER	NA	LF	985	30.00	29,550.00	45.00	44,325.00
54	000003	STANDARD MANHOLE [SEWER]	NA	EA	2	2,500.00	5,000.00	3,900.00	7,800.00
55	000003	END PLUG [SEWER]	NA	EA	2	60.00	120.00	150.00	300.00
56	510535	MINOR CONCRETE (HEADWALL)	NA	CY	4	600.00	2,400.00	660.00	2,640.00
		SUBTOTAL (Alternate 1)					184,409.40		221,998.60
		ITEM 36-56							

**Riverside County Transportation Department
Summary of Bids**

**PROJECT: ROAD IMPROVEMENTS ON BRIGGS ROAD AND
BAXTER ROAD, NORTH OF THE CITY OF MURRIETA**

Advertised: April 10, 2012 (Agenda Item: 3.50)
Addenda: 1(4/25/12), 2(5/1/12), 3(5/3/12)
Bids Open: 2 pm Date: Wednesday, May 9, 2012

PROJECT NO. C2-0156, MS 4089, IP060030

ALTERNATE 2 BID SCHEDULE (EMWD OPTION 1)		COUNTY'S ESTIMATE				Mammo, Inc. Riverside, CA 92504		1	
--	--	-------------------	--	--	--	------------------------------------	--	---	--

ITEM NO.	ITEM CODE	CONTRACT ITEM	Like Bid Item	UNITS	QUANTITY	BID UNIT PRICE	BID ESTIMATE	BID UNIT PRICE	BID ESTIMATE
57	000003	8" SDR35 PVC SEWER	NA	LF	1,945	30.00	58,350.00	45.00	87,525.00
58	000003	12" C-900 PVC WATER	NA	LF	3,385	31.00	104,935.00	35.00	118,475.00
59	000003	12" MISC. FITTINGS (WATER)	NA	EA	12	320.00	3,840.00	300.00	3,600.00
60	000003	12" GATE VALVE	NA	EA	6	1,250.00	7,500.00	1,500.00	9,000.00
SUBTOTAL (Alternate 2)							174,625.00		218,600.00

ALTERNATE 3 BID SCHEDULE (EMWD OPTION 2)		COUNTY'S ESTIMATE				Mammo, Inc. Riverside, CA 92504		1	
--	--	-------------------	--	--	--	------------------------------------	--	---	--

ITEM NO.	ITEM CODE	CONTRACT ITEM	Like Bid Item	UNITS	QUANTITY	BID UNIT PRICE	BID ESTIMATE	BID UNIT PRICE	BID ESTIMATE
61	000003	18" VITRIFIED CLAY PIPE (VCP) SEWER	NA	LF	1,945	65.00	126,425.00	85.00	165,325.00
62	000003	18" C-905 PVC WATER	NA	LF	3,385	62.00	209,870.00	80.00	270,800.00
63	000003	18" MISC. FITTINGS (WATER)	NA	EA	12	650.00	7,800.00	750.00	9,000.00
64	000003	18" GATE VALVE	NA	EA	6	2,500.00	15,000.00	10,000.00	60,000.00
SUBTOTAL (Alternate 3)							359,095.00		505,125.00

PROJECT TOTAL						2,863,737.60			3,385,000.00
ITEMS 1-64									

**Riverside County Transportation Department
Summary of Bids**

**PROJECT: ROAD IMPROVEMENTS ON BRIGGS ROAD AND
BAXTER ROAD, NORTH OF THE CITY OF MURRIETA**

Advertised: April 10, 2012 (Agenda Item: 3.50)
Addenda: 1(4/25/12), 2(5/1/12), 3(5/3/12)
Bids Open: 2 pm Date: Wednesday, May 9, 2012

PROJECT NO. C2-0156, MS 4089, IP060030

BASE BID	ITEM NO.	ITEM CODE	CONTRACT ITEM	Like Bid Item	UNITS	QUANTITY	BID UNIT PRICE	BID ESTIMATE	2		BID ESTIMATE
									Cooley Construction, Inc. Hesperia, CA 92340		
									Road Builders, Inc. National City, CA 91950		
	1	190101(F)	ROADWAY EXCAVATION	Like 1	CY	144,220	5.10	735,522.00	4.20	605,724.00	
	2	260201	CLASS 2 AGGREGATE BASE	Like 2	CY	10,371	22.50	233,347.50	15.00	155,565.00	
	3	390130	HOT MIX ASPHALT	Like 3	TON	5,793	74.00	428,682.00	67.60	391,606.80	
	4	721007	ROCK SLOPE PROTECTION (1/4-TON, METHOD B)	Like 4	CY	46	107.00	4,922.00	78.00	3,588.00	
	5	840656	PAINT TRAFFIC STRIPE (2-COAT) [8"]	Like 5	LF	10,712	0.37	3,963.44	0.60	6,427.20	
	6	066102	DUST ABATEMENT	NA	LS	1	10,000.00	10,000.00	12,800.00	12,800.00	
	7	074020	WATER POLLUTION CONTROL	NA	LS	1	27,000.00	27,000.00	33,300.00	33,300.00	
	8	120100	TRAFFIC CONTROL SYSTEM	NA	LS	1	38,000.00	38,000.00	10,100.00	10,100.00	
	9	160101	CLEARING AND GRUBBING	NA	LS	1	10,000.00	10,000.00	16,200.00	16,200.00	
	10	170101	DEVELOP WATER SUPPLY	NA	LS	1	5,000.00	5,000.00	3,600.00	3,600.00	
	11	000001	ITEM DELETED BY ADDENDUM	-----	-----	-----	-----	-----	-----	-----	
	12	000001	ITEM DELETED BY ADDENDUM	-----	-----	-----	-----	-----	-----	-----	
	13	011507	COLD PLANE ASPHALT CONCRETE PAVEMENT (12")	NA	SQFT	352	2.05	721.60	7.80	2,745.60	
	14	017304	MINOR CONCRETE (CURB AND GUTTER) (CRS 200)	NA	LF	1,495	16.00	23,920.00	11.60	17,342.00	
	15	017305	MINOR CONCRETE (CURB AND GUTTER) (CRS 201)	NA	LF	3,200	12.20	39,040.00	14.00	44,800.00	
	16	017306	MINOR CONCRETE (CURB RAMP) (CRS 403)	NA	EA	7	1,640.00	11,480.00	666.00	4,662.00	
	17	731521	MINOR CONCRETE SIDEWALK (CRS401)	NA	SQFT	27,534	3.14	86,456.76	2.60	71,588.40	
	18	731521A	MINOR CONCRETE SIDEWALK (CRS404)	NA	SQFT	4,459	3.40	15,160.60	3.65	16,275.35	
	19	017310	MINOR CONCRETE (DRIVE APPROACH)	NA	SQFT	2,592	4.20	10,886.40	5.55	14,385.60	
	20	017302	MINOR CONCRETE (CROSS-GUTTER) (CRS 209)	NA	SQFT	1,399	6.80	9,513.20	8.55	11,961.45	
	21	120120A	BARRICADE (CRS 810)	NA	LF	108	66.00	7,128.00	64.00	6,912.00	
	22	510501	MINOR CONCRETE [V-DITCH]	NA	LF	722	24.00	17,328.00	22.00	15,884.00	
	23	510520	MINOR CONCRETE (CONCRETE DRAIN) DOWN-DRAIN]	NA	LF	54	22.30	1,204.20	133.00	7,182.00	
	24	840666	PAINT PAVEMENT MARKING (2-COAT)	NA	SQFT	1,316	2.50	3,290.00	2.10	2,763.60	
	25	566011	ROADSIDE SIGN - ONE POST	NA	EA	70	230.00	16,100.00	229.00	16,030.00	
	26	820108	DELINEATOR (CLASS 2) [Type F]	NA	EA	17	42.50	722.50	57.50	977.50	
	27	840656	PAINT TRAFFIC STRIPE (2-COAT) [4"]	NA	LF	4,712	0.32	1,507.84	0.40	1,884.80	
	28	840656	PAINT TRAFFIC STRIPE (2-COAT) [12"]	NA	LF	454	2.23	1,012.42	2.10	953.40	
	29	000003	WATER SYSTEM IMPROVEMENTS	NA	LS	1	281,000.00	281,000.00	680,500.00	680,500.00	
	30	000003	SEWER SYSTEM IMPROVEMENTS	NA	LS	1	104,000.00	104,000.00	389,000.00	389,000.00	
	31	000003	STORM DRAIN SYSTEM IMPROVEMENTS	NA	LS	1	485,000.00	485,000.00	460,000.00	460,000.00	
	32	015601	STREET NAME SIGN (CRS 816)	NA	EA	3	370.00	1,110.00	340.00	1,020.00	

**Riverside County Transportation Department
Summary of Bids**

**PROJECT: ROAD IMPROVEMENTS ON BRIGGS ROAD AND
BAXTER ROAD, NORTH OF THE CITY OF MURRIETA**

Advertised: April 10, 2012 (Agenda Item: 3:50)
Addenda: 1(4/25/12), 2(5/1/12), 3(5/3/12)
Bids Open: 2 pm Date: Wednesday, May 9, 2012

PROJECT NO. C2-0156, MS 4089, IP060030

BASE BID (CONTINUED)

ITEM NO.	ITEM CODE	CONTRACT ITEM	Like Bid Item	UNITS	QUANTITY	BID UNIT PRICE	BID ESTIMATE	BID UNIT PRICE	BID ESTIMATE
33	190181	ROCK EXCAVATION	NA	FA	1	20,000.00	20,000.00	20,000.00	20,000.00
34	000003	MISCELLANEOUS DIRECTED WORK	NA	FA	1	80,000.00	80,000.00	80,000.00	80,000.00
35	019901	DE-MOBILIZATION	NA	LS	1	100,000.00	100,000.00	100,000.00	100,000.00
		SUBTOTAL (Base Bid)					2,813,018.46		3,205,778.70
		ITEMS 1-35							

ALTERNATE 1 BID SCHEDULE (BROOKFIELD LLC)

2
Cooley Construction, Inc.
Hesperia, CA 92340

3
Road Builders, Inc.
National City, CA 91950

ITEM NO.	ITEM CODE	CONTRACT ITEM	Like Bid Item	UNITS	QUANTITY	BID UNIT PRICE	BID ESTIMATE	BID UNIT PRICE	BID ESTIMATE
36	190101(F)	ROADWAY EXCAVATION	Like 1	CY	247	5.10	1,259.70	4.20	1,037.40
37	260201	CLASS 2 AGGREGATE BASE	Like 2	CY	781	22.50	17,572.50	15.00	11,715.00
38	390130	HOT MIX ASPHALT	Like 3	TON	432	74.00	31,968.00	67.60	29,203.20
39	721007	ROCK SLOPE PROTECTION (1/4-TON, METHOD B)	Like 4	CY	22	107.00	2,354.00	78.00	1,716.00
40	840656	PAINT TRAFFIC STRIPE (2-COAT) [B1]	Like 5	LF	2,066	0.37	764.42	0.60	1,239.60
41	066102	DUST ABATEMENT	NA	LS	1	860.00	860.00	1.10	1.10
42	074020	WATER POLLUTION CONTROL	NA	LS	1	7,000.00	7,000.00	1.10	1.10
43	120100	TRAFFIC CONTROL SYSTEM	NA	LS	1	2,770.00	2,770.00	1.10	1.10
44	160101	CLEARING AND GRUBBING	NA	LS	1	1,750.00	1,750.00	1.10	1.10
45	170101	DEVELOP WATER SUPPLY	NA	LS	1	530.00	530.00	3,600.00	3,600.00
46	650014	18" REINFORCED CONCRETE PIPE	NA	LF	318	75.00	23,850.00	62.50	19,875.00
47	650018	24" REINFORCED CONCRETE PIPE	NA	LF	291	105.00	30,555.00	68.70	19,991.70
48	650026	36" REINFORCED CONCRETE PIPE	NA	LF	420	107.00	44,940.00	100.70	42,294.00
49	017104A	JUNCTION STRUCTURE NO. 2	NA	EA	1	2,700.00	2,700.00	3,200.00	3,200.00
50	017101A	MANHOLE NO. 1	NA	EA	3	5,600.00	16,800.00	6,023.00	18,069.00
51	015101A	CONCRETE COLLAR	NA	EA	2	860.00	1,720.00	721.00	1,442.00
52	000003	INCLIND TRASH RACK	NA	EA	1	2,150.00	2,150.00	4,430.00	4,430.00
53	000003	8" SDR35 P.V.C. SEWER	NA	LF	985	69.00	67,965.00	80.75	79,538.75
54	000003	STANDARD MANHOLE [SEWER]	NA	EA	2	5,900.00	11,800.00	3,680.00	7,360.00
55	000003	END PLUG [SEWER]	NA	EA	2	26.50	53.00	53.00	106.00
56	510535	MINOR CONCRETE (HEADWALL)	NA	CY	4	2,900.00	11,600.00	2,290.00	9,160.00
		SUBTOTAL (Alternate 1)					280,361.62		253,982.05
		ITEM 36-56							

**Riverside County Transportation Department
Summary of Bids**

**PROJECT: ROAD IMPROVEMENTS ON BRIGGS ROAD AND
BAXTER ROAD, NORTH OF THE CITY OF MURRIETA**

Advertised: April 10, 2012 (Agenda Item: 3.50)
Addenda: 1(4/25/12), 2(5/1/12), 3(5/3/12)
Bids Open: 2 pm Date: Wednesday, May 9, 2012

PROJECT NO. C2-0156, MS 4089, IP060030

ALTERNATE 2 BID SCHEDULE (EMWD OPTION 1)		Cooley Construction, Inc. Hesperia, CA 92340		Road Builders, Inc. National City, CA 91950					
ITEM NO.	ITEM CODE	CONTRACT ITEM	Like Bid Item	UNITS	QUANTITY	BID UNIT PRICE	BID ESTIMATE	BID UNIT PRICE	BID ESTIMATE
57	000003	8" SDR35 PVC SEWER	NA	LF	1,945	88.00	171,160.00	97.20	189,054.00
58	000003	12" C-900 PVC WATER	NA	LF	3,385	64.00	216,640.00	48.80	165,188.00
59	000003	12" MISC. FITTINGS (WATER)	NA	EA	12	800.00	9,600.00	485.00	5,820.00
60	000003	12" GATE VALVE	NA	EA	6	3,600.00	21,600.00	3,330.00	19,980.00
SUBTOTAL (Alternate 2)							419,000.00		380,042.00
ITEM 57-60									
ALTERNATE 3 BID SCHEDULE (EMWD OPTION 2)		Cooley Construction, Inc. Hesperia, CA 92340		Road Builders, Inc. National City, CA 91950					
ITEM NO.	ITEM CODE	CONTRACT ITEM	Like Bid Item	UNITS	QUANTITY	BID UNIT PRICE	BID ESTIMATE	BID UNIT PRICE	BID ESTIMATE
61	000003	18" VITRIFIED CLAY PIPE (VCP) SEWER	NA	LF	1,945	138.00	268,410.00	145.50	282,997.50
62	000003	18" C-905 PVC WATER	NA	LF	3,385	106.00	358,810.00	84.00	284,340.00
63	000003	18" MISC. FITTINGS (WATER)	NA	EA	12	1,500.00	18,000.00	751.00	9,012.00
64	000003	18" GATE VALVE	NA	EA	6	18,400.00	110,400.00	16,434.00	98,604.00
SUBTOTAL (Alternate 3)							755,620.00		674,953.50
ITEM 61-64									
PROJECT TOTAL							4,268,000.08		4,514,756.25
ITEMS 1-64									

**Riverside County Transportation Department
Summary of Bids**

**PROJECT: ROAD IMPROVEMENTS ON BRIGGS ROAD AND
BAXTER ROAD, NORTH OF THE CITY OF MURRIETA**

Advertised: April 10, 2012 (Agenda Item: 3:50)
Addenda: 1(4/25/12), 2(5/1/12), 3(5/3/12)
Bids Open: 2 pm Date: Wednesday, May 9, 2012

PROJECT NO. C2-0156, MS 4089, IP060030

BASE BID			4	5
	Heartland Grading Carlsbad, CA 92010	FM & Sons, Inc. Santa Ana, CA 92705		

ITEM NO.	ITEM CODE	CONTRACT ITEM	Like Bid Item	UNITS	QUANTITY	BID UNIT PRICE	BID ESTIMATE	BID UNIT PRICE	BID ESTIMATE
1	190101(F)	ROADWAY EXCAVATION	Like 1	CY	144,220	3.50	504,770.00	3.10	447,082.00
2	260201	CLASS 2 AGGREGATE BASE	Like 2	CY	10,371	29.33	304,181.43	22.50	233,347.50
3	390130	HOT MIX ASPHALT	Like 3	TON	5,793	71.02	411,418.86	71.90	416,516.70
4	721007	ROCK SLOPE PROTECTION (1/4-TON, METHOD B)	Like 4	CY	46	106.00	4,876.00	133.00	6,118.00
5	840656	PAINT TRAFFIC STRIPE (2-COAT) [8"]	Like 5	LF	10,712	0.58	6,212.96	0.40	4,284.80
6	066102	DUST ABATEMENT	NA	LS	1	9,000.00	9,000.00	30,000.00	30,000.00
7	074020	WATER POLLUTION CONTROL	NA	LS	1	45,225.00	45,225.00	20,500.00	20,500.00
8	120100	TRAFFIC CONTROL SYSTEM	NA	LS	1	15,000.00	15,000.00	7,600.00	7,600.00
9	160101	CLEARING AND GRUBBING	NA	LS	1	9,000.00	9,000.00	25,000.00	25,000.00
10	170101	DEVELOP WATER SUPPLY	NA	LS	1	4,500.00	4,500.00	26,000.00	26,000.00
11	000001	ITEM DELETED BY ADDENDUM	-----	-----	-----	-----	-----	-----	-----
12	000001	ITEM DELETED BY ADDENDUM	-----	-----	-----	-----	-----	-----	-----
13	011507	COLD PLANE ASPHALT CONCRETE PAVEMENT (.12)	NA	SQFT	352	13.25	4,664.00	9.00	3,168.00
14	017304	MINOR CONCRETE (CURB AND GUTTER) (CRS 200)	NA	LF	1,495	13.78	20,601.10	14.00	20,930.00
15	017305	MINOR CONCRETE (CURB AND GUTTER) (CRS 201)	NA	LF	3,200	11.24	35,968.00	14.00	44,800.00
16	017306	MINOR CONCRETE (CURB RAMP) (CRS 403)	NA	EA	7	1,220.00	8,540.00	1,200.00	8,400.00
17	731521	MINOR CONCRETE SIDEWALK (CRS401)	NA	SQFT	27,534	2.44	67,182.96	2.70	74,341.80
18	731521A	MINOR CONCRETE SIDEWALK (CRS404)	NA	SQFT	4,459	2.60	11,593.40	2.70	12,039.30
19	017310	MINOR CONCRETE (DRIVE APPROACH)	NA	SQFT	2,592	3.82	9,901.44	6.00	15,552.00
20	017302	MINOR CONCRETE (CROSS-GUTTER) (CRS 209)	NA	SQFT	1,399	6.15	8,603.85	6.00	8,394.00
21	120120A	BARRICADE (CRS 810)	NA	LF	108	32.00	3,456.00	105.00	11,340.00
22	510501	MINOR CONCRETE [V-DITCH]	NA	LF	722	19.85	14,331.70	20.00	14,440.00
23	510520	MINOR CONCRETE (CONCRETE DRAIN)[DOWN-DRAIN]	NA	LF	54	22.30	1,204.20	23.00	1,242.00
24	840666	PAINT PAVEMENT MARKING (2-COAT)	NA	SQFT	1,316	2.39	3,145.24	2.60	3,421.60
25	566011	ROADSIDE SIGN - ONE POST	NA	EA	70	228.00	15,960.00	235.00	16,450.00
26	820108	DELINEATOR (CLASS 2) [Type F]	NA	EA	17	48.00	816.00	50.00	850.00
27	840656	PAINT TRAFFIC STRIPE (2-COAT) [4"]	NA	LF	4,712	0.37	1,743.44	0.40	1,884.80
28	840656	PAINT TRAFFIC STRIPE (2-COAT) [12"]	NA	LF	454	2.12	962.48	2.50	1,135.00
29	000003	WATER SYSTEM IMPROVEMENTS	NA	LS	1	693,540.00	693,540.00	450,000.00	450,000.00
30	000003	SEWER SYSTEM IMPROVEMENTS	NA	LS	1	396,300.00	396,300.00	340,000.00	340,000.00
31	000003	STORM DRAIN SYSTEM IMPROVEMENTS	NA	LS	1	453,435.00	453,435.00	535,000.00	535,000.00
32	015601	STREET NAME SIGN (CRS 816)	NA	EA	3	175.00	525.00	380.00	1,140.00

**Riverside County Transportation Department
Summary of Bids**

**PROJECT: ROAD IMPROVEMENTS ON BRIGGS ROAD AND
BAXTER ROAD, NORTH OF THE CITY OF MURRIETA**

Advertised: April 10, 2012 (Agenda Item: 3.50)
Addenda: 1(4/25/12), 2(5/1/12), 3(5/3/12)
Bids Open: 2 pm Date: Wednesday, May 9, 2012

PROJECT NO. C2-0156, MS 4089, IP060030

ITEM NO.	ITEM CODE	CONTRACT ITEM	Like Bid Item	UNITS	QUANTITY	4		5	
						BID UNIT PRICE	BID ESTIMATE	BID UNIT PRICE	BID ESTIMATE
						Heartland Grading Carlsbad, CA 92010		FM & Sons, Inc. Santa Ana, CA 92705	
33	190161	ROCK EXCAVATION	NA	FA	1	20,000.00	20,000.00	20,000.00	20,000.00
34	000003	MISCELLANEOUS DIRECTED WORK	NA	FA	1	80,000.00	80,000.00	80,000.00	80,000.00
35	019901	DE-MOBILIZATION	NA	LS	1	100,000.00	100,000.00	100,000.00	100,000.00
						SUBTOTAL (Base Bid)		2,980,977.50	
						ITEMS 1-35		3,266,658.06	
						4 Heartland Grading Carlsbad, CA 92010		5 FM & Sons, Inc. Santa Ana, CA 92705	
ITEM NO.	ITEM CODE	CONTRACT ITEM	Like Bid Item	UNITS	QUANTITY	BID UNIT PRICE	BID ESTIMATE	BID UNIT PRICE	BID ESTIMATE
36	190101(F)	ROADWAY EXCAVATION	Like 1	CY	247	3.50	864.50	3.10	765.70
37	260201	CLASS 2 AGGREGATE BASE	Like 2	CY	781	29.33	22,906.73	22.50	17,572.50
38	390130	HOT MIX ASPHALT	Like 3	TON	432	71.02	30,680.64	71.90	31,060.80
39	721007	ROCK SLOPE PROTECTION (1/4-TON, METHOD B)	Like 4	CY	22	106.00	2,332.00	133.00	2,926.00
40	840656	PAINT TRAFFIC STRIPE (2-COAT) [8"]	Like 5	LF	2,066	0.58	1,198.28	0.40	826.40
41	066102	DUST ABATEMENT	NA	LS	1	1,000.00	1,000.00	1,700.00	1,700.00
42	074020	WATER POLLUTION CONTROL	NA	LS	1	4,500.00	4,500.00	3,000.00	3,000.00
43	120100	TRAFFIC CONTROL SYSTEM	NA	LS	1	1,500.00	1,500.00	2,000.00	2,000.00
44	160101	CLEARING AND GRUBBING	NA	LS	1	1,000.00	1,000.00	1,400.00	1,400.00
45	170101	DEVELOP WATER SUPPLY	NA	LS	1	500.00	500.00	1,800.00	1,800.00
46	650014	18" REINFORCED CONCRETE PIPE	NA	LF	318	63.63	20,234.34	99.00	31,482.00
47	650018	24" REINFORCED CONCRETE PIPE	NA	LF	291	70.00	20,370.00	130.00	37,830.00
48	650026	36" REINFORCED CONCRETE PIPE	NA	LF	420	102.60	43,092.00	155.00	65,100.00
49	017104A	JUNCTION STRUCTURE NO. 2	NA	EA	1	3,275.00	3,275.00	2,100.00	2,100.00
50	017101A	MANHOLE NO. 1	NA	EA	3	6,140.00	18,420.00	4,300.00	12,900.00
51	015101A	CONCRETE COLLAR	NA	EA	2	735.00	1,470.00	930.00	1,860.00
52	000003	INCLIND TRASH RACK	NA	EA	1	4,515.00	4,515.00	4,000.00	4,000.00
53	000003	8" SDR35 P.V.C. SEWER	NA	LF	985	82.29	81,055.65	85.00	83,725.00
54	000003	STANDARD MANHOLE (SEWER)	NA	EA	2	3,750.00	7,500.00	4,000.00	8,000.00
55	000003	END PLUG (SEWER)	NA	EA	2	53.00	106.00	82.00	164.00
56	510535	MINOR CONCRETE (HEADWALL)	NA	CY	4	9,330.00	37,320.00	1,400.00	5,600.00
						SUBTOTAL (Alternate 1)		315,812.40	
						ITEM 36-56		303,840.14	

**Riverside County Transportation Department
Summary of Bids**

**PROJECT: ROAD IMPROVEMENTS ON BRIGGS ROAD AND
BAXTER ROAD, NORTH OF THE CITY OF MURRIETA**

Advertised: April 10, 2012 (Agenda Item: 3.50)
Addenda: 1(4/25/12), 2(5/1/12), 3(5/3/12)
Bids Open: 2 pm Date: Wednesday, May 9, 2012

PROJECT NO. C2-0156, MS 4089, IP060030

ALTERNATE 2 BID SCHEDULE (EMWD OPTION 1)		ALTERNATE 3 BID SCHEDULE (EMWD OPTION 2)							
ITEM NO.	ITEM CODE	CONTRACT ITEM	Like Bid Item	UNITS	QUANTITY	BID UNIT PRICE	BID ESTIMATE	BID UNIT PRICE	BID ESTIMATE
57	000003	8" SDR35 PVC SEWER	NA	LF	1,945	103.04	200,412.80	110.00	213,950.00
58	000003	12" C-900 PVC WATER	NA	LF	3,385	51.72	175,072.20	106.00	358,810.00
59	000003	12" MISC. FITTINGS (WATER)	NA	EA	12	515.00	6,180.00	630.00	7,560.00
60	000003	12" GATE VALVE	NA	EA	6	3,525.00	21,150.00	3,300.00	19,800.00
		SUBTOTAL (Alternate 2)					402,815.00		600,120.00
		ITEM 57-60							
		ALTERNATE 3 BID SCHEDULE (EMWD OPTION 2)							
		ITEM 61-64							
61	000003	18" VITRIFIED CLAY PIPE (VCP) SEWER	NA	LF	1,945	154.19	299,899.55	180.00	350,100.00
62	000003	18" C-905 PVC WATER	NA	LF	3,385	88.97	301,183.45	140.00	473,900.00
63	000003	18" MISC. FITTINGS (WATER)	NA	EA	12	795.00	9,540.00	1,200.00	14,400.00
64	000003	18" GATE VALVE	NA	EA	6	17,420.00	104,520.00	18,000.00	108,000.00
		SUBTOTAL (Alternate 3)					715,123.00		946,400.00
		ITEM 61-64							
		PROJECT TOTAL					4,688,436.20		4,843,309.90
		ITEMS 1-64							

**Riverside County Transportation Department
Summary of Bids**

**PROJECT: ROAD IMPROVEMENTS ON BRIGGS ROAD AND
BAXTER ROAD, NORTH OF THE CITY OF MURRIETA**

Advertised: April 10, 2012 (Agenda Item: 3.50)
Addenda: 1(4/25/12), 2(5/1/12), 3(5/3/12)
Bids Open: 2 pm Date: Wednesday, May 9, 2012

PROJECT NO. C2-0156, MS 4089, IP060030

BASE BID	ITEM NO.	ITEM CODE	CONTRACT ITEM	Like Bid Item	UNITS	QUANTITY	BID UNIT PRICE	6		7	
								Utah Pacific Construction Murrieta, CA 92562		Southern California Grading Irvine, CA 92606	
								BID ESTIMATE	BID UNIT PRICE	BID ESTIMATE	
	1	190101(F)	ROADWAY EXCAVATION	Like 1	CY	144,220	11.00	1,586,420.00	3.60	519,192.00	
	2	260201	CLASS 2 AGGREGATE BASE	Like 2	CY	10,371	47.00	487,437.00	28.00	290,388.00	
	3	390130	HOT MIX ASPHALT	Like 3	TON	5,793	77.00	446,061.00	72.00	417,096.00	
	4	721007	ROCK SLOPE PROTECTION (1/4-TON, METHOD B)	Like 4	CY	46	130.00	5,980.00	207.00	9,522.00	
	5	840656	PAINT TRAFFIC STRIPE (2-COAT) [8"]	Like 5	LF	10,712	0.50	5,356.00	0.60	6,427.20	
	6	066102	DUST ABATEMENT	NA	LS	1	55,000.00	55,000.00	39,068.00	39,068.00	
	7	074020	WATER POLLUTION CONTROL	NA	LS	1	39,000.00	39,000.00	36,607.00	36,607.00	
	8	120100	TRAFFIC CONTROL SYSTEM	NA	LS	1	54,000.00	54,000.00	153,898.00	153,898.00	
	9	160101	CLEARING AND GRUBBING	NA	LS	1	117,000.00	117,000.00	104,493.00	104,493.00	
	10	170101	DEVELOP WATER SUPPLY	NA	LS	1	18,000.00	18,000.00	98,761.00	98,761.00	
	11	000001	ITEM DELETED BY ADDENDUM	-----	-----	-----	-----	-----	-----	-----	
	12	000001	ITEM DELETED BY ADDENDUM	-----	-----	-----	-----	-----	-----	-----	
	13	011507	COLD PLANE ASPHALT CONCRETE PAVEMENT (12)	NA	SQFT	352	9.00	3,168.00	4.25	1,496.00	
	14	017304	MINOR CONCRETE (CURB AND GUTTER) (CRS 200)	NA	LF	1,495	11.00	16,445.00	22.80	34,086.00	
	15	017305	MINOR CONCRETE (CURB AND GUTTER) (CRS 201)	NA	LF	3,200	12.00	38,400.00	20.00	64,000.00	
	16	017306	MINOR CONCRETE (CURB RAMP) (CRS 403)	NA	EA	7	1,500.00	10,500.00	4,187.00	29,309.00	
	17	731521	MINOR CONCRETE SIDEWALK (CRS401)	NA	SQFT	27,534	3.00	82,602.00	5.50	151,437.00	
	18	731521A	MINOR CONCRETE SIDEWALK (CRS404)	NA	SQFT	4,459	3.00	13,377.00	8.00	35,672.00	
	19	017310	MINOR CONCRETE (DRIVE APPROACH)	NA	SQFT	2,592	7.00	18,144.00	9.00	23,328.00	
	20	017302	MINOR CONCRETE (CROSS-GUTTER) (CRS 209)	NA	SQFT	1,399	9.00	12,591.00	14.00	19,586.00	
	21	120120A	BARRICADE (CRS 810)	NA	LF	108	66.00	7,128.00	64.00	6,912.00	
	22	510501	MINOR CONCRETE [V-DITCH]	NA	LF	722	19.00	13,718.00	19.00	13,718.00	
	23	510520	MINOR CONCRETE (CONCRETE DRAIN) [DOWN-DRAIN]	NA	LF	54	26.00	1,404.00	22.00	1,188.00	
	24	840666	PAINT PAVEMENT MARKING (2-COAT)	NA	SQFT	1,316	5.00	6,580.00	2.00	2,632.00	
	25	566011	ROADSIDE SIGN - ONE POST	NA	EA	70	250.00	17,500.00	231.00	16,170.00	
	26	820108	DELINEATOR (CLASS 2) [Type F]	NA	EA	17	38.00	646.00	131.00	2,227.00	
	27	840656	PAINT TRAFFIC STRIPE (2-COAT) [4"]	NA	LF	4,712	0.40	1,884.80	0.50	2,356.00	
	28	840656	PAINT TRAFFIC STRIPE (2-COAT) [12"]	NA	LF	454	4.30	1,952.20	2.00	908.00	
	29	000003	WATER SYSTEM IMPROVEMENTS	NA	LS	1	523,000.00	523,000.00	555,118.00	555,118.00	
	30	000003	SEWER SYSTEM IMPROVEMENTS	NA	LS	1	429,000.00	429,000.00	507,904.00	507,904.00	
	31	000003	STORM DRAIN SYSTEM IMPROVEMENTS	NA	LS	1	756,000.00	756,000.00	944,067.00	944,067.00	
	32	015601	STREET NAME SIGN (CRS 816)	NA	EA	3	500.00	1,500.00	341.00	1,023.00	

**Riverside County Transportation Department
Summary of Bids**

**PROJECT: ROAD IMPROVEMENTS ON BRIGGS ROAD AND
BAXTER ROAD, NORTH OF THE CITY OF MURRIETA**

Advertised: April 10, 2012 (Agenda Item: 3.50)
Addenda: 1(4/25/12), 2(5/1/12), 3(5/3/12)
Bids Open: 2 pm Date: Wednesday, May 9, 2012

PROJECT NO. C2-0156, MS 4089, IP060030

6

7

BASE BID (CONTINUED)

ITEM NO.	ITEM CODE	CONTRACT ITEM	Like Bid Item	UNITS	QUANTITY	BID UNIT PRICE	BID ESTIMATE	BID UNIT PRICE	BID ESTIMATE
33	190161	ROCK EXCAVATION	NA	FA	1	20,000.00	20,000.00	20,000.00	20,000.00
34	000003	MISCELLANEOUS DIRECTED WORK	NA	FA	1	80,000.00	80,000.00	80,000.00	80,000.00
35	019901	DE-MOBILIZATION	NA	LS	1	100,000.00	100,000.00	100,000.00	100,000.00
		SUBTOTAL (Base Bid)					4,969,794.00		4,288,589.20
		ITEMS 1-35							

ALTERNATE 1 BID SCHEDULE (BROOKFIELD LLC)

Utah Pacific Construction
Murrieta, CA 92562

Southern California Grading
Irvine, CA 92606

ITEM NO.	ITEM CODE	CONTRACT ITEM	Like Bid Item	UNITS	QUANTITY	BID UNIT PRICE	BID ESTIMATE	BID UNIT PRICE	BID ESTIMATE
36	190101(F)	ROADWAY EXCAVATION	Like 1	CY	247	11.00	2,717.00	3.60	889.20
37	260201	CLASS 2 AGGREGATE BASE	Like 2	CY	781	47.00	36,707.00	28.00	21,868.00
38	390130	HOT MIX ASPHALT	Like 3	TON	432	77.00	33,264.00	72.00	31,104.00
39	721007	ROCK SLOPE PROTECTION (1/4-TON, METHOD B)	Like 4	CY	22	130.00	2,860.00	207.00	4,554.00
40	840656	PAINT TRAFFIC STRIPE (2-COAT) [8"]	Like 5	LF	2,066	0.50	1,033.00	0.60	1,239.60
41	066102	DUST ABATEMENT	NA	LS	1	8,200.00	8,200.00	575.00	575.00
42	074020	WATER POLLUTION CONTROL	NA	LS	1	15,000.00	15,000.00	575.00	575.00
43	120100	TRAFFIC CONTROL SYSTEM	NA	LS	1	18,000.00	18,000.00	575.00	575.00
44	160101	CLEARING AND GRUBBING	NA	LS	1	5,000.00	5,000.00	575.00	575.00
45	170101	DEVELOP WATER SUPPLY	NA	LS	1	5,000.00	5,000.00	575.00	575.00
46	650014	18" REINFORCED CONCRETE PIPE	NA	LF	318	109.00	34,662.00	94.24	29,968.32
47	650018	24" REINFORCED CONCRETE PIPE	NA	LF	291	142.00	41,322.00	123.90	36,054.90
48	650026	36" REINFORCED CONCRETE PIPE	NA	LF	420	197.00	82,740.00	145.95	61,299.00
49	017104A	JUNCTION STRUCTURE NO. 2	NA	EA	1	3,300.00	3,300.00	1,995.00	1,995.00
50	017101A	MANHOLE NO. 1	NA	EA	3	7,000.00	21,000.00	4,173.75	12,521.25
51	015101A	CONCRETE COLLAR	NA	EA	2	425.00	850.00	882.50	1,785.00
52	000003	INCLIND TRASH RACK	NA	EA	1	2,600.00	2,600.00	3,727.50	3,727.50
53	000003	8" SDR35 P.V.C. SEWER	NA	LF	985	131.00	129,035.00	80.00	78,800.00
54	000003	STANDARD MANHOLE [SEWER]	NA	EA	2	6,300.00	12,600.00	3,780.00	7,560.00
55	000003	END PLUG [SEWER]	NA	EA	2	365.00	730.00	78.75	157.50
56	510535	MINOR CONCRETE (HEADWALL)	NA	CY	4	2,000.00	8,000.00	1,307.25	5,229.00
		SUBTOTAL (Alternate 1)					464,620.00		301,627.27
		ITEM 36-56							

**Riverside County Transportation Department
Summary of Bids**

**PROJECT: ROAD IMPROVEMENTS ON BRIGGS ROAD AND
BAXTER ROAD, NORTH OF THE CITY OF MURRIETA**

Advertised: April 10, 2012 (Agenda Item: 3.50)
Addenda: 1(4/25/12), 2(5/1/12), 3(5/3/12)
Bids Open: 2 pm Date: Wednesday, May 9, 2012

PROJECT NO. C2-0156, MS 4089, IP060030

ALTERNATE 2 BID SCHEDULE (EMWD OPTION 1)		6		7					
ITEM NO.	ITEM CODE	CONTRACT ITEM	Like Bid Item	UNITS	QUANTITY	BID UNIT PRICE	BID ESTIMATE	BID UNIT PRICE	BID ESTIMATE
57	000003	8" SDR35 PVC SEWER	NA	LF	1,945	10.00	19,450.00	100.00	194,500.00
58	000003	12" C-900 PVC WATER	NA	LF	3,385	23.00	77,855.00	98.00	331,730.00
59	000003	12" MISC. FITTINGS (WATER)	NA	EA	12	700.00	8,400.00	577.50	6,930.00
60	000003	12" GATE VALVE	NA	EA	6	2,992.00	17,952.00	3,045.00	18,270.00
		SUBTOTAL (Alternate 2)					123,657.00		551,430.00
		ITEM 57-60							
ALTERNATE 3 BID SCHEDULE (EMWD OPTION 2)		6		7					
		Utah Pacific Construction Murrieta, CA 92562						Southern California Grading Irvine, CA 92606	
ITEM NO.	ITEM CODE	CONTRACT ITEM	Like Bid Item	UNITS	QUANTITY	BID UNIT PRICE	BID ESTIMATE	BID UNIT PRICE	BID ESTIMATE
61	000003	18" VITRIFIED CLAY PIPE (VCP) SEWER	NA	LF	1,945	40.00	77,800.00	159.00	309,255.00
62	000003	18" C-905 PVC WATER	NA	LF	3,385	53.00	179,405.00	129.00	436,665.00
63	000003	18" MISC. FITTINGS (WATER)	NA	EA	12	2,250.00	27,000.00	1,102.50	13,230.00
64	000003	18" GATE VALVE	NA	EA	6	12,500.00	75,000.00	16,642.50	99,855.00
		SUBTOTAL (Alternate 3)					359,205.00		859,005.00
		ITEM 61-64							
		PROJECT TOTAL					5,917,276.00		6,000,651.47
		ITEMS 1-64							

**Riverside County Transportation Department
Summary of Bids**

**PROJECT: ROAD IMPROVEMENTS ON BRIGGS ROAD AND
BAXTER ROAD, NORTH OF THE CITY OF MURRIETA**

Advertised: April 10, 2012 (Agenda Item: 3.50)
Addenda: 1(4/25/12), 2(5/1/12), 3(5/3/12)
Bids Open: 2 pm Date: Wednesday, May 9, 2012

PROJECT NO. C2-0156, MS 4089, IP060030

BASE BID
Hillcrest Contracting
Corona, CA 92878

ITEM NO.	ITEM CODE	CONTRACT ITEM	Like Bid Item	UNITS	QUANTITY	BID UNIT PRICE	BID ESTIMATE
1	190101(F)	ROADWAY EXCAVATION	Like 1	CY	144,220	13.00	1,874,860.00
2	260201	CLASS 2 AGGREGATE BASE	Like 2	CY	10,371	29.00	300,759.00
3	390130	HOT MIX ASPHALT	Like 3	TON	5,793	72.00	417,096.00
4	721007	ROCK SLOPE PROTECTION (1/4-TON, METHOD B)	Like 4	CY	46	106.00	4,876.00
5	840656	PAINT TRAFFIC STRIPE (2-COAT) [8"]	Like 5	LF	10,712	0.37	3,963.44
6	066102	DUST ABATEMENT	NA	LS	1	64,000.00	64,000.00
7	074020	WATER POLLUTION CONTROL	NA	LS	1	50,000.00	50,000.00
8	120100	TRAFFIC CONTROL SYSTEM	NA	LS	1	10,000.00	10,000.00
9	160101	CLEARING AND GRUBBING	NA	LS	1	1,050,000.00	1,050,000.00
10	170101	DEVELOP WATER SUPPLY	NA	LS	1	23,300.00	23,300.00
11	000001	ITEM DELETED BY ADDENDUM	-----	-----	-----	-----	-----
12	000001	ITEM DELETED BY ADDENDUM	-----	-----	-----	-----	-----
13	011507	COLD PLANE ASPHALT CONCRETE PAVEMENT (.12')	NA	SQFT	352	11.80	4,153.60
14	017304	MINOR CONCRETE (CURB AND GUTTER) (CRS 200)	NA	LF	1,495	15.80	23,621.00
15	017305	MINOR CONCRETE (CURB AND GUTTER) (CRS 201)	NA	LF	3,200	13.20	42,240.00
16	017306	MINOR CONCRETE (CURB RAMP) (CRS 403)	NA	EA	7	2,760.00	19,320.00
17	731521	MINOR CONCRETE SIDEWALK (CRS401)	NA	SQFT	27,534	2.86	78,747.24
18	731521A	MINOR CONCRETE SIDEWALK (CRS404)	NA	SQFT	4,459	3.50	15,606.50
19	017310	MINOR CONCRETE (DRIVE APPROACH)	NA	SQFT	2,592	4.90	12,700.80
20	017302	MINOR CONCRETE (CROSS-GUTTER) (CRS 209)	NA	SQFT	1,399	7.30	10,212.70
21	120120A	BARRICADE (CRS 810)	NA	LF	108	65.00	7,020.00
22	510501	MINOR CONCRETE [V-DITCH]	NA	LF	722	20.00	14,440.00
23	510520	MINOR CONCRETE (CONCRETE DRAIN] DOWN-DRAIN]	NA	LF	54	23.00	1,242.00
24	840666	PAINT PAVEMENT MARKING (2-COAT)	NA	SQFT	1,316	2.50	3,290.00
25	566011	ROADSIDE SIGN - ONE POST	NA	EA	70	230.00	16,100.00
26	820108	DELINEATOR (CLASS 2) [Type F]	NA	EA	17	42.00	714.00
27	840656	PAINT TRAFFIC STRIPE (2-COAT) [4"]	NA	LF	4,712	0.32	1,507.84
28	840656	PAINT TRAFFIC STRIPE (2-COAT) [12"]	NA	LF	454	2.23	1,012.42
29	000003	WATER SYSTEM IMPROVEMENTS	NA	LS	1	270,000.00	270,000.00
30	000003	SEWER SYSTEM IMPROVEMENTS	NA	LS	1	90,000.00	90,000.00
31	000003	STORM DRAIN SYSTEM IMPROVEMENTS	NA	LS	1	500,000.00	500,000.00
32	015601	STREET NAME SIGN (CRS 816)	NA	EA	3	370.00	1,110.00

**Riverside County Transportation Department
Summary of Bids**

**PROJECT: ROAD IMPROVEMENTS ON BRIGGS ROAD AND
BAXTER ROAD, NORTH OF THE CITY OF MURRIETA**

Advertised: April 10, 2012 (Agenda Item: 3.50)
Addenda: 1(4/25/12), 2(5/1/12), 3(5/3/12)
Bids Open: 2 pm Date: Wednesday, May 9, 2012

PROJECT NO. C2-0-156, MS 4089, IP060030

BASE BID (CONTINUED)

ITEM NO.	ITEM CODE	CONTRACT ITEM	Like Bid Item	UNITS	QUANTITY	BID UNIT PRICE	BID ESTIMATE
33	190161	ROCK EXCAVATION	NA	FA	1	20,000.00	20,000.00
34	000003	MISCELLANEOUS DIRECTED WORK	NA	FA	1	80,000.00	80,000.00
35	019901	DE-MOBILIZATION	NA	LS	1	100,000.00	100,000.00
		SUBTOTAL (Base Bid)					5,111,892.54
		ITEMS 1-35					8

ALTERNATE 1 BID SCHEDULE (BROOKFIELD LLC)

Hillcrest Contracting
Corona, CA 92878

ITEM NO.	ITEM CODE	CONTRACT ITEM	Like Bid Item	UNITS	QUANTITY	BID UNIT PRICE	BID ESTIMATE
36	190101(F)	ROADWAY EXCAVATION	Like 1	CY	247	13.00	3,211.00
37	260201	CLASS 2 AGGREGATE BASE	Like 2	CY	781	29.00	22,649.00
38	390130	HOT MIX ASPHALT	Like 3	TON	432	72.00	31,104.00
39	721007	ROCK SLOPE PROTECTION (1/4-TON, METHOD B)	Like 4	CY	22	106.00	2,332.00
40	840656	PAINT TRAFFIC STRIPE (2-COAT) [8"]	Like 5	LF	2,066	0.37	764.42
41	066102	DUST ABATEMENT	NA	LS	1	5,300.00	5,300.00
42	074020	WATER POLLUTION CONTROL	NA	LS	1	10,000.00	10,000.00
43	120100	TRAFFIC CONTROL SYSTEM	NA	LS	1	8,000.00	8,000.00
44	160101	CLEARING AND GRUBBING	NA	LS	1	12,326.96	12,326.96
45	170101	DEVELOP WATER SUPPLY	NA	LS	1	3,200.00	3,200.00
46	650014	18" REINFORCED CONCRETE PIPE	NA	LF	318	74.00	23,532.00
47	650018	24" REINFORCED CONCRETE PIPE	NA	LF	291	104.00	30,264.00
48	650026	36" REINFORCED CONCRETE PIPE	NA	LF	420	106.00	44,520.00
49	017104A	JUNCTION STRUCTURE NO. 2	NA	EA	1	2,650.00	2,650.00
50	017101A	MANHOLE NO. 1	NA	EA	3	5,600.00	16,800.00
51	015101A	CONCRETE COLLAR	NA	EA	2	560.00	1,120.00
52	000003	INCLIND TRASH RACK	NA	EA	1	2,100.00	2,100.00
53	000003	8" SDR35 P.V.C. SEWER	NA	LF	985	69.00	67,965.00
54	000003	STANDARD MANHOLE [SEWER]	NA	EA	2	5,800.00	11,600.00
55	000003	END PLUG [SEWER]	NA	EA	2	26.50	53.00
56	510535	MINOR CONCRETE (HEADWALL)	NA	CY	4	2,860.00	11,440.00
		SUBTOTAL (Alternate 1)					310,931.38
		ITEM 36-56					8

**Riverside County Transportation Department
Summary of Bids**

**PROJECT: ROAD IMPROVEMENTS ON BRIGGS ROAD AND
BAXTER ROAD, NORTH OF THE CITY OF MURRIETA**

Advertised: April 10, 2012 (Agenda Item: 3.50)
Addenda: 1(4/25/12), 2(5/1/12), 3(5/3/12)
Bids Open: 2 pm Date: Wednesday, May 9, 2012

PROJECT NO. C2-0156, MS 4089, IP060030

ALTERNATE 2 BID SCHEDULE (EMWD OPTION 1)		Hillcrest Contracting Corona, CA 92878		8			
ITEM NO.	ITEM CODE	CONTRACT ITEM	Like Bid Item	UNITS	QUANTITY	BID UNIT PRICE	BID ESTIMATE
57	000003	8" SDR35 PVC SEWER	NA	LF	1,945	104.00	202,280.00
58	000003	12" C-900 PVC WATER	NA	LF	3,385	64.00	216,640.00
59	000003	12" MISC. FITTINGS (WATER)	NA	EA	12	800.00	9,600.00
60	000003	12" GATE VALVE	NA	EA	6	3,550.00	21,300.00
SUBTOTAL (Alternate 2)							449,820.00
ITEM 57-60							8
ALTERNATE 3 BID SCHEDULE (EMWD OPTION 2)							Hillcrest Contracting Corona, CA 92878
ITEM NO.	ITEM CODE	CONTRACT ITEM	Like Bid Item	UNITS	QUANTITY	BID UNIT PRICE	BID ESTIMATE
61	000003	18" VITRIFIED CLAY PIPE (VCP) SEWER	NA	LF	1,945	155.00	301,475.00
62	000003	18" C-905 PVC WATER	NA	LF	3,385	105.00	355,425.00
63	000003	18" MISC. FITTINGS (WATER)	NA	EA	12	1,500.00	18,000.00
64	000003	18" GATE VALVE	NA	EA	6	18,200.00	109,200.00
SUBTOTAL (Alternate 3)							784,100.00
ITEM 61-64							
PROJECT TOTAL							6,656,743.92
ITEMS 1-64							



COUNTY OF RIVERSIDE TRANSPORTATION AND LAND MANAGEMENT AGENCY



Juan C. Perez, P.E., T.E.
Director of Transportation

Transportation Department

ADDENDUM NUMBER 1

Dated April 25, 2012

to the
Specifications and Contract Documents
for the construction of

Road Improvements on
Briggs Road and Baxter Road
North of the City of Murrieta

Project No. C2-0156
MS 4089, IP 060030

Bids Due: Wednesday, May 2, 2012; 2:00 PM
14th Street Transportation Annex
3525 14th Street; Riverside, CA 92501
(951) 955-6780

This Addendum is issued pursuant to the Instructions to Bidders, Item No. 8, of the Contract Documents for the reference project. This Addendum is issued as a supplement to the specification and special provisions for the referenced project. The revisions to the specifications shall become a part of the Contract Documents, and each bidder shall acknowledge receipt thereof on the Contractor's Proposal. Bidders are directed to sign this addendum as acknowledged, and attach the signed addendum to the contractor's submitted proposal.

Note: During the advertisement period of this project, this document and attachments (if any) are available upon request at the office of the Transportation Department, and are available as a free download at the Transportation Department's website:

www.tlma.co.riverside.ca.us/trans/con_bid_advertisements.html

MODIFICATIONS / CLARIFICATIONS TO SPECIAL PROVISIONS:

Item 1: Revised Proposal. Refer to "Proposal" pages B3-B5. Proposal (pages B3 - B5) is deleted and replaced with revised "Proposal" attached herewith as **Attachment "A"**. The following additional changes have been made to the Proposal Schedules:

a. The following bid item has been deleted from the Base Bid:

- Item 12, "Finishing Roadway"

8. Satisfactory completion of punch list items, all construction and administrative items of work.

De-Mobilization shall include the satisfactory completion of all items of work, but shall not be interpreted as being a separate payment for work that is paid under separate contract items. The contract item for De-Mobilization is intended for project close-out activities.

Method of Payment:

Payment for De-Mobilization will be made on a lump-sum basis in the amount of the fixed bid price after satisfactory completion of the above listed items. Payment for De-Mobilization will be included in the final pay estimate and payment. No partial payments will be made for De-Mobilization.

Item 3: Relocate Existing Fence.

The following Special Provisions are added and made part hereof:

RELOCATE FENCE:

Existing fence where shown on the plan to be relocated shall be relocated outside the public road Right-of-Way as shown on the construction plans and as directed by the Engineer.

If during relocation operations the Contractor damages the existing fencing and the material is determined to be damaged or not suitable for relocation, the Contractor shall provide fencing in a similar suitable material (and color) as determined by the Engineer at no additional cost to the County.

Method of Payment:

Full compensation for relocating existing fence shall be considered as included in the Lump Sum bid price paid for Clearing and Grubbing and shall include all labor, tools, material, equipment, and incidentals, and for doing all work involved, and no additional compensation will be allowed therefor.

MODIFICATIONS / CLARIFICATIONS TO PLANS:

Item 4: Street Improvement Plans (Sheet 5 of 13)

Refer to Street Improvement Plans (Sheet 5 of 13), and the construction note # 25 "Relocate existing Fence to R/W." Delete the number 25 and replace it with the number 27. (Only the construction note number is revised, the construction item remains applicable).

Addendum No. 1
Road Improvements on Briggs Road and Baxter Road
Project No.C2-0156, MS 4089, IP 060030
April 25, 2012
Page 5 of 7

This addendum has been prepared under the direction of the following registered Civil Engineer(s):



Paul R. Huddleston Jr., PE



A – Revised Proposal

B – Street Improvement Plans; Added Sheet 9A of 13

C – Sewer and Water Plans; Revised Sheets 1 through 9

D – Storm Drain Plans; Revised Sheets 1 through 12



COUNTY OF RIVERSIDE TRANSPORTATION AND LAND MANAGEMENT AGENCY



Juan C. Perez, P.E., T.E.
Director of Transportation

Transportation Department

ADDENDUM NUMBER 2

Dated May 1, 2012

to the
Specifications and Contract Documents
for the construction of

Road Improvements on
Briggs Road and Baxter Road
North of the City of Murrieta

Project No. C2-0156
MS 4089, IP 060030

Bids Due: (Revised)
Wednesday, May 9, 2012; 2:00 PM
14th Street Transportation Annex
3525 14th Street; Riverside, CA 92501
(951) 955-6780

This Addendum is issued pursuant to the Instructions to Bidders, Item No. 8, of the Contract Documents for the reference project. This Addendum is issued as a supplement to the specification and special provisions for the referenced project. The revisions to the specifications shall become a part of the Contract Documents, and each bidder shall acknowledge receipt thereof on the Contractor's Proposal. Bidders are directed to sign this addendum as acknowledged, and attach the signed addendum to the contractor's submitted proposal.

Note: During the advertisement period of this project, this document and attachments (if any) are available upon request at the office of the Transportation Department, and are available as a free download at the Transportation Department's website:

www.rctlma.org/trans/con_bid_advertisements.html

MODIFICATIONS / CLARIFICATIONS TO SPECIAL PROVISIONS:

Item 1: The new designated date and time for the receipt and opening of bids is revised as follows:

Wednesday, May 9, 2012; 2:00 PM
14th Street Transportation Annex
3525 14th Street; Riverside, CA 92501
(951) 955-6780

Item 2: Revised Proposal. Refer to addendum 1 and "Revised Proposal" pages B3-B5. Delete revised proposal issued by addendum 1 and replace with revised Proposal issued by this addendum as **Attachment "A"**. The following additional changes have been made to the Proposal Schedules:

a. The following bid item has been deleted from the Base Bid:

- Item 11, " Import Borrow [Earthwork Fill on Site] "

b. The description of following bid item has been revised:

- Item 61, " 18" Vitrified Clay Pipe (VCP) Sewer "

See Attachment "A"

Item 3: Import Borrow. Surplus Material. Refer to section entitled "Import Borrow" on page 69 of Spec book and delete this section.

Additionally, any surplus material of excavation shall conform to Section 19 - 2.06 of Standard Specification and as directed by the Engineer.

Item 4: Supplemental Project Information. The following Special Provisions are added and made part hereof:

Supplemental Project Information

The following supplemental project information is available at the following County website during the advertisement period of this project for bidders' information and use:

http://www.rctlma.org/trans/con_bid_advertisements.html

- Geotechnical Investigation Report

The downloadable file is provided for reference only. The County of Riverside Transportation Department does not guarantee the accuracy of the report(s) or the data presented within the report(s), nor does the County of Riverside make any claims or representations with regard to the provided information.

Item 5: Vitrified Clay Pipe (VCP). The following Special Provisions are added and made part hereof:

Vitrified Clay Pipe (VCP)

Contractor shall furnish and install VCP in accordance with Eastern Municipal Water District's Standard and Specification, Construction plans and as directed by the Engineer. Unless otherwise shown, or when shown as VCP, all pipes shall be high strength vitrified clay pipe meeting the requirements of Section 207-8 of the Standard Specifications for Public Works Construction, 1991 Edition. All pipe and fittings shall be clearly marked with the name or trademark of the manufacturer and the strength designation.

PAYMENT

The contract unit bid price for VCP will be paid for per linear foot, which shall include full compensation for furnishing all labor, materials, tools and equipment, and incidentals, and doing all work involved in furnishing and installing VCP and no additional compensation will be allowed therefor.

MODIFICATIONS / CLARIFICATIONS TO PLANS:

Item 6: Sewer and Water Plans (Sheet 1 of 9)

Refer to Sewer and Water Plans (Sheet 1 of 9) issued by Addendum No. 1 as Attachment "C". Revision is made to the quantities for 18" sewer main:

Delete **5534 LF** from Construct Sewer Main quantities table and replace with **1945 LF**.

Item 7: Street Improvement Plans (Sheet 1 of 13)

Refer to Street Improvement Plans (Sheet 1 of 13), and the table entitled "Estimates of Earthwork Quantities" on the upper right hand corner of the Sheet 1 of 13:

Delete the words "~~Import From Tract 30433 (BGR060320)~~" and replace with "**Surplus material**". Also, see item 3 of this addendum.

Item 8: Street Improvement Plans (Sheet 2 of 13)

Refer to Street Improvement Plans (Sheet 2 of 13). The following is additional information for the following stations:

Stations 54+47.21 to 59+09.37 will be similar to detail as provided for Section Stations 59+09.37 to 61+82.70. The paved width remains fixed at 38' from the left curb face; however, the right side of the road transitions in width as shown in the plan view of Sheet 6 of 13.

Regarding Stations 70+05.27 to 71+22.07, refer to plan view of Sheet 7 of 13. The typical section before this intersection terminates at station 70+05.27 and the typical section after station 71+22.07 begins. County survey crews will locate transition points of this intersection in the field.

Item 9: Street Improvement Plans (Sheet 3 of 13)

Refer to Street Improvement Plans (Sheet 3 of 13), Delete Sheet 3 of 13 and replace with revised Sheet 3 of 13 issued with this addendum as **Attachment B** and made part hereof. This revised sheet is reprinted to clarify topography contour lines.

See Attachment "B"

Addendum No. 2
Road Improvements on Briggs Road and Baxter Road
Project No. C2-0156, MS 4089, IP 060030
May 1, 2012
Page 4 of 5

This addendum has been prepared under the direction of the following registered Civil Engineer(s):



Paul R. Huddleston Jr., PE



Recommended by:

 5-1-12

Alan French, PE
County Project Manager

Concurrence:

 5/1/2012

Khalid Nasim, PE
Engineering Division Manager

Acknowledged: _____ **Date:** _____
(Contractor)

JRJ:jrj:sb

**ROAD IMPROVEMENTS ON
BRIGGS ROAD AND BAXTER ROAD
NORTH OF THE CITY OF MURRIETA**

PROJECT NO. C2-0156
MS 4089, IP 060030

PROPOSAL (Revised by Addendum #2)

Base Bid:

ITEM No.	ITEM CODE	ITEM	Like Bid Item*	UNIT	ESTIMATED QUANTITY	ITEM PRICE (IN FIGURES)	TOTAL (IN FIGURES)
1	190101(F)	ROADWAY EXCAVATION	Like 1	CY	144,220		
2	260201	CLASS 2 AGGREGATE BASE	Like 2	CY	10,371		
3	390130	HOT MIX ASPHALT	Like 3	TON	5,793		
4	721007	ROCK SLOPE PROTECTION (1/4-TON, METHOD B)	Like 4	CY	46		
5	840656	PAINT TRAFFIC STRIPE (2-COAT) [8"]	Like 5	LF	10,712		
6	066102	DUST ABATEMENT	NA	LS	1		
7	074020	WATER POLLUTION CONTROL	NA	LS	1		
8	120100	TRAFFIC CONTROL SYSTEM	NA	LS	1		
9	160101	CLEARING AND GRUBBING	NA	LS	1		
10	170101	DEVELOP WATER SUPPLY	NA	LS	1		
11	000001	ITEM DELETED BY ADDENDUM	----	----	-----	-----	-----
12	000001	ITEM DELETED BY ADDENDUM	----	----	-----	-----	-----
13	011507	COLD PLANE ASPHALT CONCRETE PAVEMENT (.12)	NA	SQFT	352		
14	017304	MINOR CONCRETE (CURB AND GUTTER) (CRS 200)	NA	LF	1,495		
15	017305	MINOR CONCRETE (CURB AND GUTTER) (CRS 201)	NA	LF	3,200		
16	017306	MINOR CONCRETE (CURB RAMP) (CRS 403)	NA	EA	7		
17	731521	MINOR CONCRETE SIDEWALK (CRS401)	NA	SQFT	27,534		
18	731521A	MINOR CONCRETE SIDEWALK (CRS404)	NA	SQFT	4,459		
19	017310	MINOR CONCRETE (DRIVE APPROACH)	NA	SQFT	2,592		
20	017302	MINOR CONCRETE (CROSS-GUTTER) (CRS 209)	NA	SQFT	1,399		
21	120120A	BARRICADE (CRS 810)	NA	LF	108		
22	510501	MINOR CONCRETE [V-DITCH]	NA	LF	722		
23	510520	MINOR CONCRETE (CONCRETE DRAIN)[DOWN-DRAIN]	NA	LF	54		
24	840666	PAINT PAVEMENT MARKING (2-COAT)	NA	SQFT	1,316		
25	566011	ROADSIDE SIGN - ONE POST	NA	EA	70		
26	820108	DELINEATOR (CLASS 2) [Type F]	NA	EA	17		
27	840656	PAINT TRAFFIC STRIPE (2-COAT) [4"]	NA	LF	4,712		
28	840656	PAINT TRAFFIC STRIPE (2-COAT) [12"]	NA	LF	454		
29	000003	WATER SYSTEM IMPROVEMENTS	NA	LS	1		
30	000003	SEWER SYSTEM IMPROVEMENTS	NA	LS	1		
31	000003	STORM DRAIN SYSTEM IMPROVEMENTS	NA	LS	1		
32	015601	STREET NAME SIGN (CRS 816)	NA	EA	3		
33	190161	ROCK EXCAVATION	NA	FA	1	20,000.00	20,000.00
34	000003	MISCELLANEOUS DIRECTED WORK	NA	FA	1	80,000.00	80,000.00
35	019901	DE-MOBILIZATION	NA	LS	1	100,000.00	100,000.00

SUB-TOTAL:
ITEMS 1-35

"WORDS"
B3

\$ _____
Attachment "A"

PROPOSAL (Revised by Addendum #2)

Alternate 1 Bid Schedule (Brookfield LLC)

ITEM No.	ITEM CODE	ITEM	Like Bid Item*	UNIT	ESTIMATED QUANTITY	ITEM PRICE (IN FIGURES)	TOTAL (IN FIGURES)
36	190101(F)	ROADWAY EXCAVATION	Like 1	CY	247		
37	260201	CLASS 2 AGGREGATE BASE	Like 2	CY	781		
38	390130	HOT MIX ASPHALT	Like 3	TON	432		
39	721007	ROCK SLOPE PROTECTION (1/4-TON, METHOD B)	Like 4	CY	22		
40	840656	PAINT TRAFFIC STRIPE (2-COAT) [8"]	Like 5	LF	2,066		
41	066102	DUST ABATEMENT	NA	LS	1		
42	074020	WATER POLLUTION CONTROL	NA	LS	1		
43	120100	TRAFFIC CONTROL SYSTEM	NA	LS	1		
44	160101	CLEARING AND GRUBBING	NA	LS	1		
45	170101	DEVELOP WATER SUPPLY	NA	LS	1		
46	650014	18" REINFORCED CONCRETE PIPE	NA	LF	318		
47	650018	24" REINFORCED CONCRETE PIPE	NA	LF	291		
48	650026	36" REINFORCED CONCRETE PIPE	NA	LF	420		
49	017104A	JUNCTION STRUCTURE NO. 2	NA	EA	1		
50	017101A	MANHOLE NO. 1	NA	EA	3		
51	015101A	CONCRETE COLLAR	NA	EA	2		
52	000003	INCLIND TRASH RACK	NA	EA	1		
53	000003	8" SDR35 P.V.C. SEWER	NA	LF	985		
54	000003	STANDARD MANHOLE [SEWER]	NA	EA	2		
55	000003	END PLUG [SEWER]	NA	EA	2		
56	510535	MINOR CONCRETE (HEADWALL)	NA	CY	4		

ALT. 1 SUB-TOTAL: _____ \$ _____
 ITEMS 36-56 "WORDS"

* NOTE: See Page A3 for "Like Bid Items". Corrections will be applied if proposal item cost discrepancies are submitted.

PROPOSAL (Revised by Addendum #2)

Alternate 2 Bid Schedule (EMWD Option 1)

ITEM No.	ITEM CODE	ITEM	Like Bid Item*	UNIT	ESTIMATED QUANTITY	ITEM PRICE (IN FIGURES)	TOTAL (IN FIGURES)
57	000003	8" SDR35 PVC Sewer	NA	LF	1,945		
58	000003	12" C-900 PVC Water	NA	LF	3,385		
59	000003	12" Misc. Fittings	NA	EA	12		
60	000003	12" Gate Valve	NA	EA	6		

ALT. 2 SUB-TOTAL: _____ \$ _____
 ITEMS 57-60 "WORDS"

Alternate 3 Bid Schedule (EMWD Option 2)

ITEM No.	ITEM CODE	ITEM	Like Bid Item*	UNIT	ESTIMATED QUANTITY	ITEM PRICE (IN FIGURES)	TOTAL (IN FIGURES)
61	000003	18" Vitrified Clay Pipe (VCP) Sewer	NA	LF	1,945		
62	000003	18" C-905 PVC Water	NA	LF	3,385		
63	000003	18" Misc. Fittings	NA	EA	12		
64	000003	18" Gate Valve	NA	EA	6		

ALT. 3 SUB-TOTAL: _____ \$ _____
 ITEMS 61-64 "WORDS"

PROJECT TOTAL: _____ \$ _____
 ITEMS 1-64 "WORDS"

* NOTE: See Page A3 for "Like Bid Items". Corrections will be applied if proposal item cost discrepancies are submitted

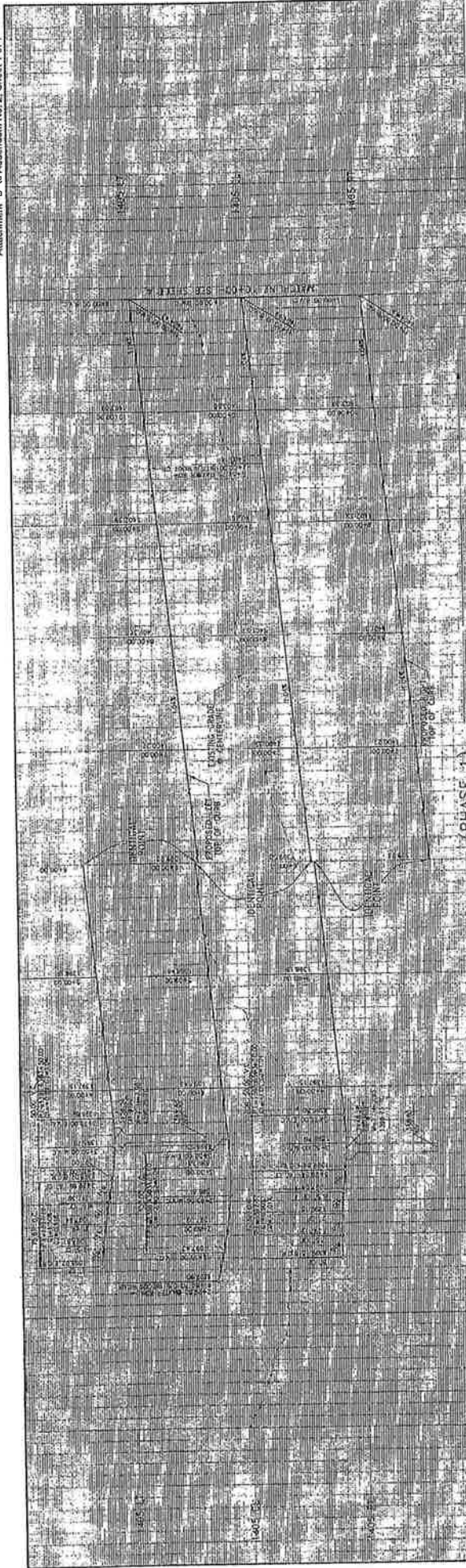

10 PROFILE SCALES: 1" = 4'
HORIZ: 1" = 40'
VERT: 1" = 4'

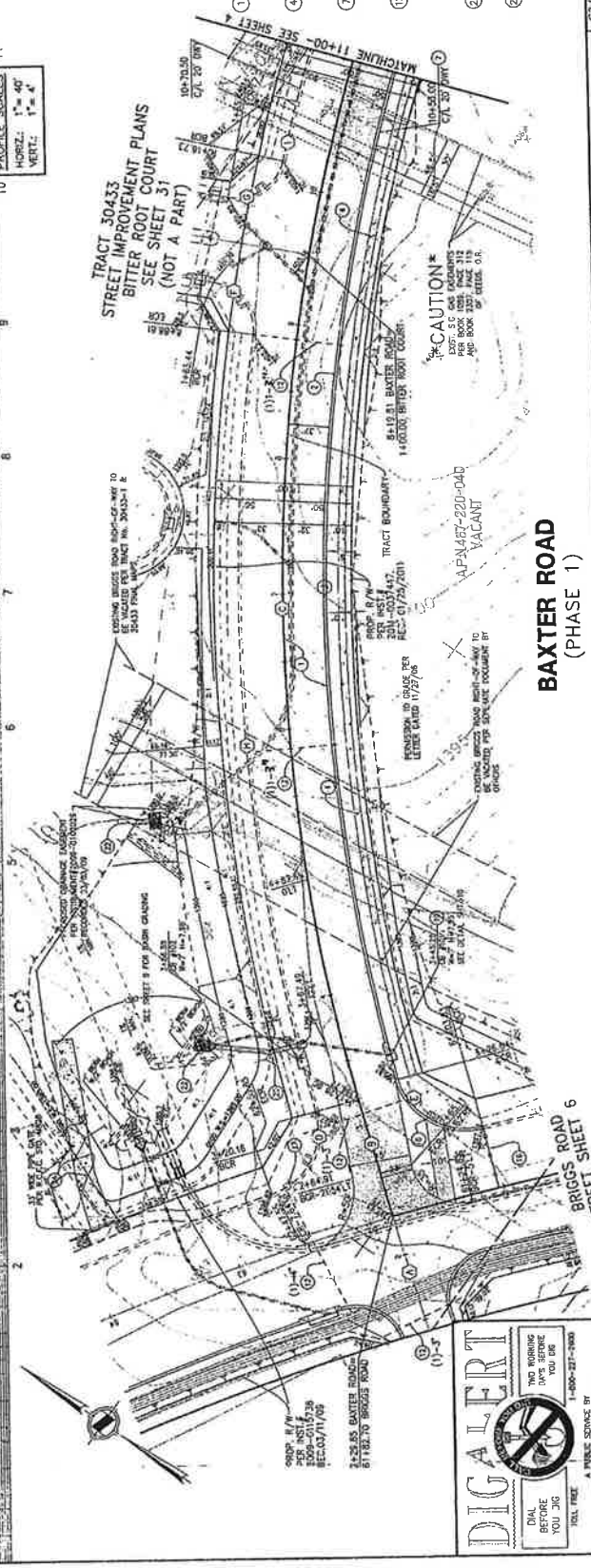

DATA TABLE

BEARING (SOUTH)	RAILS	LENGTH	TANGENT
①	S 89° 52' 44" W	88.75	87.44
②	S 89° 42' 22" W	140.00	70.72
③	S 10° 37' 30" W	50.00	75.87
④	S 89° 59' 21" W	50.00	77.32
⑤	S 89° 59' 21" W	35.07	53.36
⑥	S 87° 11' 54" W	35.07	53.36
⑦	S 87° 11' 54" W	35.07	53.36
⑧	S 87° 11' 54" W	35.07	53.36
⑨	S 87° 11' 54" W	143.00	90.65
⑩	S 27° 42' 10" W	432.00	65.17
⑪	S 27° 42' 10" W	1368.00	250.78
⑫	S 27° 42' 10" W	1368.00	250.78

- CONSTRUCTION NOTES
- CONSTRUCT STREET (AC OVER AS C. II) PER TYPICAL SECTION ON SHEET 2.
 - CONSTRUCT 6" CURB PER STANDARD K.C. 200 PER RIVERSIDE SPEC'S PER RIVERSIDE COUNTY STANDARD NO. 401, "THICKNESS".
 - CONSTRUCT ACCESS RAMP PER RIVERSIDE COUNTY STANDARD NO. 423, CASE A.
 - CONSTRUCT RESIDENTIAL DRIVEWAY PER R.C.T.D. STD. NO. 207.
 - CONSTRUCT SIDEWALK PER R.C.T.D. STD. NO. 311 (CASE PER DETAIL).
 - INSTALL CONDUIT, SIZE AND LOCATION PER PLAN.
 - CONSTRUCT BARBERCOTE PER R.C.T.D. STD. NO. 311 (CASE PER DETAIL).
 - CONSTRUCT 18" DRAIN PER DETAIL ON SHEET 11.
 - CONSTRUCT 18" DRAIN PER DETAIL ON SHEET 11.
 - CONSTRUCT 3" SLAG (OR AGGREGATE BASE) ACCESS ROAD OVER AIR COMPACTED MATR. PER DETAIL ON SHEET 11.



CX-0156 AS 4/28/20 BY: JNO. 000330 SHEET NO. 3
COUNTY OF RIVERSIDE
SCHEDULE "A"
MINIMUM STREET IMPROVEMENT PLANS
FROM STA. 2+128.00 TO 11+00
FOR BAXTER, WALLETT PARK, BRIGGS, AND BRIGGS DRIVE
DRAWN BY: JNO. 000330
DATE: 4/28/20
DESIGN: 1330A

HANSEN & ASSOCIATES
ENGINEERS
1100 W. MAIN STREET, SUITE 100
SAN ANTONIO, TEXAS 78205
PREPARED BY: JNO. 000330
DATE: 4/28/20
SCALE: 1" = 40'

COUNTY OF RIVERSIDE
TRANSPORTATION DEPARTMENT
APPROVED FOR APPROVAL
DATE: 4/30/20
BY: Alan Ford

REVISIONS

NO.	DATE	BY	REVISIONS

DIAL BEFORE YOU DIG
CALL 811
A PUBLIC SERVICE BY 1-800-281-7000
UNDERGROUND SERVICE ALERT

WORK CONTAINS WITHIN THESE PLANS SHALL NOT BE CONSIDERED AS A GUARANTEE OF THE ACCURACY OF THE INFORMATION PROVIDED HEREIN. THE USER OF THESE PLANS SHALL BE RESPONSIBLE FOR VERIFYING THE ACCURACY OF THE INFORMATION PROVIDED HEREIN. THE USER OF THESE PLANS SHALL BE RESPONSIBLE FOR OBTAINING ALL NECESSARY PERMITS AND APPROVALS FROM THE APPROPRIATE AGENCIES.



COUNTY OF RIVERSIDE TRANSPORTATION AND LAND MANAGEMENT AGENCY



Juan C. Perez, P.E., T.E.
Director of Transportation

Transportation Department

ADDENDUM NUMBER 3

Dated May 3, 2012

to the
Specifications and Contract Documents
for the construction of

Road Improvements on
Briggs Road and Baxter Road
North of the City of Murrieta

Project No. C2-0156
MS 4089, IP 060030

Bids Due: Wednesday, May 9, 2012; 2:00 PM
14th Street Transportation Annex
3525 14th Street; Riverside, CA 92501
(951) 955-6780

This Addendum is issued pursuant to the Instructions to Bidders, Item No. 8, of the Contract Documents for the reference project. This Addendum is issued as a supplement to the specification and special provisions for the referenced project. The revisions to the specifications shall become a part of the Contract Documents, and each bidder shall acknowledge receipt thereof on the Contractor's Proposal. Bidders are directed to sign this addendum as acknowledged, and attach the signed addendum to the contractor's submitted proposal.

Note: During the advertisement period of this project, this document and attachments (if any) are available upon request at the office of the Transportation Department, and are available as a free download at the Transportation Department's website:

www.rctlma.org/trans/con_bid_advertisements.html

MODIFICATIONS / CLARIFICATIONS TO SPECIAL PROVISIONS:

Item 1: Import Borrow, Surplus Material. Refer to Addendum 2, Item 3. Delete and replace the second paragraph of the item with the following:

"Additionally, any excess material shall conform to Special Provision Section 'Disposal of Excess Excavation or Materials' (page 49)."

MODIFICATIONS / CLARIFICATIONS TO PLANS:

Item 2: Street Improvement Plans (Sheet 1 of 13). Refer to Addendum 2, Item 7. Delete and replace the last paragraph of the item with the following:

“Delete the words ‘~~Import From Tract 30433 (BGR060320)~~’ and replace with ‘**Excess Material**’.”

Also, refer to item 1 of this addendum No. 3

Addendum No. 3
Road Improvements on Briggs Road and Baxter Road
Project No. C2-0156, MS 4089, IP 060030
May 3, 2012
Page 3 of 4

This addendum has been prepared under the direction of the following registered Civil Engineer(s):

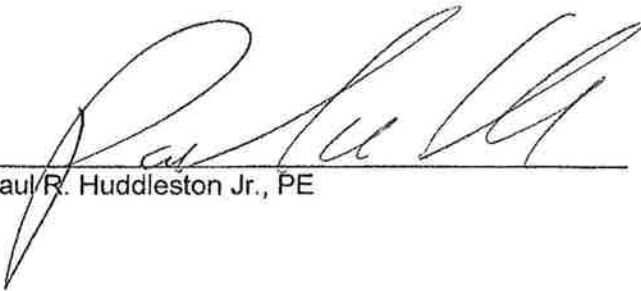

Paul R. Huddleston Jr., PE



Recommended by:

 5-3-12

Alan French, PE
County Project Manager

Concurrence:



Khalid Nasim, PE
Engineering Division Manager

Acknowledged: _____ **Date:** _____
(Contractor)

JRJ:jrj:sb

AGREEMENT

THIS AGREEMENT is entered into at Riverside, California as of the date set forth below is between County of Riverside hereafter called "County" and **Mamco, Inc.** hereafter called "Contractor".

W I T N E S S E T H

RECITALS:

1. Contractor has submitted to County his Contractor's Proposal for the construction of County Project, **Road Improvements on Briggs Road and Baxter Road, North of the City of Murrieta, Project No. C2-0156, MS 4089, IP 060030**, in strict accordance with the Contract Documents identified below and County has accepted said Proposal.
2. Contractor states that he has reexamined his Contractor's Proposal and found it to be correct, has ascertained that his subcontractors are properly licensed and possess the requisite skill and forces, has reexamined the site and Contract Documents and is of the opinion that he can presently do the work in accordance with the Contract Documents for the money set forth in his Proposal to be paid as provided in the Contract Documents.

AGREEMENT:

IT IS AGREED BY THE PARTIES AS FOLLOWS:

1. Contract Documents. The entire contract consists of the following: (a) The Agreement. (b) The Notice Inviting Bids. (c) The Instruction to Bidders. (d) The Contractor's Proposal. (e) The Bid Bond. (f) The Payment Bond. (g) The Performance Bond. (h) The General Conditions. (i) The Special Provisions. (j) The Standard Specifications of the State of California Department of Transportation edition of May 2006 as modified in other portions of the Contract Documents. (k) The Standard Plans of the Department of Transportation identified on the plans or in the Special Provisions. (l) The Plans. (m) Addenda (**three**). (n) The Determination of Prevailing Wage Rates for Public Work. (o) Any Change Orders issued. (p) Any additional or supplemental specifications, notice, instructions and drawings issued in accordance with the provisions of the Contract Documents. All of said Documents presently in existence are by this reference incorporated herein with like effect as if here set forth in full and upon the proper issuance of other documents they shall likewise be deemed incorporated. The Bid Bond is exonerated upon execution of this Agreement and the Payment Bond and Faithful Performance Bond.
2. The Work. Contractor shall do all things necessary to construct the work generally described in Recital No. 1 in accordance with the Contract Documents.

3. Liquidated Damages and Time of Completion. Attention is directed to the provisions in Section 8-1.06, "Time of Completion", and in Section 8-1.07, "Liquidated Damages", of the Standard Specifications and these Special Provisions.

The Contractor shall begin work within 15 days of the date stated within the written "Notice to Proceed".

The Contractor shall notify the Engineer, in writing, of his intent to begin work at least 72 hours before work is begun. The notice shall be delivered to the Transportation Department's Construction Engineer and shall specify the date the Contractor intends to start. If the project has more than one location of work, a separate notice shall be given for each location.

Should the Contractor begin work in advance of receiving a written "Notice to Proceed", any work performed by him in advance of the date stated in the "Notice to Proceed" shall be considered as having been done by him at his own risk and as a volunteer and subject to the following:

- (1) The Contractor shall, on commencing operations, take all precautions required for public safety and shall observe all the provisions in the Specifications and the Special Provisions.
 - (2) All work done according to the contract prior to the issuance of the "Notice to Proceed", will be considered authorized work and will be paid for as provided in the contract.
 - (3) The Contractor shall not be entitled to any additional compensation or an extension of time for any delay, hindrance or interference caused by or attributable to commencement of work prior to the issuance of the "Notice to Proceed".
4. Compensation. Contractor shall be paid in the manner set forth in the Contract Documents the amount of his Proposal as accepted by County, the above rates, subject to additions and deductions as provided in the Contract Documents. Said Proposal is on file in the Office of the Clerk of the Board of Supervisors of County.

**ROAD IMPROVEMENTS ON
BRIGGS ROAD AND BAXTER ROAD
NORTH OF THE CITY OF MURRIETA
PROJECT No. C2-0156, MS 4089, IP 060030**

AGREEMENT

BASE BID

ITEM No.	ITEM CODE	ITEM	LIKE BID ITEM	UNIT	ESTIMATED QUANTITY	ITEM PRICE (IN FIGURES)	TOTAL (IN FIGURES)
1	190101 (F)	ROADWAY EXCAVATION	Like 1	CY	144,220	4.10	591,302.00
2	260201	CLASS 2 AGGREGATE BASE	Like 2	CY	10,371	24.50	254,089.50
3	390130	HOT MIX ASPHALT	Like 3	TON	5,793	69.00	399,717.00
4	721007	ROCK SLOPE PROTECTION (1/4-TON, METHOD B)	Like 4	CY	46	90.00	4,140.00
5	840656	PAINT TRAFFIC STRIPE (2-COAT) [8"]	Like 5	LF	10,712	0.40	4,284.80
6	066102	DUST ABATEMENT	NA	LS	1	10,000.00	10,000.00
7	074020	WATER POLLUTION CONTROL	NA	LS	1	26,482.64	26,482.64
8	120100	TRAFFIC CONTROL SYSTEM	NA	LS	1	32,000.00	32,000.00
9	160101	CLEARING AND GRUBBING	NA	LS	1	10,000.00	10,000.00
10	170101	DEVELOP WATER SUPPLY	NA	LS	1	5,000.00	5,000.00
11	000001	ITEM DELETED BY ADDENDUM	-----	-----	-----	-----	-----
12	000001	ITEM DELETED BY ADDENDUM	-----	-----	-----	-----	-----
13	011507	COLD PLANE ASPHALT CONCRETE PAVEMENT (.12')	NA	SQFT	352	1.70	598.40
14	017304	MINOR CONCRETE (CURB AND GUTTER) (CRS 200)	NA	LF	1,495	12.00	17,940.00
15	017305	MINOR CONCRETE (CURB AND GUTTER) (CRS 201)	NA	LF	3,200	12.50	40,000.00
16	017306	MINOR CONCRETE (CURB RAMP) (CRS 403)	NA	EA	7	1,350.00	9,450.00
17	731521	MINOR CONCRETE SIDEWALK (CRS401)	NA	SQFT	27,534	2.25	61,951.50
18	731521A	MINOR CONCRETE SIDEWALK (CRS404)	NA	SQFT	4,459	2.50	11,147.50
19	017310	MINOR CONCRETE (DRIVE APPROACH)	NA	SQFT	2,592	4.00	10,368.00
20	017302	MINOR CONCRETE (CROSS-GUTTER) (CRS 209)	NA	SQFT	1,399	4.00	5,596.00
21	120120A	BARRICADE (CRS 810)	NA	LF	108	75.00	8,100.00
22	510501	MINOR CONCRETE [V-DITCH]	NA	LF	722	18.00	12,996.00
23	510520	MINOR CONCRETE (CONCRETE DRAIN)[DOWN-DRAIN]	NA	LF	54	50.00	2,700.00

BASE BID (CONTINUED)

ITEM No.	ITEM CODE	ITEM	LIKE BID ITEM	UNIT	ESTIMATED QUANTITY	ITEM PRICE (IN FIGURES)	TOTAL (IN FIGURES)
24	840666	PAINT PAVEMENT MARKING (2-COAT)	NA	SQFT	1,316	2.60	3,421.60
25	566011	ROADSIDE SIGN - ONE POST	NA	EA	70	235.00	16,450.00
26	820108	DELINEATOR (CLASS 2) [Type F]	NA	EA	17	45.00	765.00
27	840656	PAINT TRAFFIC STRIPE (2-COAT) [4"]	NA	LF	4,712	0.33	1,554.96
28	840656	PAINT TRAFFIC STRIPE (2-COAT) [12"]	NA	LF	454	2.25	1,021.50
29	000003	WATER SYSTEM IMPROVEMENTS	NA	LS	1	200,000.00	200,000.00
30	000003	SEWER SYSTEM IMPROVEMENTS	NA	LS	1	57,000.00	57,000.00
31	000003	STORM DRAIN SYSTEM IMPROVEMENTS	NA	LS	1	440,000.00	440,000.00
32	015601	STREET NAME SIGN (CRS 816)	NA	EA	3	400.00	1,200.00
33	190161	ROCK EXCAVATION	NA	FA	1	20,000.00	20,000.00
34	000003	MISCELLANEOUS DIRECTED WORK	NA	FA	1	80,000.00	80,000.00
35	019901	DE-MOBILIZATION	NA	LS	1	100,000.00	100,000.00

SUBTOTAL, BASE BID, ITEMS 1-35:

Two million, four hundred thirty nine thousand, two hundred seventy six dollars and forty cents \$2,439,276.40
 "WORDS"

ALTERNATE 1 BID SCHEDULE (Riverside Mitland 03 LLC a subsidiary of Brookfield LLC)

ITEM No.	ITEM CODE	ITEM	LIKE BID ITEM	UNIT	ESTIMATED QUANTITY	ITEM PRICE (IN FIGURES)	TOTAL (IN FIGURES)
36	190101(F)	ROADWAY EXCAVATION	Like 1	CY	247	4.10	1,012.70
37	260201	CLASS 2 AGGREGATE BASE	Like 2	CY	781	24.50	19,134.50
38	390130	HOT MIX ASPHALT	Like 3	TON	432	69.00	29,808.00
39	721007	ROCK SLOPE PROTECTION (1/4-TON, METHOD B)	Like 4	CY	22	90.00	1,980.00
40	840656	PAINT TRAFFIC STRIPE (2-COAT) [8"]	Like 5	LF	2,066	0.40	826.40
41	066102	DUST ABATEMENT	NA	LS	1	250.00	250.00
42	074020	WATER POLLUTION CONTROL	NA	LS	1	1,000.00	1,000.00
43	120100	TRAFFIC CONTROL SYSTEM	NA	LS	1	200.00	200.00
44	160101	CLEARING AND GRUBBING	NA	LS	1	300.00	300.00
45	170101	DEVELOP WATER SUPPLY	NA	LS	1	200.00	200.00
46	650014	18" REINFORCED CONCRETE PIPE	NA	LF	318	69.00	21,942.00
47	650018	24" REINFORCED CONCRETE PIPE	NA	LF	291	80.00	23,280.00
48	650026	36" REINFORCED CONCRETE PIPE	NA	LF	420	120.00	50,400.00
49	017104A	JUNCTION STRUCTURE NO. 2	NA	EA	1	3,000.00	3,000.00
50	017101A	MANHOLE NO. 1	NA	EA	3	3,100.00	9,300.00
51	015101A	CONCRETE COLLAR	NA	EA	2	500.00	1,000.00
52	000003	INCLIND TRASH RACK	NA	EA	1	3,300.00	3,300.00
53	000003	8" SDR35 P.V.C. SEWER	NA	LF	985	45.00	44,325.00
54	000003	STANDARD MANHOLE [SEWER]	NA	EA	2	3,900.00	7,800.00
55	000003	END PLUG [SEWER]	NA	EA	2	150.00	300.00
56	510535	MINOR CONCRETE (HEADWALL)	NA	CY	4	660.00	2,640.00

SUBTOTAL, ALTERNATE 1 BID, ITEMS 36-56:

Two hundred twenty one thousand, nine hundred ninety eight dollar and sixty cents. \$ 221,998.60
 " Words"

ALTERNATE 2 BID SCHEDULE (EMWD OPTION 1)

ITEM No.	ITEM CODE	ITEM	LIKE BID ITEM	UNIT	ESTIMATED QUANTITY	ITEM PRICE (IN FIGURES)	TOTAL (IN FIGURES)
57	000003	8" SDR35 PVC SEWER	NA	LF	1,945	0.00	0.00
58	000003	12" C-900 PVC WATER	NA	LF	3,385	0.00	0.00
59	000003	12" MISC. FITTINGS (WATER)	NA	EA	12	0.00	0.00
60	000003	12" GATE VALVE	NA	EA	6	0.00	0.00

Note: Alternate 2 Bid Schedule is not selected for award.

ALTERNATE 3 BID SCHEDULE (EMWD OPTION 2)

ITEM No.	ITEM CODE	ITEM	LIKE BID ITEM	UNIT	ESTIMATED QUANTITY	ITEM PRICE (IN FIGURES)	TOTAL (IN FIGURES)
61	000003	18" VITRIFIED CLAY PIPE (VCP) SEWER	NA	LF	1,945	85.00	165,325.00
62	000003	18" C-905 PVC WATER	NA	LF	3,385	80.00	270,800.00
63	000003	18" MISC. FITTINGS (WATER)	NA	EA	12	750.00	9,000.00
64	000003	18" GATE VALVE	NA	EA	6	10,000.00	60,000.00

SUBTOTAL, ALTERNATE 3 BID, ITEMS 61-64:

Five hundred five thousand, one hundred twenty five dollar and zero cents. \$ 505,125.00
 " Words"

PROJECT TOTAL, ITEMS 1-64:

Three million, one hundred sixty six thousand, four hundred dollars and zero cents. \$ 3,166,400.00
 " Words"

IN WITNESS WHEREOF the parties hereto have executed this agreement as of the date set forth below.

COUNTY OF RIVERSIDE

MAMCO, INC.

BY _____
Chairman, Board of Supervisors

BY _____

Dated _____

TITLE: _____
(If Corporation, Affix Seal)

ATTEST:

ATTEST:

Kecia Harper-Ihem, Clerk of the Board

BY _____
Deputy

TITLE: _____

Licensed in accordance with an act providing for the registration of Contractors,

License No. _____

Federal Employer Identification Number:

BY _____
"County"
(Seal)

"Corporation"
(Seal)

FORM APPROVED COUNTY COUNSEL
BY: MARSHAL L. VICTOR DATE: 5/24/12

PERFORMANCE BOND

Recitals:

1. **Mamco, Inc.**, (Contractor) has entered into an Agreement with COUNTY OF RIVERSIDE (County) for construction of public work known as **Road Improvements on Briggs Road and Baxter Road, North of the City of Murrieta, Project No. C2-0156, MS 4089, IP 060030.**

2. _____, a _____ corporation (Surety), is the Surety under this Bond.

Agreement:

We, Contractor, as Principal, and Surety, as Surety, jointly and severally agree, state, and are bound unto County, as obligee, as follows:

1. The amount of the obligation of this Bond is 100% of the estimated contract price for the Project of \$ **3,166,400.00 (Three million, one hundred sixty six thousand, four hundred dollars and zero cents)**, and inures to the benefit of County.

2. This Bond is exonerated by Contractor doing all things to be kept and performed by it in strict conformance with the Contract Documents for the Project, otherwise it remains in full force and effect for the recovery of loss, damage and expense of County resulting from failure of Contractor to so act. All of said Contract Documents are incorporated herein.

3. This obligation is binding on our successors and assigns.

4. For value received, Surety stipulates and agrees that no change, time extension, prepayment to Contractor, alteration or addition to the terms and requirements of the Contract Documents or the work to be performed thereunder shall affect its obligations hereunder and waives notice as to such matters, except the total contract price cannot be increased by more than 10% without approval of Surety.

THIS BOND is executed as of _____.

By _____

By _____

By _____

Type Name _____

Its Attorney in Fact
"Surety"

Title _____

"Contractor"

(Corporate Seal)

(Corporate Seal)

NOTE: This Bond must be executed by both parties with corporate seal affixed. All signatures must be acknowledged. (Attach acknowledgements).

PAYMENT BOND

(Public Work - Civil Code 3247 et seq.)

The makers of this Bond are **Mamco, Inc.**, as Principal and Original Contractor and _____, a corporation, authorized to issue Surety Bonds in California, as Surety, and this Bond is issued in conjunction with that certain public works contract to be executed between Principal and **COUNTY OF RIVERSIDE** a public entity, as Owner, for **\$ 3,166,400.00 (Three million, one hundred sixty six thousand, four hundred dollars and zero cents)**, the total amount payable. THE AMOUNT OF THIS BOND IS ONE HUNDRED PERCENT OF SAID SUM. Said contract is for public work generally consisting of **Road Improvements on Briggs Road and Baxter Road, North of the City of Murrieta, Project No. C2-0156, MS 4089, IP 0600302.**

The beneficiaries of this Bond are as is stated in 3248 of the Civil Code and requirements and conditions of this Bond are as is set forth in 3248, 3249, 3250 and 3252 of said code. Without notice, Surety consents to extension of time for performance, change in requirements, amount of compensation, or prepayment under said contract.

DATED: _____

Original Contractor - Principal

Surety

By _____

By _____
Its Attorney In Fact

Title _____

(Corporate Seal)

(If corporation, affix seal)

(Corporate Seal)

STATE OF CALIFORNIA
COUNTY OF _____

} ss. SURETY'S ACKNOWLEDGEMENT

On _____ before me, _____ personally appeared, _____, known to me, or proved to me on the basis of satisfactory evidence, to be the person whose name is subscribed to the within instrument and acknowledged to me that he/she executed the same in his/her authorized capacities, and that by his/her signature on the instrument the person, or the entity upon behalf of which the person acted, executed the instrument.

WITNESS my hand and official seal.

Signature of Notary Public

Notary Public (Seal)

NOTE: This Bond must be executed by both parties with corporate seal affixed. All signatures must be acknowledged. (Attach acknowledgements).