

**SUBMITTAL TO THE BOARD OF SUPERVISORS  
COUNTY OF RIVERSIDE, STATE OF CALIFORNIA**

434



**FROM:** TLMA - Transportation Department

**SUBMITTAL DATE:**  
July 5, 2012

**SUBJECT:** Contract Change Orders No. 8 and No. 12 - between the County of Riverside and Griffith Company for the replacement of Van Buren Boulevard Bridge over Santa Ana River, Riverside Area

**RECOMMENDED MOTION:**

- 1) That the Board execute and authorize the Transportation Department to issue Contract Change Orders No. 8 and No. 12 with Griffith Company.
- 2) That the Board increase the Authority of the Director of Transportation to execute cumulative change orders on the Van Buren Blvd Bridge Project from 10% of the original contract amount as allowed in Board Resolution 2011-015 to 15% of the original contract amount.

Patricia Romo  
Deputy Director of Transportation

Juan C. Perez  
Director of Transportation

Departmental Concurrence

dj  
(Continued On Attached Page)

<b>FINANCIAL DATA</b>	Current F.Y. Total Cost:	\$ 833,568	In Current Year Budget:	Yes
	Current F.Y. Net County Cost:	\$ 0	Budget Adjustment:	No
	Annual Net County Cost:	\$ 0	For Fiscal Year:	2011/2012

<b>SOURCE OF FUNDS:</b> Measure A / Western (48.2%), Jurupa Community Services District (51.8%) There are no general funds used in this project	<b>Positions To Be Deleted Per A-30</b>	<input type="checkbox"/>
	<b>Requires 4/5 Vote</b>	<input checked="" type="checkbox"/>

**C.E.O. RECOMMENDATION:**

APPROVE

BY:

Tina Grande

County Executive Office Signature

Dept't Recomm.:  Policy  
 Per Exec. Ofc.:  Policy  
 Consent:  Consent

Prev. Agn. Ref. 3.38 of 5/19/09 | District: 2/2 | Agenda Number:

ATTACHMENTS FILED  
WITH THE CLERK OF THE BOARD

3.36

The Honorable Board of Supervisors

RE: Contract Change Orders No. 8 and No. 12 - between the County of Riverside and Griffith Company for the replacement of Van Buren Boulevard Bridge over Santa Ana River, Riverside Area

July 5, 2012

Page 2 of 2

**BACKGROUND:** On May 19, 2009 (agenda item 3.38) the Board entered into an agreement with Griffith Company of Santa Ana, CA for the bridge replacement and the approach roadway improvements on Van Buren Boulevard at the Santa Ana River. The authorized amount of the contract was \$34,834,325.

Contract Change Order No. 8 in the amount of \$401,782.09 became necessary in order to compensate the Contractor for constructing the roadway improvements along the west side of Van Buren Boulevard between Clay Street and the new Van Buren Bridge. Contract Change Order No. 12 in the amount of \$431,785.54 became necessary in order to compensate the Contractor for constructing the JCSD sewer force extension from the new Van Buren bridge south abutment to Jurupa Avenue. This work also includes the installation of approximately 120 lineal feet of 12" Ductile Iron Pipe (DIP) at the intersection of Clay Street and Van Buren Boulevard.

The additional extra work will facilitate construction and minimize disruption to the public in the future. The change orders, in the amount of \$401,782.09 and \$431,785.54 respectively, combine for an amount of \$833,567.63 (2.4% of the original contract amount), each exceeding the Director of Transportation's approval authority under Board Resolution 2011-015.

**JUSTIFICATION:**

Contract Change Order No. 8 became necessary in order to construct the ultimate street improvements north of Van Buren Bridge to Clay Street in accordance with the City of Riverside/ County of Riverside Animal Shelter plans (MS4173). The proposed street improvements from Clay St. to the Van Buren bridge project limits include providing pavement widening, curb and gutter, sidewalks, catch basin, including electrical conduit and pull boxes for future street lights. This work was intended to be constructed as part of the Animal Shelter improvement project performed by the County's Economic Development Agency. These ultimate street improvements could not be performed by the Animal Shelter contractor because the improvements connected to the new and not yet constructed Van Buren Bridge alignment. This change will be funded with Measure A funds.

Contract Change Order No. 12 became necessary to construct the a new sewer force main extension through the project site in accordance with Jurupa Community Services District plans and standards. These changes were incorporated by JCSD in anticipation of the future sewer force main connection to the City of Riverside treatment plant. The inclusion of the installation of the 24" sewer force main extension and 12" DIP in conjunction with the bridge project construction protects the community's investment in the project by eliminating future construction impacts to that portion of Van Buren Blvd. There will be less impact to the public now and in the future since the construction of the Van Buren Bridge project is in progress. The amount of Contract Change Order No. 12 is funded entirely by JCSD per the attached commitment letter from JCSD.

The inclusion of additional work in this contract is a benefit to the public and surrounding communities, the Department considers that increasing the Director of Transportation's authority for cumulative change orders from 10% to 15% to take into account the financial impacts of these two change orders, is warranted and in the best interest of the public.

LETTER OF TRANSMITTAL

**Local Agency: County of Riverside  
Transportation Department**

**DATE: November 10, 2011  
File: Van Buren Bridge Project  
W.O. No.: B0-0801 ~~R~~ B8-0624  
C.C.O.: 8**

**TO: Juan C. Perez**

**From: Hugh Smith**

**\$401,782.09 (1.76% of the original contract amount of \$22,875,573.00)**

This Contract Change Order No. 8 became necessary to construct the ultimate improvements north of the Van Buren Blvd. Bridges to Clay St. in accordance with the City of Riverside / County of Riverside Animal Shelter plans (MS4173). No HBP funds will be used for the improvements.

The work is included in the improvement plans of the Animal Shelter to be constructed by the County's Economic Development Agency. However, the improvements could not be constructed until the completion of the Van Buren Bridge project because the Animal Shelter street plan was designed to connect and match the improvement of the bridges.

The ultimate improvement of Van Buren Blvd. from Clay St. to the limits of the bridge improvement in accordance with the Animal Shelter Plans include increasing traffic lanes, which is not a part of the bridge project plans, but is performed in conjunction with the bridge project to eliminate traffic lane transitions to the existing bridges.

The inclusion of the ultimate roadway improvement at this section of Van Buren Blvd. with the bridge project also alleviates the inconvenience to the travelling public by reduced variation of traffic patterns for passage thru the bridge during construction by both the Animal Shelter and the bridges.

This Contract Change Order is tracked separately for financial purposes.

The amount of this Change Order is \$401,782.09 and the accumulation of all Contract Change Orders thus far, including this one, is \$1,009,186.54.

Previous Contract Change Order Amounts Approved:

See C.C.O. History  
(Attached)

\$607,404.45

**File: Van Buren Bridge Project**  
**W.O. No.: B0-0801**  
**C.C.O. No. 8**  
**Page 2**

This Contract Change Order was discussed with Mr. Tayfun Saglam and he gave his concurrence to this change.

Adjustment of Time: Deferred Days

**ESTIMATE OF COST**

Items	
Force Account	
Agreed Price	\$401,782.09
Adjustment	
	<hr/>
<b>TOTAL</b>	<b>\$401,782.09</b>

---

**Hugh Smith**  
**Construction Engineer**

C. C. O. Category

Agency Mandated	√
Anticipated Force Account	
Change in Field Conditions	
Design Omission	
ROW Obligations	
Upgrades / Benefits	✓
Utilities	✓



COUNTY OF RIVERSIDE  
TRANSPORTATION DEPARTMENT

SHEET 1 OF 2 SHEETS

Contract Change Order No. 8

CONTRACT: Van Buren Bridge Project WORK ORDER NO. B0-0801

TO: Griffith Company CONTRACTOR: YOU ARE HEREBY DIRECTED TO MAKE THE HEREIN DESCRIBED CHANGES FROM THE PLANS AND SPECIFICATIONS OR DO THE FOLLOWING DESCRIBED WORK NOT INCLUDED IN THE PLANS AND SPECIFICATIONS ON THIS CONTRACT.

Description of work to be done, estimate of quantities and prices to be paid. Segregated between additional work at contract price, agreed price and force account. Unless otherwise stated, rates for rental of equipment cover only such time as equipment is actually used and no allowance will be made for idle time.

**Estimate of Extra Work at Agreed Unit Price:**

As directed by the Engineer and in accordance with the applicable sections of the Special Provisions; compensate the Contractor to construct the ultimate roadway improvements on Van Buren Blvd. between Clay St. and the Van Buren Bridges in accordance with the City of Riverside / County of Riverside Animal Shelter Street Improvement Plans. The unit prices include; but not limited to, furnishing labor, equipment, materials and all other incidentals to complete the work in place as follows:

- Item A: Remove Rip Rap      1 LS @ \$1,000.00      =      \$ 1,000.00
- Item B: Remove AC Dike      550 LF @ \$4.66 / LF      =      \$ 2,563.00
- Item C (F): Import Borrow      4,000 CY @ \$30.85 / CY      =      \$ 123,400.00  
(Final Pay Qty)
- Item D: Hot Mix Asphalt      762 TON @ \$97.05 / TON      =      \$73,952.10
- Item E: Class 2 Aggregate Base      810 CY @ \$47.60 / CY      =      \$38,556.00
- Item F: Concrete Turf Pavers      360 SF @ \$36.00 / SF      =      \$12,960.00
- Item G: Minor Concrete  
(Curb and Gutter) (CRS 201)      730 LF @ \$24.90 / LF      =      \$18,177.00
- Item H: Minor Concrete  
(Type "D" Curb) (CRS 204)      520 LF @ \$21.40 / LF      =      \$11,128.00
- Item I: Minor Concrete Driveway  
(CRS 207)      176 SF @ \$20.79 / SF      =      \$ 3,659.04
- Item J: Minor Concrete Driveway  
(CRS 207A Mod.)      308 SF @ \$20.79 / SF      =      \$ 6,403.32
- Item K: Minor Concrete Sidewalk  
(CRS 400 & 404)      7,080 SF @ \$6.00 / SF      =      \$42,480.00
- Item L: Sidewalk Only Type 26 Barrier No Conduit  
(Caltrans STD B11-54)      220 LF @ 153.74 / LF      =      \$33,822.80
- Item M: Catch Basin (CRS 300) & Gutter  
Depression Case C (CRS 312) 1 EA @ \$9,500.00 / EA      =      \$ 9,500.00



**COUNTY OF RIVERSIDE  
TRANSPORTATION DEPARTMENT**

SHEET 2 OF 2 SHEETS

Contract Change Order No. 8

CONTRACT: **Van Buren Bridge Project**

WORK ORDER NO. **B0-0801**

TO: **Griffith Company** CONTRACTOR: YOU ARE HEREBY DIRECTED TO MAKE THE HEREIN DESCRIBED CHANGES FROM THE PLANS AND SPECIFICATIONS OR DO THE FOLLOWING DESCRIBED WORK NOT INCLUDED IN THE PLANS AND SPECIFICATIONS ON THIS CONTRACT.

Description of work to be done, estimate of quantities and prices to be paid. Segregated between additional work at contract price, agreed price and force account. Unless otherwise stated, rates for rental of equipment cover only such time as equipment is actually used and no allowance will be made for idle time.

- Item N: Install Paint Traffic Stripe 1200 LF @ \$0.42 / LF = \$ 504.00  
(2-Coat)
- Item O: Thermoplastic Markings 92 SF @ \$3.18 / SF = \$ 292.56
- Item P: Edison Hand Hole 5 EA @ \$367.50 / EA = \$ 1,837.50  
(Caltrans Type 5 "EDISON" on Lid) (Street Lighting)
- Item Q: 3" PVC (Sch 80) Conduit 1000 LF @ \$17.85 / LF = \$17,850.00  
(Street Lighting)
- Item R: 1½" PVC (Sch 80) Conduit 100 LF @ \$10.50 / LF = \$ 1,050.00  
(Street Lighting)
- Item S: 1/8" Mule Tape (Street Lighting) 1200 LF @ \$2.10 / LF = \$ 2,520.00
- Item T: Pull Box Sweeps (Street Lighting) 1 LS @ \$126.77 / LS = \$ 126.77

There will be no adjustment in the Agreed Contract Unit Prices for the above items due to increases or decreases in quantity in excess of 25% of the Engineer's Estimate by reason of this Change Order. Payment will be made for the actual quantity of the items (except Item C – Import Borrow)

Estimated Cost: Decrease \$ \_\_\_\_\_ Increase \$ **401,782.09**

WE, the undersigned contractor, have given careful consideration to the change proposed and hereby agree that we will provide all equipment, furnish all materials, except as may otherwise be noted above, and perform all services necessary for the work above specified, and will accept as full payment therefor the prices shown above.

By reason of this proposed change Deferred days adjustment of time will be allowed.

Accepted [Signature] 11/8/11 Date

**Griffith Company**

[Signature] 9/28/11  
Approval Recommended Date

[Signature] 6/21/12  
Approval Recommended Date  
**Juan C. Perez**, Director of Transportation

NOTE: This change order is not effective until approved by County. If the Contractor does not sign acceptance of this order, his attention is directed to the requirements of the specifications as to proceeding with the ordered work and filing a written protest with the time therein specified.

Approved \_\_\_\_\_ Date  
**Chairman**, Riverside County Board of Supervisors



# COUNTY OF RIVERSIDE, CALIFORNIA STREET IMPROVEMENT PLANS VAN BUREN BOULEVARD

## NOTICE TO CONTRACTOR:

THE PROPOSED IMPROVEMENTS TO VAN BUREN BOULEVARD (AS SHOWN ON THESE PLANS) ARE TO BE CONSTRUCTED IN ACCORDANCE WITH THE STANDARD SPECIFICATIONS FOR HIGHWAY CONSTRUCTION, LATEST EDITION, AS ADOPTED BY THE BOARD OF SUPERVISORS OF THE COUNTY OF RIVERSIDE, CALIFORNIA. THE CONTRACTOR SHALL BE RESPONSIBLE FOR OBTAINING ALL NECESSARY PERMITS FROM THE COUNTY OF RIVERSIDE, CALIFORNIA, AND THE CITY OF VAN BUREN, CALIFORNIA. THE CONTRACTOR SHALL BE RESPONSIBLE FOR OBTAINING ALL NECESSARY PERMITS FROM THE COUNTY OF RIVERSIDE, CALIFORNIA, AND THE CITY OF VAN BUREN, CALIFORNIA. THE CONTRACTOR SHALL BE RESPONSIBLE FOR OBTAINING ALL NECESSARY PERMITS FROM THE COUNTY OF RIVERSIDE, CALIFORNIA, AND THE CITY OF VAN BUREN, CALIFORNIA.

## GENERAL NOTES:

1. THE CONTRACTOR SHALL BE RESPONSIBLE FOR OBTAINING ALL NECESSARY PERMITS FROM THE COUNTY OF RIVERSIDE, CALIFORNIA, AND THE CITY OF VAN BUREN, CALIFORNIA.
2. THE CONTRACTOR SHALL BE RESPONSIBLE FOR OBTAINING ALL NECESSARY PERMITS FROM THE COUNTY OF RIVERSIDE, CALIFORNIA, AND THE CITY OF VAN BUREN, CALIFORNIA.
3. THE CONTRACTOR SHALL BE RESPONSIBLE FOR OBTAINING ALL NECESSARY PERMITS FROM THE COUNTY OF RIVERSIDE, CALIFORNIA, AND THE CITY OF VAN BUREN, CALIFORNIA.
4. THE CONTRACTOR SHALL BE RESPONSIBLE FOR OBTAINING ALL NECESSARY PERMITS FROM THE COUNTY OF RIVERSIDE, CALIFORNIA, AND THE CITY OF VAN BUREN, CALIFORNIA.
5. THE CONTRACTOR SHALL BE RESPONSIBLE FOR OBTAINING ALL NECESSARY PERMITS FROM THE COUNTY OF RIVERSIDE, CALIFORNIA, AND THE CITY OF VAN BUREN, CALIFORNIA.
6. THE CONTRACTOR SHALL BE RESPONSIBLE FOR OBTAINING ALL NECESSARY PERMITS FROM THE COUNTY OF RIVERSIDE, CALIFORNIA, AND THE CITY OF VAN BUREN, CALIFORNIA.
7. THE CONTRACTOR SHALL BE RESPONSIBLE FOR OBTAINING ALL NECESSARY PERMITS FROM THE COUNTY OF RIVERSIDE, CALIFORNIA, AND THE CITY OF VAN BUREN, CALIFORNIA.
8. THE CONTRACTOR SHALL BE RESPONSIBLE FOR OBTAINING ALL NECESSARY PERMITS FROM THE COUNTY OF RIVERSIDE, CALIFORNIA, AND THE CITY OF VAN BUREN, CALIFORNIA.
9. THE CONTRACTOR SHALL BE RESPONSIBLE FOR OBTAINING ALL NECESSARY PERMITS FROM THE COUNTY OF RIVERSIDE, CALIFORNIA, AND THE CITY OF VAN BUREN, CALIFORNIA.
10. THE CONTRACTOR SHALL BE RESPONSIBLE FOR OBTAINING ALL NECESSARY PERMITS FROM THE COUNTY OF RIVERSIDE, CALIFORNIA, AND THE CITY OF VAN BUREN, CALIFORNIA.

## INDEX OF SHEETS:

DESCRIPTION	SHEET NO.
TITLE SHEET	1
PLAN AND PROFILES	2, 3, 4, 5, 6, 10
CROSS SECTIONS	2-12
STORM DRAIN PLAN & PROFILE	14
CHIEF METEOR PLAN	15
MODIFICATION SYMBOL PLAN	16
(VAN BUREN BLVD. & CLAY STREET)	1 OF 1

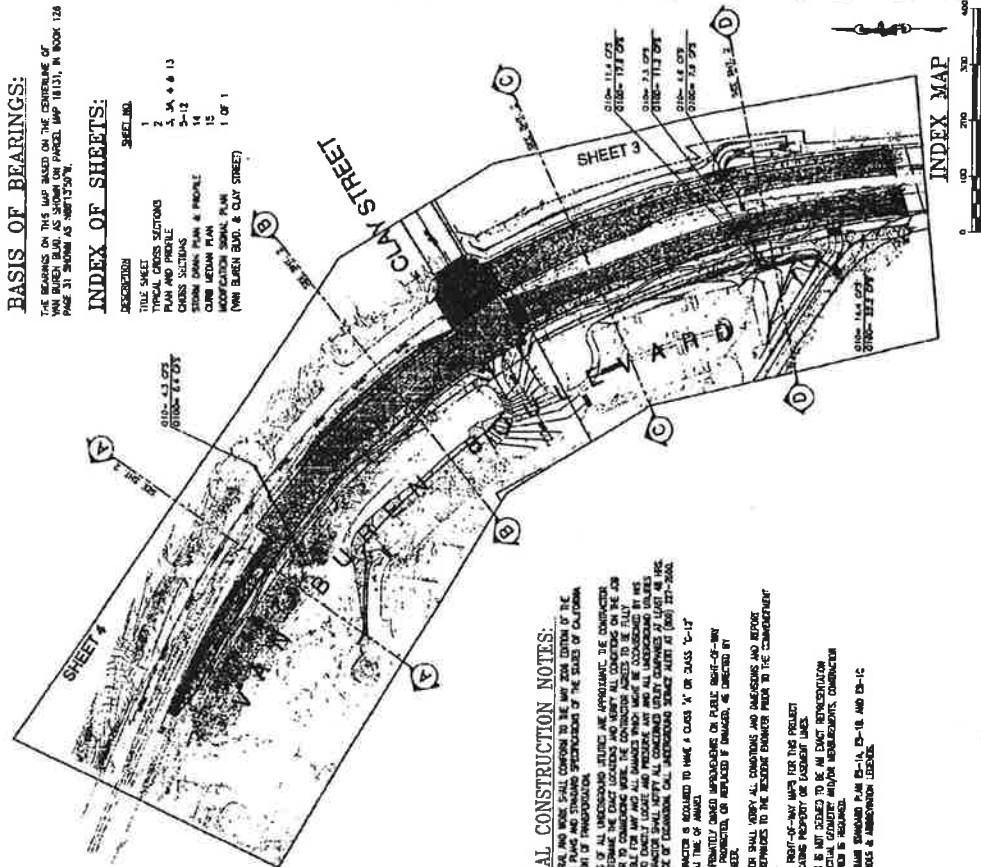

## GENERAL CONSTRUCTION NOTES:

1. ALL MATERIALS AND WORK SHALL CONFORM TO THE BEST PRACTICES OF THE COUNTY OF RIVERSIDE, CALIFORNIA.
2. THE CONTRACTOR SHALL BE RESPONSIBLE FOR OBTAINING ALL NECESSARY PERMITS FROM THE COUNTY OF RIVERSIDE, CALIFORNIA, AND THE CITY OF VAN BUREN, CALIFORNIA.
3. THE CONTRACTOR SHALL BE RESPONSIBLE FOR OBTAINING ALL NECESSARY PERMITS FROM THE COUNTY OF RIVERSIDE, CALIFORNIA, AND THE CITY OF VAN BUREN, CALIFORNIA.
4. THE CONTRACTOR SHALL BE RESPONSIBLE FOR OBTAINING ALL NECESSARY PERMITS FROM THE COUNTY OF RIVERSIDE, CALIFORNIA, AND THE CITY OF VAN BUREN, CALIFORNIA.
5. THE CONTRACTOR SHALL BE RESPONSIBLE FOR OBTAINING ALL NECESSARY PERMITS FROM THE COUNTY OF RIVERSIDE, CALIFORNIA, AND THE CITY OF VAN BUREN, CALIFORNIA.
6. THE CONTRACTOR SHALL BE RESPONSIBLE FOR OBTAINING ALL NECESSARY PERMITS FROM THE COUNTY OF RIVERSIDE, CALIFORNIA, AND THE CITY OF VAN BUREN, CALIFORNIA.
7. THE CONTRACTOR SHALL BE RESPONSIBLE FOR OBTAINING ALL NECESSARY PERMITS FROM THE COUNTY OF RIVERSIDE, CALIFORNIA, AND THE CITY OF VAN BUREN, CALIFORNIA.
8. THE CONTRACTOR SHALL BE RESPONSIBLE FOR OBTAINING ALL NECESSARY PERMITS FROM THE COUNTY OF RIVERSIDE, CALIFORNIA, AND THE CITY OF VAN BUREN, CALIFORNIA.
9. THE CONTRACTOR SHALL BE RESPONSIBLE FOR OBTAINING ALL NECESSARY PERMITS FROM THE COUNTY OF RIVERSIDE, CALIFORNIA, AND THE CITY OF VAN BUREN, CALIFORNIA.
10. THE CONTRACTOR SHALL BE RESPONSIBLE FOR OBTAINING ALL NECESSARY PERMITS FROM THE COUNTY OF RIVERSIDE, CALIFORNIA, AND THE CITY OF VAN BUREN, CALIFORNIA.

## STORM DRAIN CONSTRUCTION NOTES & QUANTITY ESTIMATE

NO.	DESCRIPTION	QUANTITY	ESTIMATE
1	INSTALL 36" DIA. 2' DIA. x 2000'	64	LF
2	INSTALL 36" DIA. 2' DIA. x 2000'	2	EA
3	INSTALL 36" DIA. 2' DIA. x 2000'	1	EA
4	INSTALL 36" DIA. 2' DIA. x 2000'	200	YD
5	INSTALL 36" DIA. 2' DIA. x 2000'	28	LF
6	INSTALL 36" DIA. 2' DIA. x 2000'	1	EA
7	INSTALL 36" DIA. 2' DIA. x 2000'	1	EA
8	INSTALL 36" DIA. 2' DIA. x 2000'	25	YD
9	INSTALL 36" DIA. 2' DIA. x 2000'	25	YD
10	INSTALL 36" DIA. 2' DIA. x 2000'	18	LF

## STREET CONSTRUCTION NOTES & QUANTITY ESTIMATE

NO.	DESCRIPTION	QUANTITY	ESTIMATE
1	CONCRETE DRIVE	41,300	SF
2	CONCRETE DRIVE	41,300	SF
3	CONCRETE DRIVE	3,000	SF
4	CONCRETE DRIVE	1,800	SF
5	CONCRETE DRIVE	1,650	SF
6	CONCRETE DRIVE	800	SF
7	CONCRETE DRIVE	3,150	SF
8	CONCRETE DRIVE	2,250	SF
9	CONCRETE DRIVE	800	SF
10	CONCRETE DRIVE	800	SF
11	CONCRETE DRIVE	8,000	SF
12	CONCRETE DRIVE	170	SF
13	CONCRETE DRIVE	1,400	SF
14	CONCRETE DRIVE	1,400	SF
15	CONCRETE DRIVE	1,400	SF
16	CONCRETE DRIVE	1,400	SF
17	CONCRETE DRIVE	1,400	SF
18	CONCRETE DRIVE	1,400	SF
19	CONCRETE DRIVE	1,400	SF
20	CONCRETE DRIVE	1,400	SF
21	CONCRETE DRIVE	1,400	SF
22	CONCRETE DRIVE	1,400	SF
23	CONCRETE DRIVE	1,400	SF
24	CONCRETE DRIVE	1,400	SF
25	CONCRETE DRIVE	1,400	SF
26	CONCRETE DRIVE	1,400	SF
27	CONCRETE DRIVE	1,400	SF
28	CONCRETE DRIVE	1,400	SF
29	CONCRETE DRIVE	1,400	SF
30	CONCRETE DRIVE	1,400	SF
31	CONCRETE DRIVE	1,400	SF
32	CONCRETE DRIVE	1,400	SF
33	CONCRETE DRIVE	1,400	SF
34	CONCRETE DRIVE	1,400	SF
35	CONCRETE DRIVE	1,400	SF
36	CONCRETE DRIVE	1,400	SF
37	CONCRETE DRIVE	1,400	SF
38	CONCRETE DRIVE	1,400	SF
39	CONCRETE DRIVE	1,400	SF
40	CONCRETE DRIVE	1,400	SF
41	CONCRETE DRIVE	1,400	SF
42	CONCRETE DRIVE	1,400	SF
43	CONCRETE DRIVE	1,400	SF
44	CONCRETE DRIVE	1,400	SF
45	CONCRETE DRIVE	1,400	SF
46	CONCRETE DRIVE	1,400	SF
47	CONCRETE DRIVE	1,400	SF
48	CONCRETE DRIVE	1,400	SF
49	CONCRETE DRIVE	1,400	SF
50	CONCRETE DRIVE	1,400	SF
51	CONCRETE DRIVE	1,400	SF
52	CONCRETE DRIVE	1,400	SF
53	CONCRETE DRIVE	1,400	SF
54	CONCRETE DRIVE	1,400	SF
55	CONCRETE DRIVE	1,400	SF
56	CONCRETE DRIVE	1,400	SF
57	CONCRETE DRIVE	1,400	SF
58	CONCRETE DRIVE	1,400	SF
59	CONCRETE DRIVE	1,400	SF
60	CONCRETE DRIVE	1,400	SF
61	CONCRETE DRIVE	1,400	SF
62	CONCRETE DRIVE	1,400	SF
63	CONCRETE DRIVE	1,400	SF
64	CONCRETE DRIVE	1,400	SF
65	CONCRETE DRIVE	1,400	SF
66	CONCRETE DRIVE	1,400	SF
67	CONCRETE DRIVE	1,400	SF
68	CONCRETE DRIVE	1,400	SF
69	CONCRETE DRIVE	1,400	SF
70	CONCRETE DRIVE	1,400	SF
71	CONCRETE DRIVE	1,400	SF
72	CONCRETE DRIVE	1,400	SF
73	CONCRETE DRIVE	1,400	SF
74	CONCRETE DRIVE	1,400	SF
75	CONCRETE DRIVE	1,400	SF
76	CONCRETE DRIVE	1,400	SF
77	CONCRETE DRIVE	1,400	SF
78	CONCRETE DRIVE	1,400	SF
79	CONCRETE DRIVE	1,400	SF
80	CONCRETE DRIVE	1,400	SF
81	CONCRETE DRIVE	1,400	SF
82	CONCRETE DRIVE	1,400	SF
83	CONCRETE DRIVE	1,400	SF
84	CONCRETE DRIVE	1,400	SF
85	CONCRETE DRIVE	1,400	SF
86	CONCRETE DRIVE	1,400	SF
87	CONCRETE DRIVE	1,400	SF
88	CONCRETE DRIVE	1,400	SF
89	CONCRETE DRIVE	1,400	SF
90	CONCRETE DRIVE	1,400	SF
91	CONCRETE DRIVE	1,400	SF
92	CONCRETE DRIVE	1,400	SF
93	CONCRETE DRIVE	1,400	SF
94	CONCRETE DRIVE	1,400	SF
95	CONCRETE DRIVE	1,400	SF
96	CONCRETE DRIVE	1,400	SF
97	CONCRETE DRIVE	1,400	SF
98	CONCRETE DRIVE	1,400	SF
99	CONCRETE DRIVE	1,400	SF
100	CONCRETE DRIVE	1,400	SF

**Underground Service Alert**  
Call 811 or 1-800-4-A-SHIELD  
227-2800

THIS PROJECT WILL BE CONSTRUCTED IN ACCORDANCE WITH THE STANDARD SPECIFICATIONS FOR HIGHWAY CONSTRUCTION, LATEST EDITION, AS ADOPTED BY THE BOARD OF SUPERVISORS OF THE COUNTY OF RIVERSIDE, CALIFORNIA. THE CONTRACTOR SHALL BE RESPONSIBLE FOR OBTAINING ALL NECESSARY PERMITS FROM THE COUNTY OF RIVERSIDE, CALIFORNIA, AND THE CITY OF VAN BUREN, CALIFORNIA.



TRANSPORTATION DEPARTMENT  
APPROVED BY:  
*Alan Ford*  
ALAN FORD, CIVIL ENGINEER  
LICENSE NO. 22208  
DATE: 2/22/08



TRANS-PACIFIC CONSULTANTS  
5411 UNIVERSITY AVENUE, SUITE 200  
SAN DIEGO, CA 92121  
PHONE: 619-591-8800  
FAX: 619-591-8801  
WWW: WWW.TPCON.COM

MR. ALVIN J. BROWN, JR.  
COUNTY ENGINEER  
COUNTY OF RIVERSIDE  
100 WEST G STREET, SUITE 100  
RIVERSIDE, CALIFORNIA 92501  
PHONE: 951-955-1100  
FAX: 951-955-1101  
WWW: WWW.COR.CA.GOV

MR. ALVIN J. BROWN, JR.  
COUNTY ENGINEER  
COUNTY OF RIVERSIDE  
100 WEST G STREET, SUITE 100  
RIVERSIDE, CALIFORNIA 92501  
PHONE: 951-955-1100  
FAX: 951-955-1101  
WWW: WWW.COR.CA.GOV

MR. ALVIN J. BROWN, JR.  
COUNTY ENGINEER  
COUNTY OF RIVERSIDE  
100 WEST G STREET, SUITE 100  
RIVERSIDE, CALIFORNIA 92501  
PHONE: 951-955-1100  
FAX: 951-955-1101  
WWW: WWW.COR.CA.GOV

MR. ALVIN J. BROWN, JR.  
COUNTY ENGINEER  
COUNTY OF RIVERSIDE  
100 WEST G STREET, SUITE 100  
RIVERSIDE, CALIFORNIA 92501  
PHONE: 951-955-1100  
FAX: 951-955-1101  
WWW: WWW.COR.CA.GOV

MR. ALVIN J. BROWN, JR.  
COUNTY ENGINEER  
COUNTY OF RIVERSIDE  
100 WEST G STREET, SUITE 100  
RIVERSIDE, CALIFORNIA 92501  
PHONE: 951-955-1100  
FAX: 951-955-1101  
WWW: WWW.COR.CA.GOV

MR. ALVIN J. BROWN, JR.  
COUNTY ENGINEER  
COUNTY OF RIVERSIDE  
100 WEST G STREET, SUITE 100  
RIVERSIDE, CALIFORNIA 92501  
PHONE: 951-955-1100  
FAX: 951-955-1101  
WWW: WWW.COR.CA.GOV

MR. ALVIN J. BROWN, JR.  
COUNTY ENGINEER  
COUNTY OF RIVERSIDE  
100 WEST G STREET, SUITE 100  
RIVERSIDE, CALIFORNIA 92501  
PHONE: 951-955-1100  
FAX: 951-955-1101  
WWW: WWW.COR.CA.GOV





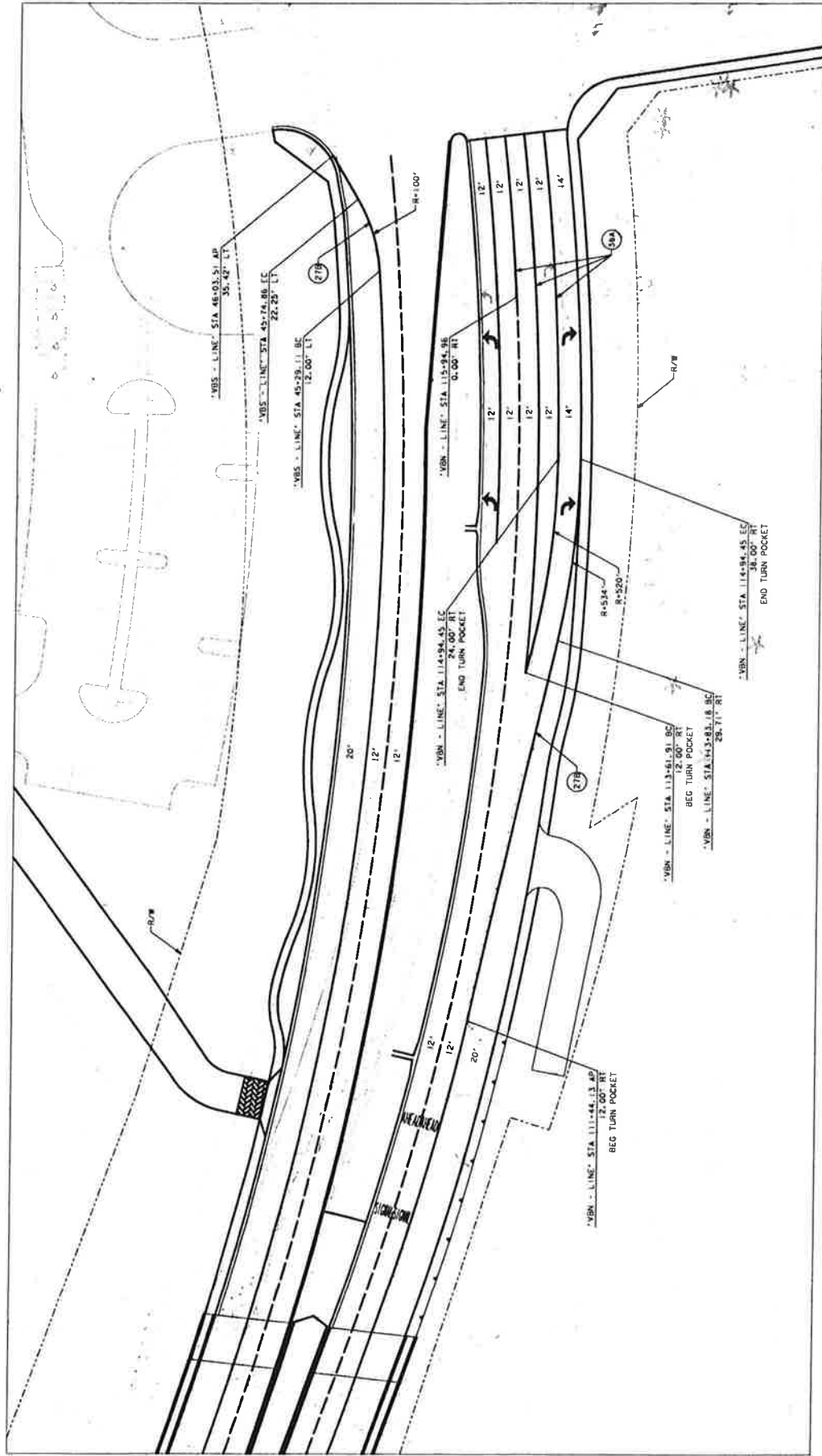

**DE DOKKEN**  
 ENGINEERING  
 CIVIL AND SURVEYING  
 1000 W. 15TH ST. SUITE 200  
 DENVER, CO 80202

DATE: JUNE 2011  
 SCALE: 1"=100'

PROJECT:  
**VAN BUREN BOULEVARD  
 ULT ANIMAL SHELTER  
 STRIPING**

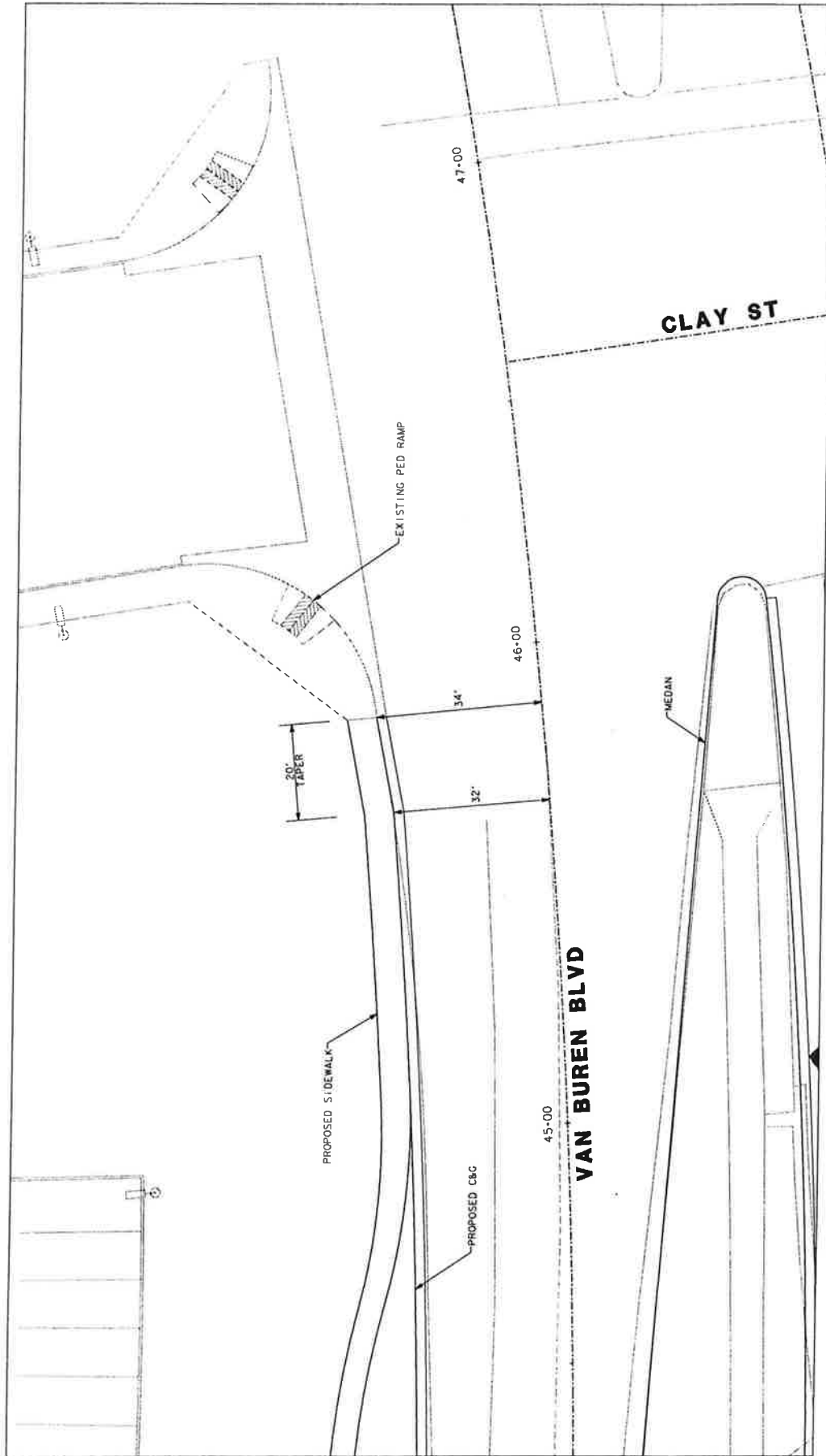

 <small>2303 LINDY POINT RD SUITE 200          FORT LAUDERDALE, FL 33309          (754) 881-0842</small>	DATE	JUNE 2011
	SCALE	SCALE 1"=20'
PROJECT	VAN BUREN BOULEVARD ULT ANIMAL SHELTER SIDEWALK CONFORM	



Van Buren Bridge and Street Improvements  
Contract CCO History

Contract No. 09-04-011  
 Work Order No. B0-0801  
 Contract Amount \$22,875,573.70

Single Maximum CCO \$150,000.00  
 Maximum CCO's \$2,287,557.37  
 Tip Budget \$40,627,000.00

Tip Comments:  
No Change

=====

CCO No.	Amount This CCO	Authority	Cumulative CCO's	% Original Authorized	Cumulative CCO %	Classification
1	\$50,000.00	Trans. Director	\$50,000.00	0.22%	0.22%	Extra/Unavoidable
2	\$49,957.00	Trans. Director	\$99,957.00	0.22%	0.44%	Extra/Unavoidable
3	\$35,000.00	Trans. Director	\$134,957.00	0.15%	0.59%	Extra/Unavoidable
3S1	\$40,000.00	Trans. Director	\$174,957.00	0.17%	0.76%	Extra/Unavoidable
5	\$50,590.94	Trans. Director	\$225,547.94	0.22%	0.99%	Extra/Unavoidable
4	\$57,633.61	Trans. Director	\$283,181.55	0.25%	1.24%	Extra/Unavoidable
6	\$237,366.90	Board Approval	\$520,548.45	1.04%	2.28%	Extra/Unavoidable
7	\$86,856.00	Trans. Director	\$607,404.45	0.38%	2.66%	Extra/Unavoidable
8	<u>\$401,782.09</u>	Board Approval	\$1,009,186.54	1.76%	4.41%	Extra/Unavoidable
	\$1,009,186.54			4.41%		

New Authorized Contract Total	\$23,884,760.24
Total CCO Dollars To Date	\$1,009,186.54
Total % Increased by CCO's	4.41%

## LETTER OF TRANSMITTAL

**Local Agency: County of Riverside  
Transportation Department**

**DATE: November 17, 2011  
File: Van Buren Bridge Project  
W.O. No.: B0-0801  
C.C.O.: 12**

**TO: Juan C. Perez**

**From: Hugh Smith**

**\$431,785.54 (1.89% of the original contract amount of \$22,875,573.00)**

Contract Change Order No. 12 became necessary to construct the sewer forcemain extension from Sta 84+32 to 97+44 (Alt No. 2), sewer forcemain extension at the intersection of Van Buren Blvd. and blow-off assembly at Sta 112+73 in accordance with Jurupa Community Services District red lined plans and standards. These changes were incorporated by JCSD in anticipation of the future sewer forcemain connection to the City of Riverside treatment plant.

The inclusion of the installation of the 24" sewer forcemain extension in conjunction with the bridge project promotes convenience and safety for the travelling public. There will be less impact to the public since the construction of the Van Buren Bridge project is in progress.

The installation of the sewer forcemain extension with the bridge project will also eliminate disturbing the new roadway structural section placed with the bridge project and avoid unsightly AC pavement patch work.

The amount of Contract Change Order No. 12 is funded entirely by JCSD per the attached commitment letter from JCSD to Mr. Tayfun Saglam.

**File: Van Buren Bridge Project**  
**W.O. No.: B0-0801**  
**C.C.O. No. 12**  
**Page 2**

The amount of this Change Order is \$431,785.54 and the accumulation of all Contract Change Orders thus far, including this one, is \$1,446,785.05.

Previous Contract Change Order Amounts Approved:  
See C.C.O. History \$1,014,999.51  
(attached)

This Contract Change Order was discussed with Mr. Tayfun Saglam and he gave his concurrence to this change.

Adjustment of Time: 16 Days

<b>ESTIMATE OF COST</b>	
Items	\$431,785.54
Force Account	
Agreed Price	
Adjustment	
	<hr/>
<b>TOTAL</b>	<b>\$431,785.54</b>

---

**Hugh Smith**  
**Construction Engineer**

C. C. O. Category

Agency Mandated	√
Anticipated Force Account	
Change in Field Conditions	
Design Omission	
ROW Obligations	✓
Upgrades / Benefits	✓
Utilities	✓



Jane F. Anderson, President  
Kenneth J. McLaughlin, Vice President  
Kathryn Bogart, Director  
Robert "Bob" Craig, Director  
Betty A. Anderson, Director



October 3, 2011

Mr. Tayfun Saglam, P.E.  
County of Riverside  
4080 Lemon Street, 8th Floor  
Riverside, CA 92502

RE: VAN BUREN BRIDGE PROJECT – SEWER FORCE MAIN EXTENSION

Dear Mr. Saglam:

As discussed in our recent meeting in which we reviewed the merits of extending the Jurupa Community Services District's (JCSD) sewer forcemain within the current bridge construction project, this letter is to provide the JCSD's commitment to fund the subject construction work. The project scope of work and associated funding obligations were reviewed and approved by our Board of Directors on September 12, 2011. The benefits of conducting the work now rather than deferring construction, includes a reduction in public inconvenience, a reduction in multiagency coordination efforts, and a reduction in facility construction costs.

Therefore, in accordance with a request made by JCSD to the Riverside County Transportation Department, Gabriel Munoz of your staff has solicited alternative construction cost proposals from the subject project's contractor (Griffith Company) to extend portions of the JCSD Regional Forcemain on both the north and south sides of the bridge project.

Of the four alternative proposals provided, JCSD has selected the one entitled "Sewer Forcemain Extension STA 84+32 Alternative 2 (Attachment A) in the amount of \$431,785.54. We note that this financial commitment represents a combination of two existing change order items, contractual impact costs and funding for the new construction scope. As indicated in Griffith Company's cost proposal letter, "If they receive a contract change order by October 7, 2011, the sewer forcemain extension work will have zero impact on the current construction schedule." For ease of review, the specific work included in the selected alternative is shown on the plans and associated details provided in Attachment B.

Attachment C provides an overall program cost summary of the JCSD work to date and proposed scope additions. As shown, the subject forcemain extension work will

Mr. Tayfun Saglam  
County of Riverside  
RE: Van Buren Bridge Project – Sewer Force Main Extension  
October 3, 2011  
Page 2

increase the overall JCSD/Riverside County Agreement by approximately \$55,000. In order to maintain a contingency for currently unforeseen work elements, we would suggest that the Agreement be increased by \$95,000, which to our understanding, is within County staff's authorization levels. It is understood and anticipated that further analysis and discussion will be needed to clarify appropriate cash flow transfers from JCSD to the County.

On behalf of JCSD, I want to express our sincerest appreciation to you, Gabriel Munoz, Stan Dery, and your staff to bring this additional work to fruition. Construction of the subject facilities at this stage in our project not only benefits the District and its rate payers but all county residents

Sincerely,

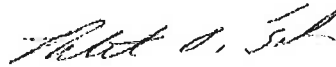

Robert O. Tock, P.E.  
Director of Engineering & Operations

Enclosure: Attachments

Copy: Eldon Horst, JCSD  
Nem Ochoa, JCSD  
Sam Gershon, AAWA  
Wally Franz, AAWA  
Stan Dery, Riv Cnty  
Gabriel Munoz, Riv Cnty

DP 3039/Ltrs/100311Ltr to COR re Force Main Extension 3039DP/NO/kb



**COUNTY OF RIVERSIDE  
TRANSPORTATION DEPARTMENT**

SHEET 1 OF 14 SHEETS

**Contract Change Order No. 12**

CONTRACT: Van Buren Bridge Project WORK ORDER NO. B0-0801

TO: Griffith Company CONTRACTOR: YOU ARE HEREBY DIRECTED TO MAKE THE HEREIN DESCRIBED CHANGES FROM THE PLANS AND SPECIFICATIONS OR DO THE FOLLOWING DESCRIBED WORK NOT INCLUDED IN THE PLANS AND SPECIFICATIONS ON THIS CONTRACT.

Description of work to be done, estimate of quantities and prices to be paid. Segregated between additional work at contract price, agreed price and force account. Unless otherwise stated, rates for rental of equipment cover only such time as equipment is actually used and no allowance will be made for idle time.

**Estimate of Extra Work at Agreed Unit Price:**

As directed by the Engineer and in accordance with the applicable sections of the Special Provisions; compensate the Contractor to construct the sewer forcemain extension from STA 84+32 to 97+44 (Alt No. 2), at the intersection of Van Buren Blvd. / Clay St. and install blow-off assembly at Sta 112+73 in accordance with Jurupa Community Services District red lined plans/standards sheets 3 thru 14 of this contract change order.

The work shall include but not limited to; furnishing all labor, materials, equipment, tools, hauling and disposal of discarded construction materials and other incidentals as required.

Item A: 24" DIP Class 150 (STA 87+00 to 97+44)	1044 LF @ \$173.25 / LF	=	\$ 180,873.00
Item B: 24" DIP Class 150 (STA 84+32 to 87+00)	268 LF @ \$210.00 / LF	=	\$ 56,280.00
Item C: 24" DIP Bend (STA 97+07 and 97+32)	2 EA @ \$1,890.00 / EA	=	\$ 3,780.00
Item D: 24" X 6" Blow Off (JCSD Fig. 5-2)	2 EA @ \$7,560.00 / EA	=	\$ 15,120.00
Item E: CDF Between SD and Sewer (STA 97+32)	1 LS @ \$1,260.00 / LS	=	\$ 1,260.00
Item F: Remove Flange and Join Existing	1 EA @ \$630.00 / EA	=	\$ 630.00
Item G: Install 24" X 12" TEE	1 EA @ \$2,940.00 / EA	=	\$ 2,940.00
Item H: Install 12" Plug Valve	1 EA @ \$5,040.00 / EA	=	\$ 5,040.00
Item I: 12" DIP Class 150	120 LF @ \$136.50 / EA	=	\$ 16,380.00
Item J: 24" End Cap	1 EA @ \$1,470.00 / EA	=	\$ 1,470.00
Item K: 12" End Cap	1 EA @ \$1,050.00 / EA	=	\$ 1,050.00
Item L: Crispin Air Valves	1 LS @ \$16,391.04 / LS	=	\$ 16,391.04
Item M: Traffic Control and Trench Repair (Van Buren and Clay) STA 97+44 to 98+06)	1 LS @ \$24,424.52 / LS 16 Days @ \$3,500.00 / Day	= =	\$ 24,424.52 \$ 56,000.00



COUNTY OF RIVERSIDE  
TRANSPORTATION DEPARTMENT

SHEET 2 OF 14 SHEETS

Contract Change Order No. 12

CONTRACT: Van Buren Bridge Project WORK ORDER NO. B0-0801

TO: Griffith Company CONTRACTOR: YOU ARE HEREBY DIRECTED TO MAKE THE HEREIN DESCRIBED CHANGES FROM THE PLANS AND SPECIFICATIONS OR DO THE FOLLOWING DESCRIBED WORK NOT INCLUDED IN THE PLANS AND SPECIFICATIONS ON THIS CONTRACT.

Description of work to be done, estimate of quantities and prices to be paid. Segregated between additional work at contract price, agreed price and force account. Unless otherwise stated, rates for rental of equipment cover only such time as equipment is actually used and no allowance will be made for idle time.

Item N: Traffic Control and Trench Repair (STA 82+42 to 84+32)	1 LS	@ \$37,454.73 / LS	= \$ 37,454.73
Item O: Time Related Overhead (Delays Caused by Extension STA 97+44 to 98+06)	16 Days	@ \$3,500.00 / Day	= \$ 56,000.00
Item P: Sewer Forcemain Extension (STA 97+44 to 98+06)	64 LF	@ \$150.00 / LF	= \$ 9,600.00
Item Q: Sewer Forcemain Extension Appurtenances (STA 97+44 to 98+06)	1 LS	@ \$3,092.25 / LS	= \$ 3,092.25

Items L, M, N and O are fixed prices and no additional compensation therefore. Payment will be made for the actual quantity of the items performed at unit prices.

Estimated Cost: Decrease \$ \_\_\_\_\_ Increase \$ 431,785.54

WE, the undersigned contractor, have given careful consideration to the change proposed and hereby agree that we will provide all equipment, furnish all materials, except as may otherwise be noted above, and perform all services necessary for the work above specified, and will accept as full payment therefor the prices shown above.

By reason of this proposed change of 16 days adjustment of time will be allowed.

Accepted [Signature] 11/10/11  
Date Griffith Company

[Signature] 11/3/11  
Approval Recommended Date

[Signature] 12/1/12  
Approval Recommended Date  
Juan C. Perez, Director of Transportation

NOTE: This change order is not effective until approved by County. If the Contractor does not sign acceptance of this order, his attention is directed to the requirements of the specifications as to proceeding with the ordered work and filing a written protest with the time therein specified.

Approved \_\_\_\_\_  
Chairman, Riverside County Board of Supervisors Date







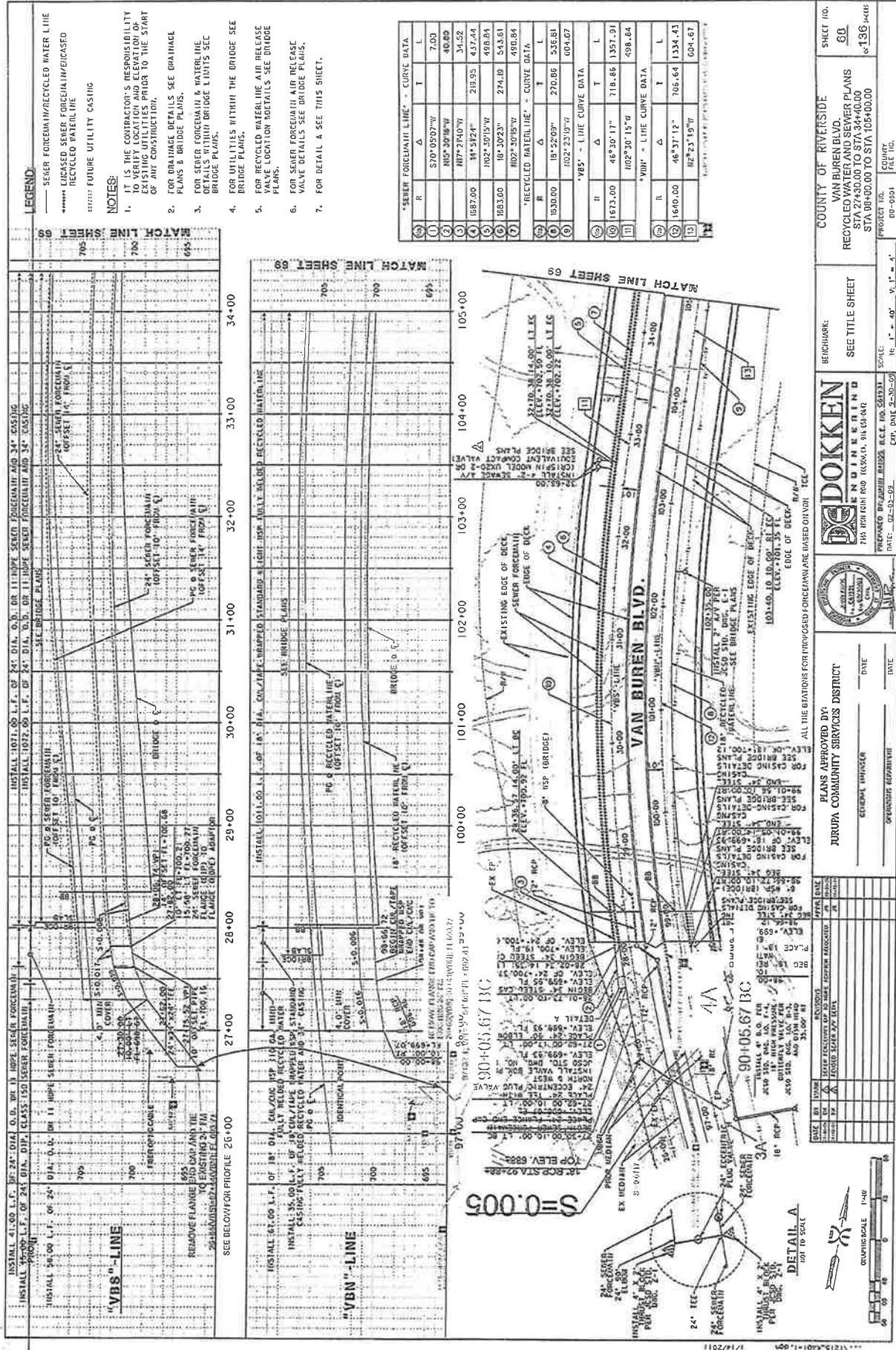

**LEGEND:**  
 — SEWER FORCEMAIN/RECYCLED WATER LINE  
 - - - - - RECYCLED SEWER FORCEMAIN/RECYCLED WATER LINE  
 - - - - - FUTURE UTILITY CASING

- NOTES:**
- IT IS THE CONTRACTOR'S RESPONSIBILITY TO VERIFY LOCATION AND ELEVATION OF EXISTING UTILITIES PRIOR TO THE START OF ANY CONSTRUCTION.
  - FOR DRAINAGE DETAILS SEE DRAINAGE PLANS & BRIDGE PLANS.
  - FOR SEWER FORCEMAIN & WATER LINE DETAILS WITHIN BRIDGE LIMITS SEE BRIDGE PLANS.
  - FOR UTILITIES WITHIN THE BRIDGE SEE BRIDGE PLANS.
  - FOR RECYCLED WATER LINE AIR RELEASE VALVE LOCATION DETAILS SEE BRIDGE PLANS.
  - FOR SEWER FORCEMAIN AIR RELEASE VALVE DETAILS SEE BRIDGE PLANS.
  - FOR DETAIL A SEE THIS SHEET.

"SEWER FORCEMAIN LINE" - CURVE DATA			
R	Δ	T	L
1	S70°05'07"W		7.00
2	N85°30'18"W		40.80
3	N77°21'40"W		34.52
4	S87°00'	219.95	437.44
5	S83°00'	274.19	498.84
6	N02°30'15"W		498.84
7	N02°30'15"W		498.84
"RECYCLED WATER LINE" - CURVE DATA			
R	Δ	T	L
8	S13°00'	270.86	536.61
9	S02°23'19"W		604.67
"VBS" - LINE CURVE DATA			
R	Δ	T	L
10	S62°30'17"	218.86	1357.91
11	N02°30'15"W		498.84
"VBN" - LINE CURVE DATA			
R	Δ	T	L
12	S62°30'17"	218.86	1357.91
13	N02°30'15"W		498.84

**PROJECT NO.** 00-001  
**DATE:** 02-10-09  
**SCALE:** R: 1" = 40'  
**PROJECT TITLE:** COUNTY OF RIVERSIDE  
 VAN BUREN BLVD.  
 RECYCLED WATER AND SEWER PLANS  
 STA 27+30.00 TO STA 34+40.00  
 STA 00+00.00 TO STA 105+00.00  
**SHEET NO.** 60  
**OF 136**

**DOKKEN**  
 CIVIL ENGINEERING  
 1740 RIVERSIDE ROAD, SUITE 204, RIVERSIDE, CA 92504  
 PHONE: 951-514-1111  
 FAX: 951-514-1112  
 E-MAIL: INFO@DOKKEN.COM  
 WWW.DOKKEN.COM

**PLANS APPROVED BY:**  
 JURUPA COMMUNITY SERVICES DISTRICT  
 GENERAL MANAGER \_\_\_\_\_ DATE \_\_\_\_\_  
 SEWERING DEPARTMENT \_\_\_\_\_ DATE \_\_\_\_\_

**DETAIL A**  
 1/2" TO SCALE

**GRAPHIC SCALE** 1"=40'

**DATE:** \_\_\_\_\_  
**SCALE:** \_\_\_\_\_  
**PROJECT NO.:** \_\_\_\_\_  
**PROJECT TITLE:** \_\_\_\_\_

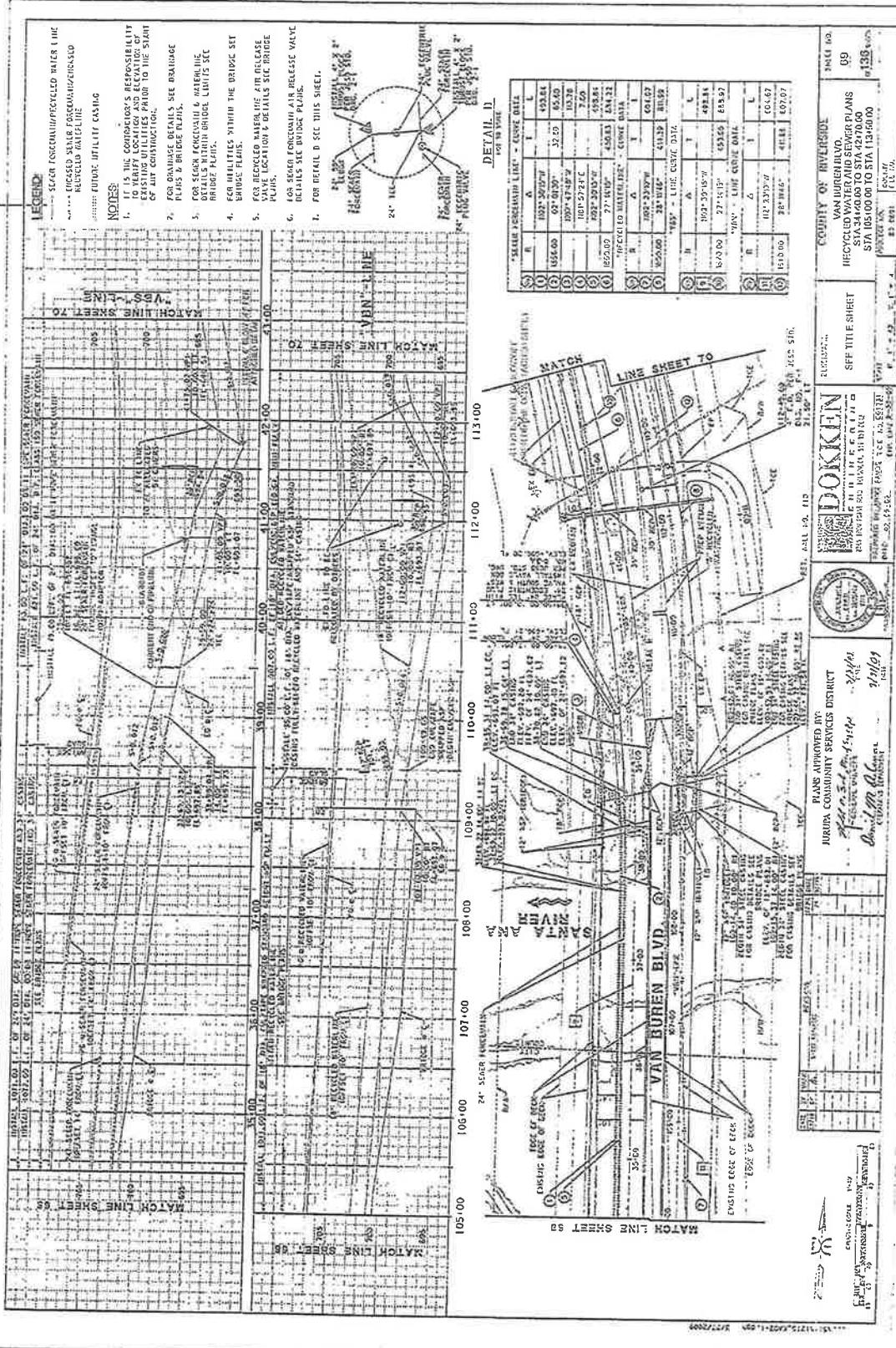

Van Buren Bridge Replacement Project  
 Project No. P0-0801, BR15ZD - 6956(124)

Aliacimouli, C. Adedemilum #2  
 Replacement Sheet 9 of 25





MINIMUM OF TWO (2) BONDING JUMPERS ARE REQUIRED PER PIPE JOINT SMALLER THAN 36"  
 MINIMUM OF THREE (3) BONDING JUMPERS ARE REQUIRED PER PIPE JOINT FOR PIPE 36" AND LARGER  
 SEE SD-700, SHEET 1, NOTE 1

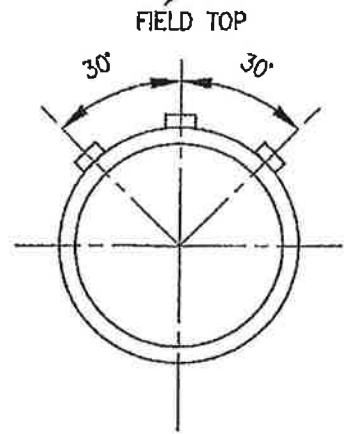

MIN. TWO (2) HMW/PE STRANDED COPPER BONDING JUMPERS CONNECTED TO PIPE AND FITTINGS BY MEANS OF EXOTHERMIC WELDING. USE MFG'S RECOMMENDED WELDER, CARTRIDGE SIZE, ADAPTER SLEEVE, ETC. FOR DUCTILE IRON PIPE (TYP.)

AFTER WELDING BONDING JUMPERS TO PIPE, APPLY EXOTHERMIC WELDING CAP, PER MANUFACTURER RECOMMENDATIONS. SEE SD-700, SHEET 1, NOTE 3

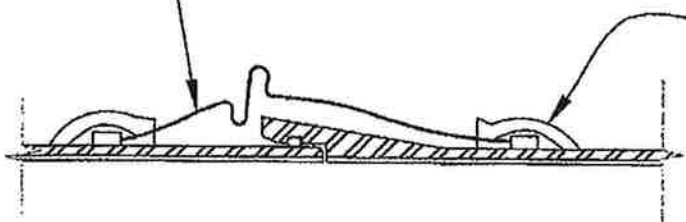

DIP BONDING CONDUCTOR INSTALLATION

CLEAN PIPE TO BRIGHT METAL IN AREAS WHERE BOND LEADS ARE TO BE ATTACHED (TYP.).  
 BONDING CONDUCTORS SHALL HAVE SUFFICIENT SLACK TO ALLOW FOR A TOTAL JOINT DISPLACEMENT OF ONE-HALF(1/2) INCH.

BONDING CABLES			
D.I.P. CLASS 350			
PIPE	NO.	AWG	MAX. LENGTH
16"	2	6	24"
24"	2	6	18"
24"	2	4	24"
30"	2	4	18"
30"	2	2	24"
36"	3	4	24"
42-48"	3	2	24"

FOR DUCTILE IRON PIPE

JURUPA COMMUNITY SERVICES DISTRICT

ALBERT A. WEBB ASSOCIATES  
 CONSULTING ENGINEERS  
 RIVERSIDE, CA

PIPE JOINT BONDING

DETAIL NO.

SD-702

SHEET 3 OF 3



## EXOTHERMIC WELDING PROCEDURES

REMOVE PIPELINE COATING—  
FILE PIPE TO BRIGHT METAL  
AND DRY ANY MOISTURE  
WITH A TOWEL

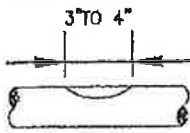

STEP 1

STRIP INSULATION  
FROM WIRE (SEE  
NOTE NO. 1)

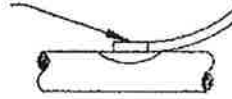

STEP 2

REMOVE SLAG  
WITH HAMMER

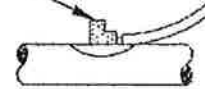

STEP 4

HOLD WELDER FIRMLY  
IN PLACE WHILE  
MAKING CONNECTION

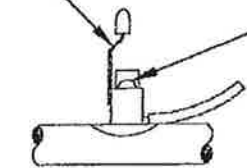

STEP 3

APPLY SPARK GUN  
AWAY FROM  
OPERATOR

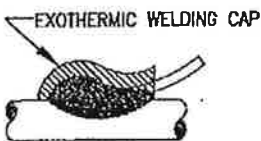

STEP 5

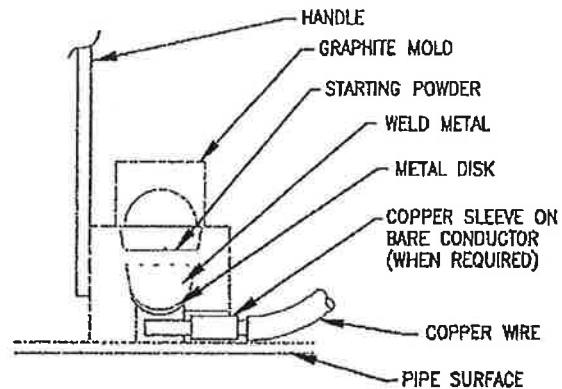

### GENERAL WELDING PROCEDURE TYPE HA

1. When using #10 to #14 AWG solid wire, it will be necessary to install a copper sleeve of adequate size over the bare end of the wire and crimp in place before attempting to make the connection. The wire should protrude at least 1/8" from the end of the sleeve.
2. Insert the conductor into mold noting any special information under "positioning" for application type in the manufacturers instructions packaged with the welder.
3. Insert steel disk in bottom of cavity inside mold. Dump the weld metal into mold being careful not to upset the steel disk. Tap the bottom of the tube to loosen all the starting powder and spread it evenly over the weld metal. Place a small amount of starting powder on the top edge of mold under cover opening for easy ignition.
4. Close cover and ignite with the flint gun. Move flint gun away quickly to prevent fouling.
5. After ignition, hold the welder in place for a moment to allow the weld to solidify. After the weld has cooled, remove the slag with a chipping hammer or wire brush.
6. Coat the connection and the entire prepared surface with an exothermic welding cap.
7. Remove all slag from the welder before making weld. Clean the cover every 5 to 10 welds.
8. Wet or damp molds will produce porous welds. Molds must be dried out before attempting to weld.
9. Connections are to be placed a minimum of 3" apart. Unsuccessful welds are to be abandoned and move to another prepared surface not less than 3" away.

## JURUPA COMMUNITY SERVICES DISTRICT

ALBERT A. WEBB ASSOCIATES  
CONSULTING ENGINEERS  
RIVERSIDE, CA

### EXOTHERMIC WELDING

DETAIL NO.

**SD-703**

**SHEET 1 OF 2**

### EXOTHERMIC WELDING MATERIALS

1. DUCTILE IRON PIPE—HORIZONTAL

ERICO—CADWELD

<u>WELDER</u>	<u>WELDMETAL</u>	<u>CONDUCTOR</u>	<u>SLEEVE</u>	<u>PIPEØ</u>
CAHBA-1L-16	CA45XF-19	#10	B133-1L	16"
CAHBA-1H-16	CA25XF-19	#6	-	16"
CAHBA-1V-16	CA45XF-19	#6	CAB112	16"
CAHBA-1V-16	CA45XF-19	#2	-	16"
CAHBA-1L-16	CA45XF-19	#4	-	16"
CAHBA-1L-24	CA45XF-19	#10	B133-1L	24"
CAHBA-1H-24	CA25XF-19	#6	-	24"
CAHBA-1V-24	CA45XF-19	#6	CAB112	24"
CAHBA-1V-24	CA45XF-19	#2	-	24"
CAHBA-1L-24	CA45XF-19	#4	-	24"
CAHBA-1L	CA45XF-19	#10	B133-1L	OVER 24"
CAHBA-1H	CA25XF-19	#6	-	OVER 24"
CAHBA-1V	CA45XF-19	#6	-	OVER 24"
CAHBA-1V	CA45XF-19	#2	-	OVER 24"
CAHBA-1L	CA45XF-19	#4	-	OVER 24"

CONTINENTAL—THERMOWELD  
FOR PIPE SMALLER THAN 24"Ø, SIZE DESIGNATION IS ON WELDER.

<u>WELDER</u>	<u>WELDMETAL</u>	<u>CONDUCTOR</u>	<u>SLEEVE</u>	<u>PIPEØ</u>
M-157	25 PCI	#10	A-208	16" AND OVER
M-157	25 PCI	#6	-	16" AND OVER
M-159	45 PCI	#4	-	16" AND OVER
M-161	45 PCI	#2	-	16" AND OVER

2. CCP/PCCP—HORIZONTAL

ERICO—CADWELD

<u>WELDER</u>	<u>WELDMETAL</u>	<u>CONDUCTOR</u>	<u>SLEEVE</u>	<u>PIPEØ</u>
CAHAA-1L	CA15	#10	B133-1L	6" AND OVER
CAHAA-1H	CA15	#6	-	4" AND OVER
CAHAA-1V	CA32	#6	CAB112	4" AND OVER
CAHAA-1V	CA32	#2	-	4" AND OVER
CAHAA-1L	CA15	#4	-	6" AND OVER

CONTINENTAL—THERMOWELD

<u>WELDER</u>	<u>WELDMETAL</u>	<u>CONDUCTOR</u>	<u>SLEEVE</u>	<u>PIPEØ</u>
M-102	15	#10	A-208	4" AND OVER
M-102	15	#6	-	4" AND OVER
M-106	15	#4	-	6" AND OVER
M-112	32	#2	-	4" AND OVER

NOTE:

FOR ANY SIZES OF PIPE NOT LISTED, CONTACT THE TUCSON WATER CORROSION UNIT  
(520) 791-2648 FOR APPROVED MATERIALS SPECIFICATIONS.

**JURUPA COMMUNITY SERVICES DISTRICT**

ALBERT A. WEBB ASSOCIATES  
CONSULTING ENGINEERS  
RIVERSIDE, CA

**EXOTHERMIC WELDING**

DETAIL NO.

**SD-703**

**SHEET 2 OF 2**

METER BOX COVER THE LETTERS "CTS" SHALL BE WELDED OR CAST ON LID. LETTER SIZES SHALL BE 3" HIGH x 1 1/2" WIDE x 1/4" THICK.

NOTE:  
#1 CONC. METER BOX COVER AND CONCRETE COLLAR SHALL BE PAINTED BLUE (POTABLE) OR PURPLE (RECLAIMED) SEE SD 700, SHEET 2  
NOTE 11

NOTE: SET METER BOX 2' BACK OF CURB

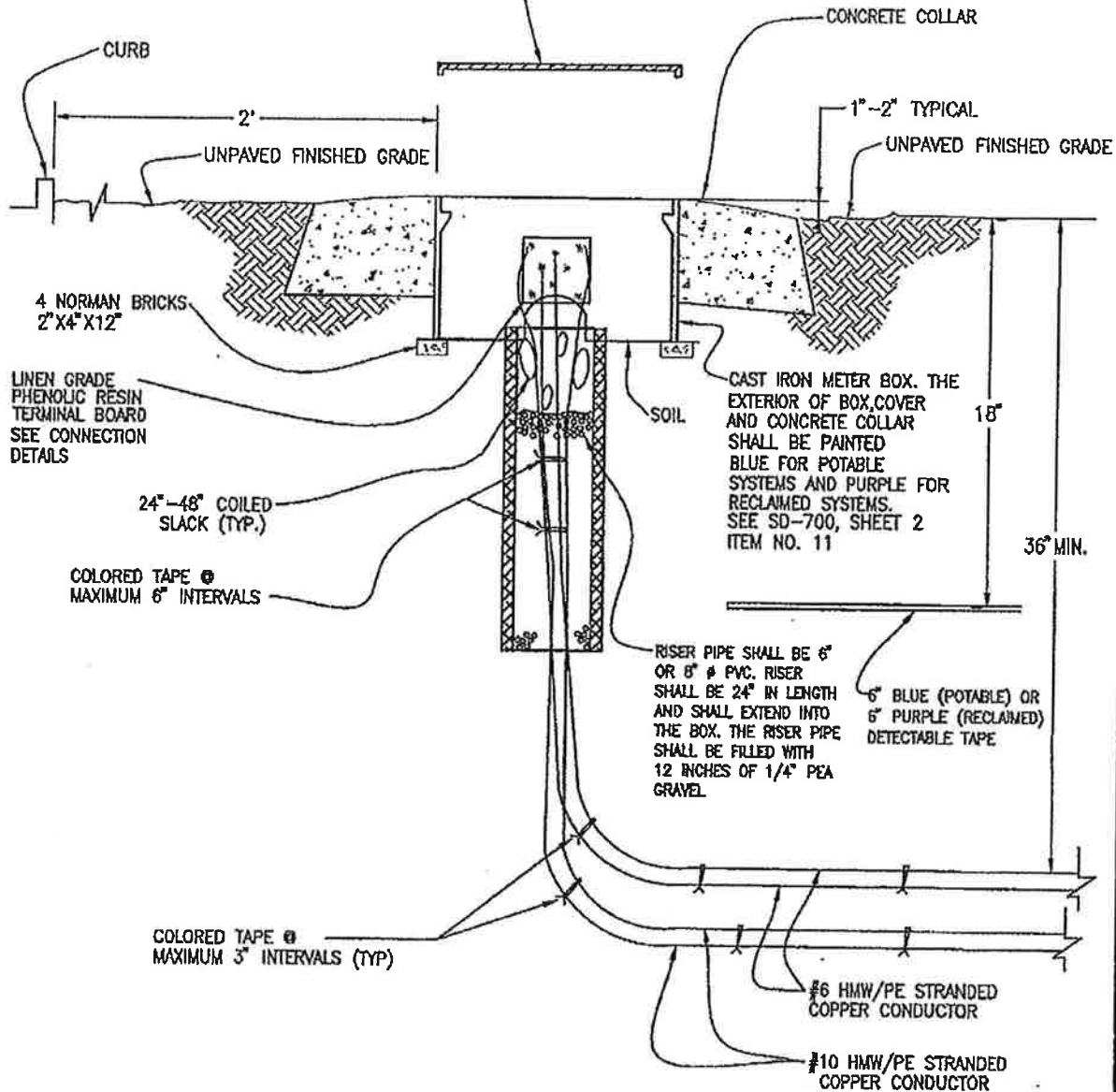

**JURUPA COMMUNITY SERVICES DISTRICT**

ALBERT A. WEBB ASSOCIATES  
CONSULTING ENGINEERS  
RIVERSIDE, CA

TEST STATION  
BELOW GRADE INSTALLATION

DETAIL NO.

**SD-705**

**SHEET 1 OF 3**

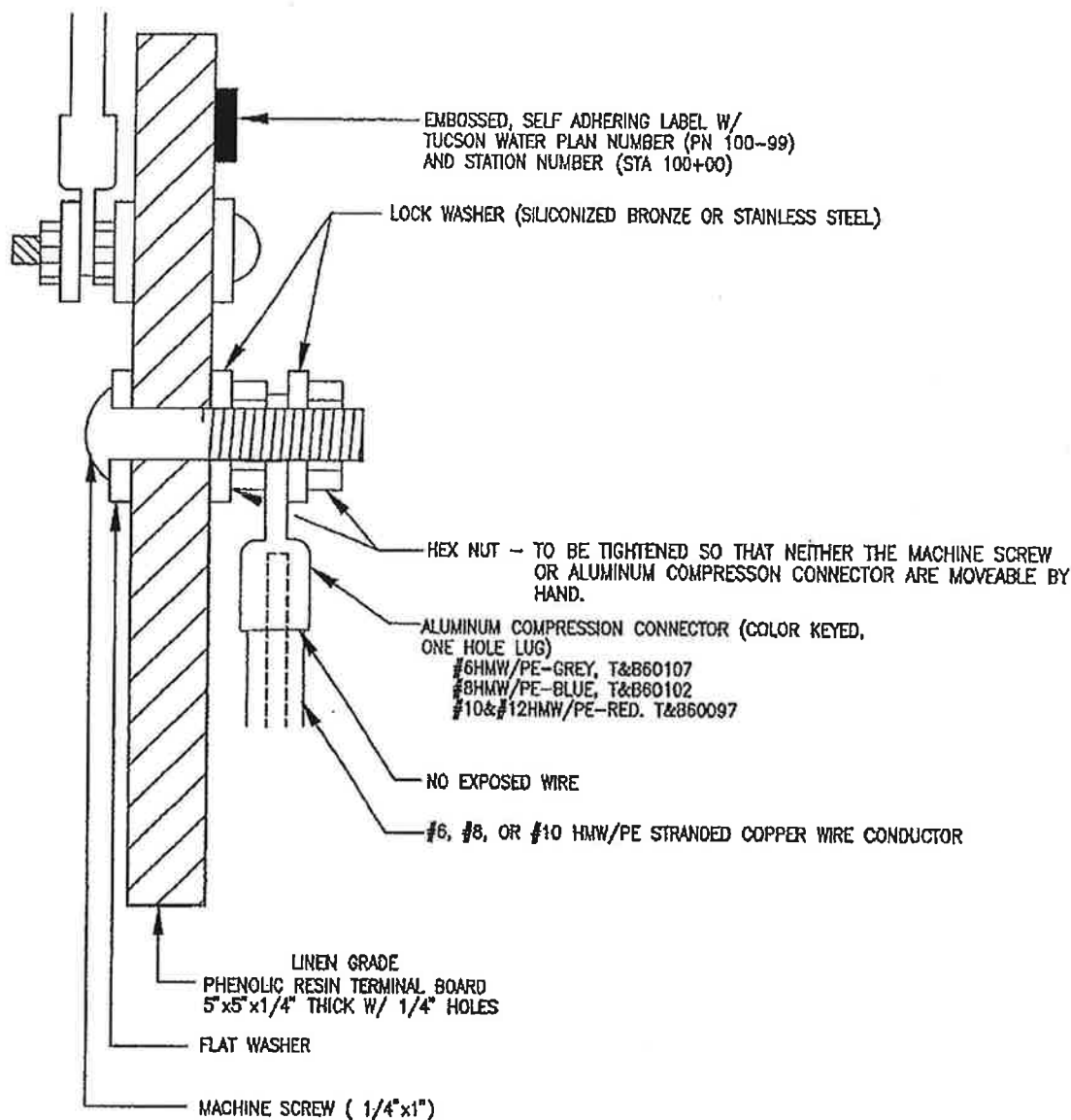

HARDWARE SHALL BE EITHER ALL STAINLESS STEEL OR ALL  
BRASS (WITH SILICONIZED BRONZE LOCK WASHERS)

CRIMPING OF RING-TYPE TERMINAL CONECTOR SHALL BE ACCOMPLISHED WITH A CRIMPING TOOL INTENDED FOR THIS  
USE. PLIERS OR OTHER SUBSTITUTES ARE NOT ACCEPTABLE. TO INSURE A PROPER, NON-REMOVABLE MECHANICAL  
FASTENING BETWEEN THE WIRE AND RING-TYPE TERMINAL CONNECTOR(S), THE RECOMMENDED CRIMP TOOL IS THE  
THOMAS AND BETTS (T+B) #TBM25S OR PRE-APPROVED EQUAL. COMPRESSION CONNECTORS SHALL BE CONNECTED  
TO BOARD SO AS NOT TO TOUCH OTHER CONNECTORS. LEADS COMING FROM SOURCES OF DIFFERENT POTENTIALS  
SHALL BE LOCATED ON OPPOSING SIDES OF THE TERMINAL BOARD SO AS TO PREVENT SHORTING OUT.

TERMINAL BOARD CONNECTION

JURUPA COMMUNITY SERVICES DISTRICT

ALBERT A. WEBB ASSOCIATES  
CONSULTING ENGINEERS  
RIVERSIDE, CA

TEST STATION  
BELOW GRADE INSTALLATION

DETAIL NO.

SD-705

SHEET 2 OF 3

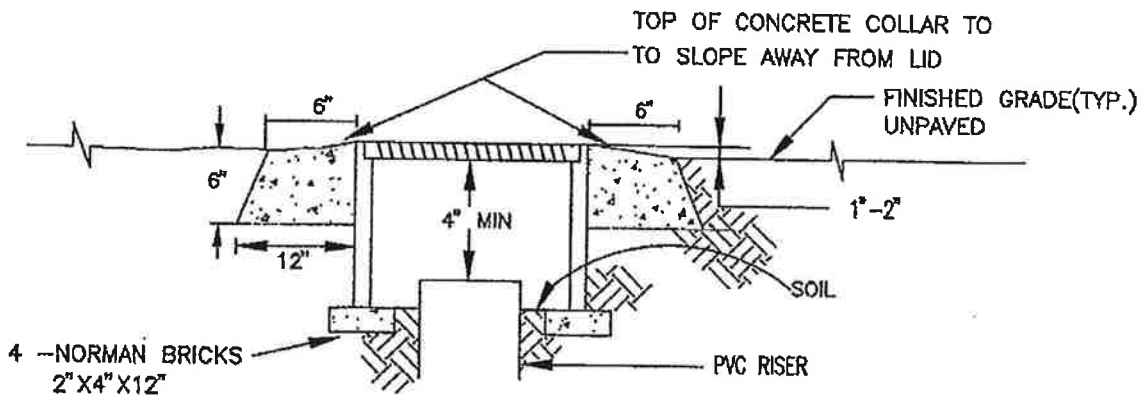
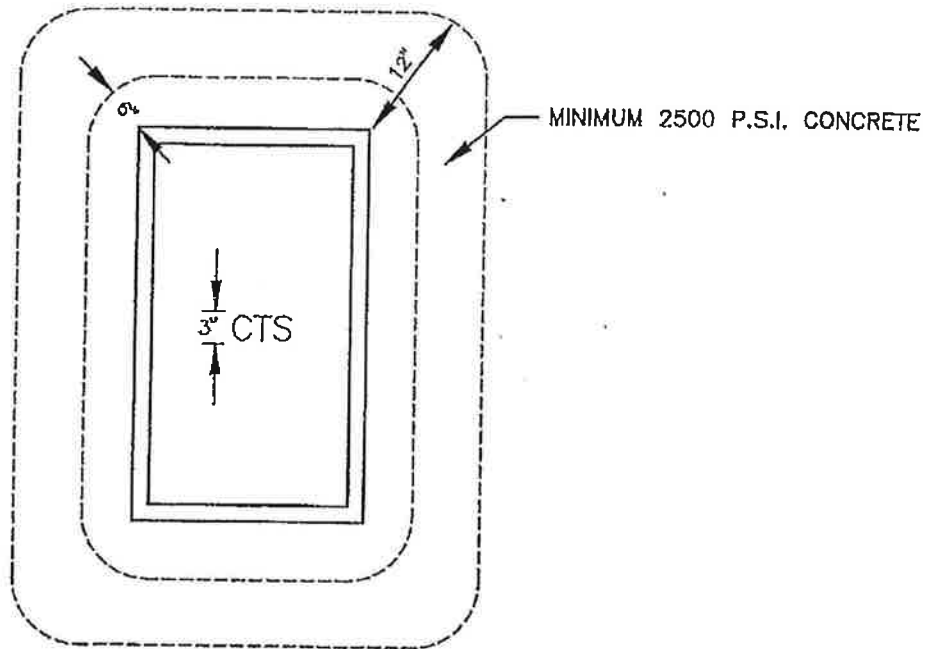

NOTE: TOP OF BOX IS TO BE SET 1"-2" ABOVE FINISHED GRADE

### CONCRETE COLLAR

JURUPA COMMUNITY SERVICES DISTRICT

ALBERT A. WEBB ASSOCIATES  
CONSULTING ENGINEERS  
RIVERSIDE, CA

TEST STATION  
BELOW GRADE INSTALLATION

DETAIL NO.

SD-705

SHEET 3 OF 3



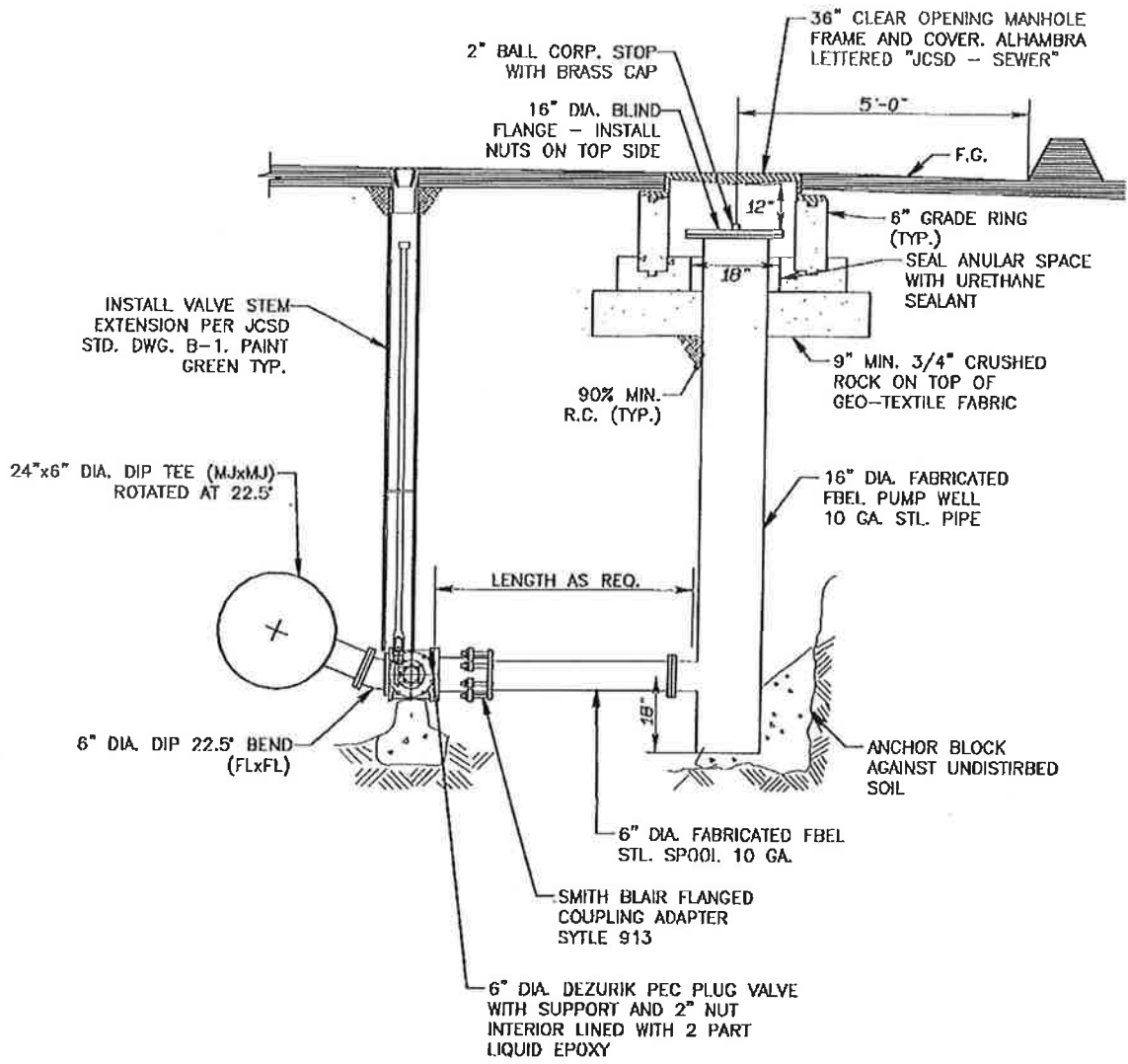

**6" FORCEMAIN BLOW OFF**

**JURUPA COMMUNITY SERVICES DISTRICT**

SCALE: NTS  
 DATE: SEPTEMBER, 2011  
 APPROVED BY: \_\_\_\_\_

**REGIONAL FORCEMAIN PDR  
 FORCEMAIN DRAIN DETAIL**

FIGURE NO.  
**5-2**

ALBERT A. WEBB ASSOCIATES  
 CONSULTING ENGINEERS  
 RIVERSIDE CALIFORNIA

W.O. 10-0239

REV.

Van Buren Bridge and Street Improvements  
Contract CCO History

Contract No. 09-04-011  
 Work Order No. B0-0801  
 Contract Amount \$22,875,573.70

Single Maximum CCO \$150,000.00  
 Maximum CCO's \$2,287,557.37  
 Tip Budget \$40,627,000.00

Tip Comments:  
No Change

=====

CCO No.	Amount This CCO	Authority	Cumulative CCO's	% Original Authorized	Cumulative CCO %	Classification
1	\$50,000.00	Trans. Director	\$50,000.00	0.22%	0.22%	Extra/Unavoidable
2	\$49,957.00	Trans. Director	\$99,957.00	0.22%	0.44%	Extra/Unavoidable
3	\$35,000.00	Trans. Director	\$134,957.00	0.15%	0.59%	Extra/Unavoidable
3S1	\$40,000.00	Trans. Director	\$174,957.00	0.17%	0.76%	Extra/Unavoidable
5	\$50,590.94	Trans. Director	\$225,547.94	0.22%	0.99%	Extra/Unavoidable
4	\$57,633.61	Trans. Director	\$283,181.55	0.25%	1.24%	Extra/Unavoidable
6	\$237,366.90	Board Approval	\$520,548.45	1.04%	2.28%	Extra/Unavoidable
7	\$86,856.00	Trans. Director	\$607,404.45	0.38%	2.66%	Extra/Unavoidable
8	\$401,782.09	Board Approval	\$1,009,186.54	1.76%	4.41%	Extra/Unavoidable
11	\$5,812.97	Trans. Director	\$1,014,999.51	0.03%	4.44%	Extra/Unavoidable
12	<u>\$431,785.54</u>	Board Approval	\$1,446,785.05	<u>1.89%</u>	6.32%	Extra/Unavoidable
	\$1,446,785.05			6.32%		

New Authorized Contract Total \$24,322,358.75  
 Total CCO Dollars To Date \$1,446,785.05  
 Total % Increased by CCO's 6.32%