

**SUBMITTAL TO THE BOARD OF SUPERVISORS
COUNTY OF RIVERSIDE, STATE OF CALIFORNIA**

643A



FROM: TLMA - Transportation Department

SUBMITTAL DATE:
July 19, 2012

SUBJECT: Overpass Agreement between the County of Riverside and the BNSF Railway Company for the improvements to the I-215/Van Buren Boulevard Interchange Project

RECOMMENDED MOTION: That the Board approve and execute the attached Overpass Agreement between the County of Riverside (County) and BNSF Railway Company (BNSF) and authorize the Chairman to execute the same.

BACKGROUND: The proposed project consists of replacing and widening the Van Buren Boulevard freeway and railroad overcrossing structures, reconfiguration and signalization of the on and off ramps and adding auxiliary lanes on Interstate 215. The project will improve traffic capacity and operation of the interchange and provide for future traffic growth that is anticipated

Juan C. Perez
Director of Transportation and Land Management

Departmental Concurrence

(Continued On Attached Page)

FINANCIAL DATA	Current F.Y. Total Cost:	\$ 0	In Current Year Budget:	Yes
	Current F.Y. Net County Cost:	\$ 0	Budget Adjustment:	No
	Annual Net County Cost:	\$ 0	For Fiscal Year:	2012/2013

SOURCE OF FUNDS:

There are no General Funds used in this project.

Positions To Be Deleted Per A-30	<input type="checkbox"/>
Requires 4/5 Vote	<input type="checkbox"/>

C.E.O. RECOMMENDATION:

APPROVE

BY:

Tina Grande

County Executive Office Signature

FORM APPROVED COUNTY COUNSEL
BY: MARSHAL L. VICTOR
DATE: 7/19/12

Dep't Recomm.: Consent Policy

Per Exec. Ofc.: Consent Policy

Prev. Agn. Ref.

District: 1/1&
5/5

Agenda Number:

3.72

ATTACHMENTS FILED WITH THE CLERK OF THE BOARD

The Honorable Board of Supervisors

RE: Overpass Agreement between the County of Riverside and the BNSF Railway Company
for the improvements to the I-215/Van Buren Boulevard Interchange Project

July 19, 2012

Page 2 of 2

with the Meridian Business Park and re-use of the March Air Reserve Base.

BNSF is currently the operator of the rail corridor crossing under the existing Van Buren Bridge and as such, BNSF must grant the County a license to construct the new overcrossing structure. This agreement defines the terms and conditions for construction and maintenance of the Van Buren Boulevard railroad overcrossing structure.

The Riverside County Transportation Commission (RCTC) is in process of switching the rail operation to Southern California Regional Rail Authority (SCRRA) for the proposed Metrolink Perris Valley Line. That acquisition should be complete in the fall of 2012. On June 28, 2011 (item 3.109) the Board approved the Construction and Maintenance agreement with RCTC and SCRRA which is required for construction occurring after the RCTC transition is complete.

All costs associated with flagging and inspection of the new overpass are included in the I-215/Van Buren interchange construction contract. The construction for improvements to the I-215/Van Buren Boulevard Interchange Project began July 9, 2012.

Project No. B70798

OVERPASS AGREEMENT

Contract No. 12-07-003
Riverside Co. Transportation

BNSF File No. BF10003130
Van Buren Overpass Widening
U.S. D.O.T. No.027325M
LS 7605
MP10.64
San Jacinto Subdivision

This Agreement ("**Agreement**"), is executed to be effective as of _____ ("**Effective Date**"), by and between BNSF RAILWAY COMPANY, a Delaware corporation ("**BNSF**"), and the County of Riverside, a political subdivision of the State of California ("**AGENCY**").

RECITALS:

WHEREAS, BNSF operates a line of railroad in and through the County of Riverside, State of California;

WHEREAS, Agency desires to modify, reconstruct and widen the existing Van Buren Overhead Overpass on Interstate 215;

WHEREAS, BNSF has a freight easement for use of the Rail Corridor and is currently responsible for maintenance thereof pursuant to its Shared Use Agreement with the Riverside County Transportation Commission ("**Commission**"); and

WHEREAS, Agency and Commission have entered into a Design and Construction Cooperative Agreement, dated June 28, 2011 providing for the design and reconstruction and widening of the Van Buren Overhead portion of the Interstate Highway I-215 reconstruction project.

NOW, THEREFORE, in consideration of the mutual covenants and agreements of the parties contained herein, the receipt and sufficiency of which are hereby acknowledged, the parties agree as follows:

ARTICLE I) SCOPE OF WORK

1. The term "**Project**" as used herein includes any and all work related to the construction of the proposed Van Buren Overpass (hereinafter referred to as the "**Structure**"), more particularly described on the Exhibit A attached hereto and incorporated herein, including, but not limited to, any and all changes to telephone,

telegraph, signal and electrical lines and appurtenances, temporary and permanent track work, fencing, grading, alterations to or new construction of drainage facilities, preliminary and construction engineering and contract preparation. Additionally, temporary controls during construction must be in compliance with Section 8A-5, "Traffic Controls During Construction and Maintenance" of the Manual of Uniform Traffic Control Devices ("MUTCD"), U.S. Department of Transportation.

ARTICLE II) BNSF OBLIGATIONS

In consideration of the covenants of Agency set forth herein and the faithful performance thereof, BNSF agrees as follows:

1. BNSF will furnish all labor, materials, tools, and equipment for railroad work required for the construction of the Project, such railroad work and the estimated cost thereof being as shown on Exhibit D attached hereto and made a part hereof. In the event construction on the Project has not commenced within six (6) months following the Effective Date, BNSF may, in its sole and absolute discretion, revise the cost estimates set forth in said Exhibit D. In such event, the revised cost estimates will become a part of this Agreement as though originally set forth herein. Any item of work incidental to the items listed on Exhibit D not specifically mentioned therein may be included as a part of this Agreement upon written approval of Agency, which approval will not be unreasonably withheld. Construction of the Project must include the following railroad work by BNSF:

- (a) Procurement of materials, equipment and supplies necessary for the railroad work;
- (b) Preliminary engineering, design, and contract preparation;
- (c) Furnishing of flagging services during construction of the Project as required and set forth in further detail on Exhibit C;
- (d) Furnishing engineering and inspection as required in connection with the construction of the Project;
- (e) Providing a contract project coordinator, at Agency's expense, to serve as a project manager for the Project;

2. BNSF will do all railroad work set forth in Article II, Section 1 above on an actual cost basis, when BNSF, in its sole discretion, determines it is required by its labor agreements to perform such work with its own employees working under applicable collective bargaining agreements.

3. Agency agrees to reimburse BNSF for work of an emergency nature caused by Agency or Agency's contractor in connection with the Project which BNSF deems is reasonably necessary for the immediate restoration of railroad operations, or for the

protection of persons or BNSF property. Such work may be performed by BNSF without prior approval of Agency and Agency agrees to fully reimburse BNSF for all such emergency work.

4. BNSF may charge Agency for insurance expenses, including self-insurance expenses, when such expenses cover the cost of Employer's Liability (including, without limitation, liability under the Federal Employer's Liability Act) in connection with the construction of the Project. Such charges will be considered part of the actual cost of the Project, regardless of the nature or amount of ultimate liability for injury, loss or death to BNSF's employees, if any.

5. During the construction of the Project, BNSF will send Agency progressive invoices detailing the costs of the railroad work performed by BNSF under this Agreement. Agency must reimburse BNSF for completed force-account work within thirty (30) days of the date of the invoice for such work. Upon completion of the Project, BNSF will send Agency a detailed invoice of final costs, segregated as to labor and materials for each item in the recapitulation shown on Exhibit D. Pursuant to this section and Article IV, Section 7 herein, Agency must pay the final invoice within ninety (90) days of the date of the final invoice. BNSF will assess a finance charge of .033% per day (12% per annum) on any unpaid sums or other charges due under this Agreement which are past its credit terms. The finance charge continues to accrue daily until the date payment is received by BNSF, not the date payment is made or the date postmarked on the payment. Finance charges will be assessed on delinquent sums and other charges as of the end of the month and will be reduced by amounts in dispute and any unposted payments received by the month's end. Finance charges will be noted on invoices sent to Agency under this section. For purposes of computing the time limits prescribed by Section 911.2 of the California Government Code for the presentment of a claim against the Agency the cause of action for failure to reimburse BNSF for the costs of the Railroad work performed by it pursuant to this Agreement shall be deemed to have accrued one hundred and eighty (180) days from the date of the final invoice.

ARTICLE III) AGENCY OBLIGATIONS

In consideration of the covenants of BNSF set forth herein and the faithful performance thereof, Agency agrees as follows:

1. Agency must furnish to BNSF plans and specifications for the Project. Four sets of said plans (reduced size 11" x 17"), together with two copies of calculations, and two copies of specifications in **English Units**, must be submitted to BNSF for approval prior to commencement of any construction. BNSF will give Agency final written approval of the plans and specifications substantially in the form of Exhibit E, attached to this Agreement and made a part hereof. Upon BNSF's final written approval of the plans and specifications, said plans and specifications will become part of this Agreement and are hereby incorporated herein. Any approval of the plans and specifications by BNSF shall in no way obligate BNSF in any manner with respect to the finished product design

and/or construction. Any approval by BNSF shall mean only that the plans and specifications meet the subjective standards of BNSF, and such approval by BNSF shall not be deemed to mean that the plans and specifications or construction is structurally sound and appropriate or that such plans and specifications meet applicable regulations, laws, statutes or local ordinances and/or building codes.

2. Agency must make any required application and obtain all required permits and approvals for the construction of the Project.

3. Agency must provide for and maintain minimum vertical and horizontal clearances, as required in Exhibit C and as approved by BNSF as part of the plans and specifications for the Project.

4. Agency must acquire all rights of way necessary for the construction of the Project.

5. Agency must make any and all arrangements, in compliance with BNSF's Utility Accommodation Manual (<http://www.bnsf.com/communities/faqs/pdf/utility.pdf>), for the installation or relocation of wire lines, pipe lines and other facilities owned by private persons, companies, corporations, political subdivisions or public utilities other than BNSF which may be necessary for the construction of the Project..

6. Agency must construct the Project as shown on the attached Exhibit A and do all work ("Agency's Work") provided for in the plans and specifications for the Project, except railroad work that will be performed by BNSF hereunder. Agency must furnish all labor, materials, tools and equipment for the performance of Agency's Work. The principal elements of Agency's Work are as follows:

- (a) Construction of the Structure;
- (b) All necessary grading and paving, including backfill of excavations and restoration of disturbed vegetation on BNSF's right-of-way;
- (c) Provide suitable drainage, both temporary and permanent;
- (d) Provide appropriate pedestrian control during construction;
- (e) Installation and maintenance of an 8-ft. high fence and/or concrete combination (throw fence) on the outside barrier of the Structure;
- (f) Job site cleanup including removal of all construction materials, concrete debris, surplus soil, refuse, contaminated soils, asphalt debris, litter and other waste materials to the satisfaction of BNSF;

7. Agency must apply and maintain said D.O.T. Crossing number 027325M, and the Public Utility Commission Crossing number _____ in a conspicuous location on the Structure.

8. Agency's Work must be performed by Agency or Agency's contractor in a manner that will not endanger or interfere with the safe and timely operations of BNSF and its facilities.

9. For any future inspection, construction or maintenance, either routine or otherwise, performed by subcontractors on behalf of the Agency, Agency shall require its subcontractors to comply with the provisions of the attached Exhibit C and execute the letter agreement attached hereto As Exhibit C-1. Prior to performing any activities on BNSF property or near BNSF tracks with its own personnel, Agency shall: (i) comply with all of BNSF's applicable safety rules and regulations; (ii) require any Agency employee working on BNSF property or near BNSF tracks to complete the safety training program at the BNSF's Internet Website "www.contractororientation.com"; and (iii) notify BNSF when, pursuant to the requirements of Exhibit C, a flagger is required to be present; procure, and have approved by BNSF's Risk Management Department, Railroad Protective Liability insurance.

10. Agency must require its contractor(s) to notify BNSF's Roadmaster at least thirty (30) calendar days prior to requesting a BNSF flagman in accordance with the requirements of Exhibit C attached hereto. Additionally, Agency must require its contractor(s) to notify BNSF's Manager of Public Projects thirty (30) calendar days prior to commencing work on BNSF property or near BNSF tracks.

11. Agency or its contractor(s) must submit four (4) copies of any plans (including two sets of calculations in **English Units**) for proposed shoring, falsework or cribbing to be used over, under, or adjacent to BNSF's tracks to BNSF's Manager of Public Projects for approval. The shoring, falsework or cribbing used by Agency's contractor shall comply with the BNSF Bridge Requirements set forth on Exhibit F and all applicable requirements promulgated by state and federal agencies, departments, commissions and other legislative bodies. If necessary, Agency must submit for approval two (2) copies of a professionally engineered demolition plan with applicable calculations to BNSF's Manager of Public Projects. The existing Van Buren Overpass will not be removed until BNSF approves Agency's demolition plan in writing.

12. Agency must include the following provisions in any contract with its contractor(s) performing work on said Project:

- (a) The Provider is placed on notice that fiber optic, communication and other cable lines and systems (collectively, the "Lines") owned by various telecommunications companies may be buried on BNSF's property or right-of-way. The locations of these Lines have been included on the plans based on information from the telecommunications companies. The Provider will be responsible for contacting BNSF's Engineering Representative – Greg Rousseau (909-386-4079), BNSF's Signal Representative – Dennis Skeels (909-386-4053) and the telecommunications companies and notifying them of any work that may damage these Lines or facilities and/or interfere with their service. The Provider must also mark all Lines shown on the plans or marked in the field in order to verify their locations. The

Provider must also use all reasonable methods when working in the BNSF right-of-way or on BNSF property to determine if any other Lines (fiber optic, cable, communication or otherwise) may exist.

- (b) The Provider will be responsible for the rearrangement of any facilities or Lines determined to interfere with the construction. The Provider must cooperate fully with any telecommunications company(ies) in performing such rearrangements.
- (c) Failure to mark or identify these Lines will be sufficient cause for BNSF's engineering representative (Greg Rousseau (909-386-4079)) to stop construction at no cost to the Agency or BNSF until these items are completed.
- (d) In addition to the liability terms contained elsewhere in this Agreement, the Provider hereby indemnifies, defends and holds harmless BNSF for, from and against all cost, liability, and expense whatsoever (including, without limitation, attorney's fees and court costs and expenses) arising out of or in any way contributed to by any act or omission of Provider, its subcontractors, agents and/or employees that cause or in any way or degree contribute to (1) any damage to or destruction of any Lines by Provider, and/or its subcontractors, agents and/or employees, on BNSF's property or within BNSF's right-of-way, (2) any injury to or death of any person employed by or on behalf of any telecommunications company, and/or its contractor, agents and/or employees, on BNSF's property or within BNSF's right-of-way, and/or (3) any claim or cause of action for alleged loss of profits or revenue by, or loss of service by a customer or user of such telecommunication company(ies). **THE LIABILITY ASSUMED BY PROVIDER WILL NOT BE AFFECTED BY THE FACT, IF IT IS A FACT, THAT THE DAMAGE, DESTRUCTION, INJURY, DEATH, CAUSE OF ACTION OR CLAIM WAS OCCASIONED BY OR CONTRIBUTED TO BY THE NEGLIGENCE OF BNSF, ITS AGENTS, SERVANTS, EMPLOYEES OR OTHERWISE, EXCEPT TO THE EXTENT THAT SUCH CLAIMS ARE PROXIMATELY CAUSED BY THE WILLFUL MISCONDUCT OR SOLE NEGLIGENCE OF BNSF.**

13. Agency must require compliance with the obligations set forth in this agreement, including Exhibit C and Exhibit C-1, and incorporate in each prime contract for construction of the Project, or the specifications therefore (i) the provisions set forth in Article III; (ii) the provisions set forth in Article IV; and (iii) the provisions set forth in Exhibit C and Exhibit C-1, attached hereto and by reference made a part hereof.

14. Except as otherwise provided below in this Section 14, all construction work performed hereunder by Agency for the Project will be pursuant to a contract or contracts to be let by Agency, and all such contracts must include the following:

- (a) All work performed under such contract or contracts within the limits of BNSF's right-of-way must be performed in a good and workmanlike manner in accordance with plans and specifications approved by BNSF;
- (b) Changes or modifications during construction that affect safety or BNSF operations must be subject to BNSF's approval;
- (c) No work will be commenced within BNSF's right-of-way until each of the prime contractors employed in connection with said work must have (i) executed and delivered to BNSF a letter agreement in the form of Exhibit C-1, and (ii) delivered to and secured BNSF's approval of the required insurance; and
- (d) To facilitate scheduling for the Project, Agency shall have its contractor give BNSF's representative Greg Rousseau (909-386-4079) 30 calendar days advance notice of the proposed times and dates for work windows. BNSF and Agency's contractor will establish mutually agreeable work windows for the Project. BNSF has the right at any time to revise or change the work windows, due to train operations or service obligations. BNSF will not be responsible for any additional costs and expenses resulting from a change in work windows. Additional costs and expenses resulting from a change in work windows shall be accounted for in the contractor's expenses for the Project.
- (e) The plans and specifications for the Project must be in compliance with the Bridge Requirements set forth on Exhibit F, attached to this Agreement and incorporated herein.

15. Agency must advise the appropriate BNSF Manager of Public Projects, in writing, of the completion date of the Project within thirty (30) days after such completion date. Additionally, Agency must notify BNSF's Manager of Public Projects, in writing, of the date on which Agency and/or its Contractor will meet with BNSF for the purpose of making final inspection of the Project.

16. TO THE FULLEST EXTENT PERMITTED BY LAW, AGENCY HEREBY RELEASES, INDEMNIFIES, DEFENDS AND HOLDS HARMLESS BNSF, ITS AFFILIATED COMPANIES, PARTNERS, SUCCESSORS, ASSIGNS, LEGAL REPRESENTATIVES, OFFICERS, DIRECTORS, SHAREHOLDERS, EMPLOYEES AND AGENTS FOR, FROM AND AGAINST ANY AND ALL CLAIMS, LIABILITIES, FINES, PENALTIES, COSTS, DAMAGES, LOSSES, LIENS, CAUSES OF ACTION, SUITS, DEMANDS, JUDGMENTS AND EXPENSES (INCLUDING, WITHOUT LIMITATION, COURT COSTS AND ATTORNEYS' FEES) OF ANY NATURE, KIND OR DESCRIPTION OF ANY PERSON (INCLUDING, WITHOUT LIMITATION, THE EMPLOYEES OF THE PARTIES HERETO) OR ENTITY DIRECTLY OR INDIRECTLY ARISING OUT OF, RESULTING FROM OR RELATED TO (IN WHOLE OR IN PART) (I) THE USE, OCCUPANCY OR PRESENCE OF AGENCY, ITS CONTRACTORS, SUBCONTRACTORS, EMPLOYEES OR AGENTS IN, ON, OR ABOUT THE CONSTRUCTION SITE, (II) THE PERFORMANCE, OR FAILURE TO PERFORM BY

THE AGENCY, ITS CONTRACTORS, SUBCONTRACTORS, EMPLOYEES, OR AGENTS, ITS WORK OR ANY OBLIGATION UNDER THIS AGREEMENT, (III) THE SOLE OR CONTRIBUTING ACTS OR OMISSIONS OF AGENCY, ITS CONTRACTORS, SUBCONTRACTORS, EMPLOYEES, OR AGENTS IN, ON, OR ABOUT THE CONSTRUCTION SITE, (IV) AGENCY'S OCCUPATION AND USE OF BNSF'S PROPERTY OR RIGHT-OF-WAY, INCLUDING, WITHOUT LIMITATION, SUBSEQUENT MAINTENANCE OF THE STRUCTURE BY AGENCY, OR (V) AN ACT OR OMISSION OF AGENCY OR ITS OFFICERS, AGENTS, INVITEES, EMPLOYEES OR CONTRACTORS OR ANYONE DIRECTLY OR INDIRECTLY EMPLOYED BY ANY OF THEM, OR ANYONE THEY CONTROL OR EXERCISE CONTROL OVER. THE LIABILITY ASSUMED BY AGENCY WILL NOT BE AFFECTED BY THE FACT, IF IT IS A FACT, THAT THE DAMAGE, DESTRUCTION, INJURY OR DEATH WAS OCCASIONED BY OR CONTRIBUTED TO BY THE NEGLIGENCE OF BNSF, ITS AGENTS, SERVANTS, EMPLOYEES OR OTHERWISE, EXCEPT TO THE EXTENT THAT SUCH CLAIMS ARE PROXIMATELY CAUSED BY THE WILLFUL MISCONDUCT OR SOLE NEGLIGENCE OF BNSF.

17. Agency must give BNSF's Manager of Public Projects written notice to proceed ("**Notice to Proceed**") with the railroad work after receipt of necessary funds for the Project. BNSF will not begin the railroad work (including, without limitation, procurement of supplies, equipment or materials) until written notice to proceed is received from Agency.

ARTICLE IV) JOINT OBLIGATIONS

IN CONSIDERATION of the premises, the parties hereto mutually agree to the following:

1. All work contemplated in this Agreement must be performed in a good and workmanlike manner and each portion must be promptly commenced by the party obligated hereunder to perform the same and thereafter diligently prosecuted to conclusion in its logical order and sequence. Furthermore, any changes or modifications during construction which affect BNSF will be subject to BNSF's written approval prior to the commencement of any such changes or modifications from the Greg Rousseau (909-386-4079).

2. The work hereunder must be done in accordance with the Bridge Requirements set forth on Exhibit F and the detailed plans and specifications approved by BNSF.

3. Agency must require its contractor(s) to reasonably adhere to the Project's construction schedule for all Project work. The parties hereto mutually agree that BNSF's failure to complete the railroad work in accordance with the construction schedule due to inclement weather or unforeseen railroad emergencies will not constitute a breach of this Agreement by BNSF and will not subject BNSF to any liability. Regardless of the requirements of the construction schedule, BNSF reserves the right to reallocate the labor forces assigned to complete the railroad work in the

event of an emergency to provide for the immediate restoration of railroad operations (BNSF or its related railroads) or to protect persons or property on or near any BNSF owned property. BNSF will not be liable for any additional costs or expenses resulting from any such reallocation of its labor forces. The parties mutually agree that any reallocation of labor forces by BNSF pursuant to this provision and any direct or indirect consequences or costs resulting from any such reallocation will not constitute a breach of this Agreement by BNSF.

4. BNSF will have the right to stop construction work on the Project if any of the following events take place: (i) Agency (or any of its contractors) performs the Project work in a manner contrary to the plans and specifications approved by BNSF; (ii) Agency (or any of its contractors), in BNSF's opinion, prosecutes the Project work in a manner which is hazardous to BNSF property, facilities or the safe and expeditious movement of railroad traffic; or (iii) the insurance described in the attached Exhibit C-1 is canceled during the course of the Project. The work stoppage will continue until all necessary actions are taken by Agency or its contractor to rectify the situation to the satisfaction of BNSF's Division Engineer or until additional insurance has been delivered to and accepted by BNSF. In the event of a breach of this Agreement, BNSF may immediately terminate the Agreement. Any such work stoppage under this provision will not give rise to any liability on the part of BNSF. BNSF's right to stop the work is in addition to any other rights BNSF may have including, but not limited to, actions or suits for damages or lost profits. In the event that BNSF desires to stop construction work on the Project, BNSF agrees to immediately notify the following individual in writing:

Patricia Romo, P.E.
Deputy Director Transportation
County of Riverside
Transportation Department
4080 Lemon Street, 8th floor
Riverside, CA 92501
Phone: (951)955-6740
Fax: (951)955-3198
E-mail: PROMO@rctlma.org

Agency must supervise and inspect the operations of all Agency contractors to assure compliance with the plans and specifications approved by BNSF, the terms of this Agreement and all safety requirements of the BNSF railroad. If BNSF determines that proper supervision and inspection is not being performed by Agency personnel at any time during construction of the Project, BNSF has the right to stop construction (within or adjacent to its operating right-of-way). Construction of the Project will not proceed until Agency corrects the situation to BNSF's reasonable satisfaction. If BNSF feels the situation is not being corrected in an expeditious manner, BNSF will immediately notify the County of Riverside for appropriate corrective action.

7. Pursuant to this section and Article II, Section 5 herein, Agency must reimburse BNSF in full for the actual costs of all work performed by BNSF under this Agreement.

In any action brought under this Agreement, the prevailing Party shall be entitled to recover its actual costs and attorneys fees pursuant to California Civil Code Section 1717, as well as other litigation costs, including expert witness fees. The prevailing Party shall also be entitled to recover all actual attorneys fees and litigation costs incurred in connection with the enforcement of a judgment arising from such action or proceeding.]

8. All expenses detailed in statements sent to Agency pursuant to Article II, Section 5 herein will comply with the terms and provisions of the Federal Aid Highway Program Manual, U.S. Department of Transportation, as amended from time to time, which manual is hereby incorporated into and made a part of this Agreement by reference. The parties mutually agree that BNSF's preliminary engineering, design, and contract preparation costs described in Article II, Section 1 herein are part of the costs of the Project even though such work may have preceded the date of this Agreement.

9. The parties mutually agree that no construction activities for the Project, nor future maintenance of the Structure once completed, will be permitted during the fourth quarter of each calendar year. Emergency work will be permitted only upon prior notification to BNSF's Network Operations Center (telephone number: 800 832-5452). The parties hereto mutually understand and agree that trains cannot be subjected to delay during this time period.

10. Subject to the restrictions imposed by Article IV, Section 9 above, the construction of the Project will not commence until Agency gives BNSF's Manager of Public Projects thirty (30) days prior written notice of such commencement. The commencement notice will reference D.O.T. Crossing No. 027325M and must state the time that construction activities will begin.

11. In addition to the terms and conditions set forth elsewhere in this Agreement, including, but not limited to, the terms and conditions stated in Exhibit F, BNSF and Agency agree to the following terms upon completion of construction of the Project:

- (a) Agency will own and maintain, at its sole cost and expense, the Structure, the highway approaches, and appurtenances thereto, lighting, drainage and any access roadways to BNSF gates installed pursuant to this Agreement. BNSF may, at its option, perform maintenance on the Structure in order to avoid conflicts with train operations. BNSF will notify Agency prior to performing any such maintenance on the Structure. In the event such maintenance involves emergency repairs, BNSF will notify Agency at its earliest opportunity. Agency must fully reimburse BNSF for the costs of maintenance performed by BNSF pursuant to this subsection
- (b).
- (b) Agency must, at Agency's sole cost and expense, keep the Structure painted and free from graffiti.
- (c) Agency must provide BNSF with any and all necessary permits and maintain roadway traffic controls, at no cost to BNSF, whenever requested

by BNSF to allow BNSF to inspect the Structure or to make emergency repairs thereto.

- (d) It is expressly understood by Agency and BNSF that any right to install utilities will be governed by a separate permit or license agreement between the parties hereto.
- (e) Agency must keep the Structure and surrounding areas clean and free from birds, pigeons, scavengers, vermin, creatures and other animals.
- (f) If Agency (including its contractors and agents) or BNSF, on behalf of Agency, performs (i) alterations or modifications to the Structure, or (ii) any maintenance or other work on the Structure with heavy tools, equipment or machinery at ground surface level horizontally within 25'-0" of the centerline of the nearest track, or (iii) any maintenance or other work outside the limits of the deck of the Structure vertically above the top of the rail, then Agency or its contractors and/or agents must procure and maintain the following insurance coverage:

Railroad Protective Liability insurance naming only the **Railroad** as the Insured with coverage of at least \$5,000,000 per occurrence and \$10,000,000 in the aggregate. The policy must be issued on a standard ISO form CG 00 35 12 04 and include the following:

- ◆ Endorsed to include the Pollution Exclusion Amendment (ISO form CG 28 31 10 93)
- ◆ Endorsed to include the Limited Seepage and Pollution Endorsement.
- ◆ Endorsed to remove any exclusion for punitive damages.
- ◆ No other endorsements restricting coverage may be added.
- ◆ The original policy must be provided to the **Railroad** prior to performing any work or services under this Agreement

As used in this paragraph, "**Railroad**" means "Burlington Northern Santa Fe, LLC", "BNSF RAILWAY COMPANY" and the subsidiaries, successors, assigns and affiliates of each.

In lieu of providing a Railroad Protective Liability Policy, Agency may participate in BNSF's Blanket Railroad Protective Liability Insurance Policy **if available** to Agency or its contractors. The limits of coverage are the same as above.

12. Agency hereby grants to BNSF, at no cost or expense to BNSF, a permanent right of access from Agency property to BNSF tracks for maintenance purposes.

13. Agency must provide one set of as built plans (prepared in **English Units**) to BNSF, as well as one set of computer diskettes containing as built CAD drawings of the Structure and identifying the software used for the CAD drawings. The "as built plans" must comply with the Bridge Requirements set forth on Exhibit F and depict all information in BNSF engineering stationing and mile post pluses. The "as built plans"

must also include plan and profile, structural bridge drawings and specifications, and drainage plans. All improvements and facilities must be shown.

14. Subject to the restrictions imposed by Article IV, Section 9 above and in accordance with the requirements of Article III, Section 9 above, Agency must notify and obtain prior authorization from BNSF's Manager of Public Projects before entering BNSF's right-of-way for **INSPECTION OR MAINTENANCE** purposes, and the BNSF Manager of Public Projects will determine if flagging is required. If the construction work hereunder is contracted, Agency must require its prime contractor(s) to comply with the obligations set forth in Exhibit C and Exhibit C-1, as the same may be revised from time to time. Agency will be responsible for its contractor(s) compliance with such obligations.

15. BNSF may, at its expense, make future changes or additions to the railroad components of the Structure if necessary or desirable, in BNSF's sole discretion, including, without limitation the following: (i) the right to raise or lower the grade or change the alignment of its tracks, (ii) the right to lay additional track or tracks, or (iii) the right to build other facilities in connection with the operation of its railroad. Such changes or additions must not change or alter the highway components of the Structure. If it becomes necessary or desirable in the future to change, alter, widen or reconstruct the highway components of the Structure to accommodate railroad projects, the cost of such work, including any cost incidental to alteration of railroad or highway facilities made necessary by any such changes to the Structure, will be the sole responsibility of the Agency.

16. Agency may, at Agency's sole expense, alter or reconstruct the highway components of the Structure if necessary or desirable, due to traffic conditions or pedestrian or other recreational traffic, provided, however, that any such alteration or reconstruction must not encroach further upon or occupy the surface of BNSF's right-of-way to a greater extent than is contemplated by the plans and specifications to be approved by BNSF pursuant to Article III, Section 1 herein, without obtaining BNSF's prior written consent and the execution of a supplement to this Agreement or the completion of a separate agreement.

17. Any books, papers, records and accounts of the parties hereto relating to the work hereunder or the costs or expenses for labor and material connected with the construction will at all reasonable times be open to inspection and audit by the agents and authorized representatives of the parties hereto, as well as the State of California and the Federal Highway Administration, for a period of one (1) year from the date of the final BNSF invoice under this Agreement.

18. The covenants and provisions of this Agreement are binding upon and inure to the benefit of the successors and assigns of the parties hereto. Notwithstanding the preceding sentence, neither party hereto may assign any of its rights or obligations hereunder without the prior written consent of the other party.

19. In the event construction of the Project does not commence within two (2) years of the Effective Date, this Agreement will become null and void.

20. Neither termination nor expiration of this Agreement will release either party from any liability or obligation under this Agreement, whether of indemnity or otherwise, resulting from any acts, omissions or events happening prior to the date of termination or expiration.

21. To the maximum extent possible, each provision of this Agreement will be interpreted in such a manner as to be effective and valid under applicable law. If any provision of this Agreement is prohibited by, or held to be invalid under, applicable law, such provision will be ineffective solely to the extent of such prohibition or invalidity and the remainder of the provision will be enforceable.

22. This Agreement (including exhibits and other documents, manuals, etc. incorporated herein) is the full and complete agreement between BNSF and Agency with respect to the subject matter herein and supersedes any and all other prior agreements between the parties hereto.

23. This Agreement may be executed in duplicate originals, each of which is deemed to be an original.

24. Any notice provided for herein or concerning this Agreement must be in writing and will be deemed sufficiently given when sent by certified mail, return receipt requested, to the parties at the following addresses:

BNSF Railway Company:
BNSF's Manager of Public Projects
740 East Carnegie Drive
San Bernardino, CA 92408

Agency:
Patricia Romo, P.E.
Deputy Director Transportation
County of Riverside
Transportation Department
4080 Lemon Street, 8th floor
Riverside, CA 92501

IN WITNESS WHEREOF, the parties hereto have caused this Agreement to be executed and attested by its duly qualified and authorized officials as of the day and year first above written.

BNSF RAILWAY COMPANY

By: _____

Printed Name: Lyn Hartley

Title: Director Public Projects

WITNESS:

AGENCY

COUNTY OF RIVERSIDE

RECOMMENDED:

_____ Date _____

JUAN C. PEREZ

Director of Transportation and Land Management

APPROVED AS TO FORM:

PAMELA J. WALLS, COUNTY COUNSEL

Pamela J. Walls Date 7/16/12
By Deputy

APPROVAL BY THE BOARD OF SUPERVISORS:

_____ Date _____

PRINTED NAME

Chairman, Riverside County Board of Supervisors

ATTEST:

_____ Date _____
KECIA HARPER-IHEM
Clerk of the Board

Exhibit A

(drawing of the project – plan/profile, drawing as a whole)

Exhibit B

(intentionally left blank)

Exhibit C & C1

See attached

EXHIBIT "C"

To Construction and Maintenance Agreement

CONTRACTOR REQUIREMENTS

Van Buren Overpass Widening

1.01 General

- **1.01.01** The Contractor must cooperate with **BNSF RAILWAY COMPANY**, hereinafter referred to as "Railway" where work is over or under on or adjacent to Railway property and/or right-of-way, hereafter referred to as "Railway Property", during the County of Riverside's ("County") widening and improvement of Interstate 215 and the Van Buren Overpass, U.S. D.O.T. No. 027325M, BNSF MP 10.64, and Line Segment 7605 on BNSF's San Jacinto Subdivision.
- **1.01.02** The Contractor must execute and deliver to the Railway duplicate copies of the Exhibit C-1 Agreement, in the form attached hereto, obligating the Contractor to provide and maintain in full force and effect the insurance called for under Section 3 of said Exhibit C-1. Questions regarding procurement of the Railroad Protective Liability Insurance should be directed to Rosa Martinez at Marsh, USA, 214-303-8519.
- **1.01.03** The Contractor must plan, schedule and conduct all work activities so as not to interfere with the movement of any trains on Railway Property.
- **1.01.04** The Contractor's right to enter Railway's Property is subject to the absolute right of Railway to cause the Contractor's work on Railway's Property to cease if, in the opinion of Railway, Contractor's activities create a hazard to Railway's Property, employees, and/or operations. Railway will have the right to stop construction work on the Project if any of the following events take place: (i) Contractor (or any of its subcontractors) performs the Project work in a manner contrary to the plans and specifications approved by Railway; (ii) Contractor (or any of its subcontractors), in Railway's opinion, prosecutes the Project work in a manner which is hazardous to Railway property, facilities or the safe and expeditious movement of railroad traffic; (iii) the insurance described in the attached Exhibit C-1 is canceled during the course of the Project; or (iv) COUNTY fails to pay Railway for the Temporary Construction License or the Easement. The work stoppage will continue until all necessary actions are taken by Contractor or its subcontractor to rectify the situation to the satisfaction of Railway's Division Engineer or until additional insurance has been delivered to and accepted by Railway. In the event of a breach of (i) the Exhibit C-1 Agreement, (ii) the Temporary Construction License, or (iii) the Easement, Railway may immediately terminate the Temporary Construction License or the Easement. Any such work stoppage under this provision will not give rise to any liability on the part of Railway. Railway's right to stop the work is in addition to any other rights Railway may have including, but not limited to, actions or suits for damages or lost profits. In the event that Railway desires to stop construction work on the Project, Railway agrees to immediately notify the following individual in writing:

Patricia Romo, P.E.
Deputy Director Transportation
County of Riverside
Transportation Department
4080 Lemon Street, 8th floor
Riverside, CA 92501
Phone: (951)955-6740
Fax: (951)955-3198
E-mail: PROMO@rctlma.org

- **1.01.05** The Contractor is responsible for determining and complying with all Federal, State and Local Governmental laws and regulations, including, but not limited to environmental laws and regulations (including but not limited to the Resource Conservation and Recovery Act, as amended; the Clean Water Act, the Oil Pollution Act, the Hazardous Materials Transportation Act, CERCLA), and health and safety laws and regulations. The Contractor hereby indemnifies, defends and holds harmless Railway for, from and against all fines or penalties imposed or assessed by Federal, State and Local Governmental Agencies against the Railway which arise out of Contractor's work under the Exhibit C-1 Agreement.
- **1.01.06** The Contractor must notify Patricia Romo, hereinafter referred to as ("**County**") and Railway's Manager Public Projects, telephone number 909-386-4472 at least thirty (30) calendar days before commencing any work on Railway Property. Contractor's notification to Railway must refer to Railway's file BF10003130.
- **1.01.07** For any bridge demolition and/or falsework above any tracks or any excavations located with any part of the excavations located within, whichever is greater, twenty-five (25) feet of the nearest track or intersecting a slope from the plane of the top of rail on a 2 horizontal to 1 vertical slope beginning at eleven (11) feet from centerline of the nearest track, both measured perpendicular to center line of track, the Contractor must furnish the Railway five sets of working drawings showing details of construction affecting Railway Property and tracks. The working drawing must include the proposed method of installation and removal of falsework, shoring or cribbing, not included in the contract plans and two sets of structural calculations of any falsework, shoring or cribbing. For all excavation and shoring submittal plans, the current "BNSF-UPRR Guidelines for Temporary Shoring" must be used for determining the design loading conditions to be used in shoring design, and all calculations and submittals must be in accordance with the current "BNSF-UPRR Guidelines for Temporary Shoring". All submittal drawings and calculations must be stamped by a registered professional engineer licensed to practice in the state the project is located. All calculations must take into consideration railway surcharge loading and must be designed to meet American Railway Engineering and Maintenance-of-Way Association (previously known as American Railway Engineering Association) Coopers E-80 live loading standard. All drawings and calculations must be stamped by a registered professional engineer licensed to practice in the state the project is located. The Contractor must not begin work until notified by the Railway that plans have been approved. The Contractor will be required to use lifting devices such as, cranes and/or winches to place or to remove any falsework over Railway's tracks. In no case will the Contractor be relieved of responsibility for results obtained by the implementation of said approved plans.

- **1.01.08** Subject to the movement of Railway's trains, Railway will cooperate with the Contractor such that the work may be handled and performed in an efficient manner. The Contractor will have no claim whatsoever for any type of damages or for extra or additional compensation in the event his work is delayed by the Railway.

1.02 Contractor Safety Orientation

- **1.02.01** No employee of the Contractor, its subcontractors, agents or invitees may enter Railway Property without first having completed Railway's Engineering Contractor Safety Orientation, found on the web site www.contractororientation.com. The Contractor must ensure that each of its employees, subcontractors, agents or invitees completes Railway's Engineering Contractor Safety Orientation through internet sessions before any work is performed on the Project. Additionally, the Contractor must ensure that each and every one of its employees, subcontractors, agents or invitees possesses a card certifying completion of the Railway Contractor Safety Orientation before entering Railway Property. The Contractor is responsible for the cost of the Railway Contractor Safety Orientation. The Contractor must renew the Railway Contractor Safety Orientation annually. Further clarification can be found on the web site or from the Railway's Representative.

1.03 Railway Requirements

- **1.03.01** The Contractor must take protective measures as are necessary to keep railway facilities, including track ballast, free of sand, debris, and other foreign objects and materials resulting from his operations. Any damage to railway facilities resulting from Contractor's operations will be repaired or replaced by Railway and the cost of such repairs or replacement must be paid for by County.
- **1.03.02** The Contractor must notify the Railway's Division Engineer at 909-386-4504 and provide blasting plans to the Railway for review seven (7) calendar days prior to conducting any blasting operations adjacent to or on Railway's Property.
- **1.03.03** The Contractor must abide by the following temporary clearances during construction:
 - 15'-0" Horizontally from centerline of nearest track
 - 21'-6" Vertically above top of rail
 - 27'-0" Vertically above top of rail for electric wires carrying less than 750 volts
 - 28'-0" Vertically above top of rail for electric wires carrying 750 volts to 15,000 volts
 - 30'-0" Vertically above top of rail for electric wires carrying 15,000 volts to 20,000 volts
 - 34'-0" Vertically above top of rail for electric wires carrying more than 20,000 volts
- **1.03.04** Upon completion of construction, the following clearances shall be maintained:
 - 25' Horizontally from centerline of nearest track
 - 24.5' Vertically above top of rail

- **1.03.05** Any infringement within State statutory clearances due to the Contractor's operations must be submitted to the Railway and to County and must not be undertaken until approved in writing by the Railway, and until the County has obtained any necessary authorization from the State Regulatory Authority for the infringement. No extra compensation will be allowed in the event the Contractor's work is delayed pending Railway approval, and/or the State Regulatory Authority's approval.
- **1.03.06** In the case of impaired vertical clearance above top of rail, Railway will have the option of installing tell-tales or other protective devices Railway deems necessary for protection of Railway operations. The cost of tell-tales or protective devices will be borne by County.
- **1.03.07** The details of construction affecting the Railway's Property and tracks not included in the contract plans must be submitted to the Railway by COUNTY for approval before work is undertaken and this work must not be undertaken until approved by the Railway.
- **1.03.08** At other than public road crossings, the Contractor must not move any equipment or materials across Railway's tracks until permission has been obtained from the Railway. The Contractor must obtain a "Temporary Construction Crossing Agreement" from the Railway prior to moving his equipment or materials across the Railways tracks. The temporary crossing must be gated and locked at all times when not required for use by the Contractor. The temporary crossing for use of the Contractor will be constructed and, at the completion of the project, removed at the expense of the Contractor.
- **1.03.09** Discharge, release or spill on the Railway Property of any hazardous substances, oil, petroleum, constituents, pollutants, contaminants, or any hazardous waste is prohibited and Contractor must immediately notify the Railway's Resource Operations Center at 1(800) 832-5452, of any discharge, release or spills in excess of a reportable quantity. Contractor must not allow Railway Property to become a treatment, storage or transfer facility as those terms are defined in the Resource Conservation and Recovery Act or any state analogue.
- **1.03.10** The Contractor upon completion of the work covered by this contract, must promptly remove from the Railway's Property all of Contractor's tools, equipment, implements and other materials, whether brought upon said property by said Contractor or any Subcontractor, employee or agent of Contractor or of any Subcontractor, and must cause Railway's Property to be left in a condition acceptable to the Railway's representative.

1.04 Contractor Roadway Worker on Track Safety Program and Safety Action Plan

- **1.04.01** Each Contractor that will perform work within 25 feet of the centerline of a track must develop and implement a Roadway Worker Protection/On Track Safety Program and work with Railway Project Representative to develop an on track safety strategy as described in the guidelines listed in the on track safety portion of the Safety Orientation. This Program must provide Roadway Worker protection/on track training for all employees of the Contractor, its subcontractors, agents or invitees. This training is reinforced at the job site through job safety briefings. Additionally, each Contractor must develop and implement the Safety Action Plan, as provided for on the web site www.contractororientation.com, which will be made available to Railway prior to commencement of any work on Railway Property.

During the performance of work, the Contractor must audit its work activities. The Contractor must designate an on-site Project Supervisor who will serve as the contact person for the Railway and who will maintain a copy of the Safety Action Plan, safety audits, and Material Safety Datasheets (MSDS), at the job site.

1.05 Railway Flagger Services:

- **1.05.01** The Contractor must give Railway's **Roadmaster (telephone 909-386-4061)** a minimum of thirty (30) calendar days advance notice when flagging services will be required so that the Roadmaster can make appropriate arrangements (i.e., bulletin the flagger's position). If flagging services are scheduled in advance by the Contractor and it is subsequently determined by the parties hereto that such services are no longer necessary, the Contractor must give the Roadmaster five (5) working days advance notice so that appropriate arrangements can be made to abolish the position pursuant to union requirements.
- **1.05.02** Unless determined otherwise by Railway's Project Representative, Railway flagger will be required and furnished when Contractor's work activities are located over, under and/or within twenty-five (25) feet measured horizontally from centerline of the nearest track and when cranes or similar equipment positioned beyond 25-feet from the track centerline could foul the track in the event of tip over or other catastrophic occurrence, but not limited thereto for the following conditions:
 - **1.05.02a** When, upon inspection by Railway's Representative, other conditions warrant.
 - **1.05.02b** When any excavation is performed below the bottom of tie elevation, if, in the opinion of Railway's representative, track or other Railway facilities may be subject to movement or settlement.
 - **1.05.02c** When work in any way interferes with the safe operation of trains at timetable speeds.
 - **1.05.02d** When any hazard is presented to Railway track, communications, signal, electrical, or other facilities either due to persons, material, equipment or blasting in the vicinity.
 - **1.05.02e** Special permission must be obtained from the Railway before moving heavy or cumbersome objects or equipment which might result in making the track impassable.
- **1.05.03** Flagging services will be performed by qualified Railway flaggers.
 - **1.05.03a** Flagging crew generally consists of one employee. However, additional personnel may be required to protect Railway Property and operations, if deemed necessary by the Railways Representative.
 - **1.05.03b** Each time a flagger is called, the minimum period for billing will be the eight (8) hour basic day.

- **1.05.03c** The cost of flagger services provided by the Railway will be borne by **COUNTY**. The estimated cost for one (1) flagger is approximately between \$800.00-\$1,600.00 for an eight (8) hour basic day with time and one-half or double time for overtime, rest days and holidays. The estimated cost for each flagger includes vacation allowance, paid holidays, Railway and unemployment insurance, public liability and property damage insurance, health and welfare benefits, vehicle, transportation, meals, lodging, radio, equipment, supervision and other costs incidental to performing flagging services. Negotiations for Railway labor or collective bargaining agreements and rate changes authorized by appropriate Federal authorities may increase actual or estimated flagging rates. **THE FLAGGING RATE IN EFFECT AT THE TIME OF PERFORMANCE BY THE CONTRACTOR HEREUNDER WILL BE USED TO CALCULATE THE ACTUAL COSTS OF FLAGGING PURSUANT TO THIS PARAGRAPH.**
- **1.05.03d** The current average train traffic on this route is 6 freight trains at 30 MPH and 0 passenger trains.

1.06 Contractor General Safety Requirements

- **1.06.01** Work in the proximity of railway track(s) is potentially hazardous where movement of trains and equipment can occur at any time and in any direction. All work performed by contractors within 25 feet of any track must be in compliance with FRA Roadway Worker Protection Regulations.
- **1.06.02** Before beginning any task on Railway Property, a thorough job safety briefing must be conducted with all personnel involved with the task and repeated when the personnel or task changes. If the task is within 25 feet of any track, the job briefing must include the Railway's flagger, as applicable, and include the procedures the Contractor will use to protect its employees, subcontractors, agents or invitees from moving any equipment adjacent to or across any Railway track(s).
- **1.06.03** Workers must not work within 25 feet of the centerline of any track without an on track safety strategy approved by the Railway's Project Representative. When authority is provided, every contractor employee must know: (1) who the Railway flagger is, and how to contact the flagger, (2) limits of the authority, (3) the method of communication to stop and resume work, and (4) location of the designated places of safety. Persons or equipment entering flag/work limits that were not previously job briefed, must notify the flagger immediately, and be given a job briefing when working within 25 feet of the center line of track.
- **1.06.04** When Contractor employees are required to work on the Railway Property after normal working hours or on weekends, the Railway's representative in charge of the project must be notified. A minimum of two employees must be present at all times.
- **1.06.05** Any employees, agents or invitees of Contractor or its subcontractors under suspicion of being under the influence of drugs or alcohol, or in the possession of same, will be removed from the Railway's Property and subsequently released to the custody of a representative of Contractor management. Future access to the Railway's Property by that employee will be denied.

- **1.06.06** Any damage to Railway Property, or any hazard noticed on passing trains must be reported immediately to the Railway's representative in charge of the project. Any vehicle or machine which may come in contact with track, signal equipment, or structure (bridge) and could result in a train derailment must be reported immediately to the Railway representative in charge of the project and to the Railway's Resource Operations Center at 1(800) 832-5452. Local emergency numbers are to be obtained from the Railway representative in charge of the project prior to the start of any work and must be posted at the job site.
- **1.06.07** For safety reasons, all persons are prohibited from having pocket knives, firearms or other deadly weapons in their possession while working on Railway's Property.
- **1.06.08** All personnel protective equipment (PPE) used on Railway Property must meet applicable OSHA and ANSI specifications. Current Railway personnel protective equipment requirements are listed on the web site, www.contractororientation.com, however, a partial list of the requirements include: a) safety glasses with permanently affixed side shields (no yellow lenses); b) hard hats c) safety shoe with: hardened toes, above-the-ankle lace-up and a defined heel; and d) high visibility retro-reflective work wear. The Railway's representative in charge of the project is to be contacted regarding local specifications for meeting requirements relating to hi-visibility work wear. Hearing protection, fall protection, gloves, and respirators must be worn as required by State and Federal regulations. **(NOTE – Should there be a discrepancy between the information contained on the web site and the information in this paragraph, the web site will govern.)**
- **1.06.09 THE CONTRACTOR MUST NOT PILE OR STORE ANY MATERIALS, MACHINERY OR EQUIPMENT CLOSER THAN 25'-0" TO THE CENTER LINE OF THE NEAREST RAILWAY TRACK. MATERIALS, MACHINERY OR EQUIPMENT MUST NOT BE STORED OR LEFT WITHIN 250 FEET OF ANY HIGHWAY/RAIL AT-GRADE CROSSINGS OR TEMPORARY CONSTRUCTION CROSSING, WHERE STORAGE OF THE SAME WILL OBSTRUCT THE VIEW OF A TRAIN APPROACHING THE CROSSING. PRIOR TO BEGINNING WORK, THE CONTRACTOR MUST ESTABLISH A STORAGE AREA WITH CONCURRENCE OF THE RAILWAY'S REPRESENTATIVE.**
- **1.06.10** Machines or vehicles must not be left unattended with the engine running. Parked machines or equipment must be in gear with brakes set and if equipped with blade, pan or bucket, they must be lowered to the ground. All machinery and equipment left unattended on Railway's Property must be left inoperable and secured against movement. (See internet Engineering Contractor Safety Orientation program for more detailed specifications)
- **1.06.11** Workers must not create and leave any conditions at the work site that would interfere with water drainage. Any work performed over water must meet all Federal, State and Local regulations.
- **1.06.12** All power line wires must be considered dangerous and of high voltage unless informed to the contrary by proper authority. For all power lines the minimum clearance between the lines and any part of the equipment or load must be; 200 KV or below - 15 feet; 200 to 350 KV - 20 feet; 350 to 500 KV - 25 feet; 500 to 750 KV - 35 feet; and 750 to 1000 KV - 45 feet. If capacity of the line is not known, a minimum clearance of 45 feet must be

maintained. A person must be designated to observe clearance of the equipment and give a timely warning for all operations where it is difficult for an operator to maintain the desired clearance by visual means.

1.07 Excavation:

- **1.07.01** Before excavating, the Contractor must determine whether any underground pipe lines, electric wires, or cables, including fiber optic cable systems are present and located within the Project work area. The Contractor must determine whether excavation on Railway's Property could cause damage to buried cables resulting in delay to Railway traffic and disruption of service to users. Delays and disruptions to service may cause business interruptions involving loss of revenue and profits. Before commencing excavation, the Contractor must contact **BNSF's Field Engineering Representative (909-386-4079)**. All underground and overhead wires will be considered HIGH VOLTAGE and dangerous until verified with the company having ownership of the line.

It is the Contractor's responsibility to notify any other companies that have underground utilities in the area and arrange for the location of all underground utilities before excavating.

- **1.07.02** The Contractor must cease all work and notify the Railway immediately before continuing excavation in the area if obstructions are encountered which do not appear on drawings. If the obstruction is a utility and the owner of the utility can be identified, then the Contractor must also notify the owner immediately. If there is any doubt about the location of underground cables or lines of any kind, no work must be performed until the exact location has been determined. There will be no exceptions to these instructions.
- **1.07.03** All excavations must be conducted in compliance with applicable OSHA regulations and, regardless of depth, must be shored where there is any danger to tracks, structures or personnel.
- **1.07.04** Any excavations, holes or trenches on the Railway's Property must be covered, guarded and/or protected when not being worked on. When leaving work site areas at night and over weekends, the areas must be secured and left in a condition that will ensure that Railway employees and other personnel who may be working or passing through the area are protected from all hazards. All excavations must be back filled as soon as possible.

1.08 Hazardous Waste, Substances and Material Reporting:

- **1.08.01** If Contractor discovers any hazardous waste, hazardous substance, petroleum or other deleterious material, including but not limited to any non-containerized commodity or material, on or adjacent to Railway's Property, in or near any surface water, swamp, wetlands or waterways, while performing any work under the Exhibit C-1 Agreement, Contractor must immediately: (a) notify the Railway's Resource Operations Center at 1(800) 832-5452, of such discovery: (b) take safeguards necessary to protect its employees, subcontractors, agents and/or third parties: and (c) exercise due care with respect to the release, including the taking of any appropriate measure to minimize the impact of such release.

1.09 Personal Injury Reporting

- **1.09.01** The Railway is required to report certain injuries as a part of compliance with Federal Railroad Administration (FRA) reporting requirements. Any personal injury sustained by an employee of the Contractor, subcontractor or Contractor's invitees while on the Railway's Property must be reported immediately (by phone mail if unable to contact in person) to the Railway's representative in charge of the project. The Non-Employee Personal Injury Data Collection Form contained herein is to be completed and sent by Fax to the Railway at 1(817) 352-7595 and to the Railway's Project Representative no later than the close of shift on the date of the injury.



NON-EMPLOYEE PERSONAL INJURY DATA COLLECTION

(If injuries are in connection with rail equipment accident/incident, highway rail grade crossing accident or automobile accident, ensure that appropriate information is obtained, forms completed and that data entry personnel are aware that injuries relate to that specific event.)

Injured Person Type:

- Passenger on train (C)
- Non-employee (N)
(i.e., emp of another railroad, or, non-BNSF emp involved in vehicle accident, including company vehicles)
- Contractor/safety sensitive (F)
- Contractor/non-safety sensitive (G)
- Volunteer/safety sensitive (H)
- Volunteer/other non-safety sensitive (I)
- Non-trespasser (D) - to include highway users involved in highway rail grade crossing accidents who did not go around or through gates
- Trespasser (E) - to include highway users involved in highway rail grade crossing accidents who went around or through gates
- Non-trespasser (J) - Off Railway Property

If train involved, Train ID:

Transmit attached information to Accident/Incident Reporting Center by:

Fax 1-817-352-7595

or by Phone 1-800-697-6736

or email to: Accident-Reporting.Center@BNSF.com

Officer Providing Information:

(Name)

(Employee No.)

(Phone #)

REPORT PREPARED TO COMPLY WITH FEDERAL ACCIDENT REPORTING REQUIREMENTS AND PROTECTED FROM DISCLOSURE PURSUANT TO 49 U.S.C. 20903 AND 83 U.S.C. 490

NON-EMPLOYEE PERSONAL INJURY DATA COLLECTION

INFORMATION REQUIRED TO BE COLLECTED PURSUANT TO FEDERAL REGULATION. IT SHOULD BE USED FOR COMPLIANCE WITH FEDERAL REGULATIONS ONLY AND IT IS NOT INTENDED TO PRESUME ACCEPTANCE OF RESPONSIBILITY OR LIABILITY

1. Accident City/St: _____ 2. Date: _____ Time: _____

County: _____ 3. Temperature: _____ 4. Weather: _____
(if non BNSF location)

Mile Post / Line Segment _____

5. Driver's License No. (and state) or other ID: _____ **SSN(required):** _____

6. Name (last, first, mi): _____

7. Address: _____ City: _____ St: _____ Zip: _____

8 Date of Birth: _____ and/or Age: _____ Gender: _____
(If available)

Phone Number: _____ Employer: _____

9. Injury: _____ 10. Body Part: _____
(i.e. laceration, etc.) (i.e. Hand, etc.)

11. Description of Accident (To include location, action, result, etc.) _____

12. Treatment:

First Aid Only _____

Required Medical Treatment _____

Other Medical Treatment _____

13. Dr. Name: _____ Date: _____

14. Dr. Address:
Street: _____ City: _____ St: _____ Zip: _____

15. Hospital Name: _____

16. Hospital Address:
Street: _____ City: _____ St: _____ Zip: _____

17. Diagnosis: _____

REPORT PREPARED TO COMPLY WITH FEDERAL ACCIDENT REPORTING REQUIREMENTS
AND PROTECTED FROM DISCLOSURE PURSUANT TO 49 U.S.C. 20903 AND 83 U.S.C. 490

EXHIBIT "C-1"

**Agreement
Between
BNSF RAILWAY COMPANY
and the
CONTRACTOR**

BNSF RAILWAY COMPANY
Attention: Manager Public Projects

Railway File: BF10003130

Agency Project: Van Buren Overpass Widening – Riverside County – 027325M

The undersigned (hereinafter called, the "Contractor"), has entered into a contract (the "Contract") dated _____, 201_, with the **COUNTY of RIVERSIDE ("County")** for the performance of certain work in connection with the following project: **The widening and reconstruction of the Van Buren Overpass in Riverside County along BNSF Railway's San Jacinto Subdivision, MP 10.64, US DOT# 027325M.**

Performance of such work will necessarily require Contractor to enter **BNSF RAILWAY COMPANY** ("Railway") right of way and property ("Railway Property"). The Contract provides that no work will be commenced within Railway Property until the Contractor employed in connection with said work for **COUNTY** (i) executes and delivers to Railway an Agreement in the form hereof, and (ii) provides insurance of the coverage and limits specified in such Agreement and Section 3 herein. If this Agreement is executed by a party who is not the Owner, General Partner, President or Vice President of Contractor, Contractor must furnish evidence to Railway certifying that the signatory is empowered to execute this Agreement on behalf of Contractor.

Accordingly, in consideration of Railway granting permission to Contractor to enter upon Railway Property and as an inducement for such entry, Contractor, effective on the date of the Contract, has agreed and does hereby agree with Railway as follows:

Section 1. RELEASE OF LIABILITY AND INDEMNITY

Contractor hereby waives, releases, indemnifies, defends and holds harmless Railway for all judgments, awards, claims, demands, and expenses (including attorneys' fees), for injury or death to all persons, including Railway's and Contractor's officers and employees, and for loss and damage to property belonging to any person, arising in any manner from Contractor's or any of Contractor's subcontractors' acts or omissions or any work performed on or about Railway's Property. **THE LIABILITY ASSUMED BY CONTRACTOR WILL NOT BE AFFECTED BY THE FACT, IF IT IS A FACT, THAT THE DESTRUCTION, DAMAGE, DEATH, OR INJURY WAS OCCASIONED BY OR CONTRIBUTED TO BY THE NEGLIGENCE OF RAILWAY, ITS AGENTS, SERVANTS, EMPLOYEES OR OTHERWISE, EXCEPT TO THE EXTENT THAT SUCH CLAIMS ARE PROXIMATELY CAUSED BY THE WILLFUL MISCONDUCT OR SOLE NEGLIGENCE OF RAILWAY.**

THE INDEMNIFICATION OBLIGATION ASSUMED BY CONTRACTOR INCLUDES ANY CLAIMS, SUITS OR JUDGMENTS BROUGHT AGAINST RAILWAY UNDER THE FEDERAL EMPLOYEE'S LIABILITY ACT, INCLUDING CLAIMS FOR STRICT LIABILITY UNDER THE SAFETY APPLIANCE ACT OR THE LOCOMOTIVE INSPECTION ACT, WHENEVER SO CLAIMED.

Contractor further agrees, at its expense, in the name and on behalf of Railway, that it will adjust and settle all claims made against Railway, and will, at Railway's discretion, appear and defend any suits or actions of law or in equity brought against Railway on any claim or cause of action arising or growing out of or in any manner connected with any liability assumed by Contractor under this Agreement for which Railway is liable or is alleged to be liable. Railway will give notice to Contractor, in writing, of the receipt or dependency of such claims and thereupon Contractor must proceed to adjust and handle to a conclusion such claims, and in the event of a suit being brought against Railway, Railway may forward summons and complaint or other process in connection therewith to Contractor, and Contractor, at Railway's discretion, must defend, adjust, or settle such suits and protect, indemnify, and save harmless Railway from and against all damages, judgments, decrees, attorney's fees, costs, and expenses growing out of or resulting from or incident to any such claims or suits.

In addition to any other provision of this Agreement, in the event that all or any portion of this Article shall be deemed to be inapplicable for any reason, including without limitation as a result of a decision of an applicable court, legislative enactment or regulatory order, the parties agree that this Article shall be interpreted as requiring Contractor to indemnify Railway to the fullest extent permitted by applicable law. **THROUGH THIS AGREEMENT THE PARTIES EXPRESSLY INTEND FOR CONTRACTOR TO INDEMNIFY RAILWAY FOR RAILWAY'S ACTS OF NEGLIGENCE.**

It is mutually understood and agreed that the assumption of liabilities and indemnification provided for in this Agreement survive any termination of this Agreement.

Section 2. TERM

This Agreement is effective from the date of the Contract until (i) the completion of the project set forth herein, and (ii) full and complete payment to Railway of any and all sums or other amounts owing and due hereunder.

Section 3. INSURANCE

Contractor shall, at its sole cost and expense, procure and maintain during the life of this Agreement the following insurance coverage:

- A. Commercial General Liability insurance. This insurance shall contain broad form contractual liability with a combined single limit of a minimum of \$5,000,000 each occurrence and an aggregate limit of at least \$10,000,000 but in no event less than the amount otherwise carried by the Contractor. Coverage must be purchased on a post 2004 ISO occurrence form or equivalent and include coverage for, but not limit to the following:

- ◆ Bodily Injury and Property Damage
- ◆ Personal Injury and Advertising Injury
- ◆ Fire legal liability
- ◆ Products and completed operations

This policy shall also contain the following endorsements, which shall be indicated on the certificate of insurance:

- ◆ The definition of insured contract shall be amended to remove any exclusion or other limitation for any work being done within 50 feet of railroad property.
- ◆ Waiver of subrogation in favor of and acceptable to Railway.
- ◆ Additional insured endorsement in favor of and acceptable to Railway.
- ◆ Separation of insureds.
- ◆ The policy shall be primary and non-contributing with respect to any insurance carried by Railway.

It is agreed that the workers' compensation and employers' liability related exclusions in the Commercial General Liability insurance policy(s) required herein are intended to apply to employees of the policy holder and shall not apply to ***Railway*** employees.

No other endorsements limiting coverage as respects obligations under this Agreement may be included on the policy with regard to the work being performed under this agreement.

B. Business Automobile Insurance. This insurance shall contain a combined single limit of at least \$1,000,000 per occurrence, and include coverage for, but not limited to the following:

- ◆ Bodily injury and property damage
- ◆ Any and all vehicles owned, used or hired

The policy shall also contain the following endorsements or language, which shall be indicated on the certificate of insurance:

- ◆ Waiver of subrogation in favor of and acceptable to Railway.
- ◆ Additional insured endorsement in favor of and acceptable to Railway.
- ◆ Separation of insureds.
- ◆ The policy shall be primary and non-contributing with respect to any insurance carried by Railway.

C. Workers Compensation and Employers Liability insurance including coverage for, but not limited to:

- ◆ Contractor's statutory liability under the worker's compensation laws of the state(s) in which the work is to be performed. If optional under State law, the insurance must cover all employees anyway.

- ◆ Employers' Liability (Part B) with limits of at least \$500,000 each accident, \$500,000 by disease policy limit, \$500,000 by disease each employee.

This policy shall also contain the following endorsements or language, which shall be indicated on the certificate of insurance:

- ◆ Waiver of subrogation in favor of and acceptable to Railway.
- D. Railroad Protective Liability insurance naming only the **Railway** as the Insured with coverage of at least \$5,000,000 per occurrence and \$10,000,000 in the aggregate. The policy Must be issued on a standard ISO form CG 00 35 12 04 and include the following:
- ◆ Endorsed to include the Pollution Exclusion Amendment
 - ◆ Endorsed to include the Limited Seepage and Pollution Endorsement.
 - ◆ Endorsed to remove any exclusion for punitive damages.
 - ◆ No other endorsements restricting coverage may be added.
 - ◆ The original policy must be provided to the **Railway** prior to performing any work or services under this Agreement
 - ◆ Definition of "Physical Damage to Property" shall be endorsed to read: "means direct and accidental loss of or damage to all property owned by any named insured and all property in any named insured' care, custody, and control arising out of the acts or omissions of the contractor named on the Declarations.

In lieu of providing a Railroad Protective Liability Policy, Licensee may participate (if available) in Railway's Blanket Railroad Protective Liability Insurance Policy.

Other Requirements:

Where allowable by law, all policies (applying to coverage listed above) shall contain no exclusion for punitive damages.

Contractor agrees to waive its right of recovery against **Railway** for all claims and suits against **Railway**. In addition, its insurers, through the terms of the policy or policy endorsement, waive their right of subrogation against **Railway** for all claims and suits. Contractor further waives its right of recovery, and its insurers also waive their right of subrogation against **Railway** for loss of its owned or leased property or property under Contractor's care, custody, or control.

Allocated Loss Expense shall be in addition to all policy limits for coverages referenced above.

Contractor is not allowed to self-insure without the prior written consent of **Railway**. If granted by **Railway**, self-insured retention or other financial responsibility for claims shall be covered directly by Contractor in lieu of insurance. Any and all **Railway** liabilities that would otherwise, in accordance with the provisions of this **Agreement**, be covered by Contractor's insurance will be covered as if Contractor elected not to include a deductible, self-insured retention or other financial responsibility for claims.

Prior to commencing the Work, Contractor shall furnish to **Railway** an acceptable certificate(s) of insurance from an authorized representative evidencing the required coverage(s), endorsements, and amendments. The certificate should be directed to the following addresses:

BNSF Railway Company
c/o CertFocus
P.O. Box 140528
Kansas City, MO 64114
Toll Free: 877-576-2378
Fax number: 817-840-7487
Email: BNSF@certfocus.com
www.certfocus.com

Contractor shall notify **Railway** in writing at least 30 days prior to any cancellation, non-renewal, substitution, or material alteration.

Any insurance policy must be written by a reputable insurance company acceptable to **Railway** or with a current Best's Guide Rating of A- and Class VII or better, and authorized to do business in the state(s) in which the service is to be provide.

If coverage is purchased on a "claims made" basis, Contractor hereby agrees to maintain coverage in force for a minimum of three years after expiration, cancellation or termination of this contract. Annually, Contractor agrees to provide evidence of such coverage as required hereunder.

Contractor represents that this **Agreement** has been thoroughly reviewed by Contractor's insurance agent(s)/broker(s), who have been instructed by Contractor to procure the insurance coverage required by this **Agreement**.

Not more frequently than once every five years, **Railway** may reasonably modify the required insurance coverage to reflect then-current risk management practices in the railroad industry and underwriting practices in the insurance industry.

If any portion of the operation is to be subcontracted by Contractor, Contractor shall require that the subcontractor shall provide and maintain the insurance coverage(s) set forth herein, naming **Railway** as an additional insured, and shall require that the subcontractor shall release, defend, and indemnify **Railway** to the same extent and under the same terms and conditions as Contractor is required to release, defend, and indemnify **Railway** herein.

Failure to provide evidence as required by this section shall entitle, but not require, **Railway** to terminate this **Agreement** immediately. Acceptance of a certificate that does not comply with this section shall not operate as a waiver of Contractor's obligations hereunder.

The fact that insurance (including, without limitation, self-insurance) is obtained by Contractor shall not be deemed to release or diminish the liability of Contractor including, without limitation, liability under the indemnity provisions of this **Agreement**. Damages recoverable by **Railway** shall not be limited by the amount of the required insurance coverage.

In the event of a claim or lawsuit involving *Railway* arising out of this agreement, Contractor will make available any required policy covering such claim or lawsuit.

These insurance provisions are intended to be a separate and distinct obligation on the part of the Contractor. Therefore, these provisions shall be enforceable and Contractor shall be bound thereby regardless of whether or not indemnity provisions are determined to be enforceable in the jurisdiction in which the work covered hereunder is performed.

For purposes of this section, *Railway* means "Burlington Northern Santa Fe LLC", "BNSF RAILWAY COMPANY" and the subsidiaries, successors, assigns and affiliates of each.

Section 4. EXHIBIT "C" CONTRACTOR REQUIREMENTS

The Contractor must observe and comply with all provisions, obligations, requirements and limitations contained in the Contract, and the Contractor Requirements set forth on Exhibit "C" attached to the Contract and this Agreement, , including, but not be limited to, payment of all costs incurred for any damages to Railway roadbed, tracks, and/or appurtenances thereto, resulting from use, occupancy, or presence of its employees, representatives, or agents or subcontractors on or about the construction site.

Section 5. TRAIN DELAY

Contractor is responsible for and hereby indemnifies and holds harmless Railway (including its affiliated railway companies, and its tenants) for, from and against all damages arising from any unscheduled delay to a freight or passenger train which affects Railway's ability to fully utilize its equipment and to meet customer service and contract obligations. Contractor will be billed, as further provided below, for the economic losses arising from loss of use of equipment, contractual loss of incentive pay and bonuses and contractual penalties resulting from train delays, whether caused by Contractor, or subcontractors, or by the Railway performing work under this Agreement. Railway agrees that it will not perform any act to unnecessarily cause train delay.

For loss of use of equipment, Contractor will be billed the current freight train hour rate per train as determined from Railway's records. Any disruption to train traffic may cause delays to multiple trains at the same time for the same period.

Additionally, the parties acknowledge that passenger, U.S. mail trains and certain other grain, intermodal, coal and freight trains operate under incentive/penalty contracts between Railway and its customer(s). Under these arrangements, if Railway does not meet its contract service commitments, Railway may suffer loss of performance or incentive pay and/or be subject to penalty payments. Contractor is responsible for any train performance and incentive penalties or other contractual economic losses actually incurred by Railway which are attributable to a train delay caused by Contractor or its subcontractors.

The contractual relationship between Railway and its customers is proprietary and confidential. In the event of a train delay covered by this Agreement, Railway will share information relevant to any train delay to the extent consistent with Railway confidentiality

obligations. Damages for train delay are currently \$382.20 per hour per incident. **THE RATE THEN IN EFFECT AT THE TIME OF PERFORMANCE BY THE CONTRACTOR HEREUNDER WILL BE USED TO CALCULATE THE ACTUAL COSTS OF TRAIN DELAY PURSUANT TO THIS AGREEMENT.**

Contractor and its subcontractors must give Railway's representative (BNSF Project Engineer, 909-386-4079) four (4) weeks advance notice of the times and dates for proposed work windows. Railway and Contractor will establish mutually agreeable work windows for the project. Railway has the right at any time to revise or change the work windows due to train operations or service obligations. Railway will not be responsible for any additional costs or expenses resulting from a change in work windows. Additional costs or expenses resulting from a change in work windows shall be accounted for in Contractor's expenses for the project.

Contractor and subcontractors must plan, schedule, coordinate and conduct all Contractor's work so as to not cause any delays to any trains.

Kindly acknowledge receipt of this letter by signing and returning to the Railway two original copies of this letter, which, upon execution by Railway, will constitute an Agreement between us.

Contractor

BNSF Railway Company

By: _____

By: _____

Printed Name: _____

Name: _____
Manager Public Projects

Title: _____

Accepted and effective this _____ day of 2012.

Contact Person: _____

Address: _____

City: _____

State: _____ Zip: _____

Fax: _____

Phone: _____

E-mail: _____

EXHIBIT D

See attached.

BNSF RAILWAY COMPANY
 FHPM ESTIMATE FOR
 RIVERSIDE COUNTY

LOCATION ALESSANDRO

DETAILS OF ESTIMATE

PLAN ITEM : 000205901

VERSION : 1

PURPOSE, JUSTIFICATION AND DESCRIPTION

PIP INSPECTION/COORDINATION SC DIV SAN JACINTO SUB LS 7605 MP 10.6-10.7 - I-215 OVERPASS - RIVERSIDE, CA

DESCRIPTION OF PROJECT AS PROVIDED BY PROJECT ENGINEER: BNSF TO PROVIDE 100 DAYS OF INSPECTION/COORDINATION FOR A FREEWAY OVERPASS WIDENING PROJECT ON THE SAN JACINTO BRANCH LINE

BILLING FOR THIS PROJECT SHOULD BE DIRECTED TO: 100% TO COUNTY OF RIVERSIDE, CA

RFA REQUESTED BY: GREG ROUSSEAU ON 6/11/12
 AFE REQUESTED BY:

MAINTAIN PROPRIETARY CONFIDENTIALITY
 THE PHYSICAL LIMITS OF THIS PROJECT ARE DESCRIBED BY LINE SEGMENT, MILE POST RANGES, AND IN SOME CASES TRACK NUMBER. THIS IS THE PRIMARY AREA FOR THE PROJECT. THERE WILL BE CASES WHERE WORK MAY OCCUR BEYOND THE DEFINED LIMITS. PROJECTS THAT INCLUDE SIGNAL, ELECTRICAL, OR TELECOMMUNICATION EQUIPMENT MAY REQUIRE ACTIVITY BEYOND THESE DEFINED TRACK LIMITS. ALL OR PORTIONS OF SOME PROJECTS MAY OCCUR IN AREAS WHERE NO MILEPOST SIGNS EXIST SUCH AS YARDS.
 THIS ESTIMATE IS GOOD FOR 90 DAYS. THEREAFTER THE ESTIMATE IS SUBJECT TO CHANGE IN COST FOR LABOR, MATERIAL, AND OVERHEAD.

DESCRIPTION	QUANTITY U/M	COST	TOTAL \$
***** LABOR *****			
TOTAL LABOR COST		0	0
***** MATERIAL *****			
TOTAL MATERIAL COST		0	0
***** OTHER *****			
INSPECTION/COORDINATION	1.0 LS	40,000	
TOTAL OTHER ITEMS COST		40,000	40,000
PROJECT SUBTOTAL			40,000
CONTINGENCIES			4,000
BILL PREPARATION FEE			440
GROSS PROJECT COST			44,440
LESS COST PAID BY BNSF			0
TOTAL BILLABLE COST			44,440

Exhibit E

[Public Projects Manager's letterhead]

Date: _____

Mr./Ms. _____ [Name of Agency Here]

_____ [Address for Agency]

Re: Final Approval of Plans and Specifications dated _____, 20__ , drafted by
_____ [insert name of architecture or engineering firm
here] (hereinafter called, the "Plans and Specifications")

Dear _____:

This letter serves as BNSF RAILWAY COMPANY's ("BNSF") final written approval of the Plans and Specifications covering the construction of _____ [insert description of the project here]. This final written approval is given to _____ [insert name of Agency here] ("Agency") pursuant to Article III, Section 1 of that certain Underpass Agreement between BNSF and Agency, dated _____, 200__ . If the Plans and Specifications are revised by Agency subsequent to the date set forth above, this letter shall no longer serve as final written approval of the Plans and Specifications and Agency must resubmit said Plans and Specifications to BNSF for final written approval.

Regards,

[Public Projects Manager's Name]

Exhibit F

BNSF Bridge Requirements

BRIDGE DESIGN, PLANS & SPECIFICATIONS:

Except for the design of temporary falsework and shoring, BNSF review of the Structure plans will be limited to the vertical and horizontal clearances, sight distance for existing train signals, foundation dimensions and drainage characteristics as they relate to existing and future tracks. BNSF will not review structural design calculations for the permanent Structure unless a member or members are influenced by railroad live loads.

Temporary falsework and shoring plans and calculations must be reviewed and approved by BNSF prior to beginning construction. The Agency shall perform an independent review of the design calculations for temporary falsework and shoring prior to submitting them to BNSF for approval. Temporary construction clearances must be no less than 15 feet measured horizontally from the centerline of the nearest track and 21 feet-6inches measured vertically from the top of rail of the most elevated track to the bottom of lowest temporary falsework member. State regulatory agencies may have more restrictive requirements for temporary railroad clearances.

For the permanent Structure, the Agency will submit plans showing the least horizontal distance from the centerline of existing and future tracks to the face of the nearest member of the proposed Structure. The location of the least horizontal distance must be accurately described such that BNSF can determine where it will occur in both the horizontal and vertical plane. If the permanent member is within 25 feet of the nearest track (or future track), collision walls shall be incorporated into the permanent Structure design according to American Railway Engineering and Maintenance Association Manual of Recommended Practice - Chapter 8 - Article 2.1.5.

For the permanent Structure, the Agency will submit plans showing the least vertical clearance from top of the most elevated rail of existing and future tracks to the lowest point of the proposed Structure. A profile of the existing top of rail elevation shall be plotted on the bridge plans. The profile shall extend for 500 feet in each direction of the proposed overpass and a separate profile shall be plotted for each track. If the existing top of rail profile(s) is not uniform such that a sag exists in the vicinity of the proposed Structure, the permanent Structure vertical clearance shall be increased sufficiently to accommodate a raise in the track profile to remove the sag. Prior to beginning construction of the permanent Structure, the top of rail elevations should be checked and verified that they have not changed from the assumed elevations utilized for the design of the bridge.

Prior to issuing any invitation to bid on construction of the Structure, the Agency should conduct a pre-bid meeting where prospective Providers have the opportunity to communicate with BNSF personnel regarding site specific train speeds, train density, and general safety requirements for men and equipment working near live tracks.

BRIDGE CONSTRUCTION:

After awarding the bid, but prior to the Provider entering BNSF's right-of-way or property, the Agency should conduct a pre-construction meeting with BNSF personnel in attendance to reiterate the safety requirements of construction activity adjacent to live tracks.

During construction, BNSF may require an independent engineering inspector to be present during certain critical activities of the Project, including but not limited to: driving foundation piles, erecting falsework, construction of shoring and retaining walls, placing concrete, placing soil backfill and compaction processes. The Agency shall reimburse BNSF for all costs of supplemental inspection services.

Within 90 days of the conclusion of the Project and final acceptance by BNSF, the Agency will provide BNSF with a complete electronic set of the bridge plans labeled "As Built". Those plans will reflect any and all deviations from the original plans that occurred during construction. The "As Built" plans will be submitted in Micro Station *.dgn electronic format (preferred) or AutoCAD *.dwg format. Electronic plans are to be submitted in the original format used for CAD plan preparation and not converted to another format prior to submission. Actual measured "as constructed" clearances shall be shown as well as depth, size and location of all foundation components. The plans shall show dimensioned locations of existing and relocated utilities.

BRIDGE MAINTENANCE:

The Agency will be responsible for maintenance and repair of the Structure including the earth retention components, embankment slopes, erosion control, surface drainage, fencing, deck drains, landscaping, paint, walkways, handrails, lighting, and other improvements associated with the Project.

Fencing and other pedestrian access controls within BNSF's right-of-way and incorporated into the Project shall be designed and maintained by the Agency. Trespasser control shall be the responsibility of the Agency. Graffiti removal will be the responsibility of the Agency.

BRIDGE INSPECTION:

The Agency will conduct annual routine structural inspections. In the event of an earthquake, fire, flood, damage from vehicular impacts or other emergent situations, the Agency will provide an immediate inspection by qualified personnel and notify BNSF of damage that may affect safe passage of trains. If necessary the Agency will embargo weights or provide lane closures or other such measures to protect the structural integrity of the Structure such that there can be continuous safe passage of trains until repairs are made.

BRIDGE ALTERATIONS:

Except as provided otherwise by this Agreement, there will be no alterations made to the Structure that will alter the railroad vertical or horizontal clearances provided by the original design. Pipelines will be not be added or attached to the Structure without first submitting plans and calculations to BNSF for review and approval.

STATE OF CALIFORNIA - DEPARTMENT OF TRANSPORTATION	CONSULTANT FUNCTIONAL SUPERVISOR	DENNIS LANDAL	CHECKED BY	SAMUEL MCHORTER	DATE REVISED	
	DESIGNED BY	NICHOLAS ROBERTS	REVISD BY			

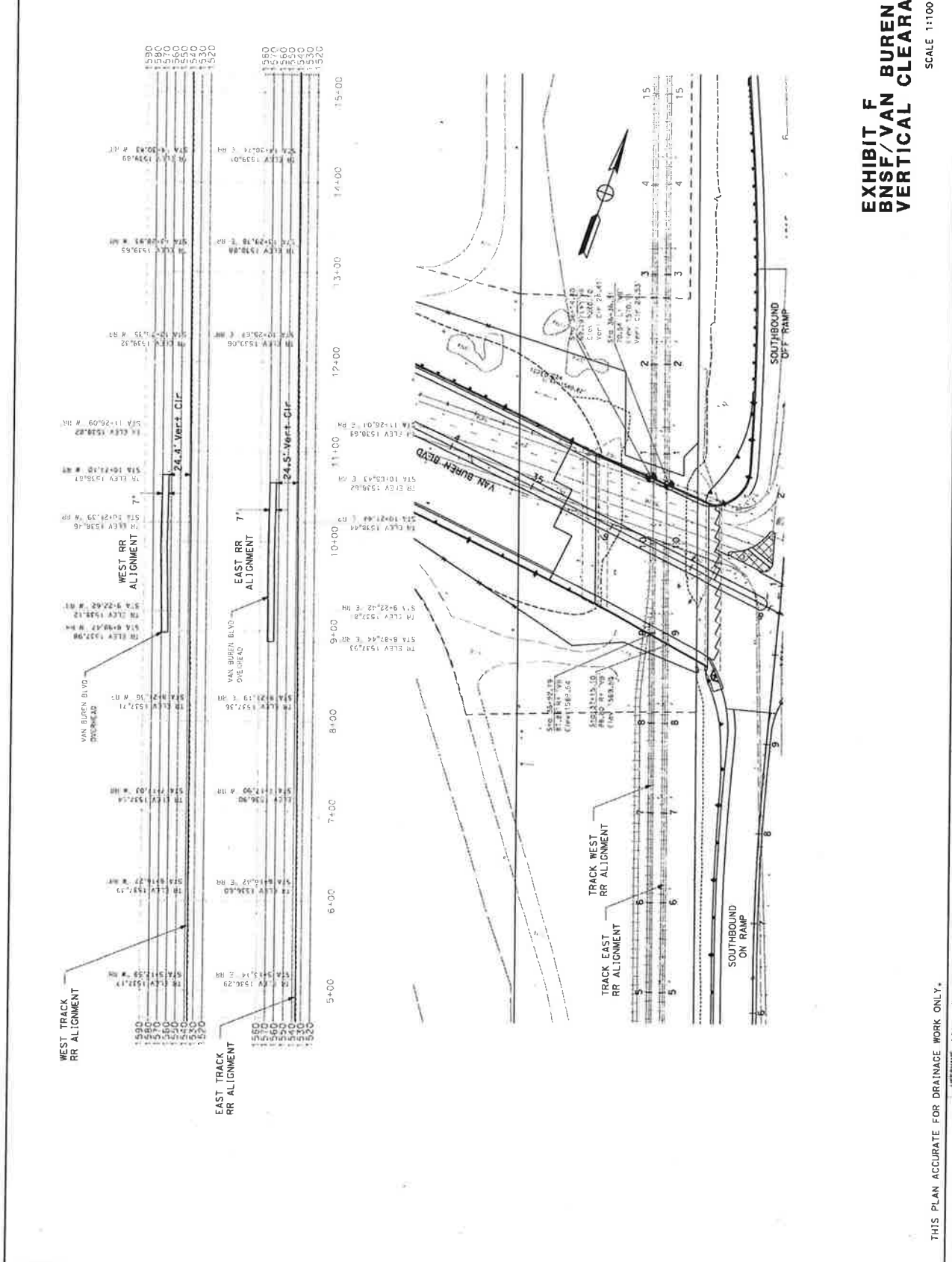

**EXHIBIT F
BNSF/VAN BUREN OVERHEAD
VERTICAL CLEARANCE**

SCALE 1:100

THIS PLAN ACCURATE FOR DRAINAGE WORK ONLY.

STATE OF CALIFORNIA - DEPARTMENT OF TRANSPORTATION

UNIT 08224

PROJECT NUMBER & PHASE

0E5201