

**SUBMITTAL TO THE BOARD OF SUPERVISORS
COUNTY OF RIVERSIDE, STATE OF CALIFORNIA**

187
A



FROM: TLMA - Transportation Department

SUBMITTAL DATE:
August 16, 2012

SUBJECT: Horsethief Canyon Road and Knabe Road Resurfacing projects, in the Temescal Valley area.

RECOMMENDED MOTION: That the Board of Supervisors:

1. Approve two Addenda to the specifications and plans, issued prior to the July 18, 2012 bid opening.
2. Accept the low bid of All American Asphalt, Inc. of Corona, CA in the amount of \$1,755,151.
3. Award the contract to All American Asphalt, Inc. and authorize the Chairman of the Board to execute the contract documents.
4. Approve the project's proposed budget as shown on Attachment A.

Juan C. Perez
Director of Transportation and Land Management

JCP:jrj:sb
(Continued On Attached Page)

FINANCIAL DATA	Current F.Y. Total Cost:	\$ 1,755,151	In Current Year Budget:	Yes
	Current F.Y. Net County Cost:	\$ 0	Budget Adjustment:	No
	Annual Net County Cost:	\$ 0	For Fiscal Year:	2012/2013

SOURCE OF FUNDS: ABX8 9 (Gas Tax Mar 2010) (33%), Proposition 1B (67%)	Positions To Be Deleted Per A-30	<input type="checkbox"/>
	Requires 4/5 Vote	<input type="checkbox"/>

There are no General Funds used in this project.

C.E.O. RECOMMENDATION:

APPROVE

BY
Tina Grande

County Executive Office Signature

FORM APPROVED COUNTY COUNSEL
BY:
MARSHAL VICTOR
DATE: 8/13/12

Departmental Concurrence

Dept't Recomm.: Policy Consent
Per Exec. Ofc.: Policy Consent

Prev. Agn. Ref. 6/19/2012 Item 3.47 | **District:** 1st / 1st | **Agenda Number:**

ATTACHMENTS FILED
WITH THE CLERK OF THE BOARD

3.103

The Honorable Board of Supervisors

RE: Horsethief Canyon Road and Knabe Road Resurfacing projects, in the Temescal Valley area.

August 16, 2012

Page 2 of 2

BACKGROUND: By Minute Order dated June 19, 2012 (Agenda Item 3.47), the Board authorized the Clerk of the Board to advertise for the Resurfacing of Horsethief Canyon Road and Knabe Road, in the Temescal Valley area.

During the advertisement period, two addenda were issued to all registered plan holders as a supplement to the specifications and special provisions. Bidders are required to acknowledge the addenda on their Contractor's Proposal, and to take the addenda into account in order to be considered for award. The addenda were issued to clarify and modify the approved contract documents. The addenda are attached as, Addendum No. 1 and Addendum No. 2.

Bids for the project were opened in the office of the Director of Transportation and Land Management at 2:00 PM, Wednesday, July 18, 2012. Five bids were received. The basis for the selection of a contractor is the lowest responsive and responsible bid for all schedules of work. The lowest responsive bid was submitted by All American Asphalt, Inc. in the amount of \$1,755,151, which is \$145,354 (7.65%) less than the Engineer's Estimate. Agreement includes the following schedules of work:

Base Bid: Primary items of work on Horsethief Canyon Road and Knabe Road.

Alternate Bid: Adjustment of manholes to be funded by Elsinore Valley Municipal Water District (EVMWD) and Lee Lake Water District (LLWD) for their respective utilities under the terms of the Cooperative Agreement.

The alternate bid is recommended to be awarded with the base bid contract. The utility owners, EVMWD and LLWD, have concurred with bid prices, as bid by the apparent low bidder. The alternate bid is included with the contract award and the costs for the work will be reimbursed by the respective utility owner.

The Transportation Improvement Program provides for the resurfacing of Horsethief Canyon Road and Knabe Road in the Temescal Valley area of Riverside County. The following are the limits of proposed work:

1. Horsethief Canyon Road: Temescal Canyon Road to Placid Hill Drive
2. Knabe Road: Forest Boundary Road to Clay Canyon Drive

The Contractor will execute the contract and provide bonds and insurance documents after Board approval. The Contractor is qualified to perform the work as outlined in the bid.

Project No. C2-0137 (Horsethief Canyon Road)
C0-0523 (Knabe Road)

Form 11 Attachment

Contract/Lease/Purchase Summary Data

Contract (for Services)

- Approval/Renewal
- Sole Source
- Personal Services
- Independent Contractor
- Other than Low Bid
- Change Order
- Public Works

Lease

- Approval/Renewal
- Multi-Year Lease
- Equipment
- Real Property
- Change Order

Purchase (for Materials)

- Sole Source
- Other than Low Bid
- Change Order

Selection Committee Member Names (RFP's Only)

User Department:	Transportation Department
-------------------------	---------------------------

N/A

Vendor/Lessor Name:	All American Asphalt
----------------------------	----------------------

Minority Status:

- M W DV None

Vendor/Lessor Location:	Corona, Ca.
--------------------------------	-------------

Local Preference Applied: Yes No N/A

Local Preference Award Cost \$
(5% maximum preference)

Local Preference FYTD: Cost \$

of Orders

Applicable Board Policy #

Comments:

RFQ/RFP Process:

Date Mailed:
Response Date:
of Responses:
of Qualified Responses:

Bidding Process:

Bid Range: \$ 1,755,151.00 to \$2,051,588.00
Local Bid Range: N/A
Responsive and
Responsible Bid Range: \$ 1,755,151.00 to \$2,051,588.00

Contract/Lease Renewals Only

Existing Agreement Items

Proposed Agreement Items

1. Rates
2. Terms
3. Conditions
4. Legal Issues
5. Accountability
6. Utilities

(continue on blank sheet if necessary)

NOTE: COMPETITIVELY BID PUBLIC WORKS CONTRACT

Attachment "A"

Riverside County Transportation Department

Project: **KNABE RD**

Project No.(s): **C0-0523**

Expenses as of: **7/30/2012**

Project Costs and Budget

Activity	Incurred Costs	Projected Costs	Total Costs	Existing Budget	Proposed Budget
Preliminary Survey					
Environmental	280		1,000	1,000	1,000
Design	46,463	1,537	48,000	35,000	48,000
Right-of-way					
Utilities					
Construction		830,343	914,000	600,000	914,000
Construction Contingency		83,034			
Construction Engineering & Inspection	430	62,570	63,000	65,000	63,000
Construction Survey		27,000	27,000	11,000	27,000
Totals:	47,173	1,004,484	1,053,000	712,000	1,053,000

Project Funding

Code	Name	Existing Budget	Proposed Budget
221	ABX8 9 (Gas Tax Mar 2010)	712,000	673,000
215	Proposition 1B (State bond funds- Local Roads)		380,000
Totals		712,000	1,053,000

Comments

UPDATED WITH ALL AMERICAN ASPHALT JULY 18, 2012 BID COSTS.

Attachment "A"

Riverside County Transportation Department

Project: **HORSETHIEF CANYON RD**

Project No.(s): **C2-0137**

Expenses as of: **7/30/2012**

Project Costs and Budget

Activity	Incurred Costs	Projected Costs	Total Costs	Existing Budget	Proposed Budget
Preliminary Survey					
Environmental	280		1,000	2,000	1,000
Design	56,568	2,432	59,000	61,000	59,000
Right-of-way					
Utilities					
Construction		924,809			
Construction Contingency 10.0%		92,481	1,018,000	1,203,000	1,018,000
Construction Engineering & Inspection 7.6%	500	70,000	71,000	61,000	71,000
Construction Survey 3.2%		30,000	30,000	13,000	30,000
Totals:	57,348	1,119,722	1,179,000	1,340,000	1,179,000

Project Funding

Code	Name	Existing Budget	Proposed Budget
221	ABX8 9 (Gas Tax Mar 2010)	63,000	60,000
999	Unfunded	1,277,000	
215	Proposition 1B (State bond funds- Local Roads)		1,119,000
Totals		1,340,000	1,179,000

Comments

UPDATED WITH ALL AMERICAN ASPHALT JULY 18, 2012 BID COSTS.

COUNTY OF RIVERSIDE
 DEPARTMENT OF TRANSPORTATION

HORSETHIEF CANYON ROAD
 RESURFACING PROJECT

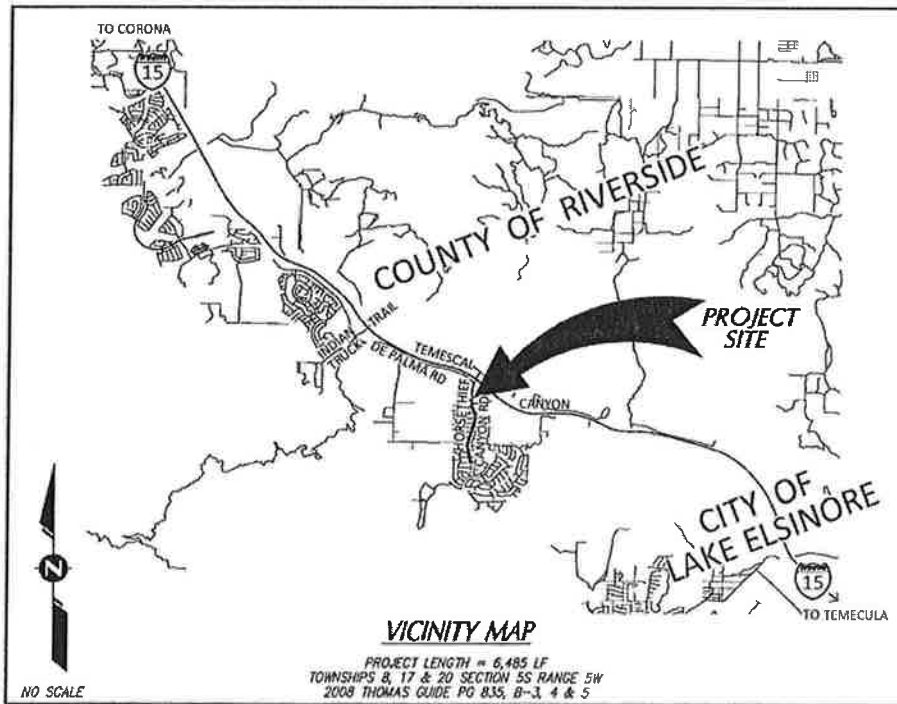
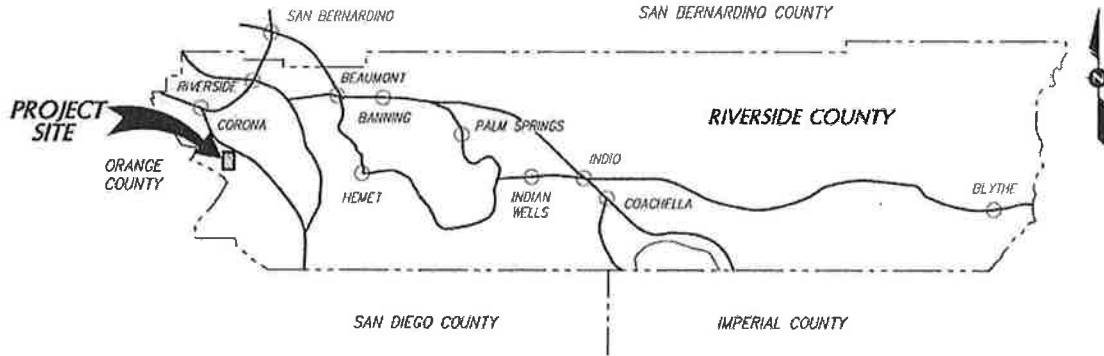

VICINITY MAP
 SCALE NONE
 EXHIBIT "A"

HORSETHIEF CANYON RD
RESURFACING PROJECT

COUNTY OF RIVERSIDE
 DEPARTMENT OF TRANSPORTATION

KNABE ROAD
 RESURFACING PROJECT

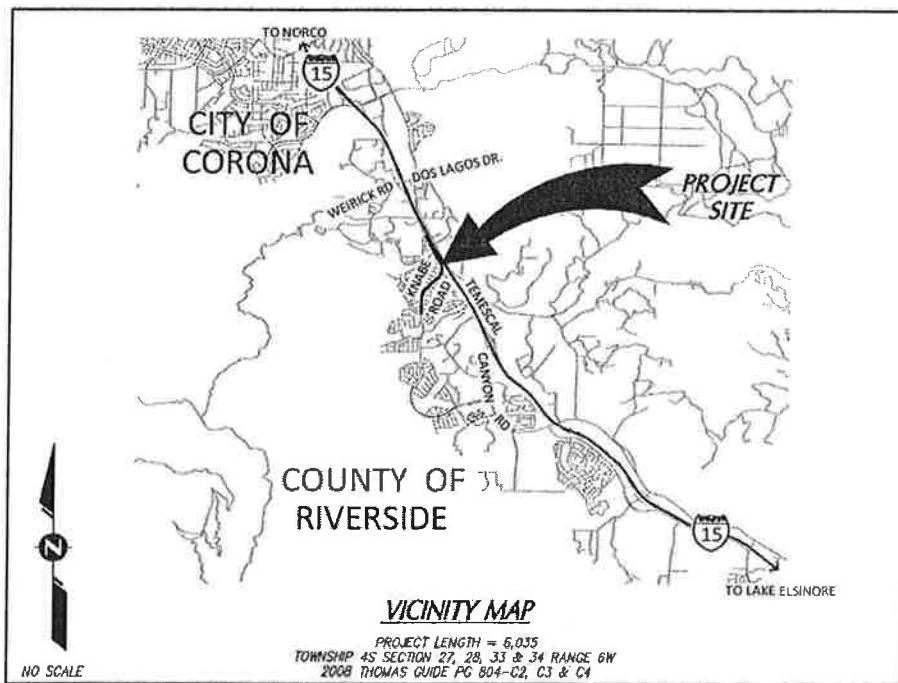
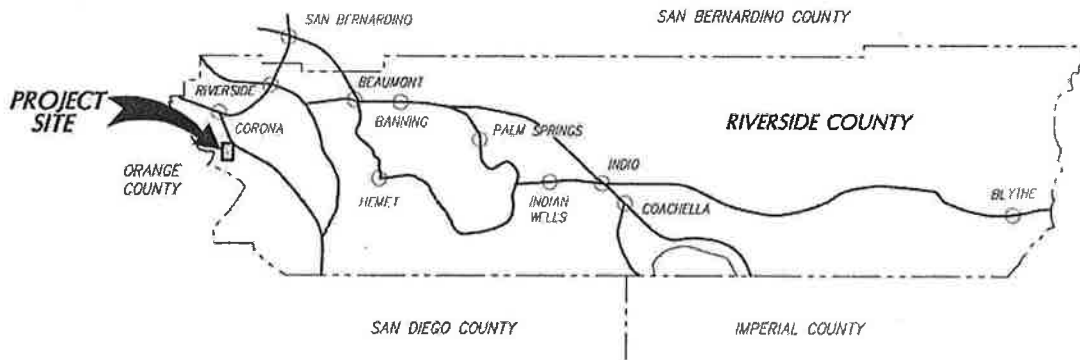

VICINITY MAP

SCALE NONE

EXHIBIT "A"

KNABE RD

RESURFACING PROJECT

**Riverside County Transportation Department
Summary of Bids**

**PROJECT: Horsethief Canyon Road and Knabe Road Resurfacing Project
in the Temescal Valley area of Riverside County**

Advertised: June 19, 2012 (Agenda Item: 3.47)
Addenda: 1(7/10/12), 2(7/12/12)

Bids Open: 2 pm Date: Wednesday, July 18, 2012

PROJECT NO. C2-0137 & C0-0523

BASE BID		COUNTY'S ESTIMATE				All American Asphalt Corona, CA 92878		
ITEM NO.	ITEM CODE	CONTRACT ITEM	UNITS	QUANTITY	UNIT PRICE	ENG ESTIMATE	BID UNIT PRICE	BID ESTIMATE
1	066102	DUST ABATEMENT	LS	1	5,000.00	5,000.00	13,815.00	13,815.00
2	074020	WATER POLLUTION CONTROL	LS	1	10,000.00	10,000.00	2,500.00	2,500.00
3	120100	TRAFFIC CONTROL SYSTEM	LS	1	40,000.00	40,000.00	12,000.00	12,000.00
4	160101	CLEARING AND GRUBBING	LS	1	10,000.00	10,000.00	3,100.00	3,100.00
5	170101	DEVELOP WATER SUPPLY	LS	1	5,000.00	5,000.00	1,840.00	1,840.00
6	190101	ROADWAY EXCAVATION	CY	570	30.00	17,100.00	11.20	6,384.00
7	011506	WEDGE PLANE ASPHALT CONCRETE	LF	21,000	1.00	21,000.00	0.83	17,430.00
8	011506	WEDGE PLANE ASPHALT CONCRETE - MEDIUM	LF	3,000	1.00	3,000.00	0.83	2,490.00
9	153103	COLD PLANE ASPHALT CONCRETE PAVEMENT	SQYD	1,000	2.00	2,000.00	1.24	1,240.00
10	000003	COLD IN-PLACE RECYCLING - MIX DESIGN, SAMPLING & TESTING	LS	1	12,000.00	12,000.00	33,660.00	33,660.00
11	020256	EMULSIFIED RECYCLING AGENT	TON	560	650.00	364,000.00	684.00	383,040.00
12	020255	COLD IN-PLACE RECYCLING	SQYD	88,500	4.50	398,250.00	3.31	292,935.00
13	390130	HOT MIX ASPHALT	TON	610	70.00	42,700.00	69.00	42,090.00
14	013901	ASPHALT RUBBER HOT MIX	TON	10,300	75.00	772,500.00	71.30	734,390.00
15	013904	PLACE ASPHALT CONCRETE DIKE (CRS 212) (8")	LF	1,800	6.00	10,800.00	7.00	12,600.00
16	017305	MINOR CONCRETE (CURB AND GUTTER) (CRS 201)	LF	500	25.00	12,500.00	43.00	21,500.00
17	017306	MINOR CONCRETE (CURB RAMP) (CRS 403)	EA	36	2,500.00	90,000.00	2,300.00	82,800.00
18	017317	MINOR CONCRETE (CROSS-GUTTER AND SPANDREL)	SQFT	250	10.00	2,500.00	24.60	6,150.00
19	731521	MINOR CONCRETE (SIDEWALK)	SQFT	500	4.00	2,000.00	5.70	2,850.00
20	017003	REPAIR CATCH BASIN (CURB INLET) (CRS 300)	EA	1	850.00	850.00	8,800.00	8,800.00
21	840519	THERMOPLASTIC CROSSWALK AND PAVEMENT MARKING	SQFT	3,540	4.00	14,160.00	3.80	13,452.00
22	840656	PAINT TRAFFIC STRIPE (2-COAT)	LF	35,900	0.40	14,360.00	0.22	7,898.00
23	850111	PAVEMENT MARKER (RETROREFLECTIVE)	EA	1,340	4.00	5,360.00	4.20	5,628.00
24	860811	DETECTOR LOOP	EA	26	250.00	6,500.00	184.00	4,784.00
25	152440	ADJUST STORM DRAIN MANHOLE TO GRADE	EA	17	500.00	8,500.00	560.00	9,520.00
26	566011	ROADSIDE SIGN - ONE POST	EA	39	250.00	9,750.00	231.00	9,009.00
27	150710	REMOVE TRAFFIC STRIPE	LF	1,000	2.00	2,000.00	1.00	1,000.00
28	000003	REMOVE AND SALVAGE SIGN AND POST	EA	10	75.00	750.00	52.00	520.00
29	000003	REPLACE EXISTING R1-1 ON EXISTING POST	EA	21	125.00	2,625.00	102.00	2,142.00
30	000003	FURNISH AND INSTALL STREET NAME SIGN (CRS 1220)	EA	12	150.00	1,800.00	372.00	4,464.00
SUBTOTAL (Base Bid)						1,887,005.00		1,740,031.00
ITEMS 1-30								

**Riverside County Transportation Department
Summary of Bids**

**PROJECT: Horsethief Canyon Road and Knabe Road Resurfacing Project
in the Temescal Valley area of Riverside County**

Advertised: June 19, 2012 (Agenda Item: 3.47)
Addenda: 1(7/10/12), 2(7/12/12)
Bids Open: 2 pm Date: Wednesday, July 18, 2012

PROJECT NO. C2-0137 & C0-0523

ALTERNATE BID (EVMWD & LEE LAKE WATER)		COUNTY'S ESTIMATE				All American Asphalt Corona, CA 92878		
ITEM NO.	ITEM CODE	CONTRACT ITEM	UNITS	QUANTITY	UNIT PRICE	ENG ESTIMATE	BID UNIT PRICE	BID ESTIMATE
31	152475	ADJUST SEWER MH/CLEAN OUT TO GRADE - KNABE	EA	18	500.00	9,000.00	560.00	10,080.00
32	152475	ADJUST SEWER MH/CLEAN OUT TO GRADE - HORSETHIEF	EA	9	500.00	4,500.00	560.00	5,040.00
		SUBTOTAL (Alternate Bid)				13,500.00		15,120.00
		ITEM 31-32						

		PROJECT TOTAL				1,900,505.00		1,755,151.00
		ITEMS 1-32						

**Riverside County Transportation Department
Summary of Bids**

**PROJECT: Horsethief Canyon Road and Knabe Road Resurfacing Project
in the Temescal Valley area of Riverside County**

Advertised: June 19, 2012 (Agenda Item: 3.47)
Addenda: 1(7/10/12), 2(7/12/12)

Bids Open: 2 pm Date: Wednesday, July 18, 2012

PROJECT NO. C2-0137 & C0-0523

BASE BID ITEM NO.	ITEM CODE	CONTRACT ITEM	UNITS	QUANTITY	2		3	
					R-J Noble Company Orange, CA 92856	BID ESTIMATE	Hardy & Harper, Inc. Santa Ana, CA 92705	BID ESTIMATE
1	066102	DUST ABATEMENT	LS	1	4,500.00	4,500.00	6,000.00	6,000.00
2	074020	WATER POLLUTION CONTROL	LS	1	3,000.00	3,000.00	3,000.00	3,000.00
3	120100	TRAFFIC CONTROL SYSTEM	LS	1	16,500.00	16,500.00	66,000.00	66,000.00
4	160101	CLEARING AND GRUBBING	LS	1	8,500.00	8,500.00	24,000.00	24,000.00
5	170101	DEVELOP WATER SUPPLY	LS	1	4,000.00	4,000.00	6,000.00	6,000.00
6	190101	ROADWAY EXCAVATION	CY	570	23.75	13,537.50	30.75	17,527.50
7	011506	WEDGE PLANE ASPHALT CONCRETE	LF	21,000	0.87	18,270.00	1.00	21,000.00
8	011506	WEDGE PLANE ASPHALT CONCRETE - MEDIUM	LF	3,000	0.87	2,610.00	1.50	4,500.00
9	153103	COLD PLANE ASPHALT CONCRETE PAVEMENT	SQYD	1,000	1.30	1,300.00	1.50	1,500.00
10	000003	COLD IN-PLACE RECYCLING - MIX DESIGN, SAMPLING & TESTING	LS	1	34,000.00	34,000.00	52,002.50	52,002.50
11	020256	EMULSIFIED RECYCLING AGENT	TON	560	690.00	386,400.00	699.00	391,440.00
12	020255	COLD IN-PLACE RECYCLING	SQYD	88,500	3.68	325,680.00	3.21	284,085.00
13	390130	HOT MIX ASPHALT	TON	610	59.00	35,990.00	67.00	40,870.00
14	013901	ASPHALT RUBBER HOT MIX	TON	10,300	71.20	733,360.00	75.50	777,650.00
15	013904	PLACE ASPHALT CONCRETE DIKE (CRS 212) (8")	LF	1,800	3.80	6,840.00	4.00	7,200.00
16	017305	MINOR CONCRETE (CURB AND GUTTER) (CRS 201)	LF	500	32.00	16,000.00	35.00	17,500.00
17	017306	MINOR CONCRETE (CURB RAMP) (CRS 403)	EA	36	2,050.00	73,800.00	1,900.00	68,400.00
18	017317	MINOR CONCRETE (CROSS-GUTTER AND SPANDREL)	SQFT	250	15.50	3,875.00	12.00	3,000.00
19	731521	MINOR CONCRETE (SIDEWALK)	SQFT	500	5.50	2,750.00	5.50	2,750.00
20	017003	REPAIR CATCH BASIN (CURB INLET) (CRS 300)	EA	1	9,000.00	9,000.00	4,000.00	4,000.00
21	840519	THERMOPLASTIC CROSSWALK AND PAVEMENT MARKING	SQFT	3,540	3.35	11,859.00	3.75	13,275.00
22	840656	PAINT TRAFFIC STRIPE (2-COAT)	LF	35,900	0.29	10,411.00	0.24	8,616.00
23	850111	PAVEMENT MARKER (RETROREFLECTIVE)	EA	1,340	3.10	4,154.00	4.00	5,360.00
24	860811	DETECTOR LOOP	EA	26	185.00	4,810.00	225.00	5,850.00
25	152440	ADJUST STORM DRAIN MANHOLE TO GRADE	EA	17	465.00	7,905.00	600.00	10,200.00
26	566011	ROADSIDE SIGN - ONE POST	EA	39	230.00	8,970.00	230.00	8,970.00
27	150710	REMOVE TRAFFIC STRIPE	LF	1,000	1.80	1,800.00	1.30	1,300.00
28	000003	REMOVE AND SALVAGE SIGN AND POST	EA	10	80.00	800.00	55.00	550.00
29	000003	REPLACE EXISTING R1-1 ON EXISTING POST	EA	21	115.00	2,415.00	130.00	2,730.00
30	000003	FURNISH AND INSTALL STREET NAME SIGN (CRS 1220)	EA	12	205.00	2,460.00	377.00	4,524.00
SUBTOTAL (Base Bid)						1,755,496.50		1,859,800.00
ITEMS 1-30								

**Riverside County Transportation Department
Summary of Bids**

Advertised: June 19, 2012 (Agenda Item: 3.47)
 Addenda: 1(7/10/12), 2(7/12/12)
 Bids Open: 2 pm Date: Wednesday, July 18, 2012

**PROJECT: Horsethief Canyon Road and Knabe Road Resurfacing Project
 in the Temescal Valley area of Riverside County**

PROJECT NO. C2-0137 & C0-0523

ALTERNATE BID (EVMWD & LEE LAKE WATER)		2		3		
ITEM NO.	ITEM CODE	CONTRACT ITEM	UNITS	QUANTITY	R.J Noble Company Orange, CA 92856	Hardy & Harper, Inc. Santa Ana, CA 92705
31	152475	ADJUST SEWER MH/CLEAN OUT TO GRADE - KNABE	EA	18	BID UNIT PRICE 465.00 BID ESTIMATE 8,370.00	BID UNIT PRICE 600.00 BID ESTIMATE 10,800.00
32	152475	ADJUST SEWER MH/CLEAN OUT TO GRADE - HORSETHIEF	EA	9	BID UNIT PRICE 465.00 BID ESTIMATE 4,185.00	BID UNIT PRICE 600.00 BID ESTIMATE 5,400.00
		SUBTOTAL (Alternate Bid)			12,555.00	16,200.00
		ITEM 31-32				

		PROJECT TOTAL				1,876,000.00
		ITEMS 1-32			1,768,051.50	

**Riverside County Transportation Department
Summary of Bids**

**PROJECT: Horsethief Canyon Road and Knabe Road Resurfacing Project
in the Temescal Valley area of Riverside County**

Advertised: June 19, 2012 (Agenda Item: 3.47)

Addenda: 1(7/10/12), 2(7/12/12)

Bids Open: 2 pm Date: Wednesday, July 18, 2012

PROJECT NO. C2-0137 & C0-0523

BASE BID ITEM NO.	ITEM CODE	CONTRACT ITEM	UNITS	QUANTITY	4		5	
					BID UNIT PRICE	BID ESTIMATE	BID UNIT PRICE	BID ESTIMATE
1	066102	DUST ABATEMENT	LS	1	5,000.00	5,000.00	3,500.00	3,500.00
2	074020	WATER POLLUTION CONTROL	LS	1	3,300.00	3,300.00	2,800.00	2,800.00
3	120100	TRAFFIC CONTROL SYSTEM	LS	1	75,750.00	75,750.00	32,000.00	32,000.00
4	160101	CLEARING AND GRUBBING	LS	1	10,000.00	10,000.00	2,500.00	2,500.00
5	170101	DEVELOP WATER SUPPLY	LS	1	4,700.00	4,700.00	3,996.00	3,996.00
6	190101	ROADWAY EXCAVATION	CY	570	32.60	18,582.00	37.00	21,090.00
7	011506	WEDGE PLANE ASPHALT CONCRETE	LF	21,000	0.70	14,700.00	1.10	23,100.00
8	011506	WEDGE PLANE ASPHALT CONCRETE - MEDIAN	LF	3,000	0.70	2,100.00	2.20	6,600.00
9	153103	COLD PLANE ASPHALT CONCRETE PAVEMENT	SQYD	1,000	1.07	1,070.00	3.30	3,300.00
10	000003	COLD IN-PLACE RECYCLING - MIX DESIGN, SAMPLING & TESTING	LS	1	38,900.00	38,900.00	75,000.00	75,000.00
11	020256	EMULSIFIED RECYCLING AGENT	TON	560	701.20	392,672.00	805.00	450,800.00
12	020255	COLD IN-PLACE RECYCLING	SQYD	88,500	4.17	369,045.00	2.80	247,800.00
13	390130	HOT MIX ASPHALT	TON	610	73.50	44,835.00	79.70	48,617.00
14	013901	ASPHALT RUBBER HOT MIX	TON	10,300	76.20	784,860.00	91.70	944,510.00
15	013904	PLACE ASPHALT CONCRETE DIKE (CRS 212) (8")	LF	1,800	4.45	8,010.00	6.00	10,800.00
16	017305	MINOR CONCRETE (CURB AND GUTTER) (CRS 201)	LF	500	32.30	16,150.00	24.00	12,000.00
17	017306	MINOR CONCRETE (CURB RAMP) (CRS 403)	EA	36	3,690.00	132,840.00	2,100.00	75,600.00
18	017317	MINOR CONCRETE (CROSS-GUTTER AND SPANDREL)	SQFT	250	12.40	3,100.00	11.00	2,750.00
19	731521	MINOR CONCRETE (SIDEWALK)	SQFT	500	7.32	3,660.00	8.30	4,150.00
20	017003	REPAIR CATCH BASIN (CURB INLET) (CRS 300)	EA	1	2,500.00	2,500.00	2,800.00	2,800.00
21	840519	THERMOPLASTIC CROSSWALK AND PAVEMENT MARKING	SQFT	3,540	4.95	17,523.00	3.60	12,744.00
22	840656	PAINT TRAFFIC STRIPE (2-COAT)	LF	35,900	0.27	9,693.00	0.30	10,770.00
23	850111	PAVEMENT MARKER (RETROREFLECTIVE)	EA	1,340	3.30	4,422.00	3.60	4,824.00
24	860811	DETECTOR LOOP	EA	26	163.00	4,238.00	200.00	5,200.00
25	152440	ADJUST STORM DRAIN MANHOLE TO GRADE	EA	17	575.00	9,775.00	600.00	10,200.00
26	566011	ROADSIDE SIGN - ONE POST	EA	39	300.00	11,700.00	250.00	9,750.00
27	150710	REMOVE TRAFFIC STRIPE	LF	1,000	1.45	1,450.00	2.00	2,000.00
28	000003	REMOVE AND SALVAGE SIGN AND POST	EA	10	50.00	500.00	83.50	835.00
29	000003	REPLACE EXISTING R1-1 ON EXISTING POST	EA	21	176.00	3,696.00	128.00	2,688.00
30	000003	FURNISH AND INSTALL STREET NAME SIGN (CRS 1220)	EA	12	405.00	4,860.00	222.00	2,664.00
SUBTOTAL (Base Bid)						1,999,631.00		2,035,388.00
ITEMS 1-30								

**Riverside County Transportation Department
Summary of Bids**

**PROJECT: Horsethief Canyon Road and Knabe Road Resurfacing Project
in the Temescal Valley area of Riverside County**

Advertised: June 19, 2012 (Agenda Item: 3.47)
Addenda: 1(7/10/12), 2(7/12/12)
Bids Open: 2 pm Date: Wednesday, July 18, 2012

PROJECT NO. C2-0137 & C0-0523

ALTERNATE BID (EVMWD & LEE LAKE WATER)		4		5				
ITEM NO.	ITEM CODE	CONTRACT ITEM	UNITS	QUANTITY	BID UNIT PRICE	BID ESTIMATE	BID UNIT PRICE	BID ESTIMATE
31	152475	ADJUST SEWER MH/CLEAN OUT TO GRADE - KNABE	EA	18	590.00	10,620.00	600.00	10,800.00
32	152475	ADJUST SEWER MH/CLEAN OUT TO GRADE - HORSETHIEF	EA	9	590.00	5,310.00	600.00	5,400.00
		SUBTOTAL (Alternate Bid) ITEM 31-32				15,930.00		16,200.00

		PROJECT TOTAL				2,015,561.00		2,051,588.00
		ITEMS 1-32						



COUNTY OF RIVERSIDE TRANSPORTATION AND LAND MANAGEMENT AGENCY



Juan C. Perez, P.E., T.E.
Director of Transportation

Transportation Department

ADDENDUM NUMBER 1

Dated July 10, 2012

to the
Specifications and Contract Documents
for the construction of

Horsethief Canyon Road and Knabe Road
Resurfacing Project in
The Temescal Valley Area of Riverside County

Project No. C2-0137 & C0-0523

Bids Due: (REVISED)
Wednesday, July 18, 2012; 2:00 PM
14th Street Transportation Annex
3525 14th Street; Riverside, CA 92501
(951) 955-6780

This Addendum is issued pursuant to the Instructions to Bidders, Item No. 8, of the Contract Documents for the reference project. This Addendum is issued as a supplement to the specification and special provisions for the referenced project. The revisions to the specifications shall become a part of the Contract Documents, and each bidder shall acknowledge receipt thereof on the Contractor's Proposal. Bidders are directed to sign this addendum as acknowledged, and attach the signed addendum to the contractor's submitted proposal.

Note: During the advertisement period of this project, this document and attachments (if any) are available upon request at the office of the Transportation Department, and are available as a free download at the Transportation Department's website:

http://www.rctlma.org/trans/con_bid_advertisements.html

MODIFICATIONS / CLARIFICATIONS TO SPECIAL PROVISIONS:

Item 1: The new designated date and time for the receipt and opening of bids is revised as follows:

Wednesday, July 18, 2012; 2:00 PM
14th Street Transportation Annex
3525 14th Street; Riverside, CA 92501
(951) 955-6780

Prepared by: _____

Joel Jimenez, PE; Senior Civil Engineer; Contracts/Bidding Unit

Acknowledged: _____ Date: _____

(Contractor)

JRJ:jjj



COUNTY OF RIVERSIDE TRANSPORTATION AND LAND MANAGEMENT AGENCY



Juan C. Perez, P.E., T.E.
Director of Transportation

Transportation Department

ADDENDUM NUMBER 2

Dated July 12, 2012

to the
Specifications and Contract Documents
for the construction of

Horsethief Canyon Road and Knabe Road
Resurfacing Project in
The Temescal Valley Area of Riverside County

Project No. C2-0137 & C0-0523

Bids Due: **Wednesday, July 18, 2012; 2:00 PM**
14th Street Transportation Annex
3525 14th Street; Riverside, CA 92501
(951) 955-6780

This Addendum is issued pursuant to the Instructions to Bidders, Item No. 8, of the Contract Documents for the reference project. This Addendum is issued as a supplement to the specification and special provisions for the referenced project. The revisions to the specifications shall become a part of the Contract Documents, and each bidder shall acknowledge receipt thereof on the Contractor's Proposal. Bidders are directed to sign this addendum as acknowledged, and attach the signed addendum to the contractor's submitted proposal.

Note: During the advertisement period of this project, this document and attachments (if any) are available upon request at the office of the Transportation Department, and are available as a free download at the Transportation Department's website:

http://www.rctlma.org/trans/con_bid_advertisements.html

MODIFICATIONS / CLARIFICATIONS TO SPECIAL PROVISIONS:

Item 1: Revised Proposal.

Refer to "Proposal" pages B3. Proposal (page B3) is deleted and replaced with revised "Proposal" attached herewith as **Attachment "A"** (two pages). The following changes have been made to the Proposal Schedule:

- a. The quantities of following bid items have been revised:
 - Item 21, "THERMOPLASTIC CROSSWALK AND PAVEMENT MARKING"
 - Item 22, "PAINT TRAFFIC STRIPE (2-COAT)"
 - Item 23, "PAVEMENT MARKER (RETROFLECTIVE)"

b. The following bid items have been added to the bid proposal:

- Item 26, "ROADSIDE SIGN - ONE POST"
- Item 27, "REMOVE TRAFFIC STRIPE"
- Item 28, "REMOVE AND SALVAGE SIGN AND POST"
- Item 29, "REPLACE EXISTING R1-1 SIGN ON EXISTING POST"
- Item 30, "FURNISH AND INSTALL STREET NAME SIGN (CRS 1220)"

c. Alternate Bid has been revised. Two bid items from previous proposal have been deleted and remainder two items have been renumbered. See revised proposal.

See Attachment "A", Revised Proposal

Item 2: Wedge Plane/Cold Plane Asphalt Concrete Pavement.

Refer to payment clause for Section "Wedge Plane/Cold Plane Asphalt Concrete Pavement " on page 67 of the Special Provisions. Pay clause revised to read as follow:

"The contract unit bid price paid per Linear Foot for Wedge Plane/Cold Plane Asphalt Concrete Pavement shall include full compensation for providing all labor, tools, equipment and disposing of the grindings, and no additional compensation will be allowed therefor."

Item 3: Cold-in-Place Recycling.

Refer to section "Cold-in-Place Recycling" and subsection entitled "Emulsified Recycling Agent" on page 82. Delete this subsection and replace with the following:

Emulsified Recycling Agent

The Emulsified Recycling Agent shall be a polymer modified rejuvenating emulsion with a latex polymer, rejuvenating agent, and paving asphalt and shall conform to the following requirements:

Table A. Recycling Agent

Emulsified Recycling Agent Requirements			
	Test Method	Requirement	
		Minimum	Maximum
Tests on emulsion:			
Sieve test, % of weight sample	AASHTO T59 ^a	---	0.1
Residue by distillation, %	AASHTO T59 ^a	60	--
Rap Coating Test (min)	AASHTO T59 ^a	Good	
Tests on residue by distillation:			
Penetration at 25°C, 100 g / 5 sec (TV) (min)	AASHTO T49 ^{b,d,e}	TV +/- 25 percent ^c	
Absolute Viscosity at 60°C, Pascal second (x10 ⁻¹) (TV) ^d	AASHTO T2171	Report Only	

Notes:

- ^a Modify AASHTO T 59 - distillation temperature of 350°F with a 20 minute hold.
- ^b CIR mixture emulsified recycling agent and water application rates to be determined using jobsite RAP in CIR mix design and submitted in job mix formula.
- ^c Target value (TV) is determined for emulsified recycling agent chosen for use and submitted in job mix formula.
- ^d Sieve residue from distillation on No. 20 sieve before determining viscosity.
- ^e Modified procedure may be used: The sample shall be removed from the bath, shaken gently to remove free water from the surface of the specimen, tested in a dry surface state, and then immediately replaced in the water bath in less than 60 seconds. Repeat for determination.

The latex polymer shall conform to the requirements in Table B:

Table B. Latex Polymer

Latex Polymer Requirements			
	Test Method	Requirement	
		Minimum	Maximum
Test on Latex Polymer:			
Specific Gravity	ASTM D1475	1.08	---
Tensile strength, die C dumbbell, psi	ASTM D412 ⁽¹⁾	500	---
Swelling in rejuvenating agent, %; 48 hours exposure @ 104°F	ASTM D471 ⁽²⁾ Modified	---	40% intact film

⁽¹⁾ Tensile Strength Determination: Samples for testing for tensile strength in accordance with ASTM D412 shall be cut using a die dumbbell at a crosshead speed of 20 in/min.

⁽²⁾ Latex Testing: Suitable substrate for film formation shall be polyethylene boards, silicone rubber sheeting, glass, or any substrate which produces a cured film of uniform cross-section. Polymer film shall be prepared from latex as follows:

Resistance to Swelling: Polymer films shall be formed by using a 50 mil drawdown bar and drawing down 50 mils of the latex on polyethylene boards. Films shall be cured for 14 days at 75°F and 50% humidity. Samples for resistance to swelling in rejuvenating agent shall be 1" by 2" rectangles cut from the cured film. Cut at least 3 specimens for each sample to be tested for swelling. Fill 3- 8 oz ointment tins with at least a ½" deep of rejuvenating agent. Swelling samples shall be weighed and then placed in the ointment tins on top of the rejuvenating agent. Then, add at least another ½" deep of rejuvenating agent over each of the latex samples. The ointment tins shall be covered and placed in an oven at 104°F for the specified 48 hours +/- 15 minutes. The ointment tins are allowed to cool to 75°F and then the latex films are removed from the tins. Unabsorbed rejuvenating agent is removed from the intact latex film by scraping with a rubber policeman and blotting with paper towels. If the latex film does not remain intact during removal from the tins or while removing the unabsorbed rejuvenating agent the sample shall be rejected. After the rejuvenating agent is removed from the samples they are then weighed. Percent swelling is reported as weight increase of the polymer film; report mass increase as a percent by weight of the original latex film mass upon exposure of films to the recycling agent.

The rejuvenating agent shall meet the requirements in Table C:

Table C. Rejuvenating Agent

Rejuvenating Agent Requirements			
	Test Method	Requirement	
		Minimum	Maximum
Test on Rejuvenating Agent:			
Viscosity, 140F, CST	ASTM D2170	50-175	
Flash Point, F, COC	ASTM D92	380	---
Saturate, % by wt.	ASTM D2006-70	---	30
Asphaltenes	ASTM D2006-70	---	1.0
Test on Residue:			
Weight Change, %	ASTM D2872	---	6.5
Viscosity Ratio (RTFO/Original)	ASTM D2170	---	3.0

Paving asphalt used to make the emulsified recycling agent shall conform to the requirements of the Performance Graded (PG) Asphalt Binder Specified in AASHTO M320. The Certificate of Compliance shall indicate the target value for penetration, and bending beam results."

Also refer to **page 84** and delete the reference of "Table B" from the text and title on table and replace with "**Table D**".

SUMMARY

HORSETHIEF CANYON ROAD

Domestic Water Valves	Lowered and raised by Contractor
Reclaimed Water Valves	Removed by Contractor, new valve covers and slip can installed by Owner to be raised to finish surface by Contractor
Sewer Manholes	Contractor to provide cost to lower and raise
Storm Drain Manholes	Lowered and raised by Contractor
All others	Protect in place

KNABE ROAD

Domestic Water Valves	Lowered and raised by Contractor
Reclaimed Water Valves	None
Sewer Manholes	Contractor to provide cost to lower and raise
Storm Drain Manholes	Lowered and raised by Contractor
All others	Protect in place

Full compensation for the removal of the existing reclaimed water concrete encased frames and covers shall be in accordance with the second paragraph of the Payment clause of the subsection entitled "Adjustment to Grade for Obstructions" of the Special Provision entitled "Obstructions" (page 55 of the contract documents.)

See Attachment "B", Valve Well and Riser Detail drawing

Item 5: Roadside Sign (Install)

The following Special Provision is added to the Contract Documents and made part hereof:

ROADSIDE SIGN (INSTALL):

Roadside signs (install) shall conform to the provisions in Section 56-2 "Roadside Signs" of the Standard Specifications and these special provisions.

The Contractor shall furnish and install roadside signs, in accordance with Standard Plans RS-2, at the locations shown on the plans or as directed by the Engineer.

Roadside signs with steel posts shall be installed at the location shown on the construction plans or where directed by the Engineer.

Roadside signs furnished by the Contractor shall be of the standard size specified in the State of California Department of Transportation Sign Specification Sheets, unless otherwise indicated on the construction plans.

Sheeting shall be guaranteed against defects for a period of ten years from the date of fabrication.

The base metal shall be new aluminum, 0.08 gauge, of alloys 6061-T6 or 5052-H38 conforming to the requirements of ASTM Designation: B209.

Any reflective sheeting supplied, as a part of this contract, whether as a legend or background, shall be FHWA FP-85 Type IIA or AASHTO M268 Type III.

Reflective sheeting shall be applied to the sign by a method approved by the manufacturer of the sheeting and shall produce a durable bond equal to or greater than the strength of the reflective sheeting. No air pockets or bubbles shall exist between the sheeting and aluminum backing.

The reflective material and screening inks or overlay film shall be graffiti proof. The graffiti proofing method shall be supplied by and/or approved by the sheeting manufacturer. Neither the color nor the reflective intensity of the finished sign shall be significantly diminished by the use of graffiti remover when used in a manner approved by the Transportation Department in conjunction with the sheeting manufacturer. Any sign graffiti with the use of over-the-counter spray paint or marking pens, which fail to be restored, shall be replaced by the sign sheeting manufacturer.

All letters and numerals shall be in accordance with the "Standard Alphabet of Highway Signs" as used by the State of California, Department of Transportation.

All signs shall be installed using hex head bolts, washers, nuts and jam nuts in accordance with Standard Plans RS2 or as directed by the Engineer.

Method of Payment

The contract price paid per each Roadside Sign shall include full compensation for furnishing all labor, materials, tools, equipment, incidentals, and for doing all the work involved including all necessary concrete, excavation and backfill as specified in the Standard Specification and these Special Provisions and no additional compensation will be allowed therefor.

Item 6: Remove and Salvage Sign and Post.

The following Special Provision is added to the Contract Documents and made part hereof:

REMOVE AND SALVAGE SIGN AND POST:

Existing roadside signs and post, shall be removed, and salvaged as shown on the plans.

Existing roadside signs at locations shown on the plans to be removed shall not be

removed until replacement signs have been installed or until the existing signs are no longer required for direction of public traffic, unless otherwise directed by the Engineer.

County owned removed and salvaged signs shall be delivered to the nearest County Maintenance Yard or as directed by the Engineer. The County Maintenance Yard is located at the following address:

19355 Ontario Avenue
Corona, CA 92881-4258
(951) 737-2310

Method of Payment

The contract price paid per each for remove and salvage sign and post shall include full compensation for furnishing all labor, materials, tools, equipment, incidentals and for doing all the work including protecting, storing, transporting and delivering Road Sign as specified in the these Special Provisions and no additional compensation will be allowed therefor.

Item 7: Remove Traffic Stripe.

The following Special Provision is added to the Contract Documents and made part hereof:

REMOVE TRAFFIC STRIPE

Where blast cleaning/grinding is used for the removal of painted/thermoplastic traffic stripes or for removal of objectionable material, and such removal operation is being performed within 10 feet of a lane occupied by public traffic, the residue including dust shall be removed immediately after contact between the sand and the surface being treated. Such removal shall be by wet abrasive blasting, hydro-blasting or vacuum blasting, and shall comply with AQMD regulations.

Blast cleaning/grinding for removal of traffic stripes shall be feathered out to irregular and varying widths.

After removal of traffic stripes, a fog seal coat shall be applied in conformance with the provisions in Section 37, "Bituminous Seals" of the Standard Specifications and the following:

If removal of existing striping is performed more than 24 hours prior to final striping, the Contractor shall place reflective temporary striping tape throughout the limits of sandblasting, to provide channelization of traffic, for all lanes of travel.

Temporary striping tape shall be removed subsequent to final striping.

Nothing in these Special Provisions shall relieve the Contractor from his responsibilities as provided in Section 7-1.09, "Public Safety" of the Standard Specifications.

Method of Payment

The contract price paid per linear foot for Remove Traffic Stripe shall include full compensation for furnishing all labor, materials, tools, equipment, incidentals and no additional compensation will be allowed therefor.

Item 8: Replace Existing R1-1 sign on Existing Post.

The following Special Provision is added to the Contract Documents and made part hereof:

REPLACE EXISTING R1-1 SIGN ON EXISTING POST:

Contractor shall remove and replace existing R1-1 signs with new R1-1 signs on existing post where shown on the plan in conformance with Section 56-2 "Roadside Signs" of the Standard Specifications and these special provisions.

The removed sign shall be salvaged at the nearest County Yard and/or as directed by the Engineer. The County Maintenance Yard is located at the following address:

19355 Ontario Avenue
Corona, CA 92881-4258
(951) 737-2310

Method of Payment

The contract price paid per each for replace existing R1-1 Sign on existing post shall include full compensation for furnishing all labor, materials, tools, equipment, incidentals and for doing all the work including protecting, storing, transporting and delivering Sign as specified in the these Special Provisions and no additional compensation will be allowed therefor.

Item 9: Furnish and Install Street Name Sign.

The following Special Provision is added to the Contract Documents and made part hereof:

FURNISH AND INSTALL STREET NAME SIGN:

Street name signs shall furnish and install in conform with the County Road Improvement Standard, Standard Specifications and these Special Provisions and as directed by the Engineer.

Method of Payment

The contract price paid per each for furnish and install street name sign shall include full compensation for furnishing all labor, materials, tools, equipment, incidentals and for doing all the work including excavation and backfill, and installation as specified in the Standard Specification and these Special Provisions and no additional compensation will be allowed therefor.

See Attachment "C", Street Name Sign Standard drawing

This addendum has been prepared under the direction of the following registered Civil Engineer:

Recommended by:

Michael O. Mueting, PE
County Project Manager



Concurrence:

 7/12/12
Khalid Nasim, PE
Engineering Division Manager

Acknowledged: _____ **Date:** _____
(Contractor)

JRJ:jj:sb

AGREEMENT

THIS AGREEMENT is entered into at Riverside, California as of the date set forth below is between County of Riverside hereafter called "County" and **All American Asphalt** hereafter called "Contractor".

W I T N E S S E T H

RECITALS:

1. Contractor has submitted to County his Contractor's Proposal for the construction of County Project, **Horsethief Canyon Road and Knabe Road Resurfacing Projects in the Temescal Valley area of Riverside County, Project No. C2-0137 & C0-0523**, in strict accordance with the Contract Documents identified below and County has accepted said Proposal.
2. Contractor states that he has reexamined his Contractor's Proposal and found it to be correct, has ascertained that his subcontractors are properly licensed and possess the requisite skill and forces, has reexamined the site and Contract Documents and is of the opinion that he can presently do the work in accordance with the Contract Documents for the money set forth in his Proposal to be paid as provided in the Contract Documents.

AGREEMENT:

IT IS AGREED BY THE PARTIES AS FOLLOWS:

1. Contract Documents. The entire contract consists of the following: (a) The Agreement. (b) The Notice Inviting Bids. (c) The Instruction to Bidders. (d) The Contractor's Proposal. (e) The Bid Bond. (f) The Payment Bond. (g) The Performance Bond. (h) The General Conditions. (i) The Special Provisions. (j) The Standard Specifications of the State of California Department of Transportation edition of May 2006 as modified in other portions of the Contract Documents. (k) The Standard Plans of the Department of Transportation identified on the plans or in the Special Provisions. (l) The Plans. (m) Addenda (**two**). (n) The Determination of Prevailing Wage Rates for Public Work. (o) Any Change Orders issued. (p) Any additional or supplemental specifications, notice, instructions and drawings issued in accordance with the provisions of the Contract Documents. All of said Documents presently in existence are by this reference incorporated herein with like effect as if here set forth in full and upon the proper issuance of other documents they shall likewise be deemed incorporated. The Bid Bond is exonerated upon execution of this Agreement and the Payment Bond and Faithful Performance Bond.
2. The Work. Contractor shall do all things necessary to construct the work generally described in Recital No. 1 in accordance with the Contract Documents.

3. Liquidated Damages and Time of Completion. Attention is directed to the provisions in Section 8-1.06, "Time of Completion", and in Section 8-1.07, "Liquidated Damages", of the Standard Specifications and these Special Provisions.

The Contractor shall begin work within 15 days of the date stated within the written "Notice to Proceed".

The Contractor shall notify the Engineer, in writing, of his intent to begin work at least 72 hours before work is begun. The notice shall be delivered to the Transportation Department's Construction Engineer and shall specify the date the Contractor intends to start. If the project has more than one location of work, a separate notice shall be given for each location.

Should the Contractor begin work in advance of receiving a written "Notice to Proceed", any work performed by him in advance of the date stated in the "Notice to Proceed" shall be considered as having been done by him at his own risk and as a volunteer and subject to the following:

- (1) The Contractor shall, on commencing operations, take all precautions required for public safety and shall observe all the provisions in the Specifications and the Special Provisions.
 - (2) All work done according to the contract prior to the issuance of the "Notice to Proceed", will be considered authorized work and will be paid for as provided in the contract.
 - (3) The Contractor shall not be entitled to any additional compensation or an extension of time for any delay, hindrance or interference caused by or attributable to commencement of work prior to the issuance of the "Notice to Proceed".
4. Compensation. Contractor shall be paid in the manner set forth in the Contract Documents the amount of his Proposal as accepted by County, the above rates, subject to additions and deductions as provided in the Contract Documents. Said Proposal is on file in the Office of the Clerk of the Board of Supervisors of County.

**HORSETHIEF CANYON ROAD AND KNABE ROAD
RESURFACING PROJECTS IN THE TEMESCAL VALLEY AREA OF
RIVERSIDE COUNTY
PROJECT No. C2-0137 & C0-0523**

AGREEMENT

BASE BID

ITEM No.	ITEM CODE	ITEM	UNIT	ESTIMATED QUANTITY	ITEM PRICE (IN FIGURES)	TOTAL (IN FIGURES)
1	066102	DUST ABATEMENT	LS	1	13,815.00	13,815.00
2	074020	WATER POLLUTION CONTROL	LS	1	2,500.00	2,500.00
3	120100	TRAFFIC CONTROL SYSTEM	LS	1	12,000.00	12,000.00
4	160101	CLEARING AND GRUBBING	LS	1	3,100.00	3,100.00
5	170101	DEVELOP WATER SUPPLY	LS	1	1,840.00	1,840.00
6	190101	ROADWAY EXCAVATION	CY	570	11.20	6,384.00
7	011506	WEDGE PLANE ASPHALT CONCRETE	LF	21,000	0.83	17,430.00
8	011506	WEDGE PLANE ASPHALT CONCRETE - MEDIAN	LF	3,000	0.83	2,490.00
9	153103	COLD PLANE ASPHALT CONCRETE PAVEMENT	SQYD	1,000	1.24	1,240.00
10	000003	COLD IN-PLACE RECYCLING - MIX DESIGN, SAMPLING & TESTING	LS	1	33,660.00	33,660.00
11	020256	EMULSIFIED RECYCLING AGENT	TON	560	684.00	383,040.00
12	020255	COLD IN-PLACE RECYCLING	SQYD	88,500	3.31	292,935.00
13	390130	HOT MIX ASPHALT	TON	610	69.00	42,090.00
14	013901	ASPHALT RUBBER HOT MIX	TON	10,300	71.30	734,390.00
15	013904	PLACE ASPHALT CONCRETE DIKE (CRS 212) (8")	LF	1,800	7.00	12,600.00
16	017305	MINOR CONCRETE (CURB AND GUTTER) (CRS 201)	LF	500	43.00	21,500.00
17	017306	MINOR CONCRETE (CURB RAMP) (CRS 403)	EA	36	2,300.00	82,800.00
18	017317	MINOR CONCRETE (CROSS-GUTTER AND SPANDREL)	SQFT	250	24.60	6,150.00
19	731521	MINOR CONCRETE (SIDEWALK)	SQFT	500	5.70	2,850.00
20	017003	REPAIR CATCH BASIN (CURB INLET) (CRS 300)	EA	1	8,800.00	8,800.00
21	840519	THERMOPLASTIC CROSSWALK AND PAVEMENT MARKING	SQFT	3,540	3.80	13,452.00
22	840656	PAINT TRAFFIC STRIPE (2-COAT)	LF	35,900	0.22	7,898.00
23	850111	PAVEMENT MARKER (RETROFLECTIVE)	EA	1,340	4.20	5,628.00

**AGREEMENT
(CONTINUED)**

ITEM No.	ITEM CODE	ITEM	UNIT	ESTIMATED QUANTITY	ITEM PRICE (IN FIGURES)	TOTAL (IN FIGURES)
24	860811	DETECTOR LOOP	EA	26	184.00	4,784.00
25	152440	ADJUST STORM DRAIN MANHOLE TO GRADE	EA	17	560.00	9,520.00
26	566011	ROADSIDE SIGN - ONE POST	EA	39	231.00	9,009.00
27	150710	REMOVE TRAFFIC STRIPE	LF	1,000	1.00	1,000.00
28	000003	REMOVE AND SALVAGE SIGN AND POST	EA	10	52.00	520.00
29	000003	REPLACE EXISTING R1-1 ON EXISTING POST	EA	21	102.00	2,142.00
30	000003	FURNISH AND INSTALL STREET NAME SIGN (CRS 1220)	EA	12	372.00	4,464.00

SUBTOTAL, BASE BID, ITEMS 1-30:

One million, seven hundred forty thousand, thirty one dollars and zero cents \$1,740,031.00
"WORDS"

ALTERNATE BID (EVMWD & LEE LAKE WATER)

ITEM No.	ITEM CODE	ITEM	UNIT	ESTIMATED QUANTITY	ITEM PRICE (IN FIGURES)	TOTAL (IN FIGURES)
31	152475	ADJUST SEWER MH/CLEAN OUT TO GRADE - KNABE	EA	18	560.00	10,080.00
32	152475	ADJUST SEWER MH/CLEAN OUT TO GRADE - HORSETHIEF	EA	9	560.00	5,040.00

SUBTOTAL, ALTERNATE BID, ITEMS 31-32:

Fifteen thousand one hundred twenty dollars and zero cents. \$ 15,120.00
" Words"

PROJECT TOTAL, ITEMS 1-32:

One million, seven hundred fifty five thousand, one hundred fifty one dollars and zero cents. \$ 1,755,151.00
" Words"

**HORSETHIEF CANYON ROAD AND KNABE ROAD
RESURFACING PROJECTS IN THE TEMESCAL VALLEY AREA OF
RIVERSIDE COUNTY
PROJECT No. C2-0137 & C0-0523**

IN WITNESS WHEREOF the parties hereto have executed this agreement as of the date set forth below.

COUNTY OF RIVERSIDE

ALL AMERICAN ASPHALT.

BY _____
Chairman, Board of Supervisors

BY _____

Dated _____

TITLE: _____
(If Corporation, Affix Seal)

ATTEST:

ATTEST:

Kecia Harper-Ihem, Clerk of the Board

BY _____
Deputy

TITLE: _____

Licensed in accordance with an act providing for the registration of Contractors,

License No. _____

Federal Employer Identification Number:

BY _____
"County"
(Seal)

_____ "Corporation"
(Seal)



ALL AMERICAN ASPHALT ALL AMERICAN AGGREGATES

P.O. BOX 2229, CORONA, CA 92878-2229
STATE CONTRACTORS LICENSE #267073-A

CORPORATE RESOLUTION

Resolved, that this Corporation, All American Asphalt, on June 1, 2012 authorizes Robert Bradley to execute contracts and agreements on behalf of the Company in the capacity of Vice President.



Michael Farkas
Secretary

PERFORMANCE BOND

Recitals:

1. **All American Asphalt** (Contractor) has entered into an Agreement with COUNTY OF RIVERSIDE (County) for construction of public work known as **Horsethief Canyon Road and Knabe Road Resurfacing Projects in the Temescal Valley area of Riverside County, Project No. C2-0137 & C0-0523**
2. _____, a _____ corporation (Surety), is the Surety under this Bond.

Agreement:

We, Contractor, as Principal, and Surety, as Surety, jointly and severally agree, state, and are bound unto County, as obligee, as follows:

1. The amount of the obligation of this Bond is 100% of the estimated contract price for the Project of \$ **1,755,151.00 (One million seven hundred fifty five thousand, one hundred fifty one dollars and zero cents)**, and inures to the benefit of County.
2. This Bond is exonerated by Contractor doing all things to be kept and performed by it in strict conformance with the Contract Documents for the Project, otherwise it remains in full force and effect for the recovery of loss, damage and expense of County resulting from failure of Contractor to so act. All of said Contract Documents are incorporated herein.
3. This obligation is binding on our successors and assigns.
4. For value received, Surety stipulates and agrees that no change, time extension, prepayment to Contractor, alteration or addition to the terms and requirements of the Contract Documents or the work to be performed thereunder shall affect its obligations hereunder and waives notice as to such matters, except the total contract price cannot be increased by more than 10% without approval of Surety.

THIS BOND is executed as of _____.

By _____

By _____

By _____

Type Name _____

Its Attorney in Fact
"Surety"

Title _____

"Contractor"

(Corporate Seal)

(Corporate Seal)

NOTE: This Bond must be executed by both parties with corporate seal affixed for each party. All signatures must be acknowledged. (Attach acknowledgements).

PAYMENT BOND

(Public Work - Civil Code 3247 et seq.)

The makers of this Bond are **All American Asphalt** as Principal and Original Contractor and _____, a corporation, authorized to issue Surety Bonds in California, as Surety, and this Bond is issued in conjunction with that certain public works contract to be executed between Principal and COUNTY OF RIVERSIDE a public entity, as Owner, for \$ **1,755,151.00 (One million seven hundred fifty five thousand, one hundred fifty one dollars and zero cents)**, the total amount payable. THE AMOUNT OF THIS BOND IS ONE HUNDRED PERCENT OF SAID SUM. Said contract is for public work generally consisting of **Horsethief Canyon Road and Knabe Road Resurfacing Projects in the Temescal Valley area of Riverside County, Project No. C2-0137 & C0-0523**

The beneficiaries of this Bond are as is stated in 3248 of the Civil Code and requirements and conditions of this Bond are as is set forth in 3248, 3249, 3250 and 3252 of said code. Without notice, Surety consents to extension of time for performance, change in requirements, amount of compensation, or prepayment under said contract.

DATED: _____

Original Contractor - Principal

Surety

By _____

By _____
Its Attorney In Fact

Title _____

(Corporate Seal)

(If corporation, affix seal)

(Corporate Seal)

STATE OF CALIFORNIA }
COUNTY OF _____ } ss. SURETY'S ACKNOWLEDGEMENT

On _____ before me, _____ personally appeared, _____, known to me, or proved to me on the basis of satisfactory evidence, to be the person whose name is subscribed to the within instrument and acknowledged to me that he/she executed the same in his/her authorized capacities, and that by his/her signature on the instrument the person, or the entity upon behalf of which the person acted, executed the instrument.

WITNESS my hand and official seal.

Signature of Notary Public

Notary Public (Seal)

NOTE: This Bond must be executed by both parties with corporate seal affixed for each party. All signatures must be acknowledged. (Attach acknowledgements).