

**SUBMITTAL TO THE BOARD OF SUPERVISORS  
COUNTY OF RIVERSIDE, STATE OF CALIFORNIA**

754



**FROM:** Successor Agency to the Redevelopment Agency

**SUBMITTAL DATE:**  
August 16, 2012

**SUBJECT:** Mead Valley Library – Change Order #4R2

**RECOMMENDED MOTION:** That the Board of Supervisors approve and authorize the Chairman of the Board to execute the attached Change Order #4R2 between Stronghold Engineering, Inc. and the County of Riverside for the upgraded waterline improvements on Oakwood Street in the amount of \$103,085.

**BACKGROUND:** On June 28, 2011, the Board of Directors awarded construction of the Mead Valley Library Project to Stronghold Engineering, Inc. The project was initially designed to include a 6-inch water line to serve the project. During the plan check process with Eastern Municipal Water District (EMWD), upgraded water line requirements were added to the project and made part of the project's responsibilities.

(Continued)

Robert Field  
Assistant County Executive Officer/EDA

<b>FINANCIAL DATA</b>	Current F.Y. Total Cost:	\$ 103,085	In Current Year Budget:	Yes
	Current F.Y. Net County Cost:	\$ 0	Budget Adjustment:	No
	Annual Net County Cost:	\$ 0	For Fiscal Year:	2012/13

**COMPANION ITEM ON BOARD AGENDA:** No

<b>SOURCE OF FUNDS:</b> I-215 Corridor Redevelopment Project Area Capital Improvement Funds – Mead Valley Sub-Area (previously approved budget)	<b>Positions To Be Deleted Per A-30</b>	<input type="checkbox"/>
	<b>Requires 4/5 Vote</b>	<input type="checkbox"/>

**C.E.O. RECOMMENDATION:**

APPROVE

Jennifer L. Sargent

**County Executive Office Signature**

Prev. Agn. Ref.: 4.11 of 6/28/11

District: 1/1

Agenda Number:

4.5

ATTACHMENTS FILED  
WITH THE CLERK OF THE BOARD

FISCAL PROCEDURES APPROVED  
 PAUL ANGULO, CPA, AUDITOR-CONTROLLER Reviewed by  
 BY: MARSHA L. VICTOR DATE: 7/17/12  
 BY: SAMUEL WONG DATE: 8/15/12

Dep't Recomm.:  Consent  Policy  
 Per Exec. Ofc.:  Consent  Policy

**BACKGROUND:** (Continued)

Since this project is making Oakwood Street an access road, it was determined that a 12-inch main water line instead of 6-inch water line would be required and would run the length of Oakwood Street with Clark Street being the point of connection. These improvements will tie into their existing infrastructure water system and in turn result in additional water line costs to the project.

The change order is well within the 10% contingency established in the Recognized Obligation Payment Schedule, which has been approved by the Oversight Board and the California Department of Finance. Change Order #4R2 will be processed in accordance with the terms of the original construction contract. The cost for Change Order #4R2 will not be an additional cost to the project as it is accounted for in the approved budget and a budget adjustment is not required.

Staff recommends that the Board approve Change Order #4R2, in the amount of \$103,085 for the additional upgraded water line requirements per the approved water improvement plans.

Attached:

- Change Order #4R2

**COUNTY OF RIVERSIDE EDA AS SUCCESSOR AGENCY TO THE REDEVELOPMENT AGENCY  
FOR THE COUNTY OF RIVERSIDE**

**CHANGE ORDER NO. 4R2**

Date: 6/4/2012

Project: Mead Valley Library

To Contractor:  
Stronghold Engineering  
2000 Market Street  
Riverside, CA 92501

Project No: 20110060 - ED15040010  
**Distribution:**  
Project Manager      Construction Manager  
Contractor            Inspector  
Fiscal                    Architect/Engineer

The County hereby makes the following unilateral offer to resolve PCO #4R2 listed below: Contractor may reserve claim rights as to balance due if contractor can show justification.

- |     |  |        |               |
|-----|--|--------|---------------|
| 1)  | PCO #4R2 Unilateral - Additional Offsite work on Oakwood St. | ADD    | \$ 103,084.57 |
| 2)  |  | ADD    |               |
| 3)  |  | DEDUCT |               |
| 4)  |  | DEDUCT |               |
| 5)  |  | ADD    |               |
| 6)  |  | DEDUCT |               |
| 7)  |  | ADD    |               |
| 8)  |  | ADD    |               |
| 9)  |  | ADD    |               |
| 10) |  | ADD    |               |
| 11) |  | ADD    |               |

The specifications, where pertinent, shall apply to these changes.  
This Change Order provides for a time extension of 0 calendar days  
Original Contract Duration (calendar days): 395  
Prior Authorized Time Extension (calendar days): 25  
Revised Construction Duration (calendar days): 420  
Original Contract Completion Date: 8/25/2012  
Revised Contract Completion Date: 9/19/2012

NOTE: This change order is not effective until ALL signatures below are obtained, and if applicable, signature authority approval by Form 11 as indicated per Change Order Guidelines.

The undersigned contractor has given careful consideration to the change proposed, including its effect on other work already contracted for, and hereby agrees, if this change order is approved, that he will provide all equipment, furnish all materials, except as may otherwise be noted above, and perform all services necessary for the work above specified, and will accept as full payment for all costs related in any way thereto the prices shown above.

1) B. Bailey 7.12.12  
Contractor (signature)      Date  
Beverly A. Bailey  
Contractor's Printed name  
Original Contract      \$ 8,660,127.00  
Prior Authorized [ X ] ADD [ ] DED      \$ 41,041.65  
Total Contract Prior to this Change      \$ 8,701,168.65

2) \_\_\_\_\_  
Chairman of the Board (signature)      Date  
John Tavaglione  
Chairman of the Board Printed name  
Authorized Changes on this C.O.:  
Addition \$ 103,084.57  
Deduction \$ 0.00  
NET: [ X ] Addition [ ] Deduction      \$ 103,084.57

3) William Judge 6.6.12  
Architect (signature)      Date  
William Judge  
Architect's Printed name  
Amount of Contract Authorized  
Including this Change Order      \$ 8,804,253.22

4) Marina Perez 6-4-2012  
Project Manager (signature)      Date  
Gloria Perez  
Project Manager's Printed name

Successor Agency Change Order Form - Revised 3-29-12

FORM APPROVED COUNTY COUNSEL

BY: Marshall Victor 7/17/12  
MARSHAL VICTOR      DATE



## STRONGHOLD ENGINEERING, INC.

Corporate Office:

2000 Market Street, Riverside, CA 92501 • Tel (951) 684-9303 • Fax (951) 684-9329 • Estimating Fax (951) 684-3813

Established 1991

To : GLORIA PEREZ- REGIONAL MGR- RIVERSIDE COUNTY EDA  
From : DENNY MCGAHEY  
Date : MAY 3, 2012  
Subject : MEAD VALLEY LIBRARY- SITE WATER CO NARRATIVE-PCO#4R2

---

PROJECT : PROJECT# 11005- MEAD VALLEY LIBRARY- PERRIS CA

Dear Gloria,

The attached cost proposal is for the revised site water plan with revisions required by Eastern Municipal Water District (EMWD). The original contract scope of work for the water line is delineated in the attached site plan noted as exhibit A. The contract work calls for a 6" water line with a point of connection (POC) at Clark St, totaling 155 lf. We have provided a detailed cost breakdown for this scope of work including all required appurtenances, which is attached as exhibit C.

EMWD did not provide their plan check comments until long after Stronghold Engineering Inc. (SEI) was awarded this project. They ultimately decided early in 2012 that EDA needed to provide a new 12" water main running the entire length of the project site along Oakwood St. Their arduous plan check and permitting process was not completed until February 27<sup>th</sup> 2012, almost 7 months after start of construction. This 7 month delay in permitting significantly impacted our ability to complete this work in proper sequence. In fact, SEI has been unable to complete any site work due to this issue, which was originally scheduled to begin October 25, 2011. In the spirit of partnering, SEI has totally re-sequenced the entire project to mitigate a vast majority of the delay impact to the project schedule due to EMWD's long permitting process. We are requesting only 21 calendar days of additional time for this revised scope of work, thanks to our team's final work around plan even though we are starting all site work 7 months behind our original approved contract schedule.

The final EMWD plan added 540 lf of 12" water main, a new hydrant and appurtenances. They also required EDA to provide new water meters and connections to the new 12" water main for all other homeowners that share Oakwood St. with the Library, all delineated in the attached revised plan marked exhibit B. We have provided a detailed cost breakdown for this revised scope of work including all required appurtenances, which is attached as exhibit D. The net cost for all items is \$122,420.00, and are broken down in and incorporated into the attached PCO#4R2 for your review and approval. Your help expediting review and approval of this critical item would be greatly appreciated.

---

**BUILDING CONSTRUCTION EXCELLENCE**

[www.strongholdengineering.com](http://www.strongholdengineering.com)

California • Arizona • Nevada • Florida • Hawaii • International

PROPOSAL/ESTIMATE FOR CONTRACT MODIFICATION

DATE: 30-Apr-12

CONTRACT TITLE: Mead Valley Library CONTRACT NO: 75 10621-00

Owner Rep: Attn: Gloria Perez

DESCRIPTION: PCO#04R2- Revised Wet Utilities per EMWD Requirements SEI No. PCO # 004R2

PRIME CONTRACTOR'S WORK				Revisions/comments	
1. Direct Materials				\$16,575.00	16,575.00
2. Sales Tax on Materials	9.75% of line 1	Included	9.75%	\$0.00	
3. Direct Labor				\$0.00	
4. Insurance, Taxes, and Fringe Benefits	39.0% of line 3	Included	39.0%	Inc above	
5. Rental Equipment				\$0.00	
6. Sales Tax on Rental Equipment	9.75% of line 5		9.75%	\$0.00	
7. Equipment Ownership and Operating Expenses				\$0.00	
8. SUBTOTAL (add lines 1-7)				\$16,575.00	
9. Field Overhead	0% of line 8		0.00%	\$0.00	
10. SUBTOTAL (Add Lines 8 & 9)				\$16,575.00	

Prime Remarks: General Conditions for 21 additional calendar days impact due to delaying this scope of work.

SUB-CONTRACTOR'S WORK				Revisions/comments	
11. Direct Materials				\$0.00	
12. Sales Tax on Materials	0.00% of line 11	Included	0.00%	\$0.00	
13. Direct Labor				\$84,524.99	
14. Insurance, Taxes, and Fringe Benefits	0.0% of line 13	Included	0.0%	\$0.00	
15. Rental Equipment				\$0.00	
16. Sales Tax on Rental Equipment	9.75% of line 15	Included	9.75%	\$0.00	
17. Equipment Ownership and Operating Expenses				\$0.00	
18. SUBTOTAL (add lines 11-17)				\$84,524.99	
19. Field Overhead	0.0% of line 18		0.0%	\$0.00	
20. SUBTOTAL (Add Lines 18 & 19)				\$84,524.99	
21. Home Office Overhead/Profit	15.0% of line 20	Included		\$12,678.75	
22. MFDB Design Fees	_____ of total change				
23. SUBTOTAL (Add Lines 20 - 22)				\$97,203.74	

Sub's Remarks:

SUMMARY				Revisions/comments	
24. Prime Contractor's work (from line 10)				\$16,575.00	97,203.74 4,260.19 102,003.93 1020.64 103,084.57
25. Sub-contractor's work (from line 23)				\$97,203.74	
26. SUBTOTAL (add lines 24 & 25)				\$113,778.74	
27. Prime Overhead on sub-contractor	0.0% of line 25		0.0%	\$0.00	
28. Prime's Home Office Overhead	10.0% of line 24		10.0%	\$1,657.50	
29. Prime's Profit	5.0% of line 26-28		5.0%	\$5,771.81	
30. SUBTOTAL (add lines 26-29)				\$121,208.05	
31. Prime Contractor's Bond Premium	1.000% of line 30		1.0%	\$1,212.08	
32. TOTAL COST (add lines 30 & 31)				\$122,420	

This change adds 21 calendar days to the project contract time.

Prime Contractor name: Stronghold Engineering, Inc.  
Sub-contractor name: J's Pipeline

Signature and title of Preparer:  SR. P.M. Date: 30-Apr-12

S/N 0105-LF-005-6900

INSTRUCTIONS FOR PREPARING PROPOSAL/ESTIMATE FOR CONTRACT MODIFICATION

The conditions and scope of the modification and shall be accompanied by a breakdown of cost, as indicated. Lump sum costs will not be accepted in either the prime or sub-contractor's breakdown of direct cost. The total cost for labor, material, and equipment rental (or ownership) for each item shall be transferred to the corresponding item on the front of this form. At the contractor's option, the overhead rates printed on the front of this form may be used for proposals under \$500,000 in lieu of detailed itemized estimates of overhead costs. The proposal should also include a request for an extension of time, in calendar days, only if overall completion of contract is impacted by the proposed modification.

BREAKDOWN OF DIRECT COSTS

Contract No.: 75 10621-00 Date: 30-Apr-12

DESCRIPTION: PCO#04R2- Revised Wet Utilities per EMWD Requirements

ITEMS OF WORK FOR Prime Contractor	QTY	UNIT	MATERIAL		LABOR		Rent/ Own	EQUIPMENT		
			Unit cost	Total Cost	Unit Cost	Total Cost		Days	Rate	Total
1 General Conditions-		15 Days	\$1,105.00	\$16,575.00	\$0.00	\$0.00				
2a		0 wks	\$0.00	\$0.00	\$0.00	\$0.00				
2b		0 ls	\$0.00	\$0.00	\$0.00	\$0.00	O	0	\$0.00	\$0.00
3a		0 hrs	\$0.00	\$0.00	\$0.00	\$0.00	O	0	\$0.00	\$0.00
3b		0 ls	\$0.00	\$0.00	\$0.00	\$0.00	O	0	\$0.00	\$0.00
4a		0 hrs	\$0.00	\$0.00	\$0.00	\$0.00	O	0	\$0.00	\$0.00
4b										
5a										
5b										
6a										
6b										
<b>DIRECT Prime Contractor's TOTALS</b>				<b>\$16,575.00</b>		<b>\$0.00</b>	R	<b>Total Rental</b>		<b>\$0.00</b>
							O	<b>Total Owned</b>		<b>\$0.00</b>

ITEMS OF WORK FOR Sub-contractor	QTY	UNIT	MATERIAL		LABOR		Rent/ Own	EQUIPMENT		
			Unit Cost	Total Cost	Unit Cost	Total Cost		Days	Rate	Total
1 Deduct orig water- J's Pipeline		1 ls	\$0.00	\$0.00	(\$19,942.81)	(\$19,942.81)		0	\$0.00	\$0.00
2 Add new water- J's Pipeline		1 ls		\$0.00	#####	\$104,467.80		0	\$0.00	\$0.00
3 Breakdown Attached		ls		\$0.00	\$0.00	\$0.00		0	\$0.00	\$0.00
4		ls		\$0.00	\$0.00	\$0.00		0	\$0.00	\$0.00
5		ls		\$0.00	\$0.00	\$0.00		0	\$0.00	\$0.00
6		ls		\$0.00	\$0.00	\$0.00		0	\$0.00	\$0.00
7		ls		\$0.00	\$0.00	\$0.00		0	\$0.00	\$0.00
8		ls		\$0.00	\$0.00	\$0.00		0	\$0.00	\$0.00
9		ls		\$0.00	\$0.00	\$0.00		0	\$0.00	\$0.00
10		ls		\$0.00	\$0.00	\$0.00		0	\$0.00	\$0.00
<b>DIRECT Sub-Contractor's TOTALS</b>				<b>\$0.00</b>		<b>\$84,524.99</b>	R	<b>Total Rental</b>		<b>\$0.00</b>
							O	<b>Total Owned</b>		<b>\$0.00</b>

# EXHIBIT "A"

**DLR Group**  
**WVICOT**  
 4201 Lakes Drive, Suite 117  
 Riverside, California 92507  
 1 800 833-2677  
 951 506-1167  
 www.dlr.com

## SEWER AND WATER PLAN

IN THE COUNTY OF RIVERSIDE, CALIFORNIA  
 MEAD VALLEY LIBRARY

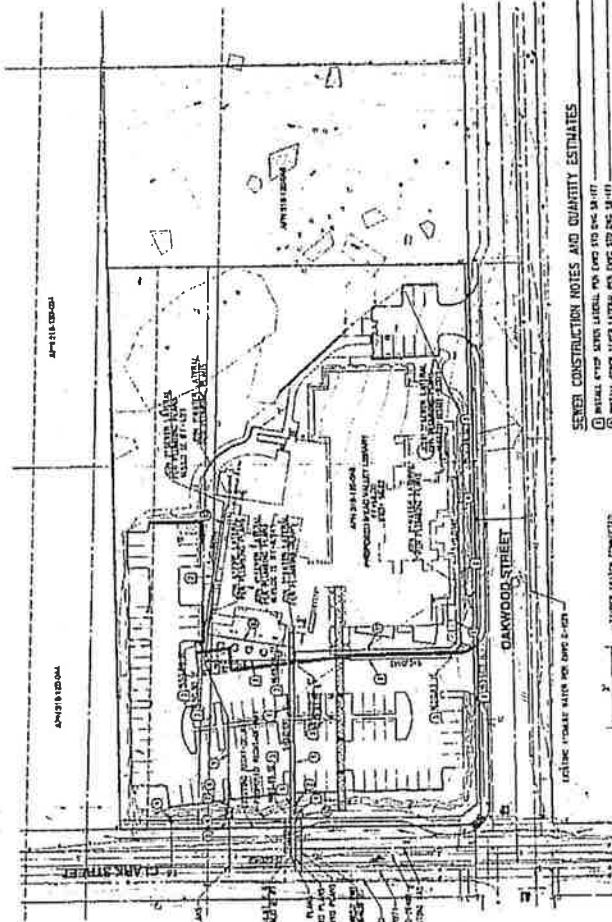

**WORK TO BE DONE**  
 THE CONTRACTOR SHALL BE RESPONSIBLE FOR OBTAINING ALL NECESSARY PERMITS FROM THE CITY OF RIVERSIDE AND THE CALIFORNIA DEPARTMENT OF WATER RESOURCES. THE CONTRACTOR SHALL BE RESPONSIBLE FOR OBTAINING ALL NECESSARY PERMITS FROM THE CALIFORNIA DEPARTMENT OF WATER RESOURCES. THE CONTRACTOR SHALL BE RESPONSIBLE FOR OBTAINING ALL NECESSARY PERMITS FROM THE CALIFORNIA DEPARTMENT OF WATER RESOURCES.

**PRIVATE ENGINEER'S NOTE TO CONTRACTOR**  
 THE CONTRACTOR SHALL BE RESPONSIBLE FOR OBTAINING ALL NECESSARY PERMITS FROM THE CITY OF RIVERSIDE AND THE CALIFORNIA DEPARTMENT OF WATER RESOURCES. THE CONTRACTOR SHALL BE RESPONSIBLE FOR OBTAINING ALL NECESSARY PERMITS FROM THE CALIFORNIA DEPARTMENT OF WATER RESOURCES. THE CONTRACTOR SHALL BE RESPONSIBLE FOR OBTAINING ALL NECESSARY PERMITS FROM THE CALIFORNIA DEPARTMENT OF WATER RESOURCES.

**OWNER/DEVELOPER**  
 MEAD VALLEY LIBRARY  
 1501 15th Street  
 Riverside, CA 92507

**CIVIL ENGINEER**  
 RICK ENGINEERING COMPANY  
 1501 15th Street, Suite 310  
 Riverside, CA 92507

**GEOTECHNICAL ENGINEER**  
 1501 15th Street, Suite 310  
 Riverside, CA 92507

### SEWER CONSTRUCTION NOTES AND QUANTITY ESTIMATES

- 1. INSTALL 12" DIA. 15' LONG 20' DIA. 2-1/2"
- 2. INSTALL 12" DIA. 15' LONG 20' DIA. 2-1/2"
- 3. INSTALL 12" DIA. 15' LONG 20' DIA. 2-1/2"

### WATER CONSTRUCTION NOTES AND QUANTITY ESTIMATES

- 1. INSTALL 12" DIA. 15' LONG 20' DIA. 2-1/2"
- 2. INSTALL 12" DIA. 15' LONG 20' DIA. 2-1/2"
- 3. INSTALL 12" DIA. 15' LONG 20' DIA. 2-1/2"

**DIG ALERT**  
 CALL BEFORE YOU DIG  
 1-800-485-5800  
 UNDERGROUND UTILITY ALERT  
 (UNCOMMON) CHIEF

**CAUTION:**  
 EXISTING LOCATION OF EXISTING  
 UNDERGROUND FACILITIES IS  
 UNKNOWN. CHECK

DATE	BY	REVISIONS	COUNTY



**PRELIMINARY**  
 NOT FOR CONSTRUCTION

MEAD  
 VALLEY  
 LIBRARY

SEWER AND  
 WATER PLAN

C2.1  
 Sheet 15





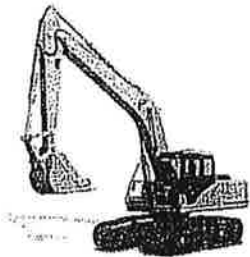

**J's Pipeline Inc.**

Sewers • Storm Drain • Water • Gas

December 8, 2011 (Revised March 20, 2012)

To: Stronghold Engineering; Attn Denny McGahey  
200 Market Street  
Riverside, California

Re: Mead Valley Library  
QU11.180R2; Credit Off Site Work Per Mead Valley Water Improvement Plans

<u>QNTY</u>	<u>MATERIAL</u>	<u>UNIT COST</u>	<u>EXTENDED</u>
(155) LF	6" DIP	\$ 30.00	(\$4,650.00)
(1) EA	6" Hot Tap	\$ 2,500.00	(\$2,500.00)
(1) EA	3" Hot Tap	\$ 2,000.00	(\$2,000.00)
(1) EA	1.5" Hot Tap	\$ 1,000.00	(\$1,000.00)
(1) EA	6" DCDA	\$ 2,410.00	(\$2,410.00)
(1) EA	1.5" Water Service	\$ 1,702.00	(\$1,702.00)
(1) EA	1.5" RP Backflow Device	\$ 830.25	(\$830.25)
(16) HR	Backhoe	\$ 65.00	(\$1,040.00)
(2) DY	Service Truck w/ Small Tools	\$ 150.00	(\$300.00)
(16) HR	Operator	\$ 72.70	(\$1,163.20)
(16) HR	Foreman	\$ 59.11	(\$945.76)
(16) HR	Pipelayer	\$ 52.60	(\$841.60)
(16) HR	Apprentice	\$ 35.00	(\$560.00)

**TOTAL THIS CHANGE ORDER REQUEST** (\$19,942.81)

EXCLUDE: PERMANENT ASPHALT, PERMITS, PERMIT FEES, ENGINEERING LAYOUT, SAWCUT, PERMANENT PATCH, GROUND WATER, BOND, REMOVAL OR DEMOLITION, HAUL OFF EXCESS SPOILS, REPLACE CONCRETE OR LANDSCAPE, HANDLING OF ANY HAZARDOUS MATERIALS, GUARD POSTS, ROCK BOULDER BLASTING, REMOVAL OF ROCK BOULDERS, ELECTRICAL WORK OF ANY KIND, OFF SITE WORK, REROUTE EXISTING UTILITY LINES, EROSION CONTROL, ALL INSPECTION FEES, OTHER FEES (IF ANY).

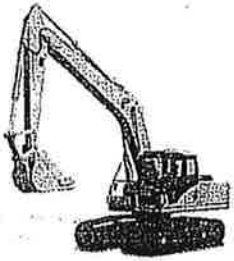

# EXHIBIT "D"

Contractor Lic A&C 34 # 727755

## J's Pipeline Inc.

Sewers • Storm Drain • Water • Gas

March 22, 2012

To: Denny McGahey  
Stronghold Engineering  
Market Street  
Riverside, California

Re: Mead Valley Library  
QU11.178R2; Additional Off Site Work Per Mead Valley Water Improvement Plans

<u>QNTY</u>	<u>MATERIAL</u>	<u>UNIT COST</u>	<u>EXTENDED</u>
540 LF	12" PVC C900	\$ 90.00	\$48,600.00
100 LF	6" PVC C900	\$ 40.00	\$4,000.00
60 LF	4" PVC C900	\$ 35.00	\$2,100.00
1 EA	8" x 12" C153 Inceaser	\$ 234.78	\$234.78
4 EA	12" PO 45Deg El C153	\$ 343.20	\$1,372.80
1 EA	12" x 4" PO x FL Tee C153	\$ 395.20	\$395.20
1 EA	4" PO x FL Gate Valve	\$ 622.63	\$622.63
2 EA	12" FL x FL Gate Valve	\$ 2,509.49	\$5,018.98
2 EA	6" PO x FL Gate Valve	\$ 821.00	\$1,642.00
2 EA	12" x 6" PO x FL Tee C153	\$ 602.16	\$1,204.32
1 EA	Fire Hydrant	\$ 2,202.50	\$2,202.50
1 EA	12" x 4" PO Eccentric Reducer	\$ 252.70	\$252.70
1 EA	3" Water Meter	\$ 3,518.00	\$3,518.00
1 EA	3" Backflow Preventor Device	\$ 2,410.00	\$2,410.00
2 EA	1" Water Service	\$ 820.00	\$1,640.00
1 EA	1.5" Water Service	\$ 1,702.00	\$1,702.00
30 EA	12" C900 Joint Restraint	\$ 136.25	\$4,087.50
1 EA	1.5" RP Backflow Device	\$ 830.26	\$830.26
1 EA	3" Meter Box	\$ 5,687.00	\$5,687.00
1 LS	Materials (Sales Tax 8.75%)	\$ 2,871.81	\$2,871.81
1 LS	Sawcut / Remove	\$ 1,200.00	\$1,200.00
1 LS	Temporary Asphalt Patch	\$ 1,000.00	\$1,000.00
8 HR	Welder	\$ 125.00	\$1,000.00
2 EA	Engineered Traffic Control Plan	\$ 1,035.00	\$2,070.00
6 DY	Eng Traffic Control Signage / Flagging	\$ 1,124.47	\$6,746.82
2 EA	Eng Traffic Control Signage Set Up	\$ 569.25	\$1,138.50
2 EA	Eng Traffic Control Signage Removal	\$ 460.00	\$920.00

**TOTAL THIS CHANGE ORDER REQUEST** \$104,467.80

EXCLUDE: PERMANENT ASPHALT, PERMITS, PERMIT FEES, ENGINEERING LAYOUT, SAWCUT, PERMANENT PATCH, GROUND WATER, BOND, REMOVAL OR DEMOLITION, HAUL OFF EXCESS SPOILS, REPLACE CONCRETE OR LANDSCAPE, HANDLING OF ANY HAZARDOUS MATERIALS, GUARD POSTS, ROCK BOULDER BLASTING, REMOVAL OF ROCK BOULDERS, ELECTRICAL WORK OF ANY KIND, OFF SITE WORK, REROUTE EXISTING UTILITY LINES, EROSION CONTROL, ALL INSPECTION FEES, OTHER FEES (IF ANY).

**SUCCESSOR AGENCY TO THE  
REDEVELOPMENT AGENCY (RDA)**

**CONSTRUCTION CHANGE DIRECTIVE**

**Project: Mead Valley Library**

**Project No.: ED1504001012**

**Distribution:**  
Project Manager

Inspector  
Contractor  
Architect

**To: Stronghold Engineering, Inc.**

**CCD No.: 1**

**Owner: County of Riverside**

**Date: March 27, 2012**

**You are hereby directed to proceed with the work below without delay:**

**Description: Additional Offsite work per Mead Valley Water Improvement Plans under PCO #4R**

**Attachments:**

Stronghold Engineering PCO#04R dated 12-Mar-12

**PROPOSED ADJUSTMENTS**

1. The proposed basis of adjustment to the Contract Sum or Guaranteed Maximum Price is:
  - Lump Sum Price -
  - Unit Price of \$ \_\_\_\_\_ per \_\_\_\_\_ .
  - As follows: Change Order Value to be approved as soon as contractor submits pricing supported by substantive backup that allows County to evaluate reasonableness of submitted pricing. Backup should include materials cost, equipment rates and hours and crewing.
  
2. The Contract Time is proposed to (be adjusted) (remain unchanged). The proposed adjustment, if any, is (an increase of \_\_\_\_\_ days) (a decrease of \_\_\_\_\_ days).

When signed by the Owner and Architectural Representative and received by the Contractor, this document becomes effective IMMEDIATELY as a Construction Change Directive (CCD), and the Contractor shall proceed with the change(s) described above.

Signature by the Contractor indicates the Contractor's agreement with the proposed adjustments in Contract Sum and Contract Time set forth in this Construction Changed Directive.

**Architect: DLR WWCOT**

**Owner: Gloria Perez**

**By:**  
**Date:**

**By:**  
**Date:**

*Gloria Perez*  
3/27/12

**Contractor: Stronghold Engineering Inc.  
Denny McGahey, Project Manager**

**By:**  
**Date:**