

**SUBMITTAL TO THE BOARD OF SUPERVISORS
COUNTY OF RIVERSIDE, STATE OF CALIFORNIA**



FROM: TLMA - Transportation Department

SUBMITTAL DATE:

SUBJECT: Notice of Completion – Skyview Road Reconstruction Project in the City of Jurupa Valley

RECOMMENDED MOTION: That the Board of Supervisors execute and file the attached "Notice of Completion"

BACKGROUND: By Minute Order 3.61 of June 5, 2012, the Board of Supervisors entered into a contract with Hardy & Harper of Santa Ana, CA for the construction of the Skyview Road Reconstruction Project in the City of Jurupa Valley.

Departmental Concurrence

Juan C. Perez
Director of Transportation and Land Management

dj
(Continued On Attached Page)

FINANCIAL DATA	Current F.Y. Total Cost:	\$250,000	In Current Year Budget:	Yes
	Current F.Y. Net County Cost:	\$ 0	Budget Adjustment:	No
	Annual Net County Cost:	\$ 0	For Fiscal Year:	2012/2013

SOURCE OF FUNDS: Proposition 1B (State Bond Funds-Local Roads) (100%) There were no General Funds used in this project	Positions To Be Deleted Per A-30	<input type="checkbox"/>
	Requires 4/5 Vote	<input type="checkbox"/>

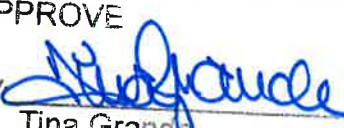
C.E.O. RECOMMENDATION: APPROVE
BY 
Tina Grande

County Executive Office Signature

Policy
 Policy
 Consent
 Consent
 Dep't Recomm.:
 Per Exec. Ofc.:

Prev. Agn. Ref. 6/5/12, Item 3.61 | **District:** 2/2 | **Agenda Number:**

3-47

The originally authorized amount of the contract was \$234,000. The total amended contract is \$250,000, which is 6.8% more than the originally authorized amount. The amended contract amount was 6.8% higher than the bid amount due to:

1. Quantity increases in Aggregate Base and Roadway Excavation to address subgrade deficiencies encountered during construction;
2. A request from the City of Jurupa to extend the limits of paving slightly at either end and at intersecting roads to address deficient pavement conditions;
3. Adjust asphalt dike and concrete driveway tie-ins and limits at various locations to better match the new construction and ensure proper drainage.

This work was completed at the direction of the Department on October 5, 2012, and was inspected by the Construction Engineering Section of the Transportation Department. Work Order C1-0534.

Budget

Original Contract Amount		\$234,000.00
Tot. Chg Orders Authorized -	0.0%	\$0.00
Est. Pending Change Orders	0.0%	\$0.00
Amended Contract Amount		\$234,000.00
* Quantity Adjustments	6.8%	\$15,999.73
+ CCO FA Adjustments	0.0%	\$0.00
Total Amended Contract Amount	106.8%	\$249,999.73

Expenditures

Total Progress Payments -		\$249,999.73
Estimated Pending Payments		
Total Expenditures		\$249,999.73

(Over)\Under Contract Amount \$0.00

+ Change Orders using the Force Account method of payment issued prior to the work being completed generally do not use the total authorized amount.

* CAL-Trans Standard Specifications 4-1.03B. Increases or decreases in the quantity of a contract item of work will be determined by comparing the total pay quantity of such item of work with the Engineer's Estimate. If the total pay quantity of any item of work required under the contract varies from the Engineer's Estimate by 25 percent or less, payment will be made for the quantity of work of said item performed at contract unit price, unless eligible for adjustment pursuant to Section 4-1.03C, "Changes in Character of Work."

PLEASE COMPLETE THIS INFORMATION
RECORDING REQUESTED BY:

**KECIA HARPER-IHEM, CLERK OF THE BOARD
RIVERSIDE CO. CLERK OF THE BOARD
4080 LEMON STREET, 1ST FLOOR CAC
P O BOX 1147 – RIVERSIDE, CA 92502**

MAIL STOP # 1010

AND WHEN RECORDED MAIL TO:

RETURN TO: STOP #1010
RIVERSIDE COUNTY CLERK OF THE BOARD
P. O. BOX 1147 – RIVERSIDE, CA 92502

THIS SPACE FOR RECORDERS USE ONLY

NOTICE OF COMPLETION

To be recorded with County Recorder
within 10 days after completion.
No recording fee.

Notice is hereby given by the undersigned owner, a public entity of the State of California, that a public work of improvement has been completed, as follows:

Project title or description of work: Skyview Road Resurfacing Project

Date of Completion: Date of this notice

Nature of owner: County of Riverside, public entity

Interest or estate of owner: Public Roadway

Address of owner: 4080 Lemon Street, 8th Floor, Riverside, CA 92501

Name of contractor: Hardy & Harper, Inc.

Street or legal description of site: Skyview Road

Dated: _____

Owner: County of Riverside
(Name of Public Entity)

By: _____
Chairman, Board of Supervisors

STATE OF CALIFORNIA)

ss

COUNTY OF RIVERSIDE)

I am the Chairman of the governing board of the County of Riverside, the public entity which executed the foregoing notice and on whose behalf I make this verification; I have read this notice, know its contents, and the same is true. I certify under penalty of perjury that the foregoing is true and correct.

Executed at Riverside, California on _____ (Date)

_____, Chairman of the Board of Supervisors

COUNTY OF RIVERSIDE
DEPARTMENT OF TRANSPORTATION

SKYVIEW RD RESURFACING PROJECT

FROM PERALTA PL TO SHARON WAY

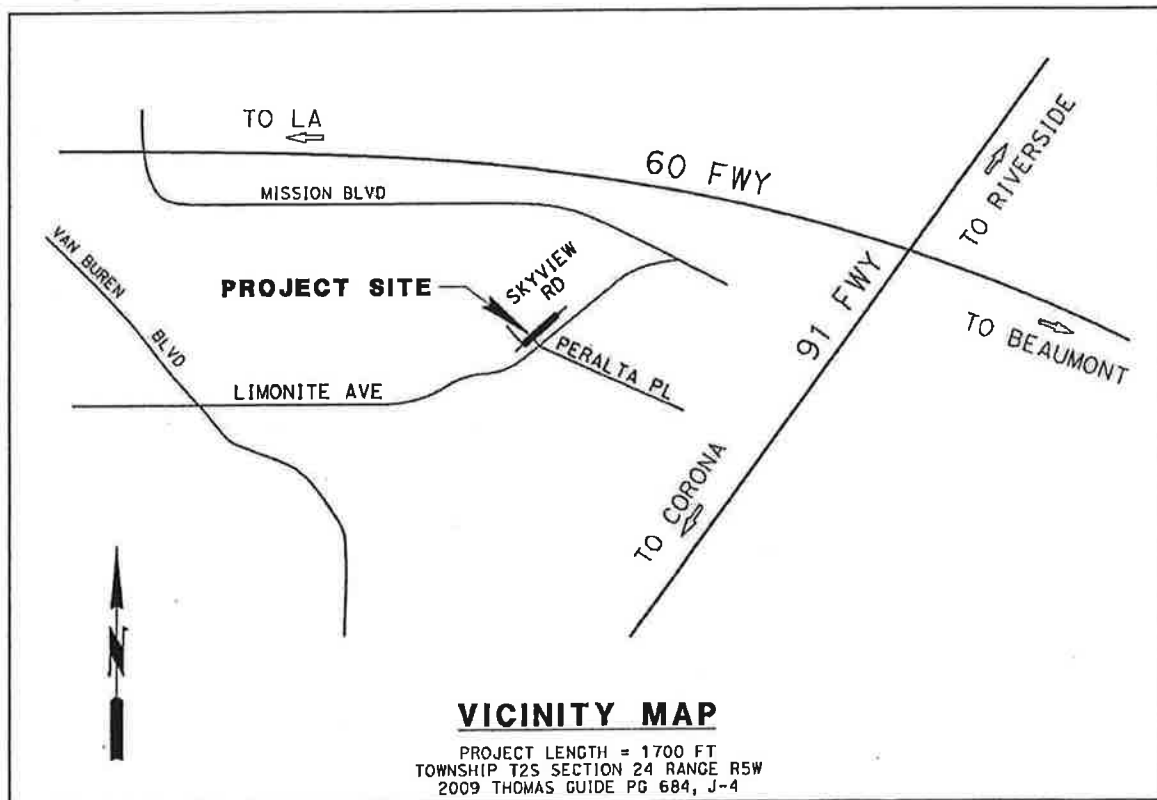
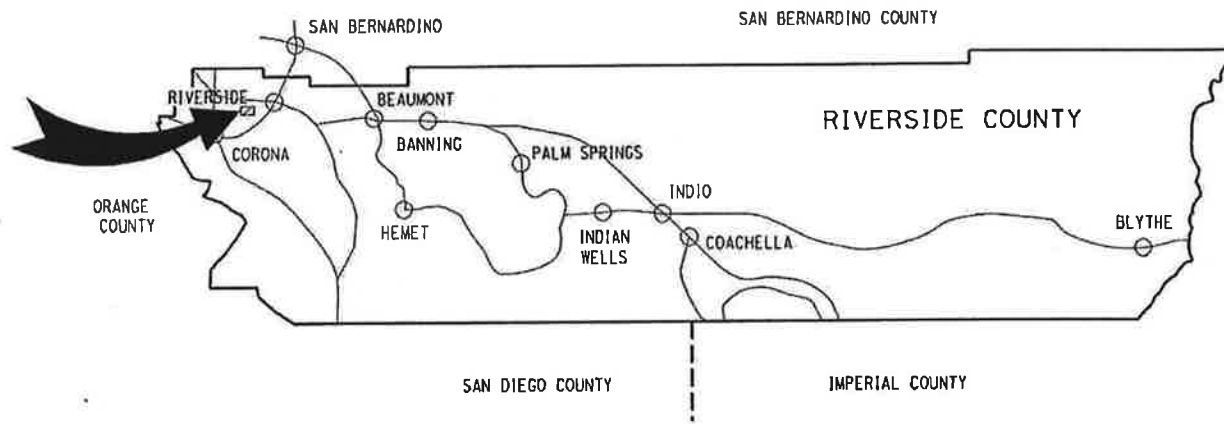

PROJECT: Skyview Road Reconstruction Project, in the city of Jurupa Valley
 County Project No.: C1-0534
 Contract No. 12-05-001

Item No.	Item Description	Units	Quantity	Unit Price	Original Contract		Change Authorized		Total Authorized		This Estimate		Previous		Total Estimate To Date		% Auth.	
					Amount	Quantity	Amount	Quantity	Amount	Quantity	Amount	Quantity	Amount	Quantity	Amount	Quantity		Amount
23	REPAIR SHALLOW WATER LATERAL	EA	8	500.00	4,000.00		8.00	4,000.00									0%	
24	ADJUST SEWER CLEANOUT TO GRADE	EA	1	300.00	300.00		1.00	300.00									0%	
25	ADJUST WATER METER BOX TO GRADE	EA	6	300.00	1,800.00		6.00	1,800.00									0%	
26	ADJUST FIRE HYDRANT	EA	1	500.00	500.00		1.00	500.00									0%	
27	ADJUST MANHOLE TO GRADE	EA	1	500.00	500.00		1.00	500.00									0%	
PROJECT TOTAL					234,000.00	0.00		234,000.00									249,999.73	



Contractor: Hardy & Harper, Inc.
 Address: 1312 E. Warner Ave.
 City, State, Zip: Santa Ana, CA 92705

Estimate No. 1 Final
 From: September 7, 2012
 To: October 25, 2012

Made by: Jessie Mendoza
 Checked by: MS 10-31
 OK Const. Supv. _____

Working Days: 20
 Days Added: 0
 Subtotal: 20
 Days Used: 14
 % Time Elapsed: 70%

Start Date: 9-7-12
 End Date: 10-5-12
 % Complete: 107%

Original Contract: \$234,000.00
 Amended Contract: \$234,000.00

TOTAL VALUE OF WORK TO DATE: \$249,999.73
 LESS RETENTION: 5% 12,499.99
 TOTAL DUE TO DATE: \$237,499.74
 LESS PREVIOUSLY INVOICED: 0.00
 LESS LABOR NON COMPLIANCE: 0.00
 TOTAL DUE THIS PAYMENT: \$237,499.74

This Estimate Approved _____ Date: _____ for: _____
 Juan C. Perez, Director of Transportation

Quantities on This Estimate Approved _____ Date: 11/7/12
 Hardy & Harper, Inc.

Received by Accounts Payable: _____ By: _____
 Account 527980
 Project ZU-0534E
 Activity ID Z3500
 Resource Type CNT
 Signature _____
 Date 11/9/12

Contractor: Hardy & Harper, Inc.
 Address: 1312 E. Warner Ave.
 City, State, Zip: Santa Ana, CA 92705

Estimate No. 1 Final
 From: September 7, 2012
 To: October 25, 2012



Item No.	Item Description	Units	Quantity	Unit Price	Original Contract Amount	Change Authorized		Total Authorized		This Estimate		Previous		Total Estimate To Date		% Auth.
						Quantity	Amount	Quantity	Amount	Quantity	Amount	Quantity	Amount	Quantity	Amount	
1	DUST ABATEMENT	LS	1	1,000.00	1,000.00			1.00	1,000.00	1.00	1,000.00			1.00	1,000.00	100%
2	WATER POLLUTION CONTROL	LS	1	2,000.00	2,000.00			1.00	2,000.00	1.00	2,000.00			1.00	2,000.00	100%
3	DEVELOP WATER SUPPLY	LS	1	1,000.00	1,000.00			1.00	1,000.00	1.00	1,000.00			1.00	1,000.00	100%
4	TRAFFIC CONTROL SYSTEM	LS	1	30,000.00	30,000.00			1.00	30,000.00	1.00	30,000.00			1.00	30,000.00	100%
5	CLEARING AND GRUBBING	LS	1	22,000.00	22,000.00			1.00	22,000.00	1.00	22,000.00			1.00	22,000.00	100%
6	FINISHING ROADWAY	LS	1	2,260.50	2,260.50			1.00	2,260.50	1.00	2,260.50			1.00	2,260.50	100%
7	RELOCATE MAILBOX COLD PLANE ASPALT CONCRETE PAVEMENT & BASE	EA	6	200.00	1,200.00			6.00	1,200.00	7.00	1,400.00			7.00	1,400.00	117%
8	ROADWAY EXCAVATION	SQYD	4,000	1.41	5,640.00			4,000.00	5,640.00	3,995.00	5,632.95			3,995.00	5,632.95	100%
9	ROADWAY EXCAVATION	CY	800	16.00	12,800.00			800.00	12,800.00	925.00	14,800.00			925.00	14,800.00	116%
10	CLASS 2 AGGREGATE BASE	CY	380	35.35	13,433.00			380.00	13,433.00	450.00	15,907.50			450.00	15,907.50	118%
11	HOT MIX ASPHALT PLACE ASPHALT CONCRETE (MISCELLANEOUS AREA)	TON	1,170	69.25	81,022.50			1,170.00	81,022.50	1,427.72	98,869.61			1,427.72	98,869.61	122%
12	PLACE ASPHALT CONCRETE DIKE (TYPE E)	SQYD	250	30.00	7,500.00			250.00	7,500.00	288.00	8,640.00			288.00	8,640.00	115%
13	ASPHALT CONCRETE OVERSIDE DRAIN (CRS 306)	LF	1,220	4.25	5,185.00			1,220.00	5,185.00	1,357.00	5,767.25			1,357.00	5,767.25	111%
14	MINOR CONCRETE (CURB AND GUTTER) (CRS 201)	EA	1	750.00	750.00			1.00	750.00	1.00	750.00			1.00	750.00	100%
15	MINOR CONCRETE (TYPE C CURB) (CRS 201)	LF	550	28.00	15,400.00			550.00	15,400.00	570.00	15,960.00			570.00	15,960.00	104%
16	MINOR CONCRETE (DRIVEWAY)	LF	550	26.00	14,300.00			550.00	14,300.00	572.00	14,872.00			572.00	14,872.00	104%
17	OBJECT MARKER (TYPE L-1)	SQYD	60	63.00	3,780.00			60.00	3,780.00	70.00	4,410.00			70.00	4,410.00	117%
18	THERMOPLASTIC PAVEMENT MARKING	EA	3	130.00	390.00			3.00	390.00	3.00	390.00			3.00	390.00	100%
19	PAINT TRAFFIC STRIPE	SQFT	350	9.00	3,150.00			350.00	3,150.00	364.00	3,276.00			364.00	3,276.00	104%
20	PAVEMENT MARKER (REFLECTIVE)	LF	3,000	0.33	990.00			3,000.00	990.00	2,924.00	964.92			2,924.00	964.92	97%
21	REPAIR SHALLOW SEWER LATERAL	EA	9	11.00	99.00			9.00	99.00	9.00	99.00			9.00	99.00	100%
22		EA	6	500.00	3,000.00			6.00	3,000.00							0%