

**SUBMITTAL TO THE BOARD OF SUPERVISORS
COUNTY OF RIVERSIDE, STATE OF CALIFORNIA**

905 A



FROM: TLMA - Transportation Department

SUBMITTAL DATE:
February 28, 2013

SUBJECT: Resolution 2013-047 Authorizing the Submittal of Functional Classification Change for Local Streets and Roads within its Jurisdiction

RECOMMENDED MOTION: That the Board of Supervisors adopt Resolution 2013-047, authorizing the submittal of functional classification changes for local streets and roads within its jurisdiction as shown on the California Road System (CRS) maps.

BACKGROUND: The Federal Highway Administration (FHWA) identifies functional classifications as key items in determining federal funding to build and maintain roads. Functional classifications are grouped according to the character of the service they provide in the highway network. All functionally classified roads in California appear on the CRS maps published by Caltrans. It is the responsibility of each local jurisdiction to update the maps as

Juan C. Perez
Director of Transportation and Land Management

SV

FORM APPROVED COUNTY COUNSEL
BY: Synthia M. Gunzel DATE: 3-13-13
SYNTHIA M. GUNZEL DEPARTMENTAL CONCURRENCE

FINANCIAL DATA	Current F.Y. Total Cost:	\$ 0	In Current Year Budget:	Yes
	Current F.Y. Net County Cost:	\$ 0	Budget Adjustment:	No
	Annual Net County Cost:	\$ 0	For Fiscal Year:	2012/2013

SOURCE OF FUNDS:	Positions To Be Deleted Per A-30	<input type="checkbox"/>
There are no General Funds used in this project.	Requires 4/5 Vote	<input type="checkbox"/>

C.E.O. RECOMMENDATION:

APPROVE

BY:
Tina Grande

County Executive Office Signature

Consent
 Policy

 Consent
 Policy

Prev. Agn. Ref. | **District:** 5/5 | **Agenda Number:**

3-11

The Honorable Board of Supervisors

RE: Resolution 2013-047 Authorizing the Submittal of Functional Classification Change for Local Streets and Roads within its Jurisdiction

February 13, 2013

Page 2 of 2

development occurs, land use changes, and roads are built and widened. A resolution by the governing body authorizing the request for changes is required. Resolution No. 2013-047 will authorize this request for change for the streets and roads described in the attachments. Inclusion in the CRS allows the County to apply for future federal dollars for improvement or maintenance of the facilities.

This submittal was initiated to address the Interstate 10 (I-10) Bypass Project, which will add a new roadway link between the communities of Cabazon and Banning, parallel to the I-10. This critical link will be built utilizing, in part, federal funds. The roadway must be functionally classified in order to qualify for federal funding.

The Transportation Department has looked at other functional classification needs in the territory spanning from Calimesa to Cabazon, known as the Pass area, specifically related to the bigger I-10 Lifeline Emergency Access Plan. Additional roadways paralleling I-10 will be considered as part of that larger plan and are being added to the CRS maps with this action. Some portions of those connections already exist, but are either under-classified as local roads or are not yet classified. Segments outside the County's jurisdiction will require updates by the appropriate agencies. The County will continue to coordinate with other agencies to ensure the roadway network is represented appropriately.

In addition to the Board's approval, the County has asked the Southern California Association of Governments for concurrence as the County's metropolitan planning organization. The completed package will be submitted to Caltrans District 8 for their concurrence and submittal to Caltrans headquarters, which will submit the request to the FHWA for approval. Once approved, the CRS maps will be updated.

SOUTHERN CALIFORNIA



**ASSOCIATION of
GOVERNMENTS**

Main Office

818 West Seventh Street

12th Floor

Los Angeles, California

90017-3435

t (213) 236-1800

f (213) 236-1825

www.scag.ca.gov

Officers

President

Glen Becerra, Simi Valley

First Vice President

Greg Pettis, Cathedral City

Second Vice President

Carl Morehouse, San Buenaventura

Immediate Past President

Pam O'Connor, Santa Monica

**Executive/Administration
Committee Chair**

Glen Becerra, Simi Valley

Policy Committee Chairs

Community, Economic and
Human Development
Paula Lantz, Pomona

Energy & Environment
Cheryl Vlegas-Walker, El Centro

Transportation
Keith Millhouse, Ventura County
Transportation Commission

February 1, 2013

Maria Aranguiz
Division of Planning
Caltrans–District 8
464 West 4th Street
San Bernardino, CA 92401

**RE: FUNCTIONAL CLASSIFICATION CHANGE –
RIVERSIDE COUNTY TRANSPORTATION & LAND MANAGEMENT
AGENCY (TLMA)**

Ms. Aranguiz:

SCAG has received a request from the Riverside County Transportation & Land Management Agency (TLMA) regarding the Functional Classification Change Request Form to be submitted to Caltrans (attached). Caltrans' Functional Classification Guidelines require that local agencies submit a metropolitan planning organization/regional transportation planning agency (MPO/RTPA) concurrence letter along with the Functional Classification Change Form to the Caltrans District Coordinator.

This letter serves as the concurrence from SCAG on the changes requested by the Riverside County TLMA.

The SCAG regional travel demand model includes roadway facilities from interstates (1) down to the equivalent of major collectors (5) on the FHWA's revised functional classification codes. To the extent that these changes affect the SCAG regional highway network, SCAG will update the network to reflect the changes requested by the Riverside County TLMA upon the final approval by Caltrans and the Federal Highway Administration.

If you have any further questions, please contact Ryan Kuo of my staff at 213-236-1813 or kuo@scag.ca.gov.

Sincerely,

Naresh Amatya
Manager, Transportation Planning

NA:rk

Enclosure: Functional Classification Change Request

Cc (email): Susan Vombaur, Riverside County TLMA

2
3 RESOLUTION NO. 2013-047

4 AUTHORIZING THE SUBMITTAL OF A FUNCTIONAL CLASSIFICATION CHANGE
5 FOR LOCAL STREETS AND ROADS WITHIN ITS JURISDICTION
6 TO THE STATE OF CALIFORNIA, DEPARTMENT OF TRANSPORTATION
7

8 WHEREAS, local agencies are responsible for initiating requests for changes to the functional
9 classifications of streets and roads within their respective jurisdictions as they appear on the California
10 Road System maps; and

11 WHEREAS, the County of Riverside (County) receives State and Federal road improvement and
12 maintenance funding based on street and road functional classification; and

13 WHEREAS the County Transportation Department has identified the need to change certain
14 roadway classifications or add newly planned roadways as identified in Exhibit A; now, therefore,

15 BE IT RESOLVED, DETERMINED AND ORDERED by the Board of Supervisors of the County
16 of Riverside, in regular session assembled on _____, 2013 in the meeting room of the
17 Board of Supervisors (Board), located on the 1st floor of the County Administrative Center, 4080 Lemon
18 Street, Riverside, California, that the Board hereby approves the submittal of the Functional Classification
19 Change for local streets and roads within its jurisdiction to the State of California, Department of
20 Transportation as recommended by the County of Riverside Director of Transportation and Land
21 Management.

22 BE IT FURTHER RESOLVED THAT the forgoing resolution was properly adopted by the Board
23 on behalf of the County at a regular meeting of the Riverside County Board of Supervisors held on
24 _____, 2013.
25
26
27
28

FORM APPROVED COUNTY COUNSEL

BY: *Stephanie M. Gunzel* 3-13-13

DATE: _____
COUNTY COUNSEL

EXHIBIT A

Functional Classification Request Forms and Maps

(10 Pages)

Functional Classification Change Request Form

Functional Classification Codes	
	Interstate
	Other Freeways or Expressways
	Other Principal Arterial
	Minor Arterial
	Major Collector
	Minor Collector
	Local

Submitted by: John Marcinek
 Date: 1/28/13

Click on any column heading for instructions.

CRS Map Number	Coordinate	CT District	County	Jurisdiction	Change/New/Delete	Road	From	To	(From) Class	(To) New Class	Length (mi)	Number of Through Lanes	AAADT
16V32	C10	8	RIV	RIVERSIDE COUN	NEW	I-10 BYPASS	APACHE TRAIL	BANNING CITY LIMIT	-	4	2.100	2	5500
16V32	K10	8	RIV	RIVERSIDE COUN	CHANGE	APACHE TRAIL	BONITA AVE	UNION PACIFIC RR X-ING	7	5	0.400	2	3500
16V34	C9	8	RIV	RIVERSIDE COUN	NEW	TAMARACK EXTENSION	1500' E/O MESQUITE RD	WHITEWATER CUT-OFF	-	5	2.200	2	3000
16V33	J9	8	RIV	RIVERSIDE COUN	CHANGE	TAMARACK RD	RUSHMORE AVE	1500'E/O MESQUITE RD	7	5	2.300	2	3300
16V34/16V44	H10	8	RIV	RIVERSIDE COUN	NEW	GARNET AV EXTENSION	PALM SPRINGS CITY LIM	5400' EAST TO EX. GARNE	-	5	1.100	2	2500

Page 2, 3
 2, 3
 5
 4, 5
 5, 6



I-10 "Lifeline" EMERGENCY ACTION PLAN

Road Conditions
Emergency 9-1-1
Inland Empire Real Time Traffic Information 5-1-1
www.iestl.org

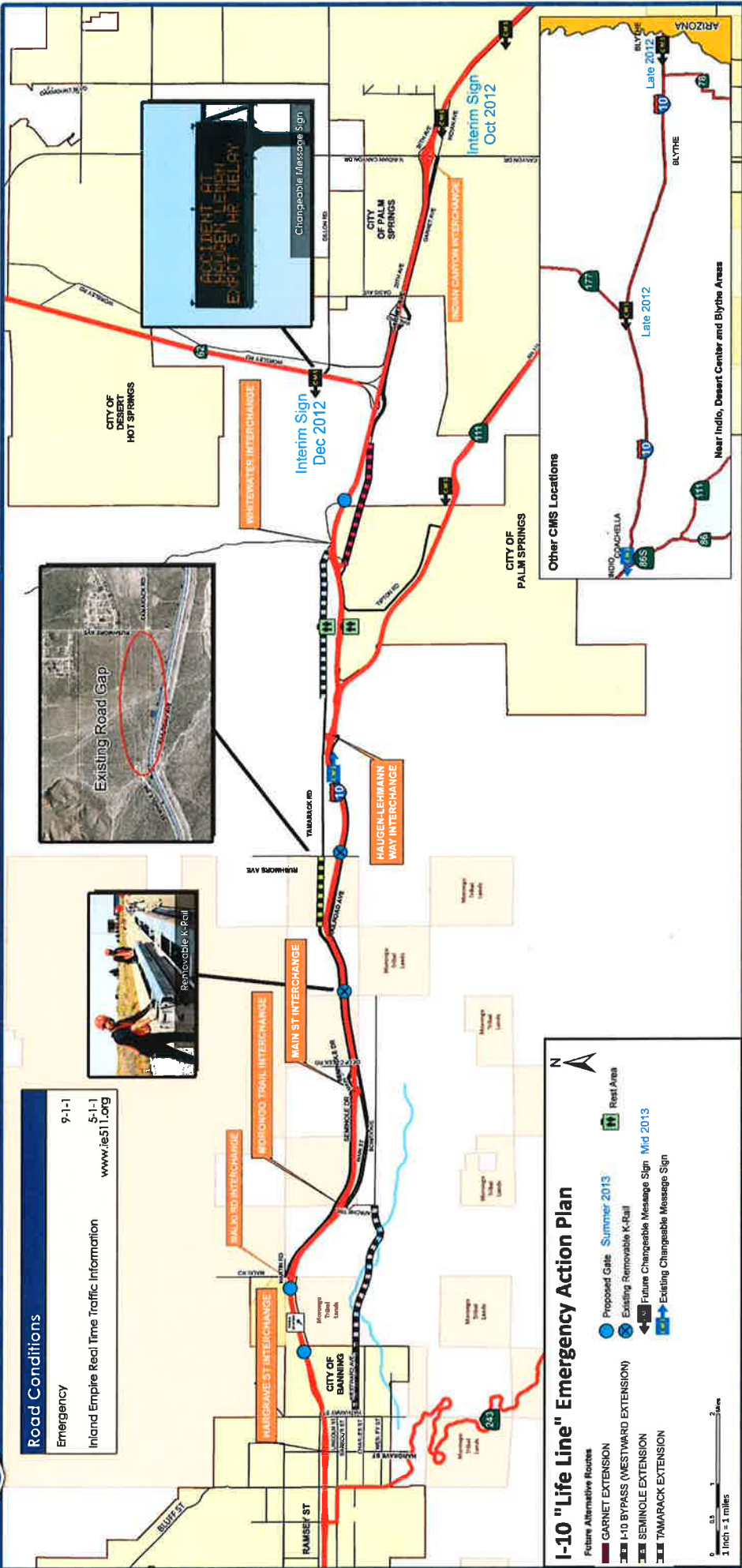

I-10 "Life Line" Emergency Action Plan

Future Alternative Routes

- GARNET EXTENSION
- I-10 BYPASS (WESTWARD EXTENSION)
- SEMINOLE EXTENSION
- TAMARACK EXTENSION

Emergency Action Plan Markers:

- Proposed Gate Summer 2013
- Rest Area
- Existing Removable K-Rail
- Future Changeable Message Sign Mid 2013
- Existing Changeable Message Sign

Scale: 1 inch = 1 miles



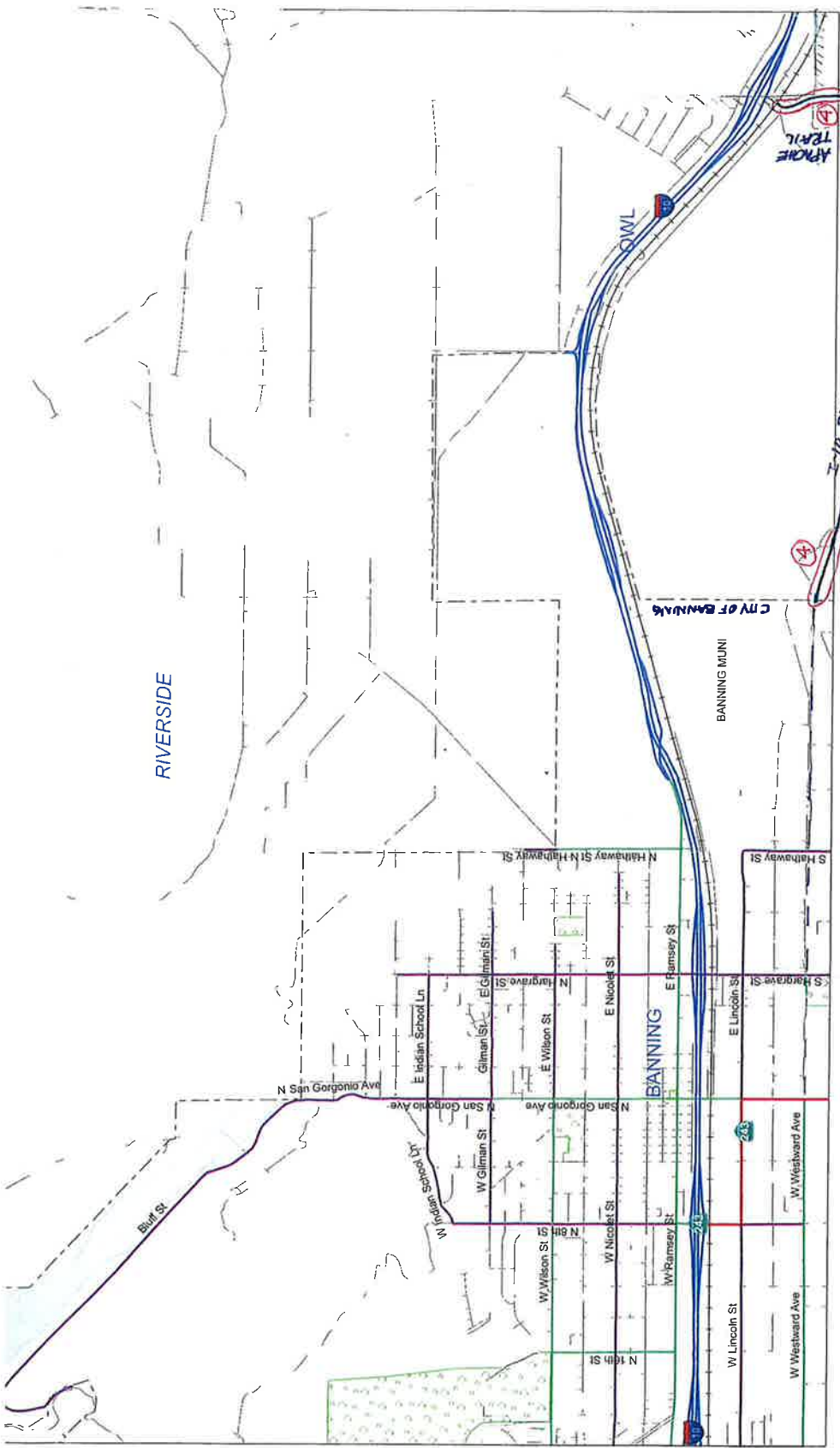

SEE MAP

San Bernardino
Riverside

MAP 16V32

FUNCTIONAL CLASSIFICATION SYSTEM

1	INTERSTATE
2	OTHER FWY OR EXPRWY
3	OTHER PRINCIPAL ARTERIAL
4	MINOR ARTERIAL
5	MAJOR COLLECTOR
6	MINOR COLLECTOR
7	LOCAL

SIGN ROUTES

6	INTERSTATE
3	U.S.
4	STATE
7	COUNTY

COUNTY BOUNDARY
CITY BOUNDARY
RAILROAD

SEE MAP 16V42

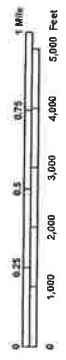

STATE OF CALIFORNIA
DEPARTMENT OF TRANSPORTATION
FEDERAL HIGHWAY ADMINISTRATION
AND LOCAL AGENCIES

APPROVED Date 8/5/11
FEDERAL HIGHWAY ADMINISTRATION
FOR: VINCENT P. MARRAMANO
DIVISION ADMINISTRATOR

Wesley Cortez-Perez



APACHE TRAIL

I-10 BYPASS
④

Wesley St

RIVERSIDE

SEE MAP 16V32

SEE MAP 16V41

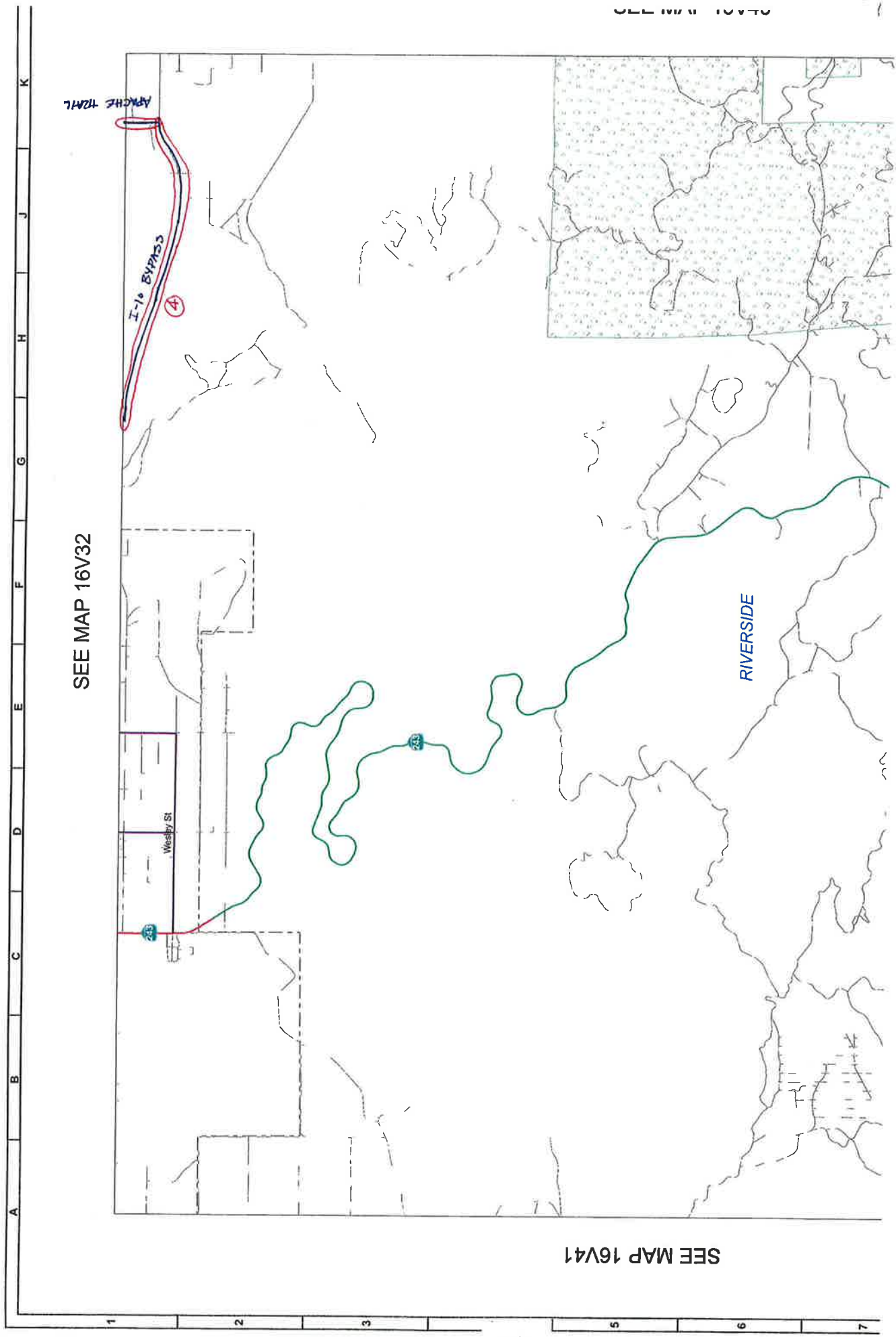

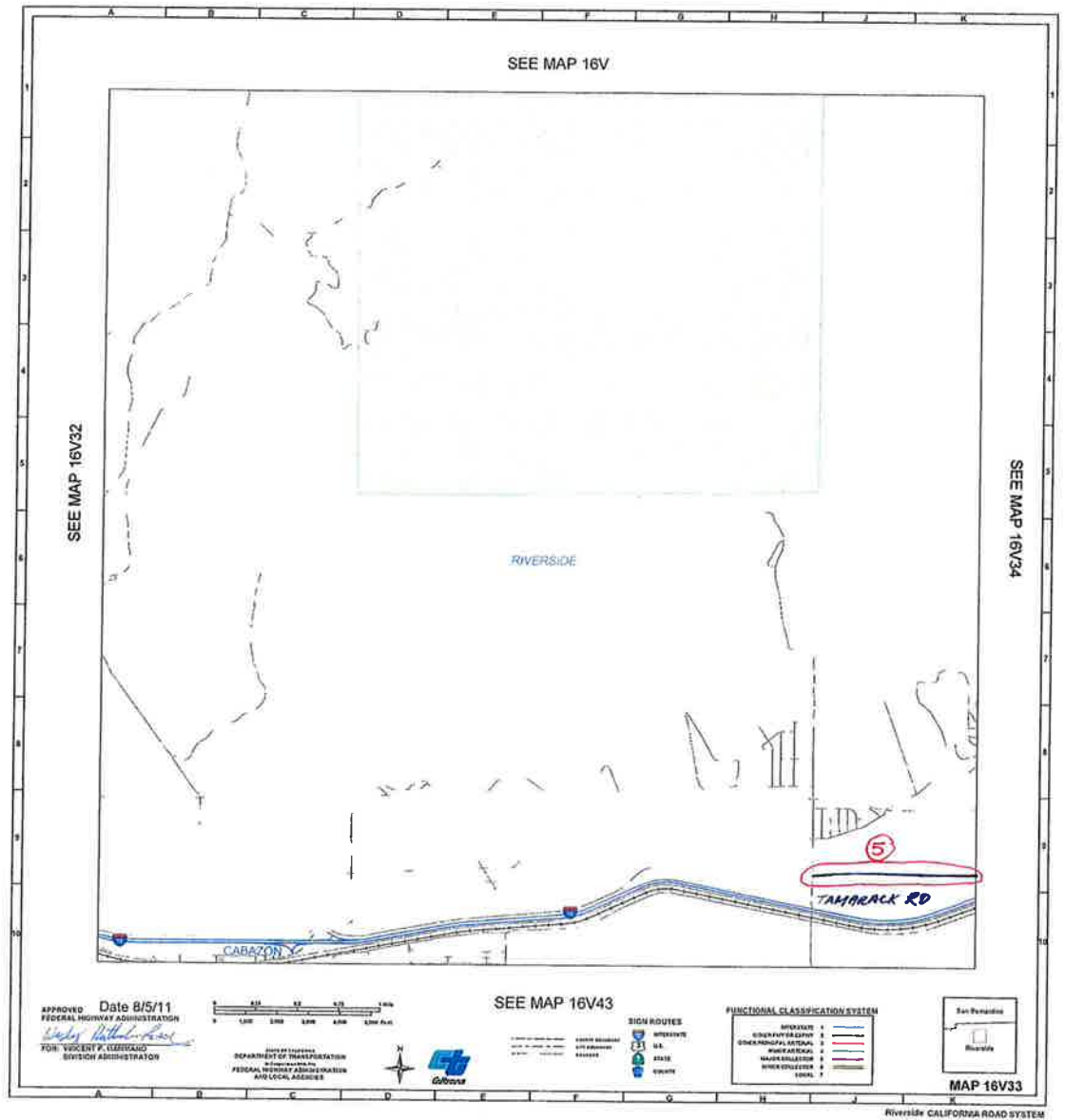

SEE MAP 16V35

SEE MAP 16V33

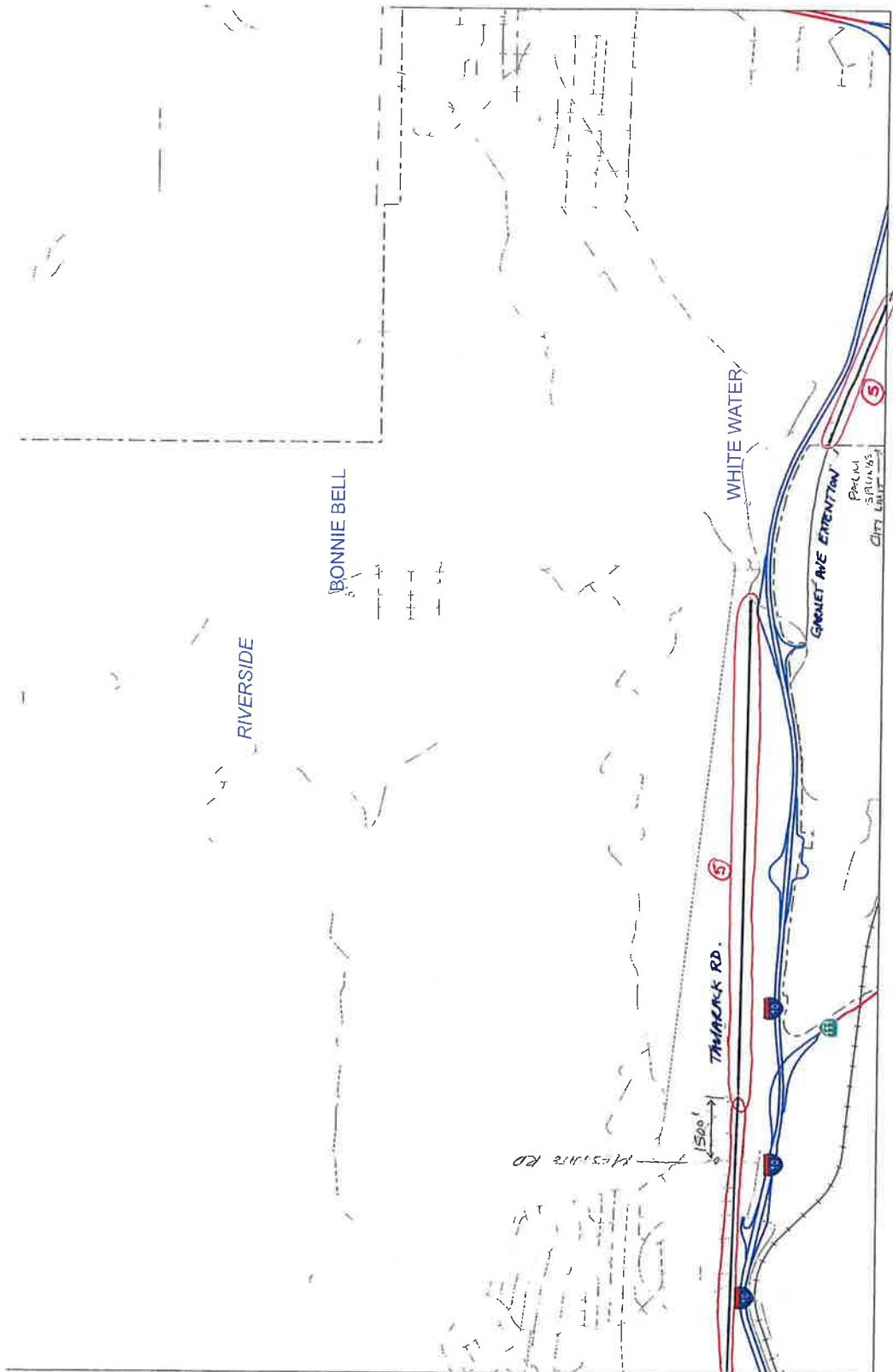

APPROVED
 FEDERAL HIGHWAY ADMINISTRATION
 Date 8/5/11
 FOR: VINCENT P. MARRAMANO
 DIVISION ADMINISTRATOR

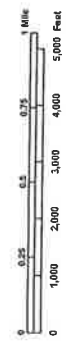

STATE OF CALIFORNIA
 DEPARTMENT OF TRANSPORTATION
 FEDERAL HIGHWAY ADMINISTRATION
 AND LOCAL AGENCIES



SEE MAP 16V44

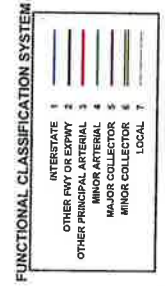

MAP 16V34

RIVERSIDE CALIFORNIA ROAD SYS

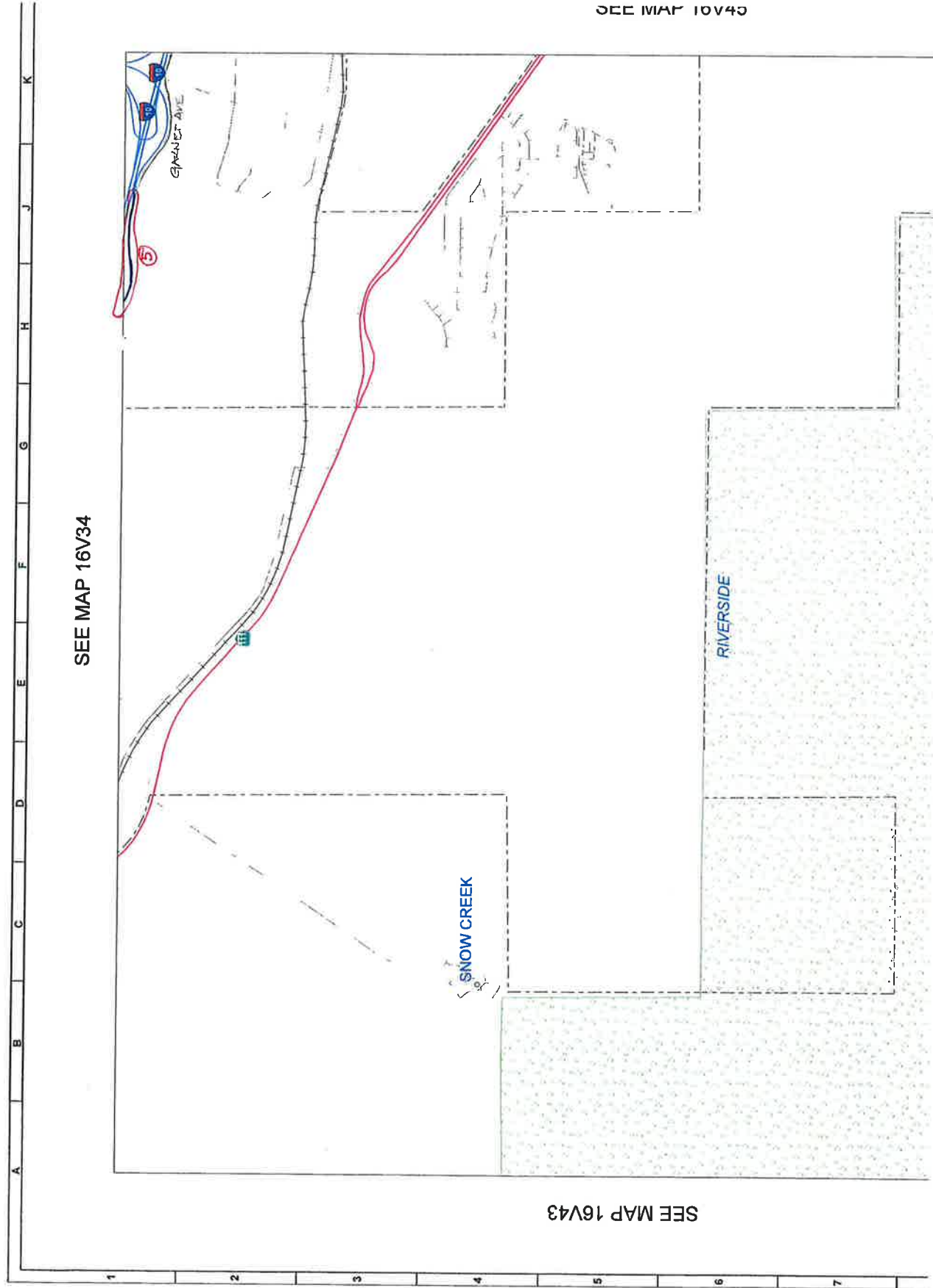

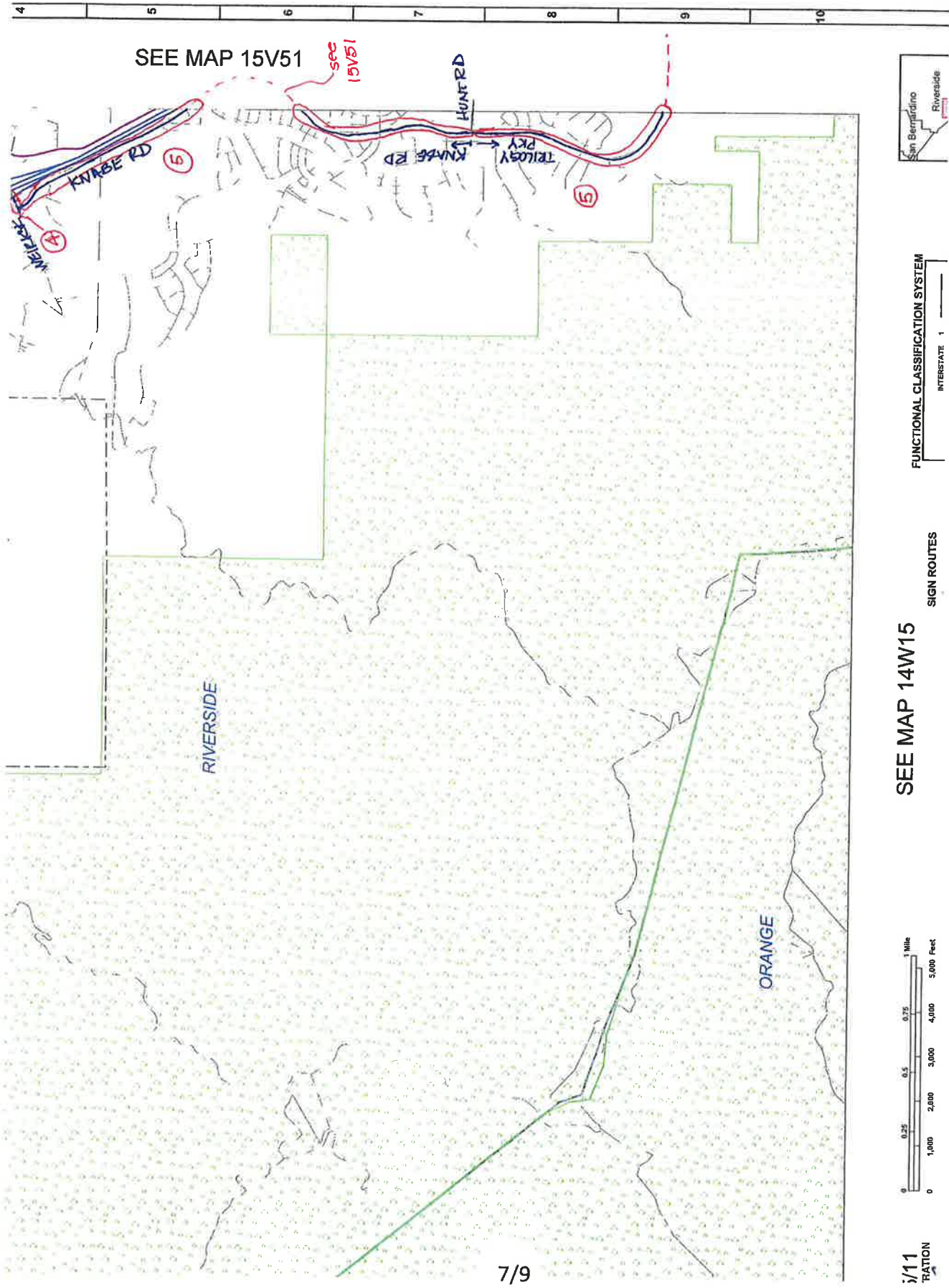

SIGN ROUTES

SEE MAP 14W15

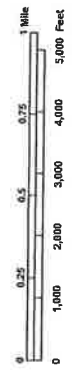

1/11
RATON

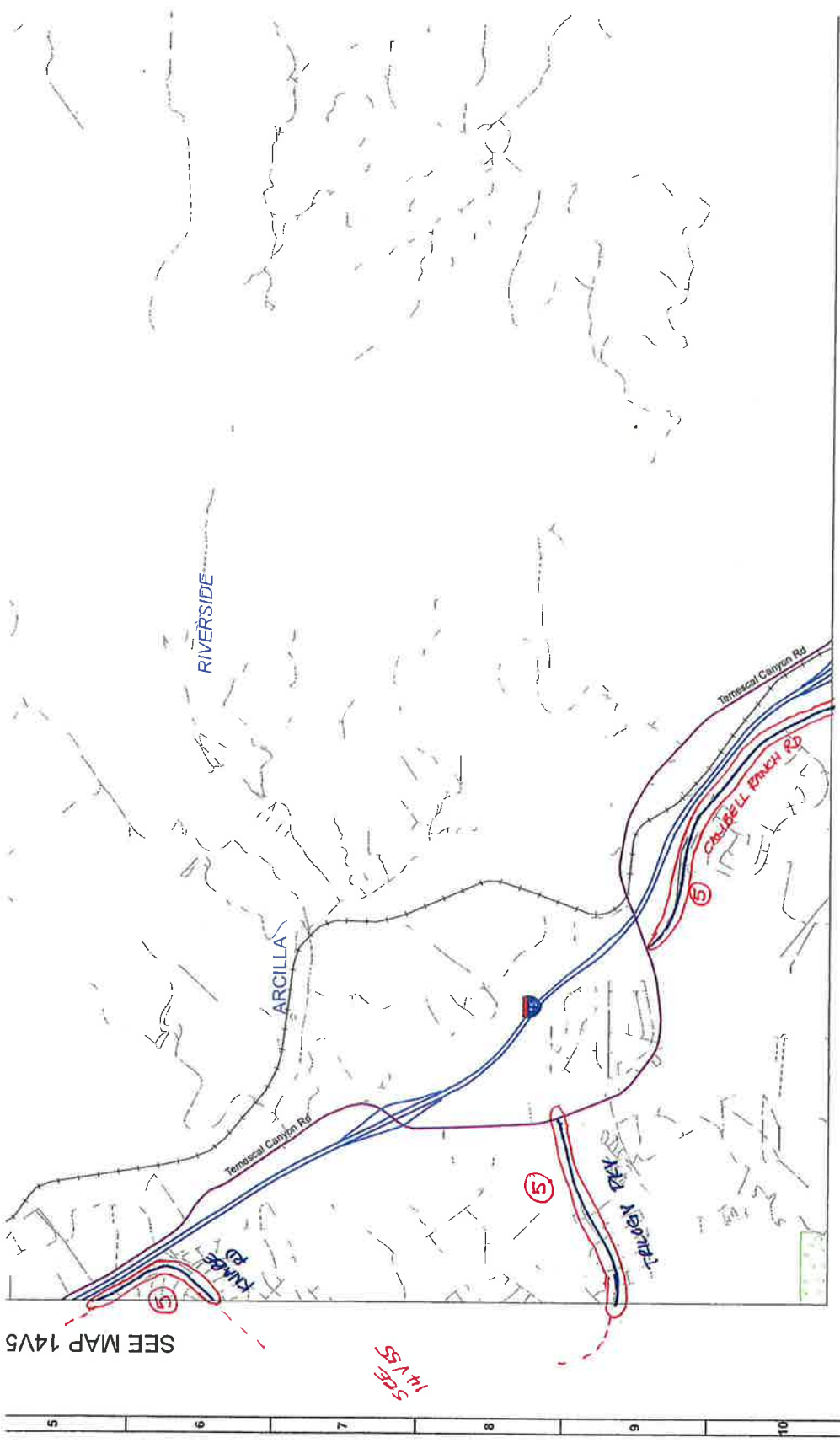

SEE MAP 14V5

SEE 14V5

APPROVED
 FEDERAL HIGHWAY ADMINISTRATION
 FOR: *Vincent P. Mammardo*
 DIVISION ADMINISTRATOR

DATE 8/5/11
 DEPARTMENT OF TRANSPORTATION
 In Cooperation With The
 FEDERAL HIGHWAY ADMINISTRATION
 AND LOCAL AGENCIES

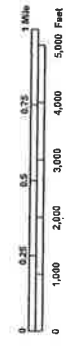

SEE MAP 15W11

- SIGN ROUTES**
- 5 INTERSTATE
 - 3 U.S.
 - 1 STATE
 - 177 COUNTY

- COUNTY BOUNDARY
- CITY BOUNDARY
- RAILROAD

FUNCTIONAL CLASSIFICATION SYSTEM

INTERSTATE	1
OTHER FWY OR EXPWY	2
OTHER PRINCIPAL ARTERIAL	3
MINOR ARTERIAL	4
MAJOR COLLECTOR	5
MINOR COLLECTOR	6
LOCAL	7

A B C D E F G H J
 Riverside C

