

Departmental Concurrence

**SUBMITTAL TO THE BOARD OF SUPERVISORS  
COUNTY OF RIVERSIDE, STATE OF CALIFORNIA**

151



**FROM:** TLMA - Transportation Department

**SUBMITTAL DATE:**

June 20, 2013

**SUBJECT:** Gilman Springs Road Pavement Rehabilitation, Soboba Road to East of State Route 79 (Sanderson Avenue/Lamb Canyon Road), San Jacinto area

**RECOMMENDED MOTION:** That the Board of Supervisors:

1. Approve one addendum to the specifications and plans issued prior to the June 12, 2013 bid opening; and,
2. Accept the low bid of All American Asphalt, of Corona, CA in the amount of \$1,695,108; and,
3. Award the contract to All American Asphalt and authorize the Chairman of the Board to execute the contract documents; and,
4. Approve the project's proposed budget as shown on Attachment "A".

  
Juan C. Perez  
Director of Transportation and Land Management

JCP:jrp:sb

(Continued On Attached Page)

<b>FINANCIAL DATA</b>	Current F.Y. Total Cost:	\$ 1,695,108	In Current Year Budget:	Yes
	Current F.Y. Net County Cost:	\$ 0	Budget Adjustment:	No
	Annual Net County Cost:	\$ 0	For Fiscal Year:	2013/2014
<b>SOURCE OF FUNDS:</b> Proposition 1B (State bond funds-Local Roads) (44.95%), Gas Tax (ABX8-9 Mar 2010 New HUTA) (51.45%), Miscellaneous (Golden Era) (3.60%)				<b>Positions To Be Deleted Per A-30</b> <input type="checkbox"/>
There are no General Funds used in this project.				<b>Requires 4/5 Vote</b> <input type="checkbox"/>

**C.E.O. RECOMMENDATION:**

APPROVE

BY:

  
Tina Grande

**County Executive Office Signature**

Dep't Recomm.: ☐ Policy ☒ Policy  
Per Exec. Ofc.: ☐ Consent ☒ Consent

Prev. Agn. Ref. 5/21/13, Item 3-26 | District: 3<sup>rd</sup> / 3<sup>rd</sup> | Agenda Number:

3-45

The Honorable Board of Supervisors

RE: Gilman Springs Road Pavement Rehabilitation, Soboba Road to East of State Route 79  
(Sanderson Avenue/Lamb Canyon Road), San Jacinto Area

June 20, 2013

Page 2 of 2

**BACKGROUND:**

The County Transportation Improvement Program (TIP) provides for safety improvements and pavement rehabilitation to Gilman Springs Road from Soboba Road to east of State Route 79 (Sanderson Avenue/Lamb Canyon Road) in the San Jacinto area of Riverside County.

By Minute Order dated May 21, 2013 (Agenda Item 3-26), the Board of Supervisors approved the plans and specifications and authorized the Clerk of the Board to advertise the Gilman Springs Road Rehabilitation Project.

During the advertisement period, one addendum was issued to all registered plan holders as a supplement to the plans, specifications, and special provisions. Bidders are required to acknowledge and take into account all issued addenda on their Contractor's Proposal in order to be considered for award. The addendum was issued to clarify and modify the approved contract documents. The addendum is attached as Addendum No. 1.

Bids for the project were opened in the office of the Director of Transportation and Land Management at 2:00 p.m., Wednesday, June 12, 2013. Two bids were received, ranging from \$1,695,108 to \$2,331,900. The basis for the selection of a contractor is the lowest responsive and responsible bid. The lowest responsible bid was submitted by All American Asphalt in the amount of \$1,695,108, which is \$171,322 (9%) below the Engineer's Estimate.

The existing pavement of Gilman Springs Road is in poor condition and requires rehabilitation. The project includes pavement grinding and overlay, median curb, safety enhancements, including centerline rumble strips between Soboba Road and State Route 79, and median delineators and rumble strips across the westbound lanes west of Soboba Road.

This project also includes the installation of rolled curb that has been requested by Golden Era Productions. These improvements will be funded by Golden Era Productions and a Reimbursement Agreement is being executed as a companion item to the award of this construction contract.

This project will require a full closure of Gilman Springs Road between Soboba Road and State Route 79. Construction will begin in July 2013 and will be completed prior to the beginning of fall semester at the San Jacinto Community College, on August 20, 2013.

There are many projects planned for Gilman Springs Road and an outreach campaign is being implemented. The Gilman Springs Road Safety Corridor Outreach Campaign will include a dedicated Web page that shows the proposed projects, time frames for planned projects and information on planned road closures.

The Contractor will execute the contract and provide bonds and insurance documents after Board approval. The Contractor is qualified.

County Project No. C1-0564

# Attachment "A"

Riverside County Transportation Department

Page 1

Project: **Gilman Spring Road - Soboba Road to State Route 79**

Project No.(s): **C1-0564**

Expenses as of: 6/1/13

## Project Costs and Budget

Activity	Incurred Costs	Projected Costs	Total Costs	Existing Budget	Proposed Budget
Preliminary Survey					
Environmental	1,200		1,200	1,000	1,000
Design	111,408	5,000	116,408	113,000	116,000
Right-of-way					
Utilities					
Construction		1,695,108	1,864,619	794,000	1,865,000
Construction Contingency 10.0%		169,511			
Construction Engineering & Inspection	1,023	300,000	301,023	122,000	301,000
Construction Survey	2,140	100,000	102,140	42,000	102,000
Totals:	115,771	2,269,619	2,385,390	1,072,000	2,385,000

## Project Funding

Code	Name	Existing Budget	Proposed Budget
215	Proposition 1B (State bond funds- Local Roads)	1,072,000	1,072,000
221	Gas Tax (ABX8-9 Mar 2010 New HUTA)		1,227,000
990	Miscellaneous (Golden Era)		86,000
Totals		1,072,000	2,385,000

## Comments

Printed: June 18,13 4:50 PM

## Form 11 Attachment

### Contract/Lease/Purchase Summary Data

☒ **Contract (for Services)**

- ☐ Approval/Renewal
- ☐ Sole Source
- ☐ Personal Services
- ☐ Independent Contractor
- ☐ Other than Low Bid
- ☐ Change Order
- ☒ Public Works

☐ **Lease**

- ☐ Approval/Renewal
- ☐ Multi-Year Lease
- ☐ Equipment
- ☐ Real Property
- ☐ Change Order

☐ **Purchase (for Materials)**

- ☐ Sole Source
- ☐ Other than Low Bid
- ☐ Change Order

**Selection Committee Member Names (RFP's Only)**

<b>User Department:</b>	<b>Transportation Department</b>
-------------------------	----------------------------------

N/A

<b>Vendor/Lessor Name:</b>	<b>All American Asphalt</b>
<b>Vendor/Lessor Location:</b>	<b>Corona, Ca.</b>

**Minority**

**Status:** ☐ M ☐ W ☐ DV ☒ None

**Local Preference Applied:** ☐ Yes ☐ No ☒ N/A

**Local Preference Award Cost \$**  
(5% maximum preference)

**Local Preference FYTD: Cost \$**

**# of Orders**

**Applicable Board Policy #**

**Comments:**

**RFQ/RFP Process:**

Date Mailed:  
Response Date:  
# of Responses:  
# of Qualified Responses:

**Bidding Process:**

Bid Range: \$ 1,695,108.00 to \$2,331,900.00  
Local Bid Range: N/A  
Responsive and Responsible Bid Range: \$ 1,695,108.00 to \$2,331,900.00

**Contract/Lease Renewals Only**

Existing Agreement Items

Proposed Agreement Items

1. Rates
2. Terms
3. Conditions
4. Legal Issues
5. Accountability
6. Utilities

(continue on blank sheet if necessary)

**NOTE: COMPETITIVELY BID PUBLIC WORKS CONTRACT**

COUNTY OF RIVERSIDE  
DEPARTMENT OF TRANSPORTATION

GILMAN SPRINGS ROAD

PAVEMENT REHABILITATION  
SOBOBA ROAD TO 0.3 MILES EAST OF (E/O) ROUTE 79  
SAN JACINTO AREA  
PROJECT NO. C1-0564

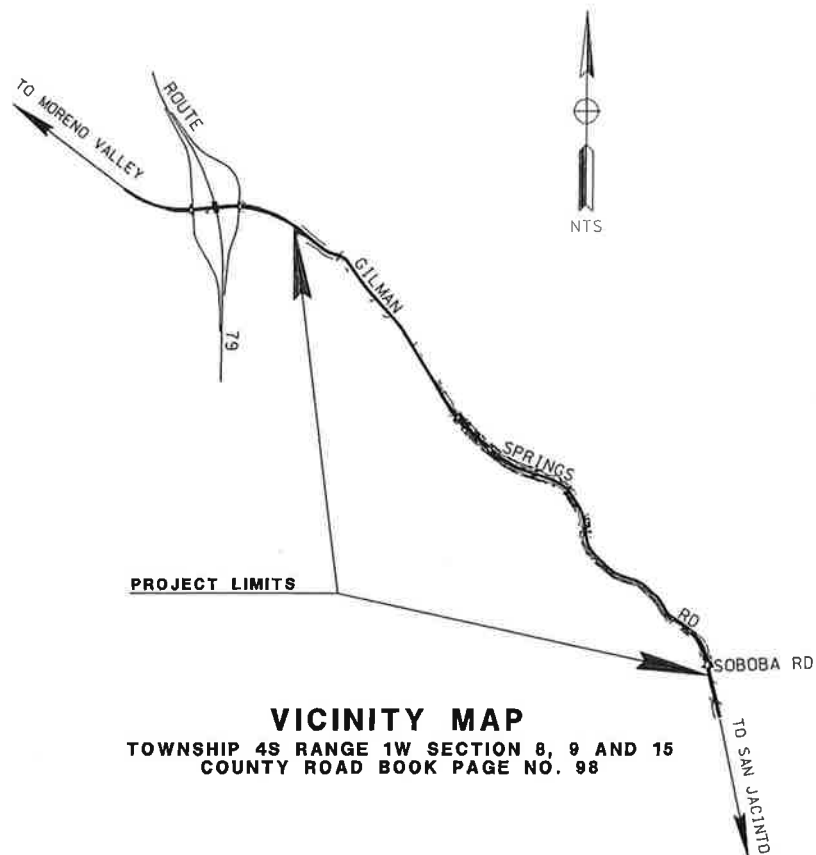
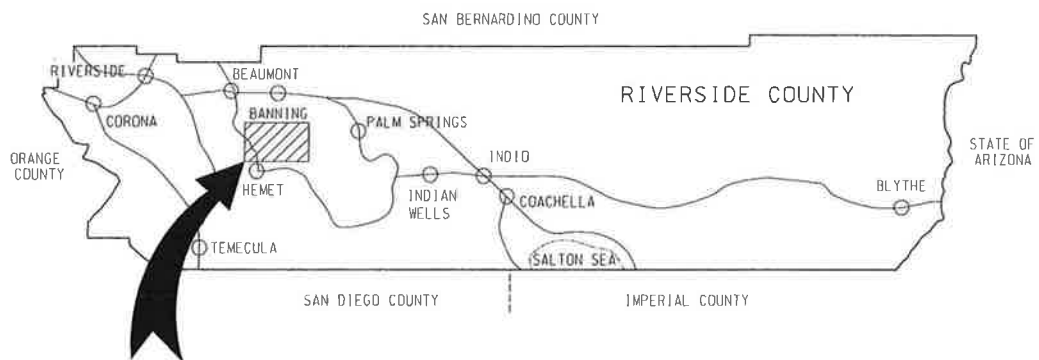

**VICINITY MAP**  
TOWNSHIP 4S RANGE 1W SECTION 8, 9 AND 15  
COUNTY ROAD BOOK PAGE NO. 98

# Riverside County Transportation Department Summary of Bids

Advertised: May 21, 2013 (Agenda Item: 3-26)

Addenda: 1 (06/05/13)

Bids Open: 2 pm Date: Wednesday, June 12, 2013

PROJECT: Gilman Springs Road, Pavement Rehabilitation Project  
Soboba Road to State Route 79 (Sanderson Ave/Lamb Canyon Road)

PROJECT NO. C1-0564

ITEM NO.	ITEM CODE	CONTRACT ITEM	UNITS	QUANTITY	COUNTY'S ESTIMATE			1	
					UNIT PRICE	ENG ESTIMATE	BID UNIT PRICE	All American Asphalt Corona, CA 92878	BID ESTIMATE
1	999990	MOBILIZATION	LS	1	50,000.00	50,000.00	27,000.00		27,000.00
2	120100	TRAFFIC CONTROL SYSTEM	LS	1	50,000.00	50,000.00	45,000.00		45,000.00
3	128650	PORTABLE CHANGEABLE MESSAGE SIGN	EA	6	5,000.00	30,000.00	263.00		1,578.00
4	170101	DEVELOP WATER SUPPLY	LS	1	2,000.00	2,000.00	2,000.00		2,000.00
5	066102	DUST ABATEMENT	LS	1	4,000.00	4,000.00	4,000.00		4,000.00
6	074020	WATER POLLUTION CONTROL	LS	1	10,000.00	10,000.00	5,500.00		5,500.00
7	010601	OBTAIN ENCROACHMENT PERMIT	FA	1	15,000.00	15,000.00	15,000.00		15,000.00
8	160101	CLEARING AND GRUBBING	LS	1	10,000.00	10,000.00	10,000.00		10,000.00
9	190101 (F)	ROADWAY EXCAVATION	CY	2,530	40.00	101,200.00	29.00		73,370.00
10	011505	GRINDING ASPHALT CONCRETE IN PLACE	SQYD	18,500	2.00	37,000.00	2.00		37,000.00
11	011506	WEDGE PLANE ASPHALT CONCRETE	LF	4,900	2.00	9,800.00	2.43		11,907.00
12	390132	HOT MIX ASPHALT (TYPE A)	TON	15	150.00	2,250.00	55.00		825.00
13	390129	HOT MIX ASPHALT (TYPE C)	TON	10,585	75.00	793,875.00	75.00		793,875.00
14	013901	ASPHALT RUBBER HOT MIX	TON	1,700	85.00	144,500.00	88.00		149,600.00
15	260201	CLASS 2 AGGREGATE BASE	CY	60	65.00	3,900.00	51.00		3,060.00
16	394074	PLACE HOT MIX ASPHALT DIKE (TYPE C)	LF	400	10.00	4,000.00	7.30		2,920.00
17	394002	PLACE ASPHALT CONCRETE (MISCELLANEOUS AREA)	SQYD	18	100.00	1,800.00	52.50		945.00
18	017304	MINOR CONCRETE (CURB AND GUTTER) (CRS 200)	LF	580	15.00	8,700.00	13.80		8,004.00
19	017307	MINOR CONCRETE (TYPE "C" CURB) (CRS 202)	LF	5,845	15.00	87,675.00	11.60		67,802.00
20	017309	MINOR CONCRETE (TYPE "D" CURB) (CRS 204)	LF	600	12.00	7,200.00	12.00		7,200.00
21	013902	ASPHALT CONCRETE OVERSIDE DRAIN (CRS 306)	CY	5	1,000.00	5,000.00	1,575.00		7,875.00
22	731502	SHOULDER BACKING	LF	4.2	450.00	1,890.00	900.00		3,780.00
23	190185	RUMBLE STRIP	LF	15,000	5.00	75,000.00	1.55		23,250.00
24	394050	TRANSVERSE RUMBLE STRIP	EA	10,000	1.00	10,000.00	0.79		7,900.00
25	000003	ROADSIDE SIGN - ONE POST	EA	3	100.00	300.00	174.00		522.00
26	566011	36" CORRUGATED STEEL PIPE INLET (108" THICK)	EA	6	250.00	1,500.00	336.00		2,016.00
27	700639	DELINEATOR (CLASS 1)	LF	4.5	600.00	2,700.00	1,580.00		7,110.00
28	820107	METAL BEAM GUARD RAILING	EA	32	100.00	3,200.00	49.00		1,568.00
29	832001	TERMINAL SYSTEM (TYPE SKT)	EA	25	40.00	1,000.00	28.00		700.00
30	839539	THERMOPLASTIC PAVEMENT MARKING	SQFT	2	3,000.00	6,000.00	3,300.00		6,600.00
31	840515	PAINT TRAFFIC STRIPE (2-COAT)	LF	540	5.00	2,700.00	4.20		2,268.00
32	840656	PAVEMENT MARKER (REFLECTIVE)	EA	42,400	0.50	21,200.00	0.27		11,448.00
33	850102	FINISHING ROADWAY	EA	460	4.00	1,840.00	4.20		1,932.00
34	220101	MISCELLANEOUS DIRECTED WORK	LS	1	10,000.00	10,000.00	525.00		525.00
35	000003	DEMOLITION	FA	1	200,000.00	200,000.00	200,000.00		200,000.00
36	019901	CONSTRUCTION ZONE ENHANCEMENT PROGRAM (COZEEP)	LS	1	100,000.00	100,000.00	100,000.00		100,000.00
37	066061	REMOVE ROADSIDE SIGN	FA	1	50,000.00	50,000.00	50,000.00		50,000.00
38	150742	RELOCATE ROADSIDE SIGN	EA	2	200.00	400.00	74.00		148.00
39	152390	PROJECT TOTAL	EA	4	200.00	800.00	220.00		880.00
		ITEMS 1 - 39				1,856,430.00			1,695,108.00

# Riverside County Transportation Department Summary of Bids

Advertised: May 21, 2013 (Agenda Item: 3-26)

Addenda: 1 (06/05/13)

Bids Open: 2 pm Date: Wednesday, June 12, 2013

PROJECT: Gilman Springs Road, Pavement Rehabilitation Project  
Soboba Road to State Route 79 (Sanderson Ave/Lamb Canyon Road)

PROJECT NO. C1-0564

2		Hardy & Harper, Inc. Santa Ana, CA 92705					
ITEM NO.	ITEM CODE	CONTRACT ITEM	UNITS	QUANTITY	BID UNIT PRICE	BID ESTIMATE	
1	999990	MOBILIZATION	LS	1	123,000.00	123,000.00	
2	120100	TRAFFIC CONTROL SYSTEM	LS	1	234,000.00	234,000.00	
3	128650	PORTABLE CHANGEABLE MESSAGE SIGN	EA	6	1,500.00	9,000.00	
4	170101	DEVELOP WATER SUPPLY	LS	1	5,000.00	5,000.00	
5	066102	DUST ABATEMENT	LS	1	7,000.00	7,000.00	
6	074020	WATER POLLUTION CONTROL	LS	1	7,000.00	7,000.00	
7	010601	OBTAIN ENCROACHMENT PERMIT	FA	1	15,000.00	15,000.00	
8	160101	CLEARING AND GRUBBING	LS	1	123,000.00	123,000.00	
9	190101 (F)	ROADWAY EXCAVATION	CY	2,530	35.00	88,550.00	
10	011505	GRINDING ASPHALT CONCRETE IN PLACE	SQYD	18,500	2.50	46,250.00	
11	011506	WEDGE PLANE ASPHALT CONCRETE	LF	4,900	2.50	12,250.00	
12	390132	HOT MIX ASPHALT (TYPE A)	TON	15	150.00	2,250.00	
13	390129	HOT MIX ASPHALT (TYPE C)	TON	10,585	77.00	815,045.00	
14	013901	ASPHALT RUBBER HOT MIX	TON	1,700	91.50	155,550.00	
15	260201	CLASS 2 AGGREGATE BASE	CY	60	150.00	9,000.00	
16	394074	PLACE HOT MIX ASPHALT DIKE (TYPE C)	LF	400	25.00	10,000.00	
17	394002	PLACE ASPHALT CONCRETE (MISCELLANEOUS AREA)	SQYD	18	100.00	1,800.00	
18	017304	MINOR CONCRETE (CURB AND GUTTER) (CRS 200)	LF	580	34.00	19,720.00	
19	017307	MINOR CONCRETE (TYPE "C" CURB) (CRS 202)	LF	5,845	30.00	175,350.00	
20	017309	MINOR CONCRETE (TYPE "D" CURB) (CRS 204)	LF	600	25.00	15,000.00	
21	013902	ASPHALT CONCRETE OVERSIDE DRAIN (CRS 306)	EA	5	1,500.00	7,500.00	
22	731502	MINOR CONCRETE (MISCELLANEOUS CONSTRUCTION)	CY	4.2	600.00	2,520.00	
23	190185	SHOULDER BACKING	LF	15,000	2.34	35,100.00	
24	394050	RUMBLE STRIP	LF	10,000	0.77	7,700.00	
25	000003	TRANSVERSE RUMBLE STRIP	EA	3	500.00	1,500.00	
26	566011	ROADSIDE SIGN - ONE POST	EA	6	350.00	2,100.00	
27	700639	36" CORRUGATED STEEL PIPE INLET (.109" THICK)	LF	4.5	3,000.00	13,500.00	
28	820107	DELINEATOR (CLASS 1)	EA	32	70.00	2,240.00	
29	832001	METAL BEAM GUARD RAILING	LF	25	40.00	1,000.00	
30	839539	TERMINAL SYSTEM (TYPE SKT)	EA	2	4,000.00	8,000.00	
31	840515	THERMOPLASTIC PAVEMENT MARKING	SQFT	540	4.25	2,295.00	
32	840656	PAINT TRAFFIC STRIPE (2-COAT)	LF	42,400	0.30	12,720.00	
33	850102	PAVEMENT MARKER (REFLECTIVE)	EA	460	5.00	2,300.00	
34	220101	FINISHING ROADWAY	LS	1	8,510.00	8,510.00	
35	000003	MISCELLANEOUS DIRECTED WORK	FA	1	200,000.00	200,000.00	
36	019901	DEMOLITION	LS	1	100,000.00	100,000.00	
37	066061	CONSTRUCTION ZONE ENHANCEMENT ENFORCEMENT PROGRAM (COZEPP)	FA	1	50,000.00	50,000.00	
38	150742	REMOVE ROADSIDE SIGN	EA	2	75.00	150.00	
39	152390	RELOCATE ROADSIDE SIGN	EA	4	250.00	1,000.00	
PROJECT TOTAL						2,331,900.00	
ITEMS 1 - 39							



# COUNTY OF RIVERSIDE TRANSPORTATION AND LAND MANAGEMENT AGENCY



Juan C. Perez, P.E., T.E.  
Director of Transportation

## Transportation Department

### **ADDENDUM NUMBER 1**

**Dated June 5, 2013**

**to the  
Specifications and Contract Documents  
for the construction of**

**Gilman Springs Road  
Pavement Rehabilitation Project  
Soboba Road to East of State Route 79 (Sanderson Avenue/Lamb Canyon Road)  
San Jacinto Area**

**Project No. C1-0564**

**Bids Due: Wednesday, June 12, 2013; 2:00 PM  
14<sup>th</sup> Street Transportation Annex  
3525 14<sup>th</sup> Street; Riverside, CA 92501  
(951) 955-6780**

This Addendum is issued pursuant to the Instructions to Bidders, Item No. 8, of the Contract Documents for the reference project. This Addendum is issued as a supplement to the specification and special provisions for the referenced project. The revisions to the specifications shall become a part of the Contract Documents, and each bidder shall acknowledge receipt thereof on the Contractor's Proposal. Bidders are directed to sign this addendum as acknowledged, and attach the signed addendum to the contractor's submitted proposal.

Note: During the advertisement period of this project, this document and attachments (if any) are available upon request at the office of the Transportation Department, and are available as a free download at the Transportation Department's website:

[http://www.rctlma.org/trans/con\\_bid\\_advertisements.html](http://www.rctlma.org/trans/con_bid_advertisements.html)

### **MODIFICATIONS / CLARIFICATIONS TO SPECIAL PROVISIONS:**

**Item 1: Revised Proposal**

Refer to "Proposal" pages B3 - B4. Proposal (page B3-B4) are deleted and replaced with revised "Proposal" attached herewith as **Attachment "A"**. The following revisions have been made to the bid Proposal:

a. The following new bid item has been added:

- Item 37, "Construction Zone Enhanced Enforcement Program (COZEEP)"
- Item 38, "Remove Roadside Sign"
- Item 39, "Relocate Roadside Sign"



**Item 2: Modified Hours of Work**

Refer to section "Modified Hours of Work" on page 49. Delete the last paragraph and replace with the following:

Contractor shall maintain access for local residents, businesses and their employees on Gilman Springs Road from State route 79 to Soboba road when construction is in progress and during road closure. Flagman will be required ~~at each end of the closure during the working hours~~ as needed, and as directed by Engineer.

**Item 3: Liquidated Damages**

Refer to section "Liquidated Damages" on page 50. Following paragraph is added to this section and made part thereof:

**Late Reopening of Closure:**

Refer to liquidated damages set forth in Section "Late Reopening of Closures" on page 65. These liquidated damages are in addition to the liquidated damages set forth in Section "Liquidated Damages" of Specification Book.

**Item 4: Roadway Excavation**

Refer to section "Roadway Excavation" on page 76. Delete the second paragraph and replace with the following:

At road connections and at limits of concrete paving, existing pavement shall be header cut, grind to a depth of 0.15', 20' to 30' length, full roadway width as directed by the Engineer. Full compensation for furnishing all labor, tools and doing all the work necessary including grinding, and sawcutting shall be considered as included in the contract price paid per cubic yard for Roadway Excavation and no additional compensation will be allowed therefor.

**Item 5: Minor Concrete**

Refer to section "Minor Concrete" on page 98 and delete the third paragraph; "The placement of aggregate... on the plans."

**Item 6: Construction Zone Enhancement Enforcement Program (COZEEP)**

The following special provision for "Construction Zone Enhanced Enforcement Program (COZEEP)" is added and made part here of:

**CONSTRUCTION ZONE ENHANCED ENFORCEMENT PROGRAM (COZEEP):**

COZEEP improves project safety through the use of supplemental California Highway Patrol Units to assist in the management of traffic passing through the construction zone. COZEEP involves the presence of the CHP in certain construction zones to serve as a reminder to the public to slow down, observe construction zone signs, and use care while driving through the work zone.

COZEEP shall be considered when above normal traffic problems are anticipated or unique conditions warrant additional public or worker protection.

The Contractor shall coordinate with the Resident Engineer when COZEEP services are needed from the California Highway Patrol.

***Method of Payment***

Contractor shall pay COZEEP service fee to California Highway Patrol (CHP) when service is rendered and County will reimburse this payment to Contractor.

Full compensation for the actual cost of COZEEP fees, as paid by the Contractor to California Highway Patrol, shall be reimbursed to the Contractor when invoiced in conformance to these Special Provisions. No markups will be allowed. All incidental costs incurred by the Contractor shall be included in the various items of work, and no additional compensation will be allowed therefor.

**Item 7: Roadside Sign (Remove/Relocate/Salvage)**

The following special provision for "Roadside Sign (Remove/Relocate/Salvage)" is added and made part here of:

**ROADSIDE SIGN (REMOVE/ RELOCATE/ SALVAGE)**

Existing roadside signs, shall be removed, relocated and/or salvaged as shown on the plans.

Existing roadside signs at locations shown on the plans to be removed shall not be removed until replacement signs have been installed or until the existing signs are no longer required for direction of public traffic, unless otherwise directed by the Engineer.

Relocation of roadside signs shall conform to the provisions in Section 56-2, "Roadside Signs" of the Standard Specifications and as directed by the Engineer.

Salvaged signs shall be delivered to the nearest County Maintenance Yard or as directed by the Engineer. The County Maintenance Yard is located at the following address:

595 N. Juanita Street  
Hemet, CA 92543  
(951) 658-5234

Full compensation for salvaging the 2 removed signs shall be considered as included in the bid item "Remove Roadside Sign" and no additional compensation will be allowed.

***Method of Payment***

The contract price paid per each for Remove Roadside Sign, and Relocate Roadside Sign shall include full compensation for furnishing all labor, materials, tools, equipment, incidentals and for doing all the work involved for sign removal and salvage, sign relocation including sign storage, sign protection, transporting and delivering Road Sign to nearest County maintenance yard, excavation and backfill, and sign installation as specified in the Standard Specification and these Special Provisions and no additional compensation will be allowed therefor.

**MODIFICATIONS / CLARIFICATIONS TO THE PLANS:**

**Item 8: Plan set Sheet 3 through 9 of 28 ("L" sheets 1-7)**

Refer to plan set sheets 3 through 9 of 28, the thickness of existing asphalt concrete (AC) and aggregate base (AB) varies. Refer to Material Report, dated October 5, 2012, for Gilman Springs Road Phase III from Highway 79 to Soboba Road.

**Note:** This Material Report supplemental information is posted on following website and available for download during the advertisement period.

[http://www.rctlma.org/trans/con\\_bid\\_advertisements.html](http://www.rctlma.org/trans/con_bid_advertisements.html)

**Item 9: Plan set Sheet 6 of 28**

Refer to plan sheet 6 of 28, and "CONCRETE APRON DETAIL-13". The design thickness of concrete apron is 0.50' (6 inches).

**Item 10: Plan set Sheet 9 of 28**

Refer to plan sheet 9 of 28. This sheet is deleted and replaced with revised sheet 9 of 28.

**Note:** This plan sheet is posted on following website and available for download during the advertisement period.

[http://www.rctlma.org/trans/con\\_bid\\_advertisements.html](http://www.rctlma.org/trans/con_bid_advertisements.html)

**See Attachment "B".**

This addendum has been prepared under the direction of the following registered Civil Engineer(s):

  
\_\_\_\_\_  
R.S. Chavez, P.E.



**Recommended by:**

  
\_\_\_\_\_  
Cindi Wachi, PE  
County Project Manager

**Concurrence:**

 6/5/13  
\_\_\_\_\_  
Khalid Nasim, P.E.  
Engineering Division Manager

**Acknowledged:** \_\_\_\_\_ **Date:** \_\_\_\_\_  
(Contractor)

JRJ:jrj:sb

**GILMAN SPRINGS ROAD  
PAVEMENT REHABILITATION PROJECT  
SOBOBA ROAD TO EAST OF STATE ROUTE 79 (SANDERSON AVENUE/ LAMB CANYON ROAD)  
SAN JACINTO AREA  
PROJECT NO. C1-0564**

**PROPOSAL (REVISED)**

**BASE BID**

ITEM No.	ITEM CODE	ITEM	UNIT	ESTIMATED QUANTITY	ITEM PRICE (IN FIGURES)	TOTAL (IN FIGURES)
1	999990	MOBILIZATION	LS	1		
2	120100	TRAFFIC CONTROL SYSTEM	LS	1		
3	128650	PORTABLE CHANGEABLE MESSAGE SIGN	EA	6		
4	170101	DEVELOP WATER SUPPLY	LS	1		
5	066102	DUST ABATEMENT	LS	1		
6	074020	WATER POLLUTION CONTROL	LS	1		
7	010601	OBTAIN ENCROACHMENT PERMIT	FA	1	15,000.00	15,000.00
8	160101	CLEARING AND GRUBBING	LS	1		
9	190101 (F)	ROADWAY EXCAVATION	CY	2,530		
10	011505	GRINDING ASPHALT CONCRETE IN PLACE	SQYD	18,500		
11	011506	WEDGE PLANE ASPHALT CONCRETE	LF	4,900		
12	390132	HOT MIX ASPHALT (TYPE A)	TON	15		
13	390129	HOT MIX ASPHALT (TYPE C)	TON	10,585		
14	013901	ASPHALT RUBBER HOT MIX	TON	1,700		
15	260201	CLASS 2 AGGREGATE BASE	CY	60		
16	394074	PLACE HOT MIX ASPHALT DIKE (TYPE C)	LF	400		
17	394002	PLACE ASPHALT CONCRETE (MISCELLANEOUS AREA)	SQYD	18		
18	017304	MINOR CONCRETE (CURB AND GUTTER) (CRS 200)	LF	580		
19	017307	MINOR CONCRETE (TYPE "C" CURB) (CRS 202)	LF	5,845		
20	017309	MINOR CONCRETE (TYPE "D" CURB) (CRS 204)	LF	600		
21	013902	ASPHALT CONCRETE OVERSIDE DRAIN (CRS 306)	EA	5		
22	731502	MINOR CONCRETE (MISCELLANEOUS CONSTRUCTION)	CY	4.2		
23	190185	SHOULDER BACKING	LF	15,000		
24	394050	RUMBLE STRIP	LF	10,000		
25	000003	TRANSVERSE RUMBLE STRIP	EA	3		
26	566011	ROADSIDE SIGN - ONE POST	EA	6		
27	700639	36" CORRUGATED STEEL PIPE INLET (.109" THICK)	LF	4.5		
28	820107	DELINEATOR (CLASS 1)	EA	32		
29	832001	METAL BEAM GUARD RAILING	LF	25		
30	839539	TERMINAL SYSTEM (TYPE SKT)	EA	2		

**PROPOSAL (REVISED)**

**BASE BID**

ITEM No.	ITEM CODE	ITEM	UNIT	ESTIMATED QUANTITY	ITEM PRICE (IN FIGURES)	TOTAL (IN FIGURES)
31	840515	THERMOPLASTIC PAVEMENT MARKING	SQFT	540		
32	840656	PAINT TRAFFIC STRIPE (2-COAT)	LF	42,400		
33	850102	PAVEMENT MARKER (REFLECTIVE)	EA	460		
34	220101	FINISHING ROADWAY	LS	1		
35	000003	MISCELLANEOUS DIRECTED WORK	FA	1	200,000.00	200,000.00
36	019901	DEMOBILIZATION	LS	1	100,000.00	100,000.00
37	066061	CONSTRUCTION ZONE ENHANCEMENT ENFORCEMENT PROGRAM (COZEEP)	FA	1	50,000.00	50,000.00
38	150742	REMOVE ROADSIDE SIGN	EA	2		
39	152390	RELOCATE ROADSIDE SIGN	EA	4		

PROJECT TOTAL: \_\_\_\_\_ \$ \_\_\_\_\_  
ITEMS 1-39 "WORDS"

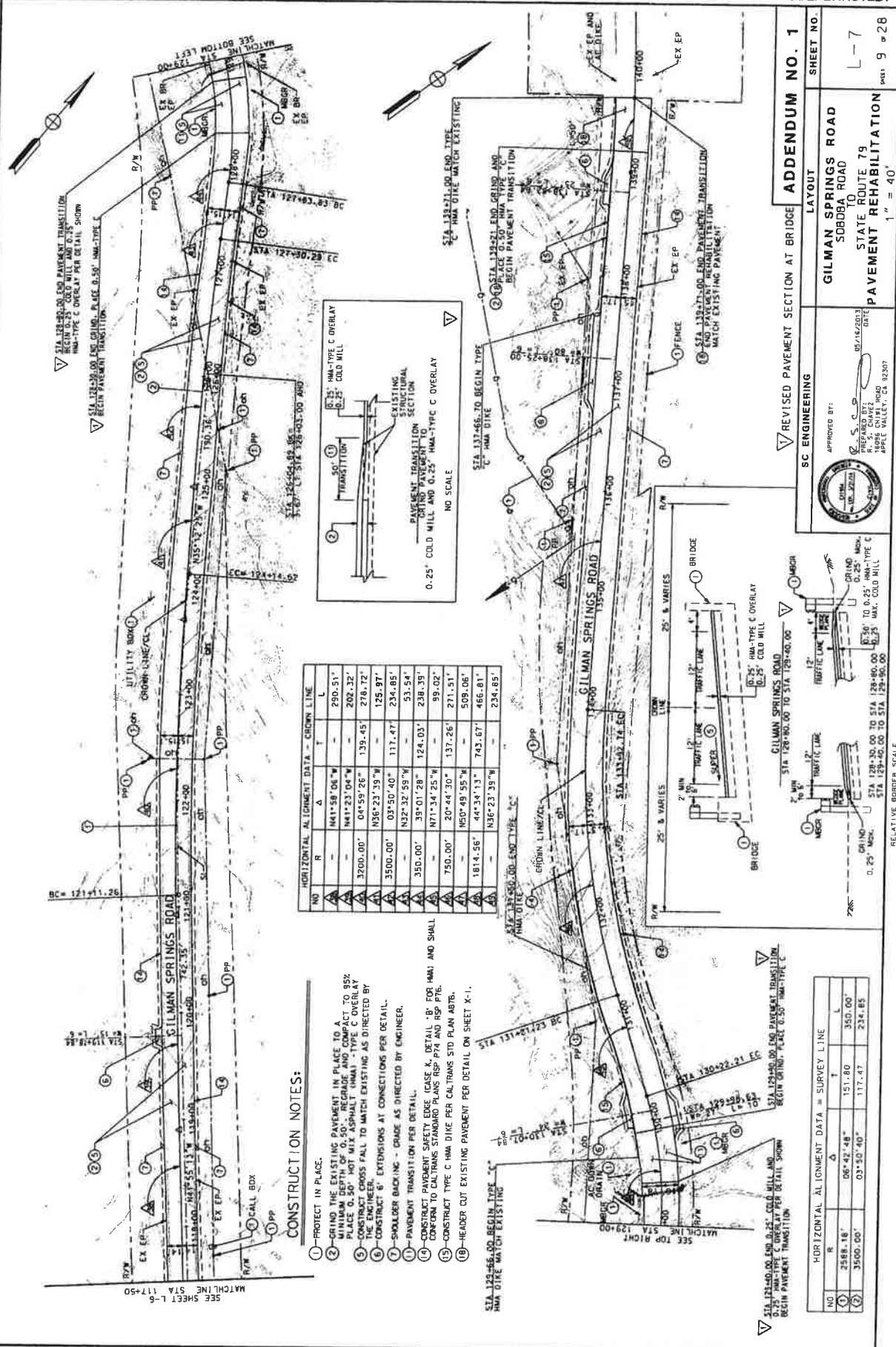

CONSTRUCTION NOTES:

- 1-PROTECT IN PLACE.
- 2-GRIND THE EXISTING PAVEMENT IN PLACE TO A MINIMUM DEPTH OF 0.50". REGRADE AND COMPACT TO 95% PLACE 0.50" HOT MIX ASPHALT (HMA) TYPE C OVERLAY.
- 3-CONSTRUCT CROSSES FALL TO MATCH EXISTING AS DIRECTED BY ENGINEER.
- 4-CONSTRUCT 6" EXTENSIONS AT CONNECTIONS PER DETAIL.
- 5-SHOULDER BACKING - GRADE AS DIRECTED BY ENGINEER.
- 6-PAVEMENT TRANSITION PER DETAIL.
- 7-CONSTRUCT PAVEMENT SAFETY EDGE (CASE & DETAIL "B" FOR HMA) AND SHALL CONFORM TO CALTRANS STANDARD PLANS RSP P74 AND RSP P76.
- 8-CONSTRUCT TYPE C HMA DIKE PER CALTRANS STD PLAN ADB7.
- 9-HEADER CUT EXISTING PAVEMENT PER DETAIL ON SHEET X-1.

HORIZONTAL ALIGNMENT DATA - CROWN LINE				
NO	R	Δ	T	L
1	441.58' 06" W	-	290.51'	
2	441.23' 04" W	-	202.32'	
3	3700.00'	04° 59' 26"	139.45'	278.72'
4	3500.00'	03° 50' 40"	117.47'	234.85'
5	350.00'	39° 01' 28"	124.03'	238.39'
6	750.00'	20° 44' 30"	137.26'	271.51'
7	1814.56'	44° 34' 13"	742.67'	466.81'
8	1814.56'	44° 34' 13"	742.67'	466.81'
9	1814.56'	44° 34' 13"	742.67'	466.81'

HORIZONTAL ALIGNMENT DATA - SURVEY LINE			
NO	R	Δ	L
1	2588.18'	06° 12' 48"	151.80'
2	3500.00'	03° 50' 40"	117.47'
3	3500.00'	03° 50' 40"	117.47'
4	3500.00'	03° 50' 40"	117.47'
5	3500.00'	03° 50' 40"	117.47'
6	3500.00'	03° 50' 40"	117.47'
7	3500.00'	03° 50' 40"	117.47'
8	3500.00'	03° 50' 40"	117.47'
9	3500.00'	03° 50' 40"	117.47'

SC ENGINEERING

APPROVED BY: [Signature]

DATE: 05/16/2013

PREPARED BY: [Signature]

DATE: 05/16/2013

15000 CHART ROAD

APPLE VALLEY, CA 92307

WO CI-0564

COUNTY FILE NO.

LAYOUT

GILMAN SPRINGS ROAD

SOBODA ROAD

STATE ROUTE 79

PAVEMENT REHABILITATION

1" = 40'

SHEET NO. L-7

9 of 28

## AGREEMENT

THIS CONTRACT is entered into at Riverside, California as of the date set forth below is between County of Riverside hereafter called "County" and **All American Asphalt** hereafter called "Contractor".

## W I T N E S S E T H

### RECITALS:

1. Contractor has submitted to County his Contractor's Proposal for the construction of County Project, **Gilman Springs Road Pavement Rehabilitation Project, Soboba Road to East of State Route 79 (Sanderson Avenue/Lamb Canyon Road), San Jacinto Area, Project No. C1-0564**, in strict accordance with the Contract Documents identified below and County has accepted said Proposal.
2. Contractor states that he has reexamined his Contractor's Proposal and found it to be correct, has ascertained that his subcontractors are properly licensed and possess the requisite skill and forces, has reexamined the site and Contract Documents and is of the opinion that he can presently do the work in accordance with the Contract Documents for the money set forth in his Proposal to be paid as provided in the Contract Documents.

### AGREEMENT:

IT IS AGREED BY THE PARTIES AS FOLLOWS:

1. Contract Documents. The entire contract consists of the following: (a) The Agreement. (b) The Notice Inviting Bids. (c) The Instruction to Bidders. (d) The Contractor's Proposal. (e) The Bid Bond. (f) The Payment Bond. (g) The Performance Bond. (h) The General Conditions. (i) The Special Provisions. (j) The Standard Specifications of the State of California Department of Transportation edition of May 2006 as modified in other portions of the Contract Documents. (k) The Standard Plans of the Department of Transportation identified on the plans or in the Special Provisions. (l) The Plans. (m) Addenda No. **(one)**. (n) The Determination of Prevailing Wage Rates for Public Work. (o) Any Change Orders issued. (p) Any additional or supplemental specifications, notice, instructions and drawings issued in accordance with the provisions of the Contract Documents. All of said Documents presently in existence are by this reference incorporated herein with like effect as if here set forth in full and upon the proper issuance of other documents they shall likewise be deemed incorporated. The Bid Bond is exonerated upon execution of this Agreement and the Payment Bond and Faithful Performance Bond.
2. The Work. Contractor shall do all things necessary to construct the work generally described in Recital No. 1 in accordance with the Contract Documents.



3. Liquidated Damages and Time of Completion. Attention is directed to the provisions in Section 8-1.06, "Time of Completion", and in Section 8-1.07, "Liquidated Damages", of the Standard Specifications and these Special Provisions.

The Contractor shall begin work within five (5) calendar days or as revised in the Special Provisions, of the date stated within the written "Notice to Proceed".

The Contractor shall notify the Engineer, in writing, of his intent to begin work at least 72 hours before work is begun. The notice shall be delivered to the Transportation Department's Construction Engineer and shall specify the date the Contractor intends to start. If the project has more than one location of work, a separate notice shall be given for each location.

Should the Contractor begin work in advance of receiving a written "Notice to Proceed", any work performed by him in advance of the date stated in the "Notice to Proceed" shall be considered as having been done by him at his own risk and as a volunteer and subject to the following:

- A. The Contractor shall, on commencing operations, take all precautions required for public safety and shall observe all the provisions in the Specifications and the Special Provisions.
  - B. All work done according to the contract prior to the issuance of the "Notice to Proceed", will be considered authorized work and will be paid for as provided in the contract.
  - C. The Contractor shall not be entitled to any additional compensation or an extension of time for any delay, hindrance or interference caused by or attributable to commencement of work prior to the issuance of the "Notice to Proceed".
4. Compensation. Contractor shall be paid in the manner set forth in the Contract Documents the amount of his Proposal as accepted by County, the above rates, subject to additions and deductions as provided in the Contract Documents. Said Proposal is on file in the Office of the Clerk of the Board of Supervisors of County.

**GILMAN SPRINGS ROAD  
PAVEMENT REHABILITATION PROJECT  
SOBOBA ROAD TO EAST OF STATE ROUTE 79 (SANDERSON AVENUE/ LAMB CANYON ROAD)  
SAN JACINTO AREA  
PROJECT NO. C1-0564**

**AGREEMENT**

ITEM No.	ITEM CODE	ITEM	UNIT	ESTIMATED QUANTITY	ITEM PRICE (IN FIGURES)	TOTAL (IN FIGURES)
1	999990	MOBILIZATION	LS	1	27,000.00	27,000.00
2	120100	TRAFFIC CONTROL SYSTEM	LS	1	45,000.00	45,000.00
3	128650	PORTABLE CHANGEABLE MESSAGE SIGN	EA	6	263.00	1,578.00
4	170101	DEVELOP WATER SUPPLY	LS	1	2,000.00	2,000.00
5	066102	DUST ABATEMENT	LS	1	4,000.00	4,000.00
6	074020	WATER POLLUTION CONTROL	LS	1	5,500.00	5,500.00
7	010601	OBTAIN ENCROACHMENT PERMIT	FA	1	15,000.00	15,000.00
8	160101	CLEARING AND GRUBBING	LS	1	10,000.00	10,000.00
9	190101 (F)	ROADWAY EXCAVATION	CY	2,530	29.00	73,370.00
10	011505	GRINDING ASPHALT CONCRETE IN PLACE	SQYD	18,500	2.00	37,000.00
11	011506	WEDGE PLANE ASPHALT CONCRETE	LF	4,900	2.43	11,907.00
12	390132	HOT MIX ASPHALT (TYPE A)	TON	15	55.00	825.00
13	390129	HOT MIX ASPHALT (TYPE C)	TON	10,585	75.00	793,875.00
14	013901	ASPHALT RUBBER HOT MIX	TON	1,700	88.00	149,600.00
15	260201	CLASS 2 AGGREGATE BASE	CY	60	51.00	3,060.00
16	394074	PLACE HOT MIX ASPHALT DIKE (TYPE C)	LF	400	7.30	2,920.00
17	394002	PLACE ASPHALT CONCRETE (MISCELLANEOUS AREA)	SQYD	18	52.50	945.00
18	017304	MINOR CONCRETE (CURB AND GUTTER) (CRS 200)	LF	580	13.80	8,004.00
19	017307	MINOR CONCRETE (TYPE "C" CURB) (CRS 202)	LF	5,845	11.60	67,802.00

ITEM No.	ITEM CODE	ITEM	UNIT	ESTIMATED QUANTITY	ITEM PRICE (IN FIGURES)	TOTAL (IN FIGURES)
20	017309	MINOR CONCRETE (TYPE "D" CURB) (CRS 204)	LF	600	12.00	7,200.00
21	013902	ASPHALT CONCRETE OVERSIDE DRAIN (CRS 306)	EA	5	1,575.00	7,875.00
22	731502	MINOR CONCRETE (MISCELLANEOUS CONSTRUCTION)	CY	4.2	900.00	3,780.00
23	190185	SHOULDER BACKING	LF	15,000	1.55	23,250.00
24	394050	RUMBLE STRIP	LF	10,000	0.79	7,900.00
25	000003	TRANSVERSE RUMBLE STRIP	EA	3	174.00	522.00
26	566011	ROADSIDE SIGN - ONE POST	EA	6	336.00	2,016.00
27	700639	36" CORRUGATED STEEL PIPE INLET (.109" THICK)	LF	4.5	1,580.00	7,110.00
28	820107	DELINEATOR (CLASS 1)	EA	32	49.00	1,568.00
29	832001	METAL BEAM GUARD RAILING	LF	25	28.00	700.00
30	839539	TERMINAL SYSTEM (TYPE SKT)	EA	2	3,300.00	6,600.00
31	840515	THERMOPLASTIC PAVEMENT MARKING	SQFT	540	4.20	2,268.00
32	840656	PAINT TRAFFIC STRIPE (2-COAT)	LF	42,400	0.27	11,448.00
33	850102	PAVEMENT MARKER (REFLECTIVE)	EA	460	4.20	1,932.00
34	220101	FINISHING ROADWAY	LS	1	525.00	525.00
35	000003	MISCELLANEOUS DIRECTED WORK	FA	1	200,000.00	200,000.00
36	019901	DEMOBILIZATION	LS	1	100,000.00	100,000.00
37	066061	CONSTRUCTION ZONE ENHANCEMENT ENFORCEMENT PROGRAM (COZEEP)	FA	1	50,000.00	50,000.00
38	150742	REMOVE ROADSIDE SIGN	EA	2	74.00	148.00
39	152390	RELOCATE ROADSIDE SIGN	EA	4	220.00	880.00

PROJECT TOTAL: One million, six hundred ninety five thousand, one hundred eight dollars and zero cents \$1,695,108.00  
 ITEMS 1-39 "WORDS"

**GILMAN SPRINGS ROAD  
PAVEMENT REHABILITATION PROJECT  
SOBOBA ROAD TO EAST OF STATE ROUTE 79 (SANDERSON AVENUE/ LAMB CANYON ROAD)  
SAN JACINTO AREA**

**PROJECT NO. C1-0564**

IN WITNESS WHEREOF the parties hereto have executed this agreement as of the date set forth below.

COUNTY OF RIVERSIDE

ALL AMERICAN ASPHALT

BY \_\_\_\_\_  
Chairman, Board of Supervisors

BY \_\_\_\_\_

Dated \_\_\_\_\_

TITLE: \_\_\_\_\_  
(If Corporation, Affix Seal)

ATTEST:

Kecia Harper-Ihem, Clerk of the Board

ATTEST:

\_\_\_\_\_

BY \_\_\_\_\_  
Deputy

TITLE: \_\_\_\_\_

Licensed in accordance with an act  
providing for the registration of  
Contractors,

License No. \_\_\_\_\_

Federal Employer Identification Number:

\_\_\_\_\_

FORM APPROVED COUNTY COUNSEL  
BY: MR. Victor 6/24/13  
MARSHA L. VICTOR DATE

BY \_\_\_\_\_  
"County"  
(Seal)

\_\_\_\_\_  
"Corporation"  
(Seal)

## Performance Bond

### Recitals:

1. All American Asphalt (Contractor) has entered into a Contract with COUNTY OF RIVERSIDE (County) for construction of public work known as Gilman Springs Road Pavement Rehabilitation Project, Soboba Road to State Route 79 (Sanderson Avenue/ Lamb Canyon Road), San Jacinto Area, Project No. C1-0564.
2. \_\_\_\_\_, a \_\_\_\_\_ corporation (Surety), is the Surety under this Bond.

### Agreement:

We, Contractor as Principal and Surety as Surety, jointly and severally agree, state, and are bound unto County, as obligee, as follows:

1. The amount of the obligation of this Bond is 100% of the estimated contract price for the Project of \$ 1,695,108.00 (One million, six hundred ninety five thousand, one hundred eight dollars and zero cents) and inures to the benefit of County.
2. This Bond is exonerated by Contractor doing all things to be kept and performed by it in strict conformance with the Contract Documents for this project, otherwise it remains in full force and effect for the recovery of loss, damage and expense of County resulting from failure of Contractor to so act. All of said Contract Documents are incorporated herein.
3. This obligation is binding on our successors and assigns.
4. For value received, Surety stipulates and agrees that no change, time extension, prepayment to Contractor, alteration or addition to the terms and requirements of the Contract Documents or the work to be performed thereunder shall affect its obligations hereunder and waives notice as to such matters, except the total contract price cannot be increased by more than 10% without approval of Surety.

THIS BOND is executed as of \_\_\_\_\_.

By \_\_\_\_\_

By \_\_\_\_\_

By \_\_\_\_\_

Type Name \_\_\_\_\_

Its Attorney in Fact  
"Surety"

Title \_\_\_\_\_

"Contractor"

(Corporate Seal)

(Corporate Seal)

**NOTE:** This Bond must be executed by both parties with corporate seal affixed. All signatures must be acknowledged. (Attach acknowledgements).

## Payment Bond

(Public Works - Civil Code §9550 et seq.)

The makers of this Bond are All American Asphalt, as Principal and Original Contractor and \_\_\_\_\_, a corporation, authorized to issue Surety Bonds in California, as Surety, and this Bond is issued in conjunction with that certain public works contract to be executed between Principal and COUNTY OF RIVERSIDE a public entity, as Owner, for \$ 1,695,108.00 (One million, six hundred ninety five thousand, one hundred eight dollars and zero cents), the total amount payable. The amount of this bond is one hundred percent (100%) of said sum. Said contract is for public work generally consisting of Gilman Springs Road Pavement Rehabilitation Project, Soboba Road to State Route 79 (Sanderson Avenue/ Lamb Canyon Road), San Jacinto Area, Project No. C1-0564.

The beneficiaries of this Bond are as is stated in 9554 of the Civil Code and requirements and conditions of this Bond are as is set forth in 9554, 9558, 9560 and 9564 of said code. Without notice, Surety consents to extension of time for performance, change in requirements, amount of compensation, or prepayment under said contract.

Dated: \_\_\_\_\_

\_\_\_\_\_  
Original Contractor – Principal

\_\_\_\_\_  
Surety

By \_\_\_\_\_

By \_\_\_\_\_

Its Attorney In Fact

Title \_\_\_\_\_

(If corporation, affix seal)

(Corporate Seal)

(Corporate Seal)

STATE OF \_\_\_\_\_  
COUNTY OF \_\_\_\_\_ }

ss. SURETY'S ACKNOWLEDGEMENT

On \_\_\_\_\_ before me, \_\_\_\_\_ personally appeared, \_\_\_\_\_, known to me, or proved to me on the basis of satisfactory evidence, to be the person whose name is subscribed to the within instrument and acknowledged to me that he executed the same in his authorized capacities, and that by his signature on the instrument the person, or the entity upon behalf of which the person acted, executed the instrument.

WITNESS my hand and official seal.

\_\_\_\_\_  
Signature of Notary Public

Notary Public (Seal)

**NOTE: This Bond must be executed by both parties with corporate seal affixed. All signatures must be acknowledged. (Attach acknowledgements).**