

Departmental Concurrence

**SUBMITTAL TO THE BOARD OF SUPERVISORS
COUNTY OF RIVERSIDE, STATE OF CALIFORNIA**

325
A



FROM: TLMA - Transportation Department

SUBMITTAL DATE:

July 3, 2013

SUBJECT: Authorization for Payment to the Imperial Irrigation District (IID) for the Relocation of Conflicting IID Facilities, Airport Boulevard at Union Pacific Railroad (UPRR) Crossing, Thermal Area

RECOMMENDED MOTION: That the Board of Supervisors authorize the payment of \$47,561 to the IID as payment for the relocation of IID owned poles and supports, which are in conflict with the Airport Boulevard Grade Separation Project.

BACKGROUND: Airport Boulevard (also known as Avenue 56) is designated in the Riverside County General Plan as a six-lane urban arterial highway that serves the Thermal community of eastern Riverside County, the City of Coachella, and the City of La Quinta while providing direct

Juan C. Perez

Director of Transportation and Land Management

JP:sd

(Continued On Attached Page)

FINANCIAL DATA	Current F.Y. Total Cost:	\$ 47,561	In Current Year Budget:	Yes
	Current F.Y. Net County Cost:	\$ 0	Budget Adjustment:	No
	Annual Net County Cost:	\$ 0	For Fiscal Year:	2013/2014
SOURCE OF FUNDS: TUMF Coachella Valley Association of Governments (CVAG) - 100%				Positions To Be Deleted Per A-30 <input type="checkbox"/>
There are no General Funds used for this project.				Requires 4/5 Vote <input type="checkbox"/>

C.E.O. RECOMMENDATION:

APPROVE

BY: Tina Grande
Tina Grande

County Executive Office Signature

Dep't Recomm.: ☐ Policy ☒ Policy
Per Exec. Ofc.: ☐ Consent ☒ Consent

Prev. Agn. Ref.

District: 4/4

Agenda Number:

3-58

The Honorable Board of Supervisors

RE: Authorization for Payment to the Imperial Irrigation District (IID) for the Relocation of Conflicting IID Facilities, Airport Boulevard at Union Pacific Railroad (UPRR) Crossing, Thermal Area

July 3, 2013

Page 2 of 2

access from State Route 86 and Grapefruit Boulevard (SH-111) to the Jacqueline Cochran Regional Airport. A UPRR at-grade crossing currently exists on Airport Boulevard just south of the City of Coachella, paralleling State Route 86. A grade separation project that will separate Airport Boulevard from the UPRR mainline tracks has been proposed, and it is anticipated that construction will begin in the first quarter of 2014.

The railroad grade separation project includes the construction of a bridge structure to elevate Airport Boulevard over the UPRR tracks. The project will improve motorist safety by separating vehicle traffic from rail traffic.

This project has been identified to receive \$10 million from the State's Prop 1B Bonds Goods Movement Program, administered through Transportation Corridor Improvement Funds. A Project Baseline Agreement with the California Transportation Commission identifying the scope and cost of the project was approved by the Riverside County Board of Supervisors on July 29, 2008. The County is required to execute a construction agreement of the improvements by December 31, 2013, under the terms of the Project Baseline Agreement.

The project has been environmentally cleared. Final plans, specifications, and estimates have been prepared; and, right-of-way acquisitions are in progress.

IID owns a number of power poles and associated equipment throughout the project limits that are in conflict with the project improvements. Most of the relocations will be performed by IID at IID expense. The submitted invoice provides payment for the relocation of two service poles and one transmission pole support for which IID has superior property rights. The relocation of those conflicting facilities is the County's funding responsibility, and is consistent with the County's request documents, which are attached and designated collectively as Exhibit "A".

Project No. A6-0241



COUNTY OF RIVERSIDE

TRANSPORTATION AND LAND MANAGEMENT AGENCY

Transportation Department



Juan C. Perez, P.E., T.E.
Director of Transportation

April 5, 2012

Rosalinda Escobedo
Imperial Irrigation District - Distribution
81-600 Avenue 58
La Quinta, CA 92201

**RE: Transmittal of Application Documents, Power Pole Relocations,
Airport Blvd. Grade Separation over Grapefruit Blvd. and UPRR Tracks,
Thomas Bros. Page 5531, Grid G-4
Project No. A6-0241**

Dear Ms. Escobedo:

Transmitted is a completed application form for the design and relocation of IID owned power poles, which are in conflict with the referenced project improvements.

This information supplements the attached letter, dated February 7, 2012, copy attached, and is provided for information purposes as requested by Carlos Puente of IID.

The Imperial Irrigation district owns 17 power poles which have been identified by the County's engineer as being in conflict with the project improvements, as shown on the attached exhibit. Additional poles may also be in conflict, and your concurrence in this matter is requested.

Cost apportionment may be subject to additional research, but my current understanding is that 15 of those poles are within County right-of-way, and the District is obligated to relocate those poles at IID expense. Two of the poles are within private property adjacent to the post office, and we believe that the County is obligated to fund the relocation of those two poles. The identified poles in conflict are as follows:

<u>Pole Number</u>	<u>Approx. Const. Station</u>
1097921	32+30 (Rt) Airport
1097922	34+30 (Rt) Airport
Unknown PP #	36+95 (Lt) Airport
96581	37+50 (Rt) Airport
902892	57+30 (Rt) Airport

The Honorable Board of Supervisors

RE: Authorization for Payment to the Imperial Irrigation District (IID) for the Relocation of Conflicting IID Facilities, Airport Boulevard at Union Pacific Railroad (UPRR) Crossing, Thermal Area

July 3, 2013

Page 2 of 2

access from State Route 86S and Grapefruit Boulevard (SH-111) to the Jacqueline Cochran Regional Airport. A UPRR at-grade crossing currently exists on Airport Boulevard just south of the City of Coachella, paralleling State Route 86S. A grade separation project that will separate Airport Boulevard from the UPRR mainline tracks has been proposed, and it is anticipated that construction will begin in the first quarter of 2014.

The railroad grade separation project includes the construction of a bridge structure to elevate Airport Boulevard over the UPRR tracks. The project will improve motorist safety by separating vehicle traffic from rail traffic.

This project has been identified to receive \$10 million from the State's Prop 1B Bonds Goods Movement Program, administered through Transportation Corridor Improvement Funds. A Project Baseline Agreement with the California Transportation Commission identifying the scope and cost of the project was approved by the Riverside County Board of Supervisors on July 29, 2008. The County is required to execute a construction agreement of the improvements by December 31, 2013 under the terms of the Project Baseline Agreement.

The project has been environmentally cleared. Final plans, specifications, and estimates have been prepared; and, right-of-way acquisitions are in progress.

IID owns a number of power poles and associated equipment throughout the project limits that are in conflict with the project improvements. Most of the relocations will be performed by IID at IID expense. The submitted invoice provides payment for the relocation of two service poles and one transmission pole support for which IID has superior property rights. The relocation of those conflicting facilities is the County's funding responsibility, and is consistent with the County's request documents, which are attached and designated collectively as Exhibit "A".

Project No. A6-0241

C O U N T Y O F R I V E R S I D E
D E P A R T M E N T O F T R A N S P O R T A T I O N

AIRPORT BLVD GRADE SEPARATION

**FROM 0.49 MILES WEST OF GRAPEFRUIT BLVD
TO 0.34 MILES EAST OF GRAPEFRUIT BLVD**

COMMUNITY OF THERMAL

PROJECT No. A6-0241

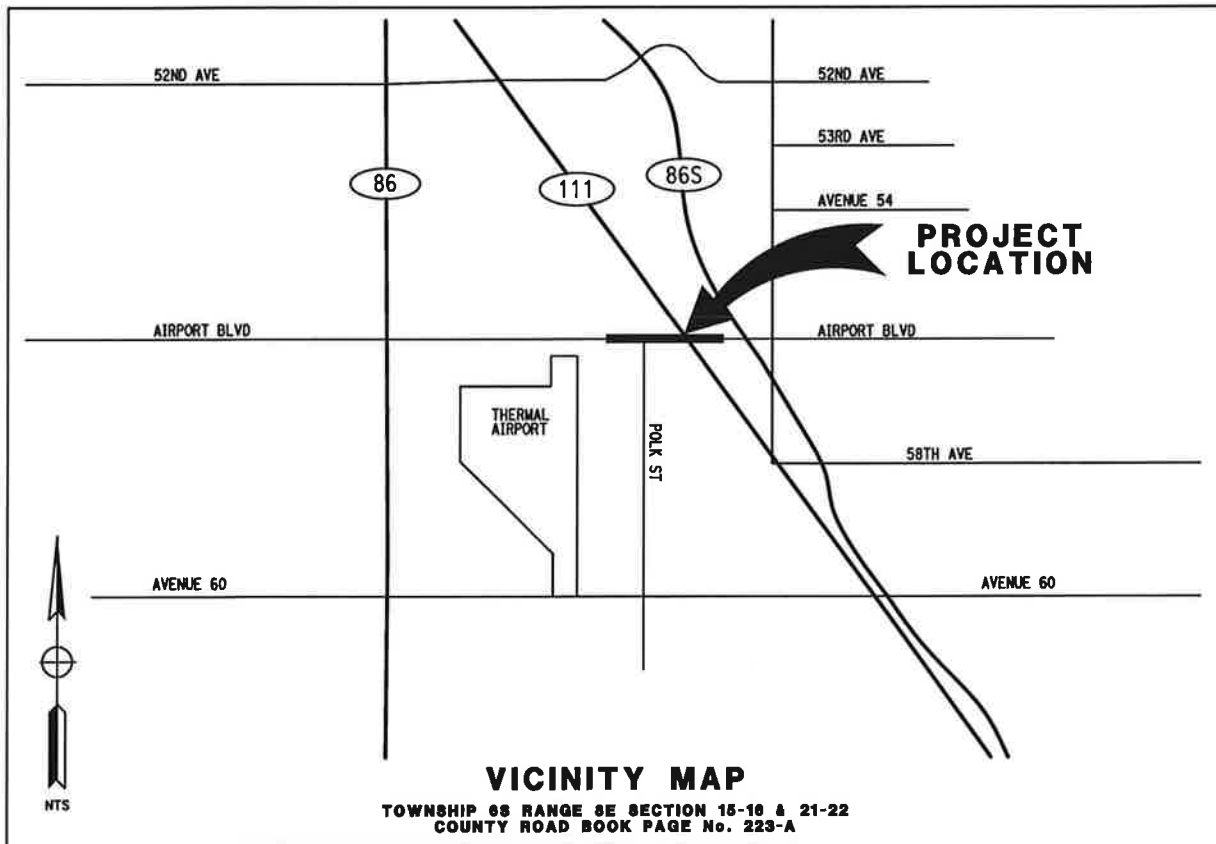
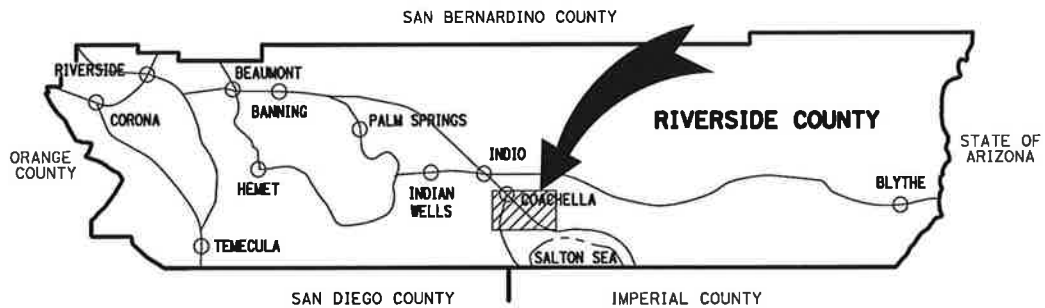

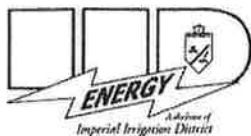

CUSTOMER OPERATIONS
81-600 AVENUE 58
LA QUINTA, CA 92253

Date: June 17, 2013.

Customer Acct. # 3329669

COUNTY OF RIVERSIDE TRANSPORTATION
3525 14TH ST
RIVERSIDE CA 92501

CSP # 4014428

AIRPORT BLVD & GRAPEFRUIT BLVD
THERMAL CA 92274

Subject: RELOCATION OF IID POLES

IID Energy thanks you for giving us the opportunity to serve your electrical needs. To ensure your project is successfully processed, payment in full is required for the balance due. Please send payment to 81-600 AVENUE 58 - LA QUINTA, CA 92253.

Regulation Charges	Amount Quoted	Balance Due
Engineering Fee	\$ 4,000.00	
IID POLES RELOCATION	\$ 47,561.28	\$ 47,561.28
Total Charges	\$ 51,561.28	\$ 47,561.28

Our Goal is to provide excellent customer service from design to construction. Please ensure requirements 1 & 2 are accomplished or contact Project Manager at 760-398-5841 if you have questions about your project.

Requirements

1. Project is paid in full
2. IID inspections are passed

Call your Project Manager once requirements 1 & 2 are accomplished. This allows us to efficiently plan and commit necessary resources to complete your project.

Important

1. Failure to acknowledge this quote by **12/14/2013** results in cancellation.
2. After Payment is made in full, actual construction date is subject to material availability (10-16 weeks).
3. Design changes caused by the customer may increase regulation charges.
4. Failure to fulfill payments and IID inspections will result in project delays.
5. Guarantee deposit is also required for **new commercial accounts**.

Sincerely,

Mr. Carlos Puente
Project Manager

96591	57+65 (Rt) Airport
<u>Pole Number</u>	<u>Approx. Const. Station</u>
902891	59+00 (Lt) Airport
1097926	59+05 (Rt) Airport
911626	60+05 (Rt) Airport
99022 and adjacent pole	60+75 (Rt) Airport
915616	62+00 (Rt) Airport
96593	63+10 (Rt) Airport
96595	68+20 (Rt) Airport
94173	34+30 (Lt) Grapefruit
914112	On USPS parcel
95188	On USPS parcel

Additionally, there may be aerial conductors that will be too close to the planned traffic signal poles and luminaire mast arms. For 12kV systems, the aerial conductors must be at least 10 feet above the traffic signal poles and mast arms. This matter is being reviewed by the electrical designer, and we will notify IID of any additional relocation requirements that may be identified.

Plans have been previously submitted to Mr. Carlos Puente of IID, and he has been in communication with our engineer, Joe Gonzalez of Parsons Engineering.

Thank you for your assistance. If you have any questions or need additional information, please call Joe Gonzalez of Parsons Engineering at (949) 333-4489. You may also contact me at (951) 955-6785 or Minio García at (951) 955-6785.

Sincerely,

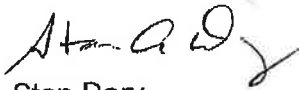

Stan Dery
Technical Engineering Unit Supervisor
Utility Unit

sd
attachments

cc: Scott Staley
John Ashlock
Joe Gonzalez
Herminio Garcia

Customer Information Packet



Imperial Irrigation District

Protecting the flow of progress.

Customer Service Operations

Imperial Valley/La Quinta

Note: The County is directing IID to relocate its conflicting power poles, most of which are within County R/W. Application is being provided at the request of IID for information purposes only, and some of the stated obligations of the County on these forms may not be applicable.

IID Energy Customer Service Operations

Imperial Valley

1699 W. Main Street, Suite A, El Centro, CA 92243
(760) 482-3300 Fax (760) 482-3301

La Quinta

81-600 Avenue 58, La Quinta, CA 92253
(760) 398-5841 Fax (760) 391-5944

Note: The County is directing IID to relocate its conflicting power poles, most of which are within County R/W. Application is being provided at the request of IID for information purposes only, and some of the stated obligations of the County on these forms may not be applicable.

COMMERCIAL APPLICATION

PRINT FORM



IID-755 (R10 4-07)
SERVICE ORDER/ COM APPLICATION

Location Airport Blvd, E and W of Grapefruit Blvd.		Name: County of Riverside	
Mail Bill To Stan Dery		Doing Business As (DBA): Transportation Department	
Principal Place of Business (Address) 3525 14th Street, Riverside, CA 92501		Is Business a Corporation? (If so, place of incorporation) NO	Print Name of 1st Person Signing Stan Dery
Type of Business	President	Title Tech. Eng. Unit Supervisor	Soc. Sec. No.
Is Business a Sole Proprietorship (If so, name)	Vice-President	Driver's License No.	State CA
Spouse's Name / Address	Secretary	Print Name of 2nd Person Signing	
Is Business a Partnership (If so, names)	Treasurer	Title	Soc. Sec. No.
1)	Federal Tax No. 95-6000930	Driver's License No.	State
2)	Letter of Authorization <input type="checkbox"/> Articles of Incorporation <input type="checkbox"/>	Phone <input checked="" type="checkbox"/> B M 951-955-6785	Phone <input type="checkbox"/> H B M

Imperial Irrigation District Regulations Governing Sale And Use of Electric Energy

Excerpts from Regulation No. 6

The customer shall, at his own risk and expense, furnish, install and keep in good and safe condition all electric wires, lines, machinery and apparatus of any sort which may be required for receiving electric energy from the District, and for applying and utilizing such energy, including all necessary protective appliances and suitable housing therefor. The District shall not be responsible for any loss or damage occasioned or caused by the negligence or want of proper care or wrongful act of the customer or any of his agents, employees or licensees on the part of the customer in installing, maintaining, using, operating or interfering with any such wires, lines, machinery or apparatus.

N/A
AD

Excerpts from Regulation No. 11

The District shall, at its option, have the right to: disconnect its services until the customer has complied with all the terms of the agreement and of the District's regulation.

N/A
AD

Excerpts from Regulation No. 15

The District will construct, own, operate and maintain lines only along public streets, roads and highways which the District has the legal right to occupy and on public lands and private property across which rights-of-way satisfactory to the District may be obtained without cost or condemnation by the District.

All Imperial Irrigation District Regulations Governing Sale and Use of Electric Energy are available for viewing at all IID Division Offices and Imperial Operating Headquarters.

The undersigned applicant hereby certifies that he has read and understands the regulations governing the sale and use of electric energy printed above and requests that Imperial Irrigation District supply electric service required at the address shown until such time as written or accepted telephone notice of discontinuance is given, and in consideration thereof does hereby agree to abide by the rules and regulations adopted by the Board of Directors of Imperial Irrigation District, and to pay all bills for services rendered pursuant thereto under the rates adopted by said Board of Directors.

Applicant (s) Signature	Date Signed 4/31/2012 4/5/12
1) <i>Stan Dery</i>	Taken By
2)	

INTERNAL USE ONLY

BP No.	<input type="checkbox"/> CO <input type="checkbox"/> DO	Cycle	Book	ARDMS Segment No.	New Seg. <input type="checkbox"/>	ARDMS Sequence No.
Contract Account No.	<input type="checkbox"/> Urban <input type="checkbox"/> Rural	CO Date	DO Date	Rate	SE	SIC
HP / Schedule Change	Meter No. 1 of 2	Reading	Mult.	Demand	Serial No.	
From To STAPP <input type="checkbox"/> Yes <input type="checkbox"/> No	Meter No. 1 of 2	Reading	Mult.	Demand	Serial No.	
Credit Est. <input type="checkbox"/> Yes <input type="checkbox"/> No	G.D. No.	Amount				
Remarks	<input type="checkbox"/> New Installation <input type="checkbox"/> Reinstall <input type="checkbox"/> Re-connect <input type="checkbox"/> Removed <input type="checkbox"/> Left on Premise					
Notes	Approved By	Received by CA	Keyed in Computer			
Make 1 of 2	Type	Phase	Make 2 of 2	Type	Phase	
Wire	Volt	AMP	Wire	Volt	AMP	
Hours	WO	Cleared A.M. P.M.	Date sdf	Workman		



Imperial Irrigation District
Protecting the flow of progress.

IID-700A (6-07)

Customer Information Sheet for New Service

Not Applicable

Project Address: _____

1. To ensure correct billing, please provide the following information: *(billing will be issued in the name under which this job was initiated.)*

Customer Name: County of Riverside Transportation Department

Mailing Address for Billing: P.O. Box 1605 Riverside, Ca. 92502-1605

Telephone No.: 951-955-6785 Fax No.: _____

Tax ID No. / Social Security: 95-6000930

2. Please provide the name and address of the person (business) who will be responsible for the line extension charges:

Developer's Name: County of Riverside Transportation Department

Address: _____

Telephone No.: 951-955-6785 Fax No.: _____

Tax ID No. / Social Security: _____

NOTE: Failure to complete this form and return it to IID could cause a delay in electric service being provided for this project.

I agree and understand that an Advanced Design Fee will be paid to begin engineering a project and will be applied as a credit toward the IID cost of the project if it goes to completion. If the project is cancelled, the Advanced Design Fee is non-refundable. Any design changes that result in the redesign of the project, and therefore alters prior scheduled IID commitments will require an additional non-refundable Advanced Design Fee (equal amount due to the original Advanced Fee) and may cause significant delays in construction schedules(s).

N/A - info only
Signature

1/31/2012
Date

Stan Dery
Print Name

Tech. Eng. Unit Supervisor
Representing

IID Energy Customer Service Operations

Imperial Valley
1699 W. Main Street, Suite A, El Centro, CA 92243
(760) 482-3300 Fax (760) 482-3301

La Quinta
81-600 Avenue 58, La Quinta, CA 92253
(760) 398-5841 Fax (760) 391-5944



Imperial Irrigation District
Protecting the flow of progress.

Service Planning Sheet Residential/Commercial

1.) Project Name: Grade Separation Project - Airport Blvd. over UPRR railroad, at Grapefruit Blvd.

2.) Project Address: _____

City Thermal State CA Zip Code 92274

Township 6S Range 8E Section 22

APN# (Assessor Parcel No.) 757-070-022

3.) Developer/Contractor: County of Riverside Transportation Department

Billing Address: 3525 14th Street, Riverside, CA 92501

4.) Contact Person Stan Dery

5.) Date Permanent Service Requested: Estimate: Late 2013 (Poles must be relocated prior to start of construction)

Main Panel Size* (Amps): _____ Installation Desired: O.H. ☐ U.G. ☒

Voltage Required: _____ Type of Service Needed: 1 Phase (Ø) _____ 3 Phase (Ø) _____

Number of Meters: _____ Single Largest Motor: 1 Phase (Ø) _____ 3 Phase (Ø) _____

Service Description: Relocation of conflicting IID power poles and associated conflicting equipment

*Service Rating shall be the termination section, pull can, service section, or, if available, main service disconnect switch electrical rating, whichever is largest.

Approximate Net Building:

Square Footage: _____ Number of Suites _____ Business Hours / Day _____ Week _____ Month _____

Electrical Load Information: (Connected Loads)**

							TOTALS
							Connected Loads
Lighting	_____ KW	1 ph Air Cond	_____ ea. @ _____	FL amps @ _____	Volts _____	VA _____	
Receptacles	_____ KW	3 ph Air Cond	_____ ea. @ _____	FL amps @ _____	Volts _____	VA _____	_____ KW
Water Heater	_____ KW	1 ph Heat Pumps	_____ ea. @ _____	HP _____		HP _____	Demand
Air Heaters	_____ KW	3 ph Heat Pumps	_____ ea. @ _____	HP _____		HP _____	_____ KW
Cooking	_____ KW	Aux. Strip Htrs	_____ ea. @ _____	KW _____		KW _____	
X-Ray (input)	_____ KW	1 ph Misc. Motors	_____ ea. @ _____	HP _____		HP _____	
Welders (input)	_____ KVA	3 ph Misc. Motors	_____ ea. @ _____	HP _____		HP _____	
Other	_____ KW/KVA/HP**						

FL = Full Load

IID Energy Customer Service Operations

Imperial Valley
1699 W. Main Street, Suite A, El Centro, CA 92243
(760) 482-3300 Fax (760) 482-3301

La Quinta
81-600 Avenue 58, La Quinta, CA 92253
(760) 398-5841 Fax (760) 391-5944



Imperial Irrigation District
Protecting the flow of progress.

Indemnification Agreement

Terms and Conditions for Receipt of Electric Utility Service for New Developments

In consideration for the provision of electrical utility service by IID for the development project identified in the Standards Specifications and Form IID-700A (6-07), Applicant and IID agree as follows:

- 1) *The provision of electric utility service to Applicant is conditioned on compliance by Applicant with all applicable laws including the Imperial Irrigation District Regulations Governing the Sale and Use of Electric Energy and Rate Schedules.*
- 2) *Applicant shall defend and indemnify IID, from any: liability, claims, suite or actions; losses, expenses, fees, or costs of any kind, so long as such things are in relation to, as a consequence of, arising out of, or in any way attributable actually, allegedly or impliedly, in whole or in par, to the provision of electrical utility service by IID to Applicant for the development project identified in the Standards Specifications and Form IID-700A (6-07); however Applicant shall not be required to indemnify and hold harmless IID as set forth above for liability attributable to the sole fault of IID.*

Signature: _____

Print Name: Stan Dery

Title: Tech. Eng. Unit Supervisor

Date: 1/31/2012

4/5/12

IID Energy Customer Service Operations

Imperial Valley
1699 W. Main Street, Suite A, El Centro, CA 92243
(760) 482-3300 Fax (760) 482-3301

La Quinta
81-600 Avenue 58, La Quinta, CA 92253
(760) 398-5841 Fax (760) 391-5944



Imperial Irrigation District
Protecting the flow of progress.

Not Applicable

IID-700D (6-07)

Motor Nameplate Data Sheet

Date: 1/31/2012

Attention: Not Applicable

Company: _____

Fax No.: _____

From: IID Energy Department

Subject: Nameplate Data for Electric Motors, 75 HP and above
Starter Data for Electric Motors 75 HP and above

In order to analyze the effect of large motors connected to the IID Energy Systems, please fill in the nameplate values for all motors, then fax reply to one of the offices listed below.

TYPICAL NAMEPLATE

Hp	_____	Ph	_____	Insul Class	_____	Hz	_____
Frame	_____			V230 A	_____		
				V460 A	_____		
Type	_____			Code	_____		
Encl.	_____			S.F.	_____		
RPM	_____			Design	_____	NEMA Nom Eff.	_____
				Max AB	_____		
ID #	_____			Temp.	_____		

(NOTE: Additional nameplate data should also be included)

In addition, please provide starter data from reduced voltage starters, ie., Wye-Delta starter, auto transformer starter, part winding starter, primary resistor starter, Solid State starter, etc. This data can be obtained from the manufacturer or the manufacturer starting procedure catalog, which is supplied with the starter.

If you have any questions please call Customer Service Operations at one of the offices listed below.

Thank you,
IID Energy Department

IID Energy Customer Service Operations

Imperial Valley
1699 W. Main Street, Suite A, El Centro, CA 92243
(760) 482-3300 Fax (760) 482-3301

La Quinta
81-600 Avenue 58, La Quinta, CA 92253
(760) 398-5841 Fax (760) 391-5944



Imperial Irrigation District
Protecting the flow of progress.

IID-817 (11-07)

CUSTOMER SERVICE OPERATIONS CAD FILE AND CONTRACTOR NOTES RECEIPT

DATE: 1/31/2012

In consideration for the receipt of IID CAD files and Contractor Notes (underground electrical installation) regarding the Airport Blvd. Grade Separation project, the developer, County of Riverside Transportation Department (and/or) the developer's designee Parsons Engineering, agree(s) as follows:

1. The CAD files and Contractor Notes shall not be provided to any other entity other than the developer or the developer's designee as stated above.
2. That portion of the CAD file that describes IID electrical facilities shall not be modified in any manner.
3. The developer or its designee shall not utilize the materials in such a way that misrepresents the actions of IID (e.g. using the CAD files to indicate IID engineering for another project, etc.)

[Signature]
Signature of Developer

Stan Dery

Print Name

1/31/2012 4/5/12
Date Signed

RECEIVED BY:

Contractor Notes: _____ E-File: _____

Signature: _____

Print Name: _____ County of Riverside

Date: _____

CSP Notification # _____

IID Energy Customer Service Operations

Imperial Valley
1699 W. Main Street, Suite A, El Centro, CA 92243
(760) 482-3300 Fax (760) 482-3301

La Quinta
81-600 Avenue 58, La Quinta, CA 92253
(760) 398-5841 Fax (760) 391-5944



COUNTY OF RIVERSIDE
TRANSPORTATION AND
LAND MANAGEMENT AGENCY
Transportation Department



Juan C. Perez, P.E., T.E.
Director of Transportation

February 7, 2012

Carlos Puente
Imperial Irrigation District
81600 58TH Avenue
La Quinta, CA 92253

RE: Airport Boulevard (AVE 56) Railroad Grade Separation
Project No. A6-0241

Dear Mr. Puente:

The County of Riverside Transportation Department plans to construct the referenced improvements in Airport Boulevard between Polk Street and Orange Street in Riverside County. The planned improvements are to widen to a four lane urban arterial roadway and provide a grade separation over Grapefruit Boulevard and UPRR tracks in the Community of Thermal in unincorporated Riverside County.

It is requested that your company review the revised plans for any conflicts and make funding and engineering preparations for any necessary relocations or adjustments to your facilities. If you would like to meet with the design engineer to discuss the project, please contact us at the phone numbers provided below.

The County sent out a letter on September 28, 2011 to the Dry Utilities regarding a reservation for a cell space opening to accommodate the current or future utility facilities on the project design drawings and/or as requested by the owning utility company. To date we have not received either a positive or negative to this request and at this point in time are again requesting the Utility Companies to confirm on formal Company letterhead their intent of a cell opening on our proposed bridge, **please advise us no later than March 23, 2012.**

Please note that it is the utility company's responsibility to furnish all materials needed and provide for any cost incurred for design and construction that pertains to your respective facilities. Each utility company will be responsible to fund and install casings for their facilities beneath the approach slab and within the bridge structure. Each utility may arrange for the design and construction work to be performed by the County's contractor or your own work forces, at the respective utility company's expense.

We strongly recommend that you carefully examine the plans, especially in the areas that require excavation. We also recommend that you pot-hole your facilities in those areas, and provide exact location information so that we may reduce or eliminate the need for utility relocations.

We request that you visit and review the project site and determine if any of your company's facilities may be present, or in conflict, which are not currently shown on the design plans.

Specific issues to which we also request your attention are:

1. Please initiate the design work required for the relocation of your facilities, which are in conflict with the County's improvements, and arrange for funding of those relocations.
2. Please be aware that your existing facilities, which may not be in direct conflict with the project improvements, may be affected by the County's contractor, during the construction of the planned improvements. For example, underground facilities that are in close proximity to the grading plane may be damaged during over-excavation and compaction operations. **Typically, subgrade is ripped and re-compacted approximately 10" to 12" below the stated structural section depth.**

Please review your existing facilities to determine if your underground, surface or aerial facilities will be in any way affected by the construction of the planned improvements. If so, then the relocation or protection of those facilities will be the responsibility of the utility owner, and we request you to initiate design of those facilities at this time.

3. Please inform us of what lead-time is required for the relocation of your facilities, and how long those relocations will take once started.
4. Please inform us if you will need a construction window for the relocation of your facilities, including working days and at what stage of the work. If a window is needed by your company, a meeting with the design engineer may be required to best coordinate your relocations with the improvements. Early communication by your company of a need for a construction window is critical as this matter must be included in our contract bid documents.
5. Please advise us if you find that additional right of way will be required for the relocation of any of your facilities. Early notification is needed so that acquisition procedures can be initiated so as to not impact the construction schedule.

6. If you intend to claim prior property rights with respect to any of the necessary relocations of your company's facilities, please provide documentation of those rights at your earliest convenience.
7. Please review your Capital Improvement Program to determine if any planned utility improvement projects are planned within the limits of the County's limits of work. If so, please determine if that work can be advanced in schedule, and request a meeting with the County to discuss timing and coordination of the projects.

We will be sending you final plans, and a notice to proceed with the relocation or removal of conflicting facilities, prior to advertisement for construction bids. We would appreciate your written response, including communication of any concerns or comments that you may have, **prior to March 23, 2012.**

We plan to advertise this street project on Airport Blvd Grade Separation over Grapefruit Blvd. and UPRR Tracks, in the Mecca area of Riverside County, for construction bids by the beginning of July 2012 and construction to start end of October 2012.

If you have any questions or need additional information, please call me at (951) 955-6856 or Stan Dery (951) 955-6785.

Sincerely,



For

Herminio L. Garcia
Senior Engineering Technician/Utilities Coordinator
Contracts and Utilities Unit

Office : 1(951) 955-6856
Cell : 1(951) 231-5534
Fax : 1(951) 955-3164
E-mail : hlgarcia@rctlma.org

Attachments

cc: Project Utility file
Project Manager: Scott Staley
John Ashlock
Joe Gonzalez