

**SUBMITTAL TO THE BOARD OF SUPERVISORS
COUNTY OF RIVERSIDE, STATE OF CALIFORNIA**

617A



FROM: TLMA - Transportation Dept.

SUBMITTAL DATE:
November 29, 2013

SUBJECT: Landscaping and Lighting Maintenance District No. 89-1-Consolidated, Annexation of Zone 185 (Rancho California) District 3/3 [\$636; L&LMD No. 89-1-C].

RECOMMENDED MOTION: That the Board of Supervisors:

With regard to the annexation of Zone 185 to Landscaping and Lighting Maintenance District No. 89-1-Consolidated, conduct the public hearing and, after closing the public hearing, direct the Director of Transportation, or his designee, who the Board of Supervisors finds to be an impartial person as that term is used in Section 53753(e) of the Government Code, to tally all ballots received prior to the close of the public hearing. All ballots received prior to the close of the public hearing will be tallied at 10:00 a.m. on Wednesday, December 11, 2013 in Conference Room C on the 8th Floor of the County Administrative Center, 4080 Lemon Street, Riverside, California. Staff is directed to cause the appropriate resolution, based on the election tally, to be prepared and returned to the Board of Supervisors for its consideration.

FORM APPROVED COUNTY COUNSEL
BY: Dale A. Gardner 11/4/13 DATE
DALE A. GARDNER
Departmental Concurrence

Juan C. Perez
Director of Transportation and
Land Management

FINANCIAL DATA	Current Fiscal Year:	Next Fiscal Year:	Total Cost:	Ongoing Cost:	POLICY/CONSENT (per Exec. Office)
COST	\$ 0	\$ 636	\$ N/A	\$ 636	Consent <input type="checkbox"/> Policy <input checked="" type="checkbox"/>
NET COUNTY COST	\$ 0	\$ 0	\$ 0	\$ 0	

SOURCE OF FUNDS L&LMD No. 89-1-C – 100%
There are no General Funds used in this project.

Budget Adjustment:	N/A
For Fiscal Year:	13/14

C.E.O. RECOMMENDATION:

APPROVE

BY: Tina Grande

County Executive Office Signature

MINUTES OF THE BOARD OF SUPERVISORS

- A-30
- 4/5 Vote
- Positions Added
- Change Order

2013 DEC -3 PM 1:01

Prev. Agn. Ref.: 10/22/13, 3-64 District: 3/3 Agenda Number:

9-7

SUBMITTAL TO THE BOARD OF SUPERVISORS, COUNTY OF RIVERSIDE, STATE OF CALIFORNIA

FORM 11: Landscaping and Lighting Maintenance District No. 89-1-Consolidated, Annexation of Zone 185 (Rancho California) District 3/3 [\$636; L&LMD No. 89-1-C].

DATE: November 29, 2013

PAGE: 2 of 2

BACKGROUND:

Summary

Pursuant to the Landscaping and Lighting Act of 1972 and Resolution 2013-241 adopted October 22, 2013, the Board of Supervisors noticed a public hearing for December 10, 2013, to receive testimony regarding the Annexation of Zone 185 to Landscaping and Lighting Maintenance District No. 89-1-Consolidated (L&LMD No. 89-1-C). Annexation of Zone 185 will fund the maintenance and servicing of fossil filters within public rights-of-way located northerly of Rancho California Road in the Rancho California area and includes one (1) commercial parcel.

On October 23, 2013, a notice of the public hearing and information sheet, a mail-in ballot, an impartial analysis, and a copy of Resolution No. 2013-241 was mailed to all property owners within Zone 185, proposed for annexation to L&LMD No. 89-1-C. Pursuant to the notice, all ballots must be returned prior to the conclusion of the public hearing.

Notice of the public hearing was also given by publication of a certified copy of Resolution No. 2013-241 in an appropriate newspaper at least ten (10) days prior to the public hearing date and by posting a certified copy of the Resolution No. 2013-241 on the official bulletin board customarily used by the Board of Supervisors for the posting of notices and in two (2) other public locations within the County.

Impact on Residents and Businesses

The property owners within the proposed boundaries of Zone 185 have petitioned the County of Riverside to annex their property to L&LMD No. 89-1-C and understand that this annexation will result in an assessment on their property to fund the maintenance and servicing of the aforementioned improvements (fossil filters).

SUPPLEMENTAL:

Additional Fiscal Information

The proposed budget for fiscal year 2014-15 for Zone 185 is \$636.00. This will result in an assessment for fiscal year 2014-15 within Zone 185 of \$636.00 per parcel. The annual assessment may be adjusted annually by the greater of 2% or the cumulative percentage increase in the Consumer Price Index for all Urban Consumers (CPI-U), if any, as it stands as of March of each year over the base index for March of 2014.

Contract History and Price Reasonableness

N/A

ATTACHMENTS:

A. Exhibit A

EXHIBIT "A"

DESCRIPTION OF BOUNDARIES

The boundaries of Zone 185 to be annexed into Landscaping and Lighting Maintenance District No. 89-1-Consolidated, of the County of Riverside, are coterminous with the boundaries of APN 943-230-001 as shown on Assessment Roll in the County of Riverside, State of California in Fiscal Year 2014-15.

1
2
3
4
5
6
7
8
9
10
11
12
13
14
15
16
17
18
19
20
21
22
23
24

ZONE 185

PORTION OF SECTION 26 & 27, T.7S., R.2W.

PLOT PLAN NO. 23017

1 PARCEL



The County of Riverside assumes no warranty or legal responsibility for the information contained on this map. Data and information represented on this map is subject to updates, modifications and may not be complete or appropriate for all purposes. County GIS and other sources should be queried for the most current information. Do not copy or resell this map.

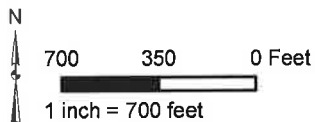

ASSESSMENT DIAGRAM

Printed by bhahn on 8/29/2013

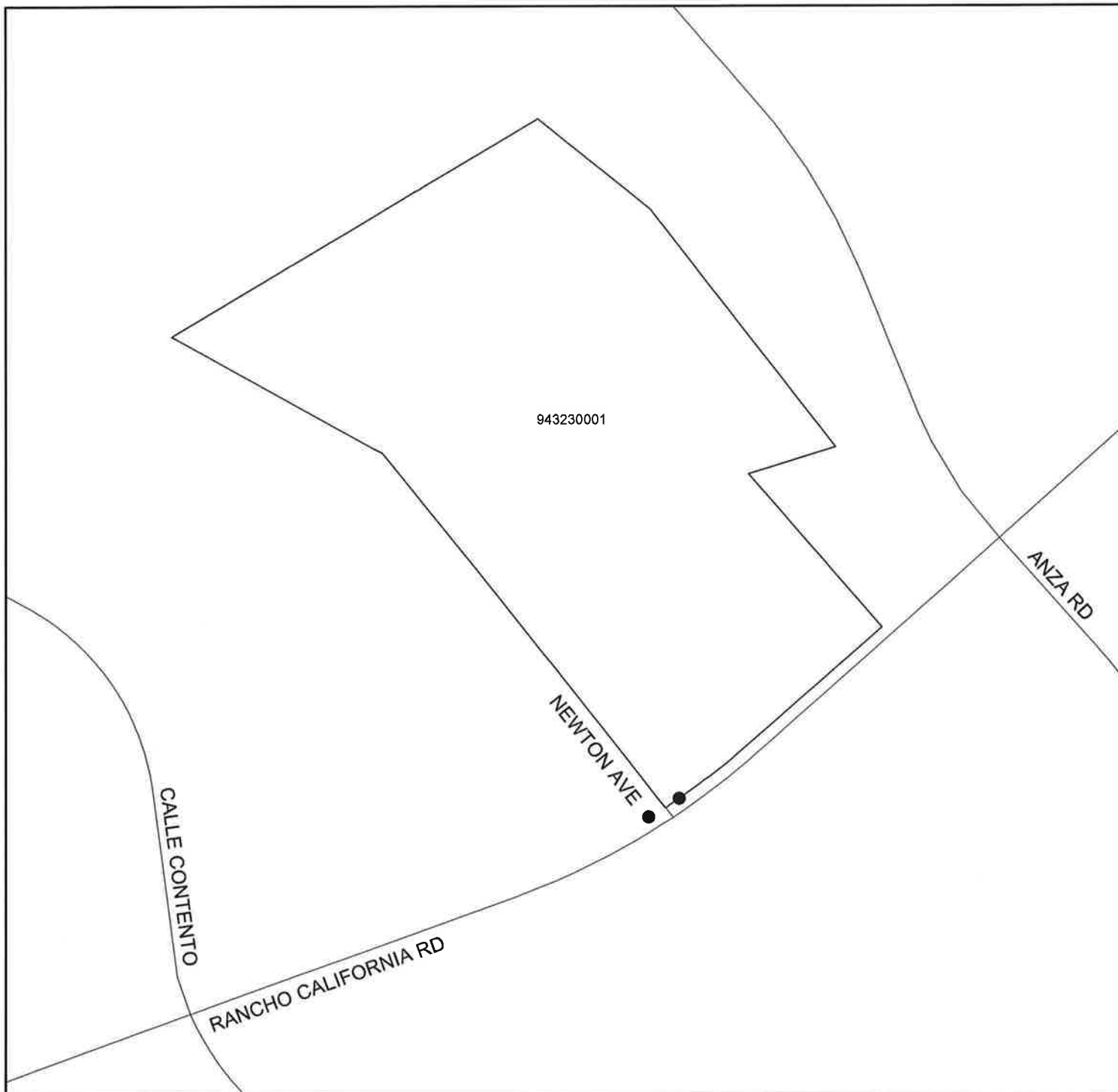

● DENOTES MAINTAINED FOSSIL FILTER