

**SUBMITTAL TO THE BOARD OF SUPERVISORS  
COUNTY OF RIVERSIDE, STATE OF CALIFORNIA**

907



**FROM:** Economic Development Agency/Facilities Management and Transportation Department

**SUBMITTAL DATE:**  
January 2, 2014

**SUBJECT:** Transportation Highway Operations Center Replacement Project – Approval of Schematics, District 1, [\$0]

**RECOMMENDED MOTION:** That the Board of Supervisors:

1. Approve the Schematic Design on file with the Economic Development Agency (EDA) for the Transportation Highway Operations Center Replacement Project; and
2. Authorize the architect to proceed to the design development and construction document phase of the project.

**BACKGROUND:**

Summary

(Commences on Page 2)

Departmental Concurrence

Juan C. Perez, Director  
Transportation and Land Management

  
Robert Field  
Assistant County Executive Officer/EDA

FINANCIAL DATA	Current Fiscal Year:	Next Fiscal Year:	Total Cost:	Ongoing Cost:	POLICY/CONSENT (per Exec. Office)
COST	\$ 0	\$ 0	\$ 0	\$ 0	Consent <input type="checkbox"/> Policy <input checked="" type="checkbox"/>
NET COUNTY COST	\$ 0	\$ 0	\$ 0	\$ 0	

<b>SOURCE OF FUNDS:</b> N/A	<b>Budget Adjustment:</b> No
	<b>For Fiscal Year:</b> 2013/14

**C.E.O. RECOMMENDATION:**

APPROVE

BY:   
Rohini Dasika

County Executive Office Signature

**MINUTES OF THE BOARD OF SUPERVISORS**

- A-30
- Positions Added
- 4/5 Vote
- Change Order

**Prev. Agn. Ref.:** 3-20 of 1/29/13; 3.73 of 6/05/12; 3.43 of 8/16/11

**District:** 1/1

**Agenda Number:**

**3-8**

**SUBMITTAL TO THE BOARD OF SUPERVISORS, COUNTY OF RIVERSIDE, STATE OF CALIFORNIA**

Economic Development Agency/Facilities Management and Transportation Department

**FORM 11:** Transportation Highway Operations Center Replacement Project – Approval of Schematics, District 1, [\$0], Transportation Department Road Funds

**DATE:** January 2, 2014

Page 2 of 2

**BACKGROUND:**

**Summary**

On August 16, 2011, the County of Riverside Board of Supervisors authorized the purchase of 19.38 acres of real property in the unincorporated area of Mead Valley for the eventual relocation of the Transportation Department's main Highway Operations Center. Through this operations center and 10 smaller satellite maintenance yards, the department maintains over 2200 miles of roadway and 350 signalized intersections throughout the unincorporated areas of the county.

The department's existing facility, located at Washington Street near the SR 91 freeway in the City of Riverside, was built in 1955 and is in need of a full functional upgrade. Due to the incorporations of various cities over the years, this existing facility is no longer central to the unincorporated areas of the county that the department serves. The proposed facility, located near the vicinity of the I-215 freeway and Cajalco Expressway, provides a more centralized location.

The Transportation Department has conducted an analysis of savings on fuel costs and lost productivity time comparing this location to the current Washington Street yard. The analysis projects a conservative operational savings in the amount of \$600,000 annually by relocating to this more centralized location. Savings would increase over time as gas costs continue to rise. Moving to this centralized location also allows the Department to consolidate some of the other yards over time into this facility and to achieve further on-going savings by terminating our lease for the facility downtown in Riverside on 14<sup>th</sup> Street and relocating staff to the new county-owned facility.

On June 5, 2012, the County of Riverside Board of Supervisors approved in principle the project to replace the Transportation Department's antiquated main Highway Operations Center.

On January 29, 2013, the Board of Supervisors approved the owner/architect agreement between the County of Riverside and Ruhnau Ruhnau Clarke of Riverside, California, and authorized the Chairman of the Board to execute the agreement on behalf of the county.

The architects have now completed the schematic design (Exhibit A) for the Transportation Highway Operations Center Replacement project. Cost estimates will be refined following the Board's approval to proceed into the design development and construction document phases in accordance with the Capital Improvement Program (Board Policy B-22). This project may be incrementally completed with phased construction so that portions are completed as funds become available.

**Additional Fiscal Information**

There are no costs associated with the approval of schematics, thus no net county costs will be incurred as a result of this Board action. No budget adjustment is necessary at this time.

Attachment:

Exhibit A – Schematics of the Transportation Highway Operations Center Replacement Project

# TRANSPORTATION HIGHWAY OPERATIONS CENTER

COUNTY OF RIVERSIDE, TRANSPORTATION DEPARTMENT



COUNTY OF RIVERSIDE ECONOMIC DEVELOPMENT AGENCY - EDA DATE

COUNTY OF RIVERSIDE TRANSPORTATION DEPARTMENT DATE

COUNTY OF RIVERSIDE

Schematic Design

**RUHNAURCHINA CLARKE**

ARCHITECTS, LANDSCAPE ARCHITECTS  
175 North University Avenue, Suite 100, Riverside, CA 92504

NOVEMBER 13, 2013

T-1.0

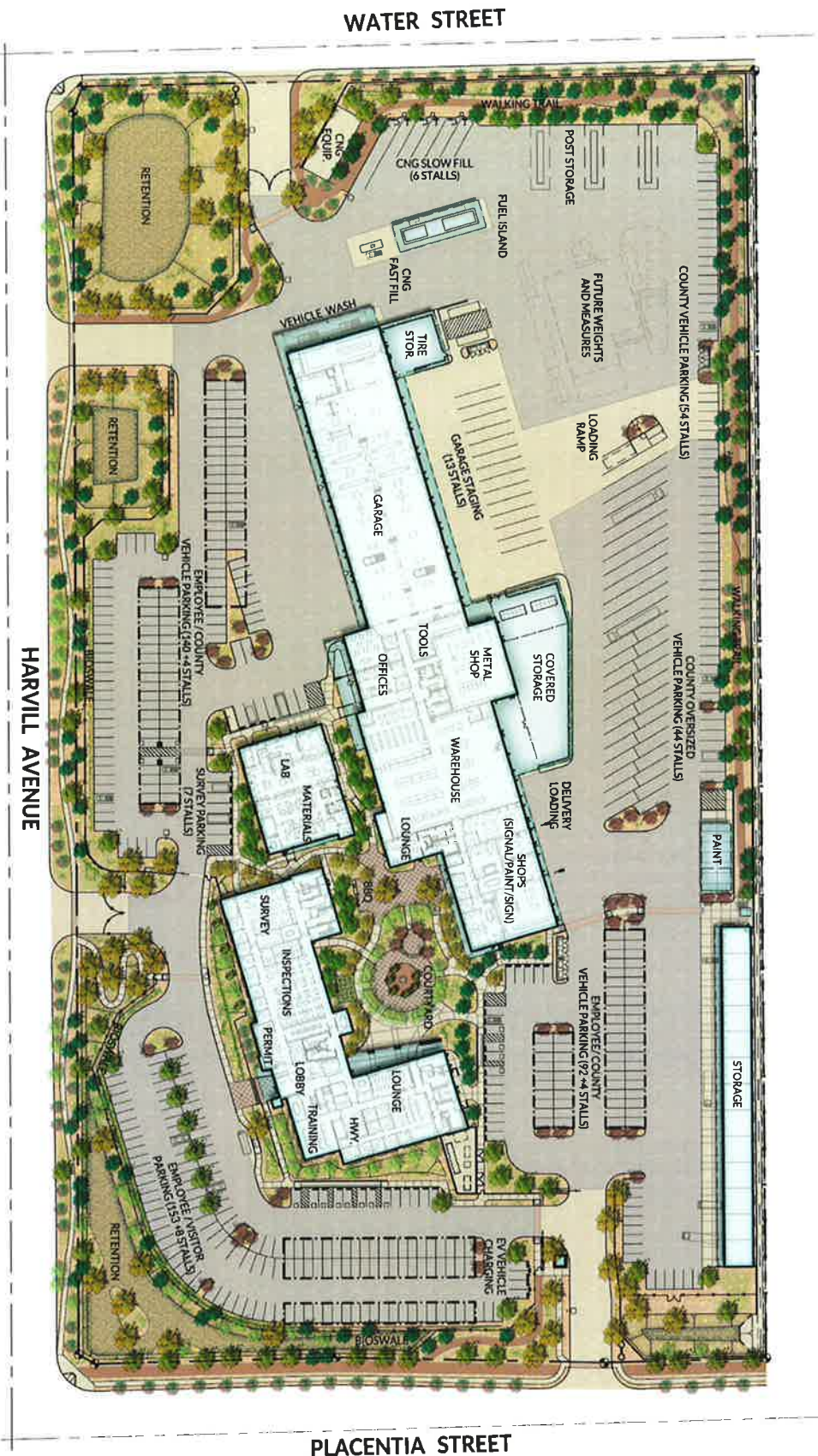

WATER STREET

PLACENTIA STREET

HARVILL AVENUE



TRANSPORTATION HIGHWAY OPERATIONS CENTER

RÜHNAU, RÜHNAU, CLARKE ARCHITECTS LLP

OVERALL SITE PLAN