

FORM APPROVED COUNTY COUNSEL
 BY: GREGORY P. PRIAMOS DATE: 10/2/14

**SUBMITTAL TO THE FLOOD CONTROL AND
 WATER CONSERVATION DISTRICT BOARD OF SUPERVISORS
 COUNTY OF RIVERSIDE, STATE OF CALIFORNIA**

9018



FROM: General Manager-Chief Engineer

SUBMITTAL DATE:
 October 28, 2014

SUBJECT: Approve for Advertising Romoland MDP Line A, Stages 4, 5 and 6, Homeland MDP Line 1 Briggs Basin, Romoland MDP Line A-2, and Romoland MDP Line A-3, Project No. 4-0-00310-04, 3rd and 5th District/3rd and 5th District [\$0]

RECOMMENDED MOTION: That the Board of Supervisors:
 Approve the attached plans and specifications for the above referenced project and authorize the Clerk of the Board to advertise the project for construction contract bids.

BACKGROUND:

Summary

The contract documents have been approved as to form by County Counsel. A brief project description and location map are attached.

Departmental Concurrence

Mark H. Williams

WARREN D. WILLIAMS
 General Manager-Chief Engineer

P8\164037

FINANCIAL DATA	Current Fiscal Year:	Next Fiscal Year:	Total Cost:	Ongoing Cost:	POLICY/CONSENT (per Exec. Office)
COST	\$ N/A	\$ N/A	\$ N/A	\$ N/A	Consent <input type="checkbox"/> Policy <input type="checkbox"/>
NET DISTRICT COST	\$ N/A	\$ N/A	\$ N/A	\$ N/A	

SOURCE OF FUNDS: N/A
Budget Adjustment: N/A
For Fiscal Year: N/A

C.E.O. RECOMMENDATION:

APPROVE

BY: *Steven C. Horn*
 Steven C. Horn

County Executive Office Signature

MINUTES OF THE BOARD OF SUPERVISORS

RJC

- A-30
- 4/5 Vote
- Positions Added
- Change Order

Prev. Agn. Ref.: | District: 3&5/3&5 | Agenda Number: **11-1**

NOTICE TO CONTRACTORS

Riverside County Flood Control and Water Conservation District hereinafter called "District", invites sealed proposals for construction of:

Romoland MDP Line A, Stages 4, 5 and 6,

Homeland MDP Line 1 Briggs Basin,

Romoland MDP Line A-2, and Romoland MDP Line A-3

Project No. 4-0-00310-04

located in the cities of Menifee, Perris and Riverside County, California

Specifications and Contract Documents may be examined at the District's office at 1995 Market Street, Riverside, California, and may be obtained upon payment to District of **\$60.00** per set, received at the District's office and **\$65.00** per set if mailed. The Specifications and Contract Documents are also offered on CD-ROM for \$10.00 received at the District's office and \$15.00 if mailed. No refund.

Each proposal must be accompanied by a certified or cashier's check or bid bond equal to ten percent (10%) of the amount bid, payable to the Riverside County Flood Control and Water Conservation District as a guarantee that the Contractor will, if awarded the contract, execute a satisfactory contract and furnish the required bonds and proof of insurance.

Proposals must be in accordance with the instructions and filed with District by **2:00 p.m. on Thursday, December 18, 2014** at the District office at the above address which time and place are fixed for the public opening of bids.

General prevailing rate per diem wages and general prevailing rate of per diem wages for holiday and overtime work, including employer payments for health and welfare, pension, vacation, apprentices and similar purposes for each craft, classification or type of workman needed for execution of contracts under the jurisdiction of District have been obtained by the Board of Supervisors of the District from the

Director of Industrial Relations of the State of California for the area where the work is to be done. The said determinations are on file in the principal office of the District, and will be made available to any interested person upon request.

Contractors submitting proposals for this project shall have an "A" Contractors license from the State of California in order to be considered eligible for the contract award.

Dated: October 28, 2014

RIVERSIDE COUNTY FLOOD CONTROL
AND WATER CONSERVATION DISTRICT

KECIA HARPER-IHEM
Clerk of the Board

BY _____
Deputy

ROMOLAND MDP LINE A, STAGES 4, 5 & 6 HOMELAND MDP LINE 1 BRIGGS BASIN ROMOLAND MDP LINE A-2 & LINE A-3

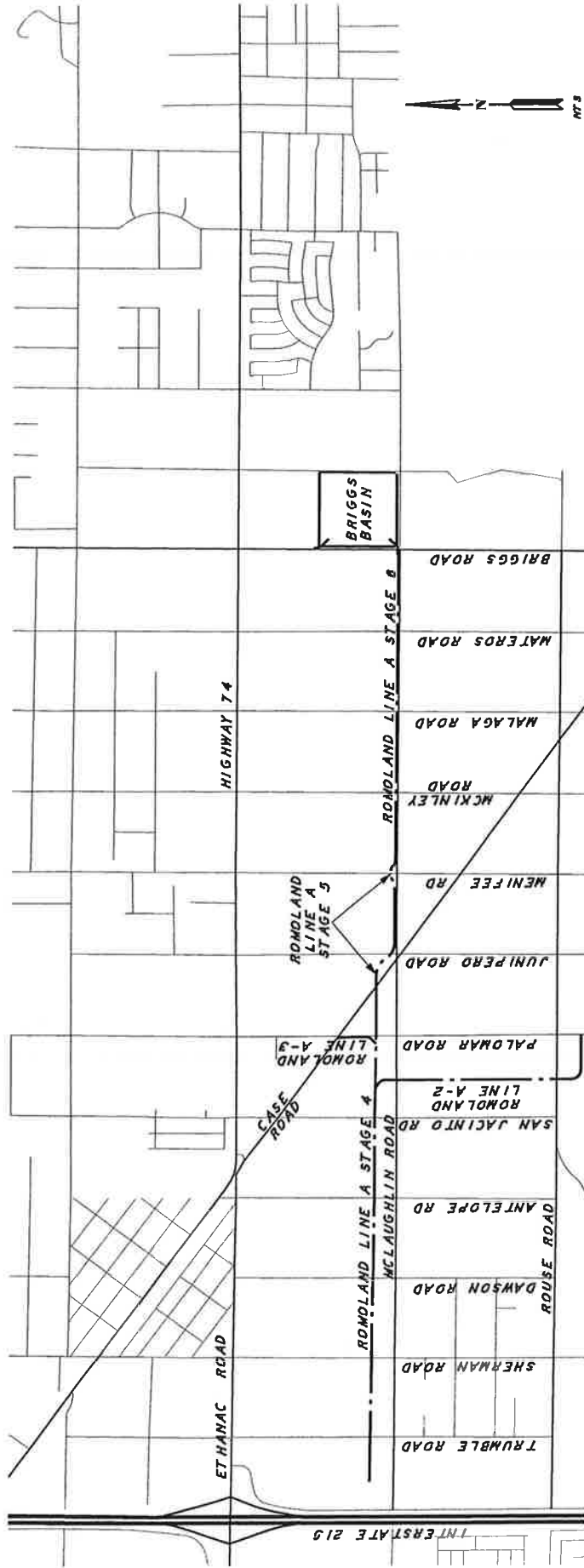

CITY OF MENIFEE

Romoland Line A Stage 4, Stage 5, Stage 6, Homeland MDP Line 1 Briggs Basin, Romoland MDP Line A-2 and Romoland MDP Line A-3 system involves the design, construction, operation and maintenance of approximately 21,000 lined-foot storm drain system consisting of open channels, reinforced concrete boxes, reinforced concrete pipes and one basin. The project begins at the upstream end of Romoland MDP Line A, Stage 3 project at Encanto Drive and I-215; traverses east along McLaughlin road and terminates at Briggs Basin located north east to the intersection of Briggs Road and McLaughlin Road. Romoland MDP Line A-2 traverses southerly 400 feet west of San Jacinto Road and terminates at its intersection with Rouse Road. Romoland MDP Line A-3 traverses northerly along Palomar Road and terminates at Case Road near the railroad tracks. The project lies within the cities of Perris, Menifee and unincorporated portions of the County.

NOTICE TO CONTRACTORS

Riverside County Flood Control and Water Conservation District hereinafter called "District", invites sealed proposals for construction of:

Romoland MDP Line A, Stages 4, 5 and 6,

Homeland MDP Line 1 Briggs Basin,

Romoland MDP Line A-2, and Romoland MDP Line A-3

Project No. 4-0-00310-04

located in the cities of Menifee, Perris and Riverside County, California

Specifications and Contract Documents may be examined at the District's office at 1995 Market Street, Riverside, California, and may be obtained upon payment to District of **\$60.00** per set, received at the District's office and **\$65.00** per set if mailed. The Specifications and Contract Documents are also offered on CD-ROM for \$10.00 received at the District's office and \$15.00 if mailed. No refund.

Each proposal must be accompanied by a certified or cashier's check or bid bond equal to ten percent (10%) of the amount bid, payable to the Riverside County Flood Control and Water Conservation District as a guarantee that the Contractor will, if awarded the contract, execute a satisfactory contract and furnish the required bonds and proof of insurance.

Proposals must be in accordance with the instructions and filed with District by **2:00 p.m. on Thursday, December 18, 2014** at the District office at the above address which time and place are fixed for the public opening of bids.

General prevailing rate per diem wages and general prevailing rate of per diem wages for holiday and overtime work, including employer payments for health and welfare, pension, vacation, apprentices and similar purposes for each craft, classification or type of workman needed for execution of contracts under the jurisdiction of District have been obtained by the Board of Supervisors of the District from the

Director of Industrial Relations of the State of California for the area where the work is to be done. The said determinations are on file in the principal office of the District, and will be made available to any interested person upon request.

Contractors submitting proposals for this project shall have an "A" Contractors license from the State of California in order to be considered eligible for the contract award.

Dated: October 28, 2014

RIVERSIDE COUNTY FLOOD CONTROL
AND WATER CONSERVATION DISTRICT

KECIA HARPER-IHEM
Clerk of the Board

BY _____
Deputy

ROMOLAND MDP LINE A, STAGES 4, 5 & 6 HOMELAND MDP LINE 1 BRIGGS BASIN ROMOLAND MDP LINE A-2 & LINE A-3

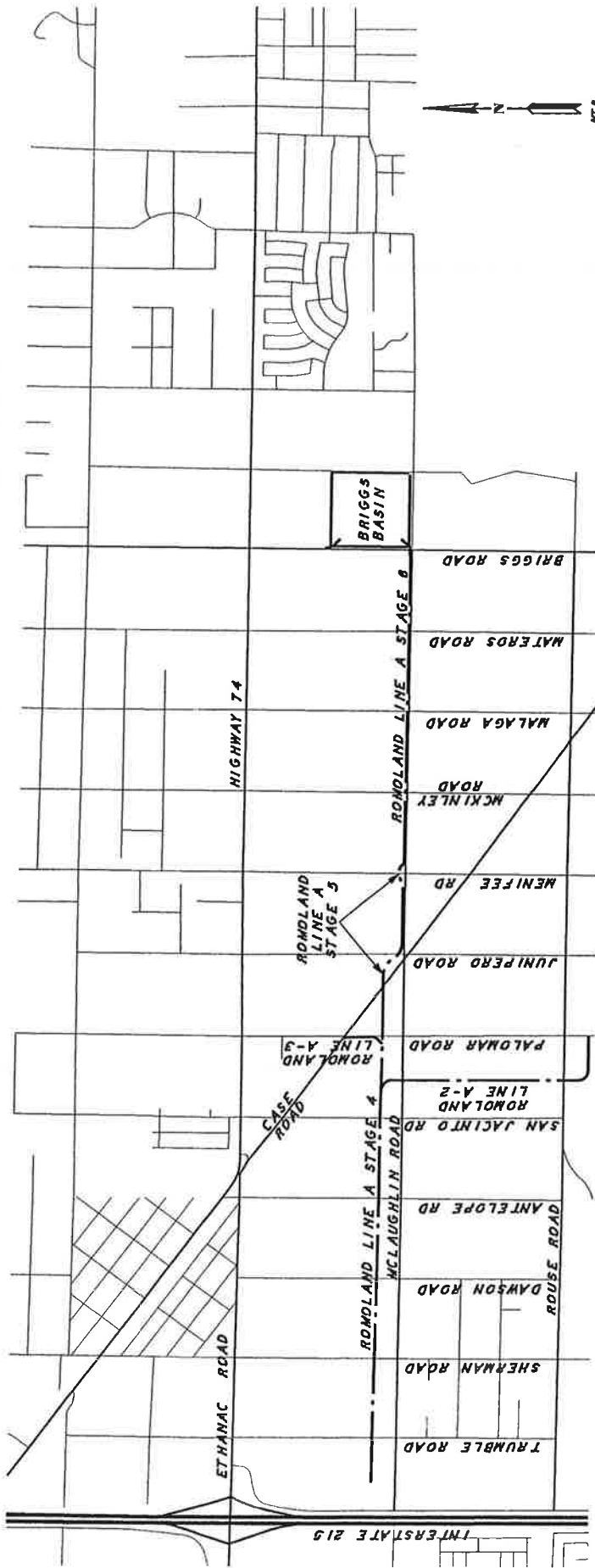

CITY OF MENIFEE

Romoland Line A Stage 4, Stage 5, Stage 6, Homeland MDP Line 1 Briggs Basin, Romoland MDP Line A-2 and Romoland MDP Line A-3 system involves the design, construction, operation and maintenance of approximately 21,000 lined-foot storm drain system consisting of open channels, reinforced concrete boxes, reinforced concrete pipes and one basin. The project begins at the upstream end of Romoland MDP Line A, Stage 3 project at Encanto Drive and I-215; traverses east along McLaughlin road and terminates at Briggs Basin located north east to the intersection of Briggs Road and McLaughlin Road. Romoland MDP Line A-2 traverses southerly 400 feet west of San Jacinto Road and terminates at its intersection with Rouse Road. Romoland MDP Line A-3 traverses northerly along Palomar Road and terminates at Case Road near the railroad tracks. The project lies within the cities of Perris, Menifee and unincorporated portions of the County.

NOTICE TO CONTRACTORS

Riverside County Flood Control and Water Conservation District hereinafter called "District", invites sealed proposals for construction of:

Romoland MDP Line A, Stages 4, 5 and 6,

Homeland MDP Line 1 Briggs Basin,

Romoland MDP Line A-2, and Romoland MDP Line A-3

Project No. 4-0-00310-04

located in the cities of Menifee, Perris and Riverside County, California

Specifications and Contract Documents may be examined at the District's office at 1995 Market Street, Riverside, California, and may be obtained upon payment to District of **\$60.00** per set, received at the District's office and **\$65.00** per set if mailed. The Specifications and Contract Documents are also offered on CD-ROM for \$10.00 received at the District's office and \$15.00 if mailed. No refund.

Each proposal must be accompanied by a certified or cashier's check or bid bond equal to ten percent (10%) of the amount bid, payable to the Riverside County Flood Control and Water Conservation District as a guarantee that the Contractor will, if awarded the contract, execute a satisfactory contract and furnish the required bonds and proof of insurance.

Proposals must be in accordance with the instructions and filed with District by **2:00 p.m. on Thursday, December 18, 2014** at the District office at the above address which time and place are fixed for the public opening of bids.

General prevailing rate per diem wages and general prevailing rate of per diem wages for holiday and overtime work, including employer payments for health and welfare, pension, vacation, apprentices and similar purposes for each craft, classification or type of workman needed for execution of contracts under the jurisdiction of District have been obtained by the Board of Supervisors of the District from the

Director of Industrial Relations of the State of California for the area where the work is to be done. The said determinations are on file in the principal office of the District, and will be made available to any interested person upon request.

Contractors submitting proposals for this project shall have an "A" Contractors license from the State of California in order to be considered eligible for the contract award.

Dated: October 28, 2014

RIVERSIDE COUNTY FLOOD CONTROL
AND WATER CONSERVATION DISTRICT

KECIA HARPER-IHEM
Clerk of the Board

BY _____
Deputy

ROMOLAND MDP LINE A, STAGES 4, 5 & 6 HOMELAND MDP LINE 1 BRIGGS BASIN ROMOLAND MDP LINE A-2 & LINE A-3

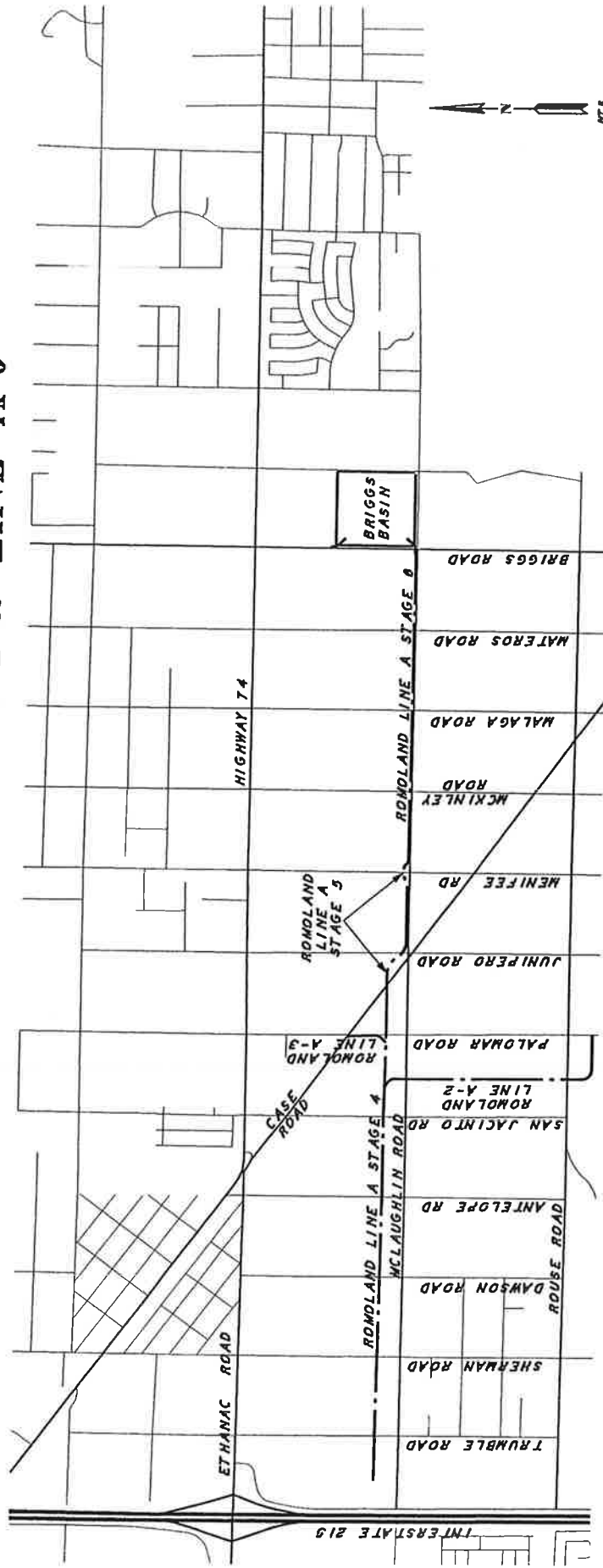

CITY OF MENIFEE

Romoland Line A Stage 4, Stage 5, Stage 6, Homeland MDP Line 1 Briggs Basin, Romoland MDP Line A-2 and Romoland MDP Line A-3 system involves the design, construction, operation and maintenance of approximately 21,000 lineal feet storm drain system consisting of open channels, reinforced concrete boxes, reinforced concrete pipes and one basin. The project begins at the upstream end of Romoland MDP Line A, Stage 3 project at Encanto Drive and I-215; traverses east along McLaughlin Road and terminates at Briggs Basin located north east to the intersection of Briggs Road and McLaughlin Road. Romoland MDP Line A-2 traverses southerly 400 feet west of San Jacinto Road and terminates at its intersection with Rouse Road. Romoland MDP Line A-3 traverses northerly along Palomar Road and terminates at Case Road near the railroad tracks. The project lies within the cities of Perris, Menifee and unincorporated portions of the County.