

**SUBMITTAL TO THE BOARD OF SUPERVISORS  
COUNTY OF RIVERSIDE, STATE OF CALIFORNIA**

502A



**FROM:** TLMA – Transportation Department

**SUBMITTAL DATE:**  
March 10, 2015

**SUBJECT:** Notice of Completion – Phase 1 of the Coachella Valley Mobile Home Park Paving Project Within the Communities of Mecca, Thermal, and Oasis. 4<sup>th</sup> District; [\$2,111,064]; Local Funds 100%

**RECOMMENDED MOTION:** That the Board of Supervisors execute and file the attached “Notice of Completion.”

**BACKGROUND:**

**Summary**

By Minute Order 3-84 of June 17, 2014, the Board of Supervisors entered into a contract with Golden Vista Construction dba Golden Valley Construction of Palm Springs, CA for the Mobile Home Park Paving Project Phase 1 within the communities of Mecca, Thermal, and Oasis.

Departmental Concurrence

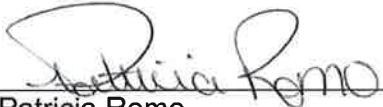
  
\_\_\_\_\_  
Patricia Romo  
Assistant Director of Transportation

  
\_\_\_\_\_  
Juan C. Perez  
Director of Transportation and Land Management

FINANCIAL DATA	Current Fiscal Year:	Next Fiscal Year:	Total Cost:	Ongoing Cost:	POLICY/CONSENT (Per Exec. Office)
<b>COST</b>	\$ 2,111,064	\$ 0	\$ 2,111,064	\$ 0	Consent <input type="checkbox"/> Policy <input checked="" type="checkbox"/>
<b>NET COUNTY COST</b>	\$ 0	\$ 0	\$ 0	\$ 0	

**SOURCE OF FUNDS:** SCAQMD AB1318 (Sentinel) Mitigation Fees Fund (100%). There were no General funds used in this project. **Budget Adjustment:** No  
**For Fiscal Year:** 14/15

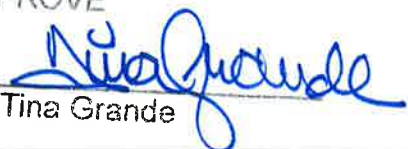
**C.E.O. RECOMMENDATION:** APPROVE  
BY:   
Tina Grande

County Executive Office Signature

**MINUTES OF THE BOARD OF SUPERVISORS**

- A-30
- Positions Added
- 4/5 Vote
- Change Order

**SUBMITTAL TO THE BOARD OF SUPERVISORS, COUNTY OF RIVERSIDE, STATE OF CALIFORNIA**  
**FORM 11: Notice of Completion – Phase 1 of the Coachella Valley Mobile Home Park Paving Project Within the Communities of Mecca, Thermal, and Oasis. 4<sup>th</sup> District; [\$2,111,064]; Local Funds 100%**

**DATE:** March 10, 2015  
**PAGE:** 2 of 2

**BACKGROUND:**

**Summary (continued)**

The originally authorized amount of the contract was \$2,270,825. The total amended contract is \$2,111,064, which is 7% less than the originally authorized amount.

The work was completed at the direction of the Transportation Department on October 2, 2014, Work Order Number C4-0053.

**Impact on Residents and Businesses**

The AB 1318 grant has enabled the County of Riverside to implement an emission reduction project that will have a direct benefit on the air quality and health of residents, while aiding in meeting regional air quality goals. Benefits of the project include improved air quality and improved ability for emergency vehicles, residents, and visitors to access mobile homes, especially during severe weather when communities can find themselves isolated.

**SUPPLEMENTAL:**

**Additional Fiscal Information**

**Budget**

Original Contract Amount		<b>\$2,270,825</b>
Total Change Orders Authorized	0.0%	<b>\$0</b>
Estimated Pending Change Orders	0.0%	<b>\$0</b>
Authorized Contract Amount		<b>\$2,270,825</b>
* Quantity Adjustments	-7.0%	<b>(\$159,761)</b>
+ CCO FA Adjustments	0.0%	<b>\$0</b>
Total Amended Contract Amount	93.0%	<b>\$2,111,064</b>

**Expenditures**

Total Progress Payments	<b>\$2,111,064</b>
Estimated Pending Payments	<b>\$0</b>
Total Expenditures	<b>\$2,111,064</b>

**(Over)/Under Contract Amount** **\$0**

+ Change Orders using the Force Account method of payment issued prior to the work being completed generally do not use the total authorized amount.

\* CAL-Trans Standard Specifications 4-1.03B. Increases or decreases in the quantity of a contract item of work will be determined by comparing the total pay quantity of such item of work with the Engineer's Estimate. If the total pay quantity of any item of work required under the contract varies from the Engineer's Estimate by 25 percent or less, payment will be made for the quantity of work of said item performed at the contract unit price, unless eligible for adjustment pursuant to Section 4-1.03C, "Changes in Character of Work."

This project was funded with \$2,111,064 of SCAQMD AB 1318 funds.

**Contract History and Price Reasonableness**

N/A

**COUNTY OF RIVERSIDE  
TRANSPORTATION DEPARTMENT**

**Coachella Valley Mobile Home Park Paving Project - Phase 1  
Communities of Mecca, Thermal and Oasis  
Project No. C4-0053  
SCAQMD Contract No. 13442**

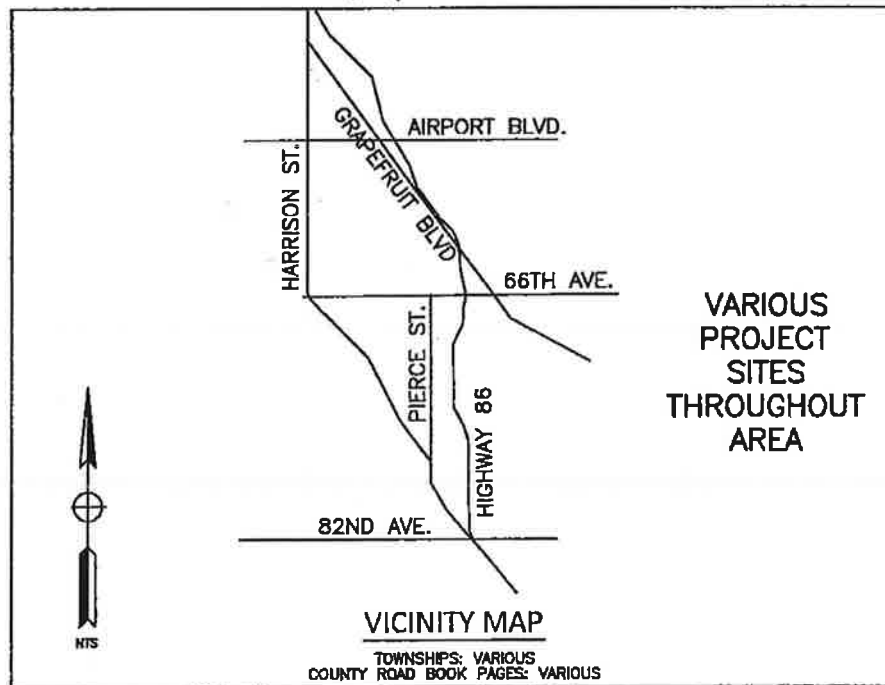
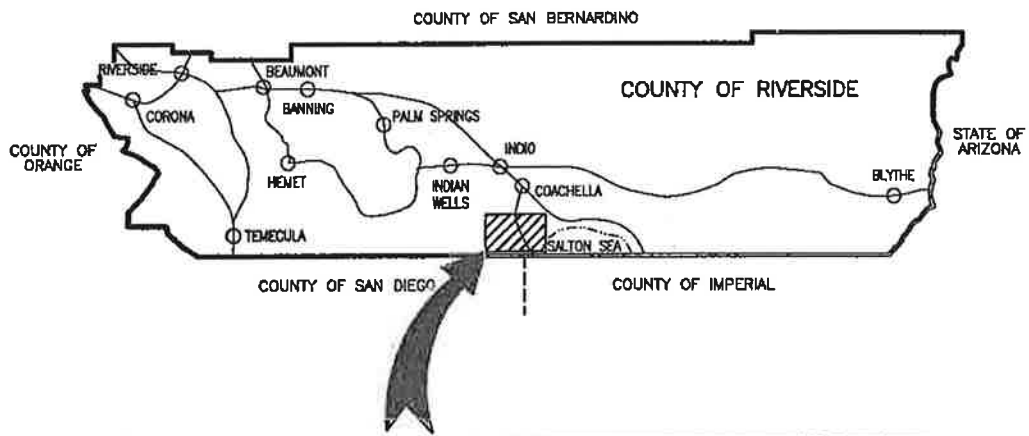

PROJECT: Coachella Valley Mobilia Home Park Paving Project Phase 1  
 County Project No.: C4-0053, SCAQMD 13442  
 Contract No. 14-05-007

Contractor: Golden Valley Construction  
 Address: 2000 Executive Drive  
 City, State, Zip: Palm Springs, CA 92262

Estimate No. 2 Final  
 From: August 26, 2014  
 To: October 25, 2014



Item No.	Item Description	Units	Quantity	Unit Price	Original Contract		Change Orders		Amended Contract		This Estimate		Previous		Total Estimate To Date		% Auth.
					Amount	Quantity	Amount	Quantity	Amount	Quantity	Amount	Quantity	Amount	Quantity	Amount	Quantity	
1	Base Bid - Location #: 7.11.12.15.17.18.19.20.21.27.29.30.31.14C.41A MOBILIZATION	LS	1	5,000.00	5,000.00				1.00	5,000.00	1.00	1.00	5,000.00	100%	1.00	5,000.00	100%
2	DEVELOP WATER SUPPLY	LS	1	2,500.00	2,500.00				1.00	2,500.00	1.00	1.00	2,500.00	100%	1.00	2,500.00	100%
3	DUST ABATEMENT	LS	1	2,000.00	2,000.00				1.00	2,000.00	1.00	1.00	2,000.00	100%	1.00	2,000.00	100%
4	WATER POLLUTION CONTROL	LS	1	1,500.00	1,500.00				1.00	1,500.00	1.00	1.00	1,500.00	100%	1.00	1,500.00	100%
5	TRAFFIC CONTROL SYSTEM	LS	1	1,000.00	1,000.00				1.00	1,000.00	1.00	1.00	1,000.00	100%	1.00	1,000.00	100%
6	CLEARING AND GRUBBING	LS	1	10,000.00	10,000.00				1.00	10,000.00	1.00	1.00	10,000.00	100%	1.00	10,000.00	100%
7	ROADWAY PREPARATION	CY	2,060	25.00	51,500.00				2,060.00	51,500.00	1,216.66	2,426.18	30,416.50	118%	2,426.18	60,654.50	118%
8	GRINDING ASPHALT CONCRETE IN PLACE	SQYD	19,030	0.65	12,369.50				19,030.00	12,369.50	14,067.22	22,743.33	9,143.69	120%	22,743.33	14,783.16	120%
9	HOT MIX ASPHALT	TON	5,720	85.00	486,200.00				5,720.00	486,200.00	4,854.21	6,120.43	412,607.85	107%	6,120.43	520,236.55	107%
10	ASPHALT CONCRETE DIKE [RIV CO STD 212 - 6 INCH]	LF	210	8.00	1,680.00				210.00	1,680.00	188.00	188.00	1,504.00	90%	188.00	1,504.00	90%
11	CLASS 2 AGGREGATE BASE	CY	7,390	35.00	258,650.00				7,390.00	258,650.00	4,960.93	7,086.91	173,632.55	96%	7,086.91	248,041.85	96%
12	SUBGRADE ENHANCEMENT FABRIC [GEOGRID 1-LAYER]	SQYD	3,550	4.50	15,975.00				3,550.00	15,975.00	101.39	4,437.50	456.26	125%	4,437.50	19,968.75	125%
13	RELOCATE ROADSIDE SIGN & REPLACE POST	EA	1	150.00	150.00				1.00	150.00	1.00	1.00	150.00	100%	1.00	150.00	100%
14	BARRIER POST (BOLLARD)	EA	3	600.00	1,800.00				3.00	1,800.00	3.00	3.00	1,800.00	100%	3.00	1,800.00	100%
15	4" WELDED STEEL EPOXY LINED AND COATED PIPE	LF	50	120.00	6,000.00				50.00	6,000.00	50.00	50.00	6,000.00	100%	50.00	6,000.00	100%
16	10" WELDED STEEL EPOXY LINED AND COATED PIPE	LF	50	250.00	12,500.00				50.00	12,500.00	50.00	50.00	12,500.00	100%	50.00	12,500.00	100%
17	18" WELDED STEEL EPOXY LINED AND COATED PIPE	LF	50	375.00	18,750.00				50.00	18,750.00	60.00	60.00	22,500.00	120%	60.00	22,500.00	120%
18	15" PLASTIC PIPE [HDPE]	LF	50	140.00	7,000.00				50.00	7,000.00	60.00	60.00	8,400.00	120%	60.00	8,400.00	120%
19	24" PLASTIC PIPE [HDPE]	LF	50	180.00	9,000.00				50.00	9,000.00	50.00	50.00	9,000.00	100%	50.00	9,000.00	100%
20	MISCELLANEOUS WORK (AS DIRECTED)	FA	394,382	1.00	394,382.00				394,382.00	394,382.00	130,888.80	130,888.80	130,888.80	33%	130,888.80	130,888.80	33%
21	MOBILIZATION	LS	1	5,000.00	5,000.00				1.00	5,000.00	1.00	1.00	5,000.00	100%	1.00	5,000.00	100%

Alternate Bid Schedule 1 - Location # 2,3,4,5,6,8,9,13,22

PROJECT: Coachella Valley Mobile Home Park Paving Project Phase 1  
 County Project No.: CA-0053, SCAQMD 13442  
 Contract No.: 14-05-007

Contractor: Golden Valley Construction  
 Address: 2000 Executive Drive  
 City, State, Zip: Palm Springs, CA 92262

Item No.	Item Description	Units	Quantity	Unit Price	Original Contract Amount	Change Orders Quantity	Change Orders Amount	Amended Contract Quantity	Amended Contract Amount	This Estimate Quantity	This Estimate Amount	Previous Quantity	Total Estimate To Date Quantity	Total Estimate To Date Amount	% Auth.
22	DEVELOP WATER SUPPLY	LS	1	1,500.00	1,500.00			1.00	1,500.00	1.00	1,500.00	1.00	1.00	1,500.00	100%
23	DUST ABATEMENT	LS	1	2,000.00	2,000.00			1.00	2,000.00	1.00	2,000.00	1.00	1.00	2,000.00	100%
24	WATER POLLUTION CONTROL	LS	1	1,000.00	1,000.00			1.00	1,000.00	1.00	1,000.00	1.00	1.00	1,000.00	100%
25	TRAFFIC CONTROL SYSTEM	LS	1	1,000.00	1,000.00			1.00	1,000.00	1.00	1,000.00	1.00	1.00	1,000.00	100%
26	CLEARING AND GRUBBING	LS	1	5,000.00	5,000.00			1.00	5,000.00	1.00	5,000.00	1.00	1.00	5,000.00	100%
27	ROADWAY PREPARATION	CY	1,780	25.00	44,500.00			1,780.00	44,500.00	164.29	4,107.25	2,013.36	2,177.65	54,441.25	122%
28	GRINDING ASPHALT CONCRETE IN PLACE	SOYD	18,180	0.65	11,817.00			18,180.00	11,817.00	5,322.78	3,459.81	14,036.67	19,359.45	12,583.64	106%
29	HOT MIX ASPHALT	TON	5,020	85.00	426,700.00			5,020.00	426,700.00	1,883.92	160,133.20	3,630.17	5,514.09	468,697.65	110%
30	ASPHALT CONCRETE DIKE [RIV CO STD 212 - 6 INCH]	LF	620	8.00	4,960.00			620.00	4,960.00	610.00	4,880.00	610.00	610.00	4,880.00	98%
31	CLASS 2 AGGREGATE BASE	CY	6,350	35.00	222,250.00			6,350.00	222,250.00	2,688.60	94,101.00	3,882.83	6,571.43	230,000.05	103%
32	MINOR CONCRETE (GUTTER DEPRESSION) [V-DITCH]	CY	5	150.00	750.00			5.00	750.00	5.00	750.00	5.00	5.00	750.00	100%
33	ROADSIDE SIGN - ONE POST ["ONE WAY" SIGNS]	EA	6	250.00	1,500.00			6.00	1,500.00	6.00	1,500.00	6.00	6.00	1,500.00	100%
34	RELOCATE ROADSIDE SIGN & REPLACE POST	EA	1	150.00	150.00			1.00	150.00	1.00	150.00	1.00	1.00	150.00	100%
35	BARRIER POST (BOLLARD)	EA	3	600.00	1,800.00			3.00	1,800.00	3.00	1,800.00	3.00	3.00	1,800.00	100%
36	4" WELDED STEEL EPOXY LINED AND COATED PIPE	LF	260	120.00	31,200.00			260.00	31,200.00	300.00	36,000.00	300.00	300.00	36,000.00	115%
Alternate Bid Schedule 2 - Location #: 10															
37	MOBILIZATION	LS	1	1,000.00	1,000.00			1.00	1,000.00			1.00	1.00	1,000.00	100%
38	DEVELOP WATER SUPPLY	LS	1	500.00	500.00			1.00	500.00			1.00	1.00	500.00	100%
39	DUST ABATEMENT	LS	1	500.00	500.00			1.00	500.00			1.00	1.00	500.00	100%
40	WATER POLLUTION CONTROL	LS	1	1,000.00	1,000.00			1.00	1,000.00			1.00	1.00	1,000.00	100%
41	TRAFFIC CONTROL SYSTEM	LS	1	500.00	500.00			1.00	500.00			1.00	1.00	500.00	100%
42	CLEARING AND GRUBBING	LS	1	2,000.00	2,000.00			1.00	2,000.00			1.00	1.00	2,000.00	100%
43	ROADWAY PREPARATION	CY	150	25.00	3,750.00			150.00	3,750.00			187.50	187.50	4,687.50	125%



Item No.	Item Description	Units	Quantity	Unit Price	Original Contract Amount	Change Orders Quantity	Change Orders Amount	Amended Contract Quantity	Amended Contract Amount	This Estimate Quantity	This Estimate Amount	Previous Quantity	Total Estimate To Date Quantity	Total Estimate To Date Amount	% Aft.
44	GRINDING ASPHALT CONCRETE IN PLACE	SQYD	1,910	0.65	1,241.50			1,910.00	1,241.50	1,910.00	1,241.50	1,877.78	1,877.78	1,220.56	98%
45	HOT MIX ASPHALT	TON	410	85.00	34,850.00			410.00	34,850.00	410.00	34,850.00	419.04	419.04	35,618.40	102%
46	ASPHALT CONCRETE DIKE [RIV CO STD 212 - 6 INCH]	LF	220	8.00	1,760.00			220.00	1,760.00	198.00	1,584.00	198.00	198.00	1,584.00	90%
47	CLASS 2 AGGREGATE BASE Alternate Bid Schedule 3 - Location # 16	CY	500	35.00	17,500.00			500.00	17,500.00	482.43	16,885.05	482.43	482.43	16,885.05	96%
48	MOBILIZATION	LS	1	500.00	500.00			1.00	500.00	1.00	500.00		1.00	500.00	100%
49	DEVELOP WATER SUPPLY	LS	1	500.00	500.00			1.00	500.00	1.00	500.00		1.00	500.00	100%
50	DUST ABATEMENT	LS	1	500.00	500.00			1.00	500.00	1.00	500.00		1.00	500.00	100%
51	WATER POLLUTION CONTROL	LS	1	500.00	500.00			1.00	500.00	1.00	500.00		1.00	500.00	100%
52	TRAFFIC CONTROL SYSTEM	LS	1	200.00	200.00			1.00	200.00	1.00	200.00		1.00	200.00	100%
53	CLEARING AND GRUBBING	LS	1	1,000.00	1,000.00			1.00	1,000.00	1.00	1,000.00		1.00	1,000.00	100%
54	ROADWAY PREPARATION	CY	60	25.00	1,500.00			60.00	1,500.00	54.00	1,350.00		54.00	1,350.00	90%
55	HOT MIX ASPHALT	TON	160	85.00	13,600.00			160.00	13,600.00	147.45	12,533.25		147.45	12,533.25	92%
56	CLASS 2 AGGREGATE BASE Alternate Bid Schedule 4 - Location # 14	CY	260	35.00	9,100.00			260.00	9,100.00	243.73	8,530.55		243.73	8,530.55	94%
57	MOBILIZATION	LS	1	500.00	500.00			1.00	500.00	1.00	500.00		1.00	500.00	100%
58	DEVELOP WATER SUPPLY	LS	1	500.00	500.00			1.00	500.00	1.00	500.00		1.00	500.00	100%
59	DUST ABATEMENT	LS	1	500.00	500.00			1.00	500.00	1.00	500.00		1.00	500.00	100%
60	WATER POLLUTION CONTROL	LS	1	200.00	200.00			1.00	200.00	1.00	200.00		1.00	200.00	100%
61	TRAFFIC CONTROL SYSTEM	LS	1	200.00	200.00			1.00	200.00	1.00	200.00		1.00	200.00	100%
62	CLEARING AND GRUBBING	LS	1	1,000.00	1,000.00			1.00	1,000.00	1.00	1,000.00		1.00	1,000.00	100%
63	ROADWAY PREPARATION	CY	170	25.00	4,250.00			170.00	4,250.00	159.26	3,981.50		159.26	3,981.50	94%
64	GRINDING ASPHALT CONCRETE IN PLACE	SQYD	3,030	0.65	1,969.50			3,030.00	1,969.50	1,794.44	1,166.39		1,794.44	1,166.39	59%

PROJECT: Coachella Valley Mobile Home Park Paving Project Phase 1  
 County Project No.: C4-0053, SCAQMD 13442  
 Contract No. 14-05-007

Contractor: Golden Valley Construction  
 Address: 2000 Executive Drive  
 City, State, Zip: Palm Springs, CA 92262

Estimate No. 2 Final  
 From: August 26, 2014  
 To: October 25, 2014



Item No.	Item Description	Units	Quantity	Unit Price	Original Contract		Change Orders		Amended Contract		This Estimate		Previous		Total Estimate To Date		% Auth.	
					Amount	Quantity	Amount	Quantity	Amount	Quantity	Amount	Quantity	Amount	Quantity	Amount	Quantity		Amount
65	HOT MIX ASPHALT	TON	440	85.00	37,400.00	440.00	37,400.00	388.60	33,031.00	388.60	33,031.00	388.60	33,031.00	388.60	33,031.00	388.60	88%	
66	CLASS 2 AGGREGATE BASE	CY	700	35.00	24,500.00	700.00	24,500.00	698.76	24,456.60	698.76	24,456.60	698.76	24,456.60	698.76	24,456.60	698.76	100%	
	<u>Alternate Bid Schedule 9 - Location # 36:</u>																	
104	MOBILIZATION	LS	1	500.00	500.00	1.00	500.00	1.00	500.00	1.00	500.00	1.00	500.00	1.00	500.00	1.00	100%	
105	DEVELOP WATER SUPPLY	LS	1	500.00	500.00	1.00	500.00	1.00	500.00	1.00	500.00	1.00	500.00	1.00	500.00	1.00	100%	
106	DUST ABATEMENT	LS	1	200.00	200.00	1.00	200.00	1.00	200.00	1.00	200.00	1.00	200.00	1.00	200.00	1.00	100%	
107	WATER POLLUTION CONTROL	LS	1	200.00	200.00	1.00	200.00	1.00	200.00	1.00	200.00	1.00	200.00	1.00	200.00	1.00	100%	
108	TRAFFIC CONTROL SYSTEM	LS	1	200.00	200.00	1.00	200.00	1.00	200.00	1.00	200.00	1.00	200.00	1.00	200.00	1.00	100%	
109	CLEARING AND GRUBBING	LS	1	1,000.00	1,000.00	1.00	1,000.00	1.00	1,000.00	1.00	1,000.00	1.00	1,000.00	1.00	1,000.00	1.00	100%	
110	ROADWAY PREPARATION	CY	80	25.00	2,000.00	80.00	2,000.00	70.37	1,759.25	70.37	1,759.25	70.37	1,759.25	70.37	1,759.25	70.37	88%	
111	HOT MIX ASPHALT	TON	220	85.00	18,700.00	220.00	18,700.00	207.61	17,646.85	207.61	17,646.85	207.61	17,646.85	207.61	17,646.85	207.61	94%	
112	ASPHALT CONCRETE DIKE [RIV CO STD 212 - 6 INCH]	LF	40	8.00	320.00	40.00	320.00	40.00	320.00	40.00	320.00	40.00	320.00	40.00	320.00	40.00	100%	
113	CLASS 2 AGGREGATE BASE	CY	340	35.00	11,900.00	340.00	11,900.00	370.37	12,962.95	370.37	12,962.95	370.37	12,962.95	370.37	12,962.95	370.37	109%	
114	4" WELDED STEEL EPOXY LINED AND COATED PIPE	LF	110	120.00	13,200.00	110.00	13,200.00	120.00	14,400.00	120.00	14,400.00	120.00	14,400.00	120.00	14,400.00	120.00	109%	

PROJECT: Coachella Valley Mobile Home Park Paving Project Phase 1  
 Contractor: Golden Valley Construction  
 Address: 2000 Executive Drive  
 City, State, Zip: Palm Springs, CA 92262

Estimate No. 2 Final  
 From: August 26, 2014  
 To: October 25, 2014

Item No.	Item Description	Units	Quantity	Unit Price	Original Contract Amount	Change Orders Quantity	Change Orders Amount	Amended Contract Quantity	Amended Contract Amount	This Estimate Quantity	This Estimate Amount	Previous Quantity	Previous Amount	Total Estimate To Date Quantity	Total Estimate To Date Amount	% Auth.
					2,270,824.50		0.00		2,270,824.50		1,268,303.25				2,111,064.05	
<b>PROJECT TOTAL</b>																

Made by: Jesse Mendoza  
 Checked by: [Signature] 11/2/14  
 OK Const. Supv. [Signature] 11/2/14

Working Days: 100  
 Days Added: 0  
 Subtotal: 100  
 Days Used: 48  
 % Time Elapsed: 48%

Start Date: 7-28-14  
 End Date: 10-2-14  
 % \$ Complete: 93%

Original Contract: \$2,270,824.50  
 Amended Contract: \$2,270,824.50

TOTAL VALUE OF WORK TO DATE: \$2,111,064.05  
 LESS RETENTION: 5% 105,553.18  
 TOTAL DUE TO DATE: \$2,005,510.87  
 LESS PREVIOUSLY INVOICED: 800,822.78  
 LESS LABOR NON COMPLIANCE: 0.00  
 TOTAL DUE THIS PAYMENT: \$1,204,688.09

This Estimate Approved [Signature] Date: 11/2/14 for: Patricia Romo, Assistant Director of Transportation

Received by Accounts Payable: \_\_\_\_\_  
 By: \_\_\_\_\_

Quantities on This Estimate Approved [Signature] Date: 11.7.14  
Mike Hertz  
 Golden Valley Construction

**PAYMENT APPROVAL**

Fund 20000  
 Dept ID 31305  
 Account 527980  
 Project EC4-0053E  
 Activity ID 33500  
 Resource Type CAI  
 Signature [Signature]  
 Date 11/13/14

794  
11.19.14



PLEASE COMPLETE THIS INFORMATION  
RECORDING REQUESTED BY:

**KECIA HARPER-IHEM, CLERK OF THE BOARD  
RIVERSIDE CO. CLERK OF THE BOARD  
4080 LEMON STREET, 1<sup>ST</sup> FLOOR CAC  
P O BOX 1147 – RIVERSIDE, CA 92502**

**MAIL STOP # 1010**

AND WHEN RECORDED MAIL TO:

**RETURN TO: STOP #1010**  
RIVERSIDE COUNTY CLERK OF THE BOARD  
P. O. BOX 1147 – RIVERSIDE, CA 92502

**THIS SPACE FOR RECORDERS USE ONLY**

**NOTICE OF COMPLETION**

To be recorded with County Recorder  
within 10 days after completion.  
No recording fee.

**Notice is hereby given by the undersigned owner, a public entity of the State of California, that a public work of improvement has been completed, as follows:**

**Project title or description of work:** Coachella Valley Mobile Home Paving Project Phase 1

**Date of Completion:** Date of this notice

**Nature of owner:** County of Riverside, public entity

**Interest or estate of owner:** Public Roadway

**Address of owner:** 4080 Lemon Street, 8th Floor, Riverside, CA 92501

**Name of contractor:** Golden Vista Construction dba Golden Valley Construction

**Street or legal description of site:** Various Locations in the Communities of Mecca, Thermal and Oasis

Dated: \_\_\_\_\_

Owner: County of Riverside  
(Name of Public Entity)

By: \_\_\_\_\_  
Chairman, Board of Supervisors

STATE OF CALIFORNIA )

ss

COUNTY OF RIVERSIDE )

I am the Chairman of the governing board of the County of Riverside, the public entity which executed the foregoing notice and on whose behalf I make this verification; I have read this notice, know its contents, and the same is true. I certify under penalty of perjury that the foregoing is true and correct.

Executed at Riverside, California on \_\_\_\_\_ (Date)

\_\_\_\_\_, Chairman of the Board of Supervisors