

FORM APPROVED COUNTY COUNSEL
 BY: GREGORY P. PRIAMOS DATE 9/29/15

Departmental Concurrence

**SUBMITTAL TO THE BOARD OF SUPERVISORS
 COUNTY OF RIVERSIDE, STATE OF CALIFORNIA**

407A



FROM: TLMA – Transportation Department

SUBMITTAL DATE:
 September 10, 2015

SUBJECT: Adopt Ordinance No. 452.239 to Establish Speed Zones Enforceable by Radar Speed Detection Equipment – Hemet, Mead Valley, North Shore, Perris, Riverside, Temecula, and Thermal Areas. 1st, 3rd, and 4th Districts; [\$6,000]; Gas Tax 100%

RECOMMENDED MOTION: That the Board of Supervisors adopt Ordinance No. 452.239, amending Ordinance No. 452 relating to prima facie speed limits to establish various speed zones in the above-referenced areas of Riverside County.

BACKGROUND:

Summary

Transportation Department staff has conducted Engineering and Traffic Surveys (E&TS) in accordance with the California Vehicle Code (CVC), Sections 627 and 40802, for various county-maintained roads in the Hemet, Mead Valley, North Shore, Perris, Riverside, Temecula and Thermal areas of Riverside County.

 Patricia Romo

Assistant Director of Transportation

 Juan C. Perez

Director of Transportation and Land Management

LTT:DA:sa

FINANCIAL DATA	Current Fiscal Year:	Next Fiscal Year:	Total Cost:	Ongoing Cost:	POLICY/CONSENT (Per Exec. Office)
COST	\$ 6,000	\$ 0	\$ 6,000	\$ 0	Consent <input type="checkbox"/> Policy <input checked="" type="checkbox"/>
NET COUNTY COST	\$ 0	\$ 0	\$ 0	\$ 0	

SOURCE OF FUNDS: Gas Tax (100%). There are no General Funds used in this project. **Budget Adjustment:** No
For Fiscal Year: 2015/2016

C.E.O. RECOMMENDATION:

APPROVE
 BY: 
 Rohini Dasika

County Executive Office Signature

MINUTES OF THE BOARD OF SUPERVISORS

- A-30
- 4/5 Vote
- Positions Added
- Change Order

Prev. Agn. Ref.:

District: 1,3,4

Agenda Number:

3-14

SUBMITTAL TO THE BOARD OF SUPERVISORS, COUNTY OF RIVERSIDE, STATE OF CALIFORNIA
FORM 11: Adopt Ordinance No. 452.239 to Establish Speed Zones Enforceable by Radar Speed Detection Equipment – Hemet, Mead Valley, North Shore, Perris, Riverside, Temecula, and Thermal Areas. 1st, 3rd, and 4th Districts; [\$6,000]; Gas Tax 100%
DATE: September 10, 2015
PAGE: 2 of 2

BACKGROUND:

Summary (continued)

Based upon the results of the E&TS for these roads, the radar-enforceable speed limits recommended by the Transportation Department are summarized in the attached tables and have been determined to be appropriate to facilitate the safe and orderly movement of vehicular traffic.

Transportation Department staff has contacted the Indio, Riverside, Temecula, and San Geronio area offices of the California Highway Patrol (CHP) regarding the recommended speed zones.

The Ordinance amendment has been reviewed and approved by County Counsel as to form.

Impact on Residents and Businesses

The establishing and posting of appropriate speed limits promote safe and orderly movements of vehicular traffic and enable the CHP to use radar equipment to enforce the speed limits. Since the recommended speed limits were determined based on actual speed surveys, the majority of the motorists are already driving at or below the recommended speed limits. Posted speed limits also guide motorists to drive at a reasonable speed in unfamiliar locations.

SUPPLEMENTAL:

Additional Fiscal Information

The cost for establishing the recommended speed limits is primarily for the installation of speed limit signs, which is estimated at about \$6,000.

Contract History and Price Reasonableness

N/A

ATTACHMENTS

- Vicinity Maps
- Memorandum to County Counsel
- Ordinance No. 452.239
- List of Speed Zone Submittals
- Engineering and Traffic Survey Sheets

ORDINANCE 452 DISTRICT 1 SPEED ZONE VICINITY MAP

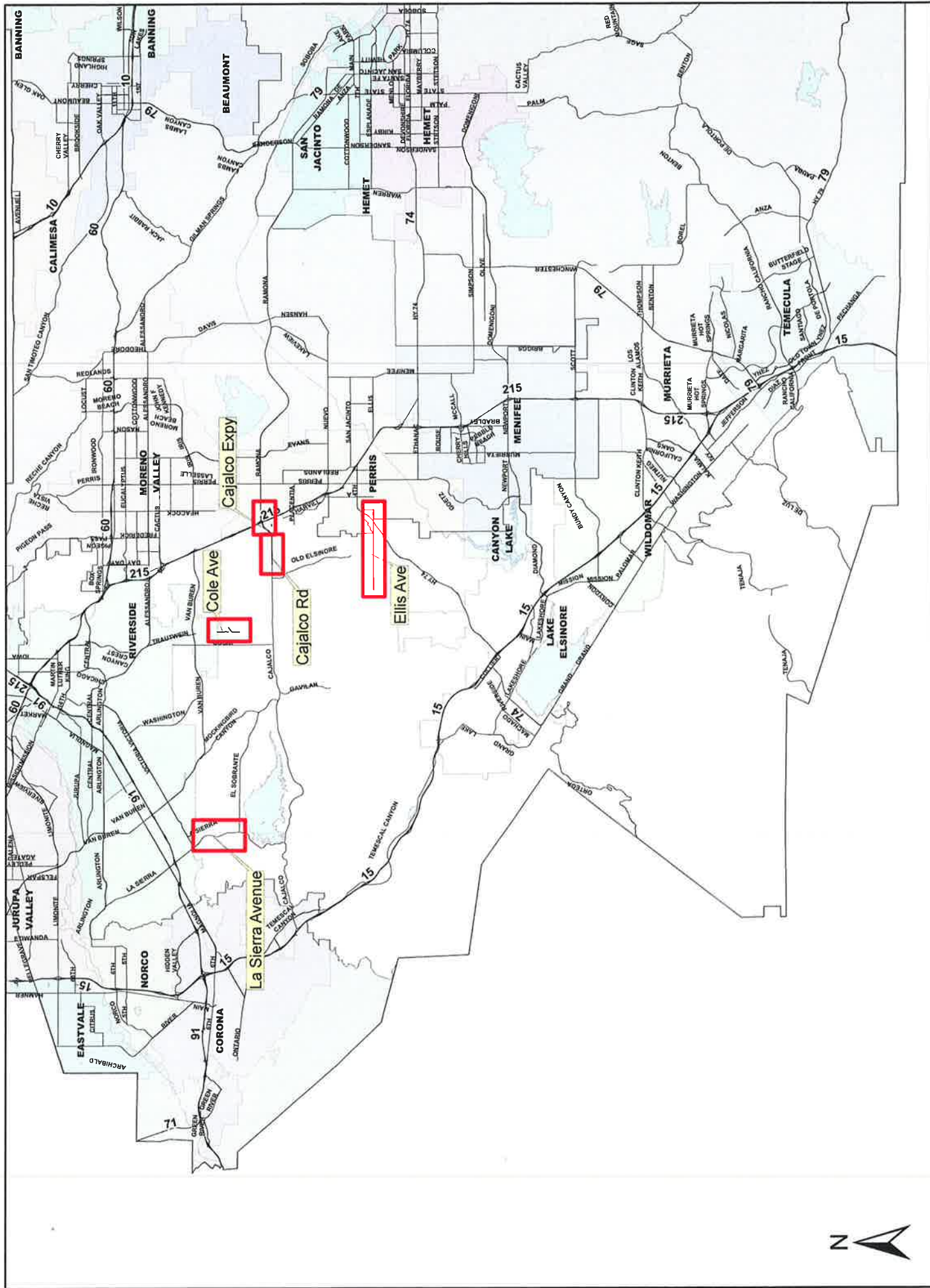

ORDINANCE 452 DISTRICT 3 SPEED ZONE VICINITY MAP

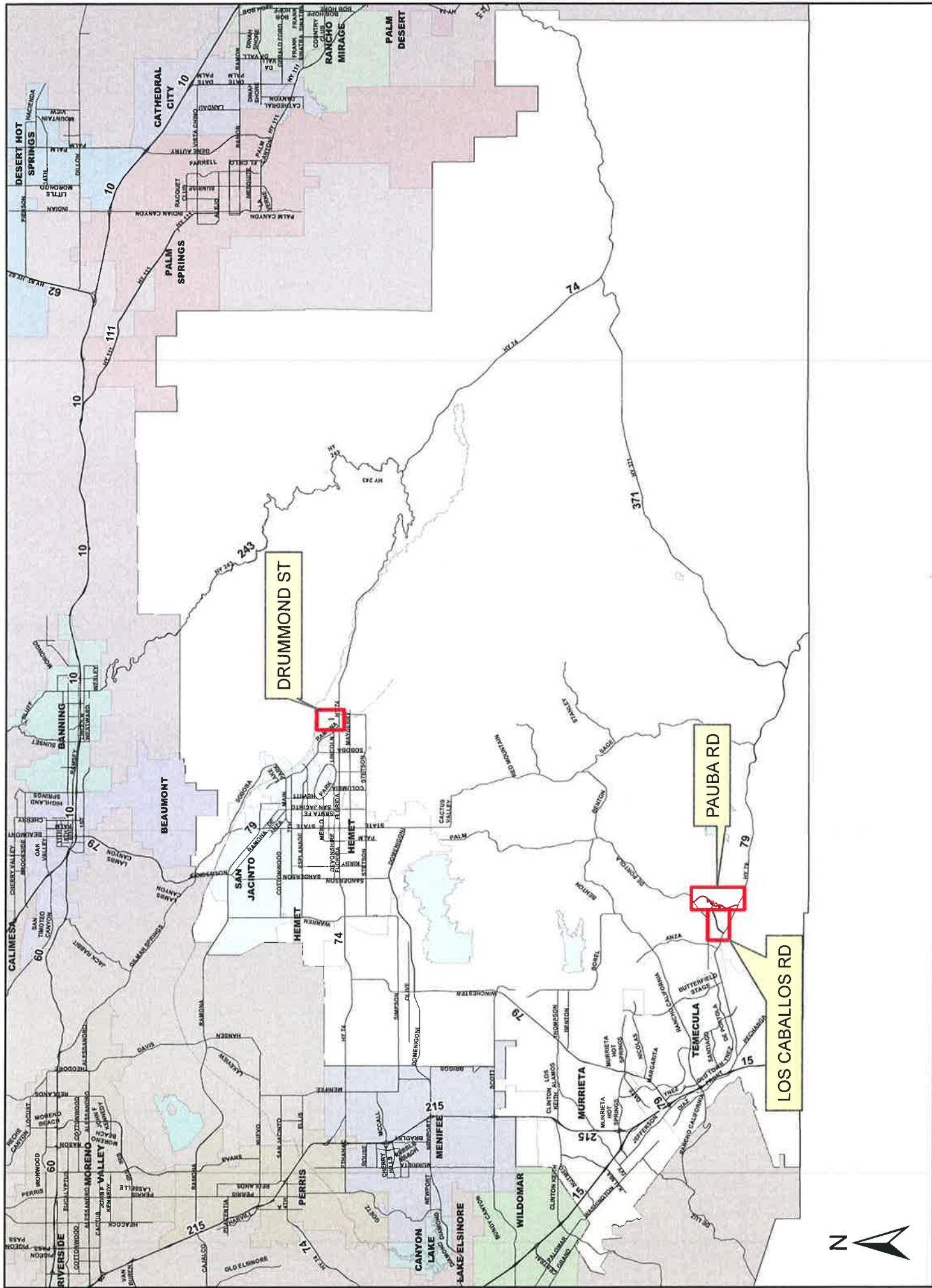

ORDINANCE 452 DISTRICT 4 SPEED ZONE VICINITY MAP

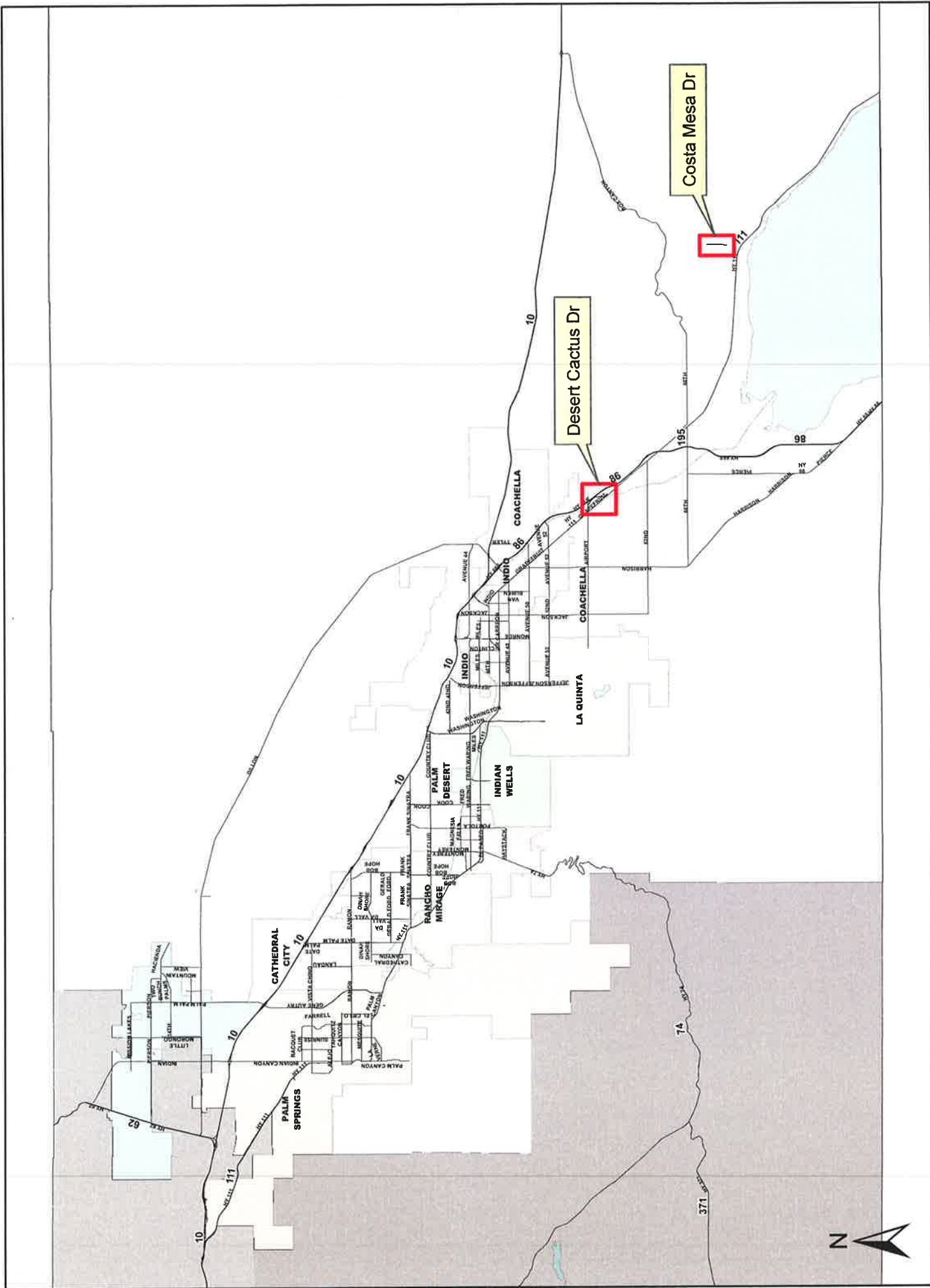



COUNTY OF RIVERSIDE
TRANSPORTATION AND
LAND MANAGEMENT AGENCY



Juan C. Perez, P.E., T.E.
Director of Transportation and
Land Management

Transportation Department

Patricia Romo, P.E.
Assistant Director of Transportation

MEMORANDUM

To: Karin Watts-Bazan, Principal Deputy County Counsel
 Attention: Bruce Fordon, Deputy County Counsel

From: Lawrence Tai 
 County Traffic Engineer

Date: July 31, 2015

Re: Ordinance 452.239 – Speed Zone (Radar Enforced)

We are requesting your approval as to form the attached Ordinance 452.239. This ordinance establishes radar-enforceable speed zones for various roadways within several areas of Riverside County.

In addition, attached for your reference are summary tables for the submitted speed zones and speed zone diagrams. Also attached are two draft Form 11's: One for the introduction of the Ordinance Amendment and the other is for the adoption of the Amendment in subsequent Board of Supervisors' meeting.

Please review the above-mentioned documents and return the approved ordinance to us. Let us know if you have any comments to the draft Form 11's.

We anticipate submitting this Ordinance Amendment (with speed zone summary tables and diagrams to go with the Form 11's for reference) to the Board of Supervisors for approval in the next two weeks. The Amendment will be routed to your office with the Form 11 for final review and approval prior to going to the Clerk of the Board.

Thank you for your assistance. If you have any questions, please contact me at Ext. 5-6800

LTT:sa
 Attachments

FORM APPROVED COUNTY COUNSEL
 BY:  8/13/15
 BRUCE G. FORDON DATE

RECEIVED
 AUG 03 2015
 COUNTY COUNSEL

1
2
3
4
5
6
7
8
9
10
11
12
13
14
15
16
17
18
19
20
21
22
23
24
25
26
27
28

83. On Desert Cactus Drive between 58th Avenue and Airport Blvd, a total distance of approximately 1.1 miles, in the Thermal area.

84. On La Sierra Avenue on the full width between El Sobrante Road and Dufferin Avenue, and the westerly half width between Dufferin Avenue and a point 2,200 feet north of Dufferin Avenue, a total distance of approximately 2.4 miles, in the Riverside area.

85. On Los Caballos Road between SH-79 and Pauba Road, for a total distance of approximately 1.3 miles, in the Temecula area.

86. On Pauba Road between SH-79 and De Portola Road, a total distance of approximately 2.33 miles, in the Temecula area.”

Section 5. Subsection 28 of Section 2.6 of Ordinance 452 adopted on February 4, 2003, pursuant to Ordinance No. 452.214, is repealed in its entirety. Subsection 28 of Section 2.6 established a fifty miles per hour speed limit on Cajalco Road between Day Street and Nevada Avenue (the City of Perris limits).

Section 6. Subsection 56 of Section 2.6 of Ordinance 452 adopted on June 2, 2009, pursuant to Ordinance No. 452.225, is repealed in its entirety. Subsection 56 of Section 2.6 established a fifty miles per hour speed limit on Ellis Avenue between Post Road and State Highway 74.

///

**LIST OF SPEED ZONE SUBMITTALS
ORDINANCE AMENDMENT NO 452.239
SUPERVISORIAL DISTRICT NO. 1**

AREA	ROAD NAME/ LIMITS	EXISTING SPEED LIMIT	PROPOSED SPEED LIMIT	NOTES
PERRIS	CAJALCO ROAD Between Day Street and Seaton Avenue	50	50	BOUNDARY CHANGE
PERRIS	CAJALCO EXPRESSWAY Between Seaton Avenue and Nevada Avenue	50	50	BOUNDARY CHANGE; WITH CORRECT REFERENCE OF STREET NAME.
MEAD VALLEY	COLE AVENUE Between Markham Street and Mariposa Avenue	Not Posted	40	NEW
PERRIS	ELLIS AVENUE Between Post Road and SH-74	50	45	UPDATE
RIVERSIDE	LA SIERRA AVENUE FULL WIDTH between El Sobrante Road and Dufferin Avenue, and WESTERLY HALF WIDTH between Dufferin Avenue and a point 2,200 feet north of Dufferin Avenue	*55	50	UPDATE

- * Maximum allowable speed limit for a two-lane highway is 55 mph
- **Maximum allowable speed limit for a multi-lane highway is 65 mph
- ***Change in speed zone boundary

**LIST OF SPEED ZONE SUBMITTALS
ORDINANCE AMENDMENT NO 452.239
SUPERVISORIAL DISTRICT NO. 3**

AREA	ROAD NAME/ LIMITS	EXISTING SPEED LIMIT	PROPOSED SPEED LIMIT	NOTES
HEMET	DRUMMOND STREET Between Palm Avenue and Olive Avenue	Not Posted*	30	NEW
TEMECULA	LOS CABALLOS ROAD Between SR-79 and Pauba Road	Not Posted*	50	NEW
TEMECULA	PAUBA ROAD Between SR-79 and De Portola Road	Not Posted*	50	NEW

- * Maximum allowable speed limit for a two-lane highway is 55 mph
- **Maximum allowable speed limit for a multi-lane highway is 65 mph
- ***Change in speed zone boundary

**LIST OF SPEED ZONE SUBMITTALS
ORDINANCE AMENDMENT NO 452.239
SUPERVISORIAL DISTRICT NO. 4**

AREA	ROAD NAME/ LIMITS	EXISTING SPEED LIMIT	PROPOSED SPEED LIMIT	NOTES
NORTH SHORE	COSTA MESA DRIVE Between 70 TH Avenue and 68 TH Avenue	Not Posted*	40	NEW
THERMAL	DESERT CACTUS DRIVE Between 58 th Avenue and Airport Boulevard	Not Posted*	50	NEW

- * Maximum allowable speed limit for a two-lane highway is 55 mph
- **Maximum allowable speed limit for a multi-lane highway is 65 mph
- ***Change in speed zone boundary

CAJALCO ROAD

(CAJALCO EXPRESSWAY)
(#1030)

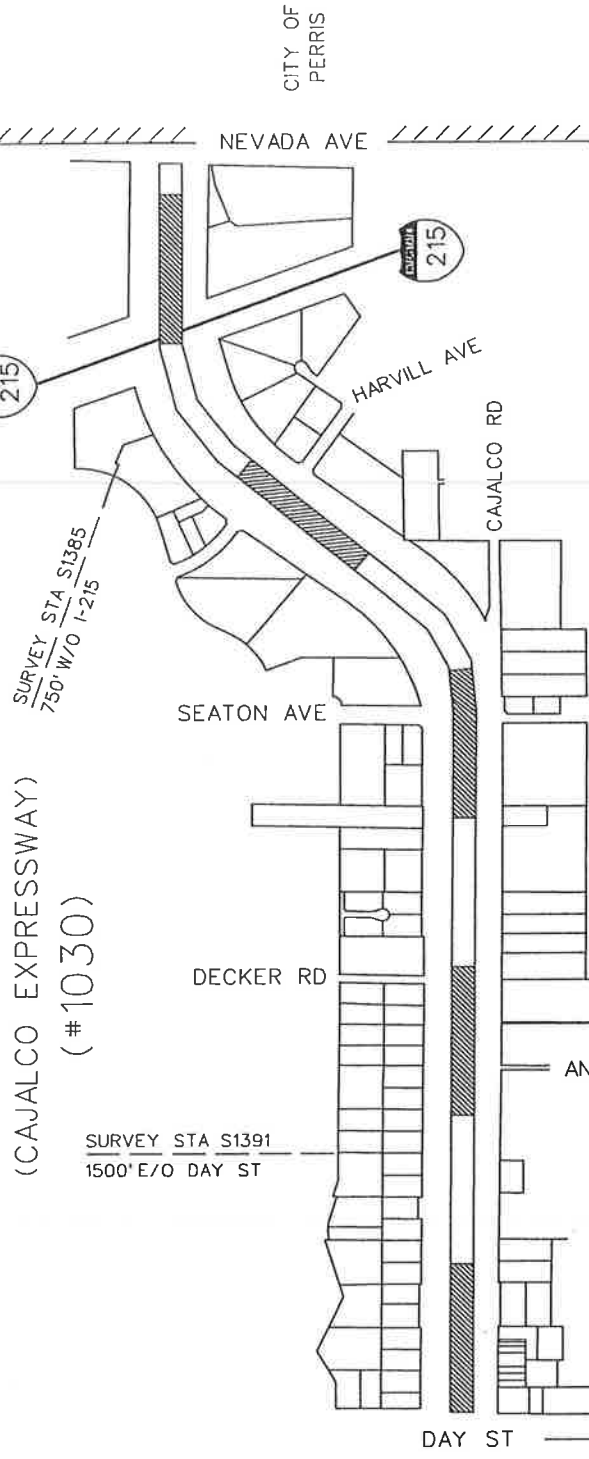

LEGEND:

- CITY LIMITS
- RADAR ZONE
- SURVEY STATION
- OTHER STREET OR ROAD

SEE SHEET
2 OF 3

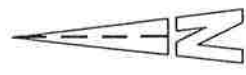

NO SCALE

RECOMMENDED SPEED LIMIT	50 MPH
85th/TILE SPEED	48.3 MPH (AVERAGE OF TWO SIMILAR SEGMENTS OF 51.6 & 45.0 MPH)
VEHICLES IN 24 HR (2 WAY)	27,670
SEGMENT LENGTH	1.88 MILE
ALL ACCIDENTS IN 2 YRS.	28
ACCIDENT RATE ☆	0.74 ACC/MVM
EXISTING SPEED LIMIT	50 MPH (Ord. 452.214 Sec. 2.6 NO. 28)

☆ RATE = $\frac{\text{ACCIDENT} \times 1,000,000}{\text{VEH} \times 365 \times 2 \times \text{MILE}}$

APPROVED BY:
Lawrence T. Tai
DATE: 6/29/2015
LAWRENCE T. TAI, P.E.
COUNTY TRAFFIC ENGINEER

SURVEY DATE: DEC 18, 2014
MAP DATE: JUN 19, 2015
DRAWN BY: N AHMAD
CAD FILE: CAJALCO.DGN

COUNTY AREA: PERRIS
COUNTY MAP: 31, 32, 57, 58, 58A, 58B
SUPERVISOR DISTRICT: 1/1

COLE AVENUE (#1542)

LEGEND:

- ////// CITY LIMITS
- ▬ RADAR ZONE
- - - SURVEY STATION
- ▬▬ OTHER STREET OR ROAD

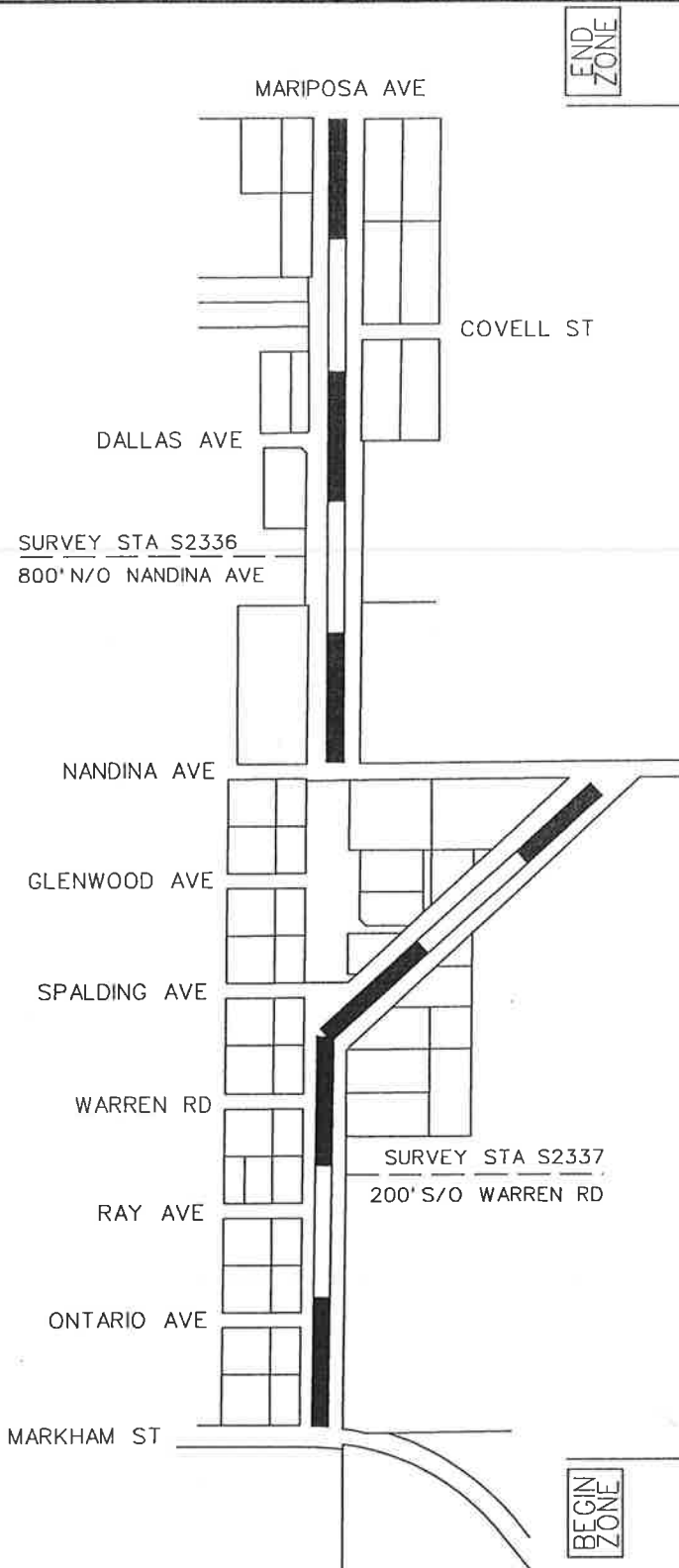

END ZONE

BEGIN ZONE

RECOMMENDED SPEED LIMIT	40 MPH	
85th% TILE SPEED	43.0 MPH	43.0 MPH
VEHICLES IN 24 HR (2 WAY)	340	620
SEGMENT LENGTH	0.58 MILE	0.5 MILE
ALL ACCIDENTS IN 2 YRS.	3	0
ACCIDENT RATE ☆	20.84 ACC/MVM	0.00 ACC/MVM
EXISTING SPEED LIMIT	NOT POSTED	

☆ RATE: NO. OF ACCIDENT x 1,000 000
VEH x 365 x 2 x MILE

SURVEY DATE: JAN 14, 2015
 MAP DATE: APR 1, 2015
 DRAWN BY: N AHMAD
 CAD FILE: COLE_AVE.DGN

APPROVED BY: *Lawrence T. Tai*
 DATE: 4/1/15
LAWRENCE T. TAI, P.E.
 COUNTY TRAFFIC ENGINEER

COUNTY OF RIVERSIDE
TRANSPORTATION DEPARTMENT
 TRAFFIC ENGINEERING DIVISION

ENGINEERING AND TRAFFIC SURVEY
 AT
COLE AVENUE

PAGE
 1 OF 1

LEGEND:

- CITY LIMITS
- RADAR ZONE
- SURVEY STATION
- OTHER STREET OR ROAD

COSTA MESA DRIVE (#1551)

SURVEY STA S2349
750' N/O GRANADA WAY

SURFSIDE AVE
SEASCAPE AVE
YAWL AVE
SURVEY STA S2350
250' N/O SURFSIDE AVE

SURFSIDE AVE

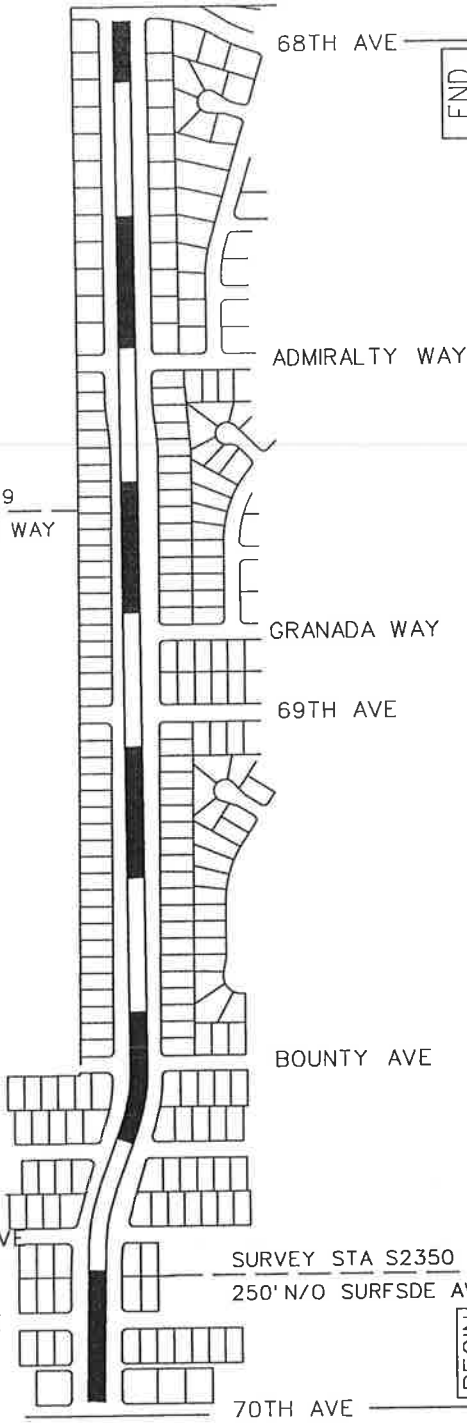

BEGIN ZONE

END ZONE

RECOMMENDED SPEED LIMIT	40 MPH
85th%TILE SPEED	40.0 MPH (AVERAGE OF TWO SIMILAR STATIONS OF 32.0 & 48.0 MPH)
VEHICLES IN 24 HR (2 WAY)	670
SEGMENT LENGTH	1.0 MILE
ALL ACCIDENTS IN 2 YRS.	0
ACCIDENT RATE ☆	0.00 ACC/MVM
EXISTING SPEED LIMIT	NOT POSTED

☆ RATE* $\frac{\text{NO. OF ACCIDENT} \times 1,000,000}{\text{VEH} \times 365 \times 2 \times \text{MILE}}$

APPROVED BY:
DATE: 4/30/2015
LAWRENCE T. TAI, P.E.
COUNTY TRAFFIC ENGINEER

SURVEY DATE: MAR 5, 2015
MAP DATE: APR 24, 2015
DRAWN BY: N AHMAD
CAD FILE: COSTA_MESA_DR.DGN

COUNTY AREA: NORTH SHORE
COUNTY MAP: 236A
SUPERVISOR DISTRICT: 4/4

LEGEND:

- ////// CITY LIMITS
- ▬ RADAR ZONE
- - - SURVEY STATION
- ==== OTHER STREET OR ROAD

DESERT CACTUS DRIVE (#1548)

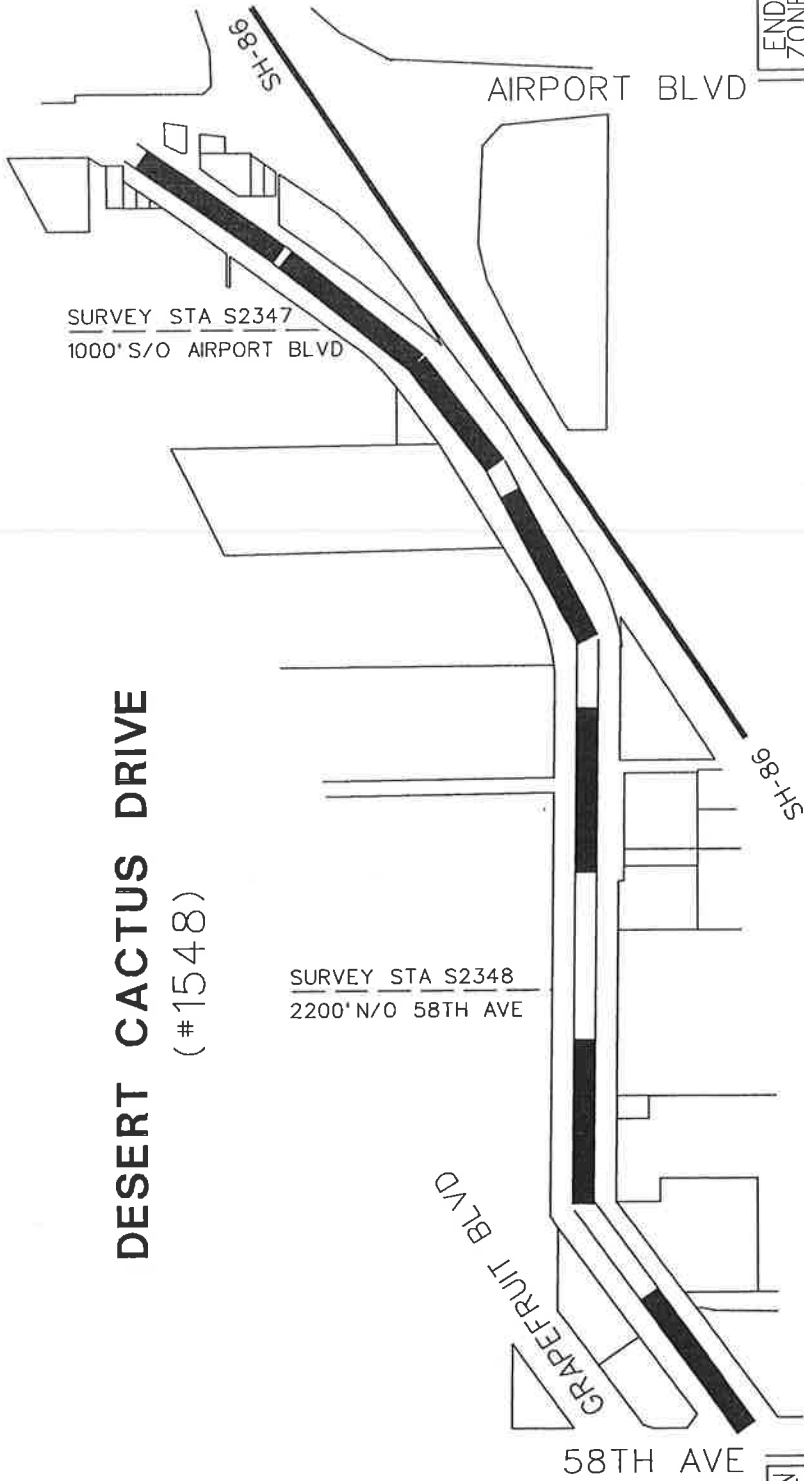

NO SCALE

BEGIN ZONE

END ZONE

RECOMMENDED SPEED LIMIT	50 MPH
85th%TILE SPEED	52.5 MPH (AVERAGE OF TWO SIMILAR STATIONS OF 51.0 & 54.0 MPH)
VEHICLES IN 24 HR (2 WAY)	1950
SEGMENT LENGTH	1.1 MILE
ALL ACCIDENTS IN 2 YRS.	4
ACCIDENT RATE ☆	2.55 ACC/MVM
EXISTING SPEED LIMIT	NOT POSTED

☆ RATE = $\frac{\text{NO. OF ACCIDENT} \times 1000.000}{\text{VEH} \times 365 \times 2 \times \text{MILE}}$

APPROVED BY: *Lawrence T. Talpe*
 DATE: 4/6/2015
LAWRENCE T. TALPE,
 COUNTY TRAFFIC ENGINEER

SURVEY DATE: MAR 5, 2015
 MAP DATE: APR 6, 2015
 DRAWN BY: N AHMAD
 CAD FILE: DESERT_CACTUS.DGN

COUNTY AREA: THERMAL
 COUNTY MAP: 223A
 SUPERVISOR DISTRICT: 4/4

LEGEND:

-  CITY LIMITS
-  RADAR ZONE
-  SURVEY STATION
-  OTHER STREET OR ROAD

SURVEY STA S2352
300' N/O PALM AVE

DRUMMOND STREET
(#1546)

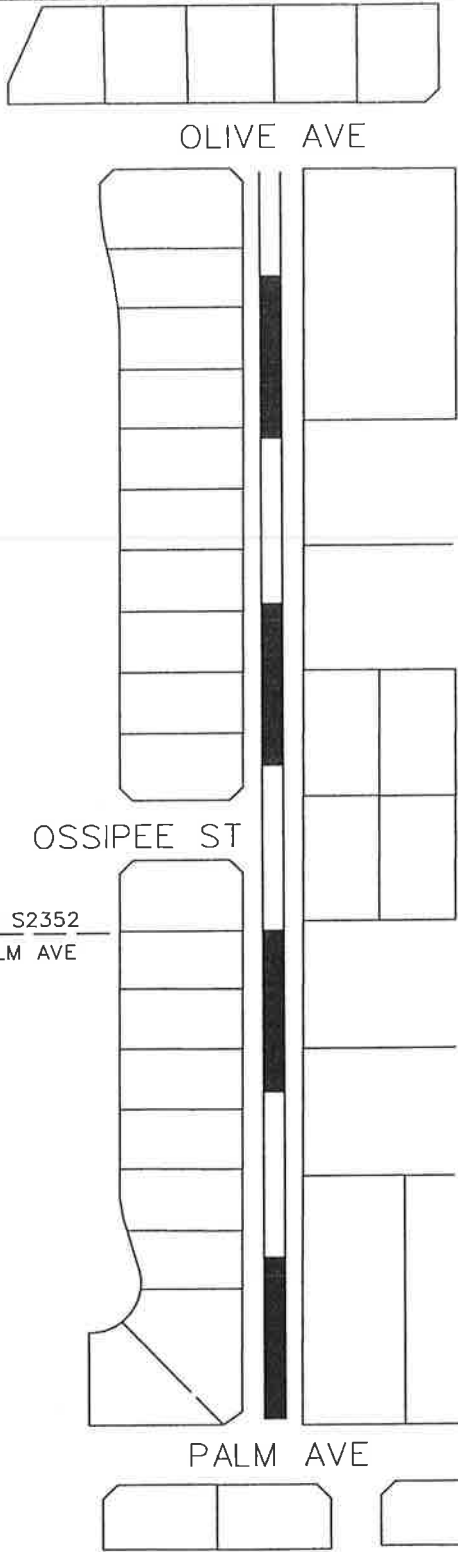

NO SCALE

BEGIN ZONE

END ZONE

RECOMMENDED SPEED LIMIT	30 MPH
85th% TILE SPEED	34.0 MPH
VEHICLES IN 24 HR (2 WAY)	440
SEGMENT LENGTH	0.25 MILE
ALL ACCIDENTS IN 2 YRS.	0
ACCIDENT RATE ☆	0.00 ACC/MVM
EXISTING SPEED LIMIT	NOT POSTED

☆ RATE* NO. OF ACCIDENT x 1,000,000
VEH x 365 x 2 x MILE

APPROVED BY: *Lawrence T. Tai, P.E.*
DATE: 4/7/2015
LAWRENCE T. TAI, P.E.
COUNTY TRAFFIC ENGINEER

SURVEY DATE: MAR 12, 2015
MAP DATE: APR 6, 2015
DRAWN BY: N AHMAD
CAD FILE: DRUMMOND_ST.DGN

COUNTY AREA: HEMET
COUNTY MAP: 112A
SUPERVISOR DISTRICT: 3/3

COUNTY OF RIVERSIDE
TRANSPORTATION DEPARTMENT
TRAFFIC ENGINEERING DIVISION
ENGINEERING AND TRAFFIC SURVEY
AT
DRUMMOND STREET

ELLIS AVENUE (#1091)

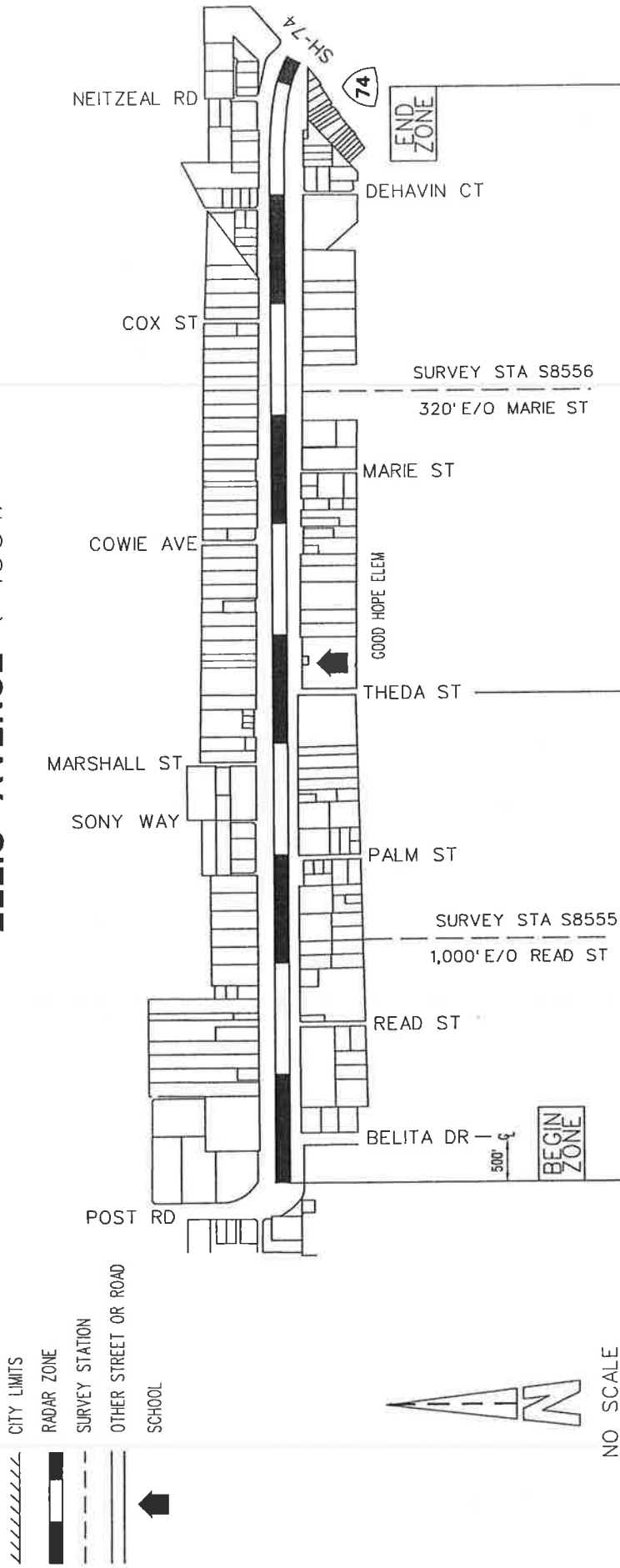

NO SCALE

RECOMMENDED SPEED LIMIT	45 MPH
PREVAILING SPEED (85%)	49.0 MPH (AVERAGE OF 48.2 & 49.8 MPH)
VEHICLES IN 24 HR (2 WAY)	4,075
SEGMENT LENGTH	1.2 MILE
ALL ACCIDENTS IN 2 YRS. ★	4
ACCIDENT RATE ★	1.12 ACC/MVM
EXISTING SPEED LIMIT	50 MPH (Ord 452.225 Sec. 2.6 No. 56)
	4,650
	1.4 MILE
	5
	1.05 ACC/MVM

★ RATE = $\frac{\text{ACCIDENT} \times 1,000,000}{\text{VEH} \times 365 \times 2 \times \text{MILE}}$

APPROVED BY: *Lawrence T. Tai*
 DATE: 6/19/2015
 LAWRENCE T. TAI, P.E.
 COUNTY TRAFFIC ENGINEER

SURVEY DATE: APR 28, 2015
 MAP DATE: JUN 17, 2015
 DRAWN BY: N AHMAD
 CAD FILE: ELLIS.DGN

COUNTY AREA: PERRIS
 COUNTY MAP: 61
 SUPERVISOR DISTRICT: 5/1

COUNTY OF RIVERSIDE
TRANSPORTATION DEPARTMENT
 TRAFFIC ENGINEERING DIVISION
 ENGINEERING AND TRAFFIC SURVEY
 AT
ELLIS AVENUE

LEGEND:

- ////// CITY LIMITS
- ▬ RADAR ZONE
- - - SURVEY STATION
- ▬▬▬ OTHER STREET OR ROAD

LOS CABALLOS ROAD

(#1544)

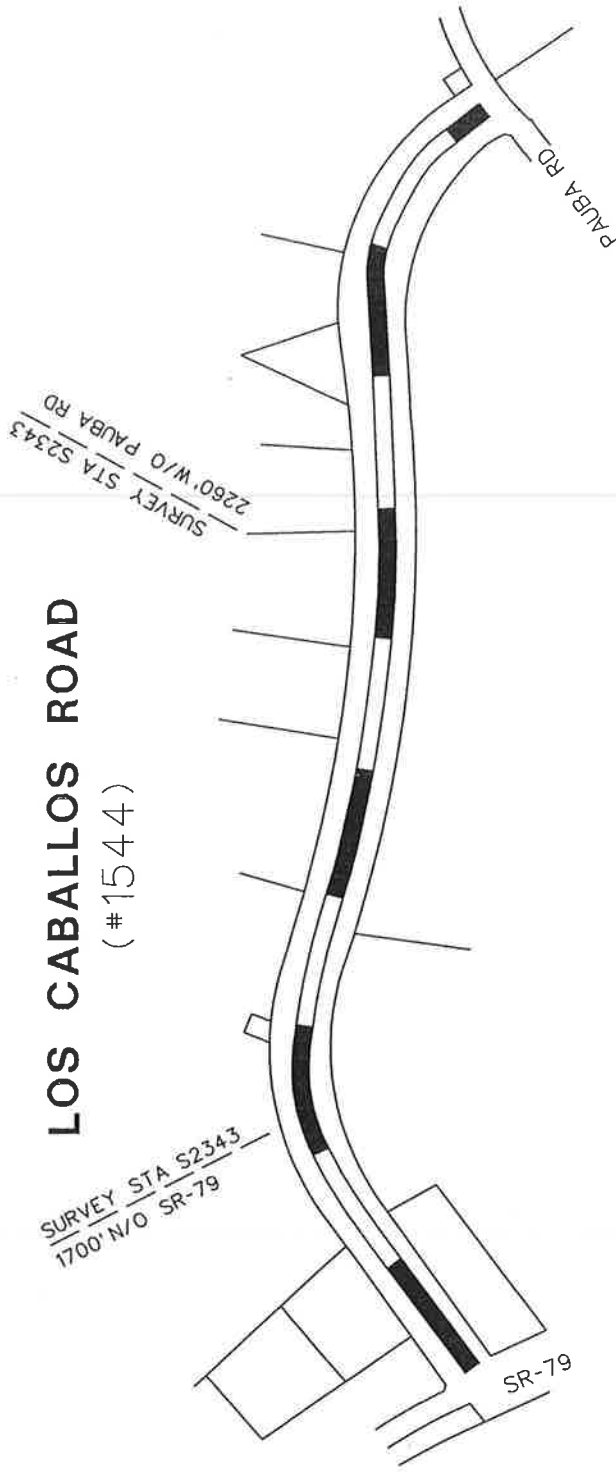

BEGIN ZONE

NO SCALE

END ZONE

NO CENTERLINE - EQUESTRIAN CENTERS - HORIZONTAL / VERTICAL CURVES - NO SIDEWALK - REDUCE TO 50 MPH		
RECOMMENDED SPEED LIMIT	50 MPH	
85th% TILE SPEED	55.5 MPH 9AVERAGE OF TWO SIMILAR STATION OF 52.0 & 59.0 MPH)	
VEHICLES IN 24 HR (2 WAY)	620	
SEGMENT LENGTH	1.3 MILE	
ALL ACCIDENTS IN 2 YRS.	1	
ACCIDENT RATE ☆	1.7 ACC/MVM	
EXISTING SPEED LIMIT	NOT POSTED	

☆ RATE: NO. OF ACCIDENT x 1,000,000
VEH x 365 x 2 x MILE

APPROVED BY:

Lawrence T. Tai, P.E.

DATE: 4/1/2015
LAWRENCE T. TAI, P.E.
COUNTY TRAFFIC ENGINEER

SURVEY DATE:	MAR 4, 2015	DRAWN BY:	N AHMAD
MAP DATE:	APR 1, 2015	CAD FILE:	LOS_CABALLOS.DGN

COUNTY AREA:	TEMECULA	SUPERVISOR DISTRICT:	3/3
COUNTY MAP:	133C, 136		

COUNTY OF RIVERSIDE
TRANSPORTATION DEPARTMENT
TRAFFIC ENGINEERING DIVISION

ENGINEERING AND TRAFFIC SURVEY
AT
LOS CABALLOS ROAD

PAUBA ROAD (#1550)

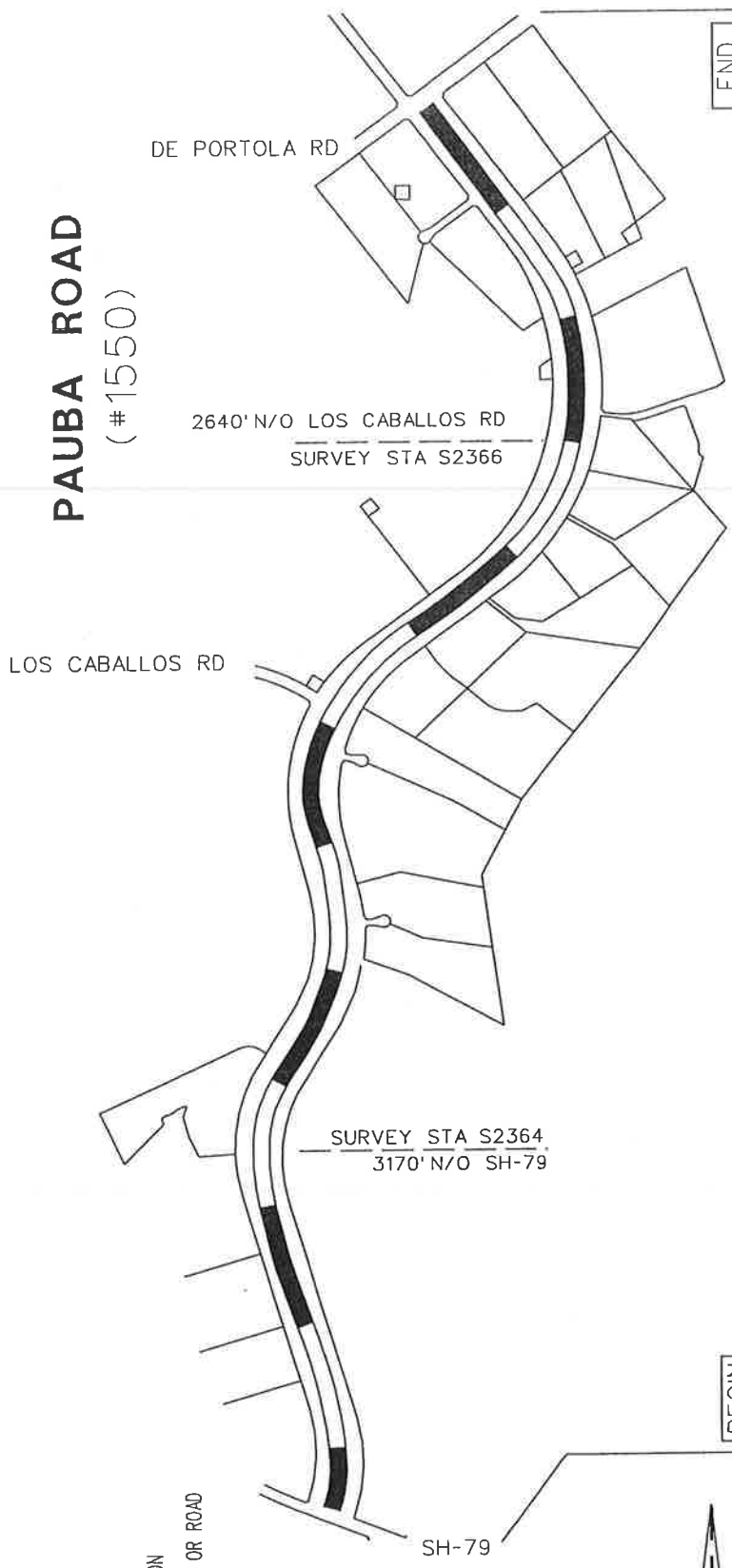

- LEGEND:
- ////// CITY LIMITS
 - ▬ RADAR ZONE
 - - - SURVEY STATION
 - OTHER STREET OR ROAD



NO SCALE

RECOMMENDED SPEED LIMIT	50 MPH
85th%TILE SPEED	54.5 (AVGERAGE OF TWO SIMILAR STATIONS OF 55.0 & 54.0 MPH)
VEHICLES IN 24 HR (2 WAY)	420
SEGMENT LENGTH	2.33 MILE
ALL ACCIDENTS IN 2 YRS.	2
ACCIDENT RATE ☆	2.80 ACC/MVM
EXISTING SPEED LIMIT	NOT POSTED

☆ RATE = $\frac{\text{NO. OF ACCIDENT} \times 1,000,000}{\text{VEH} \times 365 \times 2 \times \text{MILE}}$

APPROVED BY: *Lawrence T. Tai*
 DATE: 5/11/2015
 LAWRENCE T. TAI, P.E.
 COUNTY TRAFFIC ENGINEER

SURVEY DATE: APR 14, 2015
 MAP DATE: APR 24, 2015
 DRAWN BY: N AHMAD
 CAD FILE: PAUBA_RD.DGN

COUNTY AREA: TEMECULA
 COUNTY MAP: 133B, 136
 SUPERVISOR DISTRICT: 3/3