

**SUBMITTAL TO THE BOARD OF SUPERVISORS
COUNTY OF RIVERSIDE, STATE OF CALIFORNIA**

916A



FROM: TLMA – Transportation Department

SUBMITTAL DATE:
May 4, 2016

SUBJECT: Introduction of Ordinance No. 452.241 to Establish Speed Zones Enforceable by Radar Speed Detection Equipment in the Corona, Desert Hot Springs, Indio, Lake Elsinore, Lake Mathews, Menifee, Palm Desert, and Woodcrest Areas. 1st, 3rd, 4th and 5th Districts; [\$3,000- Total]; Gas Tax 100%

RECOMMENDED MOTION: That the Board of Supervisors introduce and adopt, on successive meetings, Ordinance No. 452.241, amending Ordinance No. 452 relating to prima facie speed limits to establish various speed zones in the above-referenced areas of the County of Riverside (County).

BACKGROUND:

Summary

The County of Riverside Transportation Department (Transportation Department) staff has conducted Engineering and Traffic Surveys (E&TS) in accordance with the California Vehicle Code (CVC), Sections 627 and 40802, for various county-maintained roads in the Corona, Desert Hot Springs, Indio, Lake Elsinore, Lake Mathews, Menifee, Palm Desert, and Woodcrest areas of Riverside County.

Patricia Romo
Assistant Director of Transportation

Juan C. Perez
Director of Transportation and Land Management

LTT:DA:sa

FINANCIAL DATA	Current Fiscal Year:	Next Fiscal Year:	Total Cost:	Ongoing Cost:	POLICY/CONSENT (Per Exec. Office)
COST	\$ 3,000	\$ 0	\$ 3,000	\$ 0	Consent <input type="checkbox"/> Policy <input checked="" type="checkbox"/>
NET COUNTY COST	\$ 0	\$ 0	\$ 0	\$ 0	

SOURCE OF FUNDS: Gas Tax (100%). There are no General Funds used in this project.

Budget Adjustment: No

For Fiscal Year: 2015/2016

C.E.O. RECOMMENDATION:

APPROVE

BY: 
Tina Grande

County Executive Office Signature

MINUTES OF THE BOARD OF SUPERVISORS

- Positions Added
- Change Order

- A-30
- 4/5 Vote

Prev. Agn. Ref.:

District: 1,3,4,5

Agenda Number:

3-76

FORM APPROVED COUNTY COUNSEL
BY: GREGORY P. PRIAMOS
DATE: 6/6/16
Departmental Concurrence

SUBMITTAL TO THE BOARD OF SUPERVISORS, COUNTY OF RIVERSIDE, STATE OF CALIFORNIA

FORM 11: Introduction of Ordinance No. 452.241 to Establish Speed Zones Enforceable by Radar Speed Detection Equipment in the Corona, Desert Hot Springs, Indio, Lake Elsinore, Lake Mathews, Menifee, Palm Desert, and Woodcrest Areas. 1st, 3rd, 4th and 5th Districts; [\$3,000- Total]; Gas Tax 100%

DATE: May 4, 2016

PAGE: 2 of 2

BACKGROUND:

Summary (continued)

Based upon the results of the E&TS for these roads, the radar-enforceable speed limits recommended by the Transportation Department are summarized in the attached tables and have been determined to be appropriate to facilitate the safe and orderly movement of vehicular traffic.

Transportation Department staff has contacted the Riverside, Temecula, and Indio area offices of the California Highway Patrol (CHP) regarding the recommended speed zones.

The Ordinance amendment has been reviewed and approved by County Counsel as to form.

Impact on Residents and Businesses

The establishing and posting of appropriate speed limits promote safe and orderly movements of vehicular traffic and enable the CHP to use radar equipment to enforce the speed limits. Since the recommended speed limits were determined based on actual speed surveys, the majority of the motorists are already driving at or below the recommended speed limits. Posted speed limits also guide motorists to drive at a reasonable speed in unfamiliar locations.

SUPPLEMENTAL:

Additional Fiscal Information

The cost for establishing the recommended speed limits is primarily for the installation of speed limit signs, which is estimated at about \$3,000.

Contract History and Price Reasonableness

N/A

ATTACHMENTS

Vicinity Maps

Ordinance No. 452.241

List of Speed Zone Submittals

Speed Zone Diagrams

ORDINANCE 452 DISTRICT 1 SPEED ZONE VICINITY MAP

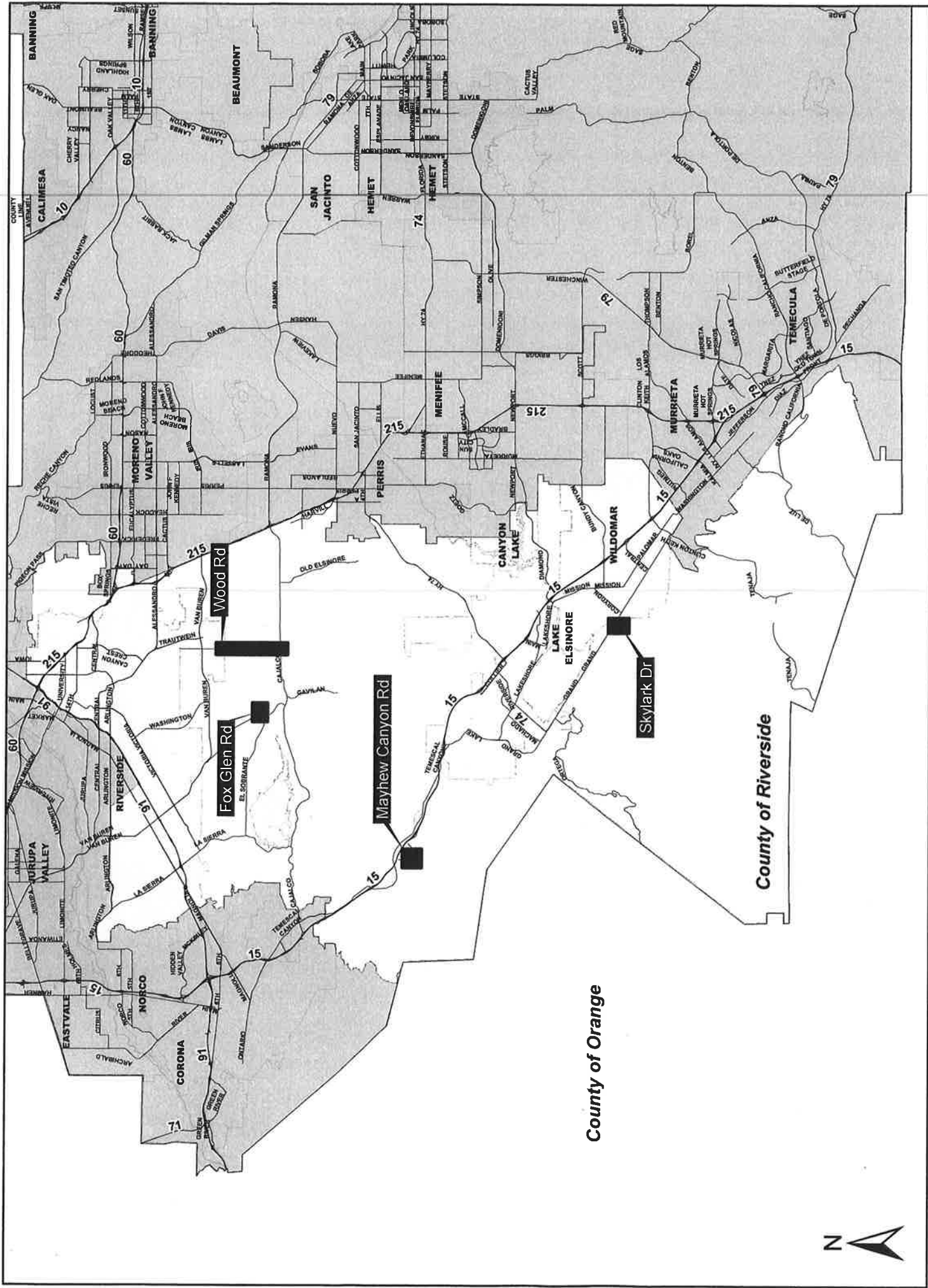

ORDINANCE 452.241 DISTRICT 3 SPEED ZONE VICINITY MAP

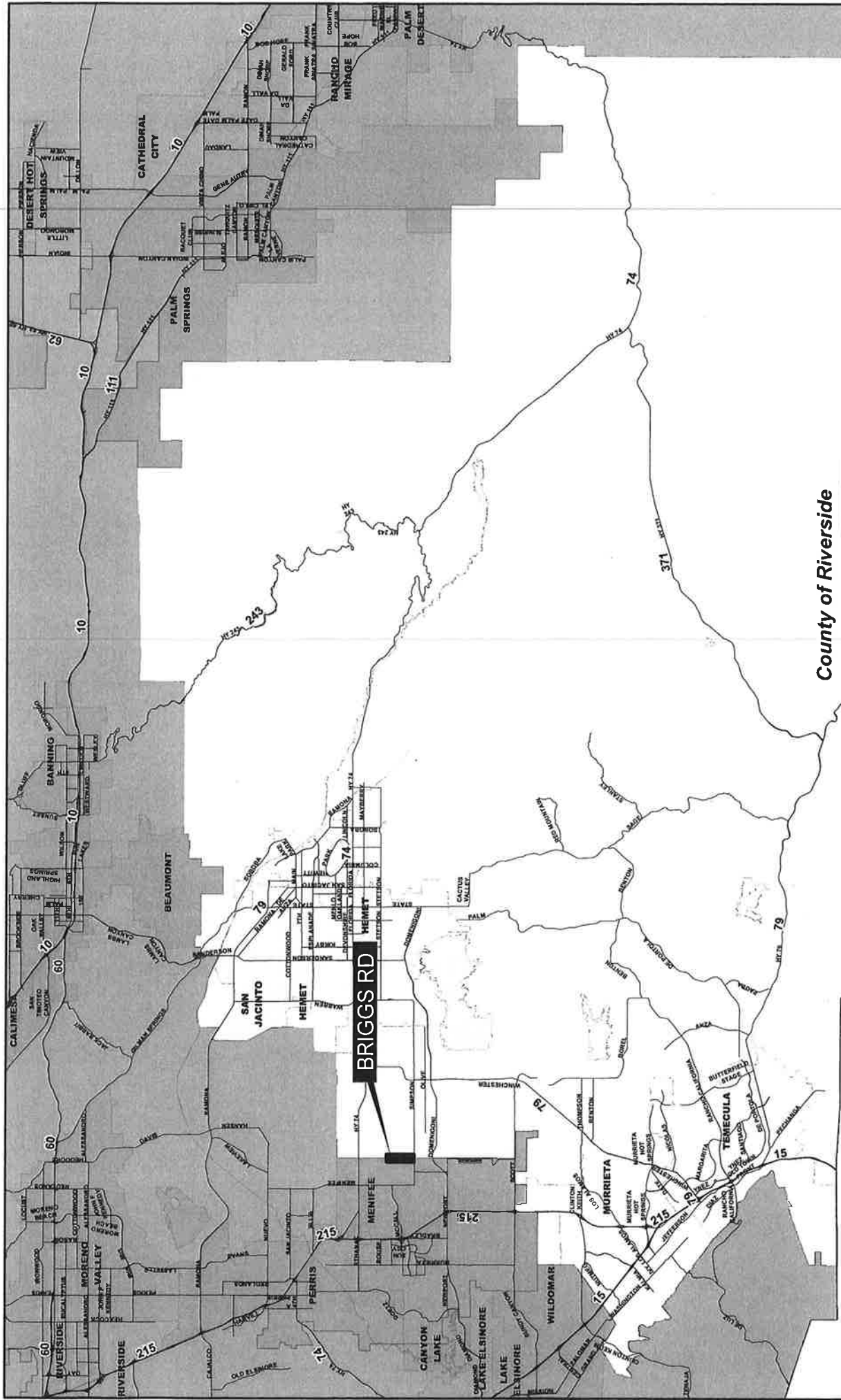

County of Riverside

County of San Diego



ORDINANCE 452 DISTRICT 4 SPEED ZONE VICINITY MAP

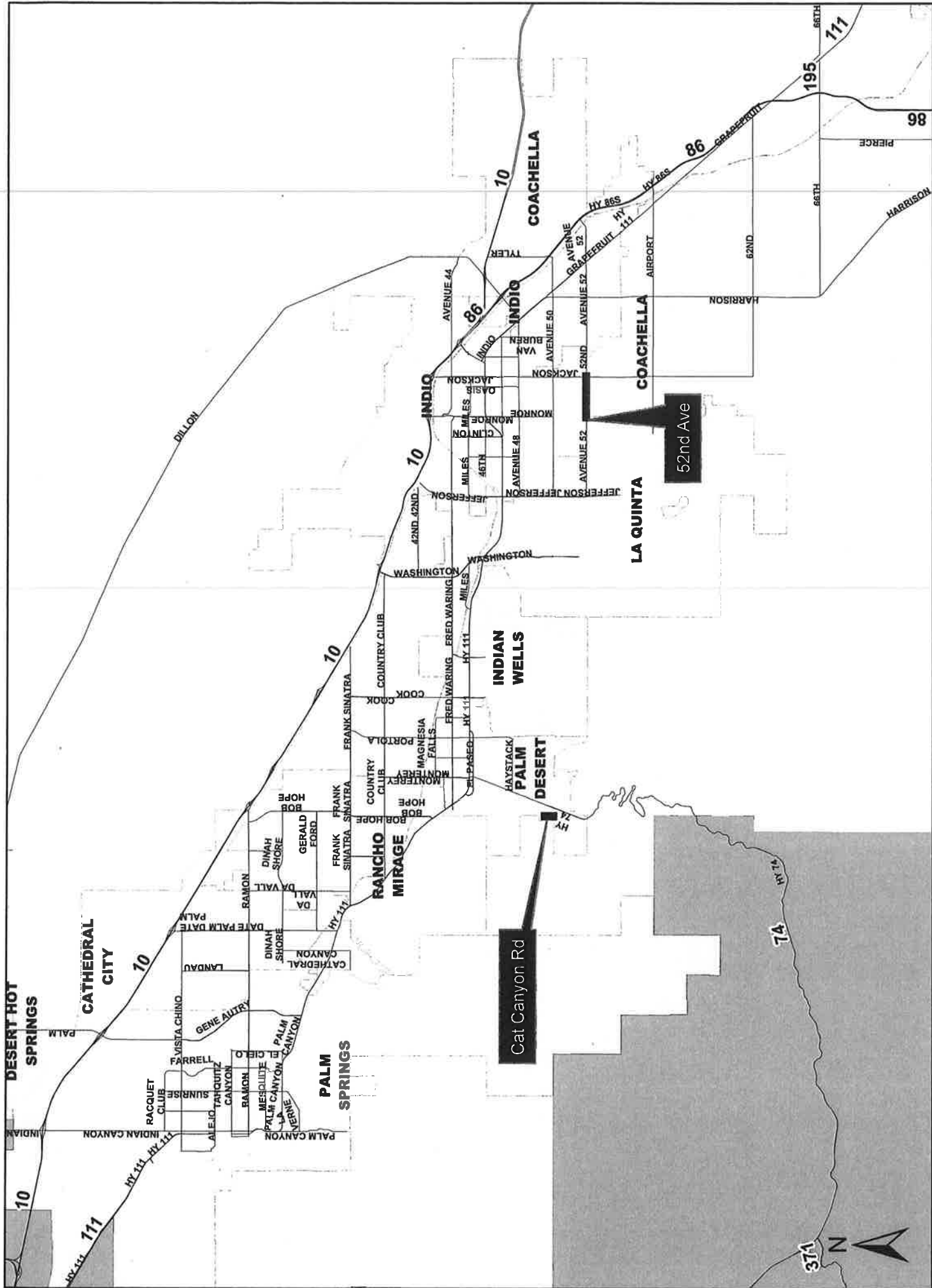

ORDINANCE 452 DISTRICT 5 SPEED ZONE VICINITY MAP

County of San Bernardino

County of Riverside

Mission Lakes Blvd

Briggs Rd

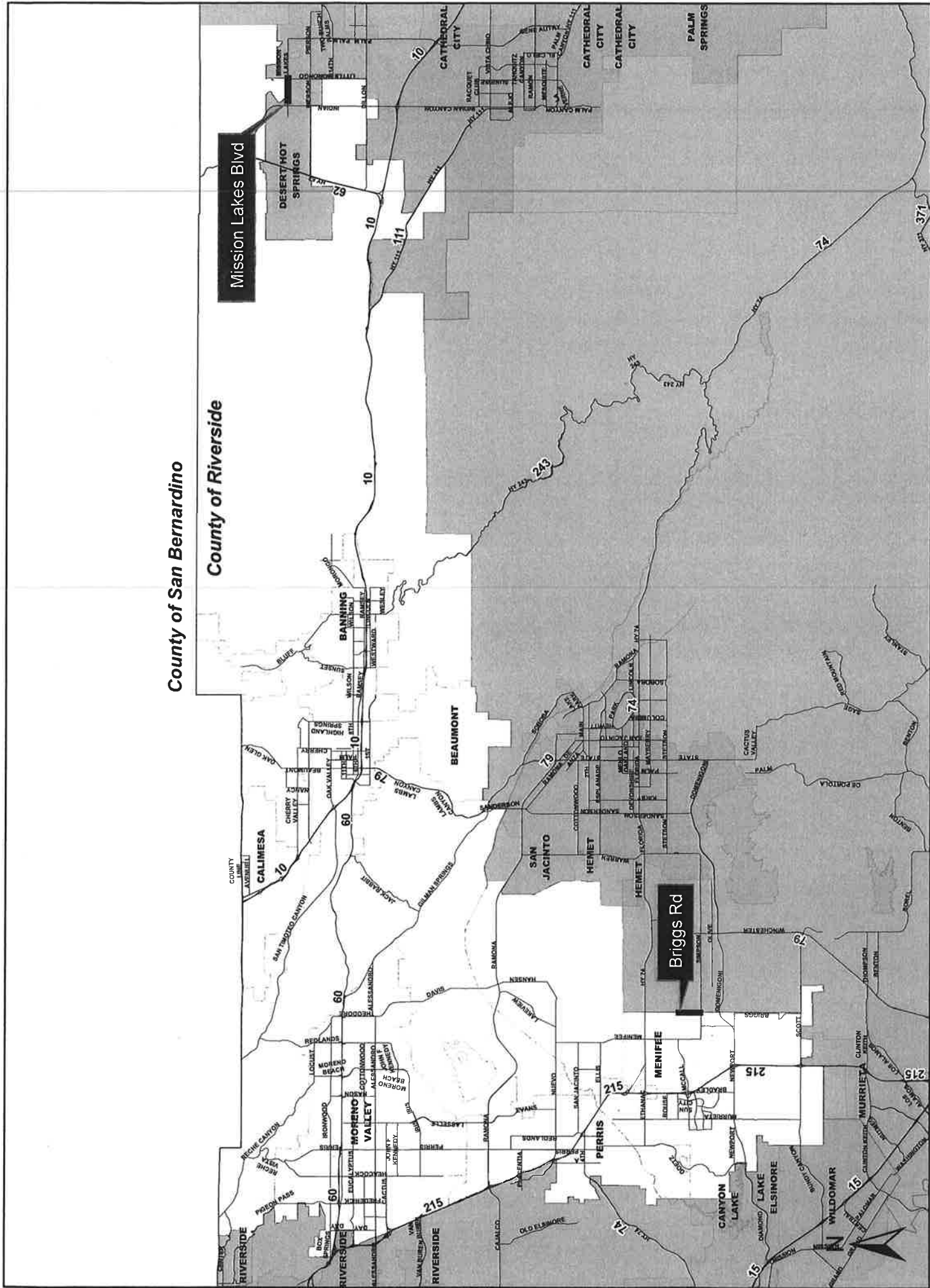

ORDINANCE NO. 452.241

AN ORDINANCE OF THE COUNTY OF RIVERSIDE

AMENDING ORDINANCE NO. 452

RELATING TO PRIMA FACIE SPEED LIMITS

The Board of Supervisors of the County of Riverside ordains as follows:

Section 1. Section 2.2 of Ordinance No. 452, entitled "Thirty miles per hour," is hereby amended to add new subsection 33 to read as follows:

"33. On Skylark Drive between Moss Drive and Grand Avenue, a total distance of approximately 0.34 miles, in the Lake Elsinore area."

Section 2. Section 2.3 of Ordinance No. 452, entitled "Thirty-five miles per hour," is hereby amended to add new subsections 131 and 132 to read as follows:

"131. On Fox Glen Road between Mockingbird Canyon Road and Sussex Road, a total distance of approximately 0.30 miles, in the Lake Mathews area.

132. On Mayhew Canyon Road between Campbell Ranch Road (W) and Campbell Ranch Road (E), a total distance of approximately 1.20 miles, in the Corona area."

Section 3. Section 2.4 of Ordinance 452, entitled "Forty miles per hour," is hereby amended to add new subsection 150 to read as follows:

"150. On the westerly half of Cat Canyon Road between Cahuilla Way and Cholla Way, a total distance of approximately 0.25 miles, in the Palm Desert area."

Section 4. Section 2.5 of Ordinance 452, entitled "Forty-five miles per hour," is hereby amended to add new subsections 170 and 171 to read as follows:

"170. On the easterly half of Briggs Road between Simpson Road and Matthews Road, a total distance of approximately 1.10 miles, in the Menifee area.

///

1 171. On Wood Road between Markham Street and Mariposa Avenue, a
2 total distance of approximately 1.0 mile, in the Woodcrest area.”

3 Section 5. Section 2.6 of Ordinance No. 452, entitled “Fifty miles per hour,” is hereby
4 amended to add new subsections 87 and 88 to read as follows:

5 “87. On the northerly half of Mission Lakes Boulevard between a point
6 450 feet west of Clubhouse Boulevard and Little Morongo Road, a
7 total distance of approximately 0.79 miles, in the Desert Hot Springs
8 area.

9 88. On Wood Road between Cajalco Road and Markham Street, a total
10 distance of approximately 1.50 miles, in the Woodcrest area.”

11 Section 6. Section 2.7 of Ordinance No. 452, entitled “Fifty-five miles per hour,” is
12 hereby amended to add new subsection 28 to read as follows:

13 “28. On the southerly half of 52nd Avenue between Monroe Street and
14 Jackson Street, a total distance of approximately 1.00 mile, in the
15 Indio area.”

16 Section 7. Subsection 87 of Section 2.3 of Ordinance 452 adopted on October 17,
17 2006, pursuant to Ordinance No. 452.223, is repealed in its entirety. Subsection 87 of Section 2.3
18 established a thirty-five miles per hour speed limit on the westerly half of Cat Canyon Road between
19 Cahuilla Way and Cholla Way.

20 Section 8. Subsection 105 of Section 2.4 of Ordinance 452 adopted on February 9,
21 2010, pursuant to Ordinance No. 452.227, is repealed in its entirety. Subsection 105 of Section 2.4
22 established a forty miles per hour speed limit on Mayhew Canyon Road between the centerline of
23 Campbell Ranch Road (W) and the centerline of Campbell Ranch Road (E).

24 Section 9. Subsection 110 of Section 2.4 of Ordinance 452 adopted on October 5,
25 2010, pursuant to Ordinance No. 452.228, is repealed in its entirety. Subsection 110 of Section 2.4
26 established a forty miles per hour speed limit on Fox Glen Road between the centerline of Mockingbird
27 Canyon Road and a point 820 feet east of Scottsdale Drive.

28 ///

1 Section 10. Subsection 36 of Section 2.6 or Ordinance 452 adopted on May 20, 2003,
2 pursuant to Ordinance No. 452.215, is repealed in its entirety. Subsection 36 of Section 2.6 established a
3 fifty miles per hour speed limit on the southerly side of Pierson Boulevard between Indian Avenue and
4 Little Morongo Road.

5 Section 11. Subsection 50 of Section 2.6 of Ordinance 452 adopted on April 18, 2006,
6 pursuant to Ordinance No. 452.222, is repealed in its entirety. Subsection 50 of Section 2.6 established a
7 fifty miles per hour speed limit on the southerly half of 52nd Avenue between Monroe Street and Jackson
8 Street.

9 Section 12. Subsection 51 of Section 2.6 of Ordinance 452 adopted on October 17,
10 2006, pursuant to Ordinance No. 452.223, is repealed in its entirety. Subsection 51 of Section 2.6
11 established a fifty miles per hour speed limit on the northerly half of Mission Lakes Boulevard between
12 Indian Avenue and Little Morongo Road.

13 Section 13. Subsection 64 of Section 2.6 of Ordinance 452 adopted on February 9,
14 2010, pursuant to Ordinance No. 452.227, is repealed in its entirety. Subsection 64 of Section 2.6
15 established a fifty miles per hour speed limit on Wood Road between the centerline of Cajalco Road and
16 the centerline of Mariposa Avenue.

17 ///

18 ///

19
20
21
22
23
24
25
26
27
28

1
2
3
4
5
6
7
8
9
10
11
12
13
14
15
16
17
18
19
20
21
22
23
24
25
26
27
28

Section 14. This ordinance shall take effect 30 days after its adoption.

BOARD OF SUPERVISORS OF THE COUNTY
OF RIVERSIDE, STATE OF CALIFORNIA

BY: _____
SUPERVISOR JOHN J. BENOIT, Chairman

ATTEST:
KECIA HARPER-IHEM, Clerk of the Board

By: _____
Deputy

APPROVED AS TO FORM:
GREGORY P. PRIAMOS, County Counsel

By: 
Deputy

LTT:sa
4/25/16 Y:\Traffic\Ord. 452 - Speed Zones\Ord. 452.241\Ord. 452.241

**LIST OF SPEED ZONE SUBMITTALS
ORDINANCE AMENDMENT NO 452.241
SUPERVISORIAL DISTRICT NO. 1**

AREA	ROAD NAME/ LIMITS	EXISTING SPEED LIMIT	PROPOSED SPEED LIMIT	NOTES
LAKE MATHEWS	FOX GLEN ROAD Between Mockingbird Canyon Road and Sussex Road	40	35	UPDATE
CORONA	MAYHEW CANYON ROAD Between Campbell Ranch Road (W) and Campbell Ranch Road (E)	40	35	UPDATE
LAKE ELSINORE	SKYLARK DRIVE Between Moss Drive and Grand Avenue	Not Posted*	30	NEW
WOODCREST	WOOD ROAD Between Markham Street and Mariposa Avenue	50	45	BOUNDARY CHANGE/UPDATE
WOODCREST	WOOD ROAD Between Cajalco Road and Markham Street	50	50	BOUNDARY CHANGE

- * Maximum allowable speed limit for a two-lane highway is 55 mph
- **Maximum allowable speed limit for a multi-lane highway is 65 mph
- ***Change in speed zone boundary

**LIST OF SPEED ZONE SUBMITTALS
ORDINANCE AMENDMENT NO 452.241
SUPERVISORIAL DISTRICT NO. 3**

AREA	ROAD NAME/ LIMITS	EXISTING SPEED LIMIT	PROPOSED SPEED LIMIT	NOTES
MENIFEE	BRIGGS ROAD On the easterly half between Simpson Road and Matthews Road	Not Posted**	45	NEW

* Maximum allowable speed limit for a two-lane highway is 55 mph
 **Maximum allowable speed limit for a multi-lane highway is 65 mph
 ***Change in speed zone boundary

**LIST OF SPEED ZONE SUBMITTALS
ORDINANCE AMENDMENT NO 452.241
SUPERVISORIAL DISTRICT NO. 4**

AREA	ROAD NAME/ LIMITS	EXISTING SPEED LIMIT	PROPOSED SPEED LIMIT	NOTES
INDIO	52ND AVENUE On the southerly half between Monroe Street and Jackson Street	50	55	UPDATE; Consistent With City of Indio Increased Posted Speed Limit
PALM DESERT	CAT CANYON ROAD On the westerly half between Cahuilla Way and Cholla Way	35	40	UPDATE; Consistent With City of Palm Desert Increased Posted Speed Limit.
DESERT HOT SPRINGS	PIERSON BOULEVARD On the southerly half between N. Indian Canyon Drive and Little Morongo Road	50	N/A	REPEAL: City of Desert Hot Springs Annexation

* Maximum allowable speed limit for a two-lane highway is 55 mph

**Maximum allowable speed limit for a multi-lane highway is 65 mph





***Change in speed zone boundary

**LIST OF SPEED ZONE SUBMITTALS
ORDINANCE AMENDMENT NO 452.241
SUPERVISORIAL DISTRICT NO. 5**

AREA	ROAD NAME/ LIMITS	EXISTING SPEED LIMIT	PROPOSED SPEED LIMIT	NOTES
MENIFEE	BRIGGS ROAD On the easterly half between Simpson Road and Matthews Road	Not Posted**	45	NEW
DESERT HOT SPRINGS	MISSION LAKES BLVD On the northerly half between a point 450 feet west of Clubhouse Blvd and Little Morongo Road	50	50	BOUNDARY CHANGE; City Annexation
DESERT HOT SPRINGS	PIERSON BOULEVARD On the southerly half between N. Indian Canyon Drive and Little Morongo Road	50	55	REPEAL: City Annexation

- * Maximum allowable speed limit for a two-lane highway is 55 mph
- **Maximum allowable speed limit for a multi-lane highway is 65 mph
- ***Change in speed zone boundary

LEGEND:

-  CITY LIMITS
-  RADAR ZONE
-  SURVEY STATION
-  OTHER STREET OR ROAD

FOX GLEN ROAD

(#1385)

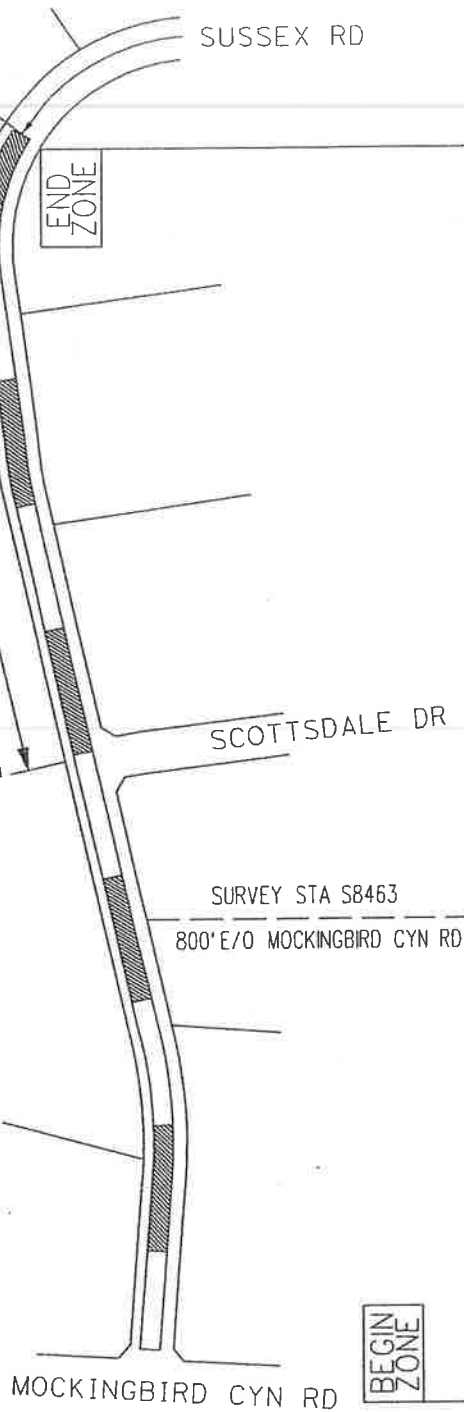

NO SCALE





RECOMMENDED SPEED LIMIT	35 MPH
PREVAILING SPEED (85%)	34 MPH
VEHICLES IN 24 HR (2 WAY)	325
SEGMENT LENGTH	0.3 MILE
ALL ACCIDENTS IN 2 YRS.	0
ACCIDENT RATE ☆	0.0 ACC/MVM
EXISTING SPEED LIMIT	40 MPH (Ord. 452.228 Sec. 2.4 No. 110)

☆ RATE = $\frac{\text{ACCIDENT} \times 1000000}{\text{VEH} \times 365 \times 2 \times \text{MILE}}$

COUNTY AREA:	LAKE MATHEWS	SURVEY DATE:	SEP 02, 2015
COUNTY MAP PAGE:	57-A	MAP DATE:	FEB 02, 2016
SUPERVISOR DISTRICT:	1/1	DRAWN BY:	J VALADEZ
		CAD FILE:	FOX GLEN.DGN

APPROVED BY: 
 DATE: 2/8/2016
 LAWRENCE T. TAI, P.E.
 COUNTY TRAFFIC ENGINEER

LEGEND:

-  CITY LIMITS
-  RADAR ZONE
-  SURVEY STATION
-  OTHER STREET OR ROAD
-  SCHOOL

BEGIN ZONE

MAYHEW CANYON ROAD

(#1455)

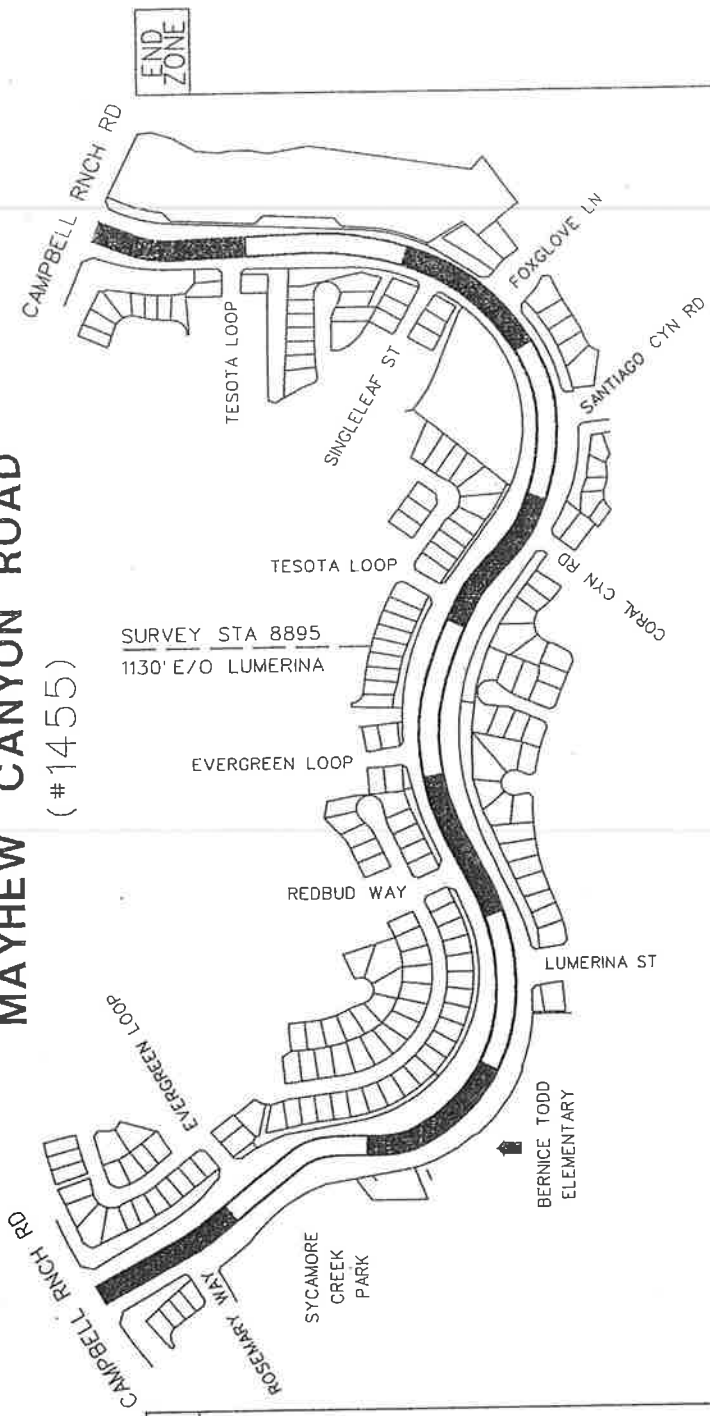

SURVEY STA 8895
1130' E/O LUMERINA

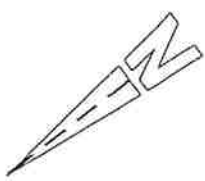

NO SCALE

RECOMMENDED SPEED LIMIT	35 MPH
85th%TILE SPEED / (50th%TILE SPEED)	39 MPH
VEHICLES IN 24 HR (2 WAY)	1420
SEGMENT LENGTH	1.2 MILE
ALL ACCIDENTS IN 2 YRS.	2
ACCIDENT RATE ☆	1.61 ACC/MVM
EXISTING SPEED LIMIT	40 MPH (Ord. 452.227 Sec. 2.4 No. 105)

☆ RATE - NO. OF ACCIDENT x 1000.000
VEH x 365 x 2 x MILE

SURVEY DATE: SEP 02, 2015
MAP DATE: JAN 27, 2016
DRAWN BY: J VALADEZ
CAD FILE: MAYHEW CYN.DGN

APPROVED BY: 
DATE: 2/17/2016
LAWRENCE T. TAI, P.E.
COUNTY TRAFFIC ENGINEER

SKYLARK DRIVE (#1566)

- LEGEND:
- CITY LIMITS
 - RADAR ZONE
 - SURVEY STATION
 - OTHER STREET OR ROAD

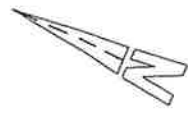
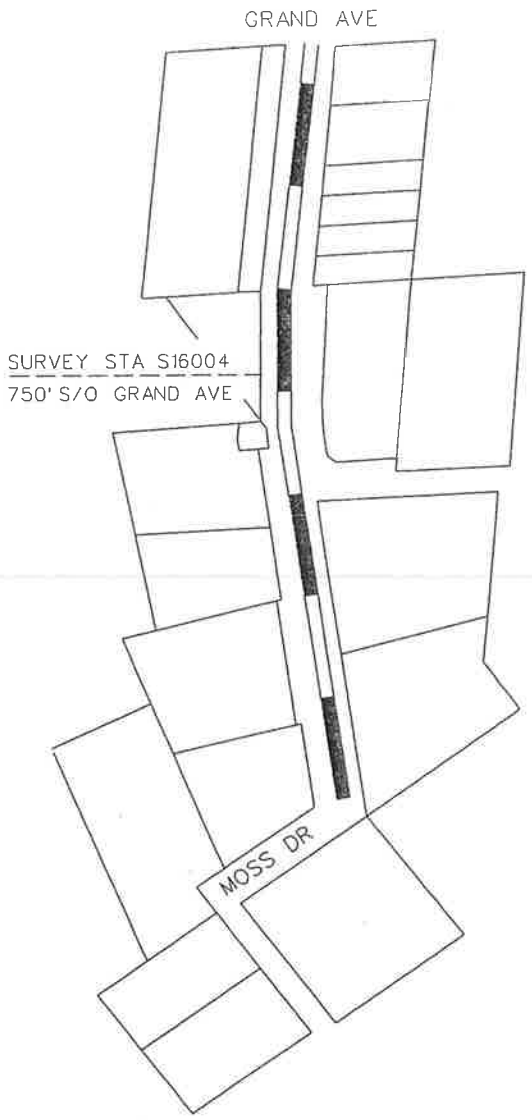

BEGIN ZONE

END ZONE

NO SCALE

RECOMMENDED SPEED LIMIT	30 MPH
85th% TILE SPEED	29 MPH
VEHICLES IN 24 HR (2 WAY)	240
SEGMENT LENGTH	0.34 MILE
ALL ACCIDENTS IN 2 YRS.	0
ACCIDENT RATE ☆	0.00 ACC/MVM
EXISTING SPEED LIMIT	NOT POSTED

☆ RATE = $\frac{\text{NO. OF ACCIDENT} \times 1,000,000}{\text{VEH} \times 365 \times 2 \times \text{MILE}}$

SURVEY DATE:	DEC 1, 2015
MAP DATE:	MAR 24, 2016
DRAWN BY:	S VENEGAS
CAD FILE:	SKYLARK DR.DGN

APPROVED BY:

 DATE: 4/12/16
 LAWRENCE T. TAI, P.E.
 COUNTY TRAFFIC ENGINEER

COUNTY OF RIVERSIDE
 TRANSPORTATION DEPARTMENT
 TRAFFIC ENGINEERING DIVISION
 ENGINEERING AND TRAFFIC SURVEY
 AT
SKYLARK DRIVE

LEGEND:

- ////// CITY LIMITS
- ▬ RADAR ZONE
- - - SURVEY STATION
- ▬▬ OTHER STREET OR ROAD
- ↑ SCHOOL

WOOD ROAD

(#1043)

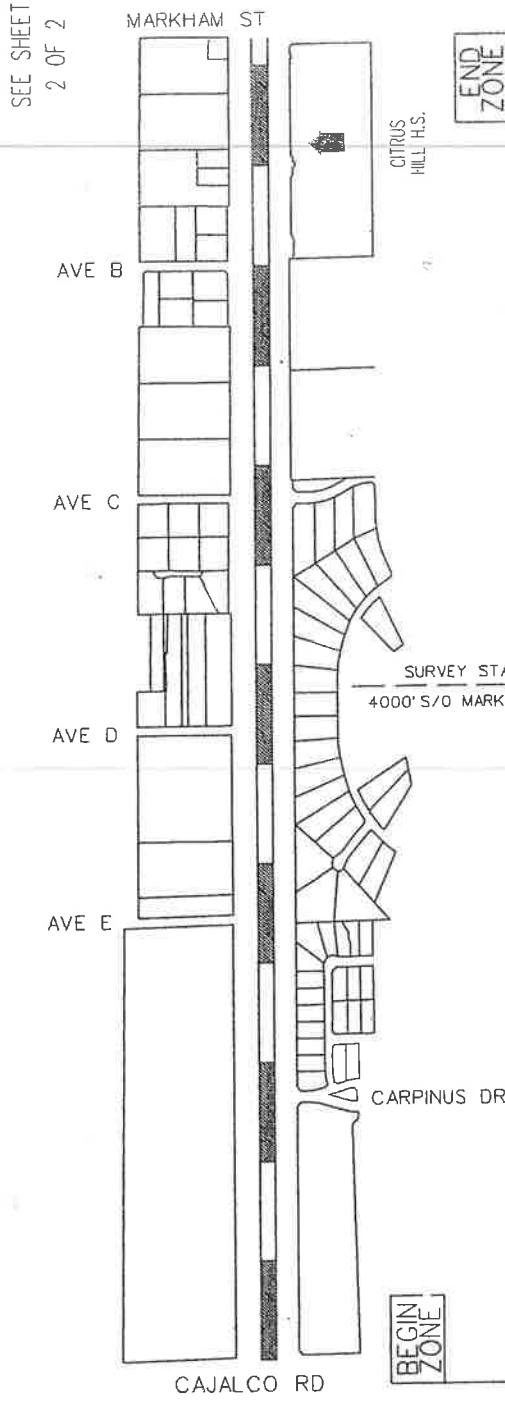

RECOMMENDED SPEED LIMIT	50 MPH
85th/TILE SPEED	52.0 MPH
VEHICLES IN 24 HR (2 WAY)	6,440
SEGMENT LENGTH	1.5 MILE
ALL ACCIDENTS IN 2 YRS.	3
ACCIDENT RATE ☆	1.06 ACC/MVM
EXISTING SPEED LIMIT	50 MPH (Ord. 452.227 Sec. 2.6 No .64)

☆ RATE: NO. OF ACCIDENT x 1000.000
VEH x 365 x 2 x MILE

SURVEY DATE: MAR, 20, 2013
 MAP DATE: FEB 17, 2016
 DRAWN BY: J VALADEZ
 CAD FILE: WOOD.DGN

APPROVED BY: *Lawrence T. Tai*
 DATE: 2/22/2016
LAWRENCE T. TAI, P.E.
 COUNTY TRAFFIC ENGINEER

COUNTY OF RIVERSIDE
TRANSPORTATION DEPARTMENT
 TRAFFIC ENGINEERING DIVISION





ENGINEERING AND TRAFFIC SURVEY
 AT
WOOD ROAD

PAGE 1 OF 2

WOOD ROAD

(#1043)

LEGEND:

-  CITY LIMITS
-  RADAR ZONE
-  SURVEY STATION
-  OTHER STREET OR ROAD

SURVEY STA S8547
410' S/O NEWMAN AVE

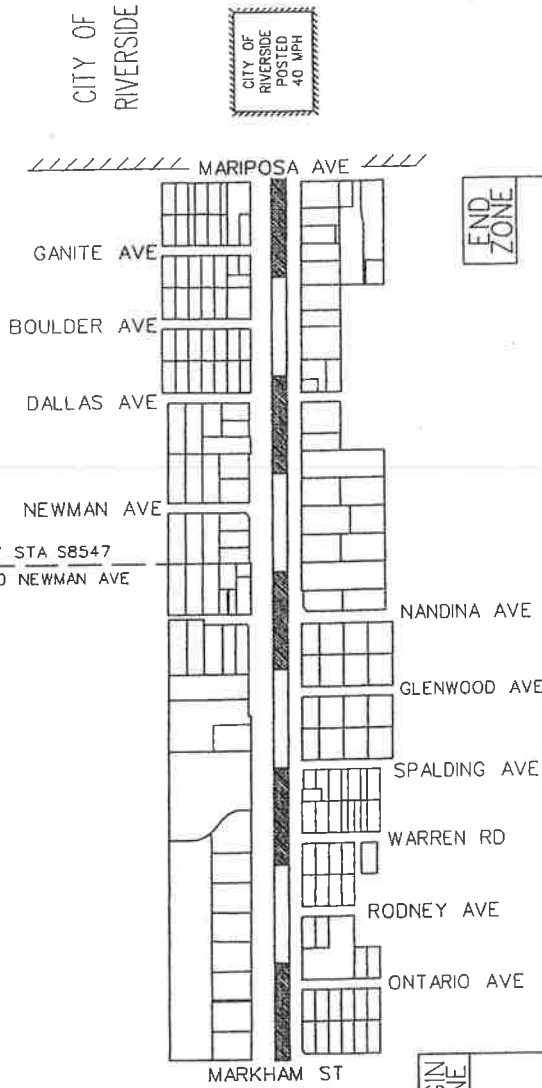

SEE SHEET
1 OF 2



NO SCALE

BEGIN ZONE

END ZONE

RECOMMENDED SPEED LIMIT	45 MPH
85th:7ILE SPEED	49.9 MPH
VEHICLES IN 24 HR (2 WAY)	5,290
SEGMENT LENGTH	1.0 MILE
ALL ACCIDENTS IN 2 YRS.	2
ACCIDENT RATE ☆	0.52 ACC/MVM
EXISTING SPEED LIMIT	50 MPH (Ord. 452.227 Sec. 2.6 No .64)

☆ RATE - NO. OF ACCIDENT x 1,000,000
VEH x 365 x 2 x MILE

APPROVED BY: *Lawrence T. Tai*
DATE: 2/22/2016
LAWRENCE T. TAI, P.E.
COUNTY TRAFFIC ENGINEER

SURVEY DATE: JAN 28, 2016
MAP DATE: FEB 17, 2016
DRAWN BY: J VALADEZ
CAD FILE: WOOD.DGN

COUNTY AREA: WOODCREST
COUNTY MAP: 54
SUPERVISOR DISTRICT: 1/1



COUNTY OF RIVERSIDE
TRANSPORTATION DEPARTMENT
TRAFFIC ENGINEERING DIVISION

ENGINEERING AND TRAFFIC SURVEY
AT

WOOD ROAD

PAGE
2 OF 2

BRIGGS ROAD (#1513)

- LEGEND:
- CITY LIMITS
 - RADAR ZONE
 - SURVEY STATION
 - OTHER STREET OR ROAD
 - RAILROAD

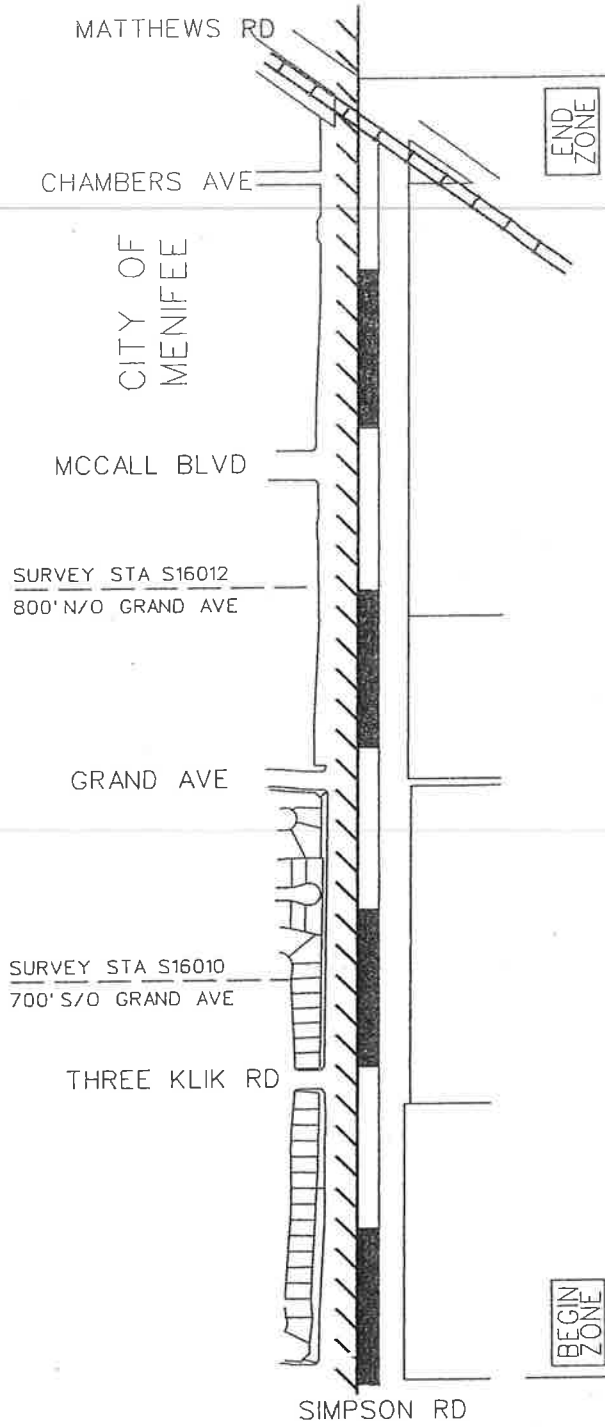

RECOMMENDED SPEED LIMIT	45 MPH
85th% TILE SPEED	48.5 MPH (AVERAGE OF TWO SIMILAR SEGMENTS OF 48 & 49 MPH)
VEHICLES IN 24 HR (2 WAY)	2,100
SEGMENT LENGTH	1.1 MILE
ALL ACCIDENTS IN 2 YRS.	0
ACCIDENT RATE ☆	0.00 ACC/MVM
EXISTING SPEED LIMIT	NOT POSTED

☆ RATE: $\frac{\text{NO. OF ACCIDENT} \times 1,000,000}{\text{VEH} \times 365 \times 2 \times \text{MILE}}$

SURVEY DATE:	DEC 10, 2015
MAP DATE:	FEB 05, 2016
DRAWN BY:	J VALADEZ
CAD FILE:	BRIGGS RD.DGN

APPROVED BY: *Lawrence T. Tai*
 DATE: 2/23/2016
 LAWRENCE T. TAI, P.E.
 COUNTY TRAFFIC ENGINEER

52ND AVENUE

(#1413)

CITY OF INDIO

- LEGEND:**
-  CITY LIMITS
 -  RADAR ZONE
 -  SURVEY STATION
 -  OTHER STREET OR ROAD

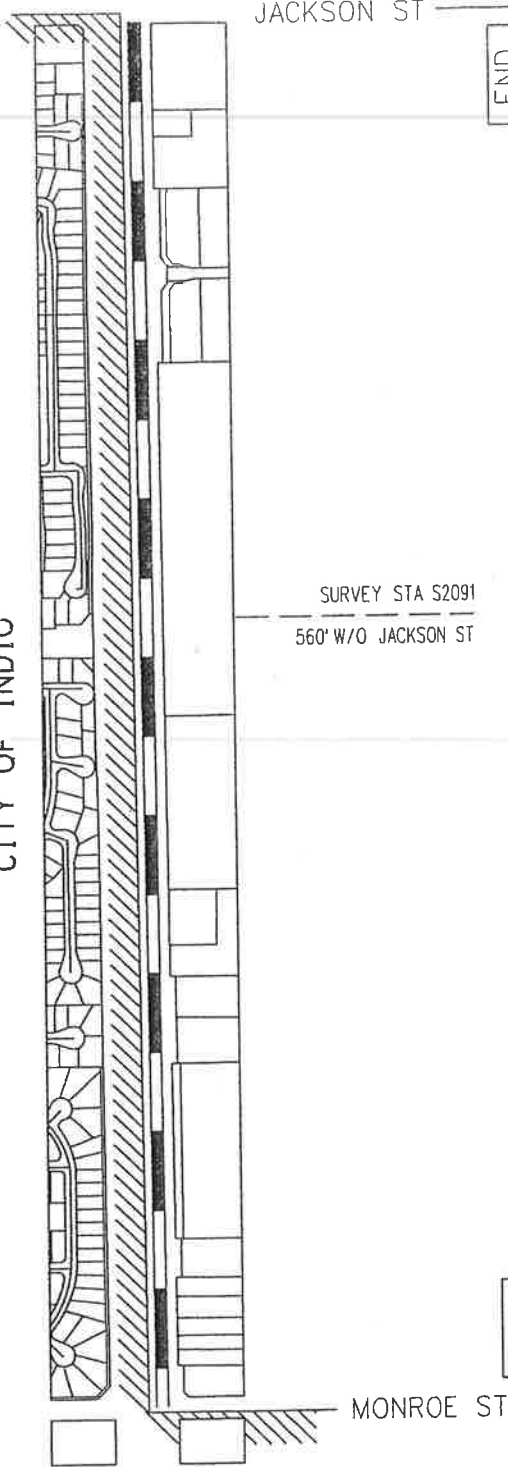

BEGIN ZONE

END ZONE

NO SCALE

RECOMMENDED SPEED LIMIT	55 MPH
PREVAILING SPEED (85%)	55 MPH
VEHICLES IN 24 HR (2 WAY)	7,380
SEGMENT LENGTH	1.0 MILE
ALL ACCIDENTS IN 2 YRS.	1 (CITY DATA NOT INCLUDED)
ACCIDENT RATE ☆	0.19 ACC/MVM
EXISTING SPEED LIMIT	50 MPH (Ord. 452.222 Sec. 2.6 No. 50)

☆ RATE = $\frac{\text{ACCIDENT} \times 1,000,000}{\text{VEH} \times 365 \times 2 \times \text{MILE}}$

APPROVED BY: 
 DATE: 12/21/2015
LAWRENCE T. TAI, P.E.
 COUNTY TRAFFIC ENGINEER

SURVEY DATE:	DEC 17, 2015
MAP DATE:	DEC 21, 2015
DRAWN BY:	J VALADEZ
CAD FILE:	52NDAVE.DGN

COUNTY AREA:	INDIO
COUNTY MAP PAGE:	218
SUPERVISOR DISTRICT:	4/4

LEGEND:

- ////// CITY LIMITS
- ▬ RADAR ZONE
- - - RADAR SURVEY STATION
- ▬▬▬ OTHER STREET OR ROAD

CAT CANYON RD
 (#1387)

STA S899
 690' N/O CAHUILLA WAY

CHOLLA WAY

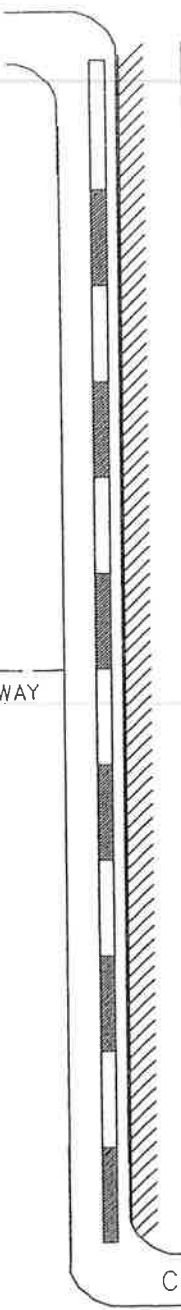

CITY OF PALM DESERT



NO SCALE

RECOMMENDED SPEED LIMIT	40 MPH
PREVAILING SPEED (85%)	41 MPH
VEHICLES IN 24 HR (2 WAY)	830
SEGMENT LENGTH	0.25 MILE
SPEED ACCIDENTS IN 2 YRS.	0
ACCIDENT RATE ☆	0.00 ACC/MVM
PRIOR POSTED LIMIT	35 MPH (Ord. 452:223 Sec. 2.3 No. 87)

☆ RATE = $\frac{\text{ACCIDENT} \times 1,000,000}{\text{VEH} \times 365 \times 2 \times \text{MILE}}$

COUNTY AREA:	PALM DESERT	SURVEY DATE:	DEC 15, 2015
COUNTY MAP:	191	MAP DATE:	JAN 28, 2016
SUPERVISOR DISTRICT:	4/4	DRAWN BY:	J VALADEZ
		CAD FILE:	CATCANYON.DGN

APPROVED BY: *Lawrence T. Tai, P.E.*
 DATE: 2/1/2016
 LAWRENCE T. TAI, P.E.
 COUNTY TRAFFIC ENGINEER

PIERSON BOULEVARD

(#1375)

- LEGEND:**
- CITY LIMITS
 - RADAR ZONE
 - SURVEY STATION
 - OTHER STREET OR ROAD

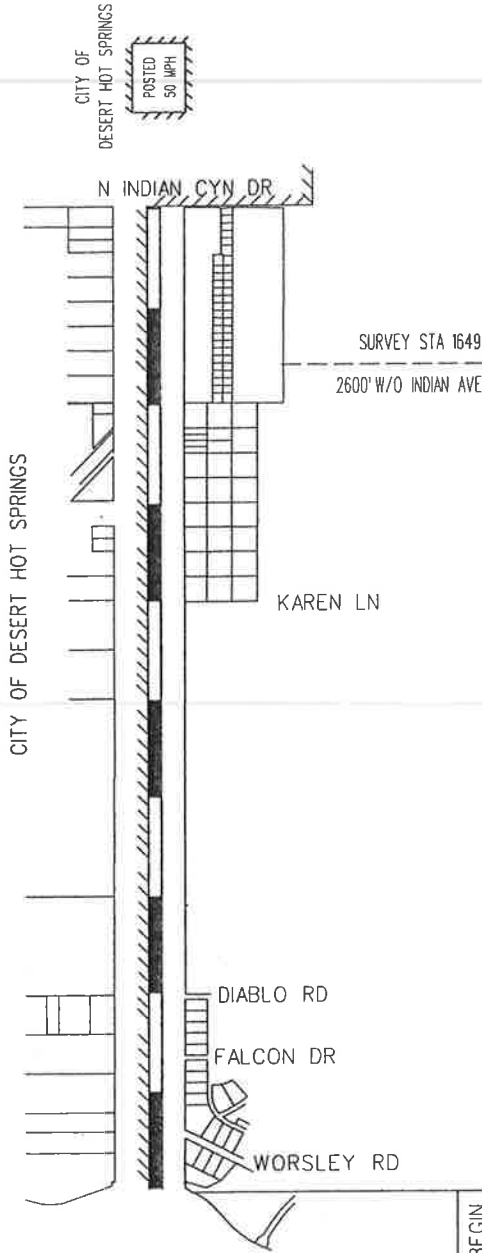

BEGIN ZONE

END ZONE

* MAX SPEED CVC 22349

RECOMMENDED SPEED LIMIT	* 55 MPH
PREVAILING SPEED (85%)	58 MPH
VEHICLES IN 24 HR (2 WAY)	2,490
SEGMENT LENGTH	2.8 MILE
ALL ACCIDENTS IN 2 YRS.	0
ACCIDENT RATE ☆	0.00 ACC/MVM
EXISTING SPEED LIMIT	* 55 MPH

☆ RATE = $\frac{\text{ACCIDENT} \times 1,000,000}{\text{VEH} \times 365 \times 2 \times \text{MILE}}$





APPROVED BY: *Lawrence T. Tai, P.E.*
 LAWRENCE T. TAI, P.E.
 COUNTY TRAFFIC ENGINEER
 DATE: 4/28/2016

SURVEY DATE: JAN 14, 2016
 MAP DATE: APR 19, 2016
 DRAWN BY: J VALADEZ
 CAD FILE: PIERSON.DGN

COUNTY AREA: DESERT HOT SPRINGS
 COUNTY MAP PAGE: 166 & 167B
 SUPERVISOR DISTRICT: 5/5, 5/4

COUNTY OF RIVERSIDE
 TRANSPORTATION DEPARTMENT
 TRAFFIC ENGINEERING SECTION
 ENGINEERING AND TRAFFIC SURVEY
 AT
PIERSON BLVD

LEGEND:

-  CITY LIMITS
-  RADAR ZONE
-  SURVEY STATION
-  OTHER STREET OR ROAD
-  RAILROAD



NO SCALE

BRIGGS ROAD (#1513)

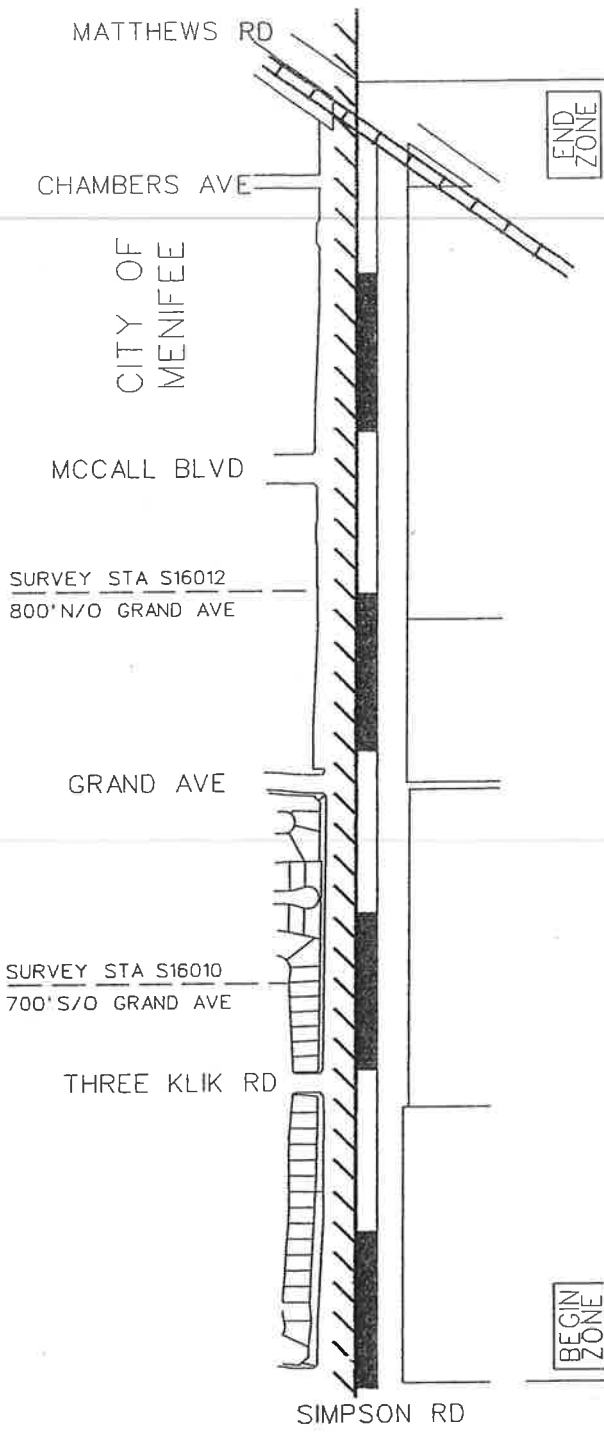

RECOMMENDED SPEED LIMIT	45 MPH
85th/TILE SPEED	48.5 MPH (AVERAGE OF TWO SIMILAR SEGMENTS OF 48 & 49 MPH)
VEHICLES IN 24 HR (2 WAY)	2,100
SEGMENT LENGTH	1.1 MILE
ALL ACCIDENTS IN 2 YRS.	0
ACCIDENT RATE ☆	0.00 ACC/MVM
EXISTING SPEED LIMIT	NOT POSTED

☆ RATE: $\frac{\text{NO. OF ACCIDENT} \times 1,000,000}{\text{VEH} \times 365 \times 2 \times \text{MILE}}$

COUNTY AREA:	MENIFEE	SURVEY DATE:	DEC 10, 2015
COUNTY MAP:	113	MAP DATE:	FEB 05, 2016
SUPERVISOR DISTRICT:	3/5, 3/3	DRAWN BY:	J VALADEZ
		CAD FILE:	BRIGGS RD.DGN

APPROVED BY: *Lawrence T. Tai*
 DATE: 2/22/2016
 LAWRENCE T. TAI, P.E.
 COUNTY TRAFFIC ENGINEER

COUNTY OF RIVERSIDE
 TRANSPORTATION DEPARTMENT
 TRAFFIC ENGINEERING DIVISION
 ENGINEERING AND TRAFFIC SURVEY
 AT
BRIGGS ROAD

MISSION LAKES BOULEVARD

(# 1432)

LEGEND:

- ////// CITY LIMITS
- ▬ RADAR ZONE
- - - RADAR SURVEY STATION
- ==== OTHER STREET OR ROAD

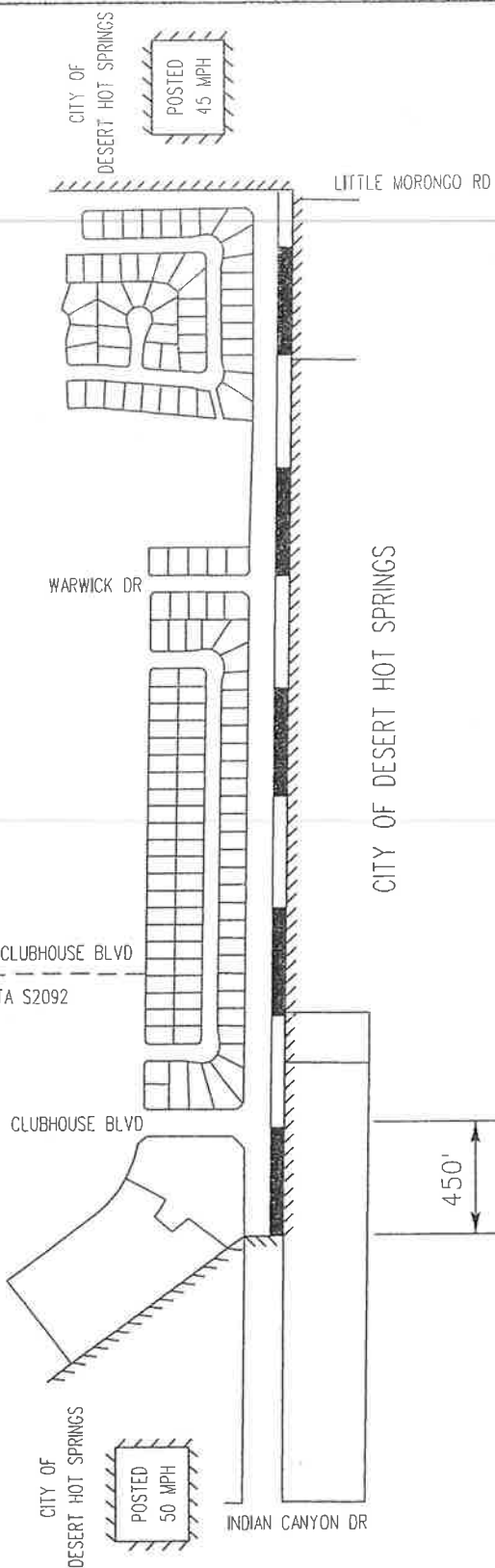

NO SCALE

RECOMMENDED SPEED LIMIT	50 MPH
PREVAILING SPEED (85%)	48 MPH
VEHICLES IN 24 HR (2 WAY)	3,110
SEGMENT LENGTH	0.79 MI
ALL ACCIDENTS IN 2 YRS.	1
ACCIDENT RATE ☆	0.56 ACC/MVM
EXISTING SPEED LIMIT	50 MPH (Ord. 452.223 Sec. 2.6 No. 51)

BEGIN ZONE

END ZONE





☆ RATE - ACCIDENT x 1,000,000
VEH x 365 x 2YR x MILE

SURVEY DATE:	JAN 14, 2016
MAP DATE:	MAR 29, 2016
DRAWN BY:	J VALADEZ
CAD FILE:	MISSIONLAKES.DGN

APPROVED BY:
Lawrence T. Talpe
LAWRENCE T. TALPE,
COUNTY TRAFFIC ENGINEER
DATE: 4/1/2016

COUNTY OF RIVERSIDE TRANSPORTATION DEPARTMENT TRAFFIC ENGINEERING DIVISION	PAGE 1 OF 1
ENGINEERING AND TRAFFIC SURVEY AT MISSION LAKES BLVD	

LEGEND:

-  CITY LIMITS
-  RADAR ZONE
-  SURVEY STATION
-  OTHER STREET OR ROAD

PIERSON BOULEVARD (#1375)

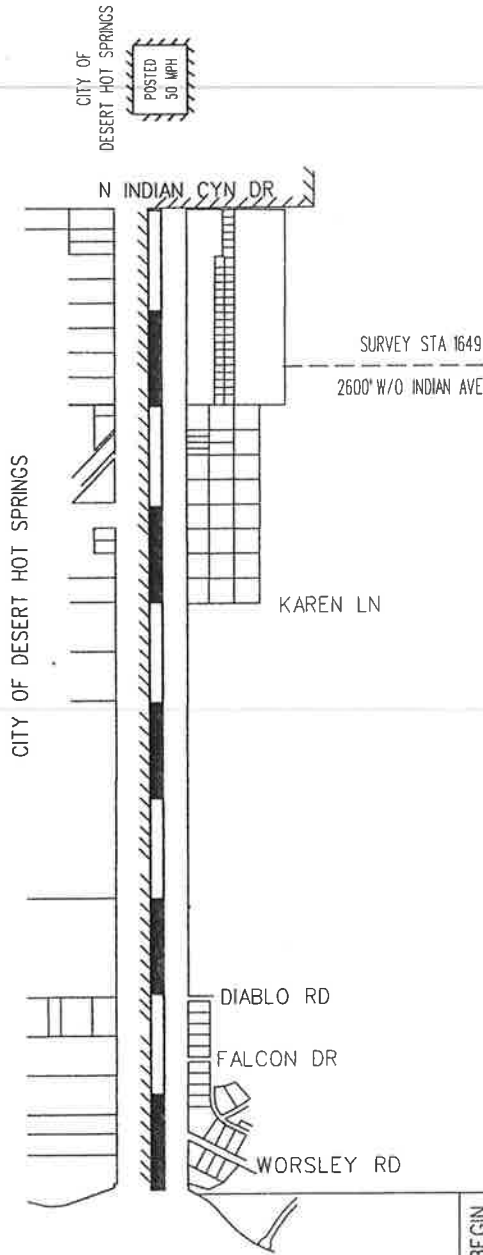

NO SCALE

* MAX SPEED CVC 22349

RECOMMENDED SPEED LIMIT	* 55 MPH
PREVAILING SPEED (85%)	58 MPH
VEHICLES IN 24 HR (2 WAY)	2,490
SEGMENT LENGTH	2.8 MILE
ALL ACCIDENTS IN 2 YRS.	0
ACCIDENT RATE ☆	0.00 ACC/MVM
EXISTING SPEED LIMIT	* 55 MPH

END ZONE

BEGIN ZONE

☆ RATE = $\frac{\text{ACCIDENT} \times 1,000,000}{\text{VEH} \times 365 \times 2 \times \text{MILE}}$

		COUNTY OF RIVERSIDE TRANSPORTATION DEPARTMENT TRAFFIC ENGINEERING SECTION	PAGE 10F 1
		ENGINEERING AND TRAFFIC SURVEY AT PIERSON BLVD	
APPROVED BY:			
SURVEY DATE:	JAN 14, 2016	DATE:	7/25/2016
MAP DATE:	APR 19, 2016	DRAWN BY:	J VALADEZ
COUNTY AREA:	DESERT HOT SPRINGS	CAD FILE:	PIERSON.DGN
COUNTY MAP PAGE:	166 & 167B	SUPERVISOR DISTRICT:	5/5, 5/4
SUPERVISOR DISTRICT:	5/5, 5/4	COUNTY TRAFFIC ENGINEER:	LAWRENCE T. TAI, P.E.