

SUBMITTAL TO THE BOARD OF SUPERVISORS
COUNTY OF RIVERSIDE, STATE OF CALIFORNIA

601 B

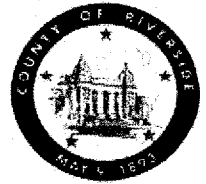

FROM: TLMA - Transportation Department

SUBMITTAL DATE:
December 29, 2009

SUBJECT: Summarily vacating the right to accept a portion of Burch Street, in the Mead Valley area, First Supervisorial District.

RECOMMENDED MOTION: Adopt Resolution No. 2010-007, summarily vacating the right to accept a portion of Burch Street.

BACKGROUND: EDA and the Transportation Department joined together in a cooperative effort to improve and bring into the County Maintained Road System many streets in the Mead Valley area. Burch Street needed to be realigned to eliminate small portions of property that were unusable by the adjacent property owners. A mutual agreement with the property owners was reached to realign the road, and the new alignment was dedicated by the property owners and accepted by the County. Per the agreement the excess right-of-way on Burch Street would be vacated by the County upon completion of the construction and acceptance of the new alignment. This resolution vacating the excess right-of-way completes the agreement.

Juan C. Perez
Director of Transportation

WJH
Attachments: Resolution No. 2010-007
Exhibit "A"

MINUTES OF THE BOARD OF SUPERVISORS

On motion of Supervisor Ashley, seconded by Supervisor Buster and duly carried by unanimous vote, IT WAS ORDERED that the above matter is approved as recommended.

Ayes: Buster, Tavaglione, Stone, Benoit and Ashley
Nays: None
Absent: None
Date: January 12, 2010
xc: Transp., Recorder

Kecia Harper-Ihem
Clerk of the Board
By:
Deputy

Prev. Agn. Ref.

District: 1

Agenda Number:

2.8

REVIEWED BY EXECUTIVE OFFICE

DATE

Tina Grande

Concurrence

FORM APPROVED COUNTY COUNSEL

BY:

SYNTHIA M. GUNZEL

DATE

☐ Policy

☒ Consent

Dep't Recomm.:

☐ Policy

☒ Consent

Per Exec. Ofc.:

VICINITY MAP



N.T.S.
T. 4S, R. 4W
SECTION 4
SBM

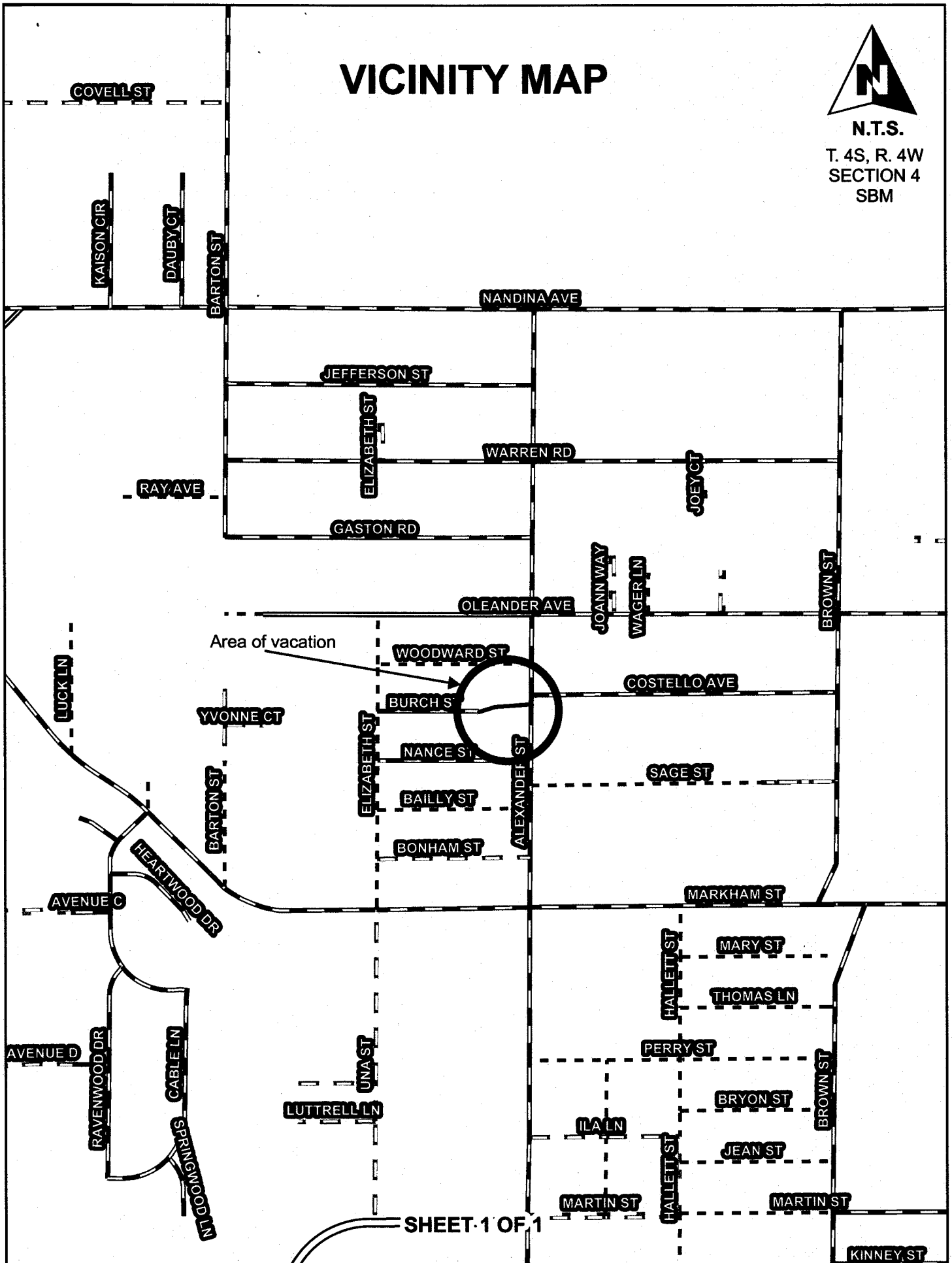

To be removed before recording

PLEASE COMPLETE THIS INFORMATION

RECORDING REQUESTED BY:

KECIA HARPER-IHEM, CLERK OF THE BOARD
RIVERSIDE CO. CLERK OF THE BOARD
4080 LEMON STREET, 1ST FLOOR CAC
P O BOX 1147 – RIVERSIDE, CA 92502

MAIL STOP # 1010

AND WHEN RECORDED MAIL TO:

RETURN TO: STOP #1010
RIVERSIDE COUNTY CLERK OF THE BOARD
P. O. BOX 1147 – RIVERSIDE, CA 92502

DOC # 2010-0056941
02/08/2010

Customer Copy Label
The paper to which this label is
affixed has not been compared
with the recorded document

Larry W Ward
County of Riverside
Assessor, County Clerk & Recorder

THIS SPACE FOR RECORDERS USE ONLY

RESOLUTION NO. 2010-007

Title of Document

SUMMARILY VACATING THE RIGHT TO ACCEPT A PORTION OF
BURCH STREET, IN THE MEAD VALLEY AREA
(AB 09015)

(FIRST SUPERVISORIAL DISTRICT)

(Transportation Department ~ Item 2.8 of 01/12/10)

THIS PAGE ADDED TO PROVIDE ADEQUATE SPACE
FOR RECORDING INFORMATION

COPY

2
3
4 **RESOLUTION NO. 2010-007**

5 SUMMARILY VACATING THE RIGHT TO ACCEPT A PORTION OF
6 BURCH STREET, IN THE MEAD VALLEY AREA

7 (AB 09015)

8 (First Supervisorial District)

9
10 **WHEREAS**, the hereinafter-described, Burch Street, described in Instrument
11 No. 121276, Recorded October 2, 1975, Official Records of Riverside County,
12 California.

13
14 **WHEREAS**, The offer of dedication of Burch Street has not been accepted by
15 the County of Riverside and;

16
17 **WHEREAS**, the hereinafter-described Burch Street is not necessary and is
18 excess Right of Way, and not required for public street or highway purposes, now,
19 therefore;

20
21 **BE IT RESOLVED, DETERMINED AND ORDERED** by the Board of
22 Supervisors of the County of Riverside, State of California, in regular session
23 assembled on January 12, 2010, as follows;

FORM APPROVED COUNTY COUNSEL
BY: Synthia M. Gunzel 12-28-09 DATE
SYNTHIA M. GUNZEL

1 **RESOLUTION NO. 2010-007**

2
3 1. Pursuant to Section 8334(a) of the Streets and Highways Code that the hereinafter-
4 described Burch Street is excess Right-of-Way, is no longer required for public street
5 and highway purposes and is hereby summarily vacated.

6
7 2. That the herein-described Burch Street is unnecessary for present or prospective
8 public use, including use as a non-motorized transportation facility. Said road is in the
9 County of Riverside, State of California and is described as follows;

10
11 **Burch Street** (see Exhibit "A") All of that Declaration of Dedication, Recorded
12 as Instrument No. 121276 on October 2, 1975, Official Records of Riverside County,
13 California.

14
15 **EXCEPTING AND RESERVING** from the vacation an easement for any existing
16 public utilities and public service facilities, together with the right to maintain, operate,
17 replace, remove, or renew such facilities, pursuant to section 8340 of the Streets and
18 Highways Code.

1 **RESOLUTION NO. 2010-007**

2
3 **BE IT FURTHER RESOLVED, DETERMINED AND ORDERED** that the Clerk
4 of the Board is directed to cause a certified copy of this resolution to be recorded in
5 the office of the Recorder of the County of Riverside, California.

6
7 **ROLL CALL:**

8 **Ayes:** Buster, Tavaglione, Stone, Benoit, and Ashley
9 **Nays:** None
10 **Absent:** None

11 The foregoing is certified to be a true copy of a resolution duly
12 adopted by said Board of Supervisors on the date therein set forth.

13 **KECIA HARPER-IHEM, Clerk of said Board**

14 By: *Samuel Thummet*
15 Deputy

16
17
18
19
20
21
22
23
24 **WJH**

25 **W.O. # B8-06947G**

WOODWARD STREET

EXHIBIT "A"



N.T.S.
T. 4S, R. 4W
SECTION 4
SBM

Vacation of the right to accept a portion of Birch Street

LOT 17

LOT 18

MB 17/75

Vacating
Instrument #121276
Recorded 10/2/1975

LOT 19

LOT 20

BURCH STREET

60.00'

60.00'

30.00'

C/L

ALEXANDER STREET

Dedicated and Accepted per
Instrument No. 2009-0056120
recorded 2/05/2009

Dedicated and Accepted Per
Instrument No. 2009-0056121
recorded 2/05/2009

LOT 29

LOT 30



**LARRY W. WARD
COUNTY OF RIVERSIDE
ASSESSOR-COUNTY CLERK-RECORDER**

Recorder
P.O. Box 751
Riverside, CA 92502-0751
(951) 486-7000

<http://riverside.asrcilkrec.com>

CERTIFICATION

Pursuant to the provisions of Government Code 27361.7, I certify under the penalty of perjury that the following is a true copy of illegible wording found in the attached document:

(Print or type the page number(s) and wording below):

CLARIFICATION OF THE SEAL for the Riverside County Board of Supervisors
(embossed on document)



Date:

1-12-10

Signature:

Sandi Schlemmer

Print Name:

Sandi Schlemmer, Deputy Clerk - Riverside County Clerk of the Board