

**SUBMITTAL TO THE BOARD OF SUPERVISORS
COUNTY OF RIVERSIDE, STATE OF CALIFORNIA**

105B



FROM: County Counsel/TLMA
Code Enforcement Department

SUBJECT: Abatement of Public Nuisance [Accumulation of Rubbish];
Case No.: CV 09-04756
Subject Property: 22841 Fisher Road, Perris;
APN: 325-200-042
District Five

SUBMITTAL DATE:
January 13, 2010

RECOMMENDED MOTION: Move that:

- (1) The accumulation of rubbish on the real property located at 22841 Fisher Street, Perris, Riverside County, California, APN: 325-200-042, be declared a public nuisance and a violation of Riverside County Ordinance No. 541 which does not permit the accumulation of rubbish on the property.
- (2) Owner Rita Nauta Alig, or whoever has possession and control of the subject real property, be directed to abate the accumulation of rubbish on the property by removing and disposing of the same from the real property within ninety (90) days.

(Continued)

[Signature]
JULIE JARVI, Deputy County Counsel
for PAMELA J. WALLS, County Counsel

FINANCIAL DATA	Current F.Y. Total Cost:	\$ N/A	In Current Year Budget:	N/A
	Current F.Y. Net County Cost:	\$ N/A	Budget Adjustment:	N/A
	Annual Net County Cost:	\$ N/A	For Fiscal Year:	N/A

SOURCE OF FUNDS:	Positions To Be Deleted Per A-30	<input type="checkbox"/>
	Requires 4/5 Vote	<input type="checkbox"/>

C.E.O. RECOMMENDATION:

APPROVE

BY: *[Signature]*
Alex Gann

County Executive Office Signature

MINUTES OF THE BOARD OF SUPERVISORS

On motion of Supervisor Stone, seconded by Supervisor Buster and duly carried, IT WAS ORDERED that the above matter is approved as recommended.

Ayes: Buster, Stone, Benoit and Ashley
Nays: None
Absent: Tavaglione
Date: January 26, 2010
xc: Co.Co., CED, Sheriff, Prop. Owner

Kecia Harper-Ihem
Clerk of the Board
By: *[Signature]*
Deputy

Prev. Agn. Ref.:

District: 5

Agenda Number:

9.4

Dep't Recomm.: ☒ Policy
Per Exec. Ofc.: ☐ Policy
Consent ☐ Consent ☐

- (3) If the owner or whoever has possession or control of the real property does not take the above described action within ninety (90) days of the date of the Board's Order to Abate, that representatives of the Code Enforcement Department, Sheriff's Department, and/or a contractor, upon consent of the owner or receipt of a Court Order authorizing entry onto the real property, when necessary under applicable law, shall abate the accumulation of rubbish by removing and disposing of the same from the real property.
- (4) The reasonable cost of abatement, after notice and an opportunity for hearing, shall be imposed as a lien on the real property, which may be collected as a special assessment against the real property pursuant to Government Code Section 25845 and Riverside County Ordinance No. 725.
- (5) County Counsel be directed to prepare the necessary Findings of Facts and Conclusions that the accumulation of rubbish on the real property is declared to be in violation of Riverside County Ordinance No. 541, and a public nuisance, and further, to prepare an Order to Abate for approval by the Board.

JUSTIFICATION:

1. An initial inspection was made of the subject real property by the Code Enforcement Officers on June 30, 2009. The inspection revealed the accumulation of rubbish on the subject property in violation of Riverside County Ordinance No. 541. The rubbish consisted of, but was not limited to: scrap wood, old furniture, trash, green waste, tires, and old clothes. There is approximately 150 tires on the property. The total square footage of rubbish on the property is 27,950, as measured by pace and fence post methods.
2. A subsequent inspection of the above-described real property on September 24, 2009 and December 30, 2009 revealed the property continues to be in violation of Riverside County Ordinance No. 541.
3. Staff and the Code Enforcement Department have complied with the requirements set forth in the appropriate laws of this jurisdiction pertaining to the administrative abatement proceedings for the removal of accumulated rubbish.

**BOARD OF SUPERVISORS
COUNTY OF RIVERSIDE**

IN RE ABATEMENT OF PUBLIC NUISANCE) CASE NO. CV 09-04756
[ACCUMULATION OF RUBBISH] APN: 325-)
200-042 22841 FISHER STREET, PERRIS,) DECLARATION OF CODE
COUNTY OF RIVERSIDE, STATE OF) ENFORCEMENT OFFICER
CALIFORNIA; RITA NAUTA ALIG, OWNER.) JENNIFER MORRIS
_____) [R.C.O. No. 541 (RCC Title 8.120)]
_____)
_____)
_____)

I, Jennifer Morris, declare that the facts set forth below are personally known to me except to the extent that certain information is based on information and belief which I believe to be true, and if called as a witness, I could and would competently testify thereto under oath:

1. I am currently employed by the Riverside County Code Enforcement Department as a Code Enforcement Officer. My current official duties as a Code Enforcement Officer include inspecting property for violations and enforcement of the provisions of Riverside County Ordinances.

2. I am informed and believe and thereon allege that on June 30, 2009, Code Enforcement Officer Richard Arriola conducted an initial inspection of the real property described as 22841 Fisher Street, Perris, Riverside County, California and further described as Assessor's Parcel Number 325-200-042 (hereinafter referred to as "THE PROPERTY"). A true and correct copy of a Thomas Brothers map indicating the location of THE PROPERTY is attached hereto as Exhibit "A" and incorporated herein by reference.

3. A review of County records and documents disclosed that THE PROPERTY was owned by Rita Nauta Alig (hereinafter referred to as the "OWNER"). Certified copies of the County Equalized Assessment Roll for the year 2008-2009 and County Geographic Information System ("GIS") report is attached hereto as Exhibit "B" and incorporated herein by reference.

4. Based on the Lot Book Report from RZ Title Service on July 2, 2009, it is determined that additional parties may potentially hold a legal interest in THE PROPERTY, to wit: Scott Edward Darling, Eastern Municipal Water District, and Alice Beasley (hereinafter collectively referred to as "INTERESTED PARTIES"). True and correct copies of the Lot Book Reports are attached hereto as Exhibit "C" and incorporated herein by this reference.

1 5. I am informed and believe and thereon allege that on June 30, 2009, Code Enforcement
2 Officer Richard Arriola conducted an initial inspection of THE PROPERTY. Officer Arriola observed
3 THE PROPERTY to be unimproved and abandoned. After breaking the lock at the front gate pursuant to
4 an inspection warrant, he entered onto THE PROPERTY and observed accumulation of rubbish
5 throughout THE PROPERTY consisting of but not limited to: scrap wood, old furniture, trash, green
6 waste, tires, and old clothes. Officer Arriola took measurements of the areas using the pacing method and
7 the fence post method. The following is a summary of the measured areas.

8 (a) Area #1 measured twenty-five (25) feet by thirty (30) feet, totaling seven hundred
9 and fifty (750) square feet.

10 (b) Area #2 measured seventy (70) feet by two hundred (200) feet, totaling fourteen
11 thousand (14,000) square feet.

12 (c) Area #3 measured ninety (90) feet by one hundred and twenty (120) feet, totaling
13 ten thousand and eight hundred (10,800) square feet.

14 (d) Area #4 measured thirty (30) feet by eighty (80) feet, totaling two thousand four
15 hundred (2,400) square feet.

16 Based on his training and experience, he determined that the amount of accumulated
17 rubbish on THE PROPERTY totaled twenty-seven thousand nine hundred fifty (27,950) square feet. He
18 posted a Notice of Violation on THE PROPERTY.

19 6. As a result of the accumulation of rubbish, THE PROPERTY constituted a public nuisance in
20 violation of the provisions set forth in Riverside County Ordinance No. 541, as codified in Riverside
21 County Code Title 8.120.

22 7. A site plan and photographs of THE PROPERTY are attached hereto and incorporated
23 herein by reference as Exhibit "D."

24 8. True and correct copies of each Notice issued in this matter and other supporting
25 documentation are attached hereto as Exhibit "E" and incorporated herein by reference.

26 9. On July 27, 2009 a Notice of Violation was mailed to OWNER by certified mail with
27 return receipt requested. On July 27, 2009 a Notice of Violation was mailed to INTERESTED PARTIES
28 by certified mail with return receipt requested.

1 10. On September 24, 2009, I conducted a follow-up inspection of THE PROPERTY. I
2 entered THE PROPERTY to make contact and found it was vacant and unoccupied. THE PROPERTY
3 was open, with No Trespassing signs directed at illegal dumpers. I observed the parcel remained covered
4 in rubbish, thus remaining in violation of Riverside County Ordinance No. 541.

5 11. Based upon my experience, knowledge and visual observations, it is my determination that
6 the conditions on THE PROPERTY are dangerous to the neighboring property owners and the general
7 public.

8 15. A Notice of Noncompliance regarding the accumulation of rubbish was recorded in the
9 Office of the Assessor, County Clerk & Recorder, County of Riverside, State of California, on July 28,
10 2009, as Instrument Number 2009-0400310. A true and correct copy of the notice is attached hereto and
11 incorporated herein by reference as Exhibit "F".

12 16. On December 30, 2009 the second notice, "Notice to Abate Public Nuisance" providing
13 notification of the Board of Supervisors' hearing scheduled for January 26, 2009, was mailed to OWNER
14 and INTERESTED PARTIES by certified mail, return receipt requested and on December 30, 2009 was
15 posted on THE PROPERTY. True and correct copies of the notice and supporting documentation are
16 attached hereto as Exhibit "G" and incorporated herein by reference.

17 17. A follow-up inspection on December 30, 2009 revealed that THE PROPERTY remains in
18 violation.

19 18. Removal of the accumulation of rubbish on THE PROPERTY is required to bring THE
20 PROPERTY into compliance with Riverside County Ordinance No. 541 (RCC Chapter 8.120) and the
21 Health and Safety Code. Under RCO No. 541, no amount of rubbish is allowed to accumulate on THE
22 PROPERTY.

23 19. The Board of Supervisors is requested to issue an Order to Abate the Nuisance described
24 herein. Accordingly, the following findings and conclusions are recommended:

25 (a) the accumulation of rubbish on THE PROPERTY to be deemed and declared a
26 public nuisance;

27 (b) the OWNER and person(s) in possession of THE PROPERTY be required to
28 remove all accumulated rubbish within ten (10) days of the date of the posting and mailing of the

1 Board's Order to Abate Nuisance, in accordance with all Riverside County Ordinances, including but not
2 limited to the provisions of County Ordinance No. 541;

3 (c) in the event the rubbish is not removed and disposed of according to the above
4 referenced ninety (90) day time period in strict accordance with all Riverside County Ordinances,
5 including but not limited to Riverside County Ordinance No. 541 (RCC Chapter 8.120), the rubbish shall
6 be abated by representatives of the Riverside County Code Enforcement Department, a contractor or the
7 Sheriff's Department; and

8 (d) reasonable costs of abatement, after notice and opportunity for hearing, shall be
9 imposed as a lien on THE PROPERTY, which may be collected as a special assessment against THE
10 PROPERTY pursuant to Government Code Section 25845 and Riverside County Ordinance Nos. 541
11 (RCC Title 8.120) and 725 (RCC Title 1).

12 I declare under penalty of perjury under the laws of the State of California that the foregoing is
13 true and correct.

14 Executed this 30th day of December, 2009, at Riverside, California.

15
16 
17 JENNIFER MORRIS

18 Code Enforcement Officer
19 Code Enforcement Department
20
21
22
23
24
25
26
27
28

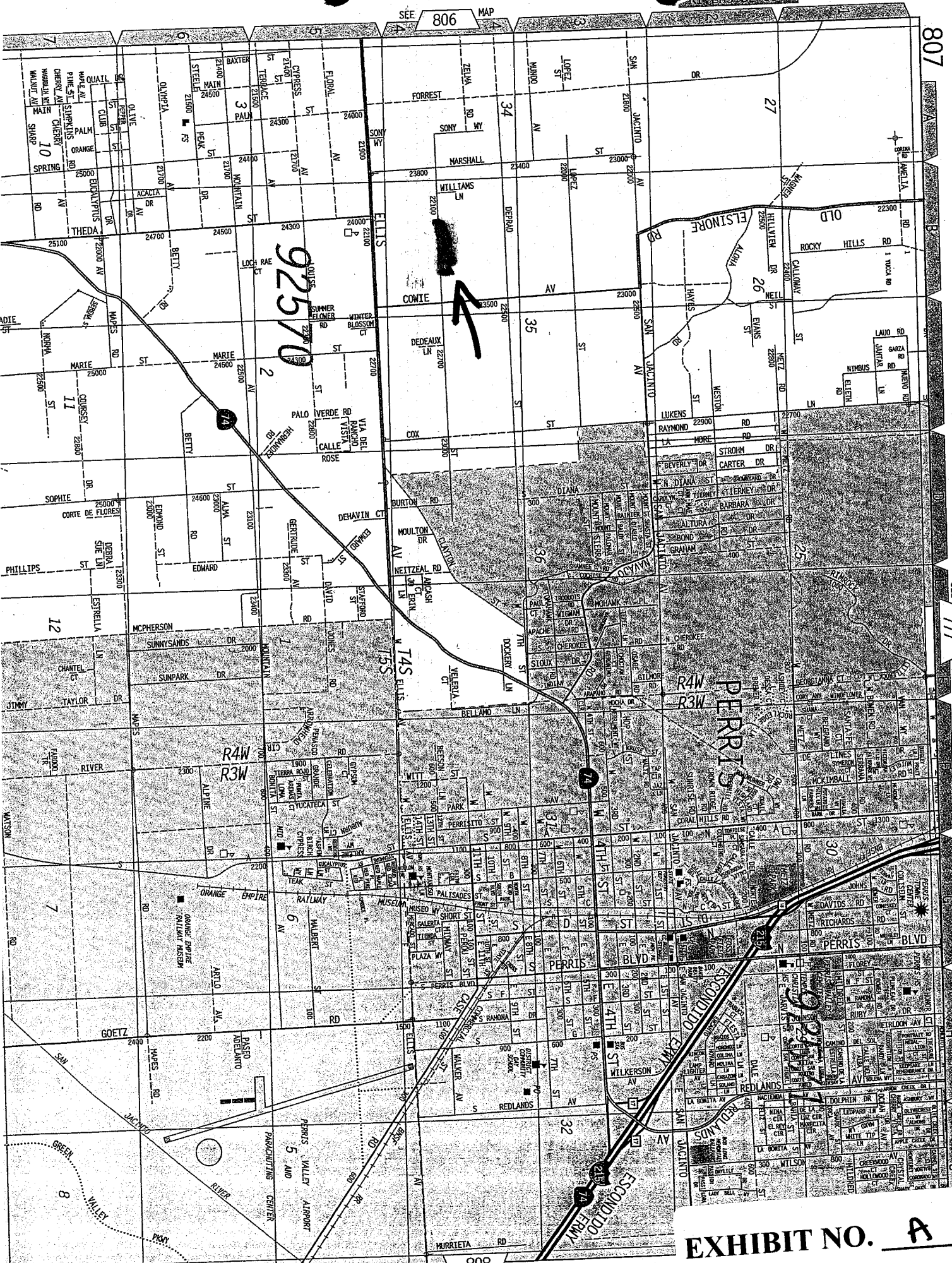

EXHIBIT NO. A

Assessment Roll For the 2009-2010 Tax Year as of January 1,2009

Assessment #325200042-0

Parcel # 325200042-0

Assessee: ALIG RITA NAUTA
Mail Address: 22841 FISHER RD PERRIS
 CA 92570
Real Property Use Code: MR
Base Year 1976
Conveyance Number: 0295543
Conveyance (mm/yy): 6/2001
PUI: M010000
TRA: 87-008
Taxability Code: 0-00
ID Data: Lot 102 RS 026/001
Situs Address: 22841 FISHER RD PERRIS
 CA 92570

Land 9,436
Structure 1,775
Full Value 11,211
Homeowners' Exemption 7,000
Total Net 4,211

[View Parcel Map](#)

This must be in red to be a
"CERTIFIED COPY"

I hereby certify the foregoing instrument to which this stamp has been affixed consisting of 1 page to be a full, true and correct copy of the original on file and of record in my office.

Larry W. Wan

Assessor - County Clerk - Recorder

County of Riverside, State of California

Dated: NOV 03 2009

Certification must be in red to be a
"CERTIFIED COPY"

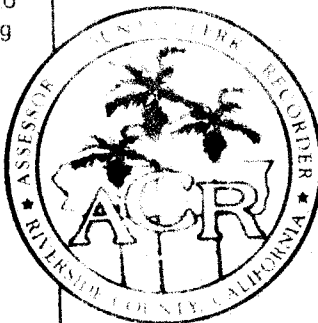

EXHIBIT NO. B

RIVERSIDE COUNTY GIS



Selected parcel(s):

325-200-042

IMPORTANT

This information is made available through the Riverside County Geographic Information System. The information is for reference purposes only. It is intended to be used as base level information only and is not intended to replace any recorded documents or other public records. Contact appropriate County Department or Agency if necessary. Reference to recorded documents and public records may be necessary and is advisable.

FULL REPORT

APN(s):

325-200-042-0

OWNER NAME / ADDRESS:

- 325-200-042
RITA NAUTA ALIG
22841 FISHER RD
PERRIS, CA. 92570

MAIL TO NAME/ADDRESS:

- 325-200-042
- (SEE OWNER)
- 22841 FISHER RD
- PERRIS CA.. 92570

APN CAME FROM:

- 325-200-042
- CAME FROM: NO DATA AVAILABLE

LOT SIZE: - 325-200-042
- RECORDED LOT SIZE IS: 2.39 ACRES

PROPERTY CHARACTERISTICS: - 1. 325-200-042
- WOOD FRAME, 740 SQFT., 2 BDRM/ 2 BATH, 1 STORY, CONST'D 1970, COMPOSITION ROOF, CENTRAL HEATING, CENTRAL COOLING,

ELEVATION (APPROXIMATE): - 1580/1604 FEET

LEGAL DESCRIPTION: - APN: 325200042
- RECORDED BOOK/PAGE: RS 26/1
- SUBDIVISION NAME: NOT AVAILABLE
- LOT/PARCEL: 102, BLOCK: NOT AVAILABLE
- TRACT NUMBER: NOT AVAILABLE

BASE YEAR ASSESSMENT: - 325-200-042
- BASE YEAR: 1976

TOWNSHIP/RANGE: - T4SR4W SEC 35

CEMETERY DISTRICTS: - PERRIS VALLEY CEMETERY DISTRICT

CITY BOUNDARY/SPHERE: - CITY: NOT WITHIN A CITY
- CITY SPHERE: PERRIS
- ANNEXATION DATE: NO DATE AVAILABLE
- LAFCO CASE #: NO CASE # AVAILABLE
- PROPOSALS: NONE

COMMUNITY: - IN OR PARTIALLY WITHIN GOOD HOPE. SEE MAP FOR MORE INFORMATION.

2001 SUPERVISORIAL DISTRICT: - MARION ASHLEY, DISTRICT 5
as established by County Ordinance 813, August 14, 2001

AREA PLAN: - MEAD VALLEY

COACHELLA VALLEY MULTI-SPECIES HABITAT CONSERVATION PLAN FEE AREA: - NOT WITHIN THE COACHELLA VALLEY MSHCP FEE AREA

COACHELLA VALLEY MULTI-SPECIES HABITAT CONSERVATION PLAN - CONSERVATION AREA: - NOT IN A CONSERVATION AREA

WESTERN RIVERSIDE MULTI-SPECIES HABITAT CONSERVATION PLAN FEE AREA: - IN OR PARTIALLY WITHIN THE WESTERN RIVERSIDE MSHCP FEE AREA. SEE MAP FOR MORE INFORMATION.

WESTERN RIVERSIDE COUNTY MSHCP AREA PLAN: - NOT IN AN AREAPLAN

WESTERN RIVERSIDE COUNTY MSHCP CELL GROUP: - NOT IN A CELLGROUP

WESTERN RIVERSIDE COUNTY MSHCP CELL NUMBER: - NOT IN A CELL

IMPORTANT NOTICE: On October 7, 2003, the County of Riverside adopted a new General Plan. The General Plan provides new land use designations for all parcels in the unincorporated area of Riverside County. For any parcel, the General Plan may provide for a different type of land use than is provided for under existing zoning. During the next one to two years, the County will undertake a program to review all the zoning in the unincorporated area, and where necessary, change the zoning, following advertised public hearings, to conform to the County's new General Plan. Until then, please be advised that there may be a difference between the zoning and General Plan designations on any parcel. This may result in, at a minimum, the need to change the zoning before desired development may proceed. For further information, please contact the Riverside County Planning Department offices in Riverside at (951) 955-3200, in Murrieta at (951) 600-6170, or in Indio at (760) 863-8277.

LANDUSE DESIGNATION: Click [here](#) for landuse descriptions.
- RC-VLDR

- CHECK MAP TO CONFIRM LANDUSE DESIGNATION
- FOR MORE INFORMATION ABOUT LANDUSE DESIGNATIONS, CALL THE COUNTY'S PLANNING DEPARTMENT AT 951-955-3200.

ZONING CLASSIFICATION(S) ORD. 348: Click [here](#) for zoning classifications.
- R-R

- CHECK MAP TO CONFIRM ZONING CLASSIFICATIONS
- FOR MORE INFORMATION ABOUT ZONING CLASSIFICATIONS, CALL THE COUNTY'S PLANNING DEPARTMENT AT 951-955-3200.

ZONING DISTRICT/AREA: - GOOD HOPE AREA

OUTDOOR BILLBOARDS: - BILLBOARDS NOT PERMITTED BY ZONING

SPECIFIC PLAN: - NOT WITHIN A SPECIFIC PLAN

NOTE: Non-mapped Policy Area issues may exist on this parcel. Please contact the Planning Department at (951)955-3200 for more information.

MAPPED POLICY AREAS: - NONE

GENERAL PLAN POLICY OVERLAY: - NOT IN A GENERAL PLAN POLICY OVERLAY AREA

DEVELOPMENT AGREEMENT #: - NOT IN A DEVELOPMENT AGREEMENT AREA

REDEVELOPMENT AREAS: - NOT IN A REDEVELOPMENT AREA

AGRICULTURE PRESERVE: - NOT IN AN AGRICULTURE PRESERVE

AIRPORT INFLUENCE AREAS: - NOT IN AN AIRPORT INFLUENCE AREA

AIRPORT COMPATIBILITY ZONES: - NOT IN AN AIRPORT COMPATIBILITY ZONE

Planning Case Map information may not be complete, current, or up-to-date for this area. Please contact the Planning Department if more information is needed.

PLANNING CASE(S): - NO PLANNING CASES DESCRIPTION: NOT APPLICABLE
APPLIED DATE: NOT APPLICABLE STATUS: NOT APPLICABLE

DEV. IMP. FEE AREA ORD. 659: - MEAD VALLEY

2000 CENSUS TRACT: - 042903

1990 FARMLAND DESIGNATION: - NOT A IN FARMLAND DESIGNATION

2000 CENSUS DESIGNATION: - CENSUS DESIGNATION REPORT IS NOT AVAILABLE

INDIAN TRIBAL LANDS: - NOT IN A TRIBAL LAND

SCHOOL DISTRICT: - PERRIS
- PERRIS UNION HIGH

ROAD & BRIDGE DISTRICT: - NOT IN A DISTRICT

ROADBOOK PAGE: - 61

* BOUNDARIES ARE APPROXIMATIONS. USE FOR REFERENCE ONLY. SURVEY INFORMATION MUST BE CONSULTED OR PREPARED TO ACCURATELY DETERMINE ANY RIGHT-OF-WAY BOUNDARY.

CETAP CORRIDORS: - NOT IN A CETAP CORRIDOR.

CIRCULATION ELEMENT ULTIMATE RIGHT-OF-WAY ROADS: - NOT IN A CIRCULATION ELEMENT RIGHT-OF-WAY

EAST T.U.M.F. ORD. 673: - NOT WITHIN THE EASTERN TUMF FEE AREA

WEST T.U.M.F. ORD. 824: - IN OR PARTIALLY WITHIN THESE FEE AREAS. SEE MAP FOR MORE INFORMATION.
- CENTRAL

WATER DISTRICT: - EASTERN MUNICIPAL WATER DISTRICT (EMWD)

FLOOD CONTROL DISTRICT: - RIVERSIDE COUNTY FLOOD CONTROL DISTRICT

FLOOD PLAIN REVIEW: - NOT REQUIRED.

WATERSHED: - SAN JACINTO VALLEY

VEGETATION: - FIELD CROPLANDS
- RESIDENTIAL/URBAN/EXOTIC

SKR FEE AREA ORD. 663.10: - IN OR PARTIALLY WITHIN A FEE AREA. SEE MAP FOR MORE INFORMATION.

HANS/ERP PROJECT: - NONE

FAULT ZONE: - NOT IN A FAULT ZONE

FAULTS: - NOT WITHIN A 1/2 MILE OF A FAULT

LIQUEFACTION POTENTIAL: - NO POTENTIAL FOR LIQUEFACTION EXISTS

SUBSIDENCE: - NOT IN A SUBSIDENCE AREA

HIGH FIRE AREA ORD. 787: - NOT IN A HIGH FIRE AREA

STATE RESPONSIBILITY AREAS: - STATE RESPONSIBILITY AREA

LIGHTING ORD. 655: - ZONE B, 36.83 MILES.

COUNTY SERVICE AREA: - IN OR PARTIALLY WITHIN
PERRIS/WAGON WHEEL #70 -
ROAD MAINTAINANCE

BUILDING PERMIT(S): -BZ270182 DESCRIPTION: SEPTIC TANK, GAS, ELEC
APPLIED DATE: 05/07/2003 STATUS AS OF 09/30/2009: FINAL
-BZ408149 DESCRIPTION: CONVERT TO NATURAL GAS
APPLIED DATE: 04/30/2001 STATUS AS OF 09/30/2009: FINAL

CODE COMPLAINTS: -CV0904756 ACCUMULATED RUBBISH
APPLIED DATE: Jun. 30, 2009 STATUS: NOTICE OF VIOLATION
-CV0809595 SUBSTANDARD MH
APPLIED DATE: Nov. 10, 2008 STATUS: NOTICE OF INTENT TO INSPECT

ENVIRON. HEALTH CASE(S): - NO ENVIRONMENTAL CASES

TAX RATE AREAS: - 087-008
• COUNTY FREE LIBRARY
• COUNTY SERVICE AREA 70 *
• COUNTY STRUCTURE FIRE PROTECTION
• COUNTY WASTE RESOURCE MGMT DIST
• CSA 152
• EASTERN MUN WATER IMP DIST 8
• EASTERN MUNICIPAL WATER
• FLOOD CONTROL ADMINISTRATION
• FLOOD CONTROL ZONE 4
• GENERAL
• GENERAL PURPOSE
• METRO WATER EAST 1301999
• MT SAN JACINTO JUNIOR COLLEGE
• PERRIS AREA ELEM SCHOOL FUND
• PERRIS JR HIGH AREA FUND
• PERRIS SCHOOL
• PERRIS UNION HIGH SCHOOL
• PERRIS VALLEY CEMETERY
• RIV CO REG PARK & OPEN SPACE
• RIV. CO. OFFICE OF EDUCATION
• SAN JACINTO BASIN RESOURCE CONS

SURFACE MINES: - NO SURFACE MINES

PALEONTOLOGICAL SENSITIVITY: - LOW POTENTIAL
FOLLOWING A LITERATURE SEARCH, RECORDS CHECK AND A FIELD SURVEY, AREAS MAY
BE DETERMINED BY A QUALIFIED VERTEBRATE PALEONTOLOGIST AS HAVING LOW
POTENTIAL FOR CONTAINING SIGNIFICANT PALEONTOLOGICAL RESOURCES SUBJECT TO
ADVERSE IMPACTS.

COMMUNITY FACILITY DISTRICTS:

- NAME: NOT IN A COMMUNITY FACILITY DISTRICT
- DISTRICT NUMBER: NOT AVAILABLE

THOMAS BROS. MAPS PAGE/GRID:

- PAGE 807- GRID C4

SPECIAL NOTES:

- NO SPECIAL NOTES

REPORT PRINTED ON...Wed Sep 30 16:22:12 2009



P.O. Box 1193
Whittier, CA 90609
Tel # (562) 325-8351
Fax # (714) 783-3038

Lot Book Report

Order Number: **19322**

Customer:

RIVERSIDE COUNTY TLMA-CODE ENFORCEMENT
4080 Lemon Street
Riverside CA 92501

Attn: Brent Steele
Reference: CV09-04756 / Richard Arriola
IN RE: NAUTA, RITA

Order Date: 7/6/2009

Dated as of: 7/2/2009

County Name: Riverside

FEE(s):

Report: \$120.00

Property Address: 22841 Fisher Road
Perris CA

Assessor's Parcel No. : 325-200-042-0

Assessments:

Land Value:	\$9,251.00
Improvement Value:	\$1,741.00
Exemption Value:	\$7,000.00
Total Value:	\$3,992.00

Tax Information

Property Taxes for the Fiscal Year	2008-2009
Total Annual Tax	\$365.94
Status: Paid through	06/30/2009

Property Vesting

The last recorded document transferring title of said property

Dated 04/24/2001

Recorded 06/28/2001



P.O. Box 1193
Whittier, CA 90609
Tel # (562) 325-8351
Fax # (714) 783-3038

Order Number: 19322

Reference: CV09-04756 / Ric

Document No.	2001-295543
D.T.T.	\$0.00
Grantor	Rita N. Alig
Grantee	Rita Nauta Alig, Family Trust of Rita Nuta Alig, dated April 24, 2001

Deeds of Trust

No Deeds of Trust of Record

Additional Information

A Notice of Lien Recorded	04/18/2006
Document No.	2006-0276769
Amount	\$679.88
Owner	Rita Nauta Alig
Claimant	Eastern Municipal Water District
Document Type	Special Assessments and Liens Against
Document No.	2008-0488690
Recorded	09/04/2008

Legal Description

THE LAND REFERRED TO IN THIS REPORT IS LOCATED IN AND IS DESCRIBED AS FOLLOWS:

THE EAST HALF OF LOT 102 OF WAGON WHEEL FARMS, IN THE COUNTY OF RIVERSIDE, STATE OF CALIFORNIA, AS SHOWN BY RECORD OF SURVEY ON FILE IN BOOK 26 PAGE 1 OF RECORDS OF SURVEY, RECORDS OF SAID COUNTY.

325-20

T.R.A. 8708

S1/2, SE 1/4, SEC. 35, T4S, R4W.

THIS MAP IS FOR
ASSESSMENT PURPOSES ONLY

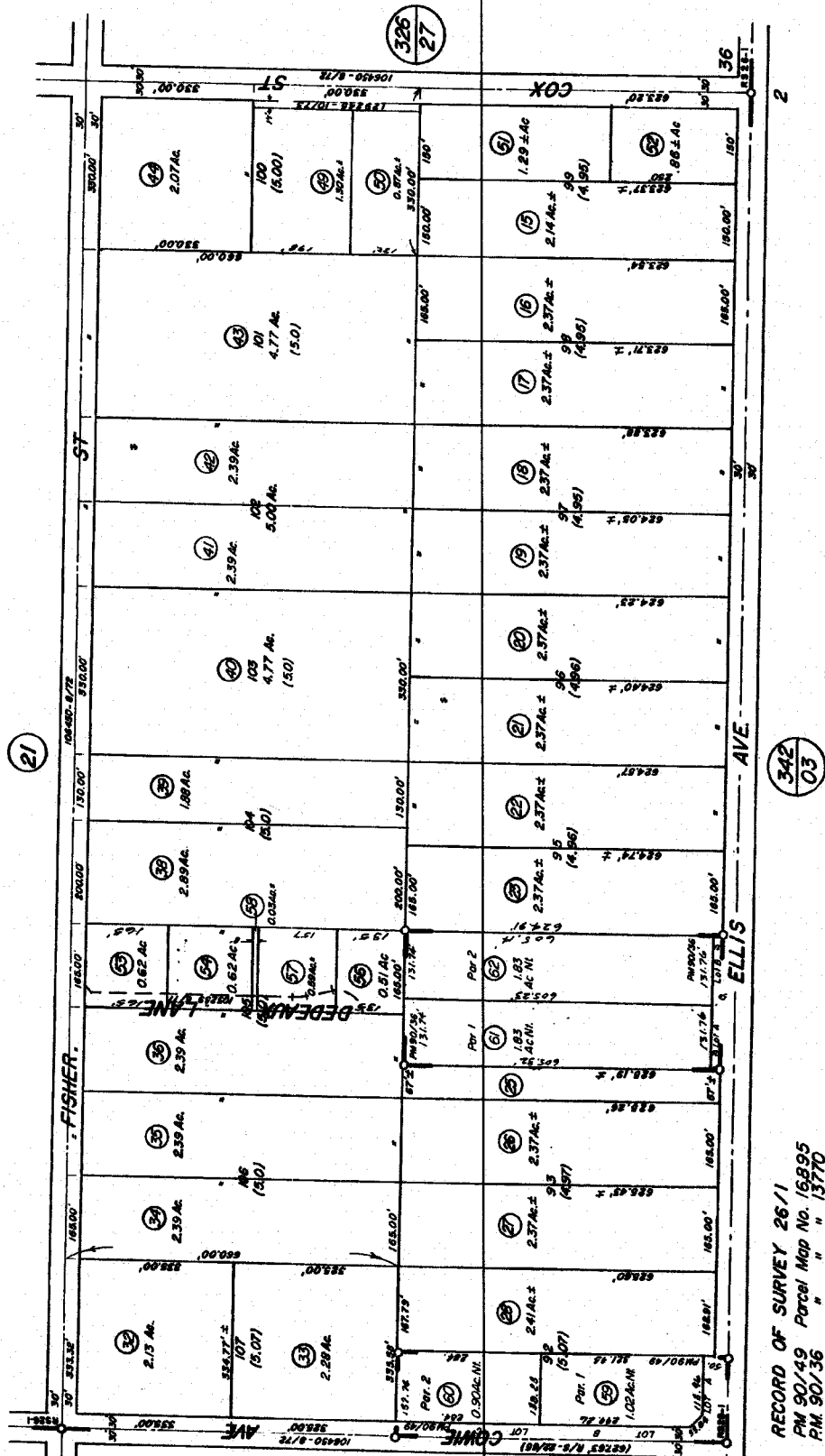
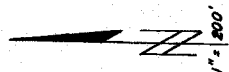

DATA: RS 03/10

ASSESSOR'S MAP BK. 325 PG. 20
RIVERSIDE COUNTY, CALIF. WC

JUL. 1971

DATE	OLD	NEW	NO.
3/28	11480	9	35 7480-48
"	31	32	41 8-2
"	11	10800 11	43 2080-46
"	29		47
12/13	445		48
3/24	48		49 50
8/170	48		51 82
2-80	37		53 - 56
3/80	55		57 58
5/81	47		59-60
5/81	24		61 62

DOC # 2001-205543

04/26/2001 08:00 Fee: \$6.00

Page 1 of 1

Recorded in Official Records

County of Riverside

Gary L. Ors

Assessor, County Clerk & Recorder



RECORDING REQUESTED BY AND TO BE RETURNED AFTER RECORDING TO:

SCOTT EDWARD DAWLING
3697 ARLINHTIN AVENUE
RIVERSIDE, CA 92506-3938

MAIL LEGAL NOTICES AND TAX STATEMENTS TO:

Mail Tax Statements and
Legal Notices to Owners address at
bottom of this page.

IN	SS	U	PROD	DES	GA	POOR	NOOR	SW	USE
A	R	L			COPY	LONG	REFILED	NOVO	EXEM

(Spec above this line for recorder use)

Documentary Transfer Tax \$ NONE No consideration for transfer City of _____ or Unincorporated Area
Computed on: X Full value of property conveyed, or X Computed on full value less liens & encumbrances existing thereon at time of sale.
Reason for exemption: Conveyance transfers the grantor's interest into grantor's revocable living trust. Rev. & Tax. Code 11911
Signature of declarant or agent determining tax: The undersigned Firm name: Scott Edward Dawling

M
SF

QUITCLAIM DEED

TRA# 087-008

FOR VALUABLE CONSIDERATION, RECEIPT OF WHICH IS HEREBY ACKNOWLEDGED,
THE FOLLOWING GRANTOR(S):

Rita N. Alig

and in whatever form of name and in whatever capacity (granted) hold use to the property

HEREBY REMISE, RELEASE, AND FOREVER QUITCLAIM TO THE FOLLOWING GRANTEE(S):

TO THE TRUSTEES (OR TO ANY SUCCESSOR TRUSTEES) OF THE TRUST COMMONLY KNOWN AS FOLLOWS:

NAME OF TRUSTEES:

Rita Nauta Alig

NAME OF TRUST:

Family Trust of Rita Nauta Alig

DATE OF TRUST DOCUMENT:

April 24, 2001

THE REAL PROPERTY SITUATED AS FOLLOWS:

CITY OF:

Perris

COUNTY OF:

Riverside

STATE OF:

California

SAID REAL PROPERTY IS DESCRIBED AS FOLLOWS:

The East Half of Lot 102 of Wagon Wheel Farms, as shown by Record of Survey on file in Book 26 Page 1 of
Records of Survey, Records of Riverside County, California

Date: 4-24-01

Grantor Signature: *Rita N. Alig*
NAME: Rita N. Alig

CERTIFICATE OF ACKNOWLEDGMENT OF NOTARY PUBLIC

State of California, County of: Riverside) SS

On April 24, 2001

before me, the undersigned, a Notary Public in and for said State, personally appeared:

Rita N. Alig

personally known to me for several years and on the basis of satisfactory evidence to be the person(s) whose name(s) were subscribed to the within instrument, and acknowledged to me that he/she/they executed the same in his/her/their authorized capacity(ies), and that by his/her/their signature(s) on the instrument the person(s), or the entity upon behalf of which the person(s) acted, executed the instrument.

WITNESS my hand and official seal.
NOTARY PUBLIC



Mail Tax and Legal Notices to: Rita Alig, 22841 Fisher Street, Perris, CA 92579

RECORDING REQUESTED BY AND
WHEN RECORDED MAIL TO:

EASTERN MUNICIPAL WATER DISTRICT
P.O. BOX 8300
PERRIS, CA 92570
ATTENTION: BILLING DEPARTMENT

NO RECORDING FEE REQUIRED
PURSUANT TO GOVERNMENT CODE
SECTION 27383

DOC # 2006-0276769
04/18/2006 08:00A Fee:NC

Page 1 of 1
Recorded in Official Records
County of Riverside

Larry W. Ward
Assessor, County Clerk & Recorder

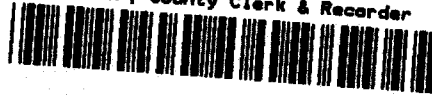

M	S	U	PAGE	SIZE	DA	PCOR	NOCOR	SMF	MSC
	1		1						
A	R	L			COPY	LONG	REFUND	NCHG	EXAM

8

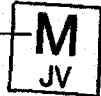

**LIEN AGAINST REAL PROPERTY
FOR UNPAID SERVICE CHARGES**

By this certificate, EASTERN MUNICIPAL WATER DISTRICT, a public agency, has a lien against all real property in the County of Riverside, California, owned by the person identified below at the time of recordation of this Certificate or may hereafter be acquired by him for delinquent and unpaid charges for water service plus interest at the rate of 10 percent per year from the date each such charge was due, until paid.

RITA NAUTA ALIG
22841 FISHER ST
PERRIS, CA

Account Number: 10071-02
Parcel Number: 325-200-042
Total Amount Due: 679.88

April 12, 2006

EASTERN MUNICIPAL WATER DISTRICT

By 
Christine Avalos-Thomsen
Customer Service Manager

State of California)
County of Riverside)

On April 12 2006 before me, **STENA G COPELAND**, Notary Public, personally appeared **CHRISTINE AVALOS-THOMSEN**, personally known to me (or proved to me on the basis of satisfactory evidence) to be the person(s) whose name(s) is/are subscribed to the within instrument and acknowledged to me that he/she/they executed the same in his/her/their authorized capacity(ies), and that by his/her/their signature(s) on the instrument the person(s), or the entity upon behalf of which the person(s) acted, executed the instrument.

(SEAL)

Witness my hand and official seal.

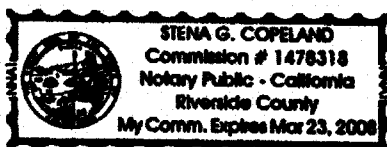

SIGNATURE OF NOTARY

DOC # 2008-0488690

09/04/2008 08:00A Fee:NC

Page 1 of 119

Recorded in Official Records
County of Riverside

Larry W. Ward
Assessor, County Clerk & Recorder



PLEASE COMPLETE THIS INFORMATION
RECORDING REQUESTED BY:

AND WHEN RECORDED MAIL TO:

Alice Beasley
P.O. Box 1280
Riverside, CA 92502

S	R	U	PAGE	SIZE	DA	MISC	LONG	RFD	COPY
			119			600			
M	A	L	465	428	PCOR	NCOR	SMF	NCHG	EXAM
						T:	CTY	UNI	043

Space above this line for recorder's use only
RESOLUTION 2008-295: A RESOLUTION OF THE COUNTY OF RIVERSIDE ORDERING THE
CONFIRMATION OF SPECIAL ASSESSMENTS AND LIENS AGAINST PARCELS OF LAND FOR UNPAID
AND DELINQUENT CHARGES FOR TRASH COLLECTION SERVICES

Title of Document



TRA: _____

DTT: _____

THIS PAGE ADDED TO PROVIDE ADEQUATE SPACE FOR RECORDING INFORMATION
(\$3:00 Additional Recording Fee Applies)

ACR 238P-A94RE0 (Rev. 03/2008)

Public Record

MINUTES OF THE BOARD OF SUPERVISORS
COUNTY OF RIVERSIDE, STATE OF CALIFORNIA



9.1

9:30 a.m. being the time set for public hearing on Adoption of Resolution 2008-295 Ordering the Confirmation of Special Assessments and Liens Against Parcels of Land for Unpaid and Delinquent Charges for Trash Collection Services, the Chairman called the matter for hearing.

John Watkins, Community Health Agency/Environmental Health Deputy Director, presented the matter.

The following individuals spoke in opposition:

Alejandro Hernandez, Riverside
Theodore Gaines, Riverside
Vu Luyen, Perris
Joyce Jeffredo, Hemet
Patricia Pittman, Murrieta
Mike Luna, Riverside
Clinton Sutherland, Perris
Dee Hydinger, Hemet

Since no one else present wished to speak on the matter, the Chairman declared the hearing closed.

Supervisor Buster feels we need the landowner to be notified on a more frequent basis that there's some kind of delinquency on these bills, and a better system for when there's a vacancy and their trash is not being collected so that the charges reflect that accurately. Also staff to come up with a protocol to give the homeowners what they need to have to show that there was a vacancy on their rental.

Supervisor Wilson stated that more responsibility is needed on the part of the waste haulers to notify Environmental Health of possible vacant properties.

I hereby certify that the foregoing is a full true, and correct copy of an order made and entered on July 29, 2008 of Supervisors Minutes.

WITNESS my hand and the seal of the Board of Supervisors

Dated: July 29, 2008
Nancy Romero, Clerk of the Board of Supervisors, in
and for the County of Riverside, State of California.

(seal)

By: [Signature] Deputy

xc: CHA/Environ. Health, Auditor, COB

AGENDA
9.1 ATTACHED TO WHICH THIS CERTIFICATE IS
ATTACHED IS CERTIFIED TO BE A FULL, TRUE AND
CORRECT COPY OF THE ORIGINAL ON FILE AND OF
RECORD IN MY OFFICE

Dated: 9/14/08
Nancy Romero
Clerk of the Board of Supervisors
County of Riverside, California
By: [Signature]

MINUTES OF THE BOARD OF SUPERVISORS
COUNTY OF RIVERSIDE, STATE OF CALIFORNIA



Supervisor Tavaglione feels that the landowners have the responsibility to structure their leases in a way that requires payment, and that we need to explore the idea that the trash haulers work out arrangements with special districts to handle collections on their behalf.

On motion of Supervisor Buster, seconded by Supervisor Tavaglione and duly carried, IT WAS ORDERED that the above matter is approved as recommended, adopting Resolution 2008-295; and,

IT WAS FURTHER ORDERED that staff is directed to come back with responses and recommendations concerning establishment of similar methods used by water and sewer districts for collection; notification to landowner on a more frequent basis that there's some kind of delinquency on these bills; a better system for when there's a vacancy and their trash is not being collected so that the charges reflect that accurately; and, staff to come up with a protocol to give the landlords on what they need to have to show that there was a vacancy on their rental, i.e. electrical being shut off.

Ayes:	Buster, Tavaglione and Wilson
Nays:	None
Absent:	Ashley

(Supervisor Stone declared a potential Conflict of Interest and left the room before the Chairman declared the hearing open.)

I hereby certify that the foregoing is a full true, and correct copy of an order made and entered on July 29, 2008 of Supervisors Minutes.

WITNESS my hand and the seal of the Board of Supervisors

Dated: July 29, 2008
Nancy Romero, Clerk of the Board of Supervisors, in
and for the County of Riverside, State of California.

(seal)

By: [Signature] Deputy

AGENDA NO.
9.1

xc: CHA/Environ. Health, Auditor, COB

1 Board of Supervisors

County of Riverside

2 RESOLUTION NO. 2008-295

3
4 A RESOLUTION OF THE COUNTY OF RIVERSIDE ORDERING THE CONFIRMATION OF
5 SPECIAL ASSESSMENTS AND LIENS AGAINST PARCELS OF LAND FOR UNPAID AND
6 DELINQUENT CHARGES FOR TRASH COLLECTION SERVICES

7
8 WHEREAS, Riverside County Ordinance 745 has established the authority of the Board of
9 Supervisors to designate areas of the County as comprehensive collection areas in which waste collection
10 services are compulsory;

11 WHEREAS, Riverside County Resolution Nos. 04-298, 05-154, 06-063, 06-159 and 06-389 have
12 established a Tax Lien Guaranteed Comprehensive Collection area for the residential properties located
13 within portions of unincorporated communities within the First, Second, Third and Fifth Districts;

14 WHEREAS, certain parcels maintained unpaid and delinquent charges for waste collection services,
15 which will be paid by the County to the Waste Hauler upon the property owner's payment of the
16 assessment, from the fund entitled, "Payment of Property Owner's Delinquencies for Solid Waste
17 Collection Service," established under Section 14 of Ordinance 745;

18 WHEREAS, the charges placed upon the parcels is the cost of the service already provided by the
19 Waste Hauler and any applicable surcharges is not a charge based upon the value of the parcels; and

20 WHEREAS, pursuant to Section 9 of Ordinance No. 745 the Waste Hauler has sent individual
21 billing notices to the various parcel owners for the cost of service;

22 WHEREAS, such property owners have had the opportunity to appeal through the procedure
23 established in Section 10 of Ordinance 745;

24 WHEREAS the property owners have been notified pursuant to Ordinance 745; and

25 ///

Resolution 2008-295 - 1

07.29.08 9.1

1 WHEREAS, the billing for those parcels listed on the attached Exhibit "A" remains unpaid; now,
2 therefore;

3 BE IT RESOLVED AND ORDERED that the Board of Supervisors of the County of Riverside,
4 State of California, in regular session assembled on July 29, 2008, that the list of parcels upon which the
5 unpaid trash collection fees for each parcel as shown on Exhibit "A" are hereby confirmed and that
6 henceforth, said delinquent charges shall constitute special assessments against the respective parcels of
7 land, and are liens on said lands in the amount of the respective assessments, as authorized by
8 Government Code section 25828. In addition, the surcharge as allowed by Riverside County Ordinance
9 640 shall take effect when the lien is applied to the property tax bill.

10 BE IT FURTHER RESOLVED AND ORDERED that a certified copy of this Resolution and the
11 attached Exhibit "A" shall be transmitted to the Auditor-Controller of Riverside County on or before
12 August 10, 2008, who shall enter the amounts of the respective assessments against the respective parcels
13 of land as they appear on the current assessment roll. Said assessments shall be collected at the same time
14 and in the same manner as ordinary municipal ad valorem taxes as provided by Section 13 of Ordinance
15 No. 745.

ROLL CALL:

16 Ayes: Buster, Tavaglione, Stone and Wilson
17 Nays: None
18 Absent: Ashley

19 FORM APPROVED COUNTY COUNSEL

20 BY: JINNY H. RA 6/5/08
DATE

21
22 The foregoing is certified to be a true copy of a resolution duly
23 adopted by said Board of Supervisors on the date therein set forth.

NANCY ROMERO, Clerk of said Board

24 The foregoing is certified to be a true copy of a
25 resolution duly adopted by said Board of Super-
visors on the date therein set forth.

NANCY ROMERO, Clerk of said Board

By: N. Romero Deputy

By: _____
Deputy

Resolution 2008-295 - 2

07.29.08 9.1

FORM APPROVED COUNTY COUNSEL
BY: JIMMY H. BA 6/5/08
DATE

**SUBMITTAL TO THE BOARD OF SUPERVISORS
COUNTY OF RIVERSIDE, STATE OF CALIFORNIA**

704



FROM: Community Health Agency/Department of Environmental Health

SUBMITTAL DATE:

June 17, 2008

SUBJECT: Public Hearing and Adoption of Resolution 2008-295 Confirming Special Assessments for Unpaid Trash Collection Fees.

RECOMMENDED MOTION:

1. That the Board receive this report in accordance with Section 12 of Ordinance 745;
2. That the Board set a public hearing for July 29, 2008 (Clerk to advertise), listing parcels upon which the unpaid trash collection fees will become a special assessment;
3. That following a public hearing, the Board adopt Resolution 2008-295 confirming special assessments for the amount incurred in unpaid trash collection fees.

BACKGROUND: Riverside County Ordinance 745 and Resolution Nos. 04-298, 05-154, 06-063, 06-159 and 06-389 establish a Tax Lien Guaranteed Comprehensive Collection area for the residential properties located within the unincorporated county, as authorized by Government Code section 25828. The franchise waste haulers mailed bills and statements of nonpayment to each owner of record in accordance with Section 9 of Riverside County Ordinance 745.
(cont.)

Gary Root, Director

FINANCIAL DATA	Current F.Y. Total Cost:	\$ 0	In Current Year Budget:	Yes
	Current F.Y. Net County Cost:	\$ 0	Budget Adjustment:	No
	Annual Net County Cost:	\$ 0	For Fiscal Year:	08/09

SOURCE OF FUNDS:

Positions To Be Deleted Per A-30 ☐
Requires 4/5 Vote ☐

C.E.O. RECOMMENDATION:

APPROVE

BY:
Debra Courmoyer

County Executive Office Signature

MINUTES OF THE BOARD OF SUPERVISORS

On motion of Supervisor Ashley, seconded by Supervisor Stone and duly carried,
IT WAS ORDERED that the above matter is approved as recommended and is set for public hearing Tuesday, July 29, 2008 at 9:30 a.m.

Ayes: Buster, Stone and Ashley
Nays: None
Absent: Taviglione, Wilson
Date: June 24, 2008
xc: CHA/Env. Health, COB₍₂₎

Nancy Romero
Clerk of the Board
By:
Deputy

Prev. Agn. Ref.:

District: 1,2,3,5 | Agenda Number:

3.14

The franchise waste haulers forwarded a list of properties with unpaid trash collection fees to the Department of Environmental Health (Department) for special assessment.

A list of parcels that are subject to fee assessment are provided on the attached Exhibit "A." Mailed notice of the public hearing will be sent to the subject property owners by the Department pursuant to Section 12 of Ordinance 745.

The delinquent trash collection fees and applicable surcharges shall be confirmed at a public hearing regarding the list of parcels upon which the cost will become a special assessment. This is the required final step to establish assessments and liens on those parcels where trash collection fees will be paid to the franchise waste haulers from the fund account "Payment of Property Owner's Delinquencies for Solid Waste Collection Service," upon the property owner's payment of the special assessment.

2 RESOLUTION NO. 2008-295

3
4 A RESOLUTION OF THE COUNTY OF RIVERSIDE ORDERING THE CONFIRMATION OF
5 SPECIAL ASSESSMENTS AND LIENS AGAINST PARCELS OF LAND FOR UNPAID AND
6 DELINQUENT CHARGES FOR TRASH COLLECTION SERVICES

7
8 WHEREAS, Riverside County Ordinance 745 has established the authority of the Board of
9 Supervisors to designate areas of the County as comprehensive collection areas in which waste collection
10 services are compulsory;

11 WHEREAS, Riverside County Resolution Nos. 04-298, 05-154, 06-063, 06-159 and 06-389 have
12 established a Tax Lien Guaranteed Comprehensive Collection area for the residential properties located
13 within portions of unincorporated communities within the First, Second, Third and Fifth Districts;

14 WHEREAS, certain parcels maintained unpaid and delinquent charges for waste collection services,
15 which will be paid by the County to the Waste Hauler upon the property owner's payment of the
16 assessment, from the fund entitled, "Payment of Property Owner's Delinquencies for Solid Waste
17 Collection Service," established under Section 14 of Ordinance 745;

18 WHEREAS, the charges placed upon the parcels is the cost of the service already provided by the
19 Waste Hauler and any applicable surcharges is not a charge based upon the value of the parcels; and

20 WHEREAS, pursuant to Section 9 of Ordinance No. 745 the Waste Hauler has sent individual
21 billing notices to the various parcel owners for the cost of service;

22 WHEREAS, such property owners have had the opportunity to appeal through the procedure
23 established in Section 10 of Ordinance 745;

24 WHEREAS the property owners have been notified pursuant to Ordinance 745; and

25 ///

Resolution 2008-295 - 1

1 WHEREAS, the billing for those parcels listed on the attached Exhibit "A" remains unpaid; now,
2 therefore;

3 BE IT RESOLVED AND ORDERED that the Board of Supervisors of the County of Riverside,
4 State of California, in regular session assembled on July 29, 2008, that the list of parcels upon which the
5 unpaid trash collection fees for each parcel as shown on Exhibit "A" are hereby confirmed and that
6 henceforth, said delinquent charges shall constitute special assessments against the respective parcels of
7 land, and are liens on said lands in the amount of the respective assessments, as authorized by
8 Government Code section 25828. In addition, the surcharge as allowed by Riverside County Ordinance
9 640 shall take effect when the lien is applied to the property tax bill.

10 BE IT FURTHER RESOLVED AND ORDERED that a certified copy of this Resolution and the
11 attached Exhibit "A" shall be transmitted to the Auditor-Controller of Riverside County on or before
12 August 10, 2008, who shall enter the amounts of the respective assessments against the respective parcels
13 of land as they appear on the current assessment roll. Said assessments shall be collected at the same time
14 and in the same manner as ordinary municipal ad valorem taxes as provided by Section 13 of Ordinance
15 No. 745.

16
17
18
19 FORM APPROVED COUNTY COUNSEL

20 BY: JINNY H. RA 6/5/08
21 DATE

22
23
24
25

Resolution 2008-295 - 2

Copy of Riv Co Tax Roll 2007 copy to Recorder 9-08

325080011	2	HERIBERTO BRAMBILA	118.00
325080013	4	CABRERA RAFAEL	177.18
325080017	8	ARRIAGA ISSAC F; ARRIAGA MARGA	383.18
325080031	0	JEFFERS, BILL L	274.06
325080039	8	TATUM, ORESE	191.16
325090006	9	LICEA SERGIO GUIZAR	321.88
325090010	2	GARCIA, GERONIMO	274.06
325090016	8	VALDEZ, VICTOR T	274.06
325090034	4	ACEBEDO, RUDOLPH R	274.06
325100003	6	GUTIERREZ, JOSE	169.94
325100006	9	COLEMAN, JEAN	274.06
325110004	8	U S BANK NA	268.80
325120013	7	RIVERA, ANA	128.06
325130025	9	PINAL, JUAN	274.06
325140022	7	WELLS TRUST	321.88
325150012	9	SHAW, LILIA	148.72
325170003	3	DEHARO MARIA SOLEDAD PATR	361.92
325181007	1	SWEENEY, NORMAN	378.14
325181011	4	PEREZ JESUS	79.20
325181012	5	SILVA, PABLO	119.40
325181013	6	ESPINOZA, BERNICE	169.96
325181030	1	KET CORP	203.88
325181037	8	HENSLER, FEBY	274.06
325190022	2	BOWERS, ELOISE BRAZEL	420.68
325190039	8	PROPERTY OWNER	271.06
325190055	2	FRANCISCO TAPIA	231.66
325200017	8	BARAJAS, ISIDORO & MARIA E	117.46
325200032	1	SERRANO, JOSE LUIS	227.38
325200036	5	DEDEAUX, VITELSIA HAGGINS	274.06
325200038	7	ANDRADES, JOSE R	271.60
325200042	0	ALIG, RITA NAUTA	274.06
325200059	6	HUTCHINSON, VICKY A	324.60
325210030	0	GREEN JORDAN , GEORGE W	274.06
325210033	3	PROPERTY OWNER	300.88
325210036	6	PROPERTY OWNER	348.90
325210053	1	PROPERTY OWNER	198.06
325220034	5	MCCOMBS, GLORIA JEAN	274.06
325220046	6	GALVAN, JO ANNE M	274.06
325220064	2	ESPARZA, GUADALUPE	109.00
325230010	4	BARAJAS, TRINIDAD	325.92
325230012	6	PETTWAY, MIREE	277.06
325240011	6	KOOLHAAS, MELVIN GLEN	118.86
325250005	2	ADAMS, ROSIE L	274.06
325250010	6	LOPEZ, HECTOR	116.40
325250011	7	MILLER, KATHERINE	274.06
325260008	6	CARDENAS RODOLFO	151.06
325260010	7	ADAMS, BRENDA L	302.16
326051006	5	RAYMOND WALLACE	118.86
326061024	2	PROPERTY OWNER	343.52
326132024	1	PROPERTY OWNER	141.00
326133001	3	HENDRICKSON, RONALD	72.80
326133002	4	PROPERTY OWNER	140.16

Q:\DEH_ERM_LEA\Tax Lien\2008\WM\Copy of Riv Co Tax Roll 2007 copy to Recorder 9-08



County of Riverside
Building and Safety Department
CODE ENFORCEMENT DIVISION
SITE PLAN

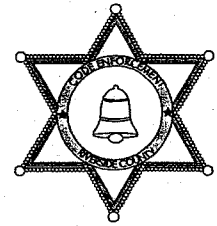

CASE #: CV09-04756

PROPERTY SITUS: 22841 FISHER ST. PERRIS

CA

A.P.N.: 325-200-042

DRAWN ON (07/02/09):

DRAWN BY: R ARRIOLA

Provide North Arrow



REAR PROPERTY LINE

S
I
D
E

P
R
O
P
E
R
T
Y

L
I
N
E

S
I
D
E

P
R
O
P
E
R
T
Y

L
I
N
E

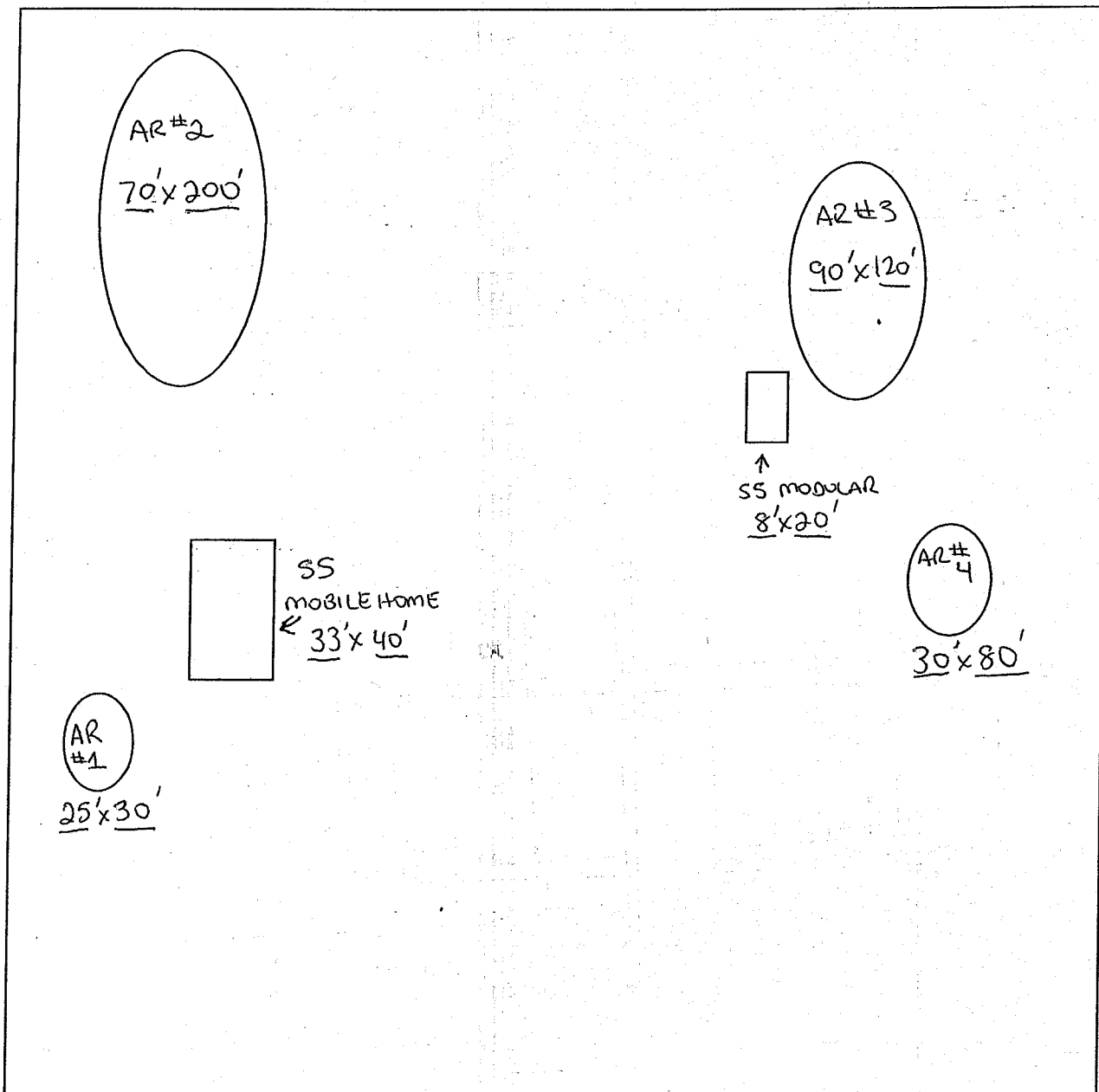

NOT TO SCALE

FRONT PROPERTY LINE

EXHIBIT NO. D



Rubbish remains- JMorris



Rubbish remains- JMorris



Rubbish remains- JMorris



Rubbish remains- JMorris



Rubbish remains- JMorris



Rubbish remains- JMorris

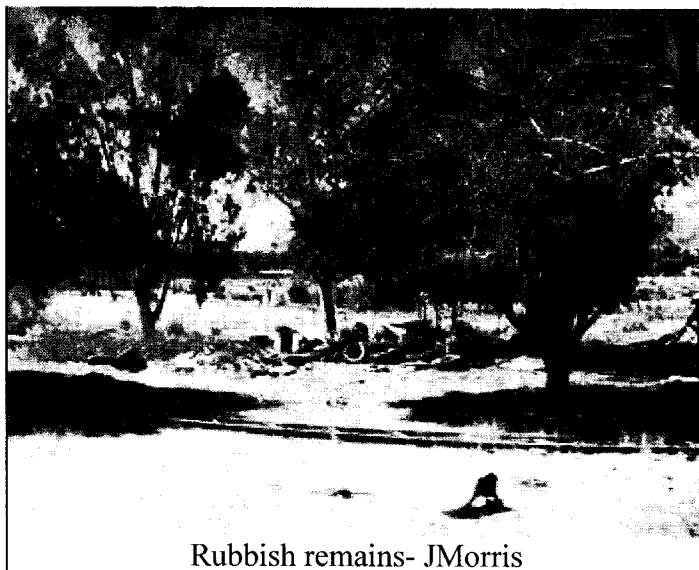

Rubbish remains- JMorris

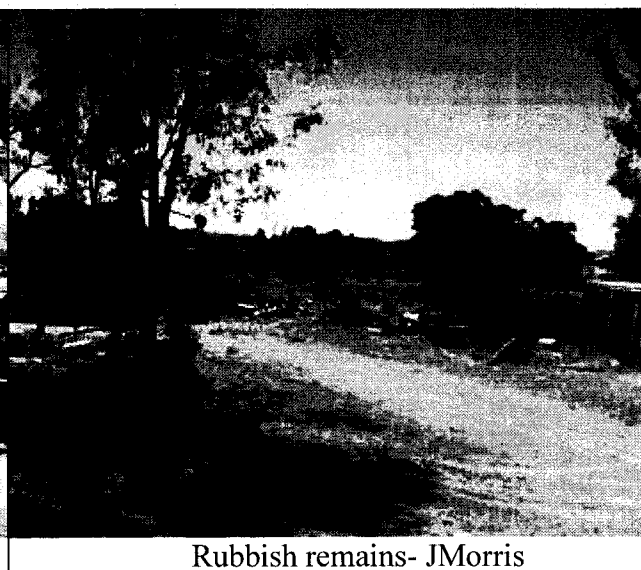

Rubbish remains- JMorris

PHOTOGRAPHIC EVIDENCE CASE NO. CV09-04756



PHOTO #_1_DATE:_06/30/09 TAKEN BY:_R ARRIOLA: NOTES: RUBBISH
CONSISTING OF SCRAP WOOD AND OLD FURNITURE. AR#1 (25'X 30')



PHOTO #_2_DATE:_06/30/09 TAKEN BY:_R ARRIOLA: NOTES: AR#2
CONSISTING OF GREEN WASTE, TIRES AND SCRAPWOOD (70'X 200')

EXHIBIT NO. DM

PHOTOGRAPHIC EVIDENCE CASE NO. CV09-04756



PHOTO #_3_ DATE:_06/30/09 TAKEN BY:_R ARRIOLA: NOTES: AR#3
CONSISTING OF GREEN WASTE, TIRES, AND SCRAP WOOD. (90'X 120')



PHOTO #_4_ DATE:_06/30/09 TAKEN BY:_R ARRIOLA: NOTES:
ANOTHER VIEW OF AR#3

PHOTOGRAPHIC EVIDENCE CASE NO. CV09-04756



PHOTO # 5 DATE: 06/30/09 TAKEN BY: R ARRIOLA: NOTES: AR#4
CONSISTING OF TIRES, SCRAP WOOD AND GREEN WASTE. (30'X 80')



PHOTO # 6 DATE: 06/30/09 TAKEN BY: R ARRIOLA: NOTES:
ANOTHER VIEW OF AR#4



COUNTY OF RIVERSIDE
CODE ENFORCEMENT DEPARTMENT

NOTICE OF VIOLATION

CASE No.: CV TBA -

THE PROPERTY AT: 22841 FISHER RD. PERMS

APN#: 325.20.042

WAS INSPECTED BY OFFICER: R. ARDIA

ID#: 71 ON 6/30/09 AT 1015 am/pm

AND FOUND TO BE IN VIOLATION OF RIVERSIDE COUNTY CODE(S) AS FOLLOWS:

<input type="radio"/>	5.28.040 (RCO 593)	Excessive Yard Sales - Cease yard sale. Limit of 3 yard sale events, not over 3 consecutive days, per year.	<input type="radio"/>	17.252.030 (RCO 348)	Unpermitted Outdoor Advertising Display - Obtain a permit from the Planning Dept. or remove display.
<input type="radio"/>	8.28.030 (RCO 821)	Unfenced Pool - Install or provide adequate fencing to secure the pool.	<input type="radio"/>	17.172.205 (RCO 348)	Prohibited Fencing - Remove fence. Fences shall not be constructed of garage doors, tires, pallets or other materials not typically used for the construction of fences.
<input checked="" type="radio"/>	8.120.010 (RCO 541)	Accumulated Rubbish - Remove all rubbish & dispose of in an approved legal landfill.	<input type="radio"/>	17._____ (RCO 348)	Excessive Outside Storage: Storage of Unpermitted Mobile Home(s) Not Allowed - Remove unpermitted mobile home(s) from the property.
<input type="radio"/>	15.08.010 (RCO 457)	Unpermitted Construction - Cease construction. Obtain the appropriate permits from the Bldg. & Safety and Planning Departments or demolish the _____.	<input type="radio"/>	17._____ (RCO 348)	Occupied RV/Trailer - Cease occupancy & disconnect all utilities to RV/Trailer.
<input type="radio"/>	15.12.020(J)(2) (RCO 457)	Unapproved Grading/Clearing - Cease grading/clearing/stockpiling/importing fill. Obtain a Restoration Assessment from the Dept. of Building & Safety. Perform complete restoration and remediation of the property affected by the unapproved grading in accordance with the Restoration Assessment.	<input type="radio"/>	17._____ (RCO 348)	Excessive Animals - Remove or reduce the number of _____ to less than _____.
<input type="radio"/>	15.16.020 (RCO 457)	Substandard Structure - Obtain a permit from the Bldg. & Safety Dept. to rehabilitate per Notice of Defects or demolish the structure.	<input type="radio"/>	17._____ (RCO 348)	Unpermitted Land Use: _____ Cease all business activities. Obtain Planning Dept. approval prior to resuming business operations.
<input type="radio"/>	15.48.010 (RCO 457)	Unpermitted Mobile Home —Vacate mobile home. Obtain the appropriate permits from the Planning Dept. & Dept. of Bldg. & Safety prior to occupancy or remove Mobile Home.	<input type="radio"/>	17._____ (RCO 348)	Excessive Outside Storage - Remove or reduce all outside storage to less than _____ square feet at the rear of the property.
<input type="radio"/>	15.48.040 (RCO 457)	Substandard Mobile Home/Trailer/RV - Obtain a permit from the Bldg. & Safety Dept. to rehabilitate per Notice of Defects and Title 25 or demolish the Mobile Home/Trailer/RV.	<input type="radio"/>		
			<input type="radio"/>		

COMMENTS: NO RUBBISH ALLOWED

IMPORTANT! CORRECTION(S) MUST BE COMPLETED BY: 6/30/09. FAILURE TO COMPLY BY THIS DATE, MAY RESULT IN THE ISSUANCE OF AN ADMINISTRATIVE CITATION WITH FINES UP TO \$500.00 PER DAY, FOR EACH VIOLATION. YOU MAY BE CITED EACH DAY THAT THE VIOLATION(S) EXIST BEYOND THE CORRECTION DATE. IN ADDITION, OTHER ENFORCEMENT ACTION, PENALTIES AND THE IMPOSITION OF A LIEN ON THE PROPERTY FOR THE ABATEMENT AND ENFORCEMENT COSTS MAY RESULT IF COMPLIANCE IS NOT ACHIEVED BY THE CORRECTION DATE.

NOTICE IS HEREBY GIVEN THAT AT THE CONCLUSION OF THIS CASE YOU WILL RECEIVE A SUMMARY OF ADMINISTRATIVE COSTS ASSOCIATED WITH THE PROCESSING OF SUCH VIOLATION(S), AT AN HOURLY RATE OF \$ 109 AS DETERMINED BY THE BOARD OF SUPERVISORS. YOU WILL HAVE THE RIGHT TO OBJECT TO THESE CHARGES BY FILING A REQUEST FOR HEARING WITH THE DEPARTMENT OF CODE ENFORCEMENT WITHIN TEN (10) DAYS OF SERVICE OF THE SUMMARY OF CHARGES, PURSUANT TO RIVERSIDE COUNTY ORDINANCE 725 AND RIVERSIDE COUNTY CODE 1.16.

SIGNATURE

PRINT NAME

DATE

EXHIBIT NO. E

CDL/CID#

D.O.B.

TEL. NO.

☒ POSTED

WHITE: VIOLATOR

GREEN: CASE FILE

YELLOW: POSTING



John Boyd
DIRECTOR

CODE ENFORCEMENT DEPARTMENT
COUNTY OF RIVERSIDE

AFFIDAVIT OF POSTING OF NOTICES

Case No. CV09-04756

I, Richard Arriola, the undersigned, hereby declare:

1. I am employed by the Riverside County Department of Code Enforcement, Code Enforcement Division; that my business address is:

County of Riverside
Code Enforcement Division
24318 Hemlock Ave., Suite C-1
Moreno Valley, CA 92557

2. That on 06/30/09 AT 1015 I securely and conspicuously posted NOTICE OF VIOLATION FOR RCC 8.120.010- ACCUMULATED RUBBISH at the property described as:

Property Address: 22841 Fisher St. Perris

Assessor's Parcel Number: 325-200-042

I declare under the penalty of perjury that the foregoing is true and correct.

Executed on July 1, 2009 at the District 5 Office in Moreno Valley, California.

CODE ENFORCEMENT DEPARTMENT

By: Richard Arriola
Richard Arriola, Code Enforcement Officer

24318 Hemlock Ave., Suite C-1, Moreno Valley, CA 92557
Phone: (951) 485-5840 * Fax: (951) 485-4938

EXHIBIT NO. E2



John Boyd
DIRECTOR

Code Enforcement Department
County Of Riverside
Moreno Valley District Office
24318 Hemlock Ave., Suite C-1
Moreno Valley, California 92557
(951) 485-5840- -- Fax (951) 485-4938

NOTICE OF VIOLATION

July 27, 2009

SEE ATTACHED NOTICE LIST

RE CASE NO.: CV09-04756

NOTICE IS HEREBY GIVEN that properties owned or controlled by you described as 22841 Fisher Road, Perris, California, Assessor's Parcel Number 325-200-042, are in violation of Riverside County Code Chapter 8.120 and constitutes a public nuisance. The subject properties are dangerous or injurious to the public because of the unauthorized accumulation of rubbish, trash and/or debris, specifically including but not limited to the following: VEGETATION WASTE, APPLIANCES, FURNITURE, HOUSEHOLD WASTE, ETC.

AS OWNER OF RECORD, you are required to abate the public nuisance by removal of all rubbish, trash, or debris from the subject properties within thirty (30) days of the date of this notice. ANY OTHER PARTY WITH INTEREST IN THE SUBJECT PROPERTY may thereafter abate the public nuisance within (15) days after expiration of the thirty (30) day period.

NOTICE IS HEREBY GIVEN THAT YOUR FAILURE TO COMPLY TO THIS NOTICE WILL RESULT IN FURTHER CIVIL, CRIMINAL OR ADMINISTRATIVE PROCEEDINGS FOR THE ABATEMENT OF THE PUBLIC NUISANCE AND COULD RESULT IN THE IMPOSITION OF A LIEN ON THE SUBJECT PROPERTIES FOR COSTS, INCLUDING ATTORNEYS' FEES, RELATED TO THE ENFORCEMENT OF THE ORDINANCES AND ABATEMENT OF THE VIOLATIVE CONDITIONS. A "NOTICE OF NONCOMPLIANCE" HAS BEEN RECORDED AGAINST THE SUBJECT PROPERTIES.

PLEASE BE ADVISED that the costs already accrued in this case, including but not limited to, enforcement and investigation costs, are recoverable by the Department, as allowed under Riverside County Ordinance number 725. The Department may seek recovery of such costs from the property owner(s) which may result in a special assessment lien against the property. Additionally, should Code Enforcement abate the property, the costs associated therewith, as well as all abatement costs allowed under Riverside County Ordinance 725, will be sought from the property owner(s) and/or may result in a special assessment lien against the property.

NOTICE IS ADDITIONALLY GIVEN that in accordance with § § 17274 and 24426.5 of the Revenue and Tax Code, a tax deduction may not be allowed for interest, taxes, depreciation, or amortization paid or incurred in the taxable year affected by these proceedings.

CODE ENFORCEMENT DEPARTMENT

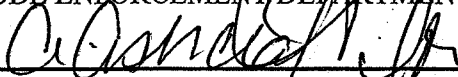

Jennifer Morris, Code Enforcement Officer

COPY

EXHIBIT NO. E3

PROOF OF SERVICE BY MAIL

Case No. CV09-04756

I Alecia Ashcraft, the undersigned, say I am a citizen of the United States and am employed in the County of Riverside, over the age of 18 years and not a party to the within action or proceeding; that my business address is 24318 Hemlock Avenue, Suite C-1, Moreno Valley, CA 92557.

I am readily familiar with our department's practice for collection and processing of correspondence for mailing with the United States Postal Service. Correspondence is deposited with the United States Postal Service on the same day in the ordinary course of business.

That on the 27th day of July, 2009. I served a copy of the papers to which this proof of service is attached, entitled:

- Notice of Violation (RCC 8.120.010)
- Summary Costs Notification
- Notice List

by depositing a copy thereof in an envelope for deposit in the United States Postal Service via Certified Mail, return receipt requested, and addressed as follows:

SEE ATTACHED NOTICE LIST

The envelope was sealed and placed for collection and mailing at MORENO VALLEY, CALIFORNIA, on the same date following the ordinary business practices.

I certify under penalty of perjury according to the laws of the State of California that the foregoing is true and correct.

Executed this 27th of July, 2009, at Moreno Valley, California.

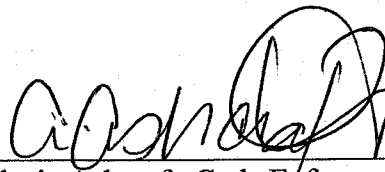

Alecia Ashcraft, Code Enforcement Aide

Article Number: 7009 0080 0000 7301 4566
7009 0080 0000 7301 4559
7009 0080 0000 7301 4542
7009 0080 0000 7301 4535



John Boyd
DIRECTOR

Code Enforcement Department
County Of Riverside
Moreno Valley District Office
24318 Hemlock Avenue, Suite C-1
Moreno Valley, California 92557
(951) 485-5840 – Fax (951) 485-4938

NOTICE LIST / INTERESTED PARTIES

July 27, 2009

RE: Case No.: CV09-04756
APN No.: 345-200-042
Address: 22841 Fisher Road, Perris, CA 92570

1. Rita Nauta Alig
22841 Fisher Road
Perris, CA 92570
2. Scott Edward Darling
3697 Arlington Avenue
Riverside, CA 92506-3938
3. Eastern Municipal Water District
Attention: Billing Department
P.O. Box 8300
Perris, CA 92570
4. Alice Beasley
P.O. Box 1280
Riverside, CA 92502

COPY

COUNTY OF RIVERSIDE
Code Enforcement Department
24318 Hemlock Avenue, Suite C-1
Moreno Valley, CA 92557

RETURN RECEIPT REQUESTED

RETURN RECEIPT REQUESTED

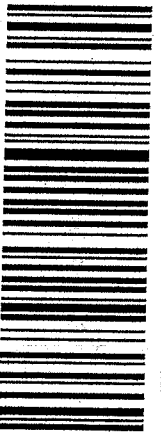

7009 0080 0000 7301 4566

FIRST CLASS



UNITED STATES POSTAGE
PRIMEY BOWES
02 1M
0004234315
MAILED FROM ZIP CODE 92504
\$ 05.54⁰⁰
JUL 28 2009

REC'D AUG 05 2009

9257036624 R010

NOT DELIVERABLE
AS ADDRESSED,
UNABLE TO FORWARD

Rita Nauta Alig
22841 Fisher Road
Perris, CA 92570
CV09-04756/JM

WTC
2020

U.S. Postal Service TM
CERTIFIED MAIL TM RECEIPT
(Domestic Mail Only; No Insurance Coverage Provided)

For delivery information visit our website at www.usps.com

OFFICIAL USE

Postage	\$
Certified Fee	
Return Receipt Fee (Endorsement Required)	
Restricted Delivery Fee (Endorsement Required)	
Total Pr	

Postmark
Here

Sent To
Street, A
or PO Box
City, State

Rita Nauta Alig
22841 Fisher Road
Perris, CA 92570
CV09-04756/JM

PS Form 3800, August 2008

See Reverse for Instructions

9954 1062 0000 0900 6002

U.S. Postal Service™
CERTIFIED MAIL™ RECEIPT
 (Domestic Mail Only; No Insurance Coverage Provided)

For delivery information visit our website at www.usps.com®

OFFICIAL USE

Postage	\$	Postmark Here
Certified Fee		
Return Receipt Fee (Endorsement Required)		
Restricted Delivery Fee (Endorsement Required)		
Total Price		

Sent To
 Street, Apt.
 or PO Box
 City, State

Scott Edward Darling
 3697 Arlington Avenue
 Riverside, CA 92506-3938
 CV09-04756/JM

PS Form 3800, August 2006

See Reverse for Instructions

SENDER: COMPLETE THIS SECTION

- Complete items 1, 2, and 3. Also complete item 4 if Restricted Delivery is desired.
- Print your name and address on the reverse so that we can return the card to you.
- Attach this card to the back of the mailpiece, or on the front if space permits.

1. Article Addressed to:

Scott Edward Darling
 3697 Arlington Avenue
 Riverside, CA 92506-3938
 CV09-04756/JM

2. Article Number
 (Transfer from service label)

7009 0080 0000 7301 4559

PS Form 3811, February 2004

Domestic Return Receipt

102595-02-M-1540

COMPLETE THIS SECTION ON DELIVERY

A. Signature ☒ Agent
☒ Addressee

B. Received by (Printed Name)

C. Date of Delivery

D. Is delivery address different from item 1? ☐ Yes
 If YES, enter delivery address below: ☒ No

REC'D JUL 30 2009

3. Service Type
☒ Certified Mail ☐ Express Mail
☐ Registered ☒ Return Receipt for Merchandise
☐ Insured Mail ☐ C.O.D.

4. Restricted Delivery? (Extra Fee) ☐ Yes

7009 0080 0000 7301 4542

U.S. Postal Service™ CERTIFIED MAIL™ RECEIPT (Domestic Mail Only; No Insurance Coverage Provided)	
For delivery information visit our website at www.usps.com	
OFFICIAL USE	
Postage \$ Certified Fee Return Receipt Fee (Endorsement Required) Restricted Delivery Fee (Endorsement Required) Total Post:	Postmark Here
Sent To Eastern Municipal Water District Attention: Billing Department P.O. Box 8300 Perris, CA 92570 CV09-04756/JM	
Street, Apt. 1 or PO Box # City, State, #	
PS Form 3800, August 2005 See Reverse for Instructions	

SENDER: COMPLETE THIS SECTION	COMPLETE THIS SECTION ON DELIVERY
<ul style="list-style-type: none"> ■ Complete items 1, 2, and 3. Also complete item 4 if Restricted Delivery is desired. ■ Print your name and address on the reverse so that we can return the card to you. ■ Attach this card to the back of the mailpiece, or on the front if space permits. 	A. Signature <i>x Marlene Strubeck</i> <input type="checkbox"/> Agent <input checked="" type="checkbox"/> Addressee
1. Article Addressed to: Eastern Municipal Water District Attention: Billing Department P.O. Box 8300 Perris, CA 92570 CV09-04756/JM	B. Received by (Printed Name) <i>Marlene Strubeck</i>
2. Article Number (Transfer from service label)	C. Date of Delivery REC'D JUL 30 2009
3. Service Type <input checked="" type="checkbox"/> Certified Mail <input type="checkbox"/> Express Mail <input type="checkbox"/> Registered <input type="checkbox"/> Return Receipt for Merchandise <input type="checkbox"/> Insured Mail <input type="checkbox"/> C.O.D.	D. Is delivery address different from item 1? <input type="checkbox"/> Yes <input checked="" type="checkbox"/> No If YES, enter delivery address below:
4. Restricted Delivery? (Extra Fee) <input type="checkbox"/> Yes	
7009 0080 0000 7301 4542	
PS Form 3811, February 2004 Domestic Return Receipt 102595-02-M-1540	

EXHIBIT NO. *E8*

7009 0080 0000 7301 4535

U.S. Postal Service™
CERTIFIED MAIL™ RECEIPT
 (Domestic Mail Only; No Insurance Coverage Provided)

For delivery information visit our website at www.usps.com®

OFFICIAL USE

Postage	\$	Postmark Here
Certified Fee		
Return Receipt Fee (Endorsement Required)		
Restricted Delivery Fee (Endorsement Required)		
Total Postage		

Sent To	Alice Beasley
Street, Ap or PO Box	P.O. Box 1280
City, State	Riverside, CA 92502
	CV09-04756/JM

PS Form 3800, August 2003

See Reverse for Instructions

SENDER: COMPLETE THIS SECTION

- Complete items 1, 2, and 3. Also complete item 4 if Restricted Delivery is desired.
- Print your name and address on the reverse so that we can return the card to you.
- Attach this card to the back of the mailpiece, or on the front if space permits.

1. Article Addressed to:

Alice Beasley
 P.O. Box 1280
 Riverside, CA 92502
 CV09-04756/JM

COMPLETE THIS SECTION ON DELIVERY

A. Signature ☒ Agent
☒ Addressee

B. Received by (Printed Name) C. Date of Delivery
 DON PETERSON 7-30-09

D. Is delivery address different from item 1? ☐ Yes
 If YES, enter delivery address below: ☐ No

REC'D JUL 31 2009

3. Service Type
☒ Certified Mail ☐ Express Mail
☐ Registered ☒ Return Receipt for Merchandise
☐ Insured Mail ☐ C.O.D.

4. Restricted Delivery? (Extra Fee) ☐ Yes

2. Article Number
 (Transfer from service label)

7009 0080 0000 7301 4535

PS Form 3811, February 2004

Domestic Return Receipt

102595-02-M-1540

EXHIBIT NO.

E9

When recorded please mail to:

Riverside County Code Enforcement Department
(District 5 Office)
24318 Hemlock Avenue, Suite C-1
Moreno Valley, CA 92557
Mail Stop No. 5002

Doc # 2009-0400310

07/31/2009 08:00A Fee:NC

Page 1 of 1

Recorded in Official Records

County of Riverside

Larry W. Ward

Assessor, County Clerk & Recorder



S	R	U	PAGE	SIZE	DA	MISC	LONG	RFD	COPY
1			1						
M	A	L	465	426	PCOR	NCOR	SMF	NCHG	EXAM
NCHG CC						T:	CTY	UNI	062

NOTICE OF NONCOMPLIANCE

In the matter of the Property of
Rita Nauta Alig

Case No. CV09-04756



NOTICE IS HEREBY GIVEN to all persons, pursuant to Section 10 of Ordinance Number 725 of the County of Riverside, State of California, that proceedings have been commenced with respect to violations of Riverside County Ordinance No.541, (RCC Title 8.120.010) described as Accumulated Rubbish. Such Proceedings are based upon the noncompliance of such real property, located at 22841 Fisher Road, Perris, CA, and more particularly described as Assessor's Parcel Number 325-200-042 and having a legal description of 2.39 ACRES IN PAR 102 RS 026/001, Records of Riverside County, with the requirements of Ordinance No. 541 (RCC Title 8.120.010).

The owner has been advised to immediately correct the above-referenced violations to avoid further action by the County of Riverside which may include demolition, removal, razing, etc., to abate the public nuisance. Any costs incurred by the County, including, but not limited to investigative, administrative and abatement costs and attorneys' fees, may become a lien on the property. Further details regarding this notice may be obtained by addressing an inquiry to the Code Enforcement Department, 24318 Hemlock Avenue, Suite C-1, Moreno Valley, California, Attention Code Enforcement Officer Jennifer Morris.

NOTICE IS FURTHER GIVEN in accordance with §17274 and §24436.5 of the California Revenue and Taxation Code, that a tax deduction may not be allowed for interest, taxes, depreciation, or amortization paid or incurred in the taxable year affected by these proceedings.

COUNTY OF RIVERSIDE
CODE ENFORCEMENT DEPARTMENT

By Mary Overholt
Mary Overholt
Code Enforcement Department

ACKNOWLEDGMENT

State of California)
County of Riverside)

On 07/28/09 before me, Ana E. Carrillo, Notary Public, personally appeared Mary Overholt, who proved to me on the basis of satisfactory evidence to be the person(s) whose name(s) is are subscribed to the within instrument and acknowledged to me that he/she/they executed the same in his/her/their authorized capacity(ies), and that by his/her/their signature(s) on the instrument the person(s), or the entity upon behalf of which the person(s) acted, executed the instrument.

I certify under PENALTY OF PERJURY under the laws of the State of California that the foregoing paragraph is true and correct.

WITNESS my hand and official seal.

Ana E. Carrillo

Commission # 1767676

Comm. Expires Sep. 14, 2011

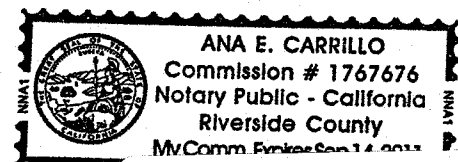

EXHIBIT NO. P

PAMELA J. WALLS
County Counsel

Principal Deputy
KATHERINE A. LIND

OFFICE OF COUNTY COUNSEL
COUNTY OF RIVERSIDE

3960 ORANGE STREET, 5TH FLOOR
RIVERSIDE, CA 92501
TELEPHONE: 951/955-6300
FAX: 951/955-6322 & 955-6363

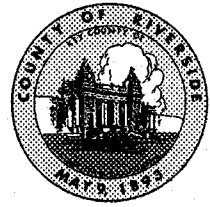

December 29, 2009

NOTICE TO CORRECT COUNTY ORDINANCE VIOLATIONS
AND ABATE PUBLIC NUISANCE

TO: Owners and Interested Parties
(See Attached Proof of Service
and Attached Notice List)

Case No.: CV09-04756
APN: 325-200-042
Property: 22841 Fisher Road, Perris

NOTICE IS HEREBY GIVEN that a hearing will be held before the Riverside County Board of Supervisors pursuant to Riverside County Ordinance Nos. 541 (RCC Title 8) and 725 (RCC Title 1) to consider the abatement of the Accumulation of Rubbish located on the SUBJECT PROPERTY described as **22841 Fisher Road, Perris, Riverside County, California**, and more particularly described as Assessor's Parcel Number 325-200-042.

YOU ARE HEREBY DIRECTED as owner of the SUBJECT PROPERTY, to appear at this hearing to show cause why the SUBJECT PROPERTY should not be condemned as a public nuisance and be abated by removing the Accumulation of Rubbish from the real property.

SAID HEARING will be held on **Tuesday, January 26, 2010, at 9:30 a.m.** in the Board of Supervisors Room, County Administrative Center, 4080 Lemon Street, 1st Floor Annex, Riverside, California at which time and place pertinent evidence will be received and/or testimony from all concerned parties will be heard. Failure to appear on your behalf will result in the exclusion of your testimony, and facts as known to the Code Enforcement Department ("Department") will be presented to the Board of Supervisors for consideration and deliberation in this matter.

Please be advised that the costs already accrued in this case, including but not limited to, enforcement and investigation costs, are recoverable by the Department, as allowed under Riverside County Ordinance No. 725. The Department may seek recovery of such costs from the property owner(s) which may result in a special assessment lien against the SUBJECT PROPERTY. Additionally, should the Department abate the property, the costs associated therewith, as well as all abatement costs allowed under Riverside County Ordinance No. 725 (RCC Title 1), will be sought from the property owner(s) and/or may result in a special assessment lien against the property.

You are encouraged to contact Supervising Code Enforcement Officer Mary Overholt at (951) 485-5840 or the undersigned prior to the hearing. Please meet the undersigned and Brian Black, Supervising Code Enforcement Officer, at 8:30 a.m. on the day of the hearing in the lobby of the 1st floor annex in front of the Clerk of the Board's Office to discuss the case.

PAMELA J. WALLS
Riverside County Counsel

JULIE A. JARVI
Deputy County Counsel

EXHIBIT NO. 6

NOTICE LIST

Subject Property: 22841 Fisher Street, Perris
Case No.: CV 09-04756; APN: 325-200-042; District 5

RITA NAUTA ALIG
22841 FISHER ROAD
PERRIS, CA 92570

SCOTT EDWARD DARLING
3697 ARLINGTON AVENUE
RIVERSIDE, CA 92506-3938

EASTERN MUNICIPAL WATER DISTRICT
PO BOX 8300
PERRIS, CA 92570

ALICE BEASLEY
P.O. BOX 1280
RIVERSIDE, CA 92502

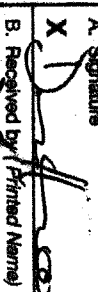
1. Article Addressed to: ALICE BEASLEY P O BOX 1280 RIVERSIDE, CA 92502 CV09-04756 *ABT* ALIG 4		2. Article Number (Transfer from service label) 7009 1680 0000 9025 4380	
3. Service Type <input checked="" type="checkbox"/> Certified Mail <input type="checkbox"/> Express Mail <input type="checkbox"/> Registered <input checked="" type="checkbox"/> Return Receipt for Merchandise <input type="checkbox"/> Insured Mail <input type="checkbox"/> C.O.D.		4. Restricted Delivery? (Extra Fee) <input type="checkbox"/> Yes	
5. Signature X  B. Received by (Printed Name) <u>Alice Beasley</u> C. Date of Delivery <u>1-5-2010</u>		6. Agent <input type="checkbox"/> 7. Is delivery address different from item 1? <input type="checkbox"/> Yes If YES, enter delivery address below: <input type="checkbox"/> No	
PS Form 3811, February 2004 Domestic Return Receipt 10000-09-00-0000			

NOTICE LIST

Subject Property: 22841 Fisher Street, Perris
Case No.: CV 09-04756; APN: 325-200-042; District 5

DEER:

- Complete items 1, 2, and 3. Also complete item 4 if Restricted Delivery is desired.
- Print your name and address on the reverse so that we can return the card to you.
- Attach this card to the back of the mailpiece, or on the front if space permits.

1. Article Addressed to:

SCOTT EDWARD DARLING
3697 ARLINGTON AVE.
RIVERSIDE, CA. 92506
CV09-04756 * ABT* ALIG 4

DEER:

A. Signature ☒ X ☐ Agent ☐ Address

B. Received by (Printed Name) ☒ C. Date of Delivery

D. Is delivery address different from item 1? ☐ Yes ☐ No
If YES, enter delivery address below:

3. Service Type

☒ Certified Mail ☐ Express Mail
☐ Registered ☒ Return Receipt for Merchandise
☐ Insured Mail ☐ C.O.D.

4. Restricted Delivery? (Extra Fee) ☐ Yes

2. Article Number

(Number from service label)

7009 1680 0000 9025 4403

PS Form 3811, February 2004

Domestic Return Receipt

PSN 95-02-10-1540

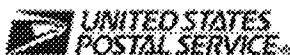
[Home](#) | [Help](#) | [Sign In](#)
[Track & Confirm](#)
[FAQs](#)

Track & Confirm

Search Results

Label/Receipt Number: 7009 1680 0000 9025 4397

Service(s): **Certified Mail™**Status: **Delivered**

Your item was delivered at 8:56 AM on December 30, 2009 in PERRIS, CA 92572.

Track & Confirm

Enter Label/Receipt Number.

Go >

Detailed Results:

- Delivered, December 30, 2009, 8:56 am, PERRIS, CA 92572
- Arrival at Unit, December 30, 2009, 8:45 am, PERRIS, CA 92570

Notification Options

Track & Confirm by email

Get current event information or updates for your item sent to you or others by email.

Go >

[Site Map](#)
[Customer Service](#)
[Forms](#)
[Gov't Services](#)
[Careers](#)
[Privacy Policy](#)
[Terms of Use](#)
[Business Customer Gateway](#)

Copyright© 2009 USPS. All Rights Reserved.

No FEAR Act EEO Data

FOIA



United States Postal Service
is an Equal Opportunity Employer



Signatures
Postmark Here

U.S. Postal Service	
CERTIFIED MAIL RECEIPT	
(Domestic Mail Only; No Insurance Coverage Provided)	
For delivery information visit our website at www.usps.com	
OFFICIAL USE	
Postage	\$.44
Certified Fee	2.80
Return Receipt Fee (Endorsement Required)	2.30
Restricted Delivery Fee (Endorsement Required)	5.84
Tr EASTERN MUNICIPAL WATER DIST	
P O BOX 8300	
PERRIS, CA. 92570	
CV09-04756 *ABT* ALIG 4	
PS Form 3800, Rev. 10-2008	

12/29/09
Postmark Here

Instructions

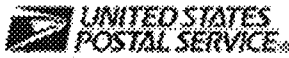
[Home](#) | [Help](#) | [Sign In](#)
[Track & Confirm](#)
[FAQs](#)

Track & Confirm

Search Results

Label/Receipt Number: **7009 1680 0000 9025 4410**

Service(s): **Certified Mail™**

Status: **Undeliverable as Addressed**

Your item was undeliverable as addressed at 2:50 PM on January 9, 2010 in PERRIS, CA 92570. It is being returned if appropriate information is available.

Detailed Results:

- **Undeliverable as Addressed, January 09, 2010, 2:50 pm, PERRIS, CA 92570**
- **Undeliverable as Addressed, December 31, 2009, 9:27 am, PERRIS, CA 92570**

Notification Options

Track & Confirm by email

Get current event information or updates for your item sent to you or others by email.

[Go >](#)
[Site Map](#)
[Customer Service](#)
[Forms](#)
[Gov't Services](#)
[Careers](#)
[Privacy Policy](#)
[Terms of Use](#)
[Business Customer Gateway](#)

Copyright© 2009 USPS. All Rights Reserved.

No FEAR Act EEO Data

FOIA



The Equal Housing Opportunity logo is a symbol of the U.S. Department of Housing and Urban Development.



The American Revolution logo is a symbol of the U.S. Department of the Interior.

U.S. Postal Service CERTIFIED MAIL RECEIPT (Domestic Mail Only, No Insurance Coverage Provided)	
For delivery information visit our website at www.usps.com	
OFFICIAL USE	
Postage	\$ 44
Certified Fee	2.80
Return Receipt Fee (Endorsement Required)	2.30
Restricted Delivery Fee (Endorsement Required)	5.51
Total Postage & Fees	\$ 11.05
RITA NAUTA ALIG 22841 FISHER RD PERRIS CA 92570 CV09-04756 *ABT* ALIG 4	

mailed 12/29/09

Postmark Here

Instructions

PROOF OF SERVICE

Case Nos. CV0-04756

STATE OF CALIFORNIA, COUNTY OF RIVERSIDE

I, Yadira Oseguera, declare that I am a citizen of the United States and am employed in the County of Riverside, over the age of 18 years and not a party to the within action or proceeding; that my business address is 3960 Orange Street, 5th Floor, Riverside, California 92501.

That on December 29, 2009 I served the following document(s):

**NOTICE TO CORRECT COUNTY ORDINANCE VIOLATIONS
AND ABATE PUBLIC NUISANCE**

by placing a true copy thereof enclosed in a sealed envelope(s) addressed as follows:

**Owners or Interested Parties
(see attached notice list)**

XX **BY CERTIFIED MAIL, RETURN RECEIPT REQUESTED.** I am "readily familiar" with the office's practice of collection and processing correspondence for mailing. Under that practice it would be deposited with the U.S. Postal Service on that same day with postage thereon fully prepaid at Riverside, California, in the ordinary course of business.

— **BY PERSONAL SERVICE:** I caused to be delivered such envelope(s) by hand to the offices of the addressee(s).

XX **STATE - I declare under penalty of perjury under the laws of the State of California that the above is true and correct.**

— **FEDERAL - I declare that I am employed in the office of a member of the bar of this court at whose direction the service was made.**

EXECUTED ON December 29, 2009 at Riverside, California.



YADIRA OSEGUERA

EXHIBIT NO. 64

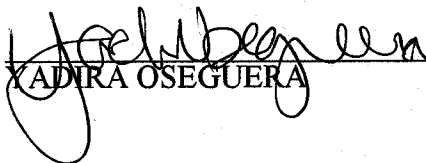
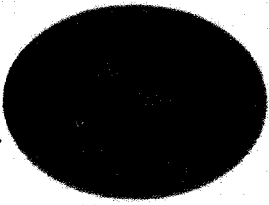

**CODE ENFORCEMENT DEPARTMENT
COUNTY OF RIVERSIDE**

JOHN BOYD
Director

AFFIDAVIT OF POSTING OF NOTICES

December 30, 2009

RE CASE NO: CV0904756

I, Jennifer Morris, hereby declare:

I am employed by the Riverside County Code Enforcement Department; that my business address is 24318 Hemlock, Ave., Suite C-1, Moreno Valley, California 92557 .

That on 12/30/09 at 10:00 hrs, I securely and conspicuously posted Notice to Correct County Ordinance Violation and Abate Public Nuisance at the property described as:

Property Address: 22841 FISHER RD, PERRIS

Assessor's Parcel Number: 325-200-042

I declare under the penalty of perjury that the foregoing is true and correct.

Executed on December 30, 2009 in the County of Riverside, California.

CODE ENFORCEMENT DEPARTMENT

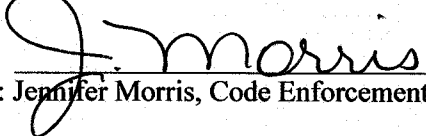
By: Jennifer Morris, Code Enforcement Officer II