

MINUTES OF THE BOARD OF SUPERVISORS
COUNTY OF RIVERSIDE, STATE OF CALIFORNIA



3.61

On motion of Supervisor Benoit, seconded by Supervisor Buster and duly carried by unanimous vote, IT WAS ORDERED the reading being waived, that an ordinance bearing the following title, is adopted:

ORDINANCE NO. 452.227

**AN ORDINANCE OF THE COUNTY OF RIVERSIDE, AMENDING
ORDINANCE NO. 452 RELATING TO PRIMA FACIE SPEED LIMITS**

I hereby certify that the foregoing is a full true, and correct copy of an order made and entered on February 9, 2010 of Supervisors
Minutes.

(seal) WITNESS my hand and the seal of the Board of Supervisors
Dated: February 9, 2010
Kecia Harper-Ihem, Clerk of the Board of Supervisors, in
and for the County of Riverside, State of California.

By: [Signature] Deputy

AGENDA NO.
3.61

xc: Transp., Co.Co., MC, COB(2)

- 1
- 2
- 3
- 4
- 5
- 6
- 7
- 8
- 9
- 10
- 11
- 12
- 13
- 14
- 15
- 16
- 17
- 18
- 19
- 20
- 21
- 22
- 23
- 24
- 25
- 26
- 27
- 28

2
3
4
5
6
7
8
9
10
11
12
13
14
15
16
17
18
19
20
21
22
23
24
25
26
27
28

3
4
5
6
7
8
9
10
11
12
13
14
15
16
17
18
19
20
21
22
23
24
25
26
27
28

4
5
6
7
8
9
10
11
12
13
14
15
16
17
18
19
20
21
22
23
24
25
26
27
28

- 5
- 6
- 7
- 8
- 9
- 10
- 11
- 12
- 13
- 14
- 15
- 16
- 17
- 18
- 19
- 20
- 21
- 22
- 23
- 24
- 25
- 26
- 27
- 28

6
7
8
9
10
11
12
13
14
15
16
17
18
19
20
21
22
23
24
25
26
27
28

8
9
10
11
12
13
14
15
16
17
18
19
20
21
22
23
24
25
26
27
28

11
12
13
14
15
16
17
18
19
20
21
22
23
24
25
26
27
28

13
14
15
16
17
18
19
20
21
22
23
24
25
26
27
28

16
17
18
19
20
21
22
23
24
25
26
27
28

19
20
21
22
23
24
25
26
27
28

21
22
23
24
25
26
27
28

24
25
26
27
28

///

///

1 Section 4. Section 2.5 of Ordinance No. 452, entitled "Forty-five miles per hour," is
2 amended to add new subsections 129, 130, 131, 132, 133, 134, 135, 136, 137, 138, 139, and 140 thereto
3 to read as follows:

- 4 "129. On the full-width of El Nido Avenue between the centerline of Orange
5 Avenue and the centerline of Walnut Avenue, and on the westerly half of El
6 Nido Avenue between the centerline of Walnut Avenue and the centerline
7 of Rider Street, a total distance of approximately 0.9 mile, in the Perris area.
- 8 130. On Leon Road between the centerline of Olive Avenue and the centerline of
9 Simpson Road, a total distance of approximately 0.5 mile, in the Winchester
10 area.
- 11 131. On Limonite Avenue between the centerline of Hamner Avenue and the
12 centerline of Wineville Avenue, a total distance of approximately 1.0 mile,
13 in the Pedley area.
- 14 132. On Magnolia Avenue between a point 400 feet west of the centerline of
15 Temescal Street and a point 2,000 feet east of the centerline of Lincoln
16 Street, a total distance of approximately 2.0 miles, in the Home Gardens
17 area.
- 18 133. On Marshall Avenue between the centerline of State Highway 74 and the
19 southerly terminus of Marshall Avenue, a total distance of 0.46 mile, in the
20 Hemet area.
- 21 134. On Mount Vernon Avenue between the centerline of Palmyrita Avenue and
22 the centerline of Main Street, a total distance of approximately 1.0 mile, in
23 the Highgrove area.
- 24 135. On Nancy Avenue between the centerline of Brookside Avenue and the
25 centerline of Cherry Valley Boulevard, a total distance of approximately 0.5
26 mile, in the Cherry Valley area.
- 27 136. On Sumner Avenue between the centerline of Citrus Street and the
28 centerline of Bellegrave Avenue, a total distance of approximately 2.14

1 miles, in the Eastvale area.

2 137. On Ontario Avenue between the centerline of State Street and the centerline
3 of El Cerrito Road, a total distance of approximately 0.7 mile, in the El
4 Cerrito area.

5 138. On Temescal Canyon Road between the centerline of El Cerrito Road and
6 the centerline of Cajalco Road, a total distance of approximately 1.1 miles,
7 in the El Cerrito area.

8 139. On Temescal Canyon Road between the centerline of Weirick Road and I-
9 15, a total distance of approximately 2.4 miles, in the Temescal Valley area.

10 140. On Valley Way between State Route 60 and the centerline of Sierra
11 Avenue, a total distance of approximately 1.0 mile, in the Sunnyslope area.”

12 Section 5. Section 2.6 of Ordinance No. 452, entitled “Fifty miles per hour,” is
13 amended to add new subsections 62, 63, and 64, thereto to read as follows:

14 “62. On Murrieta Hot Springs Road between the centerline of Calistoga Drive
15 and the centerline of Red Post Circle, a total distance of approximately 1.1
16 miles, in the Temecula area.

17 63. On Simpson Road between a point 300 feet west of Columbia Avenue and
18 the centerline of Whittier Avenue, a total distance of approximately 0.8
19 mile, in the Winchester area.

20 64. On Wood Road between the centerline of Cajalco Road and the centerline
21 of Mariposa Avenue, a total distance of approximately 2.5 miles, in the
22 Woodcrest area.”

23 Section 6. Section 2.7 of Ordinance No. 452, entitled “Fifty-five miles per hour,” is
24 amended to add a new subsection 21 thereto to read as follows:

25 “21. On Limonite Avenue between the centerline of Wineville Avenue and the
26 centerline of Etiwanda Avenue, a total distance of approximately 1.0 mile,
27 in the Pedley area.”
28

1 Section 7. Subsection 20 of Section 2.4 of Ordinance No. 452 adopted on February 4,
2 2003, pursuant to Ordinance No. 452.214 is repealed in its entirety. Subsection 20 of Section 2.4
3 established a forty miles per hour speed limit on Ontario Avenue between the centerline of State Street
4 and the centerline of El Cerrito Road, and on Temescal Canyon Road between the centerline of El Cerrito
5 Road and the centerline of Cajalco Road.

6 Subsection 23 of Section 2.4 of Ordinance No. 452 adopted on February 4, 2003, pursuant
7 to Ordinance No. 452.214 is repealed in its entirety. Subsection 23 of Section 2.4 established a forty miles
8 per hour speed limit on Temescal Canyon Road between I-15 and 1,600 feet east of Maitri Road.

9 Subsection 40 of Section 2.4 of Ordinance No. 452 adopted on February 4, 2003, pursuant
10 to Ordinance No. 452.214 is repealed in its entirety. Subsection 40 of Section 2.4 established a forty miles
11 per hour speed limit on Valley Way (Armstrong Road) from State Route 60 to the centerline of Sierra
12 Avenue.

13 Subsection 60 of Section 2.4 of Ordinance No. 452 adopted on February 4, 2003, pursuant
14 to Ordinance No. 452.214 is repealed in its entirety. Subsection 60 of Section 2.4 established a forty miles
15 per hour speed limit on Leon Road between Simpson Road and Olive Avenue.

16 Subsection 26 of Section 2.5 of Ordinance No. 452 adopted on February 4, 2003, pursuant
17 to Ordinance No. 452.214 is repealed in its entirety. Subsection 26 of Section 2.5 established a forty-five
18 miles per hour speed limit on Newport Road between the centerline of Interstate 215 freeway and the
19 centerline of Meniffee Road.

20 Subsection 33 of Section 2.5 of Ordinance No. 452 adopted on February 4, 2003, pursuant
21 to Ordinance No. 452.214 is repealed in its entirety. Subsection 33 of Section 2.5 established a forty-five
22 miles per hour speed limit on East Sixth Street between the city limit boundary of the City of Corona and
23 the centerline of Temescal Street.

24 Subsection 34 of Section 2.5 of Ordinance No. 452 adopted on February 4, 2003, pursuant
25 to Ordinance No. 452.214 is repealed in its entirety. Subsection 34 of Section 2.5 established a forty-five
26 miles per hour speed limit on Magnolia Avenue between the centerline of Temescal Street and the city
27 limit boundary of the City of Riverside.
28

1 Subsection 66 of Section 2.5 of Ordinance No. 452 adopted on February 4, 2003, pursuant
2 to Ordinance No. 452.214 is repealed in its entirety. Subsection 66 of Section 2.5 established a forty-five
3 miles per hour speed limit on Simpson Road from 300 feet west of Columbia Avenue to the centerline of
4 Patterson Avenue.

5 Subsection 84 of Section 2.5 of Ordinance No. 452 adopted on May 20, 2003, pursuant to
6 Ordinance No. 452.215 is repealed in its entirety. Subsection 84 of Section 2.5 established a forty-five
7 miles per hour speed limit on Sumner Avenue between Citrus Street and Cloverdale Road.

8 Subsection 4 of Section 2.6 of Ordinance No. 452 adopted on February 4, 2003, pursuant
9 to Ordinance No. 452.214 is repealed in its entirety. Subsection 4 of Section 2.6 established a fifty miles
10 per hour speed limit on Newport Road between Meniffee Road and Briggs Road.

11 Subsection 16 of Section 2.6 of Ordinance No. 452 adopted on February 4, 2003, pursuant
12 to Ordinance No. 452.214 is repealed in its entirety. Subsection 16 of Section 2.6 established a fifty miles
13 per hour speed limit on Temescal Canyon Road between the centerline of Cajalco Road and I-15.

14 Subsection 53 of Section 2.6 of Ordinance No. 452 adopted on September 16, 2008,
15 pursuant to Ordinance No. 452.224 is repealed in its entirety. Subsection 53 of Section 2.6 established a
16 fifty miles per hour speed limit on Newport Road between Murrieta Road and I-215.

17 Subsection 1 of Section 2.8 of Ordinance No. 452 adopted on February 4, 2003, pursuant
18 to Ordinance No. 452.214 is repealed in its entirety. Subsection 1 of Section 2.8 established a sixty miles
19 per hour speed limit on Domenigoni Parkway between the city limit boundary of the City of Hemet and
20 the easterly right-of-way boundary of Winchester Road (State Route 79).

21 ///

22 ///

23 ///

1 Section 8. This ordinance shall take effect 30 days after its adoption.

2 BOARD OF SUPERVISORS OF THE COUNTY
3 OF RIVERSIDE, STATE OF CALIFORNIA

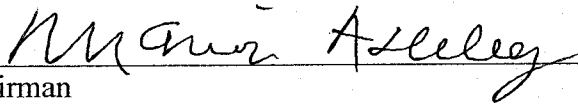
4
5 BY: 
6 Chairman

7
8
9 ATTEST:
10 KECIA HARPER-IHEM, Clerk of the Board

11
12 By: 
13 Deputy

14
15 APPROVED AS TO FORM:
16 PAMELA J. WALLS, County Counsel

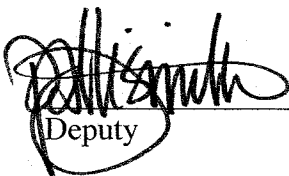
17
18 By: 
19 Deputy

1
2
3
4
5
6
7
8
9
10
11
12
13
14
15
16
17
18
19
20
21
22
23
24
25
26
27
28

STATE OF CALIFORNIA)
)
COUNTY OF RIVERSIDE) ss

I HEREBY CERTIFY that at a regular meeting of the Board of Supervisors of said county held on February 9, 2010, the foregoing ordinance consisting of 8 Sections was adopted by the following vote:

AYES: Buster, Tavaglione, Stone, Benoit, and Ashley
NAYS: None
ABSENT: None

DATE: February 9, 2010

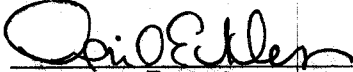
KECIA HARPER-IHEM
Clerk of the Board
BY: 
Deputy

SEAL

LEGEND:

- //// CITY LIMITS
- ▬ RADAR ZONE
- - - SURVEY STATION
- == OTHER STREET OR ROAD
- ▲ SCHOOL

DOMENIGONI PARKWAY (#1268)

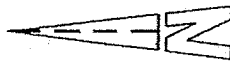
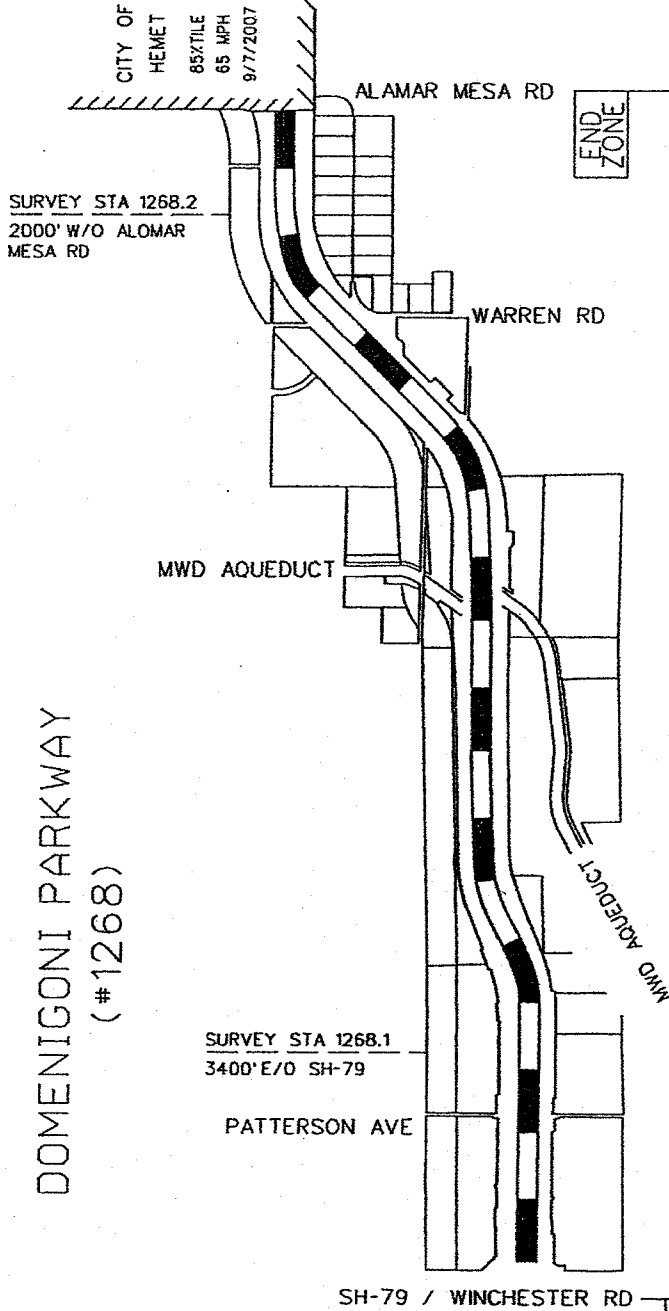

NO SCALE





** MAXIMUM PER CVC 22349

RECOMMENDED SPEED LIMIT	MAINTAIN CONSISTENT SPEED ZONE W/ CITY OF HEMET OF 65 MPH TO THE EAST - MAXIMUM PER CVC 22349	
85th/71st / (50th/71st SPEED)	** 65 MPH	
VEHICLES IN 24 HR (2 WAY)	(AVERAGE OF TWO SIMILAR SEGMENT STATIONS OF 71.0 AND 69.0 MPH) 70.0 MPH / (64.0 MPH)	
SEGMENT LENGTH	30,300	
ALL ACCIDENTS IN 2 YRS.	3.94 MILE	
ACCIDENT RATE ★	34	
EXISTING SPEED LIMIT	0.39 MVM	
	60 MPH (Ord 452.214 Sec. 2.8 No. 1)	

★ RATE: NO. OF ACCIDENT x 1000.000
VEH x 365 x 2 x MILE

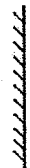
COUNTY AREA: WINCHESTER COUNTY MAP: 114, 115 SUPERVISOR DISTRICT: 3		SURVEY DATE: MAR 25, 2009 MAP DATE: APR 14, 2009 DRAWN BY: N AHMAD CAD FILE: DOMIPKWAY.DGN		APPROVED BY: <i>Lawrence T. Tai</i> DATE: 4/17/2009 LAWRENCE T. TAI, P.E. COUNTY TRAFFIC ENGINEER		COUNTY OF RIVERSIDE TRANSPORTATION DEPARTMENT TRAFFIC ENGINEERING DIVISION AT ENGINEERING AND TRAFFIC SURVEY DOMENIGONI PARKWAY		PAGE 1 OF 2
---	--	---	--	--	--	---	--	-------------

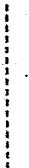
LEGEND:

-  CITY LIMITS
-  RADAR ZONE
-  SURVEY STATION
-  OTHER STREET OR ROAD

EL NIDO AVENUE (# 1430)

END
ZONE

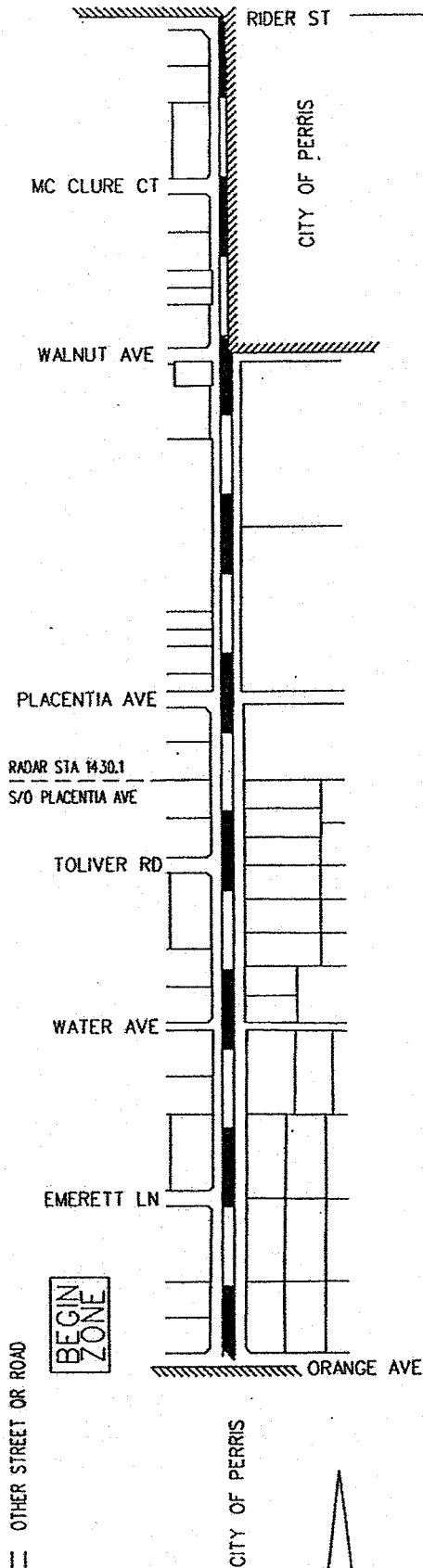

MULTIPLE HIDDEN DRIVEWAYS, PEDESTRIANS, RURAL RESIDENTIAL

RECOMMENDED SPEED LIMIT	45 MPH
PREVAILING SPEED (85%)	48.6 MPH
VEHICLES IN 24 HR (2WAY)	3,980
SEGMENT LENGTH	.90 MILE
ALL ACCIDENTS IN 2 YRS.	4
ACCIDENT RATE ★	1.53 MVM
EXISTING SPEED LIMIT	NOT POSTED

★ RATE: ACCIDENT x 1000 000
VEH x 365 x 2 x MILE

APPROVED BY:



COUNTY OF RIVERSIDE
TRANSPORTATION DEPARTMENT
TRAFFIC ENGINEERING SECTION

Lawrence T. Tai
DATE: 9/21/2007
LAWRENCE T. TAI, P.E.
COUNTY TRAFFIC ENGINEER

SURVEY DATE: MAY 2, 2006

MAP DATE: SEP 4, 2007

DRAWN BY: N AHMAD

CAD FILE: ELNIDO.DGN

COUNTY AREA: PERRIS

COUNTY MAP PAGE: 59

SUPERVISOR DISTRICT: 5

ENGINEERING AND TRAFFIC SURVEY
AT

EL NIDO AVENUE

PAGE
1 OF 1

LEGEND:

- ////// CITY LIMITS
- ▬ RADAR ZONE
- - - SURVEY STATION
- == OTHER STREET OR ROAD

GOLDEN STAR AVENUE (# 1452)

SURVEY STA 1452.1
1220' N/O WASHINGTON ST

COUNTRY MANOR LN

EVENING STAR RD

MAIN STREET

WEIKAMP LN

VALLE VISTA WY

SINGLE TREE LN

CITY OF
RIVERSIDE

BEGIN
ZONE

END
ZONE



NO SCALE

RECOMMENDED SPEED LIMIT	30 MPH
85th/TILE SPEED / (50th/TILE SPEED)	29.0 MPH / (25.0 MPH)
VEHICLES IN 24 HR (2 WAY)	820
SEGMENT LENGTH	1.0 MILE
ALL ACCIDENTS IN 2 YRS.	3
ACCIDENT RATE ★	5.01 MVM
EXISTING SPEED LIMIT	NOT POSTED

★ RATE: NO. OF ACCIDENT x 1000 000
VEH x 365 x 2 x MILE



COUNTY OF RIVERSIDE
TRANSPORTATION DEPARTMENT
TRAFFIC ENGINEERING DIVISION

PAGE
1 OF 1

APPROVED BY: *Lawrence T. Tai*
DATE: 10/27/08
LAWRENCE T. TAI, P.E.
COUNTY TRAFFIC ENGINEER

SURVEY DATE: AUG 27, 2008
MAP DATE: SEP 24, 2008
DRAWN BY: N AHMAD
CAD FILE: GOLDEN STAR AVE.DGN

COUNTY AREA: RIVERSIDE
COUNTY MAP: 27
SUPERVISOR DISTRICT: 1

ENGINEERING AND TRAFFIC SURVEY
AT
GOLDEN STAR AVENUE

LEGEND:

- ////// CITY LIMITS
- ▬ RADAR ZONE
- - - SURVEY STATION
- ▬ OTHER STREET OR ROAD
- ↑ SCHOOL

LEON ROAD (#1360)

SURVEY STA 1360.1
1000' S/O SIMPSON DR

SIMPSON RD

OLIVE AVE

BEGIN
ZONE

END
ZONE



NO SCALE

RURAL ROAD - NO SIDEWALKS - DIRT SHOULDERS - RESIDENTIAL DRIVEWAYS - REDUCE TO 45 MPH

RECOMMENDED SPEED LIMIT	45 MPH
85th%TILE SPEED / (50th%TILE SPEED)	52.0 MPH / (43.0 MPH)
VEHICLES IN 24 HR (2 WAY)	410
SEGMENT LENGTH	0.5 MILE
ALL ACCIDENTS IN 2 YRS.	0
ACCIDENT RATE ★	0.00 MVM
EXISTING SPEED LIMIT	40 MPH (Ord 452.214 Sec. 2.4 No. 60)

★ RATE: NO. OF ACCIDENT x 1000.000
VEH x 365 x 2 x MILE

COUNTY AREA:	WINCHESTER	SURVEY DATE:	MAR 25, 2009
COUNTY MAP:	113	MAP DATE:	APR 4, 2009
SUPERVISOR DISTRICT:	3	DRAWN BY:	N AHMAD
		CAD FILE:	LEON RD.DGN

APPROVED BY: *Lawrence T. Tai*
DATE: 5/11/2009
LAWRENCE T. TAI, P.E.
COUNTY TRAFFIC ENGINEER

COUNTY OF RIVERSIDE
TRANSPORTATION DEPARTMENT
TRAFFIC ENGINEERING DIVISION

ENGINEERING AND TRAFFIC SURVEY
AT

LEON ROAD

LEGEND:

- //// CITY LIMITS
- ▬ RADAR ZONE
- - - SURVEY STATION
- == OTHER STREET OR ROAD

LIMONITE AVENUE (#1012)

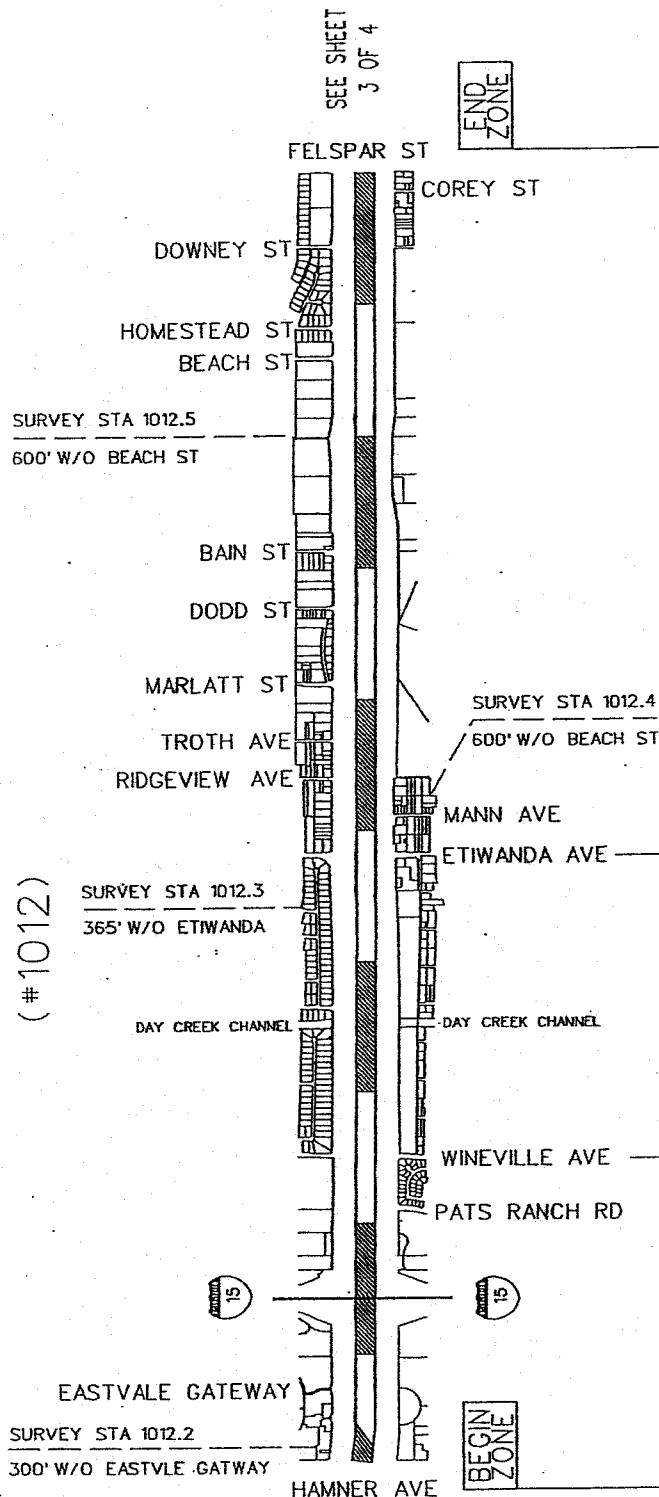

RECOMMENDED SPEED LIMIT	45 MPH	55 MPH	50 MPH	HIGH COLLISION RATE - REDUCE TO 50 MPH
85th/71th SPEED / (30th/71th SPEED)	43.8 MPH / (39.0 MPH)	59.0 MPH / (52.0 MPH)	(AVERAGE OF TWO STATIONS 49.3 MPH & 58 MPH) 53.6 MPH / (48.5 MPH)	
VEHICLES IN 24 HR (2 WAY)	19,370		21,400	
SEGMENT LENGTH	1.0 MILE	1.0 MILE	1.8 MILE	
ALL ACCIDENTS IN 2 YRS.	38	28	84	
ACCIDENT RATE*	2.69 MVM	1.98 MVM	2.99 MVM	
EXISTING SPEED LIMIT	55 MPH	55 MPH	50 MPH (Ord 452.214 Sec. 2.6 No. 27)	

☆ RATE: NO. OF ACCIDENT x 1,000 000
VEH x 365 x 2 x MILE

APPROVED BY:

Lawrence T. Tai, P.E.
DATE: 4/2/2009
LAWRENCE T. TAI, P.E.
COUNTY TRAFFIC ENGINEER

COUNTY AREA:	PEDLEY	SURVEY DATE:	MAY 31 2006
COUNTY MAP:	14, 14B, 15A, 15B, 16, 16A	MAP DATE:	MAR 17 2009
SUPERVISOR DISTRICT:	2	DRAWN BY:	N AHMAD
		CAD FILE:	LIMONITE.DGN

COUNTY OF RIVERSIDE
TRANSPORTATION DEPARTMENT
TRAFFIC ENGINEERING DIVISION

ENGINEERING AND TRAFFIC SURVEY
AT
LIMONITE AVENUE

PAGE
2 OF 4

LEGEND:

////// CITY LIMITS

▬ RADAR ZONE

- - - SURVEY STATION

== OTHER STREET OR ROAD

⬆ SCHOOL

MAGNOLIA AVENUE (#1100)

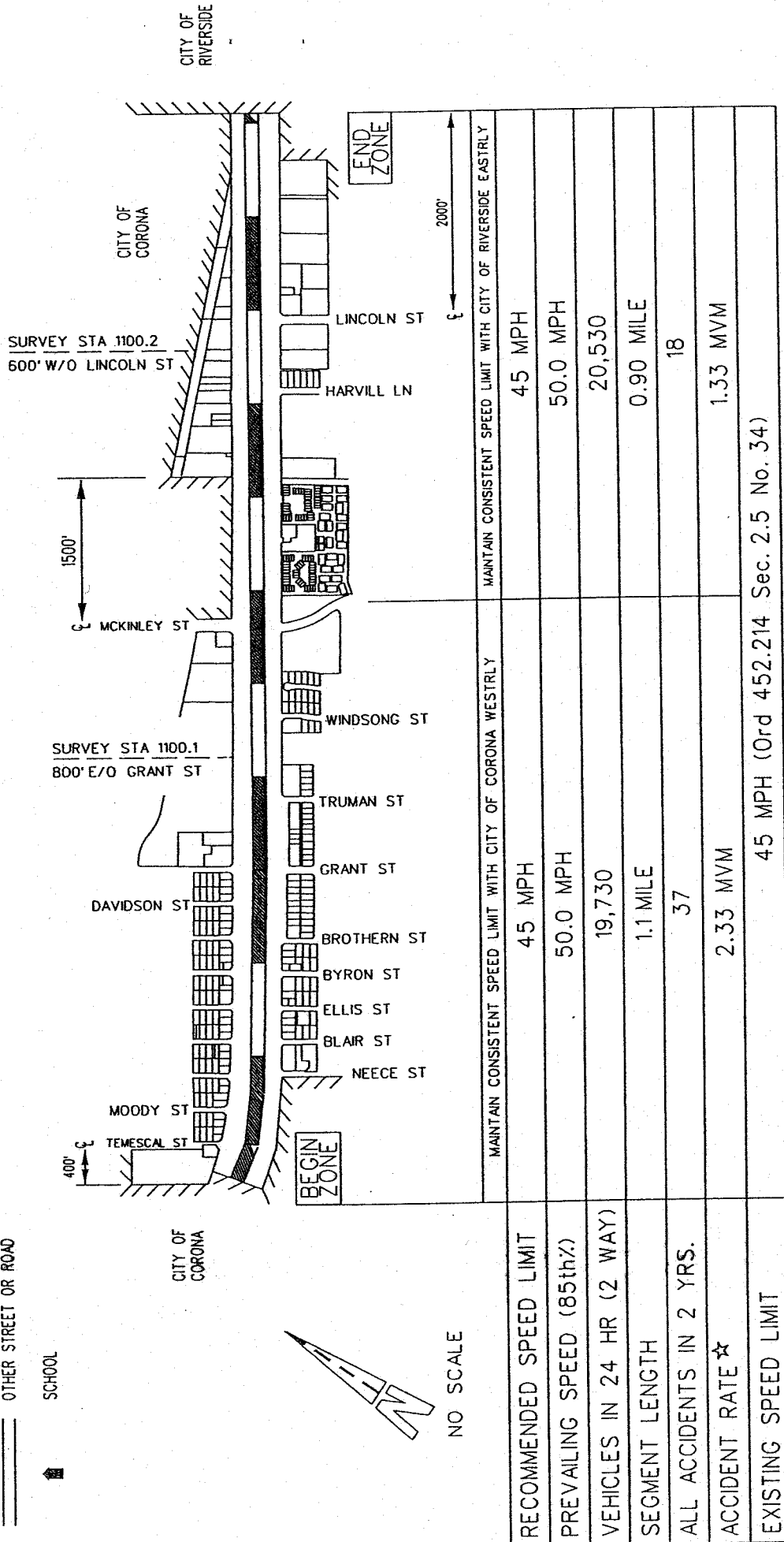

☆ RATE: $\frac{\text{ACCIDENT} \times 1000}{\text{VEH} \times 365 \times 2 \times \text{MILE}}$

APPROVED BY:

Lawrence T. Tai
DATE: 3/26/2008

LAWRENCE T. TAI, P.E.
COUNTY TRAFFIC ENGINEER

SURVEY DATE: SEP 26, 2007

MAP DATE: MAR 18, 2008

DRAWN BY: N AHMAD

CAD FILE: MAGNOLIA.DGN

COUNTY AREA: HOME GARDENS

COUNTY MAP: 22, 23A

SUPERVISOR DISTRICT: 2

COUNTY OF RIVERSIDE
TRANSPORTATION DEPARTMENT
TRAFFIC ENGINEERING DIVISION

ENGINEERING AND TRAFFIC SURVEY
AT
MAGNOLIA AVENUE

PAGE
1 OF 1

LEGEND:

- ////// CITY LIMITS
- ▬ RADAR ZONE
- - - SURVEY STATION
- == OTHER STREET OR ROAD
- ⬆ SCHOOL

MARSHALL AVENUE (#1457)

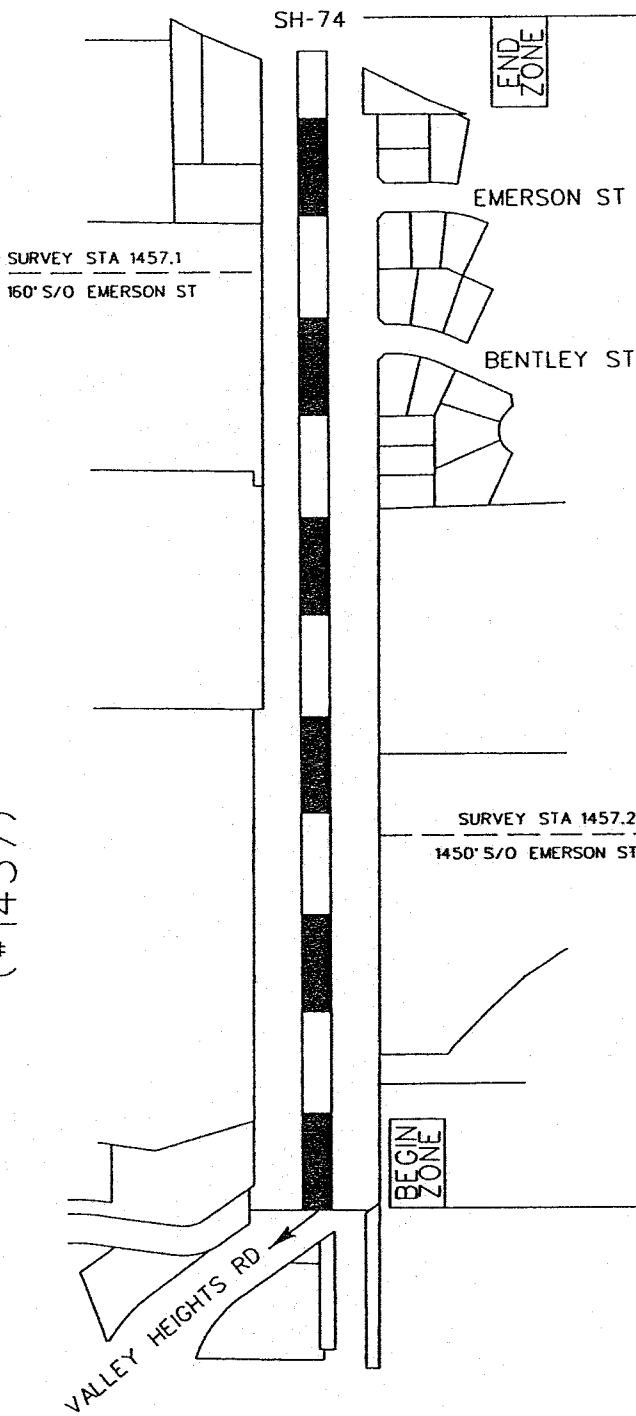

NO SCALE

RECOMMENDED SPEED LIMIT	45 MPH
85th/100th SPEED / (50th/100th SPEED)	(AVERAGE OF TWO STATIONS OF 49.0 & 42.0 MPH) 45.5 MPH / (37.5 MPH)
VEHICLES IN 24 HR (2 WAY)	(AVERAGE VOL OF TWO STATIONS OF 530 & 735 MPH) 630
SEGMENT LENGTH	0.46 MILE
ALL ACCIDENTS IN 2 YRS.	0
ACCIDENT RATE ★	0.00 MVM
EXISTING SPEED LIMIT	NOT POSTED

★ RATE: NO. OF ACCIDENT x 1000 000
VEH x 365 x 2 x MILE

COUNTY AREA:	HEMET	SURVEY DATE:	APR 1, 2009
COUNTY MAP:	152B	MAP DATE:	APR 11, 2009
SUPERVISOR DISTRICT:	3	DRAWN BY:	N AHMAD
		CAD FILE:	MARSHALL.DGN

APPROVED BY:

Lawrence T. Tai
DATE: 5/11/09.

LAWRENCE T. TAI, P.E.
COUNTY TRAFFIC ENGINEER

COUNTY OF RIVERSIDE
TRANSPORTATION DEPARTMENT
TRAFFIC ENGINEERING DIVISION

ENGINEERING AND TRAFFIC SURVEY
AT
MARSHALL AVENUE



LEGEND:

- ////// CITY LIMITS
- ===== RADAR ZONE
- SURVEY STATION
- ===== OTHER STREET OR ROAD
- ↑ SCHOOL

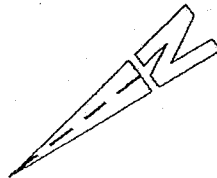
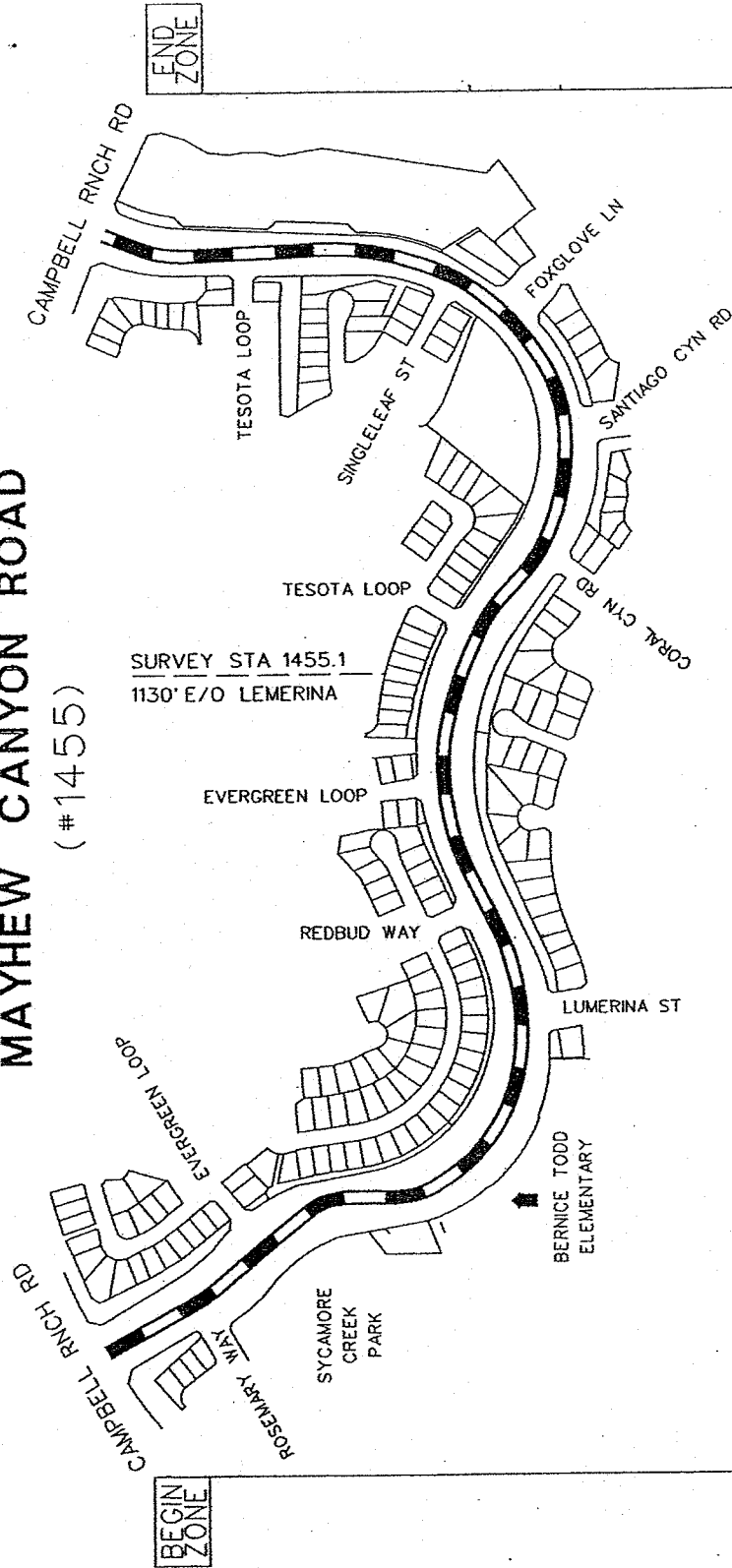

NO SCALE

RECOMMENDED SPEED LIMIT	40 MPH
85th/7ILE SPEED / (50th/7ILE SPEED)	44.0 MPH / (37.0 MPH)
VEHICLES IN 24 HR (2 WAY)	880
SEGMENT LENGTH	1.2 MILE
ALL ACCIDENTS IN 2 YRS.	0
ACCIDENT RATE ☆	0.00 MVM
EXISTING SPEED LIMIT	NOT POSTED

☆ RATE: NO. OF ACCIDENT x 1000 000
VEH x 365 x 2 x MILE

COUNTY AREA:	CORONA	SURVEY DATE:	APR 1, 2009
COUNTY MAP:	33D	MAP DATE:	APR 3, 2009
SUPERVISOR DISTRICT:	1	DRAWN BY:	N AHMAD
		CAD FILE:	MAYHEW CYN.DGN

APPROVED BY: *Lawrence T. Tai*
DATE: 4/3/2009
LAWRENCE T. TAI, P.E.
COUNTY TRAFFIC ENGINEER

LEGEND:

- ////// COUNTY / CITY LIMITS
- ▬ RAQAR ZONE
- - - SURVEY STATION
- ===== OTHER STREET OR ROAD
- ⬆ SCHOOL

MOUNT VERNON AVENUE (#1454)

SURVEY STA 1454.2
660' S/O MAIN ST

CENTER ST

SPRING ST

SURVEY STA 1454.1
800' S/O SPRING ST

BLUE MTN DR

OLD HIGHGROVE RD

PIGEON PASS RD

PALMYRITA AVE

CITY OF
RIVERSIDE

END
ZONE

BEGIN
ZONE



NO SCALE

RECOMMENDED SPEED LIMIT	45 MPH
85th%TILE SPEED / (50th%TILE SPEED)	45.0 MPH / (40.0 MPH)
VEHICLES IN 24 HR (2 WAY)	3000
SEGMENT LENGTH	1.0 MILE
ALL ACCIDENTS IN 2 YRS.	1
ACCIDENT RATE ☆	0.46 MVM
EXISTING SPEED LIMIT	NOT POSTED

☆ RATE: NO. OF ACCIDENT x 1,000,000
VEH x 365 x 2 x MILE

COUNTY AREA:	HIGHGROVE	SURVEY DATE:	FEB 11, 2009
COUNTY MAP:	44B	MAP DATE:	FEB 18, 2009
SUPERVISOR DISTRICT:	5	DRAWN BY:	N AHMAD
		CAD FILE:	MT VERNON.DGN

APPROVED BY:

Lawrence T. Tai
DATE: 2/18/2009

LAWRENCE T. TAI, P.E.
COUNTY TRAFFIC ENGINEER

COUNTY OF RIVERSIDE
TRANSPORTATION DEPARTMENT
TRAFFIC ENGINEERING DIVISION

ENGINEERING AND TRAFFIC SURVEY
AT

MOUNT VERNON AVENUE

PAGE
1 OF 1

LEGEND:

- //// CITY LIMITS
- == RADAR ZONE
- - - SURVEY STATION
- == OTHER STREET OR ROAD
- ⬆ SCHOOL

MURRIETA HOT SPRINGS ROAD

(#1267)

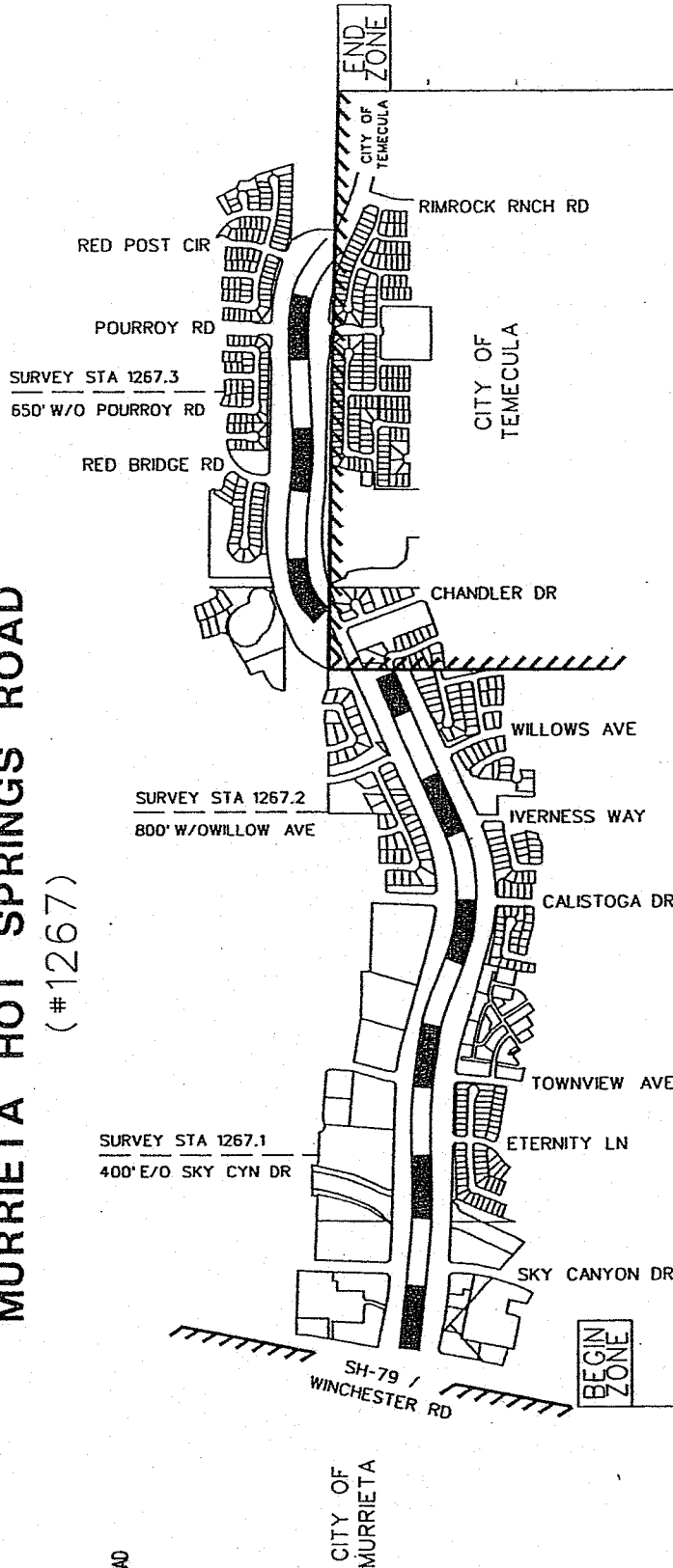

NO SCALE

RECOMMENDED SPEED LIMIT	50 MPH	50 MPH	MAINTAIN CONSISTENT SPEED LIMIT WITH SIMILAR SEGMENT TO THE WEST - REDUCE TO 50 MPH.
85th%TILE SPEED / (50th%TILE SPEED)	50.0 MPH / (44.0 MPH)	(AVERAGE OF TWO SIMILAR SEGMENTS OF 59 & 54 MPH) 56.5 MPH / (50.0 MPH)	
VEHICLES IN 24 HR (2 WAY)	18,000	11,000	
SEGMENT LENGTH	0.8 MILE	1.1 MILE	
ALL ACCIDENTS IN 2 YRS.	10	10	
ACCIDENT RATE ☆	0.95 MVM	1.13 MVM	
EXISTING SPEED LIMIT	50 MPH (Ord 452.214 Sec. 2.6 No. 33)	NOT POSTED	

☆ RATE: NO. OF ACCIDENT x 1000 000
VEH x 365 x 2 x MILE

COUNTY AREA:	TEMECULA	SURVEY DATE:	SEP 3, 2008
COUNTY MAP:	128A, 128B	MAP DATE:	MAY 19, 2009
SUPERVISOR DISTRICT:	3	DRAWN BY:	N AHMAD
		CAD FILE:	MHS.DGN

APPROVED BY: *Lawrence T. Tai*
DATE: 5/22/2009
LAWRENCE T. TAI, P.E.
COUNTY TRAFFIC ENGINEER

LEGEND:

- ////// CITY LIMITS
- ▬ RADAR ZONE
- - - SURVEY STATION
- ===== OTHER STREET OR ROAD
- 🏠 SCHOOL

NANCY AVENUE
(#1388)

SURVEY STA 1453.1
1080' N/O BROOKSIDE AVE

CHERRY VALLEY BLVD

BROOKSIDE AVE

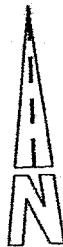

NO SCALE

BEGIN
ZONE

END
ZONE

NARROW ROAD WITH VARYING ROADSIDE CONDITIONS - DIRT SHOULDERS - NO SIDEWALK - REDUCE TO 45MPH.

RECOMMENDED SPEED LIMIT

45 MPH

85th%TILE SPEED / (50th%TILE SPEED)

50.0 MPH / (42.0 MPH)

VEHICLES IN 24 HR (2 WAY)

1780

SEGMENT LENGTH

0.5 MILE

ALL ACCIDENTS IN 2 YRS.

1

ACCIDENT RATE ☆

1.54 MVM

EXISTING SPEED LIMIT

NOT POSTED

☆ RATE. NO. OF ACCIDENT x 1000.000
VEH x 365 x 2 x MILE

COUNTY AREA:	CHERRY VALLEY	SURVEY DATE:	NOV 18, 2008
COUNTY MAP:	90	MAP DATE:	DEC 23, 2008
SUPERVISOR DISTRICT:	5	DRAWN BY:	N AHMAD
		CAD FILE:	NANCY AVE.DGN

APPROVED BY: *Lawrence T. Tai*
DATE: 12/23/2008
LAWRENCE, T. TAI, P.E.
COUNTY TRAFFIC ENGINEER

COUNTY OF RIVERSIDE
TRANSPORTATION DEPARTMENT
TRAFFIC ENGINEERING DIVISION
ENGINEERING AND TRAFFIC SURVEY
AT
NANCY AVENUE



PAGE
10F 2

LEGEND:

- ////// CITY LIMITS
- ===== RADAR ZONE
- - - - SURVEY STATION
- ===== OTHER STREET OR ROAD
- SCHOOL

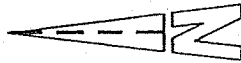

NO SCALE

SH-79 / WINCHESTER RD

GARFIELD AVE

COLUMBIA AVE

LEON RD

BRIGGS RD

LA VENTANA RD

SURVEY STA 1023.1
E/O LINDENBURGER

BEELER RD

LONGFELLOW AVE

300'

LINCOLN AVE

SURVEY STA 1023.2
500' W/O WHITTIER AVE

WHITTIER AVE

PATTERSON AVE

CALIFORNIA AVE

SURVEY STA 1023.3
W/O WARREN RD

WARREN RD

BEGIN ZONE

END ZONE

** MAXIMUM PER CVC 22349

RECOMMENDED SPEED LIMIT	** 55 MPH	50 MPH	** 55 MPH
85th%TILE SPEED / (50th%TILE SPEED)	56.0 MPH / (50.0 MPH)	54.0 MPH / (47.0 MPH)	62.0 MPH / (56.0 MPH)
VEHICLES IN 24 HR (2 WAY)	5,600	3,780	5,460
SEGMENT LENGTH	3.56 MILE	0.8 MILE	2.30 MILE
ALL ACCIDENTS IN 2 YRS.	6	4	11
ACCIDENT RATE ★	0.41 MVM	1.81 MVM	1.20 MVM
EXISTING SPEED LIMIT	** 55 MPH	45 MPH	** 55 MPH

★ RATE- NO. OF ACCIDENT x 1000 000
VEH x 365 x 2 x MILE

(Ord. 452.214 Sec. 2.5 No. 66)

APPROVED BY:

Lawrence T. Tai, P.E.
DATE: 7/2/2009
LAWRENCE T. TAI, P.E.
COUNTY TRAFFIC ENGINEER

SURVEY DATE: MAY 27, 2009
MAP DATE: JUN 10, 2009
DRAWN BY: N AHMAD
CAD FILE: SIMPSON.DGN

COUNTY AREA: WINCHESTER
COUNTY MAP: 113, 114
SUPERVISOR DISTRICT: 3

COUNTY OF RIVERSIDE
TRANSPORTATION DEPARTMENT
TRAFFIC ENGINEERING DIVISION

ENGINEERING AND TRAFFIC SURVEY
AT

SIMPSON ROAD

LEGEND:

- //// CITY LIMITS
- ▬ RADAR ZONE
- - - SURVEY STATION
- == OTHER STREET OR ROAD
- 🏠 SCHOOL

STARLIGHT LANE

(#1453)

SURVEY STA 1453.1
1200' S/O COUNTRY CLUB DR

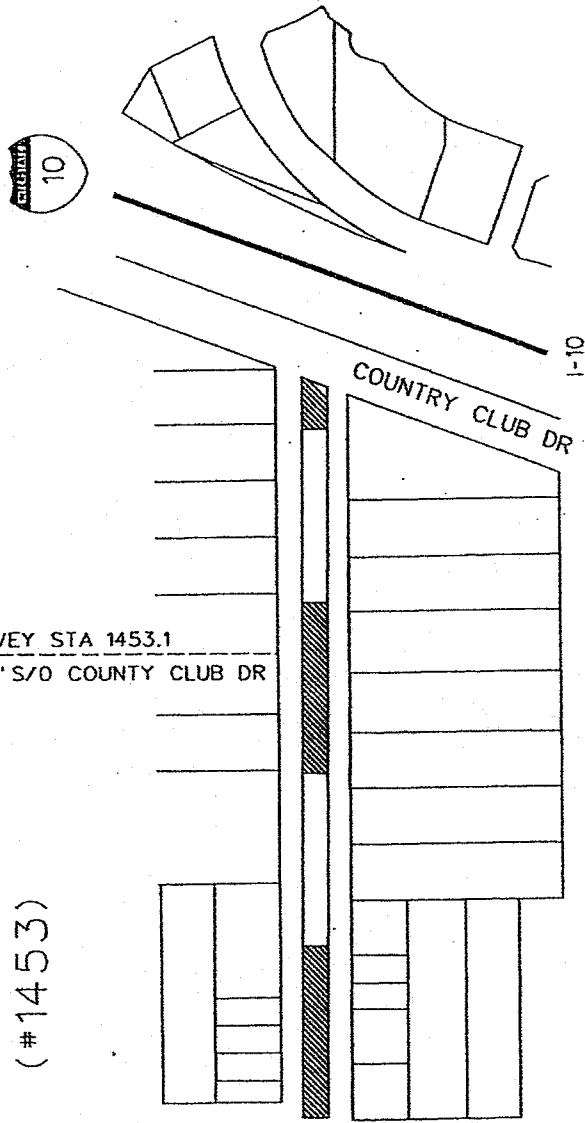

41ST AVE

BEGIN
ZONE

END
ZONE



NO SCALE

DIRT SHOULDER WITH VARYING ROADSIDE CONDITIONS
NO SIDEWALK - NO CURB & GUTTER - REDUCE TO 35 MPH.

RECOMMENDED SPEED LIMIT	35 MPH
85th/75th SPEED / (50th/75th SPEED)	41.0 MPH / (33.0 MPH)
VEHICLES IN 24 HR (2 WAY)	213
SEGMENT LENGTH	0.4 MILE
ALL ACCIDENTS IN 2 YRS.	0
ACCIDENT RATE ★	0.00 MVM
EXISTING SPEED LIMIT	NOT POSTED

★ RATE. NO. OF ACCIDENT x 1,000 000
VEH x 365 x 2 x MILE

COUNTY AREA:	BERMUDA DUNES	SURVEY DATE:	DEC 16, 2008	APPROVED BY:	<i>Lawrence T. Tai</i>
COUNTY MAP:	207A	MAP DATE:	DEC 23, 2008	DATE:	12/23/2008
SUPERVISOR DISTRICT:	4	DRAWN BY:	N AHMAD	LAWRENCE T. TAI, P.E.	COUNTY TRAFFIC ENGINEER
		CAD FILE:	STARLIGHT LN.DGN		

COUNTY OF RIVERSIDE
TRANSPORTATION DEPARTMENT
TRAFFIC ENGINEERING DIVISION

ENGINEERING AND TRAFFIC SURVEY
AT
STARLIGHT LANE



LEGEND:

- ////// COUNTY / CITY LIMITS
- ▬ RADAR ZONE
- - - SURVEY STATION
- == OTHER STREET OR ROAD
- ⬆ SCHOOL

SUMNER AVENUE (#1202)

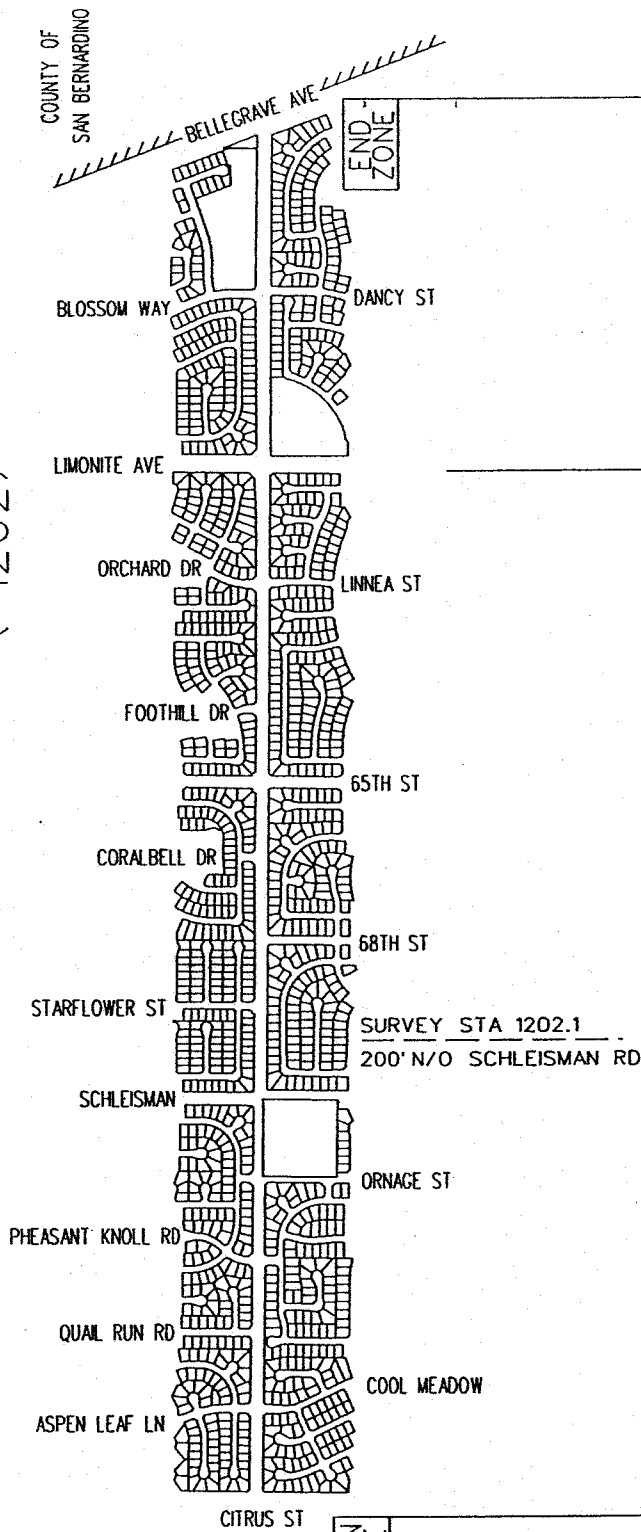

NO SCALE

RECOMMENDED SPEED LIMIT	45 MPH
85th%TILE SPEED / (50th%TILE SPEED)	48.0 MPH / (42.0 MPH)
VEHICLES IN 24 HR (2 WAY)	6,900
SEGMENT LENGTH	2.14 MILE
ALL ACCIDENTS IN 2 YRS.	13
ACCIDENT RATE ★	1.20 MVM
EXISTING SPEED LIMIT	45 MPH (Ord 452.215 Sec. 2.5 No. 84)
	NOT POSTED

★ RATE: NO. OF ACCIDENT x 1000.000
VEH x 365 x 2 x MILE

COUNTY AREA:	EASTVALE	SURVEY DATE:	MAR 25, 2008
COUNTY MAP:	14	MAP DATE:	APR 17, 2009
SUPERVISOR DISTRICT:	2	DRAWN BY:	N AHMAD
		CAD FILE:	SUMNER AVE.DGN

APPROVED BY:

Lawrence T. Talpe
DATE: 4/17/2009
LAWRENCE T. TALPE,
COUNTY TRAFFIC ENGINEER

COUNTY OF RIVERSIDE
TRANSPORTATION DEPARTMENT
TRAFFIC ENGINEERING DIVISION

ENGINEERING AND TRAFFIC SURVEY
AT

SUMNER AVENUE



TEMESCAL CANYON ROAD (ONTARIO AVENUE)

(#1068)

LEGEND:

- //// CITY LIMITS
- == RADAR ZONE
- - - SURVEY STATION
- == OTHER STREET OR ROAD

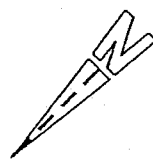
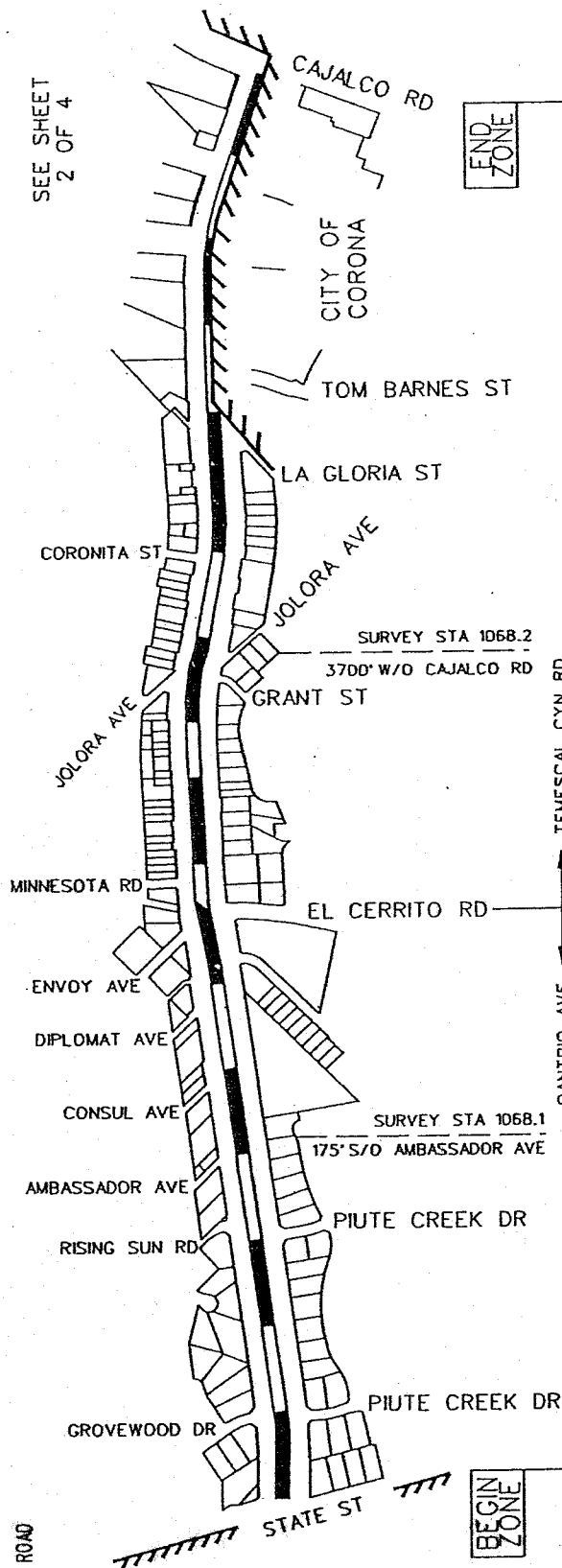

NO SCALE

RECOMMENDED SPEED LIMIT	45 MPH	CITY OF CORONA	45 MPH
85TH/ILE SPEED/ (50TH/ILE SPEED)	51.0 MPH / (44.0 MPH)	49.0 MPH / (43.0 MPH)	
VEHICLES IN 24 HR (2 WAY)	13,890	11,370	
SEGMENT LENGTH	0.7 MILE	1.1 MILE	
ALL ACCIDENTS IN 2 YRS.	0	20	
ACCIDENT RATE ☆	0.00 MVM	2.19 MVM	
EXISTING SPEED LIMIT	40 MPH (Ord 452.214 Sec 2.4 No. 20)		

☆ RATE: ACCIDENT x 1000 000
VEH x 365 x 2 x MILE

COUNTY AREA:	EL CERRITO	SURVEY DATE:	AUG 28, 2008	APPROVED BY:	<i>Lawrence T. Jalpe</i>
COUNTY MAP:	30A, 30B, 31	MAP DATE:	APR 30, 2009	DATE:	5/11/2009
SUPERVISOR DISTRICT:	2	DRAWN BY:	N AHMAD	LAWRENCE T. JALPE, COUNTY TRAFFIC ENGINEER	

COUNTY OF RIVERSIDE
TRANSPORTATION DEPARTMENT
TRAFFIC ENGINEERING SECTION

ENGINEERING AND TRAFFIC SURVEY
AT
TEMESCAL CANYON RD

LEGEND:

- ////// CITY LIMITS
- ▬ RADAR ZONE
- - - SURVEY STATION
- == OTHER STREET OR ROAD

TEMESCAL CANYON ROAD (#1068)

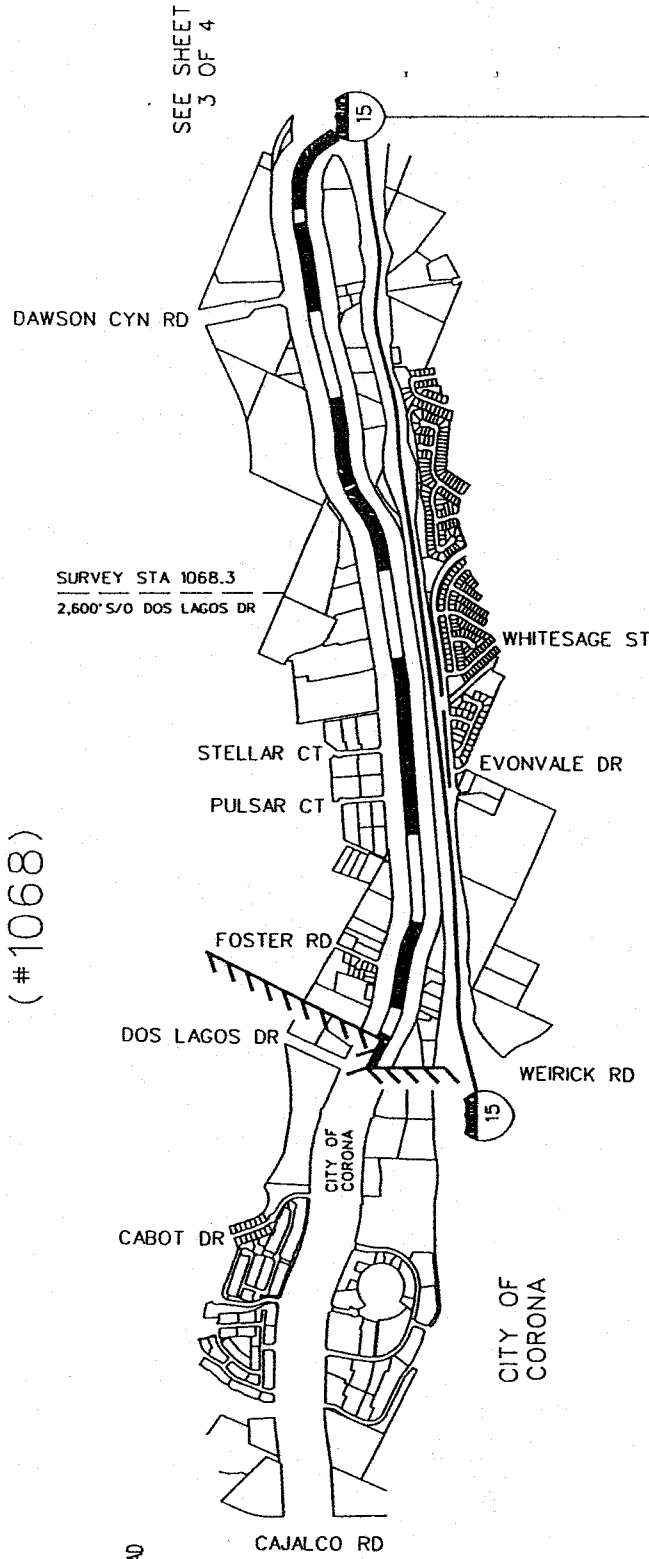

SEE SHEET
3 OF 4

SEE SHEET
2 OF 4



NO SCALE

BEGIN
ZONE

RECOMMENDED SPEED LIMIT	CITY OF CORONA	45 MPH
85TH/ILE SPEED/ (50TH/ILE SPEED)		49.0 MPH / (43.0 MPH)
VEHICLES IN 24 HR (2 WAY)		6,870
SEGMENT LENGTH		2.4 MILE
ALL ACCIDENTS IN 2 YRS.		18
ACCIDENT RATE ☆		1.48 MVM
EXISTING SPEED LIMIT	45 MPH	50 MPH (Ord 452.214 Sec. 2.6 No. 16)

☆ RATE: $\frac{\text{ACCIDENT} \times 1000 \text{ 000}}{\text{VEH} \times 365 \times 2 \times \text{MILE}}$

APPROVED BY:

Lawrence T. Tai
DATE: 5/11/2009

LAWRENCE T. TAI, P.E.
COUNTY TRAFFIC ENGINEER

SURVEY DATE: AUG 28, 2008
MAP DATE: APR 30, 2009
DRAWN BY: N AHMAD
CAD FILE: TEMESCAL CYN RD.DGN

COUNTY AREA: TEMESCAL VALLEY
COUNTY MAP: 33A, 33C
SUPERVISOR DISTRICT: 1, 2

COUNTY OF RIVERSIDE
TRANSPORTATION DEPARTMENT
TRAFFIC ENGINEERING SECTION
ENGINEERING AND TRAFFIC SURVEY
AT
TEMESCAL CANYON RD
PAGE 2 OF 4

LEGEND:

- ////// CITY LIMITS
- ===== RADAR ZONE
- SURVEY STATION
- ===== OTHER STREET OR ROAD

TEMESCAL CANYON ROAD (#1068)

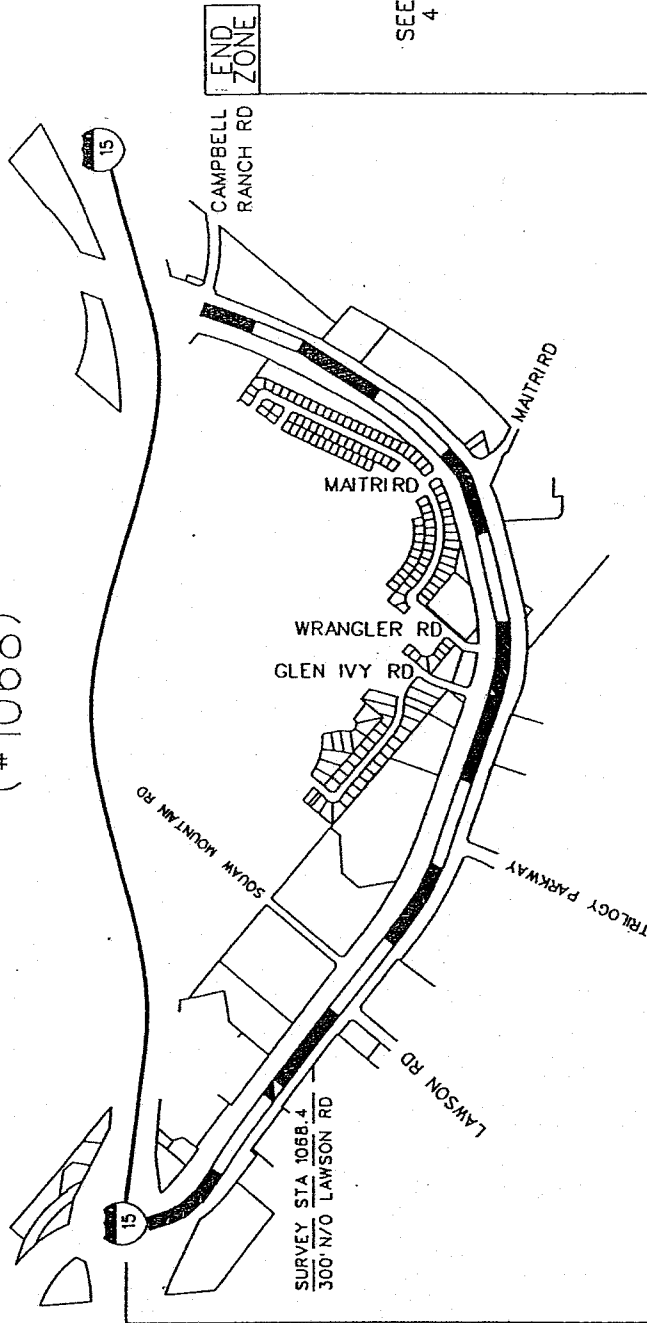

RECOMMENDED SPEED LIMIT	45 MPH
85TH/ILE SPEED / (50TH/ILE SPEED)	47.0 MPH / (41.0 MPH)
VEHICLES IN 24 HR (2 WAY)	13,440
SEGMENT LENGTH	1.8 MILE
ALL ACCIDENTS IN 2 YRS.	19
ACCIDENT RATE ☆	1.07 MVM
EXISTING SPEED LIMIT	40 MPH (Ord 452.214 Sec. 2.4 No. 23)

☆ RATE: $\frac{\text{ACCIDENT} \times 1000}{\text{VEH} \times 365 \times 2 \times \text{MILE}}$

<p>COUNTY AREA: TRILOGY</p>		<p>SURVEY DATE: AUG 28, 2008</p>		<p>COUNTY OF RIVERSIDE TRANSPORTATION DEPARTMENT TRAFFIC ENGINEERING SECTION</p>	
<p>COUNTY MAP: 35, 35A</p>		<p>MAP DATE: APR 30, 2009</p>		<p>ENGINEERING AND TRAFFIC SURVEY AT TEMESCAL CANYON RD</p>	
<p>SUPERVISOR DISTRICT: 1</p>		<p>DRAWN BY: N AHMAD</p>		<p>PAGE 3 OF 4</p>	
<p>CAD FILE: TEMESCAL CYN RD.DGN</p>		<p>DATE: 5/11/2009</p>		<p>APPROVED BY: <i>Lawrence T. Talpe</i></p>	
<p>1</p>		<p>LAWRENCE T. TALPE, COUNTY TRAFFIC ENGINEER</p>		<p>Page 4 of 4 not included - no changes</p>	

LEGEND:

- COUNTY / CITY LIMITS
- RADAR ZONE
- RADAR SURVEY STATION
- OTHER STREET OR ROAD

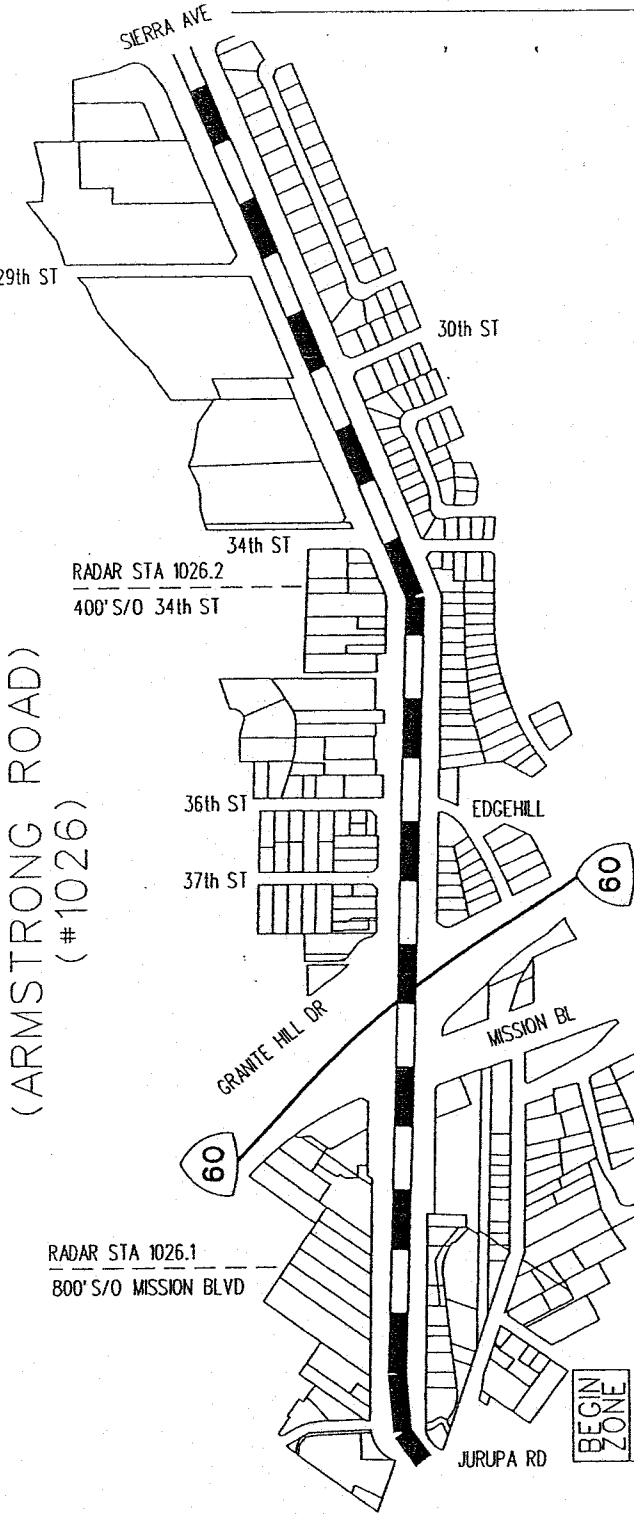

NO SCALE

	HIGH ACCIDENT RATE - REDUCE TO 40 MPH	HIGH ACCIDENT RATE - REDUCE TO 45 MPH
RECOMMENDED SPEED LIMIT	40 MPH	45 MPH
85%TILE SPEED / (50th%TILE SPEED)	45.0 MPH / (40.0)	52.0 MPH / (45.0)
VEHICLES IN 24 HR (2 WAY)	7,340	23,220
SEGMENT LENGTH	0.5 MI	1.0 MI
ALL ACCIDENTS IN 2 YRS.	20	46
ACCIDENT RATE ★	7.46 MVM	2.71 MVM
EXISTING SPEED LIMIT	40 MPH (Ord 452.214 Sec. 2.4 No. 19)	40 MPH (Ord 452.214 Sec. 2.4 No. 40)

★ RATE - $\frac{\text{ACCIDENT} \times 1,000,000}{\text{VEH} \times 365 \times 2\text{YR} \times \text{MILE}}$

APPROVED BY:

Lawrence T. Tai
DATE: 4/9/2009

SURVEY DATE:	MAR 18, 2009
MAP DATE:	APR 7, 2009
DRAWN BY:	N AHMAD
CAD FILE:	VALLEYWAY.DGN
SUNNYSLOPE	5, 11
SUPERVISOR DISTRICT:	2

COUNTY OF RIVERSIDE
TRANSPORTATION DEPARTMENT
TRAFFIC ENGINEERING DIVISION

ENGINEERING AND TRAFFIC SURVEY
AT

VALLEY WAY

LEGEND:

- //// CITY LIMITS
- ▬ RADAR ZONE
- - - SURVEY STATION
- ▬ OTHER STREET OR ROAD
- ↑ SCHOOL

FILLMORE ST

VICTORIA AVENUE (#1456)

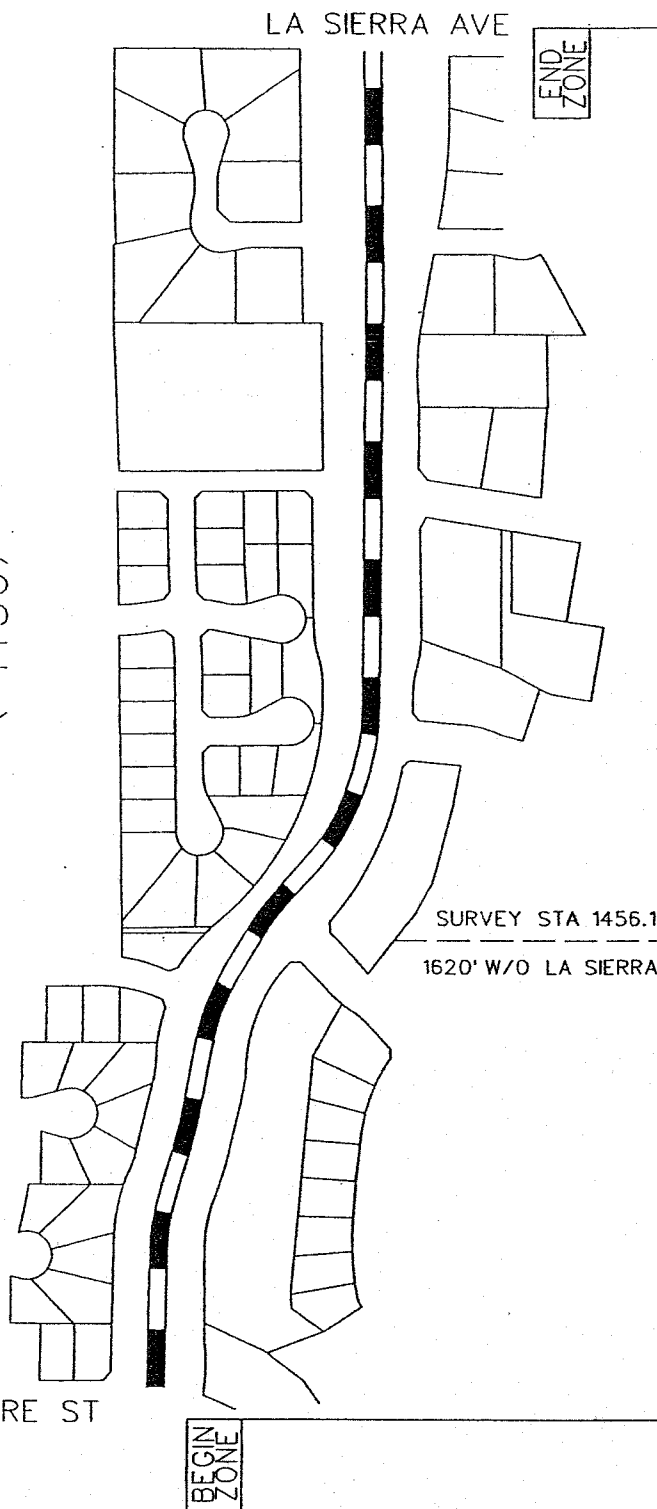

NO SCALE

RECOMMENDED SPEED LIMIT	35 MPH
85th/TILE SPEED / (50th/TILE SPEED)	40.0 MPH / (35.0 MPH)
VEHICLES IN 24 HR (2 WAY)	2,710
SEGMENT LENGTH	0.54 MILE
ALL ACCIDENTS IN 2 YRS.	1
ACCIDENT RATE ☆	0.94 MVM
EXISTING SPEED LIMIT	NOT POSTED

☆ RATE: NO. OF ACCIDENT x 1000.000
VEH x 365 x 2 x MILE

COUNTY AREA:	RIVERSIDE	SURVEY DATE:	MAR 26, 2009
COUNTY MAP:	26A	MAP DATE:	APR 7, 2009
SUPERVISOR DISTRICT:	1	DRAWN BY:	N AHMAD
		CAD FILE:	VICTORIA.DGN

APPROVED BY: *Lawrence T. Tai*
DATE: 4/9/2009
LAWRENCE T. TAI, P.E.
COUNTY TRAFFIC ENGINEER

COUNTY OF RIVERSIDE
TRANSPORTATION DEPARTMENT
TRAFFIC ENGINEERING DIVISION

ENGINEERING AND TRAFFIC SURVEY
AT
VICTORIA AVENUE



LEGEND:

- ////// CITY LIMITS
- ▬ RADAR ZONE
- - - SURVEY STATION
- ▬▬▬ OTHER STREET OR ROAD
- ↑ SCHOOL

WOOD ROAD

(#1043)

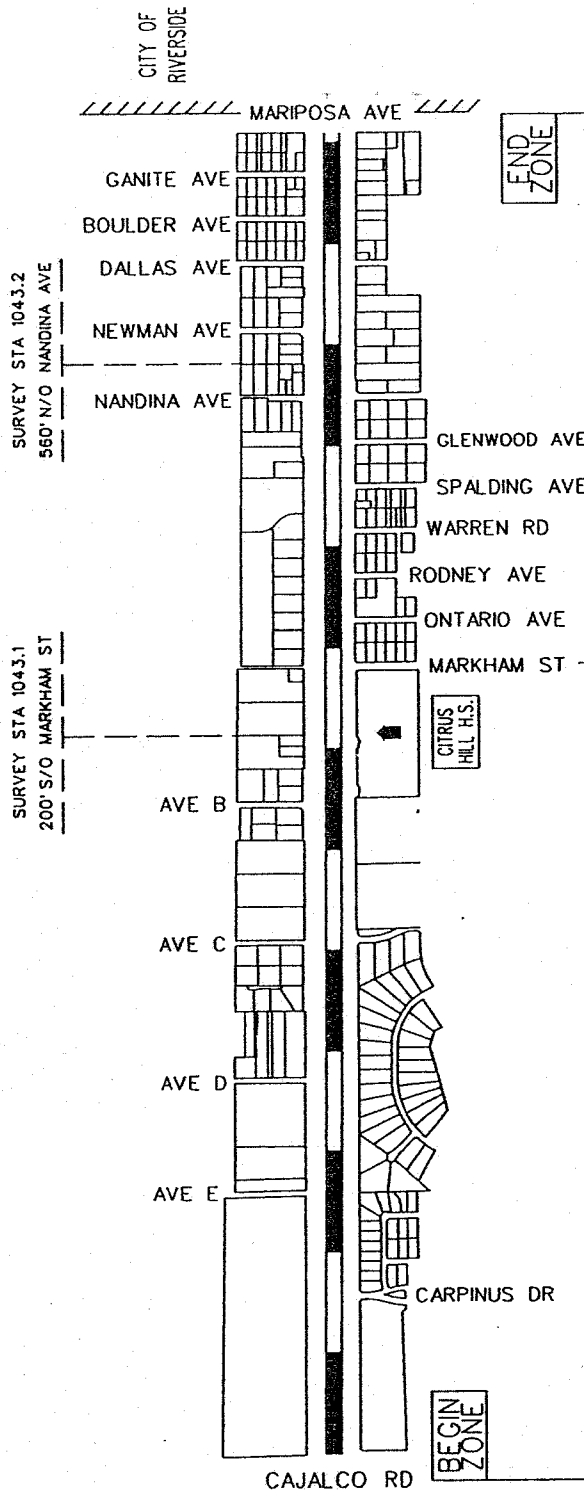

NO SCALE

** MAXIMUM PER CVC 22349

RECOMMENDED SPEED LIMIT	50 MPH	50 MPH	CITY OF RIVERSIDE
85th%TILE SPEED / (50th%TILE SPEED)	51.0 MPH / (42.0 MPH)	54.0 MPH / (47.0 MPH)	
VEHICLES IN 24 HR (2 WAY)	5,130	6,930	
SEGMENT LENGTH	1.5 MILE	1.0 MILE	
ALL ACCIDENTS IN 2 YRS.	5	3	
ACCIDENT RATE ★	0.89 MVM	0.59 MVM	
EXISTING SPEED LIMIT	** 55 MPH	** 55 MPH	45 MPH

★ RATE: NO. OF ACCIDENT x 1000.000
VEH x 365 x 2 x MILE

COUNTY AREA:	WOODCREST	SURVEY DATE:	AUG 6, 2006	APPROVED BY:	<i>Lawrence T. Tai</i>
COUNTY MAP:	53, 54, 57	MAP DATE:	AUG 8, 2008	DATE:	8/2/2008
SUPERVISOR DISTRICT:	1	DRAWN BY:	N AHMAD		LAWRENCE T. TAI, P.E. COUNTY TRAFFIC ENGINEER
		CAD FILE:	WOOD.DGN		

COUNTY OF RIVERSIDE
TRANSPORTATION DEPARTMENT
TRAFFIC ENGINEERING DIVISION

ENGINEERING AND TRAFFIC SURVEY
AT

WOOD ROAD



**LIST OF PROPOSED SPEED ZONE SUBMITTALS
ORDINANCE AMENDMENT NO. 452.227
SUPERVISORIAL DISTRICT NO. 5**

Area	Road Name/Limits	Existing Speed Limit	Recommended Speed Limit	Notes
Perris	El Nido Avenue FULL-WIDTH between Orange Ave and Walnut Ave; WESTERLY half between Walnut Ave and Rider St	Not posted*	45 mph	New
Highgrove	Mount Vernon Avenue Between Palmyrita Ave and Main St	Not posted*	45 mph	New
Cherry Valley	Nancy Avenue Between Brookside Ave and Cherry Valley Blvd	Not posted*	45 mph	New

- * Maximum allowable speed limit for a two-lane highway is 55 mph
- **Maximum allowable speed limit for a multi-lane highway is 65 mph
- ***Change in speed zone boundary

SUBMITTAL TO THE BOARD OF SUPERVISORS
COUNTY OF RIVERSIDE, STATE OF CALIFORNIA

725B



FROM: TLMA – Transportation Department

SUBMITTAL DATE:
January 21, 2010

SUBJECT: Ordinance No. 452.227 to establish speed zones enforceable by radar speed detection equipment – Riverside, Bermuda Dunes, Corona, Temescal Valley, Perris, Winchester, Pedley, Home Gardens, Hemet, Highgrove, Cherry Valley, El Cerrito, Sunnyslope, Temecula, and Woodcrest areas.

RECOMMENDED MOTION: That the Board introduce Ordinance No. 452.227, amending Ordinance No. 452 relating to prima facie speed limits to establish various speed zones in the above-referenced areas of Riverside County.

BACKGROUND: Transportation Department staff has conducted Engineering and Traffic Surveys (E&TS) for various roads in the subject areas, as required by the California Vehicle Code.

Based upon the results of the E&TS for these roads, the radar-enforceable speed limits recommended by the Department are summarized in the attached tables.

It is recommended that the Board adopt this amendment at the next regularly scheduled meeting.

County Counsel has approved the ordinance amendment.

Transportation Department staff has contacted the Riverside, San Geronio Pass, Temecula, and Indio Area offices of the California Highway Patrol regarding the proposed speed zones.

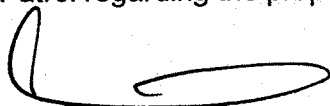

Juan C. Perez
Director of Transportation

LTT:BJL:sa

MINUTES OF THE BOARD OF SUPERVISORS

On motion of Supervisor Stone, seconded by Supervisor Benoit and duly carried by unanimous vote, IT WAS ORDERED that the above ordinance is approved as introduced with waiver of the reading.

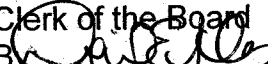
Ayes: Buster, Tavaglione, Stone, Benoit and Ashley
Nays: None
Absent: None
Date: January 26, 2010
xc: Transp., COB

Kecia Harper-Ihem
Clerk of the Board
By 
Deputy

Prev. Agn. Ref. 7/21/09 Item 3.111

District: All

Agenda Number:

3.111



OFFICE OF
CLERK OF THE BOARD OF SUPERVISORS
1st FLOOR, COUNTY ADMINISTRATIVE CENTER
P.O. BOX 1147, 4080 LEMON STREET
RIVERSIDE, CA 92502-1147
PHONE: (951) 955-1060
FAX: (951) 955-1071

KECIA HARPER-IHEM
Clerk of the Board of Supervisors

KIMBERLY A. RECTOR
Assistant Clerk of the Board

February 17, 2010

THE PRESS ENTERPRISE
ATTN: LEGALS
P.O. BOX 792
RIVERSIDE, CA 92501

FAX: (951) 368-9018
E-MAIL: legals@pe.com

RE: ADOPTION OF ORDINANCE NO. 452.227

To Whom It May Concern:

Attached is a copy for publication in your newspaper for **ONE (1) TIME** on **Friday, February 19, 2010.**

We require your affidavit of publication immediately upon completion of the last publication.

Your invoice must be submitted to this office in duplicate, WITH TWO CLIPPINGS OF THE PUBLICATION.

NOTE: PLEASE COMPOSE THIS PUBLICATION INTO A SINGLE COLUMN FORMAT.

Thank you in advance for your assistance and expertise.

Sincerely,

Mcgil

Cecilia Gil, Board Assistant to
KECIA HARPER-IHEM, CLERK OF THE BOARD

Gil, Cecilia

From: [REDACTED]
Sent: Tuesday, February 16, 2010 4:53 PM
To: Gil, Cecilia
Subject: [REDACTED] ADOPTION OF ORD. NO. 452.227

Thank You! ~Maria G. Tinajero - The Press Enterprise Legal Adv. - 1.800.880.0345 (Phone) - 951.368.9018 (fax) - Please Note: Deadline is 10:30 AM two (2) business days prior to the date you would like to publish.

From: Gil, Cecilia [mailto:CCGIL@rcbos.org]
Sent: Tuesday, February 16, 2010 4:51 PM
To: PE Legals
Subject: FOR PUBLICATION: ADOPTION OF ORD. NO. 452.227

Hello again.

Attached is an Adoption of Ordinance, for publication on Friday, Feb. 19, 2010. Please confirm. THANK YOU!

Cecilia Gil

Board Assistant to the
Clerk of the Board of Supervisors
951-955-8464

**THE COUNTY ADMINISTRATIVE CENTER IS CLOSED EVERY FRIDAY UNTIL FURTHER NOTICE.
PLEASE CONSIDER THE ENVIRONMENT BEFORE PRINTING.**



OFFICE OF
CLERK OF THE BOARD OF SUPERVISORS
1st FLOOR, COUNTY ADMINISTRATIVE CENTER
P.O. BOX 1147, 4080 LEMON STREET
RIVERSIDE, CA 92502-1147
PHONE: (951) 955-1060
FAX: (951) 955-1071

KECIA HARPER-IHEM
Clerk of the Board of Supervisors

KIMBERLY A. RECTOR
Assistant Clerk of the Board

February 17, 2010

THE DESERT SUN
ATTN: LEGALS
P.O. BOX 2734
PALM SPRINGS, CA 92263

FAX: (760) 778-4731
E-MAIL: legals@thedesertsun.com

RE: ADOPTION OF ORDINANCE NO. 452.227

To Whom It May Concern:

Attached is a copy for publication in your newspaper for **ONE (1) TIME** on **Friday, February 19, 2010.**

We require your affidavit of publication immediately upon completion of the last publication.

Your invoice must be submitted to this office in duplicate, **WITH TWO CLIPPINGS OF THE PUBLICATION.**

NOTE: PLEASE COMPOSE THIS PUBLICATION INTO A SINGLE COLUMN FORMAT.

Thank you in advance for your assistance and expertise.

Sincerely,

Mcgil

Cecilia Gil, Board Assistant to
KECIA HARPER-IHEM, CLERK OF THE BOARD

Gil, Cecilia

From: [REDACTED]
Sent: Tuesday, February 16, 2010 4:58 PM
To: Gil, Cecilia
Subject: [REDACTED]

[REDACTED]

Charlene Moeller
Public Notice Customer Service Rep.
The Desert Sun Newspaper
750 N. Gene Autry Trail, Palm Springs, CA 92262
(760) 778-4578, Fax (760) 778-4731
Desert Sun legals@thedesertsun.com
& Desert Post Weekly dpwlegals@thedesertsun.com
The Coachella Valley's #1 Source in News & Advertising!
Visit us at mydesert.com

From: Gil, Cecilia [<mailto:CCGIL@rcbos.org>]
Sent: Tuesday, February 16, 2010 4:52 PM
To: tds-legals
Subject: FOR PUBLICATION: ADOPTION OF ORD. NO. 452.227

Hello again.

Attached is an Adoption of Ord. No. 452.227, for publication on Friday, Feb. 19, 2010. Please confirm. THANK YOU!

Cecilia Gil

Board Assistant to the
Clerk of the Board of Supervisors
951-955-8464

**THE COUNTY ADMINISTRATIVE CENTER IS CLOSED EVERY FRIDAY UNTIL FURTHER NOTICE.
PLEASE CONSIDER THE ENVIRONMENT BEFORE PRINTING.**

BOARD OF SUPERVISORS OF THE COUNTY OF RIVERSIDE, STATE OF CALIFORNIA

ORDINANCE NO. 452.227

AN ORDINANCE OF THE COUNTY OF RIVERSIDE
AMENDING ORDINANCE NO. 452
RELATING TO PRIMA FACIE SPEED LIMITS

The Board of Supervisors of the County of Riverside ordains as follows:

Section 1. Section 2.2 of Ordinance No. 452, entitled "Thirty miles per hour," is amended to add a new subsection 20 thereto to read as follows:

- "20. On Golden Star Avenue between the City of Riverside city limits and the centerline of Washington Street, a total distance of approximately 1.0 mile, in the Riverside area."

Section 2. Section 2.3 of Ordinance No. 452, entitled "Thirty-five miles per hour," is amended to add new subsections 97 and 98 thereto to read as follows:

- "97. On Starlight Lane between the centerline of 41st Avenue and the centerline of Country Club Drive, a total distance of approximately 0.4 mile, in the Bermuda Dunes area.
98. On Victoria Avenue between the centerline of Fillmore Street and the centerline of La Sierra Avenue, a total distance of approximately 0.54 mile, in the Riverside area."

Section 3. Section 2.4 of Ordinance No. 452, entitled "Forty miles per hour," is amended to add a new subsection 105 and 106 thereto to read as follows:

- "105. On Mayhew Canyon Road between the centerline of Campbell Ranch Road (W) and the centerline of Campbell Ranch Road (E), a total distance of approximately 1.2 miles, in the Corona area.
106. On Temescal Canyon Road between I-15 and the centerline of Campbell Ranch Road (W), a total distance of approximately 1.8 miles, in the Temescal Valley area."

Section 4. Section 2.5 of Ordinance No. 452, entitled "Forty-five miles per hour," is amended to add new subsections 129, 130, 131, 132, 133, 134, 135, 136, 137, 138, 139, and 140 thereto to read as follows:

- "129. On the full-width of El Nido Avenue between the centerline of Orange Avenue and the centerline of Walnut Avenue, and on the westerly half of El Nido Avenue between the centerline of Walnut Avenue and the centerline of Rider Street, a total distance of approximately 0.9 mile, in the Perris area.
130. On Leon Road between the centerline of Olive Avenue and the centerline of Simpson Road, a total distance of approximately 0.5 mile, in the Winchester area.
131. On Limonite Avenue between the centerline of Hamner Avenue and the centerline of Wineville Avenue, a total distance of approximately 1.0 mile, in the Pedley area.
132. On Magnolia Avenue between a point 400 feet west of the centerline of Temescal Street and a point 2,000 feet east of the centerline of Lincoln Street, a total distance of approximately 2.0 miles, in the Home Gardens area.
133. On Marshall Avenue between the centerline of State Highway 74 and the southerly terminus of Marshall Avenue, a total distance of 0.46 mile, in the Hemet area.
134. On Mount Vernon Avenue between the centerline of Palmyrita Avenue and the centerline of Main Street, a total distance of approximately 1.0 mile, in the Highgrove area.

135. On Nancy Avenue between the centerline of Brookside Avenue and the centerline of Cherry Valley Boulevard, a total distance of approximately 0.5 mile, in the Cherry Valley area.
136. On Sumner Avenue between the centerline of Citrus Street and the centerline of Bellegrave Avenue, a total distance of approximately 2.14 miles, in the Eastvale area.
137. On Ontario Avenue between the centerline of State Street and the centerline of El Cerrito Road, a total distance of approximately 0.7 mile, in the El Cerrito area.
138. On Temescal Canyon Road between the centerline of El Cerrito Road and the centerline of Cajalco Road, a total distance of approximately 1.1 miles, in the El Cerrito area.
139. On Temescal Canyon Road between the centerline of Weirick Road and I-15, a total distance of approximately 2.4 miles, in the Temescal Valley area.
140. On Valley Way between State Route 60 and the centerline of Sierra Avenue, a total distance of approximately 1.0 mile, in the Sunnyslope area."

Section 5. Section 2.6 of Ordinance No. 452, entitled "Fifty miles per hour," is amended to add new subsections 62, 63, and 64, thereto to read as follows:

- "62. On Murrieta Hot Springs Road between the centerline of Calistoga Drive and the centerline of Red Post Circle, a total distance of approximately 1.1 miles, in the Temecula area.
63. On Simpson Road between a point 300 feet west of Columbia Avenue and the centerline of Whittier Avenue, a total distance of approximately 0.8 mile, in the Winchester area.
64. On Wood Road between the centerline of Cajalco Road and the centerline of Mariposa Avenue, a total distance of approximately 2.5 miles, in the Woodcrest area."

Section 6. Section 2.7 of Ordinance No. 452, entitled "Fifty-five miles per hour," is amended to add a new subsection 21 thereto to read as follows:

- "21. On Limonite Avenue between the centerline of Wineville Avenue and the centerline of Etiwanda Avenue, a total distance of approximately 1.0 mile, in the Pedley area."

Section 7. Subsection 20 of Section 2.4 of Ordinance No. 452 adopted on February 4, 2003, pursuant to Ordinance No. 452.214 is repealed in its entirety. Subsection 20 of Section 2.4 established a forty miles per hour speed limit on Ontario Avenue between the centerline of State Street and the centerline of El Cerrito Road, and on Temescal Canyon Road between the centerline of El Cerrito Road and the centerline of Cajalco Road.

Subsection 23 of Section 2.4 of Ordinance No. 452 adopted on February 4, 2003, pursuant to Ordinance No. 452.214 is repealed in its entirety. Subsection 23 of Section 2.4 established a forty miles per hour speed limit on Temescal Canyon Road between I-15 and 1,600 feet east of Maitri Road.

Subsection 40 of Section 2.4 of Ordinance No. 452 adopted on February 4, 2003, pursuant to Ordinance No. 452.214 is repealed in its entirety. Subsection 40 of Section 2.4 established a forty miles per hour speed limit on Valley Way (Armstrong Road) from State Route 60 to the centerline of Sierra Avenue.

Subsection 60 of Section 2.4 of Ordinance No. 452 adopted on February 4, 2003, pursuant to Ordinance No. 452.214 is repealed in its entirety. Subsection 60 of Section 2.4 established a forty miles per hour speed limit on Leon Road between Simpson Road and Olive Avenue.

Subsection 26 of Section 2.5 of Ordinance No. 452 adopted on February 4, 2003, pursuant to Ordinance No. 452.214 is repealed in its entirety. Subsection 26 of Section 2.5 established a forty-five miles per hour speed limit on Newport Road between the centerline of Interstate 215 freeway and the centerline of Menifee Road.

Subsection 33 of Section 2.5 of Ordinance No. 452 adopted on February 4, 2003, pursuant to Ordinance No. 452.214 is repealed in its entirety. Subsection 33 of Section 2.5 established a forty-five miles per hour speed limit on East Sixth Street between the city limit boundary of the City of Corona and the centerline of Temescal Street.

Subsection 34 of Section 2.5 of Ordinance No. 452 adopted on February 4, 2003, pursuant to Ordinance No. 452.214 is repealed in its entirety. Subsection 34 of Section 2.5 established a forty-five miles per hour speed limit on Magnolia Avenue between the centerline of Temescal Street and the city limit boundary of the City of Riverside.

Subsection 66 of Section 2.5 of Ordinance No. 452 adopted on February 4, 2003, pursuant to Ordinance No. 452.214 is repealed in its entirety. Subsection 66 of Section 2.5 established a forty-five miles per hour speed limit on Simpson Road from 300 feet west of Columbia Avenue to the centerline of Patterson Avenue.

Subsection 84 of Section 2.5 of Ordinance No. 452 adopted on May 20, 2003, pursuant to Ordinance No. 452.215 is repealed in its entirety. Subsection 84 of Section 2.5 established a forty-five miles per hour speed limit on Sumner Avenue between Citrus Street and Cloverdale Road.

Subsection 4 of Section 2.6 of Ordinance No. 452 adopted on February 4, 2003, pursuant to Ordinance No. 452.214 is repealed in its entirety. Subsection 4 of Section 2.6 established a fifty miles per hour speed limit on Newport Road between Menifee Road and Briggs Road.

Subsection 16 of Section 2.6 of Ordinance No. 452 adopted on February 4, 2003, pursuant to Ordinance No. 452.214 is repealed in its entirety. Subsection 16 of Section 2.6 established a fifty miles per hour speed limit on Temescal Canyon Road between the centerline of Cajalco Road and I-15.

Subsection 53 of Section 2.6 of Ordinance No. 452 adopted on September 16, 2008, pursuant to Ordinance No. 452.224 is repealed in its entirety. Subsection 53 of Section 2.6 established a fifty miles per hour speed limit on Newport Road between Murrieta Road and I-215.

Subsection 1 of Section 2.8 of Ordinance No. 452 adopted on February 4, 2003, pursuant to Ordinance No. 452.214 is repealed in its entirety. Subsection 1 of Section 2.8 established a sixty miles per hour speed limit on Domenigoni Parkway between the city limit boundary of the City of Hemet and the easterly right-of-way boundary of Winchester Road (State Route 79).

Section 8. This ordinance shall take effect 30 days after its adoption.

Marion Ashley, Chairman of the Board

I HEREBY CERTIFY that at a regular meeting of the Board of Supervisors of said County, held on **February 9, 2010**, the foregoing Ordinance consisting of eight (8) sections was adopted by said Board by the following vote:

AYES: Buster, Tavaglione, Stone, Benoit and Ashley
NAYS: None
ABSENT: None

Kecia Harper-Ihem, Clerk of the Board
By: Cecilia Gil, Board Assistant

⑨ REMITTANCE ADDRESS POST OFFICE BOX 12009 RIVERSIDE, CA 92502-2209 FAX (951) 368-9026		① BILLING PERIOD 02/19/10 - 02/19/10		② ADVERTISING/CLIENT NAME BOARD OF SUPERVISORS	
⑤ BILLING DATE 02/19/10		④ FOR BILLING INFORMATION CALL (951) 368-9713		③ PAGE NO 1	
⑥ TOTAL AMOUNT DUE 647.40		⑦ UNAPPLIED AMOUNT		⑧ TERMS OF PAYMENT Due Upon Receipt	

⑩ BILLED ACCOUNT NAME AND ADDRESS BOARD OF SUPERVISORS COUNTY OF RIVERSIDE P.O. BOX 1147 RIVERSIDE CA 92502		⑪ BILLED ACCOUNT NUMBER 045202		⑫ REP. NO. LE04	
---	--	-----------------------------------	--	--------------------	--

Statement #: 56524871 Amount Paid \$ _____ Your Check # _____

PLEASE DETACH AND RETURN UPPER PORTION WITH YOUR REMITTANCE

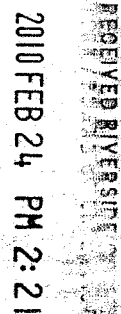
⑬ DATE	⑭ REFERENCE	⑮ ⑯ DESCRIPTION-OTHER COMMENTS/CHARGES	⑰ SAU SIZE ⑱ BILLED UNITS	⑲ RATE	⑳ GROSS AMOUNT	㉑ NET AMOUNT
02/19	4157510 C0	ORDINANCE NO. 452.227 Class : 10 Ctext Ad# 10166728 Placed By : Cecilia Gil	498 L	1.30	647.40	647.40
COMING SOON! Electronic Tearsheet Delivery Service It's easy! Search, view, save, email notification & more						<div>  <p>Transp. 3.61 of 02/09/10 1hr</p> </div>

㉒ CURRENT NET AMOUNT DUE	㉓ 30 DAYS	㉔ 60 DAYS	㉕ OVER 90 DAYS	㉖ UNAPPLIED AMOUNT	㉗ PLEASE PAY THIS AMOUNT
					647.40

THE PRESS-ENTERPRISE  P.O. BOX 12009
RIVERSIDE, CA 92502-2209
TELEPHONE (951) 368-9711
(951) 368-9720 □ (951) 368-9713

ADVERTISING
STATEMENT/INVOICE

* UNAPPLIED AMOUNTS ARE INCLUDED IN TOTAL AMOUNT DUE



㉘ STATEMENT NUMBER	㉙ BILLING PERIOD	㉚ BILLED ACCOUNT NUMBER	㉛ ADVERTISER/CLIENT NUMBER	㉜ ADVERTISER/CLIENT NAME
56524871	02/19/10 - 02/19/10	045202		BOARD OF SUPERVISORS

THE PRESS-ENTERPRISE

3450 Fourteenth Street
Riverside CA 92501-3878
951-684-1200
951-368-9018 FAX

PROOF OF PUBLICATION (2010, 2015.5 C.C.P.)

Press-Enterprise

PROOF OF PUBLICATION OF

Ad Desc.: Ordinance No. 452.227

I am a citizen of the United States. I am over the age of eighteen years and not a party to or interested in the above entitled matter. I am an authorized representative of THE PRESS-ENTERPRISE, a newspaper of general circulation, printed and published daily in the County of Riverside, and which newspaper has been adjudicated a newspaper of general circulation by the Superior Court of the County of Riverside, State of California, under date of April 25, 1952, Case Number 54446, under date of March 29, 1957, Case Number 65673 and under date of August 25, 1995, Case Number 267864; that the notice, of which the annexed is a printed copy, has been published in said newspaper in accordance with the instructions of the person(s) requesting publication, and not in any supplement thereof on the following dates, to wit:

02-19-10

I Certify (or declare) under penalty of perjury that the foregoing is true and correct.

Date: Feb. 19, 2010
At: Riverside, California

BOARD OF SUPERVISORS

P.O. BOX 1147
COUNTY OF RIVERSIDE
RIVERSIDE CA 92502

Ad #: 10166728

PO #:

Agency #: _____

Ad Copy:

BOARD OF SUPERVISORS OF THE COUNTY OF
RIVERSIDE, STATE OF CALIFORNIA

ORDINANCE NO. 452.227

AN ORDINANCE OF THE COUNTY OF RIVERSIDE AMENDING ORDINANCE NO. 452

RELATING TO PRIMA FACIE SPEED LIMITS

The Board of Supervisors of the County of Riverside ordains as follows:

Section 1. Section 2.2 of Ordinance No. 452, entitled "Thirty miles per hour," is amended to add a new subsection 20 thereto to read as follows:

"20. On Golden Star Avenue between the City of Riverside city limits and the centerline of Washington Street, a total distance of approximately 1.0 mile, in the Riverside area."

Section 2. Section 2.3 of Ordinance No. 452, entitled "Thirty-five miles per hour," is amended to add new subsections 97 and 98 thereto to read as follows:

"97. On Starlight Lane between the centerline of 41st Avenue and the centerline of Country Club Drive, a total distance of approximately 0.4 mile, in the Bermuda Dunes area."

"98. On Victoria Avenue between the centerline of Fillmore Street and the centerline of La Sierra Avenue, a total distance of approximately 0.54 mile, in the Riverside area."

Section 3. Section 2.4 of Ordinance No. 452, entitled "Forty miles per hour," is amended to add a new subsection 105 and 106 thereto to read as follows:

"105. On Mayhew Canyon Road between the centerline of Campbell Ranch Road (W) and the centerline of Campbell Ranch Road (E), a total distance of approximately 1.2 miles, in the Corona area."

"106. On Temescal Canyon Road between I-15 and the centerline of Campbell Ranch Road (W), a total distance of approximately 1.8 miles, in the Temescal Valley area."

Section 4. Section 2.5 of Ordinance No. 452, entitled "Forty-five miles per hour," is amended to add new subsections 129, 130, 131, 132, 133, 134, 135, 136, 137, 138, 139, and 140 thereto to read as follows:

"129. On the full-width of El Nido Avenue between the centerline of Orange Avenue and the centerline of Walnut Avenue, and on the westerly half of El Nido Avenue between the centerline of Walnut Avenue and the centerline of Rider Street, a total distance of approximately 0.9 mile, in the Perris area."

"130. On Leon Road between the centerline of Olive Avenue and the centerline of Simpson Road, a total distance of approximately 0.5 mile, in the Winchester area."

"131. On Limonite Avenue between the centerline of Hammer Avenue and the centerline of Wineville Avenue, a total distance of approximately 1.0 mile, in the Pedley area."

"132. On Magnolia Avenue between a point 400 feet west of the centerline of Temescal Street and a point 2,000 feet east of the centerline of Lincoln Street, a total distance of approximately 2.0 miles, in the Home Gardens area."

"133. On Marshall Avenue between the centerline of State Highway 74 and the southerly terminus of Marshall Avenue, a total distance of 0.46 mile, in the Hemet area."

"134. On Mount Vernon Avenue between the centerline of Palmyra Avenue and the centerline of Main Street, a total distance of approximately 1.0 mile, in the Highgrove area."

"135. On Nancy Avenue between the centerline of Brookside Avenue and the centerline of Cherry Valley Boulevard, a total distance of approximately 0.5 mile, in the Cherry Valley area."

"136. On Sumner Avenue between the centerline of Citrus Street and the centerline of Bellegrove Avenue, a total distance of approximately 2.14 miles, in the Eastvale area."

"137. On Ontario Avenue between the centerline of State Street and the centerline of El Cerrito Road, a total distance of approximately 0.7 mile, in the El Cerrito area."

"138. On Temescal Canyon Road between the centerline of El Cerrito Road and the centerline of Cajalco Road, a total distance of approximately 1.1 miles, in the El Cerrito area."

"139. On Temescal Canyon Road between the centerline of Weirick Road and I-15, a total distance of approximately 2.4 miles, in the Temescal Valley area."

"140. On Valley Way between State Route 60 and the centerline of Sierra Avenue, a total distance of approximately 1.0 mile, in the Sunnyslope area."

Section 5. Section 2.6 of Ordinance No. 452, entitled "Fifty miles per hour," is amended to add new subsections 62, 63, and 64, thereto to read as follows:

"62. On Murrieta Hot Springs Road between the centerline of Calistoga Drive and the centerline of Red Post Circle, a total distance of approximately 1.1 miles, in the Temecula area."

"63. On Simpson Road between a point 300 feet west of Columbia Avenue and the centerline of Whittier Avenue, a total distance of approximately 0.8 mile, in the Winchester area."

"64. On Wood Road between the centerline of Cajalco Road and the centerline of Mariposa Avenue, a total distance of approximately 2.5 miles, in the Woodcrest area."

Section 6. Section 2.7 of Ordinance No. 452, entitled "Fifty-five miles per hour," is amended to add a new subsection 21 thereto to read as follows:

"21. On Limonite Avenue between the centerline of Wineville Avenue and the centerline of Etiwanda Avenue, a total distance of approximately 1.0 mile, in the Pedley area."

Section 7. Subsection 20 of Section 2.4 of Ordinance No. 452 adopted on February 4, 2003, pursuant to Ordinance No. 452.214 is repealed in its entirety. Subsection 20 of Section 2.4 established a forty miles per hour speed limit on Ontario Avenue between the centerline of State Street and the centerline of El Cerrito Road, and on Temescal Canyon Road between the centerline of El Cerrito Road and the centerline of Cajalco Road.

Subsection 23 of Section 2.4 of Ordinance No. 452 adopted on February 4, 2003, pursuant to Ordinance No. 452.214 is repealed in its entirety. Subsection 23 of Section 2.4 established a forty miles per hour speed limit on Temescal Canyon Road between I-15 and 1,600 feet east of Maitri Road.

Subsection 40 of Section 2.4 of Ordinance No. 452 adopted on February 4, 2003, pursuant to Ordinance No. 452.214 is repealed in its entirety. Subsection 40 of Section 2.4 established a forty miles per hour speed limit on Valley Way (Armstrong Road) from State Route 60 to the centerline of Sierra Avenue.

Subsection 60 of Section 2.4 of Ordinance No. 452 adopted on February 4, 2003, pursuant to Ordinance No. 452.214 is repealed in its entirety. Subsection 60 of Section 2.4 established a forty miles per hour speed limit on Leon Road between Simpson Road and Olive Avenue.

Subsection 26 of Section 2.5 of Ordinance No. 452 adopted on February 4, 2003, pursuant to Ordinance No. 452.214 is repealed in its entirety. Subsection 26 of Section 2.5 established a forty-five miles per hour speed limit on Newport Road between the centerline of Interstate 215 freeway and the centerline of Menifee Road.

Subsection 33 of Section 2.5 of Ordinance No. 452 adopted on February 4, 2003, pursuant to Ordinance No. 452.214 is repealed in its entirety. Subsection 33 of Section 2.5 established a forty-five miles per hour speed limit on East Sixth Street between the city limit boundary of the City of Corona and the centerline of Temescal Street.

Subsection 34 of Section 2.5 of Ordinance No. 452 adopted on February 4, 2003, pursuant to Ordinance No. 452.214 is repealed in its entirety. Subsection 34 of Section 2.5 established a forty-five miles per hour speed limit on Magnolia Avenue between the centerline of Temescal Street and the city limit boundary of the City of Riverside.

Subsection 66 of Section 2.5 of Ordinance No. 452 adopted on February 4, 2003, pursuant to Ordinance No. 452.214 is repealed in its entirety. Subsection 66 of Section 2.5 established a forty-five miles per hour speed limit on Simpson Road from 300 feet west of Columbia Avenue to the centerline of Patterson Avenue.

Subsection 84 of Section 2.5 of Ordinance No. 452 adopted on May 20, 2003, pursuant to Ordinance No. 452.215 is repealed in its entirety. Subsection 84 of Section 2.5 established a forty-five miles per hour speed limit on Sumner Avenue between Citrus Street and Cloverdale Road.

Subsection 4 of Section 2.6 of Ordinance No. 452 adopted on February 4, 2003, pursuant to Ordinance No. 452.214 is repealed in its entirety. Subsection 4 of Section 2.6 established a fifty miles per hour speed limit on Newport Road between Menifee Road and Briggs Road.

Subsection 16 of Section 2.6 of Ordinance No. 452 adopted on February 4, 2003, pursuant to Ordinance No. 452.214 is repealed in its entirety. Subsection 16 of Section 2.6 established a fifty miles per hour speed limit on Temescal Canyon Road between the centerline of Cajalco Road and I-15.

Subsection 53 of Section 2.6 of Ordinance No. 452 adopted on September 16, 2008, pursuant to Ordinance No. 452.224 is repealed in its entirety. Subsection 53 of Section 2.6 established a fifty miles per hour speed limit on Newport Road between Murrieta Road and I-215.

Subsection 1 of Section 2.8 of Ordinance No. 452 adopted on February 4, 2003, pursuant to Ordinance No. 452.214 is repealed in its entirety. Subsection 1 of Section 2.8 established a sixty miles per hour speed limit on Domenigoni Parkway between the city limit boundary of the City of Hemet and the easterly right-of-way boundary of Winchester Road (State Route 79).

Section 8. This ordinance shall take effect 30 days after its adoption.

Marion Ashley, Chairman of the Board
I HEREBY CERTIFY that at a regular meeting of the Board of Supervisors of said County, held on February 9, 2010, the foregoing Ordinance consisting of eight (8) sections was adopted by said Board by the following vote:

AYES: Buster, Tavaglione, Stone, Benoit and Ashley

NAYS: None

ABSENT: None

Kecia Harper-Ihem, Clerk of the Board

By: Cecilia Gil, Board Assistant

The Desert Sun

mydesert.com

750 N. Gene Autry Trail
Palm Springs, CA 92262
Billing Inquiries: (866) 875-0854
Main Office: (760) 322-8889

ADVERTISING INVOICE/STATEMENT

Make Checks payable to DESERT SUN PUBLISHING CO.
P.O. Box 677368 Dallas, TX 75267-7368
A finance charge of 1.5% per month(18% Annually) will be
added to balances not paid by the 20th.

144

RIV0690000036880320037213210822

RIVERSIDE COUNTY-BOARD OF SUP.
PO BOX 1147
RIVERSIDE CA 92502-1147

PLEASE RETURN THIS TOP SECTION WITH PAYMENT IN THE
ENCLOSED ENVELOPE AND INCLUDE YOUR CUSTOMER NUMBER
ON REMITTANCE.

Customer No.	Invoice No.
RIV069	0003688032
For the Period	Thru
02/01/10	02/28/10
Due Date	Amount Due
03/15/10	3,721.32
AMOUNT PAID	

Date	EDT	Class	Description	Times Run	Col	Depth	Total Size	Rate	Amount
0201			BALANCE FORWARD						4,598.82
0201			COMMERCIAL PAYMENT THANK YOU						3,922.18-
0205	CLS	0001	CECILIA NO 0461 NOTICE O	8	2	135.00	2160.00		230.10
0205	CLS	0001	CECILIA NO 0462 BOARD OF	8	2	67.00	1072.00		117.22
0207	CLS	0001	CECILIA NO 0513 BOARD OF	8	2	730.00	1680.00		1,217.80
0212	CLS	0001	CECILIA NO 0590 NOTICE O	8	2	92.00	1472.00		158.72
0213	CLS	0001	CECILIA NO 0615 NOTICE O	8	2	75.00	1200.00		130.50
0213	CLS	0001	CECILIA NO 0616 NOTICE O	8	2	92.00	1472.00		158.72
0214	CLS	0001	CECILIA NO 0627 NOTICE O	8	2	92.00	1472.00		158.72
0214	CLS	0001	CECILIA NO 0628 NOTICE O	8	2	65.00	1040.00		113.90
0219	CLS	0001	CECILIA NO 0689 BOARD OF	8	2	208.00	3328.00		351.28
0219	CLS	0001	CECILIA [REDACTED] OF	8	2	242.00	3872.00		407.72
<div> <div>2010 MAR -8 PM 3:10</div> <div>RECEIVED RIVERSIDE COUNTY CLERK'S OFFICE</div> </div>									
Current		Over 30 Days	Over 60 Days	Over 90 Days	Over 120 Days	Total Due			
3,044.68		487.14	189.50	.00	.00	3,721.32			
Contract Type		Contract Qnty.	Expiration Date	Current Usage	Total Used	Quantity Remaining		Salesperson	
								MOELLER	

The Advertiser shall make payment within 15 days of the billing date indicated on Company's statement, and, in the event that it fails to make payment within such time, Company may reject advertising copy and / or immediately cancel this contract and Advertiser agrees to indemnify Company for all expenses incurred in connection with the collection of amounts payable under this contract, including but not limited to collection fees, attorney's fees and court costs. If this agreement is cancelled due to Advertiser's failure to make timely payment, Company may rebill the Advertiser for the outstanding balance due at the open or earned contract rate, whichever is applicable.

TO ENSURE PROPER CREDIT, PLEASE RETURN THE TOP SECTION AND INCLUDE YOUR CUSTOMER NUMBER ON REMITTANCE.

Customer Number	Name	Invoice Number	Amount Paid
RIV069	RIVERSIDE COUNTY-BOARD OF SUP.	0003688032	

THE DESERT SUN PUBLISHING CO.
ADVERTISING INVOICE/STATEMENT

3.61 of 02/09/10

**PROOF OF PUBLICATION
(2015.5.C.C.P)**

**STATE OF CALIFORNIA
County of Riverside**

I am a citizen of the United States and a resident of the County aforesaid; I am over the age of eighteen years, and not a party to or interested in the above-entitled matter. I am the principal clerk of a printer of the, **DESERT SUN PUBLISHING COMPANY** a newspaper of general circulation, printed and published in the city of Palm Springs, County of Riverside, and which newspaper has been adjudged a newspaper of general circulation by the Superior Court of the County of Riverside, State of California under the date of March 24, 1988. Case Number 191236; that the notice, of which the annexed is a printed copy (set in type not smaller than non paniel, has been published in each regular and entire issue of said newspaper and not in any supplement thereof on the following dates, to wit:

February 19th, 2010

All in the year 2010

I certify (or declare) under penalty of perjury that the foregoing is true and correct.

Dated at Palm Springs, California this —19th, — day

of— February —, 2010

Signature