

**SUBMITTAL TO THE BOARD OF SUPERVISORS
COUNTY OF RIVERSIDE, STATE OF CALIFORNIA**

4028



SUBMITTAL DATE:
December 22, 2009

FROM: County Counsel/TLMA
Code Enforcement Department

SUBJECT: Abatement of Public Nuisance [Substandard Structure]
Case No.: CV 09-02820 (Lyons)
Subject Property: 13220 Joshua Road, Whitewater; APN: 517-221-009
District Five

RECOMMENDED MOTION: Move that:

Departmental Concurrence

- (1) The substandard structure on the real property located at 13220 Joshua Road, Whitewater Riverside County, California, APN: 517-221-009, be declared a public nuisance and a violation of Riverside County Ordinance No. 457 which does not permit substandard structures on the property.
- (2) Mark E. Lyons, the Owners of the subject real property or whoever has possession or control of the premises, be directed to abate the substandard structure on the property by removing the same from the real property within ninety (90) days.

JULIE A. JARVI, Deputy County Counsel
for PAMELA J. WALLS, Interim County Counsel

(Continued)

FINANCIAL DATA	Current F.Y. Total Cost:	\$ N/A	In Current Year Budget:	N/A
	Current F.Y. Net County Cost:	\$ N/A	Budget Adjustment:	N/A
	Annual Net County Cost:	\$ N/A	For Fiscal Year:	N/A

SOURCE OF FUNDS:	Positions To Be Deleted Per A-30	<input type="checkbox"/>
	Requires 4/5 Vote	<input type="checkbox"/>

C.E.O. RECOMMENDATION:

APPROVE
BY:
Tina Grande

County Executive Office Signature

Policy Policy
 Consent Consent
 Dept't Recomm.: Per Exec. Ofc.:

MINUTES OF THE BOARD OF SUPERVISORS

On motion of Supervisor Ashley, seconded by Supervisor Buster and duly carried by unanimous vote, IT WAS ORDERED that the above matter is approved as recommended.

Ayes: Buster, Tavaglione, Stone, Benoit and Ashley
Nays: None
Absent: None
Date: April 20, 2010
xc: Co. Co., CED, Sheriff, Prop. Owner

Kecia Harper-Ihem
Clerk of the Board
By:
Deputy

Prev. Agn. Ref.: | **District:** 5 | **Agenda Number:**

9.9

- (3) The owner be ordered to ascertain the existence or non-existence of asbestos containing materials in said structure by survey and materials sample testing through the Industrial Hygiene Specialist of the County Health Department, Division of Special Services; and, prior to the abatement ordered in paragraph number two (2) above, to secure the removal and disposal of all asbestos containing materials discovered through such survey and testing by contract with a duly certified and licensed contractor for the handling of such materials to avoid citations and/or fines imposed by the South Coast Air Quality Management District (SCAQMD) pursuant to SCAQMD Rule No. 1403.
- (4) If the owner or whoever has possession or control of the real property does not take the above described action within ninety (90) days of the date of the Board's Order to Abate, that representatives of the Code Enforcement Department, Sheriff's Department, and/or a contractor, upon consent of the owner or receipt of a Court Order authorizing entry onto the real property when necessary under applicable law, shall abate the substandard structure and contents therein, by removing the same from the real property.
- (5) The reasonable costs of abatement, after notice and an opportunity for hearing, shall be imposed as a lien on the real property, which may be collected as a special assessment against the real property pursuant to Government Code Section 25845 and Ordinance No. 725.
- (6) County Counsel be directed to prepare the necessary Findings of Facts and Conclusions that the substandard structure on the real property is declared to be in violation of Riverside County Ordinance No. 457 and a public nuisance, and further, to prepare an Order to Abate for approval by the Board.

JUSTIFICATION:

1. An inspection was made of the subject property by the Code Enforcement Officer on April 27, 2009. The inspection revealed a substandard structure (single family dwelling) on the subject property in violation of Riverside County Ordinance No. 457 (RCC Title 15). The substandard conditions of the structure included, but were not limited to, the following: lack of or improper water closet, lavatory, bathtub, shower or kitchen; hazardous plumbing; lack of required electrical lighting; hazardous wiring; lack of adequate heating facilities; members of walls, partitions, or other vertical supports that split, lean, lost or buckle due to defective material or deterioration; faulty weather protection; general dilapidation or improper maintenance; and abandoned, vacant, public and attractive nuisance.
2. Follow-up inspections on June 2, 2009, September 21, 2009 and November 25, 2009, revealed that the property continues to be in violation of Riverside County Ordinance No. 457.
3. Staff and the Code Enforcement Department have complied with the notice requirements set forth in the appropriate laws of this jurisdiction pertaining to the administrative abatement proceedings for substandard structures.

MINUTES OF THE BOARD OF SUPERVISORS
COUNTY OF RIVERSIDE, STATE OF CALIFORNIA



9.6

9:30 a.m. being the time set for public hearing on the recommendation from County Counsel/Code Enforcement regarding the Abatement of Public Nuisance [Substandard Structure] Case No. CV 09-02820, located at 13220 Joshua Road, Whitewater, 5th District, the Chairman called the matter for hearing.

Jonathan Holub, Deputy County Counsel presented the matter.

Mark Lyons spoke on the matter.

On motion of Supervisor Ashley, seconded by Supervisor Stone and duly carried, IT WAS ORDERED that the above matter is continued to Tuesday, April 20, 2010 at 9:30 a.m.

Roll Call:

Ayes: Buster, Stone, Benoit and Ashley
Nays: None
Absent: Tavaglione

I hereby certify that the foregoing is a full true, and correct copy of an order made and entered on January 26, 2010 of Supervisors
Minutes.

WITNESS my hand and the seal of the Board of Supervisors
Dated: January 26, 2010
Kecia Harper-Ihem, Clerk of the Board of Supervisors, in
and for the County of Riverside, State of California.

(seal)

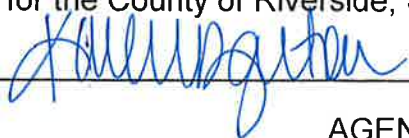
By:  Deputy

AGENDA NO.
9.6

xc: Co. Co., CED, Prop. Owner, COB

MINUTES OF THE BOARD OF SUPERVISORS
COUNTY OF RIVERSIDE, STATE OF CALIFORNIA



9.4

9:30 a.m. being the time set for public hearing on the recommendation from County Counsel/Code Enforcement regarding the Abatement of Public Nuisance [Substandard Structure] Case No. CV 09-02820, located at 13220 Joshua Road, Whitewater, 5th District, the Chairman called the matter for hearing.

Julie Jarvi, Deputy County Counsel presented the matter.

Mark Lyons spoke on the matter asking for more time.

On motion of Supervisor Ashley, seconded by Supervisor Benoit and duly carried by unanimous vote, IT WAS ORDERED that the above matter is continued to Tuesday, January 26, 2010 at 9:30 a.m.

I hereby certify that the foregoing is a full true, and correct copy of an order made and entered on December 22, 2009 of Supervisors
Minutes.

(seal)

WITNESS my hand and the seal of the Board of Supervisors
Dated: December 22, 2009
Kecia Harper-Ihem, Clerk of the Board of Supervisors, in
and for the County of Riverside, State of California.

By: [Signature] Deputy

AGENDA NO.
9.4

xc: Co. Co., CED, Prop. Owner, COB

1 **BOARD OF SUPERVISORS**
2 **COUNTY OF RIVERSIDE**

3 IN RE ABATEMENT OF PUBLIC NUISANCE)
4 [SUBSTANDARD STRUCTURE]; APN: 517-221-)
5 009, 13220 JOSHUA ROAD, WHITEWATER,)
6 COUNTY OF RIVERSIDE, STATE OF)
7 CALIFORNIA; MARK E. LYONS, OWNER.)

CASE NO. CV 09-02820

DECLARATION OF OFFICER
ANTHONY GREEN

[R.C.O. No. 457, RCC Title 15]

7 I, Anthony Green, declare:

8 1. I am currently employed by the Riverside County Code Enforcement Department as a
9 Code Enforcement Officer. My current official duties include inspecting property for violations and
10 enforcement of the provisions of Riverside County Ordinances. The following facts contained within this
11 declaration are within my personal knowledge except to the extent that certain information is based on
12 information and belief and if called as a witness in this matter, I could and would competently testify
13 thereto.

14 2. On April 27, 2009, I conducted an initial inspection of the real property known as 13220
15 Joshua Road, Whitewater, in the unincorporated area of Riverside County, California, which is further
16 described as Assessor's Parcel Number 517-221-009 (hereinafter described as "THE PROPERTY"). A
17 true and correct copy of a Thomas Brothers map page indicating the approximate location of THE
18 PROPERTY is attached hereto as Exhibit "A" and is incorporated herein by this reference.

19 3. A review of County records and documents disclosed that THE PROPERTY was owned
20 by Mark E. Lyons at the time of the inspection referenced in paragraph 2 above (hereinafter referred to as
21 "OWNER"). A certified copy of the County Equalized Assessment Roll for the year 2009-2010 is
22 attached hereto as part of Exhibit "B" and incorporated herein by reference. THE PROPERTY is located
23 within the R-R (Rural Residential) zone classification. A copy of a report generated from the County
24 Geographic Information System ("GIS") is attached hereto as part of Exhibit "B" and incorporated herein
25 by reference.

26 4. Based on the Lot Book Report from RZ Title Service dated June 11, 2009, it is determined
27 that no other party potentially holds a legal interest in THE PROPERTY. A true and correct copy of the
28 Lot Book Report is attached hereto and incorporated herein as Exhibit "C."

1 5. On April 27, 2009, I went to THE PROPERTY to conduct an initial inspection. THE
2 PROPERTY was vacant and the gate was open and there were no signs prohibiting access. The windows
3 of the structure were boarded up. I observed the following conditions as described below which caused
4 the single family dwelling to be substandard and THE PROPERTY to constitute a public nuisance in
5 violation of the provisions set forth in Riverside County Ordinance 457, as codified in Riverside County
6 Code Title 15: (See Exhibit "D" for photographs referenced below)

7 Single Family Dwelling

- 8 1) Lack of or improper water closet, lavatory, bathtub, shower or kitchen sink (See
9 photograph 9);
- 10 2) Hazardous plumbing (See photograph 9);
- 11 3) Lack of required electrical lighting (See photograph 11);
- 12 4) Hazardous wiring (See photographs 5-7, 10);
- 13 5) Lack of adequate heating facilities (See photograph 8);
- 14 6) Members of walls, partitions, or other vertical supports that split, lean, list or buckle due to
15 defective material or deterioration (See photographs 5-7);
- 16 7) Faulty weather protection (See photographs 3, 4);
- 17 8) General dilapidation or improper maintenance (See photographs 1-12);
- 18 9) Abandoned, vacant, public and attractive nuisance (See photographs 1-12).

19 6. On April 27, 2009 a Notice of Violation, Notice of Defects and "Danger Do Not Enter"
20 sign were posted on THE PROPERTY, copies of which and affidavit thereof are attached hereto as part of
21 Exhibit "E" and incorporated herein by reference.

22 7. A site plan and photographs of THE PROPERTY are attached hereto and incorporated
23 herein by reference as part of Exhibit "D."

24 8. On June 26, 2009, a Notice of Violation and Notice of Defects were mailed by certified
25 mail, return receipt requested to OWNER. True and correct copies of the notices and supporting
26 documentation are attached hereto as part of Exhibit "E" and are incorporated herein by reference.

27 9. On June 2, 2009, and September 21, 2009, I conducted follow-up inspections on THE
28 PROPERTY that showed that the substandard structure (single family dwelling) remained on THE
PROPERTY in violation of Riverside County Ordinance No. 457 (RCC Title 15). True and correct
photographs depicting the substandard condition of the structure on September 21, 2009 are attached
hereto as part of Exhibit "D" and incorporated herein by reference.

 10. On June 16, 2009 I placed a telephone call to OWNER to ascertain whether he was going

1 to secure THE PROPERTY. On June 25, 2009 attempted to return a telephone call from OWNER.
2 However, I was unable to contact him and there was no voicemail. On July 6, 2009 I attempted to return
3 another telephone call from OWNER. I was unable to contact him but I left a message on his voicemail.

4 11. Based upon my experience, knowledge and visual observations, it is my determination that
5 the substandard structure on THE PROPERTY creates an extreme health, safety, fire and structural hazard
6 to the neighbors and general public.

7 12. A Follow-up inspection on November 25, 2009 showed THE PROPERTY remained in
8 violation of Riverside County Ordinance No. 457 (RCC Title 15).

9 13. Furthermore, based on my observations of THE PROPERTY, I declare that the
10 SUBSTANDARD CONDITION of THE PROPERTY constitutes a public nuisance in violation of the
11 provisions set forth in Riverside County Ordinance No. 457 (RCC Title 15).

12 14. A Notice of Noncompliance was recorded on June 25, 2009 as Document Number 2009-
13 0325146 in the Office of the County Recorder, Riverside County, State of California. A true and correct
14 copy of this notice is attached hereto as Exhibit "F" and incorporated herein by reference.

15 15. On November 24, 2009, the second notice, Notice to Correct County Ordinance Violations
16 and Abate Public Nuisance, providing the notification of the Board of Supervisors' hearing was mailed to
17 OWNER by certified mail, return receipt requested and was posted on THE PROPERTY on November
18 25, 2009. A true and correct copy of the notice, together with proof of service, returned receipt card and
19 the Affidavit of Posting of Notice are attached as Exhibit "G" and incorporated herein by reference.

20 16. Significant rehabilitation, removal and /or demolition of the substandard structure and
21 removal and disposal of all structural debris are required to abate the public nuisance and bring THE
22 PROPERTY into compliance with Riverside County Ordinance Number 457 (RCC Title 15), the Health
23 and Safety, Uniform Housing, Administrative and Abatement of Dangerous Buildings Codes.

24 17. Accordingly, the following findings and conclusions are recommended:

25 (a) the structure be condemned as a substandard building, public nuisance and
26 attractive nuisance;

27 (b) the OWNER be required to rehabilitate or demolish said structure, including the
28 removal and disposal of all structural debris and materials, on THE PROPERTY in accordance with the

1 removal and disposal of all structural debris and materials, on THE PROPERTY in accordance with the
2 provisions of Riverside County Ordinance No. 457 (RCC Title 15);

3 (c) the OWNER be ordered to ascertain the existence or non-existence of asbestos
4 containing materials in said structure by survey and materials sample testing through the Industrial
5 Hygiene Specialist of the County Health Department, Division of Special Services; and, prior to the
6 abatement ordered in subsection (b) above, to secure the removal and disposal of all asbestos containing
7 ~~materials discovered through such survey and testing by contract with a duly certified and licensed~~
8 contractor for the handling of such materials to avoid citations an/or fines by South Coast Air Quality
9 Management District ("SCAQMD") pursuant to SCAQMD Rule NO. 1403;

10 (d) if the substandard structure is not razed, removed and disposed of, or reconstructed
11 in strict accordance with all Riverside County Ordinances, including but not limited to Riverside County
12 Ordinance No. 457 (RCC Title 15), within ninety (90) days of the date of the Board's Order to Abate, the
13 substandard structure and contents therein shall be abated by representatives of the Riverside County
14 Code Enforcement Department, a contractor or the Sheriff's Department upon receipt of an owner's
15 consent or a Court Order where necessary under applicable law authorizing entry onto THE PROPERTY;

16 (e) that reasonable costs of abatement, after notice and opportunity for hearing, shall be
17 imposed as a lien on THE PROPERTY, which may be collected as a special assessment against THE
18 PROPERTY pursuant to Government Code Section 25845 and Riverside County Ordinance Nos. 457 and
19 725 (RCC Titles 15 and 1).

20 I declare under penalty of perjury under the laws of the State of California that the
21 foregoing is true and correct.

22 Executed this 8TH day of DECEMBER, 2009, at MORENO VALLEY, California.

24 
25 ANTHONY GREEN
26 Code Enforcement Officer
27 Code Enforcement Department

28 L:\DOCS\6000\0902820\A62487.DOC

RIVERSIDE CO.

SEE 723 MAP

724

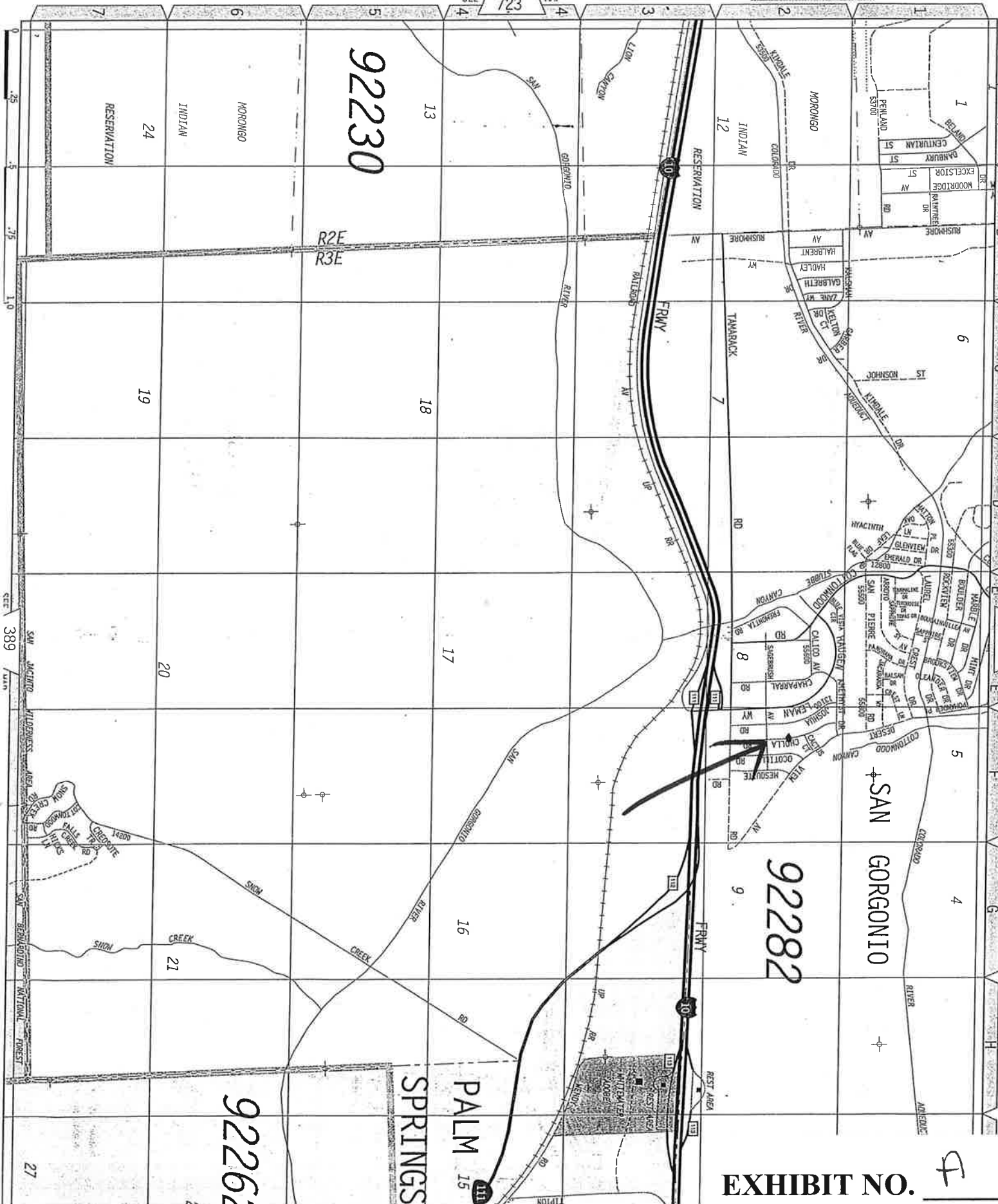

EXHIBIT NO. 4

Assessment Roll For the 2009-2010 Tax Year as of January 1, 2009

Assessment #517221009-9		Parcel # 517221009-9	
Assessee:	LYONS MARK E	Land	9,000
Mail Address:	16246 SKYWOOD CT	Structure	55,000
City, State Zip:	MORENO VALLEY CA 92551	Full Value	64,000
Real Property Use Code:	R1	Total Net	64,000
Base Year	2005		
Conveyance Number:	0069130		
Conveyance (mm/yy):	1/2004		
PUI:	R010012		
TRA:	55-031		
Taxability Code:	0-00		
ID Data:	Lot 200 MB 033/068 SAN GORGONIO PASS 3		
Situs Address:	13220 JOSHUA RD WHITEWATER CA 92282		

View Parcel Map

This must be in red to be a "CERTIFIED COPY"

I hereby certify the foregoing instrument to which this stamp has been affixed consisting of 1 page to be a full, true and correct copy of the original on file and of record in my office.

Larry W. Han
 Assessor - County Clerk - Recorder
 County of Riverside, State of California
 Dated: DEC 08 2009



Certification must be in red to be a "CERTIFIED COPY"

EXHIBIT NO. 3

RIVERSIDE COUNTY GIS

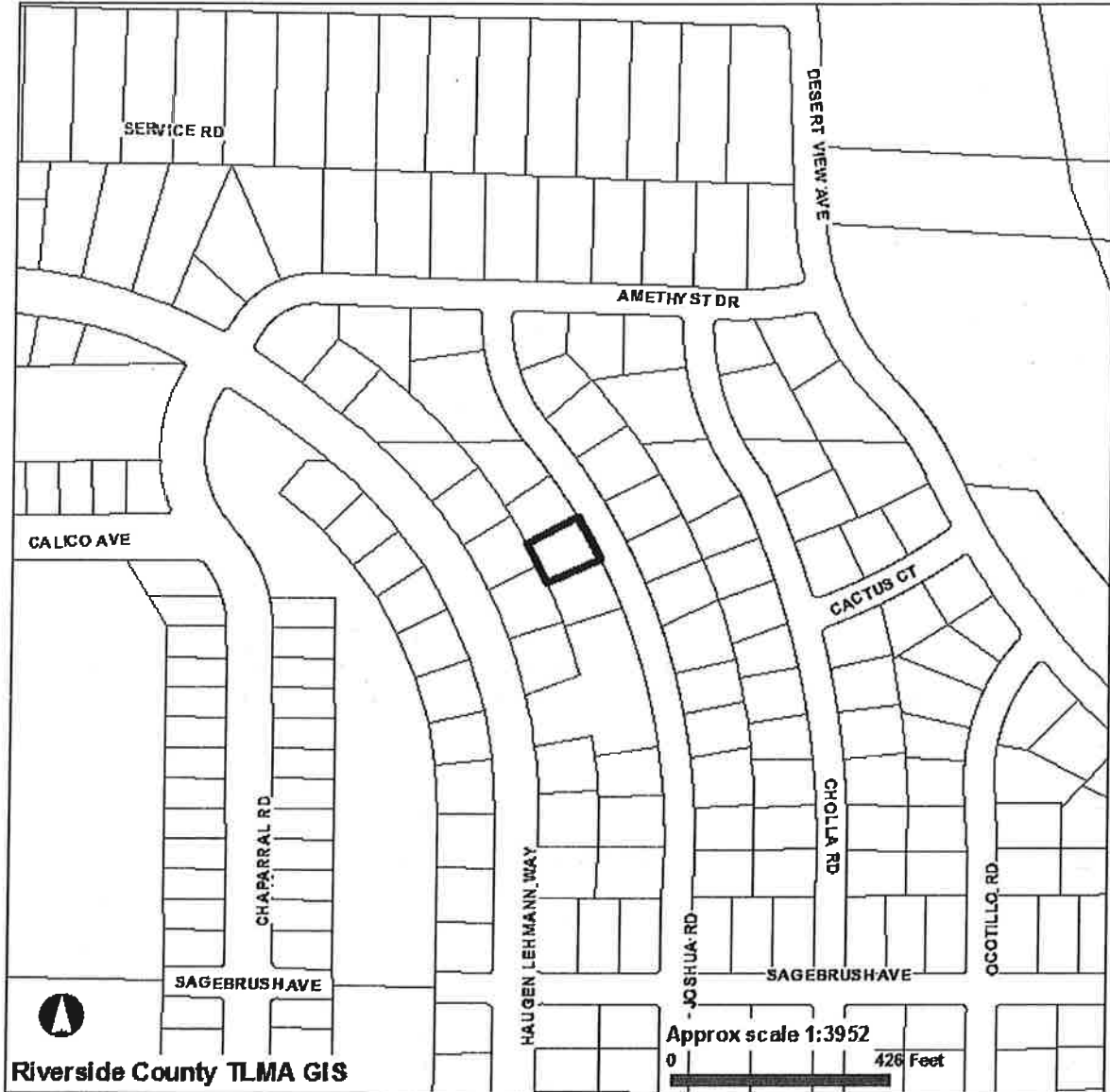

Selected parcel(s):
517-221-009

IMPORTANT

This information is made available through the Riverside County Geographic Information System. The information is for reference purposes only. It is intended to be used as base level information only and is not intended to replace any recorded documents or other public records. Contact appropriate County Department or Agency if necessary. Reference to recorded documents and public records may be necessary and is advisable.

FULL REPORT

APN(s): 517-221-009-9

OWNER NAME / ADDRESS:

- 517-221-009
MARK E LYONS
13220 JOSHUA RD
WHITEWATER, CA. 92282

MAIL TO NAME/ADDRESS:

- 517-221-009
- (SEE OWNER)
- 16246 SKYWOOD CT
- MORENO VALLEY CA. 92551

APN CAME FROM:

- 517-221-009
- CAME FROM: NO DATA AVAILABLE

B2

LOT SIZE: - 517-221-009
- RECORDED LOT SIZE IS: 0.24 ACRES

PROPERTY CHARACTERISTICS: - 1. 517-221-009
- WOOD FRAME, 1229 SQFT., 3 BDRM/ 1.5 BATH, 1 STORY, ATTACHED GARAGE(400 SQ. FT),
CONST'D 1960, COMPOSITION ROOF, CENTRAL HEATING,

ELEVATION (APPROXIMATE): - 1456/1464 FEET

LEGAL DESCRIPTION: - APN: 517221009
- RECORDED BOOK/PAGE: MB 33/68
- SUBDIVISION NAME: SAN GORGONIO PASS 3
- LOT/PARCEL: 200, BLOCK: NOT AVAILABLE
- TRACT NUMBER: NOT AVAILABLE

BASE YEAR ASSESSMENT: - 517-221-009
- BASE YEAR: 2005

TOWNSHIP/RANGE: - T3SR3E SEC 8

CEMETERY DISTRICTS: - SUMMIT CEMETERY DISTRICT

CITY BOUNDARY/SPHERE: - CITY: NOT WITHIN A CITY
- CITY SPHERE: NOT WITHIN A SPHERE
- ANNEXATION DATE: NO DATE AVAILABLE
- LAFCO CASE #: NO CASE # AVAILABLE
- PROPOSALS: NONE

COMMUNITY: - IN OR PARTIALLY WITHIN SAN GORGONIO. SEE MAP FOR MORE INFORMATION.

2001 SUPERVISORIAL DISTRICT: - MARION ASHLEY, DISTRICT 5
as established by County Ordinance 813, August 14, 2001

AREA PLAN: - WESTERN COACHELLA VALLEY

COACHELLA VALLEY MULTI-SPECIES HABITAT CONSERVATION PLAN FEE AREA: - WITHIN THE COACHELLA VALLEY MSHCP FEE AREA

COACHELLA VALLEY MULTI-SPECIES HABITAT CONSERVATION PLAN - CONSERVATION AREA: - NOT IN A CONSERVATION AREA

WESTERN RIVERSIDE MULTI-SPECIES HABITAT CONSERVATION PLAN FEE AREA: - NOT WITHIN THE WESTERN RIVERSIDE COUNTY MSHCP FEE AREA

WESTERN RIVERSIDE COUNTY MSHCP AREA PLAN: - NOT IN AN AREAPLAN

WESTERN RIVERSIDE COUNTY MSHCP CELL GROUP: - NOT IN A CELLGROUP

WESTERN RIVERSIDE COUNTY MSHCP CELL NUMBER: - NOT IN A CELL

IMPORTANT NOTICE: On October 7, 2003, the County of Riverside adopted a new General Plan. The General Plan provides new land use designations for all parcels in the unincorporated area of Riverside County. For any parcel, the General Plan may provide for a different type of land use than is provided for under existing zoning. During the next one to two years, the County will undertake a program to review all the zoning in the unincorporated area, and where necessary, change the zoning, following advertised public hearings, to conform to the County's new General Plan. Until then, please be advised that there may be a difference between the zoning and General Plan designations on any parcel. This may result in, at a minimum, the need to change the zoning before desired development may proceed. For further information, please contact the Riverside County Planning Department offices in Riverside at (951) 955-3200, in Murrieta at (951) 600-6170, or in Indio at (760) 863-8277.

LANDUSE DESIGNATION: Click [here](#) for landuse descriptions.
- MDR

- CHECK MAP TO CONFIRM LANDUSE DESIGNATION
- FOR MORE INFORMATION ABOUT LANDUSE DESIGNATIONS, CALL THE COUNTY'S PLANNING DEPARTMENT AT 951-955-3200.

ZONING CLASSIFICATION(S) ORD. 348: Click [here](#) for zoning classifications.
- R-R

- CHECK MAP TO CONFIRM ZONING CLASSIFICATIONS
- FOR MORE INFORMATION ABOUT ZONING CLASSIFICATIONS, CALL THE COUNTY'S PLANNING DEPARTMENT AT 951-955-3200.

ZONING DISTRICT/AREA: - WHITEWATER AREA

OUTDOOR BILLBOARDS: - BILLBOARDS NOT PERMITTED BY ZONING

SPECIFIC PLAN: - NOT WITHIN A SPECIFIC PLAN

NOTE: Non-mapped Policy Area issues may exist on this parcel. Please contact the Planning Department at (951)955-3200 for more information.

MAPPED POLICY AREAS: - SAN GORGONIO PASS WIND ENERGY POLICY AREA

GENERAL PLAN POLICY OVERLAY: - NOT IN A GENERAL PLAN POLICY OVERLAY AREA

DEVELOPMENT AGREEMENT #: - NOT IN A DEVELOPMENT AGREEMENT AREA

REDEVELOPMENT AREAS: - NOT IN A REDEVELOPMENT AREA

AGRICULTURE PRESERVE: - NOT IN AN AGRICULTURE PRESERVE

AIRPORT INFLUENCE AREAS: - NOT IN AN AIRPORT INFLUENCE AREA

AIRPORT COMPATIBILITY ZONES: - NOT IN AN AIRPORT COMPATIBILITY ZONE

Planning Case Map information may not be complete, current, or up-to-date for this area. Please contact the Planning Department if more information is needed.

PLANNING CASE(S): - NO PLANNING CASES DESCRIPTION: NOT APPLICABLE
 APPLIED DATE: NOT APPLICABLE STATUS: NOT APPLICABLE

DEV. IMP. FEE AREA ORD. 659: - WESTERN COACHELLA VALLEY

2000 CENSUS TRACT: - 044503

1990 FARMLAND DESIGNATION: - URBAN-BUILT UP LAND

2000 CENSUS DESIGNATION: - CENSUS DESIGNATION REPORT IS NOT AVAILABLE

INDIAN TRIBAL LANDS: - NOT IN A TRIBAL LAND

SCHOOL DISTRICT: - BANNING UNIFIED

ROAD & BRIDGE DISTRICT: - NOT IN A DISTRICT

ROADBOOK PAGE: - 142

* BOUNDARIES ARE APPROXIMATIONS. USE FOR REFERENCE ONLY. SURVEY INFORMATION MUST BE CONSULTED OR PREPARED TO ACCURATELY DETERMINE ANY RIGHT-OF-WAY BOUNDARY.

CETAP CORRIDORS: - NOT IN A CETAP CORRIDOR.

CIRCULATION ELEMENT ULTIMATE RIGHT-OF-WAY ROADS: - NOT IN A CIRCULATION ELEMENT RIGHT-OF-WAY

EAST T.U.M.F. ORD. 673: - IN OR PARTIALLY WITHIN THESE FEE AREAS. SEE MAP FOR MORE INFORMATION.
 - EAST

WEST T.U.M.F. ORD. 824: - NOT WITHIN THE WESTERN TUMF FEE AREA

WATER DISTRICT: - DESERT WATER AGENCY (DWA)

FLOOD CONTROL DISTRICT: - RIVERSIDE COUNTY FLOOD CONTROL DISTRICT

FLOOD PLAIN REVIEW: - NOT REQUIRED.

WATERSHED: - WHITEWATER

VEGETATION: - DATA NOT AVAILABLE

SKR FEE AREA ORD. 663.10: - NOT WITHIN A FEE AREA

HANS/ERP PROJECT: - NONE

FAULT ZONE: - SAN ANDREAS FAULT ZONE
CONTACT THE COUNTY'S CHIEF ENGINEERING GEOLOGIST AT (951)955-6863.

FAULTS: WITHIN A 1/2 MILE OF
- GARNET HILL FAULT
- SAN ANDREAS FAULT
- SAN ANDREAS FAULTS
CONTACT THE COUNTY'S CHIEF ENGINEERING GEOLOGIST AT (951)955-6863.

LIQUEFACTION POTENTIAL: - MODERATE

SUBSIDENCE: - SUSCEPTIBLE

HIGH FIRE AREA ORD. 787: - IN HIGH FIRE AREA - Grading And Building Permit Applications Require Fire Dept Clearance Prior To Permit Issuance.

STATE RESPONSIBILITY AREAS: - STATE RESPONSIBILITY AREA

LIGHTING ORD. 655: - ZONE B, 40.78 MILES.

COUNTY SERVICE AREA: - IN OR PARTIALLY WITHIN
W PALM SPRINGS #47 -
NO INFORMATION AVAILABLE

BUILDING PERMIT(S): -BZ357468 DESCRIPTION: REROOF DWELLING
APPLIED DATE: 05/14/2002 STATUS AS OF 09/24/2009: EXPIRED

CODE COMPLAINTS: -CV033332 CONSTRUCTION WITHOUT PERMIT
APPLIED DATE: Jul. 31, 2003 STATUS: COMPLETED
-CV0905236 ACCUMULATED RUBBISH
APPLIED DATE: Jul. 17, 2009 STATUS: INVESTIGATION
-CV0902909 VEHICLE ABATEMENT
APPLIED DATE: Apr. 27, 2009 STATUS: NOTICE TO ABATE
-CV0902820 SUBSTANDARD STRUCTURE
APPLIED DATE: Apr. 22, 2009 STATUS: NOTICE OF VIOLATION

ENVIRON. HEALTH CASE(S): - NO ENVIRONMENTAL CASES

TAX RATE AREAS: - 055-031
• BANNING UNIF SCH DIST LIB
• BANNING UNIFIED SCHOOL
• COACHELLA VALLEY RESOURCE CONSER
• COUNTY SERVICE AREA 47 *
• COUNTY STRUCTURE FIRE PROTECTION
• COUNTY WASTE RESOURCE MGMT DIST
• CSA 152
• DESERT WATER AGENCY
• FLOOD CONTROL ADMINISTRATION
• FLOOD CONTROL ZONE 6
• GENERAL
• GENERAL PURPOSE
• MISSION SPRINGS IMP E
• MISSION SPRINGS WATER DISTRICT
• MT SAN JACINTO JUNIOR COLLEGE
• RIV CO REG PARK & OPEN SPACE
• RIV. CO. OFFICE OF EDUCATION
• SAN GORGONIO PASS MEM HOSPITAL
• SUMMIT CEMETERY DISTRICT

SURFACE MINES: - NO SURFACE MINES

PALEONTOLOGICAL SENSITIVITY: - LOW POTENTIAL
FOLLOWING A LITERATURE SEARCH, RECORDS CHECK AND A FIELD SURVEY, AREAS MAY

BE DETERMINED BY A QUALIFIED VERTEBRATE PALEONTOLOGIST AS HAVING LOW POTENTIAL FOR CONTAINING SIGNIFICANT PALEONTOLOGICAL RESOURCES SUBJECT TO ADVERSE IMPACTS.

COMMUNITY FACILITY DISTRICTS: - NAME: NOT IN A COMMUNITY FACILITY DISTRICT
- DISTRICT NUMBER: NOT AVAILABLE

THOMAS BROS. MAPS PAGE/GRID: - PAGE 724- GRID E2
- PAGE 724- GRID F2

SPECIAL NOTES: - NO SPECIAL NOTES

REPORT PRINTED ON...Thu Sep 24 14:08:29 2009



P.O. Box 1193
 Whittier, CA 90609
 Tel # (562) 325-8351
 Fax # (714) 783-3038

Lot Book Report

Order Number: **19266**

Customer:

RIVERSIDE COUNTY TLMA-CODE INFORCEMENT
 4080 Lemon Street
 Riverside CA 92501

Order Date: 6/11/2009
 Dated as of: 6/10/2009
 County Name: Riverside

Attn: Brent Steele
 Reference: CV09-02820 / Thomas McMullen
 IN RE: LYONS, MARK E.

FEE(s):
 Report: \$120.00

Property Address: 13220 Joshua Road
 White Water CA 92282

Assessor's Parcel No. : 517-221-009-9

Assessments:

Land Value:	\$10,824.00
Improvement Value:	\$64,945.00
Exemption Value:	\$0.00
Total Value:	\$75,769.00

Tax Information

Property Taxes for the Fiscal Year	2008-2009
First Installment	\$477.22
Penalty	\$47.71
Status	NOT PAID-DELINQUENT
Second Installment	\$477.22
Penalty	\$78.71
Status	NOT PAID-DELINQUENT
Prior Delinquencies for tax defaulted year(s)	2007
Redemption Amount	\$1,229.84
If paid by	06/30/2009



P.O. Box 1193
Whittier, CA 90609
Tel # (562) 325-8351
Fax # (714) 783-3038

Order Number: 19266
Reference: CV09-02820 / Tho

Property Vesting

The last recorded document transferring title of said property

Dated	01/13/2004
Recorded	01/30/2004
Document No.	2004-0069130
D.T.T.	\$77.00
Grantor	Signature Alliance Corporation, a California corporation
Grantee	Mark E. Lyons, a single man

Deeds of Trust

No Deeds of Trust of Record

Additional Information

Abstract of Judgment Filed in the	Superior Court of California, County of Riverside, Banning Branch
Case No.	BAS002770
Recorded	08/05/2002
Document No.	2002-429698
Amount	\$1,370.00
Debtor	Marcus Lyons
Creditor	Katherine A. Wysocki
Abstract of Judgment Filed in the	Superior Court of California, Central Justice Center
Case No.	01CC10097
Recorded	11/05/2002
Document No.	2002-633892



P.O. Box 1193
Whittier, CA 90609
Tel # (562) 325-8351
Fax # (714) 783-3038

Order Number: 19266
Reference: CV09-02820 / Tho

Amount	\$278,718.39
Debtor	John Lyon, Mark Lyon
Creditor	Kurt Uhler
Abstract of Judgment Filed in the	Superior Court of California, County of Riverside
Case No.	TEC-054056
Recorded	09/30/2003
Document No.	2003-763574
Amount	\$27,136.66
Debtor	Mark Lyon, an individual
Creditor	Express Pipe & Supply Co., Inc.
Abstract of Support Judgment Filed in the	Superior Court of California, County of Los Angeles, Central Civil West
Case No.	NWD0005973
Recorded	09/22/2004
Document No.	2004-0753860
Debtor	Mark E. Lyon
Creditor	County of Los Angeles
Abstract of Judgment Filed in the	Superior Court of California, County of Orange, Harbor Justice Center/ Newport Beach
Case No.	06HL03260
Recorded	07/22/2008
Document No.	2008-0398439
Amount	\$2,583.00
Debtor	Mark Lyon aka Mark Lyons
Creditor	Arnel Management Company
A Bankruptcy filed by	Marcus Lyons
Social Security Number(s)	Not Shown
Date filed	03/18/2009
Case No.	14997

Legal Description

THE LAND REFERRED TO IN THIS REPORT IS LOCATED IN AND IS DESCRIBED AS FOLLOWS:



P.O. Box 1193
Whittier, CA 90609
Tel # (562) 325-8351
Fax # (714) 783-3038

Order Number: 19266

Reference: CV09-02820 / Tho

LOT 200 OF SAN GORGONIO PASS NO. 3, IN THE COUNTY OF RIVERSIDE, STATE OF CALIFORNIA, AS SHOWN BY MAP ON FILE IN BOOK 33 PAGES 68 AND 69 OF MAPS, RECORDS OF SAID COUNTY.

RECORDING REQUESTED BY
FIDELITY NATIONAL TITLE INSURANCE CO
INLAND EMPIRE DIVISION

DOC # 2004-0069130

01/30/2004 08:00A Fee:10.00
Page 1 of 2 Doc T Tax Paid
Recorded In Official Records
County of Riverside

Gary L. Orso
Assessor, County Clerk & Recorder



RECORDING REQUESTED BY:

Fidelity National Title
Escrow No. 1700014-JS
Title Order No. 33239663

When Recorded Mail Document
and Tax Statement To:

Mr. Mark E. Lyons
16246 Skywood Ct.
Moreno Valley, CA 92551

M	S	U	PAGE	SIZE	DA	PCOR	NOCOR	SMF	MISC.
			2			✓			
									YS
A	R	L				COPY	LONG	REFUND	NCHG

(10)

APN: 517-221-009-9

GRANT DEED

SPACE ABOVE THIS LINE FOR RECORDER'S USE

TRA 055031

33239663

The undersigned grantor(s) declare(s)

Documentary transfer tax is \$77.00

- computed on full value of property conveyed, or
- computed on full value less value of liens or encumbrances remaining at time of sale,
- Unincorporated Area of White Water

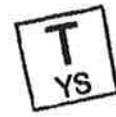

FOR A VALUABLE CONSIDERATION, receipt of which is hereby acknowledged, Signature Alliance Corporation, a California Corporation

hereby GRANT(S) to Mark E. Lyons, a single man

the following described real property in the area of White Water
County of Riverside, State of California:
SEE EXHIBIT ONE ATTACHED HERETO AND MADE A PART HEREOF

DATED: January 13, 2004

STATE OF CALIFORNIA
COUNTY OF Riverside
ON January 30, 2004 before me,
J. L. Holmes personally appeared
Paul Hamilton

Signature Alliance Corporation, a California corporation

By: Paul Hamilton
Paul Hamilton

personally known to me (or proved to me on the basis of satisfactory evidence) to be the person(s) whose name(s) is/are subscribed to the within instrument and acknowledged to me that he/she/they executed the same in his/her/their authorized capacity(ies), and that by (his/her/their signature(s)) on the instrument the person(s), or the entity upon behalf of which the person(s) acted, executed the instrument.



Witness my hand and official seal

Signature J. L. Holmes

MAIL TAX STATEMENTS AS DIRECTED ABOVE

FD-213 (Rev 7/96)

GRANT DEED

Public Record

EXHIBIT "ONE"

Lot 200 of San Gorgonio Pass No. 3, as shown by Map on file in Book 33 Pages 68 and 69 of Maps, Records of Riverside County, California; excepting and reserving to the United States, all oil and gas from said land, as set out in selection List No. 173 of the State of California as approved by the Assistant Secretary of the Interior, September 18, 1929, and excepting and reserving to the State of California, one-sixteenth of all coal and other mineral deposits contained in said land, as set out and referred to in patent from the State of California, recorded April 2, 1931 in Book 21, page 2 of Official Records of Riverside County, California.



ATTORNEY OR PARTY WITHOUT ATTORNEY (Name and Address):

TELEF

Recording requested by and return to:

KATHERINE A Wysocki
197 East 10th St
San Bernardino CA 92410

ATTORNEY FOR JUDGMENT CREDITOR ASSIGNEE OF RECORD

NAME OF COURT: SUPERIOR COURT OF CALIFORNIA
STREET ADDRESS: RIVERSIDE COUNTY
MAILING ADDRESS: BANNING BRANCH
CITY AND ZIP CODE: 155 E. HAYS
BRANCH NAME: BANNING CA, 92220

M	S	U	PAGE	SIZE	DA	PCOR	NOCOR	SMF	MSC
			2						
1					4				DL
A	R	L			COPY	LONG	REFUND	NCHG	EXAM

PLAINTIFF: KATHERINE A Wysocki

DEFENDANT: Marcus Lyons

ABSTRACT OF JUDGMENT

CASE NUMBER:

BAS002770

FOR COURT USE ONLY

C
DL

1. The judgment creditor assignee of record applies for an abstract of judgment and represents the following:

a. Judgment debtor's

Name and last known address

MARCUS LYONS
15934 Cottonwood
Whitewater, CA 92282

NOTIFICATION MAILED
USA POSTAL SERVICE

b. Driver's license No. and state:

c. Social Security No.:

d. Summons or notice of entry of sister-state judgment was personally served or mailed to (name and address):

Unknown
 Unknown

e. Additional judgment debtors are shown on reverse.

Date: 8/1/02

KATHERINE A. Wysocki
(TYPE OF PRINT NAME)

[Signature]
(SIGNATURE OF APPLICANT OR ATTORNEY)

2. a. I certify that the following is a true and correct abstract of the judgment entered in this action.

b. A certified copy of the judgment is attached.

3. Judgment creditor (name): KATHERINE A Wysocki

whose address appears on this form above the court's name.

4. Judgment debtor (full name as it appears in judgment):

MARCUS LYONS

6. Total amount of judgment as entered or last renewed:

\$ 1370.00

7. An execution attachment lien is endorsed on the judgment as follows:

a. Amount: \$

b. In favor of (name and address):



5. a. Judgment entered on

(date): 1/28/02

b. Renewal entered on (date):

c. Renewal entered on (date):

This abstract issued on (date): AUG 6 1 2002

8. A stay of enforcement has

a. not been ordered by the court.

b. been ordered by the court effective until (date):

9. This judgment is an installment judgment.

Clerk, by

[Signature]

Deputy

ABSTRACT OF JUDGMENT (CIVIL)



Code of Civil Procedure, §§ 488.49-49.1, 674, 700.1

PLAINTIFF: DEFENDANT:	CASE NUMBER:
------------------------------	--------------

INFORMATION ON ADDITIONAL JUDGMENT DEBTORS

____ Name and last known address

Driver's license No. & state: Unknown

Social Security No.: Unknown

Summons was personally served at or mailed to (address):

14. ____ Name and last known address

Driver's license No. & state: Unknown

Social Security No.: Unknown

Summons was personally served at or mailed to (address):

____ Name and last known address

Driver's license No. & state: Unknown

Social Security No.: Unknown

Summons was personally served at or mailed to (address):

15. ____ Name and last known address

Driver's license No. & state: Unknown

Social Security No.: Unknown

Summons was personally served at or mailed to (address):

12. ____ Name and last known address

Driver's license No. & state: Unknown

Social Security No.: Unknown

Summons was personally served at or mailed to (address):

16. ____ Name and last known address

Driver's license No. & state: Unknown

Social Security No.: Unknown

Summons was personally served at or mailed to (address):

13. ____ Name and last known address

Driver's license No. & state: Unknown

Social Security No.: Unknown

Summons was personally served at or mailed to (address):

17. ____ Name and last known address

Driver's license No. & state: Unknown

Social Security No.: Unknown

Summons was personally served at or mailed to (address):

18. Continued on attachment 18.



2002-429698
08/05/2002 08:00A
2 of 2

RECORDING REQUESTED BY
O'CONNOR, SCHMELTZER & ROSE

WHEN RECORDED MAIL TO
NAME LEE P. O'CONNOR, ESQ.
O'CONNOR, SCHMELTZER & ROSE
MAILING
ADDRESS 8001 Irvine Center Dr.,
Suite 1550
CITY, STATE Irvine, California
ZIP CODE 92618

DOC # 2002-633892

11/05/2002 08:00A Fee:18.00

Page 1 of 3

Recorded in Official Records
County of Riverside

Gary L. Orso
Assessor, County Clerk & Recorder



M	S	U	PAGE	SIZE	DA	PCOR	NOCOR	SMF	MISC.	
			3							
/					/				LC	
A	R	L				COPY	LONG	REFUND	NCHG	EXAM

(19)

TITLE(S)

M
LC

ABSTRACT OF JUDGMENT

Legal
Solutions
& Plus LS-201

Public Record

EJ-001

ATTORNEY OR PARTY WITHOUT ATTORNEY (Name and Address): TEL NO.:
 Recording requested by and return to: (949) 753-0700
LEE P. O'CONNOR (SBN 90016)
O'CONNOR, SCHMELTZER & ROSE
A Partnership of Professional Corp
8001 Irvine Center Drive, Suite 15
Irvine, California 92618
 ATTORNEY FOR JUDGMENT CREDITOR ASSIGNEE OF RECORD

Recorded in Official Records, County of Orange
Darlene Bloom, Interim Clerk-Recorder

28.00
 20020895113 04:30pm 10/16/02
 117 27 A03 2
 0.00 0.00 0.00 0.00 2.00 20.00 0.00 0.00

NAME OF COURT: SUPERIOR COURT OF CALIFORNIA
 STREET ADDRESS: 700 CIVIC CENTER DR. WEST
 MAILING ADDRESS: P. O. BOX 838
 CITY AND ZIP CODE: SANTA ANA, CALIFORNIA 92702-0838
 BRANCH NAME: CENTRAL JUSTICE CENTER

FOR RECORDER'S USE ONLY

PLAINTIFF: KURT UHLER
 DEFENDANT: SALYON, INC., JOHN LYON, MARK LYON, et al.

ABSTRACT OF JUDGMENT Amended

CASE NUMBER:
01CC10097

1. The judgment creditor assignee of record applies for an abstract of judgment and represents the following:

a. Judgment debtor's

Name and last known address

JOHN LYON
 6 Journey, #160
 Aliso Viejo, CA 92656

NOTIFICATION MAILED
USA POSTAL SERVICE

- b. Driver's license No. and state: Unknown
 c. Social security No.: Unknown
 d. Summons or notice of entry of sister-state judgment was personally served or mailed to (name and address):

JOHN LYON
 6 Journey, #160, Aliso Viejo, CA 92656

- e. Original abstract recorded in this county:
 (1) Date:
 (2) Instrument No.:
 f. Information on additional judgment debtors is shown on page two.

Date: September 23, 2002

LEE P. O'CONNOR

(TYPE OR PRINT NAME)

(SIGNATURE OF APPLICANT OR ATTORNEY)

2. a. I certify that the following is a true and correct abstract of the judgment entered in this action.
 b. A certified copy of the judgment is attached.
 3. Judgment creditor (name and address):
 KURT UHLER
 20555 Pascal Way, Lake Forest, CA 92630
 4. Judgment debtor (full name as it appears in judgment):
 JOHN LYON, MARK LYON
 6 Journey, #160
 Aliso Viejo, CA 92656
 5. a. Judgment entered on (date): 07/29/02
 b. Renewal entered on (date):
 c. Renewal entered on (date):
 6. Total amount of judgment as entered or last renewed:
 \$ 278,718.39
 7. An execution lien attachment lien is endorsed on the judgment as follows:
 a. Amount: \$
 b. In favor of (name and address):



Form Adopted for Mandatory Use
 Judicial Council of California
 EJ-001 [Rev. January 1, 2002]

This abstract issued on (date):
 OCT 0 - 2002

ABSTRACT OF JUDGMENT (CIVIL)

8. A stay of enforcement has
 a. not been ordered by the court.
 b. been ordered by the court effective until (date):
 9. This judgment is an installment judgment.

Clerk, by ALAN SLATER
Tina Martinez, Deputy
TINA MARTINEZ

Legal Solutions & Plus

Page 1 of 2
 Code of Civil Procedure, §§ 488.480, 874, 700.190

Public Record

PLAINTIFF: KURT UHLER	CASE NUMBER:
DEFENDANT: SALYON, INC., JOHN LYON, MARK LYON, et al.	01CC10097

INFORMATION ON ADDITIONAL JUDGMENT DEBTORS

10. Name and last known address

MARK LYON
6 Journey, #160
Aliso Viejo, CA 92656

Driver's license No. & state:

Unknown

Social security No.:

Unknown

Summons was personally served at or mailed to (address):

MARK LYON

6 Journey, #160

Aliso Viejo, CA 92656

11. Name and last known address

Driver's license No. & state:

Unknown

Social security No.:

Unknown

Summons was personally served at or mailed to (address):

14. Name and last known address

NOTIFICATION MAILED
USA POSTAL SERVICE

Driver's license No. & state:

Unknown

Social security No.:

Unknown

Summons was personally served at or mailed to (address):

15. Name and last known address

Driver's license No. & state:

Unknown

Social security No.:

Unknown

Summons was personally served at or mailed to (address):

12. Name and last known address

Driver's license No. & state:

Unknown

Social security No.:

Unknown

Summons was personally served at or mailed to (address):

16. Name and last known address

Driver's license No. & state:

Unknown

Social security No.:

Unknown

Summons was personally served at or mailed to (address):

13. Name and last known address

Driver's license No. & state:

Unknown

Social security No.:

Unknown

Summons was personally served at or mailed to (address):

17. Name and last known address

Driver's license No. & state:

Unknown

Social security No.:

Unknown

Summons was personally served at or mailed to (address):

18. Continued on Attachment 18.



2002-633892
11/05/2002 08:00A
3 of 3

RECORDING REQUESTED BY

GIBBS, GIDEN, LOCHER & TURNER LLP

AND WHEN RECORDED MAIL TO

Tomas A. Kuehn, Esq.
GIBBS, GIDEN, LOCHER & TURNER LLP
2029 Century Park East, 34th Floor
Los Angeles, CA 90067-3039

DOC # 2003-763574

09/30/2003 08:00A Fee:18.00

Page 1 of 3

Recorded in Official Records

County of Riverside

Gary L. Orso

Assessor, County Clerk & Recorder



19

M	S	U	PAGE	SIZE	DA	PCOR	NOCOR	SMP	MISC
			3						
1					1				
A	R	L			COPY	LONG	REFUND	CHG	EKAM

M
TC

ABSTRACT OF JUDGMENT

[TITLE OF DOCUMENT]

THIS PAGE ADDED TO PROVIDE ADEQUATE SPACE FOR RECORDING INFORMATION
(Govt. Code 27361.6)
(Additional recording fee applies)

Public Record

ATTORNEY OR PARTY WITHOUT ATTORNEY (Name and address): TEL NO.:
 Recording requested by and return to: (310) 552-3400
 Tomas A. Kuehn, Esq., CSB #203148
 Christopher E. Ng, Esq., CSB #216969
 GIBBS, GIDEN, LOCHER & TURNER LLC
 2029 Century Park East, 34th Floor
 Los Angeles, CA 90067

ATTORNEY FOR JUDGMENT CREDITOR ASSIGNEE OF RECORD

SUPERIOR COURT OF CALIFORNIA, COUNTY OF RIVERSIDE
 STREET ADDRESS: 4050 Main Street
 MAILING ADDRESS:
 CITY AND ZIP CODE: Riverside, CA
 BRANCH NAME: Riverside Court

FOR RECORDER'S USE ONLY

PLAINTIFF: EXPRESS PIPE & SUPPLY CO., INC., 1235 South Lewis, Anaheim, CA 92805
 DEFENDANT: MARK LYON, an individual

ABSTRACT OF JUDGMENT Amended

CASE NUMBER:
 TEC-054056

FOR COURT USE ONLY

1. The judgment creditor assignee of record applies for an abstract of judgment and represents the following:
 a. Judgment debtor's

Name and last known address
 MARK LYON, an individual
 P.O. Box 1110
 Moorpark, CA 93020

NOTIFICATION MAILED
USA POSTAL SERVICE

- b. Driver's license No. and state: Unknown
 c. Social security No.: Unknown
 d. Summons or notice of entry of sister-state judgment was personally served or mailed to (name and address):

MARK LYON, an individual, 13553 Christian Barret Drive, Moorpark, CA 93021

- e. Original abstract recorded in this county:
 (1) Date:
 (2) Instrument No.:
 f. Information on additional judgment debtors is shown on page two.

Date: August 4, 2003

Christopher E. Ng

(TYPE OR PRINT NAME)

(SIGNATURE OF APPLICANT OR ATTORNEY)

2. a. I certify that the following is a true and correct abstract of the judgment entered in this action.
 b. A certified copy of the judgment is attached.
 3. Judgment creditor (name and address):
 EXPRESS PIPE & SUPPLY CO., INC., 1235 South Lewis, Anaheim, CA 92805
 4. Judgment debtor (full name as it appears in judgment):
 MARK LYON, an individual

6. Total amount of judgment as entered or last renewed:
 \$ 27,136.66
 7. An execution lien attachment lien is endorsed on the judgment as follows:
 a. Amount: \$
 b. In favor of (name and address):



Form Adopted for Mandatory Use
 Judicial Council of California
 EJ-001 [Rev. January 1, 2003]

5. a. Judgment entered on (date): 7-24-03
 b. Renewal entered on (date):

This abstract issued on (date):

SEP 08 2003

8. A stay of enforcement has
 a. not been ordered by the court.
 b. been ordered by the court effective until (date):
 9. This judgment is an installment judgment.

Clerk, by [Signature] Deputy

ABSTRACT OF JUDGMENT
 (CIVIL)

Legal Solutions & Plus

Page 1 of 2
 Code of Civil Procedure, §§ 488.480, 674, 700.190

2003-763574
 89/36/2683 88 .06R
 2 of 3



PLAINTIFF: EXPRESS PIPE & SUPPLY CO., INC., 1235 South Lewis, Anaheim, CA 92805 DEFENDANT: MARK LYON, an individual	CASE NUMBER: TEC-054056
---	----------------------------

INFORMATION ON ADDITIONAL JUDGMENT DEBTORS

<p>10. Name and last known address</p> <p>_____</p> <p>Driver's license No. & state: <input type="checkbox"/> Unknown Social security No.: <input type="checkbox"/> Unknown Summons was personally served at or mailed to (address):</p>	<p>14. Name and last known address</p> <p>_____</p> <p>Driver's license No. & state: <input type="checkbox"/> Unknown Social security No.: <input type="checkbox"/> Unknown Summons was personally served at or mailed to (address):</p>
--	--

<p>11. Name and last known address</p> <p>_____</p> <p>Driver's license No. & state: <input type="checkbox"/> Unknown Social security No.: <input type="checkbox"/> Unknown Summons was personally served at or mailed to (address):</p>	<p>15. Name and last known address</p> <p>_____</p> <p>Driver's license No. & state: <input type="checkbox"/> Unknown Social security No.: <input type="checkbox"/> Unknown Summons was personally served at or mailed to (address):</p>
--	--

<p>12. Name and last known address</p> <p>_____</p> <p>Driver's license No. & state: <input type="checkbox"/> Unknown Social security No.: <input type="checkbox"/> Unknown Summons was personally served at or mailed to (address):</p>	<p>16. Name and last known address</p> <p>_____</p> <p>Driver's license No. & state: <input type="checkbox"/> Unknown Social security No.: <input type="checkbox"/> Unknown Summons was personally served at or mailed to (address):</p>
--	--

<p>13. Name and last known address</p> <p>_____</p> <p>Driver's license No. & state: <input type="checkbox"/> Unknown Social security No.: <input type="checkbox"/> Unknown Summons was personally served at or mailed to (address):</p>	<p>17. Name and last known address</p> <p>_____</p> <p>Driver's license No. & state: <input type="checkbox"/> Unknown Social security No.: <input type="checkbox"/> Unknown Summons was personally served at or mailed to (address):</p>
--	--

18. Continued on Attachment 18.



2003-763574
 09/30/2003 08:00A
 3 of 3

REQUESTED BY AND MAIL TO:

County of Los Angeles
CHILD SUPPORT SERVICES DEPARTMENT
5701 S. EASTERN AVE. STE 201
COMMERCE, CA 90040-2924

INDEX AS JUDGMENT ONLY

SC No: NWD0005973
FSR No: 2U3F957
County Recorder I.D.: 33
No fee per Gov.C. 6103.9 - Fam.C. 4202

DOC # 2004-0753860

09/22/2004 08:00A Fee:NC

Page 1 of 2

Recorded in Official Records
County of Riverside

Gary L. Orso
Assessor, County Clerk & Recorder



M	S	U	PAGE	SIZE	DA	PCOR	NOCOR	SMF	MISC.
			2						
1								✓	T
A	R	L				COPY	LONG	REFUND	NCHG EXAM

ABSTRACT OF SUPPORT JUDGMENT

Title of Document



THIS PAGE ADDED TO PROVIDE ADEQUATE SPACE FOR RECORDING INFORMATION

DA186REV01.00

Public Record

ATTORNEY OR PARTY WITHOUT AND ATTORNEY (Name and Address) <small>(x) Recording requested by and return to:</small> LORI A. CRUZ, Chief Attorney CHILD SUPPORT SERVICES DEPARTMENT 5701 S. EASTERN AVE. STE 201 COMMERCE, CALIFORNIA 90040-2924 <small>Attorney pursuant to Family Code §17400 and §17406</small>	TELEPHONE AND FAX NOS.: (323) 890-9800 (323) 725-0918 018.803.846 2U3F957	FOR RECORDER'S USE ONLY
SUPERIOR COURT OF CALIFORNIA, COUNTY OF LOS ANGELES STREET ADDRESS: 600 S. COMMONWEALTH MAILING ADDRESS: 600 S. COMMONWEALTH CITY AND ZIP CODE: LOS ANGELES, CALIFORNIA 90005 BRANCH NAME: CENTRAL CIVIL WEST		
PETITIONER : JAN MARIE LYON RESPONDENT : MARK EDWARD LYON		
ABSTRACT OF SUPPORT JUDGMENT		CASE NUMBER: NWD0005973

1. The judgment creditor assignee of record applies for an abstract of a support judgment and represents the following:

a. Judgment debtor's

Name and last known address MARK E. LYON 64952 LITTLE COURT DESERT HOT SPRINGS, CA 92240	

b. Driver's License No. and State: S0470230 CA Unknown
 c. Social Security number: 573-80-9111 Unknown
 d. Birthdate: APRIL 18, 1950 Unknown

FOR COURT USE ONLY

Date: 08/05/2004

by LORI A. CRUZ, CHIEF ATTORNEY
(TYPE OR PRINT NAME)

 Chief Attorney

2. I CERTIFY that the judgment entered in this action contains an order for payment of spousal, family, or child support. 3. Judgment creditor (name): County of Los Angeles whose address appears on this form above the court's name. 4. <input checked="" type="checkbox"/> The support is ordered to be paid to the following county officer (name and address): COURT TRUSTEE P.O. BOX 513544 LOS ANGELES, CALIFORNIA 90051-1544	5. Judgment debtor (full name as it appears in judgment): MARK E. LYON 6. a. A judgment was entered on (date): 07/10/1985 b. Renewal was entered on (date): c. Renewal was entered on (date): 7. <input type="checkbox"/> An execution lien is endorsed on the judgment as follows: a. Amount: \$ b. In favor of (name and address): 8. A stay of enforcement has a. <input checked="" type="checkbox"/> not been ordered by the court. b. <input type="checkbox"/> been ordered by the court effective until (date): 9. <input checked="" type="checkbox"/> This is an installment judgment. JOHN A. CLARKE, Executive Officer/ Clerk, by <u>N. Gonzalez</u> , Deputy
--	---



This abstract issued on
AUG 30 2004

Form Added by Reg 1285.80
 Judicial Council of California
 1285.80 (Rev. July 1, 1989)

ABSTRACT OF SUPPORT JUDGMENT
 (Family Law)

CCP 488.480, 674
 697.320, 700.190

DOC # 2008-0398439

07/22/2008 08:00A Fee:20.00

Page 1 of 3

Recorded in Official Records

County of Riverside

Larry W. Ward

Assessor, County Clerk & Recorder



PLEASE COMPLETE THIS INFORMATION
RECORDING REQUESTED BY:

KIMBALL, TIREY & ST. JOHN, LLP

AND WHEN RECORDED MAIL TO:

KIMBALL, TIREY & ST. JOHN, LLP
5510 Trabuco Road
Irvine, CA 92620

S	R	U	PAGE	SIZE	DA	MISC	LONG	RFD	COPY
			3						
M	PA	L	465	426	PCOR	NCOR	SMF	NCHG	EXAM
NOTICE SENT					T:	CTY	UNI	042	

Space above this line for recorder's use only

20

TRA:
DTT:

ABSTRACT OF JUDGMENT

Title of Document

C
042

THIS AREA FOR
RECORDER'S
USE ONLY

THIS PAGE ADDED TO PROVIDE ADEQUATE SPACE FOR RECORDING INFORMATION
(\$3:00 Additional Recording Fee Applies)

ACR 238P-AS4RE0 (Rev. 07/2006)

Public Record

ATTORNEY OR PARTY WITHOUT ATTORNEY (Name, address, State Bar number, and telephone number):

Recording requested by and return to:

Atty. Bar #135698/ Atty. Bar #126739
KIMBALL, TIREY & ST. JOHN, LLP
5510 Trabuco Road
Irvine, CA 92620

(800) 564-6611

ATTORNEY FOR JUDGMENT CREDITOR ASSIGNEE OF RECORD

SUPERIOR COURT OF CALIFORNIA, COUNTY OF ORANGE

STREET ADDRESS: COUNTY OF ORANGE

MAILING ADDRESS: 4601 Jamboree Rd., Suite
CITY AND ZIP CODE: Newport Beach, CA 92660-2595

BRANCH NAME: HARBOR JUSTICE CENTER/NEWPORT BEACH

FOR RECORDER'S USE ONLY

PLAINTIFF: Arnel Management Company

CASE NUMBER:

DEFENDANT: Mark Lyon; Star Lending Network Corporation

06HL03260

ABSTRACT OF JUDGMENT—CIVIL AND SMALL CLAIMS Amended

FOR COURT USE ONLY

1. The judgment creditor assignee of record applies for an abstract of judgment and represents the following:

a. Judgment debtor's

Name and last known address

Mark Lyon aka Mark Lyons
655 Baker St., #AA-105
Costa Mesa, CA 92626

b. Driver's license No. and state:

Unknown

c. Social security No.:

Unknown

d. Summons or notice of entry of sister-state judgment was personally served or mailed to (name and address):

Mark Lyon aka Mark Lyons
655 Baker St., #AA-105, Costa Mesa, CA 92626

2. Information on additional judgment debtors is shown on page 2.

4. Information on additional judgment creditors is shown on page 2.

3. Judgment creditor (name and address):

Arnel Management Company, c/o Kimball, Tirey & St. John, LLP 5510 Trabuco Rd., Irvine, CA 92620

5. Original abstract recorded in this county:

a. Date:

b. Instrument No.:

Date: 11/9/07

HELAINÉ S. ASHTON
Bar #135698

(TYPE OR PRINT NAME)

(SIGNATURE OF APPLICANT OR ATTORNEY)

6. Total amount of judgment as entered or last renewed:
\$ 2,583.00

10. Assignment execution lien attachment lien is endorsed on the judgment as follows:

a. Amount: \$

b. In favor of (name and address):

7. All judgment creditors and debtors are listed on this abstract.

8. a. Judgment entered on (date): 5/2/07

b. Renewal entered on (date):

9. This judgment is an installment judgment.

11. A stay of enforcement has

a. not been ordered by the court.

b. been ordered by the court effective until (date):

12. a. I certify that this is a true and correct abstract of the judgment entered in this action

b. A certified copy of the judgment is attached.

Clerk, by

ALAN SLATER

Deputy

R. CASTILLO



This abstract issued on (date):

JAN 15 2008

PLAINTIFF: Arnel Management Company	CASE NUMBER:
DEFENDANT: Mark Lyon; Star Lending Network Corporation	06HL03260

NAMES AND ADDRESSES OF ADDITIONAL JUDGMENT CREDITORS:

13. Judgment creditor (name and address):

14. Judgment creditor (name and address):

15. Continued on Attachment 15.

INFORMATION ON ADDITIONAL JUDGMENT DEBTORS:

16. Name and last known address
 Star Lending Network Corporation
 655 Baker St., #AA-105
 Costa Mesa, CA 92626

17. Name and last known address

Driver's license No. & state: Unknown
 Social security No.: Unknown

Driver's license No. & state: Unknown
 Social security No.: Unknown

Summons was personally served at or mailed to (address):
 Star Lending Network Corporation
 655 Baker St., #AA-105
 Costa Mesa, CA 92626

Summons was personally served at or mailed to (address):

18. Name and last known address

19. Name and last known address

Driver's license No. & state: Unknown
 Social security No.: Unknown

Driver's license No. & state: Unknown
 Social security No.: Unknown

Summons was personally served at or mailed to (address):

Summons was personally served at or mailed to (address):

20. Name and last known address

21. Name and last known address

Driver's license No. & state: Unknown
 Social security No.: Unknown

Driver's license No. & state: Unknown
 Social security No.: Unknown

Summons was personally served at or mailed to (address):

Summons was personally served at or mailed to (address):

22. Continued on Attachment 22.



John Boyd
DIRECTOR

Code Enforcement Department
County Of Riverside
Moreno Valley District Office
24318 Hemlock Avenue, Suite C-1
Moreno Valley, California 92557
(951) 485-5840 – Fax (951) 485-4938

CASES #: CV0902820 **PROPERTY SITUS:** 13220 JOSUA RD. WHITEWATER CA 92282
A.P.N.: 517-221-009 **DRAWN BY:** Officer Anthony Green **DATE:**
04/27/2009

Provide North Arrow: **N** **FRONT PROPERTY LINE**

W
E
S
T

S
I
D
E

P
R
O
P
E
R
T
Y

L
I
N
E

E
A
S
T

S
I
D
E

P
R
O
P
E
R
T
Y

L
I
N
E

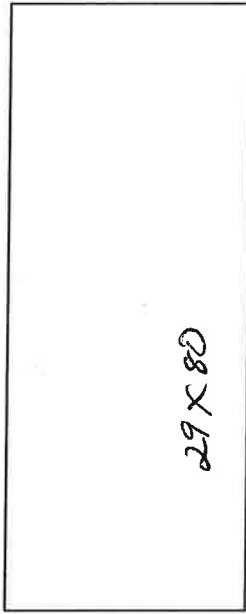

FRONT OF PROPERTY

NOT TO SCALE

REAR PROPERTY LINE

EXHIBIT NO. D

PHOTOGRAPHIC EVIDENCE CASE NO. CV0902820



PHOTO # 1 DATE: 04/27/09 TAKEN BY: A Green#69 NOTES front gate open N.O.D. # 14 , 17



PHOTO # 2 DATE: 04/27/09 TAKEN BY: a. green #69 NOTES: rear gate open

PHOTOGRAPHIC EVIDENCE CASE NO. CV0902820



PHOTO # 3 DATE: 04/27/09 TAKEN BY: A Green#69 NOTES broken windows, bullet holes

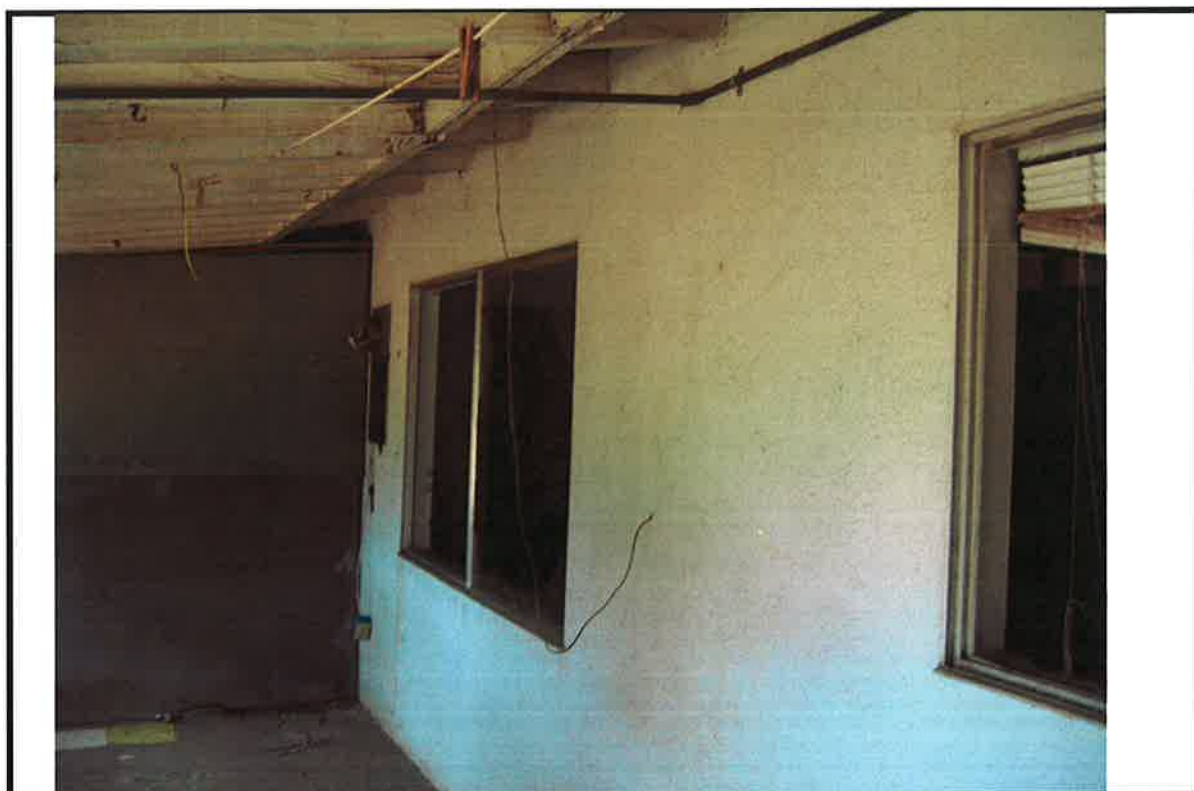

PHOTO # 4 DATE: 04/27/09 TAKEN BY: a. green #69 NOTES: broken windows re of property N.OD. # 13, 14

PHOTOGRAPHIC EVIDENCE CASE NO. CV0902820



PHOTO # 5 DATE: 04/27/09 TAKEN BY: A Green#69 NOTES N.O.D. # 6, 10



PHOTO # 6 DATE: 04/27/09 TAKEN BY: a. green #69 NOTES: #6, 14
WALLS HAVE HOLES.

EXHIBIT NO. D4

PHOTOGRAPHIC EVIDENCE CASE NO. CV0902820



PHOTO # 7 DATE: 04/27/09 TAKEN BY: A Green#69 NOTES #6, 10,



PHOTO # 8 DATE: 04/27/09 TAKEN BY: a. green #69 NOTES: HEATER
MISSING PARTS N.O.D. # 7

PHOTOGRAPHIC EVIDENCE CASE NO. CV0902820



PHOTO # 9 DATE: 04/27/09 TAKEN BY: A Green#69 NOTES PLUMBING PIPES BROKEN N.O.D.# 4



PHOTO # 10 DATE: 04/27/09 TAKEN BY: a. green #69 NOTES: N.O.D. # 6 POWER BOX

EXHIBIT NO. D4

PHOTOGRAPHIC EVIDENCE CASE NO. CV0902820



PHOTO # 11 DATE: 04/27/09 TAKEN BY: A Green#69 NOTES CEILING LIGHTING MISSING. N.O.D.# 5



PHOTO # 12 DATE: 04/27/09 TAKEN BY: a. green #69 NOTES: POSTING N.O.V. N.O.D. DANGER SIGNS.

Code Enforcement Case: CV0902820

Printed on: 09/28/2009

Attachments



IMG_6264.JPG structure is broaded up. - 09/21/2009



IMG_6263.JPG front gate is open no signs posted. Small piles of greenwaste - 09/21/2009

RIVERSIDE COUNTY DEPARTMENT OF BUILDING AND SAFETY CODE ENFORCEMENT NOTICE OF DEFECTS

UNIFORM HOUSING HEALTH & SAFETY
CODE SECTIONS CODE SECTIONS

SUBSTANDARD BUILDING CONDITIONS:

	UNIFORM HOUSING CODE SECTIONS	HEALTH & SAFETY CODE SECTIONS
1. <input checked="" type="checkbox"/> Lack of or improper water closet, lavatory, bathtub, shower or <u>kitchen sink</u>	1001(b)1,2,3	17920.3(a)1,2,3
OBTAIN PERMIT TO: <input checked="" type="checkbox"/> Repair Per Applicable Building Codes <input checked="" type="checkbox"/> Demolish Or Rehabilitate Structure		
2. <input type="checkbox"/> Lack of hot and cold running water to plumbing fixtures	1001(b)4,5	17920.3(a)4,5
OBTAIN PERMIT TO: <input type="checkbox"/> Repair Per Applicable Building Codes <input type="checkbox"/> Demolish Or Rehabilitate Structure		
3. <input type="checkbox"/> Lack of connection to required sewage system.....	1001(b)14	17920.3(a)14
OBTAIN PERMIT TO: <input type="checkbox"/> Repair Per Applicable Building Codes <input type="checkbox"/> Demolish Or Rehabilitate Structure		
4. <input checked="" type="checkbox"/> Hazardous plumbing..... <i>KITCHEN SINK WATER SINK DEFECT</i>	1001(f)	17920.3(e)
OBTAIN PERMIT TO: <input checked="" type="checkbox"/> Repair Per Applicable Building Codes <input checked="" type="checkbox"/> Demolish Or Rehabilitate Structure		
5. <input checked="" type="checkbox"/> Lack of required electrical lighting..... <i>WIRE WORK</i>	1001(b)10	17920.3(a)10
OBTAIN PERMIT TO: <input checked="" type="checkbox"/> Repair Per Applicable Building Codes <input checked="" type="checkbox"/> Demolish Or Rehabilitate Structure		
6. <input checked="" type="checkbox"/> Hazardous Wiring..... <i>THROUGHOUT HOUSE EXPOSED SOCKETS</i>	1001(e)	17920.3(d)
OBTAIN PERMIT TO: <input checked="" type="checkbox"/> Repair Per Applicable Building Codes <input checked="" type="checkbox"/> Demolish Or Rehabilitate Structure		
7. <input checked="" type="checkbox"/> Lack of adequate heating facilities..... <i>UNIT APPEARS DAMAGED</i>	1001(o)6	17920.3(a)6
OBTAIN PERMIT TO: <input checked="" type="checkbox"/> Repair Per Applicable Building Codes <input checked="" type="checkbox"/> Demolish Or Rehabilitate Structure		
8. <input type="checkbox"/> Deteriorated or inadequate foundation.....	1001(c)1	17920.3(b)1
OBTAIN PERMIT TO: <input type="checkbox"/> Repair Per Applicable Building Codes <input type="checkbox"/> Demolish Or Rehabilitate Structure		
9. <input type="checkbox"/> Defective or deteriorated flooring or floor supports.....	1001(c)2	17920.3(b)2
OBTAIN PERMIT TO: <input type="checkbox"/> Repair Per Applicable Building Codes <input type="checkbox"/> Demolish Or Rehabilitate Structure		
10. <input checked="" type="checkbox"/> Members of walls, partitions or other vertical supports that split, lean, list or buckle due to defective material or deterioration..... <i>HOLES IN WALLS</i>	1001(c)4	17920.3(b)4
OBTAIN PERMIT TO: <input checked="" type="checkbox"/> Repair Per Applicable Building Codes <input checked="" type="checkbox"/> Demolish Or Rehabilitate Structure		
11. <input type="checkbox"/> Members of ceilings, roofs, ceiling and roof supports or other horizontal members which sag, split, or buckle due to defective material or deterioration.....	1001(c)6	17920.3(b)6
OBTAIN PERMIT TO: <input type="checkbox"/> Repair Per Applicable Building Codes <input type="checkbox"/> Demolish Or Rehabilitate Structure		
12. <input type="checkbox"/> Dampness of habitable rooms.....	1001(b)11	17920.3(a)11
OBTAIN PERMIT TO: <input type="checkbox"/> Repair Per Applicable Building Codes <input type="checkbox"/> Demolish Or Rehabilitate Structure		
13. <input checked="" type="checkbox"/> Faulty weather protection.....	1001(h)1-4	17920.3(g)1-4
A. Deteriorated or ineffective weather proofing of exterior walls, roof or floors including <u>broken windows</u> or doors, lack of paint or other approved wall covering.		
OBTAIN PERMIT TO: <input checked="" type="checkbox"/> Repair Per Applicable Building Codes <input checked="" type="checkbox"/> Demolish Or Rehabilitate Structure		
14. <input checked="" type="checkbox"/> General dilapidation or improper maintenance.....	1001(b)13	17920.3(a)13
OBTAIN PERMIT TO: <input checked="" type="checkbox"/> Repair Per Applicable Building Codes <input checked="" type="checkbox"/> Demolish Or Rehabilitate Structure		
15. <input type="checkbox"/> Fire hazard.....	1001(i)	17920.3(h)
OBTAIN PERMIT TO: <input type="checkbox"/> Repair Per Applicable Building Codes <input type="checkbox"/> Demolish Or Rehabilitate Structure		
16. <input type="checkbox"/> Extensive fire damage.....		
OBTAIN PERMIT TO: <input type="checkbox"/> Repair Per Applicable Building Codes <input type="checkbox"/> Demolish Or Rehabilitate Structure		
17. <input checked="" type="checkbox"/> Public and attractive nuisance <u>abandoned/vacant</u>		
OBTAIN PERMIT TO: <input checked="" type="checkbox"/> Repair Per Applicable Building Codes <input checked="" type="checkbox"/> Demolish Or Rehabilitate Structure		
18. <input type="checkbox"/> Improper occupancy.....	1001(n)	17920.3(n)
OBTAIN PERMIT TO: <input type="checkbox"/> Repair Per Applicable Building Codes <input type="checkbox"/> Demolish Or Rehabilitate Structure		
19. <input type="checkbox"/>		
OBTAIN PERMIT TO: <input type="checkbox"/> Repair Per Applicable Building Codes <input type="checkbox"/> Demolish Or Rehabilitate Structure		
20. <input type="checkbox"/>		
OBTAIN PERMIT TO: <input type="checkbox"/> Repair Per Applicable Building Codes <input type="checkbox"/> Demolish Or Rehabilitate Structure		

*** YOU MUST CORRECT THE ABOVE CONDITIONS WITHIN 30 DAYS OF THE DATE OF THIS NOTICE

Case No. C10902820 Address 13220 JOSHUA RD. WHITEWATER

Date 04/27/09 Officer A. GREEN



Code Enforcement Department
County Of Riverside
Moreno Valley Office
24318 Hemlock Avenue, Suite C-1
Moreno Valley, California 92557
(951) 485-5840 – Fax (951) 485-4938

John Boyd
DIRECTOR

AFFIDAVIT OF POSTING OF NOTICES

Case No.: CV0902820

I, **ANTHONY GREEN** , hereby declare:

1. I am employed by the Riverside County Code Enforcement Department; that my business address is:

County of Riverside
Code Enforcement Department
13220 JOSHUA RD.
WHITEWATER CA. 92282

2. That on APRIL 27, 2009 at 14:25 P.M., I securely and conspicuously posted **NOTICE OF VIOLATION FOR R.C.C. 15.16.020 SUBSTANDARD STRUCTURE WITH NOTICE OF DEFECTS AND DANGER SIGNS POSTED** at the property described as:

Property Address:13220 JOSHUA RD. WHITEWATER CA. 92282

Assessor's Parcel Number:517-221-009

I declare under the penalty of perjury that the foregoing is true and correct.

Executed on 04/27/2009 at MORENO VALLEY , California.

CODE ENFORCEMENT DEPARTMENT

By: 
ANTHONY GREEN , Code Enforcement Officer



Code Enforcement Department
County Of Riverside
Moreno Valley District Office
24318 Hemlock Avenue, Suite C-1
Moreno Valley, California 92557
(951) 485-5840 – Fax (951) 485-4938

John Boyd
DIRECTOR

June 26, 2009

SEE ATTACHED NOTICE LIST

COPY

NOTICE OF VIOLATION

Re: **Riverside County Abatement Case No.:** CV09-02820
Subject Property: 13220 Joshua Road, Whitewater, CA; APN: 517-221-009

TO ALL OWNERS AND INTERESTED PARTIES OF THE ABOVE DESCRIBED SUBJECT PROPERTY

An inspection was made of the above referenced subject property on in response to complaints received by this office. The structure(s) were found to be substandard and a public nuisance in violation of Riverside County Code Section(s) 15.16, and as such was posted with a "Danger Do Not Enter" sign and a copy of the enclosed "Notice of Defects" which sets forth the conditions which render the building unsafe for human habitation.

THE OWNER OF RECORD of the subject property is hereby noticed and ordered within thirty (30) days of this notice to obtain all necessary permits from the Department of Building and Safety and to correct or abate the unsafe conditions either by repairing all violative conditions indicated in the attached "Notice of Defects," or demolition and removal of the structure(s). **ALL PARTIES WITH INTEREST** in the subject property may comply with the provisions of this notice within fifteen (15) days after the expiration of the thirty (30) period.

NOTICE IS HEREBY GIVEN that failure to comply with this notice will result in further civil, criminal or administrative proceedings for demolition of the structure(s) and abatement of the public nuisance and could result in the imposition of a lien on the subject properties for costs, including attorney's fees, related to the enforcement of all ordinances and abatement of violative conditions. A "Notice of Noncompliance" has been recorded with the Riverside County Recorder's Office. At the conclusion of this case, you will receive a statement of expense associated with the abatement of such nuisance.

PLEASE BE ADVISED that the costs already accrued in this case, including but not limited to, enforcement and investigation costs, are recoverable by the Department, as allowed under Riverside County Ordinance number 725. The Department may seek recovery of such costs from the property owner(s) which may result in a special assessment lien against the property. Additionally, should Code Enforcement abate the property, the costs associated therewith, as well as all abatement costs allowed under Riverside County Ordinance 725, will be sought from the property owner(s) and/or may result in a special assessment lien against the property.

NOTICE IS FURTHER GIVEN that in accordance with Sections 17274 and 24436.5 of the Revenue and Taxation Code, a tax deduction may not be allowed for interest, taxes, depreciation, or amortization paid or incurred in the taxable year affected by these abatement proceedings.

CODE ENFORCEMENT DEPARTMENT

Tom McMullen, Code Enforcement Officer III

Enclosure: Notice of Defects (1)

NOV.20 – Code Enforcement 10.07

EXHIBIT NO. E2

RIVERSIDE COUNTY DEPARTMENT OF BUILDING AND SAFETY CODE ENFORCEMENT NOTICE OF DEFECTS

UNIFORM HOUSING HEALTH & SAFETY
CODE SECTIONS CODE SECTIONS

SUBSTANDARD BUILDING CONDITIONS:

- | | | |
|---|--------------|-----------------|
| 1. <input checked="" type="checkbox"/> Lack of or improper water closet, lavatory, bathtub, shower or <u>Kitchen sink</u> | 1001(b)1,2,3 | 17920.3(a)1,2,3 |
| OBTAIN PERMIT TO: <input checked="" type="checkbox"/> Repair Per Applicable Building Codes <input checked="" type="checkbox"/> Demolish Or Rehabilitate Structure | | |
| 2. <input type="checkbox"/> Lack of hot and cold running water to plumbing fixtures | 1001(b)4,5 | 17920.3(a)4,5 |
| OBTAIN PERMIT TO: <input type="checkbox"/> Repair Per Applicable Building Codes <input type="checkbox"/> Demolish Or Rehabilitate Structure | | |
| 3. <input type="checkbox"/> Lack of connection to required sewage system..... | 1001(b)14 | 17920.3(a)14 |
| OBTAIN PERMIT TO: <input type="checkbox"/> Repair Per Applicable Building Codes <input type="checkbox"/> Demolish Or Rehabilitate Structure | | |
| 4. <input checked="" type="checkbox"/> Hazardous plumbing..... <u>KITCHEN SINK</u> | 1001(f) | 17920.3(e) |
| OBTAIN PERMIT TO: <input checked="" type="checkbox"/> Repair Per Applicable Building Codes <input checked="" type="checkbox"/> Demolish Or Rehabilitate Structure | | |
| 5. <input checked="" type="checkbox"/> Lack of required electrical lighting..... | 1001(b)10 | 17920.3(a)10 |
| OBTAIN PERMIT TO: <input checked="" type="checkbox"/> Repair Per Applicable Building Codes <input checked="" type="checkbox"/> Demolish Or Rehabilitate Structure | | |
| 6. <input checked="" type="checkbox"/> Hazardous Wiring..... <u>THROUGHOUT HOUSE</u> | 1001(e) | 17920.3(d) |
| OBTAIN PERMIT TO: <input checked="" type="checkbox"/> Repair Per Applicable Building Codes <input checked="" type="checkbox"/> Demolish Or Rehabilitate Structure | | |
| 7. <input checked="" type="checkbox"/> Lack of adequate heating facilities..... <u>UNIT APPEARS DAMAGED</u> | 1001(o)6 | 17920.3(a)6 |
| OBTAIN PERMIT TO: <input checked="" type="checkbox"/> Repair Per Applicable Building Codes <input checked="" type="checkbox"/> Demolish Or Rehabilitate Structure | | |
| 8. <input type="checkbox"/> Deteriorated or inadequate foundation..... | 1001(c)1 | 17920.3(b)1 |
| OBTAIN PERMIT TO: <input type="checkbox"/> Repair Per Applicable Building Codes <input type="checkbox"/> Demolish Or Rehabilitate Structure | | |
| 9. <input type="checkbox"/> Defective or deteriorated flooring or floor supports..... | 1001(c)2 | 17920.3(b)2 |
| OBTAIN PERMIT TO: <input type="checkbox"/> Repair Per Applicable Building Codes <input type="checkbox"/> Demolish Or Rehabilitate Structure | | |
| 10. <input checked="" type="checkbox"/> Members of walls, partitions or other vertical supports that split, lean, list or buckle
due to defective material or deterioration..... <u>HOLES IN WALLS</u> | 1001(c)4 | 17920.3(b)4 |
| OBTAIN PERMIT TO: <input checked="" type="checkbox"/> Repair Per Applicable Building Codes <input checked="" type="checkbox"/> Demolish Or Rehabilitate Structure | | |
| 11. <input type="checkbox"/> Members of ceilings, roofs, ceiling and roof supports or other horizontal members
which sag, split, or buckle due to defective material or deterioration..... | 1001(c)6 | 17920.3(b)6 |
| OBTAIN PERMIT TO: <input type="checkbox"/> Repair Per Applicable Building Codes <input type="checkbox"/> Demolish Or Rehabilitate Structure | | |
| 12. <input type="checkbox"/> Dampness of habitable rooms..... | 1001(b)11 | 17920.3(a)11 |
| OBTAIN PERMIT TO: <input type="checkbox"/> Repair Per Applicable Building Codes <input type="checkbox"/> Demolish Or Rehabilitate Structure | | |
| 13. <input checked="" type="checkbox"/> Faulty weather protection..... | 1001(h)1-4 | 17920.3(g)1-4 |
| A. Deteriorated or ineffective weather proofing of exterior walls, roof or floors
including <u>broken windows</u> or doors, lack of paint or other approved wall covering. | | |
| OBTAIN PERMIT TO: <input checked="" type="checkbox"/> Repair Per Applicable Building Codes <input checked="" type="checkbox"/> Demolish Or Rehabilitate Structure | | |
| 14. <input checked="" type="checkbox"/> General dilapidation or improper maintenance..... | 1001(b)13 | 17920.3(a)13 |
| OBTAIN PERMIT TO: <input checked="" type="checkbox"/> Repair Per Applicable Building Codes <input checked="" type="checkbox"/> Demolish Or Rehabilitate Structure | | |
| 15. <input type="checkbox"/> Fire hazard..... | 1001(i) | 17920.3(h) |
| OBTAIN PERMIT TO: <input type="checkbox"/> Repair Per Applicable Building Codes <input type="checkbox"/> Demolish Or Rehabilitate Structure | | |
| 16. <input type="checkbox"/> Extensive fire damage..... | | |
| OBTAIN PERMIT TO: <input type="checkbox"/> Repair Per Applicable Building Codes <input type="checkbox"/> Demolish Or Rehabilitate Structure | | |
| 17. <input checked="" type="checkbox"/> Public and attractive nuisance <u>abandoned/vacant</u> | | |
| OBTAIN PERMIT TO: <input checked="" type="checkbox"/> Repair Per Applicable Building Codes <input checked="" type="checkbox"/> Demolish Or Rehabilitate Structure | | |
| 18. <input type="checkbox"/> Improper occupancy..... | 1001(n) | 17920.3(n) |
| OBTAIN PERMIT TO: <input type="checkbox"/> Repair Per Applicable Building Codes <input type="checkbox"/> Demolish Or Rehabilitate Structure | | |
| 19. <input type="checkbox"/> | | |
| OBTAIN PERMIT TO: <input type="checkbox"/> Repair Per Applicable Building Codes <input type="checkbox"/> Demolish Or Rehabilitate Structure | | |
| 20. <input type="checkbox"/> | | |
| OBTAIN PERMIT TO: <input type="checkbox"/> Repair Per Applicable Building Codes <input type="checkbox"/> Demolish Or Rehabilitate Structure | | |

*** YOU MUST CORRECT THE ABOVE CONDITIONS WITHIN 30 DAYS OF THE DATE OF THIS NOTICE

Case No. C10902820 Address 13220 JOSHUA RD. WATTEWATER

Date 09/27/09 Officer A. GREEN

PROOF OF SERVICE BY MAIL

Case No. CV09-02820

I, Jennifer L. Miller, the undersigned, say I am a citizen of the United States and am employed in the County of Riverside, over the age of 18 years and not a party to the within action or proceeding; that my business address is 24318 Hemlock Avenue, Suite C-1, Moreno Valley, CA 92557.

I am readily familiar with our department's practice for collection and processing of correspondence for mailing with the United States Postal Service. Correspondence is deposited with the United States Postal Service on the same day in the ordinary course of business.

That on the 26th day of June, 2009. I served a copy of the papers to which this proof of service is attached, entitled:

- Notice of Violation (RCC 15.16.020)
- Notice of Defects (1)
- Notice List
- Summary of Costs Notification

by depositing a copy thereof in an envelope for deposit in the United States Postal Service via Certified Mail, return receipt requested, and addressed as follows:

SEE ATTACHED NOTICE LIST

The envelope was sealed and placed for collection and mailing at MORENO VALLEY, CALIFORNIA, on the same date following the ordinary business practices.

I certify under penalty of perjury according to the laws of the State of California that the foregoing is true and correct.

Executed this 26th of June, 2009, at Moreno Valley, California.

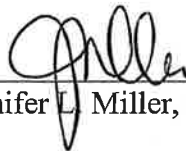

Jennifer L. Miller, Code Enforcement Aide

Article Number: 7003 1680 0005 3927 3060
7003 1680 0005 3927 3077
7003 1680 0005 3927 3084
7003 1680 0005 3927 3091
7003 1680 0005 3927 3107
7003 1680 0005 3927 3114
7003 1680 0005 3927 3121



John Boyd
DIRECTOR

Code Enforcement Department
County Of Riverside
Moreno Valley District Office
24318 Hemlock Avenue, Suite C-1
Moreno Valley, California 92557
(951) 485-5840 – Fax (951) 485-4938

NOTICE LIST / INTERESTED PARTIES

June 26, 2009

RE: Case No.: CV09-02820
APN No.: 517-221-009
Address: 13220 Joshua Road, Whitewater, CA

1. ✓ Mark E. Lyons
13220 Joshua Road
Whitewater, CA 92282
2. ✓ Mark E. Lyons
16246 Skywood Court
Moreno Valley, CA 92551
3. ✓ Katherine A. Wysocki
197 East 10th Street
San Bernardino, CA 92410
4. ✓ Lee P. O'Conner
O'Conner, Schmeltzer & Rose
A Partnership of Professional Corp.
8001 Irvine Center Drive, Suite 15
Irvine, CA 92618
5. ✓ Tomas A. Kuehn, Esq.
Christopher E. Ng, Esq.
Gibbs, Giden, Locher & Turner LLC
2029 Century Park East, 34th Floor
Los Angeles, CA 90067
6. ✓ Lori A. Cruz, Chief Attorney
Child Support Services Department
5701 S. Eastern Avenue, Suite 201
Commerce, CA 90040-2924
7. Kimball, Tirey & St. John, LLP
5510 Trabuco Road
Irvine, CA 92620

U.S. Postal Service™
CERTIFIED MAIL™ RECEIPT
(Domestic Mail Only; No Insurance Coverage Provided)

For delivery information visit our website at www.usps.com

OFFICIAL USE

7003 1680 0005 3927 3077

Postage \$	
Certified Fee	
Return Receipt Fee (Endorsement Required)	
Restricted Delivery Fee (Endorsement Required)	
Postmark Here	

Mark E. Lyons
 16246 Skywood Court
 Moreno Valley, CA 92551
 CV09-02820 / TM

See Reverse for Instructions

COUNTY OF RIVERSIDE
 Cade Enforcement Department
 24318 Hemlock Avenue, Suite C-1
 Moreno Valley, CA 92557

RETURN RECEIPT REQUESTED
 RETURN RECEIPT REQUESTED

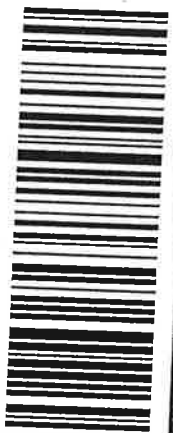

7003 1680 0005 3927 3077

FIRST CLASS

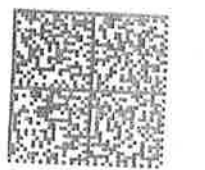

UNITED STATES POSTAGE
 02 TM
 0004277091
 MAILED FROM ZIP CODE 92504
 \$05.540
 JUN 26 2009

Mark E. Lyons
 16246 Skywood Court
 Moreno Valley, CA 92551
 CV09-02820 / TM

REC'D JUL 21 2009

NIXIE 823 SE 1 OS 07/18/09
 RETURN TO SENDER
 UNCLAIMED
 UNABLE TO FORWARD

925577224 0042
 9255707224

BC: 92557722431 *2577-04848-25-09

Handwritten initials and date: M/L 6/27



Home | Help | Sign In

Track & Confirm

FAQs

Track & Confirm

Search Results

Label/Receipt Number: 7003 1680 0005 3927 3084
Status: **Delivered**

Your item was delivered at 10:45 am on July 01, 2009 in MORENO VALLEY, CA 92557. A proof of delivery record may be available through your local Post Office for a fee.

Additional information for this item is stored in files offline.

Track & Confirm

Enter Label/Receipt Number.

Go >

[Restore Offline Details >](#)



[Return to USPS.com Home >](#)

[Site Map](#) [Customer Service](#) [Forms](#) [Gov't Services](#) [Careers](#) [Privacy Policy](#) [Terms of Use](#) [Business Customer Gateway](#)

Copyright© 2009 USPS. All Rights Reserved. No FEAR Act EEO Data FOIA

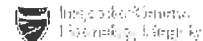
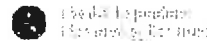

7003 1680 0005 3927 3084

U.S. Postal Service™
CERTIFIED MAIL™ RECEIPT
(Domestic Mail Only; No Insurance Coverage Provided)

For delivery information visit our website at www.usps.com

OFFICIAL USE

Postage	\$
Certified Fee	
Return Receipt Fee (Endorsement Required)	
Restricted Delivery Fee (Endorsement Required)	

Postmark
Here

Katherine A. Wysocki
197 East 10th Street
San Bernardino, CA 92410
CV09-02820 / TM

Form 3800, June 2002

See Reverse for Instructions



Home | Help | Sign In

Track & Confirm

FAQs

Track & Confirm

Search Results

Label/Receipt Number: 7003 1680 0005 3927 3091
Status: **Delivered**

Your item was delivered at 1:23 pm on June 29, 2009 in IRVINE, CA 92618. A proof of delivery record may be available through your local Post Office for a fee.

Additional information for this item is stored in files offline.

[Restore Offline Details >](#)



[Return to USPS.com Home >](#)

Track & Confirm

Enter Label/Receipt Number.

[Go >](#)

[Site Map](#) [Customer Service](#) [Forms](#) [Gov't Services](#) [Careers](#) [Privacy Policy](#) [Terms of Use](#) [Business Customer Gateway](#)

Copyright© 2009 USPS. All Rights Reserved. No FEAR Act EEO Data FOIA

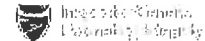
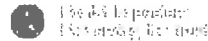

7003 1680 0005 3927 3091

U.S. Postal Service™	
CERTIFIED MAIL™ RECEIPT	
<i>(Domestic Mail Only; No Insurance Coverage Provided)</i>	
For delivery information visit our website at www.usps.com	
OFFICIAL USE	
Postage \$	Postmark Here
Certified Fee	
Return Receipt Fee (Endorsement Required)	
Restricted Delivery Fee (Endorsement Required)	
Lee P. O'Conner O'Conner, Schmeltzer & Rose A Partnership of Professional Corp. 8001 Irvine Center Drive, Suite 15 Irvine, CA 92618 CV09-02820 / TM	
PS Form 3800, June 2002 See Reverse for Instructions	

EXHIBIT NO. EV



Home | Help | Sign In

Track & Confirm **FAQs**

Track & Confirm

Search Results

Label/Receipt Number: **7003 1680 0005 3927 3107**
Status: **Delivered**

Your item was delivered at 10:36 am on July 03, 2009 in MORENO VALLEY, CA 92557. A proof of delivery record may be available through your local Post Office for a fee.

Additional information for this item is stored in files offline.

Track & Confirm

Enter Label/Receipt Number.

Go >

[Restore Offline Details >](#) ?

[Return to USPS.com Home >](#)

[Site Map](#) [Customer Service](#) [Forms](#) [Gov't Services](#) [Careers](#) [Privacy Policy](#) [Terms of Use](#) [Business Customer Gateway](#)

Copyright© 2009 USPS. All Rights Reserved. No FEAR Act EEO Data FOIA

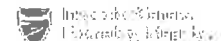
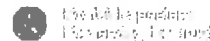

7003 1680 0005 3927 3107

U.S. Postal Service™
CERTIFIED MAIL™ RECEIPT
(Domestic Mail Only; No Insurance Coverage Provided)

For delivery information visit our website at www.usps.com

OFFICIAL USE

Postage	\$	
Certified Fee		
Return Receipt Fee (Endorsement Required)		
Restricted Delivery Fee (Endorsement Required)		

Postmark Here

Tomas A. Kuehn, Esq.
 Christopher E. Ng, Esq.
 Gibbs, Giden, Locher & Turner, LLC
 2029 Century Park East, 34th Floor
 Los Angeles, CA 90067
 CV09-02820 / TM

PST Form 3800, June 2002 See Reverse for Instructions



Home | Help | Sign In

Track & Confirm

FAQs

Track & Confirm

Search Results

Label/Receipt Number: **7003 1680 0005 3927 3114**
Status: **Delivered**

Your item was delivered at 10:46 am on June 29, 2009 in LOS ANGELES, CA 90040. A proof of delivery record may be available through your local Post Office for a fee.

Additional information for this item is stored in files offline.

[Restore Offline Details >](#)



[Return to USPS.com Home >](#)

Track & Confirm

Enter Label/Receipt Number.

[Go >](#)

[Site Map](#) [Customer Service](#) [Forms](#) [Gov't Services](#) [Careers](#) [Privacy Policy](#) [Terms of Use](#) [Business Customer Gateway](#)

Copyright© 2009 USPS. All Rights Reserved. No FEAR Act EEO Data FOIA

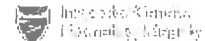
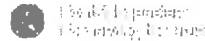

7003 1680 0005 3927 3114

U.S. Postal Service™	
CERTIFIED MAIL™ RECEIPT	
<i>(Domestic Mail Only; No Insurance Coverage Provided)</i>	
For delivery information visit our website at www.usps.com	
OFFICIAL USE	
Postage	\$
Certified Fee	
Return Receipt Fee (Endorsement Required)	
Restricted Delivery Fee (Endorsement Required)	
Postmark Here	
Lori A. Cruz, Chief Attorney Child Support Services Department 5701 S. Eastern Avenue, Suite 201 Commerce, CA 90040-2924 CV09-02820 / TM	
PS Form 3800, June 2002 See Reverse for Instructions	



Home | Help | Sign In

Track & Confirm **FAQs**

Track & Confirm

Search Results

Label/Receipt Number: **7003 1680 0005 3927 3121**
Status: **Delivered**

Your item was delivered at 10:15 am on June 29, 2009 in IRVINE, CA 92620. A proof of delivery record may be available through your local Post Office for a fee.

Additional information for this item is stored in files offline.

[Restore Offline Details >](#)



[Return to USPS.com Home >](#)

Track & Confirm

Enter Label/Receipt Number.

Go >

[Site Map](#) [Customer Service](#) [Forms](#) [Gov't Services](#) [Careers](#) [Privacy Policy](#) [Terms of Use](#) [Business Customer Gateway](#)

Copyright© 2009 USPS. All Rights Reserved. No FEAR Act EEO Data FOIA



U.S. Postal Service
1500 Pennsylvania Avenue, N.W.
Washington, D.C. 20503



Internet Access
1-800-398-7537

7003 1680 0005 3927 3121

U.S. Postal Service™
CERTIFIED MAIL™ RECEIPT
(Domestic Mail Only; No Insurance Coverage Provided)

For delivery information visit our website at www.usps.com

OFFICIAL USE

Postage	\$	
Certified Fee		
Return Receipt Fee (Endorsement Required)		
Restricted Delivery Fee (Endorsement Required)		

Postmark Here

Kimball, Tiry & St. John, LLP
5510 Trabuco Road
Irvine, CA 92620
CV09-02820 / TM

PS Form 3800, June 2002 See Reverse for Instructions

When recorded please mail:
 Riverside County Code Enforcement Department
 (District 5 Office)
 24318 Hemlock Avenue, Suite C-1
 Moreno Valley, CA 92557
 Mail Stop No. 5002

Doc. No. 2009-0325146
 06/23/2009 08:00A Fee:NC
 Page 1 of 1
 Recorded in Official Records
 County of Riverside
 Larry W. Ward
 Assessor, County Clerk & Recorder



S	R	U	PAGE	SIZE	DA	MISC	LONG	RFD	COPY
/			/						
M	A	L	465	426	PCOR	NCOR	SMF	NCHG	EXAM
NCHG CC						T:	CTY	UNI	062

NOTICE OF NONCOMPLIANCE



In the matter of the Property of
 Mark E. Lyons

) Case No. CV09-02820
)

NOTICE IS HEREBY GIVEN to all persons, pursuant to Section 10 of Ordinance Number 725 of the County of Riverside, State of California, that proceedings have been commenced with respect to violations of Riverside County Ordinance No.457, (RCC Title 15.16.020) described as Substandard structure / dwelling (quality lower than prescribed by law). Such Proceedings are based upon the noncompliance of such real property, located at 13220 Joshua Road, White water, CA, and more particularly described as Assessor's Parcel Number 517-221-009 and having a legal description of LOT 200 MB 033/068 SAN GORGONIO PASS 3, Records of Riverside County, with the requirements of Ordinance No. 457 (RCC Title 15.16.020).

The owner has been advised to immediately correct the above-referenced violations to avoid further action by the County of Riverside which may include demolition, removal, razing, etc., to abate the public nuisance. Any costs incurred by the County, including, but not limited to investigative, administrative and abatement costs and attorneys' fees, may become a lien on the property. Further details regarding this notice may be obtained by addressing an inquiry to the Code Enforcement Department, 24318 Hemlock Avenue, Suite C-1, Moreno Valley, California, Attention Code Enforcement Officer Thomas McMullen.

NOTICE IS FURTHER GIVEN in accordance with §17274 and §24436.5 of the California Revenue and Taxation Code, that a tax deduction may not be allowed for interest, taxes, depreciation, or amortization paid or incurred in the taxable year affected by these proceedings.

COUNTY OF RIVERSIDE
 CODE ENFORCEMENT DEPARTMENT

By Mary Overholt
 Mary Overholt
 Code Enforcement Department

ACKNOWLEDGMENT

State of California)
 County of Riverside)

On 06/16/09 before me, Ana E. Carrillo, Notary Public, personally appeared Mary Overholt, who proved to me on the basis of satisfactory evidence to be the person(s) whose name(s) is/are subscribed to the within instrument and acknowledged to me that he/she/they executed the same in his/her/their authorized capacity(ies), and that by his/her/their signature(s) on the instrument the person(s), or the entity upon behalf of which the person(s) acted, executed the instrument.

I certify under PENALTY OF PERJURY under the laws of the State of California that the foregoing paragraph is true and correct.

WITNESS my hand and official seal.
Ana E. Carrillo

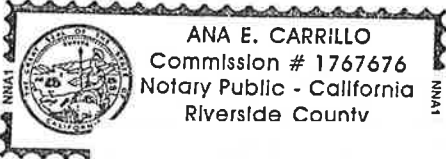

Commission # 1767676 Comm. Expires Sep. 14, 2011

EXHIBIT NO. F

PAMELA J. WALLS
County Counsel

Principal Deputy
KATHERINE A. LIND

OFFICE OF COUNTY COUNSEL
COUNTY OF RIVERSIDE

3535 TENTH STREET, SUITE 300
RIVERSIDE, CA 92501-3674
TELEPHONE: 951/955-6300
FAX: 951/955-6322 & 955-6363



November 24, 2009

NOTICE TO CORRECT COUNTY ORDINANCE VIOLATIONS
AND ABATE PUBLIC NUISANCE

TO: Owners and Interested Parties
(See Attached Proof of Service
and Attached Notice List)

Case No.: CV09-02820
APN: 517-221-009
Property: 13220 Joshua Road, Whitewater

NOTICE IS HEREBY GIVEN that a hearing will be held before the Riverside County Board of Supervisors pursuant to Riverside County Ordinance Nos. 457 (RCC Title 15) and 725 (RCC Title 1) to consider the abatement of the Substandard Structure located on the SUBJECT PROPERTY described as **13220 Joshua Road, Whitewater, Riverside County, California**, and more particularly described as Assessor's Parcel Number 517-221-009.

YOU ARE HEREBY DIRECTED as owner of the SUBJECT PROPERTY, to appear at this hearing to show cause why the SUBJECT PROPERTY should not be condemned as a public nuisance and be abated by removing the Substandard Structure from the real property.

SAID HEARING will be held on **Tuesday, December 22, at 9:30 a.m.** in the Board of Supervisors Room, County Administrative Center, 4080 Lemon Street, 1st Floor Annex, Riverside, California at which time and place pertinent evidence will be received and/or testimony from all concerned parties will be heard. Failure to appear on your behalf will result in the exclusion of your testimony, and facts as known to the Code Enforcement Department ("Department") will be presented to the Board of Supervisors for consideration and deliberation in this matter.

Please be advised that the costs already accrued in this case, including but not limited to, enforcement and investigation costs, are recoverable by the Department, as allowed under Riverside County Ordinance No. 725. The Department may seek recovery of such costs from the property owner(s) which may result in a special assessment lien against the SUBJECT PROPERTY. Additionally, should the Department abate the property, the costs associated therewith, as well as all abatement costs allowed under Riverside County Ordinance No. 725 (RCC Title 1), will be sought from the property owner(s) and/or may result in a special assessment lien against the property.

You are encouraged to contact Supervising Code Enforcement Officer Mary Overholt at (951) 485-5840 or the undersigned prior to the hearing. Please meet the undersigned and Brian Black, Supervising Code Enforcement Officer, at 8:30 a.m. on the day of the hearing in the lobby of the 1st floor annex in front of the Clerk of the Board's Office to discuss the case.

PAMELA J. WALLS
Riverside County Counsel



JULIE A. JARVI
Deputy County Counsel

1 **PROOF OF SERVICE**

2 Case Nos. CV09-02820

3 STATE OF CALIFORNIA, COUNTY OF RIVERSIDE

4 I, Yadira Oseguera, declare that I am a citizen of the United States and am employed in the County of
5 Riverside, over the age of 18 years and not a party to the within action or proceeding; that my
6 business address is 3535 Tenth Street, Suite 300, Riverside, California 92501-3674.

7 That on November 24, 2009 I served the following document(s):

8 **NOTICE TO CORRECT COUNTY ORDINANCE VIOLATIONS
9 AND ABATE PUBLIC NUISANCE**

10 by placing a true copy thereof enclosed in a sealed envelope(s) addressed as follows:

11 **Owners or Interested Parties
12 (see attached notice list)**

13 XX **BY CERTIFIED MAIL, RETURN RECEIPT REQUESTED.** I am "readily familiar"
14 with the office's practice of collection and processing correspondence for mailing. Under that
15 practice it would be deposited with the U.S. Postal Service on that same day with postage
16 thereon fully prepaid at Riverside, California, in the ordinary course of business.

17 **BY PERSONAL SERVICE:** I caused to be delivered such envelope(s) by hand to the offices
18 of the addressee(s).

19 XX **STATE - I declare under penalty of perjury under the laws of the State of California that the
20 above is true and correct.**

21 **FEDERAL - I declare that I am employed in the office of a member of the bar of this court at
22 whose direction the service was made.**

23 EXECUTED ON November 24, 2009 at Riverside, California.

24 
25 _____
26 YADIRA OSEGUERA
27
28

NOTICE LIST

Subject Property: 13220 Joshua Road, Whitewater
Case No.: CV 09-02820; APN: 517-221-009; District 5

MARK E. LYONS
13220 JOSHUA ROAD
WHITEWATER, CA 92282

MARK E. LYONS
16246 SKYWOOD COURT
MORENO VALLEY, CA 92551

OFFICE OF COUNTY COUNSEL,
3960 ORANGE STREET, 5TH FLOOR
RIVERSIDE, CA. 92501

L:\DOCS\6000\0902820\A62479.DOC

MARK E. LYONS
13220 JOSHUA ROAD
WHITEWATER, CA. 92282

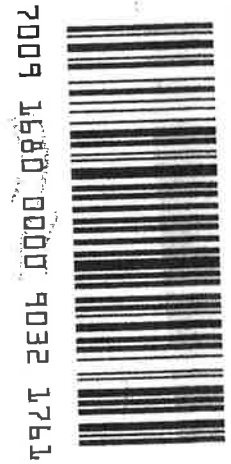

NIXIE 929 SE 1 06 11/29/09 MR
RETURN TO SENDER
ATTEMPTED TO
UNABLE TO FORWARD
BC: 92501364399 *0904-01049-24-44



Home | Help | Sign In

Track & Confirm

FAQs

Track & Confirm

Search Results

Label/Receipt Number: **7009 1680 0000 9032 1754**
Service(s): **Certified Mail™**
Status: **Notice Left**

Track & Confirm

Enter Label/Receipt Number.

Go >

We attempted to deliver your item at 2:31 PM on November 25, 2009 in MORENO VALLEY, CA 92551 and a notice was left. You may pick up the item at the Post Office indicated on the notice, go to www.usps.com/redelivery, or call 800-ASK-USPS to arrange for redelivery. If this item is unclaimed after 30 days then it will be returned to the sender. Information, if available, is updated periodically throughout the day. Please check again later.

Notification Options

Track & Confirm by email

Get current event information or updates for your item sent to you or others by email.

Go >

[Site Map](#) [Customer Service](#) [Forms](#) [Gov't Services](#) [Careers](#) [Privacy Policy](#) [Terms of Use](#) [Business Customer Gateway](#)

Copyright© 2009 USPS. All Rights Reserved.

No FEAR Act EEO Data FOIA



U.S. Postal Service
Customer Service



U.S. Postal Service
Privacy Policy

7009 1680 0000 9032 1754

U.S. Postal Service™
CERTIFIED MAIL™ RECEIPT
(Domestic Mail Only; No Insurance Coverage Provided)

For delivery information visit our website at www.usps.com.

OFFICIAL USE

Postage	\$.44
Certified Fee	2.80
Return Receipt Fee (Endorsement Required)	2.30
Restricted Delivery Fee (Endorsement Required)	5.54

mailed
11/24/09
Postmark
Here

MARK E. LYONS
16242 SKYWOOD COURT
MORENO VALLEY, CA. 92551
CV09-02820 8 *ABT* LYONS (2)

PS Form 3800, August 2006

See Reverse for Instructions



**CODE ENFORCEMENT DEPARTMENT
COUNTY OF RIVERSIDE**

JOHN BOYD
Director

AFFIDAVIT OF POSTING OF NOTICES

November 25, 2009

RE CASE NO: CV0902820

I, ANTHONY GREEN, hereby declare:

I am employed by the Riverside County Code Enforcement Department; that my business address is 24318 Hemlock, Ave., Suite C-1, Moreno Valley, California 92557 .

That on 11/25/2009 at 10:59 A.M., I securely and conspicuously posted NOTICE TO CORRECT COUNTY ORDINANCE VIOLATIONS AND ABATE PUBLIC NUISANCE at the property described as:

Property Address: 13220 JOSHUA RD, WHITEWATER

Assessor's Parcel Number: 517-221-009

I declare under the penalty of perjury that the foregoing is true and correct.

Executed on November 25, 2009 in the County of Riverside, California.

CODE ENFORCEMENT DEPARTMENT

By: ANTHONY GREEN. Code Enforcement Officer

CO OF RIVERSIDE

Fax:951-485-4938

Jan 26 2010 07:56am P002/002



**CODE ENFORCEMENT DEPARTMENT
COUNTY OF RIVERSIDE**

JOHN BOYD
Director

AFFIDAVIT OF POSTING OF NOTICES

January 13, 2010

RE CASE NO: CV0902820

I, ANTHONY GREEN, hereby declare:

I am employed by the Riverside County Code Enforcement Department; that my business address is 24318 Hemlock, Ave., Suite C-1, Moreno Valley, California 92557 .

That on 01/13/2010 at 2:18 P.M., I securely and conspicuously posted NOTICE OF CONTINUATION NOTICE TO CORRECT COUNTY ORDINANCE VIOLATIONS AND ABATE PUBLIC NUISANCE at the property described as:

Property Address: 13220 JOSHUA RD, WHITEWATER

Assessor's Parcel Number: 517-221-009

I declare under the penalty of perjury that the foregoing is true and correct.

Executed on January 13, 2010 in the County of Riverside, California.

CODE ENFORCEMENT DEPARTMENT

By: ANTHONY GREEN Code Enforcement Officer II

BOARD OF SUPERVISORS
PUBLIC HEARING

April 20, 2010
(Continued 9.6 of Jan. 26, 2009)

AGENDA ITEM NO. 9.9

Supplemental Documents

Abatement of Public Nuisance
13220 Joshua Road, Whitewater
Case No. CV 09-02820

DISTRICT 5

2010 APR 20 10 51 51

CLERK OF SUPERVISORS OFFICE

2010-04-1000 75

PAMELA J. WALLS
County Counsel

Principal Deputy
KATHERINE A. LIND

OFFICE OF COUNTY COUNSEL
COUNTY OF RIVERSIDE

3960 ORANGE STREET, 5TH FLOOR
RIVERSIDE, CA 92501
TELEPHONE: 951/955-6300
FAX: 951/955-6322 & 955-6363



February 2, 2010

CONTINUATION
NOTICE TO CORRECT COUNTY ORDINANCE VIOLATIONS
AND ABATE PUBLIC NUISANCE

TO: Owners and Interested Parties
(See Attached Notice List)

Case No.: CV09-02820
APN: 517-221-009
Property: 13220 Joshua Road, Whitewater

NOTICE IS HEREBY GIVEN that a hearing will be held before the Riverside County Board of Supervisors pursuant to Riverside County Ordinance Nos. 457 (RCC Title 15) and 725 (RCC Title 1) to consider the abatement of the Substandard Structure located on the SUBJECT PROPERTY described as **13220 Joshua Road, Whitewater, Riverside County, California**, and more particularly described as Assessor's Parcel Number 517-221-009.

YOU ARE HEREBY DIRECTED as owner of the SUBJECT PROPERTY, to appear at this hearing to show cause why the SUBJECT PROPERTY should not be condemned as a public nuisance and be abated by removing the Substandard Structure from the real property.

SAID HEARING that was held on Tuesday, January 26, 2010, at 9:30 a.m. in the Board of Supervisors Room, 4080 Lemon Street, 1st Floor Annex, Riverside, California **has been rescheduled to Tuesday, April 20, 2010 at 9:30 a.m.** at which time and place pertinent evidence will be received and/or testimony from all concerned parties will be heard. Failure to appear on your behalf will result in the exclusion of your testimony, and facts as known to this department, will be presented to the Board of Supervisors, for consideration and deliberation in this matter.

Be on notice that in addition to costs that have already accrued for this case, costs associated therewith will be sought from the property owner(s) and/or may result in a special assessment lien against the property.

You are encouraged to contact the Supervising Code Enforcement Officer Mary Overholt at (951) 485-5840 or the undersigned prior to the hearing. Please meet the undersigned or Brian Black, Supervising Code Enforcement Officer, at 8:30 a.m. on the day of the hearing in the lobby of the 1st floor annex in front of the Clerk of the Board's Office to discuss the case.

PAMELA J. WALLS
Riverside County Counsel

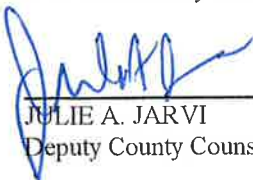

JULIE A. JARVI
Deputy County Counsel

NOTICE LIST

Subject Property: 13220 Joshua Road, Whitewater
 Case No.: CV 09-02820; APN: 517-221-009; District 5

OFFICE OF COUNTY COUNSEL
 RIVERSIDE COUNTY
 3960 ORANGE STREET 5TH FLOOR
 RIVERSIDE CA. 92501

MARK E. LYONS
 13220 JOSHUA ROAD
 WHITEWATER, CA 92282

MARK E. LYONS
 16246 SKYWOOD COURT
 MORENO VALLEY, CA 92551

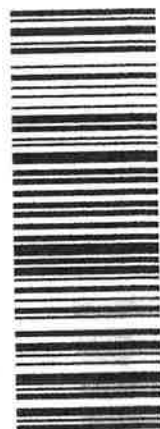

7009 1680 0000 9024 7122



UNITED STATES POSTAGE
 PITNEY BOWES
 02 1P
 0003958246 FEB 02 2010
 MAILED FROM ZIP CODE 92501
\$ 005.540

MARK E LYONS
 LYONS
 13220 JOSHUA ROAD
 WHITEWATER, CA. 92282

RTF

528233123 HQ01

NIXIE 923 SE 1 06 02/09/10
 RETURN TO SENDER
 NOT DELIVERABLE AS ADDRESSED
 UNABLE TO FORWARD



BC: 92501364405 *0804-02808-02-45

SENDER: COMPLETE THIS SECTION

- Complete items 1, 2, and 3. Also complete item 4 if Restricted Delivery is desired.
- Print your name and address on the reverse so that we can return the card to you.
- Attach this card to the back of the mailpiece, or on the front if space permits.

1. Article Addressed to:

MARK E. LYONS
 16246 SKYWOOD COURT
 MORENO VALLEY, CA 92551
 CV09-02820 * ABT* 2 LYONS

COMPLETE THIS SECTION ON DELIVERY

- A. Signature Agent
- B. Received by (Printed Name) Addressee
MARK LYONS 2-22-10
- C. Date of Delivery Yes No
- D. Is delivery address different from item 1? Yes No
 If YES, enter delivery address below:

3. Service Type

- Certified Mail Express Mail
- Registered Return Receipt for Merchandise
- Insured Mail C.O.D.

4. Restricted Delivery? (Extra Fee) Yes No

2. Article Number

(Transfer from service label)

7009 1680 0000 9024 7125

PS Form 3811, February 2004

Domestic Return Receipt

102885-02-00-10410

1 **PROOF OF SERVICE**

2 Case Nos. CV09-02820

3 STATE OF CALIFORNIA, COUNTY OF RIVERSIDE

4 I, Yadira Oseguera, declare that I am a citizen of the United States and am employed in the County of
5 Riverside, over the age of 18 years and not a party to the within action or proceeding; that my
6 business address is 3960 Orange Street, 5th Floor, Riverside, California 92501.

7 That on February 2, 2010 I served the following document(s):

8 **CONTINUED**
9 **NOTICE TO CORRECT COUNTY ORDINANCE VIOLATIONS**
10 **AND ABATE PUBLIC NUISANCE**

11 by placing a true copy thereof enclosed in a sealed envelope(s) addressed as follows:

12 **Owners or Interested Parties**
13 **(see attached notice list)**

14 XX **BY CERTIFIED MAIL, RETURN RECEIPT REQUESTED.** I am "readily familiar"
15 with the office's practice of collection and processing correspondence for mailing. Under that
16 practice it would be deposited with the U.S. Postal Service on that same day with postage
17 thereon fully prepaid at Riverside, California, in the ordinary course of business.

18 **BY PERSONAL SERVICE:** I caused to be delivered such envelope(s) by hand to the offices
19 of the addressee(s).

20 XX **STATE - I declare under penalty of perjury under the laws of the State of California that the**
21 **above is true and correct.**

22 **FEDERAL - I declare that I am employed in the office of a member of the bar of this court at**
23 **whose direction the service was made.**

24 EXECUTED ON February 2, 2010 at Riverside, California.

25 
26 YADIRA OSEGUERA
27
28



**CODE ENFORCEMENT DEPARTMENT
COUNTY OF RIVERSIDE**

JOHN BOYD
Director

AFFIDAVIT OF POSTING OF NOTICES

February 4, 2010

RE CASE NO: CV0902820

I, ANTHONY GREEN, hereby declare:

I am employed by the Riverside County Code Enforcement Department; that my business address is 24318 Hemlock, Ave., Suite C-1, Moreno Valley, California 92557 .

That on 02/03/2010 at 1315 hrs., I securely and conspicuously posted Continuation Notice to Correct and Abate Public Nuisance at the property described as:

Property Address: 13220 JOSHUA RD, WHITEWATER

Assessor's Parcel Number: 517-221-009

I declare under the penalty of perjury that the foregoing is true and correct.

Executed on February 4, 2010 in the County of Riverside, California.

CODE ENFORCEMENT DEPARTMENT

By: ANTHONY GREEN . Code Enforcement Officer II

BOARD OF SUPERVISORS
PUBLIC HEARING

January 26, 2010
(Continued 9.4 of 12/22/09)

AGENDA ITEM NO. 9.6

Supplemental Documents

Abatement of Public Nuisance
13220 Joshua Road, Whitewater
Case No. CV09-02820

DISTRICT 5

3010 7/11/10

PAMELA J. WALLS
County Counsel

Principal Deputy
KATHERINE A. LIND

OFFICE OF COUNTY COUNSEL
COUNTY OF RIVERSIDE

3960 ORANGE STREET, 5TH FLOOR
RIVERSIDE, CA 92501
TELEPHONE: 951/955-6300
FAX: 951/955-6322 & 955-6363



December 28, 2009

CONTINUATION
NOTICE TO CORRECT COUNTY ORDINANCE VIOLATIONS
AND ABATE PUBLIC NUISANCE

TO: Owners and Interested Parties
(See Attached Notice List)

Case No.: CV09-02820
APN: 517-221-009
Property: 13220 Joshua Road, Whitewater

NOTICE IS HEREBY GIVEN that a hearing will be held before the Riverside County Board of Supervisors pursuant to Riverside County Ordinance Nos. 457 (RCC Title 15) and 725 (RCC Title 1) to consider the abatement of the Substandard Structure located on the SUBJECT PROPERTY described as **13220 Joshua Road, Whitewater, Riverside County, California**, and more particularly described as Assessor's Parcel Number 517-221-009.

YOU ARE HEREBY DIRECTED as owner of the SUBJECT PROPERTY, to appear at this hearing to show cause why the SUBJECT PROPERTY should not be condemned as a public nuisance and be abated by removing the Substandard Structure from the real property.

SAID HEARING that was held on Tuesday, December 22, 2009, 2009, at 9:30 a.m. in the Board of Supervisors Room, 4080 Lemon Street, 1st Floor Annex, Riverside, California **has been rescheduled to Tuesday, January 26, 2010 at 9:30 a.m.** at which time and place pertinent evidence will be received and/or testimony from all concerned parties will be heard. Failure to appear on your behalf will result in the exclusion of your testimony, and facts as known to this department, will be presented to the Board of Supervisors, for consideration and deliberation in this matter.

Be on notice that in addition to costs that have already accrued for this case, costs associated therewith will be sought from the property owner(s) and/or may result in a special assessment lien against the property.

You are encouraged to contact the Supervising Code Enforcement Officer Mary Overholt at (951) 485-5840 or the undersigned prior to the hearing. Please meet the undersigned or Brian Black, Supervising Code Enforcement Officer, at 8:30 a.m. on the day of the hearing in the lobby of the 1st floor annex in front of the Clerk of the Board's Office to discuss the case.

PAMELA J. WALLS
Riverside County Counsel



JULIE A. JARVI
Deputy County Counsel

1 **PROOF OF SERVICE**

2 Case Nos. CV09-02820

3 STATE OF CALIFORNIA, COUNTY OF RIVERSIDE

4 I, Yadira Oseguera, declare that I am a citizen of the United States and am employed in the County of
5 Riverside, over the age of 18 years and not a party to the within action or proceeding; that my
6 business address is 3960 Orange Street, 5th Floor, Riverside, California 92501.

7 That on December 28, 2009 I served the following document(s):

8 **CONTINUED**
9 **NOTICE TO CORRECT COUNTY ORDINANCE VIOLATIONS**
10 **AND ABATE PUBLIC NUISANCE**

11 by placing a true copy thereof enclosed in a sealed envelope(s) addressed as follows:

12 **Owners or Interested Parties**
13 **(see attached notice list)**

14 XX **BY CERTIFIED MAIL, RETURN RECEIPT REQUESTED.** I am "readily familiar"
15 with the office's practice of collection and processing correspondence for mailing. Under that
16 practice it would be deposited with the U.S. Postal Service on that same day with postage
17 thereon fully prepaid at Riverside, California, in the ordinary course of business.

18 **BY PERSONAL SERVICE:** I caused to be delivered such envelope(s) by hand to the offices
19 of the addressee(s).

20 XX **STATE - I declare under penalty of perjury under the laws of the State of California that the**
21 **above is true and correct.**

22 **FEDERAL - I declare that I am employed in the office of a member of the bar of this court at**
23 **whose direction the service was made.**

24 EXECUTED ON December 28, 2009 at Riverside, California.

25 
26 YADIRA OSEGUERA
27
28

NOTICE LIST

Subject Property: 13220 Joshua Road, Whitewater
 Case No.: CV 09-02820; APN: 517-221-009; District 5

OFFICE OF COUNTY COUNSEL
RIVERSIDE COUNTY
3960 ORANGE STREET 5TH FLOOR
RIVERSIDE CA. 92501

MARK E. LYONS
 13220 JOSHUA ROAD
 WHITEWATER, CA 92282

MARK E. LYONS
 16246 SKYWOOD COURT
 MORENO VALLEY, CA 92551

CERTIFIED MAIL



7009 1680 0000 9025 4625

UNITED STATES POSTAGE
 PITNEY BOWES
 02 1P
 0003958246 DEC 28 2009
 MAILED FROM ZIP CODE 92501
\$ 005.540

PFS

MARK E. LYONS
 13220 JOSHUA ROAD
 WHITEWATER, CA. 92282

NIXIE 929 SE 1 00 01/04/10

RETURN TO SENDER
 NOT DELIVERABLE AS ADDRESSED
 UNABLE TO FORWARD

BC: 92501964405 *2404-18815-28-41

SENDER: COMPLETE THIS SECTION

- Complete items 1, 2, and 3. Also complete item 4 if Restricted Delivery is desired.
- Print your name and address on the reverse so that we can return the card to you.
- Attach this card to the back of the mailpiece, or on the front if space permits.

1. Article Addressed to:

MARK E. LYONS
 16246 SKYWOOD COURT
 MORENO VALLEY, CA. 92551
 CV09-02820 * ABT* 2 LYONS

COMPLETE THIS SECTION ON DELIVERY

A. Signature <i>Mark E. Lyons</i>	<input type="checkbox"/> Agent <input type="checkbox"/> Addressee
B. Received by (Printed Name) <i>Mark E. Lyons</i>	C. Date of Delivery
D. Is delivery address different from item 1? If YES, enter delivery address below: <input type="checkbox"/> Yes <input type="checkbox"/> No	

3. Service Type

<input checked="" type="checkbox"/> Certified Mail	<input type="checkbox"/> Express Mail
<input type="checkbox"/> Registered	<input type="checkbox"/> Return Receipt for Merchandise
<input type="checkbox"/> Insured Mail	<input type="checkbox"/> C.O.D.

4. Restricted Delivery? (Extra Fee) Yes

2. Article Number
 (Transfer from service label) 7009 1680 0000 9025 4625
 PS Form 3811, February 2004 Domestic Return Receipt 102595-02-M-1640

Riverside County Board of Supervisors
Request to Speak

Submit request to Clerk of Board (right of podium),
Speakers are entitled to three (3) minutes, subject
Board Rules listed on the reverse side of this form.

SPEAKER'S NAME: MARK LYONS

Address: 16246 Skyward Ct
(only if follow-up mail response requested)

City: Woburn MA Zip: 02591

Phone #: 951-488-0865

Date: 12-22-09 Agenda # 9.4

PLEASE STATE YOUR POSITION BELOW:

Position on "Regular" (non-appealed) Agenda Item:
Support Oppose Neutral

Note: If you are here for an agenda item that is filed
for "Appeal", please state separately your position on
the appeal below:

Support Oppose Neutral

I give my 3 minutes to: _____

Riverside County Board of Supervisors
Request to Speak

Submit request to Clerk of Board (right of podium),
Speakers are entitled to three (3) minutes, subject
Board Rules listed on the reverse side of this form.

SPEAKER'S NAME: MARK LYONS

Address: _____
(only if follow-up mail response requested)

City: _____ Zip: _____

Phone #: _____

Date: 4-20-10 Agenda # 9.9

PLEASE STATE YOUR POSITION BELOW:

Position on "Regular" (non-appealed) Agenda Item:
Support Oppose Neutral

Note: If you are here for an agenda item that is filed
for "Appeal", please state separately your position on
the appeal below:

Support Oppose Neutral

I give my 3 minutes to: _____

**Riverside County Board of Supervisors
Request to Speak**

Submit request to Clerk of Board (right of podium),
Speakers are entitled to three (3) minutes, subject
Board Rules listed on the reverse side of this form.

SPEAKER'S NAME: MARK LYONS

Address: 16246 Skywood Ct.
(only if follow-up mail response requested)

City: Marina Valley **Zip:** 92551

Phone #: 951-488-0965

Date: 1-26-10 **Agenda #** 9.6

PLEASE STATE YOUR POSITION BELOW:

Position on "Regular" (non-appealed) Agenda Item:

Support **Oppose** **Neutral**

Note: If you are here for an agenda item that is filed
for "Appeal", please state separately your position on
the appeal below:

Support **Oppose** **Neutral**

I give my 3 minutes to: myself