

**SUBMITTAL TO THE BOARD OF SUPERVISORS
COUNTY OF RIVERSIDE, STATE OF CALIFORNIA**



665 A

FROM: TLMA - Transportation Department

SUBMITTAL DATE:
April 22, 2010

SUBJECT: Notice of Completion - Construction of Traffic Signal and Lighting, at Limonite Avenue and Lucretia Avenue, Mira Loma area.

RECOMMENDED MOTION: That the Board execute and file the attached "Notice of Completion".

BACKGROUND: By Minute Order 3.48 of October 27, 2009, the Board entered into an agreement with DBX, Inc. of Temecula, CA for the construction of traffic signal and lighting, signing and striping at intersection of Limonite Avenue and Lucretia Avenue, in the Mira Loma area. The authorized amount of the contract was \$358,393. The total amended contract amount is \$386,269 which is 7.8% more than the originally authorized amount.

The cost increase was due to a minor quantity adjustment for asphalt concrete.

Juan C. Perez
Director of Transportation

dj
(Continued On Attached Page)

FINANCIAL DATA	Current F.Y. Total Cost:	\$386,269	In Current Year Budget:	Yes
	Current F.Y. Net County Cost:	\$ 0	Budget Adjustment:	No
	Annual Net County Cost:	\$ 0	For Fiscal Year:	2009/2010
SOURCE OF FUNDS: Measure A / Western (99%), Jurupa Community Service District (JCSD) (1%)				Positions To Be Deleted Per A-30 <input type="checkbox"/>
				Requires 4/5 Vote <input type="checkbox"/>

C.E.O. RECOMMENDATION:

APPROVE

BY:
Tina Grande

County Executive Office Signature

MINUTES OF THE BOARD OF SUPERVISORS

On motion of Supervisor Benoit, seconded by Supervisor Tavaglione and duly carried by unanimous vote, IT WAS ORDERED that the above matter is approved as recommended.

Ayes: Buster, Tavaglione, Stone, Benoit and Ashley
Nays: None
Absent: None
Date: May 4, 2010
xc: Transp, Recorder

Kecia Harper-Ihem
Clerk of the Board

By:
Deputy

Prev. Agn. Ref. 10/27/09, Item 3.48 | District: 2 | Agenda Number:

3.80

ATTACHMENTS FILED
WITH THE CLERK OF THE BOARD

Departmental Continuance

Policy
 Policy
 Consent
 Consent
 Dep't Recomm.:
 Per Exec. Ofc.:

The Honorable Board of Supervisors

RE: Notice of Completion - Construction of Traffic Signal and Lighting, at Limonite Avenue and Lucretia Avenue, Mira Loma area.

April 22, 2010

Page 2 of 2

All work, including the minor quantity adjustment, was completed in conformance with the plans and specifications on December 2, 2009. The work was inspected by the Construction Engineering Section of the Transportation Department. Work Order B6-0563.

Budget

Original Contract Amount		\$358,393.00
Tot. Chg Orders Authorized -	0.0%	\$0.00
Est. Pending Change Orders	0.0%	\$0.00
Amended Contract Amount		\$358,393.00
* Quantity Adjustments	7.8%	\$27,875.93
+ CCO FA Adjustments	0.0%	\$0.00
Total Amended Contract Amount	107.8%	\$386,268.93

Expenditures

Total Progress Payments -	\$386,268.93
Estimated Pending Payments	
Total Expenditures	\$386,268.93

(Over)\Under Contract Amount \$0.00

+ Change Orders using the Force Account method of payment issued prior to the work being completed generally do not use the total authorized amount.

* *CAL-Trans Standard Specifications 4-1.03B*. Increases or decreases in the quantity of a contract item of work will be determined by comparing the total pay quantity of such item of work with the Engineer's Estimate. If the total pay quantity of any item of work required under the contract varies from the Engineers Estimate by 25 percent or less, payment will be made for the quantity of work of said item performed at contract unit price, unless eligible for adjustment pursuant to Section 4-1.03C, "Changes in Character of Work."

PLEASE COMPLETE THIS INFORMATION
RECORDING REQUESTED BY:

KECIA HARPER-IHEM, CLERK OF THE BOARD
RIVERSIDE CO. CLERK OF THE BOARD
4080 LEMON STREET, 1ST FLOOR CAC
P O BOX 1147 - RIVERSIDE, CA 92502
MAIL STOP # 1010

DOC # 2010-0217335
05/11/2010

Customer Copy Label
The paper to which this label is
affixed has not been compared
with the recorded document

Larry W Ward
County of Riverside
Assessor, County Clerk & Recorder

AND WHEN RECORDED MAIL TO:

RETURN TO: STOP #1010
RIVERSIDE COUNTY CLERK OF THE BOARD
P. O. BOX 1147 - RIVERSIDE, CA 92502

THIS SPACE FOR RECORDERS USE ONLY

NOTICE OF COMPLETION

To be recorded with County Recorder
within 10 days after completion.
No recording fee.

Notice is hereby given by the undersigned owner, a public entity of the State of California, that a public work of improvement has been completed, as follows:

Project title or description of work: Construction of traffic signal and lighting, signing and striping

Date of Completion: Date of this notice 5/4/2010

Nature of owner: County of Riverside, public entity

Interest or estate of owner: Public Roadway

Address of owner: 4080 Lemon Street, 8th Floor, Riverside, CA 92501

Name of contractor: DBX, Inc.

Street or legal description of site: Limonite Avenue and Lucretia Avenue

Dated: May 4, 2010

Owner: County of Riverside
(Name of Public Entity)

By: Marion Ashley
Marion Ashley, Chairman, Board of Supervisors

STATE OF CALIFORNIA)

ss

COUNTY OF RIVERSIDE)

I am the Chairman of the governing board of the County of Riverside, the public entity which executed the foregoing notice and on whose behalf I make this verification; I have read this notice, know its contents, and the same is true. I certify under penalty of perjury that the foregoing is true and correct.

Executed at Riverside, California on 5/4/2010 (Date)

Marion Ashley, Chairman of the Board of Supervisors

ATTEST:
KECIA HARPER-IHEM, Clerk of the Board

by: Karim Sultan
Deputy

COPY

PROJECT: Limonte Ave. & Lucretia Ave. T/S and Lighting Project
 County Project No.: BB-0563
 Contract No.: 09-09-005

Contractor: DBX, Inc.
 Address: 42066 Avenida Alvarado
 City, State, Zip: Temecula, CA 92590

Estimate No. 3 Final
 From: December 25, 2009
 To: February 25, 2010



Item No.	Item Description	Units	Quantity	Unit Price	Original Contract		Change Authorized		Total Authorized		This Estimate		Previous		Total Estimate To Date		% Auth.
					Quantity	Amount	Quantity	Amount	Quantity	Amount	Quantity	Amount	Quantity	Amount	Quantity	Amount	
PROJECT TOTAL						358,393.00	0.00	358,393.00	45,190.00	386,288.93							

Made by: Ivan Mendoza
 Checked by: _____
 OK Const. Supv. _____

Working Days: 11-9-09
 Days Added: 12-2-09
 Subtotal: 108%
 Days Used: \$358,393.00
 % Time Elapsed: 86% Amended Contract: \$358,393.00

Start Date: 11-9-09
 End Date: 12-2-09
 % \$ Complete: 108%
 Original Contract: \$358,393.00
 Amended Contract: \$358,393.00

TOTAL VALUE OF WORK TO DATE: \$386,288.93
 LESS RETENTION: 10% 38,628.89
 TOTAL DUE TO DATE: \$347,642.04
 LESS PREVIOUSLY INVOICED: 306,971.04
 LESS LABOR NON COMPLIANCE: 0.00
 TOTAL DUE THIS PAYMENT: \$40,671.00

This Estimate Approved _____ Date: _____ for: \$40,671.00
 Received by Accounts Payable: _____ By: _____

Juan C. Perez
 Juan C. Perez, Director of Transportation
 DBX, Inc.

Quantities on This Estimate Approved _____ Date: 3/8/10

PAYMENT APPROVAL

Fund 20000
 Dept ID 3130500000

Account 527980

Project Z 06-0563E

Activity ID Z3500

Resource Type CNT

Signature [Signature]

Date 3/10/10



Contractor: DBX, Inc.
 Address: 42066 Avenida Alvarado
 City, State, Zip: Temecula, CA 92590

Estimate No. 3 Final
 From: December 25, 2009
 To: February 25, 2010

Item No.	Item Description	Units	Quantity	Unit Price	Original Contract Amount	Change Authorized		Total Authorized		This Estimate		Previous Quantity	Total Estimate To Date		% Auth.
						Quantity	Amount	Quantity	Amount	Quantity	Amount		Quantity	Amount	
1	MINOR CONCRETE (CURB RAMP) (CRS 403 -CASE A)	EA	2	4,670.00	9,340.00			2.00	9,340.00	2.00	2.00	2.00	9,340.00	100%	
2	MINOR CONCRETE (CURB RAMP) (403 - CASE B)	EA	1	2,660.00	2,660.00			1.00	2,660.00	1.00	1.00	1.00	2,660.00	100%	
3	DUST ABATEMENT	LS	1	800.00	800.00			1.00	800.00	1.00	1.00	1.00	800.00	100%	
4	RELOCATE SIGN	EA	1	200.00	200.00			1.00	200.00	1.00	1.00	1.00	200.00	100%	
5	WATER POLLUTION CONTROL	LS	1	1,500.00	1,500.00			1.00	1,500.00	1.00	1.00	1.00	1,500.00	100%	
6	TRAFFIC CONTROL SYSTEM	LS	1	4,200.00	4,200.00			1.00	4,200.00	1.00	1.00	1.00	4,200.00	100%	
7	REMOVE TRAFFIC STRIPE AND PAVEMENT MARKING	SOFT	7,900	0.70	5,530.00			7,900.00	5,530.00	509.00	356.30	6,000.00	4,556.30	82%	
8	SALVAGE ROADSIDE SIGN	EA	6	40.00	240.00			6.00	240.00	6.00	6.00	6.00	240.00	100%	
9	COLD PLANE ASPHALT CONCRETE PAVEMENT	SOYD	580	13.00	7,540.00			580.00	7,540.00	625.10	625.10	625.10	8,126.30	108%	
10	CLEARING AND GRUBBING	LS	1	3,000.00	3,000.00			1.00	3,000.00	1.00	1.00	1.00	3,000.00	100%	
11	DEVELOP WATER SUPPLY	LS	1	1,000.00	1,000.00			1.00	1,000.00	1.00	1.00	1.00	1,000.00	100%	
12	ROADWAY EXCAVATION	CY	1,590	19.00	30,210.00			1,590.00	30,210.00	454.00	8,626.00	1,501.67	37,157.73	123%	
13	CLASS 2 AGGREGATE BASE	CY	1,110	33.00	36,630.00			1,110.00	36,630.00	305.00	10,065.00	1,060.00	45,045.00	123%	
14	HOT ASPHALT MIX	TON	640	80.00	51,200.00			640.00	51,200.00	72.50	5,800.00	691.52	61,121.60	119%	
15	ASPHALT RUBBER HOT MIX	TON	360	99.00	35,640.00			360.00	35,640.00			391.40	38,748.60	109%	
16	PLACE ASPHALT CONCRETE DIKE (CRS 212)(8')	LF	1,104	10.00	11,040.00			1,104.00	11,040.00			1,153.00	11,530.00	104%	
17	ROADSIDE SIGN - ONE POST	EA	4	240.00	960.00			4.00	960.00			4.00	960.00	100%	
18	THERMOPLASTIC PAVEMENT MARKING & CROSSWALK	SOFT	410	3.00	1,230.00			410.00	1,230.00	418.00	1,254.00	418.00	1,254.00	102%	
19	PAINT TRAFFIC STRIPE 2 COAT	LF	19,800	0.35	6,930.00			19,800.00	6,930.00	21,894.00	7,662.90	21,894.00	7,662.90	111%	
20	PAVEMENT MARKER (REFLECTIVE)	EA	596	3.25	1,937.00			596.00	1,937.00	634.00	2,060.50	634.00	2,060.50	106%	
21	SIGNAL AND LIGHTING	LS	1	141,306.00	141,306.00			1.00	141,306.00	0.05	7,065.30	0.95	141,306.00	100%	
22	RELOCATE CATHODIC TEST STATION (JCSD)	EA	1	800.00	800.00			1.00	800.00	1.00	800.00	1.00	800.00	100%	

PROJECT: Limonite Ave. & Lucetta Ave. T/S and Lighting Project
 County Project No.: 88-0663
 Contract No.: 09-09-005

Contractor: DBX, Inc.
 Address: 42066 Avenida Alvarado
 City, State, Zip: Temecula, CA 92590

Estimate No. 3 Final
 From: December 25, 2009
 To: February 25, 2010



Item No.	Item Description	Units	Quantity	Unit Price	Original Contract Amount	Change Authorized		Total Authorized		This Estimate Quantity	This Estimate Amount	Previous Quantity	Total Estimate To Date		% Auth.
						Quantity	Amount	Quantity	Amount				Quantity	Amount	
23	RELOCATE EXISTING AIR VALVE (JCSD)	EA	1	1,500.00	1,500.00	1.00	1,500.00	1.00	1,500.00	1.00	1,500.00	1.00	1.00	1,500.00	100%
24	RAISE EXISTING AIR VALVE (JCSD)	EA	1	1,500.00	1,500.00	1.00	1,500.00	1.00	1,500.00	1.00	1,500.00	1.00	1.00	1,500.00	100%
25	RAISE EXISTING BLOW OFF VALVE (JCSD)	EA	1	1,500.00	1,500.00	1.00	1,500.00	1.00	1,500.00						0%

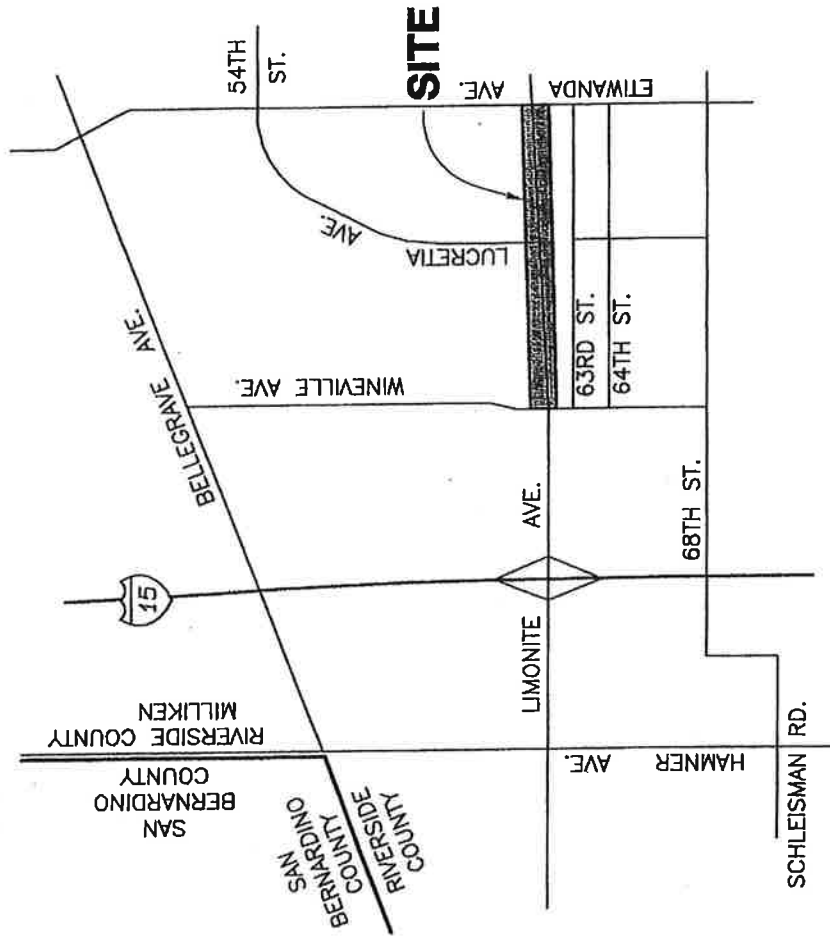

NOT TO SCALE

VICINITY MAP

PROJECT LENGTH = 5,200 FT
 SECTION 29, TOWNSHIP 2 S., RANGE 6 W.
 2008 THOMAS GUIDE PG 683, G5