

**SUBMITTAL TO THE BOARD OF SUPERVISORS
COUNTY OF RIVERSIDE, STATE OF CALIFORNIA**

609B



FROM: County Counsel
Code Enforcement Department
SUBJECT: Statement of Expense [CV 05-3982]
Subject Property: 4037 Blair Street, Corona; HERNANDEZ
APN: 115-232-006
District Two

SUBMITTAL DATE:
April 22, 2010

RECOMMENDED MOTION: Move that the Board of Supervisors:

- (1) assess the reasonable costs of abatement of a public nuisance (excess outside storage of materials and accumulated rubbish) in the above-referenced matter to be two thousand, five hundred, forty-six dollars and ninety-eight cents (US \$2,546.98);
- (2) assess the costs of abatement against the above-described subject property;
- (3) authorize the recordation of a notice of abatement lien; and
- (4) authorize the abatement costs to be added to the tax roll as a special assessment

BACKGROUND: Government Code § 25845, Riverside County Ordinance Nos. 348 (RCC Title 17), 541(RCC Chapter 8.120) and 725 (RCC Chapter 1.16) authorize the recovery of abatement costs in public nuisance cases, the recordation of a notice of abatement lien and inclusion of abatement costs on the tax roll as a special assessment upon approval of the Board of Supervisors.

JULIE A. JARVI, Deputy County Counsel
for PAMELA J. WALLS, County Counsel

(Continued)

FINANCIAL DATA	Current F.Y. Total Cost:	\$ N/A	In Current Year Budget:	N/A
	Current F.Y. Net County Cost:	\$ N/A	Budget Adjustment:	N/A
	Annual Net County Cost:	\$ N/A	For Fiscal Year:	N/A

SOURCE OF FUNDS:	Positions To Be Deleted Per A-30	<input type="checkbox"/>
	Requires 4/5 Vote	<input type="checkbox"/>

C.E.O. RECOMMENDATION: APPROVE
BY: Tina Grande
County Executive Office Signature

Dep't Recomm.: Consent Policy
Per Exec. Ofc.: Consent Policy

MINUTES OF THE BOARD OF SUPERVISORS

On motion of Supervisor Tavaglione, seconded by Supervisor Stone and duly carried by unanimous vote, IT WAS ORDERED that the above matter is approved as recommended with a revised amount of costs to \$1,500.

Ayes: Buster, Tavaglione, Stone, Benoit and Ashley
Nays: None
Absent: None
Date: May 4, 2010
xc: Co. Co., CED, Prop. Owner

Kecia Harper-Ihem
Clerk of the Board
By: Deputy

Prev. Agn. Ref.: | **District: 2** | **Agenda Number:**

Statement of Expense [CV 05-3982]
Subject Property: 4037 Blair Street, Corona; HERNANDEZ
APN: 115-232-006
District Two

The Board of Supervisors issued an Order to Abate Nuisance in this case on December 4, 2007. Subsequently, the property owners brought the property into compliance.

The Notice of Hearing re Statement of Expense has been posted on the property and mailed to the property owner and all interested parties, as required by law. Copies of all relevant notices issued in this matter together with proof of service and posting have been separately filed with the Clerk of the Board and are made a part of the record herein, pursuant to Riverside County Ordinance 725.

PAMELA J. WALLS
County Counsel

Principal Deputy
KATHERINE A. LIND

OFFICE OF COUNTY COUNSEL
COUNTY OF RIVERSIDE

3960 ORANGE STREET, 5TH FLOOR
RIVERSIDE, CA 92501
TELEPHONE: 951/955-6300
FAX: 951/955-6322 & 955-6363



March 31, 2010

NOTICE OF HEARING RE: STATEMENT OF EXPENSE

To: Owner(s) or Interested Parties
(See Attached Proof of Service
and Notice List)

Subject Property: 4037 Blair Street, Corona
Case No.: CV 05-3982
APN: 115-232-006

NOTICE IS HEREBY GIVEN that a hearing will be held before the Riverside County Board of Supervisors on **Tuesday, May 4, 2010, at 9:30 a.m.** in the Board of Supervisors Room, 4080 Lemon Street, 1st Floor Annex, Riverside, California, at which time and place pertinent testimony will be heard regarding the expenses incurred by the County of Riverside, Code Enforcement Department ("DEPARTMENT") for the above-referenced abatement case. Said abatement case involved accumulated rubbish and excessive outside storage located on your real property commonly described as 4037 Blair Street, Corona, Riverside County, California and more particularly described as Assessor's Parcel Number 115-232-006.

The total expense due, including all other fees and costs, for the abatement of the above-described dangerous or injurious condition is **two thousand, five hundred, forty-six dollars and ninety-eight cents, (US \$2,546.98)**. This amount is immediately due and payable. If you have any objections to the Statement of Expense attached hereto, you must address your objections to the Board of Supervisors at the hearing. If you have any questions about the attached Statement of Expense or would like to see additional documents in support of costs set forth on the Statement of Expense Worksheet, please contact the undersigned at (951) 955-6300. In the event the total amount due is not paid to the DEPARTMENT prior to the Board Hearing, the DEPARTMENT shall seek an order from the Board of Supervisors to place a lien against your property and collect the amount due as a special tax assessment.

Failure to appear at the hearing will result in the exclusion of your testimony and facts as known to the DEPARTMENT will be presented to the Board of Supervisors for their final consideration and deliberation of this matter.

You are encouraged to contact Supervising Code Enforcement Officer, Brian Black (951) 955-2004 prior to the hearing. Please meet with the undersigned or Brian Black at 8:30 a.m. on the day of the hearing in the lobby of the 1st floor annex in front of the Clerk of the Board's Office to discuss the case.

PAMELA J. WALLS
County Counsel



JULIE A. JARVI
Deputy County Counsel

Enclosure: Statement of Expense

MAY 04 2010 9.10



COUNTY OF RIVERSIDE

Code Enforcement Administration

STATEMENT OF EXPENSE WORKSHEET



CASE NUMBER: CV05-3982

OWNER: MANUEL AGUILAR HERNANDEZ & ELOISE HERNANDEZ

SITUS: 4037 BLAIR ST CORONA, CA. 92879

APN: 115-232-006-2

SUPERVISORIAL DISTRICT: # 2

AUTHORITY: RIVERSIDE COUNTY ORDINANCE NO(s).
348 (RCC Title 17), 541 (RCC Chapter 8.120) & 725 (RCC Chapter 1.16)

Code Enforcement Department Billable Rates: Effective June 21, 2007 (Riverside County Ordinance 725.12)

SUPER-SUPERVISING CODE ENFORCEMENT OFFICER	\$130.00/HR
SENIOR-SENIOR CODE ENFORCEMENT OFFICER	\$129.00/HR
OFFICER- CODE ENFORCEMENT OFFICER II	\$109.00/HR
TECH- CODE ENFORCEMENT TECHNICIAN	\$82.00/HR

<u>DATE</u>	<u>DESCRIPTION</u>	<u>HOURS</u>	<u>AMOUNT</u>
08/25/05 - 04/22/08	CV05-3982: Officers- Pineda, J/ Palmer, J/ Parra, D/ Lance J - Field Investigation/File Maintenance	9.6	\$1,152.80
02/04/10	Prepare/Attend Statement of Expense Hearing	0.5	\$65.00
SUBTOTAL CODE ENFORCEMENT COSTS			\$1,217.80
10/04/07 - 11/20/07	COUNTY COUNSEL- LEGAL CONSULTATION SERVICES-Includes Administrative Costs		\$1,120.18
05/31/07	CONTRACTOR SERVICES- Lot/Title Report - Optima Information Solutions LLC		\$95.00
03/08/10	Lot/Title Report		\$114.00
TOTAL COSTS DUE			\$2,546.98

I affirm and declare under penalty of perjury under the laws of the State of California that the foregoing is true and correct.

Executed this 17th day of March, 2010, at Riverside, California.



 Cuong Pham
 Code Enforcement Department

NOTICE LIST

Subject Property: 4037 Blair Street; Case No.: CV 05-3982;
APN: 115-232-006; District 2

MANUEL AGUILAR HERNANDEZ
ELOISE RAYA HERNANDEZ
4037 BLAIR STREET
CORONA CA 91720

MANUEL AGUILAR HERNANDEZ TRUSTEE
C/O MANUEL A HERNANDEZ
1249 RAMON AVENUE
SALINAS CA 93906

MANUEL AGUILAR HERNANDEZ TRUSTEE
4037 BLAIR STREET
CORONA CA 91719

MANUEL AGUILAR HERNANDEZ
C/O WILLIAM F TURNER
ATTORNEY AT LAW
1451 RIMPAU AVENUE SUITE 108
CORONA CA 92879-7521

BANK OF AMERICA NA
CUSTOM RECORDING SOLUTIONS
#68249006176299
2550 N REDHILL AVENUE
SANTA ANA CA 92705

MANUAL HERNANDEZ
ELOISE R HERNANDEZ
PO BOX 53
CORONA CA 92878

MANUAL AGUILAR
ELOISE HERNANDEZ
C/O SCOTT EDWARD DARLING
3697 ARLINGTON AVENUE
RIVERSIDE CA 92506-3938

JAMES BADALIAN
11608 HOLLY OAK DRIVE
FONTANA CA 92337

NOTICE LIST

Subject Property: 4037 Blair Street; Case No.: CV 05-3982;
APN: 115-232-006; District 2

RAYMOND F FEIST JR EST
FEIST VETTER KNAUF & LOY, APC
PO BOX 240
OCEANSIDE CA 92049-0240

MARC S HOMME
PO BOX 4250
PALM DESERT CA 92260

BRUCE W HOGAN
KINGSTON MARTINEZ & HOGAN
1300 SANTA BARBARA STREET
SANTA BARBARA CA 93101

THERESA CRAWFORD TALE ESQ
CRAWFORD & BANGS LLP
1290 E CENTER COURT DRIVE
COVINA CA 91724-3600

CRAIG E ZUNDEL ESQ
74-399 HIGHWAY 111 SUITE M
PALM DESERT CA 92260

ROBERT M BINAM ESQ
LAW OFFICES OF ROBERT M BINAM
200 S MAIN STREET SUITE 200
PO BOX 3600
CORONA CA 92878-3600

LYNN A SHINMOTO ESQ
DEVIRIAN & SHINMOTO PROF CORP
11400 WEST OLYMPIC BLVD
SUITE 200
LOS ANGELES CA 90064

LARRY G LUSHANKO
584 INDUSTRIAL WAY
SUITE A
FALLBROOK CA 92028

NOTICE LIST

Subject Property: 4037 Blair Street; Case No.: CV 05-3982;
APN: 115-232-006; District 2

STEVEN J HORN ESQ
26500 W AGOURA ROAD
CALABAS CA 91302

MANDIE BULLOCK ESQ
CIR LAW OFFICES LLP
8665 GIBBS DRIVE
SUITE 150
SAN DIEGO CA 92123

LEGAL RECOVERY LAW OFFICES INC.
MARK D WALSH ESQ
5030 CAMINO DE LA SIESTA #340
SAN DIEGO CA 92108

STATE OF CALIF – FRANCHISE TAX BOARD
SPECIAL PROCEDURES SECTION
PO BOX 2952
SACRAMENTO CA 95812-2952

INTERNAL REVENUE SERVICE
PO BOX 145585, STOP 8420G
CINCINNATI OH 45250-5585

NOTICE LIST

Subject Property: 4037 Blair Street; Case No.: CV 05-3982;
APN: 115-232-006; District 2

<p>SENDER: COMPLETE THIS SECTION</p> <ul style="list-style-type: none"> ■ Complete items 1, 2, and 3. Also complete item 4 if Restricted Delivery is desired. ■ Print your name and address on the reverse so that we can return the card to you. ■ Attach this card to the back of the mailpiece, or on the front if space permits. <p>1. Article Addressed to:</p> <p>MARC S HOMME PO BOX 4250 PALM DESERT CA 92260</p>	<p>COMPLETE THIS SECTION ON DELIVERY</p> <p>A. Signature <input type="checkbox"/> Agent <input checked="" type="checkbox"/> Addressee</p> <p>B. Received by (Printed Name) <input type="checkbox"/> Date of Delivery</p> <p>S. M. Correia 11-1-10</p> <p>D. Is delivery address different from item 1? <input type="checkbox"/> Yes If YES, enter delivery address below: <input type="checkbox"/> No</p>
<p>2. Article Number (Transfer from service label)</p> <p>05-3982 (Hernandez) SOE 21</p> <p>7009 3410 0000 1317 6048</p>	<p>3. Service Type</p> <p><input checked="" type="checkbox"/> Certified Mail <input type="checkbox"/> Express Mail <input type="checkbox"/> Registered <input checked="" type="checkbox"/> Return Receipt for Merchandise <input type="checkbox"/> Insured Mail <input type="checkbox"/> C.O.D.</p> <p>4. Restricted Delivery? (Extra Fee) <input type="checkbox"/> Yes</p>
<p>PS Form 3811, February 2004 Domestic Return Receipt</p>	<p>PS Form 3811, February 2004 Domestic Return Receipt</p>

<p>SENDER: COMPLETE THIS SECTION</p> <ul style="list-style-type: none"> ■ Complete items 1, 2, and 3. Also complete item 4 if Restricted Delivery is desired. ■ Print your name and address on the reverse so that we can return the card to you. ■ Attach this card to the back of the mailpiece, or on the front if space permits. <p>1. Article Addressed to:</p> <p>MANUEL AGUILAR HERNANDEZ C/O WILLIAM F TURNER ATTORNEY AT LAW 1451 RIMPAU AVENUE SUITE 108 CORONA CA 92879-7521</p>	<p>COMPLETE THIS SECTION ON DELIVERY</p> <p>A. Signature <input type="checkbox"/> Agent <input checked="" type="checkbox"/> Addressee</p> <p>B. Received by (Printed Name) <input type="checkbox"/> Date of Delivery</p> <p>Sherry Turner 4-7-10</p> <p>D. Is delivery address different from item 1? <input type="checkbox"/> Yes If YES, enter delivery address below: <input type="checkbox"/> No</p>
<p>2. Article Number (Transfer from service label)</p> <p>05-3982 (Hernandez) SOE 21</p> <p>7009 3410 0000 1317 5942</p>	<p>3. Service Type</p> <p><input checked="" type="checkbox"/> Certified Mail <input type="checkbox"/> Express Mail <input type="checkbox"/> Registered <input checked="" type="checkbox"/> Return Receipt for Merchandise <input type="checkbox"/> Insured Mail <input type="checkbox"/> C.O.D.</p> <p>4. Restricted Delivery? (Extra Fee) <input type="checkbox"/> Yes</p>
<p>PS Form 3811, February 2004 Domestic Return Receipt</p>	<p>PS Form 3811, February 2004 Domestic Return Receipt</p>

NOTICE LIST

Subject Property: 4037 Blair Street; Case No.: CV 05-3982;
APN: 115-232-006; District 2

SENDER: COMPLETE THIS SECTION

- Complete items 1, 2, and 3. Also complete item 4 if Restricted Delivery is desired.
- Print your name and address on the reverse so that we can return the card to you.
- Attach this card to the back of the mailpiece, or on the front if space permits.

1. Article Addressed to:

BANK OF AMERICA NA
CUSTOM RECORDING SOLUTIONS
#68249006176299
2550 N REDHILL AVENUE
SANTA ANA CA 92705

2. Article Number
(Transfer from service label) **7009 3410 0000 1317 5959**

PS Form 3811, February 2004 Domestic Return Receipt 102595-02-M-1540

COMPLETE THIS SECTION ON DELIVERY

A. Signature Agent
 Addressee

B. Received by (Printed Name) Agent
 Addressee

C. Date of Delivery
4-1-10

D. Is delivery address different from item 1? Yes
If YES, enter delivery address below: No

3. Service Type
 Certified Mail Express Mail
 Registered Return Receipt for Merchandise
 Insured Mail C.O.D.

4. Restricted Delivery? (Extra Fee) Yes

SENDER: COMPLETE THIS SECTION

- Complete items 1, 2, and 3. Also complete item 4 if Restricted Delivery is desired.
- Print your name and address on the reverse so that we can return the card to you.
- Attach this card to the back of the mailpiece, or on the front if space permits.

1. Article Addressed to:

LARRY G LUSHANKO
584 INDUSTRIAL WAY
SUITE A
FALLBROOK CA 92720

2. Article Number
(Transfer from service label) **7009 3410 0000 1317 6062**

PS Form 3811, February 2004 Domestic Return Receipt 102595-02-M-1540

COMPLETE THIS SECTION ON DELIVERY

A. Signature Agent
 Addressee

B. Received by (Printed Name) Agent
 Addressee

C. Date of Delivery
4-1-10

D. Is delivery address different from item 1? Yes
If YES, enter delivery address below: No

3. Service Type
 Certified Mail Express Mail
 Registered Return Receipt for Merchandise
 Insured Mail C.O.D.

4. Restricted Delivery? (Extra Fee) Yes

SENDER: COMPLETE THIS SECTION

- Complete items 1, 2, and 3. Also complete item 4 if Restricted Delivery is desired.
- Print your name and address on the reverse so that we can return the card to you.
- Attach this card to the back of the mailpiece, or on the front if space permits.

1. Article Addressed to:

MANDIE BULLOCK ESQ
CIR LAW OFFICES LLP
8665 GIBBS DRIVE
SUITE 150
SAN DIEGO CA 92123

2. Article Number
(Transfer from service label) **7009 3410 0000 1317 6086**

PS Form 3811, February 2004 Domestic Return Receipt 102595-02-M-1540

COMPLETE THIS SECTION ON DELIVERY

A. Signature Agent
 Addressee

B. Received by (Printed Name) Agent
 Addressee

C. Date of Delivery
APR 1 2010

D. Is delivery address different from item 1? Yes
If YES, enter delivery address below: No

3. Service Type
 Certified Mail Express Mail
 Registered Return Receipt for Merchandise
 Insured Mail C.O.D.

4. Restricted Delivery? (Extra Fee) Yes

NOTICE LIST

Subject Property: 4037 Blair Street; Case No.: CV 05-3982;
 APN: 115-232-006; District 2

SENDER: COMPLETE THIS SECTION

- Complete items 1, 2, and 3. Also complete item 4 if Restricted Delivery is desired.
- Print your name and address on the reverse so that we can return the card to you.
- Attach this card to the back of the mailpiece, or on the front if space permits.

1. Article Addressed to:
 STEVEN J HORN ESQ
 26500 W AGOURA ROAD
 CALABAS CA 91302

2. Article Number
 (Transfer from service label) **7009 3410 0000 1317 6079**

PS Form 3811, February 2004 Domestic Return Receipt 102595-02-M-1540

COMPLETE THIS SECTION ON DELIVERY

A. Signature Agent Addressee
Signature

B. Received by (Printed Name) Agent Addressee
 C. Date of Delivery **APR 02 2004**

D. Is delivery address different from item 1? Yes No
 If YES, enter delivery address below:

3. Service Type
 Certified Mail Express Mail
 Registered Return Receipt for Merchandise
 Insured Mail C.O.D.

4. Restricted Delivery? (Extra Fee) Yes

SENDER: COMPLETE THIS SECTION

- Complete items 1, 2, and 3. Also complete item 4 if Restricted Delivery is desired.
- Print your name and address on the reverse so that we can return the card to you.
- Attach this card to the back of the mailpiece, or on the front if space permits.

1. Article Addressed to:
 THERESA CRAWFORD TALE ESQ
 CRAWFORD & BANGS LLP
 1290 E CENTER COURT DRIVE
 COVINA CA 91724-3600

2. Article Number
 (Transfer from service label) **7009 3410 0000 1317 6024**

PS Form 3811, February 2004 Domestic Return Receipt 102595-02-M-1540

COMPLETE THIS SECTION ON DELIVERY

A. Signature Agent Addressee
Signature

B. Received by (Printed Name) Agent Addressee
 C. Date of Delivery **4/1/04**

D. Is delivery address different from item 1? Yes No
 If YES, enter delivery address below:

3. Service Type
 Certified Mail Express Mail
 Registered Return Receipt for Merchandise
 Insured Mail C.O.D.

4. Restricted Delivery? (Extra Fee) Yes

SENDER: COMPLETE THIS SECTION

- Complete items 1, 2, and 3. Also complete item 4 if Restricted Delivery is desired.
- Print your name and address on the reverse so that we can return the card to you.
- Attach this card to the back of the mailpiece, or on the front if space permits.

1. Article Addressed to:
 MANUAL HERNANDEZ
 ELOISE R HERNANDEZ
 PO BOX 53
 CORONA CA 92878

2. Article Number
 (Transfer from service label) **7009 3410 0000 1317 5966**

PS Form 3811, February 2004 Domestic Return Receipt 102595-02-M-1540

COMPLETE THIS SECTION ON DELIVERY

A. Signature Agent Addressee
Signature

B. Received by (Printed Name) Agent Addressee
 C. Date of Delivery **APR 01 2004**

D. Is delivery address different from item 1? Yes No
 If YES, enter delivery address below:

3. Service Type
 Certified Mail Express Mail
 Registered Return Receipt for Merchandise
 Insured Mail C.O.D.

4. Restricted Delivery? (Extra Fee) Yes

NOTICE LIST

Subject Property: 4037 Blair Street; Case No.: CV 05-3982;
APN: 115-232-006; District 2

<p>SENDER: COMPLETE THIS SECTION</p> <p>■ Complete items 1, 2, and 3. Also complete item 4 if Restricted Delivery is desired. ■ Print your name and address on the reverse so that we can return the card to you. ■ Attach this card to the back of the mailpiece, or on the front if space permits.</p> <p>1. Article Addressed to: MANUEL AGUILAR HERNANDEZ TRUSTEE 4037 BLAIR STREET CORONA CA 91719</p>	<p>COMPLETE THIS SECTION ON DELIVERY</p> <p>A. Signature <input checked="" type="checkbox"/> Agent B. Received by (Printed Name) <input type="checkbox"/> Addressee C. Date of Delivery D. Is delivery address different from item 1? <input type="checkbox"/> Yes If YES, enter delivery address below: <input type="checkbox"/> No</p>
<p>2. Article Number (Transfer from service label) PS Form 3811, February 2004</p>	<p>3. Service Type <input checked="" type="checkbox"/> Certified Mail <input type="checkbox"/> Express Mail <input type="checkbox"/> Registered <input checked="" type="checkbox"/> Return Receipt for Merchandise <input type="checkbox"/> Insured Mail <input type="checkbox"/> C.O.D.</p>
<p>2. Article Number (Transfer from service label) PS Form 3811, February 2004</p>	<p>3. Service Type <input checked="" type="checkbox"/> Certified Mail <input type="checkbox"/> Express Mail <input type="checkbox"/> Registered <input checked="" type="checkbox"/> Return Receipt for Merchandise <input type="checkbox"/> Insured Mail <input type="checkbox"/> C.O.D.</p>
<p>2. Article Number (Transfer from service label) PS Form 3811, February 2004</p>	<p>3. Service Type <input checked="" type="checkbox"/> Certified Mail <input type="checkbox"/> Express Mail <input type="checkbox"/> Registered <input checked="" type="checkbox"/> Return Receipt for Merchandise <input type="checkbox"/> Insured Mail <input type="checkbox"/> C.O.D.</p>

<p>SENDER: COMPLETE THIS SECTION</p> <p>■ Complete items 1, 2, and 3. Also complete item 4 if Restricted Delivery is desired. ■ Print your name and address on the reverse so that we can return the card to you. ■ Attach this card to the back of the mailpiece, or on the front if space permits.</p> <p>1. Article Addressed to: BRUCE W HOGAN KINGSTON MARTINEZ & HOGAN 1300 SANTA BARBARA STREET SANTA BARBARA CA 93101</p>	<p>COMPLETE THIS SECTION ON DELIVERY</p> <p>A. Signature <input checked="" type="checkbox"/> Agent B. Received by (Printed Name) <input type="checkbox"/> Addressee C. Date of Delivery D. Is delivery address different from item 1? <input type="checkbox"/> Yes If YES, enter delivery address below: <input type="checkbox"/> No</p>
<p>2. Article Number (Transfer from service label) PS Form 3811, February 2004</p>	<p>3. Service Type <input checked="" type="checkbox"/> Certified Mail <input type="checkbox"/> Express Mail <input type="checkbox"/> Registered <input checked="" type="checkbox"/> Return Receipt for Merchandise <input type="checkbox"/> Insured Mail <input type="checkbox"/> C.O.D.</p>
<p>2. Article Number (Transfer from service label) PS Form 3811, February 2004</p>	<p>3. Service Type <input checked="" type="checkbox"/> Certified Mail <input type="checkbox"/> Express Mail <input type="checkbox"/> Registered <input checked="" type="checkbox"/> Return Receipt for Merchandise <input type="checkbox"/> Insured Mail <input type="checkbox"/> C.O.D.</p>
<p>2. Article Number (Transfer from service label) PS Form 3811, February 2004</p>	<p>3. Service Type <input checked="" type="checkbox"/> Certified Mail <input type="checkbox"/> Express Mail <input type="checkbox"/> Registered <input checked="" type="checkbox"/> Return Receipt for Merchandise <input type="checkbox"/> Insured Mail <input type="checkbox"/> C.O.D.</p>

NOTICE LIST

Subject Property: 4037 Blair Street; Case No.: CV 05-3982;
 APN: 115-232-006; District 2

SENDER: COMPLETE THIS SECTION ■ Complete items 1, 2, and 3. Also complete item 4 if Restricted Delivery is desired. ■ Print your name and address on the reverse so that we can return the card to you. ■ Attach this card to the back of the mailpiece, or on the front if space permits. 1. Article Addressed to: MANUEL AGUILAR HERNANDEZ ELOISE RAYA HERNANDEZ 4037 BLAIR STREET CORONA CA 91720		COMPLETE THIS SECTION ON DELIVERY A. Signature <input checked="" type="checkbox"/> Agent B. Received by (Printed Name) <input type="checkbox"/> Addressee C. Date of Delivery D. Is delivery address different from item 1? <input type="checkbox"/> Yes If YES, enter delivery address below: <input type="checkbox"/> No	
2. Article Number (Transfer from service label)		3. Service Type <input checked="" type="checkbox"/> Certified Mail <input type="checkbox"/> Express Mail <input type="checkbox"/> Registered <input checked="" type="checkbox"/> Return Receipt for Merchandise <input type="checkbox"/> Insured Mail <input type="checkbox"/> C.O.D.	
PS Form 3811, February 2004		102595-02-M-1540	

SENDER: COMPLETE THIS SECTION ■ Complete items 1, 2, and 3. Also complete item 4 if Restricted Delivery is desired. ■ Print your name and address on the reverse so that we can return the card to you. ■ Attach this card to the back of the mailpiece, or on the front if space permits. 1. Article Addressed to: MANUEL AGUILAR HERNANDEZ ELOISE RAYA HERNANDEZ 4037 BLAIR STREET CORONA CA 91720		COMPLETE THIS SECTION ON DELIVERY A. Signature <input checked="" type="checkbox"/> Agent B. Received by (Printed Name) <input type="checkbox"/> Addressee C. Date of Delivery D. Is delivery address different from item 1? <input type="checkbox"/> Yes If YES, enter delivery address below: <input type="checkbox"/> No	
2. Article Number (Transfer from service label)		3. Service Type <input checked="" type="checkbox"/> Certified Mail <input type="checkbox"/> Express Mail <input type="checkbox"/> Registered <input checked="" type="checkbox"/> Return Receipt for Merchandise <input type="checkbox"/> Insured Mail <input type="checkbox"/> C.O.D.	
PS Form 3811, February 2004		102595-02-M-1540	

SENDER: COMPLETE THIS SECTION ■ Complete items 1, 2, and 3. Also complete item 4 if Restricted Delivery is desired. ■ Print your name and address on the reverse so that we can return the card to you. ■ Attach this card to the back of the mailpiece, or on the front if space permits. 1. Article Addressed to: MANUEL AGUILAR HERNANDEZ TRUSTEE C/O MANUEL A HERNANDEZ 1249 RAMON AVENUE SALINAS CA 93906		COMPLETE THIS SECTION ON DELIVERY A. Signature <input checked="" type="checkbox"/> Agent B. Received by (Printed Name) <input type="checkbox"/> Addressee C. Date of Delivery D. Is delivery address different from item 1? <input type="checkbox"/> Yes If YES, enter delivery address below: <input type="checkbox"/> No	
2. Article Number (Transfer from service label)		3. Service Type <input checked="" type="checkbox"/> Certified Mail <input type="checkbox"/> Express Mail <input type="checkbox"/> Registered <input checked="" type="checkbox"/> Return Receipt for Merchandise <input type="checkbox"/> Insured Mail <input type="checkbox"/> C.O.D.	
PS Form 3811, February 2004		102595-02-M-1540	

NOTICE LIST

Subject Property: 4037 Blair Street; Case No.: CV 05-3982;
 APN: 115-232-006; District 2

<p>SENDER: COMPLETE THIS SECTION</p> <ul style="list-style-type: none"> Complete items 1, 2, and 3. Also complete item 4 if Restricted Delivery is desired. Print your name and address on the reverse so that we can return the card to you. Attach this card to the back of the mailpiece, or on the front if space permits. <p>1. Article Addressed to: INTERNAL REVENUE SERVICE PO BOX 145585, STOP 8420G CINCINNATI OH 45250-5585</p> <p><i>CV05-3982 (Hernandez) SOE 21</i></p> <p>2. Article Number (Transfer from service label) 7009 3410 0000 1317 6116</p> <p>PS Form 3811, February 2004</p>	<p>COMPLETE THIS SECTION ON DELIVERY</p> <p>A. Signature <input type="checkbox"/> Agent <input type="checkbox"/> Addressee</p> <p>B. Received by (Printed Name) C. Date of Delivery</p> <p>D. Is delivery address different from item 1? <input type="checkbox"/> Yes If YES, enter delivery address below: <input type="checkbox"/> No</p> <p>APR 04 2010</p> <p>3. Service Type <input checked="" type="checkbox"/> Certified Mail <input type="checkbox"/> Express Mail <input type="checkbox"/> Registered <input checked="" type="checkbox"/> Return Receipt for Merchandise <input type="checkbox"/> Insured Mail <input type="checkbox"/> C.O.D.</p> <p>4. Restricted Delivery? (Extra Fee) <input type="checkbox"/> Yes</p>
---	---

<p>SENDER: COMPLETE THIS SECTION</p> <ul style="list-style-type: none"> Complete items 1, 2, and 3. Also complete item 4 if Restricted Delivery is desired. Print your name and address on the reverse so that we can return the card to you. Attach this card to the back of the mailpiece, or on the front if space permits. <p>1. Article Addressed to: STATE OF CALIF - FRANCHISE TAX BOARD SPECIAL PROCEDURES SECTION PO BOX 2952 SACRAMENTO CA 95812-2952</p> <p><i>CV05-3982 (Hernandez) SOE 21</i></p> <p>2. Article Number (Transfer from service label) 7009 3410 0000 1317 6109</p> <p>PS Form 3811, February 2004</p>	<p>COMPLETE THIS SECTION ON DELIVERY</p> <p>A. Signature <input type="checkbox"/> Agent <input type="checkbox"/> Addressee</p> <p>B. Received by (Printed Name) C. Date of Delivery</p> <p>D. Is delivery address different from item 1? <input type="checkbox"/> Yes If YES, enter delivery address below: <input type="checkbox"/> No</p> <p>APR 5 2010</p> <p>3. Service Type <input checked="" type="checkbox"/> Certified Mail <input type="checkbox"/> Express Mail <input type="checkbox"/> Registered <input checked="" type="checkbox"/> Return Receipt for Merchandise <input type="checkbox"/> Insured Mail <input type="checkbox"/> C.O.D.</p> <p>4. Restricted Delivery? (Extra Fee) <input type="checkbox"/> Yes</p>
---	--

<p>SENDER: COMPLETE THIS SECTION</p> <ul style="list-style-type: none"> Complete items 1, 2, and 3. Also complete item 4 if Restricted Delivery is desired. Print your name and address on the reverse so that we can return the card to you. Attach this card to the back of the mailpiece, or on the front if space permits. <p>1. Article Addressed to: LYNN A SHINMOTO ESQ DEVIRIAN & SHINMOTO PROF CORP 11400 WEST OLYMPIC BLVD SUITE 200 LOS ANGELES CA 90064</p> <p><i>CV05-3982 (Hernandez) SOE 21</i></p> <p>2. Article Number (Transfer from service label) 7009 3410 0000 1317 6055</p> <p>PS Form 3811, February 2004</p>	<p>COMPLETE THIS SECTION ON DELIVERY</p> <p>A. Signature <input type="checkbox"/> Agent <input checked="" type="checkbox"/> <i>Angela Carpio</i> <input type="checkbox"/> Addressee</p> <p>B. Received by (Printed Name) C. Date of Delivery</p> <p><i>A. CARPIO</i> <i>4/5</i></p> <p>D. Is delivery address different from item 1? <input type="checkbox"/> Yes If YES, enter delivery address below: <input type="checkbox"/> No</p> <p>3. Service Type <input checked="" type="checkbox"/> Certified Mail <input type="checkbox"/> Express Mail <input type="checkbox"/> Registered <input checked="" type="checkbox"/> Return Receipt for Merchandise <input type="checkbox"/> Insured Mail <input type="checkbox"/> C.O.D.</p> <p>4. Restricted Delivery? (Extra Fee) <input type="checkbox"/> Yes</p>
--	--

NOTICE LIST

Subject Property: 4037 Blair Street; Case No.: CV 05-3982;
 APN: 115-232-006; District 2

Office of County Counsel
 3960 Orange Street, 5th Floor
 Riverside, CA 92501

SENDER: COMPLETE THIS SECTION

- Complete Items 1, 2, and 3. Also complete Item 4 if Restricted Delivery is desired.
- Print your name and address on the reverse so that we can return the card to you.
- Attach this card to the back of the mailpiece, or on the front if space permits.

1. Article Addressed to:

JAMES BADALIAN
 11608 HOLLY OAK DRIVE
 FONTANA CA 92337

COMPLETE THIS SECTION ON DELIVERY

- A. Signature Agent Addressee
J. Badalian
- B. Received by (Printed Name) Date of Delivery
 C/O SCOTT EDWARD DARLING 2-1-10
- D. Is delivery address different from item 1? Yes No
 If YES, enter delivery address below:

3. Service Type
- Certified Mail Express Mail
 Registered Return Receipt for Merchandise
 Insured Mail C.O.D.
4. Restricted Delivery? (Extra Fee) Yes No

2. Article Number
 (Transfer from service label)

7009 3410 0000 1317 5980

PS Form 3811, February 2004

Domestic Return Receipt

10253990-00-1540

CERTIFIED MAIL

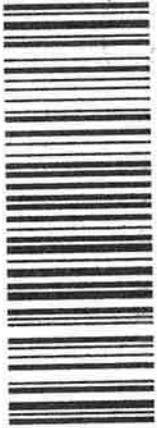

7009 3410 0000 1317 5973



UNITED STATES POSTAGE
 02 1P
 0003958246 MAR 31
 MAILED FROM ZIP CODE
\$ 005

MANUAL AQUILAR
 ELOISE HERNANDEZ
 C/O SCOTT EDWARD DARLING
 3697 RIVE

NIXIE 923 SE 1 00 04/01/10
 RETURN TO SENDER
 NOT DELIVERABLE AS ADDRESSED
 UNABLE TO FORWARD

BC: 92501364405 *2904-00583-31-39

92501364405



1 **PROOF OF SERVICE**

2 Case No. CV 05-3982

3 STATE OF CALIFORNIA, COUNTY OF RIVERSIDE

4 I, Brenda G. Peeler, declare that I am a citizen of the United States and am employed in the County
5 of Riverside, over the age of 18 years and not a party to the within action or proceeding; that my
6 business address is 3960 Orange Street, 5th Floor, Riverside, California 92501.

7 That on March 31, 2010, I served the following document(s):

- 8 - **NOTICE OF HEARING RE: STATEMENT OF EXPENSE**
9 - **STATEMENT OF EXPENSE WORKSHEET**

10 by placing a true copy thereof enclosed in a sealed envelope(s) addressed as follows:

11 **OWNERS OR INTERESTED PARTIES**
12 **(SEE NOTICE LIST ATTACHED TO NOTICE OF HEARING)**

13 XX **BY CERTIFIED MAIL, RETURN RECEIPT REQUESTED.** I am "readily familiar"
14 with the office's practice of collection and processing correspondence for mailing. Under
15 that practice it would be deposited with the U.S. Postal Service on that same day with
16 postage thereon fully prepaid at Riverside, California, in the ordinary course of business.

17 **BY PERSONAL SERVICE:** I caused to be delivered such envelope(s) by hand to the offices
18 of the addressee(s).

19 XX **STATE - I declare under penalty of perjury under the laws of the State of California that the**
20 **above is true and correct.**

21 **FEDERAL - I declare that I am employed in the office of a member of the bar of this court at**
22 **whose direction the service was made.**

23 EXECUTED ON March 31, 2010, at Riverside, California.

24 
25 _____
26 BRENDA G. PEELER
27
28



**CODE ENFORCEMENT DEPARTMENT
COUNTY OF RIVERSIDE**

JOHN BOYD
Director

AFFIDAVIT OF POSTING OF NOTICES

April 19, 2010

RE CASE NO: CV053982

I, Brian Noone, hereby declare:

I am employed by the Riverside County Code Enforcement Department; that my business address is 4080 Lemon Street, 12th Floor, Riverside, California 92501 .

That on 04/01/2010 at 12:50 PM, I securely and conspicuously posted Notice of Hearing Statement of Expense at the property described as:

Property Address: 4037 BLAIR ST, CORONA

Assessor's Parcel Number: 115-232-006

I declare under the penalty of perjury that the foregoing is true and correct.

Executed on April 19, 2010 in the County of Riverside, California.

CODE ENFORCEMENT DEPARTMENT

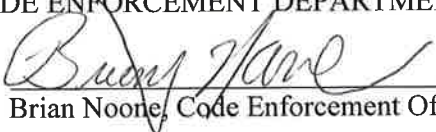
By: Brian Noone, Code Enforcement Officer

**SUBMITTAL TO THE BOARD OF SUPERVISORS
COUNTY OF RIVERSIDE, STATE OF CALIFORNIA**

FROM: County Counsel
Code Enforcement Department
SUBJECT: Statement of Expense [Case No. CV 05-3982]
Subject Property: 4037 Blair Street, Corona; HERNANDEZ
APN: 115-232-006
District Two

**TABLE OF SUPPLEMENTAL DOCUMENTS
FILED WITH THE CLERK OF THE BOARD**

Hearing Date: May 4, 2010

Statement of Expense, including Supporting Documentation	Exhibit A
Findings of Fact	Exhibit B
Notice of Noncompliance.. ..	Exhibit C
Assessment-Roll For The Year 09/10 And Geographic Information System, March 4, 2010.. ..	Exhibit D



COUNTY OF RIVERSIDE

Code Enforcement Administration

STATEMENT OF EXPENSE WORKSHEET



CASE NUMBER: CV05-3982

OWNER: MANUEL AGUILAR HERNANDEZ & ELOISE HERNANDEZ

SITUS: 4037 BLAIR ST CORONA, CA. 92879

APN: 115-232-006-2

SUPERVISORIAL DISTRICT: # 2

AUTHORITY: RIVERSIDE COUNTY ORDINANCE NO(s).
348 (RCC Title 17), 541 (RCC Chapter 8.120) & 725 (RCC Chapter 1.16)

Code Enforcement Department Billable Rates: Effective June 21, 2007 (Riverside County Ordinance 725.12)

SUPER-SUPERVISING CODE ENFORCEMENT OFFICER	\$130.00/HR
SENIOR-SENIOR CODE ENFORCEMENT OFFICER	\$129.00/HR
OFFICER- CODE ENFORCEMENT OFFICER II	\$109.00/HR
TECH- CODE ENFORCEMENT TECHNICIAN	\$82.00/HR

<u>DATE</u>	<u>DESCRIPTION</u>	<u>HOURS</u>	<u>AMOUNT</u>
08/25/05 - 04/22/08	CV05-3982: Officers- Pineda, J/ Palmer, J/ Parra, D/ Lance J - Field Investigation/File Maintenance	9.6	\$1,152.80
02/04/10	Prepare/Attend Statement of Expense Hearing	0.5	\$65.00
SUBTOTAL CODE ENFORCEMENT COSTS			\$1,217.80
10/04/07 - 11/20/07	COUNTY COUNSEL- LEGAL CONSULTATION SERVICES-Includes Administrative Costs	15.3	\$1,120.18
05/31/07	CONTRACTOR SERVICES- Lot/Title Report - Optima Information Solutions LLC		\$95.00
03/08/10	Lot/Title Report		\$114.00
TOTAL COSTS DUE			\$2,546.98

I affirm and declare under penalty of perjury under the laws of the State of California that the foregoing is true and correct.

Executed this 24th day of March, 2010, at Riverside, California.



 Cuong Pham
 Code Enforcement Department

EXHIBIT NO. A

BILL DATE	CLIENT / BILL MATTER	BILL HOURS	BILL AMOUNT	ATTY	DESCRIPTION
04-Oct-07	CV053982	0.8	51.2	LBH	review file; pull exhibits; draft notice list
11-Oct-07	CV053982	1.6	102.4	LBH	draft pleading Officer Declaration and F-11
12-Oct-07	CV053982	1.7	217.6	TNN	Review file; Draft additions to officer declaration.
16-Oct-07	CV053982	0.3	38.4	TNN	Finalize Notice of Hearing.
05-Nov-07	CV053982	1	128	TNN	Review file; Finalize Exhibits for submittal to BOS; Telephone call with E. Hernandez regarding hearing; Draft letter to E. Hernandez regarding same.
19-Nov-07	CV053982	0.6	76.8	TNN	Review updated investigation report from J. Lance; Review file in advance of abatement hearing.
20-Nov-07	CV053982	1.2	76.8	LBH	draft pleading FOF and F-11
20-Nov-07	CV053982	1.5	192	TNN	Meeting with E. Hernandez and M. Hernandez, owners; Attend BOS hearing; Review and finalize FOF/Order to Abate.
	Subtotal	8.7	883.2		
	Add				
10/17/2007	CV053982		41.68		Mailing Expenses
2/4/2010	CV053982	0.9	125.55		Prepare case for SOE Hearing
5/4/2010	CV053982	0.5	69.75		Attend SOE Hearing
	Total	10.1	1120.18		

EXHIBIT NO. A³

COUNTY COUNSEL COSTS MAILING

DATE	NAME	PROPERTY ADDRESS	CLIENT / BILL NAME	SECONDARYCASES	DOC	PGS	AMNT	TOTAL COST
17-Oct-07	Hernandez	4037 Blair Street, Corona	CV053982		Abatement	8	5.21	41.68

Total 5.21 41.68

EXHIBIT NO. A4



Information Solutions

Optima Order Number: 0508002 Customer Order Number CV05-3982 Issue Date: 5/16/2007 Effective Date: 5/10/2007

Form Version 2.25:

Begin Copy Below This Line.

PARTIES OF INTEREST REPORT

Report Cost: \$95.00

Customer Information

Customer Name: HERNANDEZ, MANUEL AGUILAR
Property Address: 4037 BLAIR ST., CORONA, CA 92879
Munic/County: RIVERSIDE

Deed Information

Grantee: MANUEL A. HERNANDEZ, AN UNMARRIED MAN
Document Type: GRANT DEED
Filed: Dated: 6/9/1967 Recorded: 6/28/1967
Book: Page: No.: 55763
Comment:

Grantee: MANUEL AGUILAR HERNANDEZ, TRUSTEE OF THE MANUEL AGUILAR HERNANDEZ REVOCABLE TRUST UTD OCTOBER 7, 2002
Document Type: TRUST TRANSFER GRANT DEED
Filed: Dated: 10/7/2002 Recorded: 11/25/2002
Book: Page: No.: 2002-696365
Comment:

Grantee: MANUEL AGUILAR HERNANDEZ, A MARRIED MAN
Document Type: TRUST TRANSFER GRANT DEED
Filed: Dated: 11/15/2005 Recorded: 11/15/2005
Book: Page: No.: 2005-0948073
Comment:

Grantee: MANUEL AGUILAR HERNANDEZ AND ELOISE RAYA HERNANDEZ, HUSBAND AND WIFE AS JOINT TENANTS
Document Type: QUITCLAIM DEED
Filed: Dated: 1/26/2006 Recorded: 2/21/2006
Book: Page: No.: 2006-0123253
Comment:

Grantee: MANUEL AGUILAR HERNANDEZ AND ELOISE R. HERNANDEZ, TRUSTEES OF THE FAMILY TRUST OF MANUEL AGUILAR HERNANDEZ AND ELOISE R. HERNANDEZ (AKA THE MANUEL AGUILAR HERNANDEZ REVOCABLE TRUST) DATED 4/20/2006
Document Type: QUITCLAIM DEED
Filed: Dated: 4/20/2006 Recorded: 12/20/2006
Book: Page: No.: 2006-0929342
Comment:

Vesting: MANUEL AGUILAR HERNANDEZ AND ELOISE R. HERNANDEZ, TRUSTEES OF THE FAMILY TRUST OF MANUEL AGUILAR HERNANDEZ AND ELOISE R. HERNANDEZ (AKA THE MANUEL AGUILAR HERNANDEZ REVOCABLE TRUST) DATED 4/20/2006

Legal Description: See Attached Exhibit 'A'

EXHIBIT NO. A⁵



Information Solutions

Optima Order Number: 0508002 Customer Order Number CV05-3982 Issue Date: 5/16/2007 Effective Date: 5/10/2007

Form Version 2.25:

Begin Copy Below This Line.

PARTIES OF INTEREST REPORT

Report Cost: \$95.00

Customer Information

Customer Name: HERNANDEZ, MANUEL AGUILAR
Property Address: 4037 BLAIR ST., CORONA, CA 92879
Munic/County: RIVERSIDE

Deed Information

Grantee: MANUEL A. HERNANDEZ, AN UNMARRIED MAN
Document Type: GRANT DEED
Filed: Dated: 6/9/1967 Recorded: 6/28/1967
Book: Page: No.: 55763
Comment:

Grantee: MANUEL AGUILAR HERNANDEZ, TRUSTEE OF THE MANUEL AGUILAR HERNANDEZ REVOCABLE TRUST UTD OCTOBER 7, 2002
Document Type: TRUST TRANSFER GRANT DEED
Filed: Dated: 10/7/2002 Recorded: 11/25/2002
Book: Page: No.: 2002-696365
Comment:

Grantee: MANUEL AGUILAR HERNANDEZ, A MARRIED MAN
Document Type: TRUST TRANSFER GRANT DEED
Filed: Dated: 11/15/2005 Recorded: 11/15/2005
Book: Page: No.: 2005-0948073
Comment:

Grantee: MANUEL AGUILAR HERNANDEZ AND ELOISE RAYA HERNANDEZ, HUSBAND AND WIFE AS JOINT TENANTS
Document Type: QUITCLAIM DEED
Filed: Dated: 1/26/2006 Recorded: 2/21/2006
Book: Page: No.: 2006-0123253
Comment:

Grantee: MANUEL AGUILAR HERNANDEZ AND ELOISE R. HERNANDEZ, TRUSTEES OF THE FAMILY TRUST OF MANUEL AGUILAR HERNANDEZ AND ELOISE R. HERNANDEZ (AKA THE MANUEL AGUILAR HERNANDEZ REVOCABLE TRUST) DATED 4/20/2006
Document Type: QUITCLAIM DEED
Filed: Dated: 4/20/2006 Recorded: 12/20/2006
Book: Page: No.: 2006-0929342
Comment:

Vesting: MANUEL AGUILAR HERNANDEZ AND ELOISE R. HERNANDEZ, TRUSTEES OF THE FAMILY TRUST OF MANUEL AGUILAR HERNANDEZ AND ELOISE R. HERNANDEZ (AKA THE MANUEL AGUILAR HERNANDEZ REVOCABLE TRUST) DATED 4/20/2006

Legal Description: See Attached Exhibit 'A'

EXHIBIT NO. A6



INVOICE

Order Number: 21320

Order Date: 3/8/2010

Customer Information:

Acct No. 1044

RIVERSIDE COUNTY TLMA-CODE ENFORCEMENT
4080 Lemon Street
Riverside, CA 92501

Attn: Brent Steele
REF: CV 05-3982/ Brenda Peeler
IN RE: HERNANDEZ, MANUEL AGUILAR

Product and/or Service ordered for Property known as:

**4037 Blair Street
Corona, CA 92879**

DESCRIPTION:
Lot Book Report

FEE:
\$114.00
\$114.00

TOTAL DUE:

Payment due upon receipt. Please remit to:

RZ Title Services, Inc.
P.O. Box 1193
Whittier, CA 90609

EXHIBIT NO. A7



1
2
3
4
5
6
7
8
9
10
11
12
13
14
15
16
17
18
19
20
21
22
23
24
25
26
27
28

WHEN RECORDED PLEASE MAIL TO:
Tiffany N. North, Deputy County Counsel
County of Riverside
OFFICE OF COUNTY COUNSEL
3535 Tenth Street, Suite 300 (Stop #1350)
Riverside, CA 92501

S	R	U	PAGE	SIZE	DA	MISC	LONG	RFD	COPY
			4						
M	A	L	465	426	PCOR	NCOR	SMF	NCHG	EXAM
NCHGIC									514

EXEMPT'6103

**BOARD OF SUPERVISORS
COUNTY OF RIVERSIDE**

C
514

IN RE ABATEMENT OF PUBLIC NUISANCE:)	CASE NO. CV 05-3982
[EXCESSIVE OUTSIDE STORAGE AND)	
ACCUMULATION OF RUBBISH]; APN 115-232-)	FINDINGS OF FACT,
006, 4037 BLAIR STREET, CORONA,)	CONCLUSIONS AND ORDER TO
RIVERSIDE COUNTY, MANUEL AGUILAR)	ABATE NUISANCE
HERNANDEZ; ELOISE R. HERNANDEZ,)	
OWNERS.)	[R.C.O. Nos. 348 (RCC Title 17), 541
)	(RCC Title 8) and 725 (RCC Title 1)]

The above-captioned matter came on regularly for hearing on November 20, 2007, before the Board of Supervisors of the County of Riverside, State of California in the Board Room, First Floor Annex, County Administrative Center, 4080 Lemon Street, Riverside, California regarding the real property described 4037 Blair Street, Corona, Riverside County, California and further described as Assessor's Parcel Number 115-232-006 and referred to hereinafter as "THE PROPERTY."

Tiffany N. North, Deputy County Counsel, appeared along with Jim Monroe, Code Enforcement Division Manager, on behalf of the Director of the Code Enforcement Department.

Owners Manuel Aguilar Hernandez and Eloise R. Hernandez spoke with Jim Monroe and Tiffany N. North before the hearing and the abatement process was explained to them. They did not address the Board the Board of Supervisors during the public hearing.

The Board of Supervisors received the Declaration of the Code Enforcement Officer together with attached Exhibits, evidencing the excessive storage of materials and accumulation of rubbish on THE PROPERTY as violations of Riverside County Ordinance Nos. 348 (Riverside County Code

FINDINGS OF FACT, CONCLUSIONS
AND ORDER TO ABAT.

EXHIBIT NO. B

1 Chapter 17.24) and 541 (Riverside County Code Chapter 8.120) and as a public nuisance.

2 **SUMMARY OF EVIDENCE**

3 1. Documents of record in the Riverside County Recorder's Office identify the Owners
4 of THE PROPERTY as Manuel Aguilar Hernandez and Eloise R. Hernandez ("OWNERS").

5 2. Documents of title indicate that another party potentially holds a legal interest in THE
6 PROPERTY, to-wit: Bank of America, NA ("INTERESTED PARTY").

7 3. THE PROPERTY was inspected by Code Enforcement Officers on August 25, 2005,
8 May 3, 2007, May 24, 2007, August 21, 2007, October 31, 2007 and November 19, 2007.

9 4. During each inspection, outside storage of materials in excess of 200 square feet and
10 accumulation of rubbish were observed on THE PROPERTY. The materials included but were not
11 limited to: furniture, appliances, electronics, lumber, auto parts, pipe, drums, machinery, work tools,
12 construction materials, recyclables, and miscellaneous items. The accumulated rubbish consisted of,
13 but not limited to: cans, bottles, litter, green waste, cardboard, scrap metal, tires, auto parks, junked
14 appliances, furniture and miscellaneous debris. The total area of excess outside storage of materials
15 and accumulated rubbish consisted of approximately seven hundred (700) square feet.

16 5. THE PROPERTY was determined to be in violation of Riverside County Ordinance
17 Nos. 348 (RCC Chapter 17.24) and 541 (RCC Chapter 8.120) by the Code Enforcement Officer.

18 6. A Notice of Noncompliance was recorded on May 17, 2007 as Document Number
19 2007-0330325 in the Office of the County Recorder, County of Riverside.

20 7. On August 25, 2005 and May 3, 2007, Notices of Violation were posted on THE
21 PROPERTY. On September 27, 2005, a Notice of Violation was mailed to OWNERS by certified
22 mail, return receipt requested. On July 6, 2007, a Notice of Violation was mailed to OWNERS and
23 INTERESTED PARTY by certified mail, return receipt requested.

24 8. On October 17, 2007, a "Notice To Correct County Ordinance Violations and Abate
25 Public Nuisance" providing notice of the public hearing before the Board of Supervisors on
26 November 20, 2007 was mailed by certified mail, return receipt requested, to THE OWNERS and
27 INTERESTED PARTY and was posted on THE PROPERTY on October 31, 2007.

28

2007-0731249
12/06/2007 08:00A
2 of 4



1 **FINDINGS AND CONCLUSIONS**

2 WHEREFORE, the Board of Supervisors of the County of Riverside, State of California, in
3 regular session assembled on November 20, 2007 finds and concludes that:

4 1. WHEREAS, the excessive outside storage of materials and accumulation of rubbish
5 on the real property located at 4037 Blair Street, Corona, Riverside County, California, also
6 identified as Assessor's Parcel Number 115-232-006 violates Riverside County Ordinance Nos. 348
7 (RCC Chapter 17.24) and 541 (RCC Chapter 8.120) and constitutes a public nuisance. Under
8 Riverside County Ordinance Nos. 348 and 541, no amount of rubbish and no amount of outside
9 storage is allowed to be accumulated on THE PROPERTY.

10 2. WHEREAS, THE OWNERS, occupants or any person having possession or control
11 of the premises should abate the condition by removing and disposing of the excess outside storage
12 of materials and accumulation of rubbish from the subject real property in strict accordance with all
13 Riverside County Ordinances, including but not limited to Riverside County Ordinance Nos. 348
14 (RCC Chapter 17.24) and 541 (RCC Chapter 8.120) within ninety (90) days.

15 3. WHEREAS, THE OWNERS AND INTERESTED PARTY ARE HEREBY
16 FURTHER NOTICED that the time within which judicial review of the administrative
17 determinations made herein must be sought is ninety (90) days from the posting and mailing of the
18 Findings of Fact, Conclusions and Order To Abate Nuisance, and is governed by California Code of
19 Civil Procedure Section 1094.6.

20 **ORDER TO ABATE NUISANCE**

21 IT IS THEREFORE ORDERED that the outside storage of materials and accumulation of
22 rubbish on THE PROPERTY be abated by the OWNERS, specifically Manuel Aguilar Hernandez
23 and Eloise R. Hernandez or anyone having possession or control of THE PROPERTY, by removing
24 all outside storage of materials and removing and disposing of accumulated rubbish from the subject
25 real property in strict accordance with all Riverside County Ordinances, including but not limited to
26 Riverside County Ordinance Nos. 348 (RCC Chapter 17.24) and 541 (RCC Chapter 8.120) within
27 ninety (90) days of the date of this Order to Abate Nuisance.

28 IT IS FURTHER ORDERED that if the materials and rubbish are not removed and disposed

2007-8731249
12/06/2007 08:00F
3 of 4



1 of in strict accordance with all Riverside County Ordinances, including but not limited to Riverside
2 County Ordinance Nos. 348 (RCC Chapter 17.24) and 541 (RCC Chapter 8.120) within ninety (90)
3 days of the date of this Order to Abate Nuisance, the outside storage of materials and accumulation
4 of rubbish shall be abated and disposed of by representatives of the Riverside County Code
5 Enforcement Department, a contractor or the Sheriff's Department upon receipt of an owner's
6 consent or a Court Order when necessary under applicable law.

7 IT IS FURTHER ORDERED that reasonable abatement costs, after notice and opportunity
8 for hearing, shall be imposed as a lien on THE PROPERTY, which may be collected as a special
9 assessment against THE PROPERTY pursuant to Government Code section 25845 and Riverside
10 County Ordinance Nos. 348 (RCC Chapter 17.24), 541 (RCC Chapter 8.120), and 725 (RCC
11 Chapter 1.16). Under Riverside County Ordinance No. 725, "abatement costs" means "any costs or
12 expenses reasonably related to the abatement of conditions which violate County Land Use
13 Ordinances, and shall include, but not be limited to, enforcement, investigation, collection and
14 administrative costs, attorneys fees, and the costs associated with the removal or correction of the
15 violation." Reasonable abatement costs accrued by the Department will be recoverable from the
16 property owner(s) even if THE PROPERTY is brought into compliance within ninety (90) days of
17 the date of this Order to Abate Nuisance.

18 Dated: December 4, 2007

COUNTY OF RIVERSIDE

By 

John Tavaglione
Chairman, Board of Supervisors

19
20
21 ATTEST:

22 NANCY ROMERO

23 Clerk to the Board

24
25 By 

26 Deputy

27 (SEAL)

28
FINDINGS OF FACT, CONCLUSIONS
AND ORDER TO ABATE NUISANCE

2007-0731249
12/06/2007 08:00A
4 of 4



PROOF OF SERVICE

Case No. CV 05-3982

1
2
3
4
5
6
7
8
9
10
11
12
13
14
15
16
17
18
19
20
21
22
23
24
25
26
27
28

STATE OF CALIFORNIA, COUNTY OF RIVERSIDE

I Kimberly Armstrong, the undersigned, declare that I am a citizen of the United States and am employed in the County of Riverside, over the age of 18 years and not a party to the within action or proceeding; that my business address is 3535 Tenth Street, Suite 300, Riverside, California 92501-3674.

That on December 18, 2007, I served the following document(s):

FINDINGS OF FACT, CONCLUSIONS AND ORDER TO ABATE NUISANCE

by placing a true copy thereof enclosed in a sealed envelope(s) addressed as follows:

**OWNERS OR INTERESTED PARTIES
(see attached notice list)**

XX **BY CERTIFIED MAIL, RETURN RECEIPT REQUESTED.** I am "readily familiar" with the office's practice of collection and processing correspondence for mailing. Under that practice it would be deposited with the U.S. Postal Service on that same day with postage thereon fully prepaid at Riverside, California, in the ordinary course of business.

— **BY PERSONAL SERVICE:** I caused to be delivered such envelope(s) by hand to the offices of the addressee(s).

XX **STATE - I declare under penalty of perjury under the laws of the State of California that the above is true and correct.**

— **FEDERAL - I declare that I am employed in the office of a member of the bar of this court at whose direction the service was made.**

EXECUTED ON December 18, 2007, at Riverside, California.

Kimberly Armstrong
KIMBERLY ARMSTRONG

SENDER: COMPLETE THIS SECTION	COMPLETE THIS SECTION ON DELIVERY
<ul style="list-style-type: none"> Complete items 1, 2, and 3. Also complete item 4 if Restricted Delivery is desired. Print your name and address on the reverse so that we can return the card to you. Attach this card to the back of the mailpiece, or on the front if space permits. 	<p>A. Signature <input checked="" type="checkbox"/> <i>Baltazar Hernandez</i> <input type="checkbox"/> Agent <input type="checkbox"/> Addressee</p> <p>B. Received by (Printed Name) <i>BALTAZAR HERNANDEZ</i></p> <p>C. Date of Delivery</p>
<p>1. Article Addressed to:</p> <p>MANUEL AGUILAR HERNANDEZ TRUSTEE C/O MANUEL A HERNANDEZ 1249 RAMON AVENUE SALINAS CA 93906</p> <p>2. Article Number <i>Hernandez EOF8 CV05-3982</i> (Transfer from service label)</p>	<p>D. Is delivery address different from item 1? <input type="checkbox"/> Yes <input type="checkbox"/> No If YES, enter delivery address below:</p> <p>3. Service Type <input checked="" type="checkbox"/> Certified Mail <input type="checkbox"/> Express Mail <input type="checkbox"/> Registered <input checked="" type="checkbox"/> Return Receipt for Merchandise <input type="checkbox"/> Insured Mail <input type="checkbox"/> C.O.D.</p> <p>4. Restricted Delivery? (Extra Fee) <input type="checkbox"/> Yes</p>
7007 2680 0000 4204 5706	

2
B

EXHIBIT NO. B

NOTICE LIST

Subject Property: 4037 Blair Street, Corona
Case No.: CV 05-3982; APN: 115-232-006; District 2

MANUEL A HERNANDEZ
ELOISE R HERNANDEZ
4037 N BLAIR STREET
CORONA CA 91720

MANUEL AGUILAR HERNANDEZ TRUSTEE
C/O MANUEL A HERNANDEZ
1249 RAMON AVENUE
SALINAS CA 93906

MANUEL AGUILAR HERNANDEZ TRUSTEE
4037 BLAIR STREET
CORONA CA 91719

MANUEL AGUILAR HERNANDEZ
C/O WILLIAM F TURNER
ATTORNEY AT LAW
1451 RIMPAU AVENUE SUITE 108
CORONA CA 92879-7521

MANUEL AGUILAR HERNANDEZ
AND ELOISE RAYA HERNANDEZ
4037 BLAIR STREET
CORONA CA 92879

BANK OF AMERICA NA
CUSTOM RECORDING SOLUTIONS
#68249006176299
2550 N REDHILL AVENUE
SANTA ANA CA

MANUAL HERNANDEZ
ELOISE R HERNANDEZ
PO BOX 53
CORONA CA 92878

MANUAL AGUILAR
ELOISE HERNANDEZ
C/O SCOTT EDWARD DARLING
3697 ARLINGTON AVENUE
RIVERSIDE CA 92506-3938

COMPLETE THIS SECTION ON DELIVERY

A. Signature Agent Addressee
Manuel

B. Received by (Printed Name) C. Date of Delivery

D. Is delivery address different from item 1? Yes No
If YES, enter delivery address below:

3. Service Type 92878
 Certified Mail Express Mail
 Registered Return Receipt for Merchandise
 Insured Mail C.O.D.

4. Restricted Delivery? (Extra Fee) Yes No

CORONA CA
JAN - 3 2008

SENDER: COMPLETE THIS SECTION

- Complete items 1, 2, and 3. Also complete item 4 if Restricted Delivery is desired.
- Print your name and address on the reverse so that we can return the card to you.
- Attach this card to the back of the mailpiece, or on the front if space permits.

1. Article Addressed to:
MANUAL HERNANDEZ
ELOISE R HERNANDEZ
PO BOX 53
CORONA CA 92878

2. Article Number
Hernandez for CV 05-3982

(Transfer from service label)

7007 2680 0000 3828 5079

PS Form 3811, February 2004
Domestic Return Receipt
102595-02-M

EXHIBIT NO. B³

HERNANDEZ

Subject Property: 4037 Blair Street, Corona
Case No.: CV 05-3982; APN: 115-232-006; District 2

SENDER: COMPLETE THIS SECTION

- Complete items 1, 2, and 3. Also complete item 4 if Restricted Delivery is desired.
- Print your name and address on the reverse so that we can return the card to you.
- Attach this card to the back of the mailpiece, or on the front if space permits.

1. Article Addressed to:
 MANUEL AGUILAR HERNANDEZ TRUSTEE
 4037 BLAIR STREET
 CORONA CA 91719

2. Article Number
Hernandez F08 CV05-3982
 7007 2680 0000 4204 5663
 (Transfer from service label)

PS Form 3811, February 2004 Domestic Return Receipt 102595-02-M-1540

COMPLETE THIS SECTION ON DELIVERY

A. Signature Agent
 Addressee
 Received by (Printed Name) *Manuel Hernandez* C. Date of Delivery *12-19-07*

D. Is delivery address different from item 1? Yes
 If YES, enter delivery address below: No

3. Service Type
 Certified Mail Express Mail
 Registered Return Receipt for Merchandise
 Insured Mail C.O.D.

4. Restricted Delivery? (Extra Fee) Yes

SENDER: COMPLETE THIS SECTION

- Complete items 1, 2, and 3. Also complete item 4 if Restricted Delivery is desired.
- Print your name and address on the reverse so that we can return the card to you.
- Attach this card to the back of the mailpiece, or on the front if space permits.

1. Article Addressed to:
 MANUEL AGUILAR HERNANDEZ
 AND ELOISE RAYA HERNANDEZ
 4037 BLAIR STREET
 CORONA CA 92879

2. Article Number
Hernandez F08 CV05-3982
 7007 2680 0000 4204 5669
 (Transfer from service label)

PS Form 3811, February 2004 Domestic Return Receipt 102595-02-M-1540

COMPLETE THIS SECTION ON DELIVERY

A. Signature Agent
 Addressee
 Received by (Printed Name) *Manuel Hernandez* C. Date of Delivery *12-19-07*

D. Is delivery address different from item 1? Yes
 If YES, enter delivery address below: No

3. Service Type
 Certified Mail Express Mail
 Registered Return Receipt for Merchandise
 Insured Mail C.O.D.

4. Restricted Delivery? (Extra Fee) Yes

SENDER: COMPLETE THIS SECTION

- Complete items 1, 2, and 3. Also complete item 4 if Restricted Delivery is desired.
- Print your name and address on the reverse so that we can return the card to you.
- Attach this card to the back of the mailpiece, or on the front if space permits.

1. Article Addressed to:
 MANUAL AGUILAR
 ELOISE HERNANDEZ
 C/O SCOTT EDWARD DARLING
 3697 ARLINGTON AVENUE
 RIVERSIDE CA 92506-3938

2. Article Number
Hernandez F08 CV05-3982
 7007 2680 0000 3828 5062
 (Transfer from service label)

PS Form 3811, February 2004 Domestic Return Receipt 102595-02-M-1540

COMPLETE THIS SECTION ON DELIVERY

A. Signature Agent
 Addressee
 Received by (Printed Name) *[Signature]* C. Date of Delivery

D. Is delivery address different from item 1? Yes
 If YES, enter delivery address below: No

3. Service Type
 Certified Mail Express Mail
 Registered Return Receipt for Merchandise
 Insured Mail C.O.D.

4. Restricted Delivery? (Extra Fee) Yes

EXHIBIT NO. ⁴B

HERNANDEZ

Subject Property: 4037 Blair Street, Corona
Case No.: CV 05-3982; APN: 115-232-006; District 2

SENDER: COMPLETE THIS SECTION		COMPLETE THIS SECTION ON DELIVERY	
<p>1. Article Addressed to:</p> <p>BANK OF AMERICA NA CUSTOM RECORDING SOLUTIONS #68249006176299 2550 N REDHILL AVENUE SANTA ANA CA</p>		<p>A. Signature <input checked="" type="checkbox"/> Agent <input type="checkbox"/> Addressee</p>	
<p>2. Article Number <i>Hernandez FOF 8 CV05-3982</i></p> <p>(Transfer from service label)</p>		<p>B. Received by (Printed Name) STEVE FISHEL</p> <p>C. Date of Delivery 12/19/07</p>	
<p>3. Service Type <input checked="" type="checkbox"/> Certified Mail <input type="checkbox"/> Registered <input type="checkbox"/> Insured Mail <input type="checkbox"/> Express Mail <input checked="" type="checkbox"/> Return Receipt for Merchandise <input type="checkbox"/> C.O.D.</p>		<p>D. Is delivery address different from item 1? <input type="checkbox"/> Yes If YES, enter delivery address below: <input type="checkbox"/> No</p>	
<p>4. Restricted Delivery? (Extra Fee) <input type="checkbox"/> Yes</p>		<p>7007 2680 0000 3828 5086</p> <p>102595-02-M-1540</p>	

SENDER: COMPLETE THIS SECTION		COMPLETE THIS SECTION ON DELIVERY	
<p>1. Article Addressed to:</p> <p>MANUEL AGUILAR HERNANDEZ C/O WILLIAM F TURNER ATTORNEY AT LAW 1451 RIMPAU AVENUE SUITE 108 CORONA CA 92879-7521</p>		<p>A. Signature <input checked="" type="checkbox"/> Agent <input type="checkbox"/> Addressee</p>	
<p>2. Article Number <i>Hernandez FOF 8 CV05-3982</i></p> <p>(Transfer from service label)</p>		<p>B. Received by (Printed Name) ERIKY TURNER</p> <p>C. Date of Delivery 12/19</p>	
<p>3. Service Type <input checked="" type="checkbox"/> Certified Mail <input type="checkbox"/> Registered <input type="checkbox"/> Insured Mail <input type="checkbox"/> Express Mail <input checked="" type="checkbox"/> Return Receipt for Merchandise <input type="checkbox"/> C.O.D.</p>		<p>D. Is delivery address different from item 1? <input type="checkbox"/> Yes If YES, enter delivery address below: <input checked="" type="checkbox"/> No</p>	
<p>4. Restricted Delivery? (Extra Fee) <input type="checkbox"/> Yes</p>		<p>7007 2680 0000 4204 5676</p> <p>102595-02-M-1540</p>	

SENDER: COMPLETE THIS SECTION	
<p>1. Article Addressed to:</p> <p>MANUEL A HERNANDEZ ELOISE R HERNANDEZ 4037 N BLAIR STREET CORONA CA 91720</p>	
<p>2. Article Number <i>Hernandez FOF 8 CV05-3982</i></p> <p>(Transfer from service label)</p>	
<p>7007 2680 0000 4204 5690</p>	

COMPLETE THIS SECTION ON DELIVERY	
<p>A. Signature <input checked="" type="checkbox"/> Agent <input type="checkbox"/> Addressee</p>	
<p>B. Received by (Printed Name) Manuel Hernandez</p> <p>C. Date of Delivery 12-19-07</p>	
<p>D. Is delivery address different from item 1? <input type="checkbox"/> Yes If YES, enter delivery address below: <input type="checkbox"/> No</p>	
<p>3. Service Type <input checked="" type="checkbox"/> Certified Mail <input type="checkbox"/> Registered <input type="checkbox"/> Insured Mail <input type="checkbox"/> Express Mail <input checked="" type="checkbox"/> Return Receipt for Merchandise <input type="checkbox"/> C.O.D.</p>	
<p>4. Restricted Delivery? (Extra Fee) <input type="checkbox"/> Yes</p>	

3

EXHIBIT NO.

COUNTY OF RIVERSIDE
CODE ENFORCEMENT DEPARTMENT
TRANSPORTATION AND LAND MANAGEMENT AGENCY

JAYE. ORR
Director

MICHAEL O'CONNOR
Deputy Director

AFFIDAVIT OF POSTING OF NOTICES

Case No: CV053982

I, Diana Parra the undersigned, hereby declare:

1. I am employed by the Riverside County Code Enforcement Department; that my business address is:

County of Riverside
Code Enforcement Department
P.O. Box 1592
Riverside CA. 92502

2. That on December 28, 2007. I securely and conspicuously posted Findings of Fact, Conclusions and Order to Abate Nuisance at the property described as:

Property Address: 4037 Blair St., Corona
Assessor's Parcel Number: 115-232-006

I declare under the penalty of perjury that the foregoing is true and correct.

Executed at Corona, California.

CODE ENFORCEMENT DEPARTMENT

By: 
Diana Parra, Code Enforcement Officer III

EXHIBIT NO. B⁶

When recorded please mail to:
2135

DOC # 2007-0330325

05/17/2007 08:00A Fee:NC

Page 1 of 1

Recorded in Official Records

County of Riverside

Larry W. Ward

Assessor, County Clerk & Recorder



S	R	U	PAGE	SIZE	DA	MISC	LONG	RFD	COPY
									1
M	A	L	465	426	PCOR	NCOR	SMF	NCHG	EXAM 023

1

NOTICE OF NONCOMPLIANCE

M
023

In the matter of the Property of
MANUEL AGUILAR HERNANDEZ
ELOISE R. HERNANDEZ

)
)

Case No. CV05-3982

NOTICE IS HEREBY GIVEN to all persons, pursuant to Section 10 of Ordinance Number 725 of the County of Riverside, State of California, that proceedings have been commenced with respect to violations of Riverside County Ordinance No.348 & 541, (RCC Title 17.24.010 & 8.120.010) described as EXCESSIVE OUTSIDE STORAGE & ACCUMULATED RUBBISH. Such Proceedings are based upon the noncompliance of such real property, located at 4037 BLAIR ST., CORONA, CA, and more particularly described as Assessor's Parcel Number 115-232-006 and having a legal description of BLOCK D LOT 7, RIVERSIDE VALLEY HOME GARDENS, T3SR6W SEC 29, MB 11/88, Records of Riverside County, with the requirements of Ordinance No. 348 & 541 (RCC Title 17.24.010 & 8.120.010).

The owner has been advised to immediately correct the above-referenced violations to avoid further action by the County of Riverside which may include demolition, removal, razing, etc., to abate the public nuisance. Any costs incurred by the County, including, but not limited to investigative, administrative and abatement costs and attorneys' fees, may become a lien on the property. Further details regarding this notice may be obtained by addressing an inquiry to the Code Enforcement Department, 5317 Mission Blvd., Riverside, CA 92507, Attention Code Enforcement Officer J. PALMER (951) 275-8739.

NOTICE IS FURTHER GIVEN in accordance with §17274 and §24436.5 of the California Revenue and Taxation Code, that a tax deduction may not be allowed for interest, taxes, depreciation, or amortization paid or incurred in the taxable year affected by these proceedings.

COUNTY OF RIVERSIDE
DEPARTMENT OF CODE ENFORCEMENT

By Candace O'Gara
Candace O'Gara
Code Enforcement Department

ACKNOWLEDGMENT

State of California)
County of Riverside)

On 5/10/07 before me, Marcella Villanueva, Notary Public, personally appeared Candace O'Gara, personally known to me (or proved to me on the basis of satisfactory evidence) to be the person(s) whose name(s) is/are subscribed to the within instrument and acknowledged to me that ~~he/she/they~~ executed the same in ~~his/her/their~~ authorized capacity(ies), and that by ~~his/her/their~~ signature(s) on the instrument the person(s), or the entity upon behalf of which the person(s) acted, executed the instrument.

WITNESS my hand and official seal.

Manuel Hernandez



Public Record

Assessment Roll For the 2009-2010 Tax Year as of January 1,2009

Assessment #115232006-2		Parcel # 115232006-2	
Assessee:	HERNANDEZ MANUEL AGUILAR	Land	9,475
Assessee:	HERNANDEZ ELOISE R	Structure	11,022
Mail Address:	4037 BLAIR ST CORONA CA 92879	Full Value	20,497
Real Property Use Code:	R1	Homeowners' Exemption	7,000
Base Year	1975	Total Net	13,497
Conveyance Number:	0653426		
Conveyance (mm/yy):	10/2007		
TRA:	59-004		
Taxability Code:	0-00		
ID Data:	Lot 7 MB 011/088 RIVERSIDE VALLEY HOME GARDENS		
Situs Address:	4037 BLAIR ST CORONA CA 92879		

View Parcel Map

This must be in red to be a
"CERTIFIED COPY"

I hereby certify the foregoing instrument to which this stamp has been affixed consisting of 1 pages to be a full, true and correct copy of the original on file and of record in my office.

Larry W. Ward
Assessor - County Clerk - Recorder
County of Riverside, State of California

MAR 08 2010

Dated _____



Certification must be in red to be a
"CERTIFIED COPY"

EXHIBIT NO. D

RIVERSIDE COUNTY GIS

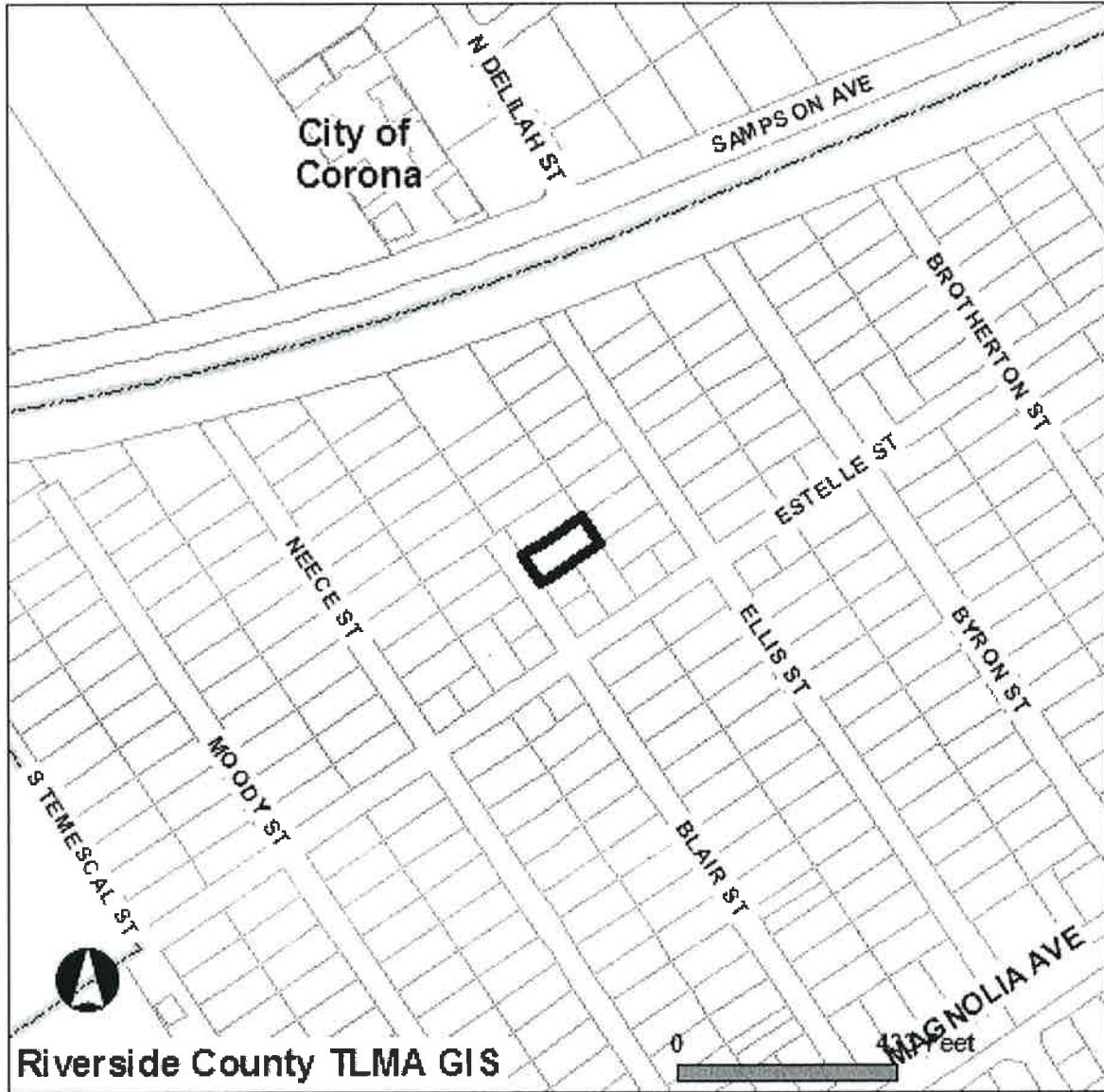

Selected parcel(s):
115-232-006

IMPORTANT

Maps and data are to be used for reference purposes only. Map features are approximate, and are not necessarily accurate to surveying or engineering standards. The County of Riverside makes no warranty or guarantee as to the content (the source is often third party), accuracy, timeliness, or completeness of any of the data provided, and assumes no legal responsibility for the information contained on this map. Any use of this product with respect to accuracy and precision shall be the sole responsibility of the user.

STANDARD REPORT

APNs

115-232-006-2

OWNER NAME / ADDRESS

MANUEL AGUILAR HERNANDEZ
ELOISE HERNANDEZ
4037 BLAIR ST
CORONA, CA. 92879

MAILING ADDRESS

(SEE OWNER)
4037 BLAIR ST
CORONA CA.. 92879

EXHIBIT NO. D²

LEGAL DESCRIPTION

RECORDED BOOK/PAGE: MB 11/88
SUBDIVISION NAME: RIVERSIDE VALLEY HOME GARDENS
LOT/PARCEL: 7, BLOCK:
TRACT NUMBER: NOT AVAILABLE

LOT SIZE

RECORDED LOT SIZE IS 0.22 ACRES

PROPERTY CHARACTERISTICS

WOOD FRAME, 616 SQFT., 2 BDRM/ 0.75 BATH, 1 STORY, CONST'D 1947COMPOSITION, ROOF

THOMAS BROS. MAPS PAGE/GRID

PAGE: 743 GRID: H5

CITY BOUNDARY/SPHERE

NOT WITHIN A CITY
CITY SPHERE: CORONA
ANNEXATION DATE: MAY. 25, 2006
LAFCO CASE #: 2005-15-1&2
NO PROPOSALS

MARCH JOINT POWERS AUTHORITY

NOT IN THE JURISDICTION OF THE MARCH JOINT POWERS AUTHORITY

INDIAN TRIBAL LAND

NOT IN A TRIBAL LAND

SUPERVISORIAL DISTRICT (ORD. 813)

JOHN TAVAGLIONE, DISTRICT 2

TOWNSHIP/RANGE

T3SR6W SEC 29

ELEVATION RANGE

662 FEET

PREVIOUS APN

064-600-060

PLANNING

LAND USE DESIGNATIONS

Zoning not consistent with the General Plan.
MDR

AREA PLAN (RCIP)

TEMESCAL CANYON

GENERAL PLAN POLICY OVERLAYS

NOT IN A GENERAL PLAN POLICY OVERLAY AREA

GENERAL PLAN POLICY AREAS

NONE

ZONING CLASSIFICATIONS (ORD. 348)

R-1

ZONING DISTRICTS AND ZONING AREAS

EAST CORONA DISTRICT

ZONING OVERLAYS

NOT IN A ZONING OVERLAY

SPECIFIC PLANS

NOT WITHIN A SPECIFIC PLAN

AGRICULTURAL PRESERVE

NOT IN AN AGRICULTURAL PRESERVE

REDEVELOPMENT AREAS

NOT IN A REDEVELOPMENT AREA

AIRPORT INFLUENCE AREAS

NOT IN AN AIRPORT INFLUENCE AREA

AIRPORT COMPATIBILITY ZONES
NOT IN AN AIRPORT COMPATIBILITY ZONE

ENVIRONMENTAL

CVMSHCP (COACHELLA VALLEY MULTI-SPECIES HABITAT CONSERVATION PLAN) CONSERVATION AREA
NOT IN A CONSERVATION AREA**CVMSHCP FLUVIAL SAND TRANSPORT SPECIAL PROVISION AREAS**
NOT IN A FLUVIAL SAND TRANSPORT SPECIAL PROVISION AREA**WRMSHCP (WESTERN RIVERSIDE COUNTY MULTI-SPECIES HABITAT CONSERVATION PLAN) CELL GROUP**
NOT IN A CELL GROUP**WRMSHCP CELL NUMBER**
NOT IN A CELL**HANS/ERP (HABITAT ACQUISITION AND NEGOTIATION STRATEGY/EXPEDITED REVIEW PROCESS)**
NONE**VEGETATION (2005)**
Developed/Disturbed Land

FIRE

HIGH FIRE AREA (ORD. 787)
NOT IN A HIGH FIRE AREA**FIRE RESPONSIBILITY AREA**
NOT IN A FIRE RESPONSIBILITY AREA

DEVELOPMENT FEES

CVMSHCP FEE AREA (ORD. 875)
NOT WITHIN THE COACHELLA VALLEY MSHCP FEE AREA**WRMSHCP FEE AREA (ORD. 810)**
IN OR PARTIALLY WITHIN THE WESTERN RIVERSIDE MSHCP FEE AREA. SEE MAP FOR MORE INFORMATION.**ROAD & BRIDGE DISTRICT**
NOT IN A DISTRICT**EASTERN TUMF (TRANSPORTATION UNIFORM MITIGATION FEE ORD. 673)**
NOT WITHIN THE EASTERN TUMF FEE AREA**WESTERN TUMF (TRANSPORTATION UNIFORM MITIGATION FEE ORD. 824)**
IN OR PARTIALLY WITHIN A TUMF FEE AREA. SEE MAP FOR MORE INFORMATION. NORTHWEST**DIF (DEVELOPMENT IMPACT FEE AREA ORD. 659)**
TEMESCAL CANYON**SKR FEE AREA (STEPHEN'S KANGAROO RAT ORD. 663.10)**
NOT WITHIN AN SKR FEE AREA.**DEVELOPMENT AGREEMENTS**
NOT IN A DEVELOPMENT AGREEMENT AREA

TRANSPORTATION

CIRCULATION ELEMENT ULTIMATE RIGHT-OF-WAY
NOT IN A CIRCULATION ELEMENT RIGHT-OF-WAY**ROAD BOOK PAGE**
22**TRANSPORTATION AGREEMENTS**
NOT IN A TRANSPORTATION AGREEMENT**CETAP (COMMUNITY AND ENVIRONMENTAL TRANSPORTATION ACCEPTABILITY PROCESS) CORRIDORS**

NOT IN A CETAP CORRIDOR.

HYDROLOGY

FLOOD PLAIN REVIEW

NOT REQUIRED.

WATER DISTRICT

WMWD

FLOOD CONTROL DISTRICT

RIVERSIDE COUNTY FLOOD CONTROL DISTRICT

WATERSHED

SANTA ANA RIVER

GEOLOGIC

FAULT ZONE

NOT IN A FAULT ZONE

FAULTS

NOT WITHIN A 1/2 MILE OF A FAULT

LIQUEFACTION POTENTIAL

HIGH

SUBSIDENCE

SUSCEPTIBLE

PALEONTOLOGICAL SENSITIVITY

HIGH SENSITIVITY (HIGH A).

BASED ON GEOLOGIC FORMATIONS OR MAPPABLE ROCK UNITS THAT ARE ROCKS THAT CONTAIN FOSSILIZED BODY ELEMENTS, AND TRACE FOSSILS SUCH AS TRACKS, NESTS AND EGGS. THESE FOSSILS OCCUR ON OR BELOW THE SURFACE.

MISCELLANEOUS

SCHOOL DISTRICT

CORONA-NORCO UNIFIED

COMMUNITIES

HOME GARDENS

COUNTY SERVICE AREA

IN OR PARTIALLY WITHIN
HOME GARDENS #52 -
NO SERVICE INFORMATION

LIGHTING (ORD. 655)

NOT APPLICABLE, 52.47 MILES FROM MT. PALOMAR OBSERVATORY

2000 CENSUS TRACT

041410

FARMLAND

URBAN-BUILT UP LAND

TAX RATE AREAS

059-004

- CORONA NORCO UNIFIED SCHOOL
- COUNTY FREE LIBRARY
- COUNTY SERVICE AREA 52 *
- COUNTY STRUCTURE FIRE PROTECTION
- COUNTY WASTE RESOURCE MGMT DIST
- CSA 152
- FLOOD CONTROL ADMINISTRATION
- FLOOD CONTROL ZONE 1
- FLOOD CONTROL ZONE 1 DEBT SERV
- GENERAL
- GENERAL PURPOSE
- HOME GARDENS CO WATER
- HOME GARDENS SANITARY

- METRO WATER WEST 1302999
- N.W. MOSQUITO & VECTOR CONT DIST
- RIV CO REG PARK & OPEN SPACE
- RIV. CO. OFFICE OF EDUCATION
- RIVERSIDE CITY COMMUNITY COLLEGE
- WESTERN MUNICIPAL WATER

SPECIAL NOTES
NO SPECIAL NOTES

CODE COMPLAINTS

Case #	Description	Start Date
CP0900205	Community Improvement	Aug. 18, 2009

REPORT PRINTED ON...Thu Mar 04 15:00:00 2010