

**SUBMITTAL TO THE BOARD OF SUPERVISORS
COUNTY OF RIVERSIDE, STATE OF CALIFORNIA**

610B



FROM: County Counsel
Code Enforcement Department

SUBMITTAL DATE:
April 22, 2010

SUBJECT: Statement of Expense [Case No. CV 06-4116]
Subject Property: 4868 Etiwanda Ave., Mira Loma; DECAMP
APN: 159-101-034
District Two

RECOMMENDED MOTION: Move that the Board of Supervisors:

- (1) assess the reasonable costs of abatement of a public nuisance (excess outside storage of materials and accumulated rubbish) in the above-referenced matter to be two thousand, two hundred, eighty-five dollars and thirty-four cents (US \$2,285.34);
- (2) assess the costs of abatement against the above-described subject property;
- (3) authorize the recordation of a notice of abatement lien; and
- (4) authorize the abatement costs to be added to the tax roll as a special assessment

BACKGROUND: Government Code § 25845, Riverside County Ordinance Nos. 348 (RCC Title 17), 541(RCC Chapter 8.120) and 725 (RCC Chapter 1.16) authorize the recovery of abatement costs in public nuisance cases, the recordation of a notice of abatement lien and inclusion of abatement costs on the tax roll as a special assessment upon approval of the Board of Supervisors.

[Signature]

JULIE A. JARVI, Deputy County Counsel
for PAMELA J. WALLS, County Counsel

(Continued)

FINANCIAL DATA	Current F.Y. Total Cost:	\$ N/A	In Current Year Budget:	N/A
	Current F.Y. Net County Cost:	\$ N/A	Budget Adjustment:	N/A
	Annual Net County Cost:	\$ N/A	For Fiscal Year:	N/A

SOURCE OF FUNDS:	Positions To Be Deleted Per A-30	<input type="checkbox"/>
	Requires 4/5 Vote	<input type="checkbox"/>

C.E.O. RECOMMENDATION: APPROVE

BY: *[Signature]*
Tina Grande

County Executive Office Signature

MINUTES OF THE BOARD OF SUPERVISORS

On motion of Supervisor Tavaglione, seconded by Supervisor Stone and duly carried by unanimous vote, IT WAS ORDERED that the above matter is approved as recommended.

Ayes: Buster, Tavaglione, Stone, Benoit and Ashley
Nays: None
Absent: None
Date: May 4, 2010
xc: Co. Co., CED, Prop. Owner

Kecia Harper-Ihem
Clerk of the Board
By: *[Signature]*
Deputy

Prev. Agn. Ref.:

District: 2

Agenda Number:

9.11

Policy
 Consent
 Policy
 Consent

 Dep't Recomm.:
 Per Exec. Ofc.:

Environmental Concerns

Statement of Expense [Case No. CV 06-4116]
Subject Property: 4868 Etiwanda Ave., Mira Loma; DECAMP
APN: 159-101-034
District Two

The Board of Supervisors issued an Order to Abate in this case on February 27, 2007. Subsequently, the property owner brought the property into compliance.

The Notice of Hearing re Statement of Expense has been posted on the property and mailed to the property owner and all interested parties, as required by law. Copies of all relevant notices issued in this matter together with proof of service and posting have been separately filed with the Clerk of the Board and are made a part of the record herein, pursuant to Riverside County Ordinance 725.

PAMELA J. WALLS
County Counsel

Principal Deputy
KATHERINE A. LIND

OFFICE OF COUNTY COUNSEL
COUNTY OF RIVERSIDE

3960 ORANGE STREET, 5TH FLOOR
RIVERSIDE, CA 92501
TELEPHONE: 951/955-6300
FAX: 951/955-6322 & 955-6363



March 18, 2010

**NOTICE OF HEARING
RE: STATEMENT OF EXPENSE**

To: Owner(s) or Interested Parties
(See Attached Proof of Service
and Notice List)

Subject Property: 4868 Etiwanda Ave., Mira Loma
Case No.: CV 06-4116; DECAMP
APN: 159-101-034

NOTICE IS HEREBY GIVEN that a hearing will be held before the Riverside County Board of Supervisors on **Tuesday, May 4, 2010, at 9:30 a.m.** in the Board of Supervisors Room, 4080 Lemon Street, 1st Floor Annex, Riverside, California, at which time and place pertinent testimony will be heard regarding the expenses incurred by the County of Riverside, Code Enforcement Department ("DEPARTMENT") for the above-referenced abatement case. Said abatement case involved accumulated rubbish and excessive outside storage located on your real property commonly described as 4868 Etiwanda Ave., Mira Loma, Riverside County, California and more particularly described as Assessor's Parcel Number 159-101-034.

The total expense due, including all other fees and costs, for the abatement of the above-described dangerous or injurious condition is **two thousand, two hundred, eighty-five dollars and thirty-four cents (US \$2,285.34)**. This amount is immediately due and payable. If you have any objections to the Statement of Expense attached hereto, you must address your objections to the Board of Supervisors at the hearing. If you have any questions about the attached Statement of Expense or would like to see additional documents in support of costs set forth on the Statement of Expense Worksheet, please contact the undersigned at (951) 955-6300. In the event the total amount due is not paid to the DEPARTMENT prior to the Board Hearing, the DEPARTMENT shall seek an order from the Board of Supervisors to place a lien against your property and collect the amount due as a special tax assessment.

Failure to appear at the hearing will result in the exclusion of your testimony and facts as known to the DEPARTMENT will be presented to the Board of Supervisors for their final consideration and deliberation of this matter.

You are encouraged to contact Supervising Code Enforcement Officer, Brian Black (951) 955-2004 prior to the hearing. Please meet with the undersigned or Brian Black at 8:30 a.m. on the day of the hearing in the lobby of the 1st floor annex in front of the Clerk of the Board's Office to discuss the case.

PAMELA J. WALLS
County Counsel



JULIE A. JARVI
Deputy County Counsel

Enclosure: Statement of Expense

MAY 04 2010 9.11



COUNTY OF RIVERSIDE

Code Enforcement Administration

STATEMENT OF EXPENSE WORKSHEET



CASE NUMBER: CV06-4116

OWNER: MELVIN L DECAMP & CAROL DECAMP

SITUS: 4868 ETIWANDA AVE, MIRA LOMA, CA. 91752

APN: 159-101-034

SUPERVISORIAL DISTRICT: 2

AUTHORITY: RIVERSIDE COUNTY ORDINANCE NO(s).
348 (RCC Title 17), 541 (RCC Title 8) & 725 (RCC Chapter 1.16)

Code Enforcement Department Billable Rates: Effective June 21, 2007 (Riverside County Ordinance 725.12)

SUPER-SUPERVISING CODE ENFORCEMENT OFFICER	\$130.00/HR
SENIOR-SENIOR CODE ENFORCEMENT OFFICER	\$129.00/HR
OFFICER- CODE ENFORCEMENT OFFICER II	\$109.00/HR
TECH- CODE ENFORCEMENT TECHNICIAN	\$82.00/HR

<u>DATE</u>	<u>DESCRIPTION</u>	<u>HOURS</u>	<u>AMOUNT</u>
08/18/06 to 11/19/07	CV06-4116: Officers- Palmer J / Engleking, T / Pollard, B - Field Investigation/File Maintenance	10.8	\$1,163.40
02/11/10	Prepare/Attend Statement of Expense Hearing	0.5	\$65.00
SUBTOTAL CODE ENFORCEMENT COSTS			\$1,228.40
11/17/06 - 02/13/07	COUNTY COUNSEL- LEGAL CONSULTATION SERVICES-Includes Administrative Costs	17.3	\$847.94
09/30/06	CONTRACTOR SERVICES- Optima Information Services - Lot Book Report		\$95.00
03/08/10	Lot/Title Report		\$114.00
TOTAL COSTS DUE			\$2,285.34

I affirm and declare under penalty of perjury under the laws of the State of California that the foregoing is true and correct.

Executed this 17th day of March, 2010, at Riverside, California.

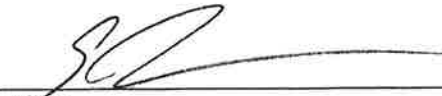

 Cuong Pham
 Code Enforcement Department

NOTICE LIST

Subject Property: 4868 Etiwanda Ave., Mira Loma; Case No.: CV 06-4116;
APN: 159-101-034; District Two

Office of County Counsel
3960 Orange Street, 5th Floor
Riverside, CA 92501

CERTIFIED MAIL

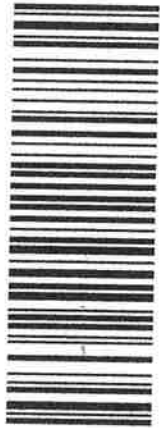

7009 3410 0000 1317 5676

UNITED STATES POSTAGE
PITNEY BOWES
02 1P
0003958246 MAR 18 2010
MAILED FROM ZIP CODE 92501
\$ 005.540

MELVIN L DECAMP
CAROL A DECAMP
4868 ETIWANDA AVE
MIRA LOMA

NIXIE

217 RE 1

00 09/22/10

NOT DELIVERABLE TO ADDRESSEE
RETURN TO SENDER
UNABLE TO FORWARD

BC: 92501364405

*0904-17175-18-36



MELVIN L DECAMP
CAROL A DECAMP
10453 N LYNN CIRCLE
APARTMENT B
MIRA LOMA CA 91752

MELVIN L DECAMP
CAROL A DECAMP
4868 ETIWANDA AVE
MIRA LOMA CA 91752

JIM BROOKS
PO BOX 1028
SEAGRAVES TX 79359

NOTICE LIST

Subject Property: 4868 Etiwanda Ave., Mira Loma; Case No.: CV 06-4116;
APN: 159-101-034; District Two

Office of County Counsel
3960 Orange Street, 5th Floor
Riverside, CA 92501

CERTIFIED MAIL



7009 3410 0000 1317 5669

ANK

JIM BROOKS
PO BOX 1028
SEAGRAVES TX 79359



UNITED STATES POSTAGE
PITNEY BOWES
02 1P \$005.540
0003958246 MAR 18 2010
MAILED FROM ZIP CODE 92501

MP

NIXIE 780 SE 1 00 03/23/10

RETURN TO SENDER
ATTEMPTED - NOT KNOWN
UNABLE TO FORWARD

7935981028

9250103644

BC: 92501364405 *0904-14823-10-36



RP

PROOF OF SERVICE

Case No. CV 06-4116

1
2
3
4
5
6
7
8
9
10
11
12
13
14
15
16
17
18
19
20
21
22
23
24
25
26
27
28

STATE OF CALIFORNIA, COUNTY OF RIVERSIDE

I, Brenda G. Peeler, declare that I am a citizen of the United States and am employed in the County of Riverside, over the age of 18 years and not a party to the within action or proceeding; that my business address is 3960 Orange Street, 5th Floor, Riverside, California 92501.

That on March 18, 2010, I served the following document(s):

- NOTICE OF HEARING RE: STATEMENT OF EXPENSE
- STATEMENT OF EXPENSE WORKSHEET

by placing a true copy thereof enclosed in a sealed envelope(s) addressed as follows:

**OWNERS OR INTERESTED PARTIES
(SEE NOTICE LIST ATTACHED TO NOTICE OF HEARING)**

XX **BY CERTIFIED MAIL, RETURN RECEIPT REQUESTED.** I am "readily familiar" with the office's practice of collection and processing correspondence for mailing. Under that practice it would be deposited with the U.S. Postal Service on that same day with postage thereon fully prepaid at Riverside, California, in the ordinary course of business.

 BY PERSONAL SERVICE: I caused to be delivered such envelope(s) by hand to the offices of the addressee(s).

XX **STATE - I declare under penalty of perjury under the laws of the State of California that the above is true and correct.**

 FEDERAL - I declare that I am employed in the office of a member of the bar of this court at whose direction the service was made.

EXECUTED ON March 18, 2010, at Riverside, California.

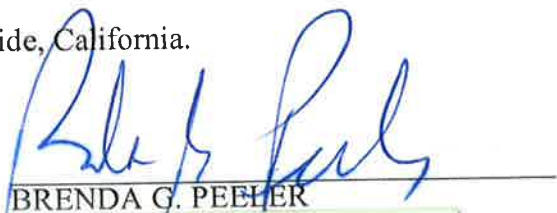
BRENDA G. PEELER

SENDER: COMPLETE THIS SECTION	COMPLETE THIS SECTION ON DELIVERY
<ul style="list-style-type: none"> ■ Complete items 1, 2, and 3. Also complete item 4 if Restricted Delivery is desired. ■ Print your name and address on the reverse so that we can return the card to you. ■ Attach this card to the back of the mailpiece, or on the front if space permits. 	A. Signature <input checked="" type="checkbox"/> Agent <input checked="" type="checkbox"/> Addressee
1. Article Addressed to: MELVIN L DECAMP CAROL A DECAMP 10453 N LYNN CIRCLE APARTMENT B MIRA LOMA CA 91752	B. Received by (Printed Name) CAROL DE CAMP-19 C. Date of Delivery
2. Article Number (Transfer from service label)	D. Is delivery address different from item 1? <input type="checkbox"/> Yes If YES, enter delivery address below: <input type="checkbox"/> No 3. Service Type <input checked="" type="checkbox"/> Certified Mail <input type="checkbox"/> Express Mail <input type="checkbox"/> Registered <input checked="" type="checkbox"/> Return Receipt for Merchandise <input type="checkbox"/> Insured Mail <input type="checkbox"/> C.O.D. 4. Restricted Delivery? (Extra Fee) <input type="checkbox"/> Yes
7009 3410 0000 1317 5683	



**CODE ENFORCEMENT DEPARTMENT
COUNTY OF RIVERSIDE**

JOHN BOYD
Director

AFFIDAVIT OF POSTING OF NOTICES

March 19, 2010

RE CASE NO: CV064116

I, Michael Romero, hereby declare:

I am employed by the Riverside County Code Enforcement Department; that my business address is 5317 Mission Blvd, Riverside, California 92502-1592 .

That on 3/19/10 at 9:50 am, I securely and conspicuously posted Notice of Hearing at the property described as:

Property Address: 4868 ETIWANDA AVE, MIRA LOMA

Assessor's Parcel Number: 159-101-034

I declare under the penalty of perjury that the foregoing is true and correct.

Executed on March 19, 2010 in the County of Riverside, California.

CODE ENFORCEMENT DEPARTMENT

By: Michael Romero, Code Enforcement Officer

**SUBMITTAL TO THE BOARD OF SUPERVISORS
COUNTY OF RIVERSIDE, STATE OF CALIFORNIA**

FROM: County Counsel
Code Enforcement Department
SUBJECT: Statement of Expense [Case No. CV 06-4116]
Subject Property: 4868 Etiwanda Ave., Mira Loma; DECAMP
APN: 159-101-034
District Two

**TABLE OF SUPPLEMENTAL DOCUMENTS
FILED WITH THE CLERK OF THE BOARD**

Hearing Date: May 4, 2010

Statement of Expense, including Supporting Documentation	Exhibit A
Findings of Fact	Exhibit B
Notice of Noncompliance	Exhibit C
Assessment-Roll For The Year 09/10 And Geographic Information System, March 4, 2010	Exhibit D



COUNTY OF RIVERSIDE

Code Enforcement Administration

STATEMENT OF EXPENSE WORKSHEET



CASE NUMBER: CV06-4116

OWNER: MELVIN L DECAMP & CAROL DECAMP

SITUS: 4868 ETIWANDA AVE, MIRA LOMA, CA. 91752

APN: 159-101-034

SUPERVISORIAL DISTRICT: 2

AUTHORITY: RIVERSIDE COUNTY ORDINANCE NO(s).
348 (RCC Title 17), 541 (RCC Title 8) & 725 (RCC Chapter 1.16)

Code Enforcement Department Billable Rates: Effective June 21, 2007 (Riverside County Ordinance 725.12)

SUPER-SUPERVISING CODE ENFORCEMENT OFFICER	\$130.00/HR
SENIOR-SENIOR CODE ENFORCEMENT OFFICER	\$129.00/HR
OFFICER- CODE ENFORCEMENT OFFICER II	\$109.00/HR
TECH- CODE ENFORCEMENT TECHNICIAN	\$82.00/HR

<u>DATE</u>	<u>DESCRIPTION</u>	<u>HOURS</u>	<u>AMOUNT</u>
08/18/06 to 11/19/07	CV06-4116: Officers- Palmer J / Engleking, T / Pollard, B - Field Investigation/File Maintenance	10.8	\$1,163.40
02/11/10	Prepare/Attend Statement of Expense Hearing	0.5	\$65.00
SUBTOTAL CODE ENFORCEMENT COSTS			\$1,228.40
11/17/06 - 02/13/07	COUNTY COUNSEL- LEGAL CONSULTATION SERVICES-Includes Administrative Costs	17.3	\$847.94
09/30/06	CONTRACTOR SERVICES- Optima Information Services - Lot Book Report		\$95.00
03/08/10	Lot/Title Report		\$114.00
TOTAL COSTS DUE			\$2,285.34

I affirm and declare under penalty of perjury under the laws of the State of California that the foregoing is true and correct.

Executed this 17th day of March, 2010, at Riverside, California.



 Cuong Pham
 Code Enforcement Department

EXHIBIT NO. A

BILL DATE	ENT / BILL MAT	BILL HOURS	BILL AMOUNT	ATTY	DESCRIPTION
17-Nov-06	CV064116	1.7	108.8	LBH	draft pleading - F-11 and Officer Declaration; review file; pull, review and organize exhibits;
29-Nov-06	CV064116	1	128	WYC	Reviewed and revised FOF and F11 for admin abatement.
04-Dec-06	CV064116	0.3	38.4	TNN	Finalize Notice of Abatement hearing.
17-Jan-07	CV064116	0.5	64	TNN	Finalize Form 11 and exhibits to place abatement file on BOS agenda.
29-Jan-07	CV064116	0.5	64	TNN	Preparation for administrative abatement hearing.
30-Jan-07	CV064116	0.5	64	TNN	Attended BOS administrative abatement appeal hearing.
30-Jan-07	CV064116	1	64	LBH	draft pleading - FOF and F-11
13-Feb-07	CV064116	0.7	89.6	TNN	Finalize FOF/Order to Abate and Form 11 regarding same.
13-Feb-07	CV064116	0.2	12.8	LBH	revise F-11
	SUBTOTAL	6.4	633.6		
12/08/06 - 03/22/07	CV064116	9.52	19.04		MAILING EXPENSE
2/11/2010	CV064116	0.9	125.55	JAJ	PREPARE CASE FOR SOE HEARING
5/4/2010	CV064116	0.5	69.75	JAJ	ATTEND SOE HEARING
	TOTAL	17.32	847.94		

11/17/06 - 2/13/07

EXHIBIT NO. _____

A²



Information Solutions

Optima Order Number: 0829001 Customer Order Number CV06-4116 Issue Date: 9/1/2006 Effective Date 8/23/2006
Form Version 2.25:

Begin Copy Below This Line.

PARTIES OF INTEREST REPORT

Report Cost: \$95.00

Customer Information

Customer Name: DECAMP, MELVIN L
Property Address: 4868 ETIWANDA AVE., MIRA LOMA, CA 91752
Munic/County: RIVERSIDE

Deed Information

Grantee: MELVIN L. DECAMP AND CAROL A. DECAMP, HUSBAND AND WIFE, AS JOINT TENANTS
Document Type: GRANT DEED
Filed: Dated: 11/24/1976 Recorded: 3/28/1977
Book: Page: No.: 51642
Comment:

Vesting: MELVIN L. DECAMP AND CAROL A. DECAMP, HUSBAND AND WIFE, AS JOINT TENANTS
Legal Description: See Attached Exhibit 'A'

Tax Information

Tax ID: 159-101-034-2

Assessment Information

Land: \$19,026.00 Building/Improvement \$2,446.00 Assessed Valuation: \$21,472.00

Judgment and Lien Information

MORTGAGE INFORMATION:

1. DEED OF TRUST
AMOUNT: \$11,522.00
RECORDED: 3/28/1977 AS INSTRUMENT NO. 51643, BOOK , PAGE
DATED: 3/18/1977
TRUSTOR: MELVIN L. DECAMP AND CAROL A. DECAMP, HUSBAND AND WIFE
TRUSTEE: WHELAN ESCROW COMPANY, A CALIFORNIA CORPORATION
BENEFICIARY: CLYDE F. MACK AND VERNA L. MACK, HUSBAND AND WIFE, AS JOINT TENANTS
COMMENT:

ASSIGNMENT OF DEED OF TRUST
RECORDED: 12/14/1977 AS INSTRUMENT NO. 248300
COMMENT: ASSIGNEE: JAMES PHILLIPS

ASSIGNMENT OF DEED OF TRUST
RECORDED: 11/20/1978 AS INSTRUMENT NO. 244237
COMMENT: ASSIGNEE: JIM BROOKS

ASSIGNMENT OF DEED OF TRUST
RECORDED: 11/20/1978 AS INSTRUMENT NO. 244238
COMMENT: ASSIGNEE: JIM BROOKS

EXHIBIT NO. A4



INVOICE

Order Number: 21322	Order Date: 3/8/2010
----------------------------	-----------------------------

Customer Information:

Acct No. 1044

RIVERSIDE COUNTY TLMA-CODE ENFORCEMENT
4080 Lemon Street
Riverside, CA 92501

Attn: Brent Steele
REF: CV 06-4116/ Brenda Peeler
IN RE: DECAMP, MELVIN L.

Product and/or Service ordered for Property known as:	
4868 Etiwanda Avenue	
Mira Loma, CA 91752	
DESCRIPTION: Lot Book Report	FEE: \$114.00
TOTAL DUE:	\$114.00

Payment due upon receipt. Please remit to:

RZ Title Services, Inc.
P.O. Box 1193
Whittier, CA 90609

EXHIBIT NO. A⁵

1
2
3
4
5
6
7
8
9
10
11
12
13
14
15
16
17
18
19
20
21
22
23
24
25
26
27
28

DOC # 2007-0142884
03/01/2007

Conformed Copy

Has not been compared with original

Larry W Ward
County of Riverside
Assessor, County Clerk & Recorder

WHEN RECORDED PLEASE MAIL TO:
Tiffany N. North, Deputy County Counsel
County of Riverside
OFFICE OF COUNTY COUNSEL
3535 Tenth Street, Suite 300 (Stop #1350)
Riverside, CA 92501

[EXEMPT'6103]

BOARD OF SUPERVISORS
COUNTY OF RIVERSIDE

IN RE ABATEMENT OF PUBLIC NUISANCE:)	CASE NO. CV 06-4116
[EXCESSIVE OUTSIDE STORAGE AND)	
ACCUMULATION OF RUBBISH]; APN 159-)	FINDINGS OF FACT,
101-034, 4868 ETIWANDA AVENUE, MIRA)	CONCLUSIONS AND ORDER TO
LOMA, RIVERSIDE COUNTY, CALIFORNIA;)	ABATE NUISANCE
MELVIN L. DECAMP AND CAROL A.)	
DECAMP, OWNERS.)	[R.C.O. Nos. 348 (RCC Title 17), 541
)	(RCC Title 8) and 725 (RCC Title 1)]

The above-captioned matter came on regularly for hearing on January 30, 2007, before the Board of Supervisors of the County of Riverside, State of California in the Board Room, First Floor Annex, County Administrative Center, 4080 Lemon Street, Riverside, California regarding the real property described 4868 Etiwanda Avenue, Mira Loma, Assessor's Parcel Number 159-101-034 and referred to hereinafter as "THE PROPERTY."

Tiffany N. North, Deputy County Counsel, appeared along with Jim Monroe, Code Enforcement Division Manager, on behalf of the Director of the Code Enforcement Department.

No one appeared on behalf of the property owners.

The Board of Supervisors received the Declaration of the Code Enforcement Officer together with attached Exhibits, evidencing the excessive outside storage of materials and accumulation of rubbish on THE PROPERTY as violations of Riverside County Ordinance Nos. 348 (Riverside County Code Title 17) and 541 (Riverside County Code Chapter 8.120), and as a public nuisance.

\\

EXHIBIT NO. B

FINDINGS OF FACT, CONCLUSIONS
AND ORDER TO ABATE NUISANCE

FEB 27 2007 2.20

COPY

SUMMARY OF EVIDENCE

1
2 1. Documents of record in the Riverside County Recorder's Office identify the owners
3 of THE PROPERTY as Melvin L. DeCamp and Carol A. DeCamp. ("OWNERS").

4 2. Documents of title indicate that another party potentially holds a legal interest in THE
5 PROPERTY, to-wit: Jim Brooks ("INTERESTED PARTY").

6 3. THE PROPERTY was inspected by Code Enforcement Officers on August 24, 2006,
7 November 1, 2006, December 12, 2006 and January 26, 2007.

8 4. During each inspection, outside storage of materials in excess of 200 square feet and
9 accumulation of rubbish were observed on THE PROPERTY. The outside storage of materials
10 included but was not limited to: drums, work tools, ceramic molds and other personal items. The
11 amount of outside storage was determined to be approximately three hundred twenty (320) square
12 feet. The items of accumulated rubbish included but were not limited to: trimmings, twigs, leaves,
13 trash, litter, garbage, boxes, cardboard vegetative waste, and other miscellaneous refuse. The amount
14 of the accumulated rubbish was determined to be approximately one hundred (100) square feet. The
15 zone classification of THE PROPERTY and the lot size (.45 acres) does not allow for any outside
16 storage of materials on THE PROPERTY without a Conditional Use Permit or Plot Plan.

17 5. THE PROPERTY was determined to be in violation of Riverside County Ordinance
18 Nos. 348 (RCC Chapter 17.72) and 541 (RCC Chapter 8.120) by the Code Enforcement Officer.

19 6. A Notice of Noncompliance was recorded on September 8, 2006 as Document
20 Number 2006-0668593 in the Office of the County Recorder, County of Riverside.

21 7. On August 24, 2006, Notices of Violation for violation of RCO Nos. 348 and 541
22 were posted on THE PROPERTY. On September 28, 2006, Notices of Violation were mailed to
23 OWNERS and INTERESTED PARTY by certified mail, return receipt requested.

24 8. On December 8, 2006, a "Notice To Abate Nuisance" providing notice of the public
25 hearing before the Board of Supervisors on January 30, 2007 was mailed by certified mail, return
26 receipt requested, to THE OWNERS and INTERESTED PARTY and was posted on THE
27 PROPERTY on December 12, 2006.

28 \ \ \

1 FINDINGS AND CONCLUSIONS

2 WHEREFORE, the Board of Supervisors of the County of Riverside, State of California, in
3 regular session assembled on January 30, 2007 finds and concludes that:

4 1. WHEREAS, the excessive outside storage of materials and accumulation of rubbish
5 on the real property located at 4868 Etiwanda Avenue, Mira Loma, Riverside County, California,
6 also identified as Assessor's Parcel Number 159-101-034 violates Riverside County Ordinance Nos.
7 348 (RCC Chapter 17.72) and 541 (RCC Chapter 8.120) and constitutes a public nuisance.

8 2. WHEREAS, THE OWNERS, occupants or any person having possession or control
9 of the premises should abate the condition by removing and disposing of the excess outside storage
10 of materials and accumulation of rubbish from the subject real property in strict accordance with all
11 Riverside County Ordinances, including but not limited to Riverside County Ordinance Nos. 348
12 (RCC Chapter 17.72) and 541 (RCC Chapter 8.120) within ninety (90) days.

13 3. WHEREAS, THE OWNERS AND INTERESTED PARTY ARE HEREBY
14 FURTHER NOTICED that the time within which judicial review of the administrative
15 determinations made herein must be sought is ninety (90) days from the posting and mailing of the
16 Findings of Fact, Conclusions and Order To Abate Nuisance, and is governed by California Code of
17 Civil Procedure Section 1094.6.

18 ORDER TO ABATE NUISANCE

19 IT IS THEREFORE ORDERED that the excess outside storage of materials and
20 accumulation of rubbish on THE PROPERTY be abated by the OWNERS, specifically Melvin L.
21 DeCamp and Carol A. DeCamp, or anyone having possession or control of THE PROPERTY by
22 removing and disposing of the outside storage of materials and accumulation of rubbish from the
23 subject real property in strict accordance with all Riverside County Ordinances, including but not
24 limited to Riverside County Ordinance Nos. 348 (RCC Chapter 17.72) and 541 (RCC Chapter 8.120)
25 within ninety (90) days of the date of this order.

26 IT IS FURTHER ORDERED that if the outside storage of materials and accumulated rubbish
27 are not removed and disposed of in strict accordance with all Riverside County Ordinances,
28 including but not limited to Riverside County Ordinance Nos. 348 (RCC Chapter 17.72) and 541

1 (RCC Chapter 8.120) within ninety (90) days of the date of this Order to Abate Nuisance, the outside
2 storage of materials and accumulation of rubbish shall be abated by representatives of the Riverside
3 County Code Enforcement Department, a contractor or the Sheriff's Department upon receipt of an
4 owner's consent or a Court Order when necessary under applicable law.

5 IT IS FURTHER ORDERED that reasonable abatement costs, after notice and opportunity
6 for hearing, shall be imposed as a lien on the property, which may be collected as a special
7 assessment against the property pursuant to Government Code section 25845 and Riverside County
8 Ordinance Nos. 348 (RCC Chapter 17.72), 541 (RCC Chapter 8.120), and 725 (RCC Chapter 1.16).
9 Under Riverside County Ordinance No. 725, "abatement costs" means "any costs or expenses
10 reasonably related to the abatement of conditions which violate County Land Use Ordinances, and
11 shall include, but not be limited to, enforcement, investigation, collection and administrative costs,
12 attorneys fees, and the costs associated with the removal or correction of the violation." Reasonable
13 abatement costs accrued by the Code Enforcement Department will be recoverable from the property
14 owner(s) even if the property is brought into compliance within ninety (90) days of the date of this
15 Order to Abate Nuisance.

16
17 Dated: FEB 27 2007

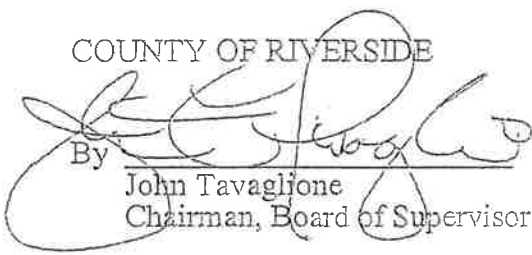
COUNTY OF RIVERSIDE
By 
John Tavaglione
Chairman, Board of Supervisors

18
19
20
21 ATTEST:
22 NANCY ROMERO

23 Clerk to the Board
24 By 
25 Deputy

26 (SEAL)

27
28 g:\property\01-code\bs\abatement\decamp\348 and 541 fof.doc

NOTICE LIST

Subject Property: 4868 Etiwanda Avenue, Mira Loma
Case No.: CV 06-4116; APN: 159-101-034; District 2

MELVIN L DECAMP
AND CAROL A DECAMP
4868 ETIWANDA
MIRA LOMA CA 91752

JIM BROOKS
BOX 1028
SEAGRAVES TX 79359

EXHIBIT NO. 82

COUNTY COUNSEL
3535 10TH SUITE 300
RIVERSIDE CA 92502

CERTIFIED MAIL™



7005 1820 0005 9929 7352

ANK
JIM BROOKS
BOX 1028
SEAGRAVE, TEXAS

NIXIE

760 SE 1 2R 03/29/07

RETURN TO SENDER
ATTEMPTED - NOT KNOWN
UNABLE TO FORWARD

7005991029 8009
9250173574

BC: 92501567499 *1004-11227-22-



3/26/07

DECAMP

Subject Property: 4868 Etiwanda Avenue, Mira Loma
Case No.: CV 06-4116; APN: 159-101-034; District 2

SENDER: COMPLETE THIS SECTION

- Complete items 1, 2, and 3. Also complete item 4 if Restricted Delivery is desired.
- Print your name and address on the reverse so that we can return the card to you.
- Attach this card to the back of the mailpiece, or on the front if space permits.

1. Article Addressed to:

MELVIN L DECAMP
AND CAROL A DECAMP
4868 ETIWANDA
MIRA LOMA CA 91752

Decamp FOIA CV06-4116

2. Article Number
(Transfer from service label)

7005 1820 0005 9929 7369

PS Form 3811, February 2004

Domestic Return Receipt

102595-02-M-1540

COMPLETE THIS SECTION ON DELIVERY

A. Signature *Melvin L Decamp* Agent Addressee

B. Received by (Printed Name) *Melvin L Decamp* C. Date of Delivery

D. Is delivery different from item 1? Yes No
If YES, enter delivery address below:

MAR 26 2007

3. Service Type
 Certified Mail Express Mail
 Registered Return Receipt for Merchandise
 Insured Mail C.O.D.

4. Restricted Delivery? (Extra Fee) Yes No

EXHIBIT NO.

B³

PROOF OF SERVICE

Case No. CV 06-4116

1
2
3
4
5
6
7
8
9
10
11
12
13
14
15
16
17
18
19
20
21
22
23
24
25
26
27
28

STATE OF CALIFORNIA, COUNTY OF RIVERSIDE

I, Kimberly Armstrong, declare that I am a citizen of the United States and am employed in the County of Riverside, over the age of 18 years and not a party to the within action or proceeding; that my business address is 3535 Tenth Street, Suite 300, Riverside, California 92501-3674.

That on March 22, 2007, I served the following document(s):

FINDINGS OF FACT, CONCLUSIONS AND ORDER TO ABATE NUISANCE

by placing a true copy thereof enclosed in a sealed envelope(s) addressed as follows:

**OWNERS OR INTERESTED PARTIES
(SEE ATTACHED NOTICE LIST)**

XX **BY CERTIFIED MAIL, RETURN RECEIPT REQUESTED.** I am "readily familiar" with the office's practice of collection and processing correspondence for mailing. Under that practice it would be deposited with the U.S. Postal Service on that same day with postage thereon fully prepaid at Riverside, California, in the ordinary course of business.

 BY PERSONAL SERVICE: I caused to be delivered such envelope(s) by hand to the offices of the addressee(s).

XX **STATE - I declare under penalty of perjury under the laws of the State of California that the above is true and correct.**

 FEDERAL - I declare that I am employed in the office of a member of the bar of this court at whose direction the service was made.

EXECUTED ON March 22, 2007, at Riverside, California.

KIMBERLY ARMSTRONG

COUNTY OF RIVERSIDE

Building and Safety Department
Code Enforcement Division

AFFIDAVIT OF POSTING OF NOTICES

Case No. CV06-4116

I, the undersigned, hereby declare:

1. I am employed by the Riverside County Department of Building and Safety Code Enforcement Division; that my business address is:

County of Riverside
Building & Safety Department
Code Enforcement Division
P.O. Box 1592
Riverside CA. 92502

2. That on 03/28/2007 at 10:45 a.m., I securely and conspicuously posted a FINDINGS OF FACT, CONCLUSIONS AND ORDER TO ABATENUISANCE at the property described as:

Property Address: 4868 Etiwanda Ave., Mira Loma
Assessor's Parcel Number: 159-101-034

I declare under the penalty of perjury that the foregoing is true and correct.

Executed on 04/02/2007, at Jurupa, California.

BUILDING & SAFETY DEPARTMENT

By: 

James Palmer, Senior Code Enforcement Officer

EXHIBIT NO. B⁵

When recorded please mail to:
2135

DOC # 2006-0668593
09/08/2006

Conformed Copy
Has not been compared with original

Larry W Ward
County of Riverside
Assessor, County Clerk & Recorder

NOTICE OF NONCOMPLIANCE

In the matter of the Property of
MELVIN L. DECAMP)
CAROL A. DECAMP) Case No. CV06-4116

NOTICE IS HEREBY GIVEN to all persons, pursuant to Section 10 of Ordinance Number 725 of the County of Riverside, State of California, that proceedings have been commenced with respect to violations of Riverside County Ordinance No.348 & 457, (RCC Title 17.72.010 & 8.120.010) described as EXCESSIVE OUTSIDE STORAGE & ACCUMULATED RUBBISH. Such Proceedings are based upon the noncompliance of such real property, located at 4868 ETIWANDA AVE., MIRA LOMA, CA, and more particularly described as Assessor's Parcel Number 159-101-034 and having a legal description of LOT 98 POR., RESERVOIR FARMS, T2SR6W SEC 16, MB 13/37, Records of Riverside County, with the requirements of Ordinance No. 348 & 457 (RCC Title 17.72.010 & 8.120.010).

The owner has been advised to immediately correct the above-referenced violations to avoid further action by the County of Riverside which may include demolition, removal, razing, etc., to abate the public nuisance. Any costs incurred by the County, including, but not limited to investigative, administrative and abatement costs and attorneys' fees, may become a lien on the property. Further details regarding this notice may be obtained by addressing an inquiry to the Building and Safety Department, 5317 Mission Blvd., Riverside, CA 92507, Attention Code Enforcement Officer JAMES PALMER, (951) 275-8739.

NOTICE IS FURTHER GIVEN in accordance with §17274 and §24436.5 of the California Revenue and Taxation Code, that a tax deduction may not be allowed for interest, taxes, depreciation, or amortization paid or incurred in the taxable year affected by these proceedings.

COUNTY OF RIVERSIDE
DEPARTMENT OF BUILDING AND SAFETY

By Brian Bealer
Brian Bealer
Code Enforcement Division

ACKNOWLEDGMENT

State of California)
County of Riverside)

On 08/21/06 before me, Cynthia M. Black , Notary Public, personally appeared Brian Bealer, personally known to me (or proved to me on the basis of satisfactory evidence) to be the person(s) whose name(s) is/are subscribed to the within instrument and acknowledged to me that he/she/they executed the same in his/her/their authorized capacity(ies), and that by his/her/their signature(s) on the instrument the person(s), or the entity upon behalf of which the person(s) acted, executed the instrument.

WITNESS my hand and official seal.

Cynthia M. Black

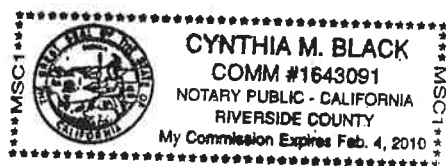

EXHIBIT NO. C

Assessment Roll For the 2009-2010 Tax Year as of January 1,2009

Assessment #159101034-2		Parcel # 159101034-2	
Assessee:	DECAMP MELVIN L	Land	20,592
Assessee:	DECAMP CAROL A	Structure	2,644
Mail Address:	10453 N LYNN CIR APT B	Full Value	23,236
City, State Zip:	MIRA LOMA CA 91752	Total Net	23,236
Real Property Use Code:	MR		
Base Year	1978		
Conveyance Number:	0031180		
Conveyance (mm/yy):	1/2001		
PUI:	M010000		
TRA:	99-095		
Taxability Code:	0-00		
ID Data:	Lot F MB 013/037 RESERVOIR FARMS		
Situs Address:	4868 ETIWANDA AVE MIRA LOMA CA 91752		

View Parcel Map

This must be in red to be a
"CERTIFIED COPY"

I hereby certify the foregoing instrument to which this stamp has been affixed consisting of 1 pages to be a full, true and correct copy of the original on file and of record in my office.

Larry W. Wan
Assessor - County Clerk - Recorder
County of Riverside, State of California

Dated **MAR 08 2010**



Certification must be in red to be a
"CERTIFIED COPY"

EXHIBIT NO. D

RIVERSIDE COUNTY GIS

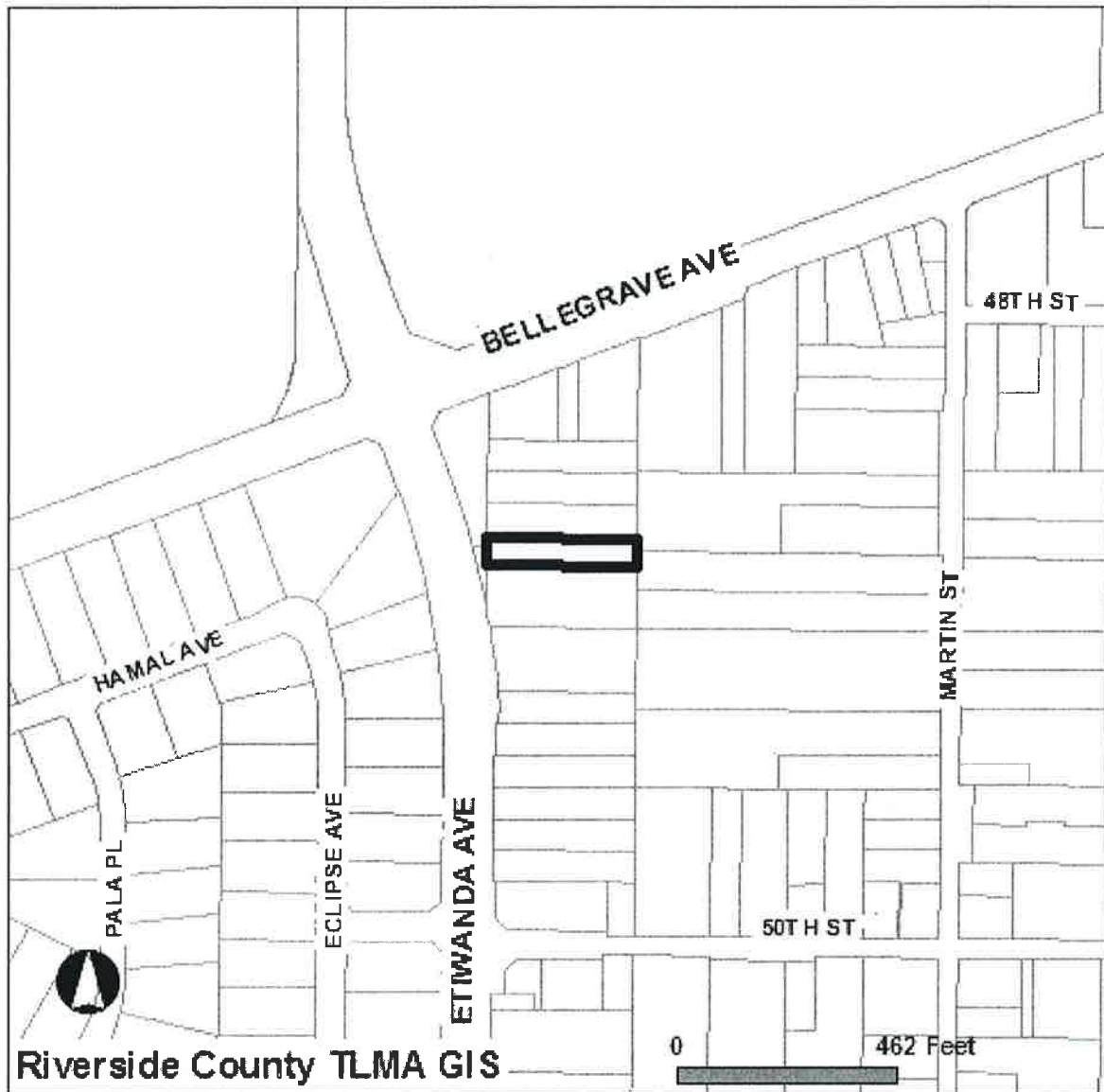

Riverside County TLMA GIS

Selected parcel(s):
159-101-034

IMPORTANT

Maps and data are to be used for reference purposes only. Map features are approximate, and are not necessarily accurate to surveying or engineering standards. The County of Riverside makes no warranty or guarantee as to the content (the source is often third party), accuracy, timeliness, or completeness of any of the data provided, and assumes no legal responsibility for the information contained on this map. Any use of this product with respect to accuracy and precision shall be the sole responsibility of the user.

STANDARD REPORT

APNs

159-101-034-2

OWNER NAME / ADDRESS

MELVIN L DECAMP
CAROL DECAMP
4868 ETIWANDA AVE
MIRA LOMA, CA. 91752

MAILING ADDRESS

(SEE OWNER)
10453 N LYNN CIR APT B
MIRA LOMA CA. 91752

EXHIBIT NO. D²

LEGAL DESCRIPTION

RECORDED BOOK/PAGE: MB 13/37
SUBDIVISION NAME: RESERVOIR FARMS
LOT/PARCEL: 98, BLOCK: NOT AVAILABLE
Por. TRACT NUMBER: NOT AVAILABLE

LOT SIZE

RECORDED LOT SIZE IS 0.45 ACRES

PROPERTY CHARACTERISTICS

WOOD FRAME, 600 SQFT., 2 BDRM/ 1 BATH, 1 STORY, CONST'D 1961 COMPOSITION, ROOF, CENTRAL HEATING, CENTRAL COOLING

THOMAS BROS. MAPS PAGE/GRID

PAGE: 683 GRID: H2

CITY BOUNDARY/SPHERE

NOT WITHIN A CITY
NOT WITHIN A CITY SPHERE
NO ANNEXATION DATE AVAILABLE
NO LAFCO CASE # AVAILABLE
NO PROPOSALS

MARCH JOINT POWERS AUTHORITY

NOT IN THE JURISDICTION OF THE MARCH JOINT POWERS AUTHORITY

INDIAN TRIBAL LAND

NOT IN A TRIBAL LAND

SUPERVISORIAL DISTRICT (ORD. 813)

JOHN TAVAGLIONE, DISTRICT 2

TOWNSHIP/RANGE

T2SR6W SEC 16

ELEVATION RANGE

729 FEET

PREVIOUS APN

159-101-002

PLANNING

LAND USE DESIGNATIONS

Zoning not consistent with the General Plan.
CR

AREA PLAN (RCIP)

JURUPA

GENERAL PLAN POLICY OVERLAYS

NOT IN A GENERAL PLAN POLICY OVERLAY AREA

GENERAL PLAN POLICY AREAS

EQUESTRIAN SPHERE POLICY AREA

ZONING CLASSIFICATIONS (ORD. 348)

C-1/C-P

ZONING DISTRICTS AND ZONING AREAS

PRADO-MIRA LOMA DISTRICT

ZONING OVERLAYS

NOT IN A ZONING OVERLAY

SPECIFIC PLANS

NOT WITHIN A SPECIFIC PLAN

AGRICULTURAL PRESERVE

NOT IN AN AGRICULTURAL PRESERVE

REDEVELOPMENT AREAS

PROJECT AREA NAME: JVPA
SUBAREA NAME: JURUPA VALLEY AMENDMENT AREA
AMENDMENT NUMBER: 0
ADOPTION DATE: JUL. 9, 1996
ACREAGE: 10692 ACRES

AIRPORT INFLUENCE AREAS
NOT IN AN AIRPORT INFLUENCE AREA

AIRPORT COMPATIBILITY ZONES
NOT IN AN AIRPORT COMPATIBILITY ZONE

ENVIRONMENTAL

CVMSHCP (COACHELLA VALLEY MULTI-SPECIES HABITAT CONSERVATION PLAN) CONSERVATION AREA
NOT IN A CONSERVATION AREA

CVMSHCP FLUVIAL SAND TRANSPORT SPECIAL PROVISION AREAS
NOT IN A FLUVIAL SAND TRANSPORT SPECIAL PROVISION AREA

WRMSHCP (WESTERN RIVERSIDE COUNTY MULTI-SPECIES HABITAT CONSERVATION PLAN) CELL GROUP
NOT IN A CELL GROUP

WRMSHCP CELL NUMBER
NOT IN A CELL

HANS/ERP (HABITAT ACQUISITION AND NEGOTIATION STRATEGY/EXPEDITED REVIEW PROCESS)
NONE

VEGETATION (2005)
Developed/Disturbed Land

FIRE

HIGH FIRE AREA (ORD. 787)
NOT IN A HIGH FIRE AREA

FIRE RESPONSIBILITY AREA
NOT IN A FIRE RESPONSIBILITY AREA

DEVELOPMENT FEES

CVMSHCP FEE AREA (ORD. 875)
NOT WITHIN THE COACHELLA VALLEY MSHCP FEE AREA

WRMSHCP FEE AREA (ORD. 810)
IN OR PARTIALLY WITHIN THE WESTERN RIVERSIDE MSHCP FEE AREA. SEE MAP FOR MORE INFORMATION.

ROAD & BRIDGE DISTRICT
NOT IN A DISTRICT

EASTERN TUMF (TRANSPORTATION UNIFORM MITIGATION FEE ORD. 673)
NOT WITHIN THE EASTERN TUMF FEE AREA

WESTERN TUMF (TRANSPORTATION UNIFORM MITIGATION FEE ORD. 824)
IN OR PARTIALLY WITHIN A TUMF FEE AREA. SEE MAP FOR MORE INFORMATION. NORTHWEST

DIF (DEVELOPMENT IMPACT FEE AREA ORD. 659)
JURUPA

SKR FEE AREA (STEPHEN'S KANGAROO RAT ORD. 663.10)
NOT WITHIN AN SKR FEE AREA.

DEVELOPMENT AGREEMENTS
NOT IN A DEVELOPMENT AGREEMENT AREA

TRANSPORTATION

CIRCULATION ELEMENT ULTIMATE RIGHT-OF-WAY
NOT IN A CIRCULATION ELEMENT RIGHT-OF-WAY

ROAD BOOK PAGE
8

TRANSPORTATION AGREEMENTS

NOT IN A TRANSPORTATION AGREEMENT

CETAP (COMMUNITY AND ENVIRONMENTAL TRANSPORTATION ACCEPTABILITY PROCESS) CORRIDORS
NOT IN A CETAP CORRIDOR.

HYDROLOGY

FLOOD PLAIN REVIEW

NOT REQUIRED.

WATER DISTRICT

WMWD

FLOOD CONTROL DISTRICT

RIVERSIDE COUNTY FLOOD CONTROL DISTRICT

WATERSHED

SANTA ANA RIVER

GEOLOGIC

FAULT ZONE

NOT IN A FAULT ZONE

FAULTS

NOT WITHIN A 1/2 MILE OF A FAULT

LIQUEFACTION POTENTIAL

MODERATE

SUBSIDENCE

SUSCEPTIBLE

PALEONTOLOGICAL SENSITIVITY

HIGH SENSITIVITY (HIGH A).

BASED ON GEOLOGIC FORMATIONS OR MAPPABLE ROCK UNITS THAT ARE ROCKS THAT CONTAIN FOSSILIZED BODY ELEMENTS, AND TRACE FOSSILS SUCH AS TRACKS, NESTS AND EGGS. THESE FOSSILS OCCUR ON OR BELOW THE SURFACE.

MISCELLANEOUS

SCHOOL DISTRICT

JURUPA UNIFIED

COMMUNITIES

MIRA LOMA

COUNTY SERVICE AREA

NOT IN A COUNTY SERVICE AREA.

LIGHTING (ORD. 655)

NOT APPLICABLE, 58.25 MILES FROM MT. PALOMAR OBSERVATORY

2000 CENSUS TRACT

040604

040605

FARMLAND

URBAN-BUILT UP LAND

TAX RATE AREAS

099-095

- COUNTY FREE LIBRARY
- COUNTY STRUCTURE FIRE PROTECTION
- COUNTY WASTE RESOURCE MGMT DIST
- CSA 152
- ERAF RDV
- FLOOD CONTROL ADMINISTRATION
- FLOOD CONTROL ZONE 1
- FLOOD CONTROL ZONE 1 DEBT SERV
- GENERAL
- GENERAL PURPOSE
- INLAND EMPIRE RCD

- JURUPA AREA REC & PARK
- JURUPA UNIFIED SCHOOL
- JURUPA UNION JT-COMP UNIF
- JURUPA VALLEY RDV AMEND AB1290
- METRO WATER WEST 1302999
- N.W. MOSQUITO & VECTOR CONT DIST
- RIV CO REG PARK & OPEN SPACE
- RIV. CO. OFFICE OF EDUCATION
- RIVERSIDE CITY COMMUNITY COLLEGE
- WESTERN MUNICIPAL WATER

SPECIAL NOTES

Mira Loma Warehouse/Distribution Center policy area PLEASE CONTACT THE PLANNING DEPARTMENT AT 951-955-3200.

CODE COMPLAINTS

NO CODE COMPLAINTS

REPORT PRINTED ON...Thu Mar 04 15:16:14 2010