

# Ratings & Analysis Center

United States | Asia Pacific | Canada | Europe

About | Contact | Sitemap

## Ratings & Analysis

- » Home
- » Best's Credit Ratings +
  - » Financial Strength Ratings—Insurer
  - » Issuer Credit Ratings
  - » Debt Ratings
  - » Financial Strength Ratings—Bank
  - » Advanced Search
- » About Best's Credit Ratings +
- » Get a Credit Rating +
- » Best's Special Reports
- » Add Best's Credit Ratings Search To Your Site
- » BestMark for Secure-Rated Insurers
- » Contact an Analyst

## News & Research

Products & Services

## Industry Information

Corporate

Support & Resources

Conferences and Events

## Zurich American Insurance Company

(a member of Zurich Financial Services Ltd)

A.M. Best #: 002563 NAIC #: 16535 FEIN #: 364233459

Address: 1400 American Lane  
Schaumburg, IL 60196-1056  
UNITED STATES

Phone: 847-605-6000

Fax: 847-605-6011

Web: [www.zurichna.com](http://www.zurichna.com)

### Best's Ratings

**Financial Strength Ratings** [View Definitions](#)    **Issuer Credit Ratings** [View Definitions](#)

Rating: **A (Excellent)**

Affiliation Code: **g (Group)**

Financial Size Category: **XV (\$2 Billion or greater)**

Outlook: **Stable**

Action: **Affirmed**

Effective Date: **December 17, 2009**

\* Denotes Under Review Ratings. See rating definitions.

This rating is assigned to companies that have, in our opinion, an excellent ability to meet their ongoing obligations to policyholders.



Print this page

Member Center

For ratings and product access

[Login](#) | [Sign-up](#)

Find a Best's Credit Rating

Enter a Company Name

» [Advanced Search](#)

Get Rated By A.M. Best

View Rating Definitions

Select one...

### Reports and News

Visit our NewsRoom for the latest [news and press releases](#) for this company and its A.M. Best Group.



**AMB Credit Report - Insurance Professional** - includes Best's Financial Strength Rating and rationale along with comprehensive analytical commentary, detailed business overview and key financial data.

Report Revision Date: 02/15/2010 (represents the latest significant change).

Historical Reports are available in [AMB Credit Report - Insurance Professional Archive](#).



**Best's Executive Summary Reports (Financial Overview)** - available in three versions, these presentation style reports feature balance sheet, income statement, key financial performance tests including profitability, liquidity and reserve analysis.

Data Status: 2010 Best's Statement File - P/C, US. Contains data compiled as of 6/7/2010 (Quality Cross Checked).

- **Single Company** - five years of financial data specifically on this company.
- **Comparison** - side-by-side financial analysis of this company with a peer group of up to five other companies you select.
- **Composite** - evaluate this company's financials against a peer group composite. Report displays both the average and total composite of your selected peer group.



**AMB Credit Report - Business Professional** - provides three years of key financial data presented with colorful charts and tables. Each report also features the latest Best's Ratings, Rating Rationale and an excerpt from our Business Review commentary.

Data Status: Contains data compiled as of 6/7/2010 (Quality Cross Checked).



**Best's Key Rating Guide Presentation Report** - includes Best's Financial Strength

Rating and financial data as provided in Best's Key Rating Guide products.

Data Status: 2008 Financial Data (Quality Cross Checked).

### Financial and Analytical Products

[Best's Key Rating Guide - P/C, US & Canada](#)

[Best's Statement File - P/C, US](#)

[Best's Statement File - Global](#)

[Best's Insurance Reports - P/C, US & Canada](#)

[Best's State Line - P/C, US](#)

[Best's Insurance Expense Exhibit \(IEE\) - P/C, US](#)

[Best's Schedule F \(Reinsurance\) - P/C, US](#)

[Best's Schedule D \(Municipal Bonds\) - US](#)

[Best's Schedule D \(Common Stocks\) - US](#)

[Best's Schedule D \(Preferred Stocks\) - US](#)

[Best's Corporate Changes and Retirements - P/C, US/CN](#)

[Best's Schedule P \(Loss Reserves\) - P/C, US](#)

[Best's Schedule D - Hybrid - P/C & L/H, US](#)

**STATE HIGHWAY  
IN RIVERSIDE COUNTY  
IN THE CITY OF PALM SPRINGS  
ON INTERSTATE 10  
FROM 0.86 km WEST TO 0.70 km EAST OF  
INDIAN CANYON Dr OVERCROSSING**

TO BE SUPPLEMENTED BY STANDARD PLANS DATED JULY 2004

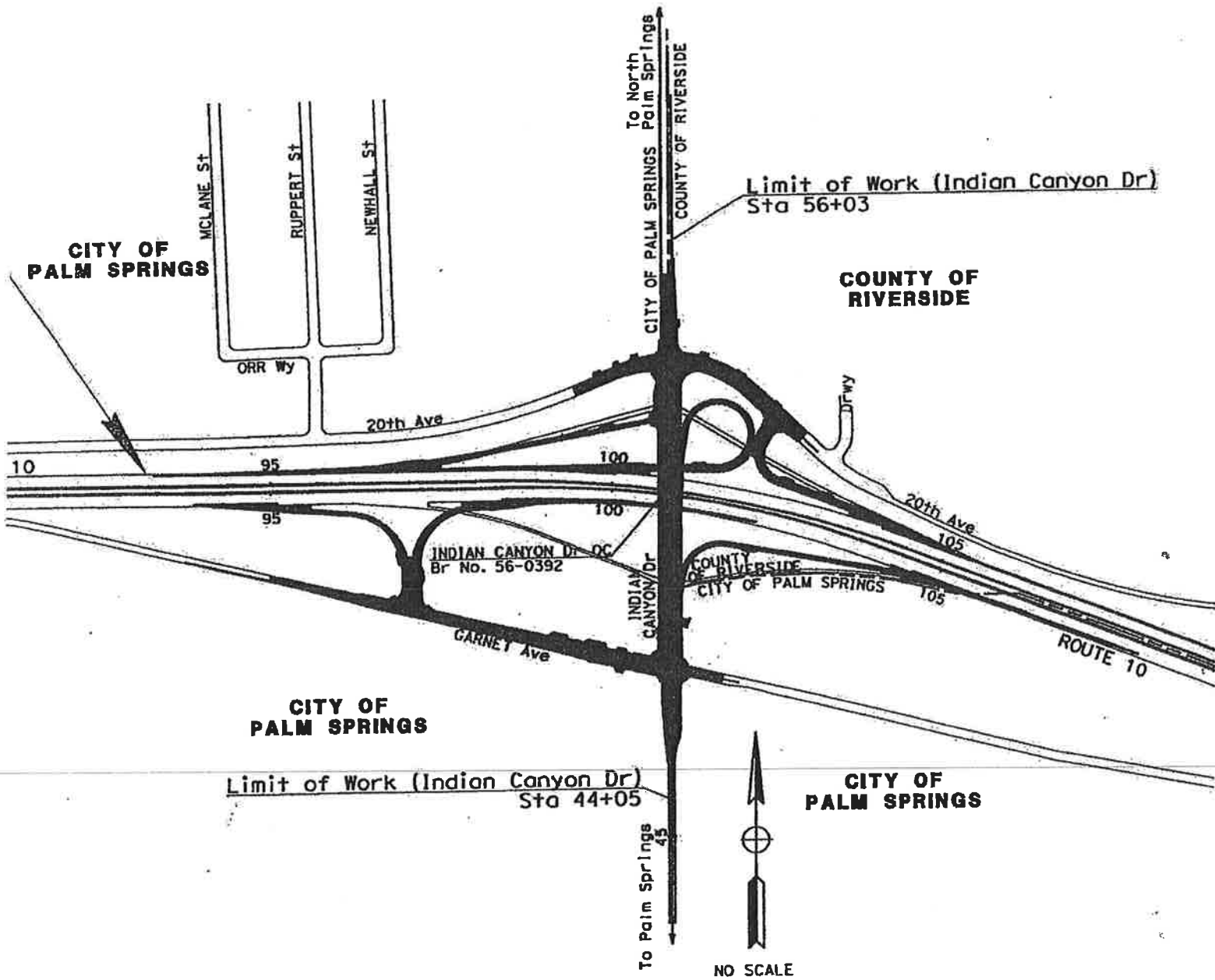

VICINITY MAP

# Attachment "A"

Riverside County Transportation Department

Project: **Indian Canyon Drive Interchange Project (Advertise, Award and Administer Only)**

Project No.(s): **A8-0372**

### Project Costs and Budget

Activity	Incurred Costs	Projected Costs	Total Costs	Existing Budget	Proposed Budget
Preliminary Survey					
Environmental					
Design					
Right-of-way					
Utilities					
Construction		16,526,137	16,526,137	30,750,000	18,179,000
Construction Contingency 10.0%		1,652,614	1,652,614		
Construction Engineering & Inspection	130,850	3,681,000	3,811,850	1,845,000	3,812,000
Construction Survey	4,500	500,000	504,500	800,000	505,000
<b>Totals:</b>	<b>135,350</b>	<b>22,359,751</b>	<b>22,495,101</b>	<b>33,395,000</b>	<b>22,496,000</b>

### Project Funding

Code	Name	Existing Budget	Proposed Budget
990	Misc. Mision Springs Water District		17,000
718	City of Palm Springs	33,395,000	22,479,000
<b>Totals</b>		<b>33,395,000</b>	<b>22,496,000</b>

### Comments

City incurred costs for Environmental, Design, and RW are not included here.

# Attachment "A"

Riverside County Transportation Department

Project: **Indian Canyon Drive Interchange Project (Total)**

Project No.(s): **A8-0372**

### Project Costs and Budget

Activity	Incurred Costs	Projected Costs	Total Costs	Existing Budget	Proposed Budget
Preliminary Survey					
Environmental					
Design	200,007	10,000	210,007	227,000	210,000
Right-of-way	27,028		27,028	9,000	27,000
Utilities					
Construction		16,526,137	16,526,137	30,750,000	18,179,000
Construction Contingency 10.0%		1,652,614	1,652,614		
Construction Engineering & Inspection	130,850	3,671,000	3,801,850	1,845,000	3,802,000
Construction Survey	4,500	500,000	504,500	800,000	505,000
<b>Totals:</b>	<b>362,385</b>	<b>22,359,751</b>	<b>22,722,136</b>	<b>33,631,000</b>	<b>22,723,000</b>

### Project Funding

Code	Name	Existing Budget	Proposed Budget
340	Transportation Uniform Mitigation Fee (CVAG)	4,431,000	81,000
718	City of Palm Springs	29,054,000	22,385,000
301	Measure A/ Coachella Valley	121,000	
332	Redevelopment Agency	25,000	25,000
622	DIF AP2 Maj. Imp. Fnd- Coachella West Area		215,000
990	Misc. Mision Springs Water District		17,000
<b>Totals</b>		<b>33,631,000</b>	<b>22,723,000</b>

### Comments

City incurred costs for Environmental, Design, and R/W are not included here.



April 30, 2010

Via Facsimile to (951) 955-3164

Riverside County Transportation Department  
14<sup>th</sup> Street Transportation Annex  
3532 14<sup>th</sup> Street  
Riverside, California 92501

Re: Request for Subcontractor Substitution  
Indian Canyon Drive at Interstate 10  
Reconstruction of Interchange, Project No. A8-0372  
Federal Aid No. ESPLHPLU-5282(034) & HP21L-5282 (035)

Attn: Joel Jimenez

Dear Mr. Jimenez:

On April 28, 2010, Granite Construction Company ("Granite") submitted the apparent low bid on the Indian Canyon Drive at Interstate 10 Reconstruction of Interchange, Project No. A8-0372, Federal Aid No. ESPLHPLU-5282(034) & HP21L-5282 (035) ("Project"). However, in submitting its proposal, Granite inadvertently listed West Coast/Tipco Pile Driving, JV, for the bridge pile driving work, when in fact, it intended to list Foundation Pile, Inc. By this correspondence, Granite formally requests subcontractor substitution pursuant to California Public Contract Code § 4107(a) (5) to add Foundation Pile, Inc. ("Foundation") in place of West Coast/Tipco Pile Driving, JV, as its subcontractor relative to the bridge piling scope of work on the Project on the grounds Foundation was erroneously and inadvertently excluded from Granite's list of subcontractors in its bid due to clerical error.

As evidenced by the declaration of John P. Douglas, attached hereto, Granite's failure to list Foundation was an inadvertent clerical error and did not facilitate any bid peddling or bid shopping in violation of the California Subcontractor Listing Law.

The Subcontractor Listing Law was enacted by the California Legislature over 50 years ago to protect subcontractors from the unfair and undesirable business practice of bid peddling and bid shopping by entities with whom they subcontract. In Public Contract Code ("PCC") §4101 the Legislature expressly declared:

The Legislature find that the practices of bid shopping and bid peddling in connection with the construction, alteration and repair of public improvements often result in poor quality of material and workmanship to the detriment of the public, deprived the public of full benefits of fair competition among prime contractors and subcontractors, and lead to insolvencies, loss of wages to employees, and other evils.

Southern California Region  
38000 Monroe St.  
Indio, CA 92203  
Phone 760/775-7500  
FAX 760/775-8227

Riverside County Transportation Department  
April 30, 2010  
Page 2 of 2

In interpreting the Subcontractor Listing Law, the California Supreme Court has defined bid peddling and bid shopping to be:

Bid shopping is the use of the low bid already received by the general contractor to pressure other subcontractors into submitting even lower bids. Bid peddling, conversely, is an attempt by the subcontractor to undercut known bids already submitted to the general contractor in order to procure the job. Southern California Acoustics Co., Inc., v. C.V. Holder, Inc., (1969) 71 Cal.2d 719, 726-727.

Relative to the Project, Granite has not engaged in any post-bid subcontractor bid peddling or bid shopping as defined under California law. Specifically, Granite did not contact any bridge piling subcontractors and solicit from them lower bids by announcing the bid of other similar subcontractors ("bid shopping"). Likewise, Granite did not receive from any subcontractors submitting bids for the bridge piling work, offers to beat or undercut any other subcontractor's prices ("bid peddling").

Based on the foregoing, Granite respectfully request permission to substitute Foundation as a subcontractor on the Project. In the event the Department is unwilling to grant Granite's request for subcontractor substitution, Granite is ready, willing and able to self perform this scope of work as required by Public Contract Code Section 4106.

Very truly yours,  
GRANITE CONSTRUCTION COMPANY

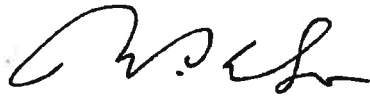

John P. Douglas  
Southern California Region Chief Estimator

Declaration of WEST COAST/TIPCO PILE DRIVING J.V.

I, ANTHONY WILL, declare as follows:

1. I am the MANAGING PARTNER of West Coast/Tipco Pile Driving, JV's. On April 28, 2010, I submitted West Coast/Tipco Pile Driving, JV's bid (a copy of which is attached hereto) in writing to Granite Construction Company ("Granite"), as well as other contractors submitting bids, in the amount of \$646,396.00 relative to the bridge pile scope of work on Indian Canyon Drive at Interstate 10, Reconstruction of Interchange, Project No. A8-0372, Federal Aid No. ESPLHPLU-5282(034) & HP21L-5282 (035) ("Project").
2. At no point in the bidding process did Granite request I lower my bid ("bid shopping") and at no point in the bidding process did I offer to lower Foundation's bid to beat or undercut the bid of any other subcontractor ("bid peddling").
3. I understand that West Coast/Tipco Pile Driving, JV was not the low bidder for the bridge piling work, and was inadvertently listed as the subcontractor for Granite Construction Company on the above referenced job. I understand that Foundation Pile was the low bidder on the project, should have been listed as the subcontractor for the project, and will be used by Granite Construction Company for the bridge piling work on the project.

I declare, under the penalty of perjury, the foregoing to be true and correct.

Executed this 4th day of May, 2010.

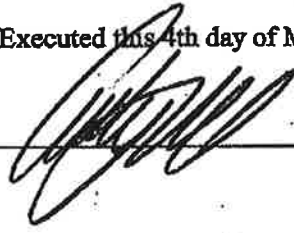
  
\_\_\_\_\_

**Declaration of Foundation Pile, Inc.**

**I, Jeff Bird, declare as follows:**

1. I am the Sr. Estimator of Foundation Pile, Inc ("Foundation")
2. On April 28, 2010, I submitted Foundations's bid (a copy of which is attached hereto) in writing to Granite Construction Company ("Granite"), as well as other contractors submitting bids, in the amount of \$598,246.00 relative to the bridge pile scope of work on Indian Canyon Drive at Interstate 10, Reconstruction of Interchange, Project No. A8-0372, Federal Aid No. ESPLHPLU-5282(034) & HP21L-5282 (035) ("Project").
3. At no point in the bidding process did Granite request I lower my bid ("bid shopping") and at no point in the bidding process did I offer to lower Foundation's bid to beat or undercut the bid of any other subcontractor ("bid peddling").

**I declare, under the penalty of perjury, the foregoing to be true and correct.**

**Executed this 30th day of April, 2010.**

  
\_\_\_\_\_  
Jeff Bird



**Declaration of John P. Douglas, Regional Chief Estimator, Granite Construction Company**

I, John P. Douglas, declare as follows:

1. I assisted in the preparation of Granite Construction Company's bid to the Riverside County Transportation Department, for the Indian Canyon Drive at Interstate 10 Reconstruction of Interchange, Project No. A8-0372, Federal Aid No. ESPLHPLU-5282(034) & HP21L-5282 (035) ("Project") by receiving subcontractor bids on April 28, 2010, relative to the bridge piling scope of work on the Project.
2. Relative to the bridge piling scope of work on the Project, Granite received the following subcontractor bids:
  1. Foundation Pile, Inc., bid for \$598,246, Exhibit A;
  2. West Coast/Tipco Pile Driving, JV, bid for \$646,396, Exhibit B
3. Based on the foregoing, Granite in submitting its proposal, included the subcontractor bid amount of Foundation as its bridge piling subcontractor on the Project, in the amount of \$598,246 in response to its bid.
4. Granite has not engaged in any post-bid subcontractor bid pedaling or bid shopping as defined under California law. Specifically, Granite did not contact any bridge piling subcontractors and solicit from them lower bids by announcing the bid of other similar subcontractors ("bid shopping"). Likewise, Granite did not receive from any of its subcontractors, offers to beat any other subcontractor's prices ("bid peddling").
5. In filling out the bid form for the Project, Granite erroneously failed to list Foundation, as Granite's bridge pile subcontractor through inadvertence and mistake.
6. Granite's bid was based upon Foundation's bid; however, Granite inadvertently and unintentionally omitted the correct subcontractor on the required listing.

I declare under the penalty of perjury, the foregoing to be true and correct.

Executed in Riverside County, this 30<sup>th</sup> day of April, 2010.

  
\_\_\_\_\_  
John P. Douglas, Southern California Regional Chief Estimator

**COUNTY OF RIVERSIDE**  
**TRANSPORTATION AND**  
**LAND MANAGEMENT AGENCY**

**Transportation Department**



May 6, 2010

West Coast/Tipco Pile Driving, JV  
Mr. Anthony Will, Managing Partner  
818 Grayson Road  
Pleasant Hill, CA 94523

RE: Indian Canyon Drive Interchange at Interstate 10

Dear Mr. Will:

Pursuant to §4107 of the California Public Contract Code, we are hereby notifying your Joint Venture that Granite Construction Company has requested that West Coast/Tipco Pile Driving, JV be substituted with Foundation Pile, Inc., as its subcontractor related to the bridge piling scope of work on the Indian Canyon Drive Interchange project.

Granite Construction Company has requested this substitution based on the grounds that West Coast/Tipco Pile Driving, JV was mistaken listed, and Foundation Pile, Inc. was erroneously excluded from Granite Construction Company's list of subcontractors in its bid due to an inadvertent clerical error (California Public Contract Code §4107.5).

Written objections to the above substitution must be submitted within 5 working days of your receipt of this letter and should be addressed to:

Riverside County Transportation Department  
Attn: Joel Jimenez, PE  
3525 14<sup>th</sup> Street  
Riverside, CA 92501

Please return a signed and dated copy of this letter to the above address.

Sincerely,

Receipt of Letter:

*for*   
Joel Jimenez  
Senior Civil Engineer

\_\_\_\_\_  
West Coast/Tipco Pile Driving, JV

\_\_\_\_\_  
Date



**COUNTY OF RIVERSIDE**  
**TRANSPORTATION AND**  
**LAND MANAGEMENT AGENCY**



**Transportation Department**

*Juan C. Perez, P.E., T.E.*  
*Director of Transportation*

May 13, 2010

West Coast/Tipco Pile Driving, JV  
Mr. Anthony Will, Managing Partner  
818 Grayson Road  
Pleasant Hill, CA 94523

RE: Indian Canyon Drive Interchange at Interstate 10

Dear Mr. Will:

Pursuant to §4107 of the California Public Contract Code, we are hereby notifying your Joint Venture that a public hearing has been set for 9:30 a.m. or as soon thereafter, on May 25, 2010, as this matter may be heard, at the Board of Supervisor's Chambers, located on the first floor of the County Administrative Center, 4080 Lemon Street in Riverside, California 92501.

At the public hearing set forth above, the Board of Supervisors will hear the testimony regarding Granite Construction Company's request that West Coast/Tipco Pile Driving, JV be substituted with Foundation Pile, Inc., as its subcontractor related to the bridge piling scope of work on the Indian Canyon Drive Interchange project.

Granite Construction Company has requested this substitution based on the grounds that West Coast/Tipco Pile Driving, JV was mistakenly listed, and Foundation Pile, Inc. was erroneously excluded from Granite Construction Company's list of subcontractors in its bid due to an inadvertent clerical error (California Public Contract Code §4107.5).

Sincerely,

Joel Jimenez  
Senior Civil Engineer

# Form 11 Attachment

## Contract/Lease/Purchase Summary Data

**Contract (for Services)**

- Approval/Renewal
- Sole Source
- Personal Services
- Independent Contractor
- Other than Low Bid
- Change Order
- Public Works

**Lease**

- Approval/Renewal
- Multi-Year Lease
- Equipment
- Real Property
- Change Order

**Purchase (for Materials)**

- Sole Source
- Other than Low Bid
- Change Order

**Selection Committee Member Names (RFP's Only)**

<b>User Department:</b>	Transportation Department
-------------------------	---------------------------

N/A

<b>Vendor/Lessor Name:</b>	Granite Construction Company
----------------------------	------------------------------

Minority Status:  M  W  DV  None

<b>Vendor/Lessor Location:</b>	Indio, CA
--------------------------------	-----------

Local Preference Applied:  Yes  No  N/A

Local Preference Award Cost \$  
(5% maximum preference)

Local Preference FYTD: Cost \$ # of Orders

**Applicable Board Policy #**

**Comments:**

**RFQ/RFP Process:**

Date Mailed:  
Response Date:  
# of Responses:  
# of Qualified Responses:

**Bidding Process:**

Bid Range: \$ 16,526,137.00 to \$ 20,083,101.50  
Local Bid Range: N/A  
Responsive and Responsible Bid Range: \$ 16,526,137.00 to \$ 20,083,101.50

**Contract/Lease Renewals Only**

Existing Agreement Items

Proposed Agreement Items

1. Rates
2. Terms
3. Conditions
4. Legal Issues
5. Accountability
6. Utilities

(continue on blank sheet if necessary)

**NOTE: COMPETITIVELY BID PUBLIC WORKS CONTRACT**

# Riverside County Transportation Department

## Summary of Bids

### PROJECT:

Advertised: March 16, 2010 (Agenda Item: 3.64)

I-10 at Indian Canyon Dr Interchange Improvement Project  
Project No. A8-0372

Bids Open: 2 pm Date: Wednesday, April 28, 2010

Federal Aid No. ESPLHPLU-5282(034) & HP21L-5282(035)

	Company Name	Base Bid Subtotal	Alternate Bid - MISSION SPRINGS WATER DISTRICT	Total
	COUNTY'S ESTIMATE	\$25,465,100.00	\$10,500.00	\$25,475,600.00
1	GRANITE CONST. CO.	\$16,510,737.00	\$15,400.00	\$16,526,137.00
2	SECURITY PAVING CO., INC.	\$16,992,002.00	\$5,110.00	\$16,997,112.00
3	SEMA CONSTRUCTION, INC.	\$17,320,936.20	\$13,300.00	\$17,334,236.20
4	RIVERSIDE CONSTRUCTION CO.	\$17,477,944.50	\$3,500.00	\$17,481,444.50
5	SKANSKA USA CIVIL WEST	\$17,561,037.00	\$4,620.00	\$17,565,657.00
6	FTR INTERNATIONAL, INC.	\$17,931,221.00	\$17,500.00	\$17,948,721.00
7	ORTIZ ENTERPRISES, INC.	\$18,104,492.90	\$6,300.00	\$18,110,792.90
8	BEADOR CONSTRUCTION	\$18,137,019.00	\$14,000.00	\$18,151,019.00
9	SUKUT CONSTRUCTION, INC.	\$20,075,681.50	\$7,420.00	\$20,083,101.50
	<i>Average Bid Prices</i>	\$17,790,119.01	\$9,683.33	\$17,799,802.34

**Riverside County Transportation Department  
Summary of Bids**

**PROJECT: I-10/Indian Canyon Drive Interchange Improvements**

**Advertised: March 16, 2010 (Agenda Item: 3.64)  
Bids Open: 2 pm Date: Wednesday, April 28, 2010**

**PROJECT NO. A8-0372; ESPLHPLU-5282(034); HP21-L-5282 (035)**

**Granite Construction Co.  
Indio, CA 92203**

**COUNTY'S ESTIMATE**

BASE BID ITEM NO.	ITEM CODE	CONTRACT ITEM	UNITS	QUANTITY	UNIT PRICE	ENG ESTIMATE	BID UNIT PRICE	BID ESTIMATE
1	000003	ENDANGERED SPECIES PROTECTION	LS	1	50,000.00	50,000.00	2,000.00	2,000.00
2	000003	NONNATIVE PLANT PRECLUSION	LS	1	10,000.00	10,000.00	1,500.00	1,500.00
3	000003	CONSTRUCTION MONITORING CAMERA (POLE AND ELECTRIC SERVICE)	LS	1	50,000.00	50,000.00	985.00	985.00
4 (S,F)	000003	METAL SCRIPT LETTERS (RAILING METHOD)	LS	1	39,600.00	39,600.00	6,500.00	6,500.00
5	-----	ITEM DELETED BY ADDENDUM	-----	-----	-----	-----	-----	-----
6	070012	PROGRESS SCHEDULE (CRITICAL PATH METHOD)	LS	1	10,000.00	10,000.00	4,500.00	4,500.00
7	071325	TEMPORARY FENCE (TYPE ESA)	M	610	16.00	9,760.00	14.00	8,540.00
8	000003	TEMPORARY FENCE (TYPE WILDLIFE)	M	610	30.00	18,300.00	18.00	10,980.00
9	074016	CONSTRUCTION SITE MANAGEMENT	LS	1	150,000.00	150,000.00	15,000.00	15,000.00
10	074020	WATER POLLUTION CONTROL	LS	1	10,000.00	10,000.00	500.00	500.00
11	074018	HEALTH AND SAFETY PLAN	LS	1	5,000.00	5,000.00	500.00	500.00
12	074028	TEMPORARY FIBER ROLLS	M	10,800	9.00	97,200.00	7.00	75,600.00
13	074029	TEMPORARY SILT FENCE	M	960	9.00	8,640.00	17.00	16,320.00
14	074033	TEMPORARY CONSTRUCTION ENTRANCE	EA	3	3,500.00	10,500.00	4,500.00	13,500.00
15	074035	TEMPORARY CHECK DAM	M	52	9.00	468.00	35.00	1,820.00
16	074037	MOVE-IN/MOVE-OUT (TEMPORARY EROSION CONTROL)	EA	4	1,000.00	4,000.00	350.00	1,400.00
17	074038	TEMPORARY DRAINAGE INLET PROTECTION	EA	39	400.00	15,600.00	125.00	4,875.00
18	074039	TEMPORARY HYDRAULIC MULCH (POLYMER STABILIZED FIBER MATRIX)	M2	136,000	1.00	136,000.00	0.20	27,200.00
19	074041	STREET SWEEPING	LS	1	65,000.00	65,000.00	65,000.00	65,000.00
20	074042	TEMPORARY CONCRETE WASHOUT (PORTABLE)	LS	1	25,000.00	25,000.00	8,500.00	8,500.00
21	120090	CONSTRUCTION AREA SIGNS	LS	1	47,000.00	47,000.00	18,000.00	18,000.00
22	120100	TRAFFIC CONTROL SYSTEMS	LS	1	140,000.00	140,000.00	150,000.00	150,000.00
23	120120	TYPE III BARRICADE	EA	140	75.00	10,500.00	35.00	4,900.00
24	120143	TEMPORARY PAVEMENT DELINEATION	M	4,460	0.95	4,237.00	5.00	22,300.00
25	120149	TEMPORARY PAVEMENT MARKING (PAINT)	M2	100	30.00	3,000.00	40.00	4,000.00
26	120199	TRAFFIC PLASTIC DRUM	EA	590	55.00	32,450.00	30.00	17,700.00
27	128650	PORTABLE CHANGEABLE MESSAGE SIGN	EA	10	10,000.00	100,000.00	7,500.00	75,000.00
28	129000	TEMPORARY RAILING (TYPE K)	M	5,300	35.00	185,500.00	27.00	143,100.00
29	129110	TEMPORARY CRASH CUSHION [SAND FILLED]	EA	210	260.00	54,600.00	275.00	57,750.00
30	129110	TEMPORARY CRASH CUSHION [ABSORB 350]	EA	6	3,500.00	21,000.00	11,500.00	69,000.00
31	150701	REMOVE YELLOW TRAFFIC STRIPE [HAZARDOUS WASTE]	M	2,870	2.00	5,740.00	2.50	7,175.00
32	150608	REMOVE CHAIN LINK FENCE	M	610	20.00	12,200.00	14.00	8,540.00
33	150659	REMOVE TERMINAL SECTION	EA	3	1,500.00	4,500.00	2,000.00	6,000.00
34	150662	REMOVE METAL BEAM GUARD RAILING	M	660	35.00	23,100.00	22.00	14,520.00
35	150710	REMOVE TRAFFIC STRIPE	M	34,100	2.00	68,200.00	1.90	64,790.00
36	150713	REMOVE PAVEMENT MARKING	M2	52	6.00	312.00	20.00	1,040.00

**Riverside County Transportation Department  
Summary of Bids**

**PROJECT: I-10/Indian Canyon Drive Interchange Improvements**

Advertised: March 16, 2010 (Agenda Item: 3.64)  
Bids Open: 2 pm Date: Wednesday, April 28, 2010

**PROJECT NO. A8-0372; ESPLHPLU-5282(034); HP21-L-5282 (035)**

**Granite Construction Co.  
Indio, CA 92203**

**COUNTY'S ESTIMATE**

ITEM NO.	ITEM CODE	CONTRACT ITEM	UNITS	QUANTITY	UNIT PRICE	ENG ESTIMATE	BID UNIT PRICE	BID ESTIMATE
37	150722	REMOVE PAVEMENT MARKER	EA	8,520	1.50	12,780.00	2.00	17,040.00
38	150742	REMOVE ROADSIDE SIGN	EA	43	142.00	6,106.00	100.00	4,300.00
39	150760	REMOVE SIGN STRUCTURE	EA	2	5,000.00	10,000.00	3,500.00	7,000.00
40	150806	REMOVE CULVERT	M	360	120.00	43,200.00	60.00	21,600.00
41	150820	REMOVE INLET	EA	1	800.00	800.00	1,000.00	1,000.00
42	150821	REMOVE HEADWALL	EA	21	750.00	15,750.00	275.00	5,775.00
43	153153	COLD PLANE ASPHALT CONCRETE PAVEMENT (45 MM MAXIMUM)	M2	1,080	4.00	4,320.00	8.50	9,180.00
44	160101	CLEARING AND GRUBBING	LS	1	82,500.00	82,500.00	82,500.00	82,500.00
45	170101	DEVELOP WATER SUPPLY	LS	1	10,000.00	10,000.00	10,000.00	10,000.00
46 (F)	190101	ROADWAY EXCAVATION	M3	29,170	20.00	583,400.00	15.00	437,550.00
47	190110	LEAD COMPLIANCE PLAN (METRIC)	LS	1	5,000.00	5,000.00	500.00	500.00
48	190113	ASBESTOS COMPLIANCE PLAN	LS	1	5,000.00	5,000.00	500.00	500.00
49	193118	CONCRETE BACKFILL	M3	14	80.00	1,120.00	225.00	3,150.00
50	194001	DITCH EXCAVATION	M3	320	30.00	9,600.00	8.00	2,560.00
51	198001	IMPORTED BORROW	M3	71,000	25.00	1,775,000.00	7.25	514,750.00
52	203016	EROSION CONTROL (TYPE D)	M2	13,200	1.50	19,800.00	0.65	8,580.00
53	203021	FIBER ROLLS (METRIC)	M	10,500	9.00	94,500.00	8.00	84,000.00
54	203026	MOVE-IN/MOVE-OUT (EROSION CONTROL)	EA	1	1,448.00	1,448.00	350.00	350.00
55	208731	200 MM CORRUGATED HIGH DENSITY POLYETHYLENE PIPE CONDUIT	M	68	200.00	13,600.00	200.00	13,600.00
56	220101	FINISHING ROADWAY	LS	1	28,000.00	28,000.00	25,000.00	25,000.00
57	260201	CLASS 2 AGGREGATE BASE	M3	14,600	50.00	730,000.00	22.00	321,200.00
58	280000	LEAN CONCRETE BASE	M3	190	190.00	36,100.00	200.00	38,000.00
59	374002	ASPHALTIC EMULSION (FOG SEAL COAT)	TONN	6	725.00	4,350.00	3,000.00	18,000.00
60	390106	ASPHALT CONCRETE (OPEN GRADED)[OPEN GRADED FRICTION COURSE]	TONN	1,310	100.00	131,000.00	90.00	117,900.00
61	390130	HOT MIX ASPHALT (TYPE A)	TONN	320	90.00	28,800.00	99.50	31,840.00
62	000003	HOT MIX ASPHALT (TYPE A BOND BREAKER)	TONN	120	115.00	13,800.00	110.00	13,200.00
63	000003	HOT MIX ASPHALT (TYPE C)	TONN	31,200	90.00	2,808,000.00	71.00	2,215,200.00
64	394071	PLACE HOT MIX ASPHALT DIKE	M	4,570	6.00	27,420.00	6.50	29,705.00
65	394090	PLACE HOT MIX ASPHALT (MISCELLANEOUS AREA)	M2	320	100.00	32,000.00	40.00	12,800.00
66	397005	TACK COAT	TONN	38	550.00	20,900.00	1,400.00	53,200.00
67	401066	CONCRETE PAVEMENT (EXIT RAMP TERMINI) [JOINTED PLAIN CONCRETE PAVEMENT]	M3	430	300.00	129,000.00	275.00	118,250.00
68	401108	RAPID STRENGTH CONCRETE [JOINTED PLAIN CONCRETE PAVEMENT]	M3	3,780	1,000.00	3,780,000.00	205.00	774,900.00
69	000003	SEAL ISOLATION JOINT	M	1,280	20.00	25,600.00	4.00	5,120.00
70	414091	SEAL LONGITUDINAL JOINT	M	2,140	6.00	12,840.00	4.00	8,560.00
71	414101	SEAL TRANSVERSE JOINT	M	2,120	6.00	12,720.00	4.00	8,480.00

**Riverside County Transportation Department  
Summary of Bids**

**PROJECT: I-10/Indian Canyon Drive Interchange Improvements**

Advertised: March 16, 2010 (Agenda Item: 3.64)  
Bids Open: 2 pm Date: Wednesday, April 28, 2010

**PROJECT NO. A8-0372; ESPLHPLU-5282(034); HP21-L-5282 (035)**

**Granite Construction Co.  
Indio, CA 92203**

**COUNTY'S ESTIMATE**

BASE BID (CONTINUED) ITEM NO.	ITEM CODE	CONTRACT ITEM	UNITS	QUANTITY	UNIT PRICE	ENG ESTIMATE	BID UNIT PRICE	BID ESTIMATE
72	518201	MASONRY STONE WALL	M2	23	262.50	6,037.50	800.00	18,400.00
73 (F)	510129	CLASS 2 CONCRETE (BOX CULVERT)	M3	190	850.00	161,500.00	1,000.00	190,000.00
74 (F)	510502	MINOR CONCRETE (MINOR STRUCTURE)	M3	110	1,350.00	148,500.00	2,000.00	220,000.00
75 (F)	520107	BAR REINFORCING STEEL (BOX CULVERT)	KG	21,271	2.50	53,177.50	2.00	42,542.00
76 (F)	560218	FURNISH SIGN STRUCTURE (TRUSS)	KG	30,000	9.00	270,000.00	9.00	270,000.00
77 (F)	560219	INSTALL SIGN STRUCTURE (TRUSS)	KG	30,000	1.20	36,000.00	1.00	30,000.00
78	560234	FURNISH LAMINATED PANEL SIGN (25.4 MM -TYPE A)	M2	67	180.00	12,060.00	250.00	16,750.00
79	560238	FURNISH SINGLE SHEET ALUMINUM SIGN (1.6 MM- UNFRAMED)	M2	56	130.00	7,280.00	125.00	7,000.00
80	560239	FURNISH SINGLE SHEET ALUMINUM SIGN (2.0 MM- UNFRAMED)	M2	30	140.00	4,200.00	140.00	4,200.00
81	560241	FURNISH SINGLE SHEET ALUMINUM SIGN (1.6 MM- FRAMED)	M2	13	170.00	2,210.00	135.00	1,755.00
82	560242	FURNISH SINGLE SHEET ALUMINUM SIGN (2.0 MM- FRAMED)	M2	71	160.00	11,360.00	150.00	10,650.00
83	561015	1524 MM CAST-IN-DRILLED-HOLE CONCRETE PILE (SIGN FOUNDATION)	M	23	3,200.00	73,600.00	4,000.00	92,000.00
84	566011	ROADSIDE SIGN - ONE POST	EA	85	400.00	34,000.00	350.00	29,750.00
85	566012	ROADSIDE SIGN - TWO POST	EA	17	900.00	15,300.00	575.00	9,775.00
86	568001	INSTALL SIGN (STRAP AND SADDLE BRACKET METHOD)	EA	8	110.00	880.00	350.00	2,800.00
87	568015	INSTALL SIGN (MAST-ARM HANGER METHOD)	EA	22	200.00	4,400.00	375.00	8,250.00
88	620909	450 MM ALTERNATIVE PIPE CULVERT	M	71	300.00	21,300.00	160.00	11,360.00
89	620913	600 MM ALTERNATIVE PIPE CULVERT	M	230	350.00	80,500.00	170.00	39,100.00
90	620924	900 MM ALTERNATIVE PIPE CULVERT	M	120	550.00	66,000.00	180.00	21,600.00
91	664097	600 MM BITUMINOUS COATED CORRUGATED STEEL PIPE (2.77 MM THICK)	M	200	450.00	90,000.00	200.00	40,000.00
92	664110	900 MM BITUMINOUS COATED CORRUGATED STEEL PIPE (2.77 MM THICK)	M	50	750.00	37,500.00	225.00	11,250.00
93	717072	100 MM POLYVINYL CHLORIDE SEWER PIPE	M	37	50.00	1,850.00	50.00	1,850.00
94	721008	ROCK SLOPE PROTECTION (LIGHT, METHOD B)	M3	140	120.00	16,800.00	160.00	22,400.00
95	721430	CONCRETE (CHANNEL LINING)	M3	73	300.00	21,900.00	500.00	36,500.00
96	729010	ROCK SLOPE PROTECTION FABRIC	M2	330	20.00	6,600.00	25.00	8,250.00
97 (F)	731504	MINOR CONCRETE (CURB AND GUTTER)	M3	250	650.00	162,500.00	775.00	193,750.00
98 (F)	000003	MINOR CONCRETE (COLORED)	M2	1,890	120.00	226,800.00	120.00	226,800.00
99 (F)	731521	MINOR CONCRETE (SIDEWALK)	M3	260	600.00	156,000.00	525.00	136,500.00
100 (F)	731530	MINOR CONCRETE (TEXTURED PAVING)	M2	1,190	180.00	214,200.00	125.00	148,750.00
101 (F)	750001	MISCELLANEOUS IRON AND STEEL	KG	1,262	4.50	5,679.00	10.00	12,620.00
102	800391	CHAIN LINK FENCE (TYPE CL-1.8)	M	940	50.00	47,000.00	65.00	61,100.00
103	820105	DELINEATOR (SPECIAL)	EA	23	75.00	1,725.00	60.00	1,380.00
104	820107	DELINEATOR (CLASS 1)	EA	160	50.00	8,000.00	50.00	8,000.00
105	832003	METAL BEAM GUARD RAILING (WOOD POST)	M	670	90.00	60,300.00	99.00	66,330.00
106	839541	TRANSITION RAILING (TYPE WB)	EA	4	3,800.00	15,200.00	6,000.00	24,000.00



**Riverside County Transportation Department  
Summary of Bids**

**PROJECT: I-10/Indian Canyon Drive Interchange Improvements**

Advertised: March 16, 2010 (Agenda Item: 3.64)

Bids Open: 2 pm Date: Wednesday, April 28, 2010

**PROJECT NO. A8-0372; ESPLHPLU-5282(034) & HP21L-5282 (035)**

**Granite Construction Co.  
Indio, CA 92203**

**COUNTY'S ESTIMATE**

ITEM NO.	ITEM CODE	CONTRACT ITEM	UNITS	QUANTITY	UNIT PRICE	ENG ESTIMATE	BID UNIT PRICE	BID ESTIMATE
107	839568	TERMINAL ANCHOR ASSEMBLY (TYPE SFT)	EA	5	900.00	4,500.00	900.00	4,500.00
108	839585	ALTERNATIVE FLARED TERMINAL SYSTEM [TYPE SRT]	EA	9	2,200.00	19,800.00	3,500.00	31,500.00
109	839605	CRASH CUSHION (REACT 9SCBS)	EA	3	50,000.00	150,000.00	75,000.00	225,000.00
110	839703	CONCRETE BARRIER (TYPE 60C)	M	270	300.00	81,000.00	525.00	141,750.00
111	839705	CONCRETE BARRIER (TYPE 60E)	M	89	600.00	53,400.00	515.00	45,835.00
112	840515	THERMOPLASTIC PAVEMENT MARKING	M2	360	40.00	14,400.00	40.00	14,400.00
113	840563	200 MM THERMOPLASTIC TRAFFIC STRIPE	M	1,210	3.00	3,630.00	3.00	3,630.00
114	840571	100 MM THERMOPLASTIC TRAFFIC STRIPE (BROKEN 5:18 M - 2:14 M)	M	9,600	2.00	19,200.00	2.25	21,600.00
115	840656	PAINT TRAFFIC STRIPE (2-COAT)	M	13,100	2.00	26,200.00	1.25	16,375.00
116	850101	PAVEMENT MARKER (NON-REFLECTIVE)	EA	15,300	2.00	30,600.00	2.10	32,130.00
117	850110	PAVEMENT MARKER (RETROREFLECTIVE-SPECIAL TYPE C)	EA	86	60.00	5,160.00	5.00	430.00
118	850111	PAVEMENT MARKER (RETROREFLECTIVE-SPECIAL TYPE D)	EA	790	3.00	2,370.00	5.00	3,950.00
119	850112	PAVEMENT MARKER (RETROREFLECTIVE-SPECIAL TYPE G)	EA	2,790	4.00	11,160.00	5.00	13,950.00
120	850113	PAVEMENT MARKER (RETROREFLECTIVE-SPECIAL TYPE H)	EA	450	4.00	1,800.00	5.00	2,250.00
121	860251	SIGNAL AND LIGHTING (LOCATION 1)	LS	1	150,000.00	150,000.00	210,000.00	210,000.00
122	860252	SIGNAL AND LIGHTING (LOCATION 2)	LS	1	150,000.00	150,000.00	195,000.00	195,000.00
123	860300	SIGNAL AND LIGHTING (CITY STREET LOCATION 1)	LS	1	180,000.00	180,000.00	235,000.00	235,000.00
124	860302	SIGNAL AND LIGHTING (CITY STREET LOCATION 2)	LS	1	180,000.00	180,000.00	250,000.00	250,000.00
125	860460	LIGHTING AND SIGN ILLUMINATION	LS	1	175,000.00	175,000.00	590,000.00	590,000.00
126	860701	INTERCONNECTION CONDUIT AND CONDUCTOR	LS	1	15,000.00	15,000.00	160,000.00	160,000.00
127	861101	RAMP METERING SYSTEM (LOCATION 1)	LS	1	75,000.00	75,000.00	130,000.00	130,000.00
128	861102	RAMP METERING SYSTEM (LOCATION 2)	LS	1	80,000.00	80,000.00	140,000.00	140,000.00
129	861103	RAMP METERING SYSTEM (LOCATION 3)	LS	1	75,000.00	75,000.00	120,000.00	120,000.00
130	861104	RAMP METERING SYSTEM (LOCATION 4)	LS	1	90,000.00	90,000.00	130,000.00	130,000.00
131	861349	REMOVE EXISTING SIGNAL SYSTEM (LOCATION 1)	LS	1	10,000.00	10,000.00	80,000.00	80,000.00
132	861350	REMOVE EXISTING SIGNAL SYSTEM (LOCATION 2)	LS	1	10,000.00	10,000.00	80,000.00	80,000.00
133	999990	MOBILIZATION	LS	1	2,000,000.00	2,000,000.00	834,000.00	834,000.00
134	000003	COURSE OF CONSTRUCTION INSURANCE	LS	1	25,000.00	25,000.00	8,000.00	8,000.00
135	019901	DEMobilIZATION	LS	1	467,000.00	467,000.00	500.00	500.00
136	066102	DUST ABATEMENT	LS	1	25,000.00	25,000.00	45,000.00	45,000.00
137	066105	RESIDENT ENGINEER OFFICE	LS	1	410,000.00	410,000.00	25,000.00	25,000.00
138	066840	TRAFFIC SIGNAL CONTROLLER ASSEMBLY [WITH BATTERY BACK-UP][2-LOCATIONS]	LS	1	13,600.00	13,600.00	13,600.00	13,600.00
139	066843	MODEL 170 CONTROLLER ASSEMBLY [RAMP METER][4-LOCATIONS]	LS	1	19,200.00	19,200.00	19,200.00	19,200.00
140	066015	FEDERAL TRAINEE PROGRAM	LS	1	8,800.00	8,800.00	5,000.00	5,000.00
141	047403	610 MM STEEL PIPE CASING	M	26	200.00	5,200.00	1,000.00	26,000.00

**Riverside County Transportation Department  
Summary of Bids**

**PROJECT: I-10/Indian Canyon Drive Interchange Improvements**

Advertised: March 16, 2010 (Agenda Item: 3.64)  
Bids Open: 2 pm Date: Wednesday, April 28, 2010

**PROJECT NO. A8-0372; ESPLHPLU-5282(034); HP21-L-5282 (035)**

**Granite Construction Co.  
Indio, CA 92203**

BASE BID (CONTINUED)		COUNTY'S ESTIMATE						
ITEM NO.	ITEM CODE	CONTRACT ITEM	UNITS	QUANTITY	UNIT PRICE	ENG ESTIMATE	BID UNIT PRICE	BID ESTIMATE
142	157550	BRIDGE REMOVAL	LS	1	150,000.00	150,000.00	85,000.00	85,000.00
143 (F)	192003	STRUCTURE EXCAVATION (BRIDGE)	M3	1,150	100.00	115,000.00	90.00	103,500.00
144 (F)	193003	STRUCTURE BACKFILL (BRIDGE)	M3	490	120.00	58,800.00	125.00	61,250.00
145	490566	FURNISH STEEL PILING (HP 360 X 132)	M	2,977	300.00	893,100.00	165.00	491,205.00
146	490567	DRIVE STEEL PILE (HP 360 X 132)	EA	196	2,500.00	490,000.00	1,525.00	298,900.00
147	*****	ITEM DELETED BY ADDENDUM	*****	*****	*****	*****	*****	*****
148	*****	ITEM DELETED BY ADDENDUM	*****	*****	*****	*****	*****	*****
149	500020	PRESTRESSING PRECAST GIRDER	LS	1	120,000.00	120,000.00	95,000.00	95,000.00
150 (F)	510051	STRUCTURAL CONCRETE, BRIDGE FOOTING	M3	220	700.00	154,000.00	425.00	93,500.00
151 (F)	510053	STRUCTURAL CONCRETE, BRIDGE	M3	1,710	1,100.00	1,881,000.00	870.00	1,487,700.00
152 (F)	510086	STRUCTURAL CONCRETE, APPROACH SLAB (TYPE N)	M3	210	1,000.00	210,000.00	650.00	136,500.00
153	511036	ARCHITECTURAL SURFACE [LAVA ROCK FACING]	M2	170	110.00	18,700.00	250.00	42,500.00
154 (F)	511063	FRACTURED FIN TEXTURE	M2	140	110.00	15,400.00	130.00	18,200.00
155	512254	FURNISH PRECAST PRESTRESSED CONCRETE BULB-TEE GIRDER (25 M-30 M)	EA	26	30,000.00	780,000.00	20,000.00	520,000.00
156	512255	FURNISH PRECAST PRESTRESSED CONCRETE BULB-TEE GIRDER (30 M-35 M)	EA	13	35,000.00	455,000.00	24,000.00	312,000.00
157	512500	ERECT PRECAST PRESTRESSED CONCRETE GIRDER	EA	39	5,000.00	195,000.00	2,200.00	85,800.00
158	519123	JOINT SEAL (TYPE B - MR 50 MM)	M	72	230.00	16,560.00	300.00	21,600.00
159 (F)	520102	BAR REINFORCING STEEL (BRIDGE)	KG	244,000	4.65	1,134,600.00	2.00	488,000.00
160 (F)	721810	SLOPE PAVING (CONCRETE)	M3	72	800.00	57,600.00	1,360.00	97,920.00
161 (F)	750505	BRIDGE DECK DRAINAGE SYSTEM	KG	470	20.00	9,400.00	22.50	10,575.00
162 (F)	833088	TUBULAR HANDRAILING	M	10	100.00	1,000.00	240.00	2,400.00
163 (F)	833142	CONCRETE BARRIER (TYPE 26 MODIFIED)	M	110	400.00	44,000.00	690.00	75,900.00
164	839727	CONCRETE BARRIER (TYPE 736 MODIFIED)	M	110	350.00	38,500.00	420.00	46,200.00
165 (F)	833020	CHAIN LINK RAILING [MINI MESH]	M	91	200.00	18,200.00	1,250.00	113,750.00
		<b>BSAE BID TOTAL</b>				<b>25,465,100.00</b>		<b>16,510,737.00</b>
		ITEMS 1 - 165						

**ALTERNATE BID:**

THE MISSION SPRINGS WATER DISTRICT

166	0000003	ADJUST WATER VALVE COVER TO GRADE	EA	14	750.00	10,500.00	1,100.00	15,400.00
		<b>ALTERNATE BID TOTAL</b>				<b>10,500.00</b>		<b>15,400.00</b>
		ITEMS 166						

		<b>PROJECT TOTAL</b>				<b>25,475,600.00</b>		<b>16,526,137.00</b>
		ITEMS 1 - 166						

# Riverside County Transportation Department Summary of Bids

PROJECT: I-10/Indian Canyon Drive Interchange Improvements

Advertised: March 16, 2010 (Agenda Item: 3.64)

Bids Open: 2 pm Date: Wednesday, April 28, 2010

PROJECT NO. A8-0372; ESPLHPLU-5282(034); HP21-L-5282 (035)

Security Paving Co., Inc.  
Sun Valley, CA 91352

SEMA Const. Inc.  
Lake Forest, CA 92630

BASE BID	ITEM NO.	ITEM CODE	CONTRACT ITEM	UNITS	QUANTITY	BID UNIT PRICE	BID ESTIMATE	BID UNIT PRICE	BID ESTIMATE
1		000003	ENDANGERED SPECIES PROTECTION	LS	1	4,320.00	4,320.00	4,000.00	4,000.00
2		000003	NONNATIVE PLANT PRECLUSION	LS	1	2,000.00	2,000.00	9,400.00	9,400.00
3		000003	CONSTRUCTION MONITORING CAMERA (POLE AND ELECTRIC SERVICE)	LS	1	8,100.00	8,100.00	16,100.00	16,100.00
4 (S,F)		000003	METAL SCRIPT LETTERS (RAILING METHOD)	LS	1	32,400.00	32,400.00	51,900.00	51,900.00
5		*****	ITEM DELETED BY ADDENDUM	-----	-----	-----	-----	-----	-----
6		070012	PROGRESS SCHEDULE (CRITICAL PATH METHOD)	LS	1	5,000.00	5,000.00	5,000.00	5,000.00
7		071325	TEMPORARY FENCE (TYPE ESA)	M	610	14.00	8,540.00	8.50	5,185.00
8		000003	TEMPORARY FENCE (TYPE WILDLIFE)	M	610	16.00	9,760.00	8.50	5,185.00
9		074016	CONSTRUCTION SITE MANAGEMENT	LS	1	15,000.00	15,000.00	43,800.00	43,800.00
10		074020	WATER POLLUTION CONTROL	LS	1	5,000.00	5,000.00	10,000.00	10,000.00
11		074018	HEALTH AND SAFETY PLAN	LS	1	1,000.00	1,000.00	5,500.00	5,500.00
12		074028	TEMPORARY FIBER ROLLS	M	10,800	8.40	90,720.00	7.00	75,600.00
13		074029	TEMPORARY SILT FENCE	M	960	7.35	7,056.00	6.00	5,760.00
14		074033	TEMPORARY CONSTRUCTION ENTRANCE	EA	3	3,000.00	9,000.00	1,000.00	3,000.00
15		074035	TEMPORARY CHECK DAM	M	52	6.00	312.00	46.00	2,392.00
16		074037	MOVE-IN/MOVE-OUT (TEMPORARY EROSION CONTROL)	EA	4	420.00	1,680.00	500.00	2,000.00
17		074038	TEMPORARY DRAINAGE INLET PROTECTION	EA	39	210.00	8,190.00	84.00	3,276.00
18		074039	TEMPORARY HYDRAULIC MULCH (POLYMER STABILIZED FIBER MATRIX)	M2	136,000	0.25	34,000.00	0.22	29,920.00
19		074041	STREET SWEEPING	LS	1	60,000.00	60,000.00	19,000.00	19,000.00
20		074042	TEMPORARY CONCRETE WASHOUT (PORTABLE)	LS	1	5,500.00	5,500.00	10,800.00	10,800.00
21		120090	CONSTRUCTION AREA SIGNS	LS	1	25,000.00	25,000.00	51,500.00	51,500.00
22		120100	TRAFFIC CONTROL SYSTEMS	LS	1	150,000.00	150,000.00	275,000.00	275,000.00
23		120120	TYPE III BARRICADE	EA	140	80.00	11,200.00	190.00	26,600.00
24		120143	TEMPORARY PAVEMENT DELINEATION	M	4,460	2.10	9,366.00	0.70	3,122.00
25		120149	TEMPORARY PAVEMENT MARKING (PAINT)	M2	100	27.00	2,700.00	35.00	3,500.00
26		120199	TRAFFIC PLASTIC DRUM	EA	590	105.00	61,950.00	82.00	48,380.00
27		128650	PORTABLE CHANGEABLE MESSAGE SIGN	EA	10	4,860.00	48,600.00	3,800.00	38,000.00
28		129000	TEMPORARY RAILING (TYPE K)	M	5,300	29.00	153,700.00	33.00	174,900.00
29		129110	TEMPORARY CRASH CUSHION [SAND FILLED]	EA	210	178.00	37,380.00	170.00	35,700.00
30		129110	TEMPORARY CRASH CUSHION [ABSORB 350]	EA	6	2,100.00	12,600.00	20,600.00	123,600.00
31		150701	REMOVE YELLOW TRAFFIC STRIPE [HAZARDOUS WASTE]	M	2,870	1.60	4,592.00	3.30	9,471.00
32		150608	REMOVE CHAIN LINK FENCE	M	610	14.00	8,540.00	17.00	10,370.00
33		150659	REMOVE TERMINAL SECTION	EA	3	160.00	480.00	700.00	2,100.00
34		150662	REMOVE METAL BEAM GUARD RAILING	M	660	28.00	18,480.00	27.00	17,820.00
35		150710	REMOVE TRAFFIC STRIPE	M	34,100	0.10	3,410.00	0.15	5,115.00
36		150713	REMOVE PAVEMENT MARKING	M2	52	16.00	832.00	20.00	1,040.00

**Riverside County Transportation Department  
Summary of Bids**

**PROJECT: I-10/Indian Canyon Drive Interchange Improvements**

Advertised: March 16, 2010 (Agenda Item: 3.64)  
Bids Open: 2 pm Date: Wednesday, April 28, 2010

**PROJECT NO. A8-0372; ESPLHPLU-5282(034); HP21-L-5282 (035)**

BASE BID (CONTINUED)		Security Paving Co., Inc. Sun Valley, CA 91352		SEMA Const. Inc. Lake Forest, CA 92630				
ITEM NO.	ITEM CODE	CONTRACT ITEM	UNITS	QUANTITY	BID UNIT PRICE	BID ESTIMATE	BID UNIT PRICE	BID ESTIMATE
37	150722	REMOVE PAVEMENT MARKER	EA	8,520	0.55	4,686.00	0.70	5,964.00
38	150742	REMOVE ROADSIDE SIGN	EA	43	168.00	7,224.00	94.00	4,042.00
39	150760	REMOVE SIGN STRUCTURE	EA	2	3,000.00	6,000.00	1,900.00	3,800.00
40	150806	REMOVE CULVERT	M	360	40.00	14,400.00	60.00	21,600.00
41	150820	REMOVE INLET	EA	1	800.00	800.00	950.00	950.00
42	150821	REMOVE HEADWALL	EA	21	570.00	11,970.00	610.00	12,810.00
43	153153	COLD PLANE ASPHALT CONCRETE PAVEMENT (45 MM MAXIMUM)	M2	1,080	11.00	11,880.00	15.00	16,200.00
44	160101	CLEARING AND GRUBBING	LS	1	30,000.00	30,000.00	82,500.00	82,500.00
45	170101	DEVELOP WATER SUPPLY	LS	1	60,000.00	60,000.00	10,000.00	10,000.00
46 (F)	190101	ROADWAY EXCAVATION	M3	29,170	12.00	350,040.00	14.00	408,380.00
47	190110	LEAD COMPLIANCE PLAN (METRIC)	LS	1	7,000.00	7,000.00	5,000.00	5,000.00
48	190113	ASBESTOS COMPLIANCE PLAN	LS	1	8,000.00	8,000.00	31,900.00	31,900.00
49	193118	CONCRETE BACKFILL	M3	14	262.00	3,668.00	200.00	2,800.00
50	194001	DITCH EXCAVATION	M3	320	7.00	2,240.00	16.00	5,120.00
51	198001	IMPORTED BORROW	M3	71,000	12.00	852,000.00	7.00	497,000.00
52	203016	EROSION CONTROL (TYPE D)	M2	13,200	1.05	13,860.00	1.30	17,160.00
53	203021	FIBER ROLLS (METRIC)	M	10,500	9.50	99,750.00	7.00	73,500.00
54	203026	MOVE-IN/REMOVE-OUT (EROSION CONTROL)	EA	1	525.00	525.00	500.00	500.00
55	208731	200 MM CORRUGATED HIGH DENSITY POLYETHYLENE PIPE CONDUIT	M	68	150.00	10,200.00	130.00	8,840.00
56	220101	FINISHING ROADWAY	LS	1	13,000.00	13,000.00	10,000.00	10,000.00
57	260201	CLASS 2 AGGREGATE BASE	M3	14,600	29.00	423,400.00	82.00	1,197,200.00
58	280000	LEAN CONCRETE BASE	M3	190	210.00	39,900.00	390.00	74,100.00
59	374002	ASPHALTIC EMULSION (FOG SEAL COAT)	TONN	6	1,200.00	7,200.00	1,500.00	9,000.00
60	390106	ASPHALT CONCRETE (OPEN GRADED)[OPEN GRADED FRICTION COURSE]	TONN	1,310	120.00	157,200.00	180.00	235,800.00
61	390130	HOT MIX ASPHALT (TYPE A)	TONN	320	97.00	31,040.00	190.00	60,800.00
62	000003	HOT MIX ASPHALT (TYPE A BOND BREAKER)	TONN	120	175.00	21,000.00	250.00	30,000.00
63	000003	HOT MIX ASPHALT (TYPE C)	TONN	31,200	103.00	3,213,600.00	110.00	3,432,000.00
64	394071	PLACE HOT MIX ASPHALT DIKE	M	4,570	6.00	27,420.00	1.60	7,312.00
65	394090	PLACE HOT MIX ASPHALT (MISCELLANEOUS AREA)	M2	320	26.00	8,320.00	52.00	16,640.00
66	397005	TACK COAT	TONN	38	640.00	24,320.00	520.00	19,760.00
67	401066	CONCRETE PAVEMENT (EXIT RAMP TERMINI) [JOINTED PLAIN CONCRETE PAVEMENT]	M3	430	300.00	129,000.00	360.00	154,800.00
68	401108	RAPID STRENGTH CONCRETE [JOINTED PLAIN CONCRETE PAVEMENT]	M3	3,780	565.00	2,135,700.00	380.00	1,436,400.00
69	000003	SEAL ISOLATION JOINT	M	1,280	37.00	47,360.00	22.00	28,160.00
70	414091	SEAL LONGITUDINAL JOINT	M	2,140	18.00	38,520.00	6.50	13,910.00
71	414101	SEAL TRANSVERSE JOINT	M	2,120	18.00	38,160.00	6.50	13,780.00

**Riverside County Transportation Department  
Summary of Bids**

**PROJECT: I-10/Indian Canyon Drive Interchange Improvements**

**Advertised: March 16, 2010 (Agenda Item: 3.64)**

**Bids Open: 2 pm Date: Wednesday, April 28, 2010**

**PROJECT NO. A8-0372; ESPLHPLU-5282(034); HP21-L-5282 (035)**

**Security Paving Co., Inc.  
Sun Valley, CA 91352**

**SEMA Const. Inc.  
Lake Forest, CA 92630**

BASE BID (CONTINUED)		ITEM CODE	CONTRACT ITEM	UNITS	QUANTITY	BID UNIT PRICE	BID ESTIMATE	BID UNIT PRICE	BID ESTIMATE
72		518201	MASONRY STONE WALL	M2	23	340.00	7,820.00	260.00	5,980.00
73 (F)		510129	CLASS 2 CONCRETE (BOX CULVERT)	M3	190	485.00	92,150.00	750.00	142,500.00
74 (F)		510502	MINOR CONCRETE (MINOR STRUCTURE)	M3	110	1,800.00	198,000.00	1,300.00	143,000.00
75 (F)		520107	BAR REINFORCING STEEL (BOX CULVERT)	KG	21,271	2.00	42,542.00	1.20	25,525.20
76 (F)		560218	FURNISH SIGN STRUCTURE (TRUSS)	KG	30,000	5.60	168,000.00	6.23	186,900.00
77 (F)		560219	INSTALL SIGN STRUCTURE (TRUSS)	KG	30,000	0.45	13,500.00	0.30	9,000.00
78		560234	FURNISH LAMINATED PANEL SIGN (25.4 MM -TYPE A)	M2	67	147.00	9,849.00	220.00	14,740.00
79		560238	FURNISH SINGLE SHEET ALUMINUM SIGN (1.6 MM- UNFRAMED)	M2	56	90.00	5,040.00	100.00	5,600.00
80		560239	FURNISH SINGLE SHEET ALUMINUM SIGN (2.0 MM- UNFRAMED)	M2	30	96.00	2,880.00	110.00	3,300.00
81		560241	FURNISH SINGLE SHEET ALUMINUM SIGN (1.6 MM- FRAMED)	M2	13	115.00	1,495.00	200.00	2,600.00
82		560242	FURNISH SINGLE SHEET ALUMINUM SIGN (2.0 MM- FRAMED)	M2	71	122.00	8,662.00	140.00	9,940.00
83		561015	1524 MM CAST-IN-DRILLED-HOLE CONCRETE PILE (SIGN FOUNDATION)	M	23	2,010.00	46,230.00	3,800.00	87,400.00
84		566011	ROADSIDE SIGN - ONE POST	EA	85	300.00	25,500.00	240.00	20,400.00
85		566012	ROADSIDE SIGN - TWO POST	EA	17	420.00	7,140.00	550.00	9,350.00
86		568001	INSTALL SIGN (STRAP AND SADDLE BRACKET METHOD)	EA	8	240.00	1,920.00	110.00	880.00
87		568015	INSTALL SIGN (MAST-ARM HANGER METHOD)	EA	22	790.00	17,380.00	460.00	10,120.00
88		620909	450 MM ALTERNATIVE PIPE CULVERT	M	71	193.00	13,703.00	170.00	12,070.00
89		620913	600 MM ALTERNATIVE PIPE CULVERT	M	230	166.00	38,180.00	210.00	48,300.00
90		620924	900 MM ALTERNATIVE PIPE CULVERT	M	120	229.00	27,480.00	240.00	28,800.00
91		664097	600 MM BITUMINOUS COATED CORRUGATED STEEL PIPE (2.77 MM THICK)	M	200	200.00	40,000.00	200.00	40,000.00
92		664110	900 MM BITUMINOUS COATED CORRUGATED STEEL PIPE (2.77 MM THICK)	M	50	300.00	15,000.00	250.00	12,500.00
93		717072	100 MM POLYVINYL CHLORIDE SEWER PIPE	M	37	40.00	1,480.00	71.00	2,627.00
94		721008	ROCK SLOPE PROTECTION (LIGHT, METHOD B)	M3	140	175.00	24,500.00	140.00	19,600.00
95		721430	CONCRETE (CHANNEL LINING)	M3	73	300.00	21,900.00	310.00	22,630.00
96		729010	ROCK SLOPE PROTECTION FABRIC	M2	330	3.00	990.00	10.00	3,300.00
97 (F)		731504	MINOR CONCRETE (CURB AND GUTTER)	M2	250	605.00	151,250.00	640.00	160,000.00
98 (F)		000003	MINOR CONCRETE (COLORED)	M2	1,890	120.00	226,800.00	58.00	109,620.00
99 (F)		731521	MINOR CONCRETE (SIDEWALK)	M3	260	530.00	137,800.00	430.00	111,800.00
100 (F)		731530	MINOR CONCRETE (TEXTURED PAVING)	M2	1,190	140.00	166,600.00	97.00	115,430.00
101 (F)		750001	MISCELLANEOUS IRON AND STEEL	KG	1,262	5.00	6,310.00	4.00	5,048.00
102		800391	CHAIN LINK FENCE (TYPE CL-1.8)	M	940	40.00	37,600.00	50.00	47,000.00
103		820105	DELINEATOR (SPECIAL)	EA	23	42.00	966.00	31.00	713.00
104		820107	DELINEATOR (CLASS 1)	EA	160	37.00	5,920.00	36.00	5,760.00
105		832003	METAL BEAM GUARD RAILING (WOOD POST)	M	670	64.00	42,880.00	84.00	56,280.00
106		839541	TRANSITION RAILING (TYPE WB)	EA	4	3,150.00	12,600.00	2,800.00	11,200.00

**Riverside County Transportation Department  
Summary of Bids**

**PROJECT: I-10/Indian Canyon Drive Interchange Improvements**

Advertised: March 16, 2010 (Agenda Item: 3.64)

Bids Open: 2 pm Date: Wednesday, April 28, 2010

**PROJECT NO. A8-0372; ESPLHPLU-5282(034) & HP21L-5282 (035)**

**Security Paving Co., Inc.  
Sun Valley, CA 91352**

**SEMA Const. Inc.  
Lake Forest, CA 92630**

ITEM NO.	ITEM CODE	CONTRACT ITEM	UNITS	QUANTITY	BID UNIT PRICE	BID ESTIMATE	BID UNIT PRICE	BID ESTIMATE
107	839568	TERMINAL ANCHOR ASSEMBLY (TYPE SFT)	EA	5	735.00	3,675.00	1,000.00	5,000.00
108	839585	ALTERNATIVE FLARED TERMINAL SYSTEM [TYPE SRT]	EA	9	2,310.00	20,790.00	2,300.00	20,700.00
109	839605	CRASH CUSHION (REACT 9SCBS)	EA	3	61,000.00	183,000.00	51,100.00	153,300.00
110	839703	CONCRETE BARRIER (TYPE 60C)	M	270	200.00	54,000.00	210.00	56,700.00
111	839705	CONCRETE BARRIER (TYPE 60E)	M	89	256.00	22,784.00	420.00	37,380.00
112	840515	THERMOPLASTIC PAVEMENT MARKING	M2	360	37.00	13,320.00	22.00	7,920.00
113	840563	200 MM THERMOPLASTIC TRAFFIC STRIPE	M	1,210	3.10	3,751.00	5.00	6,050.00
114	840571	100 MM THERMOPLASTIC TRAFFIC STRIPE (BROKEN 5.18 M - 2.14 M)	M	9,600	1.45	13,920.00	1.10	10,560.00
115	840656	PAINT TRAFFIC STRIPE (2-COAT)	M	13,100	1.20	15,720.00	0.25	3,275.00
116	850101	PAVEMENT MARKER (NON-REFLECTIVE)	EA	15,300	1.30	19,890.00	1.40	21,420.00
117	850110	PAVEMENT MARKER (RETROREFLECTIVE-SPECIAL TYPE C)	EA	86	5.00	430.00	6.50	559.00
118	850111	PAVEMENT MARKER (RETROREFLECTIVE-SPECIAL TYPE D)	EA	790	5.00	3,950.00	6.50	5,135.00
119	850112	PAVEMENT MARKER (RETROREFLECTIVE-SPECIAL TYPE G)	EA	2,790	5.00	13,950.00	2.90	8,091.00
120	850113	PAVEMENT MARKER (RETROREFLECTIVE-SPECIAL TYPE H)	EA	450	5.00	2,250.00	6.50	2,925.00
121	860251	SIGNAL AND LIGHTING (LOCATION 1)	LS	1	119,700.00	119,700.00	112,100.00	112,100.00
122	860252	SIGNAL AND LIGHTING (LOCATION 2)	LS	1	101,850.00	101,850.00	106,900.00	106,900.00
123	860300	SIGNAL AND LIGHTING (CITY STREET LOCATION 1)	LS	1	185,850.00	185,850.00	190,000.00	190,000.00
124	860302	SIGNAL AND LIGHTING (CITY STREET LOCATION 2)	LS	1	190,050.00	190,050.00	185,000.00	185,000.00
125	860460	LIGHTING AND SIGN ILLUMINATION	LS	1	231,000.00	231,000.00	241,100.00	241,100.00
126	860701	INTERCONNECTION CONDUIT AND CONDUCTOR	LS	1	56,805.00	56,805.00	86,000.00	86,000.00
127	861101	RAMP METERING SYSTEM (LOCATION 1)	LS	1	55,650.00	55,650.00	53,700.00	53,700.00
128	861102	RAMP METERING SYSTEM (LOCATION 2)	LS	1	72,345.00	72,345.00	64,500.00	64,500.00
129	861103	RAMP METERING SYSTEM (LOCATION 3)	LS	1	56,595.00	56,595.00	43,000.00	43,000.00
130	861104	RAMP METERING SYSTEM (LOCATION 4)	LS	1	58,800.00	58,800.00	59,100.00	59,100.00
131	861349	REMOVE EXISTING SIGNAL SYSTEM (LOCATION 1)	LS	1	8,190.00	8,190.00	8,500.00	8,500.00
132	861350	REMOVE EXISTING SIGNAL SYSTEM (LOCATION 2)	LS	1	9,450.00	9,450.00	9,800.00	9,800.00
133	999990	MOBILIZATION	LS	1	815,534.00	815,534.00	1,250,000.00	1,250,000.00
134	000003	COURSE OF CONSTRUCTION INSURANCE	LS	1	115,000.00	115,000.00	241,700.00	241,700.00
135	019901	DEMOLITION	LS	1	26,000.00	26,000.00	25,000.00	25,000.00
136	066102	DUST ABATEMENT	LS	1	31,000.00	31,000.00	89,700.00	89,700.00
137	066105	RESIDENT ENGINEER OFFICE	LS	1	65,000.00	65,000.00	56,700.00	56,700.00
138	066840	TRAFFIC SIGNAL CONTROLLER ASSEMBLY [WITH BATTERY BACK-UP][2-LOCATIONS]	LS	1	13,600.00	13,600.00	13,600.00	13,600.00
139	066843	MODEL 170 CONTROLLER ASSEMBLY [RAMP METER] [4-LOCATIONS]	LS	1	19,200.00	19,200.00	19,200.00	19,200.00
140	066015	FEDERAL TRAINEE PROGRAM	LS	1	8,000.00	8,000.00	23,000.00	23,000.00
141	047403	610 MM STEEL PIPE CASING	M	26	400.00	10,400.00	870.00	22,620.00

**Riverside County Transportation Department  
Summary of Bids**

**PROJECT: I-10/Indian Canyon Drive Interchange Improvements**

Advertised: March 16, 2010 (Agenda Item: 3.64)  
Bids Open: 2 pm Date: Wednesday, April 28, 2010

**PROJECT NO. A8-0372; ESPLHPLU-5282(034); HP21-L-5282 (035)**

**Security Paving Co., Inc.  
Sun Valley, CA 91352**

**SEMA Const. Inc.  
Lake Forest, CA 92630**

ITEM NO.	ITEM CODE	CONTRACT ITEM	UNITS	QUANTITY	BID UNIT PRICE	BID ESTIMATE	BID UNIT PRICE	BID ESTIMATE
142	157550	BRIDGE REMOVAL	LS	1	90,000.00	90,000.00	85,800.00	85,800.00
143 (F)	192003	STRUCTURE EXCAVATION (BRIDGE)	M3	1,150	80.00	92,000.00	110.00	126,500.00
144 (F)	193003	STRUCTURE BACKFILL (BRIDGE)	M3	490	85.00	41,650.00	190.00	93,100.00
145	490566	FURNISH STEEL PILING (HP 360 X 132)	M	2,977	137.00	407,849.00	140.00	416,780.00
146	490567	DRIVE STEEL PILE (HP 360 X 132)	EA	196	1,323.00	259,308.00	130.00	25,480.00
147	*****	ITEM DELETED BY ADDENDUM	*****	*****	*****	*****	*****	*****
148	*****	ITEM DELETED BY ADDENDUM	*****	*****	*****	*****	*****	*****
149	500020	PRESTRESSING PRECAST GIRDER	LS	1	98,000.00	98,000.00	90,700.00	90,700.00
150 (F)	510051	STRUCTURAL CONCRETE, BRIDGE FOOTING	M3	220	500.00	110,000.00	340.00	74,800.00
151 (F)	510053	STRUCTURAL CONCRETE, BRIDGE	M3	1,710	715.00	1,222,650.00	578.00	988,380.00
152 (F)	510086	STRUCTURAL CONCRETE, APPROACH SLAB (TYPE N)	M3	210	620.00	130,200.00	400.00	84,000.00
153	511036	ARCHITECTURAL SURFACE [LAVA ROCK FACING]	M2	170	245.00	41,650.00	470.00	79,900.00
154 (F)	511063	FRACTURED FIN TEXTURE	M2	140	248.00	34,720.00	300.00	42,000.00
155	512254	FURNISH PRECAST PRESTRESSED CONCRETE BULB-TEE GIRDER (25 M-30 M)	EA	26	18,700.00	486,200.00	18,600.00	483,600.00
156	512255	FURNISH PRECAST PRESTRESSED CONCRETE BULB-TEE GIRDER (30 M-35 M)	EA	13	18,700.00	243,100.00	18,600.00	241,800.00
157	512500	ERECT PRECAST PRESTRESSED CONCRETE GIRDER	EA	39	2,072.00	80,808.00	1,800.00	70,200.00
158	519123	JOINT SEAL (TYPE B - MR 50 MM)	M	72	273.00	19,656.00	82.00	5,904.00
159 (F)	520102	BAR REINFORCING STEEL (BRIDGE)	KG	244,000	1.75	427,000.00	1.74	424,560.00
160 (F)	721810	SLOPE PAVING (CONCRETE)	M3	72	457.00	32,904.00	590.00	42,480.00
161 (F)	750505	BRIDGE DECK DRAINAGE SYSTEM	KG	470	22.00	10,340.00	12.00	5,640.00
162 (F)	833088	TUBULAR HANDRAILING	M	10	210.00	2,100.00	200.00	2,000.00
163 (F)	833142	CONCRETE BARRIER (TYPE 26 MODIFIED)	M	110	416.00	45,760.00	130.00	14,300.00
164	839727	CONCRETE BARRIER (TYPE 736 MODIFIED)	M	110	335.00	36,850.00	100.00	11,000.00
165 (F)	833020	CHAIN LINK RAILING [MINI MESH]	M	91	1,450.00	131,950.00	1,100.00	100,100.00
		<b>BSAE BID TOTAL</b>				<b>16,992,002.00</b>		<b>17,320,936.20</b>
		ITEMS 1 - 165						

**ALTERNATE BID:**

**THE MISSION SPRINGS WATER DISTRICT**

166	0000003	ADJUST WATER VALVE COVER TO GRADE	EA	14	365.00	5,110.00	950.00	13,300.00
		<b>ALTERNATE BID TOTAL</b>				<b>5,110.00</b>		<b>13,300.00</b>
		ITEMS 166						

		<b>PROJECT TOTAL</b>				<b>16,997,112.00</b>		<b>17,334,236.20</b>
		ITEMS 1 - 166						

**Riverside County Transportation Department  
Summary of Bids**

**PROJECT: I-10/Indian Canyon Drive Interchange Improvements**

**Advertised: March 16, 2010 (Agenda Item: 3.64)  
Bids Open: 2 pm Date: Wednesday, April 28, 2010**

**PROJECT NO. A8-0372; ESPLHPLU-5282(034); HP21-L-5282 (035)**

**Riverside Construction Co.  
Riverside, CA 92502**  
**Skanska USA Civil West  
Riverside, CA 92509**

BASE BID	ITEM NO.	ITEM CODE	CONTRACT ITEM	UNITS	QUANTITY	BID UNIT PRICE	BID ESTIMATE	BID UNIT PRICE	BID ESTIMATE
	1	000003	ENDANGERED SPECIES PROTECTION	LS	1	15,000.00	15,000.00	3,000.00	3,000.00
	2	000003	NONNATIVE PLANT PRECLUSION	LS	1	5,600.00	5,600.00	1,000.00	1,000.00
	3	000003	CONSTRUCTION MONITORING CAMERA (POLE AND ELECTRIC SERVICE)	LS	1	25,000.00	25,000.00	7,500.00	7,500.00
	4 (S,F)	000003	METAL SCRIPT LETTERS (RAILING METHOD)	LS	1	15,000.00	15,000.00	26,000.00	26,000.00
	5	-----	ITEM DELETED BY ADDENDUM	-----	-----	-----	-----	-----	-----
	6	070012	PROGRESS SCHEDULE (CRITICAL PATH METHOD)	LS	1	5,000.00	5,000.00	1,700.00	1,700.00
	7	071325	TEMPORARY FENCE (TYPE ESA)	M	610	15.00	9,150.00	6.50	3,965.00
	8	000003	TEMPORARY FENCE (TYPE WILDLIFE)	M	610	20.00	12,200.00	28.50	17,385.00
	9	074016	CONSTRUCTION SITE MANAGEMENT	LS	1	25,000.00	25,000.00	20,000.00	20,000.00
	10	074020	WATER POLLUTION CONTROL	LS	1	7,500.00	7,500.00	3,500.00	3,500.00
	11	074018	HEALTH AND SAFETY PLAN	LS	1	2,500.00	2,500.00	2,500.00	2,500.00
	12	074028	TEMPORARY FIBER ROLLS	M	10,800	7.00	75,600.00	5.35	57,780.00
	13	074029	TEMPORARY SILT FENCE	M	960	10.00	9,600.00	5.50	5,280.00
	14	074033	TEMPORARY CONSTRUCTION ENTRANCE	EA	3	5,000.00	15,000.00	4,000.00	12,000.00
	15	074035	TEMPORARY CHECK DAM	M	52	10.00	520.00	18.50	962.00
	16	074037	MOVE-IN/MOVE-OUT (TEMPORARY EROSION CONTROL)	EA	4	500.00	2,000.00	500.00	2,000.00
	17	074038	TEMPORARY DRAINAGE INLET PROTECTION	EA	39	200.00	7,800.00	116.00	4,524.00
	18	074039	TEMPORARY HYDRAULIC MULCH (POLYMER STABILIZED FIBER MATRIX)	M2	136,000	0.30	40,800.00	0.60	81,600.00
	19	074041	STREET SWEEPING	LS	1	50,000.00	50,000.00	86,000.00	86,000.00
	20	074042	TEMPORARY CONCRETE WASHOUT (PORTABLE)	LS	1	15,000.00	15,000.00	10,000.00	10,000.00
	21	120090	CONSTRUCTION AREA SIGNS	LS	1	35,000.00	35,000.00	42,500.00	42,500.00
	22	120100	TRAFFIC CONTROL SYSTEMS	LS	1	200,000.00	200,000.00	135,000.00	135,000.00
	23	120120	TYPE III BARRICADE	EA	140	75.00	10,500.00	50.00	7,000.00
	24	120143	TEMPORARY PAVEMENT DELINEATION	M	4,460	2.00	8,920.00	4.00	17,840.00
	25	120149	TEMPORARY PAVEMENT MARKING (PAINT)	M2	100	25.00	2,500.00	35.00	3,500.00
	26	120199	TRAFFIC PLASTIC DRUM	EA	590	75.00	44,250.00	43.00	25,370.00
	27	128650	PORTABLE CHANGEABLE MESSAGE SIGN	EA	10	3,500.00	35,000.00	7,600.00	76,000.00
	28	129000	TEMPORARY RAILING (TYPE K)	M	5,300	30.00	159,000.00	31.00	164,300.00
	29	129110	TEMPORARY CRASH CUSHION [SAND FILLED]	EA	210	200.00	42,000.00	218.00	45,780.00
	30	129110	TEMPORARY CRASH CUSHION [ABSORB 350]	EA	6	8,500.00	51,000.00	5,100.00	30,600.00
	31	150701	REMOVE YELLOW TRAFFIC STRIPE [HAZARDOUS WASTE]	M	2,870	2.00	5,740.00	2.00	5,740.00
	32	150608	REMOVE CHAIN LINK FENCE	M	610	15.00	9,150.00	16.00	9,760.00
	33	150659	REMOVE TERMINAL SECTION	EA	3	350.00	1,050.00	250.00	750.00
	34	150662	REMOVE METAL BEAM GUARD RAILING	M	660	25.00	16,500.00	26.00	17,160.00
	35	150710	REMOVE TRAFFIC STRIPE	M	34,100	0.10	3,410.00	2.00	68,200.00
	36	150713	REMOVE PAVEMENT MARKING	M2	52	15.00	780.00	2.00	104.00



# Riverside County Transportation Department Summary of Bids

PROJECT: I-10/Indian Canyon Drive Interchange Improvements

Advertised: March 16, 2010 (Agenda Item: 3.64)  
Bids Open: 2 pm Date: Wednesday, April 28, 2010

PROJECT NO. A8-0372; ESPLHPLU-5282(034); HP21-L-5282 (035)

Riverside Construction Co.  
Riverside, CA 92502

Skanska USA Civil West  
Riverside, CA 92509

BASE BID (CONTINUED)		CONTRACT ITEM	UNITS	QUANTITY	BID UNIT PRICE	BID ESTIMATE	BID UNIT PRICE	BID ESTIMATE
37	150722	REMOVE PAVEMENT MARKER	EA	8,520	0.50	4,260.00	0.50	4,260.00
38	150742	REMOVE ROADSIDE SIGN	EA	43	100.00	4,300.00	46.00	1,978.00
39	150760	REMOVE SIGN STRUCTURE	EA	2	3,000.00	6,000.00	1,800.00	3,600.00
40	150806	REMOVE CULVERT	M	360	50.00	18,000.00	62.50	22,500.00
41	150820	REMOVE INLET	EA	1	550.00	550.00	2,575.00	2,575.00
42	150821	REMOVE HEADWALL	EA	21	500.00	10,500.00	575.00	12,075.00
43	153153	COLD PLANE ASPHALT CONCRETE PAVEMENT (45 MM MAXIMUM)	M2	1,080	6.00	6,480.00	3.00	3,240.00
44	160101	CLEARING AND GRUBBING	LS	1	82,500.00	82,500.00	25,000.00	25,000.00
45	170101	DEVELOP WATER SUPPLY	LS	1	10,000.00	10,000.00	22,500.00	22,500.00
46 (F)	190101	ROADWAY EXCAVATION	M3	29,170	25.00	729,250.00	38.00	1,108,460.00
47	190110	LEAD COMPLIANCE PLAN (METRIC)	LS	1	5,000.00	5,000.00	2,500.00	2,500.00
48	190113	ASBESTOS COMPLIANCE PLAN	LS	1	2,500.00	2,500.00	2,500.00	2,500.00
49	193118	CONCRETE BACKFILL	M3	14	200.00	2,800.00	1,310.00	18,340.00
50	194001	DITCH EXCAVATION	M3	320	25.00	8,000.00	10.50	3,360.00
51	198001	IMPORTED BORROW	M3	71,000	8.50	603,500.00	1.00	71,000.00
52	203016	EROSION CONTROL (TYPE D)	M2	13,200	1.75	23,100.00	1.38	18,216.00
53	203021	FIBER ROLLS (METRIC)	M	10,500	8.00	84,000.00	5.50	57,750.00
54	203026	MOVE-IN/MOVE-OUT (EROSION CONTROL)	EA	1	500.00	500.00	200.00	200.00
55	208731	200 MM CORRUGATED HIGH DENSITY POLYETHYLENE PIPE CONDUIT	M	68	200.00	13,600.00	94.00	6,392.00
56	220101	FINISHING ROADWAY	LS	1	50,000.00	50,000.00	6,500.00	6,500.00
57	260201	CLASS 2 AGGREGATE BASE	M3	14,600	55.00	803,000.00	23.50	343,100.00
58	280000	LEAN CONCRETE BASE	M3	190	200.00	38,000.00	200.00	38,000.00
59	374002	ASPHALTIC EMULSION (FOG SEAL COAT)	TONN	6	1,400.00	8,400.00	665.00	3,990.00
60	390106	ASPHALT CONCRETE (OPEN GRADED)/OPEN GRADED FRICTION COURSE	TONN	1,310	132.00	172,920.00	95.00	124,450.00
61	390130	HOT MIX ASPHALT (TYPE A)	TONN	320	175.00	56,000.00	95.00	30,400.00
62	000003	HOT MIX ASPHALT (TYPE A BOND BREAKER)	TONN	120	270.00	32,400.00	217.00	26,040.00
63	000003	HOT MIX ASPHALT (TYPE C)	TONN	31,200	112.00	3,494,400.00	82.00	2,558,400.00
64	394071	PLACE HOT MIX ASPHALT DIKE	M	4,570	7.50	34,275.00	6.40	29,248.00
65	394090	PLACE HOT MIX ASPHALT (MISCELLANEOUS AREA)	M2	320	50.00	16,000.00	50.00	16,000.00
66	397005	TACK COAT	TONN	38	500.00	19,000.00	590.00	22,420.00
67	401066	CONCRETE PAVEMENT (EXIT RAMP TERMINI) [JOINTED PLAIN CONCRETE PAVEMENT]	M3	430	250.00	107,500.00	350.00	150,500.00
68	401108	RAPID STRENGTH CONCRETE [JOINTED PLAIN CONCRETE PAVEMENT]	M3	3,780	350.00	1,323,000.00	555.00	2,097,900.00
69	000003	SEAL ISOLATION JOINT	M	1,280	20.00	25,600.00	21.40	27,392.00
70	414091	SEAL LONGITUDINAL JOINT	M	2,140	7.00	14,980.00	6.30	13,482.00
71	414101	SEAL TRANSVERSE JOINT	M	2,120	7.00	14,840.00	6.30	13,356.00

**Riverside County Transportation Department  
Summary of Bids**

**PROJECT: I-10/Indian Canyon Drive Interchange Improvements**

Advertised: March 16, 2010 (Agenda Item: 3.64)

Bids Open: 2 pm Date: Wednesday, April 28, 2010

**PROJECT NO. A8-0372; ESPLHPLU-5282(034); HP21-L-5282 (035)**

**Riverside Construction Co.  
Riverside, CA 92502**

**Skanska USA Civil West  
Riverside, CA 92509**

BASE BID (CONTINUED)		CONTRACT ITEM	UNITS	QUANTITY	BID UNIT PRICE	BID ESTIMATE	BID UNIT PRICE	BID ESTIMATE
72	518201	MASONRY STONE WALL	M2	23	375.00	8,625.00	1,500.00	34,500.00
73 (F)	510129	CLASS 2 CONCRETE (BOX CULVERT)	M3	190	575.00	109,250.00	1,050.00	199,500.00
74 (F)	510502	MINOR CONCRETE (MINOR STRUCTURE)	M3	110	1,250.00	137,500.00	1,200.00	132,000.00
75 (F)	520107	BAR REINFORCING STEEL (BOX CULVERT)	KG	21,271	1.50	31,906.50	2.00	42,542.00
76 (F)	560218	FURNISH SIGN STRUCTURE (TRUSS)	KG	30,000	6.00	180,000.00	7.00	210,000.00
77 (F)	560219	INSTALL SIGN STRUCTURE (TRUSS)	KG	30,000	0.30	9,000.00	0.30	9,000.00
78	560234	FURNISH LAMINATED PANEL SIGN (25.4 MM -TYPE A)	M2	67	150.00	10,050.00	217.00	14,539.00
79	560238	FURNISH SINGLE SHEET ALUMINUM SIGN (1.6 MM- UNFRAMED)	M2	56	130.00	7,280.00	95.00	5,320.00
80	560239	FURNISH SINGLE SHEET ALUMINUM SIGN (2.0 MM- UNFRAMED)	M2	30	165.00	4,950.00	105.00	3,150.00
81	560241	FURNISH SINGLE SHEET ALUMINUM SIGN (1.6 MM- FRAMED)	M2	13	150.00	1,950.00	120.00	1,560.00
82	560242	FURNISH SINGLE SHEET ALUMINUM SIGN (2.0 MM- FRAMED)	M2	71	200.00	14,200.00	140.00	9,940.00
83	561015	1524 MM CAST-IN-DRILLED-HOLE CONCRETE PILE (SIGN FOUNDATION)	M	23	3,500.00	80,500.00	3,500.00	80,500.00
84	566011	ROADSIDE SIGN - ONE POST	EA	85	200.00	17,000.00	250.00	21,250.00
85	566012	ROADSIDE SIGN - TWO POST	EA	17	500.00	8,500.00	250.00	4,250.00
86	568001	INSTALL SIGN (STRAP AND SADDLE BRACKET METHOD)	EA	8	150.00	1,200.00	200.00	1,600.00
87	568015	INSTALL SIGN (MAST-ARM HANGER METHOD)	EA	22	350.00	7,700.00	250.00	5,500.00
88	620909	450 MM ALTERNATIVE PIPE CULVERT	M	71	200.00	14,200.00	240.00	17,040.00
89	620913	600 MM ALTERNATIVE PIPE CULVERT	M	230	235.00	54,050.00	205.00	47,150.00
90	620924	900 MM ALTERNATIVE PIPE CULVERT	M	120	240.00	28,800.00	275.00	33,000.00
91	664097	600 MM BITUMINOUS COATED CORRUGATED STEEL PIPE (2.77 MM THICK)	M	200	265.00	53,000.00	302.00	60,400.00
92	664110	900 MM BITUMINOUS COATED CORRUGATED STEEL PIPE (2.77 MM THICK)	M	50	320.00	16,000.00	505.00	25,250.00
93	717072	100 MM POLYVINYL CHLORIDE SEWER PIPE	M	37	20.00	740.00	101.00	3,737.00
94	721008	ROCK SLOPE PROTECTION (LIGHT, METHOD B)	M3	140	175.00	24,500.00	145.00	20,300.00
95	721430	CONCRETE (CHANNEL LINING)	M3	73	425.00	31,025.00	265.00	19,345.00
96	729010	ROCK SLOPE PROTECTION FABRIC	M2	330	3.50	1,155.00	9.50	3,135.00
97 (F)	731504	MINOR CONCRETE (CURB AND GUTTER)	M3	250	380.00	95,000.00	255.00	63,750.00
98 (F)	000003	MINOR CONCRETE (COLORED)	M2	1,890	65.00	122,850.00	95.00	179,550.00
99 (F)	731521	MINOR CONCRETE (SIDEWALK)	M3	260	380.00	98,800.00	205.00	53,300.00
100 (F)	731530	MINOR CONCRETE (TEXTURED PAVING)	M2	1,190	100.00	119,000.00	160.00	190,400.00
101 (F)	750001	MISCELLANEOUS IRON AND STEEL	KG	1,262	6.50	8,203.00	4.00	5,048.00
102	800391	CHAIN LINK FENCE (TYPE CL-1.8)	M	940	40.00	37,600.00	48.00	45,120.00
103	820105	DELINEATOR (SPECIAL)	EA	23	30.00	690.00	75.00	1,725.00
104	820107	DELINEATOR (CLASS 1)	EA	160	40.00	6,400.00	75.00	12,000.00
105	832003	METAL BEAM GUARD RAILING (WOOD POST)	M	670	60.00	40,200.00	80.00	53,600.00
106	839541	TRANSITION RAILING (TYPE WB)	EA	4	3,500.00	14,000.00	2,650.00	10,600.00

**Riverside County Transportation Department  
Summary of Bids**

**PROJECT: I-10/Indian Canyon Drive Interchange Improvements**

Advertised: March 16, 2010 (Agenda Item: 3.64)  
Bids Open: 2 pm Date: Wednesday, April 28, 2010

**PROJECT NO. A8-0372; ESPLHPLU-5282(034) & HP21L-5282 (035)**

BASE BID (CONTINUED)		Riverside Construction Co. Riverside, CA 92502		Skanska USA Civil West Riverside, CA 92509				
ITEM NO.	ITEM CODE	CONTRACT ITEM	UNITS	QUANTITY	BID UNIT PRICE	BID ESTIMATE	BID UNIT PRICE	BID ESTIMATE
107	839568	TERMINAL ANCHOR ASSEMBLY (TYPE SFT)	EA	5	750.00	3,750.00	680.00	3,400.00
108	839585	ALTERNATIVE FLARED TERMINAL SYSTEM [TYPE SRT]	EA	9	2,500.00	22,500.00	2,150.00	19,350.00
109	839605	CRASH CUSHION (REACT 9SCBS)	EA	3	50,000.00	150,000.00	48,600.00	145,800.00
110	839703	CONCRETE BARRIER (TYPE 60C)	M	270	425.00	114,750.00	300.00	81,000.00
111	839705	CONCRETE BARRIER (TYPE 60E)	M	89	550.00	48,950.00	400.00	35,600.00
112	840515	THERMOPLASTIC PAVEMENT MARKING	M2	360	35.00	12,600.00	35.00	12,600.00
113	840563	200 MM THERMOPLASTIC TRAFFIC STRIPE	M	1,210	3.00	3,630.00	3.00	3,630.00
114	840571	100 MM THERMOPLASTIC TRAFFIC STRIPE (BROKEN 5.18 M - 2.14 M)	M	9,600	1.50	14,400.00	1.40	13,440.00
115	840656	PAINT TRAFFIC STRIPE (2-COAT)	M	13,100	1.20	15,720.00	1.15	15,065.00
116	850101	PAVEMENT MARKER (NON-REFLECTIVE)	EA	15,300	1.50	22,950.00	1.25	19,125.00
117	850110	PAVEMENT MARKER (RETROREFLECTIVE-SPECIAL TYPE C)	EA	86	5.00	430.00	5.00	430.00
118	850111	PAVEMENT MARKER (RETROREFLECTIVE-SPECIAL TYPE D)	EA	790	5.00	3,950.00	5.00	3,950.00
119	850112	PAVEMENT MARKER (RETROREFLECTIVE-SPECIAL TYPE G)	EA	2,790	5.00	13,950.00	5.00	13,950.00
120	850113	PAVEMENT MARKER (RETROREFLECTIVE-SPECIAL TYPE H)	EA	450	5.00	2,250.00	5.00	2,250.00
121	860251	SIGNAL AND LIGHTING (LOCATION 1)	LS	1	100,000.00	100,000.00	114,000.00	114,000.00
122	860252	SIGNAL AND LIGHTING (LOCATION 2)	LS	1	95,000.00	95,000.00	97,000.00	97,000.00
123	860300	SIGNAL AND LIGHTING (CITY STREET LOCATION 1)	LS	1	160,000.00	160,000.00	177,000.00	177,000.00
124	860302	SIGNAL AND LIGHTING (CITY STREET LOCATION 2)	LS	1	175,000.00	175,000.00	181,000.00	181,000.00
125	860460	LIGHTING AND SIGN ILLUMINATION	LS	1	250,000.00	250,000.00	230,000.00	230,000.00
126	860701	INTERCONNECTION CONDUIT AND CONDUCTOR	LS	1	45,000.00	45,000.00	54,100.00	54,100.00
127	861101	RAMP METERING SYSTEM (LOCATION 1)	LS	1	42,000.00	42,000.00	53,000.00	53,000.00
128	861102	RAMP METERING SYSTEM (LOCATION 2)	LS	1	55,000.00	55,000.00	68,900.00	68,900.00
129	861103	RAMP METERING SYSTEM (LOCATION 3)	LS	1	52,000.00	52,000.00	53,900.00	53,900.00
130	861104	RAMP METERING SYSTEM (LOCATION 4)	LS	1	55,000.00	55,000.00	56,000.00	56,000.00
131	861349	REMOVE EXISTING SIGNAL SYSTEM (LOCATION 1)	LS	1	15,000.00	15,000.00	7,800.00	7,800.00
132	861350	REMOVE EXISTING SIGNAL SYSTEM (LOCATION 2)	LS	1	15,000.00	15,000.00	9,000.00	9,000.00
133	999990	MOBILIZATION	LS	1	1,650,000.00	1,650,000.00	1,750,000.00	1,750,000.00
134	000003	COURSE OF CONSTRUCTION INSURANCE	LS	1	20,000.00	20,000.00	78,000.00	78,000.00
135	019901	DEMOBILIZATION	LS	1	100,000.00	100,000.00	5,200.00	5,200.00
136	066102	DUST ABATEMENT	LS	1	75,000.00	75,000.00	36,000.00	36,000.00
137	066105	RESIDENT ENGINEER OFFICE	LS	1	35,000.00	35,000.00	61,000.00	61,000.00
138	066840	TRAFFIC SIGNAL CONTROLLER ASSEMBLY [WITH BATTERY BACK-UP][2-LOCATIONS]	LS	1	13,600.00	13,600.00	13,600.00	13,600.00
139	066843	MODEL 170 CONTROLLER ASSEMBLY [RAMP METER] [4-LOCATIONS]	LS	1	19,200.00	19,200.00	19,200.00	19,200.00
140	066015	FEDERAL TRAINEE PROGRAM	LS	1	5,000.00	5,000.00	2,000.00	2,000.00
141	047403	610 MM STEEL PIPE CASING	M	26	950.00	24,700.00	1,070.00	27,820.00

**Riverside County Transportation Department  
Summary of Bids**

**PROJECT: I-10/Indian Canyon Drive Interchange Improvements**

Advertised: March 16, 2010 (Agenda Item: 3.64)

Bids Open: 2 pm Date: Wednesday, April 28, 2010

**PROJECT NO. A8-0372; ESPLHPLU-5282(034); HP21-L-5282 (035)**

**Riverside Construction Co.  
Riverside, CA 92502**

**Skanska USA Civil West  
Riverside, CA 92509**

BASE BID (CONTINUED)		ITEM CODE	CONTRACT ITEM	UNITS	QUANTITY	BID UNIT PRICE	BID ESTIMATE	BID UNIT PRICE	BID ESTIMATE
142		157550	BRIDGE REMOVAL	LS	1	65,000.00	65,000.00	110,000.00	110,000.00
143 (F)		192003	STRUCTURE EXCAVATION (BRIDGE)	M3	1,150	100.00	115,000.00	155.00	178,250.00
144 (F)		193003	STRUCTURE BACKFILL (BRIDGE)	M3	490	200.00	98,000.00	84.00	41,160.00
145		490566	FURNISH STEEL PILING (HP 360 X 132)	M	2,977	145.00	431,665.00	149.00	443,573.00
146		490567	DRIVE STEEL PILE (HP 360 X 132)	EA	196	1,200.00	235,200.00	1,150.00	225,400.00
147		*****	ITEM DELETED BY ADDENDUM	*****	*****	*****	*****	*****	*****
148		*****	ITEM DELETED BY ADDENDUM	*****	*****	*****	*****	*****	*****
149		500020	PRESTRESSING PRECAST GIRDER	LS	1	75,000.00	75,000.00	88,000.00	88,000.00
150 (F)		510051	STRUCTURAL CONCRETE, BRIDGE FOOTING	M3	220	500.00	110,000.00	450.00	99,000.00
151 (F)		510053	STRUCTURAL CONCRETE, BRIDGE	M3	1,710	700.00	1,197,000.00	975.00	1,667,250.00
152 (F)		510086	STRUCTURAL CONCRETE, APPROACH SLAB (TYPE N)	M3	210	600.00	126,000.00	510.00	107,100.00
153		511036	ARCHITECTURAL SURFACE [LAVA ROCK FACING]	M2	170	100.00	17,000.00	189.00	32,130.00
154 (F)		511063	FRACTURED FIN TEXTURE	M2	140	100.00	14,000.00	73.00	10,220.00
155		512254	FURNISH PRECAST PRESTRESSED CONCRETE BULB-TEE GIRDER (25 M-30 M)	EA	26	18,000.00	468,000.00	21,200.00	551,200.00
156		512255	FURNISH PRECAST PRESTRESSED CONCRETE BULB-TEE GIRDER (30 M-35 M)	EA	13	18,000.00	234,000.00	24,700.00	321,100.00
157		512500	ERECT PRECAST PRESTRESSED CONCRETE GIRDER	EA	39	1,800.00	70,200.00	1,145.00	44,655.00
158		519123	JOINT SEAL (TYPE B - MR 50 MM)	M	72	350.00	25,200.00	387.00	27,864.00
159 (F)		520102	BAR REINFORCING STEEL (BRIDGE)	KG	244,000	1.50	366,000.00	1.75	427,000.00
160 (F)		721810	SLOPE PAVING (CONCRETE)	M3	72	525.00	37,800.00	400.00	28,800.00
161 (F)		750505	BRIDGE DECK DRAINAGE SYSTEM	KG	470	25.00	11,750.00	10.00	4,700.00
162 (F)		833088	TUBULAR HANDRAILING	M	10	325.00	3,250.00	425.00	4,250.00
163 (F)		833142	CONCRETE BARRIER (TYPE 26 MODIFIED)	M	110	350.00	38,500.00	470.00	51,700.00
164		839727	CONCRETE BARRIER (TYPE 736 MODIFIED)	M	110	300.00	33,000.00	355.00	39,050.00
165 (F)		833020	CHAIN LINK RAILING [MINI MESH]	M	91	1,000.00	91,000.00	1,000.00	91,000.00
			BSAE BID TOTAL				17,477,944.50		17,561,037.00
			ITEMS 1 - 165						

**ALTERNATE BID:**

**THE MISSION SPRINGS WATER DISTRICT**

166		0000003	ADJUST WATER VALVE COVER TO GRADE	EA	14	250.00	3,500.00	330.00	4,620.00
			ALTERNATE BID TOTAL				3,500.00		4,620.00
			ITEMS 166						

			PROJECT TOTAL				17,481,444.50		17,565,657.00
			ITEMS 1 - 166						

**Riverside County Transportation Department  
Summary of Bids**

**PROJECT: I-10/Indian Canyon Drive Interchange Improvements**

Advertised: March 16, 2010 (Agenda Item: 3.64)  
Bids Open: 2 pm Date: Wednesday, April 28, 2010

**PROJECT NO. A8-0372; ESPLHPLU-5282(034); HP21-L-5282 (035)**

**FTR International, Inc.  
Irvine, CA 92602**

**Ortiz Enterprises, Inc.  
Irvine, CA 92618**

ITEM NO.	ITEM CODE	CONTRACT ITEM	UNITS	QUANTITY	BID UNIT PRICE	BID ESTIMATE	BID UNIT PRICE	BID ESTIMATE
1	000003	ENDANGERED SPECIES PROTECTION	LS	1	75,000.00	75,000.00	30,000.00	30,000.00
2	000003	NONNATIVE PLANT PRECLUSION	LS	1	65,000.00	65,000.00	60,000.00	60,000.00
3	000003	CONSTRUCTION MONITORING CAMERA (POLE AND ELECTRIC SERVICE)	LS	1	20,000.00	20,000.00	15,000.00	15,000.00
4 (S,F)	000003	METAL SCRIPT LETTERS (RAILING METHOD)	LS	1	2,500.00	2,500.00	30,000.00	30,000.00
5	-----	ITEM DELETED BY ADDENDUM	-----	-----	-----	-----	-----	-----
6	070012	PROGRESS SCHEDULE (CRITICAL PATH METHOD)	LS	1	5,000.00	5,000.00	5,000.00	5,000.00
7	071325	TEMPORARY FENCE (TYPE ESA)	M	610	18.00	10,980.00	3.00	1,830.00
8	000003	TEMPORARY FENCE (TYPE WILDLIFE)	M	610	30.00	18,300.00	24.00	14,640.00
9	074016	CONSTRUCTION SITE MANAGEMENT	LS	1	25,000.00	25,000.00	15,000.00	15,000.00
10	074020	WATER POLLUTION CONTROL	LS	1	12,000.00	12,000.00	80,000.00	80,000.00
11	074018	HEALTH AND SAFETY PLAN	LS	1	5,000.00	5,000.00	3,000.00	3,000.00
12	074028	TEMPORARY FIBER ROLLS	M	10,800	8.00	86,400.00	8.00	86,400.00
13	074029	TEMPORARY SILT FENCE	M	960	5.00	4,800.00	4.00	3,840.00
14	074033	TEMPORARY CONSTRUCTION ENTRANCE	EA	3	650.00	1,950.00	10,000.00	30,000.00
15	074035	TEMPORARY CHECK DAM	M	52	6.00	312.00	20.00	1,040.00
16	074037	MOVE-IN/MOVE-OUT (TEMPORARY EROSION CONTROL)	EA	4	600.00	2,400.00	600.00	2,400.00
17	074038	TEMPORARY DRAINAGE INLET PROTECTION	EA	39	100.00	3,900.00	200.00	7,800.00
18	074039	TEMPORARY HYDRAULIC MULCH (POLYMER STABILIZED FIBER MATRIX)	M2	136,000	0.50	68,000.00	0.30	40,800.00
19	074041	STREET SWEEPING	LS	1	160,000.00	160,000.00	80,000.00	80,000.00
20	074042	TEMPORARY CONCRETE WASHOUT (PORTABLE)	LS	1	15,000.00	15,000.00	13,000.00	13,000.00
21	120090	CONSTRUCTION AREA SIGNS	LS	1	50,000.00	50,000.00	100,000.00	100,000.00
22	120100	TRAFFIC CONTROL SYSTEMS	LS	1	68,000.00	68,000.00	125,000.00	125,000.00
23	120120	TYPE III BARRICADE	EA	140	75.00	10,500.00	150.00	21,000.00
24	120143	TEMPORARY PAVEMENT DELINEATION	M	4,460	1.00	4,460.00	3.00	13,380.00
25	120149	TEMPORARY PAVEMENT MARKING (PAINT)	M2	100	10.00	1,000.00	50.00	5,000.00
26	120199	TRAFFIC PLASTIC DRUM	EA	590	55.00	32,450.00	250.00	147,500.00
27	128650	PORTABLE CHANGEABLE MESSAGE SIGN	EA	10	13,500.00	135,000.00	4,000.00	40,000.00
28	129000	TEMPORARY RAILING (TYPE K)	M	5,300	30.00	159,000.00	89.00	471,700.00
29	129110	TEMPORARY CRASH CUSHION [SAND FILLED]	EA	210	215.00	45,150.00	200.00	42,000.00
30	129110	TEMPORARY CRASH CUSHION [ABSORB 350]	EA	6	300.00	1,800.00	11,000.00	66,000.00
31	150701	REMOVE YELLOW TRAFFIC STRIPE [HAZARDOUS WASTE]	M	2,870	3.00	8,610.00	3.00	8,610.00
32	150608	REMOVE CHAIN LINK FENCE	M	610	18.00	10,980.00	10.00	6,100.00
33	150659	REMOVE TERMINAL SECTION	EA	3	260.00	780.00	325.00	975.00
34	150662	REMOVE METAL BEAM GUARD RAILING	M	660	28.00	18,480.00	25.00	16,500.00
35	150710	REMOVE TRAFFIC STRIPE	M	34,100	1.00	34,100.00	0.30	10,230.00
36	150713	REMOVE PAVEMENT MARKING	M2	52	15.00	780.00	52.00	2,704.00

**Riverside County Transportation Department  
Summary of Bids**

**PROJECT: I-10/Indian Canyon Drive Interchange Improvements**

Advertised: March 16, 2010 (Agenda Item: 3.64)  
Bids Open: 2 pm Date: Wednesday, April 28, 2010

**PROJECT NO. A8-0372; ESPLHPLU-5282(034); HP21-L-5282 (035)**

**FTR International, Inc.  
Irvine, CA 92602**

**Ortiz Enterprises, Inc.  
Irvine, CA 92618**

ITEM NO.	ITEM CODE	CONTRACT ITEM	UNITS	QUANTITY	BID UNIT PRICE	BID ESTIMATE	BID UNIT PRICE	BID ESTIMATE
37	150722	REMOVE PAVEMENT MARKER	EA	8,520	2.00	17,040.00	2.00	17,040.00
38	150742	REMOVE ROADSIDE SIGN	EA	43	105.00	4,515.00	100.00	4,300.00
39	150760	REMOVE SIGN STRUCTURE	EA	2	5,000.00	10,000.00	3,500.00	7,000.00
40	150806	REMOVE CULVERT	M	360	93.00	33,480.00	110.00	39,600.00
41	150820	REMOVE INLET	EA	1	1,130.00	1,130.00	1,900.00	1,900.00
42	150821	REMOVE HEADWALL	EA	21	1,240.00	26,040.00	1,200.00	25,200.00
43	153153	COLD PLANE ASPHALT CONCRETE PAVEMENT (45 MM MAXIMUM)	M2	1,080	12.00	12,960.00	8.00	8,640.00
44	160101	CLEARING AND GRUBBING	LS	1	82,500.00	82,500.00	82,500.00	82,500.00
45	170101	DEVELOP WATER SUPPLY	LS	1	10,000.00	10,000.00	10,000.00	10,000.00
46 (F)	190101	ROADWAY EXCAVATION	M3	29,170	10.00	291,700.00	18.00	525,060.00
47	190110	LEAD COMPLIANCE PLAN (METRIC)	LS	1	5,000.00	5,000.00	5,000.00	5,000.00
48	190113	ASBESTOS COMPLIANCE PLAN	LS	1	2,500.00	2,500.00	5,000.00	5,000.00
49	193118	CONCRETE BACKFILL	M3	14	233.00	3,262.00	200.00	2,800.00
50	194001	DITCH EXCAVATION	M3	320	8.00	2,560.00	11.00	3,520.00
51	198001	IMPORTED BORROW	M3	71,000	9.80	695,800.00	11.00	781,000.00
52	203016	EROSION CONTROL (TYPE D)	M2	13,200	1.00	13,200.00	2.00	26,400.00
53	203021	FIBER ROLLS (METRIC)	M	10,500	8.00	84,000.00	8.00	84,000.00
54	203026	MOVE-IN/MOVE-OUT (EROSION CONTROL)	EA	1	600.00	600.00	600.00	600.00
55	208731	200 MM CORRUGATED HIGH DENSITY POLYETHYLENE PIPE CONDUIT	M	68	175.00	11,900.00	170.00	11,560.00
56	220101	FINISHING ROADWAY	LS	1	15,000.00	15,000.00	1,000.00	1,000.00
57	260201	CLASS 2 AGGREGATE BASE	M3	14,600	23.00	335,800.00	42.00	613,200.00
58	280000	LEAN CONCRETE BASE	M3	190	350.00	66,500.00	175.00	33,250.00
59	374002	ASPHALTIC EMULSION (FOG SEAL COAT)	TONN	6	650.00	3,900.00	1,400.00	8,400.00
60	390106	ASPHALT CONCRETE (OPEN GRADED)[OPEN GRADED FRICTION COURSE]	TONN	1,310	120.00	157,200.00	132.00	172,920.00
61	390130	HOT MIX ASPHALT (TYPE A)	TONN	320	88.00	28,160.00	175.00	56,000.00
62	000003	HOT MIX ASPHALT (TYPE A BOND BREAKER)	TONN	120	89.00	10,680.00	270.00	32,400.00
63	000003	HOT MIX ASPHALT (TYPE C)	TONN	31,200	86.00	2,683,200.00	106.00	3,307,200.00
64	394071	PLACE HOT MIX ASPHALT DIKE	M	4,570	2.00	9,140.00	6.00	27,420.00
65	394090	PLACE HOT MIX ASPHALT (MISCELLANEOUS AREA)	M2	320	160.00	51,200.00	50.00	16,000.00
66	397005	TACK COAT	TONN	38	1,500.00	57,000.00	500.00	19,000.00
67	401066	CONCRETE PAVEMENT (EXIT RAMP TERMINI) [JOINTED PLAIN CONCRETE PAVEMENT]	M3	430	480.00	206,400.00	490.00	210,700.00
68	401108	RAPID STRENGTH CONCRETE [JOINTED PLAIN CONCRETE PAVEMENT]	M3	3,780	700.00	2,646,000.00	420.00	1,587,600.00
69	000003	SEAL ISOLATION JOINT	M	1,280	22.00	28,160.00	22.00	28,160.00
70	414091	SEAL LONGITUDINAL JOINT	M	2,140	7.00	14,980.00	7.00	14,980.00
71	414101	SEAL TRANSVERSE JOINT	M	2,120	7.00	14,840.00	7.00	14,840.00

**Riverside County Transportation Department  
Summary of Bids**

**PROJECT: I-10/Indian Canyon Drive Interchange Improvements**

Advertised: March 16, 2010 (Agenda Item: 3.64)

Bids Open: 2 pm Date: Wednesday, April 28, 2010

**PROJECT NO. A8-0372; ESPLHPLU-5282(034); HP21-L-5282 (035)**

**FTR International, Inc.  
Irvine, CA 92602**

**Ortiz Enterprises, Inc.  
Irvine, CA 92618**

BASE BID (CONTINUED)		ITEM CODE	CONTRACT ITEM	UNITS	QUANTITY	BID UNIT PRICE	BID ESTIMATE	BID UNIT PRICE	BID ESTIMATE
72		518201	MASONRY STONE WALL	M2	23	214.00	4,922.00	350.00	8,050.00
73 (F)		510129	CLASS 2 CONCRETE (BOX CULVERT)	M3	190	900.00	171,000.00	600.00	114,000.00
74 (F)		510502	MINOR CONCRETE (MINOR STRUCTURE)	M3	110	1,600.00	176,000.00	1,050.00	115,500.00
75 (F)		520107	BAR REINFORCING STEEL (BOX CULVERT)	KG	21,271	2.00	42,542.00	1.90	40,414.90
76 (F)		560218	FURNISH SIGN STRUCTURE (TRUSS)	KG	30,000	7.00	210,000.00	5.40	162,000.00
77 (F)		560219	INSTALL SIGN STRUCTURE (TRUSS)	KG	30,000	1.00	30,000.00	0.92	27,600.00
78		560234	FURNISH LAMINATED PANEL SIGN (25.4 MM -TYPE A)	M2	67	225.00	15,075.00	210.00	14,070.00
79		560238	FURNISH SINGLE SHEET ALUMINUM SIGN (1.6 MM- UNFRAMED)	M2	56	115.00	6,440.00	107.00	5,992.00
80		560239	FURNISH SINGLE SHEET ALUMINUM SIGN (2.0 MM- UNFRAMED)	M2	30	115.00	3,450.00	142.00	4,260.00
81		560241	FURNISH SINGLE SHEET ALUMINUM SIGN (1.6 MM- FRAMED)	M2	13	130.00	1,690.00	120.00	1,560.00
82		560242	FURNISH SINGLE SHEET ALUMINUM SIGN (2.0 MM- FRAMED)	M2	71	150.00	10,650.00	140.00	9,940.00
83		561015	1524 MM CAST-IN-DRILLED-HOLE CONCRETE PILE (SIGN FOUNDATION)	M	23	4,272.00	98,256.00	3,100.00	71,300.00
84		566011	ROADSIDE SIGN - ONE POST	EA	85	360.00	30,600.00	340.00	28,900.00
85		566012	ROADSIDE SIGN - TWO POST	EA	17	1,250.00	21,250.00	1,100.00	18,700.00
86		568001	INSTALL SIGN (STRAP AND SADDLE BRACKET METHOD)	EA	8	110.00	880.00	100.00	800.00
87		568015	INSTALL SIGN (MAST-ARM HANGER METHOD)	EA	22	210.00	4,620.00	200.00	4,400.00
88		620909	450 MM ALTERNATIVE PIPE CULVERT	M	71	277.00	19,667.00	220.00	15,620.00
89		620913	600 MM ALTERNATIVE PIPE CULVERT	M	230	234.00	53,820.00	240.00	55,200.00
90		620924	900 MM ALTERNATIVE PIPE CULVERT	M	120	336.00	40,320.00	310.00	37,200.00
91		664097	600 MM BITUMINOUS COATED CORRUGATED STEEL PIPE (2.77 MM THICK)	M	200	306.00	61,200.00	290.00	58,000.00
92		664110	900 MM BITUMINOUS COATED CORRUGATED STEEL PIPE (2.77 MM THICK)	M	50	320.00	16,000.00	355.00	17,750.00
93		717072	100 MM POLYVINYL CHLORIDE SEWER PIPE	M	37	250.00	9,250.00	220.00	8,140.00
94		721008	ROCK SLOPE PROTECTION (LIGHT, METHOD B)	M3	140	190.00	26,600.00	130.00	18,200.00
95		721430	CONCRETE (CHANNEL LINING)	M3	73	265.00	19,345.00	350.00	25,550.00
96		729010	ROCK SLOPE PROTECTION FABRIC	M2	330	8.00	2,640.00	10.00	3,300.00
97 (F)		731504	MINOR CONCRETE (CURB AND GUTTER)	M3	250	416.00	104,000.00	395.00	98,750.00
98 (F)		000003	MINOR CONCRETE (COLORED)	M2	1,890	47.00	88,830.00	44.00	83,160.00
99 (F)		731521	MINOR CONCRETE (SIDEWALK)	M3	260	360.00	93,600.00	340.00	88,400.00
100 (F)		731530	MINOR CONCRETE (TEXTURED PAVING)	M2	1,190	87.00	103,530.00	82.00	97,580.00
101 (F)		750001	MISCELLANEOUS IRON AND STEEL	KG	1,262	4.00	5,048.00	10.00	12,620.00
102		800391	CHAIN LINK FENCE (TYPE CL-1.8)	M	940	50.00	47,000.00	38.00	35,720.00
103		820105	DELINEATOR (SPECIAL)	EA	23	50.00	1,150.00	125.00	2,875.00
104		820107	DELINEATOR (CLASS 1)	EA	160	50.00	8,000.00	50.00	8,000.00
105		832003	METAL BEAM GUARD RAILING (WOOD POST)	M	670	85.00	56,950.00	61.00	40,870.00
106		839541	TRANSITION RAILING (TYPE WB)	EA	4	2,700.00	10,800.00	3,500.00	14,000.00

**Riverside County Transportation Department  
Summary of Bids**

**PROJECT: I-10/Indian Canyon Drive Interchange Improvements**

Advertised: March 16, 2010 (Agenda Item: 3.64)

Bids Open: 2 pm Date: Wednesday, April 28, 2010

PROJECT NO. A8-0372; ESPLHPLU-5282(034) & HP21L-5282 (035)

FTR International, Inc.  
Irvine, CA 92602

Ortiz Enterprises, Inc.  
Irvine, CA 92618

BASE BID (CONTINUED)		CONTRACT ITEM		UNITS	QUANTITY	BID UNIT PRICE	BID ESTIMATE	BID UNIT PRICE	BID ESTIMATE
ITEM NO.	ITEM CODE								
107	839568	TERMINAL ANCHOR ASSEMBLY (TYPE SFT)		EA	5	700.00	3,500.00	700.00	3,500.00
108	839585	ALTERNATIVE FLARED TERMINAL SYSTEM [TYPE SRT]		EA	9	2,200.00	19,800.00	2,200.00	19,800.00
109	839605	CRASH CUSHION (REACT 9SCBS)		EA	3	22,000.00	66,000.00	49,000.00	147,000.00
110	839703	CONCRETE BARRIER (TYPE 60C)		M	270	380.00	102,600.00	200.00	54,000.00
111	839705	CONCRETE BARRIER (TYPE 60E)		M	89	360.00	32,040.00	200.00	17,800.00
112	840515	THERMOPLASTIC PAVEMENT MARKING		M2	360	20.00	7,200.00	41.00	14,760.00
113	840563	200 MM THERMOPLASTIC TRAFFIC STRIPE		M	1,210	2.00	2,420.00	5.00	6,050.00
114	840571	100 MM THERMOPLASTIC TRAFFIC STRIPE (BROKEN 5.18 M - 2.14 M)		M	9,600	1.00	9,600.00	1.60	15,360.00
115	840656	PAINT TRAFFIC STRIPE (2-COAT)		M	13,100	1.00	13,100.00	1.30	17,030.00
116	850101	PAVEMENT MARKER (NON-REFLECTIVE)		EA	15,300	3.00	45,900.00	1.40	21,420.00
117	850110	PAVEMENT MARKER (RETROREFLECTIVE-SPECIAL TYPE C)		EA	86	3.00	258.00	28.00	2,408.00
118	850111	PAVEMENT MARKER (RETROREFLECTIVE -SPECIAL TYPE D)		EA	790	3.00	2,370.00	8.00	6,320.00
119	850112	PAVEMENT MARKER (RETROREFLECTIVE-SPECIAL TYPE G)		EA	2,790	3.00	8,370.00	6.00	16,740.00
120	850113	PAVEMENT MARKER (RETROREFLECTIVE-SPECIAL TYPE H)		EA	450	2.00	900.00	10.00	4,500.00
121	860251	SIGNAL AND LIGHTING (LOCATION 1)		LS	1	125,000.00	125,000.00	100,000.00	100,000.00
122	860252	SIGNAL AND LIGHTING (LOCATION 2)		LS	1	110,000.00	110,000.00	85,000.00	85,000.00
123	860300	SIGNAL AND LIGHTING (CITY STREET LOCATION 1)		LS	1	180,000.00	180,000.00	145,000.00	145,000.00
124	860302	SIGNAL AND LIGHTING (CITY STREET LOCATION 2)		LS	1	185,000.00	185,000.00	160,000.00	160,000.00
125	860460	LIGHTING AND SIGN ILLUMINATION		LS	1	375,000.00	375,000.00	235,000.00	235,000.00
126	860701	INTERCONNECTION CONDUIT AND CONDUCTOR		LS	1	70,000.00	70,000.00	40,000.00	40,000.00
127	861101	RAMP METERING SYSTEM (LOCATION 1)		LS	1	60,000.00	60,000.00	45,000.00	45,000.00
128	861102	RAMP METERING SYSTEM (LOCATION 2)		LS	1	75,000.00	75,000.00	55,000.00	55,000.00
129	861103	RAMP METERING SYSTEM (LOCATION 3)		LS	1	60,000.00	60,000.00	44,000.00	44,000.00
130	861104	RAMP METERING SYSTEM (LOCATION 4)		LS	1	60,000.00	60,000.00	46,000.00	46,000.00
131	861349	REMOVE EXISTING SIGNAL SYSTEM ( LOCATION 1)		LS	1	15,000.00	15,000.00	8,000.00	8,000.00
132	861350	REMOVE EXISTING SIGNAL SYSTEM ( LOCATION 2)		LS	1	15,000.00	15,000.00	9,000.00	9,000.00
133	999990	MOBILIZATION		LS	1	1,250,000.00	1,250,000.00	2,000,000.00	2,000,000.00
134	000003	COURSE OF CONSTRUCTION INSURANCE		LS	1	160,000.00	160,000.00	129,000.00	129,000.00
135	019901	DEMOBILIZATION		LS	1	50,000.00	50,000.00	10,000.00	10,000.00
136	066102	DUST ABATEMENT		LS	1	10,000.00	10,000.00	35,000.00	35,000.00
137	066105	RESIDENT ENGINEER OFFICE		LS	1	150,000.00	150,000.00	135,000.00	135,000.00
138	066840	TRAFFIC SIGNAL CONTROLLER ASSEMBLY [WITH BATTERY BACK-UP][2-LOCATIONS]		LS	1	13,600.00	13,600.00	13,600.00	13,600.00
139	066843	MODEL 170 CONTROLLER ASSEMBLY [RAMP METER] [4-LOCATIONS]		LS	1	19,200.00	19,200.00	19,200.00	19,200.00
140	066015	FEDERAL TRAINEE PROGRAM		LS	1	45,000.00	45,000.00	11,000.00	11,000.00
141	047403	6'10 MM STEEL PIPE CASING		M	26	1,500.00	39,000.00	950.00	24,700.00



**Riverside County Transportation Department  
Summary of Bids**

**PROJECT: I-10/Indian Canyon Drive Interchange Improvements**

Advertised: March 16, 2010 (Agenda Item: 3.64)

Bids Open: 2 pm Date: Wednesday, April 28, 2010

**PROJECT NO. A8-0372; ESPLHPLU-5282(034); HP21-L-5282 (035)**

BASE BID (CONTINUED)		CONTRACT ITEM		UNITS	QUANTITY	BID UNIT PRICE	BID ESTIMATE	BID UNIT PRICE	BID ESTIMATE
ITEM NO.	ITEM CODE								
142	157550	BRIDGE REMOVAL		LS	1	68,000.00	68,000.00	78,000.00	78,000.00
143 (F)	192003	STRUCTURE EXCAVATION (BRIDGE)		M3	1,150	30.00	34,500.00	125.00	143,750.00
144 (F)	193003	STRUCTURE BACKFILL (BRIDGE)		M3	490	35.00	17,150.00	120.00	58,800.00
145	490566	FURNISH STEEL PILING (HP 360 X 132)		M	2,977	155.00	461,435.00	140.00	416,780.00
146	490567	DRIVE STEEL PILE (HP 360 X 132)		EA	196	1,220.00	239,120.00	1,650.00	323,400.00
147	*****	ITEM DELETED BY ADDENDUM							
148	*****	ITEM DELETED BY ADDENDUM							
149	500020	PRESTRESSING PRECAST GIRDER		LS	1	95,000.00	95,000.00	90,000.00	90,000.00
150 (F)	510051	STRUCTURAL CONCRETE, BRIDGE FOOTING		M3	220	715.00	157,300.00	350.00	77,000.00
151 (F)	510053	STRUCTURAL CONCRETE, BRIDGE		M3	1,710	645.00	1,102,950.00	535.00	914,850.00
152 (F)	510086	STRUCTURAL CONCRETE, APPROACH SLAB (TYPE N)		M3	210	430.00	90,300.00	600.00	126,000.00
153	511036	ARCHITECTURAL SURFACE [LAVA ROCK FACING]		M2	170	760.00	129,200.00	115.00	19,550.00
154 (F)	511063	FRACTURED FIN TEXTURE		M2	140	780.00	109,200.00	125.00	17,500.00
155	512254	FURNISH PRECAST PRESTRESSED CONCRETE BULB-TEE GIRDER (25 M-30 M)		EA	26	20,500.00	533,000.00	18,000.00	468,000.00
156	512255	FURNISH PRECAST PRESTRESSED CONCRETE BULB-TEE GIRDER (30 M-35 M)		EA	13	23,150.00	300,950.00	18,000.00	234,000.00
157	512500	ERECT PRECAST PRESTRESSED CONCRETE GIRDER		EA	39	1,320.00	51,480.00	1,200.00	46,800.00
158	519123	JOINT SEAL (TYPE B - MR 50 MM)		M	72	387.00	27,864.00	387.00	27,864.00
159 (F)	520102	BAR REINFORCING STEEL (BRIDGE)		KG	244,000	2.10	512,400.00	1.65	402,600.00
160 (F)	721810	SLOPE PAVING (CONCRETE)		M3	72	400.00	28,800.00	400.00	28,800.00
161 (F)	750505	BRIDGE DECK DRAINAGE SYSTEM		KG	470	18.00	8,460.00	40.00	18,800.00
162 (F)	833088	TUBULAR HANDRAILING		M	10	435.00	4,350.00	325.00	3,250.00
163 (F)	833142	CONCRETE BARRIER (TYPE 26 MODIFIED)		M	110	490.00	53,900.00	365.00	40,150.00
164	839727	CONCRETE BARRIER (TYPE 736 MODIFIED)		M	110	280.00	30,800.00	145.00	15,950.00
165 (F)	833020	CHAIN LINK RAILING [MINI MESH]		M	91	1,100.00	100,100.00	1,400.00	127,400.00
		<b>BSAE BID TOTAL</b>					<b>17,931,221.00</b>		<b>18,104,492.90</b>
		ITEMS 1 - 165							

**ALTERNATE BID:**

THE MISSION SPRINGS WATER DISTRICT		CONTRACT ITEM		UNITS	QUANTITY	BID UNIT PRICE	BID ESTIMATE	BID UNIT PRICE	BID ESTIMATE
ITEM NO.	ITEM CODE								
166	0000003	ADJUST WATER VALVE COVER TO GRADE		EA	14	1,250.00	17,500.00	450.00	6,300.00
		<b>ALTERNATE BID TOTAL</b>					<b>17,500.00</b>		<b>6,300.00</b>
		ITEMS 166							
		<b>PROJECT TOTAL</b>					<b>17,948,721.00</b>		<b>18,110,792.90</b>
		ITEMS 1 - 166							

# Riverside County Transportation Department Summary of Bids

PROJECT: I-10/Indian Canyon Drive Interchange Improvements

Advertised: March 16, 2010 (Agenda Item: 3.64)  
Bids Open: 2 pm Date: Wednesday, April 28, 2010

PROJECT NO. A8-0372; ESPLHPLU-5282(034); HP21-L-5282 (035)

BASE BID		CONTRACT ITEM		UNITS	QUANTITY	BID UNIT PRICE	BID ESTIMATE	BID UNIT PRICE	BID ESTIMATE
ITEM NO.	ITEM CODE	CONTRACT ITEM							
1	000003	ENDANGERED SPECIES PROTECTION		LS	1	5,000.00	5,000.00	2,500.00	2,500.00
2	000003	NONNATIVE PLANT PRECLUSION		LS	1	5,000.00	5,000.00	6,000.00	6,000.00
3	000003	CONSTRUCTION MONITORING CAMERA (POLE AND ELECTRIC SERVICE)		LS	1	25,000.00	25,000.00	9,000.00	9,000.00
4 (S,F)	000003	METAL SCRIPT LETTERS (RAILING METHOD)		LS	1	52,500.00	52,500.00	13,000.00	13,000.00
5	*****	ITEM DELETED BY ADDENDUM		*****	*****	*****	*****	*****	*****
6	070012	PROGRESS SCHEDULE (CRITICAL PATH METHOD)		LS	1	5,000.00	5,000.00	5,000.00	5,000.00
7	071325	TEMPORARY FENCE (TYPE ESA)		M	610	4.50	2,745.00	10.50	6,405.00
8	000003	TEMPORARY FENCE (TYPE WILDLIFE)		M	610	6.50	3,965.00	10.50	6,405.00
9	074016	CONSTRUCTION SITE MANAGEMENT		LS	1	30,000.00	30,000.00	15,000.00	15,000.00
10	074020	WATER POLLUTION CONTROL		LS	1	12,500.00	12,500.00	2,120.00	2,120.00
11	074018	HEALTH AND SAFETY PLAN		LS	1	2,500.00	2,500.00	2,120.00	2,120.00
12	074028	TEMPORARY FIBER ROLLS		M	10,800	7.75	83,700.00	5.00	54,000.00
13	074029	TEMPORARY SILT FENCE		M	960	6.75	6,480.00	7.75	7,440.00
14	074033	TEMPORARY CONSTRUCTION ENTRANCE		EA	3	2,400.00	7,200.00	3,100.00	9,300.00
15	074035	TEMPORARY CHECK DAM		M	52	5.75	299.00	227.00	11,804.00
16	074037	MOVE-IN/MOVE-OUT (TEMPORARY EROSION CONTROL)		EA	4	500.00	2,000.00	900.00	3,600.00
17	074038	TEMPORARY DRAINAGE INLET PROTECTION		EA	39	125.00	4,875.00	325.00	12,675.00
18	074039	TEMPORARY HYDRAULIC MULCH (POLYMER STABILIZED FIBER MATRIX)		M2	136,000	0.23	31,280.00	0.20	27,200.00
19	074041	STREET SWEEPING		LS	1	125,000.00	125,000.00	1,900.00	1,900.00
20	074042	TEMPORARY CONCRETE WASHOUT (PORTABLE)		LS	1	15,000.00	15,000.00	19,000.00	19,000.00
21	120090	CONSTRUCTION AREA SIGNS		LS	1	25,000.00	25,000.00	8,500.00	8,500.00
22	120100	TRAFFIC CONTROL SYSTEMS		LS	1	533,133.40	533,133.40	175,000.00	175,000.00
23	120120	TYPE III BARRICADE		EA	140	47.00	6,580.00	64.00	8,960.00
24	120143	TEMPORARY PAVEMENT DELINEATION		M	4,460	0.50	2,230.00	3.25	14,495.00
25	120149	TEMPORARY PAVEMENT MARKING (PAINT)		M2	100	8.00	800.00	34.00	3,400.00
26	120199	TRAFFIC PLASTIC DRUM		EA	590	40.00	23,600.00	424.00	250,160.00
27	128650	PORTABLE CHANGEABLE MESSAGE SIGN		EA	10	11,250.00	112,500.00	10,600.00	106,000.00
28	129000	TEMPORARY RAILING (TYPE K)		M	5,300	20.00	106,000.00	26.00	137,800.00
29	129110	TEMPORARY CRASH CUSHION [SAND FILLED]		EA	210	250.00	52,500.00	196.00	41,160.00
30	129110	TEMPORARY CRASH CUSHION [ABSORB 350]		EA	6	3,000.00	18,000.00	5,300.00	31,800.00
31	150701	REMOVE YELLOW TRAFFIC STRIPE [HAZARDOUS WASTE]		M	2,870	2.25	6,457.50	2.10	6,027.00
32	150608	REMOVE CHAIN LINK FENCE		M	610	6.25	3,812.50	17.50	10,675.00
33	150659	REMOVE TERMINAL SECTION		EA	3	250.00	750.00	530.00	1,590.00
34	150662	REMOVE METAL BEAM GUARD RAILING		M	660	26.00	17,160.00	23.00	15,180.00
35	150710	REMOVE TRAFFIC STRIPE		M	34,100	0.45	15,345.00	1.40	47,740.00
36	150713	REMOVE PAVEMENT MARKING		M2	52	13.50	702.00	23.00	1,196.00

Beador Construction  
Corona, CA 92883

Sukat Construction, Inc.  
Riverside, CA 92505

**Riverside County Transportation Department  
Summary of Bids**

**PROJECT: I-10/Indian Canyon Drive Interchange Improvements**

Advertised: March 16, 2010 (Agenda Item: 3.64)  
Bids Open: 2 pm Date: Wednesday, April 28, 2010

**PROJECT NO. A8-0372; ESPLHPLU-5282(034); HP21-L-5282 (035)**

BASE BID (CONTINUED)		Beador Construction Corona, CA 92883		Sukut Construction, Inc. Riverside, CA 92505				
ITEM NO.	ITEM CODE	CONTRACT ITEM	UNITS	QUANTITY	BID UNIT PRICE	BID ESTIMATE	BID UNIT PRICE	BID ESTIMATE
37	150722	REMOVE PAVEMENT MARKER	EA	8,520	1.00	8,520.00	1.05	8,946.00
38	150742	REMOVE ROADSIDE SIGN	EA	43	50.00	2,150.00	159.00	6,837.00
39	150760	REMOVE SIGN STRUCTURE	EA	2	7,425.00	14,850.00	6,360.00	12,720.00
40	150806	REMOVE CULVERT	M	360	38.00	13,680.00	49.00	17,640.00
41	150820	REMOVE INLET	EA	1	1,250.00	1,250.00	1,060.00	1,060.00
42	150821	REMOVE HEADWALL	EA	21	750.00	15,750.00	742.00	15,582.00
43	153153	COLD PLANE ASPHALT CONCRETE PAVEMENT (45 MM MAXIMUM)	M2	1,080	9.50	10,260.00	3.80	4,104.00
44	160101	CLEARING AND GRUBBING	LS	1	82,500.00	82,500.00	33,000.00	33,000.00
45	170101	DEVELOP WATER SUPPLY	LS	1	10,000.00	10,000.00	20,000.00	20,000.00
46 (F)	190101	ROADWAY EXCAVATION	M3	29,170	20.00	583,400.00	24.00	700,080.00
47	190110	LEAD COMPLIANCE PLAN (METRIC)	LS	1	5,000.00	5,000.00	5,000.00	5,000.00
48	190113	ASBESTOS COMPLIANCE PLAN	LS	1	5,000.00	5,000.00	1,908.00	1,908.00
49	193118	CONCRETE BACKFILL	M3	14	180.00	2,520.00	423.00	5,922.00
50	194001	DITCH EXCAVATION	M3	320	11.50	3,680.00	12.00	3,840.00
51	198001	IMPORTED BORROW	M3	71,000	6.00	426,000.00	10.00	710,000.00
52	203016	EROSION CONTROL (TYPE D)	M2	13,200	1.30	17,160.00	1.25	16,500.00
53	203021	FIBER ROLLS (METRIC)	M	10,500	6.70	70,350.00	6.75	70,875.00
54	203026	MOVE-IN/MOVE-OUT (EROSION CONTROL)	EA	1	500.00	500.00	880.00	880.00
55	208731	200 MM CORRUGATED HIGH DENSITY POLYETHYLENE PIPE CONDUIT	M	68	1.75	119.00	111.00	7,548.00
56	220101	FINISHING ROADWAY	LS	1	40,000.00	40,000.00	21,800.00	21,800.00
57	260201	CLASS 2 AGGREGATE BASE	M3	14,600	46.00	671,600.00	35.00	511,000.00
58	280000	LEAN CONCRETE BASE	M3	190	175.00	33,250.00	295.00	56,050.00
59	374002	ASPHALTIC EMULSION (FOG SEAL COAT)	TONN	6	2,075.00	12,450.00	1,450.00	8,700.00
60	390106	ASPHALT CONCRETE (OPEN GRADED)[OPEN GRADED FRICTION COURSE]	TONN	1,310	165.00	216,150.00	135.00	176,850.00
61	390130	HOT MIX ASPHALT (TYPE A)	TONN	320	110.00	35,200.00	185.00	59,200.00
62	000003	HOT MIX ASPHALT (TYPE A BOND BREAKER)	TONN	120	175.00	21,000.00	280.00	33,600.00
63	000003	HOT MIX ASPHALT (TYPE C)	TONN	31,200	105.00	3,276,000.00	111.00	3,463,200.00
64	394071	PLACE HOT MIX ASPHALT DIKE	M	4,570	7.00	31,990.00	12.00	54,840.00
65	394090	PLACE HOT MIX ASPHALT (MISCELLANEOUS AREA)	M2	320	65.00	20,800.00	52.00	16,640.00
66	397005	TACK COAT	TONN	38	1,400.00	53,200.00	525.00	19,950.00
67	401066	CONCRETE PAVEMENT (EXIT RAMP TERMINI) [JOINTED PLAIN CONCRETE PAVEMENT]	M3	430	350.00	150,500.00	440.00	189,200.00
68	401108	RAPID STRENGTH CONCRETE [JOINTED PLAIN CONCRETE PAVEMENT]	M3	3,780	600.00	2,268,000.00	775.00	2,929,500.00
69	000003	SEAL ISOLATION JOINT	M	1,280	21.00	26,880.00	5.75	7,360.00
70	414091	SEAL LONGITUDINAL JOINT	M	2,140	6.25	13,375.00	45.00	96,300.00
71	414101	SEAL TRANSVERSE JOINT	M	2,120	6.25	13,250.00	5.75	12,190.00

# Riverside County Transportation Department Summary of Bids

PROJECT: I-10/Indian Canyon Drive Interchange Improvements

Advertised: March 16, 2010 (Agenda Item: 3.64)

Bids Open: 2 pm Date: Wednesday, April 28, 2010

PROJECT NO. A8-0372; ESPLHPLU-5282(034); HP21-L-5282 (035)

BASE BID (CONTINUED)		CONTRACT ITEM		UNITS	QUANTITY	BID UNIT PRICE	BID ESTIMATE	BID UNIT PRICE	BID ESTIMATE
ITEM NO.	ITEM CODE								
72	518201	MASONRY STONE WALL		M2	23	435.00	10,005.00	277.00	6,371.00
73 (F)	510129	CLASS 2 CONCRETE (BOX CULVERT)		M3	190	820.00	155,800.00	775.00	147,250.00
74 (F)	510502	MINOR CONCRETE (MINOR STRUCTURE)		M3	110	1,550.00	170,500.00	1,600.00	176,000.00
75 (F)	520107	BAR REINFORCING STEEL (BOX CULVERT)		KG	21,271	1.80	38,287.80	1.50	31,906.50
76 (F)	560218	FURNISH SIGN STRUCTURE (TRUSS)		KG	30,000	5.40	162,000.00	5.85	175,500.00
77 (F)	560219	INSTALL SIGN STRUCTURE (TRUSS)		KG	30,000	0.60	18,000.00	0.47	14,100.00
78	560234	FURNISH LAMINATED PANEL SIGN (25.4 MM -TYPE A)		M2	67	150.00	10,050.00	216.00	14,472.00
79	560238	FURNISH SINGLE SHEET ALUMINUM SIGN (1.6 MM- UNFRAMED)		M2	56	66.00	3,696.00	93.00	5,208.00
80	560239	FURNISH SINGLE SHEET ALUMINUM SIGN (2.0 MM- UNFRAMED)		M2	30	71.00	2,130.00	93.00	2,790.00
81	560241	FURNISH SINGLE SHEET ALUMINUM SIGN (1.6 MM- FRAMED)		M2	13	92.00	1,196.00	123.00	1,599.00
82	560242	FURNISH SINGLE SHEET ALUMINUM SIGN (2.0 MM- FRAMED)		M2	71	104.00	7,384.00	131.00	9,301.00
83	561015	1524 MM CAST-IN-DRILLED-HOLE CONCRETE PILE (SIGN FOUNDATION)		M	23	2,450.00	56,350.00	4,500.00	103,500.00
84	566011	ROADSIDE SIGN - ONE POST		EA	85	270.00	22,950.00	281.00	23,885.00
85	566012	ROADSIDE SIGN - TWO POST		EA	17	575.00	9,775.00	504.00	8,568.00
86	568001	INSTALL SIGN (STRAP AND SADDLE BRACKET METHOD)		EA	8	230.00	1,840.00	186.00	1,488.00
87	568015	INSTALL SIGN (MAST-ARM HANGER METHOD)		EA	22	205.00	4,510.00	265.00	5,830.00
88	620909	450 MM ALTERNATIVE PIPE CULVERT		M	71	208.00	14,768.00	344.00	24,424.00
89	620913	600 MM ALTERNATIVE PIPE CULVERT		M	230	245.00	56,350.00	300.00	69,000.00
90	620924	900 MM ALTERNATIVE PIPE CULVERT		M	120	350.00	42,000.00	250.00	30,000.00
91	664097	600 MM BITUMINOUS COATED CORRUGATED STEEL PIPE (2.77 MM THICK)		M	200	220.00	44,000.00	340.00	68,000.00
92	664110	900 MM BITUMINOUS COATED CORRUGATED STEEL PIPE (2.77 MM THICK)		M	50	280.00	14,000.00	550.00	27,500.00
93	717072	100 MM POLYVINYL CHLORIDE SEWER PIPE		M	37	40.00	1,480.00	31.00	1,147.00
94	721008	ROCK SLOPE PROTECTION (LIGHT, METHOD B)		M3	140	195.00	27,300.00	205.00	28,700.00
95	721430	CONCRETE (CHANNEL LINING)		M3	73	320.00	23,360.00	335.00	24,455.00
96	729010	ROCK SLOPE PROTECTION FABRIC		M2	330	5.50	1,815.00	3.00	990.00
97 (F)	731504	MINOR CONCRETE (CURB AND GUTTER)		M3	250	400.00	100,000.00	540.00	135,000.00
98 (F)	000003	MINOR CONCRETE (COLORED)		M2	1,890	44.00	83,160.00	53.00	100,170.00
99 (F)	731521	MINOR CONCRETE (SIDEWALK)		M3	260	345.00	89,700.00	480.00	124,800.00
100 (F)	731530	MINOR CONCRETE (TEXTURED PAVING)		M2	1,190	80.00	95,200.00	87.00	103,530.00
101 (F)	750001	MISCELLANEOUS IRON AND STEEL		KG	1,262	5.00	6,310.00	3.00	3,786.00
102	800391	CHAIN LINK FENCE (TYPE CL-1.8)		M	940	48.00	45,120.00	63.00	59,220.00
103	820105	DELINEATOR (SPECIAL)		EA	23	100.00	2,300.00	29.00	667.00
104	820107	DELINEATOR (CLASS 1)		EA	160	45.00	7,200.00	29.00	4,640.00
105	832003	METAL BEAM GUARD RAILING (WOOD POST)		M	670	80.00	53,600.00	87.00	58,290.00
106	839541	TRANSITION RAILING (TYPE WB)		EA	4	2,750.00	11,000.00	3,600.00	14,400.00

Beador Construction  
Corona, CA 92883

Sukut Construction, Inc.  
Riverside, CA 92505

**Riverside County Transportation Department  
Summary of Bids**

**PROJECT: I-10/Indian Canyon Drive Interchange Improvements**

**Advertised: March 16, 2010 (Agenda Item: 3.64)**

**Bids Open: 2 pm Date: Wednesday, April 28, 2010**

**PROJECT NO. A8-0372; ESPLHPLU-5282(034) & HP21L-5282 (035)**

BASE BID (CONTINUED)		Beador Construction Corona, CA 92883		Sukut Construction, Inc. Riverside, CA 92505				
ITEM NO.	ITEM CODE	CONTRACT ITEM	UNITS	QUANTITY	BID UNIT PRICE	BID ESTIMATE	BID UNIT PRICE	BID ESTIMATE
107	839568	TERMINAL ANCHOR ASSEMBLY (TYPE SFT)	EA	5	680.00	3,400.00	636.00	3,180.00
108	839585	ALTERNATIVE FLARED TERMINAL SYSTEM [TYPE SRT]	EA	9	2,225.00	20,025.00	3,100.00	27,900.00
109	839605	CRASH CUSHION (REACT 9SCBS)	EA	3	54,200.00	162,600.00	6,400.00	19,200.00
110	839703	CONCRETE BARRIER (TYPE 60C)	M	270	265.00	71,550.00	350.00	94,500.00
111	839705	CONCRETE BARRIER (TYPE 60E)	M	89	510.00	45,390.00	460.00	40,940.00
112	840515	THERMOPLASTIC PAVEMENT MARKING	M2	360	15.00	5,400.00	48.00	17,280.00
113	840563	200 MM THERMOPLASTIC TRAFFIC STRIPE	M	1,210	1.60	1,936.00	4.00	4,840.00
114	840571	100 MM THERMOPLASTIC TRAFFIC STRIPE (BROKEN 5.18 M - 2.14 M)	M	9,600	0.75	7,200.00	1.90	18,240.00
115	840656	PAINT TRAFFIC STRIPE (2-COAT)	M	13,100	0.20	2,620.00	1.60	20,960.00
116	850101	PAVEMENT MARKER (NON-REFLECTIVE)	EA	15,300	1.00	15,300.00	1.75	26,775.00
117	850110	PAVEMENT MARKER (RETROREFLECTIVE-SPECIAL TYPE C)	EA	86	2.30	197.80	7.00	602.00
118	850111	PAVEMENT MARKER (RETROREFLECTIVE-SPECIAL TYPE D)	EA	790	2.00	1,580.00	7.00	5,530.00
119	850112	PAVEMENT MARKER (RETROREFLECTIVE-SPECIAL TYPE G)	EA	2,790	2.00	5,580.00	7.00	19,530.00
120	850113	PAVEMENT MARKER (RETROREFLECTIVE-SPECIAL TYPE H)	EA	450	2.00	900.00	7.00	3,150.00
121	860251	SIGNAL AND LIGHTING (LOCATION 1)	LS	1	107,000.00	107,000.00	165,000.00	165,000.00
122	860252	SIGNAL AND LIGHTING (LOCATION 2)	LS	1	102,000.00	102,000.00	165,000.00	165,000.00
123	860300	SIGNAL AND LIGHTING (CITY STREET LOCATION 1)	LS	1	180,000.00	180,000.00	200,000.00	200,000.00
124	860302	SIGNAL AND LIGHTING (CITY STREET LOCATION 2)	LS	1	175,000.00	175,000.00	220,000.00	220,000.00
125	860460	LIGHTING AND SIGN ILLUMINATION	LS	1	230,000.00	230,000.00	170,000.00	170,000.00
126	860701	INTERCONNECTION CONDUIT AND CONDUCTOR	LS	1	36,000.00	36,000.00	80,000.00	80,000.00
127	861101	RAMP METERING SYSTEM (LOCATION 1)	LS	1	49,000.00	49,000.00	80,000.00	80,000.00
128	861102	RAMP METERING SYSTEM (LOCATION 2)	LS	1	69,000.00	69,000.00	125,000.00	125,000.00
129	861103	RAMP METERING SYSTEM (LOCATION 3)	LS	1	50,000.00	50,000.00	90,000.00	90,000.00
130	861104	RAMP METERING SYSTEM (LOCATION 4)	LS	1	55,000.00	55,000.00	80,000.00	80,000.00
131	861349	REMOVE EXISTING SIGNAL SYSTEM (LOCATION 1)	LS	1	6,100.00	6,100.00	30,000.00	30,000.00
132	861350	REMOVE EXISTING SIGNAL SYSTEM (LOCATION 2)	LS	1	6,400.00	6,400.00	30,000.00	30,000.00
133	999990	MOBILIZATION	LS	1	1,800,000.00	1,800,000.00	1,540,000.00	1,540,000.00
134	000003	COURSE OF CONSTRUCTION INSURANCE	LS	1	52,000.00	52,000.00	140,000.00	140,000.00
135	019901	DEMOBILIZATION	LS	1	25,000.00	25,000.00	80,000.00	80,000.00
136	066102	DUST ABATEMENT	LS	1	25,000.00	25,000.00	33,920.00	33,920.00
137	066105	RESIDENT ENGINEER OFFICE	LS	1	50,000.00	50,000.00	40,704.00	40,704.00
138	066840	TRAFFIC SIGNAL CONTROLLER ASSEMBLY [WITH BATTERY BACK-UP][2-LOCATIONS]	LS	1	13,600.00	13,600.00	13,600.00	13,600.00
139	066843	MODEL 170 CONTROLLER ASSEMBLY [RAMP METER] [4-LOCATIONS]	LS	1	19,200.00	19,200.00	19,200.00	19,200.00
140	066015	FEDERAL TRAINEE PROGRAM	LS	1	5,000.00	5,000.00	12,720.00	12,720.00
141	047403	610 MM STEEL PIPE CASING	M	26	665.00	17,290.00	600.00	15,600.00

**Riverside County Transportation Department  
Summary of Bids**

**PROJECT: I-10/Indian Canyon Drive Interchange Improvements**

Advertised: March 16, 2010 (Agenda Item: 3.64)  
Bids Open: 2 pm Date: Wednesday, April 28, 2010

**PROJECT NO. A8-0372; ESPLHPLU-5282(034); HP21-L-5282 (035)**

**Beador Construction  
Corona, CA 92883**

**Sukut Construction, Inc.  
Riverside, CA 92505**

ITEM NO.	ITEM CODE	CONTRACT ITEM	UNITS	QUANTITY	BID UNIT PRICE	BID ESTIMATE	BID UNIT PRICE	BID ESTIMATE
142	157550	BRIDGE REMOVAL	LS	1	72,000.00	72,000.00	105,000.00	105,000.00
143 (F)	192003	STRUCTURE EXCAVATION (BRIDGE)	M3	1,150	80.00	92,000.00	195.00	224,250.00
144 (F)	193003	STRUCTURE BACKFILL (BRIDGE)	M3	490	155.00	75,950.00	137.00	67,130.00
145	490566	FURNISH STEEL PILING (HP 360 X 132)	M	2,977	150.00	446,550.00	120.00	357,240.00
146	490567	DRIVE STEEL PILE (HP 360 X 132)	EA	196	1,080.00	211,680.00	1,050.00	205,800.00
147	*****	ITEM DELETED BY ADDENDUM	*****	*****	*****	*****	*****	*****
148	*****	ITEM DELETED BY ADDENDUM	*****	*****	*****	*****	*****	*****
149	500020	PRESTRESSING PRECAST GIRDER	LS	1	90,000.00	90,000.00	98,000.00	98,000.00
150 (F)	510051	STRUCTURAL CONCRETE, BRIDGE FOOTING	M3	220	550.00	121,000.00	525.00	115,500.00
151 (F)	510053	STRUCTURAL CONCRETE, BRIDGE	M3	1,710	650.00	1,111,500.00	975.00	1,667,250.00
152 (F)	510086	STRUCTURAL CONCRETE, APPROACH SLAB (TYPE N)	M3	210	640.00	134,400.00	775.00	162,750.00
153	511036	ARCHITECTURAL SURFACE [LAVA ROCK FACING]	M2	170	97.00	16,490.00	42.00	7,140.00
154 (F)	511063	FRACTURED FIN TEXTURE	M2	140	54.00	7,560.00	73.00	10,220.00
155	512254	FURNISH PRECAST PRESTRESSED CONCRETE BULB-TEE GIRDER (25 M-30 M)	EA	26	18,000.00	468,000.00	20,000.00	520,000.00
156	512255	FURNISH PRECAST PRESTRESSED CONCRETE BULB-TEE GIRDER (30 M-35 M)	EA	13	18,165.00	236,145.00	22,000.00	286,000.00
157	512500	ERECT PRECAST PRESTRESSED CONCRETE GIRDER	EA	39	1,970.00	76,830.00	1,950.00	76,050.00
158	519123	JOINT SEAL (TYPE B - MR 50 MM)	M	72	440.00	31,680.00	200.00	14,400.00
159 (F)	520102	BAR REINFORCING STEEL (BRIDGE)	KG	244,000	1.60	390,400.00	1.30	317,200.00
160 (F)	721810	SLOPE PAVING (CONCRETE)	M3	72	620.00	44,640.00	1,050.00	75,600.00
161 (F)	750505	BRIDGE DECK DRAINAGE SYSTEM	KG	470	27.00	12,690.00	52.00	24,440.00
162 (F)	833088	TUBULAR HANDRAILING	M	10	430.00	4,300.00	348.00	3,480.00
163 (F)	833142	CONCRETE BARRIER (TYPE 26 MODIFIED)	M	110	500.00	55,000.00	475.00	52,250.00
164	839727	CONCRETE BARRIER (TYPE 736 MODIFIED)	M	110	335.00	36,850.00	550.00	60,500.00
165 (F)	833020	CHAIN LINK RAILING [MINI MESH]	M	91	1,000.00	91,000.00	139.00	12,649.00
		<b>BSAE BID TOTAL</b>				<b>18,137,019.00</b>		<b>20,075,681.50</b>
		<b>ITEMS 1 - 165</b>						

**ALTERNATE BID:**

**THE MISSION SPRINGS WATER DISTRICT**

166	0000003	ADJUST WATER VALVE COVER TO GRADE	EA	14	1,000.00	14,000.00	530.00	7,420.00
		<b>ALTERNATE BID TOTAL</b>				<b>14,000.00</b>		<b>7,420.00</b>
		<b>ITEMS 166</b>						
		<b>PROJECT TOTAL</b>				<b>18,151,019.00</b>		<b>20,083,101.50</b>
		<b>ITEMS 1 - 166</b>						

**BID TO THE COUNTY OF RIVERSIDE**  
**INDIAN CANYON DRIVE AT INTERSTATE 10**  
**RECONSTRUCT OF INTERCHANGE**  
**PROJECT NO. A8-0372**  
**FEDERAL AID NO. ESPLHPLU-5282 (034) & HP21L-5282 (035)**

**NAME OF BIDDER:** GRANITE CONSTRUCTION COMPANY

The work for which this bid is submitted is for construction in conformance with the special provisions (including the payment of not less than the State general prevailing wage rates or Federal minimum wage rates), the project plans described below, including any addenda thereto, the contract annexed hereto, and also in conformance with the California Department of Transportation Standard Plans, dated May 2006, the Standard Specifications, dated May 2006, and the Labor Surcharge and Equipment Rental Rates in effect on the date the work is accomplished.

The work to be done is shown upon plans entitled, Indian Canyon drive at Interstate 10 – Reconstruct of Interchange.

**ADDENDA -**

This Bid is submitted with respect to the changes to the contract included in addenda number/s: 1,2,3

*(Fill in addenda numbers if addenda have been received and insert, in this Bid, any Engineer's Estimate sheets that were received as part of the addenda.)*

**TO THE COUNTY OF RIVERSIDE:**

The undersigned, as bidder, declares that the only persons or parties interested in this Bid as principals are those named herein; that this Bid is made without collusion with any other person, firm, or corporation and in submitting this Bid, the undersigned bidder agrees that if it is determined that he is the successful bidder, he will execute the non-collusion affidavit required by the Federal requirements set forth under Section 6 of these Special Provisions; that he has carefully examined the location of the proposed work, the annexed proposed form of contract, and the plans therein referred to; and he proposes and agrees if this Bid is accepted that he will contract with the County of Riverside in the form of the copy of the contract annexed hereto, and will deliver the Faithful Performance Bond, Payment Bond, and Insurance Certificate with endorsements, which comply with the requirements set forth in the contract documents, within 10 working days of the date of the Notice of Acceptance of Bid and Intent to Award as issued by the County of Riverside, and agrees to provide all necessary machinery, tools, apparatus, and other means of construction, and to do all the work and furnish all the materials specified in the contract, in the manner and time herein prescribed, and according to the requirements of the Engineer as therein set forth, and that he will take in full payment therefore the following item prices, to wit:

INDIAN CANYON DRIVE AT INTERSTATE 10  
RECONSTRUCTION OF INTERCHANGE  
PROJECT No. A8-0372  
FEDERAL AID No. ESPLHPLU-5282(034) and HP21L-5282(035)

**PROPOSAL (Revised)**

**BASE BID:**

ITEM No.	ITEM CODE	ITEM	UNIT	ESTIMATED QUANTITY	ITEM PRICE	TOTAL (IN FIGURES)
1	000003	ENDANGERED SPECIES PROTECTION	LS	1	2,000. <sup>00</sup>	2,000. <sup>00</sup>
2	000003	NONNATIVE PLANT PRECLUSION	LS	1	1,500. <sup>00</sup>	1,500. <sup>00</sup>
3	000003	CONSTRUCTION MONITORING CAMERA (POLE AND ELECTRIC SERVICE)	LS	1	985. <sup>00</sup>	985. <sup>00</sup>
4 (S,F)	000003	METAL SCRIPT LETTERS (RAILING METHOD)	LS	1	6,500. <sup>00</sup>	6,500. <sup>00</sup>
5	-----	ITEM DELETED BY ADDENDUM	-----	-----	-----	-----
6	070012	PROGRESS SCHEDULE (CRITICAL PATH METHOD)	LS	1	4,500. <sup>00</sup>	4,500. <sup>00</sup>
7	071325	TEMPORARY FENCE (TYPE ESA)	M	610	14. <sup>00</sup>	8,540. <sup>00</sup>
8	000003	TEMPORARY FENCE (TYPE WILDLIFE)	M	610	18. <sup>00</sup>	10,980. <sup>00</sup>
9	074016	CONSTRUCTION SITE MANAGEMENT	LS	1	15,000. <sup>00</sup>	15,000. <sup>00</sup>
10	074020	WATER POLLUTION CONTROL	LS	1	500. <sup>00</sup>	500. <sup>00</sup>
11	074018	HEALTH AND SAFETY PLAN	LS	1	500. <sup>00</sup>	500. <sup>00</sup>
12	074028	TEMPORARY FIBER ROLLS	M	10,800	7. <sup>00</sup>	75,600. <sup>00</sup>
13	074029	TEMPORARY SILT FENCE	M	960	17. <sup>00</sup>	16,320. <sup>00</sup>
14	074033	TEMPORARY CONSTRUCTION ENTRANCE	EA	3	4,500. <sup>00</sup>	13,500. <sup>00</sup>
15	074035	TEMPORARY CHECK DAM	M	52	35. <sup>00</sup>	1,820. <sup>00</sup>
16	074037	MOVE-IN/MOVE-OUT (TEMPORARY EROSION CONTROL)	EA	4	350. <sup>00</sup>	1,400. <sup>00</sup>
17	074038	TEMPORARY DRAINAGE INLET PROTECTION	EA	39	125. <sup>00</sup>	4,875. <sup>00</sup>
18	074039	TEMPORARY HYDRAULIC MULCH (POLMER STABILIZED FIBER MATRIX)	M2	136,000	0.20	27,200. <sup>00</sup>
19	074041	STREET SWEEPING	LS	1	65,000. <sup>00</sup>	65,000. <sup>00</sup>
20	074042	TEMPORARY CONCRETE WASHOUT (PORTABLE)	LS	1	8,500. <sup>00</sup>	8,500. <sup>00</sup>
21	120090	CONSTRUCTION AREA SIGNS	LS	1	18,000. <sup>00</sup>	18,000. <sup>00</sup>
22	120100	TRAFFIC CONTROL SYSTEMS	LS	1	150,000. <sup>00</sup>	150,000. <sup>00</sup>
23	120120	TYPE III BARRICADE	EA	140	35. <sup>00</sup>	4,900. <sup>00</sup>
24	120143	TEMPORARY PAVEMENT DELINEATION	M	4,460	5. <sup>00</sup>	22,300. <sup>00</sup>
25	120149	TEMPORARY PAVEMENT MARKING (PAINT)	M2	100	40. <sup>00</sup>	4,000. <sup>00</sup>
26	120199	TRAFFIC PLASTIC DRUM	EA	590	30. <sup>00</sup>	17,700. <sup>00</sup>
27	128650	PORTABLE CHANGEABLE MESSAGE SIGN	EA	10	7,500. <sup>00</sup>	75,000. <sup>00</sup>
28	129000	TEMPORARY RAILING (TYPE K)	M	5,300	27. <sup>00</sup>	143,100. <sup>00</sup>
29	129110	TEMPORARY CRASH CUSHION [SAND FILLED]	EA	210	275. <sup>00</sup>	57,750. <sup>00</sup>
30	129110	TEMPORARY CRASH CUSHION [ABSORB 350]	EA	6	11,500. <sup>00</sup>	69,000. <sup>00</sup>



INDIAN CANYON DRIVE AT INTERSTATE 10  
RECONSTRUCTION OF INTERCHANGE  
PROJECT No. A8-0372  
FEDERAL AID No. ESPLHPLU-5282(034) and HP21L-5282(035)

**PROPOSAL (Revised)**

ITEM No.	ITEM CODE	ITEM	UNIT	ESTIMATED QUANTITY	ITEM PRICE	TOTAL (IN FIGURES)
31	150701	REMOVE YELLOW TRAFFIC STRIPE [HAZARDOUS WASTE]	M	2,870	2.50	7,175. <sup>00</sup>
32	150608	REMOVE CHAIN LINK FENCE	M	610	14. <sup>00</sup>	8,540. <sup>00</sup>
33	150659	REMOVE TERMINAL SECTION	EA	3	2,000. <sup>00</sup>	6,000. <sup>00</sup>
34	150662	REMOVE METAL BEAM GUARD RAILING	M	660	22. <sup>00</sup>	14,520. <sup>00</sup>
35	150710	REMOVE TRAFFIC STRIPE	M	34,100	1.90	64,790. <sup>00</sup>
36	150713	REMOVE PAVEMENT MARKING	M2	52	20. <sup>00</sup>	1,040. <sup>00</sup>
37	150722	REMOVE PAVEMENT MARKER	EA	8,520	2. <sup>00</sup>	17,040. <sup>00</sup>
38	150742	REMOVE ROADSIDE SIGN	EA	43	100. <sup>00</sup>	4,300. <sup>00</sup>
39	150760	REMOVE SIGN STRUCTURE	EA	2	3,500. <sup>00</sup>	7,000. <sup>00</sup>
40	150806	REMOVE CULVERT	M	360	60. <sup>00</sup>	21,600. <sup>00</sup>
41	150820	REMOVE INLET	EA	1	1,000. <sup>00</sup>	1,000. <sup>00</sup>
42	150821	REMOVE HEADWALL	EA	21	275. <sup>00</sup>	5,775. <sup>00</sup>
43	153153	COLD PLANE ASPHALT CONCRETE PAVEMENT (45 MM MAXIMUM)	M2	1,080	8.50	9,180. <sup>00</sup>
44	160101	CLEARING AND GRUBBING	LS	1	82,500. <sup>00</sup>	82,500. <sup>00</sup>
45	170101	DEVELOP WATER SUPPLY	LS	1	10,000. <sup>00</sup>	10,000. <sup>00</sup>
46 (F)	190101	ROADWAY EXCAVATION	M3	29,170	15. <sup>00</sup>	437,550. <sup>00</sup>
47	190110	LEAD COMPLIANCE PLAN (METRIC)	LS	1	500. <sup>00</sup>	500. <sup>00</sup>
48	190113	ASBESTOS COMPLIANCE PLAN	LS	1	500. <sup>00</sup>	500. <sup>00</sup>
49	193118	CONCRETE BACKFILL	M3	14	225. <sup>00</sup>	3,150. <sup>00</sup>
50	194001	DITCH EXCAVATION	M3	320	8. <sup>00</sup>	2,560. <sup>00</sup>
51	198001	IMPORTED BORROW	M3	71,000	7.25	514,750. <sup>00</sup>
52	203016	EROSION CONTROL (TYPE D)	M2	13,200	0.65	8,580. <sup>00</sup>
53	203021	FIBER ROLLS (METRIC)	M	10,500	8. <sup>00</sup>	84,000. <sup>00</sup>
54	203026	MOVE-IN/MOVE-OUT (EROSION CONTROL)	EA	1	350. <sup>00</sup>	350. <sup>00</sup>
55	208731	200 MM CORRUGATED HIGH DENSITY POLYETHYLENE PIPE CONDUIT	M	68	200. <sup>00</sup>	13,600. <sup>00</sup>
56	220101	FINISHING ROADWAY	LS	1	25,000. <sup>00</sup>	25,000. <sup>00</sup>
57	260201	CLASS 2 AGGREGATE BASE	M3	14,600	22. <sup>00</sup>	321,200. <sup>00</sup>
58	280000	LEAN CONCRETE BASE	M3	190	200. <sup>00</sup>	38,000. <sup>00</sup>
59	374002	ASPHALTIC EMULSION (FOG SEAL COAT)	TONN	6	3,000. <sup>00</sup>	18,000. <sup>00</sup>
60	390106	ASPHALT CONCRETE (OPEN GRADED) [OPEN GRADED FRICTION COURSE]	TONN	1,310	90. <sup>00</sup>	117,900. <sup>00</sup>

INDIAN CANYON DRIVE AT INTERSTATE 10  
 RECONSTRUCTION OF INTERCHANGE  
 PROJECT No. A8-0372  
 FEDERAL AID No. ESPLHPLU-5282(034) and HP21L-5282(035)

**PROPOSAL (Revised)**

ITEM No.	ITEM CODE	ITEM	UNIT	ESTIMATED QUANTITY	ITEM PRICE	TOTAL (IN FIGURES)
61	390130	HOT MIX ASPHALT (TYPE A)	TONN	320	99. <sup>50</sup>	31,840. <sup>00</sup>
62	000003	HOT MIX ASPHALT (TYPE A BOND BREAKER)	TONN	120	110. <sup>00</sup>	13,200. <sup>00</sup>
63	000003	HOT MIX ASPHALT (TYPE C)	TONN	31,200	71. <sup>00</sup>	2,215,200. <sup>00</sup>
64	394071	PLACE HOT MIX ASPHALT DIKE	M	4,570	6. <sup>50</sup>	29,705. <sup>00</sup>
65	394090	PLACE HOT MIX ASPHALT (MISCELLANEOUS AREA)	M2	320	40. <sup>00</sup>	12,800. <sup>00</sup>
66	397005	TACK COAT	TONN	38	1,400. <sup>00</sup>	53,200. <sup>00</sup>
67	401066	CONCRETE PAVEMENT (EXIT RAMP TERMINI) [JOINTED PLAIN CONCRETE PAVEMENT]	M3	430	275. <sup>00</sup>	118,250. <sup>00</sup>
68	401108	RAPID STRENGTH CONCRETE [JOINTED PLAIN CONCRETE PAVEMENT]	M3	3,780	205. <sup>00</sup>	774,900. <sup>00</sup>
69	000003	SEAL ISOLATION JOINT	M	1,280	4. <sup>00</sup>	5,120. <sup>00</sup>
70	414091	SEAL LONGITUDINAL JOINT	M	2,140	4. <sup>00</sup>	8,560. <sup>00</sup>
71	414101	SEAL TRANSVERSE JOINT	M	2,120	4. <sup>00</sup>	8,480. <sup>00</sup>
72	518201	MASONRY STONE WALL	M2	23	800. <sup>00</sup>	18,400. <sup>00</sup>
73 (F)	510129	CLASS 2 CONCRETE (BOX CULVERT)	M3	190	1,000. <sup>00</sup>	190,000. <sup>00</sup>
74 (F)	510502	MINOR CONCRETE (MINOR STRUCTURE)	M3	110	2,000. <sup>00</sup>	220,000. <sup>00</sup>
75 (F)	520107	BAR REINFORCING STEEL (BOX CULVERT)	KG	21,271	2. <sup>00</sup>	42,542. <sup>00</sup>
76 (F)	560218	FURNISH SIGN STRUCTURE (TRUSS)	KG	30,000	9. <sup>00</sup>	270,000. <sup>00</sup>
77 (F)	560219	INSTALL SIGN STRUCTURE (TRUSS)	KG	30,000	1. <sup>00</sup>	30,000. <sup>00</sup>
78	560234	FURNISH LAMINATED PANEL SIGN (25.4 MM -TYPE A)	M2	67	250. <sup>00</sup>	16,750. <sup>00</sup>
79	560238	FURNISH SINGLE SHEET ALUMINUM SIGN (1.6 MM-UNFRAMED)	M2	56	125. <sup>00</sup>	7,000. <sup>00</sup>
80	560239	FURNISH SINGLE SHEET ALUMINUM SIGN (2.0 MM-UNFRAMED)	M2	30	140. <sup>00</sup>	4,200. <sup>00</sup>
81	560241	FURNISH SINGLE SHEET ALUMINUM SIGN (1.6 MM- FRAMED)	M2	13	135. <sup>00</sup>	1,755. <sup>00</sup>
82	560242	FURNISH SINGLE SHEET ALUMINUM SIGN (2.0 MM- FRAMED)	M2	71	150. <sup>00</sup>	10,650. <sup>00</sup>
83	561015	1524 MM CAST-IN-DRILLED-HOLE CONCRETE PILE (SIGN FOUNDATION)	M	23	4,000. <sup>00</sup>	92,000. <sup>00</sup>
84	566011	ROADSIDE SIGN - ONE POST	EA	85	350. <sup>00</sup>	29,750. <sup>00</sup>
85	566012	ROADSIDE SIGN - TWO POST	EA	17	575. <sup>00</sup>	9,775. <sup>00</sup>
86	568001	INSTALL SIGN (STRAP AND SADDLE BRACKET METHOD)	EA	8	350. <sup>00</sup>	2,800. <sup>00</sup>
87	568015	INSTALL SIGN (MAST-ARM HANGER METHOD)	EA	22	375. <sup>00</sup>	8,250. <sup>00</sup>
88	620909	450 MM ALTERNATIVE PIPE CULVERT	M	71	160. <sup>00</sup>	11,360. <sup>00</sup>
89	620913	600 MM ALTERNATIVE PIPE CULVERT	M	230	170. <sup>00</sup>	39,100. <sup>00</sup>
90	620924	900 MM ALTERNATIVE PIPE CULVERT	M	120	180. <sup>00</sup>	21,600. <sup>00</sup>

INDIAN CANYON DRIVE AT INTERSTATE 10  
 RECONSTRUCTION OF INTERCHANGE  
 PROJECT No. A8-0372  
 FEDERAL AID No. ESPLHPLU-5282(034) and HP21L-5282(035)

PROPOSAL (Revised)

ITEM No.	ITEM CODE	ITEM	UNIT	ESTIMATED QUANTITY	ITEM PRICE	TOTAL (IN FIGURES)
91	664097	600 MM BITUMINOUS COATED CORRUGATED STEEL PIPE (2.77 MM THICK)	M	200	200. <sup>00</sup>	40,000. <sup>00</sup>
92	664110	900 MM BITUMINOUS COATED CORRUGATED STEEL PIPE (2.77 MM THICK)	M	50	225. <sup>00</sup>	11,250. <sup>00</sup>
93	717072	100 MM POLYVINYL CHLORIDE SEWER PIPE	M	37	50. <sup>00</sup>	1,850. <sup>00</sup>
94	721008	ROCK SLOPE PROTECTION (LIGHT, METHOD B)	M3	140	160. <sup>00</sup>	22,400. <sup>00</sup>
95	721430	CONCRETE (CHANNEL LINING)	M3	73	500. <sup>00</sup>	36,500. <sup>00</sup>
96	729010	ROCK SLOPE PROTECTION FABRIC	M2	330	25. <sup>00</sup>	8,250. <sup>00</sup>
97 (F)	731504	MINOR CONCRETE (CURB AND GUTTER)	M3	250	775. <sup>00</sup>	193,750. <sup>00</sup>
98 (F)	000003	MINOR CONCRETE (COLORED)	M2	1,890	120. <sup>00</sup>	226,800. <sup>00</sup>
99 (F)	731521	MINOR CONCRETE (SIDEWALK)	M3	260	525. <sup>00</sup>	136,500. <sup>00</sup>
100 (F)	731530	MINOR CONCRETE (TEXTURED PAVING)	M2	1,190	125. <sup>00</sup>	148,750. <sup>00</sup>
101 (F)	750001	MISCELLANEOUS IRON AND STEEL	KG	1,262	10. <sup>00</sup>	12,620. <sup>00</sup>
102	800391	CHAIN LINK FENCE (TYPE CL-1.8)	M	940	65. <sup>00</sup>	61,100. <sup>00</sup>
103	820105	DELINEATOR (SPECIAL)	EA	23	60. <sup>00</sup>	1,380. <sup>00</sup>
104	820107	DELINEATOR (CLASS 1)	EA	160	50. <sup>00</sup>	8,000. <sup>00</sup>
105	832003	METAL BEAM GUARD RAILING (WOOD POST)	M	670	99. <sup>00</sup>	66,330. <sup>00</sup>
106	839541	TRANSITION RAILING (TYPE WB)	EA	4	6,000. <sup>00</sup>	24,000. <sup>00</sup>
107	839568	TERMINAL ANCHOR ASSEMBLY (TYPE SFT)	EA	5	900. <sup>00</sup>	4,500. <sup>00</sup>
108	839585	ALTERNATIVE FLARED TERMINAL SYSTEM [TYPE SRT]	EA	9	3,500. <sup>00</sup>	31,500. <sup>00</sup>
109	839605	CRASH CUSHION (REACT 9SCBS)	EA	3	75,000. <sup>00</sup>	225,000. <sup>00</sup>
110	839703	CONCRETE BARRIER (TYPE 60C)	M	270	525. <sup>00</sup>	141,750. <sup>00</sup>
111	839705	CONCRETE BARRIER (TYPE 60E)	M	89	515. <sup>00</sup>	45,835. <sup>00</sup>
112	840515	THERMOPLASTIC PAVEMENT MARKING	M2	360	40. <sup>00</sup>	14,400. <sup>00</sup>
113	840563	200 MM THERMOPLASTIC TRAFFIC STRIPE	M	1,210	3. <sup>00</sup>	3,630. <sup>00</sup>
114	840571	100 MM THERMOPLASTIC TRAFFIC STRIPE (BROKEN 5.18 M - 2.14 M)	M	9,600	2. <sup>25</sup>	21,600. <sup>00</sup>
115	840656	PAINT TRAFFIC STRIPE (2-COAT)	M	13,100	1. <sup>25</sup>	16,375. <sup>00</sup>
116	850101	PAVEMENT MARKER (NON-REFLECTIVE)	EA	15,300	2. <sup>10</sup>	32,130. <sup>00</sup>
117	850110	PAVEMENT MARKER (RETROREFLECTIVE-SPECIAL TYPE C)	EA	86	5. <sup>00</sup>	430. <sup>00</sup>
118	850111	PAVEMENT MARKER (RETROREFLECTIVE -SPECIAL TYPE D)	EA	790	5. <sup>00</sup>	3,950. <sup>00</sup>
119	850112	PAVEMENT MARKER (RETROREFLECTIVE-SPECIAL TYPE G)	EA	2,790	5. <sup>00</sup>	13,950. <sup>00</sup>
120	850113	PAVEMENT MARKER (RETROREFLECTIVE-SPECIAL TYPE H)	EA	450	5. <sup>00</sup>	2,250. <sup>00</sup>

INDIAN CANYON DRIVE AT INTERSTATE 10  
 RECONSTRUCTION OF INTERCHANGE  
 PROJECT No. A8-0372  
 FEDERAL AID No. ESPLHPLU-5282(034) and HP21L-5282(035)

**PROPOSAL (Revised)**

ITEM No.	ITEM CODE	ITEM	UNIT	ESTIMATED QUANTITY	ITEM PRICE	TOTAL (IN FIGURES)
121	860251	SIGNAL AND LIGHTING (LOCATION 1)	LS	1	210,000. <sup>00</sup>	210,000. <sup>00</sup>
122	860252	SIGNAL AND LIGHTING (LOCATION 2)	LS	1	195,000. <sup>00</sup>	195,000. <sup>00</sup>
123	860300	SIGNAL AND LIGHTING (CITY STREET LOCATION 1)	LS	1	235,000. <sup>00</sup>	235,000. <sup>00</sup>
124	860302	SIGNAL AND LIGHTING (CITY STREET LOCATION 2)	LS	1	250,000. <sup>00</sup>	250,000. <sup>00</sup>
125	860460	LIGHTING AND SIGN ILLUMINATION	LS	1	590,000. <sup>00</sup>	590,000. <sup>00</sup>
126	860701	INTERCONNECTION CONDUIT AND CONDUCTOR	LS	1	160,000. <sup>00</sup>	160,000. <sup>00</sup>
127	861101	RAMP METERING SYSTEM (LOCATION 1)	LS	1	130,000. <sup>00</sup>	130,000. <sup>00</sup>
128	861102	RAMP METERING SYSTEM (LOCATION 2)	LS	1	140,000. <sup>00</sup>	140,000. <sup>00</sup>
129	861103	RAMP METERING SYSTEM (LOCATION 3)	LS	1	120,000. <sup>00</sup>	120,000. <sup>00</sup>
130	861104	RAMP METERING SYSTEM (LOCATION 4)	LS	1	130,000. <sup>00</sup>	130,000. <sup>00</sup>
131	861349	REMOVE EXISTING SIGNAL SYSTEM ( LOCATION 1)	LS	1	80,000. <sup>00</sup>	80,000. <sup>00</sup>
132	861350	REMOVE EXISTING SIGNAL SYSTEM ( LOCATION 2)	LS	1	80,000. <sup>00</sup>	80,000. <sup>00</sup>
133	999990	MOBILIZATION	LS	1	834,000. <sup>00</sup>	834,000. <sup>00</sup>
134	000003	COURSE OF CONSTRUCTION INSURANCE	LS	1	8,000. <sup>00</sup>	8,000. <sup>00</sup>
135	019901	DEMOBILIZATION	LS	1	500. <sup>00</sup>	500. <sup>00</sup>
136	066102	DUST ABATEMENT	LS	1	45,000. <sup>00</sup>	45,000. <sup>00</sup>
137	066105	RESIDENT ENGINEER OFFICE	LS	1	25,000. <sup>00</sup>	25,000. <sup>00</sup>
138	066840	TRAFFIC SIGNAL CONTROLLER ASSEMBLY [WITH BATTERY BACK-UP] [ 2-LOCATIONS]	LS	1	13,600.00	13,600.00
139	066843	MODEL 170 CONTROLLER ASSEMBLY [RAMP METER] [ 4-LOCATIONS]	LS	1	19,200.00	19,200.00
140	066015	FEDERAL TRAINEE PROGRAM	LS	1	5,000. <sup>00</sup>	5,000. <sup>00</sup>
141	047403	610 MM STEEL PIPE CASING	M	26	1,000. <sup>00</sup>	<del>26,000.</del> - 26,000. <sup>00</sup>
142	157550	BRIDGE REMOVAL	LS	1	85,000. <sup>00</sup>	85,000. <sup>00</sup>
143 (F)	192003	STRUCTURE EXCAVATION (BRIDGE)	M3	1,150	90. <sup>00</sup>	103,500. <sup>00</sup>
144 (F)	193003	STRUCTURE BACKFILL (BRIDGE)	M3	490	125. <sup>00</sup>	61,250. <sup>00</sup>
145	490566	FURNISH STEEL PILING (HP 360 X 132)	M	<del>2,377</del> 2,377	165. <sup>00</sup>	491,205. <sup>00</sup>
146	490567	DRIVE STEEL PILE (HP 360 X 132)	EA	196	1,525. <sup>00</sup>	298,900. <sup>00</sup>
147	-----	ITEM DELETED BY ADDENDUM	-----	-----	-----	-----
148	-----	ITEM DELETED BY ADDENDUM	-----	-----	-----	-----
149	500020	PRESTRESSING PRECAST GIRDER	LS	1	95,000. <sup>00</sup>	95,000. <sup>00</sup>
150 (F)	510051	STRUCTURAL CONCRETE, BRIDGE FOOTING	M3	220	425. <sup>00</sup>	93,500. <sup>00</sup>

INDIAN CANYON DRIVE AT INTERSTATE 10  
RECONSTRUCTION OF INTERCHANGE  
PROJECT No. A8-0372  
FEDERAL AID No. ESPLHPLU-5282(034) and HP21L-5282(035)

**PROPOSAL (Revised)**

ITEM No.	ITEM CODE	ITEM	UNIT	ESTIMATED QUANTITY	ITEM PRICE	TOTAL (IN FIGURES)
151 (F)	510053	STRUCTURAL CONCRETE, BRIDGE	M3	1,710	870. <sup>00</sup>	1,487,700. <sup>00</sup>
152 (F)	510086	STRUCTURAL CONCRETE, APPROACH SLAB (TYPE N)	M3	210	650. <sup>00</sup>	136,500. <sup>00</sup>
153	511036	ARCHITECTURAL SURFACE [LAVA ROCK FACING]	M2	170	250. <sup>00</sup>	42,500. <sup>00</sup>
154 (F)	511063	FRACTURED FIN TEXTURE	M2	140	130. <sup>00</sup>	18,200. <sup>00</sup>
155	512254	FURNISH PRECAST PRESTRESSED CONCRETE BULB-TEE GIRDER (25 M-30 M)	EA	26	20,000. <sup>00</sup>	520,000. <sup>00</sup>
156	512255	FURNISH PRECAST PRESTRESSED CONCRETE BULB-TEE GIRDER (30 M-35 M)	EA	13	24,000. <sup>00</sup>	312,000. <sup>00</sup>
157	512500	ERECT PRECAST PRESTRESSED CONCRETE GIRDER	EA	39	2,200. <sup>00</sup>	85,800. <sup>00</sup>
158	519123	JOINT SEAL (TYPE B - MR 50 MM)	M	72	300. <sup>00</sup>	21,600. <sup>00</sup>
159 (F)	520102	BAR REINFORCING STEEL (BRIDGE)	KG	244,000	2. <sup>00</sup>	488,000. <sup>00</sup>
160 (F)	721810	SLOPE PAVING (CONCRETE)	M3	72	1,360. <sup>00</sup>	97,920. <sup>00</sup>
161 (F)	750505	BRIDGE DECK DRAINAGE SYSTEM	KG	470	22. <sup>50</sup>	10,575. <sup>00</sup>
162 (F)	833088	TUBULAR HANDRAILING	M	10	240. <sup>00</sup>	2,400. <sup>00</sup>
163 (F)	833142	CONCRETE BARRIER (TYPE 26 MODIFIED)	M	110	690. <sup>00</sup>	75,900. <sup>00</sup>
164	839727	CONCRETE BARRIER (TYPE 736 MODIFIED)	M	110	420. <sup>00</sup>	46,200. <sup>00</sup>
165 (F)	833020	CHAIN LINK RAILING [MINI MESH]	M	91	1,250. <sup>00</sup>	113,750. <sup>00</sup>

PROJECT SUBTOTAL Sixteen million five hundred ten thousand seven hundred thirty seven 16,510,737.<sup>00</sup>  
ITEMS 1-165 dollars and zero cents "WORDS"

## ALTERNATE BID:

## THE MISSION SPRINGS WATER DISTRICT

166	0000003	ADJUST WATER VALVE COVER TO GRADE	EA	14	1,100. <sup>00</sup>	15,400. <sup>00</sup>
-----	---------	-----------------------------------	----	----	----------------------	-----------------------

PROJECT SUBTOTAL Fifteen Thousand four hundred dollars and zero cents 15,400.<sup>00</sup>  
ITEMS 166 "WORDS"

PROJECT TOTAL Sixteen million five hundred twenty six thousand one hundred 16,526,137.<sup>00</sup>  
ITEMS 1-166 thirty seven dollars and zero cents "WORDS"

Accompanying this Bid is a certified check, cashier check or bid bond in an amount equal to at least 10 percent of the total bid.

The names of all persons interested in the foregoing Bid as principals are as follows:

**IMPORTANT NOTICE** If bidder or other interested person is a corporation, state legal name of corporation, also names of the president, secretary, treasurer and manager thereof; if a co-partnership, state true name of firm, also names of all individual co-partners composing firm; if bidder or other interested person is an individual, state first and last names in full.

**TRUE NAME OF BIDDER:**

GRANITE CONSTRUCTION COMPANY - ( a California corporation ) 01/04/1922  
William G. Dorey, President; Michael Futch, Secretary; Jigisha Desai, Treasurer  
Pat Kelly, Regional Manager; Mark Chalfa, Area Construction Manager

By my signature on this Bid I certify, under penalty of perjury under the laws of the State of California, that the foregoing questionnaire and statements are true and correct and that the bidder has complied with the requirements of Section 8103 of the Fair Employment and Housing Commission Regulations (Chapter 5, Title 2 of the California Administrative Code). By my signature on this Bid I further certify, under penalty of perjury under the laws of State of California and the United States of America, that the Title 23 United States Code, Section 112 Non-Collusion Affidavit and Title 49 code of Federal Regulations, Part 29 Debarment and Suspension Certification are true and correct.

Date: April 28, 2010 Jigisha Desai, Vice President  
PRINT NAME AND TITLE

\*SEE ATTACHED CERTIFICATE  
OF SECRETARY...

  
Signature of Bidder  
Jigisha Desai  
Vice President, GRANITE CONSTRUCTION COMPANY  
TITLE

\* If the bidder is a corporation, attach the Corporate Resolution which authorizes the signatory to represent the Corporation)

NAME OF BIDDER GRANITE CONSTRUCTION COMPANY  
BUSINESS P.O. BOX P.O. Box 50085  
CITY, STATE, ZIP Watsonville, CA 95077-5085  
BUSINESS STREET ADDRESS 585 W. Beach Street  
*(Please include even if P.O. Box used)*  
CITY, STATE, ZIP Watsonville, CA 95076  
TELEPHONE NO: AREA CODE ( 831 ) 724-1011  
FAX NO: AREA CODE ( 831 ) 768-4021  
ELECTRONIC MAIL: \_\_\_\_\_  
CONTRACTOR LICENSE NO. 89  
EXPIRATION DATE: May 31, 2011  
LICENSE CLASSIFICATIONS: A, B, C, (copy enclosed)

SUBCONTRACTORS :

The undersigned bidder herewith sets forth the name and location of the place of business of each subcontractor who will perform work or labor or render service to the general Contractor in or about the construction of the work or improvement in an amount in excess of one-half (1/2) of the one percent (1%) of the general Contractor's total bid or \$10,000 whichever is greater, and the portion of the work which will be done by each subcontractor as follows:

Subcontractor's Name	License No.	Place of Business	Description of Work
<u>Innovative</u>	<u>720938</u>	<u>Quartz Hill, CA</u>	<u>Minor Concrete Items 97-100</u>
<u>Statewide</u>	<u>523594</u>	<u>Poway, CA</u>	<u>Signs</u>
<u>Ranch Rock Corporation</u>	<u>923649</u>	<u>Corona, CA</u>	<u>Striping &amp; Markings</u>
<u>Coral Construction</u>	<u>332441A</u>	<u>Riverside, CA</u>	<u>Signs - Large</u>
<u>Schwager Davis Inc.</u>	<u>492582</u>	<u>San Jose, CA</u>	<u>Stressing</u>
<u>Pomeroy</u>	<u>929340</u>	<u>Perris, CA</u>	<u>Precast Girders</u>
<u>West Coast / Tipped (TV)</u>	<u>940884</u>	<u>Pleasant Hill, CA</u>	<u>Piling</u>
<u>Marina Landscape</u>	<u>492862</u>	<u>Anaheim, CA</u>	<u>Erosion Control</u>
<u>Miller Environmental</u>	<u>772797</u>	<u>Anaheim, CA</u>	<u>Bridge Demo</u>
<u>Lincok Pacific</u>	<u>828467</u>	<u>Baldwin Park, CA</u>	<u>Electrical</u>
<u>Crown Fence</u>	<u>1315</u>	<u>Corona, CA</u>	<u>Fence</u>
<u>United Steel Pieces</u>	<u>738904</u>	<u>Rancho Cucamonga, CA</u>	<u>Rebar</u>
<u>Our Valley Fence</u>	<u>892954</u>	<u>Ridgecrest, CA</u>	<u>MBGR</u>

Percent of work to be performed by sub-contractors: 27.4 %  
 (Note: 50% of work required to be performed by general contractor)

TITLE 49, CODE OF FEDERAL REGULATIONS, PART 29

DEBARMENT AND SUSPENSION CERTIFICATION

The bidder, under penalty of perjury, certifies that, except as noted below, he/she or any person associated therewith in the capacity of owner, partner, director, officer, manager:

is not currently under suspension, debarment, voluntary exclusion, or determination of ineligibility by any federal agency;

has not been suspended, debarred, voluntarily excluded or determined ineligible by any Federal agency within the past 3 years;

does not have a proposed debarment pending; and

has not been indicted, convicted, or had a civil judgment rendered against it by a court of competent jurisdiction in any matter involving fraud or official misconduct within the past 3 years.

If there are any exceptions to this certification, insert the exceptions in the following space.

No Exceptions.

Exceptions will not necessarily result in denial of award, but will be considered in determining bidder responsibility. For any exception noted above, indicate below to whom it applies, initiating agency, and dates of action.

Note: Providing false information may result in criminal prosecution or administrative sanctions.

The above certification is part of the Bid. Signing this Bid on the signature portion thereof shall also constitute signature of this Certification.



DECLARATION

The bidder hereby declares under penalty of perjury that the bidder has \_\_\_\_\_, has not X been convicted within the preceding three years by a court of competent jurisdiction of any charge of fraud, bribery, collusion, conspiracy, or any other act in violation of any state or federal antitrust law in connection with the bidding upon, award of, or performance of, any public works contract, as defined in Public Contract Code Section 1101, with any public entity, as defined in Public Contract Code Section 1100.

The term "bidder" is understood to include any partner, member, officer, director, responsible managing officer, or responsible managing employee thereof.

Note:

The bidder must place a check mark after "has" or "has not" in one of the blank spaces provided.

The above Statement is part of the Bid. Signing this Bid on the signature portion thereof shall also constitute signature of this Statement.

Bidders are cautioned that making a false certification may subject the certifier to criminal prosecution.

## QUESTIONNAIRE

The Bidder shall complete, under penalty of perjury, the following questionnaire:

Has the bidder, any officer of the bidder, or any employee of the bidder who has a proprietary interest in the bidder, ever been disqualified, removed, or otherwise prevented from bidding on, or completing a Federal, State, or local government project because of a violation of law or a safety regulation?

Yes \_\_\_\_\_ No   x  

If the answer is yes, explain circumstances on a separate page.

## COMPLIANCE WITH ORDERS OF NATIONAL LABOR RELATIONS BOARD STATEMENT

The Contractor, hereby states under penalty of perjury, that no more than one final unappealable finding of contempt of court by a Federal court has been issued against the Contractor within the immediately preceding two year period because of the Contractor's failure to comply with an order of a Federal court which orders the Contractor to comply with an order of the National Labor Relations Board.

## NON-COLLUSION AFFIDAVIT

In accordance with Public Contract Code Section 7106, the bidder shall execute the Non-Collusion Affidavit that is a part of this Bid, as appropriate for the bidder's business category.

EQUAL EMPLOYMENT OPPORTUNITY CERTIFICATION

The bidder   X  , proposed subcontractor \_\_\_\_\_, hereby certifies that he has   X  , has not \_\_\_\_\_, participated in a previous contract or subcontract subject to the equal opportunity clause, as required by Executive Orders 10925, 11114, or 11246, and that, where required, he has filed with the Joint Reporting Committee, the Director of the Office of Federal Contract Compliance, a Federal Government contracting or administering agency, or the former President's Committee on Equal Employment Opportunity, all reports due under the applicable filing requirement.

GRANITE CONSTRUCTION COMPANY

(Company)

By: \_\_\_\_\_

*Janisha Desai*  
Janisha Desai

Vice President

(Title)

Date:   April 28, 2010  

NOTE:

The above certification is required by the Equal Employment Opportunity Regulations of the Secretary of Labor (41 CFR 60-1.7(b) (1), and must be submitted by bidders and proposed subcontractors only in connection with contracts and subcontracts which are subject to the equal opportunity clause. Contracts and subcontracts which are exempt from the equal opportunity clause are set forth in 41 CFR 60-1.5. (Generally only contracts or subcontracts of \$10,000 or under are exempt.)

Currently, Standard Form 100 (EEO-1) is the only report required by the Executive Orders or their implementing regulations.

Proposed prime contractors and subcontractors who have participated in a previous contract or subcontract subject to the Executive Orders and have not filed the required reports should note that 41 CFR 60-1.7(b) (1) prevents the award of contracts and subcontracts unless such contractor submits a report covering the delinquent period or such other period specified by the Federal Highway Administration or by the Director, Office of Federal Contract Compliance, U.S. Department of Labor.

EQUAL EMPLOYMENT OPPORTUNITY CERTIFICATION

The bidder \_\_\_\_\_, proposed subcontractor X, hereby certifies that he has X, has not \_\_\_\_\_, participated in a previous contract or subcontract subject to the equal opportunity clause, as required by Executive Orders 10925, 11114, or 11246, and that, where required, he has filed with the Joint Reporting Committee, the Director of the Office of Federal Contract Compliance, a Federal Government contracting or administering agency, or the former President's Committee on Equal Employment Opportunity, all reports due under the applicable filing requirement.

Innovative  
(Company)

By: Steve Timm via fax

Estimator  
(Title)

Date: 4-28-10

NOTE:

The above certification is required by the Equal Employment Opportunity Regulations of the Secretary of Labor (41 CFP 60-1.7(b) (1), and must be submitted by bidders and proposed subcontractors only in connection with contracts and subcontracts which are subject to the equal opportunity clause. Contracts and subcontracts which are exempt from the equal opportunity clause are set forth in 41 CFR 60-1.5. (Generally only contracts or subcontracts of \$10,000 or under are exempt.)

Currently, Standard Form 100 (EEO-1) is the only report required by the Executive Orders or their implementing regulations.

Proposed prime contractors and subcontractors who have participated in a previous contract or subcontract subject to the Executive Orders and have not filed the required reports should note that 41 CFR 60-1.7(b) (1) prevents the award of contracts and subcontracts unless such contractor submits a report covering the delinquent period or such other period specified by the Federal Highway Administration or by the Director, Office of Federal Contract Compliance, U.S. Department of Labor.

Make

EQUAL EMPLOYMENT OPPORTUNITY CERTIFICATION

The bidder \_\_\_\_\_, proposed subcontractor X, hereby certifies that he has X, has not \_\_\_\_\_, participated in a previous contract or subcontract subject to the equal opportunity clause, as required by Executive Orders 10925, 11114, or 11246, and that, where required, he has filed with the Joint Reporting Committee, the Director of the Office of Federal Contract Compliance, a Federal Government contracting or administering agency, or the former President's Committee on Equal Employment Opportunity, all reports due under the applicable filing requirement.

Statewide

(Company)

By: Dave Nicholas via Fax

Estimator

(Title)

Date: 4-28-10

NOTE:

The above certification is required by the Equal Employment Opportunity Regulations of the Secretary of Labor (41 CFR 60-1.7(b) (1), and must be submitted by bidders and proposed subcontractors only in connection with contracts and subcontracts which are subject to the equal opportunity clause. Contracts and subcontracts which are exempt from the equal opportunity clause are set forth in 41 CFR 60-1.5. (Generally only contracts or subcontracts of \$10,000 or under are exempt.)

Currently, Standard Form 100 (EEO-1) is the only report required by the Executive Orders or their implementing regulations.

Proposed prime contractors and subcontractors who have participated in a previous contract or subcontract subject to the Executive Orders and have not filed the required reports should note that 41 CFR 60-1.7(b) (1) prevents the award of contracts and subcontracts unless such contractor submits a report covering the delinquent period or such other period specified by the Federal Highway Administration or by the Director, Office of Federal Contract Compliance, U.S. Department of Labor.

Mako

EQUAL EMPLOYMENT OPPORTUNITY CERTIFICATION

The bidder \_\_\_\_\_, proposed subcontractor X, hereby certifies that he has X, has not \_\_\_\_\_, participated in a previous contract or subcontract subject to the equal opportunity clause, as required by Executive Orders 10925, 11114, or 11246, and that, where required, he has filed with the Joint Reporting Committee, the Director of the Office of Federal Contract Compliance, a Federal Government contracting or administering agency, or the former President's Committee on Equal Employment Opportunity, all reports due under the applicable filing requirement.

Ranch Rock Corporation  
(Company)

By: Jason Hannah  
Mark Robertson via fax

Estimator  
(Title)

Date: 4-28-10

NOTE:

The above certification is required by the Equal Employment Opportunity Regulations of the Secretary of Labor (41 CFP 60-1.7(b) (1), and must be submitted by bidders and proposed subcontractors only in connection with contracts and subcontracts which are subject to the equal opportunity clause. Contracts and subcontracts which are exempt from the equal opportunity clause are set forth in 41 CFR 60-1.5. (Generally only contracts or subcontracts of \$10,000 or under are exempt.)

Currently, Standard Form 100 (EEO-1) is the only report required by the Executive Orders or their implementing regulations.

Proposed prime contractors and subcontractors who have participated in a previous contract or subcontract subject to the Executive Orders and have not filed the required reports should note that 41 CFR 60-1.7(b) (1) prevents the award of contracts and subcontracts unless such contractor submits a report covering the delinquent period or such other period specified by the Federal Highway Administration or by the Director, Office of Federal Contract Compliance, U.S. Department of Labor.

Mako

EQUAL EMPLOYMENT OPPORTUNITY CERTIFICATION

The bidder \_\_\_\_\_, proposed subcontractor X, hereby certifies that he has X, has not \_\_\_\_\_, participated in a previous contract or subcontract subject to the equal opportunity clause, as required by Executive Orders 10925, 11114, or 11246, and that, where required, he has filed with the Joint Reporting Committee, the Director of the Office of Federal Contract Compliance, a Federal Government contracting or administering agency, or the former President's Committee on Equal Employment Opportunity, all reports due under the applicable filing requirement.

Coral Construction

(Company)

By: Mark Roberts via fax

Estimator

(Title)

Date: 4-28-10

NOTE:

The above certification is required by the Equal Employment Opportunity Regulations of the Secretary of Labor (41 CFR 60-1.7(b) (1), and must be submitted by bidders and proposed subcontractors only in connection with contracts and subcontracts which are subject to the equal opportunity clause. Contracts and subcontracts which are exempt from the equal opportunity clause are set forth in 41 CFR 60-1.5. (Generally only contracts or subcontracts of \$10,000 or under are exempt.)

Currently, Standard Form 100 (EEO-1) is the only report required by the Executive Orders or their implementing regulations.

Proposed prime contractors and subcontractors who have participated in a previous contract or subcontract subject to the Executive Orders and have not filed the required reports should note that 41 CFR 60-1.7(b) (1) prevents the award of contracts and subcontracts unless such contractor submits a report covering the delinquent period or such other period specified by the Federal Highway Administration or by the Director, Office of Federal Contract Compliance, U.S. Department of Labor.

Mark

EQUAL EMPLOYMENT OPPORTUNITY CERTIFICATION

The bidder \_\_\_\_\_, proposed subcontractor X, hereby certifies that he has X, has not \_\_\_\_\_, participated in a previous contract or subcontract subject to the equal opportunity clause, as required by Executive Orders 10925, 11114, or 11246, and that, where required, he has filed with the Joint Reporting Committee, the Director of the Office of Federal Contract Compliance, a Federal Government contracting or administering agency, or the former President's Committee on Equal Employment Opportunity, all reports due under the applicable filing requirement.

Schwager Davis Inc.  
(Company)

By: Michael Williams via fax

QA and Safety Manager  
(Title)

Date: 4-28-10

NOTE:

The above certification is required by the Equal Employment Opportunity Regulations of the Secretary of Labor (41 CFP 60-1.7(b) (1), and must be submitted by bidders and proposed subcontractors only in connection with contracts and subcontracts which are subject to the equal opportunity clause. Contracts and subcontracts which are exempt from the equal opportunity clause are set forth in 41 CFR 60-1.5. (Generally only contracts or subcontracts of \$10,000 or under are exempt.)

Currently, Standard Form 100 (EEO-1) is the only report required by the Executive Orders or their implementing regulations.

Proposed prime contractors and subcontractors who have participated in a previous contract or subcontract subject to the Executive Orders and have not filed the required reports should note that 41 CFR 60-1.7(b) (1) prevents the award of contracts and subcontracts unless such contractor submits a report covering the delinquent period or such other period specified by the Federal Highway Administration or by the Director, Office of Federal Contract Compliance, U.S. Department of Labor.

Make



EQUAL EMPLOYMENT OPPORTUNITY CERTIFICATION

The bidder \_\_\_\_\_, proposed subcontractor X, hereby certifies that he has P, has not \_\_\_\_\_, participated in a previous contract or subcontract subject to the equal opportunity clause, as required by Executive Orders 10925, 11114, or 11246, and that, where required, he has filed with the Joint Reporting Committee, the Director of the Office of Federal Contract Compliance, a Federal Government contracting or administering agency, or the former President's Committee on Equal Employment Opportunity, all reports due under the applicable filing requirement.

Pomeroy  
\_\_\_\_\_  
(Company)

By: John Grafton via fax  
\_\_\_\_\_

Estimator  
\_\_\_\_\_  
(Title)

Date: 4-28-10  
\_\_\_\_\_

NOTE:

The above certification is required by the Equal Employment Opportunity Regulations of the Secretary of Labor (41 CFP 60-1.7(b) (1), and must be submitted by bidders and proposed subcontractors only in connection with contracts and subcontracts which are subject to the equal opportunity clause. Contracts and subcontracts which are exempt from the equal opportunity clause are set forth in 41 CFR 60-1.5. (Generally only contracts or subcontracts of \$10,000 or under are exempt.)

Currently, Standard Form 100 (EEO-1) is the only report required by the Executive Orders or their implementing regulations.

Proposed prime contractors and subcontractors who have participated in a previous contract or subcontract subject to the Executive Orders and have not filed the required reports should note that 41 CFR 60-1.7(b) (1) prevents the award of contracts and subcontracts unless such contractor submits a report covering the delinquent period or such other period specified by the Federal Highway Administration or by the Director, Office of Federal Contract Compliance, U.S. Department of Labor.

Make

EQUAL EMPLOYMENT OPPORTUNITY CERTIFICATION

The bidder \_\_\_\_\_, proposed subcontractor X, hereby certifies that he has X, has not \_\_\_\_\_, participated in a previous contract or subcontract subject to the equal opportunity clause, as required by Executive Orders 10925, 11114, or 11246, and that, where required, he has filed with the Joint Reporting Committee, the Director of the Office of Federal Contract Compliance, a Federal Government contracting or administering agency, or the former President's Committee on Equal Employment Opportunity, all reports due under the applicable filing requirement.

West Coast (Tipco JV)  
(Company)

By: Anthony Will via fax

Estimator  
(Title)

Date: 4-28-10

NOTE:

The above certification is required by the Equal Employment Opportunity Regulations of the Secretary of Labor (41 CFP 60-1.7(b) (1), and must be submitted by bidders and proposed subcontractors only in connection with contracts and subcontracts which are subject to the equal opportunity clause. Contracts and subcontracts which are exempt from the equal opportunity clause are set forth in 41 CFR 60-1.5. (Generally only contracts or subcontracts of \$10,000 or under are exempt.)

Currently, Standard Form 100 (EEO-1) is the only report required by the Executive Orders or their implementing regulations.

Proposed prime contractors and subcontractors who have participated in a previous contract or subcontract subject to the Executive Orders and have not filed the required reports should note that 41 CFR 60-1.7(b) (1) prevents the award of contracts and subcontracts unless such contractor submits a report covering the delinquent period or such other period specified by the Federal Highway Administration or by the Director, Office of Federal Contract Compliance, U.S. Department of Labor.

Make

EQUAL EMPLOYMENT OPPORTUNITY CERTIFICATION

The bidder \_\_\_\_\_, proposed subcontractor X, hereby certifies that he has ✓, has not \_\_\_\_\_, participated in a previous contract or subcontract subject to the equal opportunity clause, as required by Executive Orders 10925, 11114, or 11246, and that, where required, he has filed with the Joint Reporting Committee, the Director of the Office of Federal Contract Compliance, a Federal Government contracting or administering agency, or the former President's Committee on Equal Employment Opportunity, all reports due under the applicable filing requirement.

Marina Landscape  
(Company)

By: Joseph Fuentes via Fax

Estimator  
(Title)

Date: 4-28-10

NOTE:

The above certification is required by the Equal Employment Opportunity Regulations of the Secretary of Labor (41 CFP 60-1.7(b) (1), and must be submitted by bidders and proposed subcontractors only in connection with contracts and subcontracts which are subject to the equal opportunity clause. Contracts and subcontracts which are exempt from the equal opportunity clause are set forth in 41 CFR 60-1.5. (Generally only contracts or subcontracts of \$10,000 or under are exempt.)

Currently, Standard Form 100 (EEO-1) is the only report required by the Executive Orders or their implementing regulations.

Proposed prime contractors and subcontractors who have participated in a previous contract or subcontract subject to the Executive Orders and have not filed the required reports should note that 41 CFR 60-1.7(b) (1) prevents the award of contracts and subcontracts unless such contractor submits a report covering the delinquent period or such other period specified by the Federal Highway Administration or by the Director, Office of Federal Contract Compliance, U.S. Department of Labor.

Mako

EQUAL EMPLOYMENT OPPORTUNITY CERTIFICATION

The bidder \_\_\_\_\_, proposed subcontractor X, hereby certifies that he has X, has not \_\_\_\_\_, participated in a previous contract or subcontract subject to the equal opportunity clause, as required by Executive Orders 10925, 11114, or 11246, and that, where required, he has filed with the Joint Reporting Committee, the Director of the Office of Federal Contract Compliance, a Federal Government contracting or administering agency, or the former President's Committee on Equal Employment Opportunity, all reports due under the applicable filing requirement.

Lincoln Pacific  
(Company)

By: John Wang via fax

Executive Vice President  
(Title)

Date: 4-28-10

NOTE:

The above certification is required by the Equal Employment Opportunity Regulations of the Secretary of Labor (41 CFP 60-1.7(b) (1), and must be submitted by bidders and proposed subcontractors only in connection with contracts and subcontracts which are subject to the equal opportunity clause. Contracts and subcontracts which are exempt from the equal opportunity clause are set forth in 41 CFR 60-1.5. (Generally only contracts or subcontracts of \$10,000 or under are exempt.)

Currently, Standard Form 100 (EEO-1) is the only report required by the Executive Orders or their implementing regulations.

Proposed prime contractors and subcontractors who have participated in a previous contract or subcontract subject to the Executive Orders and have not filed the required reports should note that 41 CFR 60-1.7(b) (1) prevents the award of contracts and subcontracts unless such contractor submits a report covering the delinquent period or such other period specified by the Federal Highway Administration or by the Director, Office of Federal Contract Compliance, U.S. Department of Labor.

Make

EQUAL EMPLOYMENT OPPORTUNITY CERTIFICATION

The bidder \_\_\_\_\_, proposed subcontractor X, hereby certifies that he has X, has not \_\_\_\_\_, participated in a previous contract or subcontract subject to the equal opportunity clause, as required by Executive Orders 10925, 11114, or 11246, and that, where required, he has filed with the Joint Reporting Committee, the Director of the Office of Federal Contract Compliance, a Federal Government contracting or administering agency, or the former President's Committee on Equal Employment Opportunity, all reports due under the applicable filing requirement.

Miller Environmental

(Company)

By: Rich Chavez via fax

Estimator

(Title)

Date: 4-28-10

NOTE:

The above certification is required by the Equal Employment Opportunity Regulations of the Secretary of Labor (41 CFP 60-1.7(b) (1), and must be submitted by bidders and proposed subcontractors only in connection with contracts and subcontracts which are subject to the equal opportunity clause. Contracts and subcontracts which are exempt from the equal opportunity clause are set forth in 41 CFR 60-1.5. (Generally only contracts or subcontracts of \$10,000 or under are exempt.)

Currently, Standard Form 100 (EEO-1) is the only report required by the Executive Orders or their implementing regulations.

Proposed prime contractors and subcontractors who have participated in a previous contract or subcontract subject to the Executive Orders and have not filed the required reports should note that 41 CFR 60-1.7(b) (1) prevents the award of contracts and subcontracts unless such contractor submits a report covering the delinquent period or such other period specified by the Federal Highway Administration or by the Director, Office of Federal Contract Compliance, U.S. Department of Labor.

Mako

EQUAL EMPLOYMENT OPPORTUNITY CERTIFICATION

The bidder \_\_\_\_\_, proposed subcontractor Y, hereby certifies that he has X, has not \_\_\_\_\_, participated in a previous contract or subcontract subject to the equal opportunity clause, as required by Executive Orders 10925, 11114, or 11246, and that, where required, he has filed with the Joint Reporting Committee, the Director of the Office of Federal Contract Compliance, a Federal Government contracting or administering agency, or the former President's Committee on Equal Employment Opportunity, all reports due under the applicable filing requirement.

Crown Fence  
(Company)

By: Mike Williams via fax

Estimator  
(Title)

Date: 4-28-10

NOTE:

The above certification is required by the Equal Employment Opportunity Regulations of the Secretary of Labor (41 CFP 60-1.7(b) (1), and must be submitted by bidders and proposed subcontractors only in connection with contracts and subcontracts which are subject to the equal opportunity clause. Contracts and subcontracts which are exempt from the equal opportunity clause are set forth in 41 CFR 60-1.5. (Generally only contracts or subcontracts of \$10,000 or under are exempt.)

Currently, Standard Form 100 (EEO-1) is the only report required by the Executive Orders or their implementing regulations.

Proposed prime contractors and subcontractors who have participated in a previous contract or subcontract subject to the Executive Orders and have not filed the required reports should note that 41 CFR 60-1.7(b) (1) prevents the award of contracts and subcontracts unless such contractor submits a report covering the delinquent period or such other period specified by the Federal Highway Administration or by the Director, Office of Federal Contract Compliance, U.S. Department of Labor.

Make

EQUAL EMPLOYMENT OPPORTUNITY CERTIFICATION

The bidder \_\_\_\_\_, proposed subcontractor X, hereby certifies that he has X, has not \_\_\_\_\_, participated in a previous contract or subcontract subject to the equal opportunity clause, as required by Executive Orders 10925, 11114, or 11246, and that, where required, he has filed with the Joint Reporting Committee, the Director of the Office of Federal Contract Compliance, a Federal Government contracting or administering agency, or the former President's Committee on Equal Employment Opportunity, all reports due under the applicable filing requirement.

United Steel Placers

(Company)

By: Kirk Negretti via fax

Estimator

(Title)

Date: 4-28-10

NOTE:

The above certification is required by the Equal Employment Opportunity Regulations of the Secretary of Labor (41 CFR 60-1.7(b) (1), and must be submitted by bidders and proposed subcontractors only in connection with contracts and subcontracts which are subject to the equal opportunity clause. Contracts and subcontracts which are exempt from the equal opportunity clause are set forth in 41 CFR 60-1.5. (Generally only contracts or subcontracts of \$10,000 or under are exempt.)

Currently, Standard Form 100 (EEO-1) is the only report required by the Executive Orders or their implementing regulations.

Proposed prime contractors and subcontractors who have participated in a previous contract or subcontract subject to the Executive Orders and have not filed the required reports should note that 41 CFR 60-1.7(b) (1) prevents the award of contracts and subcontracts unless such contractor submits a report covering the delinquent period or such other period specified by the Federal Highway Administration or by the Director, Office of Federal Contract Compliance, U.S. Department of Labor.

Mako

EQUAL EMPLOYMENT OPPORTUNITY CERTIFICATION

The bidder \_\_\_\_\_, proposed subcontractor X, hereby certifies that he has Y, has not \_\_\_\_\_ participated in a previous contract or subcontract subject to the equal opportunity clause, as required by Executive Orders 10925, 11114, or 11246, and that, where required, he has filed with the Joint Reporting Committee, the Director of the Office of Federal Contract Compliance, a Federal Government contracting or administering agency, or the former President's Committee on Equal Employment Opportunity, all reports due under the applicable filing requirement.

Our Valley Fence  
(Company)

By: Roger Baker *via fax*

Estimator  
(Title)

Date: 4-28-10

NOTE:

The above certification is required by the Equal Employment Opportunity Regulations of the Secretary of Labor (41 CFP 60-1.7(b) (1), and must be submitted by bidders and proposed subcontractors only in connection with contracts and subcontracts which are subject to the equal opportunity clause. Contracts and subcontracts which are exempt from the equal opportunity clause are set forth in 41 CFR 60-1.5. (Generally only contracts or subcontracts of \$10,000 or under are exempt.)

Currently, Standard Form 100 (EEO-1) is the only report required by the Executive Orders or their implementing regulations.

Proposed prime contractors and subcontractors who have participated in a previous contract or subcontract subject to the Executive Orders and have not filed the required reports should note that 41 CFR 60-1.7(b) (1) prevents the award of contracts and subcontracts unless such contractor submits a report covering the delinquent period or such other period specified by the Federal Highway Administration or by the Director, Office of Federal Contract Compliance, U.S. Department of Labor.

Make



**AFFIDAVIT FOR INDIVIDUAL CONTRACTORS**

\_\_\_\_\_ declares as follows:

That he or she is the party making the foregoing proposal or bid; that the bid is not made in the interest of, or on behalf of, any undisclosed person, partnership, company, association, organization, or corporation; that the bid is genuine and not collusive or sham; that the bidder has not directly or indirectly induced or solicited any other bidder to put in a false or sham bid, and has not directly or indirectly colluded, conspired, connived, or agreed with any bidder or anyone else to put in a sham bid, or that anyone shall refrain from bidding; that the bidder has not in any manner, directly or indirectly, sought by agreement, communication, or conference with anyone to fix the bid price of the bidder or any other bidder, or to fix any overhead, profit, or cost element of the bid price, or of that of any other bidder, or to secure any advantage against the County of Riverside or anyone interested in the proposed contract; that all statements contained in the bid are true; and, further, that the bidder has not, directly or indirectly, submitted his or her bid price or any breakdown thereof, or the contents thereof, or divulged information or data relative thereto, or paid, and will not pay, any fee to any corporation, partnership, company association, organization, bid depository, or to any member or agent thereof to effectuate a collusive or sham bid.

**I declare, under penalty of perjury, that the foregoing is true and correct.**

Dated this \_\_\_\_\_ (day) of \_\_\_\_\_ (month),  
\_\_\_\_\_ (year) at \_\_\_\_\_, California

**Signature of affiant:** \_\_\_\_\_

Note: Notarization of signature required

**AFFIDAVIT FOR JOINT VENTURE OR COPARTNERSHIP CONTRACTOR**

\_\_\_\_\_ Declares as follows:

That he or she is a member of the joint venture or copartnership firm designated as \_\_\_\_\_ which is the party making the foregoing proposal or bid; that the bid is not made in the interest of, or on behalf of, any undisclosed person, partnership, company, association, organization, or corporation; that the bid is genuine and not collusive or sham; that the bidder has not directly or indirectly induced or solicited any other bidder to put in a false or sham bid, and has not directly or indirectly colluded, conspired, connived, or agreed with any bidder or anyone else to put in a sham bid, or that anyone shall refrain from bidding; that the bidder has not in any manner, directly or indirectly, sought by agreement, communication, or conference with anyone to fix the bid price of the bidder or any other bidder, or to fix any overhead, profit, or cost element of the bid price, or of that of any other bidder, or to secure any advantage against the County of Riverside or anyone interested in the proposed contract; that all statements contained in the bid are true; and, further, that the bidder has not, directly or indirectly, submitted his or her bid price or any breakdown thereof, or the contents thereof, or divulged information or data relative thereto, or paid, and will not pay, any fee to any corporation, partnership, company association, organization, bid depository or to any member or agent thereof to effectuate a collusive or sham bid.

That he has been and is duly vested with authority to make and sign instruments for the joint venture or copartnership by \_\_\_\_\_ who constitute the other members of the joint venture or copartnership.

**I declare, under penalty of perjury, that the foregoing is true and correct.**

Dated this \_\_\_\_\_ (day) of \_\_\_\_\_ (month),  
\_\_\_\_\_ (year)  
at \_\_\_\_\_, California

**Signature of affiant:** \_\_\_\_\_

Note: Notarization of signature required

**AFFIDAVIT FOR CORPORATE CONTRACTOR**

Jigisha Desai declares as follows:

That he or she is Vice President of GRANITE CONSTRUCTION COMPANY a corporation which is the party making the foregoing proposal or bid; that the bid is not made in the interest of, or on behalf of, any undisclosed person, partnership, company, association, organization, or corporation; that the bid is genuine and not collusive or sham; that the bidder has not directly or indirectly induced or solicited any other bidder to put in a false or sham bid, and has not directly or indirectly colluded, conspired, connived, or agreed with any bidder or anyone else to put in a sham bid, or that anyone shall refrain from bidding; that the bidder has not in any manner, directly or indirectly, sought by agreement, communication, or conference with anyone to fix the bid price of the bidder or any other bidder, or to fix any overhead, profit, or cost element of the bid price, or of that of any other bidder, or to secure any advantage against the County of Riverside or anyone interested in the proposed contract; that all statements contained in the bid are true; and, further, that the bidder has not, directly or indirectly, submitted his or her bid price or any breakdown thereof, or the contents thereof, or divulged information or data relative thereto, or paid, and will not pay, any fee to any corporation, partnership, company association, organization, bid depository, or to any member or agent thereof to effectuate a collusive or sham bid.

**I declare, under penalty of perjury, that the foregoing is true and correct.**

Dated this 28th (day) of April (month),  
2010 (year)  
at Watsonville, California

GRANITE CONSTRUCTION COMPANY

Signature of affiant: \_\_\_\_\_



Jigisha Desai, Vice President

Note: Notarization of signature required

\*SEE ATTACHED CALIFORNIA NOTARIAL JURAT #4409...