

FOR THE APPROVED COUNTY COUNCIL
 BY: *H. Victor*
 DATE: 6/14/10
 MARSHAL VICTOR

**SUBMITTAL TO THE BOARD OF SUPERVISORS
 COUNTY OF RIVERSIDE, STATE OF CALIFORNIA**

315
A



FROM: TLMA - Transportation Department

SUBMITTAL DATE:
June 17, 2010

SUBJECT: Resurfacing and Reconstruction Project of five roads, Coachella Valley area.

RECOMMENDED MOTION: That the Board of Supervisors reject all bids received for the Resurfacing and Reconstruction Project of five roads, Coachella Valley area.

BACKGROUND: By Minute Order dated December 15, 2009 (agenda item 3.22) the Board authorized the Clerk of the Board to advertise for the resurfacing and reconstruction project of five roads in the Coachella Valley area. Bids for the project were opened in the office of the Director of Transportation at 2:00 PM, Wednesday, January 13, 2010. Five bids were received, ranging from \$2,631,362.00 to \$3,849,948.00. The engineer's estimate was \$2,945,000.00.

 Juan C. Perez
 Director of Transportation

JCP:rrj:rr
 (Continued On Attached Page)

FINANCIAL DATA	Current F.Y. Total Cost:	\$ 0	In Current Year Budget:	Yes
	Current F.Y. Net County Cost:	\$ 0	Budget Adjustment:	No
	Annual Net County Cost:	\$ 0	For Fiscal Year:	2009/2010

SOURCE OF FUNDS: Proposition 42 [Sales Tax on Gasoline] (0.2%), Proposition 1B [State Bond Funds- Local Roads] (99.7%), Measure A [Coachella Valley] (0.1%)	Positions To Be Deleted Per A-30	<input type="checkbox"/>
	Requires 4/5 Vote	<input type="checkbox"/>

C.E.O. RECOMMENDATION:

APPROVE
 BY: *Tina Grande*
 Tina Grande

County Executive Office Signature

MINUTES OF THE BOARD OF SUPERVISORS

On motion of Supervisor Buster, seconded by Supervisor Stone and duly carried, IT WAS ORDERED that the above matter is approved as recommended.

Ayes: Buster, Tavaglione, Stone and Benoit
 Nays: None
 Absent: Ashley
 Date: June 29, 2010
 xc: Transp.

Kecia Harper-Ihem
 Clerk of the Board
 BY: *Kecia Harper-Ihem*
 Deputy

Prev. Agn. Ref. 12/15/09, Item 3.22 | **District:** 4 | **Agenda Number:**

3.65

ATTACHMENTS FILED WITH
 THE CLERK OF THE BOARD

Departmental Concurrence

Dept's Recomm.: Consent Policy
 Per Exec. Ofc.: Consent Policy

The Honorable Board of Supervisors

RE: Resurfacing and Reconstruction Project of five roads, Coachella Valley area.

June 17, 2010

Page 2 of 2

Shortly before the opening of bids, Caltrans began construction on the Bob Hope Interchange project. After the bids were opened, Caltrans informed the Transportation Department that the interchange contractor would be transporting materials on Varner Road and Rio del Sol Road. The interchange Contractor's start date, duration and number of trips could not be determined, but it could be several hundred trips per day and would include round the clock trucking. The County's contract included full closure of each half of Varner Road for up to seven days, but required the contractor to maintain continual access to all the local businesses.

The combination of constraints from the Caltrans interchange project and the County rehabilitation project, make construction of both projects at the same time impractical.

The work on Varner Road and Rio del Sol Road comprise over 60% of the County Resurfacing and Reconstruction project. The project was bid as one project and, cannot be separated into smaller projects and there continues to be issues that affect the Caltrans contractor's sequencing of work.

Based on these finding, the Transportation Department recommends that all bids be rejected.

The Transportation Department intends to bid the five roads as two separate projects as follows:

Project 1 – Re-advertise in summer 2010

<u>ROAD:</u>	<u>FROM:</u>	<u>TO:</u>	<u>Pavement Improvement:</u>	<u>COMMUNITY:</u>
52nd Avenue	Jackson Street	Calhoun Street	Resurfacing	Coachella
66th Avenue	Grant Street	Hayes Street	Resurfacing	Mecca
Washington Street	Thousand Palm Cyn Road	Frances Way	Resurfacing	Thousand Palms/ Sun City

Project 2 - Advertisement date subject to Bob Hope Interchange construction schedule.

<u>ROAD:</u>	<u>FROM:</u>	<u>TO:</u>	<u>Pavement Improvement:</u>	<u>COMMUNITY:</u>
Varner Road	Ramon Road	Rio Del Sol Road	Resurfacing	Thousand Palms
Rio Del Sol Road	Varner Road	Vista Chino	Reconstruction	Thousand Palms

Project No: X1003

COUNTY OF RIVERSIDE
DEPARTMENT OF TRANSPORTATION

COACHELLA VALLEY

52ND AVE
66TH AVE
RESURFACING

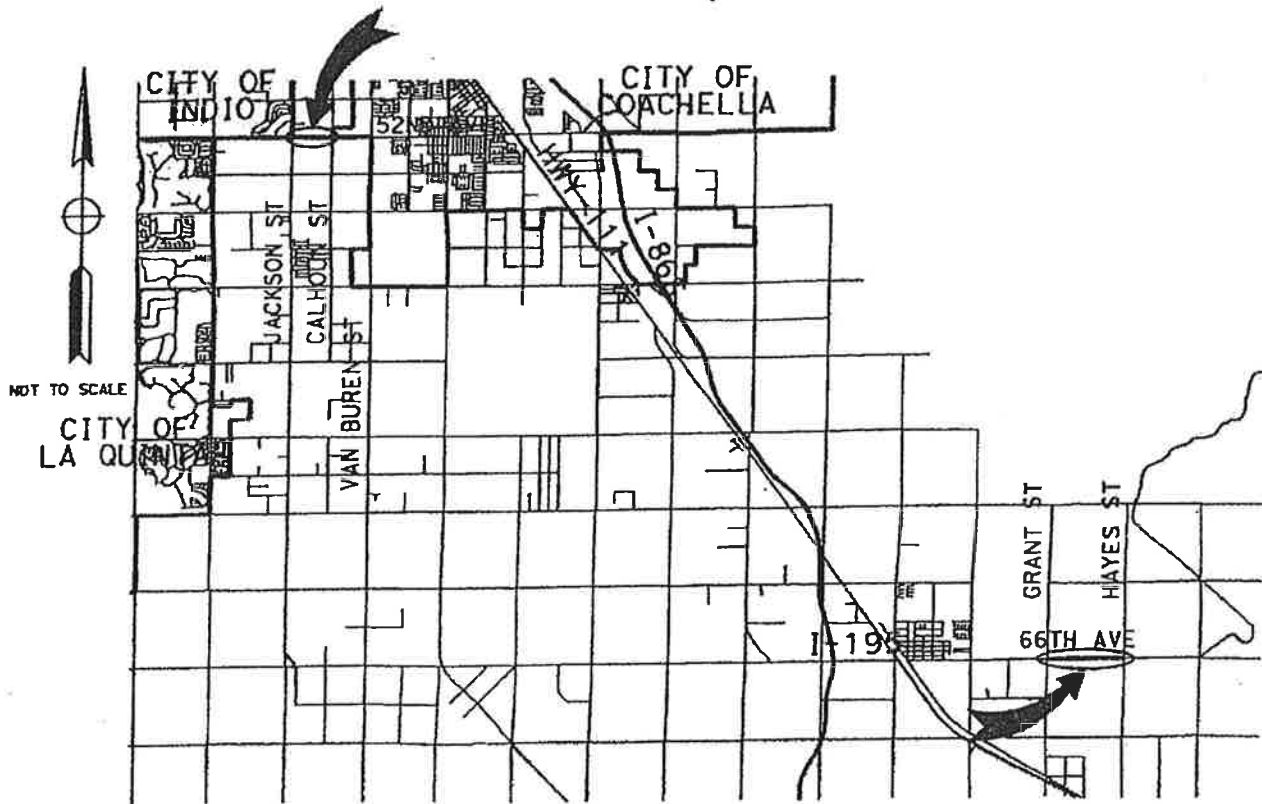
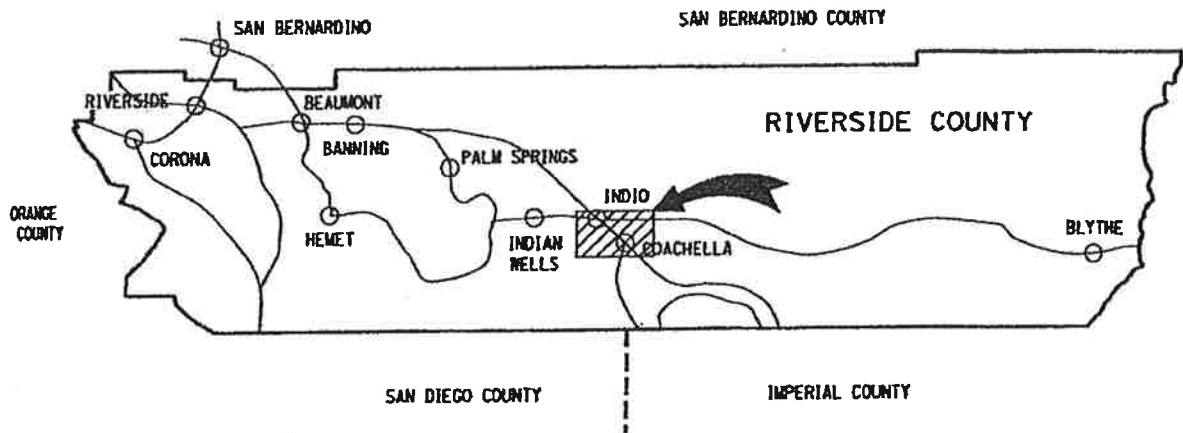

VICINITY MAP

PROJECT LENGTH = 1.5 MILES
T8807E 81, T7809E 810
2004 THOMAS GUIDE P08: 6470 (H7), 5593 (A6)

COUNTY OF RIVERSIDE
DEPARTMENT OF TRANSPORTATION

COACHELLA VALLEY

VARNER RD
RIO DEL SOL RD
WASHINGTON ST
RESURFACING AND RECONSTRUCTION

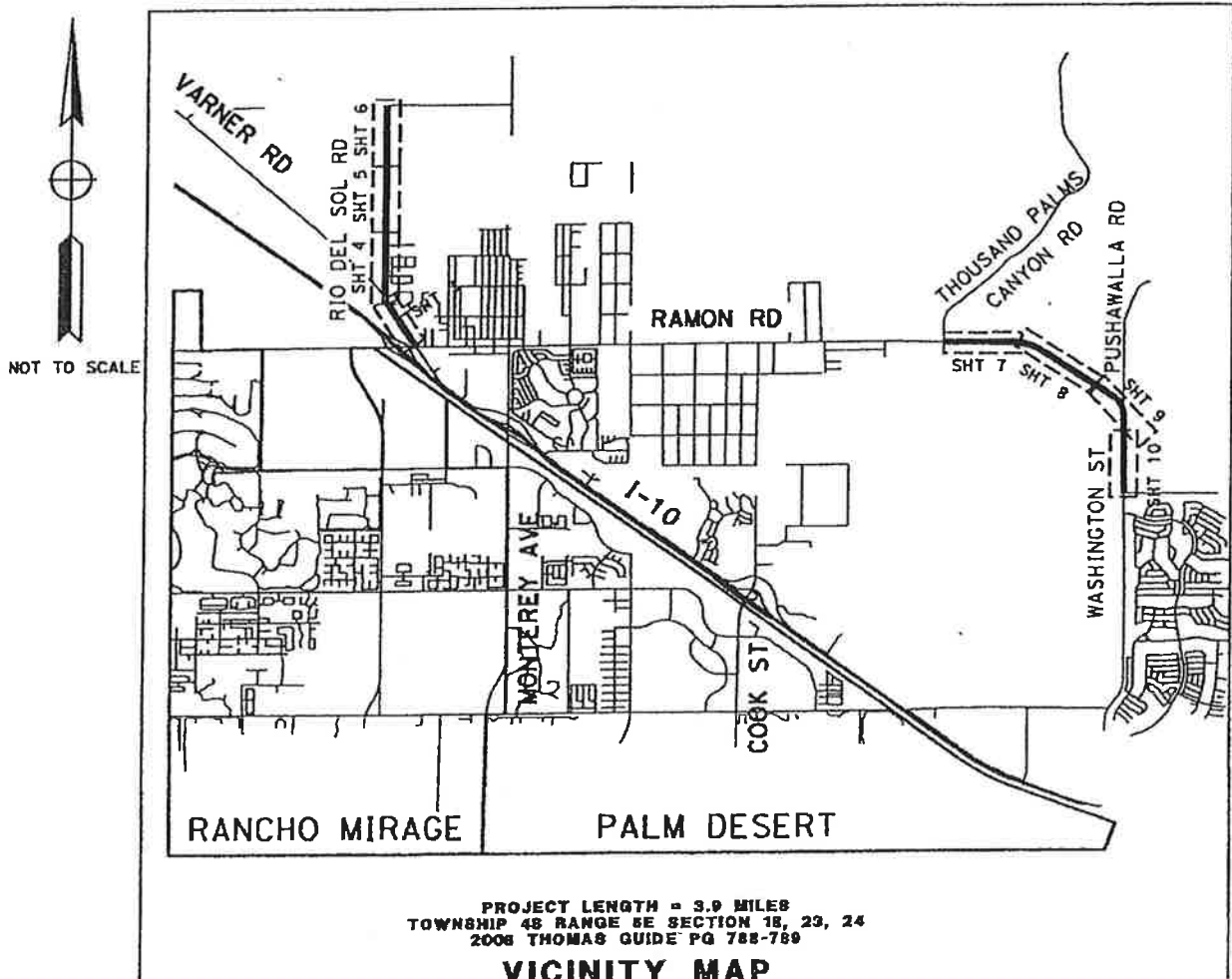
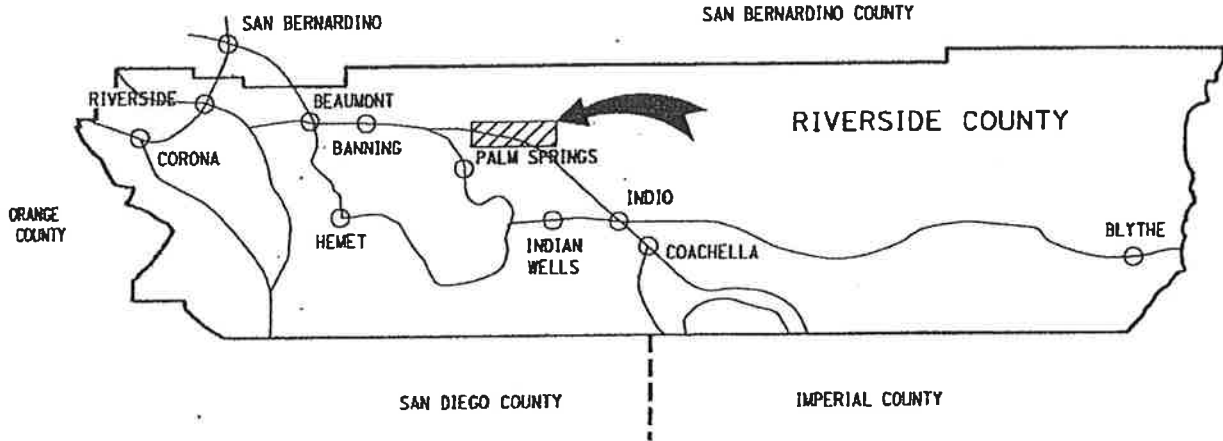

**Riverside County Transportation Department
Summary of Bids**

Advertised: December 15, 2009 (Agenda Item: 3.22)
Bids Open: 2 pm Date: Wednesday, January 13, 2010

PROJECT: Coachella Valley Resurfacing and Reconstruction Project
52nd Avenue, 66th Avenue, Varner Road, Rio Del Sol Road, and
Washington Street
PROJECT NO. X1003

		COUNTY'S ESTIMATE				GRANITE CONSTRUCTION Indio, CA 92203		
ITEM NO.	ITEM CODE	CONTRACT ITEM	UNITS	QUANTITY	UNIT PRICE	ENG ESTIMATE	BID	AMOUNT
1	066102	DUST ABATEMENT	LS	1	21,500.00	21,500.00	7,500.00	7,500.00
2	066147	RELOCATE MAILBOX	EA	1	500.00	500.00	900.00	900.00
3	066148	RELOCATE SIGNS	EA	2	200.00	400.00	150.00	300.00
4	074020	WATER POLLUTION CONTROL	LS	1	35,000.00	35,000.00	2,500.00	2,500.00
5	120100	TRAFFIC CONTROL SYSTEM	LS	1	80,000.00	80,000.00	250,451.00	250,451.00
6	011503	UNDER SIDEWALK DRAIN CAST IN PLACE (CRS 309)	EA	1	3,000.00	3,000.00	1,500.00	1,500.00
7	011505	GRINDING CONCRETE ASPHALT IN PLACE	SQYD	49,000	2.00	98,000.00	1.75	85,750.00
8	153103	COLD PLANE ASPHALT CONCRETE PAVEMENT	SQYD	4,000	3.00	12,000.00	4.00	16,000.00
9	170101	DEVELOP WATER SUPPLY	LS	1	13,000.00	13,000.00	6,000.00	6,000.00
10	190101	ROADWAY EXCAVATION	CY	5,500	27.00	148,500.00	22.00	121,000.00
11	190185	SHOULDER BACKING	LF	54,000	2.00	108,000.00	0.80	43,200.00
12	260201	CLASS 2 AGGREGATE BASE	CY	900	40.00	36,000.00	28.00	25,200.00
13	013904	PLACE ASPHALT CONCRETE DIKE (CRS 21) (8")	LF	200	10.00	2,000.00	17.30	3,460.00
14	390130	HOT MIX ASPHALT	TON	21,500	75.00	1,612,500.00	65.00	1,397,500.00
15	401108	REPLACE CONCRETE PAVEMENT (RAPID STRENGTH CONCRETE)	CY	1,650	350.00	577,500.00	285.00	470,250.00
16	414111	ROUT AND SEAL RANDOM CRACKS	LS	1	4,400.00	4,400.00	12,000.00	12,000.00
17	017302	MINOR CONCRETE (CROSS-GUTTER) (CRS 209)	SQFT	3,000	25.00	75,000.00	25.00	75,000.00
18	731504	MINOR CONCRETE (CURB AND GUTTER)	LF	350	15.00	5,250.00	39.00	13,650.00
19	731516	MINOR CONCRETE [DRIVEWAY APPROACH]	SQFT	3,400	5.00	17,000.00	7.00	23,800.00
20	731521	MINOR CONCRETE (SIDEWALK)	SQFT	2,300	5.00	11,500.00	6.00	13,800.00
21	731623	MINOR CONCRETE (CURB RAMP)	EA	11	3,000.00	33,000.00	2,500.00	27,500.00
22	840515	THERMOPLASTIC PAVEMENT MARKING	SQFT	1,300	6.00	7,800.00	1.75	2,275.00
23	840656	PAINT TRAFFIC STRIPE (2-COAT)	LF	105,000	0.20	21,000.00	0.20	21,000.00
24	850102	PAVEMENT MARKER (REFLECTIVE)	EA	3,631	5.00	18,155.00	2.00	7,262.00
25	860811	DETECTOR LOOP	EA	11	350.00	3,850.00	324.00	3,564.00
						2,944,855.00		2,631,362.00

**Riverside County Transportation Department
Summary of Bids**

PROJECT: Coachella Valley Resurfacing and Reconstruction Project
52nd Avenue, 66th Avenue, Varner Road, Rio Del Sol Road, and
Washington Street
PROJECT NO. X1003

Advertised: December 15, 2009 (Agenda Item: 3.22)
Bids Open: 2 pm Date: Wednesday, January 13, 2010

ITEM NO.	ITEM CODE	CONTRACT ITEM	UNITS	QUANTITY	SKANSKA		COOLEY CONSTRUCTION	
					BID	AMOUNT	BID	AMOUNT
1	066102	DUST ABATEMENT	LS	1	7,000.00	7,000.00	14,000.00	14,000.00
2	066147	RELOCATE MAILBOX	EA	1	650.00	650.00	234.00	234.00
3	066148	RELOCATE SIGNS	EA	2	125.00	250.00	184.00	368.00
4	074020	WATER POLLUTION CONTROL	LS	1	2,000.00	2,000.00	23,400.00	23,400.00
5	120100	TRAFFIC CONTROL SYSTEM	LS	1	90,999.80	90,999.80	117,000.00	117,000.00
6	011503	UNDER SIDEWALK DRAIN CAST IN PLACE (CRS 309)	EA	1	2,500.00	2,500.00	1,200.00	1,200.00
7	011505	GRINDING CONCRETE ASPHALT IN PLACE	SQYD	49,000	0.65	31,850.00	1.18	57,820.00
8	153103	COLD PLANE ASPHALT CONCRETE PAVEMENT	SQYD	4,000	2.00	8,000.00	3.30	13,200.00
9	170101	DEVELOP WATER SUPPLY	LS	1	5,000.00	5,000.00	4,500.00	4,500.00
10	190101	ROADWAY EXCAVATION	CY	5,500	40.00	220,000.00	75.00	412,500.00
11	190185	SHOULDER BACKING	LF	64,000	0.80	43,200.00	0.57	30,780.00
12	260201	CLASS 2 AGGREGATE BASE	CY	900	38.00	34,200.00	50.00	45,000.00
13	013904	PLACE ASPHALT CONCRETE DIKE (CRS 21) (8")	LF	200	15.00	3,000.00	23.70	4,740.00
14	390130	HOT MIX ASPHALT	TON	21,500	74.00	1,591,000.00	67.00	1,440,500.00
15	401108	REPLACE CONCRETE PAVEMENT (RAPID STRENGTH CONCRETE)	CY	1,650	465.00	767,250.00	502.00	828,300.00
16	414111	ROUT AND SEAL RANDOM CRACKS	LS	1	35,000.00	35,000.00	12,700.00	12,700.00
17	017302	MINOR CONCRETE (CROSS-GUTTER) (CRS 209)	SQFT	3,000	9.00	27,000.00	9.80	29,400.00
18	731504	MINOR CONCRETE (CURB AND GUTTER)	LF	350	30.00	10,500.00	28.60	10,010.00
19	731516	MINOR CONCRETE [DRIVEWAY APPROACH]	SQFT	3,400	7.00	23,800.00	9.10	30,940.00
20	731521	MINOR CONCRETE (SIDEWALK)	SQFT	2,300	5.00	11,500.00	6.30	14,490.00
21	731623	MINOR CONCRETE (CURB RAMP)	EA	11	2,000.00	22,000.00	2,900.00	31,900.00
22	840515	THERMOPLASTIC PAVEMENT MARKING	SQFT	1,300	2.75	3,575.00	2.90	3,770.00
23	840656	PAINT TRAFFIC STRIPE (2-COAT)	LF	105,000	0.15	15,750.00	0.11	11,550.00
24	850102	PAVEMENT MARKER (REFLECTIVE)	EA	3,631	3.20	11,619.20	2.64	9,585.84
25	850811	DETECTOR LOOP	EA	11	250.00	2,750.00	244.00	2,684.00
						2,970,394.00		3,150,571.84

**Riverside County Transportation Department
Summary of Bids**

PROJECT: Coachella Valley Resurfacing and Reconstruction Project
52nd Avenue, 66th Avenue, Varner Road, Rio Del Sol Road, and
Washington Street
PROJECT NO. X1003

Advertised: December 15, 2009 (Agenda Item: 3.22)
Bids Open: 2 pm Date: Wednesday, January 13, 2010

ITEM NO.	ITEM CODE	CONTRACT ITEM	UNITS	QUANTITY	DWC CONSTRUCTION		MATICH CORPORATION	
					BID	AMOUNT	BID	AMOUNT
1	066102	DUST ABATEMENT	LS	1	32,000.00	32,000.00	10,000.00	10,000.00
2	066147	RELOCATE MAILBOX	EA	1	600.00	600.00	800.00	800.00
3	066148	RELOCATE SIGNS	EA	2	600.00	1,200.00	275.00	550.00
4	074020	WATER POLLUTION CONTROL	LS	1	24,000.00	24,000.00	15,000.00	15,000.00
5	120100	TRAFFIC CONTROL SYSTEM	LS	1	84,000.00	84,000.00	649,030.00	649,030.00
6	011503	UNDER SIDEWALK DRAIN CAST IN PLACE (CRS 309)	EA	1	9,360.00	9,360.00	8,500.00	8,500.00
7	011505	GRINDING CONCRETE ASPHALT IN PLACE	SQYD	49,000	0.44	21,560.00	2.00	98,000.00
8	153103	COLD PLANE ASPHALT CONCRETE PAVEMENT	SQYD	4,000	4.75	19,000.00	3.00	12,000.00
9	170101	DEVELOP WATER SUPPLY	LS	1	8,200.00	8,200.00	7,500.00	7,500.00
10	190101	ROADWAY EXCAVATION	CY	5,500	50.40	277,200.00	30.00	165,000.00
11	190185	SHOULDER BACKING	LF	54,000	4.25	229,500.00	0.45	24,300.00
12	260201	CLASS 2 AGGREGATE BASE	CY	900	58.57	52,713.00	63.00	56,700.00
13	013904	PLACE ASPHALT CONCRETE DIKE (CRS 21) (8")	LF	200	20.16	4,032.00	24.00	4,800.00
14	390130	HOT MIX ASPHALT	TON	21,500	77.84	1,673,560.00	78.00	1,677,000.00
15	401108	REPLACE CONCRETE PAVEMENT (RAPID STRENGTH CONCRETE)	CY	1,650	315.80	521,070.00	500.00	825,000.00
16	414111	ROUT AND SEAL RANDOM CRACKS	LS	1	38,000.00	38,000.00	12,000.00	12,000.00
17	017302	MINOR CONCRETE (CROSS-GUTTER) (CRS 209)	SQFT	3,000	13.00	39,000.00	16.00	48,000.00
18	731504	MINOR CONCRETE (CURB AND GUTTER)	LF	350	37.80	13,230.00	55.00	19,250.00
19	731516	MINOR CONCRETE [DRIVEWAY APPROACH]	SQFT	3,400	12.52	42,568.00	17.00	57,800.00
20	731521	MINOR CONCRETE (SIDEWALK)	SQFT	2,300	8.63	19,849.00	23.00	52,900.00
21	731623	MINOR CONCRETE (CURB RAMP)	EA	11	1,276.45	14,040.95	2,700.00	29,700.00
22	840515	THERMOPLASTIC PAVEMENT MARKING	SQFT	1,300	2.76	3,588.00	3.00	3,900.00
23	840656	PAINT TRAFFIC STRIPE (2-COAT)	LF	105,000	0.28	29,400.00	0.55	57,750.00
24	850102	PAVEMENT MARKER (REFLECTIVE)	EA	3,631	2.75	9,985.25	3.00	10,893.00
25	850811	DETECTOR LOOP	EA	11	772.72	8,499.92	325.00	3,575.00
						3,176,156.12		3,849,948.00