

**SUBMITTAL TO THE BOARD OF SUPERVISORS
COUNTY OF RIVERSIDE, STATE OF CALIFORNIA**

317 B



FROM: County Counsel/TLMA
Code Enforcement Department

SUBMITTAL DATE:
June 17, 2010

SUBJECT: Abatement of Public Nuisance [Substandard Structures]
Case No.: CV 10-00386 (VELARDE)
Subject Property: 21665 Eucalyptus Lane, Perris; APN: 325-060-013
District Five

RECOMMENDED MOTION: Move that:

- (1) The substandard structure (barn) on the real property located at 21665 Eucalyptus Lane, Perris, Riverside County, California, APN: 325-060-013, be declared a public nuisance and a violation of Riverside County Ordinance No. 457 which does not permit substandard structures on the property.
- (2) John B. Velarde and Elvia O. Velarde, the owners of the subject real property or whoever has possession or control of the premises, be directed to abate the substandard structure on the property by removing the same from the real property within ninety (90) days.

[Signature]
L. ALEXANDRA FONG, Deputy County Counsel
for PAMELA J. WALLS, County Counsel

(Continued)

FINANCIAL DATA	Current F.Y. Total Cost:	\$ N/A	In Current Year Budget:	N/A
	Current F.Y. Net County Cost:	\$ N/A	Budget Adjustment:	N/A
	Annual Net County Cost:	\$ N/A	For Fiscal Year:	N/A

SOURCE OF FUNDS:	Positions To Be Deleted Per A-30	<input type="checkbox"/>
	Requires 4/5 Vote	<input type="checkbox"/>

C.E.O. RECOMMENDATION: APPROVE
BY: *[Signature]*
Tina Grande
County Executive Office Signature

Dep't Recomm.: Consent Policy Policy
Per Exec. Ofc.: Consent Policy

MINUTES OF THE BOARD OF SUPERVISORS

On motion of Supervisor Benoit, seconded by Supervisor Stone and duly carried, IT WAS ORDERED that the above matter is approved as recommended.

Ayes: Buster, Tavaglione, Stone and Benoit
Nays: None
Absent: Ashley
Date: June 29, 2010
xc: Co. Co., CED(2), Prop. Owner, Sheriff

Kecia Harper-Ihem
Clerk of the Board
By: *[Signature]*
Deputy

Prev. Agn. Ref.: | **District:** 5 | **Agenda Number:** 9.8

ATTACHMENTS FILED WITH THE CLERK OF THE BOARD

- (3) The owners be ordered to ascertain the existence or non-existence of asbestos containing materials in said structure by survey and materials sample testing through the Industrial Hygiene Specialist of the County Health Department, Division of Special Services; and, prior to the abatement ordered in paragraph number two (2) above, to secure the removal and disposal of all asbestos containing materials discovered through such survey and testing by contract with a duly certified and licensed contractor for the handling of such materials to avoid citations and/or fines imposed by the South Coast Air Quality Management District (SCAQMD) pursuant to SCAQMD Rule No. 1403.
- (4) If the owners or whoever has possession or control of the real property does not take the above described action within ninety (90) days of the date of the Board's Order to Abate, that representatives of the Code Enforcement Department, Sheriff's Department, and/or a contractor, upon consent of the owner or receipt of a Court Order authorizing entry onto the real property when necessary under applicable law, shall abate the substandard structure and contents therein, by removing the same from the real property.
- (5) The reasonable costs of abatement, after notice and an opportunity for hearing, shall be imposed as a lien on the real property, which may be collected as a special assessment against the real property pursuant to Government Code Section 25845 and Ordinance No. 725.
- (6) County Counsel be directed to prepare the necessary Findings of Facts and Conclusions that the substandard structure on the real property is declared to be in violation of Riverside County Ordinance No. 457 and a public nuisance, and further, to prepare an Order to Abate for approval by the Board.

JUSTIFICATION:

1. An inspection was made of the subject property by the Code Enforcement Officer on January 15, 2010. The inspection revealed two (2) substandard structures (barn and shed) on the subject property in violation of Riverside County Ordinance No. 457 (RCC Title 15). The substandard conditions of the structures included, but were not limited to, the following: hazardous wiring; members of walls, partitions, or other vertical supports that split, lean, list or buckle due to defective material or deterioration; members of ceilings, roofs, ceiling and roof supports or other horizontal members which sag, split, or buckle due to defective material or deterioration; dampness of habitable rooms; faulty weather protection; general dilapidation or improper maintenance; unpermitted and public and attractive nuisance.
2. Subsequent follow-up inspections on March 29, 2010 and June 11, 2010, revealed that the barn remained on site and the shed had been demolished and the debris removed from the property. The property continues to be in violation of Riverside County Ordinance No. 457.
3. Staff and the Code Enforcement Department have complied with the notice requirements set forth in the appropriate laws of this jurisdiction pertaining to the administrative abatement proceedings for substandard structures.

1 **BOARD OF SUPERVISORS**
2 **COUNTY OF RIVERSIDE**

3 IN RE ABATEMENT OF PUBLIC NUISANCE) CASE NO. CV 10-00386
4 [SUBSTANDARD STRUCTURES]; APN: 325-)
5 060-013, 21665 EUCALYPTUS LANE, PERRIS,) DECLARATION OF OFFICER
6 COUNTY OF RIVERSIDE, STATE OF) JENNIFER MORRIS
CALIFORNIA; JOHN B. VELARDE AND)
ELVIA O. VELARDE, OWNERS.) [R.C.O. No. 457, RCC Title 15]

7 I, Jennifer Morris, declare:

8 1. I am currently employed by the Riverside County Code Enforcement Department as a
9 Code Enforcement Officer. My current official duties include inspecting property for violations and
10 enforcement of the provisions of Riverside County Ordinances. The following facts contained within this
11 declaration are within my personal knowledge except to the extent that certain information is based on
12 information and belief and if called as a witness in this matter, I could and would competently testify
13 thereto.

14 2. On January 15, 2010, I conducted an initial inspection of the real property known as 21665
15 Eucalyptus Lane, Perris, in the unincorporated area of Riverside County, California, which is further
16 described as Assessor's Parcel Number 325-060-013 (hereinafter described as "THE PROPERTY"). A
17 true and correct copy of a Thomas Brothers map page indicating the approximate location of THE
18 PROPERTY is attached hereto as Exhibit "A."

19 3. A review of County records and documents disclosed that THE PROPERTY was owned
20 by John B. Velarde and Elvia O. Velarde at the time of the inspection referenced in paragraph 2 above
21 (hereinafter referred to as "OWNER"). A certified copy of the County Equalized Assessment Roll for the
22 year 2009-2010 and a report generated from the County Geographic Information System ("GIS") are
23 attached hereto as Exhibit "B" and incorporated herein by reference.

24 4. Based on the Lot Book Report from RZ Title Service on October 12, 2009 and updated on
25 April 15, 2010, it is determined that no other parties potentially hold a legal interest in THE PROPERTY.
26 True and correct copies of the Lot Book Reports are attached hereto and incorporated herein as Exhibit
27 "C."

28 ///

1 5. On January 15, 2010, I arrived at THE PROPERTY to conduct an initial inspection of
2 THE PROPERTY. I met OWNER and he granted me permission to inspect. I entered and observed the
3 following conditions as described below which caused the barn and shed be substandard and THE
4 PROPERTY to constitute a public nuisance in violation of the provisions set forth in Riverside County
5 Ordinance 457, as codified in Riverside County Code Title 15.

6 Barn:

- 7 1) Hazardous wiring;
- 8 2) Members of walls, partitions, or other vertical supports that split, list, lean or buckle due to
 defective material or deterioration;
- 9 3) Members of ceilings, roof, ceiling and roof supports or other horizontal members which
 sag, split, or buckle due to defective material or deterioration;
- 10 4) Dampness of habitable rooms;
- 11 5) Faulty weather protection;
- 12 6) General dilapidation or improper maintenance;
- 13 7) Unpermitted;
- 14 8) Public and attractive nuisance.

15 Shed:

- 16 1) Members of walls, partitions, or other vertical supports that split, list, lean or buckle due to
 defective material or deterioration;
- 17 2) Members of ceilings, roof, ceiling and roof supports or other horizontal members which
 sag, split, or buckle due to defective material or deterioration;
- 18 3) Dampness of habitable rooms;
- 19 4) Faulty weather protection;
- 20 5) General dilapidation or improper maintenance;
- 21 6) Unpermitted;
- 22 6) Public and attractive nuisance.

23 6. A Notice of Violation, Notice of Defects and "Danger Do Not Enter" signs were posted on
24 THE PROPERTY on January 15, 2010.

25 7. On January 19, 2010, Notices of Violation and Notices of Defects were mailed to
26 OWNERS by certified mail, return receipt requested.

27 8. A site plan and photographs of the condition of THE PROPERTY are attached hereto and
28 as Exhibit "D" and are incorporated herein by reference.

 9. True and correct copies of each Notice issued in this matter and other documentation are
attached hereto as Exhibit "E" and incorporated herein by reference.

///

1 10. On March 29, 2010, I met OWNER at THE PROPERTY and conducted a follow up
2 inspection. I observed that the shed had been demolished and all debris had been removed from THE
3 PROPERTY. The barn remained on THE PROPERTY in substandard condition and remained in
4 violation of Riverside County Ordinance No. 457 (RCC Title 15).

5 11. Based upon my experience, knowledge and visual observations, it is my determination that
6 the substandard structure (barn) on THE PROPERTY creates an extreme health, safety, fire and structural
7 hazard to the neighbors and general public.

8 12. A follow-up inspection on June 11, 2010 showed THE PROPERTY remained in violation
9 of Riverside County Ordinance No. 457 (RCC Title 15).

10 13. Furthermore, based on my observations of THE PROPERTY, I declare that the
11 substandard conditions of THE PROPERTY constitute a public nuisance in violation of the provisions set
12 forth in Riverside County Ordinance No. 457 (RCC Title 15).

13 14. A Notice of Noncompliance was recorded on January 28, 2010, as Document Number
14 2010-0039005 in the Office of the County Recorder, Riverside County, State of California. A true and
15 correct copy of this notice is attached hereto as Exhibit "F" and incorporated herein by reference.

16 15. On June 10, 2010, the second notice, Notice to Correct County Ordinance Violations and
17 Abate Public Nuisance, providing the notification of the Board of Supervisors' hearing was mailed to
18 OWNERS by certified mail, return receipt requested and was posted on THE PROPERTY on June 11,
19 2010. A true and correct copy of the notice, together with proof of service, returned receipt card and the
20 Affidavit of Posting of Notice are attached as Exhibit "G" and incorporated herein by reference.

21 16. Significant rehabilitation, removal and /or demolition of the substandard structure and
22 removal and disposal of all structural debris are required to abate the public nuisance and bring THE
23 PROPERTY into compliance with Riverside County Ordinance Number 457 (RCC Title 15), the Health
24 and Safety, Uniform Housing, Administrative and Abatement of Dangerous Buildings Codes.

25 17. Accordingly, the following findings and conclusions are recommended:

26 (a) the structure (barn) be condemned as a substandard building, public nuisance and
27 attractive nuisance;

28 ///

1 (b) the OWNERS be required to rehabilitate or demolish said structure, including the
 2 removal and disposal of all structural debris and materials, on THE PROPERTY in accordance with the
 3 provisions of Riverside County Ordinance No. 457 (RCC Title 15),

4 (c) the OWNERS be ordered to ascertain the existence or non-existence of asbestos
 5 containing materials in said structure by survey and materials sample testing through the Industrial
 6 Hygiene Specialist of the County Health Department, Division of Special Services; and, prior to the
 7 abatement ordered in subsection (b) above, to secure the removal and disposal of all asbestos containing
 8 materials discovered through such survey and testing by contract with a duly certified and licensed
 9 contractor for the handling of such materials to avoid citations and/or fines by South Coast Air Quality
 10 Management District ("SCAQMD") pursuant to SCAQMD Rule NO. 1403;

11 (d) if the substandard structure is not razed, removed and disposed of, or reconstructed
 12 in strict accordance with all Riverside County Ordinances, including but not limited to Riverside County
 13 Ordinance No. 457 (RCC Title 15), within ninety (90) days of the date of the Board's Order to Abate, the
 14 substandard structure and contents therein shall be abated by representatives of the Riverside County
 15 Code Enforcement Department, a contractor or the Sheriff's Department upon receipt of an owner's
 16 consent or a Court Order where necessary under applicable law authorizing entry onto THE PROPERTY;

17 (e) that reasonable costs of abatement, after notice and opportunity for hearing, shall be
 18 imposed as a lien on THE PROPERTY, which may be collected as a special assessment against THE
 19 PROPERTY pursuant to Government Code Section 25845 and Riverside County Ordinance Nos. 457 and
 20 725 (RCC Titles 15 and 1).

21 I declare under penalty of perjury under the laws of the State of California that the
 22 foregoing is true and correct.

23 Executed this 11th day of June, 2010, at Riverside, California.

24
 25 
 26 JENNIFER MORRIS
 27 Code Enforcement Officer
 28 Code Enforcement Department

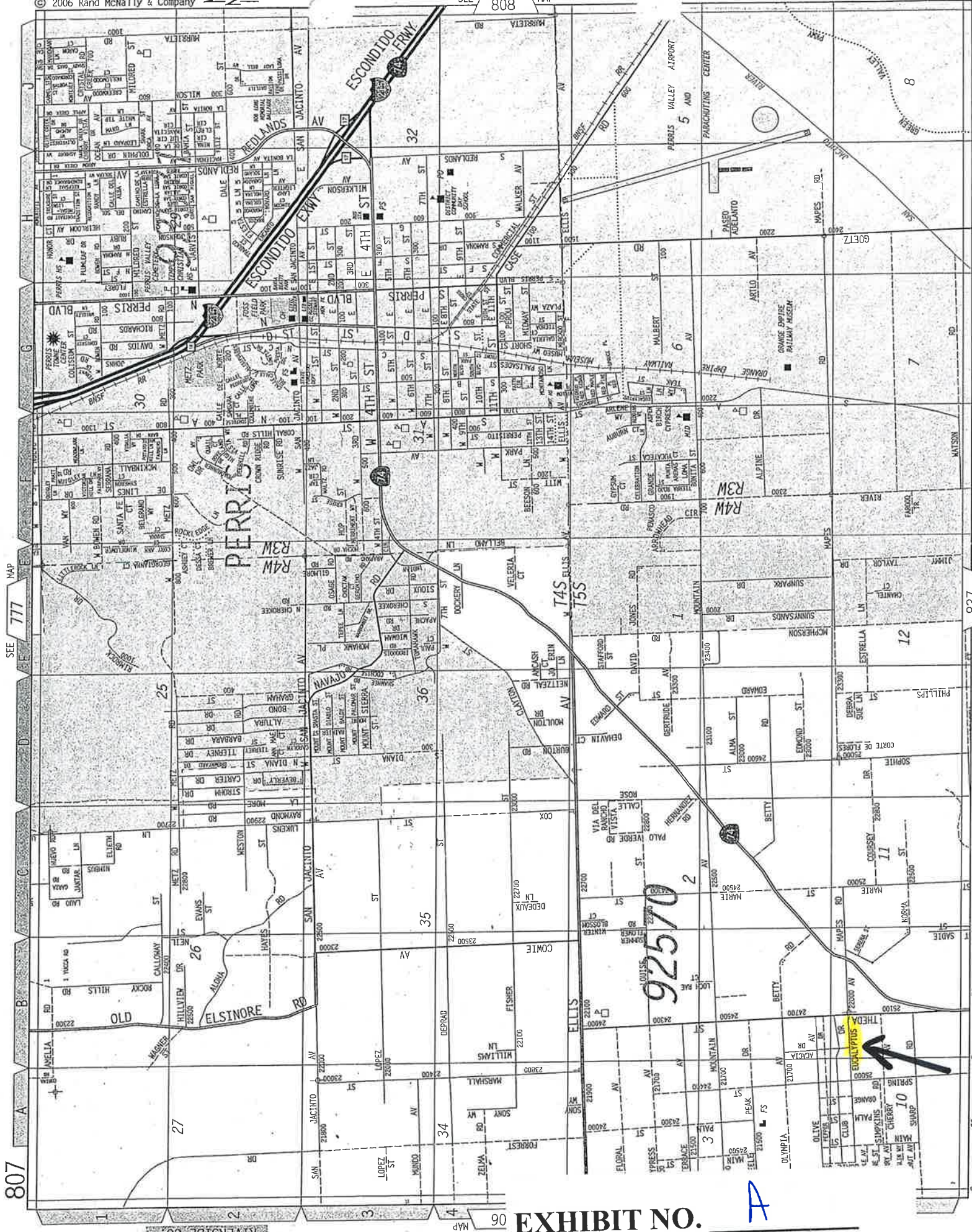

807

SEE 777 MAP

837

EXHIBIT NO.

A

RIVERSIDE CO.

MAP 06

Assessment Roll For the 2009-2010 Tax Year as of January 1,2009

Assessment #325060013-2		Parcel # 325060013-2	
Assessee:	VELARDE JOHN B	Land	13,200
Assessee:	VELARDE ELVIA O	Structure	6,193
Mail Address:	29873 SUN COUNTRY LN	Full Value	19,393
City, State Zip:	SUN CITY, CA 92586	Total Net	19,393
Real Property Use Code:	MR		
Base Year	1977		
Conveyance Number:	0061887		
Conveyance (mm/yy):	5/1976		
PUI:	M010012		
TRA:	87-014		
Taxability Code:	0-00		
ID Data:	Lot 8 RS 024/059		
Situs Address:	21665 EUCALYPTUS LN PERRIS CA 92570		

[View Parcel Map](#)

EXHIBIT NO. B

RIVERSIDE COUNTY GIS

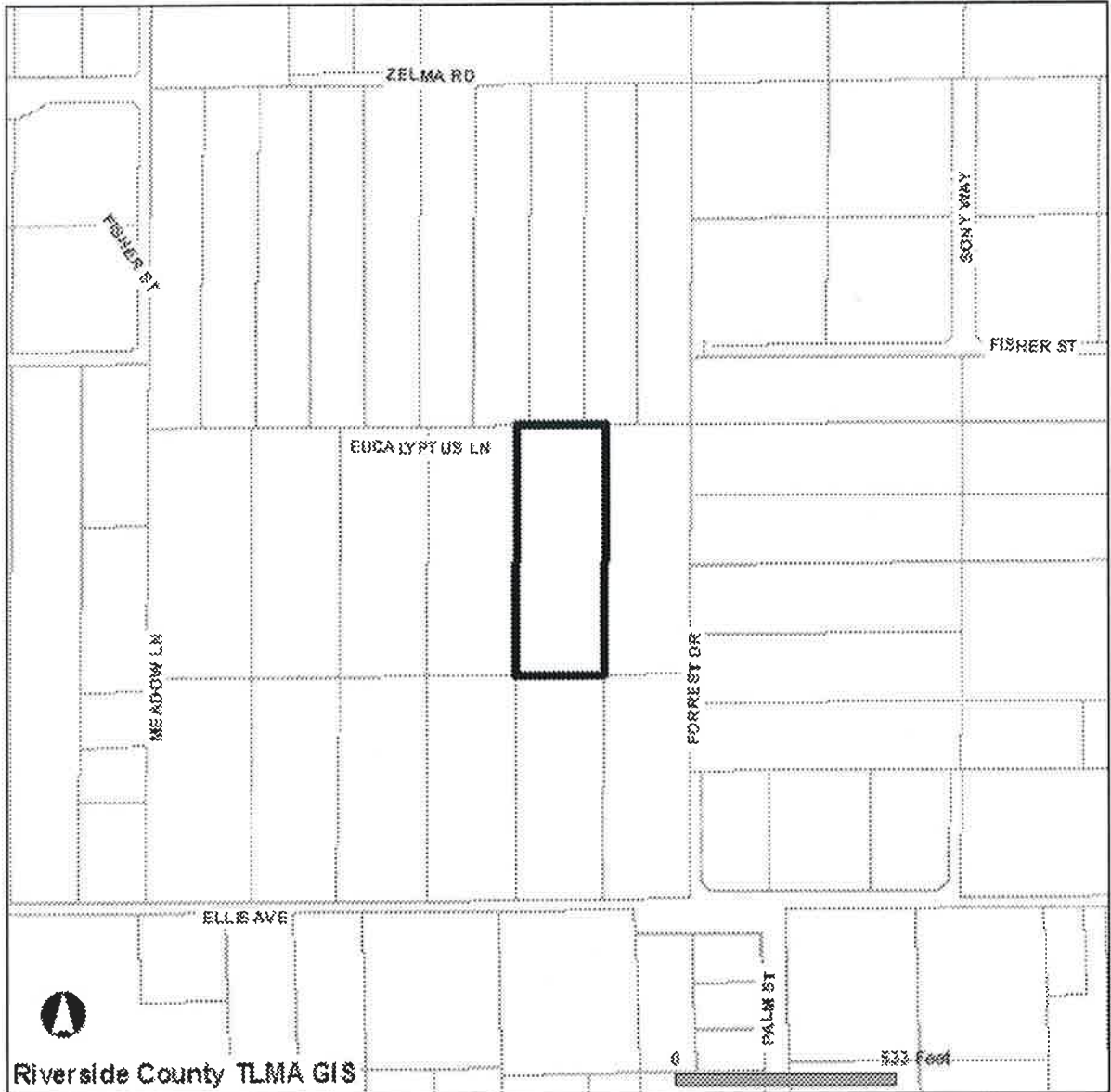

Selected parcel(s):
325-060-013

"IMPORTANT"

Maps and data are to be used for reference purposes only. Map features are approximate, and are not necessarily accurate to surveying or engineering standards. The County of Riverside makes no warranty or guarantee as to the content (the source is often third party), accuracy, timeliness, or completeness of any of the data provided, and assumes no legal responsibility for the information contained on this map. Any use of this product with respect to accuracy and precision shall be the sole responsibility of the user.

STANDARD REPORT

APNs

325-060-013-2

OWNER NAME / ADDRESS

JOHN B VELARDE
ELVIA VELARDE
21665 EUCALYPTUS LN
PERRIS, CA. 92570

MAILING ADDRESS

(SEE OWNER)

EXHIBIT NO.

B²

29873 SUN COUNTRY LN
SUN CITY CA. 92586

LEGAL DESCRIPTION

RECORDED BOOK/PAGE: RS 24/59
SUBDIVISION NAME: NOT AVAILABLE
LOT/PARCEL: 8, BLOCK: NOT AVAILABLE
TRACT NUMBER: NOT AVAILABLE

LOT SIZE

RECORDED LOT SIZE IS 2.77 ACRES

PROPERTY CHARACTERISTICS

WOOD FRAME, 1410 SQFT., 2 BDRM/ 2 BATH, 1 STORY, CONST'D 1967COMPOSITION, ROOF, CENTRAL HEATING, CENTRAL COOLING

THOMAS BROS. MAPS PAGE/GRID

PAGE: 807 GRID: A4

CITY BOUNDARY/SPHERE

NOT WITHIN A CITY
CITY SPHERE: PERRIS
NO ANNEXATION DATE AVAILABLE
NO LAFCO CASE # AVAILABLE
NO PROPOSALS

MARCH JOINT POWERS AUTHORITY

NOT IN THE JURISDICTION OF THE MARCH JOINT POWERS AUTHORITY

INDIAN TRIBAL LAND

NOT IN A TRIBAL LAND

SUPERVISORIAL DISTRICT (ORD. 813)

MARION ASHLEY, DISTRICT 5

TOWNSHIP/RANGE

T4SR4W SEC 34

ELEVATION RANGE

1656/1684 FEET

PREVIOUS APN

NO DATA AVAILABLE

PLANNING

LAND USE DESIGNATIONS

Zoning not consistent with the General Plan.
RC-VLDR

AREA PLAN (RCIP)

MEAD VALLEY

GENERAL PLAN POLICY OVERLAYS

NOT IN A GENERAL PLAN POLICY OVERLAY AREA

GENERAL PLAN POLICY AREAS

NONE

ZONING CLASSIFICATIONS (ORD. 348)

R-R

ZONING DISTRICTS AND ZONING AREAS

GOOD HOPE AREA

ZONING OVERLAYS

NOT IN A ZONING OVERLAY

SPECIFIC PLANS

NOT WITHIN A SPECIFIC PLAN

AGRICULTURAL PRESERVE

NOT IN AN AGRICULTURAL PRESERVE

REDEVELOPMENT AREAS

NOT IN A REDEVELOPMENT AREA

AIRPORT INFLUENCE AREAS
NOT IN AN AIRPORT INFLUENCE AREA

AIRPORT COMPATIBILITY ZONES
NOT IN AN AIRPORT COMPATIBILITY ZONE

ENVIRONMENTAL

CVMSHCP (COACHELLA VALLEY MULTI-SPECIES HABITAT CONSERVATION PLAN) CONSERVATION AREA
NOT IN A CONSERVATION AREA

CVMSHCP FLUVIAL SAND TRANSPORT SPECIAL PROVISION AREAS
NOT IN A FLUVIAL SAND TRANSPORT SPECIAL PROVISION AREA

WRMSHCP (WESTERN RIVERSIDE COUNTY MULTI-SPECIES HABITAT CONSERVATION PLAN) CELL GROUP
NOT IN A CELL GROUP

WRMSHCP CELL NUMBER
NOT IN A CELL

HANS/ERP (HABITAT ACQUISITION AND NEGOTIATION STRATEGY/EXPEDITED REVIEW PROCESS)
NONE

VEGETATION (2005)
Developed/Disturbed Land
Riparian Scrub, Woodland, Forest

FIRE

HIGH FIRE AREA (ORD. 787)
NOT IN A HIGH FIRE AREA

FIRE RESPONSIBILITY AREA
STATE RESPONSIBILITY AREA

DEVELOPMENT FEES

CVMSHCP FEE AREA (ORD. 875)
NOT WITHIN THE COACHELLA VALLEY MSHCP FEE AREA

WRMSHCP FEE AREA (ORD. 810)
IN OR PARTIALLY WITHIN THE WESTERN RIVERSIDE MSHCP FEE AREA. SEE MAP FOR MORE INFORMATION.

ROAD & BRIDGE DISTRICT
NOT IN A DISTRICT

EASTERN TUMF (TRANSPORTATION UNIFORM MITIGATION FEE ORD. 673)
NOT WITHIN THE EASTERN TUMF FEE AREA

WESTERN TUMF (TRANSPORTATION UNIFORM MITIGATION FEE ORD. 824)
IN OR PARTIALLY WITHIN A TUMF FEE AREA. SEE MAP FOR MORE INFORMATION.CENTRAL

DIF (DEVELOPMENT IMPACT FEE AREA ORD. 659)
MEAD VALLEY

SKR FEE AREA (STEPHEN'S KANGAROO RAT ORD. 663.10)
IN OR PARTIALLY WITHIN AN SKR FEE AREA. SEE MAP FOR MORE INFORMATION.

DEVELOPMENT AGREEMENTS
NOT IN A DEVELOPMENT AGREEMENT AREA

TRANSPORTATION

CIRCULATION ELEMENT ULTIMATE RIGHT-OF-WAY
NOT IN A CIRCULATION ELEMENT RIGHT-OF-WAY

ROAD BOOK PAGE

61

TRANSPORTATION AGREEMENTS

NOT IN A TRANSPORTATION AGREEMENT

CETAP (COMMUNITY AND ENVIRONMENTAL TRANSPORTATION ACCEPTABILITY PROCESS) CORRIDORS

NOT IN A CETAP CORRIDOR.

HYDROLOGY

FLOOD PLAIN REVIEW

NOT REQUIRED.

WATER DISTRICT

EMWD

FLOOD CONTROL DISTRICT

RIVERSIDE COUNTY FLOOD CONTROL DISTRICT

WATERSHED

SAN JACINTO VALLEY

GEOLOGIC

FAULT ZONE

NOT IN A FAULT ZONE

FAULTS

WITHIN A 1/2 MILE OF

FAULT IN BASEMENT ROCKS

CONTACT THE COUNTY'S CHIEF ENGINEERING GEOLOGIST AT (951)955-6863.

LIQUEFACTION POTENTIAL

MODERATE

SUBSIDENCE

SUSCEPTIBLE

PALEONTOLOGICAL SENSITIVITY

UNDETERMINED POTENTIAL.

AREAS UNDERLAIN BY SEDIMENTARY ROCKS FOR WHICH LITERATURE AND UNPUBLISHED STUDIES ARE NOT AVAILABLE HAVE

UNDETERMINED POTENTIAL FOR CONTAINING SIGNIFICANT PALEONTOLOGICAL RESOURCES. THESE AREAS MUST BE INSPECTED BY A

FIELD SURVEY CONDUCTED BY A QUALIFIED VERTEBRATE PALEONTOLOGIST.

MISCELLANEOUS

SCHOOL DISTRICT

PERRIS & PERRIS UNION HIGH

COMMUNITIES

GOOD HOPE

COUNTY SERVICE AREA

NOT IN A COUNTY SERVICE AREA.

LIGHTING (ORD. 655)

ZONE B, 37.56 MILES FROM MT. PALOMAR OBSERVATORY

2000 CENSUS TRACT

042903

FARMLAND

OTHER LANDS

TAX RATE AREAS

087-014

• COUNTY FREE LIBRARY

• COUNTY STRUCTURE FIRE PROTECTION

• COUNTY WASTE RESOURCE MGMT DIST

- CSA 152
- EASTERN MUN WATER IMP DIST 8
- EASTERN MUNICIPAL WATER
- FLOOD CONTROL ADMINISTRATION
- FLOOD CONTROL ZONE 4
- GENERAL
- GENERAL PURPOSE
- METRO WATER EAST 1301999
- MT SAN JACINTO JUNIOR COLLEGE
- PERRIS AREA ELEM SCHOOL FUND
- PERRIS JR HIGH AREA FUND
- PERRIS SCHOOL
- PERRIS UNION HIGH SCHOOL
- PERRIS VALLEY CEMETERY
- RIV CO REG PARK & OPEN SPACE
- RIV. CO. OFFICE OF EDUCATION
- SAN JACINTO BASIN RESOURCE CONS

SPECIAL NOTES

NO SPECIAL NOTES

CODE COMPLAINTS

Case #	Description	Start Date
CV0710463	NEIGHBORHOOD ENFORCEMENT	Dec. 18, 2007
CV078101	VEHICLE ABATEMENT	Sep. 27, 2007
CV078103	ABATEMENT	Sep. 27, 2007
CV1000386	ABATEMENT	Jan. 15, 2010

REPORT PRINTED ON...Tue May 11 15:11:37 2010
Version 100412



INVOICE

Order Number: 21457

Order Date: 4/15/2010

Customer Information:

Acct No. 1044

RIVERSIDE COUNTY TLMA-CODE ENFORCEMENT
4080 Lemon Street
Riverside, CA 92501

Attn: Brent Steele
REF: CV10-00386/ Yadira Oseguera
IN RE: VELARDE, JOHN B.

Product and/or Service ordered for Property known as:

**21665 Eucalyptus Lane
Perris, CA 92570**

DESCRIPTION:

Updated Lot Book

FEE:

\$57.00

TOTAL DUE:

\$57.00

Payment due upon receipt. Please remit to:

RZ Title Services, Inc.
P.O. Box 1193
Whittier, CA 90609

EXHIBIT NO. C



P.O. Box 1193
 Whittier, CA 90609
 Tel # (562) 325-8351
 Fax # (714) 783-3038

Updated Lot Book

Customer:

RIVERSIDE COUNTY TLMA-CODE INFORCEMENT

4080 Lemon Street
 Riverside

CA 92501

Attn: Brent Steele
 Reference: CV10-00386/ Yadira Oseguera
 IN RE: VELARDE, JOHN B.

Order Number: **21457**

Order Date: 4/15/2010

Dated as of: 4/13/2010

County Name: Riverside

FEE(s):
 Report: \$57.00

Property Address: 21665 Eucalyptus Lane
 Perris

CA 92570

RZ Title Reporting Service hereby reports, as disclosed by the Official Records of the Recorder of said County as of the date shown above, that subsequent to the date of the original report that (i) No document in the chain of title to said land has been recorded purporting to convey the fee title to said land, and (ii) No encumbrances affecting said land have been recorded nor has a homestead been executed on said land, and (iii) No encumbrances affecting said land on the date of the original report have been released or reconveyed.

All exceptions are as follows:

Assessor's Parcel No. : 325-060-013-2

Assessments:	Land Value:	\$13,200.00
	Improvement Value:	\$6,193.00
	Exemption Value:	\$0.00
	Total Value:	\$19,393.00

Property Taxes for the Fiscal Year	2009-2010
First Installment	\$130.95
Penalty	\$0.00
Status	PAID (PAID THRU 01/31/2010)
Second Installment	\$130.95
Penalty	\$41.08
Status	NOT PAID-DELINQUENT

Notice of Non-Compliance filed by	County of Riverside Code Enforcement Department
In the matter of the property of	John B. Velarde and Elvia O. Velarde
Case No.	CV10-00386
Recorded	01/28/2010



P.O. Box 1193
Whittier, CA 90609
Tel # (562) 325-8351
Fax # (714) 783-3038

Order Number: 21457

Reference: CV10-00386/ Yadi

Document No. 2010-0039005

NO OTHER EXCEPTIONS

When recorded please mail to:
Riverside County Code Enforcement Department
(District 5 Office)
24318 Hemlock Avenue, Suite C-1
Moreno Valley, CA 92557
Mail Stop No. 5002

DOC # 2010-0039005

01/28/2010 08:00A Fee:NC

Page 1 of 1

Recorded in Official Records
County of Riverside

Larry W. Ward
Assessor, County Clerk & Recorder



M
039
159

NOTICE OF NONCOMPLIANCE

In the matter of the Property of) Case No. CV10-00386
John B. Velarde)
Elvia O. Velarde)

NOTICE IS HEREBY GIVEN to all persons, pursuant to Section 10 of Ordinance Number 725 of the County of Riverside, State of California, that proceedings have been commenced with respect to violations of Riverside County Ordinance No.457, (RCC Title 15.16.020) described as substandard structures / accessory buildings: barn/ workshop and shed (quality lower than prescribed by law). Such Proceedings are based upon the noncompliance of such real property, located at 21665 Eucalyptus Lane, Perris, CA, and more particularly described as Assessor's Parcel Number 325-060-013 and having a legal description of 2.77 ACRES IN PAR 8 RS 024/059, Records of Riverside County, with the requirements of Ordinance No. 457 (RCC Title 15.16.020).

The owner has been advised to immediately correct the above-referenced violations to avoid further action by the County of Riverside which may include demolition, removal, razing, etc., to abate the public nuisance. Any costs incurred by the County, including, but not limited to investigative, administrative and abatement costs and attorneys' fees, may become a lien on the property. Further details regarding this notice may be obtained by addressing an inquiry to the Code Enforcement Department, 24318 Hemlock Avenue, Suite C-1, Moreno Valley, California, Attention Code Enforcement Officer Jennifer Morris.

NOTICE IS FURTHER GIVEN in accordance with §17274 and §24436.5 of the California Revenue and Taxation Code, that a tax deduction may not be allowed for interest, taxes, depreciation, or amortization paid or incurred in the taxable year affected by these proceedings.

COUNTY OF RIVERSIDE
CODE ENFORCEMENT DEPARTMENT

By Mary Overholt
Mary Overholt
Code Enforcement Department

ACKNOWLEDGMENT

State of California)
County of Riverside)

On 01/19/10 before me, Ana E. Carrillo, Notary Public, personally appeared Mary Overholt, who proved to me on the basis of satisfactory evidence to be the person(s) whose name(s) is/are subscribed to the within instrument and acknowledged to me that he/she/they executed the same in his/her/their authorized capacity(ies), and that by his/her/their signature(s) on the instrument the person(s), or the entity upon behalf of which the person(s) acted, executed the instrument.

I certify under PENALTY OF PERJURY under the laws of the State of California that the foregoing paragraph is true and correct.

WITNESS my hand and official seal.

Ana E. Carrillo

Commission # 1767676 Comm. Expires Sep. 14, 2011

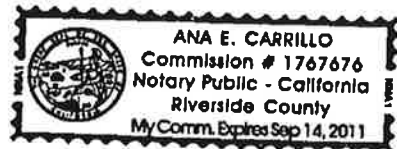



P.O. Box 1193
Whittier, CA 90609
Tel # (562) 325-8351
Fax # (714) 783-3038

Lot Book Report

Order Number: **20205**

Customer:

RIVERSIDE COUNTY TLMA-CODE ENFORCEMENT

4080 Lemon Street

Riverside

CA 92501

Attn: Brent Steele

Reference: CV07-8103/Jennifer Morris

IN RE: VELARDE, ELVIA AND VELARDE, JOHN

Order Date: 10/7/2009

Dated as of: 10/12/2009

County Name: Riverside

FEE(s):

Report: \$114.00

Property Address: 21665 Eucalyptus Lane

Perris

CA 92570

Assessor's Parcel No. : 325-060-013-2

Assessments:

Land Value:	\$13,200.00
Improvement Value:	\$6,193.00
Exemption Value:	\$0.00
Total Value:	\$19,393.00

Tax Information

Property Taxes for the Fiscal Year	2009-2010
First Installment	\$130.95
Penalty	\$0.00
Status	OPEN NOT-PAID (DUE DATE 12/10/2009)
Second Installment	\$130.95
Penalty	\$0.00
Status	OPEN NOT-PAID (DUE DATE 04/10/2010)



P.O. Box 1193
Whittier, CA 90609
Tel # (562) 325-8351
Fax # (714) 783-3038

Order Number: 20205
Reference: CV07-8103/Jennif

Property Vesting

The last recorded document transferring title of said property

Dated	04/08/1976
Recorded	05/06/1976
Document No.	61887
D.T.T.	\$3.85
Grantor	James Dunn and Ida Dunn, husband and wife
Grantee	John B. Velarde and Elvia O. Velarde, husband and wife as joint tenants

Deeds of Trust

No Deeds of Trust of Record

Additional Information

Notice of Non-Compliance filed by	County of Riverside Code Enforcement Department
In the matter of the property of	John B. Velarde and Elvia O. Velarde
Case No.	CV07-8103, CV07-10464, CV07-10463 and CV07-8101
Recorded	02/27/2008
Document No.	2008-0094101

Legal Description

THE LAND REFERRED TO IN THIS REPORT IS LOCATED IN AND IS DESCRIBED AS FOLLOWS:

PARCEL 8 OF RECORDS OF SURVEY, IN THE COUNTY OF RIVERSIDE, STATE OF CALIFORNIA, AS SHOWN BY MAP ON FILE IN BOOK 24 PAGE 59 OF RECORDS OF SURVEY, RECORDS OF SAID COUNTY RECORDER.

W1/2, SE 1/4, SEC. 34, T4S, R4W.

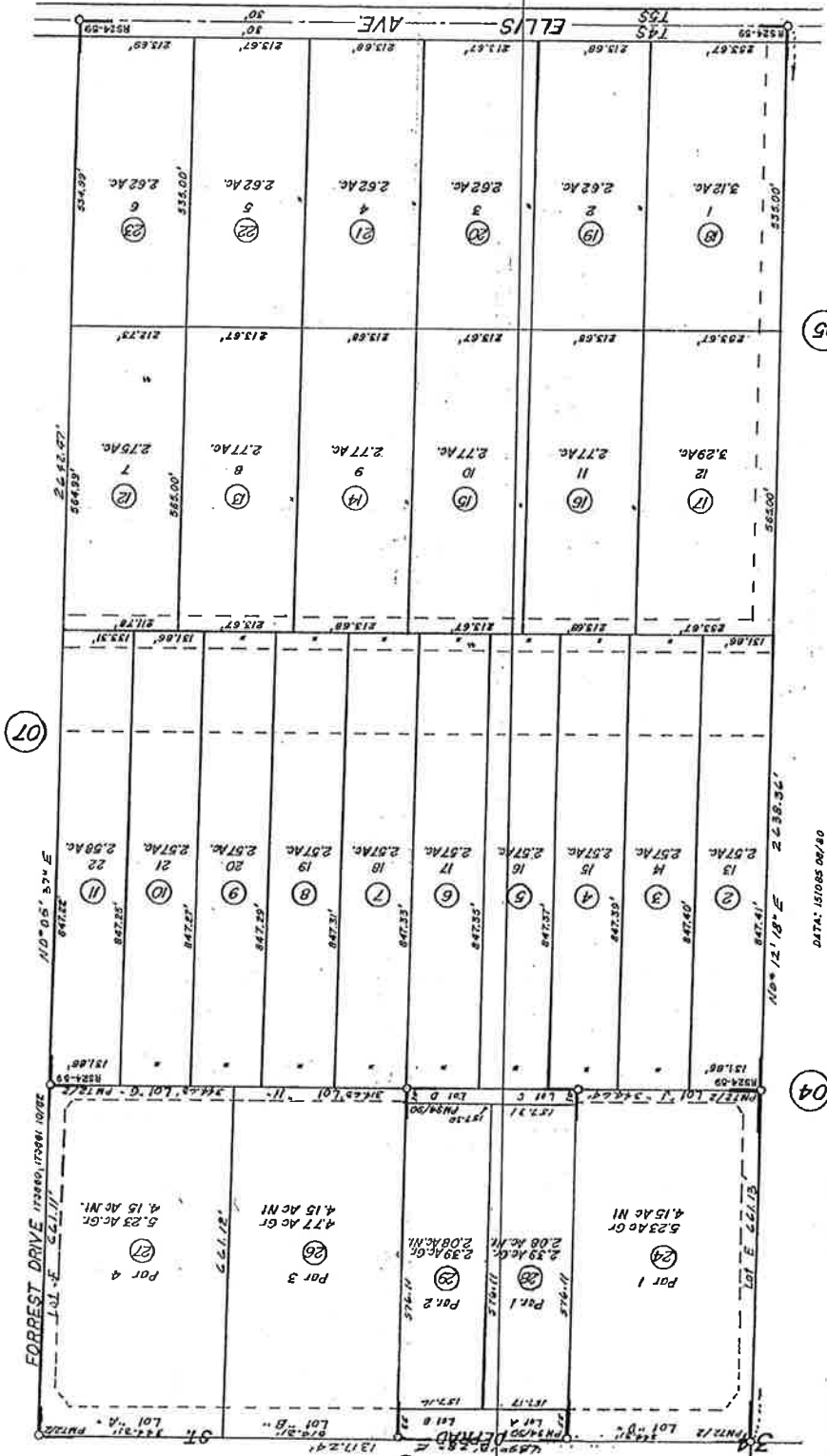

DATE	LOG	NO.	NEW NO.
11-79	1	24-27	
9/81	25	28, 29	

61887

RECORDING REQUESTED BY

AND WHEN RECORDED MAIL THIS DEED AND, UNLESS OTHERWISE SHOWN BELOW, MAIL TAX STATEMENTS TO

NAME Mr. & Mrs. John Velarde
STREET ADDRESS 222 Carter Drive
CITY, STATE ZIP Perris, Calif. 92370

PAID
Doc. Transfer Tax
W. D. BALOGH
RIV. CO. RECORDER

RECEIVED FOR RECORD
MAY 6 1976
AT 9:00 O'CLOCK A.M.
As Recorder of
SUTCO TITLE INSURANCE CO.
Book 1976, Page 61887
Recorded in Official Records
of Riverside County, California
W.D. Balogh Recorder
FEE \$

TITLE ORDER NO _____ ESCROW No 1207

SPACE ABOVE THIS LINE FOR RECORDER'S USE

GRANT DEED UNINCORPORATED AREA

THE UNDERSIGNED GRANTOR(S) DECLARE(S)
DOCUMENTARY TRANSFER TAX is \$ 3.85
 computed on full value of property conveyed, or
 computed on full value less value of liens or encumbrances remaining at time of sale, and

FOR A VALUABLE CONSIDERATION, receipt of which, is hereby acknowledged,
JAMES DUNN AND IDA DUNN, husband and wife

hereby GRANT(S) to
JOHN B. VELARDE AND ELVIA O. VELARDE, husband and wife as joint tenants

the following described real property in the
County of Riverside State of California:

Parcel 8 of Records of Survey as shown by map on file in Book 24 page 59 of Records of Survey, Records of Riverside County, Riverside County, California.

#2; 436927-3

Dated April 8, 1976

STATE OF CALIFORNIA }
COUNTY OF Riverside } ss.
On April 8, 1976 before me, the

Undersigned, a Notary Public in and for said State, personally appeared
James Dunn and Ida Dunn

James Dunn
James Dunn

Ida Dunn
Ida Dunn

to be the person whose name subscribed to the within instrument and acknowledged that they executed the same.
WITNESS my hand and official seal.

Signature *Yvonne Lavender*

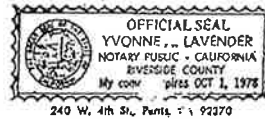

(This space for official notarial seal)

MAIL TAX STATEMENTS AS DIRECTED ABOVE.

PR 4/76

END RECORDED DOCUMENT

W. D. BALOGH, COUNTY RECORDER

When recorded please mail to:
5002

DOC # 2008-0094101
02/27/2008 08:00A Fee:NC
Page 1 of 1
Recorded in Official Records
County of Riverside
Larry W. Ward
Assessor, County Clerk & Recorder



NOTICE OF NONCOMPLIANCE

062

In the matter of the Property of
John B. Velarde
Elvia O. Velarde

)
)

Case No. CV07-8103, CV07-10464
CV07-10463, CV07-8101

NOTICE IS HEREBY GIVEN to all persons, pursuant to Section 10 of Ordinance Number 725 of the County of Riverside, State of California, that proceedings have been commenced with respect to violations of Riverside County Ordinance No.541, (RCC Title 8.120.010) described as Accumulated Rubbish, Riverside County Ordinance No. 348; (RCC Title 17.16.010) described as Excessive Outside Storage, Occupied Recreational Vehicle & Use without planning approval, Riverside County Ordinance No. 457, (RCC Title 15.08.010) described as Constructions without the required permit(s) - Shed & Barn, & Riverside County Ordinance No. 520, (RCC Title 10.04.150) described as a Vehicle Abatement (inoperative, dismantled, wrecked vehicles). Such Proceedings are based upon the noncompliance of such real property, located at 21665 Eucalyptus Lane, Perris, CA, and more particularly described as Assessor's Parcel Number 325-060-013 and having a legal description of 2.77 ACRES IN PAR 8 RS 024/059, Records of Riverside County, with the requirements of Ordinance No. 541, 348, 457 & 520 (RCC Title 8.120.010, 17.16.010, 15.08.010 & 10.04.150).

The owner has been advised to immediately correct the above-referenced violations to avoid further action by the County of Riverside which may include demolition, removal, razing, etc., to abate the public nuisance. Any costs incurred by the County, including, but not limited to investigative, administrative and abatement costs and attorneys' fees, may become a lien on the property. Further details regarding this notice may be obtained by addressing an inquiry to the Code Enforcement Department, 24318 Hemlock Ave., Suite C-1, Moreno Valley, CA 92557, Attention Code Enforcement Officer Thomas McMullen.

NOTICE IS FURTHER GIVEN in accordance with §17274 and §24436.5 of the California Revenue and Taxation Code, that a tax deduction may not be allowed for interest, taxes, depreciation, or amortization paid or incurred in the taxable year affected by these proceedings.

COUNTY OF RIVERSIDE
CODE ENFORCEMENT DEPARTMENT

By

Theresa L. Towner

Code Enforcement Department

ACKNOWLEDGMENT

State of California)
County of Riverside)

On 02/06/08 before me, Ana E. Carrillo, Notary Public, personally appeared Theresa L. Towner, who proved to me on the basis of satisfactory evidence to be the person(s) whose name(s) is are subscribed to the within instrument and acknowledged to me that he/she/they executed the same in his/her/their authorized capacity(ies), and that by his/her/their signature(s) on the instrument the person(s), or the entity upon behalf of which the person(s) acted, executed the instrument.

I certify under PENALTY OF PERJURY under the laws of the State of California that the foregoing paragraph is true and correct.

WITNESS my hand and official seal.

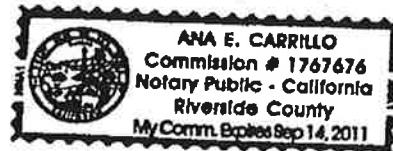

SITE PLAN: Case # CV-1000386

OWNER(S): JOHN B VELARDE / ELVIA O VELARDE
ADDRESS: 29873 SUN COUNTRY LN, SUN CITY, CA 92586
ASSESSOR'S PARCEL: 325-060-013
ACREAGE: 2.769999

NORTH ARROW: ↓

REAR PROPERTY LINE

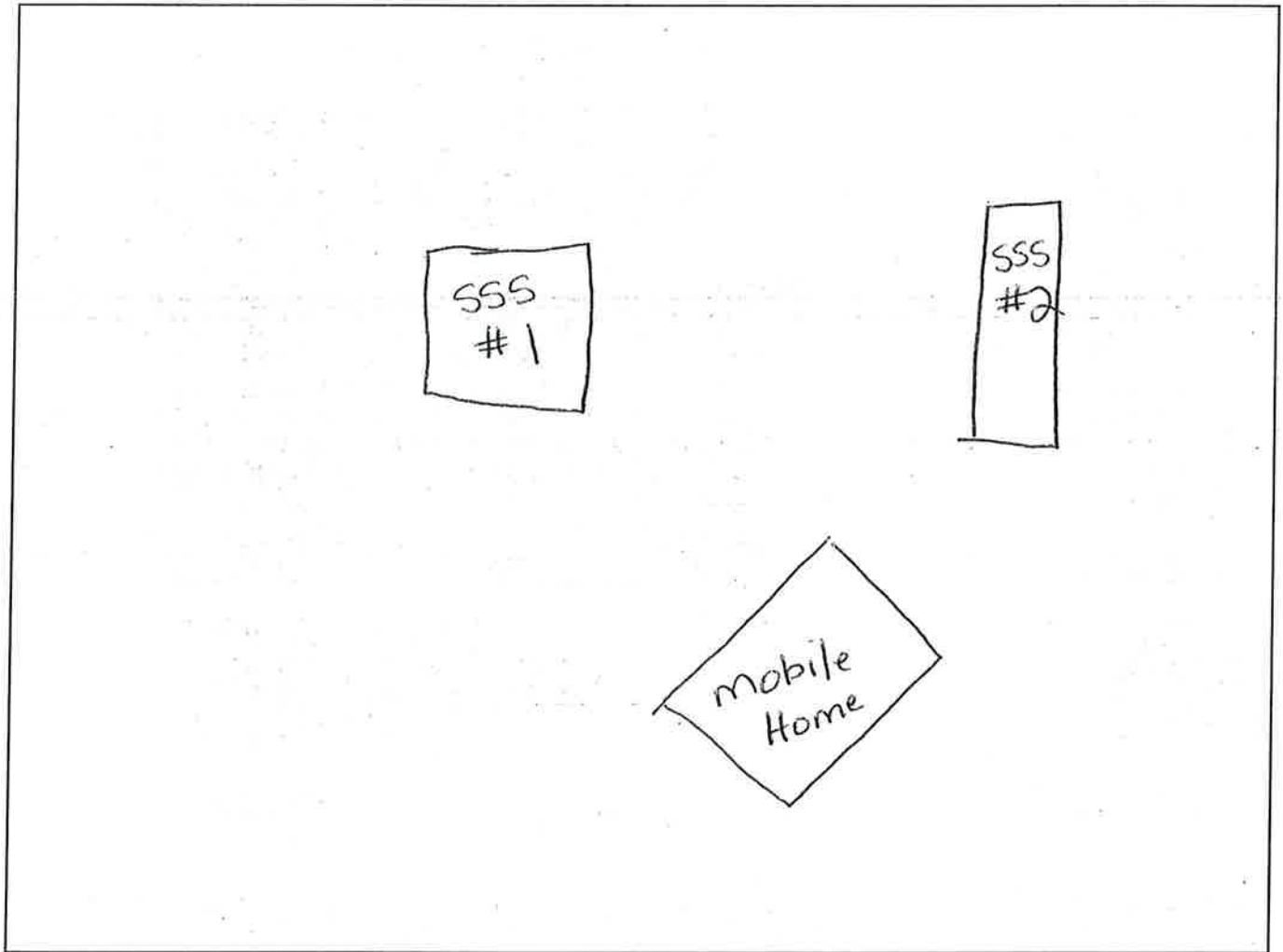

FRONT PROPERTY LINE: 21665 EUCALYPTUS LN, PERRIS

PREPARED BY: V. Morris DATE: 1/15/10

EXHIBIT NO. D

Code Enforcement Case: CV1000386

Printed on: 04/06/2010

Photographs



SSS#1-NOD#10, #11, #12, #13, #14, #17, and #19-JMorris - 01/15/2010

EXHIBIT NO. D2



SSS#1-NOD#10, #11, #12, #13, #14, #17, and #19-JMorris - 01/15/2010

EXHIBIT NO. D3



SSS#1-NOD#1, #6, #10, #11, #12, #13, #14, #17, and #19-JMorris - 01/15/2010

EXHIBIT NO. D⁴



SSS#1-NOD#1, #6, #10, #11, #12, #13, #14, #17, and #19-JMorris - 01/15/2010

EXHIBIT NO. D5



SSS#1-NOD#1, #6, #10, #11, #12, #13, #14, #17, and #19-JMorris - 01/15/2010

EXHIBIT NO. D6



SSS#2-#10, #11, #12, #13, #14, #17, and #19-JMorris - 01/15/2010

EXHIBIT NO. D7



SSS#2-#10, #11, #12, #13, #14, #17, and #19-JMorris - 01/15/2010

EXHIBIT NO. D8



SSS#2-#10, #11, #12, #13, #14, #17, and #19-JMorris - 01/15/2010

EXHIBIT NO. D⁹



SSS#2-#10, #11, #12, #13, #14, #17, and #19-JMorris - 01/15/2010

EXHIBIT NO. D¹⁰



SSS#1 remains-JMorris - 03/29/2010

EXHIBIT NO. D''



SSS#1 remains-JMorris - 03/29/2010

EXHIBIT NO. D¹²



SSS#1 remains-JMorris - 03/29/2010

EXHIBIT NO. D13



SSS#1 remains-JMorris - 03/29/2010

EXHIBIT NO. D14



SSS#2 removed-JMorris - 03/29/2010

EXHIBIT NO. D15



COUNTY OF RIVERSIDE
CODE ENFORCEMENT DEPARTMENT

NOTICE OF VIOLATION

CASE No.: CV 10-00386

THE PROPERTY AT: 21665 Eucalyptus Ln, Perris APN#: 325-060-013

WAS INSPECTED BY OFFICER: J. Morris ID#: 129 ON 1/15/10 AT 0940 am/pm

AND FOUND TO BE IN VIOLATION OF RIVERSIDE COUNTY CODE(S) AS FOLLOWS:

Table with 4 columns: Code, Description, Code, Description. Contains violations such as Excessive Yard Sales, Unfenced Pool, Accumulated Rubbish, etc.

COMMENTS:

IMPORTANT! CORRECTION(S) MUST BE COMPLETED BY: 2/15/10. FAILURE TO COMPLY BY THIS DATE, MAY RESULT IN THE ISSUANCE OF AN ADMINISTRATIVE CITATION WITH FINES UP TO \$500.00 PER DAY...

NOTICE IS HEREBY GIVEN THAT AT THE CONCLUSION OF THIS CASE YOU WILL RECEIVE A SUMMARY OF ADMINISTRATIVE COSTS ASSOCIATED WITH THE PROCESSING OF SUCH VIOLATION(S), AT AN HOURLY RATE OF \$109.00...

SIGNATURE PRINT NAME DATE PROPERTY OWNER TENANT

CDL/CID# D.O EXHIBIT NO. E POSTED

RIVERSIDE COUNTY CODE ENFORCEMENT DEPARTMENT CODE ENFORCEMENT NOTICE OF DEFECTS

UNIFORM HOUSING HEALTH & SAFETY
CODE SECTIONS CODE SECTIONS

SUBSTANDARD BUILDING CONDITIONS:

	UNIFORM HOUSING CODE SECTIONS	HEALTH & SAFETY CODE SECTIONS
1. <input checked="" type="checkbox"/> Lack of or improper water closet, lavatory, bathtub, shower or kitchen sink.....	1001(b)1,2,3	17920.3(a)1,2,3
OBTAIN PERMIT TO: <input checked="" type="checkbox"/> Repair Per Applicable Building Codes <input checked="" type="checkbox"/> Demolish Or Rehabilitate Structure		
2. <input type="checkbox"/> Lack of hot and cold running water to plumbing fixtures	1001(b)4,5	17920.3(a)4,5
OBTAIN PERMIT TO: <input type="checkbox"/> Repair Per Applicable Building Codes <input type="checkbox"/> Demolish Or Rehabilitate Structure		
3. <input type="checkbox"/> Lack of connection to required sewage system.....	1001(b)14	17920.3(a)14
OBTAIN PERMIT TO: <input type="checkbox"/> Repair Per Applicable Building Codes <input type="checkbox"/> Demolish Or Rehabilitate Structure		
4. <input type="checkbox"/> Hazardous plumbing.....	1001(f)	17920.3(e)
OBTAIN PERMIT TO: <input type="checkbox"/> Repair Per Applicable Building Codes <input type="checkbox"/> Demolish Or Rehabilitate Structure		
5. <input type="checkbox"/> Lack of required electrical lighting.....	1001(b)10	17920.3(a)10
OBTAIN PERMIT TO: <input type="checkbox"/> Repair Per Applicable Building Codes <input type="checkbox"/> Demolish Or Rehabilitate Structure		
6. <input checked="" type="checkbox"/> Hazardous Wiring <u>Unpermitted</u>	1001(e)	17920.3(d)
OBTAIN PERMIT TO: <input checked="" type="checkbox"/> Repair Per Applicable Building Codes <input checked="" type="checkbox"/> Demolish Or Rehabilitate Structure		
7. <input type="checkbox"/> Lack of adequate heating facilities.....	1001(o)6	17920.3(a)6
OBTAIN PERMIT TO: <input type="checkbox"/> Repair Per Applicable Building Codes <input type="checkbox"/> Demolish Or Rehabilitate Structure		
8. <input type="checkbox"/> Deteriorated or inadequate foundation.....	1001(e)1	17920.3(b)1
OBTAIN PERMIT TO: <input type="checkbox"/> Repair Per Applicable Building Codes <input type="checkbox"/> Demolish Or Rehabilitate Structure		
9. <input type="checkbox"/> Defective or deteriorated flooring or floor supports.....	1001(e)2	17920.3(b)2
OBTAIN PERMIT TO: <input type="checkbox"/> Repair Per Applicable Building Codes <input type="checkbox"/> Demolish Or Rehabilitate Structure		
10. <input checked="" type="checkbox"/> Members of walls, partitions or other vertical supports that split, lean, list or buckle due to defective material or deterioration.....	1001(c)4	17920.3(b)4
OBTAIN PERMIT TO: <input checked="" type="checkbox"/> Repair Per Applicable Building Codes <input checked="" type="checkbox"/> Demolish Or Rehabilitate Structure		
11. <input checked="" type="checkbox"/> Members of ceilings, roofs, ceiling and roof supports or other horizontal members which sag, split, or buckle due to defective material or deterioration.....	1001(e)6	17920.3(b)6
OBTAIN PERMIT TO: <input checked="" type="checkbox"/> Repair Per Applicable Building Codes <input checked="" type="checkbox"/> Demolish Or Rehabilitate Structure		
12. <input checked="" type="checkbox"/> Dampness of habitable rooms.....	1001(b)11	17920.3(a)11
OBTAIN PERMIT TO: <input checked="" type="checkbox"/> Repair Per Applicable Building Codes <input checked="" type="checkbox"/> Demolish Or Rehabilitate Structure		
13. <input checked="" type="checkbox"/> Faulty weather protection.....	1001(h)1-4	17920.3(g)1-4
A. Deteriorated or ineffective weather proofing of exterior walls, roof or floors including broken windows or doors, lack of paint or other approved wall covering.		
OBTAIN PERMIT TO: <input checked="" type="checkbox"/> Repair Per Applicable Building Codes <input checked="" type="checkbox"/> Demolish Or Rehabilitate Structure		
14. <input checked="" type="checkbox"/> General dilapidation or improper maintenance.....	1001(b)13	17920.3(a)13
OBTAIN PERMIT TO: <input checked="" type="checkbox"/> Repair Per Applicable Building Codes <input checked="" type="checkbox"/> Demolish Or Rehabilitate Structure		
15. <input type="checkbox"/> Fire hazard.....	1001(i)	17920.3(h)
OBTAIN PERMIT TO: <input type="checkbox"/> Repair Per Applicable Building Codes <input type="checkbox"/> Demolish Or Rehabilitate Structure		
16. <input type="checkbox"/> Extensive fire damage.....		
OBTAIN PERMIT TO: <input type="checkbox"/> Repair Per Applicable Building Codes <input type="checkbox"/> Demolish Or Rehabilitate Structure		
17. <input checked="" type="checkbox"/> Public and attractive nuisance - abandoned/vacant.....		
OBTAIN PERMIT TO: <input checked="" type="checkbox"/> Repair Per Applicable Building Codes <input checked="" type="checkbox"/> Demolish Or Rehabilitate Structure		
18. <input type="checkbox"/> Improper occupancy.....	1001(n)	17920.3(n)
OBTAIN PERMIT TO: <input type="checkbox"/> Repair Per Applicable Building Codes <input type="checkbox"/> Demolish Or Rehabilitate Structure		
19. <input checked="" type="checkbox"/> <u>Unpermitted</u>		
OBTAIN PERMIT TO: <input checked="" type="checkbox"/> Repair Per Applicable Building Codes <input checked="" type="checkbox"/> Demolish Or Rehabilitate Structure		
20. <input type="checkbox"/>		
OBTAIN PERMIT TO: <input type="checkbox"/> Repair Per Applicable Building Codes <input type="checkbox"/> Demolish Or Rehabilitate Structure		

*** YOU MUST CORRECT THE ABOVE CONDITIONS WITHIN 30 DAYS OF THE DATE OF THIS NOTICE

Case No. CV10-00386 Address 21665 Eucalyptus Ln, Perris
Date 1/15/10 Officer J. Morris

SSS#

RIVERSIDE COUNTY CODE ENFORCEMENT DEPARTMENT CODE ENFORCEMENT NOTICE OF DEFECTS

UNIFORM HOUSING HEALTH & SAFETY
CODE SECTIONS CODE SECTIONS

SUBSTANDARD BUILDING CONDITIONS:

- | | | |
|--|--------------|-----------------|
| 1. <input type="checkbox"/> Lack of or improper water closet, lavatory, bathtub, shower or kitchen sink..... | 1001(b)1,2,3 | 17920.3(a)1,2,3 |
| OBTAIN PERMIT TO: <input type="checkbox"/> Repair Per Applicable Building Codes <input type="checkbox"/> Demolish Or Rehabilitate Structure | | |
| 2. <input type="checkbox"/> Lack of hot and cold running water to plumbing fixtures | 1001(b)4,5 | 17920.3(a)4,5 |
| OBTAIN PERMIT TO: <input type="checkbox"/> Repair Per Applicable Building Codes <input type="checkbox"/> Demolish Or Rehabilitate Structure | | |
| 3. <input type="checkbox"/> Lack of connection to required sewage system..... | 1001(b)14 | 17920.3(a)14 |
| OBTAIN PERMIT TO: <input type="checkbox"/> Repair Per Applicable Building Codes <input type="checkbox"/> Demolish Or Rehabilitate Structure | | |
| 4. <input type="checkbox"/> Hazardous plumbing..... | 1001(f) | 17920.3(e) |
| OBTAIN PERMIT TO: <input type="checkbox"/> Repair Per Applicable Building Codes <input type="checkbox"/> Demolish Or Rehabilitate Structure | | |
| 5. <input type="checkbox"/> Lack of required electrical lighting..... | 1001(b)10 | 17920.3(a)10 |
| OBTAIN PERMIT TO: <input type="checkbox"/> Repair Per Applicable Building Codes <input type="checkbox"/> Demolish Or Rehabilitate Structure | | |
| 6. <input type="checkbox"/> Hazardous Wiring..... | 1001(e) | 17920.3(d) |
| OBTAIN PERMIT TO: <input type="checkbox"/> Repair Per Applicable Building Codes <input type="checkbox"/> Demolish Or Rehabilitate Structure | | |
| 7. <input type="checkbox"/> Lack of adequate heating facilities..... | 1001(o)6 | 17920.3(a)6 |
| OBTAIN PERMIT TO: <input type="checkbox"/> Repair Per Applicable Building Codes <input type="checkbox"/> Demolish Or Rehabilitate Structure | | |
| 8. <input type="checkbox"/> Deteriorated or inadequate foundation..... | 1001(c)1 | 17920.3(b)1 |
| OBTAIN PERMIT TO: <input type="checkbox"/> Repair Per Applicable Building Codes <input type="checkbox"/> Demolish Or Rehabilitate Structure | | |
| 9. <input type="checkbox"/> Defective or deteriorated flooring or floor supports..... | 1001(c)2 | 17920.3(b)2 |
| OBTAIN PERMIT TO: <input type="checkbox"/> Repair Per Applicable Building Codes <input type="checkbox"/> Demolish Or Rehabilitate Structure | | |
| 10. <input checked="" type="checkbox"/> Members of walls, partitions or other vertical supports that split, lean, list or buckle
due to defective material or deterioration..... | 1001(c)4 | 17920.3(b)4 |
| OBTAIN PERMIT TO: <input checked="" type="checkbox"/> Repair Per Applicable Building Codes <input checked="" type="checkbox"/> Demolish Or Rehabilitate Structure | | |
| 11. <input checked="" type="checkbox"/> Members of ceilings, roofs, ceiling and roof supports or other horizontal members
which sag, split, or buckle due to defective material or deterioration..... | 1001(c)6 | 17920.3(b)6 |
| OBTAIN PERMIT TO: <input checked="" type="checkbox"/> Repair Per Applicable Building Codes <input checked="" type="checkbox"/> Demolish Or Rehabilitate Structure | | |
| 12. <input checked="" type="checkbox"/> Dampness of habitable rooms..... | 1001(b)11 | 17920.3(a)11 |
| OBTAIN PERMIT TO: <input checked="" type="checkbox"/> Repair Per Applicable Building Codes <input checked="" type="checkbox"/> Demolish Or Rehabilitate Structure | | |
| 13. <input checked="" type="checkbox"/> Faulty weather protection..... | 1001(h)1-4 | 17920.3(g)1-4 |
| A. Deteriorated or ineffective weather proofing of exterior walls, roof or floors
including broken windows or doors, lack of paint or other approved wall covering. | | |
| OBTAIN PERMIT TO: <input checked="" type="checkbox"/> Repair Per Applicable Building Codes <input checked="" type="checkbox"/> Demolish Or Rehabilitate Structure | | |
| 14. <input checked="" type="checkbox"/> General dilapidation or improper maintenance..... | 1001(b)13 | 17920.3(a)13 |
| OBTAIN PERMIT TO: <input checked="" type="checkbox"/> Repair Per Applicable Building Codes <input checked="" type="checkbox"/> Demolish Or Rehabilitate Structure | | |
| 15. <input type="checkbox"/> Fire hazard..... | 1001(i) | 17920.3(h) |
| OBTAIN PERMIT TO: <input type="checkbox"/> Repair Per Applicable Building Codes <input type="checkbox"/> Demolish Or Rehabilitate Structure | | |
| 16. <input type="checkbox"/> Extensive fire damage..... | | |
| OBTAIN PERMIT TO: <input type="checkbox"/> Repair Per Applicable Building Codes <input type="checkbox"/> Demolish Or Rehabilitate Structure | | |
| 17. <input checked="" type="checkbox"/> Public and attractive nuisance - abandoned/vacant..... | | |
| OBTAIN PERMIT TO: <input checked="" type="checkbox"/> Repair Per Applicable Building Codes <input checked="" type="checkbox"/> Demolish Or Rehabilitate Structure | | |
| 18. <input type="checkbox"/> Improper occupancy..... | 1001(n) | 17920.3(n) |
| OBTAIN PERMIT TO: <input type="checkbox"/> Repair Per Applicable Building Codes <input type="checkbox"/> Demolish Or Rehabilitate Structure | | |
| 19. <input checked="" type="checkbox"/> <u>Unpermitted</u> | | |
| OBTAIN PERMIT TO: <input checked="" type="checkbox"/> Repair Per Applicable Building Codes <input checked="" type="checkbox"/> Demolish Or Rehabilitate Structure | | |
| 20. <input type="checkbox"/> | | |
| OBTAIN PERMIT TO: <input type="checkbox"/> Repair Per Applicable Building Codes <input type="checkbox"/> Demolish Or Rehabilitate Structure | | |

*** YOU MUST CORRECT THE ABOVE CONDITIONS WITHIN 30 DAYS OF THE DATE OF THIS NOTICE

Case No. CV10-00386 Address 21665 Eucalyptus, Perris

Date 1/15/10 Officer J. Morris

SSS#2



**CODE ENFORCEMENT DEPARTMENT
COUNTY OF RIVERSIDE**

JOHN BOYD
Director

AFFIDAVIT OF POSTING OF NOTICES

January 15, 2010

RE CASE NO: CV1000386

I, Jennifer Morris, hereby declare:

I am employed by the Riverside County Code Enforcement Department; that my business address is 24318 Hemlock, Ave., Suite C-1, Moreno Valley, California 92557 .

That on 1/15/10 at 09:50 hrs, I securely and conspicuously posted Notice of Violation for 15.16.020 (Substandard Structure), Notice of Defects for Substandard Structure, and Danger Do Not Enter Sign at the property described as:

Property Address: 21665 EUCALYPTUS LN, PERRIS

Assessor's Parcel Number: 325-060-013

I declare under the penalty of perjury that the foregoing is true and correct.

Executed on January 15, 2010 in the County of Riverside, California.

CODE ENFORCEMENT DEPARTMENT



By: Jennifer Morris, Code Enforcement Officer II

EXHIBIT NO. E4

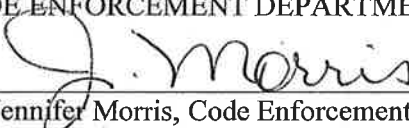

**CODE ENFORCEMENT DEPARTMENT
COUNTY OF RIVERSIDE**

JOHN BOYD
Director

NOTICE OF VIOLATION

January 19, 2010

JOHN B VELARDE / ELVIA O VELARDE
29873 SUN COUNTRY LN
SUN CITY, CA 92586

RE CASE NO: CV10-00386

NOTICE IS HEREBY GIVEN that property owned or controlled by you at 21665 EUCALYPTUS LN, PERRIS California, Assessor's Parcel Number 325-060-013, is in violation of Section(s) RCC Section No. 15.16.020 (Ord. 457), of the Riverside County Code.

Said violation is described as:

- 1) 15.16.020 (Ord. 457) - An inspection was made of the above-referenced subject property in response to complaints received by this office. The structure(s) was/were found to be substandard and a public nuisance in violation of Riverside County Code Section 15.16, and as such, was posted with a "Danger Do Not Enter" sign and a copy of the enclosed "Notice of Defects," which sets forth the conditions that render the building unsafe for human habitation.

NOTICE IS HEREBY GIVEN that failure to comply with this notice will result in further civil, criminal, or administrative proceedings for demolition of the structure(s) and abatement of the public nuisance and could result in the imposition of a lien on the subject property(ies) for costs, including attorney's fees, related to the enforcement of all ordinances and abatement of violative conditions. A "Notice of Noncompliance" has been recorded with the Riverside County Recorder's Office. At the conclusion of this case, you will receive a Statement of Expense associated with the abatement of such nuisance.

NOTICE IS FURTHER GIVEN that in accordance with Sections 17274 and 24436.5 of the Revenue and Taxation Code, a tax deduction may not be allowed for interest, taxes, depreciation, or amortization paid or incurred in the taxable year affected by these abatement proceedings.

YOU ARE HEREBY REQUIRED TO COMPLY with the provisions of the ordinance by:

- 1) THE OWNER OF RECORD of the subject property is hereby noticed and ordered within thirty (30) days of this notice to obtain all necessary permits from the Department of Building and Safety and to correct or abate the unsafe conditions either by repairing all violative conditions indicated in the attached "Notice of Defects" or demolition and removal of the structure(s). ALL PARTIES WITH INTEREST in the subject property may comply with the provisions of this notice within fifteen (15) days after the expiration of the thirty (30) day period.

COMPLIANCE MUST BE COMPLETED BY February 19, 2010. FAILURE TO COMPLY WILL RESULT IN LEGAL ACTION BEING BROUGHT AGAINST YOU.

NOTICE IS HEREBY GIVEN THAT AT THE CONCLUSION OF THIS CASE YOU WILL RECEIVE A SUMMARY OF ADMINISTRATIVE COSTS ASSOCIATED WITH THE PROCESSING OF SUCH VIOLATION(S), AT AN HOURLY RATE OF \$109.00 AS DETERMINED BY THE BOARD OF SUPERVISORS.

YOU WILL HAVE THE RIGHT TO OBJECT TO THESE CHARGES BY FILING A REQUEST FOR HEARING WITH THE DEPARTMENT OF CODE ENFORCEMENT WITHIN TEN (10) DAYS OF SERVICE OF THE SUMMARY OF CHARGES, PURSUANT TO SECTION 1.16.080 OF RIVERSIDE COUNTY CODE.

CODE ENFORCEMENT DEPARTMENT

By: Jennifer Morris, Code Enforcement Officer II

EXHIBIT NO. E6

RIVERSIDE COUNTY CODE ENFORCEMENT DEPARTMENT CODE ENFORCEMENT NOTICE OF DEFECTS

UNIFORM HOUSING HEALTH & SAFETY
CODE SECTIONS CODE SECTIONS

SUBSTANDARD BUILDING CONDITIONS:

	UNIFORM HOUSING CODE SECTIONS	HEALTH & SAFETY CODE SECTIONS
1. <input checked="" type="checkbox"/> Lack of or improper water closet, lavatory, bathtub, shower or kitchen sink.....	1001(b)1,2,3	17920.3(a)1,2,3
OBTAIN PERMIT TO: <input checked="" type="checkbox"/> Repair Per Applicable Building Codes <input checked="" type="checkbox"/> Demolish Or Rehabilitate Structure		
2. <input type="checkbox"/> Lack of hot and cold running water to plumbing fixtures	1001(b)4,5	17920.3(a)4,5
OBTAIN PERMIT TO: <input type="checkbox"/> Repair Per Applicable Building Codes <input type="checkbox"/> Demolish Or Rehabilitate Structure		
3. <input type="checkbox"/> Lack of connection to required sewage system.....	1001(b)14	17920.3(a)14
OBTAIN PERMIT TO: <input type="checkbox"/> Repair Per Applicable Building Codes <input type="checkbox"/> Demolish Or Rehabilitate Structure		
4. <input type="checkbox"/> Hazardous plumbing.....	1001(f)	17920.3(e)
OBTAIN PERMIT TO: <input type="checkbox"/> Repair Per Applicable Building Codes <input type="checkbox"/> Demolish Or Rehabilitate Structure		
5. <input type="checkbox"/> Lack of required electrical lighting.....	1001(b)10	17920.3(a)10
OBTAIN PERMIT TO: <input type="checkbox"/> Repair Per Applicable Building Codes <input type="checkbox"/> Demolish Or Rehabilitate Structure		
6. <input checked="" type="checkbox"/> Hazardous Wiring <u>Unpermitted</u>	1001(e)	17920.3(d)
OBTAIN PERMIT TO: <input checked="" type="checkbox"/> Repair Per Applicable Building Codes <input checked="" type="checkbox"/> Demolish Or Rehabilitate Structure		
7. <input type="checkbox"/> Lack of adequate heating facilities.....	1001(o)6	17920.3(a)6
OBTAIN PERMIT TO: <input type="checkbox"/> Repair Per Applicable Building Codes <input type="checkbox"/> Demolish Or Rehabilitate Structure		
8. <input type="checkbox"/> Deteriorated or inadequate foundation.....	1001(c)1	17920.3(b)1
OBTAIN PERMIT TO: <input type="checkbox"/> Repair Per Applicable Building Codes <input type="checkbox"/> Demolish Or Rehabilitate Structure		
9. <input type="checkbox"/> Defective or deteriorated flooring or floor supports.....	1001(c)2	17920.3(b)2
OBTAIN PERMIT TO: <input type="checkbox"/> Repair Per Applicable Building Codes <input type="checkbox"/> Demolish Or Rehabilitate Structure		
10. <input checked="" type="checkbox"/> Members of walls, partitions or other vertical supports that split, lean, list or buckle due to defective material or deterioration.....	1001(c)4	17920.3(b)4
OBTAIN PERMIT TO: <input checked="" type="checkbox"/> Repair Per Applicable Building Codes <input checked="" type="checkbox"/> Demolish Or Rehabilitate Structure		
11. <input checked="" type="checkbox"/> Members of ceilings, roofs, ceiling and roof supports or other horizontal members which sag, split, or buckle due to defective material or deterioration.....	1001(c)6	17920.3(b)6
OBTAIN PERMIT TO: <input checked="" type="checkbox"/> Repair Per Applicable Building Codes <input checked="" type="checkbox"/> Demolish Or Rehabilitate Structure		
12. <input checked="" type="checkbox"/> Dampness of habitable rooms.....	1001(b)11	17920.3(a)11
OBTAIN PERMIT TO: <input checked="" type="checkbox"/> Repair Per Applicable Building Codes <input checked="" type="checkbox"/> Demolish Or Rehabilitate Structure		
13. <input checked="" type="checkbox"/> Faulty weather protection.....	1001(h)1-4	17920.3(g)1-4
A. Deteriorated or ineffective weather proofing of exterior walls, roof or floors including broken windows or doors, lack of paint or other approved wall covering.		
OBTAIN PERMIT TO: <input checked="" type="checkbox"/> Repair Per Applicable Building Codes <input checked="" type="checkbox"/> Demolish Or Rehabilitate Structure		
14. <input checked="" type="checkbox"/> General dilapidation or improper maintenance.....	1001(b)13	17920.3(a)13
OBTAIN PERMIT TO: <input checked="" type="checkbox"/> Repair Per Applicable Building Codes <input checked="" type="checkbox"/> Demolish Or Rehabilitate Structure		
15. <input type="checkbox"/> Fire hazard.....	1001(i)	17920.3(h)
OBTAIN PERMIT TO: <input type="checkbox"/> Repair Per Applicable Building Codes <input type="checkbox"/> Demolish Or Rehabilitate Structure		
16. <input type="checkbox"/> Extensive fire damage.....		
OBTAIN PERMIT TO: <input type="checkbox"/> Repair Per Applicable Building Codes <input type="checkbox"/> Demolish Or Rehabilitate Structure		
17. <input checked="" type="checkbox"/> Public and attractive nuisance - abandoned/vacant.....		
OBTAIN PERMIT TO: <input checked="" type="checkbox"/> Repair Per Applicable Building Codes <input checked="" type="checkbox"/> Demolish Or Rehabilitate Structure		
18. <input type="checkbox"/> Improper occupancy.....	1001(n)	17920.3(n)
OBTAIN PERMIT TO: <input type="checkbox"/> Repair Per Applicable Building Codes <input type="checkbox"/> Demolish Or Rehabilitate Structure		
19. <input checked="" type="checkbox"/> <u>Unpermitted</u>		
OBTAIN PERMIT TO: <input checked="" type="checkbox"/> Repair Per Applicable Building Codes <input checked="" type="checkbox"/> Demolish Or Rehabilitate Structure		
20. <input type="checkbox"/>		
OBTAIN PERMIT TO: <input type="checkbox"/> Repair Per Applicable Building Codes <input type="checkbox"/> Demolish Or Rehabilitate Structure		

***** YOU MUST CORRECT THE ABOVE CONDITIONS WITHIN 30 DAYS OF THE DATE OF THIS NOTICE**

Case No. CV10-00386 Address 21665 Eucalyptus Ln, Perris

Date 1/15/10 Officer J. Morris

SSS#1

RIVERSIDE COUNTY CODE ENFORCEMENT DEPARTMENT CODE ENFORCEMENT NOTICE OF DEFECTS

UNIFORM HOUSING HEALTH & SAFETY
CODE SECTIONS CODE SECTIONS

SUBSTANDARD BUILDING CONDITIONS:

1. <input type="checkbox"/> Lack of or improper water closet, lavatory, bathtub, shower or kitchen sink.....	1001(b)1,2,3	17920.3(a)1,2,3
OBTAIN PERMIT TO: <input type="checkbox"/> Repair Per Applicable Building Codes <input type="checkbox"/> Demolish Or Rehabilitate Structure		
2. <input type="checkbox"/> Lack of hot and cold running water to plumbing fixtures	1001(b)4,5	17920.3(a)4,5
OBTAIN PERMIT TO: <input type="checkbox"/> Repair Per Applicable Building Codes <input type="checkbox"/> Demolish Or Rehabilitate Structure		
3. <input type="checkbox"/> Lack of connection to required sewage system.....	1001(b)14	17920.3(a)14
OBTAIN PERMIT TO: <input type="checkbox"/> Repair Per Applicable Building Codes <input type="checkbox"/> Demolish Or Rehabilitate Structure		
4. <input type="checkbox"/> Hazardous plumbing.....	1001(f)	17920.3(e)
OBTAIN PERMIT TO: <input type="checkbox"/> Repair Per Applicable Building Codes <input type="checkbox"/> Demolish Or Rehabilitate Structure		
5. <input type="checkbox"/> Lack of required electrical lighting.....	1001(b)10	17920.3(a)10
OBTAIN PERMIT TO: <input type="checkbox"/> Repair Per Applicable Building Codes <input type="checkbox"/> Demolish Or Rehabilitate Structure		
6. <input type="checkbox"/> Hazardous Wiring.....	1001(e)	17920.3(d)
OBTAIN PERMIT TO: <input type="checkbox"/> Repair Per Applicable Building Codes <input type="checkbox"/> Demolish Or Rehabilitate Structure		
7. <input type="checkbox"/> Lack of adequate heating facilities.....	1001(c)6	17920.3(a)6
OBTAIN PERMIT TO: <input type="checkbox"/> Repair Per Applicable Building Codes <input type="checkbox"/> Demolish Or Rehabilitate Structure		
8. <input type="checkbox"/> Deteriorated or inadequate foundation.....	1001(c)1	17920.3(b)1
OBTAIN PERMIT TO: <input type="checkbox"/> Repair Per Applicable Building Codes <input type="checkbox"/> Demolish Or Rehabilitate Structure		
9. <input type="checkbox"/> Defective or deteriorated flooring or floor supports.....	1001(c)2	17920.3(b)2
OBTAIN PERMIT TO: <input type="checkbox"/> Repair Per Applicable Building Codes <input type="checkbox"/> Demolish Or Rehabilitate Structure		
10. <input checked="" type="checkbox"/> Members of walls, partitions or other vertical supports that split, lean, list or buckle due to defective material or deterioration.....	1001(c)4	17920.3(b)4
OBTAIN PERMIT TO: <input checked="" type="checkbox"/> Repair Per Applicable Building Codes <input checked="" type="checkbox"/> Demolish Or Rehabilitate Structure		
11. <input checked="" type="checkbox"/> Members of ceilings, roofs, ceiling and roof supports or other horizontal members which sag, split, or buckle due to defective material or deterioration.....	1001(c)6	17920.3(b)6
OBTAIN PERMIT TO: <input checked="" type="checkbox"/> Repair Per Applicable Building Codes <input checked="" type="checkbox"/> Demolish Or Rehabilitate Structure		
12. <input checked="" type="checkbox"/> Dampness of habitable rooms.....	1001(b)11	17920.3(a)11
OBTAIN PERMIT TO: <input checked="" type="checkbox"/> Repair Per Applicable Building Codes <input checked="" type="checkbox"/> Demolish Or Rehabilitate Structure		
13. <input checked="" type="checkbox"/> Faulty weather protection.....	1001(h)1-4	17920.3(g)1-4
A. Deteriorated or ineffective weather proofing of exterior walls, roof or floors including broken windows or doors, lack of paint or other approved wall covering.		
OBTAIN PERMIT TO: <input checked="" type="checkbox"/> Repair Per Applicable Building Codes <input checked="" type="checkbox"/> Demolish Or Rehabilitate Structure		
14. <input checked="" type="checkbox"/> General dilapidation or improper maintenance.....	1001(b)13	17920.3(a)13
OBTAIN PERMIT TO: <input checked="" type="checkbox"/> Repair Per Applicable Building Codes <input checked="" type="checkbox"/> Demolish Or Rehabilitate Structure		
15. <input type="checkbox"/> Fire hazard.....	1001(i)	17920.3(h)
OBTAIN PERMIT TO: <input type="checkbox"/> Repair Per Applicable Building Codes <input type="checkbox"/> Demolish Or Rehabilitate Structure		
16. <input type="checkbox"/> Extensive fire damage.....		
OBTAIN PERMIT TO: <input type="checkbox"/> Repair Per Applicable Building Codes <input type="checkbox"/> Demolish Or Rehabilitate Structure		
17. <input checked="" type="checkbox"/> Public and attractive nuisance - abandoned/vacant.....		
OBTAIN PERMIT TO: <input checked="" type="checkbox"/> Repair Per Applicable Building Codes <input checked="" type="checkbox"/> Demolish Or Rehabilitate Structure		
18. <input type="checkbox"/> Improper occupancy.....	1001(n)	17920.3(n)
OBTAIN PERMIT TO: <input type="checkbox"/> Repair Per Applicable Building Codes <input type="checkbox"/> Demolish Or Rehabilitate Structure		
19. <input checked="" type="checkbox"/> Unpermitted		
OBTAIN PERMIT TO: <input checked="" type="checkbox"/> Repair Per Applicable Building Codes <input checked="" type="checkbox"/> Demolish Or Rehabilitate Structure		
20. <input type="checkbox"/>		
OBTAIN PERMIT TO: <input type="checkbox"/> Repair Per Applicable Building Codes <input type="checkbox"/> Demolish Or Rehabilitate Structure		

*** YOU MUST CORRECT THE ABOVE CONDITIONS WITHIN 30 DAYS OF THE DATE OF THIS NOTICE

Case No. CV10-00386 Address 21665 Eucalyptus, Perris

Date 1/15/10 Officer J. Morris

SSS#2



**CODE ENFORCEMENT DEPARTMENT
COUNTY OF RIVERSIDE**

JOHN BOYD
Director

NOTICE OF VIOLATION

January 19, 2010

JOHN B VELARDE / ELVIA O VELARDE
21665 EUCALYPTUS LN
PERRIS, CA 92570

RE CASE NO: CV10-00386

NOTICE IS HEREBY GIVEN that property owned or controlled by you at 21665 EUCALYPTUS LN, PERRIS California, Assessor's Parcel Number 325-060-013, is in violation of Section(s) RCC Section No. 15.16.020 (Ord. 457), of the Riverside County Code.

Said violation is described as:

- 1) 15.16.020 (Ord. 457) - An inspection was made of the above-referenced subject property in response to complaints received by this office. The structure(s) was/were found to be substandard and a public nuisance in violation of Riverside County Code Section 15.16, and as such, was posted with a "Danger Do Not Enter" sign and a copy of the enclosed "Notice of Defects," which sets forth the conditions that render the building unsafe for human habitation.

NOTICE IS HEREBY GIVEN that failure to comply with this notice will result in further civil, criminal, or administrative proceedings for demolition of the structure(s) and abatement of the public nuisance and could result in the imposition of a lien on the subject property(ies) for costs, including attorney's fees, related to the enforcement of all ordinances and abatement of violative conditions. A "Notice of Noncompliance" has been recorded with the Riverside County Recorder's Office. At the conclusion of this case, you will receive a Statement of Expense associated with the abatement of such nuisance.

NOTICE IS FURTHER GIVEN that in accordance with Sections 17274 and 24436.5 of the Revenue and Taxation Code, a tax deduction may not be allowed for interest, taxes, depreciation, or amortization paid or incurred in the taxable year affected by these abatement proceedings.

YOU ARE HEREBY REQUIRED TO COMPLY with the provisions of the ordinance by:

- 1) THE OWNER OF RECORD of the subject property is hereby noticed and ordered within thirty (30) days of this notice to obtain all necessary permits from the Department of Building and Safety and to correct or abate the unsafe conditions either by repairing all violative conditions indicated in the attached "Notice of Defects" or demolition and removal of the structure(s). ALL PARTIES WITH INTEREST in the subject property may comply with the provisions of this notice within fifteen (15) days after the expiration of the thirty (30) day period.

COMPLIANCE MUST BE COMPLETED BY February 19, 2010. FAILURE TO COMPLY WILL RESULT IN LEGAL ACTION BEING BROUGHT AGAINST YOU.

NOTICE IS HEREBY GIVEN THAT AT THE CONCLUSION OF THIS CASE YOU WILL RECEIVE A SUMMARY OF ADMINISTRATIVE COSTS ASSOCIATED WITH THE PROCESSING OF SUCH VIOLATION(S), AT AN HOURLY RATE OF \$109.00 AS DETERMINED BY THE BOARD OF SUPERVISORS.

24318 HEMLOCK AVE., SUITE C-1, MORENO
(951) 485-5840 • FAX (9

EXHIBIT NO. E⁹

YOU WILL HAVE THE RIGHT TO OBJECT TO THESE CHARGES BY FILING A REQUEST FOR HEARING WITH THE DEPARTMENT OF CODE ENFORCEMENT WITHIN TEN (10) DAYS OF SERVICE OF THE SUMMARY OF CHARGES, PURSUANT TO SECTION 1.16.080 OF RIVERSIDE COUNTY CODE.

CODE ENFORCEMENT DEPARTMENT

By: Jennifer Morris, Code Enforcement Officer II

EXHIBIT NO. E¹⁰

RIVERSIDE COUNTY CODE ENFORCEMENT DEPARTMENT CODE ENFORCEMENT NOTICE OF DEFECTS

UNIFORM HOUSING HEALTH & SAFETY
CODE SECTIONS CODE SECTIONS

SUBSTANDARD BUILDING CONDITIONS:

	UNIFORM HOUSING CODE SECTIONS	HEALTH & SAFETY CODE SECTIONS
1. <input checked="" type="checkbox"/> Lack of or improper water closet, lavatory, bathtub, shower or kitchen sink.....	1001(b)1,2,3	17920.3(a)1,2,3
OBTAIN PERMIT TO: <input checked="" type="checkbox"/> Repair Per Applicable Building Codes <input checked="" type="checkbox"/> Demolish Or Rehabilitate Structure		
2. <input type="checkbox"/> Lack of hot and cold running water to plumbing fixtures	1001(b)4,5	17920.3(a)4,5
OBTAIN PERMIT TO: <input type="checkbox"/> Repair Per Applicable Building Codes <input type="checkbox"/> Demolish Or Rehabilitate Structure		
3. <input type="checkbox"/> Lack of connection to required sewage system.....	1001(b)14	17920.3(a)14
OBTAIN PERMIT TO: <input type="checkbox"/> Repair Per Applicable Building Codes <input type="checkbox"/> Demolish Or Rehabilitate Structure		
4. <input type="checkbox"/> Hazardous plumbing.....	1001(f)	17920.3(e)
OBTAIN PERMIT TO: <input type="checkbox"/> Repair Per Applicable Building Codes <input type="checkbox"/> Demolish Or Rehabilitate Structure		
5. <input type="checkbox"/> Lack of required electrical lighting.....	1001(b)10	17920.3(a)10
OBTAIN PERMIT TO: <input type="checkbox"/> Repair Per Applicable Building Codes <input type="checkbox"/> Demolish Or Rehabilitate Structure		
6. <input checked="" type="checkbox"/> Hazardous Wiring <u>Unpermitted</u>	1001(e)	17920.3(d)
OBTAIN PERMIT TO: <input checked="" type="checkbox"/> Repair Per Applicable Building Codes <input checked="" type="checkbox"/> Demolish Or Rehabilitate Structure		
7. <input type="checkbox"/> Lack of adequate heating facilities.....	1001(o)6	17920.3(a)6
OBTAIN PERMIT TO: <input type="checkbox"/> Repair Per Applicable Building Codes <input type="checkbox"/> Demolish Or Rehabilitate Structure		
8. <input type="checkbox"/> Deteriorated or inadequate foundation.....	1001(c)1	17920.3(b)1
OBTAIN PERMIT TO: <input type="checkbox"/> Repair Per Applicable Building Codes <input type="checkbox"/> Demolish Or Rehabilitate Structure		
9. <input type="checkbox"/> Defective or deteriorated flooring or floor supports.....	1001(c)2	17920.3(b)2
OBTAIN PERMIT TO: <input type="checkbox"/> Repair Per Applicable Building Codes <input type="checkbox"/> Demolish Or Rehabilitate Structure		
10. <input checked="" type="checkbox"/> Members of walls, partitions or other vertical supports that split, lean, list or buckle due to defective material or deterioration.....	1001(c)4	17920.3(b)4
OBTAIN PERMIT TO: <input checked="" type="checkbox"/> Repair Per Applicable Building Codes <input checked="" type="checkbox"/> Demolish Or Rehabilitate Structure		
11. <input checked="" type="checkbox"/> Members of ceilings, roofs, ceiling and roof supports or other horizontal members which sag, split, or buckle due to defective material or deterioration.....	1001(c)6	17920.3(b)6
OBTAIN PERMIT TO: <input checked="" type="checkbox"/> Repair Per Applicable Building Codes <input checked="" type="checkbox"/> Demolish Or Rehabilitate Structure		
12. <input checked="" type="checkbox"/> Dampness of habitable rooms.....	1001(b)11	17920.3(a)11
OBTAIN PERMIT TO: <input checked="" type="checkbox"/> Repair Per Applicable Building Codes <input checked="" type="checkbox"/> Demolish Or Rehabilitate Structure		
13. <input checked="" type="checkbox"/> Faulty weather protection.....	1001(h)1-4	17920.3(g)1-4
A. Deteriorated or ineffective weather proofing of exterior walls, roof or floors including broken windows or doors, lack of paint or other approved wall covering.		
OBTAIN PERMIT TO: <input checked="" type="checkbox"/> Repair Per Applicable Building Codes <input checked="" type="checkbox"/> Demolish Or Rehabilitate Structure		
14. <input checked="" type="checkbox"/> General dilapidation or improper maintenance.....	1001(b)13	17920.3(a)13
OBTAIN PERMIT TO: <input checked="" type="checkbox"/> Repair Per Applicable Building Codes <input checked="" type="checkbox"/> Demolish Or Rehabilitate Structure		
15. <input type="checkbox"/> Fire hazard.....	1001(i)	17920.3(h)
OBTAIN PERMIT TO: <input type="checkbox"/> Repair Per Applicable Building Codes <input type="checkbox"/> Demolish Or Rehabilitate Structure		
16. <input type="checkbox"/> Extensive fire damage.....		
OBTAIN PERMIT TO: <input type="checkbox"/> Repair Per Applicable Building Codes <input type="checkbox"/> Demolish Or Rehabilitate Structure		
17. <input checked="" type="checkbox"/> Public and attractive nuisance - abandoned/vacant.....		
OBTAIN PERMIT TO: <input checked="" type="checkbox"/> Repair Per Applicable Building Codes <input checked="" type="checkbox"/> Demolish Or Rehabilitate Structure		
18. <input type="checkbox"/> Improper occupancy.....	1001(n)	17920.3(n)
OBTAIN PERMIT TO: <input type="checkbox"/> Repair Per Applicable Building Codes <input type="checkbox"/> Demolish Or Rehabilitate Structure		
19. <input checked="" type="checkbox"/> <u>Unpermitted</u>		
OBTAIN PERMIT TO: <input checked="" type="checkbox"/> Repair Per Applicable Building Codes <input checked="" type="checkbox"/> Demolish Or Rehabilitate Structure		
20. <input type="checkbox"/>		
OBTAIN PERMIT TO: <input type="checkbox"/> Repair Per Applicable Building Codes <input type="checkbox"/> Demolish Or Rehabilitate Structure		

***** YOU MUST CORRECT THE ABOVE CONDITIONS WITHIN 30 DAYS OF THE DATE OF THIS NOTICE**

Case No. CV10-00386 Address 21665 Eucalyptus Ln, Perris

Date 1/15/10 Officer J. Morris

SSS#1

RIVERSIDE COUNTY CODE ENFORCEMENT DEPARTMENT CODE ENFORCEMENT NOTICE OF DEFECTS

UNIFORM HOUSING HEALTH & SAFETY
CODE SECTIONS CODE SECTIONS

SUBSTANDARD BUILDING CONDITIONS:

1. <input type="checkbox"/> Lack of or improper water closet, lavatory, bathtub, shower or kitchen sink.....	1001(b)1,2,3	17920.3(a)1,2,3
OBTAIN PERMIT TO: <input type="checkbox"/> Repair Per Applicable Building Codes <input type="checkbox"/> Demolish Or Rehabilitate Structure		
2. <input type="checkbox"/> Lack of hot and cold running water to plumbing fixtures	1001(b)4,5	17920.3(a)4,5
OBTAIN PERMIT TO: <input type="checkbox"/> Repair Per Applicable Building Codes <input type="checkbox"/> Demolish Or Rehabilitate Structure		
3. <input type="checkbox"/> Lack of connection to required sewage system.....	1001(b)14	17920.3(a)14
OBTAIN PERMIT TO: <input type="checkbox"/> Repair Per Applicable Building Codes <input type="checkbox"/> Demolish Or Rehabilitate Structure		
4. <input type="checkbox"/> Hazardous plumbing.....	1001(f)	17920.3(e)
OBTAIN PERMIT TO: <input type="checkbox"/> Repair Per Applicable Building Codes <input type="checkbox"/> Demolish Or Rehabilitate Structure		
5. <input type="checkbox"/> Lack of required electrical lighting.....	1001(b)10	17920.3(a)10
OBTAIN PERMIT TO: <input type="checkbox"/> Repair Per Applicable Building Codes <input type="checkbox"/> Demolish Or Rehabilitate Structure		
6. <input type="checkbox"/> Hazardous Wiring.....	1001(e)	17920.3(d)
OBTAIN PERMIT TO: <input type="checkbox"/> Repair Per Applicable Building Codes <input type="checkbox"/> Demolish Or Rehabilitate Structure		
7. <input type="checkbox"/> Lack of adequate heating facilities.....	1001(c)6	17920.3(a)6
OBTAIN PERMIT TO: <input type="checkbox"/> Repair Per Applicable Building Codes <input type="checkbox"/> Demolish Or Rehabilitate Structure		
8. <input type="checkbox"/> Deteriorated or inadequate foundation.....	1001(c)1	17920.3(b)1
OBTAIN PERMIT TO: <input type="checkbox"/> Repair Per Applicable Building Codes <input type="checkbox"/> Demolish Or Rehabilitate Structure		
9. <input type="checkbox"/> Defective or deteriorated flooring or floor supports.....	1001(c)2	17920.3(b)2
OBTAIN PERMIT TO: <input type="checkbox"/> Repair Per Applicable Building Codes <input type="checkbox"/> Demolish Or Rehabilitate Structure		
10. <input checked="" type="checkbox"/> Members of walls, partitions or other vertical supports that split, lean, list or buckle due to defective material or deterioration.....	1001(c)4	17920.3(b)4
OBTAIN PERMIT TO: <input checked="" type="checkbox"/> Repair Per Applicable Building Codes <input checked="" type="checkbox"/> Demolish Or Rehabilitate Structure		
11. <input checked="" type="checkbox"/> Members of ceilings, roofs, ceiling and roof supports or other horizontal members which sag, split, or buckle due to defective material or deterioration.....	1001(c)6	17920.3(b)6
OBTAIN PERMIT TO: <input checked="" type="checkbox"/> Repair Per Applicable Building Codes <input checked="" type="checkbox"/> Demolish Or Rehabilitate Structure		
12. <input checked="" type="checkbox"/> Dampness of habitable rooms.....	1001(b)11	17920.3(a)11
OBTAIN PERMIT TO: <input checked="" type="checkbox"/> Repair Per Applicable Building Codes <input checked="" type="checkbox"/> Demolish Or Rehabilitate Structure		
13. <input checked="" type="checkbox"/> Faulty weather protection.....	1001(h)1-4	17920.3(g)1-4
A. Deteriorated or ineffective weather proofing of exterior walls, roof or floors including broken windows or doors, lack of paint or other approved wall covering.		
OBTAIN PERMIT TO: <input checked="" type="checkbox"/> Repair Per Applicable Building Codes <input checked="" type="checkbox"/> Demolish Or Rehabilitate Structure		
14. <input checked="" type="checkbox"/> General dilapidation or improper maintenance.....	1001(b)13	17920.3(a)13
OBTAIN PERMIT TO: <input checked="" type="checkbox"/> Repair Per Applicable Building Codes <input checked="" type="checkbox"/> Demolish Or Rehabilitate Structure		
15. <input type="checkbox"/> Fire hazard.....	1001(i)	17920.3(h)
OBTAIN PERMIT TO: <input type="checkbox"/> Repair Per Applicable Building Codes <input type="checkbox"/> Demolish Or Rehabilitate Structure		
16. <input type="checkbox"/> Extensive fire damage.....		
OBTAIN PERMIT TO: <input type="checkbox"/> Repair Per Applicable Building Codes <input type="checkbox"/> Demolish Or Rehabilitate Structure		
17. <input checked="" type="checkbox"/> Public and attractive nuisance - abandoned/vacant.....		
OBTAIN PERMIT TO: <input checked="" type="checkbox"/> Repair Per Applicable Building Codes <input checked="" type="checkbox"/> Demolish Or Rehabilitate Structure		
18. <input type="checkbox"/> Improper occupancy.....	1001(n)	17920.3(n)
OBTAIN PERMIT TO: <input type="checkbox"/> Repair Per Applicable Building Codes <input type="checkbox"/> Demolish Or Rehabilitate Structure		
19. <input checked="" type="checkbox"/> <u>Unpermitted</u>		
OBTAIN PERMIT TO: <input checked="" type="checkbox"/> Repair Per Applicable Building Codes <input checked="" type="checkbox"/> Demolish Or Rehabilitate Structure		
20. <input type="checkbox"/>		
OBTAIN PERMIT TO: <input type="checkbox"/> Repair Per Applicable Building Codes <input type="checkbox"/> Demolish Or Rehabilitate Structure		

*** YOU MUST CORRECT THE ABOVE CONDITIONS WITHIN 30 DAYS OF THE DATE OF THIS NOTICE

Case No. CV10-00386 Address 21665 Eucalyptus, Perris

Date 1/15/10 Officer J. Morris

SSS#2



**CODE ENFORCEMENT DEPARTMENT
COUNTY OF RIVERSIDE**

JOHN BOYD
Director

NOTICE OF VIOLATION

January 19, 2010

MR. & MRS. JOHN VELARDE
222 CARTER DR.
PERRIS, CA 92370

RE CASE NO: CV10-00386

NOTICE IS HEREBY GIVEN that property owned or controlled by you at 21665 EUCALYPTUS LN, PERRIS California, Assessor's Parcel Number 325-060-013, is in violation of Section(s) RCC Section No. 15.16.020 (Ord. 457), of the Riverside County Code.

Said violation is described as:

- 1) 15.16.020 (Ord. 457) - An inspection was made of the above-referenced subject property in response to complaints received by this office. The structure(s) was/were found to be substandard and a public nuisance in violation of Riverside County Code Section 15.16, and as such, was posted with a "Danger Do Not Enter" sign and a copy of the enclosed "Notice of Defects," which sets forth the conditions that render the building unsafe for human habitation.

NOTICE IS HEREBY GIVEN that failure to comply with this notice will result in further civil, criminal, or administrative proceedings for demolition of the structure(s) and abatement of the public nuisance and could result in the imposition of a lien on the subject property(ies) for costs, including attorney's fees, related to the enforcement of all ordinances and abatement of violative conditions. A "Notice of Noncompliance" has been recorded with the Riverside County Recorder's Office. At the conclusion of this case, you will receive a Statement of Expense associated with the abatement of such nuisance.

NOTICE IS FURTHER GIVEN that in accordance with Sections 17274 and 24436.5 of the Revenue and Taxation Code, a tax deduction may not be allowed for interest, taxes, depreciation, or amortization paid or incurred in the taxable year affected by these abatement proceedings.

YOU ARE HEREBY REQUIRED TO COMPLY with the provisions of the ordinance by:

- 1) THE OWNER OF RECORD of the subject property is hereby noticed and ordered within thirty (30) days of this notice to obtain all necessary permits from the Department of Building and Safety and to correct or abate the unsafe conditions either by repairing all violative conditions indicated in the attached "Notice of Defects" or demolition and removal of the structure(s). ALL PARTIES WITH INTEREST in the subject property may comply with the provisions of this notice within fifteen (15) days after the expiration of the thirty (30) day period.

COMPLIANCE MUST BE COMPLETED BY February 19, 2010. FAILURE TO COMPLY WILL RESULT IN LEGAL ACTION BEING BROUGHT AGAINST YOU.

NOTICE IS HEREBY GIVEN THAT AT THE CONCLUSION OF THIS CASE YOU WILL RECEIVE A SUMMARY OF ADMINISTRATIVE COSTS ASSOCIATED WITH THE PROCESSING OF SUCH VIOLATION(S), AT AN HOURLY RATE OF \$109.00 AS DETERMINED BY THE BOARD OF SUPERVISORS.

YOU WILL HAVE THE RIGHT TO OBJECT TO THESE CHARGES BY FILING A REQUEST FOR HEARING WITH THE DEPARTMENT OF CODE ENFORCEMENT WITHIN TEN (10) DAYS OF SERVICE OF THE SUMMARY OF CHARGES, PURSUANT TO SECTION 1.16.080 OF RIVERSIDE COUNTY CODE.

CODE ENFORCEMENT DEPARTMENT

By: Jennifer Morris, Code Enforcement Officer II

EXHIBIT NO. E14

RIVERSIDE COUNTY CODE ENFORCEMENT DEPARTMENT CODE ENFORCEMENT NOTICE OF DEFECTS

UNIFORM HOUSING HEALTH & SAFETY
CODE SECTIONS CODE SECTIONS

SUBSTANDARD BUILDING CONDITIONS:

	UNIFORM HOUSING CODE SECTIONS	HEALTH & SAFETY CODE SECTIONS
1. <input checked="" type="checkbox"/> Lack of or improper water closet, lavatory, bathtub, shower or kitchen sink.....	1001(b)1,2,3	17920.3(a)1,2,3
OBTAIN PERMIT TO: <input checked="" type="checkbox"/> Repair Per Applicable Building Codes <input checked="" type="checkbox"/> Demolish Or Rehabilitate Structure		
2. <input type="checkbox"/> Lack of hot and cold running water to plumbing fixtures.....	1001(b)4,5	17920.3(a)4,5
OBTAIN PERMIT TO: <input type="checkbox"/> Repair Per Applicable Building Codes <input type="checkbox"/> Demolish Or Rehabilitate Structure		
3. <input type="checkbox"/> Lack of connection to required sewage system.....	1001(b)14	17920.3(a)14
OBTAIN PERMIT TO: <input type="checkbox"/> Repair Per Applicable Building Codes <input type="checkbox"/> Demolish Or Rehabilitate Structure		
4. <input type="checkbox"/> Hazardous plumbing.....	1001(f)	17920.3(e)
OBTAIN PERMIT TO: <input type="checkbox"/> Repair Per Applicable Building Codes <input type="checkbox"/> Demolish Or Rehabilitate Structure		
5. <input type="checkbox"/> Lack of required electrical lighting.....	1001(b)10	17920.3(a)10
OBTAIN PERMIT TO: <input type="checkbox"/> Repair Per Applicable Building Codes <input type="checkbox"/> Demolish Or Rehabilitate Structure		
6. <input checked="" type="checkbox"/> Hazardous Wiring <u>Unpermitted</u>	1001(e)	17920.3(d)
OBTAIN PERMIT TO: <input checked="" type="checkbox"/> Repair Per Applicable Building Codes <input checked="" type="checkbox"/> Demolish Or Rehabilitate Structure		
7. <input type="checkbox"/> Lack of adequate heating facilities.....	1001(o)6	17920.3(a)6
OBTAIN PERMIT TO: <input type="checkbox"/> Repair Per Applicable Building Codes <input type="checkbox"/> Demolish Or Rehabilitate Structure		
8. <input type="checkbox"/> Deteriorated or inadequate foundation.....	1001(c)1	17920.3(b)1
OBTAIN PERMIT TO: <input type="checkbox"/> Repair Per Applicable Building Codes <input type="checkbox"/> Demolish Or Rehabilitate Structure		
9. <input type="checkbox"/> Defective or deteriorated flooring or floor supports.....	1001(c)2	17920.3(b)2
OBTAIN PERMIT TO: <input type="checkbox"/> Repair Per Applicable Building Codes <input type="checkbox"/> Demolish Or Rehabilitate Structure		
10. <input checked="" type="checkbox"/> Members of walls, partitions or other vertical supports that split, lean, list or buckle due to defective material or deterioration.....	1001(c)4	17920.3(b)4
OBTAIN PERMIT TO: <input checked="" type="checkbox"/> Repair Per Applicable Building Codes <input checked="" type="checkbox"/> Demolish Or Rehabilitate Structure		
11. <input checked="" type="checkbox"/> Members of ceilings, roofs, ceiling and roof supports or other horizontal members which sag, split, or buckle due to defective material or deterioration.....	1001(c)6	17920.3(b)6
OBTAIN PERMIT TO: <input checked="" type="checkbox"/> Repair Per Applicable Building Codes <input checked="" type="checkbox"/> Demolish Or Rehabilitate Structure		
12. <input checked="" type="checkbox"/> Dampness of habitable rooms.....	1001(b)11	17920.3(a)11
OBTAIN PERMIT TO: <input checked="" type="checkbox"/> Repair Per Applicable Building Codes <input checked="" type="checkbox"/> Demolish Or Rehabilitate Structure		
13. <input checked="" type="checkbox"/> Faulty weather protection.....	1001(b)1-4	17920.3(g)1-4
A. Deteriorated or ineffective weather proofing of exterior walls, roof or floors including broken windows or doors, lack of paint or other approved wall covering.		
OBTAIN PERMIT TO: <input checked="" type="checkbox"/> Repair Per Applicable Building Codes <input checked="" type="checkbox"/> Demolish Or Rehabilitate Structure		
14. <input checked="" type="checkbox"/> General dilapidation or improper maintenance.....	1001(b)13	17920.3(a)13
OBTAIN PERMIT TO: <input checked="" type="checkbox"/> Repair Per Applicable Building Codes <input checked="" type="checkbox"/> Demolish Or Rehabilitate Structure		
15. <input type="checkbox"/> Fire hazard.....	1001(i)	17920.3(h)
OBTAIN PERMIT TO: <input type="checkbox"/> Repair Per Applicable Building Codes <input type="checkbox"/> Demolish Or Rehabilitate Structure		
16. <input type="checkbox"/> Extensive fire damage.....		
OBTAIN PERMIT TO: <input type="checkbox"/> Repair Per Applicable Building Codes <input type="checkbox"/> Demolish Or Rehabilitate Structure		
17. <input checked="" type="checkbox"/> Public and attractive nuisance - abandoned/vacant.....		
OBTAIN PERMIT TO: <input checked="" type="checkbox"/> Repair Per Applicable Building Codes <input checked="" type="checkbox"/> Demolish Or Rehabilitate Structure		
18. <input type="checkbox"/> Improper occupancy.....	1001(n)	17920.3(n)
OBTAIN PERMIT TO: <input type="checkbox"/> Repair Per Applicable Building Codes <input type="checkbox"/> Demolish Or Rehabilitate Structure		
19. <input checked="" type="checkbox"/> <u>Unpermitted</u>		
OBTAIN PERMIT TO: <input checked="" type="checkbox"/> Repair Per Applicable Building Codes <input checked="" type="checkbox"/> Demolish Or Rehabilitate Structure		
20. <input type="checkbox"/>		
OBTAIN PERMIT TO: <input type="checkbox"/> Repair Per Applicable Building Codes <input type="checkbox"/> Demolish Or Rehabilitate Structure		

*** YOU MUST CORRECT THE ABOVE CONDITIONS WITHIN 30 DAYS OF THE DATE OF THIS NOTICE

Case No. CV10-00386 Address 21665 Eucalyptus Ln, Perris
Date 1/15/10 Officer J. Morris

SSS#1

E15

RIVERSIDE COUNTY CODE ENFORCEMENT DEPARTMENT CODE ENFORCEMENT NOTICE OF DEFECTS

UNIFORM HOUSING HEALTH & SAFETY
CODE SECTIONS CODE SECTIONS

SUBSTANDARD BUILDING CONDITIONS:

1. <input type="checkbox"/> Lack of or improper water closet, lavatory, bathtub, shower or kitchen sink.....	1001(b)1,2,3	17920.3(a)1,2,3
OBTAIN PERMIT TO: <input type="checkbox"/> Repair Per Applicable Building Codes <input type="checkbox"/> Demolish Or Rehabilitate Structure		
2. <input type="checkbox"/> Lack of hot and cold running water to plumbing fixtures	1001(b)4,5	17920.3(a)4,5
OBTAIN PERMIT TO: <input type="checkbox"/> Repair Per Applicable Building Codes <input type="checkbox"/> Demolish Or Rehabilitate Structure		
3. <input type="checkbox"/> Lack of connection to required sewage system.....	1001(b)14	17920.3(a)14
OBTAIN PERMIT TO: <input type="checkbox"/> Repair Per Applicable Building Codes <input type="checkbox"/> Demolish Or Rehabilitate Structure		
4. <input type="checkbox"/> Hazardous plumbing.....	1001(f)	17920.3(e)
OBTAIN PERMIT TO: <input type="checkbox"/> Repair Per Applicable Building Codes <input type="checkbox"/> Demolish Or Rehabilitate Structure		
5. <input type="checkbox"/> Lack of required electrical lighting.....	1001(b)10	17920.3(a)10
OBTAIN PERMIT TO: <input type="checkbox"/> Repair Per Applicable Building Codes <input type="checkbox"/> Demolish Or Rehabilitate Structure		
6. <input type="checkbox"/> Hazardous Wiring.....	1001(e)	17920.3(d)
OBTAIN PERMIT TO: <input type="checkbox"/> Repair Per Applicable Building Codes <input type="checkbox"/> Demolish Or Rehabilitate Structure		
7. <input type="checkbox"/> Lack of adequate heating facilities.....	1001(o)6	17920.3(a)6
OBTAIN PERMIT TO: <input type="checkbox"/> Repair Per Applicable Building Codes <input type="checkbox"/> Demolish Or Rehabilitate Structure		
8. <input type="checkbox"/> Deteriorated or inadequate foundation.....	1001(c)1	17920.3(b)1
OBTAIN PERMIT TO: <input type="checkbox"/> Repair Per Applicable Building Codes <input type="checkbox"/> Demolish Or Rehabilitate Structure		
9. <input type="checkbox"/> Defective or deteriorated flooring or floor supports.....	1001(c)2	17920.3(b)2
OBTAIN PERMIT TO: <input type="checkbox"/> Repair Per Applicable Building Codes <input type="checkbox"/> Demolish Or Rehabilitate Structure		
10. <input checked="" type="checkbox"/> Members of walls, partitions or other vertical supports that split, lean, list or buckle due to defective material or deterioration.....	1001(c)4	17920.3(b)4
OBTAIN PERMIT TO: <input checked="" type="checkbox"/> Repair Per Applicable Building Codes <input checked="" type="checkbox"/> Demolish Or Rehabilitate Structure		
11. <input checked="" type="checkbox"/> Members of ceilings, roofs, ceiling and roof supports or other horizontal members which sag, split, or buckle due to defective material or deterioration.....	1001(c)6	17920.3(b)6
OBTAIN PERMIT TO: <input checked="" type="checkbox"/> Repair Per Applicable Building Codes <input checked="" type="checkbox"/> Demolish Or Rehabilitate Structure		
12. <input checked="" type="checkbox"/> Dampness of habitable rooms.....	1001(b)11	17920.3(a)11
OBTAIN PERMIT TO: <input checked="" type="checkbox"/> Repair Per Applicable Building Codes <input checked="" type="checkbox"/> Demolish Or Rehabilitate Structure		
13. <input checked="" type="checkbox"/> Faulty weather protection.....	1001(h)1-4	17920.3(g)1-4
A. Deteriorated or ineffective weather proofing of exterior walls, roof or floors including broken windows or doors, lack of paint or other approved wall covering.		
OBTAIN PERMIT TO: <input checked="" type="checkbox"/> Repair Per Applicable Building Codes <input checked="" type="checkbox"/> Demolish Or Rehabilitate Structure		
14. <input checked="" type="checkbox"/> General dilapidation or improper maintenance.....	1001(b)13	17920.3(a)13
OBTAIN PERMIT TO: <input checked="" type="checkbox"/> Repair Per Applicable Building Codes <input checked="" type="checkbox"/> Demolish Or Rehabilitate Structure		
15. <input type="checkbox"/> Fire hazard.....	1001(i)	17920.3(h)
OBTAIN PERMIT TO: <input type="checkbox"/> Repair Per Applicable Building Codes <input type="checkbox"/> Demolish Or Rehabilitate Structure		
16. <input type="checkbox"/> Extensive fire damage.....		
OBTAIN PERMIT TO: <input type="checkbox"/> Repair Per Applicable Building Codes <input type="checkbox"/> Demolish Or Rehabilitate Structure		
17. <input checked="" type="checkbox"/> Public and attractive nuisance - abandoned/vacant.....		
OBTAIN PERMIT TO: <input checked="" type="checkbox"/> Repair Per Applicable Building Codes <input checked="" type="checkbox"/> Demolish Or Rehabilitate Structure		
18. <input type="checkbox"/> Improper occupancy.....	1001(n)	17920.3(n)
OBTAIN PERMIT TO: <input type="checkbox"/> Repair Per Applicable Building Codes <input type="checkbox"/> Demolish Or Rehabilitate Structure		
19. <input checked="" type="checkbox"/> Unpermitted		
OBTAIN PERMIT TO: <input checked="" type="checkbox"/> Repair Per Applicable Building Codes <input checked="" type="checkbox"/> Demolish Or Rehabilitate Structure		
20. <input type="checkbox"/>		
OBTAIN PERMIT TO: <input type="checkbox"/> Repair Per Applicable Building Codes <input type="checkbox"/> Demolish Or Rehabilitate Structure		

***** YOU MUST CORRECT THE ABOVE CONDITIONS WITHIN 30 DAYS OF THE DATE OF THIS NOTICE**

Case No. CV10-00386 Address 21665 Eucalyptus, Perris
 Date 1/15/10 Officer J. Morris

SSS#2

COUNTY OF RIVERSIDE
Code Enforcement Department
24318 Hemlock Avenue, Suite C-1
Moreno Valley, CA 92557

RETURN RECEIPT REQUESTED

RETURN RECEIPT REQUESTED



7009 0820 0001 7230 2878

FIRST CLASS



02 1M
0004234315
JAN 19 2010
MAILED FROM ZIP CODE 92504

\$ 05.71⁰

1-21-10

22

C-2

NR

REC'D FEB 17 2010

John B. Velarde
Elvia O. Velarde
29873 Sun Country Lane
Sun City, CA 92586
CV10-00386 / JM 325

UNCLAIMED

217

NIXIE

921 SE 1

00 02/13/10

RETURN TO SENDER
UNCLAIMED
UNABLE TO FORWARD

9255707224

EC: 92557722431

*0904-14991-19-99

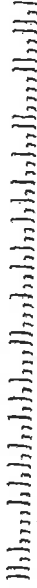

7009 0820 0001 7230 2878

U.S. Postal Service™
CERTIFIED MAIL™ RECEIPT
 (Domestic Mail Only; No Insurance Coverage Provided)

For delivery information visit our website at www.usps.com

OFFICIAL USE

Postage \$		Postmark Here
Certified Fee		
Return Receipt Fee (Endorsement Required)		
Restricted Delivery Fee (Endorsement Required)		

John B. Velarde
 Elvia O. Velarde
 29873 Sun Country Lane
 Sun City, CA 92586

CV10-00386 / JM 325
 PS Form 3800, August 2006 See Reverse for Instructions

EXHIBIT NO. EN

CERTIFIED MAIL™

COUNTY OF RIVERSIDE
Code Enforcement Department
24318 Hemlock Avenue, Suite C-1
Moreno Valley, CA 92557

RETURN RECEIPT REQUESTED
RETURN RECEIPT REQUESTED



7009 0620 0001 7230 2892

REC'D FEB 17 2010

Mr. & Mrs. John Velarde
222 Carter Drive
Perris, CA 92370
CV10-00386 / JM 325



UNCLAIMED

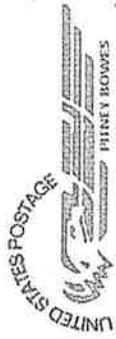

02 1M
0004234315
MAILED FROM ZIP CODE 92504

FIRST CLASS

1-20-10

22

C-2

12 MONTHS
ZIP 92370
AV

NIXIE 921 5E 1 00 02/13/10

RETURN TO SENDER
UNCLAIMED
UNABLE TO FORWARD

BC: 92557722431 *0904-12962-19-99

9257081658

9255707224



7009 0620 0001 7230 2892

U.S. Postal Service™
CERTIFIED MAIL™ RECEIPT
(Domestic Mail Only; No Insurance Coverage Provided)

For delivery information visit our website at www.usps.com®

OFFICIAL USE

Postage	\$
Certified Fee	
Return Receipt Fee (Endorsement Required)	
Restricted Delivery Fee (Endorsement Required)	

Postmark
Here

Mr. & Mrs. John Velarde
222 Carter Drive
Perris, CA 92370
CV10-00386 / JM 325

PS Form 3800, August 2006

See Reverse for Instructions

EXHIBIT NO. _____

E18

7009 0820 0001 7230 2885

U.S. Postal Service TM
CERTIFIED MAIL TM RECEIPT
(Domestic Mail Only; No Insurance Coverage Provided)

For delivery information visit our website at www.usps.com

OFFICIAL USE

Postage	\$
Certified Fee	
Return Receipt Fee (Endorsement Required)	
Restricted Delivery Fee (Endorsement Required)	

Postmark
Here

John B. Velarde
Elvia O. Velarde
21665 Eucalyptus Lane
Perris, CA 92570
CV10-00386 / JM 325

PS Form 3800, August 2006 See Reverse for Instructions



\$ 05.71⁰
02 1M
0004234315 JAN 19 2010
MAILED FROM ZIP CODE 92504



FIRST CLASS



7009 0820 0001 7230 2885

REC'D FEB 17 2010

COUNTY OF RIVERSIDE
Code Enforcement Department
24318 Hemlock Avenue, Suite C-1
Moreno Valley, CA 92557

ETURN RECEIPT REQUESTED

ETURN RECEIPT REQUESTED

John B. Velarde
Elvia O. Velarde
21665 Eucalyptus Lane
Perris, CA 92570
CV10-00386 / JM 325



UNCLAIMED

NIXIE 921 SE 1 00 02/13/10

RETURN TO SENDER
UNCLAIMED
UNABLE TO FORWARD

BC: 92557722431 *0904-12355-19-09

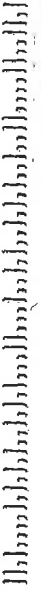

9257086199

9255707224

EXHIBIT NO. EA



**CODE ENFORCEMENT DEPARTMENT
COUNTY OF RIVERSIDE**

JOHN BOYD
Director

PROOF OF SERVICE

Case No. CV10-00386

STATE OF CALIFORNIA, COUNTY OF RIVERSIDE

I, Jennifer Miller, declare that I am a citizen of the United States and am employed in the County of Riverside, over the age of 18 years and not a party to the within action or proceeding; that my business address is at the footer of this notice.

That on January 19, 2010, I served the following documents(s):

**NOTICE RE: Notice of Violation (RCC 15.16.020)
Notice of Defects (2)
Summary of Costs Notification**

by placing a true copy thereof enclosed in a sealed envelope(s) **BY CERTIFIED MAIL, RETURN RECEIPT REQUESTED** and address as follows:

JOHN B VELARDE / ELVIA O VELARDE 29873 SUN COUNTRY LN, SUN CITY, CA 92586
JOHN B VELARDE / ELVIA O VELARDE 21665 EUCALYPTUS LN, PERRIS, CA 92570
MR. AND MRS. JOHN VELARDE 222 CARTER DR., PERRIS, CA 92370

XX BY FIRST CLASS MAIL. I am readily familiar with the office's practice of collection and processing correspondence for mailing. Under that practice it would be deposited with the U.S. Postal Service with postage thereon fully prepaid at Riverside, California, in the ordinary course of business.

XX STATE. I declare under the penalty of perjury under the laws of the State of California that the above is true and correct.

EXECUTED ON January 19, 2010 in the County of Riverside, California.

CODE ENFORCEMENT DEPARTMENT

By: Jennifer Miller, Code Enforcement Aide

EXHIBIT NO. E²⁰

When recorded please mail to:
Riverside County Code Enforcement Department
(District 5 Office)
24318 Hemlock Avenue, Suite C-1
Moreno Valley, CA 92557
Mail Stop No. 5002

DOC # 2010-0039005
01/28/2010 08:00A Fee:NC
Page 1 of 1
Recorded in Official Records
County of Riverside
Larry W. Ward
Assessor, County Clerk & Recorder



M
039
BJ

NOTICE OF NONCOMPLIANCE

In the matter of the Property of
John B. Velarde
Elvia O. Velarde

)
)

Case No. CV10-00386

NOTICE IS HEREBY GIVEN to all persons, pursuant to Section 10 of Ordinance Number 725 of the County of Riverside, State of California, that proceedings have been commenced with respect to violations of Riverside County Ordinance No.457, (RCC Title 15.16.020) described as substandard structures / accessory buildings: barn/ workshop and shed (quality lower than prescribed by law). Such Proceedings are based upon the noncompliance of such real property, located at 21665 Eucalyptus Lane, Perris, CA, and more particularly described as Assessor's Parcel Number 325-060-013 and having a legal description of 2.77 ACRES IN PAR 8 RS 024/059, Records of Riverside County, with the requirements of Ordinance No. 457 (RCC Title 15.16.020).

The owner has been advised to immediately correct the above-referenced violations to avoid further action by the County of Riverside which may include demolition, removal, razing, etc., to abate the public nuisance. Any costs incurred by the County, including, but not limited to investigative, administrative and abatement costs and attorneys' fees, may become a lien on the property. Further details regarding this notice may be obtained by addressing an inquiry to the Code Enforcement Department, 24318 Hemlock Avenue, Suite C-1, Moreno Valley, California, Attention Code Enforcement Officer Jennifer Morris.

NOTICE IS FURTHER GIVEN in accordance with §17274 and §24436.5 of the California Revenue and Taxation Code, that a tax deduction may not be allowed for interest, taxes, depreciation, or amortization paid or incurred in the taxable year affected by these proceedings.

COUNTY OF RIVERSIDE
CODE ENFORCEMENT DEPARTMENT

By Mary Overholt
Mary Overholt
Code Enforcement Department

ACKNOWLEDGMENT

State of California)
County of Riverside)

On 01/19/10 before me, Ana E. Carrillo, Notary Public, personally appeared Mary Overholt, who proved to me on the basis of satisfactory evidence to be the person(s) whose name(s) is/are subscribed to the within instrument and acknowledged to me that he/~~she~~ they executed the same in his/~~her~~ their authorized capacity(ies), and that by his/~~her~~ their signature(s) on the instrument the person(s), or the entity upon behalf of which the person(s) acted, executed the instrument.

I certify under PENALTY OF PERJURY under the laws of the State of California that the foregoing paragraph is true and correct.

WITNESS my hand and official seal.

Ana E. Carrillo

Commission # 1767676 Comm. Expires Sep. 14, 2011

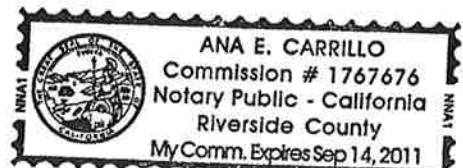

EXHIBIT NO. F

PAMELA J. WALLS
County Counsel

Principal Deputy
KATHERINE A. LIND

OFFICE OF COUNTY COUNSEL
COUNTY OF RIVERSIDE

3960 ORANGE STREET, 5TH FLOOR
RIVERSIDE, CA 92501
TELEPHONE: 951/955-6300
FAX: 951/955-6322 & 955-6363



June 10, 2010

**NOTICE TO CORRECT COUNTY ORDINANCE VIOLATIONS
AND ABATE PUBLIC NUISANCE**

TO: Owners and Interested Parties
(See Attached Proof of Service
and Attached Notice List)

Case No.: CV 10-00386
APN: 325-060-013; VELARDE
Property: 21665 Eucalyptus Lane, Perris

NOTICE IS HEREBY GIVEN that a hearing will be held before the Riverside County Board of Supervisors pursuant to Riverside County Ordinance Nos. 457 (RCC Title 15) and 725 (RCC Title 1) to consider the abatement of the substandard structures located on the SUBJECT PROPERTY described as 21665 Eucalyptus Lane, Perris, **Riverside County, California**, and more particularly described as Assessor's Parcel Number 325-060-013.

YOU ARE HEREBY DIRECTED as owner of the SUBJECT PROPERTY, to appear at this hearing to show cause why the SUBJECT PROPERTY should not be condemned as a public nuisance and be abated by removing the substandard structures from the real property.

SAID HEARING will be held on **Tuesday, June 29, 2010, at 9:30 a.m.** in the Board of Supervisors Room, County Administrative Center, 4080 Lemon Street, 1st Floor Annex, Riverside, California at which time and place pertinent evidence will be received and/or testimony from all concerned parties will be heard. Failure to appear on your behalf will result in the exclusion of your testimony, and facts as known to the Code Enforcement Department ("Department") will be presented to the Board of Supervisors for consideration and deliberation in this matter.

Please be advised that the costs already accrued in this case, including but not limited to, enforcement and investigation costs, are recoverable by the Department, as allowed under Riverside County Ordinance No. 725. The Department may seek recovery of such costs from the property owner(s) which may result in a special assessment lien against the SUBJECT PROPERTY. Additionally, should the Department abate the property, the costs associated therewith, as well as all abatement costs allowed under Riverside County Ordinance No. 725 (RCC Title 1), will be sought from the property owner(s) and/or may result in a special assessment lien against the property.

You are encouraged to contact Supervising Code Enforcement Officer Mary Overholt at (951) 485-5840 or the undersigned prior to the hearing. Please meet the undersigned and Brian Black, Supervising Code Enforcement Officer, at 8:30 a.m. on the day of the hearing in the lobby of the 1st floor annex in front of the Clerk of the Board's Office to discuss the case.

PAMELA J. WALLS
Riverside County Counsel



L. ALEXANDRA FONG
Deputy County Counsel

EXHIBIT NO. 6

NOTICE LIST

Subject Property: 21665 Eucalyptus Lane, Perris
Case No.: CV 10-00386 APN: 325-060-013; District 5

JOHN B. VELARDE
ELVIA O. VELARDE
29873 SUN COUNTRY LANE
SUN CITY, CA 92586

[Via Certified and U.S. Mail]

EXHIBIT NO. 6²



Track & Confirm

Search Results

Label/Receipt Number: **7009 3410 0000 1318 4210**
Service(s): **Certified Mail™**
Status: **Notice Left**

We attempted to deliver your item at 2:49 PM on June 12, 2010 in PERRIS, CA 92570 and a notice was left. You may pick up the item at the Post Office indicated on the notice, go to www.usps.com/redelivery, or call 800-ASK-USPS to arrange for redelivery. If this item is unclaimed after 30 days then it will be returned to the sender. Information, if available, is updated periodically throughout the day. Please check again later.

Track & Confirm

Enter Label/Receipt Number.

Go >

Notification Options

Track & Confirm by email

Get current event information or updates for your item sent to you or others by email. [Go >](#)

7009 3410 0000 1318 4210

U.S. Postal Service	
CERTIFIED MAIL RECEIPT	
<i>(Domestic Mail Only; No Insurance Coverage Provided)</i>	
For delivery information visit our website at www.usps.com	
OFFICIAL USE	
Postage	\$.41
Certified Fee	2.80
Return Receipt Fee (Endorsement Required)	2.30
Restricted Delivery Fee (Endorsement Required)	
Total Postage & Fees	\$ 5.51

Mailed 6/10/10

Postmark Here

Sent To	
Street, Apt or PO Box	JOHN B VELARDE
City, State	ELVIA O VELARDE
	29873 SUN COUNTRY LANE
	SUN CITY CA 92586

PS Form 3800, August 2006 See Reverse for Instructions

EXHIBIT NO. G3

1 **PROOF OF SERVICE**

2 Case No. CV 10-00386

3 STATE OF CALIFORNIA, COUNTY OF RIVERSIDE

4 I, Brenda Peeler, declare that I am a citizen of the United States and am employed in the County of
5 Riverside, over the age of 18 years and not a party to the within action or proceeding; that my
6 business address is 3960 Orange Street, 5th Floor, Riverside, California 92501.

7 That on June 10, 2010, I served the following document(s):

8 **NOTICE TO CORRECT COUNTY ORDINANCE VIOLATIONS
9 AND ABATE PUBLIC NUISANCE**

10 by placing a true copy thereof enclosed in a sealed envelope(s) addressed as follows:

11 **Owners or Interested Parties
12 (see attached notice list)**

13 XX **BY CERTIFIED MAIL, RETURN RECEIPT REQUESTED.** I am "readily familiar"
14 with the office's practice of collection and processing correspondence for mailing. Under
15 that practice it would be deposited with the U.S. Postal Service on that same day with
16 postage thereon fully prepaid at Riverside, California, in the ordinary course of business.

17 XX **BY FIRST CLASS MAIL.** I am "readily familiar" with the office's practice of collection
18 and processing correspondence for mailing. Under that practice it would be deposited with
19 the U.S. Postal Service on that same day with postage thereon fully prepaid at Riverside,
20 California, in the ordinary course of business.

21 — **BY PERSONAL SERVICE:** I caused to be delivered such envelope(s) by hand to the offices
22 of the addressee(s).

23 XX **STATE - I declare under penalty of perjury under the laws of the State of California that the
24 above is true and correct.**

25 — **FEDERAL - I declare that I am employed in the office of a member of the bar of this court at
26 whose direction the service was made.**

27 EXECUTED ON June 10, 2010, at Riverside, California.

28 

BRENDA PEELER

EXHIBIT NO. 64

CO OF RIVERSIDE

Fax:951-485-4938

Jun 16 2010 07:03am P002/002

**CODE ENFORCEMENT DEPARTMENT
COUNTY OF RIVERSIDE****JOHN BOYD**
Director**AFFIDAVIT OF POSTING OF NOTICES**

June 11, 2010

RE CASE NO: CV1000386

I, Jennifer Morris, hereby declare:

I am employed by the Riverside County Code Enforcement Department; that my business address is 24318 Hemlock, Ave., Suite C-1, Moreno Valley, California 92557.

That on 6/11/10 at 10:15 hrs, I securely and conspicuously posted Notice to Correct County Ordinance Violation and Abate Public Nuisance at the property described as:

Property Address: 21665 EUCALYPTUS LN, PERRIS**Assessor's Parcel Number:** 325-060-013

I declare under the penalty of perjury that the foregoing is true and correct.

Executed on June 11, 2010 in the County of Riverside, California.

CODE ENFORCEMENT DEPARTMENT

A handwritten signature in cursive script, appearing to read "Jennifer Morris", is written over a horizontal line.
By: Jennifer Morris, Code Enforcement Officer**EXHIBIT NO.** 6⁵

Riverside County Board of Supervisors
Request to Speak



Submit request to Clerk of Board (right of podium),
Speakers are entitled to three (3) minutes, subject
Board Rules listed on the reverse side of this form.

SPEAKER'S NAME: JOHN VELARDE

Address: 21665 EUCALYPTUS LANE
(only if follow-up mail response requested)

City: PERRIS, CA **Zip:** 92570

Phone #: 951-852-7427

Date: JUNE/29/10 **Agenda #** 9.8

PLEASE STATE YOUR POSITION BELOW:

Position on "Regular" (non-appealed) Agenda Item:

Support Oppose Neutral

Note: If you are here for an agenda item that is filed
for "Appeal", please state separately your position on
the appeal below:

Support Oppose Neutral

I give my 3 minutes to: _____