

**SUBMITTAL TO THE BOARD OF SUPERVISORS
COUNTY OF RIVERSIDE, STATE OF CALIFORNIA**

665A



FROM: TLMA - Transportation Department

SUBMITTAL DATE:
July 15, 2010

SUBJECT: Completion of Improvements on Goetz Road between Railroad Canyon Road and North of Normandy Road including bridge over Salt Creek in the Audie Murphy Ranch.

RECOMMENDED MOTION: That the Board of Supervisors:

1. Approve the plans and specifications for the completion of improvements on Goetz Road between Railroad Canyon Road and North of Normandy Road including bridge over salt creek in the "Audie Murphy Ranch" in the Cities of Menifee and Canyon Lake ; and,
2. Authorize the Clerk to advertise for bids to be received in the office of the Director of Transportation up to the hour of 2:00 pm, Wednesday, September 1, 2010, at which time bids will be opened.

Juan C. Perez
Director of Transportation

JCP:nn:jrj:sb
(Continued On Attached Page)

FINANCIAL DATA	Current F.Y. Total Cost:	\$ 7,063,221	In Current Year Budget:	Yes
	Current F.Y. Net County Cost:	\$ 0	Budget Adjustment:	No
	Annual Net County Cost:	\$ 0	For Fiscal Year:	2010/2011

SOURCE OF FUNDS: Developer Performance Bond Fund (70%), TUMF (23.52%), (Eastern Municipal Water District) [EMWD] (6.48%).	Positions To Be Deleted Per A-30	<input type="checkbox"/>
	Requires 4/5 Vote	<input type="checkbox"/>

C.E.O. RECOMMENDATION:

APPROVE

BY: Tina Grande

County Executive Office Signature

MINUTES OF THE BOARD OF SUPERVISORS

On motion of Supervisor Stone, seconded by Supervisor Benoit and duly carried, IT WAS ORDERED that the above matter is approved as recommended.

Ayes: Buster, Stone, Benoit and Ashley
 Nays: None
 Absent: Tavaglione
 Date: July 27, 2010
 xc: Transp., COB

Kecia Harper-Ihem
 Clerk of the Board
 By: Deputy

Prev. Agn. Ref. 12/8/09 (Item 3.27) & District: 3 **Agenda Number:**
 2/9/10 (Item 3.59)

ATTACHMENTS FILED
 WITH THE CLERK OF THE BOARD

3.81

FORM APPROVED COUNTY COUNSEL
 BY: MARSHAL VICTOR
 DATE: 7/19/10

Departmental Concurrence

Dept't Recomm.: Consent Policy
 Per Exec. Ofc.: Consent Policy

The Honorable Board of Supervisors

RE: Completion of Improvements on Goetz Road between Railroad Canyon Road and North of Normandy Road including bridge over Salt Creek in the Audie Murphy Ranch.

July 15, 2010

Page 2 of 2

BACKGROUND: The Transportation Improvement Program provides for the completion of improvements on Goetz Road and Newport Road in the "Audie Murphy Ranch" development, in the Cities of Menifee and Canyon Lake. The master developer of the "Audie Murphy Ranch" filed for a bankruptcy and left various roads within this development incomplete. These roads need to be completed in order to open them for public use. Strong interest has been expressed by the public and by officials of the City of Menifee and the City of Canyon Lake to complete the improvements of Goetz Road and Newport Road. The first phase of improvements included the completion of pavement, drainage facilities, and modification of a traffic signal and associated work on Newport Road and Berea Road. The second phase consists of widening Goetz Road to four lanes, a new bridge over the Salt Creek, raised median, sidewalk, curb and gutter, trail, drainage facilities, traffic signal modification at Canyon Lake Drive, completion of road improvements on Newport Road including the construction of a traffic signal at the intersection of Goetz Road and Newport Road, and associated work.

By minute order dated December 8, 2009 (Agenda Item 3.27) and February 9, 2010 (Agenda Item 3.59) respectively, the Board authorized the clerk to advertise and approve the award of the Newport Road and Berea Road construction project, as part of the first phase of the overall project. This first phase of the project is under construction and will be completed prior to commencement of the Goetz Road project which is the second and final phase of the road improvement completion work in the Audie Murphy Ranch Development.

The County was able to successfully negotiate a settlement of \$6.3 million with the bonding company that provided security to complete the construction of these improvements. The Transportation Department has also obtained a commitment of \$4 million from WRCOG TUMF funds towards these improvements. Together with the \$ 6.3 million settlement, this provides a total of \$ 10.3 million that the Transportation Department will use for the completion of improvements on Goetz Road and Newport Road. Since the County entered into the Bonds and Securities Agreement prior to the incorporation of Menifee, we are utilizing the proceeds of the settlement agreement to build these improvements on behalf of the Cities.

The extension of a 24" waterline owned by the Eastern Municipal Water District (EMWD) is included in the bid package as an alternate bid schedule. If the District approves the award of the alternate bid schedule as bid by the apparent low bidder, the cost for the work will be funded by the District, under the terms of a funding agreement which will be submitted prior to or concurrent with the award package.

Environmental Clearance will be complete prior to awarding the project.

Project No. B8-0643

COUNTY OF RIVERSIDE
DEPARTMENT OF TRANSPORTATION

GOETZ ROAD & NEWPORT ROAD COMPLETION PLANS

STREET, BRIDGE, STREET WIDENING, DRAINAGE, WATERLINE, RECLAIMED WATERLINE
RECYCLED WATER, GRADING, AND COMPLETION OF IMPROVEMENTS

LIMITS - "NEW" NEWPORT ROAD TO APPROX. 900' NORTH OF
"OLD" NEWPORT ROAD (NORMANDY ROAD)

PROJECT NO. B8 - 0643

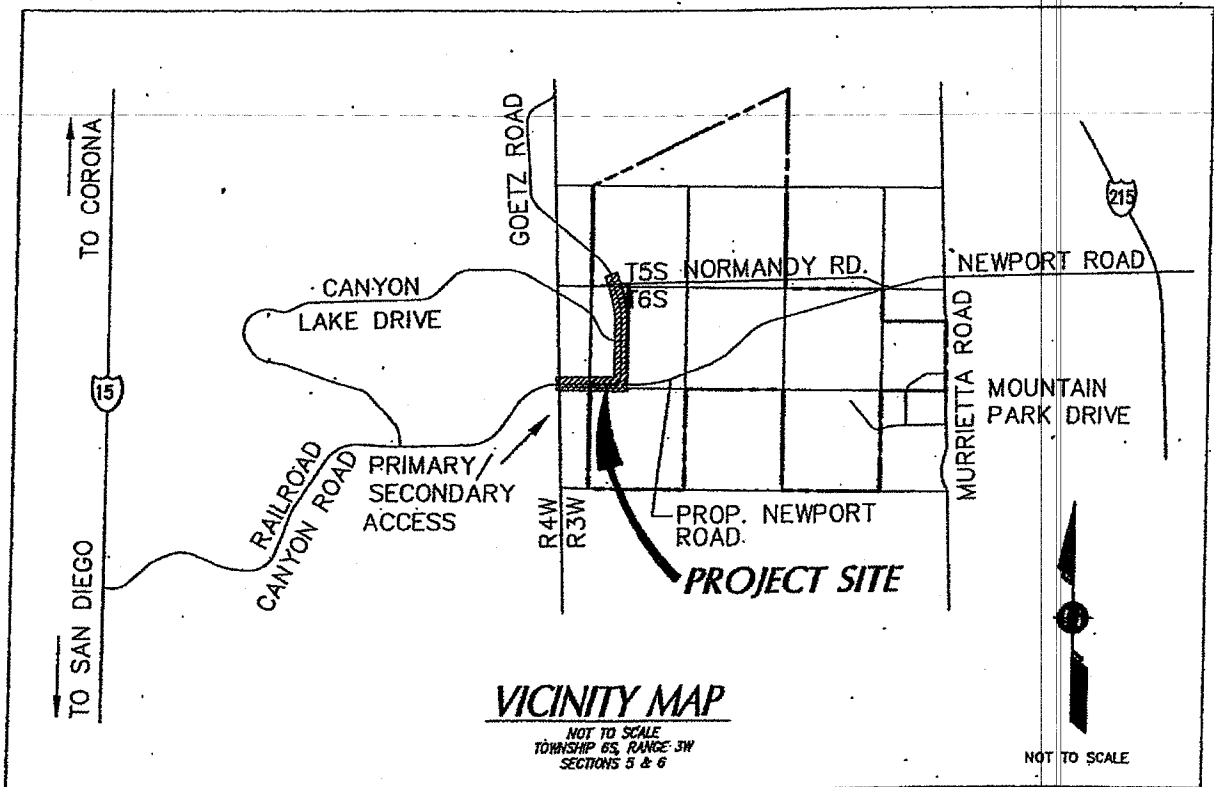

Goetz Road (From Newprt Rd to 900 feet N of Normandy Rd) & Newport Road Completion

BASE BID, PROJECT NUMBER: BB - 0643

Description: Roadway Reconstruction

Engineer's Estimate

ITEM NO	ITEM CODE	ITEM	UNIT	ESTIMATED QUANTITY	UNIT PRICE	EXTENDED AMOUNT
1	999990	MOBILIZATION	LS	1	\$ 25,000.00	\$ 25,000.00
2	066102	DUST ABATMENT	LS	1	\$ 25,000.00	\$ 25,000.00
3	074020	WATER POLLUTION CONTROL	LS	1	\$ 25,000.00	\$ 25,000.00
4	120100	TRAFFIC CONTROL SYSTEM	LS	1	\$ 70,000.00	\$ 70,000.00
5	66105	RESIDENT ENGINEERS OFFICE	LS	1	\$ 10,000.00	\$ 10,000.00
6	170101	DEVELOP WATER SUPPLY	LS	1	\$ 5,000.00	\$ 5,000.00
7	160101	CLEARING AND GRUBBING	LS	1	\$ 10,000.00	\$ 10,000.00
8	000003	COURSE OF CONSTRUCTION INSURANCE	LS	1	\$ 8,000.00	\$ 8,000.00
9	190101	EARTHWORK / ROADWAY EXCAVATION	CY	70,000	\$ 10.00	\$ 700,000.00
10	000003	DEMOLISHING EXISTING BLOCK WALL	LS	1	\$ 10,000.00	\$ 10,000.00
11	198001	IMPORT BORROW [EARTHWORK FILL]	CY	44,000	\$ 5.00	\$ 220,000.00
12	000003	MISCELLANEOUS DIRECTED WORK	FA	1	\$ 25,000.00	\$ 25,000.00
13	510501	MINOR CONCRETE [PAVEMENT (8" THICK) OVER CEMENT TREATED BASE (12" THICK), CRS 814 FOR BUS TURN OUT]	SQFT	1,700	\$ 12.00	\$ 20,400.00
14	510501	MINOR CONCRETE (CURB AND GUTTER) (CRS 200)	LF	5,560	\$ 20.00	\$ 111,200.00
15	017309	MINOR CONCRETE (TYPE "D" CURB) (CRS 204 [6"]	LF	3,980	\$ 18.00	\$ 71,640.00
16	017309	MINOR CONCRETE (TYPE "D" CURB) (CRS 204 [8"]	LF	2,950	\$ 18.00	\$ 53,100.00
17	510501	MINOR CONCRETE (CROSS-GUTTER) (CRS 209)	SQFT	2,740	\$ 15.00	\$ 41,100.00
18	510501	MINOR CONCRETE SIDEWALK (CRS 401)	SQFT	20,700	\$ 4.50	\$ 93,150.00
19	510501	MINOR CONCRETE (CURB RAMP) (CRS 403 - CASE A)	EA	5	\$ 2,200.00	\$ 11,000.00
20	510501	MINOR CONCRETE [COMMERCIAL DRIVEWAY APPROACH(CRS 207A) W=30' R=15']	SQ FT	780	\$ 10.00	\$ 7,800.00
21	510501	MINOR CONCRETE V-DITCH	LF	680	\$ 12.00	\$ 8,160.00
22	013903	PLACE ASPHALT CONCRETE DIKE (CRS 212) (6")	LF	1,400	\$ 4.00	\$ 5,600.00
23	260201	CLASS 2 AGGREGATE BASE	CY	12,200	\$ 45.00	\$ 549,000.00
24	390130	HOT MIX ASPHALT	TON	10,100	\$ 65.00	\$ 656,500.00
25	018031	GUARD RAILING (BARRICADE) (CRS 810)	LF	54	\$ 30.00	\$ 1,620.00
26	000003	METAL HAND RAILING PER A.P.W.A. 606-1 TYPE B	LF	125	\$ 30.00	\$ 3,750.00
27	832001	METAL BEAM GUARD RAILING	LF	63	\$ 30.00	\$ 1,890.00
28	839565	TERMINAL SYSTEM (TYPE SRT)	EA	1	\$ 5,000.00	\$ 5,000.00
29	17003	CATCHBASIN (RIV. CO. STD 311)	EA	12	\$ 8,000.00	\$ 96,000.00
30	000003	FLO-GARD PLUS FILTER	EA	13	\$ 500.00	\$ 6,500.00
31	650014	18" REINFORCED CONCRETE PIPE	LF	235	\$ 60.00	\$ 14,100.00
32	650017	24" REINFORCED CONCRETE PIPE	LF	130	\$ 70.00	\$ 9,100.00
33	800300	CHAIN LINK FENCE [RCFC&WCD STD. DWG. NO. M-801]	LF	25	\$ 50.00	\$ 1,250.00
34	000003	JUNCTION STRUCTURE PER RCFC STD. DWG NO. JS227 (BREAK INTO EXISTING 18" RCP]	EA	1	\$ 2,500.00	\$ 2,500.00
35	000003	MEDIAN DRAIN INLET (CALTRANS STD. DWG. D73, TYPE G1)	EA	1	\$ 4,000.00	\$ 4,000.00
36	665016	18" CORRUGATED METAL PIPE	LF	225	\$ 40.00	\$ 9,000.00
37	703220	18" CORRUGATED METAL PIPE RISER	EA	2	\$ 2,500.00	\$ 5,000.00
38	705001	END SECTION PER CAL TRANS D94A	EA	2	\$ 1,500.00	\$ 3,000.00
39	721025	ROCK SLOPE PROTECTION (2-TON, METHOD B)	CY	40	\$ 45.00	\$ 1,800.00
40	721007	ROCK SLOPE PROTECTION (1/4-TON, METHOD B)	CY	100	\$ 25.00	\$ 2,500.00
41	721007	ROCK SLOPE PROTECTION (1/2-TON, METHOD B)	CY	100	\$ 30.00	\$ 3,000.00
42	840519	THERMOPLASTIC CROSSWALK AND PAVEMENT MARKING	SQFT	1,850	\$ 3.00	\$ 5,550.00
43	840656	PAINT TRAFFIC STRIPE (2 COAT)	LF	22,700	\$ 0.15	\$ 3,405.00
44	850102	PAVEMENT MARKER (REFLECTIVE)	EA	1,100	\$ 2.25	\$ 2,475.00

Goetz Road (From Newprt Rd to 900 feet N of Normandy Rd) & Newport Road Completion

45	566011	ROADSIDE SIGN - ONE POST	EA	28	\$	150.00	\$	4,200.00
46	820107	DELINEATOR (CLASS 1) [TYPE Q]	EA	13	\$	40.00	\$	520.00
47	860811	DETECTOR LOOP	EA	15	\$	325.00	\$	4,875.00
48	860201	TRAFFIC SIGNAL AND LIGHTING [NEWPORT RD ROAD & GOETZ OAD INTERSECTION]	LS	1	\$	200,000.00	\$	200,000.00
49	861502	TRAFFIC SIGNAL MODIFICATION [GOETZ ROAD & CANYON LAKE DRIVE]	LS	1	\$	175,000.00	\$	175,000.00
50	203031	ERROSION CONTROL (HYDRO SEED) [LANDSCAPE SLOPE AREAS]	SQFT	17,130	\$	0.20	\$	3,426.00
51	150740	REMOVE AND SALVAGE SIGN [EXISTING]	EA	17	\$	100.00	\$	1,700.00
52	861349	REMOVE EXISTING TRAFFIC SIGNAL [GOETZ ROAD & NORMANDY ROAD]	LS	1	\$	15,000.00	\$	15,000.00
53	071325	TEMPORARY FENCE (TYPE ESA)	LF	1,200	\$	5.00	\$	6,000.00
54	000003	PRESSURE GROUTING (NORTH ABUTEMENT)	LS	1	\$	150,000.00	\$	150,000.00
55	192003(F)	STRUCTURE EXCAVATION (BRIDGE) TYPE (D)	CY	1,964	\$	50.00	\$	98,200.00
56	193003(F)	STRUCTURE BACKFILL (BRIDGE)	CY	1,612	\$	70.00	\$	112,840.00
57	512253(F)	FURNISH PRECAST/PRESTRESSED CONCRETE "BULB TEE" GIRDER	EA	12	\$	16,500.00	\$	198,000.00
58	512500(F)	ERECT PRECAST/PRESTRESSED CONCRETE "BULB TEE" GIRDER	EA	12	\$	3,500.00	\$	42,000.00
59	510051(F)	STRUCTURAL CONCRETE (BRIDGE FOOTING)	CY	452	\$	375.00	\$	169,500.00
60	510053(F)	STRUCTURAL CONCRETE (BRIDGE)	CY	717	\$	655.00	\$	469,635.00
61	510086(F)	STRUCTURAL CONCRETE, APPROACH SLAB TYPE N(S)	CY	180	\$	400.00	\$	72,000.00
62	519088(F)	JOINT SEAL TYPE B (MR=1")	LF	202	\$	75.00	\$	15,150.00
63	520102 (P-F-S)	BAR REINFORCING STEEL (BRIDGE)	LB	250,800	\$	0.75	\$	188,100.00
64	839541	TRANSITION RAILING (TYPE WB)	EA	1	\$	4,500.00	\$	4,500.00
65	000003	SEISMIC EXPANSION JOINTS	EA	4	\$	8,000.00	\$	32,000.00
66	833140(F)	CONCRETE BARRIER TYPE 26 (MOD)	LF	360	\$	150.00	\$	54,000.00
67	833088(F)	TUBULAR HANDRAILING	LF	360	\$	50.00	\$	18,000.00
68	750501(P-F)	MISCELLANEOUS METAL (BRIDGE)	LB	2,240	\$	6.00	\$	13,440.00
69	511035	ARCHITECTURAL FINISH (STONE VENEER)	SQFT	995	\$	30.00	\$	29,850.00
70	721810(F)	SLOPE PAVING (CONCRETE) [SLOPE PROTECTION]	SQFT	10,000	\$	50.00	\$	500,000.00
71	703450(P-F)	WELDED STEEL PIPE CASING (BRIDGE) (37 3/8" DIA)	LF	65	\$	150.00	\$	9,750.00
72	703450(P-F)	WELDED STEEL PIPE CASING (BRIDGE) (12" DIA)	LF	186	\$	75.00	\$	13,950.00
73	703450(P-F)	WELDED STEEL PIPE CASING (BRIDGE) (20 5/8" DIA)	LF	186	\$	140.00	\$	26,040.00
74	518002	SOUND WALL (12" MASONRY BLOCK WALL)	SQFT	19,200	\$	30.00	\$	576,000.00
75	000003	FURNISH & INSTALL 24"CML&P WATER INCLUDING FULL WELD DOUBLE PASS JOINTS [EMWD]	LF	126	\$	150.00	\$	18,900.00
76	000003	FURNISH & INSTALL 24"CML&C WATER INCLUDING FULL WELD DOUBLE PASS JOINTS [EMWD]	LF	45	\$	150.00	\$	6,750.00
77	000003	FURNISH & INSTALL 24"PVC, CL-235 WATERLINE INCLUDING RESTRAIN JOINTS [EMWD]	LF	99	\$	175.00	\$	17,325.00
78	000003	FURNISH & INSTALL 2" AV&R PER B-367 AND PER DETAIL D-34066 [EMWD]	EA	1	\$	4,500.00	\$	4,500.00
79	000003	FURNISH & INSTALL FLEX TEND [EMWD]	EA	2	\$	20,500.00	\$	41,000.00
80	000003	FURNISH & INSTALL 6" BLOWOFF PER B-568 [EMWD]	EA	1	\$	4,500.00	\$	4,500.00
81	000003	REMOVE CAP AND JOIN EXISTING 24" WATERLINE	EA	1	\$	4,500.00	\$	4,500.00
82	000003	PROVIDE CONCRETE CAP PER B-408 [EMWD]	CY	120	\$	150.00	\$	18,000.00
83	000003	PROVIDE AND INSTALL CORROSION PROTECTION PER DETAIL 2 [EMWD]	LS	2	\$	150.00	\$	300.00
84	000003	FURNISH & INSTALL 6" PVC, C-900, DR-18 RECYCLED WATER PIPELINES WITHOUT RESTRAINT [EMWD]	LF	351	\$	30.00	\$	10,530.00
85	000003	FURNISH & INSTALL 6" PVC, C-900, DR-18 RECYCLED WATER PIPELINES INCLUDING RESTRAINTS [EMWD]	LF	141	\$	40.00	\$	5,640.00
86	000003	FURNISH & INSTALL 12" PVC, C-900, DR-18 RECYCLED WATER PIPELINES INCLUDING RESTRAINTS [EMWD]	LF	200	\$	75.00	\$	15,000.00
87	000003	FURNISH & INSTALL 12" PVC, C-900, DR-18 RECYCLED WATER PIPELINES WITHOUT RESTRAINT [EMWD]	LF	325	\$	65.00	\$	21,125.00
88	000003	REMOVE 6" END CAP AND JOIN EXISTING 6" RECYCLED WATER PIPELINE [EMWD]	EA	1	\$	2,500.00	\$	2,500.00
89	000003	REMOVE 12" END CAP AND JOIN EXISTING 12" RECYCLED WATER PIPELINE [EMWD]	EA	2	\$	3,500.00	\$	7,000.00
90	000003	FURNISH AND INSTALL 12" FXH RSGV PER B-255 [EMWD]	EA	1	\$	2,750.00	\$	2,750.00
91	000003	FURNISH AND INSTALL 12-INCH DIAMETER DUCTILE IRON PIPE, CLASS 350, CEMENT MORTAR LINED AND POLYETHYLENE WRAP COMPLETE IN PLACE [EMWD]	LF	829	\$	200.00	\$	165,800.00

Goetz Road (From Newprt Rd to 900 feet N of Normandy Rd) & Newport Road Completion

92	000003	FURNISH AND INSTALL 8-INCH DIAMETER DUCTILE IRON PIPE, CLASS 350, CEMENT MORTAR LINED AND POLYETHYLENE WRAP COMPLETE IN PLACE. [EVMWD]	LF	87	\$	180.00	\$	15,660.00
93	000003	FURNISH AND INSTALL 20-INCH ID STEEL CASING [EVMWD]	LF	32	\$	550.00	\$	17,600.00
94	000003	FURNISH AND INSTALL 6-INCH BLOW OFF ASSEMBLY PER EVMWD STD. DWG. NO. W-19, COMPLETE IN PLACE [EVMWD]	EA	1	\$	4,800.00	\$	4,800.00
95	000003	FURNISH AND INSTALL 8-INCH BLOW OFF ASSEMBLY PER EVMWD STD. DWG. NO. W-19, COMPLETE IN PLACE [EVMWD]	EA	1	\$	5,000.00	\$	5,000.00
96	000003	FURNISH AND INSTALL 8-INCH RESILIENT WEDGE GATE VALVE PER EVMWD SPECIFICATIONS AND STD. DWG. NO. W-13, COMPLETE IN PLACE [EVMWD]	EA	2	\$	3,800.00	\$	7,600.00
97	000003	FURNISH AND INSTALL 12-INCH RESILIENT WEDGE GATE VALVE PER EVMWD SPECIFICATIONS AND STD. DWG. NO. W-13, COMPLETE IN PLACE [EVMWD]	EA	2	\$	4,000.00	\$	8,000.00
98	000003	HYDROSTATIC PRESSURE TESTING AND DISINFECTION OF PIPELINES AND APPURTENANCES IN ACCORDANCE WITH SPECIFICATION 15044 [EVMWD]	LS	1	\$	1,500.00	\$	1,500.00
99	000003	PROVIDING, INSTALLING, AND COMPLETING ALL SYSTEM INTERCONNECTIONS. [EVMWD]	LS	1	\$	2,000.00	\$	2,000.00
100	000003	PROVIDING AND RECONNECTING POTABLE WATER SERVICES [EVMWD]	LS	1	\$	2,000.00	\$	2,000.00
101	000003	ALL ITEMS SHOWN, IMPLIED OR NECESSARY TO PROVIDE COMPLETE WATER SYSTEM NOT SPECIFICALLY LISTED ELSEWHERE. [EVMWD]	LS	1	\$	2,000.00	\$	2,000.00
102	000003	MAINTAINING, PREPARING, AND SUBMITTING RECORD DOCUMENTS IN ACCORDANCE WITH SPECIFICATION 01770 [EVMWD]	LS	1	\$	1,000.00	\$	1,000.00

BASE BID SUB TOTAL:
(Items 1-102)

\$ 6,560,046.00

ALTERNATE BID SCHEDULE 1 (EMWD, EXTENSION OF 24" LINE) Description: Roadway Reconstruction

ITEM NO	ITEM CODE	ITEM	UNIT	ESTIMATED QUANTITY	UNIT PRICE	EXTENDED AMOUNT	
103	000003	FURNISH & INSTALL 24"PVC, CL-235 WATERLINE WITHOUT RESTRAINT	LF	1,349	\$	150.00	\$ 202,350.00
104	000003	FURNISH & INSTALL 24"PVC, CL-235 WATERLINE INCLUDING RESTRAINTS	LF	1,051	\$	175.00	\$ 183,925.00
105	000003	FURNISH & INSTALL 6" FIRE HYDRANT PER B-362	EA	5	\$	4,500.00	\$ 22,500.00
106	000003	FURNISH & INSTALL 42" HDPE CASING	LF	35	\$	550.00	\$ 19,250.00
107	000003	REMOVE 24" END CAP	EA	1	\$	110.00	\$ 110.00
108	000003	JOIN EXISTING 24" WATERLINE	EA	2	\$	4,500.00	\$ 9,000.00
109	000003	FURNISH & INSTALL 12" PVC, C-900, CL-200 INCLUDING RESTRAINTS	LF	25	\$	75.00	\$ 1,875.00
110	000003	FURNISH & INSTALL 12" PVC, C-900, DR-18 INCLUDING RESTRAINTS	LF	101	\$	65.00	\$ 6,565.00
111	000003	FURNISH & INSTALL 1" AV&AR PER B-598	EA	1	\$	2,750.00	\$ 2,750.00
112	000003	FURNISH & INSTALL 6" BLOWOFF PER B-568	EA	1	\$	4,500.00	\$ 4,500.00
113	000003	FURNISH & INSTALL 12" RSGV PER B-255	EA	1	\$	2,750.00	\$ 2,750.00
114	000003	FURNISH & INSTALL 24" RSGV PER B-255	EA	2	\$	22,000.00	\$ 44,000.00
115	000003	REMOVE 18" BLIND FLANGE	EA	1	\$	250.00	\$ 250.00
116	000003	REMOVE 18" FXF BFV	EA	1	\$	450.00	\$ 450.00
117	000003	REMOVE EXISTING BLOWOFF AND INSTALL BLIND FLANGE	EA	2	\$	1,450.00	\$ 2,900.00

ALTERNATE BID SUB TOTAL:
(Items 103-117)

\$ 503,175.00

SUB TOTAL OF ALL ITEMS
(Items 1-117)

\$ 7,063,221.00

	999994	CONTINGENCY [@ 10%]	LS	1	\$	706,322.10	\$	706,322.10
--	--------	---------------------	----	---	----	------------	----	------------

TOTAL OF ALL ITEMS

\$ 7,769,543.10

**GOETZ ROAD AND NEWPORT ROAD
COMPLETION OF IMPROVEMENTS
PROJECT NO. B8-0643**

SPECIFICATIONS AND CONTRACT DOCUMENTS

for
the construction of

**GOETZ ROAD AND NEWPORT ROAD
COMPLETION OF IMPROVEMENTS**

PROJECT NO. B8-0643

Contract Approvals:

Approved By:

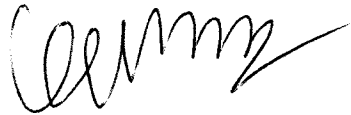

Khalid Nasim,
Engineering Division Manager

6/28/10

Date

Recommended by:



Neil Nilchian,
County Project Manager

6/27/10

Date

SPECIFICATIONS AND CONTRACT DOCUMENTS

for the construction of

**GOETZ ROAD
COMPLETION OF IMPROVEMENTS**

PROJECT NO. B8-0643

Engineering Certification:

These specifications, Special Provisions, and estimates have been prepared by or under the direction of the following Registered Civil Engineer:



Amir H. Fallahi,
No. 55534

4/7/2010

Date



SPECIFICATIONS AND CONTRACT DOCUMENTS

for the construction of

**GOETZ ROAD
COMPLETION OF IMPROVEMENTS**

PROJECT NO. B8-0643

Goetz Road Bridge [Audie Murphy Ranch Bridge] Technical Specifications

Engineering Certification:

These specifications, Special Provisions, and estimates have been prepared by or under the direction of the following Registered Civil Engineer:

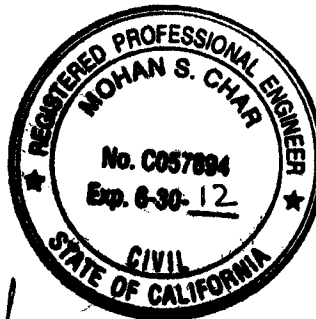

Mohan Char

06/11/10

Mohan Char
C 057894

Date

TABLE OF CONTENTS

	<u>PAGE</u>
Notice Inviting Bids	
Instruction to Bidders	A1-A7
Contractor's Proposal	B1-B7
Non-Collusion Affidavit	B8-B10
Bid Bond	B11
Agreement	C1-C3
Performance Bond	C4
Payment Bond	C5
General Conditions	1-21
Definitions	1
Standard Specifications	1
Director of Transportation	2
Site Inspection	3
Protection of Premises	4
Change Orders	5
Substitution of Equals	6
Final Inspection - Notice of Completion	7
Termination of Contracts	7
Payments and Monthly Estimates	8
Force Account Payment	9
Final Payment	9
Damages	10
Documents of Contractor	10
Responsibility of Contractor in Emergency	11
Labor Code	11
Obstructions	12
Insurance - Hold Harmless	12
Equal Employment Opportunity	14
Deposit of Securities	16
Assignment of Claims	16
Claims Resolution	17
Dust Abatement	18
AQMD Requirements	22-47
Special Provisions	48-183
Appendix A (Compaction Grouting Specification)	
Appendix B (Subsurface Investigation Plan)	
Appendix C (Environmental Specification)	
Reference Drawings	

SPECIAL PROVISIONS

DESCRIPTION	49
STANDARD PLANS AND SPECIFICATIONS	50
SUPPLEMENTAL PROJECT INFORMATION	50
AMENDMENTS TO STATE STANDARD SPECIFICATIONS	50
DISPOSAL OF EXCESS EXCAVATION OR MATERIALS	51
RECORD DRAWINGS	51
ORDER OF WORK	52
LIQUIDATED DAMAGES	52
EXAMINATION OF PLANS, SPECIFICATIONS, CONTRACT, AND SITE WORK	53
DIFFERING SITE CONDITIONS	53
COOPERATION	54
MISCELLANEOUS DIRECTED WORK (FORCED ACCOUNT)	54
ITEMS OF WORK	55
PROGRESS SCHEDULE (CRITICAL PATH METHOD)	55
MOBILIZATION	59
PAYMENTS	59
TRAFFIC CONTROL SYSTEM	60
ENCROACHMENT PERMIT	62
AREAS FOR CONTRACTOR'S USE	62
INSURANCE	63
COURSE OF CONSTRUCTION INSURANCE	64
CLEARING AND GRUBBING	64
DEVELOP WATER SUPPLY	65
EARTHWORK/ROADWAY EXCAVATION (INCLUDING GRADING)	65
FINISHING ROADWAY	70
IMPORT BORROW	70
WATER POLLUTION CONTROL	70
EROSION CONTROL [HYDROSEED LANDSCAPE SLOPE AREA]	78
EXISTING HIGHWAY FACILITIES	79
AGGREGATE BASE	79
PREPARING EXISTING ROADBED FOR RESURFACING	80
HOT MIX ASPHALT	81
COMPENSATION ADJUSTMENTS FOR PRICE INDEX FLUCTUATIONS	89
MINOR CONCRETE CURB AND GUTTER, TYPE "D" CURB, CROSS-GUTTER, PAD, DRIVEWAY APPROACHES, CURB RAMPS, SIDEWALK AND CONCRETE PAVEMENT FOR BUS TURNOUT	91
PLACE ASPHALT CONCRETE DIKE	92
REINFORCED CONCRETE PIPE	93
CORRUGATED METAL PIPE AND RISER	93
MINOR CONCRETE STRUCTURES	93
FLO-GARD FILTER	94
ROCK SLOPE PROTECTION	94
METAL HAND RAILING	94
CHAIN LINK FENCE	95
GUARD RAILING (BARRICADE)	95
RESIDENT ENGINEER'S OFFICE	95
DEMOLITION OF EXISTING BLOCK WALL	97
AUDIE MURPHY RANCH BRIDGE	98

MATERIALS	98
WELDING	105
PRESTRESSING CONCRETE	114
PRECAST PRESTRESSED CONCRETE BRIDGE MEMBERS	117
SLIDING BEARINGS	120
ELASTOMERIC BEARING PADS	121
SEALING JOINTS	121
STRUCTURE APPROACH SLABS	122
ARCHITECTURAL FINISH (STONE VENEER)	125
REINFORCEMENT	127
WELDED STEEL PIPE CASING AND UTILITY CONDUIT SUPPORTS	127
CONCRETE SLOPE PROTECTION (SLOPE PAVING)	129
MISCELLANEOUS METAL (BRIDGE)	130
TUBULAR HAND RAILING	130
SEISMIC EXPANSION JOINT ASSEMBLY	131
METAL BEAM GUARD RAILING	132
TERMINAL SYSTEM (ALTERNATIVE FLARED SYSTEM)	133
TRANSITION RAILING (TYPE WB)	134
CONCRETE BARRIER TYPE 26	134
TELEPHONE AND ELECTRICAL CONDUIT SYSTEM	135
ROADSIDE SIGN (INSTALL/RELOCATE/REMOVE/SALVAGE)	135
DELINEATORS (CLASS I, TYPE Q)	136
REMOVE TRAFFIC STRIPE AND PAVEMENT MARKING	137
THERMOPLASTIC CROSSWALK AND PAVEMENT MARKING	137
PAINT TRAFFIC STRIPE	138
PAVEMENT MARKER (REFLECTIVE)	139
SIGNAL AND LIGHTING	139
BATTERY BACKUP SYSTEM	173
OBSTRUCTIONS	181

NOTICE INVITING BIDS

County of Riverside, herein called Owner, invites sealed proposals for:

**GOETZ ROAD AND NEWPORT ROAD
COMPLETION OF IMPROVEMENTS
PROJECT NO. B8-0643**

Proposal shall be delivered to the Riverside County Transportation Department, 14th Street Annex, 3525 14th Street, Riverside, California 92501, telephone (951) 955-6780 not later than 2:00 p.m., on Wednesday, September 1, 2010, to be promptly opened in public at said address. Each proposal shall be in accordance with plans, specifications, and other contract documents, dated June 2010, and prepared by County of Riverside, whose address is same as the above, from whom they may be obtained upon deposit of \$60.00 per set plus mailing. No refund. Prospective bidders may preview the plans, specifications and other contract documents, at no charge prior to purchase, at the above noted location.

The Contractor is required to have a Class "A" license at the time of bid submission.

Engineering Estimate:	\$ 5,900,000.00 - \$ 6,900,000.00
Alternate Schedule 1:	\$ 453,000.00 - \$ 529,000.00
Bid Bond	10 %
Performance Bond	100 %
Payment Bond	100 %
Working Days	90 Days

www.tlma.co.riverside.ca.us/trans

INSTRUCTIONS TO BIDDERS

1. Form of Proposal. The proposal must be made on the form of Contractor's Proposal which is included in the Contract Documents and must be completely filled in, dated and signed. If provision is made for alternates, they must all be bid, unless otherwise provided in the Special Provisions.
2. Bid Bond. The proposal must be accompanied by a 10% Bid Bond, using the form provided in the Contract Documents, or by a certified or cashier's check payable to the order of County in an amount not less than 10% of the amount bid, inclusive of alternates.
3. Submission of Proposal. A proposal must be submitted in a sealed opaque envelope which clearly identifies the bidder and the project. Bids must be received by the time and at the place set forth in the Notice Inviting Bids and may be withdrawn only as stated in the proposal. **Bids shall be completed in ink.**
4. Contract Documents. The complete Contract Documents are identified in the Agreement. Potential bidders are cautioned that the successful bidder incurs duties and obligations under all of the Contract Documents and that they should not merely examine the Plans and Specifications in making their bid.
5. License. To be considered for award of the contract, a potential bidder must have the kind of license required under provisions of the California Business and Professions Code for the work covered in this proposal. This includes joint ventures.

Each item of work will be performed by a Contractor which is qualified and properly licensed for that work.

Pursuant to California Labor Code Section 3099, certification is required for all persons who perform work as electricians for Contractors licensed as Class C-10 Electrical Contractors. Proof of certification shall be provided to the County before the start of construction.

6. Quantities. The amount of work to be done or materials to be furnished under the Contract as shown in the Contractor's Proposal are but estimates and are not to be taken as an expressed or an implied statement that the actual amount of work or materials will correspond to the estimate.

County reserves the right to increase or decrease or to entirely eliminate certain items from the work or materials to be furnished if such action is found to be desirable or expedient. Contractor is cautioned against the unbalancing of his bid by prorating his overhead only into one or two items when there are a number of items listed in the schedule.

7. Interpretation of Documents. Discrepancies, omissions, ambiguities, requirements likely to cause disputes between trades and similar matter shall be promptly brought to the attention of the County of Riverside in writing. When appropriate, Addenda will be issued by County.

If the Bidder requires clarification or interpretation of the Bidding Documents, the Bidder shall make a written request to the County by a Request for Information (RFI). All requests for information must be submitted, in writing, between the hours of 8:00 AM and 5:00 PM on any day, Monday through Friday (except holidays), up to, including and no later than the fifth (5th) day prior to Bid Closing Deadline, by hand delivery, mail, fax or electronic mail. The County of Riverside will not respond to Requests for Information submitted after that time, unless the County determines, at its sole discretion, which it is in the best interest of the public and the County to do so. Requests for Information should be addressed to County of Riverside, Transportation Department, Attn: Joel Jimenez; 3525 14th Street, Riverside, CA 92501, facsimile (951) 955-3164, electronic mail: jrjimenez@rctlma.org

No communication by anyone as to such matters except by an Addendum affects the meaning or requirements of the Contract Documents.

8. ADDENDA. County reserves the right to issue Addenda to the Contract Documents at any time prior to the time set to open bids. Each potential bidder shall leave with the County Transportation Department his name and address for the purpose of receiving Addenda to be mailed or delivered to such names at such addresses. To be considered, a Contractor's Proposal must list and take into account all issued Addenda.
9. Inspection of Site. Bidders must examine the site and acquaint themselves with all conditions affecting the work. By making his bid a bidder warrants that he has made such site examination as he deems necessary as to the condition of the site, its accessibility for materials, workmen and utilities and ability to protect existing surface and subsurface improvements. No claim for allowances - time or money - will be allowed as to such matters.
10. Bonds. The County requires a 100% Payment Bond and 100% Performance Bond from the successful bidder. All Bonds must be on County's forms contained in the Contract Documents.

The bonds must be underwritten by a Surety Company, which is admitted to transact the business of insurance in the State of California, and which carries a rating in the current issue of Best's Insurance Guide of "A" or better with a financial size of at least "VIII". The bond forms included in the project documents shall be used. All signatures on the bonds shall be notarized. Bonds shall be provided with an executed Power of Attorney issued by the surety.

11. Bids. Bids are required for the entire work, including all alternate bid schedules, if applicable, unless otherwise explicitly allowed in the bid documents. The amount of the bid for comparison purposes will be the total of all items. The total of unit basis items will be determined by extension of the item price bid on the basis of the estimated quantity set forth for the item.

The bidder shall set forth for each item of work in clearly legible figures, an item price and a total for the item in the respective spaces provided for this purpose. In the case of unit basis items, the amount set forth under the "Total" column shall be the extension of the item price bid on the basis of the estimated quantity for the item.

In case of discrepancy between the item price and the total set forth for the item, the item price shall prevail, provided, however, if the amount set forth as an item price is ambiguous, unintelligible or uncertain for any cause, or is omitted, or in the case of unit basis items, is the same amount as the entry in the "Total" column, then the amount set forth in the "Total" column for the item shall prevail in accordance with the following:

- a. As to lump sum items, the amount set forth in the "Total" column shall be the item price.
- b. As to unit basis items, the amount set forth in the "Total" column shall be divided by the estimated quantity for the item and the price thus obtained shall be the item price.

The bidder is advised that the items of work may be grouped into bid schedules, and that certain bid items may be listed in more than one bid schedule, and with different bid item numbers, and the following shall apply thereto:

The bidder is directed to submit the same bid amount for all contract bid items that are listed with the same item code and item description. Said bid items are referred to herein as "Like Bid Items".

"Like Bid Items" shall be considered a single bid item for purposes of calculating increased and decreased quantities, and as otherwise applicable in Section 4-1.03, "Changes" of the Standard Specifications.

The following are not subject to this bidding requirement:

1. Bid items with the same item code but different item descriptions.
2. Bid items that are measured as "lump sum" or "force account".

3. Alternate bid schedules.

In the event that a bidder submits different unit bid amounts for "Like Bid Items", as described above, the bid will be corrected by applying the lowest of the unit bid amounts to all the respective "Like Bid Items".

No bidder may withdraw his bid for a period of ninety (90) days after the bid opening.

12. Award of Contract. The County reserves the right to reject all bids received. Acceptance by the governing body of the County by resolution or minute order at a meeting regularly called and held of a Contractor's Proposal constitutes an award of the contract and the execution of the Agreement is a written memorial thereof.

The County of Riverside will submit the contract documents to the low responsive and responsible bidder for execution prior to award utilizing the following procedures and requirements:

- a. A bidder whose proposal is accepted shall execute the formal construction agreement with the County of Riverside, similar to the form attached hereto as a sample, and shall return said agreement, together with approved performance and payment bonds and with complete evidence of insurance as required elsewhere herein, including executed additional insured endorsements and waivers of subrogation, within ten (10) working days from the date of the Notice of Acceptance of Proposal and Intent to Award as issued by the Transportation Department. All submittals shall meet the requirements of the bid documents. Corrections, if required, shall be made and the revised documents shall be resubmitted within two (2) working days of Contractor's receipt of review comments.
- b. The contract bonds and insurance documentation shall be submitted in accordance with the contract requirements prior to submission to the County of Riverside Board of Supervisors for award by the Transportation Department, and prior to the performance of any work under the contract.
- c. If a Bidder to whom a Notice of Acceptance of Proposal and Intent to Award has been issued, fails or refuses to sign a construction agreement, or to furnish the bonds or insurance certificates and endorsements as required within the prescribed period of time as described above, the County of Riverside may, at its sole discretion, rescind the

Notice of Acceptance, and the bid guarantee submitted by that Contractor shall become the property of the County of Riverside as prescribed in the bid documents and as allowed by law.

- d. If it is in the best interest of the County of Riverside, the County reserves the right to award the contract prior to execution by the Contractor. Thereafter, County shall mail or deliver to the lowest responsible bidder the agreement for Contractor's execution and return.
13. Return of Guarantee. Bid bonds will not be returned unless specifically requested by the bidder. Any submitted negotiable securities of unsuccessful bidders will be returned by mail within 30 days of the award of a contract to the successful bidder. Any submitted negotiable security of the successful bidder will be returned by mail within 30 days of receipt by the County of executed contract, certificate of insurance, performance bond and payment Bond.
14. Subletting and Subcontracting. Bidders are required pursuant to the Subletting and Subcontracting Fair Practices Act (commencing with Section 4100 of the Public Contracts Code) to list in their proposal the name and location of place of business of each subcontractor who will perform work or labor or render services in or about the construction of the work or improvement or a subcontractor who specifically fabricates and installs a portion of the work or improvement according to detailed drawings contained in the Plans and Specifications in excess of 1/2 of 1% of this prime Contractor's total bid. Failure to list a subcontractor for a portion of the work means that the prime Contractor will do that portion of the work. It is the County's intent for the Subletting and Subcontracting Fair Practice Act to apply to all phases of the work.
15. Qualifications of Bidders. No award will be made to any bidder who cannot give satisfactory assurance to the Board of Supervisors as to his own ability to carry out the contract, both from his financial standing and by reason of his previous experience as a Contractor on work of the nature contemplated in the contract. The bidder may be required to submit his record of work of similar nature to that proposed under these specifications, and unfamiliarity with the type of work may be sufficient cause for rejection of bid.
16. Contract Participation. Riverside County's M/W/DVBE Contract Participation Program affirms the utilization and participation of qualified minority, women and disabled veteran firms in its contracting and procurement activities. The County encourages general and prime Contractors to afford competitive subcontracting opportunities to minority,

women and disabled veteran firms where possible, in their contracting and procurement activities with the County of Riverside.

17. Hours of Work. Attention is directed to Section 8-1.06, "Time of Completion" and Section 7-1.01A (1), "Hours of Labor" of the Standard Specifications.

Daily working hours shall be between the hours of 7:00 a.m. and 6:00 p.m., Monday through Friday, except legal holidays, as approved by the Engineer. Exceptions and specific work schedules shall be submitted to the Engineer for consideration.

18. Labor Code. Pursuant to the Labor Code, the governing board of the Owner has obtained from the Director of the Department of Industrial Relations, State of California, his determinations of general prevailing rates of per diem wages applicable to the work, and for holiday, and overtime work, including employer payments for health and welfare, pensions, vacation and similar purpose, as set forth on schedule which is on file at the principal office of the Owner, and which will be made available to any interested person upon request.

19. Alternate Bid Schedules. If the Proposal includes bid items listed under a Base Bid Schedule and one or more Alternate Bid Schedules, the following shall apply: The County may award only the items of work listed on the Base Bid Schedule, or may choose to award some or all of the Alternate Bid Schedules in addition to the Base Bid Schedule. Unless otherwise specified, the basis of the selection of the lowest bid shall be the lowest responsive and responsible bid for the sum of all Bid Schedules.

If the Proposal includes bid items listed under two or more Alternate Bid Schedules with no Base Bid Schedule, the following shall apply: This project contains Alternate Bid Schedules that may or may not be mutually exclusive, as described elsewhere in the bid documents. The County may award the items of work listed on one or more of the Alternate Bid Schedules. In the case of mutually exclusive Alternate Bid Schedules, only one of the Alternate Bid Schedules will be selected for award. Unless otherwise specified, the basis of the selection of the lowest bid shall be the lowest responsive and responsible bid for the sum of all Bid Schedules.

The County also reserves the right to reject all bids received.

20. Dust Abatement. Attention is directed to Section 23, "Dust Abatement" with regard to the dust abatement provisions of the contract.

21. Submission of Insurance Certificate. Within ten (10) working days of the date of the Notice of Acceptance of Proposal and Intent to Award issued by the County of Riverside, the successful Contractor shall submit a certificate of insurance, including required endorsements, which provides evidence that the bidding Contractor has insurance coverage that meets the requirements of Section 18 of the General Conditions. Failure to have complete insurance coverage in place and to provide all required certificates and endorsements within the specified ten (10) working days period will be grounds for declaring the bidder to not be in compliance with the bid documents, rescinding the Notice of Acceptance, making a claim against the bid bond, and awarding to the second low bidder, at the sole discretion of the County.

CONTRACTOR'S PROPOSAL

TO: COUNTY OF RIVERSIDE

DATE: _____

hereafter called "County":

BIDDER: _____
(hereafter called "Contractor")

THE UNDERSIGNED, Contractor, having carefully examined the site and the Contract Documents for the construction of GOETZ ROAD AND NEWPORT ROAD COMPLETION OF IMPROVEMENTS, Project No. B8-0643 hereby proposes to construct the work in accordance with the Contract Documents, including Addenda Nos. _____ for the amount stated in this Proposal.

By submitting this Proposal, Contractor agrees with County:

1. That unless withdrawn in person by Contractor or some person authorized in writing by Contractor not by telephone or telegram before the time specified in the Notice Inviting Bids for the public opening of bids, this Proposal constitutes an irrevocable offer for 90 calendar days after that date.
2. County has the right to reject any or all Proposals and to waive any irregularities or informalities contained in a Proposal.
3. To execute the Agreement and deliver the Faithful Performance Bond, Payment Bond and Insurance Certificate with endorsements, which comply with the requirements set forth in the Instructions to Bidders and General Conditions, within ten (10) working days of the date of the Notice of Acceptance of Proposal and Intent to Award as issued by the County of Riverside.
4. That the contract shall be awarded upon a resolution or minute order to that effect duly adopted by the governing body of County; and that execution of the Contract Documents shall constitute a written memorial thereof.
5. To submit to County such information as County may require to determine whether a particular Proposal is the lowest responsible bid submitted.
6. That the accompanying certified or cashier's check or Bid Bond is in an amount not less than 10% of the total bid submitted and constitutes a guarantee that if awarded the contract, Contractor

will execute the Agreement and deliver the required bonds within ten (10) days after notice of award. If Contractor fails to execute and deliver said documents, the check or bond is to be charged with the costs of the resultant damages to County, including but not limited to publication costs, the difference in money between the amount bid and the amount in excess of the bid which it costs County to do or cause to be done the work involved, lease and rental costs, additional salaries and overhead, increased interest and costs of funding the project, attorney expense, additional engineering and architectural expense and cost of maintaining or constructing alternate facilities occasioned by the failure to execute and deliver said documents.

7. By signing this proposal the Contractor certifies that the representations made therein are made under penalty of perjury.

**Goetz Road and Newport Road
Completion of Improvements**

Project No. B8-0643

PROPOSAL

BASE BID

ITEM No.	ITEM CODE	ITEM	UNIT	ESTIMATED QUANTITY	ITEM PRICE (IN FIGURES)	TOTAL (IN FIGURES)
1	999990	MOBILIZATION	LS	1		
2	066102	DUST ABATEMENT	LS	1		
3	074020	WATER POLLUTION CONTROL	LS	1		
4	120100	TRAFFIC CONTROL SYSTEM	LS	1		
5	066105	RESIDENT ENGINEERS OFFICE	LS	1		
6	170101	DEVELOP WATER SUPPLY	LS	1		
7	160101	CLEARING AND GRUBBING	LS	1		
8	000003	COURSE OF CONSTRUCTION INSURANCE	LS	1		
9	190101	EARTHWORK / ROADWAY EXCAVATION	CY	70,000		
10	000003	DEMOLISHING EXISTING BLOCK WALL	LS	1		
11	198001	IMPORT BORROW [EARTHWORK FILL]	CY	44,000		
12	000003	MISCELLANEOUS DIRECTED WORK	FA	1	25,000.00	25,000.00
13	510501	MINOR CONCRETE [PAVEMET (8" THICK) OVER CEMENT TREATED BASE (12" THICK), CRS 814 FOR BUS TURN OUT]	SQFT	1,700		
14	510501	MINOR CONCRETE (CURB AND GUTTER) (CRS 200)	LF	5,560		
15	510501	MINOR CONCRETE (TYPE "D" CURB) (CRS 204) [6"]	LF	3,980		
16	510501	MINOR CONCRETE (TYPE "D" CURB) (CRS 204) [8"]	LF	2,950		
17	510501	MINOR CONCRETE (CROSS-GUTTER) (CRS 209)	SQFT	2,740		
18	510501	MINOR CONCRETE SIDEWALK (CRS401)	SQFT	20,700		
19	510501	MINOR CONCRETE (CURB RAMP) (CRS 403 - CASE A)	EA	5		
20	510501	MINOR CONCRETE (COMMERCIAL DRIVE APPROACH (CRS 207A W=30' R=15')	SQFT	780		
21	510501	MINOR CONCRETE V-DITCH	LF	680		
22	013903	PLACE ASPHALT CONCRETE DIKE (CRS 212) (6")	LF	1,400		
23	260201	CLASS 2 AGGREGATE BASE	CY	12,200		
24	390130	HOT MIX ASPHALT	TON	10,100		
25	018031	GUARD RAILING (BARRICADE) (CRS 810)	LF	54		
26	000003	METAL HAND RAILING PER A.P.W.A. 606-1 TYPE B	LF	125		
27	832001	METAL BEAM GUARD RAILING	LF	63		
28	839565	TERMINAL SYSTEM(TYPE SRT)	EA	1		
29	017003	CATCH BASIN (RIV. CO. STD. 311)	EA	12		
30	000003	FLO-GARD PLUS FILTER	EA	13		
31	650014	18" REINFORCED CONCRETE PIPE	LF	235		
32	650017	24" REINFORCED CONCRETE PIPE	LF	130		
33	800300	CHAIN LINK FENCE [RCFC&WCD STD. DWG. NO. M-801]	LF	25		
34	000003	JUNCTION STRUCTURE PER RCFC STD.NO. JS227 (BREAK INTO EXISTING 18" RCP)	EA	1		
35	000003	MEDIAN DRAIN INLET (CALTRANS STD. DWG. D73, TYPE G1)	EA	1		

PROPOSAL

BASE BID

ITEM No.	ITEM CODE	ITEM	UNIT	ESTIMATED QUANTITY	ITEM PRICE (IN FIGURES)	TOTAL (IN FIGURES)
36	665016	18" CORRUGATED METAL PIPE	LF	225		
37	703220	18" CORRUGATED METAL PIPE RISER	EA	2		
38	705001	END SECTION PER CAL TRANS D94A	EA	2		
39	721025	ROCK SLOPE PROTECTION (2-TON, METHOD B)	CY	40		
40	721007	ROCK SLOPE PROTECTION (1/4-TON, METHOD B)	CY	100		
41	721007	ROCK SLOPE PROTECTION (1/2-TON METHOD A)	CY	100		
42	840519	THERMOPLASTIC CROSSWALK AND PAVEMENT MARKING	SQFT	1,850		
43	840656	PAINT TRAFFIC STRIPE (2 COAT)	LF	22,700		
44	850102	PAVEMENT MARKER (REFLECTIVE)	EA	1,100		
45	566011	ROADSIDE SIGN - ONE POST	EA	28		
46	820107	DELINEATOR (CLASS 1) [TYPE Q]	EA	13		
47	860811	DETECTOR LOOP	EA	15		
48	860201	TRAFFIC SIGNAL AND LIGHTING [NEWPORT ROAD & GOETZ ROAD INTERSECTION]	LS	1		
49	861502	TRAFFIC SIGNAL MODIFICATION[GOETZ ROAD & CANYON LAKE DRIVE]	LS	1		
50	203031	ERROSION CONTROL (HYDRO SEED) [LANDSCAPE SLOPE AREAS]	SQFT	17,130		
51	150740	REMOVE AND SALVAGE SIGN [EXISTING]	EA	17		
52	861349	REMOVE EXISTING TRAFFIC SIGNAL [GOETZ ROAD & NORMANDY ROAD]	LS	1		
53	071325	TEMPORARY FENCE (TYPE ESA)	LF	1,200		
54	000003	PRESSURE GROUTING (NORTH ABUTMENT)	LS	1		
55	192003(F)	STRUCTURE EXCAVATION (BRIDGE) TYPE (D)	CY	1,964		
56	193003(F)	STRUCTURE BACKFILL (BRIDGE)	CY	1,612		
57	512253(F)	FURNISH PRECAST/PRESTRESSED CONCRETE "BULB TEE" GIRDER	EA	12		
58	512500(F)	ERECT PRECAST/PRESTRESSED CONCRETE "BULB TEE" GIRDER	EA	12		
59	510051(F)	STRUCTURAL CONCRETE (BRIDGE FOOTING)	CY	452		
60	510053(F)	STRUCTURAL CONCRETE (BRIDGE)	CY	717		
61	510086(F)	STRUCTURAL CONCRETE, APPROACH SLAB TYPE N(S)	CY	180		
62	519088(F)	JOINT SEAL TYPE B (MR=1")	LF	202		
63	520102 (P-F-S)	BAR REINFORCING STEEL (BRIDGE)	LB	250,800		
64	839541	TRANSITION RAILING (TYPE WB)	EA	1		
65	000003	SEISMIC EXPANSION JOINTS	EA	4		
66	833140(F)	CONCRETE BARRIER TYPE 26	LF	360		
67	833088(F)	TUBULAR HANDRAILING	LF	360		
68	750501(P-F)	MISCELLANEOUS METAL (BRIDGE)	LB	2,240		
69	511035	ARCHITECTURAL FINISH (STONE VENEER)	SQFT	995		
70	721810(F)	SLOPE PAVING (CONCRETE) [SLOPE PROTECTION]	SQFT	10,000		
71	703450(P-F)	WELDED STEEL PIPE CASING (BRIDGE) (37 3/8" DIA)	LF	65		
72	703450(P-F)	WELDED STEEL PIPE CASING (BRIDGE) (12" DIA)	LF	186		
73	703450(P-F)	WELDED STEEL PIPE CASING (BRIDGE) (20 5/8" DIA)	LF	186		

PROPOSAL

BASE BID

ITEM No.	ITEM CODE	ITEM	UNIT	ESTIMATED QUANTITY	ITEM PRICE (IN FIGURES)	TOTAL (IN FIGURES)
74	518002	SOUND WALL (MASONRY BLOCK WALL)	SQFT	193,200		
75	000003	FURNISH & INSTALL 24" CML&P WATER INCLUDING FULL WELD DOUBLE PASS JOINTS [EMWD]	LF	126		
76	000003	FURNISH & INSTALL 24" CML&C WATER INCLUDING FULL WELD DOUBLE PASS [EMWD]	LF	45		
77	000003	FURNISH & INSTALL 24" PVC, CL-235 WATERLINE INCLUDING RESTRAIN JOINTS [EMWD]	LF	99		
78	000003	FURNISH & INSTALL 2" AV&AR PER B-367 AND PER DETAIL D 34066 [EMWD]	EA	1		
79	000003	FURNISH & INSTALL FLEX TEND [EMWD]	EA	2		
80	000003	FURNISH & INSTALL 6" BLOWOFF PER B-568 [EMWD]	EA	1		
81	000003	REMOVE CAP AND JOIN EXISTING 24" WATERLINE	EA	1		
82	000003	PROVIDE CONCRETE CAP PER B-408 [EMWD]	CY	120		
83	000003	PROVIDE AND INSTALL CORROSION PROTECTION PER DETAIL 2 [EMWD]	LS	2		
84	000003	FURNISH & INSTALL 6" PVC, C-900, DR-18 RECYCLED WATER PIPELINES WITHOUT RESTRAINT [EMWD]	LF	351		
85	000003	FURNISH & INSTALL 6" PVC, C-900, DR-18 RECYCLED WATER PIPELINES INCLUDING RESTRAINTS [EMWD]	LF	141		
86	000003	FURNISH & INSTALL 12" PVC, C-900, DR-18 RECYCLED WATER PIPELINES INCLUDING RESTRAINTS [EMWD]	LF	200		
87	000003	FURNISH & INSTALL 12" PVC, C-900, DR-18 RECYCLED WATER PIPELINES WITHOUT RESTRAINT [EMWD]	LF	325		
88	000003	REMOVE 6" END CAP AND JOIN EXISTING 6" RECYCLED WATER PIPELINE [EMWD]	EA	1		
89	000003	REMOVE 12" END CAP AND JOIN EXISTING 12" RECYCLED WATER PIPELINE [EMWD]	EA	2		
90	000003	FURNISH AND INSTALL 12" FXH RSGV PER B-255 [EMWD]	EA	1		
91	000003	FURNISH AND INSTALL 12-INCH DIAMETER DUCTILE IRON PIPE, CLASS 350, CEMENT MORTAR LINED AND POLYETHYLENE WRAP COMPLETE IN PLACE [EVMWD]	LF	829		
92	000003	FURNISH AND INSTALL 8-INCH DIAMETER DUCTILE IRON PIPE, CLASS 350, CEMENT MORTAR LINED AND POLYETHYLENE WRAP COMPLETE IN PLACE. [EVMWD]	LF	87		
93	000003	FURNISH AND INSTALL 20-INCH ID STEEL CASING [EVMWD]	LF	32		
94	000003	FURNISH AND INSTALL 8-INCH BLOW OFF ASSEMBLY PER EVMWD STD. DWG. NO. W-19, COMPLETE IN PLACE [EVMWD]	EA	1		
95	000003	FURNISH AND INSTALL 8-INCH BLOW OFF ASSEMBLY PER EVMWD STD. DWG. NO. W-19, COMPLETE IN PLACE [EVMWD]	EA	1		
96	000003	FURNISH AND INSTALL 8-INCH RESILIENT WEDGE GATE VALVE PER EVMWD SPECIFICATIONS AND STD. DWG. NO. W-13, COMPLETE IN PLACE [EVMWD]	EA	2		
97	000003	FURNISH AND INSTALL 12-INCH RESILIENT WEDGE GATE VALVE PER EVMWD SPECIFICATIONS AND STD. DWG. NO. W-13, COMPLETE IN PLACE [EVMWD]	EA	2		
98	000003	HYDROSTATIC PRESSURE TESTING AND DISINFECTION OF PIPELINES AND APPURTENANCES IN ACCORDANCE WITH SPECIFICATION 15044 [EVMWD]	LS	1		
99	000003	PROVIDING, INSTALLING, AND COMPLETING ALL SYSTEM INTERCONNECTIONS. [EVMWD]	LS	1		
100	000003	PROVIDING AND RECONNECTING POTABLE WATER SERVICES [EVMWD]	LS	1		

PROPOSAL

BASE BID

ITEM No.	ITEM CODE	ITEM	UNIT	ESTIMATED QUANTITY	ITEM PRICE (IN FIGURES)	TOTAL (IN FIGURES)
101	000003	ALL ITEMS SHOWN, IMPLIED OR NECESSARY TO PROVIDE COMPLETE WATER SYSTEM NOT SPECIFICALLY LISTED ELSEWHERE. [EVMWD]	LS	1		
102	000003	MAINTAINING, PREPARING, AND SUBMITTING RECORD DOCUMENTS IN ACCORDANCE WITH SPECIFICATION 01770 [EVMWD]	LS	1		

SUB-TOTAL: _____ \$ _____

ITEMS 1-102 "WORDS" _____

Alternate Bid Schedule 1 (EMWD, Extension of 24" line)

103	000003	FURNISH & INSTALL 24"PVC, CL-235 WATERLINE WITHOUT RESTRAINT	LF	1,349		
104	000003	FURNISH & INSTALL 24"PVC, CL-235 WATERLINE INCLUDING RESTRAINTS	LF	1,051		
105	000003	FURNISH & INSTALL 6" FIRE HYDRANT PER B-362	EA	5		
106	000003	FURNISH & INSTALL 42" HDPE CASING	LF	35		
107	000003	REMOVE 24" END CAP	EA	1		
108	000003	JOIN EXISTING 24" WATERLINE	EA	2		
109	000003	FURNISH & INSTALL 12" PVC, C-900, CL-200 INCLUDING RESTRAINTS	LF	25		
110	000003	FURNISH & INSTALL 12" PVC, C-900, DR-18 INCLUDING RESTRAINTS	LF	101		
111	000003	FURNISH & INSTALL 1" AV&AR PER B-598	EA	1		
112	000003	FURNISH & INSTALL 6" BLOWOFF PER B-568	EA	1		
113	000003	FURNISH & INSTALL 12" RSGV PER B-255	EA	1		
114	000003	FURNISH & INSTALL 24" RSGV PER B-255	EA	2		
115	000003	REMOVE 18" BLIND FLANGE	EA	1		
116	000003	REMOVE 18" FXF BFV	EA	1		
117	000003	REMOVE EXISTING BLOWOFF AND INSTALL BLIND FLANGE	EA	2		

SUB-TOTAL: _____ \$ _____

ITEM 103-117 "WORDS" _____

PROJECT TOTAL: _____ \$ _____

ITEMS 1-117 "WORDS" _____

BIDDER DATA:

Name of Bidder _____

Type of Organization _____

Person(s) Authorized to Sign for Bidder _____

Address _____

Phone _____

Contractor's License Type & Number _____

Expiration Date _____

8. **DESIGNATION OF SUBCONTRACTORS:** Contractor submits the following complete list of each subcontractor who will perform work or labor or render service in or about the construction in an amount in excess of 1/2 of 1% of the total bid.

<u>ITEM</u>	<u>SUBCONTRACTOR</u>	<u>ADDRESS</u>	<u>LICENSE NO.</u>
-------------	----------------------	----------------	--------------------

Percent of work to be performed by sub-contractors: ___%
(Note: 50% of the work required to be performed by general contractor)

IN WITNESS WHEREOF Contractor executed this Proposal as of the date set forth on Page 1 of this proposal.

TITLE _____
"Contractor"

AFFIDAVIT FOR INDIVIDUAL CONTRACTORS

_____ declares as follows:

That he or she is the party making the foregoing proposal or bid; that the bid is not made in the interest of, or on behalf of, any undisclosed person, partnership, company, association, organization, or corporation; that the bid is genuine and not collusive or sham; that the bidder has not directly or indirectly induced or solicited any other bidder to put in a false or sham bid, and has not directly or indirectly colluded, conspired, connived, or agreed with any bidder or anyone else to put in a sham bid, and that anyone shall refrain from bidding; that the bidder has not in any manner, directly or indirectly, sought by agreement, communication, or conference with anyone to fix the bid price of the bidder or any other bidder, or to fix any overhead, profit, or cost element of the bid price, or of that of any other bidder, or to secure any advantage against the County of Riverside or anyone interested in the proposed contract; that all statements contained in the bid are true; and, further, that the bidder has not, directly or indirectly, submitted his or her bid price or any breakdown thereof, or the contents thereof, or divulged information or data relative thereto, or paid, and will not pay, any fee to any corporation, partnership, company association, organization, bid depository, or to any member or agent thereof to effectuate a collusive or sham bid.

I declare, under penalty of perjury, that the foregoing is true and correct.

Dated this _____ (day) of _____ (month),
_____ (year) at _____, California

Signature of affiant: _____

Note: Notarization of signature required

AFFIDAVIT FOR JOINT VENTURE OR COPARTNERSHIP CONTRACTOR

Declares as follows:

That he or she is a member of the joint venture or copartnership firm designated as _____ which is the party making the foregoing proposal or bid; that the bid is not made in the interest of, or on behalf of, any undisclosed person, partnership, company, association, organization, or corporation; that the bid is genuine and not collusive or sham; that the bidder has not directly or indirectly induced or solicited any other bidder to put in a false or sham bid, and has not directly or indirectly colluded, conspired, connived, or agreed with any bidder or anyone else to put in a sham bid, or that anyone shall refrain from bidding; that the bidder has not in any manner, directly or indirectly, sought by agreement, communication, or conference with anyone to fix the bid price of the bidder or any other bidder, or to fix any overhead, profit, or cost element of the bid price, or of that of any other bidder, or to secure any advantage against the County of Riverside or anyone interested in the proposed contract; that all statements contained in the bid are true; and, further, that the bidder has not, directly or indirectly, submitted his or her bid price or any breakdown thereof, or the contents thereof, or divulged information or data relative thereto, or paid, and will not pay, any fee to any corporation, partnership, company association, organization, bid depository or to any member or agent thereof to effectuate a collusive or sham bid.

That he has been and is duly vested with authority to make and sign instruments for the joint venture or copartnership by _____ who constitute the other members of the joint venture or copartnership.

I declare, under penalty of perjury, that the foregoing is true and correct.

Dated this _____ (day) of _____ (month),
_____ (year)
at _____, California

Signature of affiant: _____

Note: Notarization of signature required

AFFIDAVIT FOR CORPORATE CONTRACTOR

_____ declares as follows:

That he or she is _____ of _____ a corporation which is the party making the foregoing proposal or bid; that the bid is not made in the interest of, or on behalf of, any undisclosed person, partnership, company, association, organization, or corporation; that the bid is genuine and not collusive or sham; that the bidder has not directly or indirectly induced or solicited any other bidder to put in a false or sham bid, and has not directly or indirectly colluded, conspired, connived, or agreed with any bidder or anyone else to put in a sham bid, or that anyone shall refrain from bidding; that the bidder has not in any manner, directly or indirectly, sought by agreement, communication, or conference with anyone to fix the bid price of the bidder or any other bidder, or to fix any overhead, profit, or cost element of the bid price, or of that of any other bidder, or to secure any advantage against the County of Riverside or anyone interested in the proposed contract; that all statements contained in the bid are true; and, further, that the bidder has not, directly or indirectly, submitted his or her bid price or any breakdown thereof, or the contents thereof, or divulged information or data relative thereto, or paid, and will not pay, any fee to any corporation, partnership, company, association, organization, bid depository, or to any member or agent thereof to effectuate a collusive or sham bid.

I declare, under penalty of perjury, that the foregoing is true and correct.

Dated this _____ (day) of _____ (month),
_____ (year)
at _____, California

Signature of affiant: _____

Note: Notarization of signature required

BID BOND

Recitals:

1. _____ "Contractor", has submitted his Contractor's Proposal to County of Riverside, "County", for the construction of public work for _____ in accordance with a Notice Inviting Bids of County dated _____.
2. _____ a _____ corporation, hereafter called "Surety", is the surety of this Bond.

Agreement:

We, Contractor as principal and Surety as surety, jointly and severally agree and state as follows:

1. The amount of the obligation of this bond is 10% of the amount of the Contractor's Proposal, including bid alternates, and inures to the benefit of County.
2. This Bond is exonerated by (1) County rejecting said Proposal or, in the alternate, (2) if said Proposal is accepted, Contractor executes the Agreement and furnishes the Bonds as agreed to in its Proposal, otherwise it remains in full force and effect for the recovery of loss, damage and expense of County resulting from failure of Contractor to act as agreed to in its Proposal. Some types of possible loss, damage and expense are specified in the Contractor's Proposal.
3. Surety, for value received, stipulates and agrees that its obligations hereunder shall in no way be impaired or affected by any extension of time within which County may accept the Proposal and waives notice of any such extension.
4. This Bond is binding on our heirs, executors, administrators, successors and assigns.

Dated: _____

By _____
Title: Attorney in Fact
"Surety"

By _____
Title: _____
"Contractor"

STATE OF CALIFORNIA
COUNTY OF _____

} ss. SURETY'S ACKNOWLEDGEMENT

On _____ before me, _____ personally appeared, _____, known to me, or proved to me on the basis of satisfactory evidence, to be the person whose name is subscribed to the within instrument and acknowledged to me that he/she executed the same in his/her authorized capacities, and that by his/her signature on the instrument the person, or the entity upon behalf of which the person acted, executed the instrument.

WITNESS my hand and official seal.

Signature of Notary Public

Notary Public (Seal)

Note: This Bond must be executed by both parties with corporate seal affixed. All signatures must be notarized

AGREEMENT

THIS AGREEMENT is entered into at Riverside, California as of the date set forth below is between County of Riverside hereafter called "County" and _____ hereafter called "Contractor".

W I T N E S S E T H

RECITALS:

1. Contractor has submitted to County his Contractor's Proposal for the construction of County Project, _____ in strict accordance with the Contract Documents identified below and County has accepted said Proposal.
2. Contractor states that he has reexamined his Contractor's Proposal and found it to be correct, has ascertained that his subcontractors are properly licensed and possess the requisite skill and forces, has reexamined the site and Contract Documents and is of the opinion that he can presently do the work in accordance with the Contract Documents for the money set forth in his Proposal to be paid as provided in the Contract Documents.

AGREEMENT:

IT IS AGREED BY THE PARTIES AS FOLLOWS:

1. Contract Documents. The entire contract consists of the following: (a) The Agreement. (b) The Notice Inviting Bids. (c) The Instruction to Bidders. (d) The Contractor's Proposal. (e) The Bid Bond. (f) The Payment Bond. (g) The Performance Bond. (h) The General Conditions. (i) The Special Provisions. (j) The Standard Specifications of the State of California Department of Transportation edition of May 2006 as modified in other portions of the Contract Documents. (k) The Standard Plans of the Department of Transportation identified on the plans or in the Special Provisions. (l) The Plans. (m) Addenda No. _____. (n) The Determination of Prevailing Wage Rates for Public Work. (o) Any Change Orders issued. (p) Any additional or supplemental specifications, notice, instructions and drawings issued in accordance with the provisions of the Contract Documents. All of said Documents presently in existence are by this reference incorporated herein with like effect as if here set forth in full and upon the proper issuance of other documents they shall likewise be deemed incorporated. The Bid Bond is exonerated upon execution of this Agreement and the Payment Bond and Faithful Performance Bond.
2. The Work. Contractor shall do all things necessary to construct the work generally described in Recital No. 1 in accordance with the Contract Documents.

3. Liquidated Damages and Time of Completion. Attention is directed to the provisions in Section 8-1.06, "Time of Completion", and in Section 8-1.07, "Liquidated Damages", of the Standard Specifications and these Special Provisions.

The Contractor shall begin work within 15 days of the date stated within the written "Notice to Proceed".

The Contractor shall notify the Engineer, in writing, of his intent to begin work at least 72 hours before work is begun. The notice shall be delivered to the Transportation Department's Construction Engineer and shall specify the date the Contractor intends to start. If the project has more than one location of work, a separate notice shall be given for each location.

Should the Contractor begin work in advance of receiving a written "Notice to Proceed", any work performed by him in advance of the date stated in the "Notice to Proceed" shall be considered as having been done by him at his own risk and as a volunteer and subject to the following:

- (1) The Contractor shall, on commencing operations, take all precautions required for public safety and shall observe all the provisions in the Specifications and the Special Provisions.
- (2) All work done according to the contract prior to the issuance of the "Notice to Proceed", will be considered authorized work and will be paid for as provided in the contract.
- (3) The Contractor shall not be entitled to any additional compensation or an extension of time for any delay, hindrance or interference caused by or attributable to commencement of work prior to the issuance of the "Notice to Proceed".

4. Compensation. Contractor shall be paid in the manner set forth in the Contract Documents the amount of his Proposal as accepted by County, the above rates, subject to additions and deductions as provided in the Contract Documents. Said Proposal is on file in the Office of the Clerk of the Board of Supervisors of County.

IN WITNESS WHEREOF the parties hereto have executed this agreement as of the date set forth below.

COUNTY OF RIVERSIDE

CONTRACTOR

BY _____
Chairman, Board of Supervisors

BY _____

Dated _____

TITLE: _____
(If Corporation, Affix Seal)

ATTEST:

ATTEST:

Kecia Harper-Ihem, Clerk of the Board

BY _____
Deputy

TITLE: _____

Licensed in accordance with an act providing for the registration of Contractors,

License No. _____

Federal Employer Identification Number:

"County"
(Seal)

"Corporation"
(Seal)

PERFORMANCE BOND

Recitals:

1. _____ (Contractor) intend to enter into an Agreement with COUNTY OF RIVERSIDE (County) for construction of public work known as _____.
2. _____, a _____ corporation (Surety), is the Surety under this Bond.

Agreement:

We, Contractor, as Principal, and Surety, as Surety, jointly and severally agree, state, and are bound unto County, as obligee, as follows:

1. The amount of the obligation of this Bond is 100% of the estimated contract price for the Project of \$ _____ and inures to the benefit of County.
2. This Bond is exonerated by Contractor doing all things to be kept and performed by it in strict conformance with the Contract Documents for the Project, otherwise it remains in full force and effect for the recovery of loss, damage and expense of County resulting from failure of Contractor to so act. All of said Contract Documents are incorporated herein.
3. This obligation is binding on our successors and assigns.
4. For value received, Surety stipulates and agrees that no change, time extension, prepayment to Contractor, alteration or addition to the terms and requirements of the Contract Documents or the work to be performed thereunder shall affect its obligations hereunder and waives notice as to such matters, except the total contract price cannot be increased by more than 10% without approval of Surety.

THIS BOND is executed as of _____.

By _____

By _____

By _____

Type Name _____

Its Attorney in Fact
"Surety"

Title _____

"Contractor"

(Corporate Seal)

(Corporate Seal)

NOTE: This Bond must be executed by both parties with corporate seal affixed. All signatures must be acknowledged. (Attach acknowledgements).

PAYMENT BOND

(Public Work - Civil Code 3247 et seq.)

The makers of this Bond are _____, as Principal and Original Contractor and _____, a corporation, authorized to issue Surety Bonds in California, as Surety, and this Bond is issued in conjunction with that certain public works contract to be executed between Principal and COUNTY OF RIVERSIDE a public entity, as Owner, for \$ _____, the total amount payable. THE AMOUNT OF THIS BOND IS ONE HUNDRED PERCENT OF SAID SUM. Said contract is for public work generally consisting of _____.

The beneficiaries of this Bond are as is stated in 3248 of the Civil Code and requirements and conditions of this Bond are as is set forth in 3248, 3249, 3250 and 3252 of said code. Without notice, Surety consents to extension of time for performance, change in requirements, amount of compensation, or prepayment under said contract.

DATED: _____

Original Contractor - Principal

Surety

By _____

By _____
Its Attorney In Fact

Title _____
(If corporation, affix seal)

(Corporate Seal)

STATE OF CALIFORNIA }
COUNTY OF _____ } ss. SURETY'S ACKNOWLEDGEMENT

On _____ before me, _____ personally appeared, _____, known to me, or proved to me on the basis of satisfactory evidence, to be the person whose name is subscribed to the within instrument and acknowledged to me that he/she executed the same in his/her authorized capacities, and that by his/her signature on the instrument the person, or the entity upon behalf of which the person acted, executed the instrument.

WITNESS my hand and official seal.

Signature of Notary Public

Notary Public (Seal)

Note: This Bond must be executed by both parties with corporate seal affixed. All signatures must be notarized

GENERAL CONDITIONS

SS 1. DEFINITIONS:

- a. "County", "Contractor", and "Contract Documents" are identified in the Agreement. "County" and "Contractor" includes their authorized representatives are treated throughout as if each were singular in number. "Contractor" includes its surety.
- b. "Engineer" and "Director of Transportation" means the Director of Transportation for the County of Riverside, and includes his authorized representatives.
- c. "Plans" means the portion of the Contract Documents consisting of all drawings prepared for the direction and characteristics of the work. A schedule of said drawings which constitutes the plans as of the execution of the Agreement is set forth in the Special Provisions and are supplemented by the Standard Plans referred to in the Special Provisions.
- d. "State of California", "Department of Transportation" and "Director of Transportation", means the County of Riverside.

SS 2. STANDARD SPECIFICATIONS:

The Standard Specifications of the State of California Department of Transportation, edition of May 2006 hereafter called "Standard Specifications", are incorporated herein as modified in these General Conditions, the Special Provisions and the Plans.

The following subsections of the Standard Specifications are deleted:

1-1.13, 1-1.15, 1-1.18, 1-1.25, 1-1.37, 1-1.40, 2-1.01, 2-1.05, 2-1.07, 5-1.14, 7-1.165, 8-1.03, 9-1.05, 9-1.065, 9-1.10, 12-2.02.

Section 3 of the Standard Specifications is deleted.

The following deletions and additions are made from the following subsections of the Standard Specifications.

Subsection 5-1.04, add to the second paragraph at its end the following sentence: "The General Conditions govern over all of the Contract Documents except the Special Provisions, the Agreement and Bonds."

Subsection 7-1.01A (2), strike the last sentence of the second paragraph and in its place read: "These wage rates are on file in the Office of the County Clerk and are a part of the Contract."

Subsection 7-1.15, for "Director" read "Director of Transportation" except for last reference read "County of Riverside".

Subsection 7-1.16, delete references to Subsection 7-1.165.

Subsection 8-1.06, strike the last paragraph.

Subsection 8-1.08, strike "as provided in the State Contract Act".

SS 3. DIRECTOR OF TRANSPORTATION:

All work shall be done under the supervision of the Director of Transportation who shall determine the amount, quality, acceptability and fitness of all parts of the work, and interpret the Contract Documents. No act or omission of the Director of Transportation relieves Contractor of the duty to proceed with the work in strict conformity with the Contract Documents.

Upon request, Director of Transportation shall reduce to writing any oral order, objection, requirement or determination. Whenever Director of Transportation's approval is required it shall be in writing only.

All communications to County by Contractor shall be via Director of Transportation.

No work shall be performed on site other than during normal working hours without the knowledge and consent of Director of Transportation.

When in Director of Transportation's opinion, weather or other conditions are such that attempts to perform a portion of the work will probably result in work not in accordance with the Contract Documents, he shall so advise Contractor. When Contractor advises Director of Transportation that he intends to proceed despite such advise, he does so at his peril. The Director of Transportation may then order Contractor, in writing which specifies the portion of the work involved and the conditions warranting the issuance of the order, not to proceed on such portion of the work if (1) proceeding will in his judgment have an adverse effect on Contractor's ability to complete the work within the stipulated time period, or (2) proceeding will in his judgment necessitate unusual tests and procedures to ascertain whether said portion of the work is in accordance

with the Contract Documents. Contractor shall comply with such orders at its expense.

Nothing herein contained relieves Contractor from the duty to make independent determinations as to weather and other conditions affecting the proper completion of the work.

Failure for any reason of Director of Transportation to advise Contractor as to such matters, or to issue an order as above provided, does not relieve Contractor from the duty to accomplish the work in accordance with the Contract Documents.

As stated elsewhere, amounts shown in the Proposal and Agreement as to quantities are but estimates only. From time to time Director of Transportation shall direct Contractor as to the prosecution of the work in such a manner as to increase or decrease such estimates as to the work actually to be done. Contractor shall comply with such instructions and shall be paid only for work actually done based on the unit price set out in the Agreement.

SS 4. SITE INSPECTION - EFFECT OF OTHER IMPROVEMENTS SHOWN AND CONTRACTOR PROCEDURE:

Elsewhere in the Contract Documents reference may be made, graphically, descriptively or both, to the existence or possible existence of other improvements affecting the site and the prosecution of the work such as surface and subsurface utilities, drainage ditches and courses, buildings, fencing, retaining walls, roadways, curbs, trees, shrubs, and similar matters. Such matters are included to be used by Contractor to the extent he deems appropriate. However, it is expressly understood and agreed:

- a. Showing or describing such items does not mean that it is an exhaustive and complete presentation and that as to matters shown or described that they necessarily exist.
- b. All graphic presentations are schematic only unless the contrary is clearly set out elsewhere as to a particular matter.
- c. Whenever in the plans survey markers are shown, boundaries of the site are shown or contour lines are shown, Contractor may assume that such matters are shown in accordance with acceptable standards.

All improvements of the nature above described, whether elsewhere shown or described or not, shall, unless the contrary is elsewhere specifically directed, remain in

place, undisturbed and suitably protected during the course of the work.

Whenever during the course of the work a subsurface improvement is discovered which Contractor believes is unknown to County, he shall immediately so inform Director of Transportation. Except as elsewhere provided, whenever in the course of the work it becomes apparent that the work cannot proceed without the destruction or relocation of any improvement, whether shown or described or not, Contractor shall immediately cease work affecting such improvements and notify Director of Transportation as to such circumstance and await instructions as to how to proceed.

- d. The Contractor shall be required to cooperate fully with all utility forces or forces of other public agencies engaged in relocation, lowering, altering or otherwise rearranging any facilities interfering with the progress of work or installing any facilities thereon.

The Contractor will also be required to cooperate fully with any County or State forces working on or near the project, or requiring access to the work in the performance of their duties.

SS 5. USE OF AND PROTECTION OF PREMISES AND REMOVAL OF DEBRIS:

At his expense Contractor shall:

- a. Take every precaution against injuries to persons or damage to property.
- b. Comply with regulations governing the use of the property.
- c. Store and suitably protect his apparatus, equipment, materials and supplies in an orderly fashion on site.
- d. Place on the work only such loads as are consistent with the safety of the work.
- e. Effect all cutting, fitting, or patching of his work required to make it conform to the Plans and Specifications and interrelate with other improvements or except with the consent of Director of Transportation, cut or otherwise alter existing improvements.
- f. Protect and preserve established bench marks and monuments, make no changes in the location of such without the prior written approval of County, replace and relocate any of them which may be lost or destroyed

or which require shifting because of necessary changes in grades or locations. All replacement and relocation work shall be accomplished only after approval of County and under the direct supervision and instruction of Director of Transportation.

- g. Before final payment remove all surplus materials, false work, temporary structures, debris, and similar matter resulting from his operations from the site and to put the site in an orderly condition.
- h. Construct, operate and maintain all passageways, guard fences, lights, barricades and other facilities required for protection by State or municipal laws and regulations and local conditions during the course of the work.
- i. Guard County's property from injury or loss.
- j. Take all reasonable precautions for dust and noise control and generally conduct operations so as not to constitute a nuisance.
- k. The Contractor shall be responsible for the protection of existing signs, fences, concrete curb and gutter and other highway facilities which may be encountered in the roadway. The replacement or repair of any facilities which the County deems necessary as a result of the Contractor's operations shall be done by the Contractor at his own expense and to the satisfaction of the County Transportation Department.

SS 6. CHANGE ORDERS - DETAIL DRAWINGS AND INSTRUCTIONS:

Reference is made to 4-1.03 and 4-1.03A of the Standard Specifications regarding change orders. Wherever in these subsections the word "Engineer" appears read "County".

Each approved change order shall be considered as an amendment to the Contract Documents and will not be considered approved until executed by the Board of Supervisors, except Director of Transportation can approve certain change orders without the necessity of approval by the Board as provided in a Resolution of the Board adopted March 30, 1993, Resolution Number 93-047.

The above does not limit the ability of Director of Transportation to issue further detail drawings, explanations and instructions which are customarily given by an Engineer during the course of similar work. Director of Transportation will furnish Contractor with reasonable promptness such further detailed explanations, instructions and drawings as may be necessary for the proper execution of the work, and

Contractor shall conform to same provided they are consistent with the intent of the Contract Documents. In giving such additional instructions, explanations and drawings Director of Transportation has authority to make minor changes in the work which do not involve extra cost and are not inconsistent with the Contract Documents.

Contractor's acting on such instructions, explanations and drawings of Director of Transportation means that Contractor agrees that such explanations, instructions and drawings are within the scope of the work in accordance with the intent of the Contract Documents and do not constitute a basis for modification of the Contract Documents as to price or time.

SS 7. BRAND OR TRADE NAME - SUBSTITUTE OF EQUALS:

Reference is made to Section 3400 of the Public Contracts Code, which is by this reference incorporated herein with like effect as if here set forth in full.

If a potential bidder believes he knows of an equal to a specified brand or trade name which is not mentioned in the Contract Documents, then such potential bidder may so advise Director of Transportation of such fact, giving all relevant information. If appropriate, an addendum will be issued as to the alleged equal provided that such issuance may be accomplished at least 5 days before the time fixed for opening bids.

Unless the subject article or product is expressly designated for matching others in use in a particular public improvement either completed or in the course of completion, any bidder may, as part of its bid proposal, include a request for substitution of an item equal to any specified by brand or trade name.

Within 35 calendar days after award of the contract, Contractor may submit to Director of Transportation data substantiating such a request, and the difference, if any, in cost. Director of Transportation shall promptly investigate the request and make a recommendation to County as to equality. The governing body of County shall promptly determine whether the substitute is equal in every respect to the item specified, and approve or deny the request accordingly, and shall notify Director of Transportation of the determination made, who shall advise Contractor in writing of the decision. Unless the request is granted, substitution will not be permitted.

Nothing herein shall authorize a change in the contract price or prevent the use of change orders in the manner provided elsewhere in the Contract Documents.

SS 8. FINAL INSPECTION - NOTICE OF COMPLETION:

When the work is ready for final inspection County shall cause the work to be inspected and subjected to such tests as seem to it to be required for the purpose of determining if the work is complete in every respect.

At a meeting of the governing body of County held within 10 days after final inspection, the governing body shall consider the facts developed at the inspection. If it is found that the work is apparently complete in every respect, County will accept the work and a notice of completion will be recorded.

As between the parties, the recordation of the Notice of Completion, unless recorded because of a cessation of labor, means only that the time for final payment and the commencement of the guarantee period commences to run.

SS 9. COUNTY'S RIGHT TO STOP WORK OR TERMINATE THE CONTRACT:

(1) Contractor shall be adjudged bankrupt or make an assignment for the benefit of creditors, or (2) a receiver or liquidator is appointed for Contractor or any of his property, or (3) Contractor shall refuse or fail after Notice of Warning from County by Director of Transportation to supply sufficient properly skilled workmen or suitable materials, or (4) Contractor fails to prosecute the work with such diligence as will insure its completion within the stipulated time period, or (5) Contractor shall fail to make payments to persons supplying labor or materials for the work, or (6) Contractor does not comply with applicable law or instructions of Director of Transportation, or (7) Contractor is otherwise guilty of a substantial violation of any provision of the Contract Documents, then County without prejudice to such other and further right, remedy or relief it may be entitled to, may by 10 days notice to Contractor, terminate the employment of Contractor and his right to proceed, either as to the entire work, or at County's option, as to any portion thereof as to which delay shall have occurred or breach or noncompliance relates, and may thereupon take possession of the affected work and complete the work by contract or otherwise, as County deems expedient. In such case Contractor shall not be entitled to receive any further payment until the work is finished. If the unpaid balance shall exceed the expense of completion, and other damage, expense or loss of County occasioned by Contractor's failure to properly perform, such excess shall be paid by Contractor. If such expense and damage exceeds the unpaid balance, Contractor is liable to County for the excess. If County elects to proceed under this Section, it may take possession of and utilize in completing the work such materials, supplies, plant and equipment on site which may be

necessary or convenient for the purpose of completing the work, County is expressly granted the right - acting via Director of Transportation, an Engineer or otherwise - to operate equipment and machinery on site for the purpose of determining whether it has a basis for proceeding under this section.

If the construction of the project herein is damaged, which damage is determined to have been proximately caused by an act of God, in excess of 5% of the contract amount, provided that the work damaged is built in accordance with applicable building standards and the plans and specifications, then the Owner, upon certification by the Engineer, may, without prejudice to any other right of remedy, terminate the contract.

Decision by County not to proceed under this Section does not constitute a waiver by County of any right it might from time to time have against Contractor under the Contract Documents.

SS 10. PAYMENT AND MONTHLY ESTIMATES:

Director of Transportation, once each month, after said work is commenced and until after the completion and acceptance thereof, shall make and deliver to Contractor duplicate certificates stating the value of work then completed according to the contract, estimated according to the standard of the unit contract price, and thereupon Contractor shall be paid an amount sufficient with all previous payments to make the aggregate ninety percent (90%) of the amount earned as certified.

The partial payments made as the work progresses will be payment on account on work performed as of the 25th of the month and shall in no way be considered as an acceptance of any part of the work or material of the contract, nor shall they in any way govern the final estimate. No such estimate or payment shall be made when in the judgement of the Director of Transportation the total value of the work done since the last estimate amounts to less than \$300.

For the purpose of timely payment, the "receipt of payment request" date, as described in Public Contract Code 20104.50 and as referred to herein, shall be considered to be the fifth working day following the 25th day of each month. Within 5 working days of the 25th day of each month the County shall:

- a. Calculate and prepare the certificate ("progress pay estimate") stating the value of the work completed for the billing month, for the purpose of determining the proper progress payment amount.

- b. If a progress pay estimate has been prepared by the County but has been contested by the Contractor as of the "receipt of payment request" date, as defined above, the County shall submit to the Contractor a document setting forth in writing a description of the dispute pertaining to the progress billing, and the County's reason for it's position. Said document shall be submitted to the Contractor as soon as practicable, but not later than 7 calendar days after the "receipt of payment request" date.

Any progress pay estimate which is undisputed and remains unpaid for thirty (30) calendar days, after the "receipt of payment request date" shall accrue interest to the Contractor equivalent to the legal rate set forth in subdivision (a) of Section 685.010 of the California Code of Civil Procedure. The number of days available to the County to make a payment without incurring interest pursuant to this section shall be reduced by the number of days by which the County exceeds the seven-day submittal requirement set forth in the paragraph above.

Pursuant to Public Contract Code Section 20104.50, subsection (e), the progress payment date is the date that funds are encumbered and the payment warrant is issued.

SS 11. PAYMENT FOR EXTRA WORK (FORCE ACCOUNT BASIS):

Extra work to be paid for on a force account basis as directed by the Engineer will be paid for as set forth in Section 9-1.03 of the Standard Specifications. The labor surcharge, equipment rental rates and the right of way delay factors for each classification of equipment are listed in the Department of Transportation publication entitled Labor Surcharge and Equipment Rental Rates. A copy of which is on file at the Office of the Director of Transportation and is hereby incorporated herein in its entirety.

SS 12. FINAL PAYMENT:

Within thirty (30) days after the completion of the work and its acceptance by the Board of Supervisors, Director of Transportation will make a proposed final estimate in writing of the quantities of work done under the contract and the value of such work and will submit such estimate to Contractor. Within thirty (30) days thereafter Contractor shall submit to Director of Transportation his written approval of said proposed final estimate or a written statement of all claims which he has for additional compensation claimed to be due under the contract.

On Contractor's approval or if he files no claims within said period of thirty (30) days, Director of Transportation will issue a final written estimate as submitted to Contractor and County shall pay the entire sum so found to be due after deducting there from all previous payments and all amounts to be kept and all amounts to be retained under the provisions of the contract.

If Contractor within said period of thirty (30) days files claims, Director of Transportation will issue as a semi-final estimate the proposed estimate submitted to Contractor and the County will within thirty (30) days pay the sum found due thereon after deducting all prior payments and all amounts to be kept and retained under the provisions of the contract, Director of Transportation shall then consider and investigate Contractor's claims and shall make such revisions in the said estimate as he may find to be due, and shall then make and issue his final written estimate. County will pay the amount so found due after deducting all previous payments and amount to be retained under the contract.

All prior or partial estimates and payments shall be subjected to correction in the final estimate and payment.

The final estimate shall be conclusive and binding against both parties to the contract on all questions relating to the performance of the contract and the amount of work done there under and compensation therefore, except in the case of gross error. Acceptance of final payment constitutes a release of County by Contractor of all claims relating to the work.

SS 13. DAMAGES:

Contractor acknowledges that failure to perform in strict accordance with the Contract Documents will cause County to suffer special damages in addition to cost of completion of the work in accordance with the provisions of the Contract Documents. Such special damage could include, but is not limited to, lease and rental cost, additional salaries and overhead, interest during construction, attorney expense, additional engineering, and inspection expense and cost of maintaining or constructing alternate facilities.

SS 14. DOCUMENTS OF CONTRACTOR:

Upon demand, Contractor shall make available to County all documents in its possession relevant to the work accomplished or to be accomplished or any demand or claim of Contractor as to County. This includes copies of documents sent by Contractor or others in its possession. Contractor shall further make available to County conformed copies of all documents submitted to the sureties who executed the Bid

Bond, Faithful Performance Bond or Payment Bond for the purpose of obtaining the sureties' signature, including any guarantee or indemnification made to such surety by others for such purpose. Contractor shall maintain in his possession all documents relative to the work for three years after Notice of Completion.

SS 15. RESPONSIBILITY OF CONTRACTOR TO ACT IN AN EMERGENCY:

In case of an emergency which threatens loss or injury to property or life, Contractor shall act without previous instructions as the situation may warrant. Contractor shall notify Director of Transportation immediately thereafter. Any compensation claimed by Contractor, together with substantiating documentation shall be submitted to County via Director of Transportation.

SS 16. LABOR CODE:

Reference is made to Chapter 1, Part 7, Division 2 of the California Labor Code (commencing with Section 1720). By this reference said Chapter 1 is incorporated herein with like effect as if it were here set forth in full. The parties recognize that said Chapter 1 deals, among other things with discrimination, penalties and forfeitures, their disposition and enforcement, wages, working hours, and securing worker's compensation insurance and directly effect the method of prosecution of the work by Contractor and subject it under certain conditions to penalties and forfeitures. Execution of the Agreement by the parties constitutes their agreement to abide by said Chapter 1, their stipulation as to all matters which they are required to stipulate as to by the provisions of said Chapter 1, constitutes Contractor's certification that he is aware of the provisions of said Chapter 1 and will comply with them and further constitutes Contractor's certification as follows: "I am aware of the provisions of Section 3700 of the California Labor Code which require every employer to be insured against liability for worker's compensation or to undertake self-insurance in accordance with the provisions of that Code, and I will comply with such provisions before commencing the performance of the work of this contract." Contractor and his subcontractors shall comply with the provisions of SS 1777.5 of the Labor Code regarding apprentices.

Contractor shall post at each job site during the course of the work a copy of County's "Determination of Prevailing Wage Rates", copies of said Determination are available from County for this purpose.

SS 17. OBSTRUCTIONS:

Attention is directed to Sections 8-1.10, "Utility and Non-Highway Facilities" and 15, "Existing Highway Facilities" of the Standard Specifications and these Special Provisions.

Add the following to the fourth paragraph of Section 8-1.10, "Utility and Non-Highway Facilities", of the Standard Specifications is amended to read:

In the event that the utility facilities mentioned above are not removed or relocated by the times specified and, if in the opinion of the Engineer, the Contractor's operations are delayed or interfered with by reason of the utility facilities not being removed or relocated by said times, the State will compensate the Contractor for such delays to the extent provided in Section 8-1.09, "Right of Way Delays" of the Standard Specifications, and not otherwise, except as provided in Section 8-1.10, "Utility and Non-Highway Facilities" of the Standard Specifications.

SS 18. INSURANCE - HOLD HARMLESS:

In lieu of the provisions of Section 7-1.12 the following shall apply:

Contractor shall not commence work under this contract until he has obtained the insurance required hereunder and satisfactory proof of said insurance has been submitted to and approved by the County of Riverside.

Contractor shall submit to the County of Riverside a Certificate of Insurance, signed by an authorized representative of the Contractor's insurance provider or agency, which certifies to the County that insurance coverage is provided in accordance with the requirements of this section. The Certificate of Insurance shall include as attachments the required "Waiver of Subrogation" and "Additional Insured" policy endorsements.

I. Workers Compensation Insurance:

Contractor shall procure and maintain during the life of the contract Worker's Compensation Insurance coverage as prescribed by the laws of the State of California. Policy shall include Employers' Liability including Occupational Disease with limits not less than \$1,000,000 per occurrence. Policy shall be endorsed to provide a Borrowed Servant Endorsement, Alternate Employer Endorsement, or Additional Insured Endorsement naming the County of Riverside, its Director's Officers,

Special Districts, Board of Supervisors, employees, agents or representatives as Additional Insureds. Policy shall contain a Waiver of Subrogation in favor of the County of Riverside.

Contractor shall further require each of its subcontractors to procure Worker's Compensation Insurance as required by the State while working on the project and the Contractor shall require the subcontractors to endorse the policy to provide a Borrowed Servant Endorsement, Alternate Employer Endorsement, or Additional Insured Endorsement naming the County of Riverside, its Director's Officers, Special Districts, Board of Supervisors, employees, agents or representatives as Additional Insureds. Policy shall contain a Wavier of Subrogation in favor of the County of Riverside.

II. Comprehensive General Liability Insurance:

Contractor shall take out and maintain during the course of the work General Liability Insurance covering bodily injury and property damage insurance and blanket contractual coverage as to the work and obligations covered hereunder. The amount of the insurance shall be in an amount **not less than \$2,000,000**. The policy may be a combined single limit or split limits, but the amount must be no less than \$2,000,000 per occurrence. The insurance carrier must have a current rating of "A" or better by the A.M. Best Company, a financial size of at least "VIII", and be an admitted carrier in the State of California. Any exceptions must be approved in advance by the County of Riverside Risk Management. Said insurance must contain an endorsement the County of Riverside is named as an additional insured as respects the work covered hereunder and **said insurance must not contain, as respects the work covered hereunder, any exclusions as to bodily injury or death or property damage arising out of blasting, explosion, or underground damage to wire, pipes, conduits, mains, sewers, tank tunnels or any similar property - i.e. the so-called "x c u" exclusions.** The insurance certificate evidencing such insurance must **affirmatively state** that the insurance carrier (s) will give Owner 30 days written notice prior to cancellation of the insurance or a reduction in coverage, and that "County of Riverside--its Director's Officers, Special Districts, Board of Supervisors, employees, agents and representatives" are named as Additional Insureds.

In the alternate to naming County of Riverside as additional insured, Contractor may take out and maintain during the course of the work and until acceptance by County, Owner's Protective Liability Insurance in an

amount not less-than \$2,000,000 covering Riverside County.

III. Auto Liability:

If Lessee's vehicles or licensed mobile equipment will be on the premises or used in any manner on behalf of the County, then Lessee shall maintain auto liability insurance for all owned, non-owned or hired automobiles in an amount not less than \$1,000,000 per occurrence combined single limit. Policy shall name the "County of Riverside, its Director's Officers, Special Districts, Board of Supervisors, employees, agents, or representatives" as Additional Insureds.

IV. Hold Harmless:

Contractor shall hold County of Riverside its officers, agent, and employees free and harmless from any liability whatsoever, including wrongful death, based or asserted upon any act or omission of Contractor, its officers, agents, employees or subcontractors relating to or in anywise connected with or arising from the accomplishment of the work, whether or not such acts or omissions were in furtherance of the work required by the Contract Documents and agrees to defend at his expense, including attorney fees, Owner, County of Riverside its officers, agents and employees in any legal action based upon any such alleged acts or omissions.

SS 19. EQUAL EMPLOYMENT OPPORTUNITY:

General:

Contractor shall not discriminate in its recruiting, hiring, promotion, demotion or termination practices on the basis of race, religious creed, color, national origin, ancestry, sex, age or physical handicap in the performance of this Contract shall comply with the provisions of the California Fair Employment Practice Act (commencing with SS 1410 of the Labor Code), the Federal Civil Rights Act of 1964 (P.L. 88-352) and all amendments thereto, Executive Order No. 11246 (30 Federal Register 12319), as amended, and all administrative rules and regulations issued pursuant to said Acts and Order. See particularly 41 Code of Federal Regulation (CFR) Chapter 60.

Contractor shall require each of its subcontractors to comply with the preceding paragraph and shall include in each subcontract language similar to the preceding paragraph.

Contractor shall permit access to its records of employment, employment advertisement, application forms and other pertinent data and records by Owner and any State or Federal agency having jurisdiction for the purpose of investigation to ascertain compliance with this Section.

Owner may assign an affirmative action representative to monitor Contractor and its subcontractor (s) conduct required by this Section, including the right of entry to the construction site for the purpose of obtaining information from persons performing work on the project providing such inspection does not interfere with the progress of the work.

Elsewhere in the Contract Documents specific requirements may be contained covering the same subject matter of this Section. If so, such specific requirements prevail over this Section in case of conflict.

Transactions of \$10,000 or Under:

Contracts and subcontracts not exceeding \$10,000 are exempt from the requirements of this Section. No Contractor or subcontractor shall procure supplies and/or services in less than usual quantities to avoid applicability of this Section. With respect to contracts and subcontractors for indefinite quantities, this Section applies unless the amount required in any one year under such contract will reasonably be expected not to exceed \$10,000.

Transactions in Excess of \$10,000, but Less Than \$50,000:

At Owner's request, Contractor shall certify that it has in effect an affirmative action plan and agrees to comply with all State and Federal laws and regulations regarding Fair Employment Practices. Contractor shall maintain a written copy of its affirmative action plan and furnish Owner a copy of the plan upon request. Owner may require Contractor to complete an Affirmative Action Compliance Report, on a form furnished by Owner, setting forth definite goals during the term of the Contract.

Transactions of \$50,000 or More:

If Contractor has fifty or more employees and a Contract for \$50,000 or more, it shall develop and submit to Owner, within thirty days after award, a written affirmative action compliance program providing in detail specific steps to guarantee equal employment opportunity. Contractor shall include in its affirmative action program a table of job classifications, which table shall include but need not be limited to job titles, duties, and rates of pay.

Contractor shall in each subcontract let to do a portion of the work covered hereunder, where the subcontractor involved has fifty or more employees and the subcontract is for \$50,000 or more, impose in the subcontract the above requirements.

For the purpose of determining the number of employees, the average of the Contractor's or its subcontractor's employees for the twelve month period immediately prior to award, or the total number of employees the Contractor or its subcontractor will have when performing this contract, whichever is higher, shall be used.

Federal Assisted Construction:

If this project is a Federally assisted construction project, then the contract provisions contained in 41 CFR SS 60-1.04 (b) are incorporated herein and the Contractor shall likewise incorporate said provisions in each subcontract entered by Contractor to perform the work. Federally assisted construction is identified as such in the Notice Inviting Bids.

SS 20. DEPOSIT OF SECURITIES:

In accordance with Public Contract Code Section 22300 and other applicable law, the Contractor may substitute securities for any moneys withheld to ensure performance under the contract.

SS 21. ASSIGNMENT OF CLAIMS:

In submitting a bid on this public works project, or any subcontractor agreeing to supply goods, services, or materials, and entering a contract pursuant thereto, the Contractor and/or subcontractor do offer and agree to assign to the Owner all rights, title, and interest in and to all causes of action it may have under Section 4 of the Clayton Act (15 U.S.C. Section 15) or under the Cartwright Act (Chapter 2 (commencing with Section 16700) of Part 2 of Division 7 of the Business and Professions Code), arising from purchases of goods, services, or materials pursuant to the public works contract or the subcontract. This assignment shall be made and become effective at the time the awarding body tenders final payment to the Contractor, without further acknowledgement by the parties.

SS 22. CLAIMS RESOLUTION:

In accordance with Public Contract Code Section 20104 - 20104.8 and other applicable law, public works claims of \$375,000 or less which arise between the Contractor and the Owner shall be resolved following the statutory procedure unless the Owner has elected to resolve the dispute pursuant to Public Contract Code SS 10240 et seq.

1. All claims shall be submitted in writing and accompanied by substantiating documentation. Claims must be filed on or before the date of final payment unless other notice requirements are provide in the contract. "Claim" means a separate demand by the claimant for (1) a time extension, (2) payment of money or damages arising from work done by or on behalf of the claimant and payment of which is not otherwise expressly provided for or the claimant is not otherwise entitled, or (3) an amount the payment of which is disputed by the Owner.
 - (a) Claims Under or equal to \$50,000. The Owner shall respond in writing to the claim within 45 days of receipt of the claim, or, the Owner may request, in writing, within 30 days of receipt of the claim, any additional documentation supporting the claim or relating to defenses or claims the Owner may have. If additional information is needed thereafter, it shall be provided upon mutual agreement of the Owner and the claimant. The Owner's written response shall be submitted 15 days after receiving the additional documentation, or within the same period of time taken by the claimant to produce the additional information, whichever is greater.
 - (b) Claims over \$50,000 but less than or equal to \$375,000. The Owner shall respond in writing within 60 days of receipt, or, may request in writing within 30 days of receipt of the claim, any additional documents supporting the claim or relating to defenses or claims the Owner may have against the claimant. If additional information is needed thereafter, it shall be provided pursuant to mutual agreement between the Owner and the claimant. The Owner's response shall be submitted within 30 days after receipt of the further documents, or within the same period of time taken by the claimant to produce the additional information or documents, whichever is greater.
2. If the claimant disputes the Owner's response, or if the Owner fails to respond within the statutory time period, the claimant may so notify the Owner within 15 days of the receipt of the response or the failure to respond,

and demand an informal conference to meet and confer for settlement. Upon such demand, the Owner shall schedule a meet and confer conference within 30 days.

3. If following the meet and confer conference, the claim or any portion thereof remains in dispute, the claimant may file a claim pursuant to Government Code SS 900 et seq. and Government Code SS 910 et seq. For purposes of those provisions, the time within which a claim must be filed shall be tolled from the time the claimant submits the written claim until the time the claim is denied, including any time utilized for the meet and confer conference.
4. If a civil action is filed to resolve any claim, the provisions of Public Contract Code SS 20104.4 shall be followed, providing for non-binding mediation and judicial arbitration.

SS 23. DUST ABATEMENT:

Dust control shall conform to Section 10, "Dust Control", Section 7-1.01F, "Air Pollution Control", Section 17, "Watering", and Section 18, "Dust Palliative" of the Standard Specifications, Rules no. 401, 402, 403 and 403.1 of the South Coast Air Quality Management District (AQMD), Riverside County Code, Chapter 8.52, "Fugitive Dust Reduction Program For Coachella Valley", all other applicable Federal and State laws, and the requirements set forth herein.

The Contractor is cautioned that failure to control fugitive dust may result in fines being levied by the South Coast Air Quality Management District to both the Contractor and the County of Riverside, as owner. The Contractor shall be fully responsible for payment of all fines pertaining to air pollution control violations, resulting from Contractor's operations related to the construction contract, which may be levied against both the Contractor and the County of Riverside by the AQMD or other regulatory agencies. The Contractor's attention is directed to Section 7-1.01, "Laws to be Observed" of the Standard Specifications. The cost of all fines levied against the County of Riverside will be deducted from any moneys due or which may become due to the Contractor, unless other payment arrangements are made by the Contractor.

Dust control of all of the Contractor's operations is required 24 hours per day, 7 days a week for the duration of the contract, and until the disturbed soil is permanently stabilized. The Contractor shall take every precaution to prevent emissions of fugitive dust from the project site, from locations of stockpiled materials, from unpaved driving surfaces, from haul vehicles, from inactive construction

areas, and from all other operations of the Contractor. The Contractor shall plan for and carry out proper and efficient measures to prevent his operations from producing dust in amounts damaging to property or which constitute a public nuisance, or which cause harm to persons living or working in the vicinity of the work. Of particular concern are emissions of PM10 particles, which are fine particulate matter of 10 microns or less and which are associated with sickness and death from respiratory disease.

The Contractor shall furnish and post dust mitigation signs, which shall be, at a minimum, in accordance with the "AQMD Signage Recommendations", attached hereto. Additional copies are available upon request from the Engineer. The sign shall include the Contractor's phone number which shall be maintained on a 24 hour basis. The sign message, size and design, including any deviations from the signage recommendations, shall be approved by the Engineer prior to fabrication.

The Contractor shall respond to complaints by mobilizing equipment and personnel at the construction site within 2 hours of each complaint to control fugitive dust.

Attention is directed to AQMD Rule 403.1, which applies to all contracts within the Coachella Valley Area of Riverside County. That AQMD Rule requires the Contractor to take specified dust control actions when prevailing wind speeds exceed 25 miles per hour. Wind forecasts, AQMD Rules and other related information are provided by AQMD at 1-800-CUT-SMOG and at www.aqmd.gov.

Any days on which the Contractor is prevented from working, due to the requirements of AQMD Rules, will be considered as non-working days, in accordance with Section 8-1.06, "Time of Completion" of the Standard Specifications.

The Contractor shall utilize the "Best Available Control Measures" of controlling fugitive dust, as prepared by the AQMD. For projects within the Coachella Valley, the "Reasonably Available Control Measures" may be employed, if effective within the context of the AQMD rules. However, if fugitive dust crosses the project boundary, more effective control measures, including the "Best Available Control Measures" shall be implemented.

A site-specific fugitive dust control plan shall be submitted to the Engineer for review and approval at least 10 days prior to the start of construction. Additionally, for projects outside of the Coachella Valley which meet the criteria for AQMD plan approval, the Contractor shall submit the dust control plan to AQMD for approval. AQMD plan submittal criteria is defined in AQMD Rule 403 as being for projects that will have disturbed surface area in excess of

100 acres, or for projects with a scope of work which requires the movement of more than 10,000 cubic yards of soil on each of any three working days.

A sample plan and other pertinent information is attached, and additional copies are available from the Engineer upon request. The fugitive dust control plan shall include the "Reasonably Available Control Measures" and "Best Available Control Measures" of controlling fugitive dust, as may be appropriate and necessary, including but not limited to watering, application of chemical dust suppressants, wind fencing, covering of haul vehicles, haul vehicle bed-liners, covering or chemically stabilizing stored materials, phased grading, planting of vegetation, the use of a 24 hour environmental observer, and track-out controls at locations where unpaved construction accesses intersect with paved roads. The use of chemical stabilizers, which are approved by all environmental regulatory agencies, and the use of reclaimed water is encouraged. If water is intended as a primary dust control tool, the dust control plan shall provide for at least one 2,000 gallon water truck for every 4 acres of disturbed soil, unless otherwise approved by the Engineer.

If the Construction Engineer determines that the project scope and the forecasted weather conditions are such that the Contractor's work is unlikely to be a source of dust emissions, the Construction Engineer has the authority to waive the requirements for submittal of a dust control plan and for placement of the dust control signs described herein. However, the Contractor's responsibilities for the control of fugitive dust and the other requirements of this section may not be waived.

A completion notice will not be filed, and the final payment will not be made to the Contractor until the areas of disturbed soil on the construction site, including roadway shoulders, are suitably stabilized for long term control of fugitive dust.

The successful Contractor shall attend an AQMD PM10 Dust Control Program training session, and furnish evidence of attendance to the Engineer. Attendance at AQMD training seminars can be scheduled through AQMD at 1-866-861-DUST (1-866-861-3878) or by email to dustcontrol@aqmd.gov. Current AQMD certification of previous attendance will be accepted. At that training session, the successful Contractor will be furnished with the AQMD prepared Rule 403 and Rule 403.1 implementation handbooks, which include the "Best Available Control Measures" and "Reasonably Available Control Measures", and other associated information, including a listing of suggested dust control related devices, materials and chemicals.

The signature of the Contractor on the Proposal constitutes acknowledgement by the Contractor of the dust control requirements established by law and described herein, and the enforceability of those requirements.

When the contract includes a bid item for Dust Abatement, full compensation for conformance with these dust abatement requirements, including labor, equipment, materials, developing water supply and incidentals, shall be paid at the lump sum price for Dust Abatement, and no additional compensation will be allowed therefor.

When the contract does not include a bid item for Dust Abatement, full compensation for conformance with these dust abatement requirements, including labor, equipment, materials, developing water supply and incidentals, shall be considered as included in the various items of work, and no additional compensation will be allowed therefor.

AQMD SIGNAGE RECOMMENDATIONS

November, 2001

Plan holder shall post signage at specified locations on the subject property in accordance with the standards specified below. The exception to the standards is that all letters shall be 4 inches high, with the names and telephone numbers of appropriate contacts and services in bold print, as indicated in the standards. These signs shall also include the SCAQMD toll free complaint line 1-800-CUT-SMOG (1-800-288-7664) and the telephone number for the Environmental Observer. These signs shall be posted within 50 feet of the curb on all four (4) corners of the subject property.

For each Dust Control Plan aggregating less than, or equal to, ten (10) acres:

1. The applicant shall install a sign on such property which is visible to the public that meets the following requirements:
 - (a) Such sign shall measure at least four (4) feet wide by four (4) feet high and conform to the specifications in 1 (a) below.

For each Dust Control Plan aggregating over ten (10) acres:

2. The applicant shall install a sign on such property which is visible to the public that meets the following requirements:
 - (a) Such sign shall measure at least eight (8) feet wide by four (4) feet high and conform to the specifications in 1 (b) below.

THE SIGN SHALL CONFORM TO THE FOLLOWING REQUIREMENTS:

1. The sign boards shall be constructed with materials capable of withstanding the environment in which they are placed.

(a) For 4' x 4' signs, the District recommends the following:

- I. ¾" A/C laminated plywood board
- II. Two 4" x 4" posts
- III. The posts should be attached to the edges of the plywood board with at least 2 carriage bolts on each post.
- IV. The front surface of the sign board should be painted in the contrasting color of a white background with black lettering.

(b) For 4' x 8' signs, the District recommends the following:

- I. 1" A/C laminated plywood board
- II. Two 5" x 6" posts
- III. The posts should be attached to the 4' edges of the plywood board with at least 2 carriage bolts on each post.
- IV. The front surface of the sign board should be painted in the contrasting color of a white background with black lettering.

2. The sign board shall be installed and maintained in a condition such that members of the public can easily view, access, and read the sign at all times until the expiration date of the Dust Control plan.

(a) For 4' x 4' signs, the District recommends the following:

- I. The lower edge of the sign board should be mounted at least 2' above the existing ground surface to facilitate ease of viewing.
- II. The posts should be set in a hole at least 3' deep with concrete footings to preclude downing by high winds.
- III. On the construction site, the sign should be positioned such that nothing obstructs the public's view from the primary street access point.
- IV. For construction projects that are developed in phases, the sign should be moved to the area that is under active construction.
- V. In situations where all phases of the construction project are completed on a property prior to expiration of the Dust Control Plan, a written request for cancellation of the Dust Control Plan must be submitted to the Engineer.

(b) For 4' x 8' signs, the District recommends the following:

- I. The lower edge of the sign board should be mounted at least 2' above the existing ground surface to facilitate ease of viewing.
- II. The posts should be set in a hole at least 4' deep with concrete footings to preclude downing by high winds.
- III. On the construction site, the sign should be positioned such that nothing obstructs the public's view from the primary street access point.
- IV. For construction projects that are developed in phases, the sign should be moved to the area that is under active construction.
- V. In situations where all phases of the construction project are completed on a property prior to expiration of the Dust Control Plan, a written request for cancellation of the Dust Control Plan must be submitted to the Engineer.

3. The sign board shall contain the following information:

- (a) Project Name
- (b) Name of Prime Contractor
- (c) Phone Number of Contractor's Employee Responsible for Dust Control Matters
- (d) County designated phone number (to be provided by the Engineer)
- (e) South Coast Air Quality Management District Phone Number

4. The sign board shall be designed to the following alpha and numeric text dimensions (sign boards written in longhand are unacceptable).

(a) For a permittee subject to the 4' x 4' sign requirement, the District provides the following example: (as modified by the County of Riverside for use on County Public Works projects)

1" UPPERCASE Letters	PROJECT NAME:		3 ½" Title Case Bold Letters
1" UPPERCASE Letters	CONTRACTOR		3 ½" Title Case Bold Letters
1" Title Case Letters	Contractor's Dust Control Phone #		3" Bold Numbers
1" Title Case Letters	County of Riverside Phone #		3" Bold Numbers
1" Title Case Letters	Phone Number:	SCAQMD 1-800-CUT-SMOG	3 ½" Bold Numbers

"Title Case" means the first letter of a word is capitalized and subsequent letters are lower case.

(b) For a permittee subject to the 4' x 8' sign requirement, the District provides the following example: (as modified by the County of Riverside)

2" UPPERCASE Letters	PROJECT NAME:		4" Title Case Bold Letters
2" UPPERCASE Letters	CONTRACTOR		4" Title Case Bold Letters
2" Title Case Letters	Contractor's Dust Control Phone #		4" Bold Numbers
2" Title Case Letters	County of Riverside Phone #	909-	4" Bold Numbers
2" Title Case Letters	Phone Number:	SCAQMD 1-800-CUT-SMOG	4 1/2" Bold Numbers
2" Title Case Letters	COUNTY OF RIVERSIDE TRANSPORTATION DEPARTMENT		

Plan Review Checklist Clearing/Grubbing/Mass Grading Phase

If feasible, use grading permit conditions to break the project into phases so that only a portion of the site is disturbed at any given time to ensure control of fugitive dust. This technique is critical for project sites with greater than 100 acres.

Prior to initiating activity, pre-water site through use of portable irrigation lines. At least 72 hours of pre-watering is recommended for each area prior to initiating earth-movement. Require the Applicant to specify water source and available flow rate (g/m).

Water applied continuously to all disturbed portions of the site by means of water truck/water pull as necessary to maintain sufficient visible moisture on the soil surface. For reference, one 2,000 gallon water truck can treat approximately 4 acres of active construction per hour. Also, for cut and fill activities, one 10,000 gallon water pull is estimated to be necessary for each 7,000 cubic yards of daily earth-movement. Multiple 4,000-gallon water trucks may be used in place of one 10,000-gallon water pull. Touch and visual contrast are reasonably good indicators of soil moisture. Surface areas that are dry to the touch and appear lighter-colored require the application of additional water to prevent visible or fugitive dust. Require the Applicant to specify the number of watering vehicles available for dust control during mass grading and during off-hours as well as availability of back-up water trucks if the site experiences dust control problems.

Water towers are necessary for projects with more than 10 acres of active construction. Without a water tower, it can take up to 30 minutes to fill a 2,000 gallon water truck. Also, multiple water towers are necessary for projects that use water pulls as filling one 10,000 gallon water pull can drain a water tower which takes up to 40 minutes to refill.

Wind fencing is necessary between the site and nearby residences or businesses. Off-site upwind fencing and on-site wind fencing for larger projects can also keep blowsand from being deposited onto the site or traveling through the site.

A perimeter watering system consisting of portable irrigation equipment may be an effective mitigation system to protect surrounding residences and businesses. The portable watering system may be used in place of or in conjunction with watering trucks. The local jurisdiction may also be provided access to this equipment.

Remember...

**DUST CONTROL IS REQUIRED 24 HOURS A DAY, 7 DAYS A WEEK,
REGARDLESS OF CONSTRUCTION STATUS**

Section 1

Simplified Sample Site Plan

Existing Residential

Distance and location of nearest:
 Residence _____
 Business _____

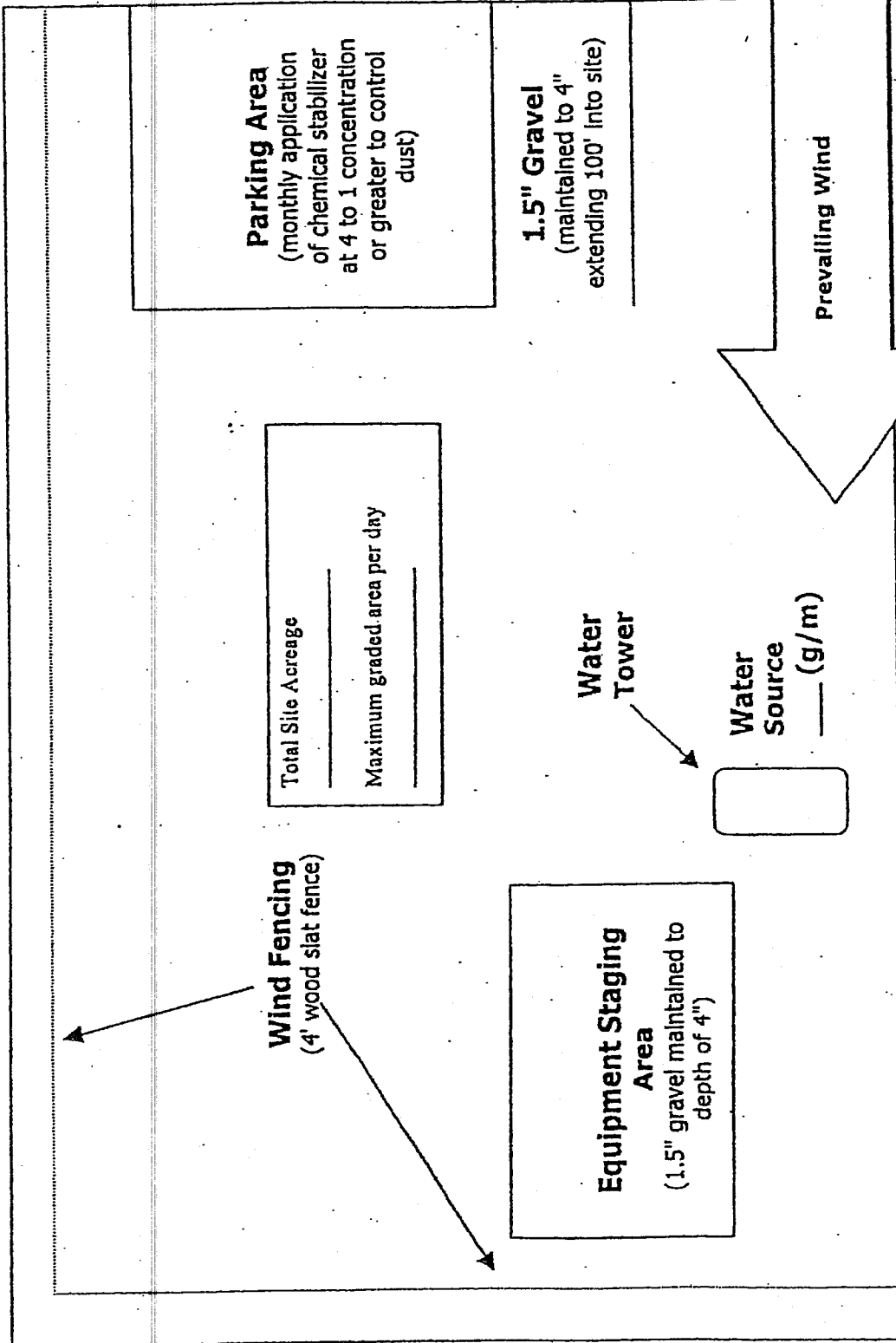
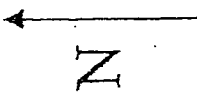

Existing Residential

Existing Residential

Vacant Land

Remember...
**DUST CONTROL IS REQUIRED 24 HOURS A DAY, 7 DAYS A WEEK,
 REGARDLESS OF CONSTRUCTION STATUS**

Construction site accesses are to be improved with 1.5" gravel maintained to a depth of 4" , at least 20' wide, and extending 100 feet into the site. If the project site is not balanced, a wheel washing system and/or ribbed steel plates should be placed in the roadway before the vehicle enters the graveled area to clean the tires and prevent trackout.

Equipment staging areas are to be treated with 1.5" gravel maintained to a depth of 4".

Employee parking areas are to be covered with 1.5" gravel maintained to a depth of 4" or treated with chemical dust suppressants at a 4 to 1 ratio on at least a monthly basis to prevent fugitive dust.

Chemical dust suppressants are to be mixed at a ratio of 20 to 1 and applied to all disturbed surfaces that are proposed to remain inactive for a period of at least 10 consecutive days. These products are effective in preventing and controlling dust. Recordkeeping is necessary to demonstrate compliance.

All project sites greater than 100 acres shall monitor daily wind speeds and AQMD forecasted wind events (call 1.800.CUT.SMOG; press one for air quality information, and then press five for Coachella Valley wind forecasts). Operators shall maintain these records for review by any local code enforcement officer or AQMD inspector.

An environmental observer whose primary duty is to oversee dust control at the site is to be used for construction projects greater than 100 acres and/or sites with more than 50 acres of active construction. The environmental observer is tasked with monitoring dust abatement measures and authorized to deploy additional water trucks and other dust control actions (i.e., wind fencing, street sweepers, chemical dust suppressants, etc.) as necessary to prevent or control fugitive dust.

Other (specify): _____

Remember...
DUST CONTROL IS REQUIRED 24 HOURS A DAY, 7 DAYS A WEEK,
REGARDLESS OF CONSTRUCTION STATUS

Plan Review Checklist Finish Grading Phase

Water applied continuously to all disturbed portions of the site by means of water truck/water pull as necessary to maintain sufficient visible moisture on the soil surface. For reference, one 2,000 gallon water truck can treat approximately 4 acres of active construction per hour. Also, for cut and fill activities, one 10,000 gallon water pull is estimated to be necessary for each 7,000 cubic yards of daily earth-movement. Multiple 4,000-gallon water trucks may be used in place of a 10,000-gallon water pull. Touch and visual contrast are reasonably good indicators of soil moisture. Surface areas that are dry to the touch and appear lighter-colored require the application of additional water to prevent visible or fugitive dust. Require the Applicant to specify the number of watering vehicles available for dust control during finish grading and during off-hours as well as availability of back-up water trucks if the site experiences dust control problems.

Water towers are necessary for projects with more than 10 acres of active construction. Without a water tower, it can take up to 30 minutes to fill a 2,000 gallon water truck. Also, multiple water towers are necessary for projects that use water pulls as filling one 10,000 gallon water pull can drain a water tower which takes up to 40 minutes to refill.

Wind fencing is necessary between the site and nearby residences or businesses to reduce fugitive dust. Off-site upwind fencing and on-site wind fencing for larger projects can also keep blow-sand from being deposited onto the site or traveling through a site.

Chemical dust suppressants are to be applied at a concentration of at least 10 to 1 to finish graded areas once final elevations have been reached. For areas that will remain inactive for longer periods, vegetation can be a cost-effective alternative to chemical stabilization. Wind fencing or other obstructions can keep the stabilized area free from future disturbances.

Construction site access(es) are to be improved with 1.5" gravel maintained to a depth of at least 4" with a minimum width of at least 20', extending 100 feet into the project site.

Equipment staging areas are to be treated with 1.5" gravel maintained to a depth of 4".

Internal roadway networks are to be treated with chemical dust suppressants at a minimum rate of at least 4 to 1 and retreated on a monthly basis once final roadway elevations have been reached.

Employee parking areas are to be treated with chemical dust suppressants at a mix ratio of at least 4 to 1 and retreated on at least a monthly basis or covered with 1.5" gravel maintained to a depth of 4" to prevent fugitive dust.

Other (specify): _____

Remember...

**DUST CONTROL IS REQUIRED 24 HOURS A DAY, 7 DAYS A WEEK,
REGARDLESS OF CONSTRUCTION STATUS**

Plan Review Checklist Construction Phase

Water applied continuously to all disturbed portions of the site by means of water truck/water pull is necessary to maintain sufficient visible moisture on the soil surface. For reference, one 2,000 gallon water truck can treat approximately 4 acres of active construction per hour. Touch and visual contrast are reasonably good indicators of soil moisture. Surface areas that are dry to the touch and appear lighter-colored require the application of additional water to prevent visible or fugitive dust. Require the Applicant to specify the number of watering vehicles available for dust control during the construction phase and during off-hours as well as availability of back-up water trucks if the site experiences dust control problems.

Wind fencing is necessary between the site and nearby residences or businesses. Off-site upwind fencing and on-site wind fencing for larger projects can also keep blowsand from being deposited onto the site or traveling through the site. Block walls, if part of the final project, can replace wind fencing during the construction phase.

Chemical dust suppressants are to be applied at a concentration of at least 20 to 1 to finish graded areas once final elevations have been reached. For areas that will remain inactive for longer periods, vegetation can be a cost-effective alternative to chemical stabilization. Wind fencing or other obstructions can keep the stabilized area free from future disturbances.

Construction site accesses are to be improved with 1.5" gravel, maintained to a depth of 4", with a width of at least 20', extending 100' into the project site. Paving internal roadways can substitute for gravel.

Internal roadway networks are to be paved as early as feasible in the construction phase. Street sweeping of internal and/or external access roads will likely be required to control entrained road dust.

Employee parking areas are to be treated with chemical dust suppressants at a mix ratio of no less than 4 to 1 and retreated on a monthly basis, or more frequently if fugitive dust is observed. If internal roadway is complete, employees are to be instructed to park on paved roads.

Other (specify): _____

Remember...
DUST CONTROL IS REQUIRED 24 HOURS A DAY, 7 DAYS A WEEK,
REGARDLESS OF CONSTRUCTION STATUS

RULE 403 IMPLEMENTATION HANDBOOK

REASONABLY AVAILABLE CONTROL MEASURES

Paragraph (d)(3) of Rule 403 allows activities outside the South Coast Air Basin (see Figure 2-1) to implement reasonably available control measures in lieu of best available control measures. Additionally, as specified by subparagraph (f)(3)(D) of Rule 403, any person seeking approval of a fugitive dust emissions control plan for projects outside the South Coast Air Basin must demonstrate to the satisfaction of the District that the given activity is employing all reasonably available fugitive dust control measures.

The District has prepared the attached listing of reasonably available fugitive dust control measures for a variety of source categories. This list is based on the U.S. Environmental Protection Agency's reference document entitled, "Control of Open Fugitive Dust Sources," Midwest Research Institute, September 1988.

The District encourages the use of those dust control measures that minimize the use of potable water. When water is needed, reclaimed water should be utilized to the greatest extent feasible.

RULE 403 IMPLEMENTATION HANDBOOK

REASONABLY AVAILABLE CONTROL MEASURES

The left column contains a listing of the sources of fugitive dust which are intended for emission control under District Rule 403 and a listing of control measures and high-wind measures. The right column contains a description of the reasonably available fugitive dust control measures for each of the sources:

Source: (1) Land Clearing/Earth-Moving

CONTROL MEASURES

DESCRIPTION

(A) Watering

(1) Application of water by means of trucks, hoses and/or sprinklers prior to conducting any land clearing. This will increase the moisture content of the soils; thereby increasing its stability.

(2) Pre-application of water to depths of proposed cuts.

(3) Once the land clearing/earth moving activities are complete, a second application of water can generate a thin crust that stabilizes the disturbed surface area provided that it is not disturbed. (Security fencing can be used to prevent unwanted future disturbances of sites where a surface crust has been created).

(B) Chemical stabilizers

(1) Only effective in areas which are not subject to daily disturbances.

(2) Vendors can supply information on product application and required concentrations to meet the specifications established by the Rule.

(C) Wind fencing

(1) Three- to five-foot barriers with 50% or less porosity located adjacent to roadways or urban areas can be effective in reducing the amount of windblown material leaving a site.

(2) Would likely be used in conjunction with other measures (e.g., watering, chemical stabilization, etc.) to ensure that visible emissions do not cross a property line.

(D) Cover haul vehicles

(1) Entire surface area of hauled earth should be covered once vehicle is full.

(E) Bedliners in haul vehicles

(1) When feasible, use in bottom-dumping haul vehicles.

HIGH WIND MEASURE

(a) Cease all active operations; or

(b) Apply water within 15 minutes to any soil surface which is being moved or otherwise disturbed.

Source: (2) Unpaved Roads

CONTROL MEASURES

DESCRIPTION

- (F) Paving
 - (1) Requires street sweeping/cleaning if subject to material accumulation.
- (G) Chemical stabilization
 - (1) Vendors can supply information as to application methods and concentrations to meet the specifications established by the Rule
 - (2) Not recommended for high volume or heavy equipment traffic use.
- (H) Watering
 - (1) In sufficient quantities to keep surface moist.
 - (2) Required application frequency will vary according to soil type, weather conditions, and vehicular use.
- (I) Reduce speed limits
 - (1) 15 mile per hour maximum. May need to be used in conjunction with watering or chemical stabilization to prevent visible emissions from crossing the property line.
- (J) Reduce vehicular trips
 - (1) Access restriction or redirecting traffic to reduce vehicle trips by a minimum of 60 percent.
- (K) Gravel
 - (1) Gravel maintained to a depth of four inches can be an effective measure.
 - (2) Should only be used in areas where paving, chemical stabilization or frequent watering is not feasible.

HIGH WIND MEASURE

- (c) Apply a chemical stabilizer (to meet the specifications established by the Rule) prior to wind events; or
- (d) Apply water once each hour; or
- (e) Stop all vehicular traffic.

RULE 403 IMPLEMENTATION HANDBOOK

Source: (3) Storage Piles

CONTROL MEASURES

DESCRIPTION

- | | |
|--|--|
| (L) Wind sheltering | (1) Enclose in silos.
(2) Install three-sided barriers equal to height of material, with no more than 50 percent porosity. |
| (M) Watering | (1) Application methods include: spray bars, hoses and water trucks.
(2) Frequency of application will vary on site-specific conditions: |
| (N) Chemical stabilizers | (1) Best for use on storage piles subject to infrequent disturbances. |
| (O) Altering load-in/load-out procedures | (1) Confine load-in/load-out procedures to leeward (downwind) side of the material.
(2) May need to be used in conjunction with wind sheltering to prevent visible emissions from crossing the property line. |
| (P) Coverings | (1) Tarps, plastic, or other material can be used as a temporary covering.
(2) When used, these should be anchored to prevent wind from removing coverings. |

HIGH WIND MEASURE

- (f) Apply chemical stabilizers (to meet the specifications established by the Rule) prior to wind events; or
(g) Apply water once per hour; or
(h) Install temporary covers.

Source: (4) Paved Road Track-Out

CONTROL MEASURES

DESCRIPTION

- | | |
|--------------------------------|--|
| (Q) Chemical stabilization | (1) Most effective when used on areas where active operations have ceased. |
| (R) Sweep/clean roadways | (2) Vendors can supply information on methods for application and required concentrations. |
| (S) Cover haul vehicles | (1) Either sweeping or water flushing may be used. |
| (T) Bedliners in haul vehicles | (1) Entire surface area should be covered once vehicle is full. |
| (U) Site access improvement | (1) When feasible, use in bottom dumping vehicles. |
| | (1) Pave internal roadway system. |
| | (2) Most important segment, last 100 yards from the connection with paved public roads |

HIGH WIND MEASURE

- (i) Cover all haul vehicles; and
(i) Clean streets with water flushing, unless prohibited by the Regional Water Quality Control Board.

RULE 403 IMPLEMENTATION HANDBOOK

Source: (5) Disturbed Surface Areas/Inactive Construction Sites

CONTROL MEASURES

DESCRIPTION

- (Q) Chemical stabilization
 - (1) Most effective when used on areas where active operations have ceased.
 - (2) Vendors can supply information on methods for application and required concentrations.
- (R) Watering
 - (1) Requires frequent applications unless a surface crust can be developed.
- (S) Wind fencing
 - (1) Three- to five-foot barriers with 50% or less porosity adjacent to roadways or urban areas can be effective in reducing the amount of wind blown material leaving a site.
- (T) Vegetation
 - (1) Establish as quickly as possible when active operations have ceased.
 - (2) Use of drought tolerant, native vegetation is encouraged.

HIGH WIND MEASURES

- (k) Apply chemical stabilizers (to meet the specifications established by the Rule); or
- (l) Apply water to all disturbed surface areas 3 times per day.

BEST AVAILABLE CONTROL MEASURES

Rule 403, paragraph (d)(2) requires active operations [defined in Rule 403, paragraph (c)(1)] within the South Coast Air Basin (see Figure 2-1) to implement at least one best available control measure for each fugitive dust source type on site. Additionally, as specified by subparagraph (f)(3)(D) of Rule 403, any person seeking approval of a fugitive dust emissions control plan for projects within the South Coast Air Basin must demonstrate to the satisfaction of the AQMD that the given activity is employing all best available fugitive dust control measures.

The AQMD has prepared the attached listing of best available fugitive dust control measures for a variety of source categories. This list is based on the U.S. Environmental Protection Agency's reference document entitled, "Fugitive Dust Background Document and Technical Information Document for Best Available Control Measures," Office of Air and Radiation, September 1992.

The AQMD encourages the use of those dust control measures that minimize the use of potable water. When water is needed, reclaimed water should be utilized to the greatest extent feasible.

RULE 403 IMPLEMENTATION HANDBOOK

BEST AVAILABLE CONTROL MEASURES

The left column contains a listing of the sources of fugitive dust which are intended for emission control under District Rule 403 and a listing of control measures and high-wind measures. The right column contains a description of the best available fugitive dust control measures for each of the sources.

Source: (1) Land Clearing/Earth-Moving

CONTROL MEASURES

DESCRIPTION

- | | |
|--------------------------------|---|
| (A) Watering (pre-grading) | (1) Application of water by means of trucks, hoses and/or sprinklers prior to conducting any land clearing. This will increase the moisture content of the soils; thereby increasing its stability. |
| (A-1) Watering (post-grading) | (2) Pre-application of water to depths of proposed cuts. |
| (A-2) Pre-grading planning | (1) In active earth-moving areas water should be applied at sufficient frequency and quantity to prevent visible emissions from extending more than 100 feet from the point of origin. |
| (B) Chemical stabilizers | (1) Grade each phase separately, timed to coincide with construction phase; or
(2) Grade entire project, but apply chemical stabilizers or ground cover to graded areas where construction phase begins more than 60 days after grading phase ends. |
| (C) Wind fencing | (1) Only effective in areas which are not subject to daily disturbances.
(2) Vendors can supply information on product application and required concentrations to meet the specifications established by the Rule. |
| (D) Cover-haul vehicles | (1) Three- to five-foot barriers with 50% or less porosity located adjacent to roadways or urban areas can be effective in reducing the amount of windblown material leaving a site. Must be implemented in conjunction with either measure (A-1) or (B). |
| (E) Bedliners in haul vehicles | (1) Entire surface area of hauled earth should be covered once vehicle is full.
(1) When feasible, use in bottom-dumping haul vehicles. |

HIGH WIND MEASURE

- (a) Cease all active operations; or
(b) Apply water within 15 minutes to any soil surface which is being moved or otherwise disturbed.

RULE 403 IMPLEMENTATION HANDBOOK

Source: (2) Unpaved Roads

CONTROL MEASURES

DESCRIPTION

- | | |
|----------------------------|---|
| (F) Paving | (1) Requires street sweeping/cleaning if subject to material accumulation. |
| (G) Chemical stabilization | (1) Vendors can supply information as to application methods and concentrations to meet the specifications established by the Rule
(2) Not recommended for high volume or heavy equipment traffic use. |
| (H) Watering | (1) In sufficient quantities to keep surface moist.
(2) Required application frequency will vary according to soil type, weather conditions, and vehicular use. |
| (I) Reduce speed limits | (1) 15 mile per hour maximum. May need to be used in conjunction with watering or chemical stabilization to prevent visible emissions from crossing the property line. |
| (J) Reduce vehicular trips | (1) Access restriction or redirecting traffic to reduce vehicle trips by a minimum of 60 percent. |
| (K) Gravel | (1) Gravel maintained to a depth of four inches can be an effective measure.
(2) Should only be used in areas where paving, chemical stabilization or frequent watering is not feasible. |

HIGH WIND MEASURE

- (a) Apply a chemical stabilizer (to meet the specifications established by the Rule) prior to wind events; or
(b) Apply water once each hour; or
(c) Stop all vehicular traffic.

RULE 403 IMPLEMENTATION HANDBOOK

Source: (3) Storage Piles

CONTROL MEASURES

DESCRIPTION

- (L) Wind sheltering
- (1) Enclose in silos.
 - (2) Install three-sided barriers equal to height of material, with no more than 50 percent porosity.
- (M) Watering
- (1) Application methods include: spray bars, hoses and water trucks.
 - (2) Frequency of application will vary on site-specific conditions.
- (N) Chemical stabilizers
- (1) Best for use on storage piles subject to infrequent disturbances.
- (O) Altering load-in/load-out procedures
- (1) Confine load-in/load-out procedures to leeward (downwind) side of the material.
Must be used in conjunction with either measure (L), (M), (N), or (P).
- (P) Coverings
- (1) Tarps, plastic, or other material can be used as a temporary covering.
 - (2) When used, these should be anchored to prevent wind from removing coverings.

HIGH WIND MEASURE

- (a) Apply chemical stabilizers (to meet the specifications established by the Rule) prior to wind events, or
- (b) Apply water once per hour; or
- (c) Install temporary covers.

RULE 403 IMPLEMENTATION HANDBOOK

Source: (4) Paved Road Track-Out

CONTROL MEASURES

Compliance with District Rule 403.

DESCRIPTION

Paragraph (d)(5).

RULE 403 IMPLEMENTATION HANDBOOK

Source: (5) Disturbed Surface Areas/ Inactive Construction Sites

CONTROL MEASURES

DESCRIPTION

- (Q) Chemical stabilization
- (1) Most effective when used on areas where active operations have ceased.
- (2) Vendors can supply information on methods for application and required concentrations.
- (R) Watering
- (1) Requires frequent applications unless a surface crust can be developed.
- (S) Wind fencing
- (1) Three- to five-foot barriers with 50% or less porosity adjacent to roadways or urban areas can be effective in reducing the amount of wind blown material leaving a site. Must be used in conjunction with either measure (Q), (R), or (T).
- (T) Vegetation
- (1) Establish as quickly as possible when active operations have ceased.

HIGH WIND MEASURES

- (a) Apply chemical stabilizers (to meet the specifications established by the Rule); or
- (b) Apply water to all disturbed surface areas 3 times per day.

* Use of drought tolerant, native vegetation is encouraged.

TABLE 1

BEST [REASONABLY]* AVAILABLE CONTROL MEASURES FOR HIGH WIND CONDITIONS

FUGITIVE DUST SOURCE CATEGORY	<u>CONTROL MEASURES</u>
Earth-moving	(1A) Cease all active operations; OR (2A) Apply water to soil not more than 15 minutes prior to moving such soil.
Disturbed surface areas	(0B) On the last day of active operations prior to a weekend, holiday, or any other period when active operations will not occur for not more than four consecutive days: apply water with a mixture of chemical stabilizer diluted to not less than 1/20 of the concentration required to maintain a stabilized surface for a period of six months; OR (1B) Apply chemical stabilizers prior to wind event; OR (2B) Apply water to all unstabilized disturbed areas 3 times per day. If there is any evidence of wind driven fugitive dust, watering frequency is increased to a minimum of four times per day; OR (3B) Take the actions specified in Table 2, Item (3c); OR (4B) Utilize any combination of control actions (1B), (2B), and (3B) such that, in total, these actions apply to all disturbed surface areas.
Unpaved roads	(1C) Apply chemical stabilizers prior to wind event; OR (2C) Apply water twice [once] per hour during active operation; OR (3C) Stop all vehicular traffic.
Open storage piles	(1D) Apply water twice [once] per hour; OR (2D) Install temporary coverings.
Paved road track-out	(1E) Cover all haul vehicles; OR (2E) Comply with the vehicle freeboard requirements of Section 23114 of the California Vehicle Code for both public and private roads.
All Categories	(1F) Any other control measures approved by the Executive Officer and the U.S. EPA as equivalent to the methods specified in Table 1 may be used.

* Measures in [brackets] are reasonably available control measures and only apply to sources not within the South Coast Air Basin.

January 1999

TABLE 2
DUST CONTROL ACTIONS FOR EXEMPTION FROM PARAGRAPH (d)(4)*

<u>FUGITIVE DUST SOURCE CATEGORY</u>	<u>CONTROL ACTIONS</u>
Earth-moving (except construction cutting and filling areas, and mining operations)	<p>(1a) Maintain soil moisture content at a minimum of 12 percent, as determined by ASTM method D-2216, or other equivalent method approved by the Executive Officer, the California Air Resources Board, and the U.S. EPA. Two soil moisture evaluations must be conducted during the first three hours of active operations during a calendar day, and two such evaluations each subsequent four-hour period of active operations; OR</p> <p>(1a-1) For any earth-moving which is more than 100 feet from all property lines, conduct watering as necessary to prevent visible dust emissions from exceeding 100 feet in length in any direction.</p>
Earth-moving: Construction fill areas:	<p>(1b) Maintain soil moisture content at a minimum of 12 percent, as determined by ASTM method D-2216, or other equivalent method approved by the Executive Officer, the California Air Resources Board, and the U.S. EPA. For areas which have an optimum moisture content for compaction of less than 12 percent, as determined by ASTM Method 1557 or other equivalent method approved by the Executive Officer and the California Air Resources Board and the U.S. EPA, complete the compaction process as expeditiously as possible after achieving at least 70 percent of the optimum soil moisture content. Two soil moisture evaluations must be conducted during the first three hours of active operations during a calendar day, and two such evaluations during each subsequent four-hour period of active operations.</p>

* Measures in [brackets] are reasonably available control measures and only apply to sources not within the South Coast Air Basin.

TABLE 2 (Continued)

<u>FUGITIVE DUST SOURCE CATEGORY</u>	<u>CONTROL ACTIONS</u>
Earth-moving: Construction cut areas and mining operations:	(1c) Conduct watering as necessary to prevent visible emissions from extending more than 100 feet beyond the active cut or mining area unless the area is inaccessible to watering vehicles due to slope conditions or other safety factors.
Disturbed surface areas (except completed grading areas)	(2a/b) Apply dust suppression in sufficient quantity and frequency to maintain a stabilized surface. Any areas which cannot be stabilized, as evidenced by wind driven fugitive dust must have an application of water at least twice per day to at least 80 [70] percent of the unstabilized area.
Disturbed surface areas: Completed grading areas	(2c) Apply chemical stabilizers within five working days of grading completion; OR (2d) Take actions (3a) or (3c) specified for inactive disturbed surface areas.
Inactive disturbed surface areas	(3a) Apply water to at least 80 [70] percent of all inactive disturbed surface areas on a daily basis when there is evidence of wind driven fugitive dust, excluding any areas which are inaccessible to watering vehicles due to excessive slope or other safety conditions; OR (3b) Apply dust suppressants in sufficient quantity and frequency to maintain a stabilized surface; OR (3c) Establish a vegetative ground cover within 21 [30] days after active operations have ceased. Ground cover must be of sufficient density to expose less than 30 percent of unstabilized ground within 90 days of planting, and at all times thereafter; OR (3d) Utilize any combination of control actions (3a), (3b), and (3c) such that, in total, these actions apply to all inactive disturbed surface areas.

* Measures in [brackets] are reasonably available control measures and only apply to sources not within the South Coast Air Basin.

January 1999

TABLE 2 (Continued)

<u>FUGITIVE DUST SOURCE CATEGORY</u>	<u>CONTROL ACTIONS</u>
Unpaved Roads	<p>(4a) Water all roads used for any vehicular traffic at least once per every two hours of active operations [3 times per normal 8 hour work day]; OR</p> <p>(4b) Water all roads used for any vehicular traffic once daily and restrict vehicle speeds to 15 miles per hour; OR</p> <p>(4c) Apply a chemical stabilizer to all unpaved road surfaces in sufficient quantity and frequency to maintain a stabilized surface.</p>
Open storage piles	<p>(5a) Apply chemical stabilizers; OR</p> <p>(5b) Apply water to at least 80 [70] percent of the surface area of all open storage piles on a daily basis when there is evidence of wind driven fugitive dust; OR</p> <p>(5c) Install temporary coverings; OR</p> <p>(5d) Install a three-sided enclosure with walls with no more than 50 percent porosity which extend, at a minimum, to the top of the pile.</p>
<u>All Categories</u>	<p>(6a) Any other control measures approved by the Executive Officer and the U.S. EPA as equivalent to the methods specified in Table 2 may be used.</p>

* Measures in [brackets] are reasonably available control measures and only apply to sources not within the South Coast Air Basin.

January 1999

TABLE 3
TRACK-OUT CONTROL OPTIONS
PARAGRAPH (d)(5)(B)

CONTROL OPTIONS

(1)	Pave or apply chemical stabilization at sufficient concentration and frequency to maintain a stabilized surface starting from the point of intersection with the public paved surface, and extending for a centerline distance of at least 100 feet and a width of at least 20 feet.
(2)	Pave from the point of intersection with the public paved road surface, and extending for a centerline distance of at least 25 feet and a width of at least 20 feet, and install a track-out control device immediately adjacent to the paved surface such that exiting vehicles do not travel on any unpaved road surface after passing through the track-out control device.
(3)	Any other control measures approved by the Executive Officer and the U.S. EPA as equivalent to the methods specified in Table 3 may be used.

January 1999

SPECIAL PROVISIONS

**GOETZ ROAD AND NEWPORT ROAD
COMPLETION OF IMPROVEMENTS**

PROJECT NO. B8-0643

SPECIAL PROVISIONS

DESCRIPTION:

In general, this project consists of the completion of Goetz Road (Newport Road to north of Normandy Road) and Newport Road (Goetz Road to Railroad Canyon Road) improvement located in City of Canyon Lake and City of Menifee. The work involves the construction of bridge over salt creek, construction of two (2) Southbound lanes of Goetz Road, construction of final asphalt concrete cap layer of Northbound two lanes of Newport Road, curb, gutter and sidewalks, storm drain and construction of sound wall with demolition of existing block wall, installation of traffic signal at intersection of Goetz road and Newport Road, signal modification at intersection of Canyon Lake Drive and Goetz Road, and removal of existing traffic signal at intersection of Goetz Road and Normandy Road. The completion of drainage improvements including installation of Flo-Gard filters in catch basins and maintaining the system for three months after completion of the project, roadway embankment grading and fine grading, and protecting existing utility lines in-place, and other work as may be required. Utilities companies will relocate their facilities as may be required.

The bridge work to be done consists of the following:

Goetz Road Bridge (Audie Murphy Ranch Bridge) is located in the city of Menifee. The bridge Crosses Salt Creek on Goetz Road.

The proposed bridge is a single span Precast Prestressed Caltrans "Bulb-Tee" Girder structure measuring 128.2-ft in length, 100.92-ft in width and 5.67-ft in depth. The bridge carries two 12-ft traffic lanes each way, a 22-ft median, two 8-ft shoulders and two 6.38-ft sidewalks [Caltrans Type 26 Mod]. Caltrans Tubular Handrailing is mounted on top of the Type 26 Barrier (Mod) on either side of the bridge.

The superstructure is supported on Short Seat-Type abutments founded on spread footings. At bridge approaches, Caltrans Type (23S) and Type (25S) approach slabs are provided at Abutment 1 and Abutment 2 respectively. At Abutments 1 & 2, concrete slope paving is provided.

STANDARD PLANS AND SPECIFICATIONS:

Except as stated otherwise, this project shall conform to the requirements of the May 2006 edition of the Standard Specifications and Standard Plans as issued by the State of California Department of Transportation.

In case of conflict between the State Standard Specifications and these Special Provisions, the Special Provisions shall take precedence over and be used in lieu of such conflicting portions.

In instances where the applicable State Standard Specifications are not specified or where there appear to be overlapping or conflicting areas of jurisdiction, the State Standard Specifications shall take precedence.

When the specifications require working drawings to be submitted to the Office of Structure Design, the drawings shall be submitted to the County of Riverside.

Where the specifications require payment to the State, it shall imply payment to the County of Riverside.

Requirements on the construction plans for Portland Cement Concrete are modified to the PCC Class designations, as described in Section 90-1.01 of the Standard Specifications, as follows:

- Class "A" shall mean Class "2"
- Class "B" shall mean Class "3"
- Class "C" shall mean Class "4"
- Class "D" shall mean Class "1"

SUPPLEMENTAL PROJECT INFORMATION:

During the advertisement period of this project, the following information is available as a free download for use by the Contractor at the following County website:

http://www.rctlma.org/trans/con_bid_advertisements.html

1. Goetz Rd Bridge & Newport Rd Improvements, construction order # 66804 [specification related to Eastern Municipal Water District (EMWD)].
2. Book 3, Elsinore Valley Municipal Water District, 8" and 12" waterlines and appurtenances.

Supplement project information is part of the Contract Documents and Special Provisions. These documents are also available upon request to the Transportation Department: (951) 955-6780.

AMENDMENTS TO STATE STANDARD SPECIFICATIONS:

Amendments to the State Standard Specifications set forth in these Special Provisions shall be considered as part of the State Standard Specifications for the purposes set forth in Section 5-1.04, "Coordination and Interpretation of Plans, Standard Specifications,

and Special Provisions," of the State Standard Specifications. Whenever either the term "Standard Specifications is amended" or the term "Standard Specifications are amended" is used in these Special Provisions, the text or table following the term shall be considered an amendment to the State Standard Specifications. In case of conflict between such amendments and the State Standard Specifications, the amendments shall take precedence over and be used in lieu of the conflicting portions.

DISPOSAL OF EXCESS EXCAVATION OR MATERIALS:

Excess earth excavation, pavement grindings and other excess materials resulting from construction operations shall be disposed of by the Contractor outside of the highway right of way, as provided in Section 7-1.13 of the Standard Specifications.

The second paragraph of Section 7-1.13 of the Standard Specifications is modified to read as follows:

When any material is to be disposed of outside the highway right of way, and the County of Riverside has not made arrangements for the disposal of such material, the Contractor shall first obtain written authorization from the property owner on whose property the disposal is to be made and he shall file with the Engineer said authorization or a certified copy thereof together with a written release from the property owner absolving the County of Riverside from any and all responsibility in connection with the disposal of material on said property. If the disposal of materials is to be made at an established disposal facility that is available for public use, the Contractor shall retain all authorizations and receipts from said disposal facility and shall provide copies to the Engineer upon request.

Full compensation for all costs involved in disposing of materials as specified in this section, including all costs of hauling, shall be considered as included in the price paid for the other contract items of work and no additional compensation will be allowed therefore

RECORD DRAWINGS:

The Contractor shall keep one clean set of bond originals to note any changes which take place during construction. These changes to the original plans and/or specifications shall be noted at the appropriate locations with the appropriate changes indicated in red pencil or ink. The Contractor shall note in large letters "RECORD DRAWINGS" on the Title Sheet of the plans. The job will not be finalized by the Engineer until these record drawings have been completed to the satisfaction of the Engineer. The changes shall be noted on the plans as the changes occur. The record drawings shall be submitted to the Resident Engineer, and become the property of the County at conclusion of the project.

Full compensation for maintaining and compiling the record drawings shall be considered to be included in other items of work and no additional compensation will be allowed therefor.

ORDER OF WORK:

Order of work shall conform to the provisions in Section 5-1.05, "Order of Work," of the Standard Specifications and these special provisions.

Attention is directed to "Progress Schedule (Critical Path Method)" of these special provisions regarding the submittal of a general time-scaled logic diagram within 10 days after approval of the contract. The diagram shall be submitted prior to performing any work that may be affected by any proposed deviations to the construction staging of the project.

When embankment settlement periods or surcharge embankment settlement periods are specified, the settlement periods and the deferment of portions of the work shall comply with the provisions in Section 19-6.025, "Settlement Period," of the Standard Specifications and in "Earthwork" of these special provisions.

As one of first orders of work, the contractor shall prepare the shop drawings for the precast girders for approval by the Engineer. The contractor shall begin fabricating girders immediately after the approval of shop drawings by the Engineer.

Approach Slabs shall not be constructed until the waterlines, gas line and future utility casings are installed.

Contractor is required to place an order for all prefabrication components of the bridge.

Contractor shall place an order for all signal poles and equipments simultaneously.

Utility coordination with all other works can be performed concurrently.

LIQUIDATED DAMAGES:

The Contractor shall diligently prosecute the work to completion before the expiration of combined 90 working days including Saturdays from the date stated in the "Notice to Proceed". The Contractor shall pay to the County of Riverside the sum of \$1,500.00 per day, for each and every calendar day's delay in finishing the work in excess of the number of working days prescribed above.

In addition to the liquidated damages set forth above, the first lift of asphalt concrete paving shall be placed within seven (7) calendar days of the removal of existing asphalt concrete for each street segment. A street segment is hereby defined as that area of

road removed in one (1) day. Contractor shall pay to the County of Riverside the sum of **\$800.00 per day**, for each and every calendar day's delay in completing paving within the number of calendar days prescribed above, for each street segment subjected to delay, and shall apply separately to each street segment within the scope of work.

In addition to the liquidated damages set forth in Section 4 of these contract documents, the Contractor shall pay to the County of Riverside the sum of **\$400** per day for each and every calendar day's delay in receiving all of the below listed equipment, onto the job site or the contractors storage facility, and available for installation, within 60 calendar days if standards/ posts, anchor bolts and IISNS mast arms were furnished by the County; otherwise, 100 calendar days of the contract award:

1. Traffic Signal Controller Assemblies
2. Service Equipment Enclosures
3. LED Modules

EXAMINATION OF PLANS, SPECIFICATIONS, CONTRACT, AND SITE WORK:

Attention is directed to "Differing Site Conditions" of these Special Provisions regarding physical conditions at the site which may differ from those indicated in the bridge foundation report, log of test borings or other geotechnical information obtained by the geotechnical investigation of the site conditions.

DIFFERING SITE CONDITIONS:

Attention is directed to Section 5-1.116, "Differing Site Conditions" of the State Standard Specifications.

During the progress of the work, if subsurface or latent conditions are encountered at the site which differ materially from those indicated in the bridge foundation report, log of test borings or other geotechnical information obtained by the geotechnical investigation of the site conditions, or an examination of the conditions above ground at the site, the party discovering said conditions shall promptly notify the other party in writing of the specific differing conditions before said conditions become disturbed and before any work in the affected area is performed.

The Contractor will be allowed 15 days, from the notification of the Engineer's determination of whether or not an adjustment of the contract is warranted, in which to file a notice of potential claim in conformance with the provisions of Section 9-1.04, "Notice of Potential Claim," of the Standard Specifications and as specified herein; otherwise, the decision of the Engineer shall be deemed to have been accepted by the Contractor as correct and undisputed. The notice of potential claim shall set forth in what respects the

Contractor's position differs from the Engineer's determination and provide and additional information obtained by the Contractor, including but not limited to additional geotechnical data. The notice of potential claim shall be accompanied by the Contractor's certification the the following were made in preparation of the bid: a review of the contract, and review of the "Materials Information," a review of the log of test borings and other records of geotechnical data to the extent they were made available to bidders prior to the opening of bids, and an examination of the conditions above ground at the site. Supplementary information, obtained by the Contractor subsequent to the filing of the notice of potential claim, shall be submitted to the Engiener in an expeditious manner.

COOPERATION:

Attention is directed to Section 7-1.14, "Cooperation," and Section 8-1.10, "Utility and Non-Highway Facilities," of the Standard Specifications and these special provisions.

It is anticipated that work by another contractor or contractors, may be in progress adjacent to or within the limits of the project during the progress of work on this contract.

The Contractor shall cooperate with the other contractors and utilities companies to the end that any delay or hindrance to their work will be avoided.

Extensive coordination between the Bridge Contractor and Precast Contractor shall be maintained to facilitate the erection of Bulb-Tee Girders as shown on the Contract Plans.

Extensive coordination between the Bridge Contractor utilities companies (gas, electrical, cable, telephone and water) shall be maintained prior to the erection of their facilities as shown on the contract plans.

Extensive Coordination with SCE (Southern California Edison) and Verizon regarding their conduits, is required to facilitate to erection of girders. The companies shall be notified at least fifteen (15) working days prior to installation of their facilities.

The gas company shall be notified at least fifteen (15) working days, and shall be provided fifteen (15) working days window prior to casting of deck.

All utilities companies shall be provided forty five (45) days construction window to perform necessary work on their facilities.

MISCELLANEOUS DIRECTED WORK (FORCED ACCOUNT):

Miscellaneous directed work shall consist of necessary work that is not included in other contract bid items including environmental mitigation as determined by the Engineer. Miscellaneous directed work shall be performed as directed by the Engineer and in

accordance with the applicable standards and specifications. Payment for implementing miscellaneous directed work will be paid for on a force account basis, in accordance with Section 9-1.03 of the Standard Specifications, up to the fixed bid price, for the work performed.

ITEMS OF WORK:

PROGRESS SCHEDULE (CRITICAL PATH METHOD):

The Contractor shall submit to the Engineer practicable critical path method (CPM) progress schedules in conformance with these Special Provisions. Whenever the term "schedule" is used in this section it shall mean CPM progress schedule.

The Contractor shall submit to the Engineer construction schedule update every two weeks, each consistent in all respects with the time and order of work requirements of the contract. The project work shall be executed in the sequence indicated on the current accepted schedule.

Schedule activities shall include the following:

- A. A clear and legible description.
- B. Start and finish dates.
- C. A duration of not less than one working day, except for event activities, and not more than 20 working days, unless otherwise authorized by the Engineer.
- D. At least one predecessor and one successor activity, except for project start and finish milestones.
- E. Required constraints.
- F. Codes for responsibility, stage, work shifts, location and contract pay item numbers.

The Contractor may show early completion time on any schedule provided that the requirements of the contract are met. Early completion time shall be considered a resource for the exclusive use of the Contractor. The Contractor may increase early completion time by improving production, reallocating resources to be more efficient, performing sequential activities concurrently or by completing activities earlier than planned. The Contractor may also submit for approval a cost reduction incentive proposal in conformance with the provisions in Section 5-1.14, "Cost Reduction Incentive" of the Standard Specifications that will reduce time of construction.

The Engineer may adjust contract working days for ordered changes that affect the scheduled completion date, in conformance with the provisions in Section 4-1.03, "Changes" of the Standard Specifications. The Contractor shall prepare a time impact analysis to determine the effect of the change in conformance with the provisions in "Time Impact Analysis" specified herein, and shall include the impacts acceptable to the Engineer in the next update schedule. Changes that do not affect the controlling operation on

the critical path will not be considered as the basis for a time adjustment. Changes that do affect the controlling operation on the critical path will be considered by the Engineer in decreasing time or granting an extension of time for completion of the contract. Time extensions will only be granted if the total float is absorbed and the scheduled completion date is delayed one or more working days because of the ordered change.

The Engineer's review and acceptance of schedules shall not waive any contract requirements and shall not relieve the Contractor of any obligation thereunder or responsibility for submitting complete and accurate information. Schedules that are rejected shall be corrected by the Contractor and resubmitted to the Engineer within 5 working days of notification by the Engineer, at which time a new review period of one week will begin.

Errors or omissions on schedules shall not relieve the Contractor from finishing all work within the time limit specified for completion of the contract. If, after a schedule has been accepted by the Engineer, either the Contractor or the Engineer discover that any aspect of the schedule has an error or omission, it shall be corrected by the Contractor on the next update schedule.

The Contractor shall include the following for each schedule submittal:

- A. Two sets of originally plotted, time-scaled network diagrams.
- B. Two copies of a narrative report.
- C. Two copies of each of 3 sorts of the CPM software-generated tabular reports.
- D. One 1.44-megabyte 3.5 inch floppy diskette containing the schedule data.

The time-scaled network diagrams shall conform to the following:

- A. Show a continuous flow of information from left to right.
- B. Be based on early start and early finish dates of activities.
- C. Clearly show the primary paths of criticality using graphical presentation.
- D. Be prepared on E-size sheets, 34" x 44".
- E. Include a title block and a timeline on each page.

The narrative report shall be organized in the following sequence with all applicable documents included:

- A. Contractor's transmittal letter.
- B. Work completed during the period.
- C. Identification of unusual conditions or restrictions regarding labor, equipment or material; including multiple shifts, 6-day work weeks, specified overtime or work at times other than regular days or hours.
- D. Description of the current critical path.
- E. Changes to the critical path and scheduled completion date since the last schedule submittal.

- F. Description of problem areas.
- G. Current and anticipated delays:
 - 1. Cause of delay.
 - 2. Impact of delay on other activities, milestones and completion dates.
 - 3. Corrective action and schedule adjustments to correct the delay.
- H. Pending items and status thereof:
 - 1. Permits.
 - 2. Change orders.
 - 3. Time adjustments.
 - 4. Noncompliance notices.
- I. Reasons for an early or late scheduled completion date in comparison to the contract completion date.

Tabular reports shall be software-generated and provide information for each activity included in the project schedule. Three different reports shall be sorted by (1) activity number, (2) early start and (3) total float. Tabular reports shall be 8-1/2" x 11" in size and shall include, as a minimum, the following applicable information:

- A. Data date.
- B. Activity number and description.
- C. Predecessor and successor activity numbers and descriptions.
- D. Activity codes.
- E. Scheduled, or actual and remaining durations (work days) for each activity.
- F. Earliest start (calendar) date.
- G. Earliest finish (calendar) date.
- H. Actual start (calendar) date.
- I. Actual finish (calendar) date.
- J. Latest start (calendar) date.
- K. Latest finish (calendar) date.
- L. Free float (work days).
- M. Total float (work days).
- N. Percentage of activity complete and remaining duration for incomplete activities.
- O. Lags.
- P. Required constraints.

Schedule submittals will only be considered complete when all documents and data have been provided as described above.

Update Schedule:

The Contractor shall submit an update schedule and meet with the Engineer to review contract progress, on or before the first day of each month, beginning one month after the baseline schedule is accepted. The Contractor shall allow 2 weeks for the Engineer's review after the update schedule and all support data are submitted, except that the review period shall not start until the previous month's required schedule is accepted. Update schedules that are not

accepted or rejected within the review period will be considered accepted by the Engineer.

The update schedule shall have a data date of the twenty-first day of the month or other date established by the Engineer. The update schedule shall show the status of work actually completed to date and the work yet to be performed as planned. Actual activity start dates, percent complete and finish dates shall be shown as applicable. Durations for work that has been completed shall be shown on the update schedule as the work actually occurred, including Engineer submittal review and Contractor re-submittal times.

The Contractor may include modifications such as adding or deleting activities or changing activity constraints, durations or logic that do not (1) alter the critical path(s) or near critical path(s) or (2) extend the scheduled completion date compared to that shown on the current accepted schedule. The Contractor shall state in writing the reasons for any changes to planned work. If any proposed changes in planned work will result in (1) or (2) above, then the Contractor shall submit a time impact analysis as described herein.

Time Impact Analysis:

The Contractor shall submit a written time impact analysis (TIA) to the Engineer with each request for adjustment of contract time, or when the Contractor or Engineer consider that an approved or anticipated change may impact the critical path or contract progress.

The TIA shall illustrate the impacts of each change or delay on the current scheduled completion date or internal milestone, as appropriate. The analysis shall use the accepted schedule that has a data date closest to and prior to the event. If the Engineer determines that the accepted schedule used does not appropriately represent the conditions prior to the event, the accepted schedule shall be updated to the day before the event being analyzed. The TIA shall include an impact schedule developed from incorporating the event into the accepted schedule by adding or deleting activities, or by changing durations or logic of existing activities. If the impact schedule shows that incorporating the event modifies the critical path and scheduled completion date of the accepted schedule, the difference between scheduled completion dates of the two schedules shall be equal to the adjustment of contract time. The Engineer may construct and utilize an appropriate project schedule or other recognized method to determine adjustments in contract time until the Contractor provides the TIA.

The Contractor shall submit a TIA in duplicate within 15 working days of receiving a written request for a TIA from the Engineer. The Contractor shall allow the Engineer 2 weeks after receipt to approve or reject the submitted TIA. All approved TIA schedule changes shall be shown on the next update schedule.

If a TIA submitted by the Contractor is rejected by the Engineer, the Contractor shall meet with the Engineer to discuss and resolve issues related to the TIA. If agreement is not reached, the

Contractor will be allowed 15 days from the meeting with the Engineer to give notice in conformance with the provisions in Section 9-1.04, "Notice of Potential Claim" of the Standard Specifications. The Contractor shall only show actual as-built work, not unapproved changes related to the TIA, in subsequent update schedules. If agreement is reached at a later date, approved TIA schedule changes shall be shown on the next update schedule. The Engineer will withhold remaining payment on the schedule contract item if a TIA is requested by the Engineer and not submitted by the Contractor within 15 working days. The schedule item payment will resume on the next estimate after the requested TIA is submitted. No other contract payment will be retained regarding TIA submittals.

Final Update Schedule:

The Contractor shall submit a final update, as-built schedule with actual start and finish dates for the activities, within 30 days after completion of contract work. The Contractor shall provide a written certificate with this submittal signed by the Contractor's project manager and an officer of the company stating, "To my knowledge and belief, the enclosed final update schedule reflects the actual start and finish dates of the actual activities for the project contained herein". An officer of the company may delegate in writing the authority to sign the certificate to a responsible manager.

Full compensation, except as otherwise provided herein, for conforming to the requirements of this article shall be considered as included in the contract bid prices paid for the various items of work, and no additional compensation will be allowed therefor.

MOBILIZATION:

Mobilization shall conform to Section 11 of the Standard Specifications and these Special Provisions.

Payment: Full compensation for Mobilization, except as otherwise provided herein, for conforming to the requirements of this article shall be paid for on a lump sum basis and no additional compensation will be allowed therefor.

PAYMENTS:

Attention is directed to Sections 9 1.06, "Partial Payments," and 9 1.07, "Payment After Acceptance," of the Standard Specifications and these special provisions.

For the purpose of making partial payments pursuant to Section 9-1.06, "Partial Payments," of the Standard Specifications, the amount set forth for the contract items of work hereinafter listed shall be deemed to be the maximum value of the contract item of work which will be recognized for progress payment purposes:

A.	Clearing and Grubbing	\$ 10,000
B.	Mobilization	\$ 25,000
C.	Develop Water Supply	\$ 5,000
D.	Demolition of Existing Block Wall	\$ 10,000

After acceptance of the contract pursuant to the provisions in Section 7-1.17, "Acceptance of Contract" of the Standard Specifications, the amount, if any, payable for a contract item of work in excess of the maximum value for progress payment purposes hereinabove listed for the item, will be included for payment in the first estimate made after acceptance of the contract.

TRAFFIC CONTROL SYSTEM:

Contractor shall prepare construction staging and traffic control plans for review and approval by the Transportation Department.

Proposed plans shall be submitted by the Contractor for review and approval by the Transportation Department at least two weeks prior to the start of construction. The construction staging and traffic control plans shall be prepared, signed and stamped by a Civil Engineer or Traffic Engineer who is registered as such in the State of California, unless otherwise specifically allowed by the Engineer. The Contractor shall revise and implement the plans as directed by the Construction Engineer. Construction shall not begin until the Engineer provides Contractor with County approval of the plans.

Construction staging and traffic control plans shall be in accordance with the appropriate standards and specifications, including the State of California Highway Design Manual, the State of California Traffic Manual and Manual of Traffic Controls, Standard Plans and Standard Specifications, and the Work Area Traffic Control Handbook (WATCH), as published by Building News, Inc. Any requests for deviation from the established design standards or specifications are to be submitted to the Construction Engineer for review and approval prior to submission of the required plans.

With regard to the preparation and implementation of the plans, attention is especially directed to Sections 7-1.06, 7-1.08, 7-1.09, 7-1.11, 7-1.12 and Section 12 of the State of California Standard Specifications. Section 12-2.02 of the Standard Specifications is deleted.

Maintaining traffic shall conform to the provisions in 7-1.02 "Load Limitations", 7-1.06 "Safety and Health Provisions", 7-1.08 "Public Convenience", 7-1.09 "Public Safety", and 12-3.04 "Portable Delineators" of the Standard Specifications, the Manual of Traffic Controls, the Section of these contract documents entitled "Insurance - Hold Harmless", and these Special Provisions.

All existing traffic control signs and street name signs shall be maintained in visible locations as directed by the Engineer.

The detour plan is being provided to bidders. This plan provides necessary information to the Contractor regarding the required signs and their locations. The work included in this item shall include supplying all labor, materials, equipment, supervision, and incidentals required to implement, monitor, and maintain the detour as shown on the Detour Plan. The Detour Route shall include routing traffic on Normandy Road, Berea Road, and Newport Road to accommodate the proposed closure of Goetz Road from Canyon Lake Drive to Newport Road and for the closure of the Goetz Road connection on the north side of the Railroad Canyon Road Right-of-Way. The Contractor's responsibility shall include, but not limited to, traffic signs, special signs, portable changeable message signs, barricades, type III barricades, delineators, and other incidental items for the detour. The Contractor will be required to conduct his operations in conformance with the detour plans and as directed by the Engineer.

The Contractor shall be responsible for implementing, monitoring, and maintaining the detour route until the acceptance of the project.

The Contractor shall notify the City of Canyon Lake 30 calendar days prior to the implementation of the closure of Goetz Road and again 3 calendar days prior to the implementation of the closure of Goetz Road.

All warning lights, signs, flares, barricades and other facilities for the sole convenience and direction of public traffic shall be furnished and maintained by the Contractor. All traffic control devices shall conform to and be placed in accordance with the Manual on Uniform Traffic Control Devices 2006 Edition, the corresponding California Supplement, and subsequent modifications as adopted by the State of California Department of Transportation.

All construction signs shall be either covered or removed when not required by the nature of the work or if no present hazard to the motorist exists.

The Contractor shall notify the appropriate regional notification center for operators of subsurface installations at least 2 working days, but not more than 14 calendar days, prior to commencing excavation for construction area sign posts. The regional notification centers include, but not limited to, the following:

Notification Center	Telephone Number
Underground Service Alert-Southern California (USA)	1-800-422-4133 1-800-227-2600 or 811

Excavations required to install construction area signs shall be performed by hand methods without the use of power equipment, except that power equipment may be used if it is determined there are no utility facilities in the area of the proposed post holes.