

**SUBMITTAL TO THE BOARD OF SUPERVISORS
COUNTY OF RIVERSIDE, STATE OF CALIFORNIA**

721B



SUBMITTAL DATE:
July 29, 2010

FROM: County Counsel/TLMA
Code Enforcement Department

SUBJECT: Abatement of Public Nuisance [Accumulation of Rubbish]
Case No.: CV 09-12072 (DAVILA)
Subject Property: 52127 Acorn Lane, Idyllwild
APN: 559-272-002
District Three

RECOMMENDED MOTION: Move that:

- (1) The accumulation of rubbish on the real property located at 52127 Acorn Lane, Idyllwild, Riverside County, California, APN: 559-272-002, be declared a public nuisance and a violation of Riverside County Ordinance No. 541 which does not permit the accumulation of rubbish on the property.
- (2) Janet L. Davila, owner, or whoever has possession and control of the subject real property, be directed to abate the accumulation of rubbish on the property by removing and disposing of the same from the real property within ninety (90) days.

L. Alexandra Fong
L. ALEXANDRA FONG, Deputy County Counsel
for PAMELA J. WALLS, County Counsel

(Continued)

FINANCIAL DATA	Current F.Y. Total Cost:	\$ N/A	In Current Year Budget:	N/A
	Current F.Y. Net County Cost:	\$ N/A	Budget Adjustment:	N/A
	Annual Net County Cost:	\$ N/A	For Fiscal Year:	N/A

SOURCE OF FUNDS:

Positions To Be Deleted Per A-30

Requires 4/5 Vote

APPROVE

C.E.O. RECOMMENDATION:

BY: *Tina Grande*
Tina Grande

County Executive Office Signature

Dep't Recomm.: Consent Policy Policy

Per Exec. Ofc.: Consent Policy

MINUTES OF THE BOARD OF SUPERVISORS

On motion of Supervisor Stone, seconded by Supervisor Tavaglione and duly carried by unanimous vote, IT WAS ORDERED that the above matter is approved as recommended.

Ayes: Buster, Tavaglione, Stone, Benoit and Ashley
Nays: None
Absent: None
Date: August 10, 2010
xc: Co. Co., CED(2), Prop. Owner, Sheriff

Kecia Harper-Ihem
Clerk of the Board
By: *Kecia Harper-Ihem*
Deputy

Prev. Agn. Ref.:

District: 3

Agenda Number:

ATTACHMENTS FILED
WITH THE CLERK OF THE BOARD

9.5

- (3) If the owner or whoever has possession or control of the real property does not take the above described action within ninety (90) days of the date of the Board's Order to Abate, that representatives of the Code Enforcement Department, Sheriff's Department, and/or a contractor, upon consent of the owner or receipt of a Court Order authorizing entry onto the real property, when necessary under applicable law, shall abate the accumulation of rubbish by removing and disposing of the same from the real property.
- (4) The reasonable cost of abatement, after notice and an opportunity for hearing, shall be imposed as a lien on the real property, which may be collected as a special assessment against the real property pursuant to Government Code Section 25845 and Riverside County Ordinance No. 725.
- (5) County Counsel be directed to prepare the necessary Findings of Facts and Conclusions that the accumulation of rubbish on the real property is declared to be in violation of Riverside County Ordinance No. 541, and a public nuisance, and further, to prepare an Order to Abate for approval by the Board.

JUSTIFICATION:

1. An initial inspection was made of the subject real property by the Code Enforcement Officer on November 16, 2009. The inspection revealed the accumulation of rubbish on the subject property in violation of Riverside County Ordinance No. 541. The rubbish consisted of, but was not limited to: black plastic trash bags filled with green waste, clothing, scattered debris and tree branches.
2. Subsequent inspections of the above-described real property on December 17, 2009, January 21, 2010, February 4, 2010, March 3, 2010, April 19, 2010 and July 1, 2010, revealed the property continues to be in violation of Riverside County Ordinance No. 541.
3. Staff and the Code Enforcement Department have complied with the requirements set forth in the appropriate laws of this jurisdiction pertaining to the administrative abatement proceedings for the removal of accumulated rubbish.

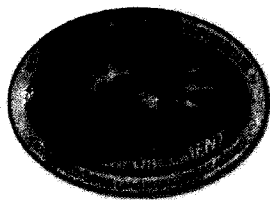

**CODE ENFORCEMENT DEPARTMENT
COUNTY OF RIVERSIDE**

JOHN BOYD
Director

AFFIDAVIT OF POSTING OF NOTICES

July 1, 2010

RE CASE NO: CV0912072

I, Anita Bustillos, hereby declare:

I am employed by the Riverside County Code Enforcement Department; that my business address is 39493 Los Alamos Road, Suite #A, Murrieta, California 92563 .

That on 07/01/2010 at 11:26 a.m., I securely and conspicuously posted Notice To Correct County Ordinance Violations and Abate Public Nuisance at the property described as:

Property Address: 52127 ACORN LN, IDYLLWILD

Assessor's Parcel Number: 559-272-002

I declare under the penalty of perjury that the foregoing is true and correct.

Executed on July 1, 2010 in the County of Riverside, California.

CODE ENFORCEMENT DEPARTMENT

Anita Bustillos

By: Anita Bustillos, Code Enforcement Technician

EXHIBIT NO. G⁵

**BOARD OF SUPERVISORS
COUNTY OF RIVERSIDE**

IN RE ABATEMENT OF PUBLIC NUISANCE) CASE NO. CV 09-12072
[ACCUMULATION OF RUBBISH] APN: 559-)
272-002, 52127 ACORN LANE, IDYLLWILD,)
COUNTY OF RIVERSIDE, STATE OF) DECLARATION OF CODE
CALIFORNIA; JANET L. DAVILA, OWNER.) ENFORCEMENT OFFICER
CAROL FORREY
[R.C.O. No. 541 (RCC Title 8.120)]

I, Carol Forrey, declare that the facts set forth below are personally known to me except to the extent that certain information is based on information and belief which I believe to be true, and if called as a witness, I could and would competently testify thereto under oath:

1. I am currently employed by the Riverside County Code Enforcement Department as a Code Enforcement Officer. My current official duties as a Code Enforcement Officer include inspecting property for violations and enforcement of the provisions of Riverside County Ordinances.

2. I am informed and believe and based thereon allege that on November 16, 2009, Code Enforcement Officer Durant conducted an initial inspection of the real property described as 52127 Acorn Lane, Idyllwild, Riverside County, California and further described as Assessor's Parcel Number 559-272-002 (hereinafter referred to as "THE PROPERTY"). A true and correct copy of a Thomas Brothers map indicating the location of THE PROPERTY is attached hereto as Exhibit "A" and incorporated herein by reference.

3. A review of County records and documents disclosed that THE PROPERTY is owned by Janet L. Davila (hereinafter referred to as the "OWNER"). A certified copy of the County Equalized Assessment Roll for the year 2009-2010 and a copy of the County Geographic Information System ("GIS") report are attached hereto as Exhibit "B" and incorporated herein by reference.

4. Based on the Lot Book Report from RZ Title Service on January 8, 2010 and updated on May 19, 2010, it is determined that additional parties may potentially hold a legal interest in THE PROPERTY, to wit: Capital One Bank and State of California Franchise Tax Board (hereinafter collectively referred to as "INTERESTED PARTIES"). True and correct copies of the Lot Book Reports are attached hereto as Exhibit "C" and incorporated herein by reference.

///

8/10/10 9.5

1 5. I am informed and believe and based thereon allege that on November 16, 2009, Code
2 Enforcement Officer Durant conducted an initial inspection of THE PROPERTY. THE PROPERTY was
3 unfenced and accessible and Officer Durant walked onto the parcel and observed an accumulation of
4 rubbish consisting of but not limited to: black plastic trash bags filled with green waste, clothing,
5 scattered debris and tree branches. Officer Durant took measurements of the area and calculated the
6 amount of accumulated rubbish on THE PROPERTY as five hundred (500) square feet. He posted a
7 Notice of Violation on THE PROPERTY.

8 6. As a result of the accumulation of rubbish, THE PROPERTY constituted a public nuisance in
9 violation of the provisions set forth in Riverside County Ordinance No. 541, as codified in Riverside
10 County Code Title 8.120.

11 7. A site plan and photographs of THE PROPERTY are attached hereto and incorporated
12 herein by reference as Exhibit "D."

13 8. True and correct copies of each Notice issued in this matter and other supporting
14 documentation are attached hereto as Exhibit "E" and incorporated herein by reference.

15 9. On November 18, 2009 and March 10, 2010, a Notice of Violation was mailed to OWNER
16 by certified mail, return receipt requested. On March 10, 2010, a Notice of Violation was mailed to
17 INTERESTED PARTIES by certified mail, return receipt requested.

18 10. I am informed and believe and based thereon allege that on December 17, 2009 and
19 February 4, 2010, Officer Durant conducted follow-up inspections of THE PROPERTY. From the road
20 right of way, he observed the parcel was unchanged and remained in violation of Riverside County
21 Ordinance No. 541.

22 11. On March 3, 2010 and April 19, 2010, I drove to THE PROPERTY to conduct follow-up
23 inspections. THE PROPERTY was open and accessible and I observed the conditions on THE
24 PROPERTY remained unchanged from previous inspections and in violation of RCO No. 541.

25 12. Based upon my experience, knowledge and visual observations, it is my determination that
26 the conditions on THE PROPERTY are dangerous to the neighboring property owners and the general
27 public.

28 ///

1 13. A Notice of Noncompliance regarding the accumulation of rubbish was recorded in the
2 Office of the Assessor, County Clerk & Recorder, County of Riverside, State of California, on March 16,
3 2010, as Instrument Number 2010-0120738. A true and correct copy of the notice is attached hereto and
4 incorporated herein by reference as Exhibit "F".

5 14. On June 30, 2010 the second notice, "Notice to Abate Public Nuisance" providing
6 notification of the Board of Supervisors' hearing scheduled for August 10, 2010, was mailed to OWNER
7 and INTERESTED PARTIES by certified mail, return receipt requested and on July 1, 2010 was posted
8 on THE PROPERTY. True and correct copies of the notice and supporting documentation are attached
9 hereto as Exhibit "G" and incorporated herein by reference.

10 15. A follow-up inspection on July 1, 2010 revealed that THE PROPERTY remains in
11 violation.

12 16. Removal of the accumulation of rubbish on THE PROPERTY is required to bring THE
13 PROPERTY into compliance with Riverside County Ordinance No. 541 (RCC Chapter 8.120) and the
14 Health and Safety Code. Under RCO No. 541, no amount of rubbish is allowed to accumulate on THE
15 PROPERTY.

16 17. The Board of Supervisors is requested to issue an Order to Abate the Nuisance described
17 herein. Accordingly, the following findings and conclusions are recommended:

18 (a) the accumulation of rubbish on THE PROPERTY to be deemed and declared a
19 public nuisance;

20 (b) the OWNER and person(s) in possession of THE PROPERTY be required to
21 remove all accumulated rubbish within ninety (90) days of the date of the posting and mailing of the
22 Board's Order to Abate Nuisance, in accordance with all Riverside County Ordinances, including but not
23 limited to the provisions of County Ordinance No. 541;

24 (c) in the event the rubbish is not removed and disposed of according to the above
25 referenced ninety (90) day time period in strict accordance with all Riverside County Ordinances,
26 including but not limited to Riverside County Ordinance No. 541 (RCC Chapter 8.120), the rubbish shall
27 be abated by representatives of the Riverside County Code Enforcement Department, a contractor or the
28 Sheriff's Department; and

1 (d) reasonable costs of abatement, after notice and opportunity for hearing, shall be
2 imposed as a lien on THE PROPERTY, which may be collected as a special assessment against THE
3 PROPERTY pursuant to Government Code Section 25845 and Riverside County Ordinance Nos. 541
4 (RCC Title 8.120) and 725 (RCC Title 1).

5 I declare under penalty of perjury under the laws of the State of California that the foregoing is
6 true and correct.

7 Executed this 30th day of June, 2010, at Riverside, California.

8
9
10 
11 CAROL FORREY
12 Code Enforcement Officer
13 Code Enforcement Department
14
15
16
17
18
19
20
21
22
23
24
25
26
27
28

RIVERSIDE CO.

SEE 389 MAP

SEE 814 MAP

782

SEE 389 MAP

SEE 389 MAP

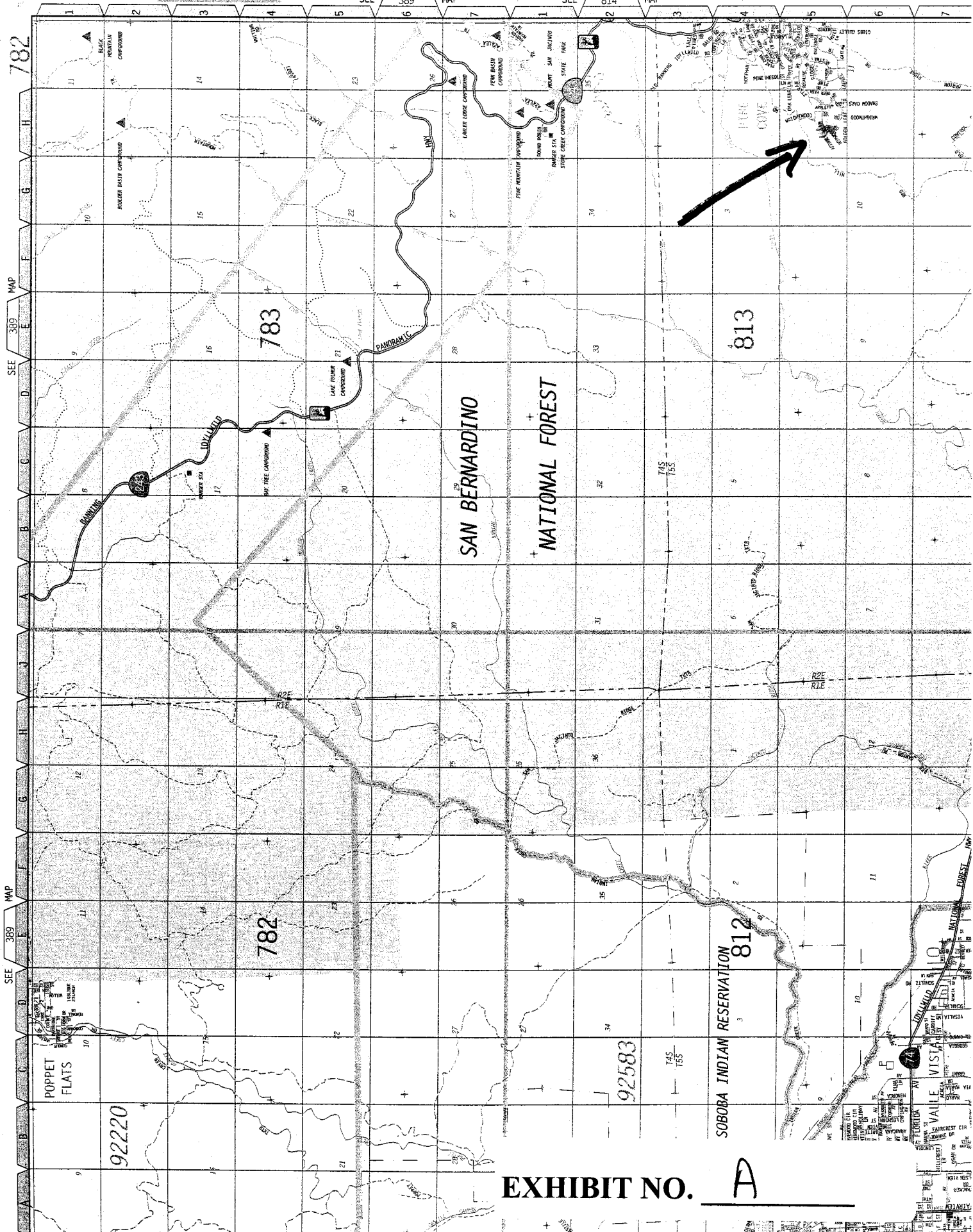

SAN BERNARDINO NATIONAL FOREST

SOBOBA INDIAN RESERVATION 812

EXHIBIT NO.

A

Assessment Roll For the 2009-2010 Tax Year as of January 1,2009

Assessment #559272002-6		Parcel # 559272002-6	
Assessee:	DAVILA JANET L	Land	55,000
Mail Address:	P O BOX 2232	Structure	140,000
City, State Zip:	IDYLLWILD CA 92549	Full Value	195,000
Real Property Use Code:	R1	Total Net	195,000
Base Year	2005		
Conveyance Number:	0030683		
Conveyance (mm/yy):	1/2004		
PUI:	R010000		
TRA:	71-304		
Taxability Code:	0-00		
ID Data:	Lot 15 MB 054/015 TR 3351		
Situs Address:	52127 ACORN LN IDYLLWILD CA 92549		

View Parcel Map

EXHIBIT NO. B

RIVERSIDE COUNTY GIS

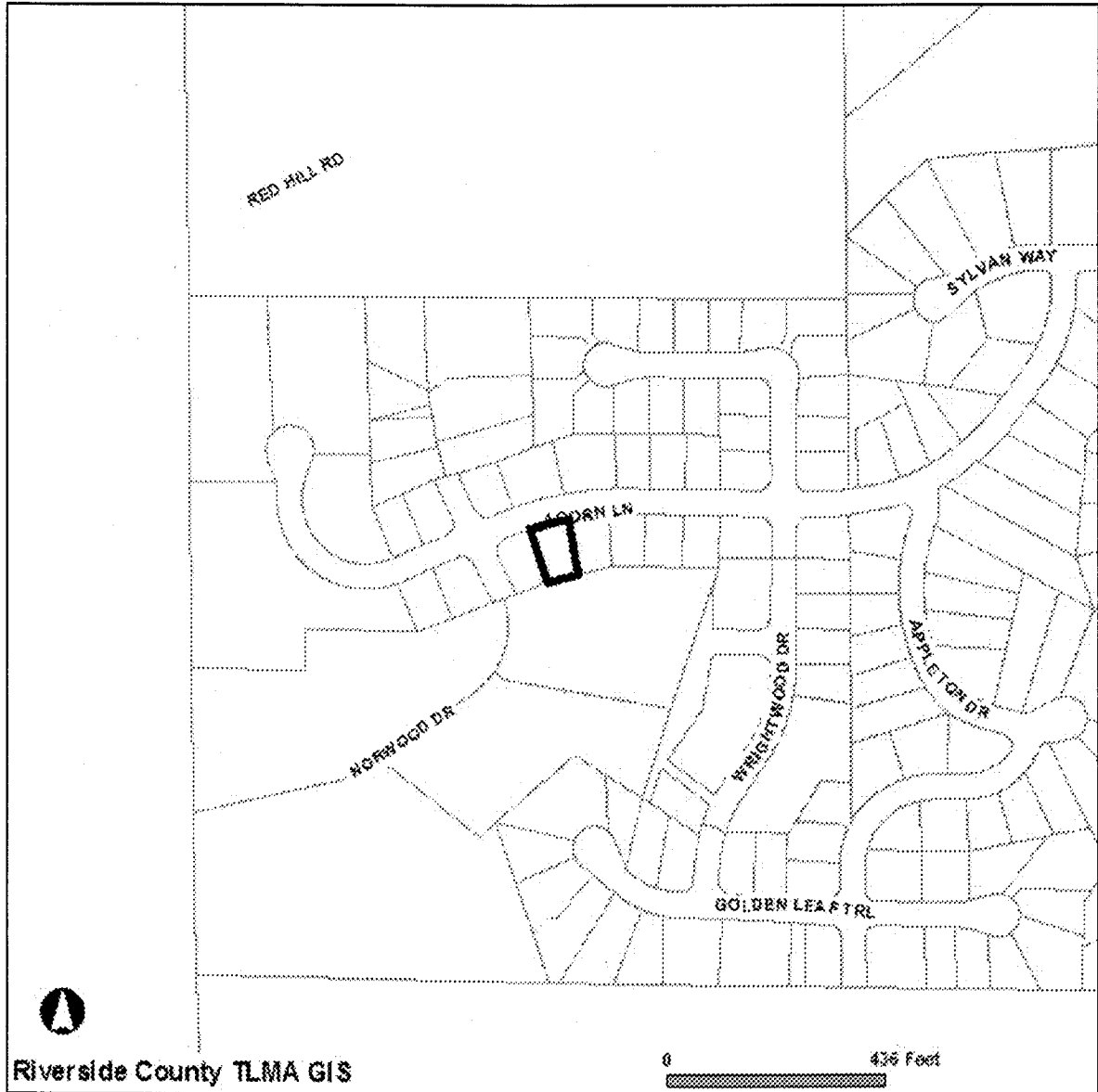

Selected parcel(s):
559-272-002

IMPORTANT

Maps and data are to be used for reference purposes only. Map features are approximate, and are not necessarily accurate to surveying or engineering standards. The County of Riverside makes no warranty or guarantee as to the content (the source is often third party), accuracy, timeliness, or completeness of any of the data provided, and assumes no legal responsibility for the information contained on this map. Any use of this product with respect to accuracy and precision shall be the sole responsibility of the user.

STANDARD REPORT

APNs

559-272-002-6

OWNER NAME / ADDRESS

JANET L DAVILA
52127 ACORN LN
IDYLLWILD, CA. 92549

MAILING ADDRESS

(SEE OWNER)
P O BOX 2232

EXHIBIT NO. C

IDYLLWILD CA. 92549

LEGAL DESCRIPTION

RECORDED BOOK/PAGE: MB 54/15
SUBDIVISION NAME: TR 3351
LOT/PARCEL: 15, BLOCK: NOT AVAILABLE
TRACT NUMBER: 3351

LOT SIZE

RECORDED LOT SIZE IS 0.18 ACRES

PROPERTY CHARACTERISTICS

WOOD FRAME, 1404 SQFT., 2 BDRM/ 1.5 BATH, 1 STORY, CONST'D 1980COMPOSITION, ROOF

THOMAS BROS. MAPS PAGE/GRID

PAGE: 813 GRID: H5

CITY BOUNDARY/SPHERE

NOT WITHIN A CITY
NOT WITHIN A CITY SPHERE
NO ANNEXATION DATE AVAILABLE
NO LAFCO CASE # AVAILABLE
NO PROPOSALS

MARCH JOINT POWERS AUTHORITY

NOT IN THE JURISDICTION OF THE MARCH JOINT POWERS AUTHORITY

INDIAN TRIBAL LAND

NOT IN A TRIBAL LAND

SUPERVISORIAL DISTRICT (ORD. 813)

JEFF STONE, DISTRICT 3

TOWNSHIP/RANGE

T5SR2E SEC 11

ELEVATION RANGE

5812/5824 FEET

PREVIOUS APN

NO DATA AVAILABLE

PLANNING

LAND USE DESIGNATIONS

Zoning not consistent with the General Plan.
VLDR

AREA PLAN (RCIP)

REMAP

GENERAL PLAN POLICY OVERLAYS

NOT IN A GENERAL PLAN POLICY OVERLAY AREA

GENERAL PLAN POLICY AREAS

VILLAGE TOURIST POLICY AREA

ZONING CLASSIFICATIONS (ORD. 348)

R-1A-20000

ZONING DISTRICTS AND ZONING AREAS

PINE COVE DISTRICT

ZONING OVERLAYS

NOT IN A ZONING OVERLAY

SPECIFIC PLANS

NOT WITHIN A SPECIFIC PLAN

AGRICULTURAL PRESERVE

NOT IN AN AGRICULTURAL PRESERVE

REDEVELOPMENT AREAS

NOT IN A REDEVELOPMENT AREA

AIRPORT INFLUENCE AREAS
NOT IN AN AIRPORT INFLUENCE AREA

AIRPORT COMPATIBILITY ZONES
NOT IN AN AIRPORT COMPATIBILITY ZONE

ENVIRONMENTAL

CVMSHCP (COACHELLA VALLEY MULTI-SPECIES HABITAT CONSERVATION PLAN) CONSERVATION AREA
NOT IN A CONSERVATION AREA

CVMSHCP FLUVIAL SAND TRANSPORT SPECIAL PROVISION AREAS
NOT IN A FLUVIAL SAND TRANSPORT SPECIAL PROVISION AREA

WRMSHCP (WESTERN RIVERSIDE COUNTY MULTI-SPECIES HABITAT CONSERVATION PLAN) CELL GROUP
NOT IN A CELL GROUP

WRMSHCP CELL NUMBER
NOT IN A CELL

HANS/ERP (HABITAT ACQUISITION AND NEGOTIATION STRATEGY/EXPEDITED REVIEW PROCESS)
NONE

VEGETATION (2005)
Montane Coniferous Forest

FIRE

HIGH FIRE AREA (ORD. 787)
IN HIGH FIRE AREA - Grading And Building Permit Applications Require Fire Dept Clearance Prior To Permit Issuance.

FIRE RESPONSIBILITY AREA
STATE RESPONSIBILITY AREA

DEVELOPMENT FEES

CVMSHCP FEE AREA (ORD. 875)
NOT WITHIN THE COACHELLA VALLEY MSHCP FEE AREA

WRMSHCP FEE AREA (ORD. 810)
IN OR PARTIALLY WITHIN THE WESTERN RIVERSIDE MSHCP FEE AREA. SEE MAP FOR MORE INFORMATION.

ROAD & BRIDGE DISTRICT
NOT IN A DISTRICT

EASTERN TUMF (TRANSPORTATION UNIFORM MITIGATION FEE ORD. 673)
NOT WITHIN THE EASTERN TUMF FEE AREA

WESTERN TUMF (TRANSPORTATION UNIFORM MITIGATION FEE ORD. 824)
NOT WITHIN THE WESTERN TUMF FEE AREA

DIF (DEVELOPMENT IMPACT FEE AREA ORD. 659)
REMAP

SKR FEE AREA (STEPHEN'S KANGAROO RAT ORD. 663.10)
NOT WITHIN AN SKR FEE AREA.

DEVELOPMENT AGREEMENTS
NOT IN A DEVELOPMENT AGREEMENT AREA

TRANSPORTATION

CIRCULATION ELEMENT ULTIMATE RIGHT-OF-WAY
NOT IN A CIRCULATION ELEMENT RIGHT-OF-WAY

ROAD BOOK PAGE
154

TRANSPORTATION AGREEMENTS
NOT IN A TRANSPORTATION AGREEMENT**CETAP (COMMUNITY AND ENVIRONMENTAL TRANSPORTATION ACCEPTABILITY PROCESS) CORRIDORS**
NOT IN A CETAP CORRIDOR.

HYDROLOGY**FLOOD PLAIN REVIEW**
NOT REQUIRED.**WATER DISTRICT**
DATA NOT AVAILABLE**FLOOD CONTROL DISTRICT**
RIVERSIDE COUNTY FLOOD CONTROL DISTRICT**WATERSHED**
SAN JACINTO VALLEY

GEOLOGIC**FAULT ZONE**
NOT IN A FAULT ZONE**FAULTS**
NOT WITHIN A 1/2 MILE OF A FAULT**LIQUEFACTION POTENTIAL**
NO POTENTIAL FOR LIQUEFACTION EXISTS**SUBSIDENCE**
NOT IN A SUBSIDENCE AREA**PALEONTOLOGICAL SENSITIVITY**
LOW POTENTIAL.
FOLLOWING A LITERATURE SEARCH, RECORDS CHECK AND A FIELD SURVEY, AREAS MAY BE DETERMINED BY A QUALIFIED VERTEBRATE PALEONTOLOGIST AS HAVING LOW POTENTIAL FOR CONTAINING SIGNIFICANT PALEONTOLOGICAL RESOURCES SUBJECT TO ADVERSE IMPACTS.

MISCELLANEOUS**SCHOOL DISTRICT**
HEMET UNIFIED**COMMUNITIES**
PINE COVE**COUNTY SERVICE AREA**
IN OR PARTIALLY WITHIN
PINE COVE #38 -
NO SERVICE INFORMATION**LIGHTING (ORD. 655)**
ZONE B, 28.16 MILES FROM MT. PALOMAR OBSERVATORY**2000 CENSUS TRACT**
044401**FARMLAND**
NOT MAPPED**TAX RATE AREAS**
071-304
• COACHELLA VALLEY RESOURCE CONSER
• COUNTY FREE LIBRARY
• COUNTY SERVICE AREA 38 *
• COUNTY STRUCTURE FIRE PROTECTION
• COUNTY WASTE RESOURCE MGMT DIST
• CSA 152

- CSA 153
- FLOOD CONTROL ADMINISTRATION
- FLOOD CONTROL ZONE 4
- GENERAL
- GENERAL PURPOSE
- HEMET UNIFIED SCHOOL
- MT SAN JACINTO JUNIOR COLLEGE
- PINE COVE COUNTY WATER
- RIV CO REG PARK & OPEN SPACE
- RIV. CO. OFFICE OF EDUCATION
- SAN JACINTO BASIN RESOURCE CONS
- VALLEY HEALTH SYSTEM HOSP DIST

SPECIAL NOTES
NO SPECIAL NOTES

CODE COMPLAINTS

Case #	Description	Start Date
CV0906764	VEHICLE ABATEMENT	Sep. 9, 2009
CV0912072	ABATEMENT	Nov. 12, 2009

REPORT PRINTED ON...Wed May 19 14:01:21 2010
Version 100412



P.O. Box 1193
 Whittier, CA 90609
 Tel # (562) 325-8351
 Fax # (714) 783-3038

Updated Lot Book

Customer:

RIVERSIDE COUNTY TLMA-CODE INFORCEMENT

4080 Lemon Street
 Riverside CA 92501

Attn: Brent Steele
 Reference: CV09-12072 / Yadira Oseguera
 IN RE: DAVILA, JANET L.

Property Address: 52127 Acorn Lane
 Idyllwid CA 92549

Order Number: **21535**

Order Date: 5/19/2010
 Dated as of: 5/13/2010

County Name: Riverside

FEE(s):
 Report: \$57.00

RZ Title Reporting Service hereby reports, as disclosed by the Official Records of the Recorder of said County as of the date shown above, that subsequent to the date of the original report that (i) No document in the chain of title to said land has been recorded purporting to convey the fee title to said land, and (ii) No encumbrances affecting said land have been recorded nor has a homestead been executed on said land, and (iii) No encumbrances affecting said land on the date of the original report have been released or reconveyed.

All exceptions are as follows:

Assessor's Parcel No. : 559-272-002-6

Assessments:	Land Value:	\$55,000.00
	Improvement Value:	\$140,000.00
	Exemption Value:	\$0.00
	Total Value:	\$195,000.00

Property Taxes for the Fiscal Year	2009-2010
First Installment	\$1,152.15
Penalty	\$115.20
Status	NOT PAID-DELINQUENT
Second Installment	\$1,152.15
Penalty	\$143.20
Status	NOT PAID-DELINQUENT

Notice of Non-Compliance filed by	County of Riverside Department of Code Enforcement
In the matter of the property of	Janet L. Davila
Case No.	CV09-12072
Recorded	03/16/2010



P.O. Box 1193
Whittier, CA 90609
Tel # (562) 325-8351
Fax # (714) 783-3038

Order Number: 21535

Reference: CV09-12072 / Yad

Document No.

2010-0120738

NO OTHER EXCEPTIONS

When recorded please mail to:
Riverside County
Code Enforcement Department
39493 Los Alamos Rd.
Murrieta, CA 92563
Mail Stop No. 5155

DOC # 2010-0120738

03/16/2010 08:00A Fee:NC

Page 1 of 1

Recorded in Official Records
County of Riverside

Larry W. Ward
Assessor, County Clerk & Recorder

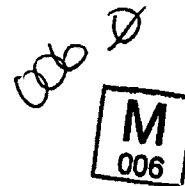

NOTICE OF NONCOMPLIANCE

In the matter of the Property of)

Janet L. Davila)

Case No.: CV09-12072

NOTICE IS HEREBY GIVEN to all persons, pursuant to Section 10 of Ordinance Number 725 of the County of Riverside, State of California, that proceedings have been commenced with respect to violations of Riverside County Ordinance No.541, (RCC Title 8.120.010) described as Accumulated Rubbish. Such Proceedings are based upon the noncompliance of such real property, located at 52127 Acorn Lane, Idyllwild, CA, and more particularly described as Assessor's Parcel Number 559-272-002 and having a legal description of 0.18 Acres, MB 54/15, TR 3351, LOT 15, Records of Riverside County, with the requirements of Ordinance No. 541 (RCC Title 8.120.010).

The owner has been advised to immediately correct the above-referenced violation to avoid further action by the County of Riverside, which may include remediation or restoration to abate the public nuisance or other remedies available to the department by a court of competent jurisdiction. Any costs incurred by the County, including, but not limited to investigative, administrative and abatement costs and attorneys' fees, may become a lien on the property. Further details regarding this notice may be obtained by addressing an inquiry to the Code Enforcement Department, 39493 Los Alamos Road, Murrieta, CA 92563; Attention: Code Enforcement Officer C. Forrey (951) 600-6140.

NOTICE IS FURTHER GIVEN in accordance with §17274 and §24436.5 of the California Revenue and Taxation Code, that a tax deduction may not be allowed for interest, taxes, depreciation, or amortization paid or incurred in the taxable year affected by these proceedings.

COUNTY OF RIVERSIDE
DEPARTMENT OF CODE ENFORCEMENT

By: Hector Viray
Hector Viray
Code Enforcement Department

ACKNOWLEDGEMENT

State of California)
County of Riverside)

On 03/10/10 before me, Elizabeth B. Ross, Notary Public, personally appeared Hector Viray, who proved to me on the basis of satisfactory evidence to be the person(s) whose name(s) is/are subscribed to the within instrument and acknowledged to me that he/she/they executed the same in his/her/their authorized capacity(ies), and that by his/her/their signature(s) on the instrument the person(s), or the entity upon behalf of which the person(s) acted, executed the instrument.

I certify under PENALTY OF PERJURY under the laws of the State of California that the foregoing paragraph is true and correct.

WITNESS my hand and official seal.

Elizabeth B. Ross
Commission #1838743 Comm. Expires March 12, 2013

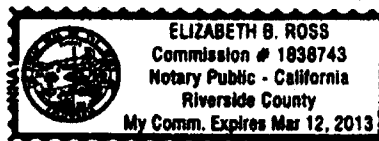

Public Record



P.O. Box 1193
Whittier, CA 90609
Tel # (562) 325-8351
Fax # (714) 783-3038

Lot Book Report

Order Number: **21077**

Customer:

RIVERSIDE COUNTY TLMA-CODE ENFORCEMENT

4080 Lemon Street

Riverside

CA 92501

Attn:

Brent Steele

Reference:

CV09-12072/Liz Ross

IN RE:

DAVILA, JANET L

Order Date: 12/21/2009

Dated as of: 1/8/2010

County Name: Riverside

FEE(s):

Report: \$114.00

Property Address: 52127 Acorn Lane

Idyllwild

CA 92549

Assessor's Parcel No. : 559-272-002

Assessments:

Land Value:	\$55,000.00
Improvement Value:	\$140,000.00
Exemption Value:	\$0.00
Total Value:	\$195,000.00

Tax Information

Property Taxes for the Fiscal Year	2009-2010
First Installment	\$1,152.15
Penalty	\$115.20
Status	NOT PAID-DELINQUENT
Second Installment	\$1,152.15
Penalty	\$0.00
Status	OPEN NOT-PAID (DUE DATE 04/10/2010)



P.O. Box 1193
Whittier, CA 90609
Tel # (562) 325-8351
Fax # (714) 783-3038

Order Number: 21077
Reference: CV09-12072/Liz R

Property Vesting

The last recorded document transferring title of said property

Dated	12/30/2003
Recorded	01/15/2004
Document No.	2004-0030683
D.T.T.	\$203.50
Grantor	Stephen A. Loveland and Judith A. Loveland, Trustees of the Loveland Revocable Trust under instrument dated January 21, 1994
Grantee	Janet L. Davila, an unmarried woman

Deeds of Trust

No Deeds of Trust of Record

Additional Information

Abstract of Judgment Filed in the	Superior Court of California, County of Riverside - Hemet Dept.
Case No.	HEC021961
Recorded	03/21/2007
Document No.	2007-0193435
Amount	\$11,659.39
Debtor	Janet L. Davila
Creditor	Capital One Bank
A Notice of State Tax Lien Recorded	12/29/2009
Document No.	2009-0665865
Amount	\$1,247.62
Account No.	1211881416
Certificate No.	09351303345



P.O. Box 1193
Whittier, CA 90609
Tel # (562) 325-8351
Fax # (714) 783-3038

Order Number: 21077
Reference: CV09-12072/Liz R

Debtor

Janet L Davila

Creditor: State of California,

Franchise Tax Board

Legal Description

THE LAND REFERRED TO IN THIS REPORT IS LOCATED IN AND IS DESCRIBED AS FOLLOWS:

LOT 15 OF TRACT NO. 3351, IN THE COUNTY OF RIVERSIDE, STATE OF CALIFORNIA, AS SHOWN BY MAP ON FILE IN BOOK 54, PAGES 15 AND 16 OF MAPS, RECORDS OF SAID COUNTY RECORDER.

THIS MAP WAS PREPARED FOR ASSESSMENT PURPOSES ONLY. NO LIABILITY IS ASSUMED FOR ACCURACY OF THE DATA SHOWN. ASSESSORS PRICES MAY NOT COMPLY WITH LOCAL LOT SPLIT OR BUILDING SITE ORDINANCES.

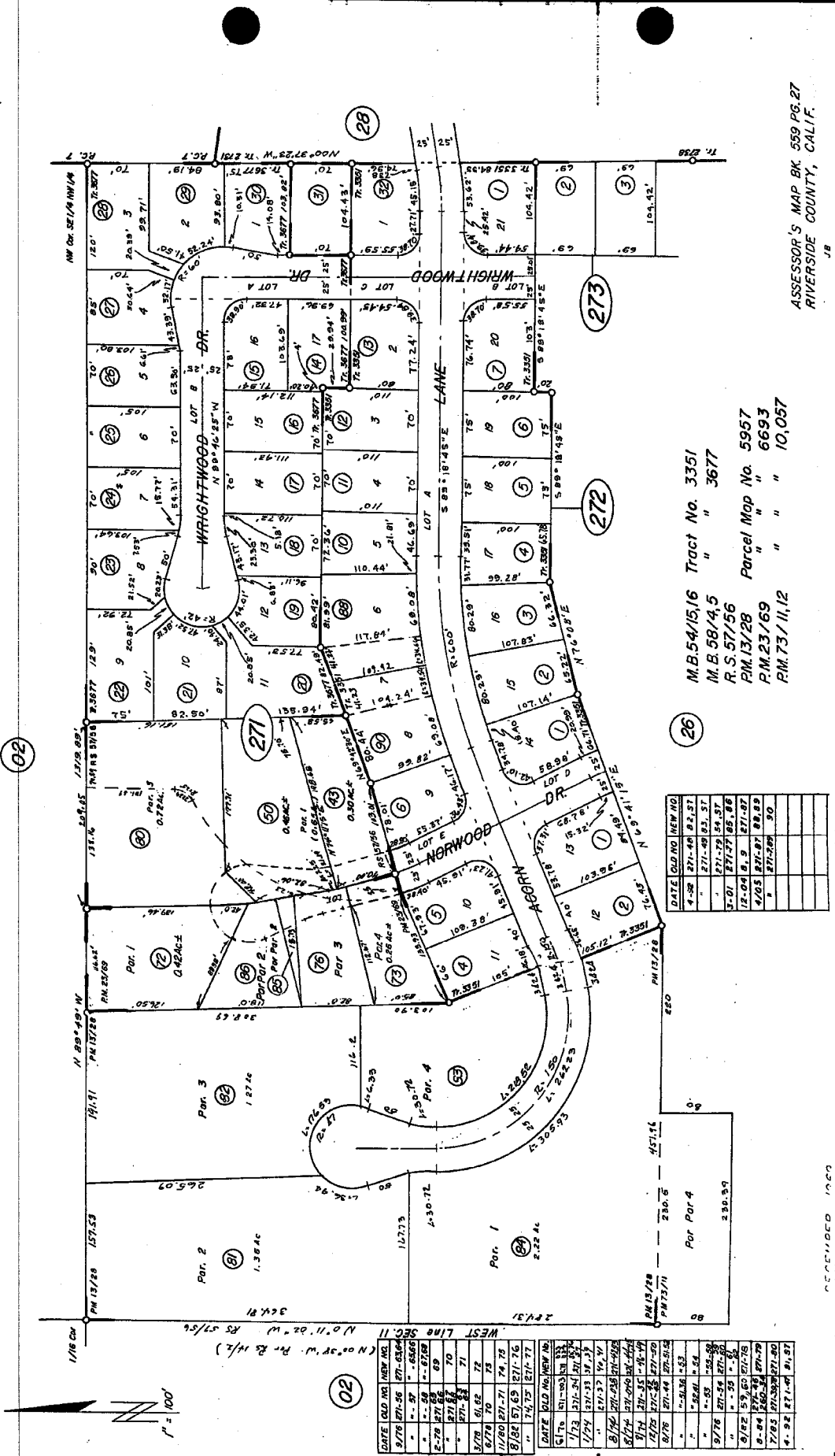

DATE	OLD NO.	NEW NO.
4-28	271-49	22-57
5-01	271-79	54-57
12-04	8-9	271-87
4-03	271-89	88-89
7-03	271-89	90

M.B.54/15,16 Tract No. 3351
 M.B. 58/4,5 " " 3677
 R.S. 57/56 Parcel Map No. 5957
 P.M.13/28 " " " 6693
 P.M.23/69 " " " 10,057

ASSESSOR'S MAP BK 559 PG.27
 RIVERSIDE COUNTY, CALIF.

RECORDED 1000

DATE	OLD NO.	NEW NO.
3/76	271-95	271-95
5-78	271-95	89
5-78	271-95	70
5/78	01-05	72
11/20	271-71	74, 75
8/92	57-69	271-76
"	74, 75	271-77

DATE	OLD NO.	NEW NO.
6/76	271-93	271-93
1/79	271-93	58-59
"	271-93	10-11
8/74	271-258	271-258
8/74	271-258	44-45
12/75	271-55	11-19
12/75	271-55	271-90
8/76	271-44	271-51, 52
"	271-51	1-3
"	271-51	54
9/78	271-51	38-39
"	271-51	55
9/82	59-63	271-75
9-84	260-34	271-79
7/83	271-90	271-90
4-92	271-40	21, 27



RECORDING REQUESTED BY

AND WHEN RECORDED MAIL TO:
Janet L. Davila
1400 East Menlo #45
Hemet, CA 92544

RECORDING REQUESTED BY
EDELITY NATIONAL TITLE INSURANCE

M	S	U	PAGE	SIZE	DA	PCOR	NOCOR	SMF	MSC
									CM
A	R	L			COPY	LONG	REFUND	NCHG	EXAM

A.P.N.: 559-272-002-6 TRA #: 071-304

Order No.: 33238436

Escrow No.: 8362-B

GRANT DEED



THE UNDERSIGNED GRANTOR(S) DECLARE(S) THAT DOCUMENTARY TRANSFER TAX IS: COUNTY \$203.50

- computed on full value of property conveyed, or
- computed on full value less value of liens or encumbrances remaining at time of sale,
- unincorporated area;

FOR A VALUABLE CONSIDERATION, Receipt of which is hereby acknowledged,
Stephen A. Loveland and Judith A. Loveland, Trustees of the Loveland Revocable Trust under instrument dated
January 21, 1994

hereby GRANT(S) to Janet L. Davila, an unmarried woman

the following described property in the of unincorporated area, County of Riverside State of California;

Lot 15 of Tract 3351, as shown by map on file in Book 54, Pages 15 and 16 of maps, Records of Riverside County,
California.

Stephen A. Loveland and Judith A.
Loveland, Trustees of the Loveland
Revocable Trust under instrument dated
January 21, 1994

By: Stephen A. Loveland
Stephen A. Loveland, Trustee

By: Judith A. Loveland
Judith A. Loveland, Trustee

Document Date: December 30, 2003

STATE OF CALIFORNIA)
COUNTY OF Riverside)
On January 2, 2004 before me, Wendy Heard, notary public
personally appeared Stephen A. Loveland and Judith A. Loveland
personally known to me (or proved to me on the basis of satisfactory evidence) to be the person(s) whose name(s) is/are subscribed to the within instrument
and acknowledged to me that as they executed the same in his/her their authorized capacity(ies) and that by his/her their signature(s) on the instrument
the person(s) or the entity upon behalf of which the person(s) acted, executed the instrument.
WITNESS my hand and official seal.

Signature Wendy Heard

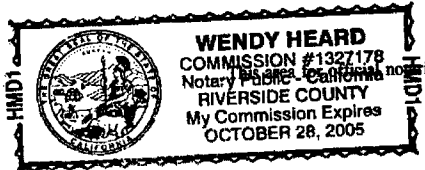

Mail Tax Statements to: SAME AS ABOVE or Address Noted Below

DOC # 2007-0193435
03/21/2007 08:00A Fee:18.00

Page 1 of 3
Recorded in Official Records
County of Riverside
Larry W. Ward
Assessor, County Clerk & Recorder

PLEASE COMPLETE THIS INFORMATION
RECORDING REQUESTED BY:

AND WHEN RECORDED MAIL TO:
Eskanos & Adler, P.C.
2325 Clayton Road
Concord, Ca. 94520



S	R	U	PAGE	SIZE	DA	MISC	LONG	RFD	COPY
			3						
M	(A)	L	465	426	PCOR	NCOR	SMF	NCHG	EXAM
NOTICE SENT									001

18

Space above this line for recorder's use only

TRA:
DTT: Abstract of Judgment

M
001

Title of Document

THIS AREA FOR
RECORDER'S
USE ONLY

THIS PAGE ADDED TO PROVIDE ADEQUATE SPACE FOR RECORDING INFORMATION
(\$3:00 Additional Recording Fee Applies)

ACR 238P-AS4RE0 (Rev. 02/2003)

Public Record

JAN 12 2007

ATTORNEY OR PARTY WITHOUT ATTORNEY (Name, address, State Bar number, and telephone number):
Recording requested by and return to: 800-364-9919

ESKANOS & ADLER, PC. SB 83936/208602
DONALD R. STEBBINS/JANET L. BROWN
KURTISS A. JACOBS/JEROME M. YALON 218950/84204
2325 CLAYTON ROAD, CONCORD, CA 94520
File No. 062195-1 DESK:003

ATTORNEY FOR JUDGMENT CREDITOR ASSIGNEE OF RECORD

SUPERIOR COURT OF CALIFORNIA, COUNTY OF RIVERSIDE

STREET ADDRESS: 880 N. STATE ST.

MAILING ADDRESS:

CITY AND ZIP CODE: HEMET CA 92343

BRANCH NAME: HEMET DEPT.

FOR RECORDER'S USE ONLY

PLAINTIFF: CAPITAL ONE BANK

CASE NUMBER:

DEFENDANT: JANET L. DAVILA; , et al.,

HEC021961

ABSTRACT OF JUDGMENT—CIVIL AND SMALL CLAIMS Amended

FOR COURT FUSE ONLY

1 The judgment creditor assignee of record applies for an abstract of judgment and represents the following:
a. Judgment debtor's

Name and last known address
JANET L. DAVILA;
1400 E MENLO AVE SPC 45
HEMET CA 92544

b. Driver's license No. and state: Unknown
c. Social security No.: 566961618 Unknown
d. Summons or notice of entry of sister-state judgment was personally served or mailed to (name and address): JANET L. DAVILA;
1400 E MENLO AVE SPC 45
HEMET CA 92544

2. Information on additional judgment debtors is shown on page 2.

4. Information on additional judgment creditors is shown on page 2.

3. Judgment creditor (name and address):
CAPITAL ONE BANK

5. Original abstract recorded in this county:

c/o 2325 Clayton Road, Concord, Ca 94520

a. Date:
b. Instrument No.:

Date: 01/05/07 DONALD R. STEBBINS/JANET L. BROWN
KURTISS A. JACOBS/JEROME M. YALON, JR.

(TYPE OR PRINT NAME)

SIGNATURE OF APPLICANT OR ATTORNEY

6. Total amount of judgment as entered or last renewed:
\$ 11,659.39

10. An execution lien attachment lien is endorsed on the judgment as follows:

7. All judgment creditors and debtors are listed on this abstract.

a. Amount: \$
b. In favor of (name and address):

8. a. Judgment entered on (date): 12/22/06
b. Renewal entered on (date):

9. This judgment is an installment judgment.

11. A stay of enforcement has
a. not been ordered by the court

b. been ordered by the court effective until (date):

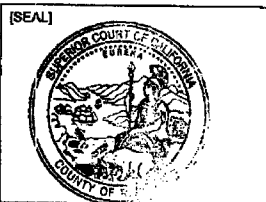

This abstract issued on (date):
JAN 16 2007

12. a. I certify that this is a true and correct abstract of the judgment entered in this action.
b. A certified copy of the judgment is attached.

Clerk, by J. Conner, Deputy

Form Adopted for Mandatory Use
Judicial Council of California
EJ-001 (Rev. January 1, 2006)

ABSTRACT OF JUDGMENT—CIVIL AND SMALL CLAIMS

American LegalNet, Inc.
www.USCourtForms.com

Page 1 of 2
Code of Civil Procedure, §§ 488.480,
674, 700.190



form=ex11&R12

file #:062195-1

Public Record

Recording Requested by

STATE OF CALIFORNIA
FRANCHISE TAX BOARD
Sacramento CA 95812-2952

And When Recorded Mail to

Special Procedures Section
PO BOX 2952
Sacramento CA 95812-2952

DOC # 2009-0665865

12/29/2009 08:00A Fee:NC

Page 1 of 1

Recorded in Official Records

County of Riverside

Larry W. Ward

Assessor, County Clerk & Recorder



0 M
059



NOTICE OF STATE TAX LIEN

FILED WITH: RIVERSIDE

CERTIFICATE NUMBER: 09351303345

The Franchise Tax Board of the State of California hereby certifies that the following named taxpayer(s) is liable under parts 10 or 11 of Division 2 of the Revenue and Taxation Code to the State of California for amount due and required to be paid by said taxpayer as follows:

Name of Taxpayer(s) : JANET L DAVILA

FTB Account Number : 1211881416

Social Security Number(s) : XXX-XX-1618

Last Known Address : PO BOX 2232
: IDYLLWILD CA 92549-2232

For Taxable Years : 2007

TAX	PENALTY	INTEREST	COLLECTION FEES	PAYMENTS	ADJUSTMENTS	* TOTAL
\$1,144.00	\$186.00	\$87.62	\$230.00	\$-15.00	\$-385.00	\$1,247.62

Further interest and fees will accrue at the rate prescribed by law until paid; that the Franchise Tax Board of the State of California complied with all of the provisions of parts 10 or 11 of Division 2 of the Revenue and Taxation Code of the State of California in computing, levying, determining and assessing the tax; the said amounts are due and payable and have not been paid. Said lien attaches to all property and rights to such property now owned or later acquired by the taxpayer.

IN WITNESS WHEREOF, the Franchise Tax Board of the State of California has duly authorized the undersigned to execute this Notice in its name.

DATED: 12/22/09

FRANCHISE TAX BOARD
of the State of California

Collection Bureau
Telephone Number: (916) 845-4350

By:

*Additional interest is accruing at the rate prescribed by law.

Authorized facsimile signature.

FTB 2930 V1 ARCS (REV 03-2008)

Public Record

SITE PLAN: Case # CV-0912072

OWNER(S): JANET L DAVILA
SITE ADDRESS: 52127 ACORN LN, IDYLLWILD
ASSESSOR'S PARCEL: 559-272-002
ACREAGE: 0.180000

NORTH ARROW: 

REAR PROPERTY LINE

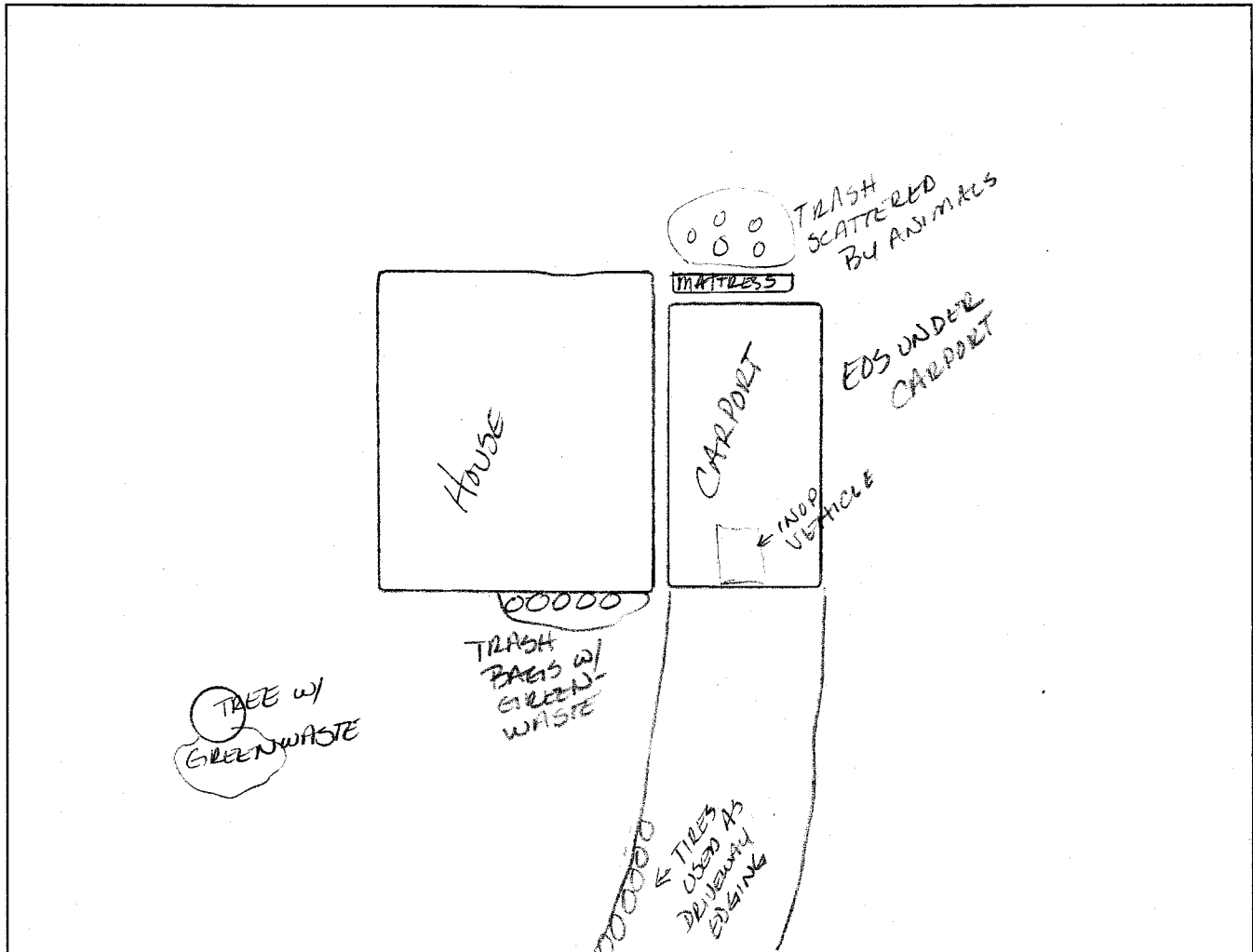

FRONT PROPERTY LINE: 52127 ACORN LN, IDYLLWILD

PREPARED BY: C. Forley DATE: 04-15-10

EXHIBIT NO. D

Photographs



wdurant/photo of trash on site



wdurant/photo of trash on site



wdurant/photo of trash on site



wdurant/photo of trash on site



wdurant/photo of trash on site



wdurant/photo of trash on site

EXHIBIT NO. D²



wdurant/photo of rubbish on site



wdurant/photo of storage on site



CForrey / Greenwaste in front of property



CForrey / Trash under carport



CForrey / Trash under carport



CForrey / Household trash scattered by animal

EXHIBIT NO. _____

D³



CForrey / Mattresses behind carport



CForrey/ overview of property

EXHIBIT NO. _____

D⁴

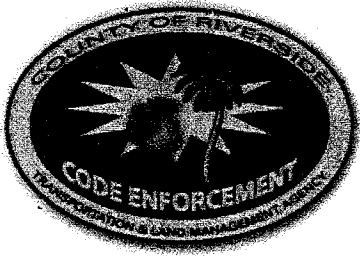

COUNTY OF RIVERSIDE
CODE ENFORCEMENT DEPARTMENT

NOTICE OF VIOLATION

CASE No.: CV -
TBA

THE PROPERTY AT: 52127 ACORN LANE APN#: _____

WAS INSPECTED BY OFFICER: W. DURANT ID#: 46 ON 11-16-09 AT 11:00 ^{am} pm

AND FOUND TO BE IN VIOLATION OF RIVERSIDE COUNTY CODE(S) AS FOLLOWS:

<input type="checkbox"/>	5.28.040 (RCO 593)	Excessive Yard Sales - Cease yard sale. Limit of 3 yard sale events, not over 3 consecutive days, per year.	<input type="checkbox"/>	17.252.030 (RCO 348)	Unpermitted Outdoor Advertising Display - Obtain a permit from the Planning Dept. or remove display.
<input type="checkbox"/>	8.28.030 (RCO 821)	Unfenced Pool - Install or provide adequate fencing to secure the pool.	<input type="checkbox"/>	17.172.205 (RCO 348)	Prohibited Fencing - Remove fence. Fences shall not be constructed of garage doors, tires, pallets or other materials not typically used for the construction of fences.
<input checked="" type="checkbox"/>	8.120.010 (RCO 541)	Accumulated Rubbish - Remove all rubbish & dispose of in an approved legal landfill.	<input type="checkbox"/>	17. _____ (RCO 348)	Excessive Outside Storage: Storage of Unpermitted Mobile Home(s) Not Allowed - Remove unpermitted mobile home(s) from the property.
<input type="checkbox"/>	15.08.010 (RCO 457)	Unpermitted Construction - Cease construction. Obtain the appropriate permits from the Bldg. & Safety and Planning Departments or demolish the _____.	<input type="checkbox"/>	17. _____ (RCO 348)	Occupied RV/Trailer - Cease occupancy & disconnect all utilities to RV/Trailer.
<input type="checkbox"/>	15.12.020(J)(2) (RCO 457)	Unapproved Grading/Clearing - Cease grading/clearing/stockpiling/importing fill. Obtain a Restoration Assessment from the Dept. of Building & Safety. Perform complete restoration and remediation of the property affected by the unapproved grading in accordance with the Restoration Assessment.	<input type="checkbox"/>	17. _____ (RCO 348)	Excessive Animals - Remove or reduce the number of _____ to less than _____.
<input type="checkbox"/>	15.16.020 (RCO 457)	Substandard Structure - Obtain a permit from the Bldg. & Safety Dept. to rehabilitate per Notice of Defects or demolish the structure.	<input type="checkbox"/>	17. _____ (RCO 348)	Unpermitted Land Use: _____ Cease all business activities. Obtain Planning Dept. approval prior to resuming business operations.
<input type="checkbox"/>	15.48.010 (RCO 457)	Unpermitted Mobile Home —Vacate mobile home. Obtain the appropriate permits from the Planning Dept. & Dept. of Bldg. & Safety prior to occupancy or remove Mobile Home.	<input type="checkbox"/>	17. _____ (RCO 348)	Excessive Outside Storage - Remove or reduce all outside storage to less than _____ square feet at the rear of the property.
<input type="checkbox"/>	15.48.040 (RCO 457)	Substandard Mobile Home/Trailer/RV - Obtain a permit from the Bldg. & Safety Dept. to rehabilitate per Notice of Defects and Title 25 or demolish the Mobile Home/Trailer/RV.	<input type="checkbox"/>		
			<input type="checkbox"/>		
			<input type="checkbox"/>		

COMMENTS: PICK UP AND DISPOSE OF BAGS OF TRASH, PINE NEEDLES, AND LITTERED DEBRIS. CLEAN UP ITEMS IN YARD AND UNDER CAR COVER

IMPORTANT! CORRECTION(S) MUST BE COMPLETED BY: 12-16-2009 FAILURE TO COMPLY BY THIS DATE, MAY RESULT IN THE ISSUANCE OF AN ADMINISTRATIVE CITATION WITH FINES UP TO \$500.00 PER DAY, FOR EACH VIOLATION. YOU MAY BE CITED EACH DAY THAT THE VIOLATION(S) EXIST BEYOND THE CORRECTION DATE. IN ADDITION, OTHER ENFORCEMENT ACTION, PENALTIES AND THE IMPOSITION OF A LIEN ON THE PROPERTY FOR THE ABATEMENT AND ENFORCEMENT COSTS MAY RESULT IF COMPLIANCE IS NOT ACHIEVED BY THE CORRECTION DATE.

NOTICE IS HEREBY GIVEN THAT AT THE CONCLUSION OF THIS CASE YOU WILL RECEIVE A SUMMARY OF ADMINISTRATIVE COSTS ASSOCIATED WITH THE PROCESSING OF SUCH VIOLATION(S), AT AN HOURLY RATE OF \$ 109 AS DETERMINED BY THE BOARD OF SUPERVISORS. YOU WILL HAVE THE RIGHT TO OBJECT TO THESE CHARGES BY FILING A REQUEST FOR HEARING WITH THE DEPARTMENT OF CODE ENFORCEMENT WITHIN TEN (10) DAYS OF SERVICE OF THE SUMMARY OF CHARGES, PURSUANT TO RIVERSIDE COUNTY ORDINANCE 725 AND RIVERSIDE COUNTY CODE 1.16.

SIGNATURE PRINT NAME DATE PROPERTY OWNER TENANT

CDL/CID# _____ D.O.B. _____ EXHIBIT NO. E

POSTED



**CODE ENFORCEMENT DEPARTMENT
COUNTY OF RIVERSIDE**

JOHN BOYD
Director

AFFIDAVIT OF POSTING OF NOTICES

November 18, 2009

RE CASE NO: CV0912072

I, Wayne Durant, hereby declare:

I am employed by the Riverside County Code Enforcement Department; that my business address is 39493 Los Alamos Road, Suite #A, Murrieta, California 92563 .

That on 11/16/2009 at 11:00 AM, I securely and conspicuously posted R.C.C. 8.120.010 \"AR\" at the property described as:

Property Address: 52127 ACORN LN, IDYLLWILD

Assessor's Parcel Number: 559-272-002

I declare under the penalty of perjury that the foregoing is true and correct.

Executed on November 18, 2009 in the County of Riverside, California.

CODE ENFORCEMENT DEPARTMENT

By: 
Wayne Durant, Code Enforcement Officer III

EXHIBIT NO. E²



**CODE ENFORCEMENT DEPARTMENT
COUNTY OF RIVERSIDE**

JOHN BOYD
Director

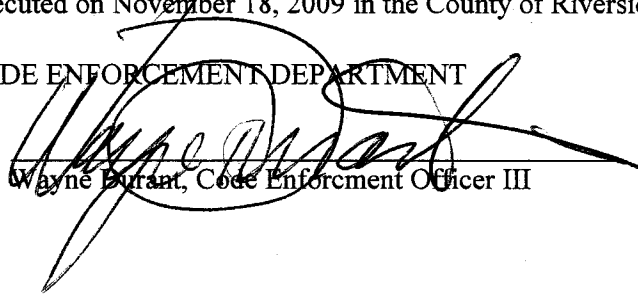
NOTICE OF VIOLATION

November 18, 2009

JANET L DAVILA
P O BOX 2232
IDYLLWILD, CA 92549

RE CASE NO: CV0912072

NOTICE IS HEREBY GIVEN that property owned or controlled by you at 52127 ACORN LN, IDYLLWILD California, Assessor's Parcel Number 559-272-002, is in violation of Section(s) RCC Section No. 8.120.010 (Ord. 541), of the Riverside County Code.

Said violation is described as:

- 1) 8.120.010 (Ord. 541) - No person or entity shall permit the accumulation of rubbish or other material, dangerous or injurious to the health and welfare of persons or the environment, on any real property in the unincorporated area of Riverside County owned by them or under their control.

YOU ARE HEREBY REQUIRED TO COMPLY with the provisions of the ordinance by:

- 1) Remove all rubbish and dispose of it in an approved, legal landfill.

COMPLIANCE MUST BE COMPLETED BY December 16, 2009. FAILURE TO COMPLY WILL RESULT IN LEGAL ACTION BEING BROUGHT AGAINST YOU.

NOTICE IS HEREBY GIVEN THAT AT THE CONCLUSION OF THIS CASE YOU WILL RECEIVE A SUMMARY OF ADMINISTRATIVE COSTS ASSOCIATED WITH THE PROCESSING OF SUCH VIOLATION(S), AT AN HOURLY RATE OF \$109.00 AS DETERMINED BY THE BOARD OF SUPERVISORS.

YOU WILL HAVE THE RIGHT TO OBJECT TO THESE CHARGES BY FILING A REQUEST FOR HEARING WITH THE DEPARTMENT OF CODE ENFORCEMENT WITHIN TEN (10) DAYS OF SERVICE OF THE SUMMARY OF CHARGES, PURSUANT TO SECTION 1.16.080 OF RIVERSIDE COUNTY CODE.

CODE ENFORCEMENT DEPARTMENT

By: Wayne Durant, Code Enforcement Officer III

EXHIBIT NO. E³



**CODE ENFORCEMENT DEPARTMENT
COUNTY OF RIVERSIDE**

JOHN BOYD
Director

PROOF OF SERVICE

Case No. CV0912072

STATE OF CALIFORNIA, COUNTY OF RIVERSIDE

I, Elizabeth Ross, declare that I am a citizen of the United States and am employed in the County of Riverside, over the age of 18 years and not a party to the within action or proceeding; that my business address is at the footer of this notice.

That on November 18, 2009, I served the following documents(s):

NOTICE RE: Notice of Violation

by placing a true copy thereof enclosed in a sealed envelope(s) by **BY CERTIFIED MAIL, RETURN RECEIPT REQUESTED** addressed as follows:

JANET L DAVILA P O BOX 2232, IDYLLWILD, CA 92549

XX **By First Class Mail.** I am readily familiar with the office's practice of collection and processing correspondence for mailing. Under that practice it would be deposited with the U.S. Postal Service with postage thereon fully prepaid in the County of Riverside, California, in the ordinary course of business.

XX **STATE.** I declare under the penalty of perjury under the laws of the State of California that the above is true and correct.

EXECUTED ON November 18, 2009, in the County of Riverside, California.

CODE ENFORCEMENT DEPARTMENT

By: Elizabeth Ross, Code Enforcement Aide

EXHIBIT NO. E4

CERTIFIED MAIL™

County of Riverside
Code Enforcement Department
39493 Los Alamos Road
Murrieta, CA 92563

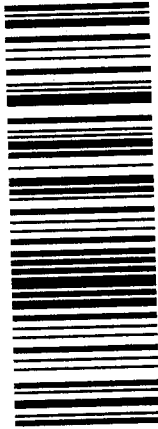

7007 1490 0003 4244 6397

SP

RECD MAR 15 2010 *RS*



Occupant
52127 ACORN LN
IDYLLWILD, CA 92549

RETURN RECEIPT REQUESTED

3254 9256390999



02 1M
0004277091 MAR 11 2010
MAILED FROM ZIP CODE 92504

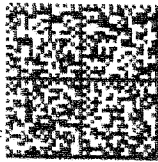

NIXIE 923 SE 1 00 03/13/10

RETURN TO SENDER
NOT DELIVERABLE AS ADDRESSED
UNABLE TO FORWARD

BC: 9256390999 *2404-02899-11-99

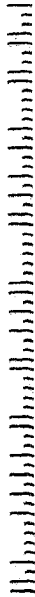

7007 1490 0003 4244 6397

U.S. Postal Service™
CERTIFIED MAIL™ RECEIPT
(Domestic Mail Only; No Insurance Coverage Provided)

For delivery information visit our website at www.usps.com

OFFICIAL USE

Postage	\$	
Certified Fee		
Return Receipt Fee (Endorsement Required)		
Restricted Delivery Fee (Endorsement Required)		

Postmark
Here

Occupant
52127 ACORN LN
IDYLLWILD, CA 92549
CV09-12072 APN: 559

PS Form 3800, August 2006

See Reverse for Instructions

EXHIBIT NO. _____

ES

County of Riverside
Code Enforcement Department
193 Los Alamos Road
Murrieta, CA 92563

CERTIFIED MAIL™

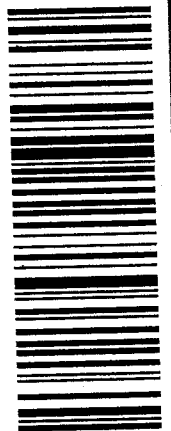

7006 2760 0000 0579 370J

REC'D DEC 08 2009

TURN RECEIPT REQUEST

JANET L DAVILA
P O BOX 2232
IDYLLWILD, CA 92



05039

UNC

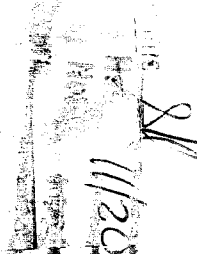

FIRST CLASS

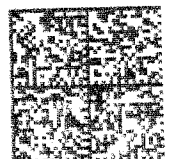

UNITED STATES POSTAGE
\$ 05.540
NOV 19 2009
004234315
02 1M
MAILED FROM ZIP CODE 9250

923 SE 1 00 12/08/09
RETURN TO SENDER
UNCLAIMED
UNABLE TO FORWARD

BC: 92563503993 *2704-00178-19-40

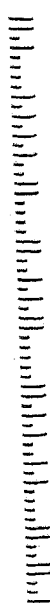

EXHIBIT NO.

EG

U.S. Postal Service™
CERTIFIED MAIL™ RECEIPT
(Domestic Mail Only; No Insurance Coverage Provided)
For delivery information visit our website at www.usps.com

OFFICIAL USE

Postage	\$	
Certified Fee		
Return Receipt Fee (Endorsement Required)		
Restricted Delivery Fee (Endorsement Required)		

Postmark Here

JANET L DAVILA
P O BOX 2232
IDYLLWILD, CA 92549
CV09-12072 APN: 559

PS Form 3800, August 2006 See Reverse for Instructions

102E 6450 0000 0922 9002

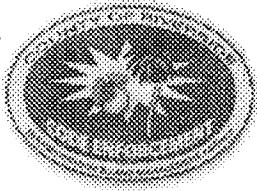

**CODE ENFORCEMENT DEPARTMENT
COUNTY OF RIVERSIDE**

JOHN BOYD
Director

NOTICE OF VIOLATION

March 10, 2010

JANET L DAVILA
P O BOX 2232
IDYLLWILD, CA 92549

RE CASE NO: CV0912072

NOTICE IS HEREBY GIVEN that property owned or controlled by you at 52127 ACORN LN, IDYLLWILD California, Assessor's Parcel Number 559-272-002, is in violation of Section(s) RCC Section No. 8.120.010 (Ord. 541), of the Riverside County Code.

Said violation is described as:

- 1) 8.120.010 (Ord. 541) - No person or entity shall permit the accumulation of rubbish or other material, dangerous or injurious to the health and welfare of persons or the environment, on any real property in the unincorporated area of Riverside County owned by them or under their control.

YOU ARE HEREBY REQUIRED TO COMPLY with the provisions of the ordinance by:

- 1) Remove all rubbish and dispose of it in an approved, legal landfill.

COMPLIANCE MUST BE COMPLETED BY April 9, 2010. FAILURE TO COMPLY WILL RESULT IN LEGAL ACTION BEING BROUGHT AGAINST YOU.

NOTICE IS HEREBY GIVEN THAT AT THE CONCLUSION OF THIS CASE YOU WILL RECEIVE A SUMMARY OF ADMINISTRATIVE COSTS ASSOCIATED WITH THE PROCESSING OF SUCH VIOLATION(S), AT AN HOURLY RATE OF \$109.00 AS DETERMINED BY THE BOARD OF SUPERVISORS.

YOU WILL HAVE THE RIGHT TO OBJECT TO THESE CHARGES BY FILING A REQUEST FOR HEARING WITH THE DEPARTMENT OF CODE ENFORCEMENT WITHIN TEN (10) DAYS OF SERVICE OF THE SUMMARY OF CHARGES, PURSUANT TO SECTION 1.16.080 OF RIVERSIDE COUNTY CODE.

CODE ENFORCEMENT DEPARTMENT

By: Carol Forrey, Code Enforcement Officer

39493 LOS ALAMOS ROAD, SUITE #A, MURRIETA, CALIFORNIA 92563
(951) 600-6140 • FAX (951) 600-6190

EXHIBIT NO. E7



**CODE ENFORCEMENT DEPARTMENT
COUNTY OF RIVERSIDE**

JOHN BOYD
Director

PROOF OF SERVICE

Case No. CV0912072

STATE OF CALIFORNIA, COUNTY OF RIVERSIDE

I, Elizabeth Ross, declare that I am a citizen of the United States and am employed in the County of Riverside, over the age of 18 years and not a party to the within action or proceeding; that my business address is at the footer of this notice.

That on March 10, 2010, I served the following document(s):

NOTICE RE: Notice of Violation

by placing a true copy thereof enclosed in a sealed envelope(s) by **BY CERTIFIED MAIL, RETURN RECEIPT REQUESTED** addressed as follows:

JANET L DAVILA P O BOX 2232, IDYLLWILD, CA 92549
OCCUPANT 52127 ACORN LN, IDYLLWILD, CA 92549
JANET DAVILA 1400 EAST MENLO #45, HEMET, CA 92544
ESKANOS AND ADLER., P.C. 2325 CLAYTON ROAD, CONCORD, CA 94520
State of California Franchise Tax Board Special Procedures Section P.O. Box 2952, Sacramento, Ca. 95812-2952

XX **By First Class Mail.** I am readily familiar with the office's practice of collection and processing correspondence for mailing. Under that practice it would be deposited with the U.S. Postal Service with postage thereon fully prepaid in the County of Riverside, California, in the ordinary course of business.

XX **STATE.** I declare under the penalty of perjury under the laws of the State of California that the above is true and correct.

EXECUTED ON March 10, 2010 in the County of Riverside, California.

CODE ENFORCEMENT DEPARTMENT

Elizabeth Ross

By: Elizabeth Ross, Code Enforcement Aide

EXHIBIT NO. E8

U.S. Postal Service™
CERTIFIED MAIL™ RECEIPT
 (Domestic Mail Only; No Insurance Coverage Provided)

For delivery information visit our website at www.usps.com

OFFICIAL USE

7007 1490 0003 4244 6427

Postage	\$
Certified Fee	
Return Receipt Fee (Endorsement Required)	
Restricted Delivery Fee (Endorsement Required)	

Postmark
Here

State of California Franchise Tax Board
Special Procedures Section
P.O. Box 2952
Sacramento, Ca. 95812-2952
CV09-12072 APN: 559

PS Form 3800, August 2006 See Reverse for Instructions

SENDER: COMPLETE THIS SECTION

- Complete items 1, 2, and 3. Also complete item 4 if Restricted Delivery is desired.
- Print your name and address on the reverse so that we can return the card to you.
- Attach this card to the back of the mailpiece, or on the front if space permits.

1. Article Addressed to:

State of California Franchise Tax Board
Special Procedures Section
P.O. Box 2952
Sacramento, Ca. 95812-2952
CV09-12072 APN: 559

COMPLETE THIS SECTION ON DELIVERY

A. Signature Agent
 Addressee
X
 B. Received By *Joseph Mickelson* Date of Delivery
Joseph Mickelson
 D. Is delivery address different from item 1? Yes
 If YES, enter delivery address below: No

REC'D MAR 18 2010
 MAR 19 2010

ie
 Mail Express Mail
 ed Return Receipt for Merchandise
 Mail C.O.D.

4. Restricted Delivery? (Extra Fee) Yes

2. Article Number
 (Transfer from service label) 7007 1490 0003 4244 6427

EXHIBIT NO. E⁹

U.S. Postal Service™
CERTIFIED MAIL™ RECEIPT
(Domestic Mail Only; No Insurance Coverage Provided)

For delivery information visit our website at www.usps.com®

7007 1490 0003 4244 6410

OFFICIAL USE

Postage	\$
Certified Fee	
Return Receipt Fee (Endorsement Required)	
Restricted Delivery Fee (Endorsement Required)	

Postmark
Here

ESKANOS AND ADLER., P.C.
2325 CLAYTON ROAD
CONCORD, CA 94520
CV09-12072 APN: 559

PS Form 3800, August 2006

See Reverse for Instructions

EXHIBIT NO. E¹⁰



[Home](#) | [Help](#) | [Sign In](#)

[Track & Confirm](#) [FAQs](#)

Track & Confirm

Search Results

Label/Receipt Number: 7007 1490 0003 4244 6410

Service(s): **Certified Mail™**

Status: **Arrival at Unit**

Your item arrived at 9:05 AM on March 16, 2010 in ROCKVILLE, MD 20850. Information, if available, is updated periodically throughout the day. Please check again later.

Track & Confirm

Enter Label/Receipt Number.

[Go >](#)

Notification Options

Track & Confirm by email

Get current event information or updates for your item sent to you or others by email. [Go >](#)

[Site Map](#) [Customer Service](#) [Forms](#) [Gov't Services](#) [Careers](#) [Privacy Policy](#) [Terms of Use](#) [Business Customer Gateway](#)

Copyright© 2010 USPS. All Rights Reserved. No FEAR Act EEO Data FOIA

EXHIBIT NO. E¹¹

CERTIFIED MAIL™

County of Riverside
Code Enforcement Department
39493 Los Alamos Road
Murrieta, CA 92563

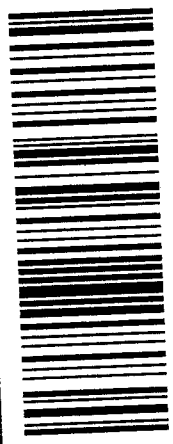

7007 1490 0003 4244 6403

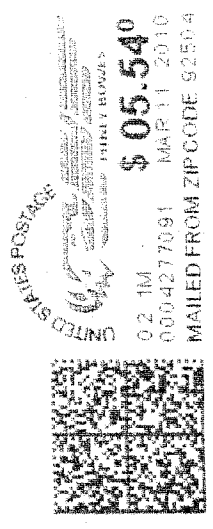

REC'D MAR 19 2010



JANET DAVILA
1400 EAST MENLO #45
HEMET, CA 92544

Handwritten signature: Janet Davila

NIXIE 929 SE 1 OO 09/15/10
RETURN TO SENDER
INSUFFICIENT ADDRESS
UNABLE TO FORWARD

EC: 9256950999 *2504-09919-11-41

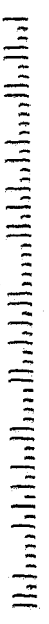

9254425695039

RETURN RECEIPT REQUESTED

7007 1490 0003 4244 6403

U.S. Postal Service™
CERTIFIED MAIL™ RECEIPT
(Domestic Mail Only; No Insurance Coverage Provided)
For delivery information visit our website at www.usps.com

OFFICIAL USE

Postage	\$	
Certified Fee		
Return Receipt Fee (Endorsement Required)		
Restricted Delivery Fee (Endorsement Required)		

Postmark
Here

JANET DAVILA
1400 EAST MENLO #45
HEMET, CA 92544
CV09-12072 APN: 559

PS Form 3800, August 2006 See Reverse for Instructions

EXHIBIT NO. ER

**U.S. Postal Service™
CERTIFIED MAIL™ RECEIPT**
(Domestic Mail Only; No Insurance Coverage Provided)

For delivery information visit our website at www.usps.com

OFFICIAL USE

7007 1490 0003 4244 6380

Postage	\$
Certified Fee	
Return Receipt Fee (Endorsement Required)	
Restricted Delivery Fee (Endorsement Required)	

Postmark
Here

**JANET L DAVILA
P O BOX 2232
IDYLLWILD, CA 92549
CV09-12072 APN: 559**

PS Form 3800, August 2006

See Reverse for Instructions

SENDER: COMPLETE THIS SECTION

- Complete items 1, 2, and 3. Also complete item 4 if Restricted Delivery is desired.
- Print your name and address on the reverse so that we can return the card to you.
- Attach this card to the back of the mailpiece, or on the front if space permits.

1. Article Addressed to:

REC'D APR 04 2010

COMPLETE THIS SECTION ON DELIVERY

A. Signature

X *J Davila*

Agent
 Addressee

B. Received by (Printed Name)

Janet Davila

C. Date of Delivery

3-31-10

Is delivery address different from item 1? Yes
If YES, enter delivery address below: No

**JANET L DAVILA
P O BOX 2232
IDYLLWILD, CA 92549
CV09-12072 APN: 559**

Mail Express Mail
 Registered Mail Return Receipt for Merchandise
 Mail C.O.D.

4. Restricted Delivery? (Extra Fee) Yes

2. Article Number
(Transfer from service label)

7007 1490 0003 4244 6380

PS Form 3811, February 2004

Domestic Return Receipt

102595-02-M-154

EXHIBIT NO.

E13

When recorded please mail to:
Riverside County
Code Enforcement Department
39493 Los Alamos Rd.
Murrieta, CA 92563
Mail Stop No. 5155

DOC # 2010-0120738

03/16/2010 08:00A Fee:NC

Page 1 of 1

Recorded in Official Records

County of Riverside

Larry W. Ward

Assessor, County Clerk & Recorder



006

M
006

NOTICE OF NONCOMPLIANCE

In the matter of the Property of)

Janet L. Davila)

Case No.: CV09-12072

NOTICE IS HEREBY GIVEN to all persons, pursuant to Section 10 of Ordinance Number 725 of the County of Riverside, State of California, that proceedings have been commenced with respect to violations of Riverside County Ordinance No.541, (RCC Title 8.120.010) described as Accumulated Rubbish. Such Proceedings are based upon the noncompliance of such real property, located at 52127 Acorn Lane, Idyllwild, CA, and more particularly described as Assessor's Parcel Number 559-272-002 and having a legal description of 0.18 Acres, MB 54/15, TR 3351, LOT 15, Records of Riverside County, with the requirements of Ordinance No. 541 (RCC Title 8.120.010).

The owner has been advised to immediately correct the above-referenced violation to avoid further action by the County of Riverside, which may include remediation or restoration to abate the public nuisance or other remedies available to the department by a court of competent jurisdiction. Any costs incurred by the County, including, but not limited to investigative, administrative and abatement costs and attorneys' fees, may become a lien on the property. Further details regarding this notice may be obtained by addressing an inquiry to the Code Enforcement Department, 39493 Los Alamos Road, Murrieta, CA 92563; Attention: Code Enforcement Officer C. Forrey (951) 600-6140.

NOTICE IS FURTHER GIVEN in accordance with §17274 and §24436.5 of the California Revenue and Taxation Code, that a tax deduction may not be allowed for interest, taxes, depreciation, or amortization paid or incurred in the taxable year affected by these proceedings.

COUNTY OF RIVERSIDE
DEPARTMENT OF CODE ENFORCEMENT

By: Hector Viray
Hector Viray
Code Enforcement Department

ACKNOWLEDGEMENT

State of California)
County of Riverside)

On 03/10/10 before me, Elizabeth B. Ross, Notary Public, personally appeared Hector Viray, who proved to me on the basis of satisfactory evidence to be the person(s) whose name(s) is/are subscribed to the within instrument and acknowledged to me that he/she/they executed the same in his/her/their authorized capacity(ies), and that by his/her/their signature(s) on the instrument the person(s), or the entity upon behalf of which the person(s) acted, executed the instrument.

I certify under PENALTY OF PERJURY under the laws of the State of California that the foregoing paragraph is true and correct.

WITNESS my hand and official seal.

Elizabeth B. Ross
Commission #1838743 Comm. Expires March 12, 2013

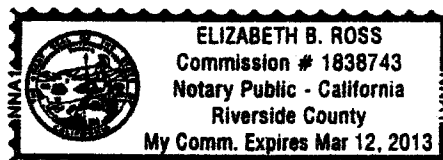

EXHIBIT NO. F

PAMELA J. WALLS
County Counsel

Principal Deputy
KATHERINE A. LIND

OFFICE OF COUNTY COUNSEL
COUNTY OF RIVERSIDE

3960 ORANGE STREET, 5TH FLOOR
RIVERSIDE, CA 92501
TELEPHONE: 951/955-6300
FAX: 951/955-6322 & 955-6363



June 30, 2010

**NOTICE TO CORRECT COUNTY ORDINANCE VIOLATIONS
AND ABATE PUBLIC NUISANCE**

TO: Owners and Interested Parties
(See Attached Proof of Service
and Attached Notice List)

Case No.: CV 09-12072
APN: 559-272-002; DAVILA
Property: 52127 Acorn Lane, Idyllwild

NOTICE IS HEREBY GIVEN that a hearing will be held before the Riverside County Board of Supervisors pursuant to Riverside County Ordinance Nos. 541 (RCC Title 8) and 725 (RCC Title 1) to consider the abatement of the accumulated rubbish located on the SUBJECT PROPERTY described as 52127 Acorn Lane, Idyllwild, **Riverside County, California**, and more particularly described as Assessor's Parcel Number 559-272-002.

YOU ARE HEREBY DIRECTED as owner of the SUBJECT PROPERTY, to appear at this hearing to show cause why the SUBJECT PROPERTY should not be condemned as a public nuisance and be abated by removing the accumulated rubbish from the real property.

SAID HEARING will be held on **Tuesday, August 10, 2010, at 9:30 a.m.** in the Board of Supervisors Room, County Administrative Center, 4080 Lemon Street, 1st Floor Annex, Riverside, California at which time and place pertinent evidence will be received and/or testimony from all concerned parties will be heard. Failure to appear on your behalf will result in the exclusion of your testimony, and facts as known to the Code Enforcement Department ("Department") will be presented to the Board of Supervisors for consideration and deliberation in this matter.

Please be advised that the costs already accrued in this case, including but not limited to, enforcement and investigation costs, are recoverable by the Department, as allowed under Riverside County Ordinance No. 725. The Department may seek recovery of such costs from the property owner(s) which may result in a special assessment lien against the SUBJECT PROPERTY. Additionally, should the Department abate the property, the costs associated therewith, as well as all abatement costs allowed under Riverside County Ordinance No. 725 (RCC Title 1), will be sought from the property owner(s) and/or may result in a special assessment lien against the property.

You are encouraged to contact Supervising Code Enforcement Officer Hector Viray at (951) 600-6140 or the undersigned prior to the hearing. Please meet the undersigned and Brian Black, Supervising Code Enforcement Officer, at 8:30 a.m. on the day of the hearing in the lobby of the 1st floor annex in front of the Clerk of the Board's Office to discuss the case.

PAMELA J. WALLS
Riverside County Counsel



L. ALEXANDRA FONG
Deputy County Counsel

EXHIBIT NO. 6

NOTICE LIST

Subject Property: 52127 Acorn Lane, Idyllwild
Case No.: CV 09-12072 APN: 559-272-002; District 3

JANET L. DAVILA
PO BOX 2232
IDYLLWILD, CA 92549

CAPITAL ONE BANK
C/O ESKANOS & ADLER, PC
2325 CLAYTON ROAD
CONCORD, CA 94520

STATE OF CALIFORNIA
FRANCHISE TAX BOARD
PO BOX 2952
SACRAMENTO, CA 95812

SENDER: COMPLETE THIS SECTION

- Complete items 1, 2, and 3. Also complete item 4 if Restricted Delivery is desired.
- Print your name and address on the reverse so that we can return the card to you.
- Attach this card to the back of the mailpiece, or on the front if space permits.

1. Article Addressed to:

JANET L. DAVILA
PO BOX 2232
IDYLLWILD, CA 92549

2. Article Number
(Transfer from service label)

CV09-12072 (DMA) Art 3

PS Form 3811, February 2004

Domestic Return Receipt

7009 3410 0000 1317 6895

102595-02-M-15

COMPLETE THIS SECTION ON DELIVERY

<p>A. Signature <i>[Signature]</i></p> <p>B. Received by (Printed Name) <i>Ramon Brito</i></p> <p>D. Is delivery address different from item 1? <input checked="" type="checkbox"/> Yes If YES, enter delivery address below: <i>PO BOX 2952</i></p>	<p><input type="checkbox"/> Agent <input type="checkbox"/> Addressee</p> <p>C. Date of Delivery <i>JUL 2 2010</i></p>
--	---

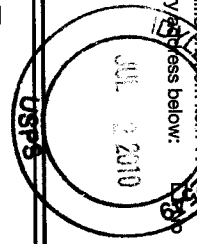

3. Service Type

Certified Mail Express Mail

Registered Return Receipt for Merchandise

Insured Mail C.O.D.

4. Restricted Delivery? (Extra Fee) Yes

SENDER: COMPLETE THIS SECTION

- Complete items 1, 2, and 3. Also complete item 4 if Restricted Delivery is desired.
- Print your name and address on the reverse so that we can return the card to you.
- Attach this card to the back of the mailpiece, or on the front if space permits.

1. Article Addressed to:

STATE OF CALIFORNIA
FRANCHISE TAX BOARD
PO BOX 2952
SACRAMENTO, CA 95812

COMPLETE THIS SECTION ON DELIVERY

<p>A. Signature X <i>Ramon Brito</i></p> <p>B. Received by (Printed Name) <i>Ramon Brito</i></p> <p>D. Is delivery address different from item 1? <input type="checkbox"/> Yes If YES, enter delivery address below: <i>JUL 2 2010</i></p>	<p><input type="checkbox"/> Agent <input type="checkbox"/> Addressee</p> <p>C. Date of Delivery <i>JUL 2 2010</i></p>
---	---

3. Service Type

Certified Mail Express Mail

Registered Return Receipt for Merchandise

Insured Mail C.O.D.

4. Restricted Delivery? (Extra Fee) Yes

2. Article Number
(Transfer from service label)

CV09-12072 (DMA) Art 3

PS Form 3811, February 2004

Domestic Return Receipt

7009 3410 0000 1317 6918

102595-02-M

EXHIBIT NO. 52



[Home](#) | [Help](#) | [Sign In](#)

[Track & Confirm](#) [FAQs](#)

Track & Confirm

Search Results

Label/Receipt Number: **7009 3410 0000 1317 6901**
 Service(s): **Certified Mail™**
 Status: **Delivered**

Your item was delivered at 12:41 PM on July 19, 2010 in ROCKVILLE, MD 20850.

Track & Confirm

Enter Label/Receipt Number.

[Go >](#)

Detailed Results:

- Delivered, July 19, 2010, 12:41 pm, ROCKVILLE, MD 20850
- Forwarded, July 08, 2010, 2:24 pm, CONCORD, CA
- Undeliverable as Addressed, July 07, 2010, 9:55 am, CONCORD, CA 94520
- Forwarded, July 02, 2010, 10:17 pm, CONCORD, CA
- Undeliverable as Addressed, July 02, 2010, 9:54 am, CONCORD, CA 94520
- Arrival at Unit, July 02, 2010, 7:20 am, CONCORD, CA 94520

Notification Options

Track & Confirm by email

Get current event information or updates for your item sent to you or others by email. [Go >](#)

[Site Map](#) [Customer Service](#) [Forms](#) [Gov't Services](#) [Careers](#) [Privacy Policy](#) [Terms of Use](#) [Business Customer Gateway](#)

Copyright© 2010 USPS. All Rights Reserved. No FEAR Act EEO Data FOIA



U.S. Postal Service™ CERTIFIED MAIL™ RECEIPT (Domestic Mail Only; No Insurance Coverage Provided)	
For delivery information visit our website at www.usps.com	
OFFICIAL USE	
Postage	\$ 44
Certified Fee	2.80
Return Receipt Fee (Endorsement Required)	2.30
Restricted Delivery Fee (Endorsement Required)	
Total Postage & Fees	\$ 5.54
Mailed 6/30/10 Postmark Here	
Sent To Street, Ap or PO Box City, State	
CAPITAL ONE BANK C/O ESKANOS & ADLER, PC 2325 CLAYTON ROAD CONCORD, CA 94520	

7009 3410 0000 1317 6901

PS Form 3800, August 2006

See Reverse for Instructions

EXHIBIT NO. _____ G³

1 **PROOF OF SERVICE**

2 Case No. CV 09-12072

3 STATE OF CALIFORNIA, COUNTY OF RIVERSIDE

4 I, Brenda Peeler, declare that I am a citizen of the United States and am employed in the County of
5 Riverside, over the age of 18 years and not a party to the within action or proceeding; that my
6 business address is 3960 Orange Street, 5th Floor, Riverside, California 92501.

7 That on June 30, 2010, I served the following document(s):

8 **NOTICE TO CORRECT COUNTY ORDINANCE VIOLATIONS
9 AND ABATE PUBLIC NUISANCE**

10 by placing a true copy thereof enclosed in a sealed envelope(s) addressed as follows:

11 **Owners or Interested Parties
12 (see attached notice list)**

13 XX **BY CERTIFIED MAIL, RETURN RECEIPT REQUESTED.** I am "readily familiar"
14 with the office's practice of collection and processing correspondence for mailing. Under
15 that practice it would be deposited with the U.S. Postal Service on that same day with
16 postage thereon fully prepaid at Riverside, California, in the ordinary course of business.

17 **BY PERSONAL SERVICE:** I caused to be delivered such envelope(s) by hand to the offices
18 of the addressee(s).

19 XX **STATE - I declare under penalty of perjury under the laws of the State of California that the
20 above is true and correct.**

21 **FEDERAL - I declare that I am employed in the office of a member of the bar of this court at
22 whose direction the service was made.**

23 EXECUTED ON June 30, 2010, at Riverside, California.

24 
25 _____
26 BRENDA PEELER
27
28

EXHIBIT NO. 64